

DRURY-0020-A1

Load: 16

AUTIO

DIAMOND DRILL RECORD

Hole No. 1 Sheet No. 1

Property Location DRURY TWP. S.E. 1/4 of South
half lot 5, con. 3

-20.00 Dip _____
Total Footage _____

Elev. Coll. _____
Datum _____
Date Started Nov. 14
Date Completed Nov. 16
Drilled by H. Autio
Logged by J. P. McGregor

Footage		Formation	Sample Number	Sample Footage	Sample Width	Gold Sample	Gold Sludge	Remarks
From	To							
0.0		COLLAR						
0.0	20.4	Gabbro, mass, med. grain, rare spot sulfide pyrrhotite						
20.4	20.5	Sulfide, chalcopyrite - pyrrhotite stringer, contact vague						
20.5	44.0	Gabbro, mass, med. grain						
	44.0	END OF HOLE						

Date of Examination NOV. 21, 1954

Harvey Carter Autio

DIAMOND DRILL RECORD

Hole No. 2

Sheet No. 1

-27.00

ft

Property _____
Location DRURY TWP., S.E. $\frac{1}{4}$, of South _____
 half lot 5, con. 3 _____
Latitude _____
Departure _____
Bearing _____

Total Footage _____

Elev. Collar _____
Datum _____
Date Started Nov. 16 _____
Date Completed Nov. 17 _____
Drilled by H. Antio _____
Logged by J. P. McGregor _____

Footage		Formation	Sample Number	Sample Footage	Sample Width	Gold Sample	Gold Sludge	Remarks
From	To							
0.0		COLLAR						
0.0	22.0	Gabbro, mass, occasional short sect shows few spot sulfide						
22.0	23.5	Gabbro as above except small spot pyrrhotite common						
23.5	24.0	Sulfide, prom fine disseminated pyrrhotite with minor associated chalcopyrite of lower contact						
24.0	35.0	Gabbro, mass						
	35.0	END OF HOLE						

Date of Examination NOV. 21, 1954

Harvey Antio

DIAMOND DRILL RECORD

Hole No. 3 Sheet No. 1

Property Location DRURY TWP., S.E. 1/4 of South half lot 5, con. 3

-45.00

Dip

Elev. Collar _____
 Datum _____
 Date Started Nov. 16
 Date Completed Nov. 18
 Drilled by H. Autio
 Logged by J. P. McGregor

Latitude _____
 Departure _____
 Bearing _____

Total Footage _____

Footage		Formation	Sample Number	Sample Footage	Sample Width	Gold Sample	Gold Sludge	Remarks
From	To							
0.0		COLLAR						
0.0	50.0	Gabbro, mass, medium grain with local minor variation, sulfide rare						
	50.0	END OF HOLE						

Date of Examination NOV. 21, 1954

Harvey Autio

DIAMOND DRILL RECORD

Hole No. 4 Sheet No. 1

Property Location DRURY TWP., S.E. 1/4 of South half of lot 5, con. 3

-5.00

Dip

Elev. Collar _____
 Date _____
 Date Started Nov. 18
 Date Completed Nov. 20
 Drilled by H. Autio
 Logged by J. P. McGregor

Latitude _____
 Longitude _____
 Bearing _____

Total Footage

Footage		Formation	Sample Number	Sample Footage	Sample Width	Gold Sample	Gold Sludge	Remarks
From	To							
0.0		COLLAR						
0.0	6.8	Gabbro, mass, medium grain						
6.8	7.5	Sulfide, composed of elongate spots of & diss pyrrhotite						
7.5	22.5	Gabbro, mass, medium grain						
22.5	23.5	Sulfide, very heavy fine disseminated pyrrhotite minor associated chalcopyrite at upper contact						
23.5	24.5	Gabbro, mass, medium grain						
24.5	24.9	Sulfide, zone of prom small spots & some diss pyrrhotite						
24.9	25.3	Gabbro, massive, medium grain						
25.3	25.4	Sulfide, vague stringer disseminated pyrrhotite						
25.4	27.0	Gabbro, mass, medium grain						
27.0	27.5	Sulfide, prominent fine disseminated pyrrhotite						
27.5	35.0	Gabbro, mass, med. grain						
	35.0	END OF HOLE						

Date of Examination NOV. 21, 1954

Harvey Carter

DIAMOND DRILL RECORD

Hole No. 5 Sheet No. 1

Property Location DRURY TWP., S.E. 1/4, of South
half lot 5, con. 3

± 5.00 Dip

Latitude _____
Departure _____
Clearing _____

Total Footage _____

Elev. Collar _____
Datum _____
Date Started Nov. 21
Date Completed Nov. 22
Drilled by H. Autio
Logged by J. P. McGregor

Footage		Formation	Sample Number	Sample Footage	Sample Width	Gold Sample	Gold Sludge	Remarks
From	To							
0.0		COLLAR						
0.0	7.3	Gabbro, mass, medium grain						
7.3	7.5	Sulfide, vague str. concentration of elongate spots of pyrrhotite with diss pyrrhotite between						
7.5	22.4	Gabbro, mass, medium grain, occasional chlorite slip, rare speck pyrrhotite						
22.4	23.4	Sulfide, very strong fine disseminated pyrrhotite, sharp contacts at 45°						
23.4	24.4	Gabbro, mass, medium grain						
24.4	24.9	Sulfide, quite heavy fine disseminated pyrrhotite						
24.9	33.0	Gabbro, mass, medium grain						
	33.0	END OF HOLE						

Date of Examination NOV. 21, 1954

Harry Autio

NORTH

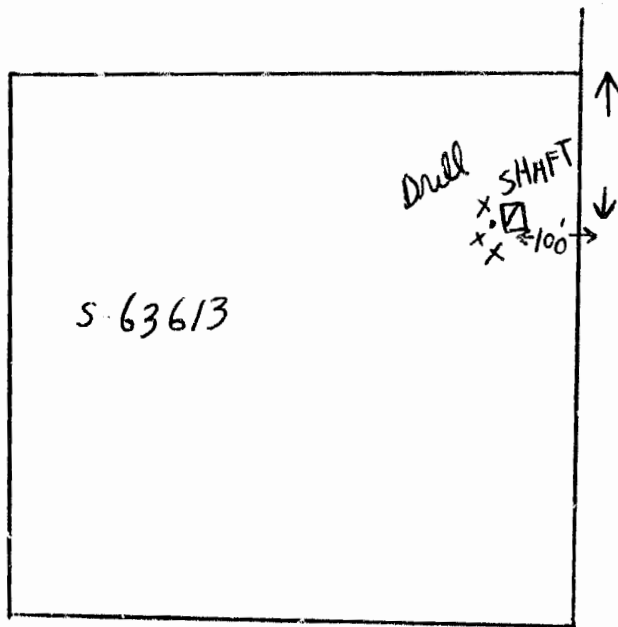

SE $\frac{1}{4}$ of S $\frac{1}{2}$ lot 5 (on 111 Drury.

Claim No S-63613

Harvey Auto Drury sp.

DIAMOND DRILL RECORD

Hole No. 2 Sheet No. 1

Property _____
 Location Drury township
N.E. 1/4 of S. 1/2
Lot 5, commission 3
 Latitude _____
 Departure _____
 bearing _____

Dip +50° 00'

Elev. Collar _____
 Datum _____
 Date Started _____
 Date Completed _____
 Drilled by H. Auto
 Logged by HRH. Cook

Total Footage _____

Footage		Formation	Sample Number	Sample Footage	Sample Width	Gold Sample	Gold Sludge	Remarks
From	To							
0.0	10.0	Collar						
0.0	50.0	Gabbro, massive medium grained, local variations grain size and color, occasional salic clotty zones and rare narrow biotite rich bands.						
50.0	65.0	Gabbro, as above but slightly darker grey color and finer grain size.						
65.0	90.0	Gabbro, light grey green to medium grey, medium grain size, uniform texture.						
0.0	0.0	Collar						
0.0	50.0	Gabbro, massive medium grained, local variations grain size and color, occasional salic clotty zones and rare narrow biotite rich bands.						
50.0	65.0	Gabbro, as above but slightly darker grey colour and finer grain size.						
65.0	90.0	Gabbro, light grey green to medium grey, medium grain size, uniform texture.						

Date of Examination August 10, 1957

HRH. Cook

DIAMOND DRILLING.

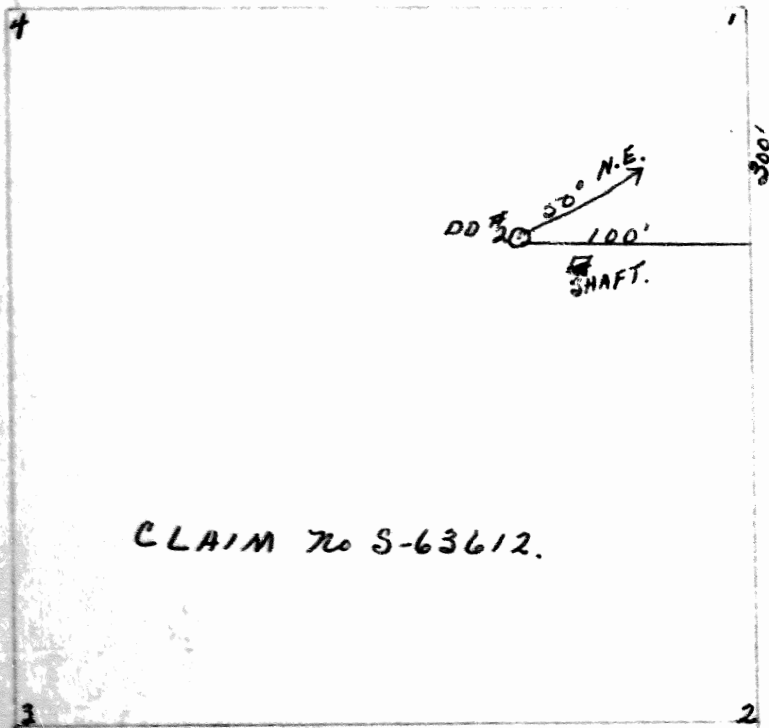

CLAIM No S-63612.

DIAMOND DRILL RECORD

Hole No. 3

Sheet No. 2

Property _____
 Location Dancy township
N.W. 1/4 of S. 1/2 of T. 16 S
R. 10 E. N. 3
 Latitude _____
 Departure _____
 Bearing _____

Dip 17° 00'

Total Footage 40' 00"

Elev. Collar _____
 Datum _____
 Date Started _____
 Date Completed _____
 Drilled by H. Austria
 Logged by MRH Cook

Footage		Formation	Sample Number	Sample Footage	Sample Width	Gold Sample	Gold Sludge	Remarks
From	To							
0.0	0.0	Collar						
0.0	40.0	<i>Gabbro, massive medium grained grey to dark grey green, even texture with occasional saddle clots, rare chlorite slips</i>						
		Collar						
0.0	40.0	Gabbro, massive medium grained grey to dark grey green, even texture with occasional saddle clots, rare chlorite slips						

Date of Examination August 10, 1957

MRH. Cook

DIAMOND DRILLING

4

1

310'

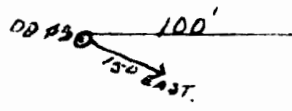

CLAIM No S-63612

3.

2.

DIAMOND DRILL RECORD

Hole No. /

Sheet No. /

Property

Location Denny Township, N.E. 1/4 of S. 3
T. 5, R. 3, Con. 3

Latitude

Departure

Bearing

Dip

+ 70° 10'

Elev. Collar

Datum

Date Started

Date Completed

Drilled by

Logged by

H. R. Cook
A.P.H. Cook

Total Footage

37.0

Footage		Formation	Sample Number	Sample Footage	Sample Width	Gold Sample	Gold Sludge	Remarks
From	To							
0.0		Collar						
0.0	35.0	Gabbro, massive medium grained medium grey green colour with even texture and grain size, throughout occasional iron stained chlorite slips cut the core at generally acute low angles.						
		Collar						
0.0	35.0	Gabbro, massive medium grained medium grey green colour with even texture and grain size, throughout occasional iron stained chlorite slips cut the core at generally acute low angles.						

Date of Examination

August 10, 1957

A.P.H. Cook

Trill Twp. (M-1163)

scale: 1 inch = 40 chains.

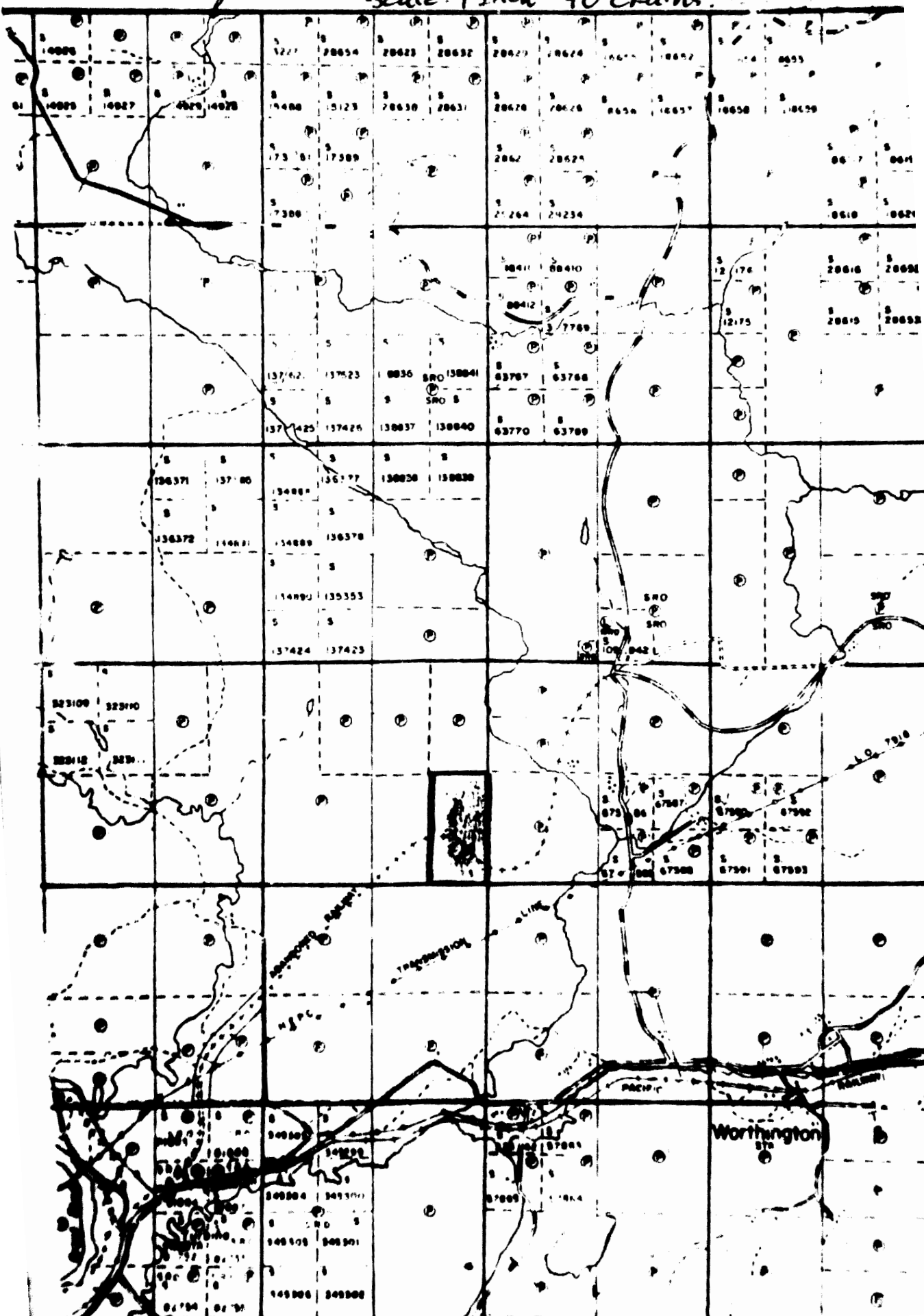

DIAMOND DRILLING

4

10

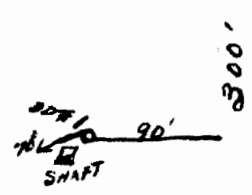

CLAIM No S-63612.

7

11

scale: 1 Inch = 40 chains.

