



010

Diamond Drilling

Township of Drury

Report NO: 20

Work performed by: B.W. Lang/Acme Gas & Oil co. Ltd.

Claim NO	Hole NO	Footage	Date	Note
S 137420	A.Q.#1	152'	Apr/67	(1)
S 137424	A.Q.#2	71'	May/67	(2)
Total: 2 DH		223 FT		

Notes:

- (1) 67(C)
- (2) 67 (D)

DIAMOND DRILL RECORD

PROPERTY Drury Township - Claim S-137423

HOLE No. A.Q.# 1

SHEET NUMBER 1

SECTION FROM TO

STARTED April 17th, 1967

LATITUDE

DATUM

COMPLETED April 28th, 1967

DEPARTURE

BEARING S-07 deg. E

ULTIMATE DEPTH 152

Drilled by : Acme Gas & Oil

ELEVATION

DIP -45 deg.

~~XXXXXXXXXX~~

DEPTH FEET	FORMATION	SAMPLE NO	FROM	TO	WIDTH	ASSAY VALUES			
0 - 17	Casing								
17 - 19	Arkose (Boulder?) pinkish grey, feldspar and quartz, coarse grained with dark grey chloritic matrix.								
19 -123	Quartzite pale grey to medium grey, fine grained, well bedded quartzite with occasional vague pebble, a few beds sericitic imparting waxy green colour, minor disseminated pyrite, bedding 60 deg. to core axis. 98-123 strongly colour banded 115-117 dark, well bedded greywacke.								
123 -138	Greywacke, dark grey to white colour banded well bedded, very fine grained, equigranular.								
138 -152	Phyllite, dark grey-green very fine grained soft, chloritic.								
152 -	END								

**DUPLICATE COPY
POOR QUALITY ORIGINAL
TO FOLLOW**

DIAMOND DRILL HOLE RECORD, DDH No. A.O. #1

 PROPERTY Drury Township

 CLAIM S-137423

 SHEET No. 1

LATITUDE _____ BEARING S-07 deg. E. STARTED April 17th, 1967
 DEPARTURE _____ DIP. - 45 deg. COMPLETED April 28th, 1967
 ELEVATION _____ HORIZ. _____ VERT. _____ DEPTH 152

 DRILLED BY Acme Gas & Oil

DEPTH - FEET	FORMATION	SAMPLE NO.	FROM	TO	WIDTH	VALUES				ECONOMIC GEOLOGY MINERALIZATION
0 - 17	Casing									
17 - 19	Arkose (Boulder?) pinkish grey, feldspar and quartz, coarse grained with dark grey chloritic matrix.									
19 - 123	Quartzite, pale grey to medium grey, fine grained, well bedded quartzite with occa- sional vague pebble, a few beds sericitic imparting waxy green colour, minor disse- minated pyrite, bedding 60 deg. to core axis. 98-123 strongly colour banded. 115-117 dark, well bedded greywacke.									
123-138	Greywacke, dark grey to white colour banded well bedded, very fine grained, equigranular									
138 - 152	Phyllite, dark grey-green very fine grained soft, chloritic.									
	152 - END									

ENGINEER

DIAMOND DRILL RECORD

PROPERTY Drury Township - Claim S-137424

HOLE No. A.Q # 2

SHEET NUMBER 1

SECTION FROM TO

STARTED May 3rd, 1967

LATITUDE

DATUM

COMPLETED May 9th, 1967

DEPARTURE

BEARING S-07 deg. E

ULTIMATE DEPTH 71

ELEVATION

DIP - 45 deg.

PROPOSED DEPTH

DEPTH FEET	FORMATION	SAMPLE NO	FROM	TO	WIDTH	ASSAY VALUES			
0 - 15.5	Casing								
15.5-18	Greywacke, dark grey fine grained bedded 63 deg. to core axis.								
18 - 71	Quartzite, pale greyish to grey to waxy greenish fine grained, well bedded colour banded, 55 deg. to core axis, locally trace pyrite.								
	71 - END								

Drilled By : Acme Gas & Oil Co. Ltd.

**DUPLICATE COPY
POOR QUALITY ORIGINAL
TO FOLLOW**



41106NW0057 0012A1 DRURY

900

July 28, 1967.

Dr. J. F. Donovan,
Resident Geologist,
172 Elm Street W.,
Sudbury, Ontario.

Dear Dr. Donovan:

Enclosed are drill hole records and
sketches for work performed on claims S-137423 and
S-137424, Drury Township, in the name of B. W. Lang.

Yours very truly,

K. M. Hallock
Mining Recorder

KMH/mr

2. D. D. H.

SEE ACCOMPANYING
MAP(S) IDENTIFIED AS
DRURY-0012-A1 #1, #2

LOCATED IN THE MAP
CHANNEL IN THE FOLLOWING
SEQUENCE (X)

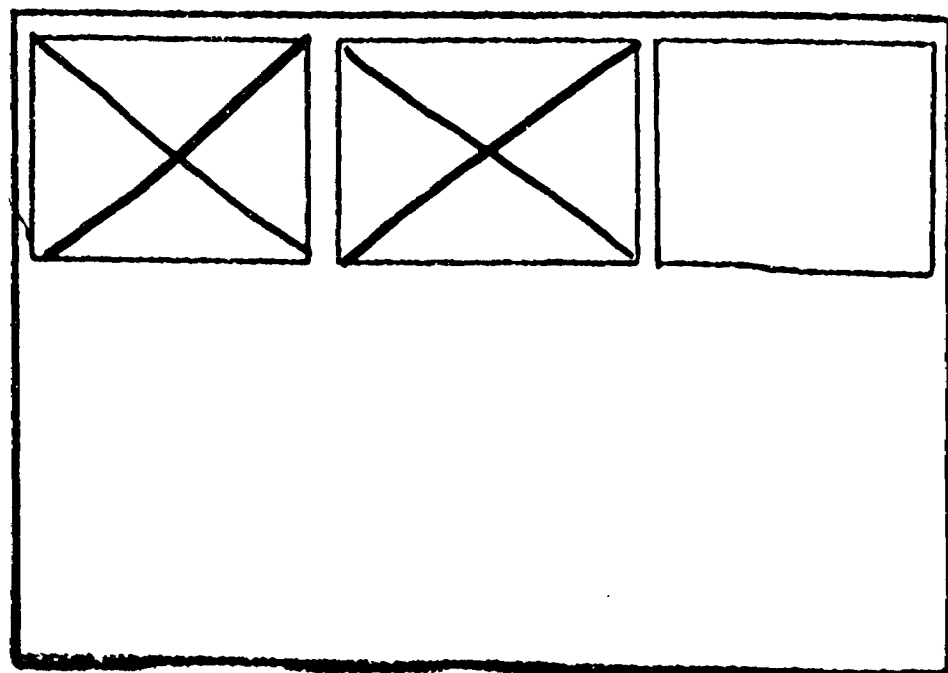

LOCATION MAP 1" = 400'

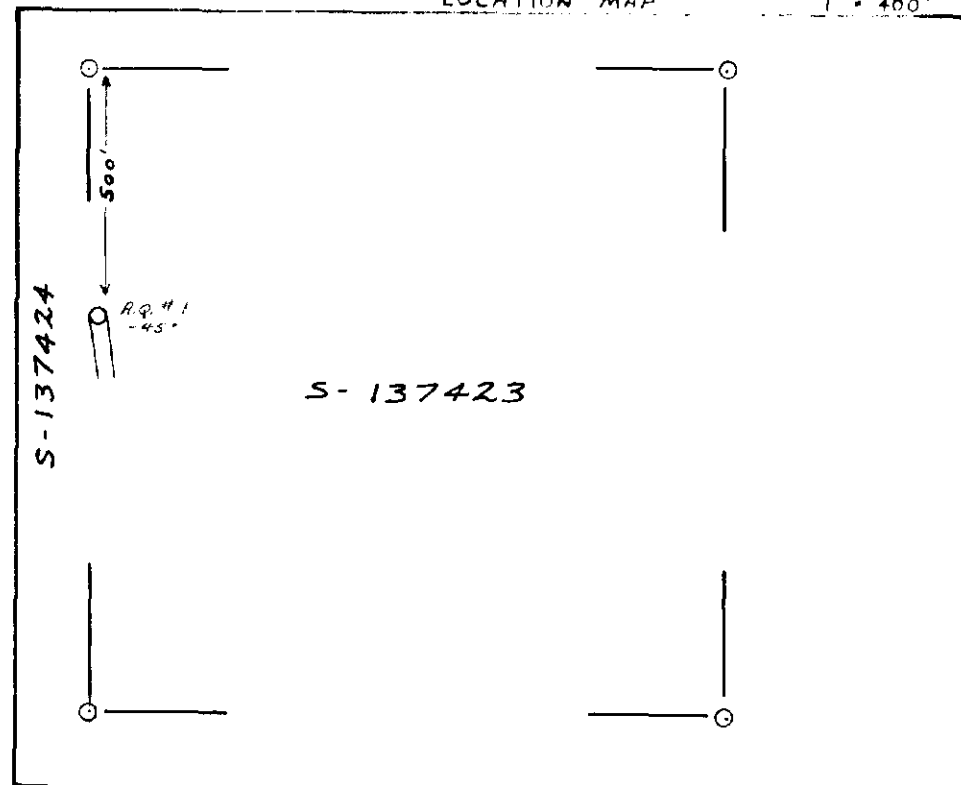

645-5

19' 11" Casing
 Arkose (boulder?)
 Quartzite - pale gray to mid gray
 fine grained.
 123' Graywacke dk grey
 152' Phyllite, dk grey-green.

L-1420-E

ACME GAS AND OIL CO. LTD.

DRURY TWP.

D.D.H. A.Q. # 1

CLAIM S-137423

SECTION BEARING SOUTH - 07° EAST.

Scale: 1" = 100'

Date: July 8/67.

DRURY-0012-A1 #1



41106NW0057 0012A1 DRURY

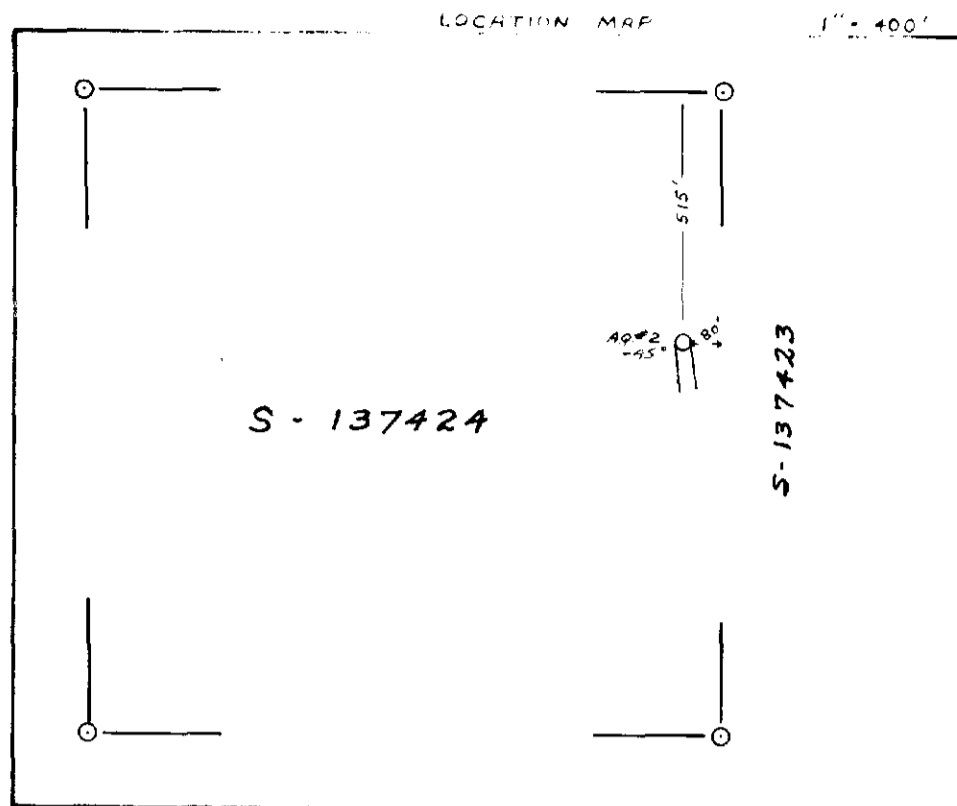

6-20-S

153' cutting
18' graywacke, dk. gray fine grained
71' Quantity pale grayish to grey to waxy green
fine grained.
Trace by

L-13+20-E

ACME GAS AND OIL CO. LTD.
DRURY TWP.
D.D.H. A.G. # 2
CLAIM S - 137424
SECTION BEARING SOUTH- 07° EAST.

Scale 1" = 100'

Date JULY 8/67.

DRURY-0012-A1 #2



41106N0057 0012A1 DRURY