



41106NW0301 FAIRBANK18C1 FAIRBANK

010

SUDBAY EXPLORATION & MINING CO. LTD.Log of Diamond Drill Hole #1

Claim S. 60335

Location: 728 S., 50 W. (Quartz vein)
 Dip at collar: 45°
 Bearing: S. 61½° E. Ast.
 Logged by: E. K. Fockler - August 16th, 1952
 Hole completed: August 10th, 1952.

0' - 5'	Casing	
5' - 33'.4	Micropegmatite, massive.	
33'.4 - 44'.8	Quartz shear	
	33'.4 - 34'.8	--Sheared micropegmatite with 5%-10% quartz stringers and silicification, nil sulphides.
	34'.8 - 36'.4	--50% vein quartz with sheared micropegmatite inclusion material, very scant sulphides, chalcopyrite.
	36'.4 - 41'.0	--At 36' - leached, slightly rusted. --Silicified micropegmatite with quartz chlorite stringers at 39½'.
	41'.0 - 44'.8	Slightly disseminated fine arsenopyrite. --From 40' - 40'.5 - Lost core --Vein material; 80%+ quartz with chlorite - leached, slightly rusted sections - 1% sulphides, chalcopyrite, trace galena at 42½'.
44'.8 - 80'	Micropegmatite, massive.	--From 69' - 69'.5 - Barren white quartz.
80'	END OF HOLE.	

N.B. - Hole started August 8, 1952 - Water lost at 20'

SOLE #1 - SAMPLE RECORD

<u>No.</u>	<u>Footage</u>	<u>Core Length</u>	<u>ASSAY</u>	
			<u>Gold</u>	<u>Silver</u>
006	34'.8 - 40'	5'.2	nil	trace
	40'.0 - 40'.5	.5	Lost core	
	40'.5 - 41'	.5	Barren micropegmatite	
007	41' - 44'.8	3'.8	Nil	trace

SUDBAY EXPLORATION & MINING CO. LTD.

Log of Diamond Drill Hole #2

Location: 728 E., 100 W. (Quartz vein) Claim S. 60335
 Bearing: S. 61 $\frac{1}{2}$ E. Ast.
 Dip at collar: 49°
 Elevation: 4' above D.D. Hole #1
 Logged by: E. K. Fockler - August 16th, 1952
 Hole completed: August 18th, 1952.

0' - 12'	Casing.	
12' - 64'	Micropegmatite, massive.	
64' - 68'.0	Quartz shear - 40% vein quartz with sheared, altered micropegmatite inclusions.	
		--From 68'.2 - 87'.5 (1'.8) with 1-2% galena, chalcopyrite, pyrite, pyrrhotite in seams, with chlorite.
		--At 68' - Crushed galena on slip.
68' - 126'	Micropegmatite, massive.	--At 69' - $\frac{1}{2}$ " barren quartz stringers.
		--At 69'.5 - 1" quartz with slight galena.
		--At 69'.5 - 1/8" barren quartz carbonate.
126'	END OF HOLE.	

N.B. - Hole cemented at 66' where water lost.
 Sludge recovered from 60' - 66'.5
 66'.5 - 80'

HOLE #2 - SAMPLE RECORD

No.	Footage	Core Length	Assay	
			Gold	Silver
008	64' - 68'	4'.0	Nil	Trace

SUDBAY EXPLORATION & MINING CO. LTD.

Log of Diamond Drill Hole #3

Claim S. 80335

Location: 648 S., 50' W. (Quartz vein)
 Bearing: E. 51 1/2° E. Apt.
 Dip at collar: 45°
 Elevation: 2' below D. D. #1
 Hole completed: August 14th, 1952
 Logged by: E. K. Fockler - August 16th, 1952.

0' - 5 1/2'	Casing.	
5 1/2' - 32'	Micropegmatite, massive.	
	31 1/2' - 32'	--Slightly altered
32' - 40.6'	Quartz shear	
	32' - 33'	--15-20% quartz leached. From 32 1/2' - 33' - 3 - 5% chalcopyrite, galena in broken leached material.
	33' - 35' .2	--Lost core - rusty broken material washed away.
	35' .2 - 38' .7	--80% white vein quartz with chlorite. - 1% disseminated chalcopyrite, galena.
	38' .7 - 40' .6	--Reddish alteration, of massive micropegmatite with 5% quartz stringers. Nil sulphides.
40' .6 - 75 1/2'	Micropegmatite, massive, grey, medium grained.	
75 1/2'	End of hole.	

M.B. - Sludge received throughout hole.

SOLE #3 - SAMPLE RECORD

<u>No.</u>	<u>Footage</u>	<u>Core Length</u>	<u>ASSAY</u>			
			<u>Gold</u>	<u>Silver</u>	<u>LEAD</u>	<u>Copper</u>
009	30' - 40' (sludge)	10'	nil	0.78	1.89	0.15

SUDBAY EXPLORATION & MINING CO., LTD.

Log of Diamond Drill Hole #4

Claim S. 60335

Location: 648 S., 100' W. (Quartz vein)
 Bearing: S. 81° E. Ast.
 Dip at collar: 51°
 Elevation: 82' above D.D. #3
 Hole completed: August 18, 1952
 Logged by: E. K. Fockler - August 18, 1952

- 0' - 6' Casing.
- 6' - 42' Micropegmatite, massive.
 - From 22' - 23'.5 pink silicification.
- 42' - 47' Vein shear.
 - 42' - 43' --1/8" barren quartz stringer. Parallel core.
 - 43' - 44'.5 --Sheared, altered, nil sulphides.
 - 44'.5 - 46'.5 --Pink silicification with 5 - 7% quartz stringers, i.e. At 44'.6 - 2" barren quartz-chlorite. At 45'.8 - 1" badly leached with fine chalcopyrite in vugs in quartz.
 - 46'.5 - 47' --Altered, sheared micropegmatite.
- 47' - 58' Micropegmatite, massive.
 - 47' - 49' --moderately altered and sheared, no sulphides, no vein.
- 58' - 75' Altered, sheared micropegmatite.
 - 58' - 59' --Pink alteration, 2 1/2" barren quartz stringer.
 - 59' - 58 1/2' --Lost core. At 62' - 1" barren white quartz stringer. From 74' - 74'.6 - Vein material. 30% quartz vein with chlorite, 2-5% pyrite with galena.
- 75' - 97' Slight alteration, slightly sheared.
 - At 78' - 1/2" white calcite.
 - At 89'.3 - Epidote development.

SUDBAY EXPLORATION & MINING CO. LTD.

From 94' - 96' - high silicification, occasional 1/8" barren quartz seams.

97' - 126' Massive micropegmatite.
126' End of hole.

HOLE #4 - SAMPLE RECORD

<u>No.</u>	<u>Footage</u>	<u>Core length</u>	<u>A S S A Y</u>	
			<u>Au.</u>	<u>Ag.</u>
010	44'.5 - 46'.5	2'.0	nil	trace

SUDBAY EXPLORATION & MINING CO., LTD.

Log of Diamond Drill Hole #8

Location: 800 E., 100 W. Claim S. 60335
 Dip at collar: 50°
 Elevation: 4½' below D.D. #4
 Bearing: 86½° E. Ast.
 Logged by: E. K. Fockler - August 19th, 1952
 Abandoned in overburden - August 18th, 1952.

0'	-	10'	Casing	
10'	-	20'	Micropegmatite	
		10'	- 14½'	--Well sheared - 45' to core, fine grained, grey.
		14½'	- 15'	--Lost core
		15'	- 15½'	--Sheared
		15½'	- 16½'	--Lost core
		16½'	- 20'	--Moderately sheared; nil sul- phides.

20' Hole ran out of ledge.

M.A.B. - No samples

BUDRAY EXPLORATION & MINING CO. LTD.

Log of Diamond Drill Hole #5A

Location: Same as Hole #5
Bearing: " " " " Claim S. 60835
Dip at collar: 58.9°
Completed: August 19th, 1952
Logged by: R. E. Fockler - August 19th, 1952

0' - 15'	Casing
15' - 75'	Micropegmatite.
	15' - 40' --Moderately sheared and silicified. 40' - 75' --Massive, grey.
75' - 78'	Veined shear - pinkish alteration (silicification with 3 - 4" barren quartz stringers (50' to core) with chlorite development.
78' - 107'.8	Micropegmatite; massive, pinkish to grey, medium grained; no veining, nil sulphides.
107'.8	END OF HOLE

H.B. - No samples (sludge recovered)

SUDBAY EXPLORATION & MINING CO., LTD.

Log of Diamond Drill Hole #6

Location: Claim S. 60355
7+80 S; 100' W.
Bearing: S. 61 $\frac{1}{2}$ ° E. Ast.
Dip at Collar: 50°, at 125' - 49° corrected
Elevation: 8' below D. D. #2
Logged by: A. E. Jerome
Hole completed: Aug. 21, 1952.

0' - 14' Casing.
14' - 72' Micropegmatite.
72' - 85'.1 Sheared zone;
72' - 74 $\frac{1}{2}$ ' --Altered
74 $\frac{1}{2}$ ' - 78 $\frac{1}{2}$ ' --Sheared, no mineralization.
77 $\frac{1}{2}$ ' - 85'.1 --Sheared, silicified.
From 82' to 82'.7 - scant pyrrho-
tite, chalcopyrite.
85'.1 - 127' Micropegmatite; coarse grained.
127' END OF HOLE.

SUBBAY EXPLORATION & MINING CO. LTD.

Log of Diamond Drill Hole #7

Location: Collar on claim S. 62109
150' North, 250' West (Base Line Ref.)
Bearing: S. 80° E. Ast.
Dip at collar: 45° (no dip tests)
Elevation of Collar: 20' above D.D. Hole #3
Hole completed: Sept. 6th, 1952
Logged by: A. E. Jerome

0' - 15' Casing.

15' - 250' Micropegmatite;
15' - 185' --Dark type
185' - 191' --Altered, aplitic
191' - 193' --Dark, diabasic
193' - 250' --Grey type

250' - 264½' Brecciated aplitic zone; highly carbonated (apple green colour over 25% of core), no mineralization.

264½' - 271' Highly fractured, carbonated along slips.

271' - 707' Micropegmatite;
271' - 314½' --Dark type, dioritic, moderately fractured
314½' - 364' --Grey type
364 - 707' --Dark type, appears dioritic in texture.

707' END OF HOLE.

N.B. - At 350' D.D. Hole #7 enters Claim S. 62108 for balance of footage, i.e. 357'.

SUDBAY EXPLORATION & MINING CO. LTD.

Log of Diamond Drill Hole #8

Location: Claim S. 60887
1700 S, 100' W. (Base Line ref.)
Bearing: E. 80° E. Ast.
Dip at Collar: 45° (no dip tests)
Elevation: Same as D. D. Hole #2
Hole Completed: Sept. 15th, 1952.
Logged by: A. E. Jerome

0'	-	10'	Casing.		
10'	-	106½'	Micropegmatite;		
		38'	-	39'	--Aplitic
		45'	-	58'	--Aplitic
106½'	-	108'	Sheared and aplitic, resembling silicification associated with quartz vein.		
108'	-	405'	Micropegmatite;		
					--At 135½' - 2" calcite.
405'			END OF HOLE.		

SURBAY EXPLORATION & MINING CO., LTD.

Log of Diamond Drill Hole #9

Location: Claim S. 60316
 450' N. and 135' E. of #5 Post - Claim S. 60316
 Bearing: N. 40° W. Ast.
 Dip at Collar: 45° - @ 100' - 43° corrected
 200' - 42° " "
 500' - 36° " "
 400' - 34° " "
 500' - 33° " "
 600' - 37° " "
 700' - 44° " "

Hole completed: Oct. 8th, 1952
 Logged by: E. K. Fockler, Oct. 18th, 1952

0' - 4' Casing.
 4' - 147' Basic tuffs; dark grey, finely grained, uniformly bedded.
 147' - 159' Silicified shear; with occasional seams and stringers of mineralized blue quartz.
 --From 151½' - 154½' - 1 - 2% fine chalcopryite mixed with 2 - 3% fine pyrrhotite, some pyrite.
 159' - 233' Basic tuffs; as above, with light scattered pyrrhotite.
 233' - 510' Agglomerate; in part granitized tuff (silicified sections)
 --From 312' - 313' - a few quartz seams with light disseminated chalcopryite, galena and trace of sphalerite.
 --From 476½' - 478' - Lost core.
 510' - 720' Siliceous tuffs;
 510' - 612' --Moderately sheared
 612' - 680' --Slightly sheared
 680' - 706½' --Moderately to well sheared
 706½' - 720' --Massive
 720' END OF HOLE.

N.B. - Water lost at 80'
 N.B. - At 360' D.D.H. #9 enters Claim S.60315 for balance of footage, i.e. 360'.

SOLE #9 - SAMPLE RECORD

Footage	Core Length	ASSAY	
		% Cu.	% Ni.
351'.5 - 354'.5	3'.0	0.52	0.04

SUDBAY EXPLORATION & MINING CO. LTD.

Log of Diamond Drill Hole #10

Location: Claim S. 60315
280' S. and 190' W. of No. 1 Post Cl. S. 60315
Bearing: N. 40° W. Ast.
Dip at collar: 45°
Elevation: 20' below collar of D. D. Hole #9
Hole completed: Oct. 18, 1958
Logged by: E. K. Fockler, October 20, 1958

0' - 4'	Casing.	
4' - 35'	Agglomerate; massive.	
35' - 342'	Acidic tuffs;	
	35' - 77'	--Massive, occasional granitic fragmental material.
	77' - 331½'	--Moderately sheared. From 125' - 127' - 1 - 2% fine disseminated pyrite.
	287' - 288'	--Lost core.
	288½' - 293'	--Lost core.
	222½' - 223'	--Lost core.
	331½' - 342'	--Fine breccia band with light, fine disseminated pyrite.
342' - 362½'	Basic tuffs; finely banded.	
		At 348' - ¼" quartz seam with fine pyrrhotite and trace of chalcopyrite.
362½'	END OF HOLE.	

SUDRAY EXPLORATION & MINING CO., LTD.

Log of Diamond Drill Hole #11

Location: Claim E. 60318
100' S. of Post No. 1 - S. 60318 - on claim line
Bearing: N. 60° W. Ast.
Dip at collar: 45°, at 200' - 45°, at 362' - 45°
Elevation: 55' below collar of D. D. Hole #9
Hole completed: Oct. 25, 1958
Logged by: A. E. Jerome

0'	- 16'	Casing.
16'	- 101'	Agglomerate or fragmental tuff; massive, no sulphides.
101'	- 110'	Silicified tuff; slightly pyritized.
110'	- 175'	Granitized tuff; aplitic character, pinkish-grey colour, dense.
175'	- 362'	Agglomerate or fragmental tuff; massive, no sulphides.
362'		END OF HOLE.

SUREX EXPLORATION & MINING CO. LTD.

Log of D. D. Hole #12

Location: Claim 6, 60817 - on claim line, 200' S. of #1 Post -
S. 60817
Bearing: N. 50° W. Act.
Dip at collar: 45°, at 382' - 39° corrected
Date completed: Nov. 7, 1952
Logged by: A. E. Jerome

0' - 71' Casing.
71' - 382' Fragmental tuff;
71' - 82' --Agglomeratic.
82' - 83' --Quartz vein, barren.
83' - 85' --Granitized.
85' - 92' --Pebble-sized fragments.
92' - 203' Bedded tuff;
124' - 129' --Fractured; calcite veins.
--Below 129' - occasional fragments.
203' - 262' Fragmental tuff, agglomeratic.
262' - 278' Breccia zone; narrow calcite stringers and disseminated
pyrite.
278' - 284' Fragmental tuff; pinkish fragments of pebble-size.
284' - 350' Bedded tuff;
350' - 382' Banded tuff, distinct banding, differing from
foregoing bedded tuff.
382' END OF HOLE.

SUDBAY EXPLORATION & MINING CO. LTD.

Log of Diamond Drill Hole #13

Location: Claim B. 60306 - 200' S. and 150' E. of #4 Post
 Claim B. 60306
 Bearing: N. 45° W. Ast.
 Dip at Collar: 45°, at 364' - 39° corrected
 Elevation: 15' lower than collar D.D.H. #12
 Date completed: Nov. 18, 1958
 Logged by: A. E. Jerome

0'	- 4'	Casing.	
4'	- 38'	Fragmental tuff; granitized.	
38'	-148'	Bedded tuff;	
			--From 45' - 48 1/2' - disseminated chalcopryite
			--From 50' - 54 1/2' - altered, rusted
			--From 97' - 112' - sheared and brecciated
			--From - 132' - 148' sheared
148'	-159'	Breccia zone; with calcite stringers and fair disseminated pyrite	
159'	-337'	Fragmental tuff; pebble-sized fragments of cherty character.	
337'	-347'	Bedded tuffs; siliceous, calcite in slip.	
347'	-364'	Fragmental tuff; as above.	
364'		END OF HOLE.	



41106NW0301 FAIRBANK18C1 FAIRBANK

900

OFFICE OF MINING RECORDER



ONTARIO

DEPARTMENT OF MINES

SUDBURY MINING DIVISION

SUDBURY, ONTARIO

January 9th, 1953.

Dr. M. E. Hurst,
Provincial Geologist,
Ont. Dept. of Mines,
Parliament Buildings,
TORONTO, Ontario.



Dear Sir:

Please find enclosed herewith diamond drill logs and locational plans submitted by E. K. Fockler, consulting geologist, on behalf of Sudbay Explorations & Mining Co.

These logs cover drilling on their claims in Fairbank Twp. The cores are stored in boxes on the property.

Yours truly,

J. R. McGinn
J. R. McGinn,
Mining Recorder.

DAJ.

Encl.

70. / 18

125

 Veining





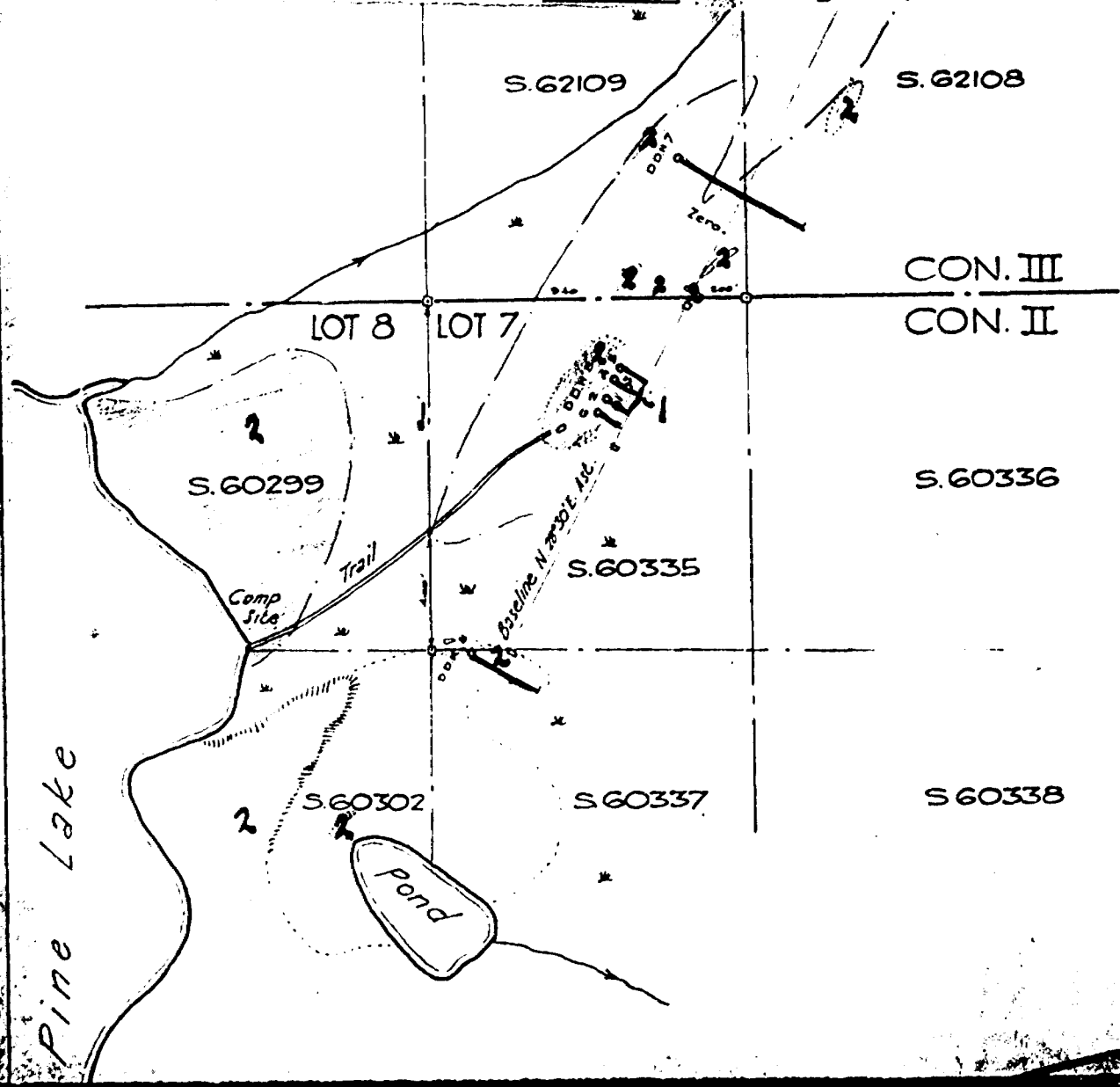

 Micropegmatite

SUDBAY EXPLORATION & MINING LIMITED
PLAN OF D.D. HOLES NOS. 1 TO 8 &
SURFACE WORKINGS
PINE LAKE SECTION
LOT 7, CONC. II & III, FAIRBANK TWP. ONT.

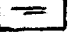
SCALE: 1" = 400'

E. K. FOCKLER
DEC. 1952

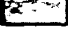

-  Veining
-  1 Granitic injection
-  2 Micropegmatite
-  3 Granitized volcanics
-  4 Acidic tuff
-  5 Basic tuff
-  6 Agglomerate

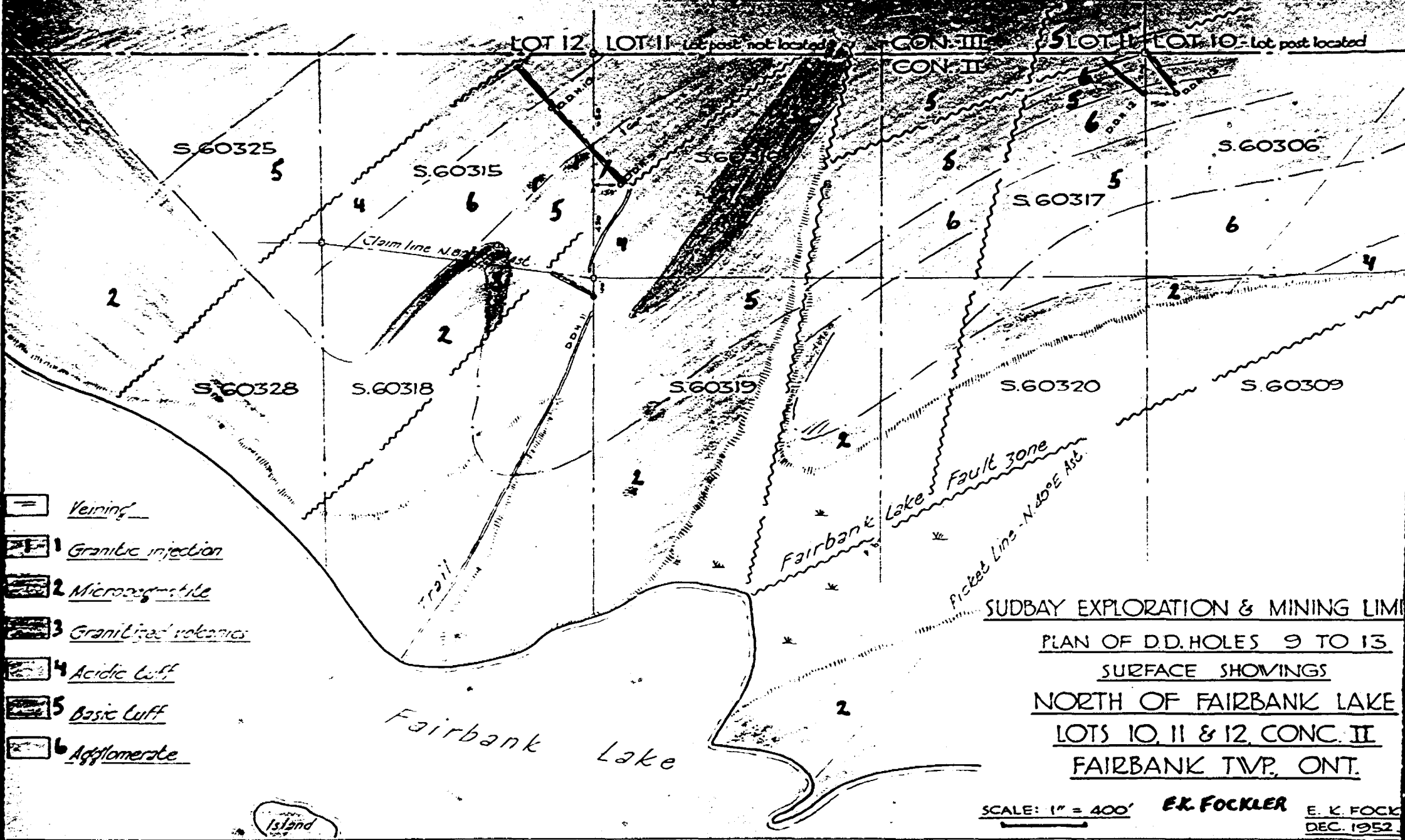

SUBBAY EXPLORATION & MINING LIM
 PLAN OF D.D. HOLES 9 TO 13
 SURFACE SHOWINGS
 NORTH OF FAIRBANK LAKE
 LOTS 10, 11 & 12, CONC. II
 FAIRBANK TWP., ONT.

SCALE: 1" = 400' **E.K. FOCKLER** E. K. FOCKLER
 DEC. 1952