



41109NW0066 0010 DAVIS

010

Diamond Drilling

Township OF DAVIS

Report No: 10

Work performed by: ALBA EXPLORATIONS / TOMROSE MINES LTD.

Claim No	Hole No	Footage	Date	Note
S-85100	1	34'1"	1955	
	2	37'1"	1955	
	3	44'4"	1955	
	4	40'5"	1955	
	5	45'7"	1955	
	6	47'9"	1955	
	7	42'10"	1955	
	8	40'8"	1955	
	9	30'3"	1955	
	S-9A	146'6"	Feb./56	
	S-10A	157'	Mar/56	
	S-11A	155'	Mar/56	
	S-12A	225'	Mar/56	
S.85099	S-1A	270'	Jan/56	
	S-2A	267'	Jan/56	
	S-3A	212'	Jan/56	
	S-4A	212'	Feb/56	
	S-5A	364'	Feb/56	
S.85103	S-6A	221'	Feb/56	
	S-7A	332'	Feb/56	
	S-8A	258'	Jan/56	
S.87124	S-13A	300'	Mar/56	

22

3478

Notes:

Hole No. 7 (42' 10")

35° Dip
Bearing 175°

0 - 42' 10" Gabbro

Hole No. 8 (40' 8")

Dip 35°
Bearing 175°

0 - 40' 8" Gabbro

Hole No. 9 (30' 3")

Dip 40°
Bearing 175°

0 - 30' 3" Gabbro

Footage of 363 certified correct for
Alba Explorations Limited.

S. L. Macdonald
B.Sc.
(S. L. Macdonald)

16th November, 1955.

DIAMOND DRILL RECORD

PROPERTY ALBA EXPLORATIONS LIMITED (DAVIS TOWNSHIP)

HOLE No. S-1A

SHEET NUMBER 1 SECTION FROM 0 TO 270° STARTED January 21, 1956

LATITUDE DATUM Base Line, 15 / 50E, 159 Ft. N. COMPLETED January 24, 1956

DEPARTURE BEARING South ULTIMATE DEPTH 270 ft.

ELEVATION DIP 45° PROPOSED DEPTH

DEPTH FEET	FORMATION	SAMPLE NO.	FROM	TO	WIDTH	ASSAY VALUES			
0-41	Casing								
41-100	Greywacke - ALT 93-96								
100-107	Greywacke								
107-115	Contact Zone - Altered								
115-175	Greywacke - Alt. 120 - 143 ft.								
175-182	Greywacke								
182-184	Diabase Str.								
184-206	Greywacke - Alt Carbonate								
206-223	Diabase - 216'6" Granite Str. Chalco.								
223-234	Diabase - Altered Zone								
234-270	- S.M. at 243 ft, 258								
	258' - Chalco small dabs (dabs)								
	END OF HOLE								

NORTHERN MINER FORM 505 REV. 7/54

DRILLED BY Inspiration Mining & Development Co. Ltd.

SIGNED

S. J. Glackwald

DIAMOND DRILL RECORD

PROPERTY ALBA EXPLORATIONS LTD. - DAVIS TWP
ALBA EXPLORATIONS LIMITED (DAVIS TOWNSHIP) HOLE No. B-2A

SHEET NUMBER 1 SECTION FROM 0 TO 267' STARTED January 28, 1958

LATITUDE _____ DATUM Baseline, 14 / 75E, 155 ft. N COMPLETED January 28, 1958

DEPARTURE _____ BEARING South ULTIMATE DEPTH 267 ft.

ELEVATION _____ DIP 45° PROPOSED DEPTH _____

DEPTH FEET	FORMATION	SAMPLE NO.	FROM	TO	WIDTH	ASSAY VALUES			
0-50	Casing								
50-125	Sediments - Altered								
125-175	Greywacke GREYWACKE								
175-267	Greywacke GREYWACKE								
END OF HOLE									

SULBURY
RECEIVED
OCT 11 1958
MINING DIVISION

SULBURY
RECEIVED
JUN 11 1959
MINING DIVISION

S. Macdonald

Claim No. S-85099
S-85099

DIAMOND DRILL RECORD

PROPERTY ALBA EXPLORATIONS LTD. - DAVIS TWP
Alba Explorations Limited (Davis Twp)

HOLE No. S - 3A S - 3A

SHEET NUMBER 1 SECTION FROM 0 TO 212 STARTED 29 January, 1956.

LATITUDE _____ DATUM Base Line 14+00E COMPLETED 31 January, 1956.

DEPARTURE _____ BEARING South SOUTH ULTIMATE DEPTH 212 212

ELEVATION _____ DIP 49° 48° PROPOSED DEPTH _____

DEPTH FEET	FORMATION	SAMPLE NO.	FROM	TO	WIDTH	ASSAY VALUES			
0 - 33	Casing								
33 - 77	Greywacke - Alt. Cont Zone <u>ALT. CONT ZONE</u>								
77 - 124	Greywacke - ALT some carbonate. <u>ALT SOME CARBONATE</u>								
124 - 163	Contact zone S M at 159' <u>- S M at 159'</u>								
163 - 212	Diabase - ALT 197' - 211' <u>ALT 197' - 211'</u>								
	S. Chalco 167' <u>S. CHALCO 167'</u>								
	END OF HOLE								

RECEIVED
JUN 1 1956
MINING DIVISION

RECEIVED
JUN 21 1956
MINING DIVISION

NORTHERN MINER FORM 808 REV. 54

DRILLED BY INSPECTION MINING & DEVELOPMENT CO. LTD. SIGNATURE W. J. Woodcock

DIAMOND DRILL RECORD

ALBA EXPLORATIONS LIMITED - DAVIS TWP

PROPERTY ALBA EXPLORATIONS LIMITED (DAVIS TOWNSHIP) HOLE No. 8-4A S-4A

SHEET NUMBER 1 SECTION FROM 0 TO 212' STARTED February 2, 1956

LATITUDE DATUM Baseline, 13 / 25' S, 111 ft. N. COMPLETED February 3, 1956
 Baseline, 13-25'E, 111 ft. N

DEPARTURE BEARING South ULTIMATE DEPTH 207' 207'

ELEVATION DIP 45° 45° PROPOSED DEPTH

DEPTH FEET	FORMATION	SAMPLE NO.	FROM	TO	WIDTH	ASSAY VALUES			
0-13	Casing								
13-19.6'	Diabase								
19.6-75'	Sediments Alt.								
75-122	Diabase - Some Alt.								
122-175	Sediments - Alt. 143-157								
	Some Carbonate - Contact Zone								
175-207	Diabase - Alt. 192-212								
	END OF HOLE								

SUDBURY RECEIVED
 OCT 11 1953
 MINING DIVISION

SUDBURY RECEIVED
 JUN 21 1953
 MINING DIVISION

NORTHERN MINER FORM 505 REV. 54
 Inspiration Mining & Development Co. Ltd.

DRILLED BY _____ SIGNED J. J. [Signature]

DIAMOND DRILL RECORD

PROPERTY Alba Explorations Ltd. (Davis Township)

HOLE No. S-6A

SHEET NUMBER 1 SECTION FROM 0 TO 175'9"

STARTED 18 February 1956

LATITUDE..... DATUM Base Line S + 00 E, 50 ft. N

COMPLETED 19 February 1956

DEPARTURE..... BEARING S - 8° E E

ULTIMATE DEPTH 221'

ELEVATION..... DIP 40°

PROPOSED DEPTH.....

DEPTH FEET	FORMATION	SAMPLE NO.	FROM	TO	WIDTH	ASSAY VALUES			
						ni	Cu	Au	Ag
0 - 30	Casing								
30 - 67	Greywacke - narrow strgs								
	Alt Diabase								
67 - 70	Lost Core - Probable								
	contact								
75-100	Diabase - small blebs								
	chalco 79' - 80'6", 85' - 85'6"								
	90'6" - 90'8"								
100-125	Diabase - small blebs								
	chalco 115'6" - 116'6", 120'6" - 124'6"								
150-175	Diabase - small blebs								
	chalco, pyrrhotite 173' - 173'								
173'9" - 175'9"	Dia. w. Min Pyrr - No visible	3401	173'9"	175'9"	2	0.12			
	chalco								

NORTHERN MINER FORM 505 REV. 1/54

DRILLED BY Inspiration Mining & Development Co. Ltd.

SIGNED

S. J. Woodhead

96

DIAMOND DRILL RECORD

PROPERTY Alba Explorations Ltd. (Davis Township) HOLE No. S-6A
 SHEET NUMBER 2 SECTION FROM 175'9" TO 221' STARTED 18 February, 1956
 LATITUDE..... DATUM Base Line S & 00 E, 50 ft. N. COMPLETED 19 February 1956
 DEPARTURE..... BEARING S - 8° E ULTIMATE DEPTH..... 221'
 ELEVATION..... DIP 40° PROPOSED DEPTH.....

DEPTH FEET	FORMATION	SAMPLE NO.	FROM	TO	WIDTH	ASSAY VALUES			
						Ni	Cu	Au	Az
175'9" - 178'9"	Dia. S.M. Pyrr & Chalco	3402	175'9"	178'9"	3'	0.08	-		
178'9" - 180'	Dia. S.M. Pyrr & Chalco	3403	178'9"	180'	15"	0.09	-		
180' - 181'-6"	Dia. W. Min. Pyrr & Chalco	3404	180'	181'6"	18"	0.34	0.74		
181'6" - 221'	Diabase								
	End of hole								

DIAMOND DRILL RECORD

PROPERTY Alba Explorations Limited (Davis Township) **HOLE No.** S-7A
SHEET NUMBER 1 **SECTION FROM** 0 **TO** 122'6" **STARTED** 23 February, 1956
LATITUDE _____ **DATUM** Base Line 7 x 35 E, 75' No. **COMPLETED** 25 February, 1956
DEPARTURE _____ **BEARING** AZ 172° S-8° E E **ULTIMATE DEPTH** 322'
ELEVATION _____ **DIP** 45° **PROPOSED DEPTH** _____

DEPTH FEET	FORMATION	SAMPLE NO.	FROM	TO	WIDTH	ASSAY VALUES			
0-36	Casing								
46'6"	Diabase								
46'6" - 47'8"	Lost Core (Sludge retained)								
	(46-56) No. Min either end of Loss								
47'8" - 49'	Diabase								
49' - 52'3"	Sediments - altered - silicified								
52'3" - 53'3"	Lost core (sludge retained)								
	No Min either end (46" - 56")								
53'3" - 57'4"	AIT sediments								
57'4" - 58'8"	Lost core (sludge retained)								
	(56-66') No min either end								
58'8" - 75	Sediments - alt - silicified								
75 - 122'6"	Sediments - alt - silicified								
	All sediments to probably grey wacke								

RECEIVED
 JUN 11 1955
 RECEIVED
 JUN 21 1955
 DIVISION
 DIVISION

NORTHERN MINER FORM 505 REV. 7/54
 Drilled by Inspiration Mining & Development Co. Ltd.
 DRILLED BY _____ SIGNED _____

S. J. Ulicki

DIAMOND DRILL RECORD

PROPERTY Alba Explorations Limited (Davis Township) HOLE No. S-7A

SHEET NUMBER 2 SECTION FROM 122'6" TO 300' STARTED 23 February, 1956

LATITUDE..... DATUM Base Line 7. + 35 E COMPLETED 25 February, 1956

DEPARTURE..... BEARING S 8° E ULTIMATE DEPTH 332'

ELEVATION..... DIP 45 PROPOSED DEPTH.....

DEPTH FEET	FORMATION	SAMPLE NO.	FROM	TO	WIDTH	ASSAY VALUES			
122'6 - 126'	Diabase								
126 - 127	Lost core (Sludge retained)								
	(126 - 136) No min either end								
127-131	Diabase								
131-132	Lost core (sludge retained)								
	(126-136) No min either ends								
132-155'6"	Diabase								
155' - 169'	Diabase - S. Min - Pyrrhotite								
	Chalcopyrites ^M								
169-200	Diabase - silicious 175 - 178'								
200-225	Diabase No. Mix								
225-275	Diabase								
275-300	Diabase - S.M. Chalco 293-297								

NORTHERN MINER FORM 505 REV. 1954

DRILLED BY Inspiration Mining & Development Co. Ltd.

SIGNED

1 1 1956
MINING DIVISION

DIAMOND DRILL RECORD

PROPERTY Alba Explorations Ltd. (Davis Township) HOLE No. S-7A
 SHEET NUMBER 3 SECTION FROM 300 TO 332 STARTED 22 February, 1956
 LATITUDE _____ DATUM Base Line 7+35E COMPLETED 25 February, 1956.
 DEPARTURE _____ BEARING 3 - 8°E ULTIMATE DEPTH 332'
 ELEVATION _____ DIP 45° PROPOSED DEPTH _____

DEPTH FEET	FORMATION	SAMPLE NO.	FROM	TO	WIDTH	ASSAY VALUES			
300 - 301'6"	Diabase - fracture at 301"								
	qtz fill								
301'6" - 314	Diabase - S. Min - Blebs								
	Chalcopyrites & pyrrhotite								
	(Sub Assay Grade)								
314 - 332	Diabase								
	End of Hole								

NORTHERN MINER FORM 505 REV./54

DRILLED BY Inspiration Mining & Development Co. Ltd. SIGNED _____

11 1956
 JUN 2 1956
 MINING DIVISION

DIAMOND DRILL RECORD

PROPERTY Alba Explorations Limited (Davis Township)

HOLE No. S-8A

SHEET NUMBER 1

SECTION FROM 0 TO 258'

STARTED January 17, 1956

LATITUDE

DATUM Baseline - 2+35 E, 35 ft. S.

COMPLETED January 19, 1956.

DEPARTURE

BEARING South

ULTIMATE DEPTH 258'

ELEVATION

DIP 35°

PROPOSED DEPTH

DEPTH FEET	FORMATION	SAMPLE NO.	FROM	TO	WIDTH	ASSAY VALUES			
0 - 20	Casing								
20 - 75	Diabase								
75 - 175	Diabase, M. 160 - 163	3405	160'3"	163'3"	3				
	S.M. scattered to 175' - 6" str.								
	Massive Pyrrhotite at 163'9"								
175 - 258	Diabase Disseminated								
	Mn. Pyrr. scant to 232 ft.								
	END OF HOLE								

MINING DIVISION
 JAN 21 1956
 JAN 2 1956
 MINING DIVISION

DIAMOND DRILL RECORD

PROPERTY Alba Explorations Limited

HOLE No. S-9A

SHEET NUMBER 1

SECTION FROM 0 TO 146'6"

STARTED 27 Feb. 1956

LATITUDE

DATUM Base line 14+75E, 100' South

COMPLETED 29 Feb. 1956

DEPARTURE

BEARING (N 5 W)

ULTIMATE DEPTH 146'

ELEVATION

DIP 45°

PROPOSED DEPTH

DEPTH FEET	FORMATION	SAMPLE NO	FROM	TO	WIDTH	ASSAY VALUES	
						Cu	Ni
0 - 13	Casing						
13 - 54	Diabase						
54 - 55	Lost Core (Sludge 45-55)						
56 - 57	Lost core						
57.6-58.6"	Lost Core (Sludge 55-65)						
55 - 67	Diabase						
62 - 63	Lost core (sludge 55-65)						
63 - 75	Diabase (Min. 67-75)						
75-146.5"	Diabase	3502	90.6'	92.6'	2'	0.46	0.10
	From 90.6' to 100' W Min.	3503	92.6'	95'	2.6'	1.60	0.57
	Blebs of Chalco & Pyrrhotite	3504	95'	97.6'	2.6'	0.63	0.30
	100 - 10" S.Min with scattered	3505	97.6'	100'	2.6'	0.44	0.26
	blebs chalco & pyrrhotite	3506	100'	102'	2'	0.12	0.03
	END OF HOLE						

**DUPLICATE COPY
POOR QUALITY ORIGINAL
TO FOLLOW**

Drilled by : Inspiration Mining & Development Co. Ltd.

DIAMOND DRILL RECORD

PROPERTY Alba Explorations Limited

HOLE No. S-9A

SHEET NUMBER 1

SECTION FROM 0 TO 146'6"

STARTED 27 Feb. 1956

LATITUDE.....

DATUM Base line 14+75E, 100' South

COMPLETED 29 Feb. 1956

DEPARTURE.....

BEARING (N 5 W)

ULTIMATE DEPTH 146'

ELEVATION.....

DIP 45°

PROPOSED DEPTH

DEPTH FEET	FORMATION	SAMPLE NO	FROM	TO	WIDTH	ASSAY VALUES	
						Cu	Ni
0 - 13	Casing						
13 - 54	Diabase						
54 - 55	Lost Core (Sludge 45-55)						
56 - 57	Lost core						
57.6-58.6"	Lost Core (Sludge 55-65)						
55 - 67	Diabase						
62 - 63	Lost core (sludge 55-65)						
63 - 75	Diabase (Min. 67-75)						
75-146.5"	Diabase	3502	90.6'	92.6'	2'	0.46	0.10
	From 90.6' to 100' W Min	3503	92.6'	95'	2.6'	1.60	0.57
	Blebs of Chalco & Pyrrhotite	3504	95'	97.6'	2.6'	0.63	0.30
	100 - 10" S.Min with scattered	3505	97.6'	100'	2.6'	0.44	0.26
	blebs chalco & pyrrhotite	3506	100'	102'	2'	0.12	0.03

**DUPLICATE COPY
POOR QUALITY ORIGINAL
TO FOLLOW**

END OF HOLE

Drilled by : Inspiration Mining & Development Co. Ltd.

DIAMOND DRILL RECORD

PROPERTY Alba Explorations Limited HOLE No. B-9A
 SHEET NUMBER 1 SECTION FROM 0 TO 146'6" STARTED 27 Feb. 1958
 LATITUDE _____ DATUM Base Line 14 & 75 S. 100' South COMPLETED 29 Feb. 1958
 DEPARTURE _____ BEARING (N 8 W) ULTIMATE DEPTH 146'
 ELEVATION _____ DIP 45° PROPOSED DEPTH _____

DEPTH FEET	FORMATION	SAMPLE NO.	FROM	TO	WIDTH	ASSAY VALUES		
							Cu	Ni
0-15	Casing							
15-54	Diabase							
54-55	Lost Core (Sludge 45-55)							
55-57	Lost core							
57'6" - 58'6"	Lost core (Sludge 55-65)							
58-67	Diabase							
62-63	Lost core (sludge 55-65)							
63-75	Diabase (Min. 67-75)							
75-146'6"	Diabase	3502	90'6"	92'6"	2"		0.46	0.10
	From 90'6" to 100' N. Min	3503	92'6"	95'	2'6"		1.40	0.57
	Blebs of Chalco & Pyrrhotite	3504	95	97'6"	2'6"		0.65	0.30
	100 - 10" S. Min with scattered	3505	97'6"	100'	2'6"		0.44	0.26
	blebs chalco & pyrrhotite	3506	100	102	2'		0.45	0.25
	END OF HOLE							

NORTHERN MINER FORM 505 REV./54

DRILLED BY Inspiration Mining & Development Co. Ltd.

SIGNED _____

S. J. Waldorff

DIAMOND DRILL RECORD

PROPERTY Alba Explorations Limited HOLE No. B-2A
 SHEET NUMBER 1 SECTION FROM 0 TO 146' 6" STARTED 27 Feb. 1958
 LATITUDE..... DATUM Base Line 14 & 75 N, 100' South COMPLETED 29 Feb. 1958
 DEPARTURE..... BEARING (N 8 W) ULTIMATE DEPTH 146'
 ELEVATION..... DIP 45° PROPOSED DEPTH.....

DEPTH FEET	FORMATION	SAMPLE NO.	FROM	TO	WIDTH	ASSAY VALUES		
							Cu	K1
0-13	Casing							
13-54	Diabase							
54-55	Lost Core (Sludge 43-55)							
55-57	Lost core							
57'6" - 58'6"	Lost core (Sludge 55-55)							
58-67	Diabase							
62-63	Lost core (sludge 58-65)							
63-75	Diabase (Min. 67-75)							
75-146'5"	Diabase	3502	90'6"	92'6"	2'		0.44	0.10
	From 90'6" to 100' N. Min	3503	92'6"	95'	2'6"		1.69	0.57
	blsbs of Chalco & Pyrrhotite	3504	95	97'6"	2'6"		0.43	0.30
	100 - 10" S. Min with scattered	3505	97'6"	100'	2'6"		0.44	0.26
	blsbs chalco & pyrrhotite	3506	100	102	2'			0.05
	END OF HOLE							

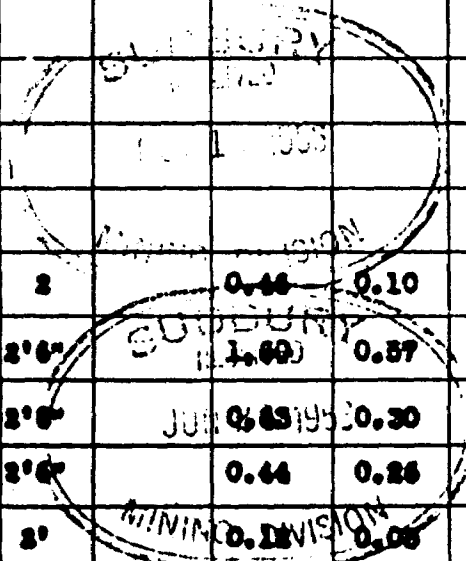

NORTHERN MINER FORM 505 REV. 54

DRILLED BY Inspiration Mining & Development Co. Ltd.

SIGNED

S. Waldorff

DIAMOND DRILL RECORD

LITHO 1105 - 50100

PROPERTY Alba Explorations Limited HOLE No. 9-104
 SHEET NUMBER 1 SECTION FROM 0 TO 157 STARTED 1 March/56
 LATITUDE..... DATUM Base Line 14 + 00 E 128°E COMPLETED 3 March/56
 DEPARTURE..... BEARING N 8° W ULTIMATE DEPTH 157'
 ELEVATION..... DIP 38° - 39° PROPOSED DEPTH.....

DEPTH FEET	FORMATION	SAMPLE NO.	FROM	TO	WIDTH	ASSAY VALUES		
							Cu	Ni
0-6	Casing							
6-48	Diabase - SM 24' - 26'	3501	48	51	3		0.15	0.04
	S.M. 38 - 40'							
	S.M. 62 - 76' S.M. 99 - 100							
	S.M. 100 - 105, 118 - 119							
	S... (Chalco) 142'6"							
- 157	Diabase							
	END OF HOLE							

RECEIVED

JUN 1 1956

MINING DIVISION

RECEIVED

JUN 21 1956

MINING DIVISION

NORTHERN MINER FORM 505 REV./54
 DRILLED BY Inspiration Mining & Development Co. Ltd. SIGNED S. J. Macdonald

DIAMOND DRILL RECORD

PROPERTY Alba Explorations Limited (Davis Township) HOLE No. S-11A
 SHEET NUMBER 1 SECTION FROM 0 TO 155' STARTED 4 March, 1956
 LATITUDE Base Line 15+25E, 100' South DATUM COMPLETED 8 March, 1956
 DEPARTURE BEARING North 7° West ULTIMATE DEPTH 155'
 ELEVATION DIP 45° PROPOSED DEPTH

DEPTH FEET	FORMATION	SAMPLE NO.	FROM	TO	WIDTH	ASSAY VALUES		
							Cu	Ni
0 - 10	Casing							
10 - 41'6"	Diabase - 1" Qtz. pyrrhotite blebs							
41'6" - 93'6"	Diabase							
93'6" -	Diabase - sediment contact	3507	93'6"	95'6"	2'		0.16	Ni1
	zone - Min chalco - pyrr	3508	95'6"	98'	2'6"		0.22	0.02
113'	93'6" - 98' altered							
113' - 116'	Altered zone. Coarse blebs	3509	113	116	3'		0.49	0.30
	pyrrhotite - chalcopryite							
116' - 125'	Altered sediments - flakes mica							
125' - 155'	Greywacke - S.M. for 6" at 125'							
	END OF HOLE							

RECEIVED
 JUN 1 1956
 RECEIVED
 JUN 21 1956
 RECEIVED
 JUN 21 1956
 RECEIVED
 JUN 21 1956

NORTHERN MINER FORM 504 REV. 1954

Inspiration Mining & Development Co. Ltd.

DRILLED BY _____

SIGNED _____

S. J. Macdonald

DIAMOND DRILL RECORD

PROPERTY Alba Explorations Limited (Davis Township)

HOLE No. S-12-A

SHEET NUMBER

SECTION FROM TO

STARTED 9 March, 1956

LATITUDE

DATUM Base line 14 & 75E, 120'S

COMPLETED 11 March, 1956

DEPARTURE

BEARING N 70° W

ULTIMATE DEPTH 225'

ELEVATION

DIP 76°

PROPOSED DEPTH

DEPTH FEET	FORMATION	SAMPLE NO.	FROM	TO	WIDTH	ASSAY VALUES	
						CU	NI
0 - 13	Casing						
13 - 95	Diabase 6" from 94'6" to 95 W. min. pyrr & chalco.						
95 -138	Diabase S. Min. at 129 and 134'						
138 -142	Granitic stringer						
142 -150	Diabase (alt) with narrow granitic stringers						
150 -193	Diabase (alt) W.M. with pyrrhotite at 150 to 151', 175 to 176.3' and 165 to 188' Scant Min. scattered	3510 3511 3512	150' 175' 185'	151' 176.3' 188'	1' 15" 3'		0.35 0.13 0.26
193 -211	Contact zone (alt) S.M. in short section.	3513	206.3	208.6	2.3'		1.05 0.18
211 -225	Greywacke						
	END OF HOLE						

**DUPLICATE COPY
POOR QUALITY ORIGINAL
TO FOLLOW**

DIAMOND DRILL RECORD

PROPERTY ALBA EXPLORATIONS LIMITED (DAVIS TOWNSHIP)

HOLE No. C-12 A

SHEET NUMBER

SECTION FROM

TO

STARTED 9 March, 1956.

LATITUDE

DATUM Base Line 14 & 755, 120' S

COMPLETED 11 March, 1956.

DEPARTURE

BEARING N 70° W

ULTIMATE DEPTH 225'

ELEVATION

DIP

76°

PROPOSED DEPTH

DEPTH FEET	FORMATION	SAMPLE NO.	FROM	TO	WIDTH	ASSAY VALUES		
							Cu	Ni
0 - 13	Casing							
13 - 95	Diabase 6" from 94'6" to 95'							
	W. Min pyrr & chalco							
95 - 138	Diabase S. Min at 129 & 134'							
138 - 142	Granitic stringer							
142 - 150	Diabase (alt) with narrow granitic stringers							
150 - 193	Diabase (alt) W.M. with pyrrhotite at 150 to 151', 175' to 176'3" & 195' to 188'	3510	150'	151'	1'		0.35	0.20
		3511	175'	176'3"	15"		1.84	0.13
		3512	185'	188'	3'		1.21	0.26
	Scant Min scattered.							
193 - 211	Contact zone (alt) S.M. in short sectn.	3513	206'3"	208'6"	2'3"		1.95	0.18
211 - 225	Greywacke							
	END OF HOLE							

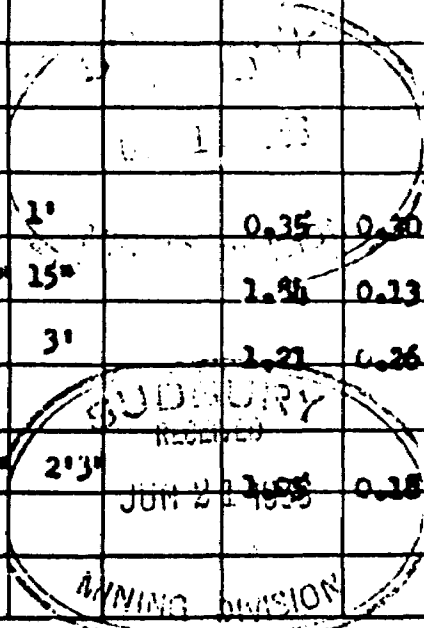

NORTHERN MINER FORM 908 REV. 5/54

Inspiration Mining & Development Co. Ltd.

DRILLED BY

SIGNED

LOCATION DRILL HOLES

MURRAY LAKE

N. AST



S-6A - S-8A inc.

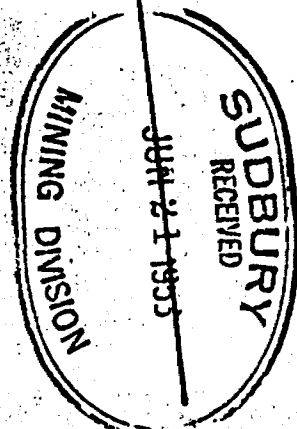
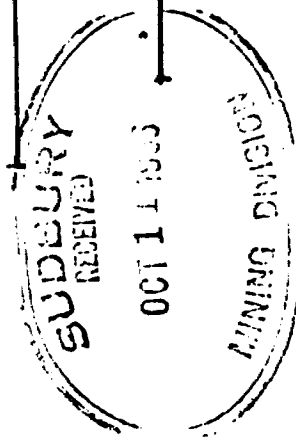
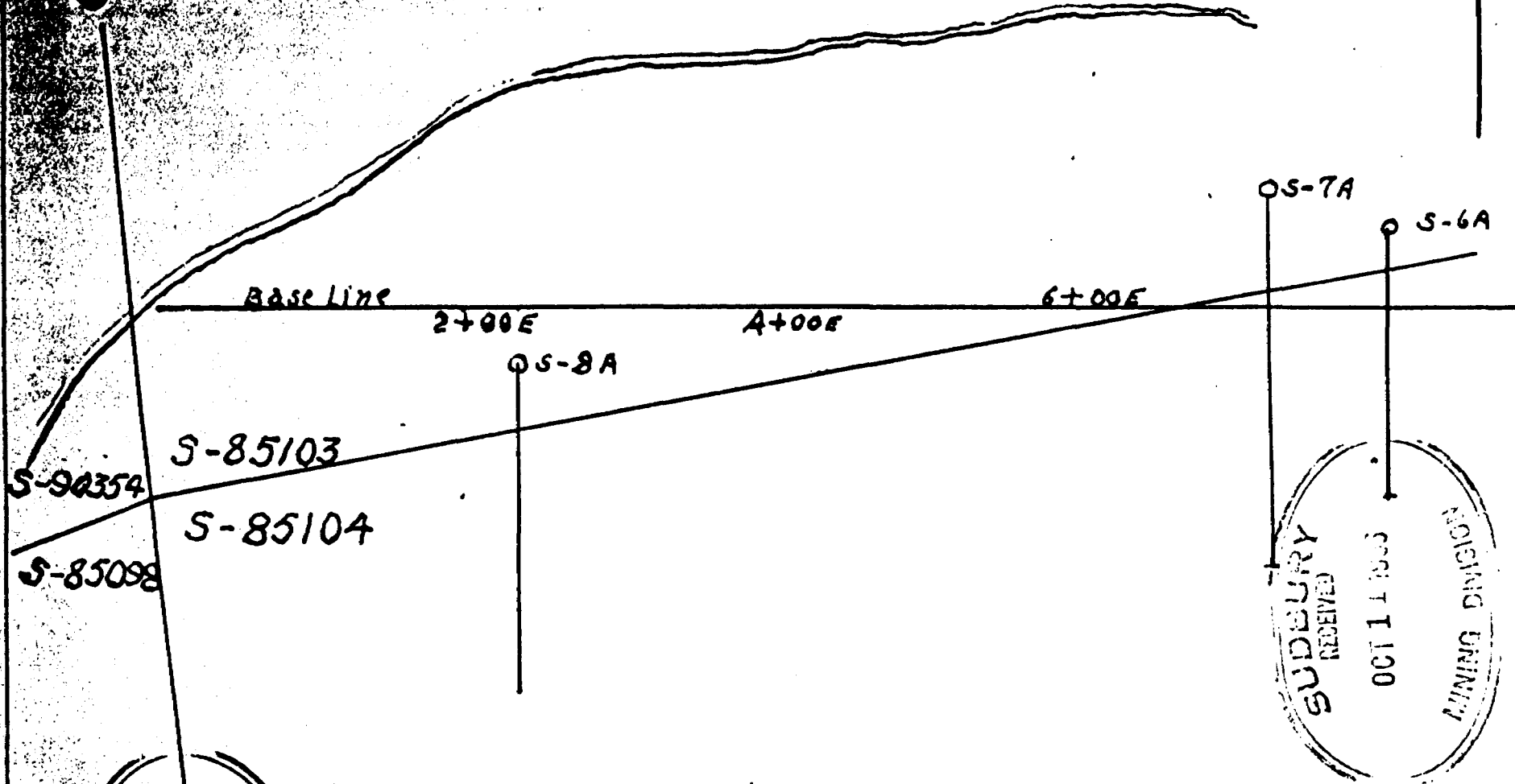

ALBA EXPLORATIONS LIMITED
DAVIS TOWNSHIP

Scale 1in = 100ft.



S. J. ...

39

DIAMOND DRILL RECORD

PROPERTY Alba Explorations Limited (Davis Township) HOLE No. S-13A
 SHEET NUMBER 1 SECTION FROM 0 TO 300' STARTED March 17, 1956
 LATITUDE _____ DATUM Claim No. S-87124 Picket COMPLETED March 22, 1956
 DEPARTURE _____ BEARING Line 39 / 00E 500 ft. W. ULTIMATE DEPTH 300'
N.57° N.MAG.
 ELEVATION _____ DIP 45° PROPOSED DEPTH _____

DEPTH FEET	FORMATION	SAMPLE NO.	FROM	TO	WIDTH	ASSAY VALUES			
0-30	Casing								
30-52	Sediments - Slaty								
52-57	Sediments - Fractured Iron Stain								
57-125	Sediments - Slaty - No water								
	Return after 125'								
125-233	Sediments - Slaty								
233-250	Sediments - Some Alt. with fine traced magnetite in slips								
	small inclusion granite at 233'								
250-300	Sediments - Slaty at 253' - 3" granite str. hematite marked in slip planes								
	END OF HOLE								

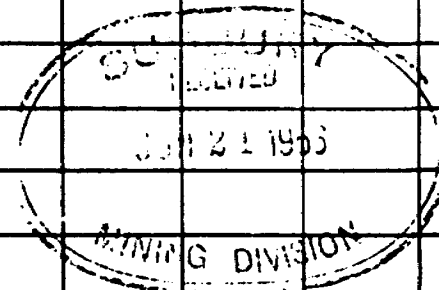

S.P. MacDonald

LOCATION DRILL HOLES

S-1A-S-5A inc & S-9A-S-11A inc

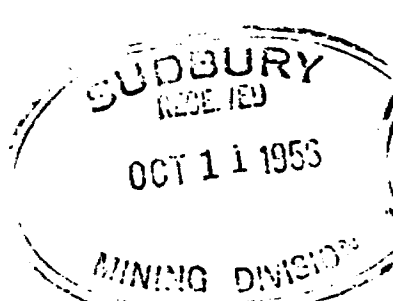
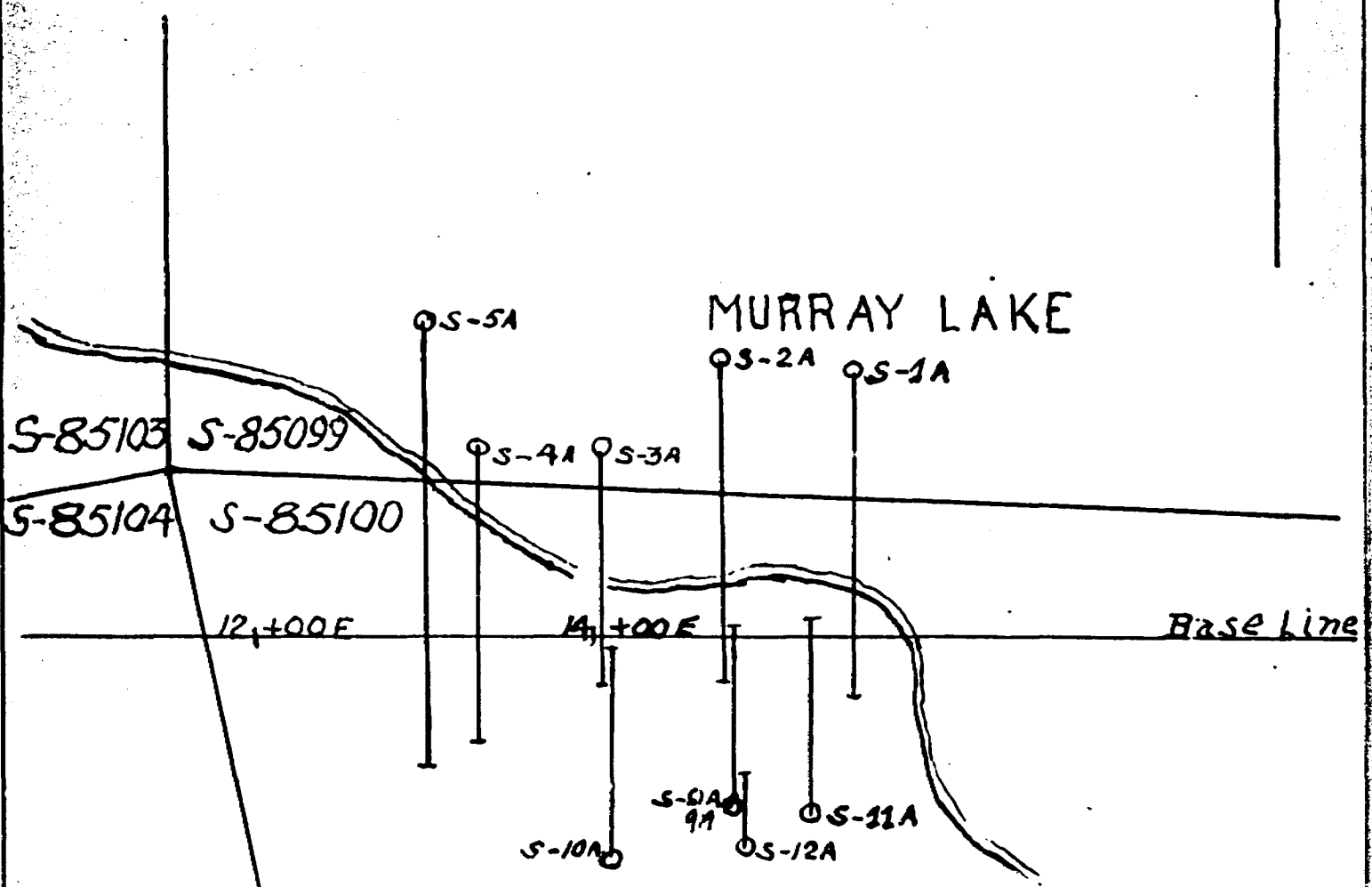
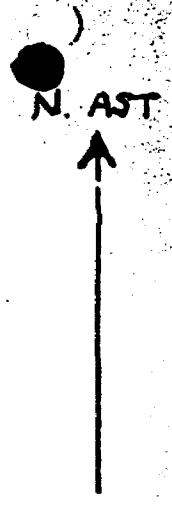

ALBA EXPLORATIONS LIMITED
DAVIS TOWNSHIP

Scale 1 in = 100 ft.

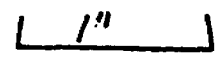

S. Walden

S-85098

LOCATION

DDH-S13A

S-13A

N.AST

S-87124

Base Line

S-87121

39+00.6
SUDBURY
RECEIVED

OCT 11 1955

MINING DIVISION

ALBA EXPLORATIONS LIMITED
DAVIS TOWNSHIP



Scale 1in = 100ft.

S. J. Macdonald

PLAN OF DRILLING

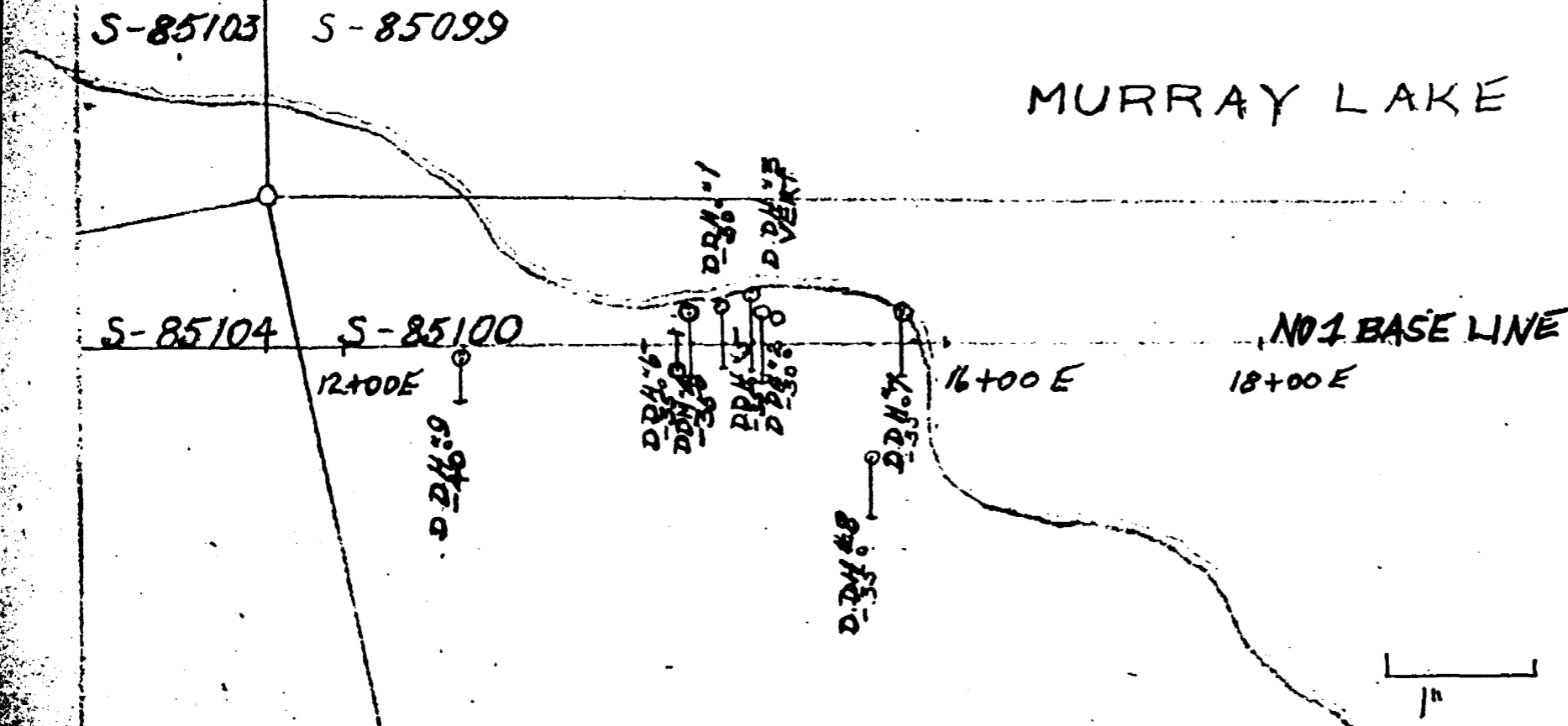

ALBA EXPLORATIONS LIMITED
DAVIS TOWNSHIP
SUDBURY MINING DIVISION
SCALE 1in=100ft

11 NOVEMBER 1955

S. J. McDonald

S. 143972

1/2

Murray Lake

Low Ground

S. 143971

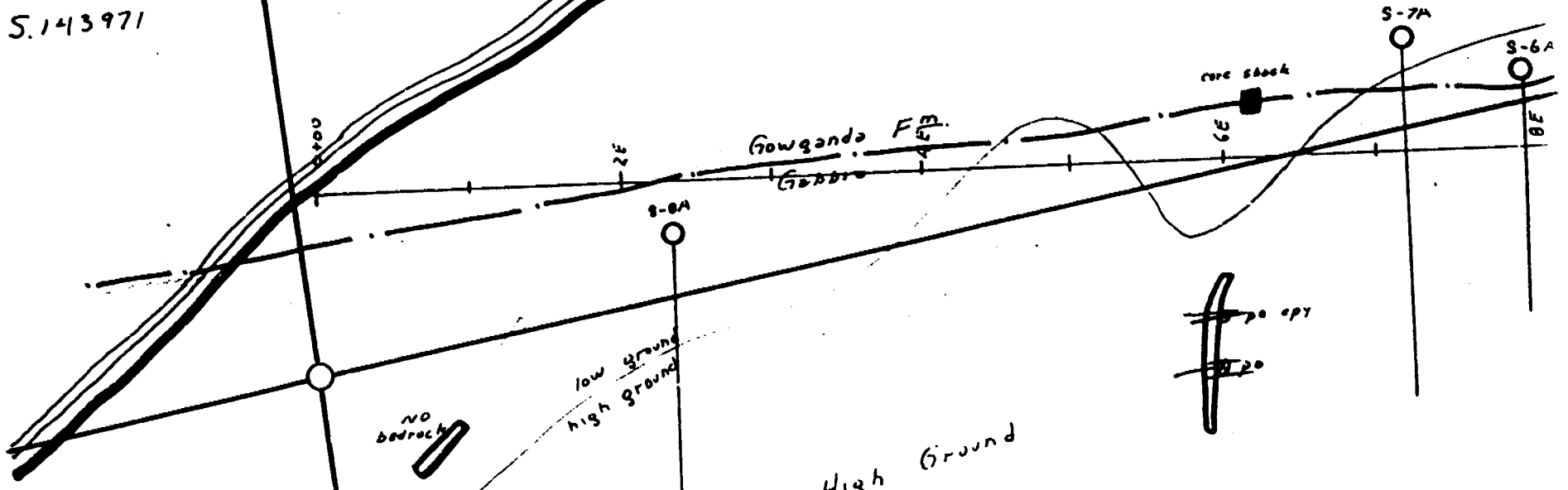

High Ground

S. 144135

S. 144134

Tomrose Mines Ltd.
 Alba Drilling - 1956
 1" = 100'
 1" = 100'

2/2

2 of 8

S. 143973

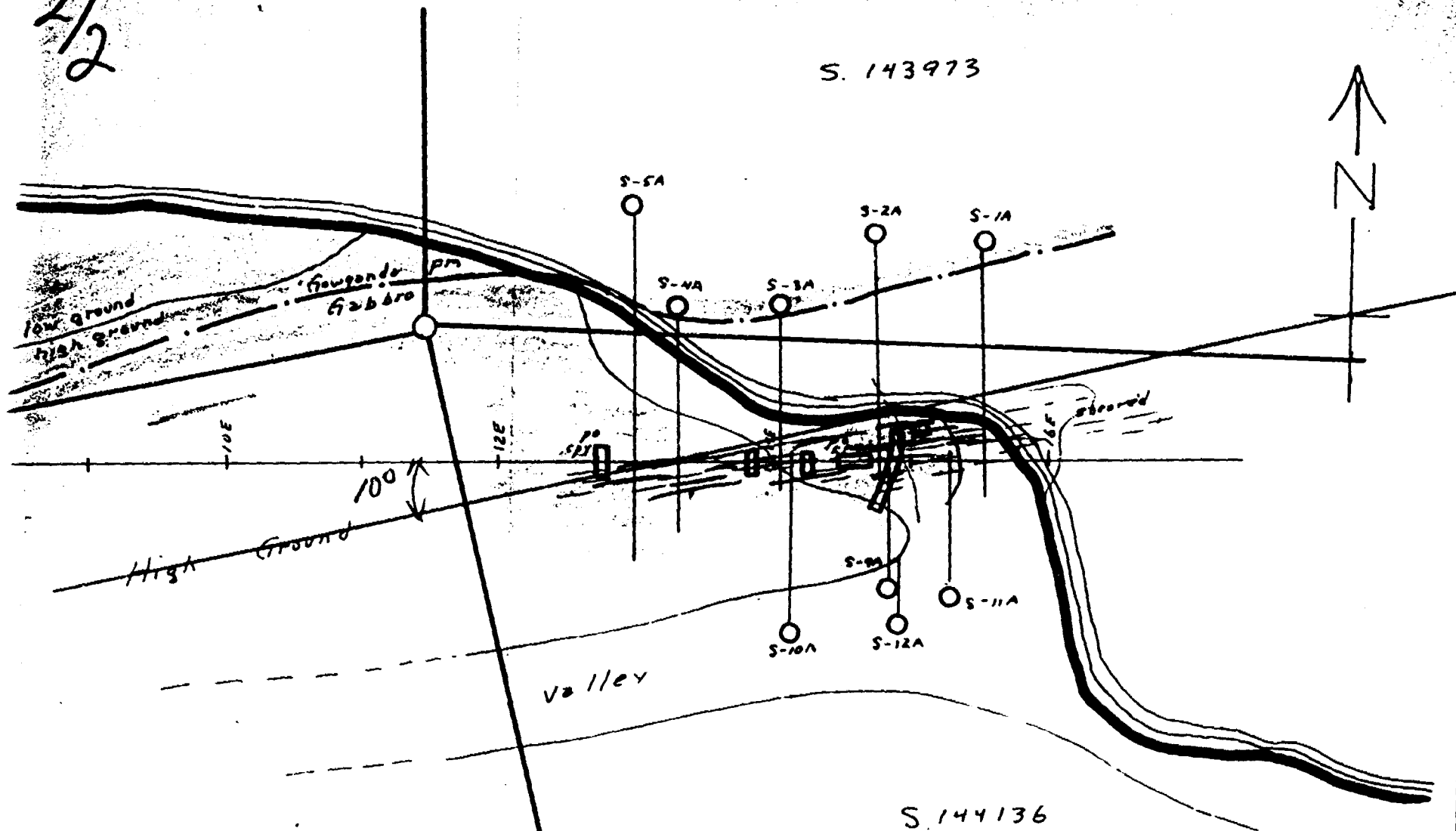

S. 144136

Tomrose Mines Ltd.
 Alba Drilling - 1956
 Davis Twp.

1" = 100' 1" = 100'

date Nov 167 Signed J.G. Harper
 NOV 167

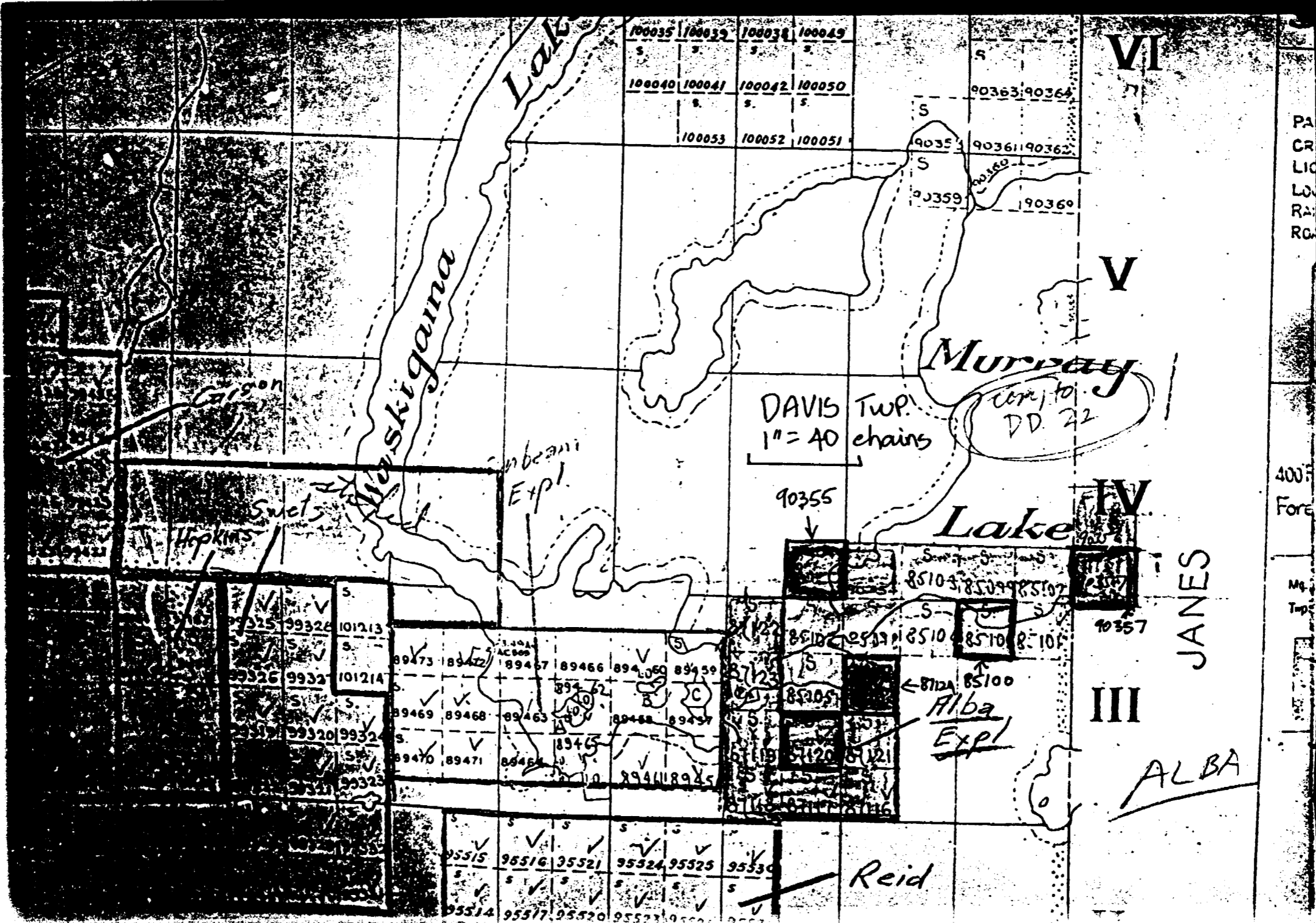

100035	100039	100038	100049
S	S	S	S
100040	100041	100042	100050
S	S	S	S
100053	100052	100051	

90363	90364
S	S
90353	90361
S	S
90359	90360
S	S

DAVIS TWP.
1" = 40 chains

cont. to
DD. 22

90355

Lake

99325	99326	101213	S
S	S	S	S
99326	99327	101214	S
S	S	S	S
99327	99328	99329	S
S	S	S	S
99328	99329	99330	S
S	S	S	S
99329	99330	99331	S
S	S	S	S
99330	99331	99332	S
S	S	S	S
99331	99332	99333	S
S	S	S	S
99332	99333	99334	S
S	S	S	S
99333	99334	99335	S
S	S	S	S
99334	99335	99336	S
S	S	S	S
99335	99336	99337	S
S	S	S	S
99336	99337	99338	S
S	S	S	S
99337	99338	99339	S
S	S	S	S
99338	99339	99340	S
S	S	S	S
99339	99340	99341	S
S	S	S	S
99340	99341	99342	S
S	S	S	S
99341	99342	99343	S
S	S	S	S
99342	99343	99344	S
S	S	S	S
99343	99344	99345	S
S	S	S	S
99344	99345	99346	S
S	S	S	S
99345	99346	99347	S
S	S	S	S
99346	99347	99348	S
S	S	S	S
99347	99348	99349	S
S	S	S	S
99348	99349	99350	S
S	S	S	S
99349	99350	99351	S
S	S	S	S
99350	99351	99352	S
S	S	S	S
99351	99352	99353	S
S	S	S	S
99352	99353	99354	S
S	S	S	S
99353	99354	99355	S
S	S	S	S
99354	99355	99356	S
S	S	S	S
99355	99356	99357	S
S	S	S	S
99356	99357	99358	S
S	S	S	S
99357	99358	99359	S
S	S	S	S
99358	99359	99360	S
S	S	S	S
99359	99360	99361	S
S	S	S	S
99360	99361	99362	S
S	S	S	S
99361	99362	99363	S
S	S	S	S
99362	99363	99364	S
S	S	S	S
99363	99364	99365	S
S	S	S	S
99364	99365	99366	S
S	S	S	S
99365	99366	99367	S
S	S	S	S
99366	99367	99368	S
S	S	S	S
99367	99368	99369	S
S	S	S	S
99368	99369	99370	S
S	S	S	S
99369	99370	99371	S
S	S	S	S
99370	99371	99372	S
S	S	S	S
99371	99372	99373	S
S	S	S	S
99372	99373	99374	S
S	S	S	S
99373	99374	99375	S
S	S	S	S
99374	99375	99376	S
S	S	S	S
99375	99376	99377	S
S	S	S	S
99376	99377	99378	S
S	S	S	S
99377	99378	99379	S
S	S	S	S
99378	99379	99380	S
S	S	S	S
99379	99380	99381	S
S	S	S	S
99380	99381	99382	S
S	S	S	S
99381	99382	99383	S
S	S	S	S
99382	99383	99384	S
S	S	S	S
99383	99384	99385	S
S	S	S	S
99384	99385	99386	S
S	S	S	S
99385	99386	99387	S
S	S	S	S
99386	99387	99388	S
S	S	S	S
99387	99388	99389	S
S	S	S	S
99388	99389	99390	S
S	S	S	S
99389	99390	99391	S
S	S	S	S
99390	99391	99392	S
S	S	S	S
99391	99392	99393	S
S	S	S	S
99392	99393	99394	S
S	S	S	S
99393	99394	99395	S
S	S	S	S
99394	99395	99396	S
S	S	S	S
99395	99396	99397	S
S	S	S	S
99396	99397	99398	S
S	S	S	S
99397	99398	99399	S
S	S	S	S
99398	99399	99400	S
S	S	S	S

IV

III

JANES

ALBA

Reid

PA
CR
LIC
LO
RA
RO

400
Fore

M
Twp

S. L. MACDONALD
MINING ENGINEER



41109NW0066 0010 DAVIS

300

Second Floor
145 Yonge Street
Toronto 1, Ontario
Tel. EM. 3-0737

November 16th, 1955.

Ontario Department of Mines,
Queens Park,
Toronto, Ontario.

Gentlemen:

Re: Claims Nos. S-85098 to S-85106 inc.
DAVIS TOWNSHIP
SUDBURY MINING DIVISION

This group of claims is owned outright by ALBA EXPLORATIONS LIMITED, Suite 402, 100 Adelaide Street West, Toronto and any assessment work carried out should be recorded in their name.

Yours truly,

(S. L. Macdonald)

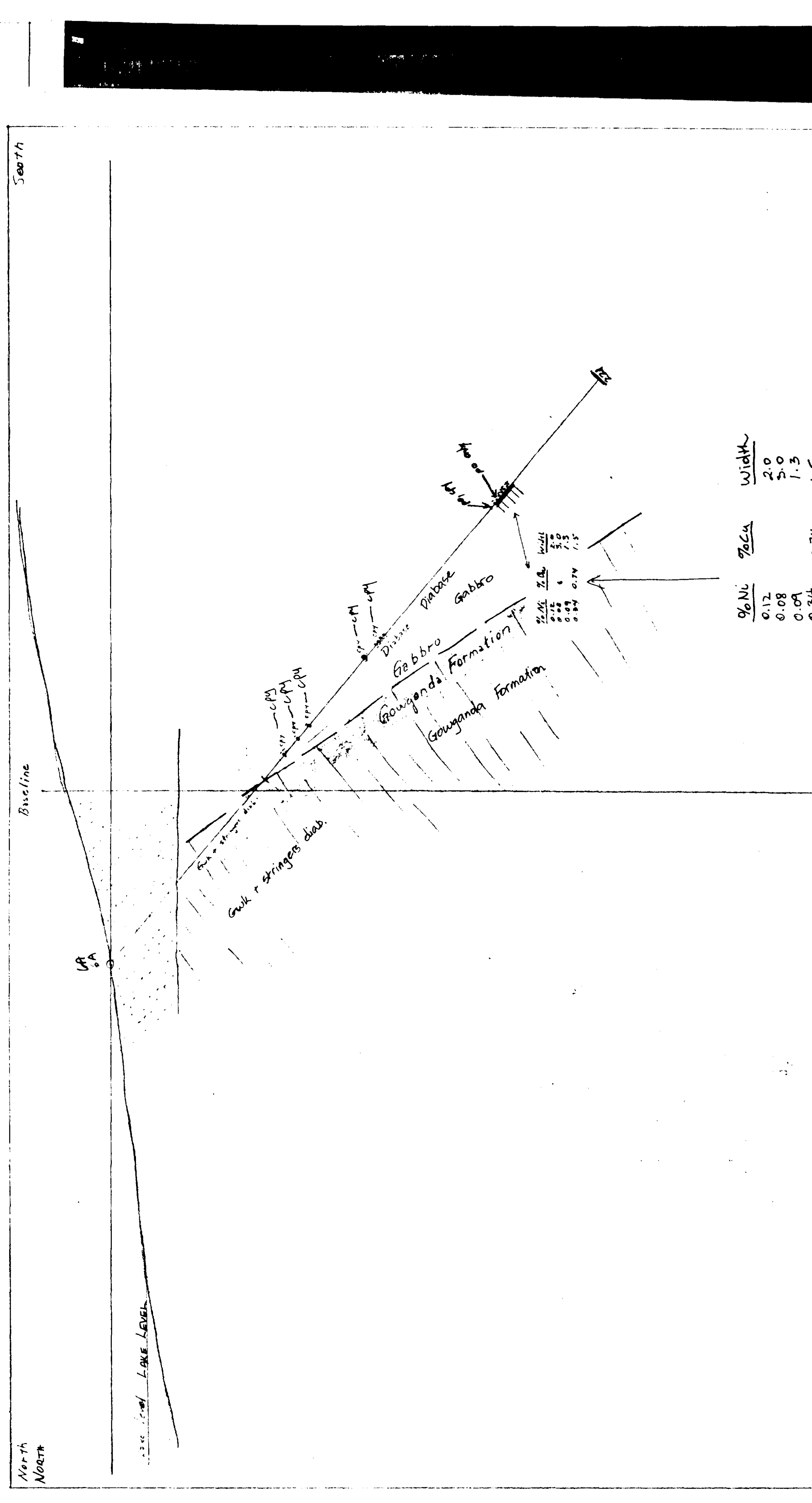
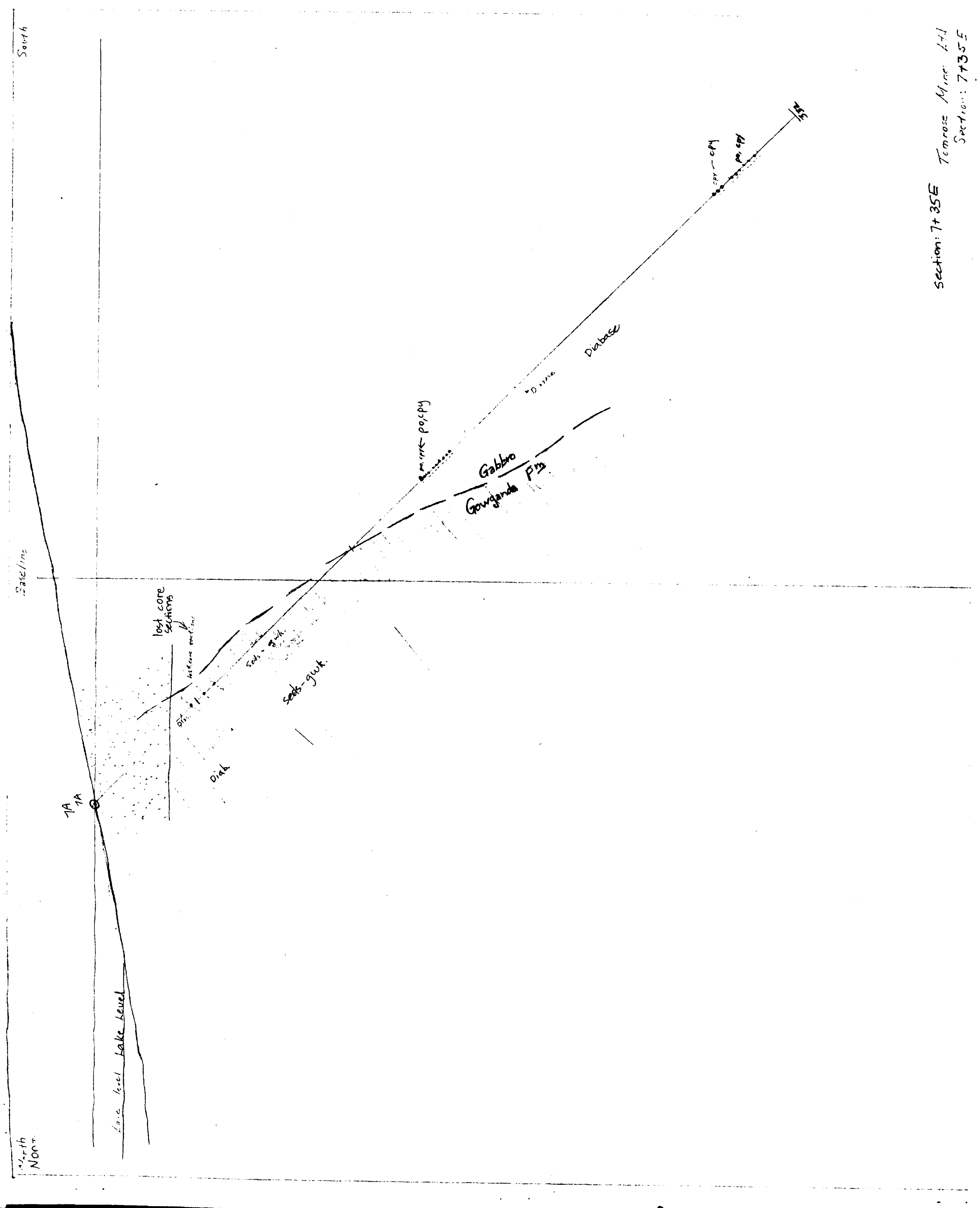

Gr. No.	Area	Width
0.12	20	2.0
0.08	20	1.6
0.04	20	0.8

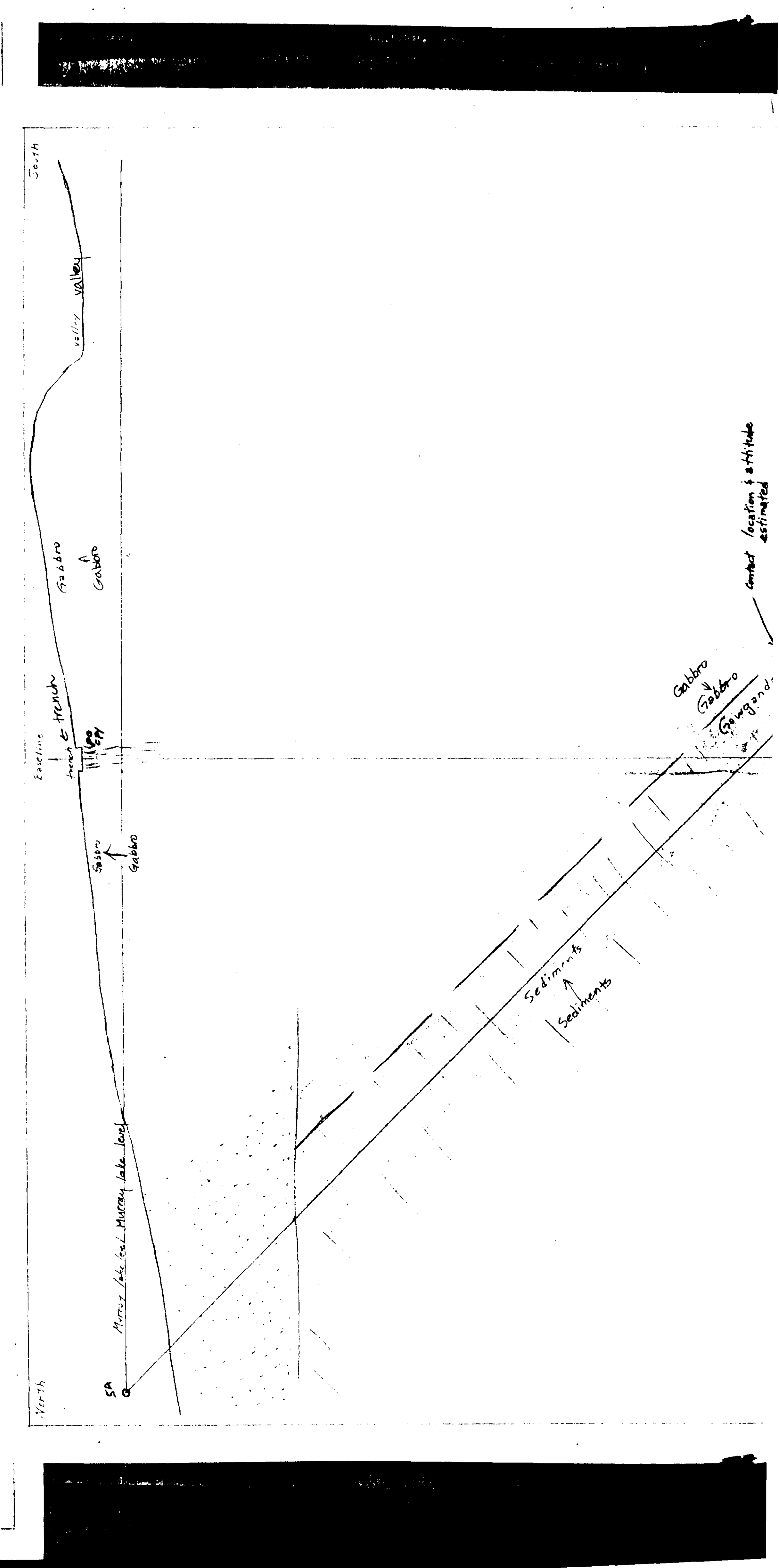
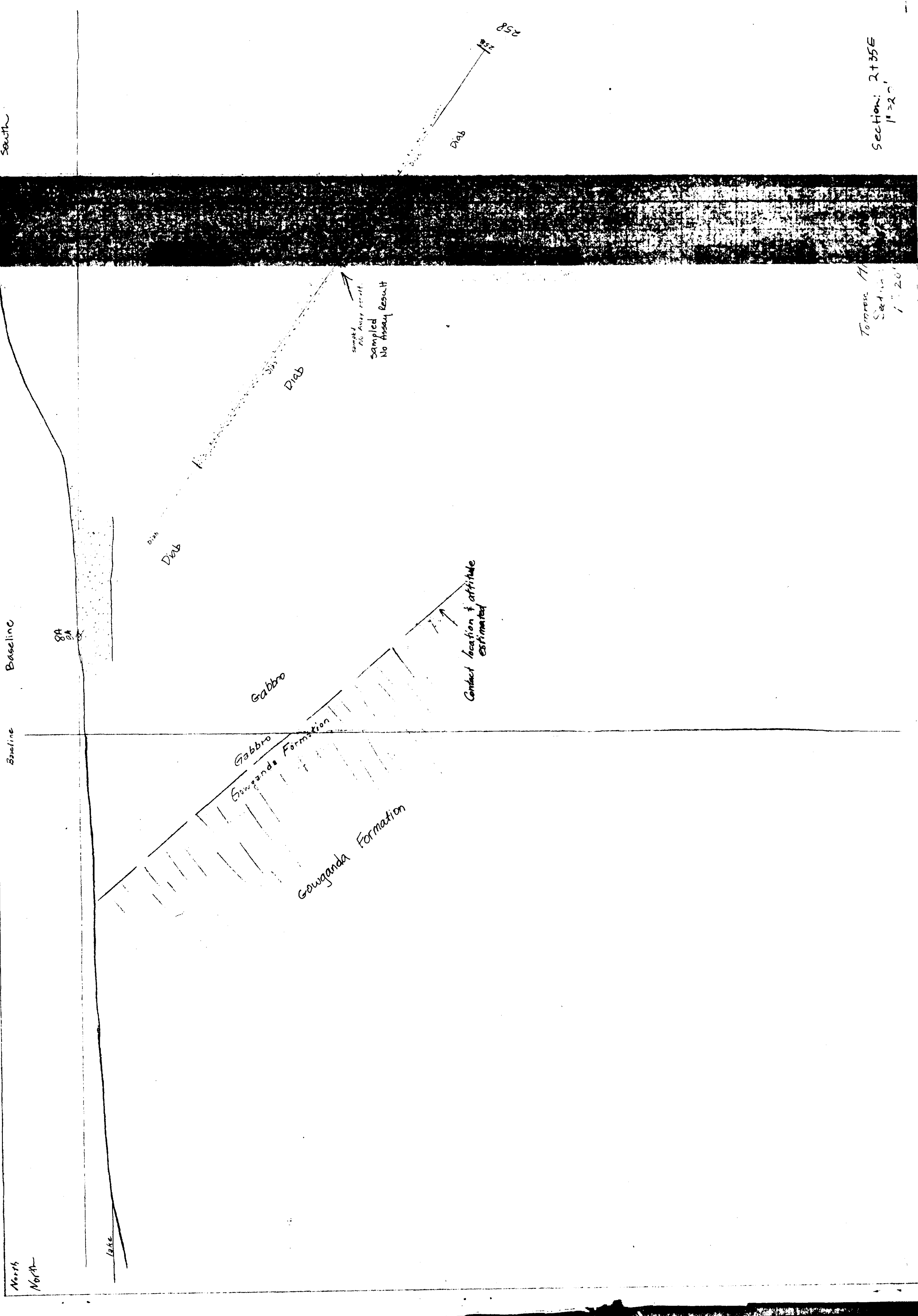

contact location & attitude estimated

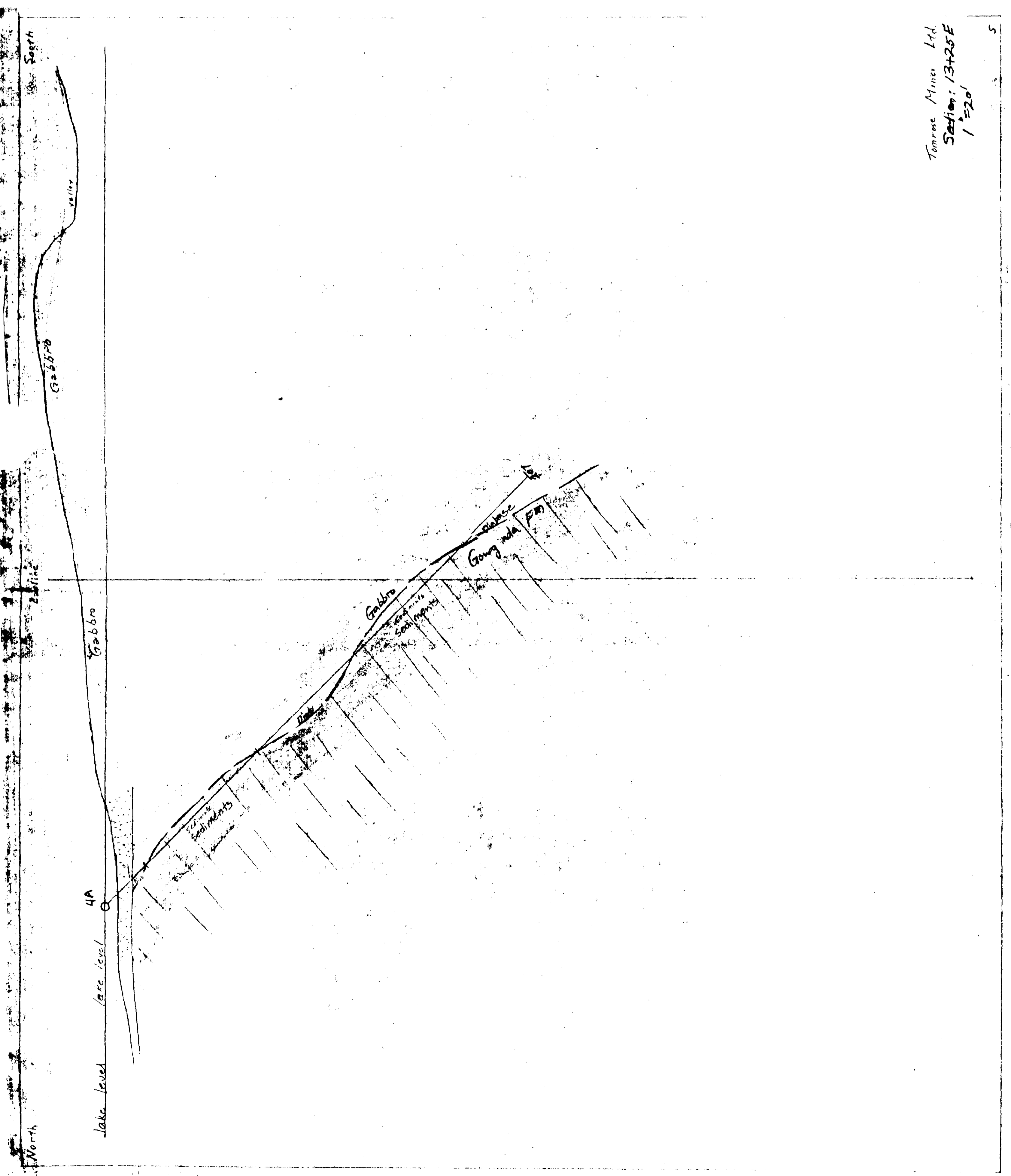

TOMARLE MINES LTD.
SECTION 13420E
1/520

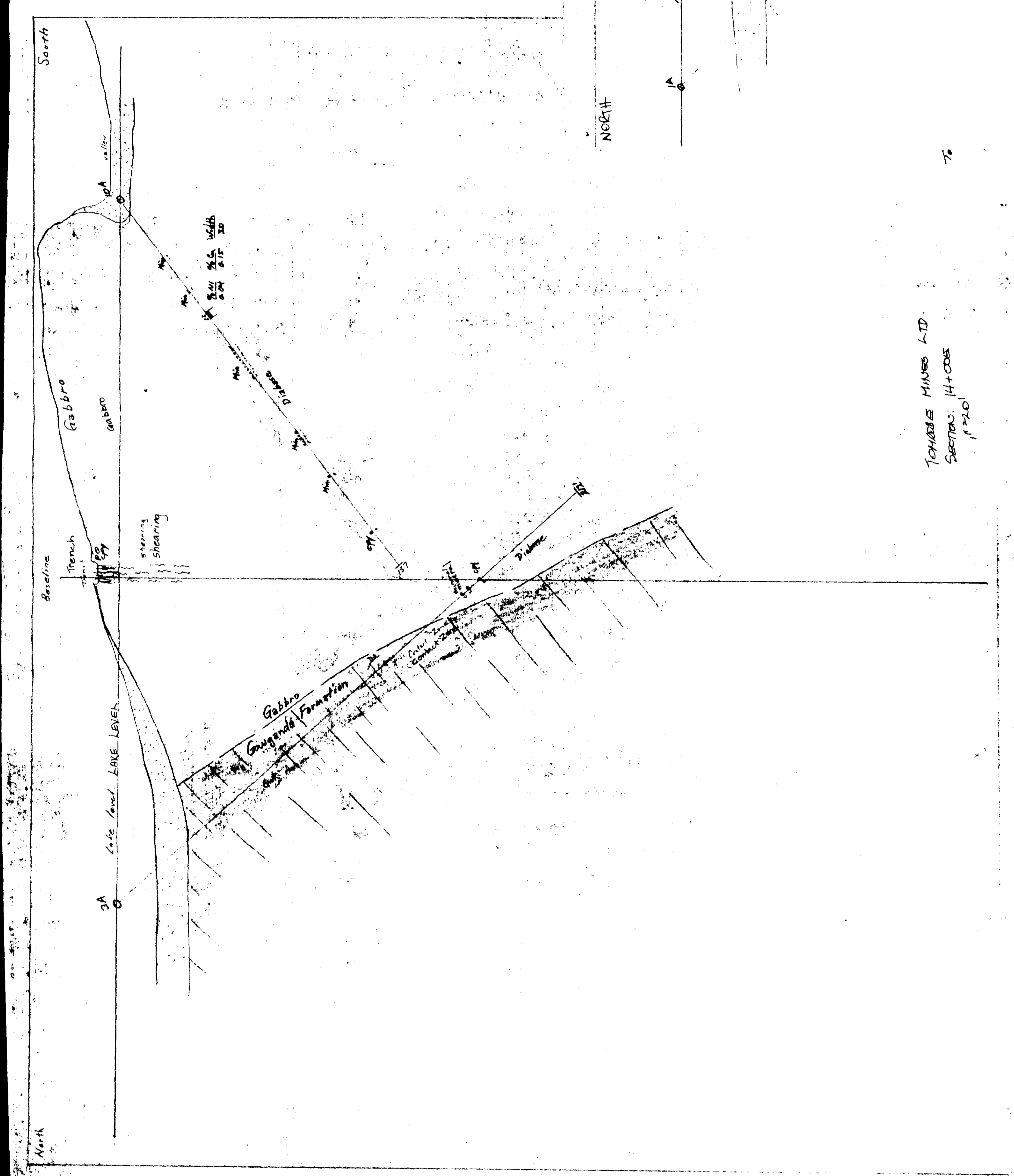
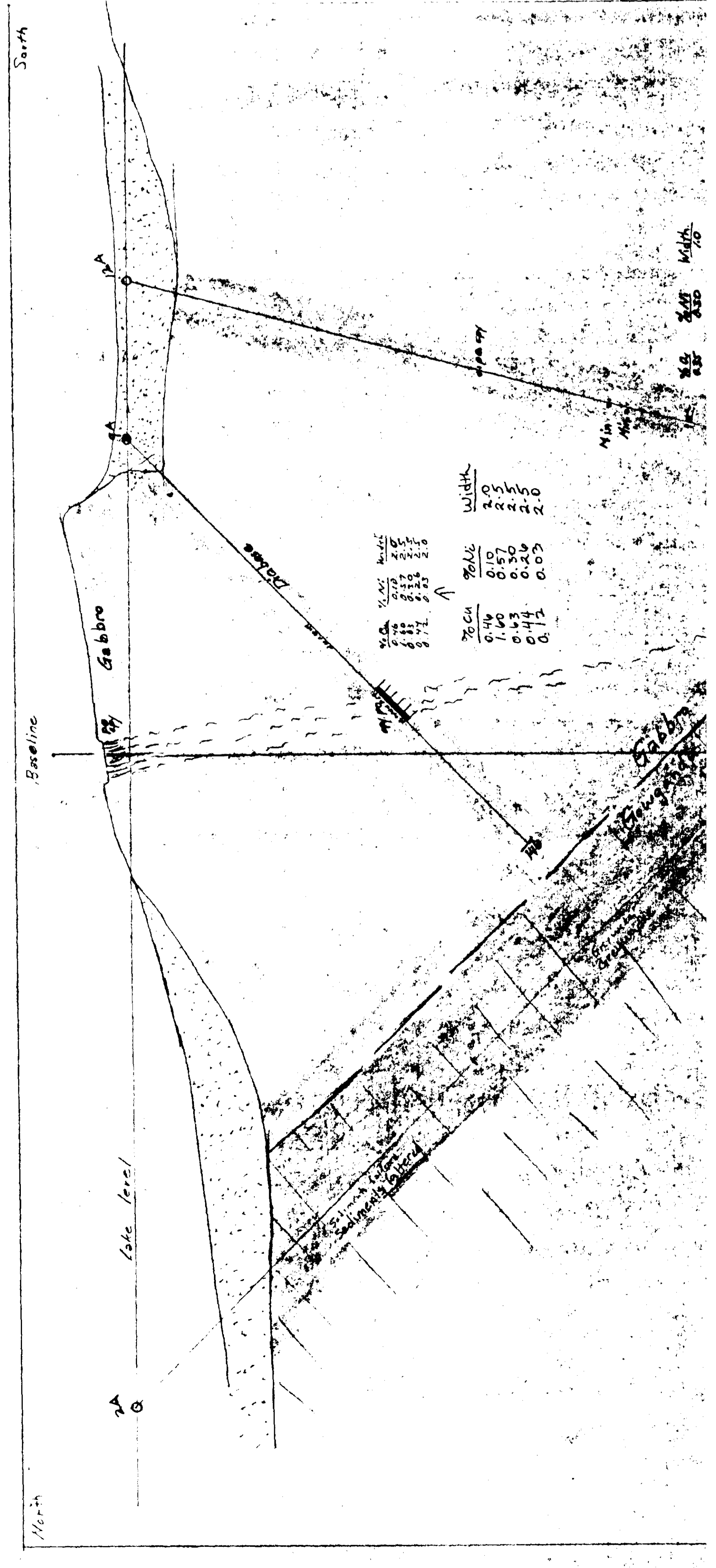

TOMARLE MINES LTD.
SECTION 14100E
1/520

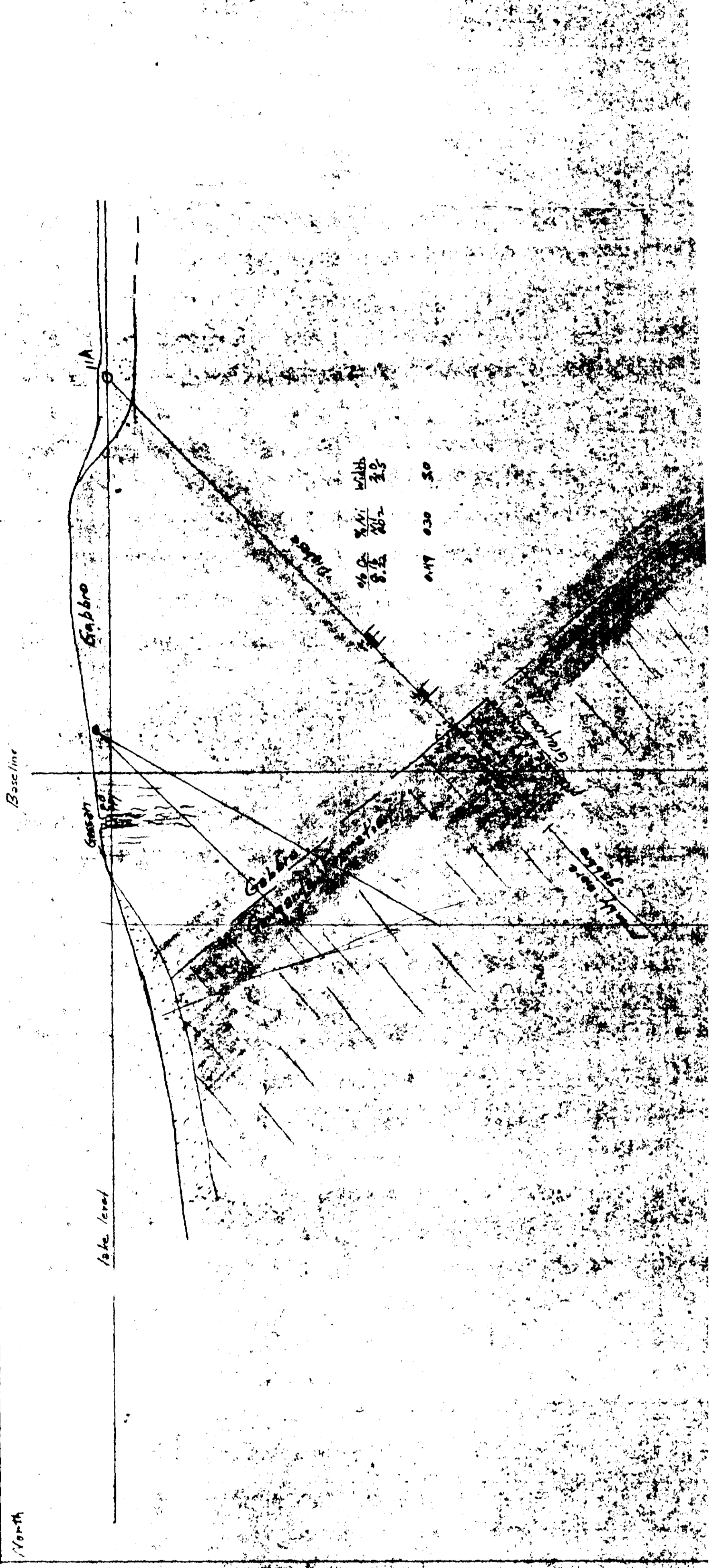

TOMARLE MINES LTD.
SECTION 15150E

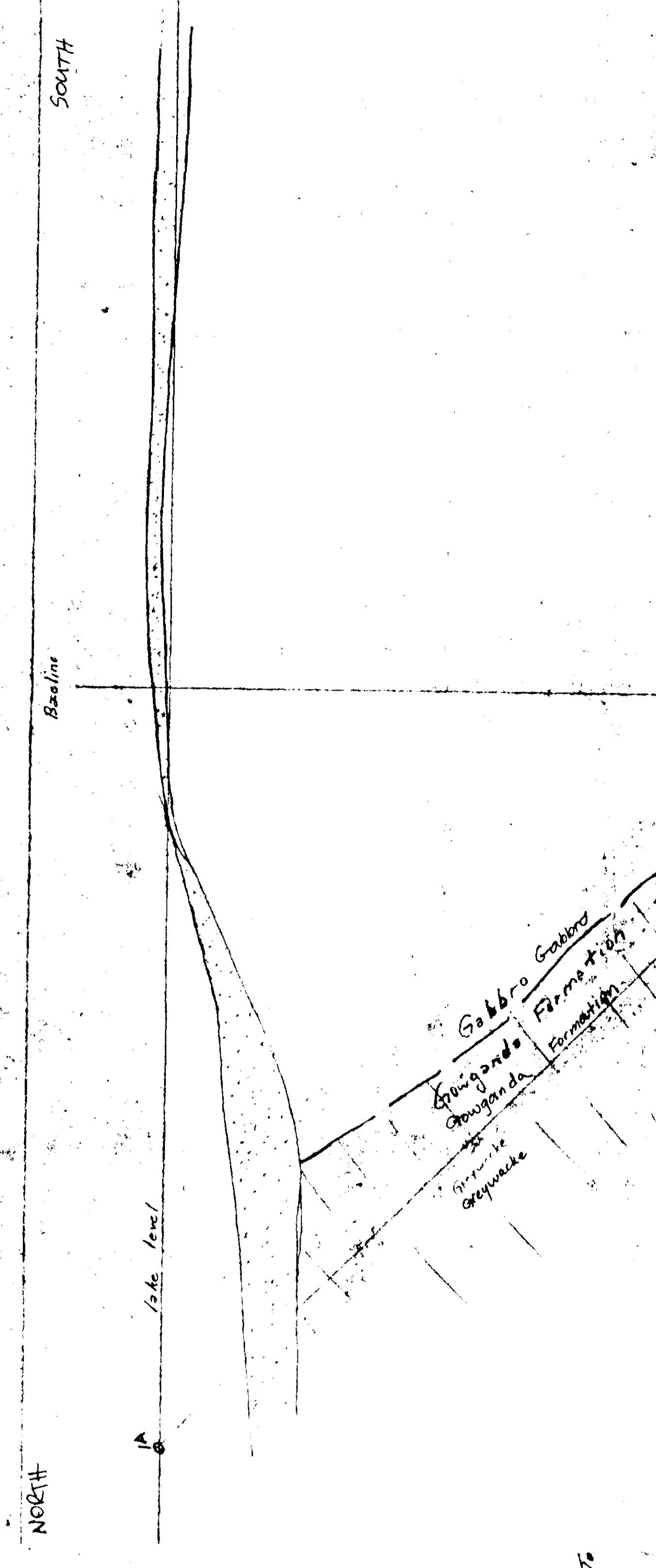
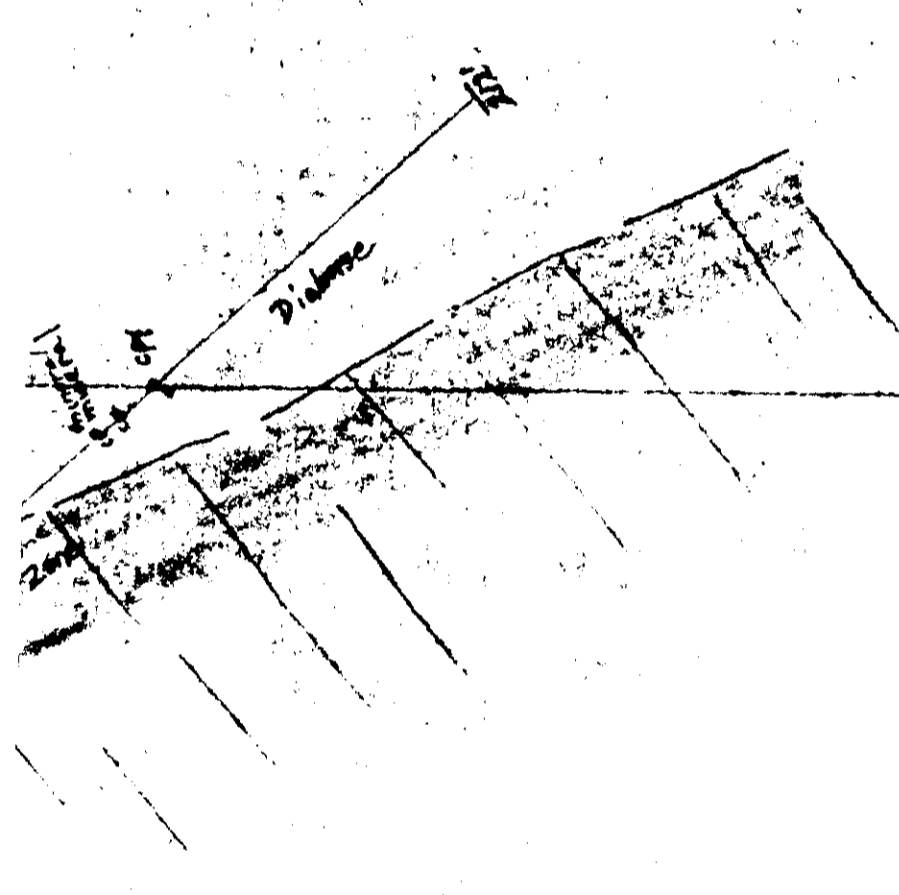

TOMMIE MINES LTD.
SECTION: 14+005
1" = 20'

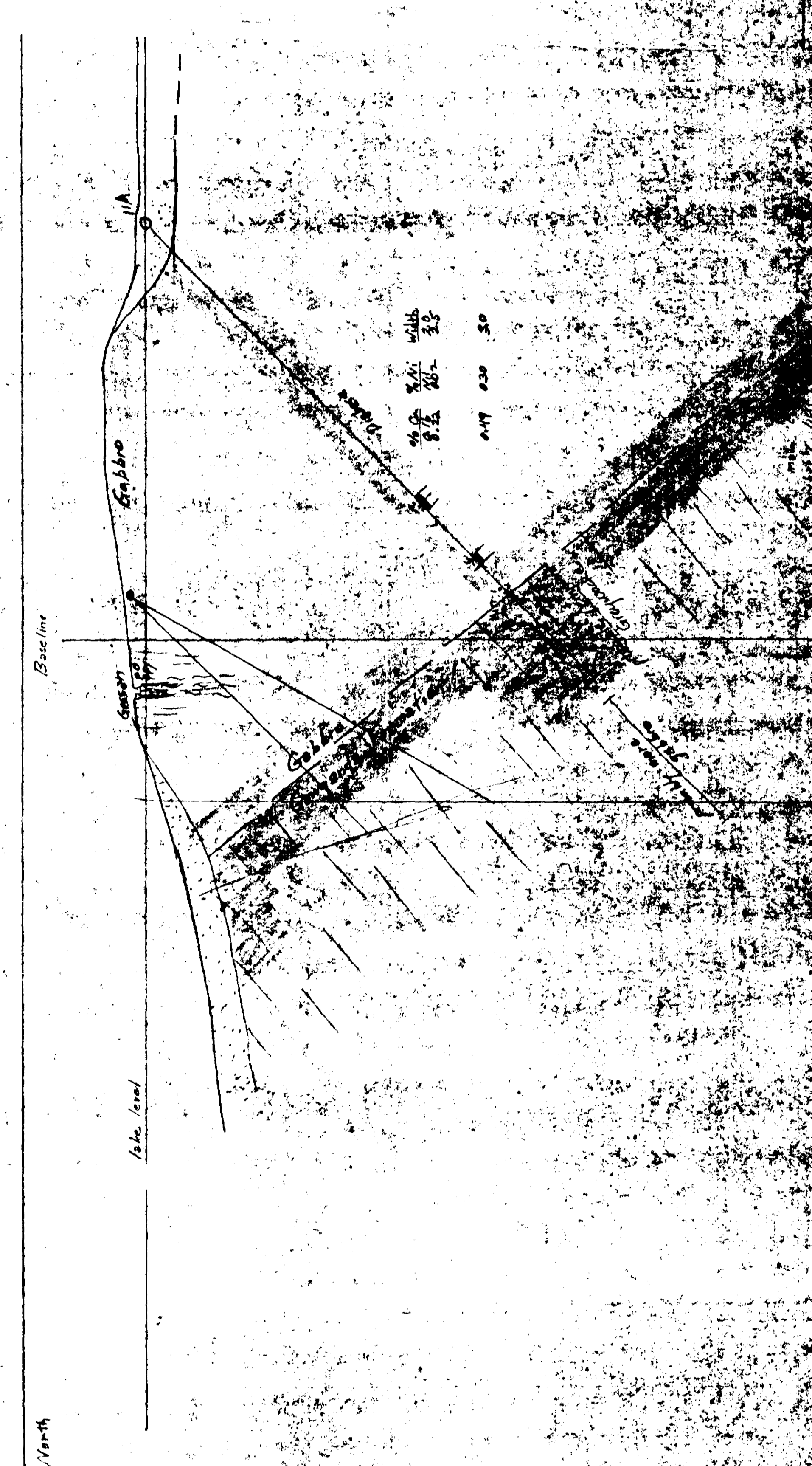

TOMMIE MINES LTD.
SECTION: 15+005
1" = 20'

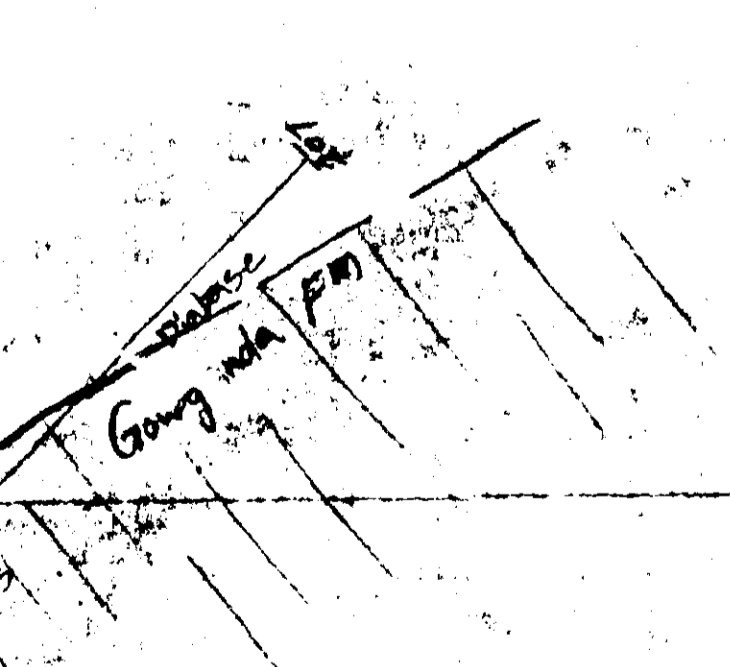

TOMMIE MINES LTD.
SECTION: 13+005E
1" = 20'

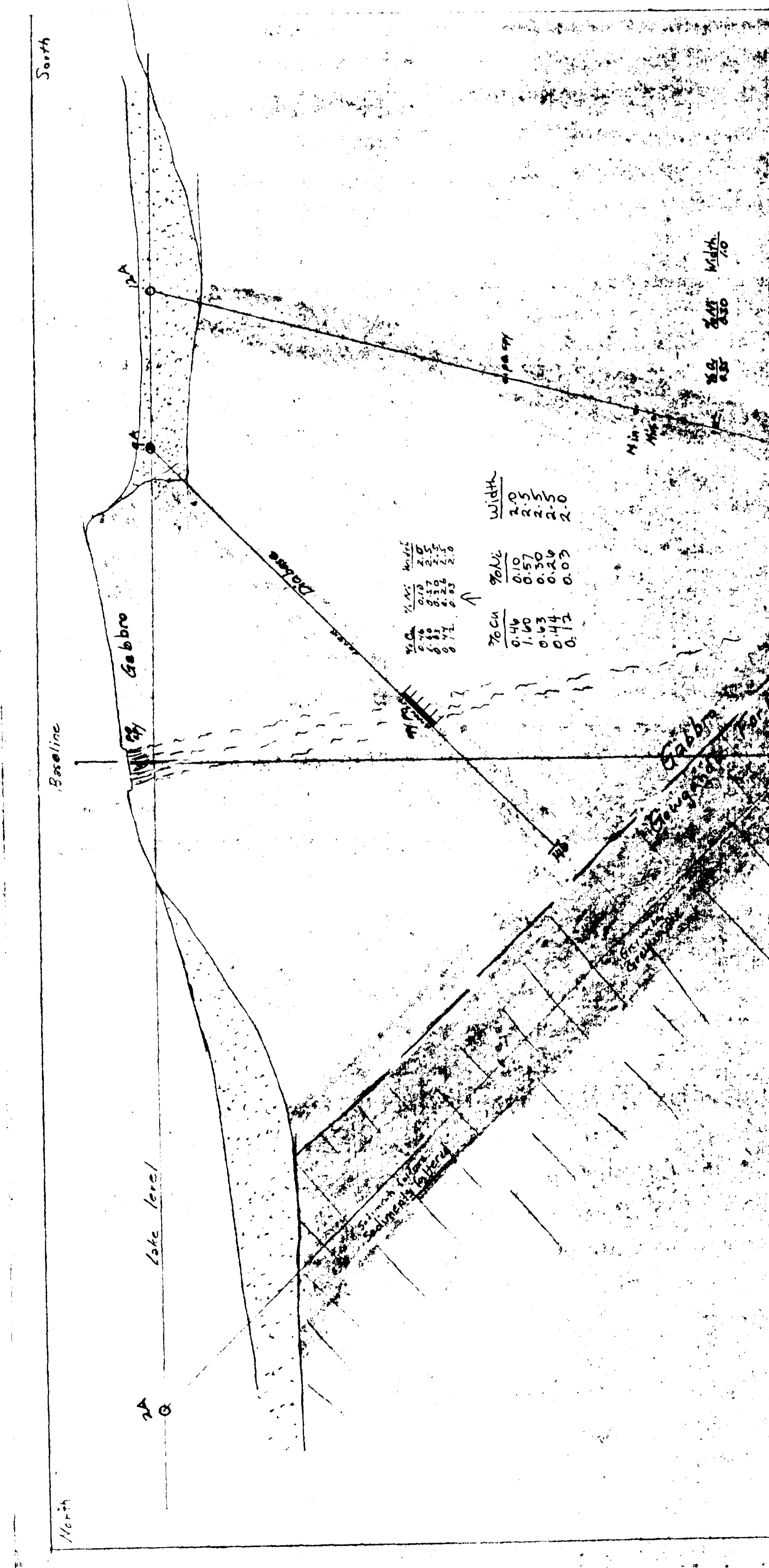

Loc	Top	Bottom	Width
1	100	100	100
2	100	100	100
3	100	100	100
4	100	100	100
5	100	100	100
6	100	100	100
7	100	100	100
8	100	100	100
9	100	100	100
10	100	100	100

★ DAVIS-0010 #2

TOMMIE MINES LTD.
SECTION: 13+005E
1" = 20'

