



411095E0011 0011 CRERAR

010

# Diamond Drilling

Township of CRERAR

Report NO 11

Work performed by: Tomrose Mines Limited

| Claim NO | Hole NO | Footage | Date    | Note |
|----------|---------|---------|---------|------|
| T 52410  | 1       | 106.0'  | Aug/63  |      |
|          | 2       | 108.0'  | Aug/63  |      |
|          | 3       | 496.5'  | Sept/63 |      |
|          | 4       | 198.0'  | Sept/63 |      |
|          | 5       | 303.0'  | Sept/63 |      |
| T 51683  | 6       | 250.0'  | Sept/63 |      |
| T 52408  | 7       | 233.5'  | Oct/63  |      |
| T 51688  | 8       | 503.0'  | Oct/63  |      |
|          | 9       | 503.0'  | Nov/63  |      |
| T 51682  | 64-13   | 625.0'  | June/64 |      |
| T 51689  | 64-10   | 281.0'  | June/64 |      |
|          | 64-11   | 300.0'  | June/64 |      |
|          | 64-12   | 501.0'  | June/64 |      |

13

4408

Notes:



PROPERTY: TOMROSE MINES LTD. - Grerar Twp.

HOLE NO. 1.

|            |           |      |             |            |               |
|------------|-----------|------|-------------|------------|---------------|
| LATITUDE : | BEARING:  | DIP: | STARTED:    | COMPLETED: | Sheet 2 of 2. |
| DIAMETER:  | V.D.      | H.D. | DRILLED BY: |            | DEPTH:        |
| ELEVATION: | LOCATION: |      |             |            | LOGGED BY:    |

| FOOTAGE     | DESCRIPTION   | SAMPLE FOOTAGES | SAMPLE No. | WIDTH FT. | ASSAY DATA |  |  |  |  |  |
|-------------|---|-----------------|------------|-----------|------------|--|--|--|--|--|
|             |   |                 |            |           |            |  |  |  |  |  |
| 95.0 - 97.8 | Strongly Altered Amphibolite - Qtz injected, cse. grain |                 |            |           |            |  |  |  |  |  |
| 106         | GROUND CORE   |                 |            |           |            |  |  |  |  |  |
|             | END OF HOLE   |                 |            |           |            |  |  |  |  |  |
|             |   |                 |            |           |            |  |  |  |  |  |
|             |   |                 |            |           |            |  |  |  |  |  |
|             |   |                 |            |           |            |  |  |  |  |  |
|             |   |                 |            |           |            |  |  |  |  |  |
|             |   |                 |            |           |            |  |  |  |  |  |
|             |   |                 |            |           |            |  |  |  |  |  |
|             |   |                 |            |           |            |  |  |  |  |  |
|             |   |                 |            |           |            |  |  |  |  |  |
|             |   |                 |            |           |            |  |  |  |  |  |
|             |   |                 |            |           |            |  |  |  |  |  |
|             |   |                 |            |           |            |  |  |  |  |  |
|             |   |                 |            |           |            |  |  |  |  |  |
|             |   |                 |            |           |            |  |  |  |  |  |
|             |   |                 |            |           |            |  |  |  |  |  |
|             |   |                 |            |           |            |  |  |  |  |  |
|             |   |                 |            |           |            |  |  |  |  |  |
|             |   |                 |            |           |            |  |  |  |  |  |

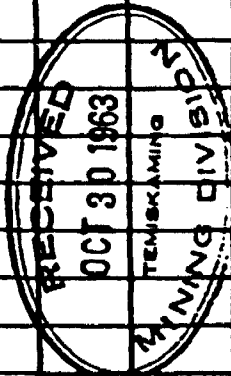

*[Handwritten signature/initials]*

PROPERTY: TOMROSE MINES LTD. - Creerar Twp.

LATITUDE: L28 + 25W BEARING: S 80° E DIP: - 85° STARTED: Aug. 12/63 COMPLETED: Aug. 21/63

DEPTH: 108. DRILLED BY: Arcade Dupras

ELEVATION: LOCATION: T52410 - 1300' N 20 E of #3 Post EXT. LOGGED BY: H.G.H.

BOLE NO. 2. Sheet 1 of 2

| FOOTAGE | DESCRIPTION   | SAMPLE FOOTAGES | SAMPLE No. | WIDTH FT. | ASSAY DATA |  |  |  |
|---------|---|-----------------|------------|-----------|------------|--|--|--|
|         |   |                 |            |           |            |  |  |  |
| 0 - 2.5 | Altered Intrusive - rich in garnet & chl. - cse grained - Minor diss py & pyr.  |                 |            |           |            |  |  |  |
| 5.0     | Qtz. rich section - replaced? lower contact @ 45°   |                 |            |           |            |  |  |  |
| 6.4     | 0.3 Qtz Vein - white, no mineral, chl. walls  |                 |            |           |            |  |  |  |
| 8.8     | Norite - fresh appearance   |                 |            |           |            |  |  |  |
| 12.3    | Norite - med fine grained - strong chl. - some diss. sulphides (5%) mostly py, some cpy.  |                 |            |           |            |  |  |  |
| 14.7    | Lamprophyre - very fine grained - sharp lower contact but angle indeterminate   |                 |            |           |            |  |  |  |
| 18.6    | Norite - cse grained - some blue quartz   |                 |            |           |            |  |  |  |
| 21.8    | Lamprophyre - Fractured @ 10°, chl filled. lower contact @ 45   |                 |            |           |            |  |  |  |
| 25.0    | Norite - med. fine grained. - Cse hyp. - Qtz. groundmass  |                 |            |           |            |  |  |  |
| 27.7    | Lamprophyre   |                 |            |           |            |  |  |  |
| 32.5    | Norite - cse hyp. Low in qtz.   |                 |            |           |            |  |  |  |
| 35      | Norite - massive hyp. (?) - mauve grey color  |                 |            |           |            |  |  |  |
| 37.5    | Norite - cse hyp. - Low in qtz.   |                 |            |           |            |  |  |  |
| 48      | Norite - Qtz rich phase   |                 |            |           |            |  |  |  |
| 51.6    | Lamprophyre   |                 |            |           |            |  |  |  |
|         | 55 - 55.2 Qtz stringer - grey - replaced @ 45   |                 |            |           |            |  |  |  |
| 59      | Norite - somewhat altered - hyp & odd blue qtz. fair sulphides, diss. py, cpy, pyr. - minor lamprophyre entering & fading rapidly sulphide sections - 77. & 82.5 - 83.2 |                 |            |           |            |  |  |  |
| 65      | Altered Norite - med. grained - highly irregular  |                 |            |           |            |  |  |  |
| 78      | Metamorphosed Sediments - highly variable - crudely   |                 |            |           |            |  |  |  |

|   |            |       |              |                    |               |
|---|------------|-------|--------------|--------------------|---------------|
| <b>PROPERTY: TOMROSE MINES LTD. - Grerar Twp.</b> |            |       |              | <b>FILE NO. 2.</b> |               |
| LATITUDE :  | BEARING :  | DIP : | STARTED :    | COMPLETED :        | Sheet 2 of 2. |
| DIAMETER :  | V.D.       | H.D.  | DRILLED BY : |                    | DEPTH :       |
| ELEVATION :                                       | LOCATION : |       |              |                    | LOGGED BY :   |

| FOOTAGE   | DESCRIPTION  | SAMPLE FOOTAGES | SAMPLE No. | WIDTH FT. | ASSAY DATA |  |  |  |  |  |
|-----------|--|-----------------|------------|-----------|------------|--|--|--|--|--|
|           |  |                 |            |           |            |  |  |  |  |  |
|           | gneissic from 45 - 60 - Biotite, garnet & quartzic bands irregularly dispersed. Some injected qtz. |                 |            |           |            |  |  |  |  |  |
| 78 - 83.2 | Original Quartzite (?) - gneissic @ 45   |                 |            |           |            |  |  |  |  |  |
| 108       | Biotite Amphibolite - med. fine grained - some very soft sections due to chlorite content          |                 |            |           |            |  |  |  |  |  |
|           | 94.2 - 95 Ground Core  |                 |            |           |            |  |  |  |  |  |
|           | 100 - 108 Ground Core  |                 |            |           |            |  |  |  |  |  |
|           | END OF HOLE  |                 |            |           |            |  |  |  |  |  |
|           |  |                 |            |           |            |  |  |  |  |  |
|           |  |                 |            |           |            |  |  |  |  |  |
|           |  |                 |            |           |            |  |  |  |  |  |
|           |  |                 |            |           |            |  |  |  |  |  |
|           |  |                 |            |           |            |  |  |  |  |  |
|           |  |                 |            |           |            |  |  |  |  |  |
|           |  |                 |            |           |            |  |  |  |  |  |
|           |  |                 |            |           |            |  |  |  |  |  |
|           |  |                 |            |           |            |  |  |  |  |  |
|           |  |                 |            |           |            |  |  |  |  |  |
|           |  |                 |            |           |            |  |  |  |  |  |
|           |  |                 |            |           |            |  |  |  |  |  |
|           |  |                 |            |           |            |  |  |  |  |  |
|           |  |                 |            |           |            |  |  |  |  |  |
|           |  |                 |            |           |            |  |  |  |  |  |
|           |  |                 |            |           |            |  |  |  |  |  |
|           |  |                 |            |           |            |  |  |  |  |  |
|           |  |                 |            |           |            |  |  |  |  |  |
|           |  |                 |            |           |            |  |  |  |  |  |

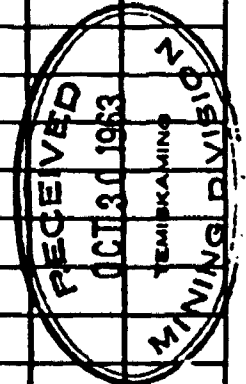

H. W. Harris





PROPERTY: TOMROSE MINES LTD. - Grerar Twp.

ROLL NO. 3  
Sheet 3 of 3.

LATITUDE :

BEARING:

DIP:

STARTED:

COMPLETED:

SHAPE:

V.D.

H.D.

DRILLED BY:

DEPTH:

ELEVATION:

LOCATION:

LOGGED BY:

| FOOTAGE     | DESCRIPTION   | SAMPLE FOOTAGES | SAMPLE No. | WIDTH FT. | ASSAY DATA |  |  |  |  |  |
|-------------|---|-----------------|------------|-----------|------------|--|--|--|--|--|
|             |   |                 |            |           |            |  |  |  |  |  |
| 463.5 - 470 | Altered Anorthosite - some gneissosity                                      |                 |            |           |            |  |  |  |  |  |
| 470         | Lamprophyre   |                 |            |           |            |  |  |  |  |  |
| 496.5       | Anorthosite - rather too heavy in dk. mineral<br>some minor gneissic phases |                 |            |           |            |  |  |  |  |  |
|             | END OF HOLE   |                 |            |           |            |  |  |  |  |  |
|             |   |                 |            |           |            |  |  |  |  |  |
|             |   |                 |            |           |            |  |  |  |  |  |
|             |   |                 |            |           |            |  |  |  |  |  |
|             |   |                 |            |           |            |  |  |  |  |  |
|             |   |                 |            |           |            |  |  |  |  |  |
|             |   |                 |            |           |            |  |  |  |  |  |
|             |   |                 |            |           |            |  |  |  |  |  |
|             |   |                 |            |           |            |  |  |  |  |  |
|             |   |                 |            |           |            |  |  |  |  |  |
|             |   |                 |            |           |            |  |  |  |  |  |
|             |   |                 |            |           |            |  |  |  |  |  |
|             |   |                 |            |           |            |  |  |  |  |  |
|             |   |                 |            |           |            |  |  |  |  |  |
|             |   |                 |            |           |            |  |  |  |  |  |
|             |   |                 |            |           |            |  |  |  |  |  |
|             |   |                 |            |           |            |  |  |  |  |  |
|             |   |                 |            |           |            |  |  |  |  |  |
|             |   |                 |            |           |            |  |  |  |  |  |
|             |   |                 |            |           |            |  |  |  |  |  |
|             |   |                 |            |           |            |  |  |  |  |  |
|             |   |                 |            |           |            |  |  |  |  |  |
|             |   |                 |            |           |            |  |  |  |  |  |

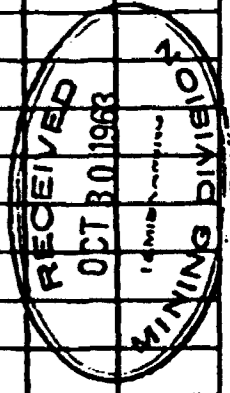

*N.G. Hampton*





|  |           |             |            |
|--|-----------|-------------|------------|
| PROPERTY: TOMROSE MINES LTD. - Grerar Twp. |           |             | HOLE NO. 4 |
| LATITUDE :                                 | BEARING:  | DIP:        | STARTED:   |
| DEPTH:                                     | V.D.      | H.D.        | COMPLETED: |
| ELEVATION:                                 | LOCATION: | DRILLED BY: | DEPTH:     |
|  |           |             | LOGGED BY: |

| FOOTAGE     | DESCRIPTION  | SAMPLE FOOTAGES | SAMPLE No. | WIDTH FT. | ASSAY DATA |  |  |  |  |
|-------------|--|-----------------|------------|-----------|------------|--|--|--|--|
|             |  |                 |            |           |            |  |  |  |  |
| 171 - 173.6 | Altered Norite - med. cse grained - very irregular   |                 |            |           |            |  |  |  |  |
| 176.        | Lamprophyre - upper contact sharp at 30<br>lower contact diffuse @ 30                              |                 |            |           |            |  |  |  |  |
| 186.7       | Norite - somewhat altered - lt. grey col. - Med.<br>grained - Some scatt. sulphides                |                 |            |           |            |  |  |  |  |
| 198         | Altered Zone - gneissosity weakly developed @ 30 -<br>Rich in chl. - probably approaching contact. |                 |            |           |            |  |  |  |  |
|             | - END OF HOLE -  |                 |            |           |            |  |  |  |  |
|             |  |                 |            |           |            |  |  |  |  |
|             |  |                 |            |           |            |  |  |  |  |
|             |  |                 |            |           |            |  |  |  |  |
|             |  |                 |            |           |            |  |  |  |  |
|             |  |                 |            |           |            |  |  |  |  |
|             |  |                 |            |           |            |  |  |  |  |
|             |  |                 |            |           |            |  |  |  |  |
|             |  |                 |            |           |            |  |  |  |  |
|             |  |                 |            |           |            |  |  |  |  |
|             |  |                 |            |           |            |  |  |  |  |
|             |  |                 |            |           |            |  |  |  |  |
|             |  |                 |            |           |            |  |  |  |  |
|             |  |                 |            |           |            |  |  |  |  |
|             |  |                 |            |           |            |  |  |  |  |
|             |  |                 |            |           |            |  |  |  |  |
|             |  |                 |            |           |            |  |  |  |  |
|             |  |                 |            |           |            |  |  |  |  |

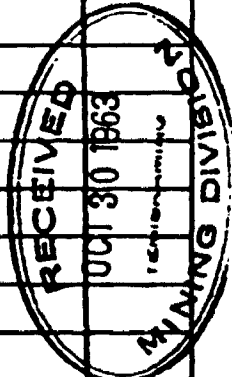

M.G. Horne

PROPERTY: TOMROSE MINES LTD. - Grerar Twp.

LATITUDE: L 29 + 90W

BEARING: S 15° W

DIP: - 60°

STARTED: Sept. 20/63

COMPLETED: Sept. 24/63

HOLE NO. 5.

Sheet 1 of 2.

DEPTH: 3 + 75 N

V.D. 262.

H.D. 153

DRILLED BY: S. Bradley, Sturgeon Falls.

DEPTH: 303

ELEVATION:

LOCATION: T 52410 - 400' N 25 E of #3 Post

EXT.

LOGGED BY: H.G.H.

| DEPTH   | DESCRIPTION   | SAMPLE FOOTAGES | SAMPLE No. | WIDTH FT. | ASSAY DATA |  |  |  |
|---------|---|-----------------|------------|-----------|------------|--|--|--|
|         |   |                 |            |           |            |  |  |  |
| 0 - 7.5 | Casing  |                 |            |           |            |  |  |  |
| 8.5     | Norite  |                 |            |           |            |  |  |  |
| 34.2    | Lamprophyre or DIORITE (?) - Fine grained to med. fine grained - White feldspar in dk chloritic matrix. |                 |            |           |            |  |  |  |
| 62.5    | Altered Intrusive - chl. rims - cse grained but variable. Minor diss. py, cpy & pyr. locally            |                 |            |           |            |  |  |  |
| 67.4    | Norite - hypersthene (?) phenocrysts in dk groundmass   |                 |            |           |            |  |  |  |
| 75.5    | Norite - very cse grained - grey black  |                 |            |           |            |  |  |  |
| 80.0    | Norite - light grey color   |                 |            |           |            |  |  |  |
| 86.6    | Norite - med. cse grained - dioritic  |                 |            |           |            |  |  |  |
| 87.3    | Fine Grained Phase - upper contact @ 45   |                 |            |           |            |  |  |  |
| 92.1    | Norite - very cse grained - dioritic  |                 |            |           |            |  |  |  |
| 94.2    | Norite - med. grained - dioritic  |                 |            |           |            |  |  |  |
| 98.5    | Norite - qtz injected - cse grained   |                 |            |           |            |  |  |  |
| 100     | GARNET Phase  |                 |            |           |            |  |  |  |
| 102.6   | Diorite - med cse grained   |                 |            |           |            |  |  |  |
| 104.7   | Lamprophyre - contacts at 90  |                 |            |           |            |  |  |  |
| 108.8   | Norite - very cse grained   |                 |            |           |            |  |  |  |
| 118.0   | Fine Grained Phase - some narrow cse greenish bands included  |                 |            |           |            |  |  |  |
| 132.6   | Norite - cse grained  |                 |            |           |            |  |  |  |
| 134.6   | Fine grained Phase  |                 |            |           |            |  |  |  |
| 135.5   | Norite - cse grained  |                 |            |           |            |  |  |  |

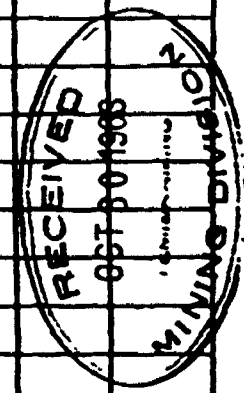

PROPERTY: TOMROSE MINES LTD. - Grerar Twp.

HOLE NO. 5  
Sheet 2 of 2.

|            |           |      |             |            |            |
|------------|-----------|------|-------------|------------|------------|
| LATITUDE : | BEARING:  | DIP: | STARTED:    | COMPLETED: | DEPTH:     |
| DEPTURE:   | V.D.      | H.D. | DRILLED BY: |            | LOGGED BY: |
| ELEVATION: | LOCATION: |      |             |            |            |

| FOOTAGE     | DESCRIPTION  | SAMPLE FOOTAGES | SAMPLE No. | WIDTH FT. | ASSAY DATA |  |  |  |  |
|-------------|--|-----------------|------------|-----------|------------|--|--|--|--|
|             |  |                 |            |           |            |  |  |  |  |
| 135.5-136.9 | Fine Grained Phase   |                 |            |           |            |  |  |  |  |
| 143.9       | Mineralized Norite - Py, pyr, & cpy up to 5% filling<br>narrow fractures @ 90 but mostly filling interstices                                       |                 |            |           |            |  |  |  |  |
| 154.6       | Norite - cse grained   |                 |            |           |            |  |  |  |  |
| 158.5       | Mineralized Norite - Interstitial py, pyr & cpy (1%+)  |                 |            |           |            |  |  |  |  |
| 214.6       | Norite - cse grained - local 4" to 6" bands carry<br>- med. fine grained<br>up to 5% combined py, pyr & cpy. - Minor diss.<br>sulphides throughout |                 |            |           |            |  |  |  |  |
| 223.0       | Altered Norite - Crudely gneissic or banded @ 30<br>1/4" tale seem at 216.5 @ 30 - strong cpy assoc.   |                 |            |           |            |  |  |  |  |
|             | 218.5 - 2" Qtz Vein with 1" qtz crystal  |                 |            |           |            |  |  |  |  |
| 224.4       | Fine Grained Phase   |                 |            |           |            |  |  |  |  |
| 229         | Norite - cse grained - Scatt. low sulphides  |                 |            |           |            |  |  |  |  |
| 268.9       | Norite - cse grained.<br>243.8 Fault GOUGE ????? - 2"  |                 |            |           |            |  |  |  |  |
| 270.8       | Fine Grained Phase   |                 |            |           |            |  |  |  |  |
| 283.4       | Norite - cse grained<br>280 - 1" heavy sulphides   |                 |            |           |            |  |  |  |  |
| 289         | Fine Grained Phase   |                 |            |           |            |  |  |  |  |
| 290         | Altered Norite (?) - very cse grained - chl rims   |                 |            |           |            |  |  |  |  |
| 292         | Amphibolite - lt. grey - gneissic @ 45   |                 |            |           |            |  |  |  |  |
| 293.5       | Qtz. VEIN - 45 - glassy, white - no sulphides  |                 |            |           |            |  |  |  |  |
| 303         | Biotite Gneiss - highly variable in composition<br>- finely banded   |                 |            |           |            |  |  |  |  |
|             | END OF HOLE  |                 |            |           |            |  |  |  |  |

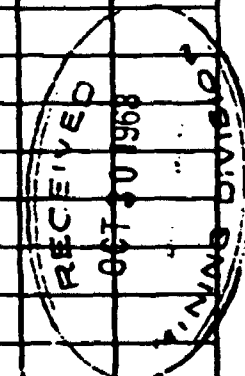

*Handwritten signature/initials*



PROPERTY: **TOMBOSE MINES LTD. - Crerar Twp.**

HOLE NO. **6.**  
Sheet 2 of 2.

|             |            |       |              |             |
|-------------|------------|-------|--------------|-------------|
| LATITUDE :  | BEARING :  | DIP : | STARTED :    | COMPLETED : |
| DEPTH :     | V.D.       | H.D.  | DRILLED BY : |             |
| ELEVATION : | LOCATION : |       |              | LOGGED BY : |

| FOOTAGE     | SAMPLE FOOTAGES                     | SAMPLE No. | WIDTH FT. | ASSAY DATA |  |  |  |
|-------------|-------------------------------------|------------|-----------|------------|--|--|--|
| 244.7 - 250 | Norite - Normal cse grained variety |            |           |            |  |  |  |
|             | END OF HOLE                         |            |           |            |  |  |  |
|             |                                     |            |           |            |  |  |  |
|             |                                     |            |           |            |  |  |  |
|             |                                     |            |           |            |  |  |  |
|             |                                     |            |           |            |  |  |  |
|             |                                     |            |           |            |  |  |  |
|             |                                     |            |           |            |  |  |  |
|             |                                     |            |           |            |  |  |  |
|             |                                     |            |           |            |  |  |  |
|             |                                     |            |           |            |  |  |  |
|             |                                     |            |           |            |  |  |  |
|             |                                     |            |           |            |  |  |  |
|             |                                     |            |           |            |  |  |  |
|             |                                     |            |           |            |  |  |  |
|             |                                     |            |           |            |  |  |  |
|             |                                     |            |           |            |  |  |  |
|             |                                     |            |           |            |  |  |  |
|             |                                     |            |           |            |  |  |  |
|             |                                     |            |           |            |  |  |  |
|             |                                     |            |           |            |  |  |  |
|             |                                     |            |           |            |  |  |  |
|             |                                     |            |           |            |  |  |  |
|             |                                     |            |           |            |  |  |  |
|             |                                     |            |           |            |  |  |  |
|             |                                     |            |           |            |  |  |  |
|             |                                     |            |           |            |  |  |  |
|             |                                     |            |           |            |  |  |  |
|             |                                     |            |           |            |  |  |  |
|             |                                     |            |           |            |  |  |  |
|             |                                     |            |           |            |  |  |  |
|             |                                     |            |           |            |  |  |  |
|             |                                     |            |           |            |  |  |  |
|             |                                     |            |           |            |  |  |  |

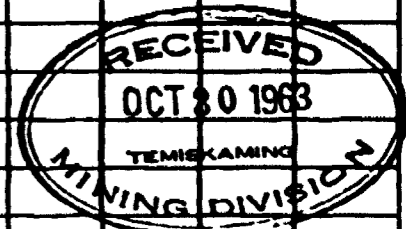

*Handwritten signature/initials: J/G/H*



PROPERTY: TOMROSE MINES LTD. - Creer Twp.

|            |           |      |             |            |               |
|------------|-----------|------|-------------|------------|---------------|
| LATITUDE : | BEARING:  | DIP: | STARTED:    | COMPLETED: | NOTE NO. 7.   |
| DIRECTION: | V.D.      | H.D. | DRILLED BY: |            | Sheet 2 of 2. |
| ELEVATION: | LOCATION: |      |             |            | DEPTH:        |
|            |           |      |             |            | LOGGED BY:    |

| FOOTAGE      | DESCRIPTION  | SAMPLE FOOTAGES | SAMPLE No. | WIDTH FT. | ASSAY DATA |  |  |  |
|--------------|--|-----------------|------------|-----------|------------|--|--|--|
|              |  |                 |            |           |            |  |  |  |
| 210.9 -216.2 | Altered Norite - chl rim variety - rich in qtz.                                    |                 |            |           |            |  |  |  |
| 222.3        | Qtz. - feldspar VEIN -- glassy, coarse crystals<br>upper contact @ 30 - no mineral |                 |            |           |            |  |  |  |
| 233.5        | Altered Norite - chl variety - cse grained. rich<br>in qtz.                        |                 |            |           |            |  |  |  |
|              | END OF HOLE  |                 |            |           |            |  |  |  |
|              |  |                 |            |           |            |  |  |  |
|              |  |                 |            |           |            |  |  |  |
|              |  |                 |            |           |            |  |  |  |
|              |  |                 |            |           |            |  |  |  |
|              |  |                 |            |           |            |  |  |  |
|              |  |                 |            |           |            |  |  |  |
|              |  |                 |            |           |            |  |  |  |
|              |  |                 |            |           |            |  |  |  |
|              |  |                 |            |           |            |  |  |  |
|              |  |                 |            |           |            |  |  |  |
|              |  |                 |            |           |            |  |  |  |
|              |  |                 |            |           |            |  |  |  |
|              |  |                 |            |           |            |  |  |  |
|              |  |                 |            |           |            |  |  |  |
|              |  |                 |            |           |            |  |  |  |
|              |  |                 |            |           |            |  |  |  |
|              |  |                 |            |           |            |  |  |  |
|              |  |                 |            |           |            |  |  |  |

RECEIVED  
OCT 30 1963  
MINING DIVISION

H. G. Haynie



PROPERTY: TOM ROSE MINES LTD. - Creerar Twp.

T 51688

HOLE NO. 8

LATITUDE : L 40 + 00 W

BEARING: S 50 E

DIP: - 40

STARTED: Oct. 28/63

COMPLETED: Nov 2/63

Sheet 1 of 2

DEPTH: 2 + 50 S

V.D. 320

H.N. 380

DRILLED BY: S. Bradley, Sturgeon Falls

DEPTH: 503

ELEVATION:

LOCATION: T 51688 - 220' @ 570 E of #4 Post.

EXT.

LOGGED BY: H.G.H.

| FOOTAGE | DESCRIPTION  | SAMPLE FOOTAGES | SAMPLE No. | WIDTH FT. | ASSAY DATA |  |  |  |  |  |  |  |  |  |  |  |  |  |  |
|---------|--|-----------------|------------|-----------|------------|--|--|--|--|--|--|--|--|--|--|--|--|--|--|
|         |  |                 |            |           |            |  |  |  |  |  |  |  |  |  |  |  |  |  |  |
| 0 - 2.5 | Casing   |                 |            |           |            |  |  |  |  |  |  |  |  |  |  |  |  |  |  |
| 8       | Diorite - fine grained - grey color  |                 |            |           |            |  |  |  |  |  |  |  |  |  |  |  |  |  |  |
| 59.1    | Altered Gabbro - chloritic   |                 |            |           |            |  |  |  |  |  |  |  |  |  |  |  |  |  |  |
| 72.5    | Norite - altered slightly  |                 |            |           |            |  |  |  |  |  |  |  |  |  |  |  |  |  |  |
| 84      | Altered Gabbro - parts are bio rich, fair<br>BLUE QTZ - heavy chl.                         |                 |            |           |            |  |  |  |  |  |  |  |  |  |  |  |  |  |  |
| 85      | Diabase dike   |                 |            |           |            |  |  |  |  |  |  |  |  |  |  |  |  |  |  |
| 87      | Norite - altered by dike   |                 |            |           |            |  |  |  |  |  |  |  |  |  |  |  |  |  |  |
| 89.5    | Norite   |                 |            |           |            |  |  |  |  |  |  |  |  |  |  |  |  |  |  |
| 105     | Gabbro - some BLUE QTZ. Heavy chl - odd<br>speck cpy                                       |                 |            |           |            |  |  |  |  |  |  |  |  |  |  |  |  |  |  |
| 110     | Norite   |                 |            |           |            |  |  |  |  |  |  |  |  |  |  |  |  |  |  |
| 134     | Gabbro - highly variable - gradational contacts  |                 |            |           |            |  |  |  |  |  |  |  |  |  |  |  |  |  |  |
| 150     | Gabbro ? " altered - heavy intro Qtz.<br>143 - 10" Qtz vein                                |                 |            |           |            |  |  |  |  |  |  |  |  |  |  |  |  |  |  |
| 158     | Norite - slightly altered - scatt. BLUE QTZ. - med<br>to cse grained.                      |                 |            |           |            |  |  |  |  |  |  |  |  |  |  |  |  |  |  |
| 167     | Gabbro - altered - fair to heavy BLUE QTZ. some<br>garnets                                 |                 |            |           |            |  |  |  |  |  |  |  |  |  |  |  |  |  |  |
| 185     | Gabbro - altered - chl rimmed - heavy Qtz.<br>181 - 182 - Qtz. Vein                        |                 |            |           |            |  |  |  |  |  |  |  |  |  |  |  |  |  |  |
| 207     | Norite - slightly altered - fair BLUE QTZ locally<br>some blue Qtz follows minor fractures |                 |            |           |            |  |  |  |  |  |  |  |  |  |  |  |  |  |  |
| 230     | Norite - cse grained - normal  |                 |            |           |            |  |  |  |  |  |  |  |  |  |  |  |  |  |  |
| 285     | Altered Gabbro - heavy chl & Qtz - variable<br>some garnet - minor BLUE QTZ                |                 |            |           |            |  |  |  |  |  |  |  |  |  |  |  |  |  |  |



PROPERTY: TOM ROSE MINES LTD.

|            |           |      |             |            |                             |
|------------|-----------|------|-------------|------------|-----------------------------|
| LATITUDE : | BEARING:  | DIP: | STARTED:    | COMPLETED: | HOLE NO. 18<br>Sheet 2 of 2 |
| DEVIATION: | V.D.      | H.D. | DRILLED BY: |            | DEPTH:                      |
| ELEVATION: | LOCATION: |      |             |            | LOGGED BY:                  |

| FOOTAGE  | DESCRIPTION   | SAMPLE FOOTAGES | SAMPLE No. | WIDTH FT. | ASSAY DATA |  |  |  |  |  |
|----------|---|-----------------|------------|-----------|------------|--|--|--|--|--|
|          |   |                 |            |           |            |  |  |  |  |  |
| 285 -298 | Norite - fine grained, massive  |                 |            |           |            |  |  |  |  |  |
| 342.5    | Gabbro - highly variable - short noritic sections<br>minor BLUE QTZ locally - Tr. sulphides |                 |            |           |            |  |  |  |  |  |
|          | 338 - 3" qtz vein   |                 |            |           |            |  |  |  |  |  |
| 361.6    | Norite - fine grained   |                 |            |           |            |  |  |  |  |  |
| 379.5    | Gabbro - fine grained   |                 |            |           |            |  |  |  |  |  |
| 407 -    | Diorite - fine grained - may be a dike  |                 |            |           |            |  |  |  |  |  |
|          | 398 - 6" qtz vein @ 45  |                 |            |           |            |  |  |  |  |  |
| 476      | Contact Phase   |                 |            |           |            |  |  |  |  |  |
|          | 426 - 10" qtz vein  |                 |            |           |            |  |  |  |  |  |
| 503      | Sedimentary Gneisses - rich in qtz. bio. chl.   |                 |            |           |            |  |  |  |  |  |
|          | END OF HOLE   |                 |            |           |            |  |  |  |  |  |
|          |   |                 |            |           |            |  |  |  |  |  |
|          |   |                 |            |           |            |  |  |  |  |  |
|          |   |                 |            |           |            |  |  |  |  |  |
|          |   |                 |            |           |            |  |  |  |  |  |
|          |   |                 |            |           |            |  |  |  |  |  |
|          |   |                 |            |           |            |  |  |  |  |  |
|          |   |                 |            |           |            |  |  |  |  |  |
|          |   |                 |            |           |            |  |  |  |  |  |
|          |   |                 |            |           |            |  |  |  |  |  |
|          |   |                 |            |           |            |  |  |  |  |  |
|          |   |                 |            |           |            |  |  |  |  |  |
|          |   |                 |            |           |            |  |  |  |  |  |
|          |   |                 |            |           |            |  |  |  |  |  |
|          |   |                 |            |           |            |  |  |  |  |  |
|          |   |                 |            |           |            |  |  |  |  |  |
|          |   |                 |            |           |            |  |  |  |  |  |
|          |   |                 |            |           |            |  |  |  |  |  |



J.G. Hunt

PROPERTY: TOMROSE MINES LTD. - Creerar Twp.

SOLE NO. 9

LATITUDE : L 42 + 00 W

BEARING: S 35 W

DIP: - 45°

STARTED: Nov. 11/63

COMPLETED: Nov. 15/63

Sheet 1 of 2

DIURE: 5 + 00 S

V.D. 353

H.D. 353

DRILLED BY: S. Bradley, Sturgeon Falls.

DEPTH: 503

ELEVATION:

LOCATION: T. 51688 - 500' South #4 Post

EXT.

LOGGED BY: H.G.H.

| FOOTAGE | SAMPLE FOOTAGES   | SAMPLE No. | WIDTH FT. | ASSAY DATA |  |  |  |
|---------|---|------------|-----------|------------|--|--|--|
|         |   |            |           |            |  |  |  |
| 0-17    | Casing  |            |           |            |  |  |  |
| 30      | Norite - med. grain - some hyp.   |            |           |            |  |  |  |
| 63.5    | FAULT ZONE - brecciated mylonitized, highly altered - hem. qtz. carb introduced. Fracturing from 15 to 45 |            |           |            |  |  |  |
| 68.6    | Altered Gabbro - introduced qtz & hem - strong chl. alteration  |            |           |            |  |  |  |
| 110     | Norite - med. grained   |            |           |            |  |  |  |
| 112     | Altered Zone - introduced qtz & hem.  |            |           |            |  |  |  |
| 115     | FAULT - red gouge - 45  |            |           |            |  |  |  |
| 122.5   | Altered Zone - intro qtz. low hem, abundant chl.  |            |           |            |  |  |  |
| 130.7   | Norite - med. grained   |            |           |            |  |  |  |
| 131.5   | BLUE QTZ NORITE - no mineral  |            |           |            |  |  |  |
| 150     | Norite - med grain - add speck cpy  |            |           |            |  |  |  |
| 150.1   | FAULT SLIP - bio in walls, intro qtz & hem.   |            |           |            |  |  |  |
| 156.5   | Gabbro - altered & bleached locally - much chl.   |            |           |            |  |  |  |
| 165.6   | Altered Zone due to fault - intro qtz & hem. some BLUE QTZ - apparently introduced.                       |            |           |            |  |  |  |
| 173     | FAULT ZONE - heavy gouge - mineralized with qtz. & hem.   |            |           |            |  |  |  |
| 195     | Altered Gabbro - chl. qtz. hem - fine to med. gr.   |            |           |            |  |  |  |
| 197.5   | FAULT ZONE  |            |           |            |  |  |  |
| 202     | Altered Gabbro  |            |           |            |  |  |  |
| 208     | FAULT ZONE  |            |           |            |  |  |  |
| 275     | Altered Gabbro - mauve color - abundant chl. - some qtz.  |            |           |            |  |  |  |



PROPERTY: TOMROSE MINES LTD. - Crerar Twp.

ROLL NO. 9

|             |            |       |              |             |              |
|-------------|------------|-------|--------------|-------------|--------------|
| LATITUDE :  | BEARING :  | DIP : | STARTED :    | COMPLETED : | Sheet 2 of 2 |
| DEPTH :     | V.D.       | H.D.  | DRILLED BY : |             | DEPTH :      |
| ELEVATION : | LOCATION : |       |              |             | LOGGED BY :  |

| FOOTAGE     | DESCRIPTION   | SAMPLE FOOTAGES | SAMPLE No. | WIDTH FT. | ASSAY DATA |  |  |  |  |  |  |
|-------------|---|-----------------|------------|-----------|------------|--|--|--|--|--|--|
|             |   |                 |            |           |            |  |  |  |  |  |  |
|             | 258 - 259 BLUE QTZ - poorly developed   |                 |            |           |            |  |  |  |  |  |  |
| 275 - 281.5 | Diorite - grey, fine grained, altered feldspar peppered with fine grained py & cpy  |                 |            |           |            |  |  |  |  |  |  |
| 282.4       | Diabase Dike @ 45   |                 |            |           |            |  |  |  |  |  |  |
| 295         | Diorite & Norite mixture with minor BLUE QTZ.   |                 |            |           |            |  |  |  |  |  |  |
| 332.5       | Norite - somewhat chloritized   |                 |            |           |            |  |  |  |  |  |  |
| 338         | Gabbro - chlorite rimmed  |                 |            |           |            |  |  |  |  |  |  |
| 340.3       | Diabase dike @ 45   |                 |            |           |            |  |  |  |  |  |  |
| 344.5       | Norite  |                 |            |           |            |  |  |  |  |  |  |
| 349.2       | BLUE QTZ NORITE   |                 |            |           |            |  |  |  |  |  |  |
| 350         | BRECCIA ZONE - qtz & hem filled, some py, cpy.  |                 |            |           |            |  |  |  |  |  |  |
| 368.8       | Norite - cse grained  |                 |            |           |            |  |  |  |  |  |  |
|             | 359.2 - BLUE QTZ VEINLET - cpy assoc.   |                 |            |           |            |  |  |  |  |  |  |
| 369.2       | Diorite - low py & cpy  |                 |            |           |            |  |  |  |  |  |  |
| 398.8       | SEDIMENTS ? - garnetiferous, altered, scattered bio, py & cpy   |                 |            |           |            |  |  |  |  |  |  |
| 402.2       | Diabase dike @ 45   |                 |            |           |            |  |  |  |  |  |  |
| 472         | SEDIMENTS ? - widely variable, abundant garnet heavily chloritized, rich in qtz & feldspar slightly gneissic texture locally - odd TR sulphides |                 |            |           |            |  |  |  |  |  |  |
| 484.5       | Altered Gabbro - variable comp. & texture   |                 |            |           |            |  |  |  |  |  |  |
| 503         | Mostly Norite - med gr. - variable - short sections of fine grained diorite   |                 |            |           |            |  |  |  |  |  |  |



*H. E. Harper*

PROPERTY TOMROSE MINES LTD. - Creerar Twp.

|                     |   |          |  |                   |
|---------------------|---|----------|--|-------------------|
| LATITUDE : 2 + 34 N | BEARING: N 80E                            | DIP: -75 | STARTED: June 1/64                     | COMPLETED: 1/74   |
| DEPARTURE: L 38 W   | V.D. 270                                  | H.D. 70  | DRILLED BY: S. Bradley, Sturgeon Falls | DEPTH: 281        |
| ELEVATION:          | LOCATION: T-51689 - 220' S70E of # 4 Post |          |  | EXT: _____        |
|                     |   |          |  | LOGGED BY: Harper |

| FOOTAGE | SAMPLE FOOTAGES | SAMPLE No. | WIDTH FT. | ASSAY DATA |
|---------|-----------------|------------|-----------|------------|
|---------|-----------------|------------|-----------|------------|

0 - 4 Casing  
 15 Chl. rimmed - cse grained  
 22 Norite - slightly altered  
 30 Blue Qtz. Diorite - well mineralized, py, po, cpy, also pentlandite ?  
 30 Talcy - chl. Fault ? @ 20°  
 50 Altered Norite - some chl. & garnet  
 76 Norite  
 80 Altered Norite - very fine grained 87.5 2" qtz. vein - no mineral  
 99.5 Chlorite rimmed  
 114 Highly altered Norite - ? - fine grained.  
 121 Chlorite rimmed.  
 129.0 Norite - cse grained.  
 149.2 Blue Qtz. Diorite - low po, cpy.  
 152.0 Chlorite Rimmed - sharp contact.  
 171.7 Altered Norite  
 173 Diabase dyke  
 193 Altered Norite - highly variable  
 196 Norite  
 198.7 Strongly mineralized copy, po, py  
 203 Norite - fresh  
 213 Altered Norite - odd speck of sulphide  
 227 Norite - odd speck of sulphide  
 239 Altered Norite - strongly chloritized in parts  
 250 Norite - fine grained low py, cpy.  
 250-272 BLUE QTZ. DIORITE - occurs in narrow mineralized bands.  
 281 Fault zone - gneissic chloritic bands @ 40° - some bull QTZ injections.

END OF HOLE

**DUPLICATE COPY  
 POOR QUALITY ORIGINAL  
 TO FOLLOW**





PROPERTY TOMROSE MINES LTD. - Creer Twp.

| LATITUDE : 2 + 34 N | BEARING: S75W                             | DIP: -75° | STARTED: June 6/64                     | COMPLETED: June 13/64  |            |
|---------------------|---|-----------|--|------------------------|------------|
| DEPARTURE: L 38 W   | V.D. 290                                  | H.D. 70   | DRILLED BY: S. BRADLEY, STURGEON FALLS | DEPTH: 300             |            |
| ELEVATION:          | LOCATION: T-51689 - 220' S70E of # 4 Post |           |  | EXT. LOGGED BY: Harper |            |
| FOOTAGE             | SAMPLE FOOTAGES                           |           | SAMPLE No.                             | WIDTH FT.              | ASSAY DATA |

- 0-25 Chlorite rimmed - local reddish feldspar  
15-16 rusty weathered qtz. veins  
20-23.5 LOST CORE
- 49.5 Altered intrusive also brecciated @45° quartz filling  
34-35 BLUE QUARTZ DIORITE - low sulphides.
- 69 Norite, fresh, cse grained.
- 98 Altered Norite - some chl. rimmed.
- 107 Norite - med. grain.
- 155 Altered norite - some garnet, tr. sulphides, odd  
short section of Blue Qtz. Diorite
- 197 Norite - med. gr. - some narrow alteration zones.
- 205 BLUE QTZ. DIORITE - irregular - no mineral.
- 300 Norite - Med. grained - fresh, massive.

END OF HOLE

**DUPLICATE COPY  
POOR QUALITY ORIGINAL  
TO FOLLOW**





|                     |   |                 |  |                     |
|---------------------|---|-----------------|--|---------------------|
| LATITUDE : 3 + 84 N | BEARING: N 85 E                           | DIP: -55°       | STARTED: June 15/64                    | COMPLETED: 10/21/64 |
| DEPARTURE: L31-79W  | V.D. 408                                  | H.D. 290        | DRILLED BY: S. Bradley, Sturgeon Falls | DEPTH: 501          |
| ELEVATION:          | LOCATION: T52410 - 280' north of # 3 Post |                 |  | LOGGED BY: Harper   |
| FOOTAGE             |   | SAMPLE FOOTAGES | SAMPLE No.                             | WIDTH FT.           |
|                     |   |                 |  | ASSAY DATA          |

**DUPLICATE COPY  
POOR QUALITY ORIGINAL  
TO FOLLOW**

- 0 - 12 Casing
  - 25 Chlorite Rimmed - narrow fine grained bands
  - 51 DIORITE ? - fine grained, basic, narrow bands of altered norite.
  - 64 Altered norite
  - 71 Anorthosite - mottled appearance.
  - 72.5 Talc Zone - FAULT(?) Heavily mineralized.
  - 88.5 Norite-cse grained, slightly altered
  - 98 Anorthosite - irregular
  - 111.5 Norite - some po & cpy at 107
  - 133 Anorthosite - irregular narrow zone of po. & cpy.-4" wide
  - 135.5 Schist zone-chloritized-Tr. sulphides-1" qtz. vein @ 45°
  - 141 Anorthosite - Very irregular
  - 144.5 Altered Norite - narrow well mineralized section - should be sampled.
  - 148 Schist Zone - well chloritized - some banded cpy which is quite unusual.
  - 170.5 Norite - med. gr. - slt. altered - narrow mineralized sections
  - 198.5 Anorthosite(?) - very irregular
  - 201.5 Schistose - chloritic - fine gr. Tr. of sulphides.
  - 239 Norite - cse gr. - quite variable - some fine grained diorite included.
  - 248 Diorite - f.gr. - variable - some BLUE QUARTZ
  - 248-260 BLUE QTZ. DIORITE - fair mineralization - should sample 12' - cpy. po
  - 280 Norite - slightly altered - narrow BLUE QTZ. section with Tr. sulphides.
  - 284.5 Anorthosite
  - 286.5 FAULT - cemented with hem and qtz.
  - 305 Anorthosite.
  - 322.5 DIORITE - f.gr.highly variable.
  - 335 Anorthosite - very irregular.
  - 360 Gneiss - chl - thin banded / 353 - 2" heavy cpy
  - 367 Gneiss - ophitic texture
  - 384 Norite - med. gr. slightly altered.
  - 389 Gneiss - ophitic texture
  - 408 Gneiss - gneitic @ 45°
  - 413 LOST CORE
  - 501 Metamorphics - massive - neg. gneissosity - ophitic texture.
- END OF HOLE.





PROPERTY: TOMROSE MINES LTD. - Crerar Twp.

|                     |   |          |  |                       |                 |
|---------------------|---|----------|--|-----------------------|-----------------|
| LATITUDE : 4 + 15 S | BEARING: S10E                           | DIP: -75 | STARTED: June 27/64                    | COMPLETED: July 17/64 | DEPTH: 625      |
| DEPARTURE: L 5500 W | V.D. 604                                | H.D. 160 | DRILLED BY: S. Bradley, Sturgeon Falls |                       | LOGGED BY: Harp |
| ELEVATION:          | LOCATION: T51682 - 440' S.E. of #4 Post |          |  |                       | EXT:            |
| FOOTAGE             | SAMPLE FOOTAGES                         |          | SAMPLE No.                             | WIDTH FT.             | ASSAY DATA      |

0 - 11 Casing  
 20.5 Norite - low cpy & po throughout  
 43 Chlorite altered - Light green colour - med. gr.  
 50 Altered Norite - med. gr.  
 64 MINERALIZED SECTION - cpy. po. - minor BLUE QTZ.  
 68.5 Talc FAULT Zone @ 15  
 82 Altered Norite - Tr. sulphides.  
 94 Chlorite - altered zone - pale green  
 100 Diorite - fine grained - well mineralized  
 122.5 Altered Intrusive. - 100-105 low sulphides.  
 123 Diabase dike  
 124.3 Altered Intrusive.  
 160 Diorite - fine grained - erratically mineralized with py, cpy, po.  
 178 Altered Intrusive  
 208 Anorthosite - gradational contacts.  
 222.5 Altered Intrusive  
 225 Diorite - Tr. of BLUE QTZ.  
 234 Altered Norite  
 236 MINERALIZED SECTION - cpy, py, po  
 291 Altered Intrusive - heavy chlorite.  
 297.5 Norite - slightly altered.  
 312.5 Altered Intrusive - heavy chlorite.  
 317.5 Norite.  
 317.5-319.5 Diorite - fine grained.  
 347 Norite  
 352.5 Anorthosite  
 355.5 Diorite  
 370 Anorthosite - some chl. altered  
 377 Norite  
 432 Altered Norite  
 443 Altered Intrusive - strong chlorite  
 447 Breccia Zone - richly colored.  
 455 Altered Intrusive - chlorite  
 463 Diorite - fine grained  
 480 Altered Norite - 470 Breccia Zone  
 494 FAULT ZONE - partly altered & brecciated 496 - 8" lost core  
 519 Altered Gabbro  
 525 Diabase dike

**DUPLICATE COPY  
 POOR QUALITY ORIGINAL  
 TO FOLLOW**

PROPERTY

|             |                 |       |              |             |             |
|-------------|-----------------|-------|--------------|-------------|-------------|
| LATITUDE :  | BEARING :       | DIP : | STARTED :    | COMPLETED : | SHEET NO. : |
| DEPARTURE : | V.D.            | H.D.  | DRILLED BY : | DEPTH :     | LOGGED BY : |
| ELEVATION : | LOCATION :      |       |              |             |             |
| FOOTAGE     | SAMPLE FOOTAGES |       | SAMPLE No.   | WIDTH FT.   | ASSAY DATA  |
|             |                 |       |              |             |             |

556 Norite - some altered to gabbro  
 560.8 BLUE QTZ. DIORITE - low py, cpy, po  
 584 Norite - lower contact sharp  
 602.5 Chlorite Rimmed.  
 625 Norite

END OF HOLE

**DUPLICATE COPY  
 POOR QUALITY ORIGINAL  
 TO FOLLOW**



PROPERTY: TONGUE MINE LTD.

|             |            |       |              |             |             |
|-------------|------------|-------|--------------|-------------|-------------|
| LATITUDE :  | BEARING :  | DIP : | STARTED :    | COMPLETED : | BUREAU :    |
| DEPARTURE : | V.D.       | H.D.  | DRILLED BY : |             | DEPTH :     |
| ELEVATION : | LOCATION : |       |              |             | LOGGED BY : |

| FOOTAGE     | DESCRIPTION                              | SAMPLE FOOTAGES | SAMPLE No. | WIDTH FT. | ASSAY DATA |  |  |  |  |  |  |
|-------------|--|-----------------|------------|-----------|------------|--|--|--|--|--|--|
|             |  |                 |            |           |            |  |  |  |  |  |  |
| 317.5-319.5 | Diorite - fine grained                   |                 |            |           |            |  |  |  |  |  |  |
| 347         | Norite                                   |                 |            |           |            |  |  |  |  |  |  |
| 352.5       | Anorthosite                              |                 |            |           |            |  |  |  |  |  |  |
| 355.5       | Diorite                                  |                 |            |           |            |  |  |  |  |  |  |
| 370         | Anorthosite - some chl. altered          |                 |            |           |            |  |  |  |  |  |  |
| 377         | Norite                                   |                 |            |           |            |  |  |  |  |  |  |
| 432         | Altered Norite                           |                 |            |           |            |  |  |  |  |  |  |
| 443         | Altered Intrusive - strong chlorite      |                 |            |           |            |  |  |  |  |  |  |
| 447         | Breccia Zone - richly colored            |                 |            |           |            |  |  |  |  |  |  |
| 455         | Altered Intrusive - chlorite             |                 |            |           |            |  |  |  |  |  |  |
| 463         | Diorite - fine grained                   |                 |            |           |            |  |  |  |  |  |  |
| 480         | Altered Norite                           |                 |            |           |            |  |  |  |  |  |  |
|             | 470 - Breccia Zone                       |                 |            |           |            |  |  |  |  |  |  |
| 494         | FAULT ZONE - partly altered & brecciated |                 |            |           |            |  |  |  |  |  |  |
|             | 496 - 8" lost core                       |                 |            |           |            |  |  |  |  |  |  |
| 519         | Altered Gabbro                           |                 |            |           |            |  |  |  |  |  |  |
| 525         | Diabase dike                             |                 |            |           |            |  |  |  |  |  |  |
| 556         | Norite - some altered to gabbro          |                 |            |           |            |  |  |  |  |  |  |
| 560.8       | BLUE QTZ DIORITE - low py, cpy, po       |                 |            |           |            |  |  |  |  |  |  |
| 584         | Norite - lower contact sharp             |                 |            |           |            |  |  |  |  |  |  |
| 602.5       | Chlorite Rimmed                          |                 |            |           |            |  |  |  |  |  |  |
| 625         | Norite                                   |                 |            |           |            |  |  |  |  |  |  |
|             | END OF HOLE                              |                 |            |           |            |  |  |  |  |  |  |

*H. G. May*





ONTARIO  
DEPARTMENT OF MINES

24 Jan. 1964



4110SSE0011 0011 CRERAR

900

Dr. K. D. Card,  
P. O. Box 1030,  
SUDBURY, Ontario.

Dear Sir:-

Herewith Core Logs and Sketch of diamond  
drilling performed on mining claim T 51688 in the  
Township of Crerar.

Yours truly,

W. A. Buchan,  
Mining Recorder.

/AER  
Encls. 3.

RECEIVED

JAN 6 2 1964

RESIDENT GEOLOGIST  
SUDBURY

ASSESSMENT WORK

OFFICE OF MINING RECORDER



ONTARIO  
DEPARTMENT OF MINES

TIMISKAMING MINING DIVISION  
HAILESBURY, ONTARIO

September 4, 1964.

Dr. K. D. Card,  
Resident Geologist,  
Box 1030,  
Sudbury, Ontario.

Dear Sir:

Enclosed herewith Drill logs and maps  
covering drilling conducted by Tomrose Mines Ltd.  
in Crerar Township.

Yours truly,

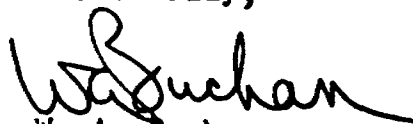
  
W. A. Buchan,  
Mining Recorder.

WAB/MAL

Encl.

FOR ADDITIONAL INFORMATION

RE: DD LOCATION

SEE MAP

CRERAR - 0012 - A1 #1

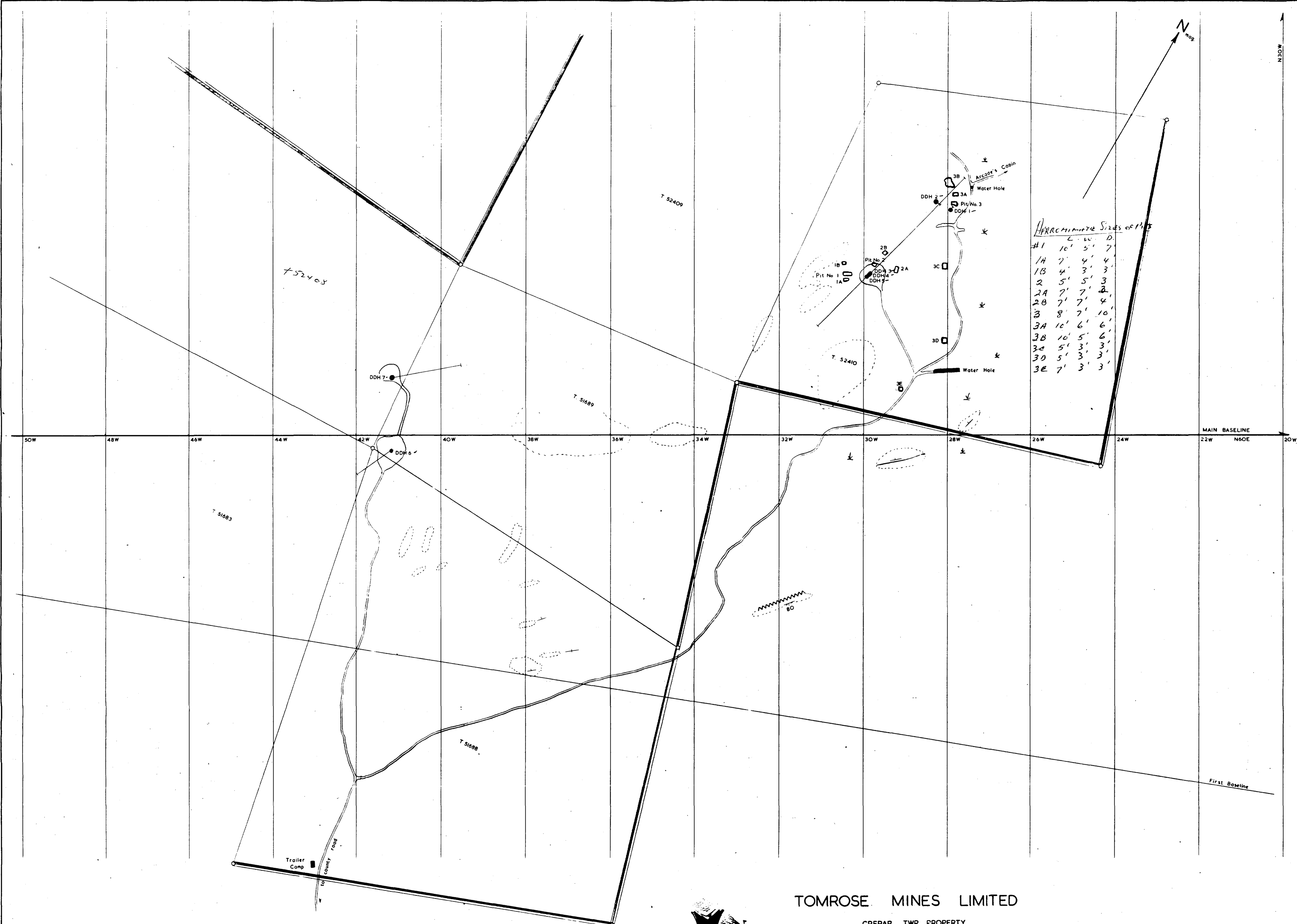

APPROXIMATE SIZES OF PITS

| #  | L   | W  | D   |
|----|-----|----|-----|
| #1 | 10' | 5' | 7'  |
| 1A | 7'  | 4' | 4'  |
| 1B | 4'  | 3' | 3'  |
| 2  | 5'  | 5' | 3'  |
| 2A | 7'  | 7' | 4'  |
| 2B | 7'  | 7' | 4'  |
| 3  | 8'  | 7' | 10' |
| 3A | 16' | 6' | 6'  |
| 3B | 10' | 5' | 6'  |
| 3C | 5'  | 3' | 3'  |
| 3D | 5'  | 3' | 3'  |
| 3E | 7'  | 3' | 3'  |

TOMROSE MINES LIMITED

CRERAR TWP PROPERTY

SURFACE PLAN

H. GRANT HARPER, P. ENG.  
314 HENDON AVE., WILLOWDALE,  
ONTARIO.

DATE 2/21/67 SIGNED H. G. Harper

CRERAR-0011 #1



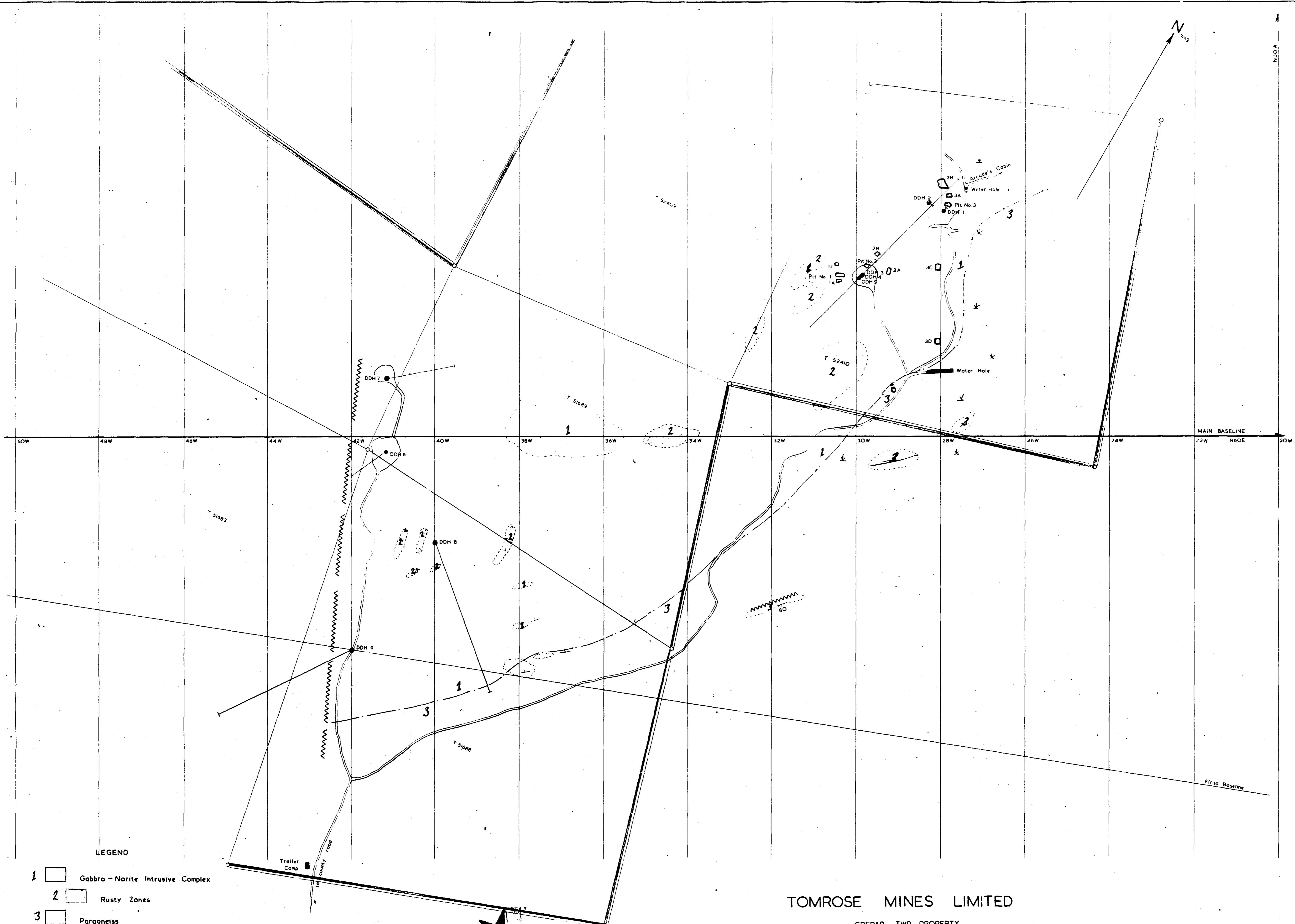

LEGEND

- 1 [ ] Gabbro - Norite Intrusive Complex
- 2 [ ] Rusty Zones
- 3 [ ] Paragneiss

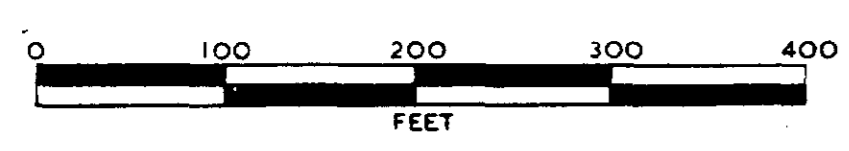

★  
 CRERAR-0011- #2.



TOMROSE MINES LIMITED  
 CRERAR TWP PROPERTY

SURFACE PLAN

Tr. #11  
 Crerar Twp.

H. GRANT HARPER, P. ENG.  
 3-4 HENDON AVE., WILLOWDALE, ONTARIO.

DATE Dec 5/83 SIGNED [Signature]





Approximate Size of Pits

|      |            |
|------|------------|
| # 1  | 10 x 5 x 7 |
| # 1A | 7 x 4 x 4  |
| # 1B | 4 x 3 x 3  |
| # 2  | 5 x 5 x 3  |
| # 3  | 7 x 7 x 4  |
| # 4  | 7 x 7 x 4  |
| # 5  | 8 x 7 x 4  |
| # 6  | 10 x 6 x 6 |
| # 7  | 10 x 5 x 6 |
| # 8  | 5 x 3 x 3  |
| # 9  | 5 x 3 x 3  |
| # 10 | 7 x 3 x 3  |

**TOMROSE MINES LIMITED**  
 CRERAR TWP PROPERTY  
 DETAIL AREA "A"  
 SURFACE PLAN

H. GRANT HARPER, P. ENG.  
 314 HENDON AVE., WILLOWDALE,  
 ONTARIO.  
 DATE Aug 17 1964 SIGNED H.G. Harper.

# 3

CREAR-0011

- LEGEND**
- 2 Gabbro - Norite Intrusive Complex
  - 3 Rusty Zones
  - 1 Paragneiss

