

PROSPECTING REPORT
ON THE
PELANGIO LARDER MINES LTD.
FORTUNE LAKE GOLD PROPERTY
DAVIS TWP.
NORTHERN ONTARIO

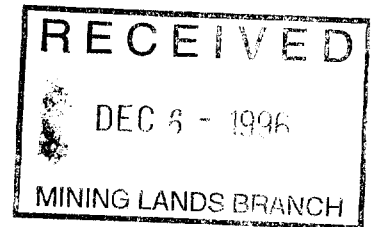

2 . 1 6 9 2 6

Oct. 12/96

*Qual. #
2.3466*
**By: Kevin Filo
HBSc. Geo.**



41110NE0128 2.16926 DAVIS

Fig. 1

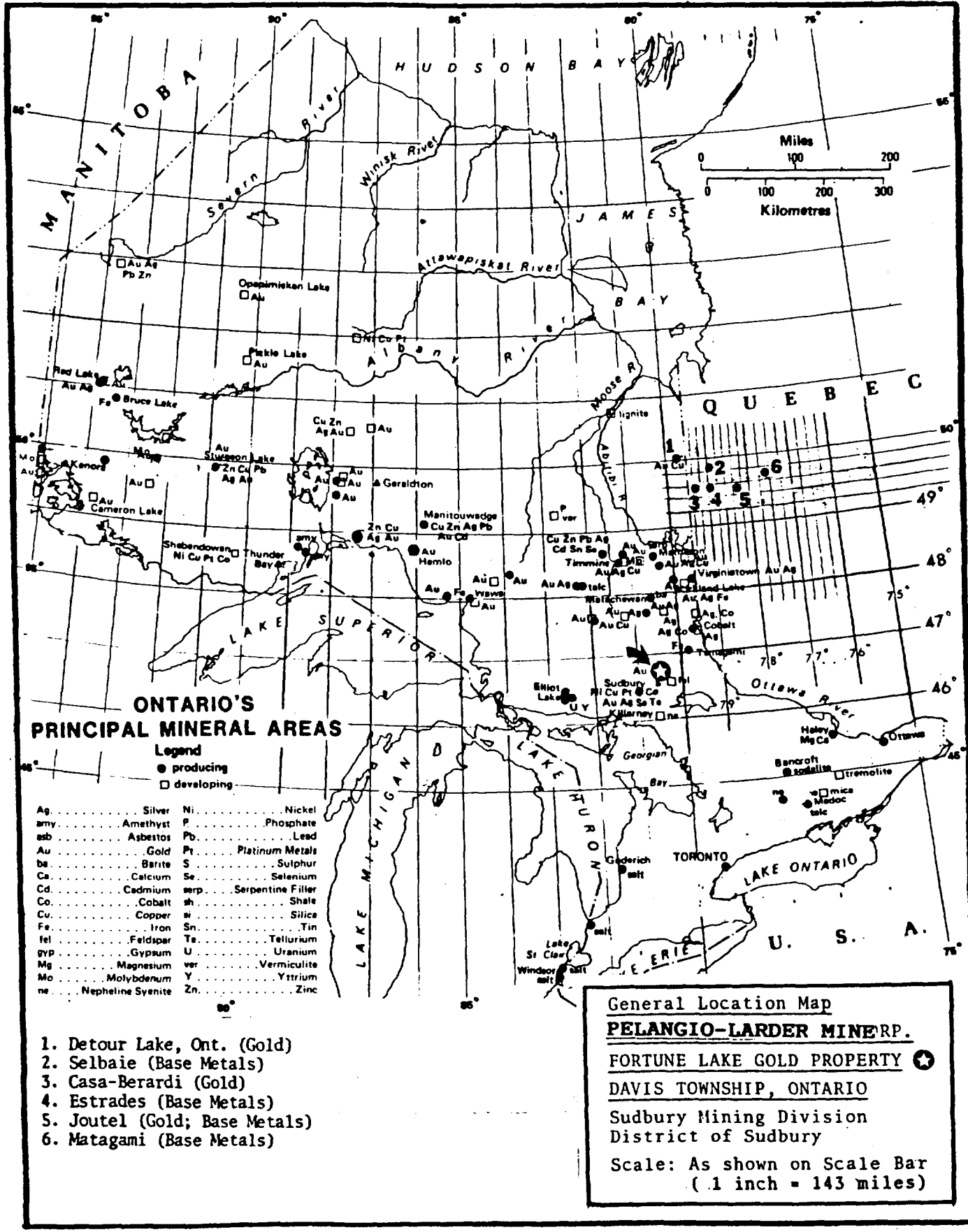

INTRODUCTION

In early Oct. of 1996 the Fortune Lake Gold Prospect was reexamined by Pelangio Larder Mine's consulting geologist. The principal purpose of this reexamination was to evaluate the main showing on the property, carry out some sampling, and maintain the prospect in good standing for the near term. This visit also allowed the author to become a little more familiar with the property as corporate files show that the last time a Pelangio geologist was on this property was 1985, just over ten years ago.

A number of samples were taken from the main showing during the course of the evaluation. All of these were assayed for gold and a series of other elements. A description of these samples is presented in Appendix 1. The locations of these samples along with old workings, limited geology, and vein orientations at the main showing area are all presented in the accompanying figures. Assays were not available at the time this brief report was being written, but they will accompany this report at a later date when assays are made available. This report was put together prior to receiving assays so that assessment commitments could be complied with to maintain the project in good standing.

PROPERTY, LOCATION AND ACCESS

The property currently consists of two claims numbered 830718 and 717190 (fig.3). In total the two claims cover approximately 40 acres of area as the second claim is a small claim covering a lake. The claims are located in NW Davis Twp. near the Scadding/Davis boundary, approximately 26 air miles NE of the City of Sudbury. Access to the property may be attained by float plane or by a secondary road and trail network north of Highway 17 .

PROPERTY HISTORY

The historical data on this prospect was taken from a private corporate report written by K. Darke, P. Eng. in Oct. of 1995. This history is documented in point form as follows:

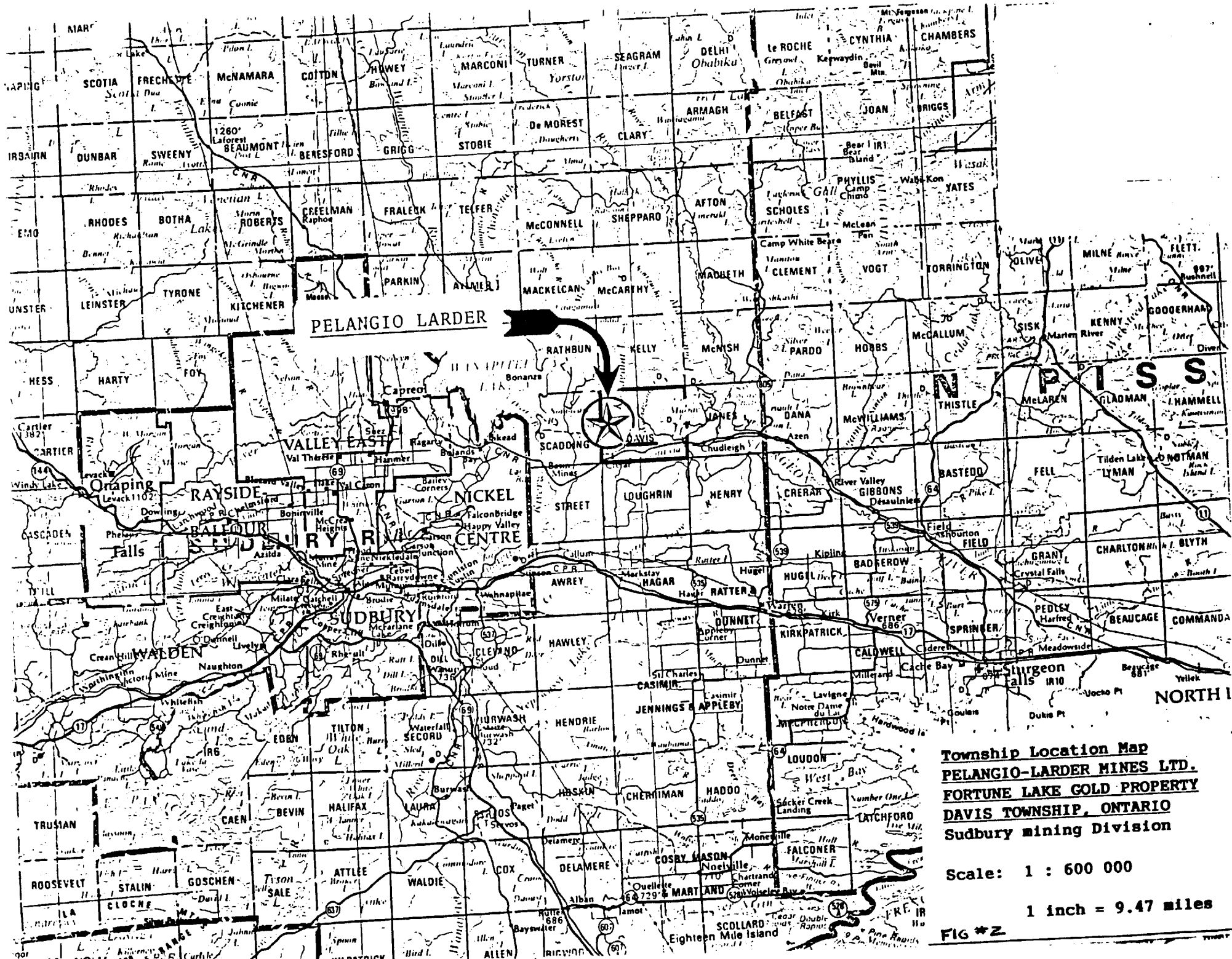

Township Location Map
PELANGIO-LARDER MINES LTD.
FORTUNE LAKE GOLD PROPERTY
DAVIS TOWNSHIP, ONTARIO
Sudbury mining Division

Scale: 1 : 600 000
 1 inch = 9.47 miles

FIG #2

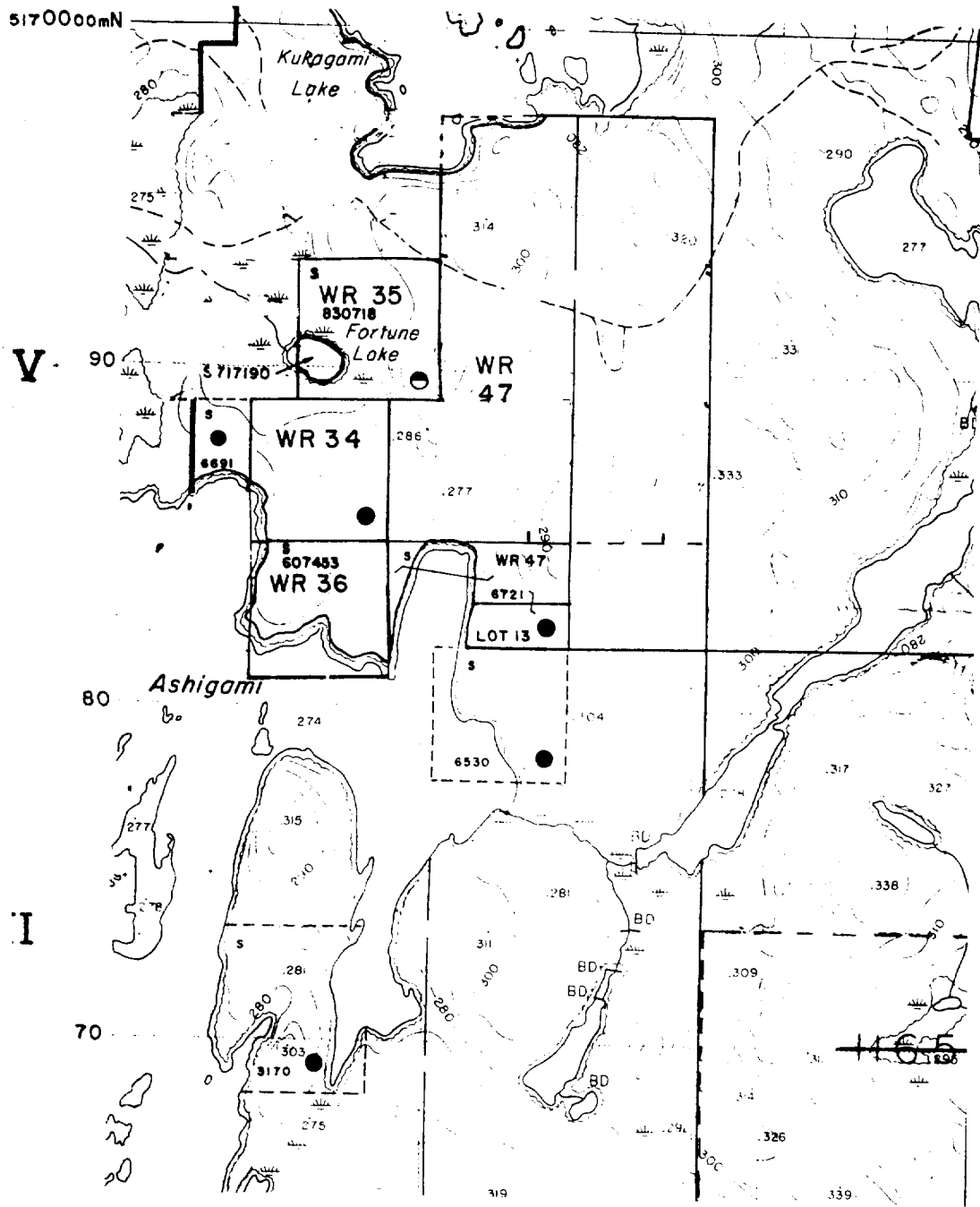

Figure 3: Claim Location Map for Fortune Gold Prospect, Davis Twp.

Mackenzie Mine (1897)

-Two shallow inclined shafts sunk 170 feet apart to test gold bearing quartz structure.

Mac-Auer Gold Mines Limited (1934-1935)

-In 1934 Mac-Auer Gold Mines Limited acquires option on Mackenzie Mine.

-From 1934-35 dewatering and some development work carried out.

-Indicated reserves of 7692 tons @ 0.87 oz./ton Au reported to exist between the two shafts.

Pelangio Larder Mines Limited (1985)

-Pelangio carried out reconnaissance geology, prospecting, sampling, linecutting and a VLF-EM survey. Old pits and trenches also resampled.

Golden Hemlock Resources (1985-1988)

-A geological survey, limited induced polarization surveying, trenching, sampling and limited diamond drilling were initiated.

DISCUSSION OF RECENT OBSERVATIONS

At the main showing area adjacent to what is believed to be the most easterly shaft on the property, the author observed a very narrow quartz vein (50cm. max.) The strike extension of this vein ran into the shaft, and thus this vein was thought to represent the main vein explored in the past, the vein with the documented reserve.

This vein had a strike of 315-320 degrees az. and a fairly steep dip, almost vertical. The wall rock adjacent to the vein was brecciated in places and contained fragments of greywacke and quartz. This breccia was very weathered and significant sulphide had been weathered out of it, thus a gossan zone is present locally along portions of the vein contact.

The vein appears to contain some marcasite and minor chalcopyrite. In some portions of the vein there are very heavy sections of sulphide rich quartz. Two types of quartz were also observed, a milky white quartz and a grey translucent quartz.

The vein is hosted in a bedded greywacke (Gowganda Fm.?) that strikes at 015 degrees az and dips 35 degrees south. There does not appear to be any major structure or alteration package associated with the vein.

The author observed some drill core from an unknown location, none of this core appeared to be split or assayed. No vein material was observed but some fine pyrite (1-2%) was noted in a greywacke host. Two samples of this core were sent for assay.

CONCLUSIONS AND RECOMMENDATIONS

Data by Darke, P. Eng. (1995) suggests that this property obviously has a fairly interesting gold resource. Darke, also states that the property should have more detailed induced polarization surveying and further drilling to further explore the known zone of interest and any other potential zones.

This author concurs with this evaluation providing the assays taken verify that there is reasonable gold content in the known vein. Further, it is very interesting that some mineralization is present in the greywacke outside of known vein systems. If low grade gold is present in the surrounding wall rock with sulphides this prospect may be of significant interest as a low grade bulk tonnage target. However, the reader is cautioned it is premature to speculate about this at present. If the drill core samples contain any anomalous gold further sampling of wall rock outside of the main vein will have to be initiated to determine if this prospect does indeed have some potential for this type of deposit.

Respectfully Submitted,



Kevin Filo P. Geo.

APPENDIX 1
ROCK SAMPLE DESCRIPTIONS

DESCRIPTION OF SAMPLES FROM DAVIS TWP.

Samples taken in place from outcrop:

D-1: Wall rock adjacent main vein. This rock is a totally oxidized gossan with fragments of wall rock and quartz. There was probably significant sulphide in this sample at one time, prior to extreme oxidation.

D-1A: Quartz vein material from the main vein, sample comprised of both milky white quartz and smoky grey translucent quartz. Some very minor pyrite noted in this sample, less than 1%.

D-2: Quartz vein material from main vein. Once again sample contains both milky white quartz and smoky grey translucent quartz. There appears to be a black massive to needle shaped mineral in this sample that is likely tourmaline. Some pyrite, and marcasite?, perhaps 1% maximum sulphide content and some oxidized sulphide.

D-3: Quartz vein material from main vein. Mainly white milky quartz with some iron staining and some nodular marcasite?, less than 0.5%. Minor iron staining of pyrite.

D-4: Wall rock material between main vein and a small mineralized splay off of main vein. This rock appears to be a grey coloured fine grained greywacke. This particular sample has minor iron staining and appears barren of any sulphide.

D-5: Greywacke that is grey in colour on fresh surface and has a sugary texture. Some iron staining evident on this sample, but no significant sulphide evident.

Samples taken from muck pile outside shaft:

D6: Grey black smoky quartz with minor marcasite, less than 0.5%.

D7: Milky white quartz and some grey smoky quartz with some marcasite, perhaps 1% overall found in a series of blebs and stringers.

D8: This sample is a sample of wall rock material from the muck pile, it appears to be an altered silicified greywacke, that is sugary textured and fine grained. No significant pyrite was noted.

D9: Milky white quartz with no significant sulphide.

D10: As per description for D-8.

D-11: Grey smoky quartz and some milky white quartz with 2-3% marcasite.

Diamond drill core found on site:

D-12: Grey unaltered fine grained greywacke with minor fine pyrite, 1-2%.

D-13: Grey unaltered banded fine grained greywacke with minor fine pyrite, 1-2%.

**To: Mining Recorder's Office
Sudbury Ontario**
From: Kevin Filo
**Subject: Pelangio Larder Mines
Davis Twp. Assay Sheets**
Date: Nov.11/95

Please, find attached assay sheets to accompany a report for Pelangio Larder Mines Ltd.'s Fortune Lake Property in Davis Twp. near Sudbury Ontario, filed previously in Oct. 1996. Two copies of original sheets to follow this via mail today. If any problems please contact Kevin Filo at 7052680371 via phone or fax.

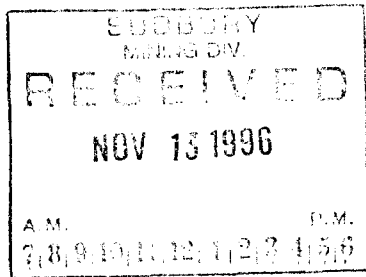

Thank You

Kevin Filo

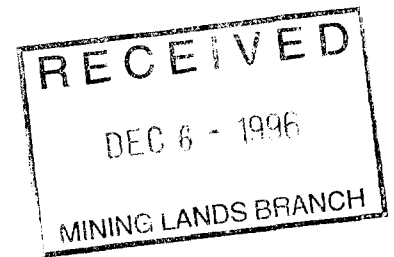

2 . 1 6 9 2 6

OCT 23 '96 09:00

DE CHIMITEC BONDAR CLEGG

A 17052680371



Inchcape Testing Services

Bondar Clegg

Certificate of Analysis

CLIENT: PELANGIO LARDER MINES
REPORT: T96-57562.0 (PARTIAL)

PROJECT: DAVIS
DATE PRINTED: 22-OCT-96

PAGE 1

SAMPLE NUMBER	ELEMENT UNITS	AU G/T	Cu PPM	Pb PPM	Zn PPM	Ag PPM	ALREX G/T
D-1		<0.03	197	14	44	<0.1	
D-1A		<0.03	46	5	6	<0.1	
D-02		2.83	78	10	4	0.2	
D-03		29.82	40	9	5	4.0	29.07
D-04		0.26	112	20	33	0.4	
D-05		0.08	282	10	44	0.2	
D-06		0.07	281	10	44	<0.1	
D-07		353.90	230	14	42	24.3	310.91
D-08		<0.03	37	4	9	<0.1	
D-09		<0.03	27	6	2	<0.1	
D-10		<0.03	14	4	13	<0.1	
D-11		60.36	345	9	5	1.2	18.75
D-12		0.11	103	11	105	<0.1	
D-13		0.06	546	6	47	0.3	

Bondar-Clegg & Company Ltd.
5420 Canotek Road, Ottawa, Ontario, K1J 9G2, Canada
Tel: (613) 749-2220, Fax: (613) 749-7170

Lab Supervisor
*** PAGE TOTALE, 002 ***

OCT 23 '96 09:00

DE CHIMITEC BONDAR CLEGG

A 17052680371



Inchcape Testing Services

Bondar Clegg

Certificate
of
Analysis

CLIENT: PELANGIO LARDER MINES
REPORT: 196-57562.0 (PARTIAL)

PROJECT: DAVIS
DATE PRINTED: 22-OCT-96 PAGE 1

SAMPLE NUMBER	ELEMENT UNITS	AU G/T	CU PPM	PB PPM	ZN PPM	AG PPM	AURAU G/T
D-1		<0.03	197	14	44	<0.1	
D-1A		<0.03	46	5	6	<0.1	
D-02		2.83	78	10	4	0.2	
D-03		29.82	40	9	5	4.0	29.07
D-04		0.26	112	20	33	0.4	
D-05		0.08	262	10	44	0.2	
D-06		0.07	281	10	44	<0.1	
D-07		353.90	230	14	42	24.3	310.91
D-08		<0.03	57	4	9	<0.1	
D-09		<0.03	87	6	2	<0.1	
D-10		<0.03	14	4	13	<0.1	
D-11		60.36	345	9	5	1.2	18.75
D-12		0.11	103	11	105	<0.1	
D-13		0.06	546	6	47	0.3	

Bondar-Clegg & Company Ltd.
5420 Cazotek Road, Ottawa, Ontario, K1J 9G2, Canada
Tel: (613) 749-2220, Fax: (613) 749-7170

Lab Supervisor
** PAGE TOTALE 002 **

Personal information collected on this form is obtained under the authority of the Mining Act. This information will be used for correspondence. Questions about this collection should be directed to the Provincial Manager, Mining Lands, Ministry of Northern Development and Mines, Fourth Floor, 159 Cedar Street Sudbury, Ontario, P3E 6A5, telephone (705) 670-7264.

200920

- Instructions:
- Please type or print and submit in duplicate.
 - Refer to the Mining Act and Regulations for Recorder.
 - A separate copy of this form must be completed.
 - Technical reports and maps must accompany.
 - A sketch, showing the claims the work is as:



900

Recorded Holder(s) <i>RELANGLIO LARSEN MINES LTD</i>		Client No. <i>180621</i>
Address <i>Cedar Hill Connaught Ont, P0W 1A0</i>		Telephone No. <i>705 264 3100</i>
Mining Division <i>Sudbury</i>	Township/Area <i>DAVIS</i>	M or G Plan No.
Dates Work Performed From: <i>Oct. 10/96</i>		To: <i>Oct. 12/96</i>

Work Performed (Check One Work Group Only)

Work Group	Type
Geotechnical Survey	<i>Prospecting & Sampling (PROSP) (OBJECT)</i>
Physical Work, Including Drilling	
Rehabilitation	
Other Authorized Work	<i>REBLAZING OF CLAIM LINES</i>
Assays	
Assignment from Reserve	

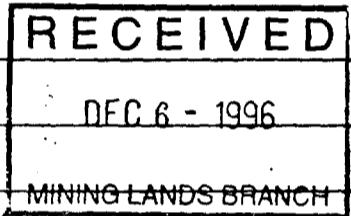

Total Assessment Work Claimed on the Attached Statement of Costs \$ *1248*

Note: The Minister may reject for assessment work credit all or part of the assessment work submitted if the recorded holder cannot verify expenditures claimed in the statement of costs within 30 days of a request for verification.

Persons and Survey Company Who Performed the Work (Give Name and Address of Author of Report)

Name	Address
<i>Kevin Fild</i>	<i>535 Bartleman Timmins Ont</i>

(attach a schedule if necessary)

Certification of Beneficial Interest * See Note No. 1 on reverse side

I certify that at the time the work was performed, the claims covered in this work report were recorded in the current holder's name or held under a beneficial interest by the current recorded holder.	Date <i>Oct. 12/96</i>	Recorded Holder or Agent (Signature) <i>[Signature]</i>
--	---------------------------	--

Certification of Work Report

I certify that I have a personal knowledge of the facts set forth in this Work report, having performed the work or witnessed same during and/or after its completion and annexed report is true.		
Name and Address of Person Certifying <i>J. Kevin Fild 535 Bartleman Timmins Ont</i>		
Telephone No. <i>705 268 0371</i> <i>705 268 9045</i>	Date <i>Oct. 12/96</i>	Certified By (Signature) <i>[Signature]</i>

For Office Use Only

Total Value Cr. Recorded <i>Appl. \$11,800</i> <i>RD \$48.00</i>	Date Recorded <i>October 16/96</i>	Mining Recorder <i>[Signature]</i>	Received Stamp <i>SECRETARY MINES DIV.</i> <i>OCT 16 1996</i> <i>104424</i> A.M. 7:8, 9:10, 11:12, 1:2, 3:35
	Deemed Approval Date <i>January 14/97</i>	Date Approved	
	Date Notice for Amendments Sent		

Number for Applying Reserve	Claim Number (see Note 2)	Number of Claim Units
	830718	1
	911140	1
Total Number of Claims		2

Value of Assessment Work Done on this Claim	Value Applied to this Claim	
1248	400	
0	800	
Total Value Work Done		1248
Total Value Work Applied		1200

Value Assigned from this Claim	Reserve: Work to be Claimed at a Future Date	
800	48	
0	0	
Total Assigned From		800
Total Reserve		48

92697.2

RECEIVED
DEC 8 - 1996
MINING LANDS BRANCH

Credits you are claiming in this report may be cut back. In order to minimize the adverse effects of such deletions, please indicate from which claims you wish to prioritize the deletion of credits. Please mark (✓) one of the following:

- Credits are to be cut back starting with the claim listed last, working backwards.
- Credits are to be cut back equally over all claims contained in this report of work.
- Credits are to be cut back as prioritized on the attached appendix.

In the event that you have not specified your choice of priority, option one will be implemented.

Note 1: Examples of beneficial interest are unrecorded transfers, option agreements, memorandum of agreements, etc., with respect to the mining claims.

Note 2: If work has been performed on patented or leased land, please complete the following:

I certify that the recorded holder had a beneficial interest in the patented or leased land at the time the work was performed.	Signature <i>M. W. [Signature]</i>	Date <i>12/1/96</i>
---	------------------------------------	---------------------

Personal information collected on this form is obtained under the authority of subsection 6(1) of the Assessment Work Regulation 6/96 Under section 8 of the Mining Act, the information is a public record. This information will be used to review the assessment work and correspond with the mining land holder. Questions about this collection should be directed to the Chief Mining Recorder, Ministry of Northern Development and Mines, 6th Floor, 933 Ramsey Lake Road, Sudbury, Ontario, P3E 8B5.

Work Type	Units of Work <small>Depending on the type of work, list the number of hours/days worked, metres of drilling, kilometres of grid line, number of samples, etc.</small>	Cost Per Unit	Total Cost
Prospecting	1 DAY	\$150 / DAY	150
Assaying	14 samples, multi-element	\$23.71 / sample	332
Reblazing Claims	1 DAY, 1 m row	\$214 / DAY	214
Drafting, Report	1.5 days	\$214 / DAY	321
Associated Costs (e.g. supplies, mobilization and demobilization).			
	Copies, Bindings	\$7.50 / report	15
Transportation Costs			
	Truck 800km return from Tombas to Davis Top	\$29 / km	
Food and Lodging Costs			
Total Value of Assessment Work			1248

RECEIVED
 DEC 6 - 1996
 MINING LANDS BRANCH

Calculations of Filing Discounts:

1. Work filed within two years of performance is claimed at 100% of the above Total Value of Assessment Work.
2. If work is filed after two years and up to five years after performance, it can only be claimed at 50% of the Total Value of Assessment Work. If this situation applies to your claims, use the calculation below:

TOTAL VALUE OF ASSESSMENT WORK x 0.50 = Total \$ value of worked claimed.

Note:

- Work older than 5 years is not eligible for credit.
- A recorded holder may be required to verify expenditures claimed in this statement of costs within 45 days of a request for verification and/or correction/clarification. If verification and/or correction/clarification is not made, the Minister may reject all or part of the assessment work submitted.

Certification verifying costs:

I, J. Kevin Fink (please print full name), do hereby certify, that the amounts shown are as accurate as may reasonably be determined and the costs were incurred while conducting assessment work on the lands indicated on the accompanying Declaration of Work form as [Signature] I am authorized (recorded holder, agent, or state company position with signing authority) to make this certification.

Signature <u>[Signature]</u>	Date <u>Oct. 12/96</u>
------------------------------	------------------------

Ministry of
Northern Development
and Mines

Ministère du
Développement du Nord
et des Mines



Geoscience Assessment Office
933 Ramsey Lake Road
6th Floor
Sudbury, Ontario
P3E 6B5

December 23, 1996

Roy Denomme
Mining Recorder
933 Ramsey Lake Road, 3rd Floor
Sudbury, ON
P6E 6B5

Telephone: (705) 670-5853
Fax: (705) 670-5863

Dear Sir or Madam:

Submission Number: 2.16926

Subject: Transaction Number(s): W9670.00159

We have reviewed your Assessment Work submission with the above noted Transaction Number(s). The attached summary page(s) indicate the results of the review. We recommend you read this summary for the details pertaining to your assessment work.

If the status for a transaction is a 45 Day Notice, the summary will outline the reasons for the notice, and any steps you can take to remedy deficiencies. The 90-day deemed approval provision, subsection 6(7) of the Assessment Work Regulation, will no longer be in effect for assessment work which has received a 45 Day Notice.

Please note any revisions must be submitted in DUPLICATE to the Geoscience Assessment Office, by the response date on the summary.

NOTE: This correspondence may affect the status of your mining lands. Please contact the Mining Recorder to determine the available options and the status of your claims.

If you have any questions regarding this correspondence, please contact Steve Beneteau at (705)670-5855.

Yours sincerely,

A handwritten signature in black ink, appearing to read "Ron C. Gashinski".

ORIGINAL SIGNED BY
Ron C. Gashinski
Senior Manager, Mining Lands Section
Mines and Minerals Division

Work Report Assessment Results

Submission Number: 2.16926

Date Correspondence Sent: December 23, 1996

Assessor: Steve Beneteau

Transaction Number	First Claim Number	Township(s) / Area(s)	Status	Approval Date
W9670.00159	830718	DAVIS	Approval	December 20, 1996

Section:

9 Prospecting PROSP

Correspondence to:

Mining Recorder
Sudbury, ON

Resident Geologist
Sudbury, ON

Assessment Files Library
Sudbury, ON

Recorded Holder(s) and/or Agent(s):

Kevin Filo
TIMMINS, ONTARIO, CANADA

PELANGIO - LARDER MINES, LIMITED
CONNAUGHT, Ontario

Aerial Cableway	Pipeline
Boundary	Railroad
Intermunicipal	Single Track
District, Township	Double Track
Section Reserve	Abandoned
Approximate	Footpath
Lot, Concession	Road
Approximate	Highway, County
Perk Boundary	Township
Bridge	Access Road of doubtful
Beam, Ballast	width (shown as dashed)
Building	Trail, Back Road
Chimney	(shown as dashed)
Cliff, Pit, Pile	Rapids
Contours	Double line river
Interpretation	with multiple rapids
Approximate	Reservoir
Depression	River, Stream, Canal
Control Points	Approximate
Horizontal	position
Vertical	position of flow
Calvert	Rock
Falls	Spit
Double line river	Elevation
Fence, Hedge,	(shown as dashed)
Wall	Spot
Feature Outline	Elevation
(Construction features, etc.)	Transmission Line
Flooded Land	Pole
Lock	Pylon
Marsh or Swamp	Utility Pole
Mast	Wharf, Dock, Pier
Mine Head Frame	Wooded Area
Outcrop	

AREAS WITHDRAWN FROM DISPOSITION

M.R.O. - MINING RIGHTS ONLY
 S.R.O. - SURFACE RIGHTS ONLY
 M.+S. - MINING AND SURFACE RIGHTS

Disposition	Order No.	Date	Disposition	File
SEC. 43/70	M.14/75	20/12/75	M.R.S.	46288-2

NOTE
 THE SUBDIVISION OF THIS TOWNSHIP INTO LOTS AND CONCESSIONS WAS PARTIALLY ANNULLED ON DECEMBER 29, 1993.

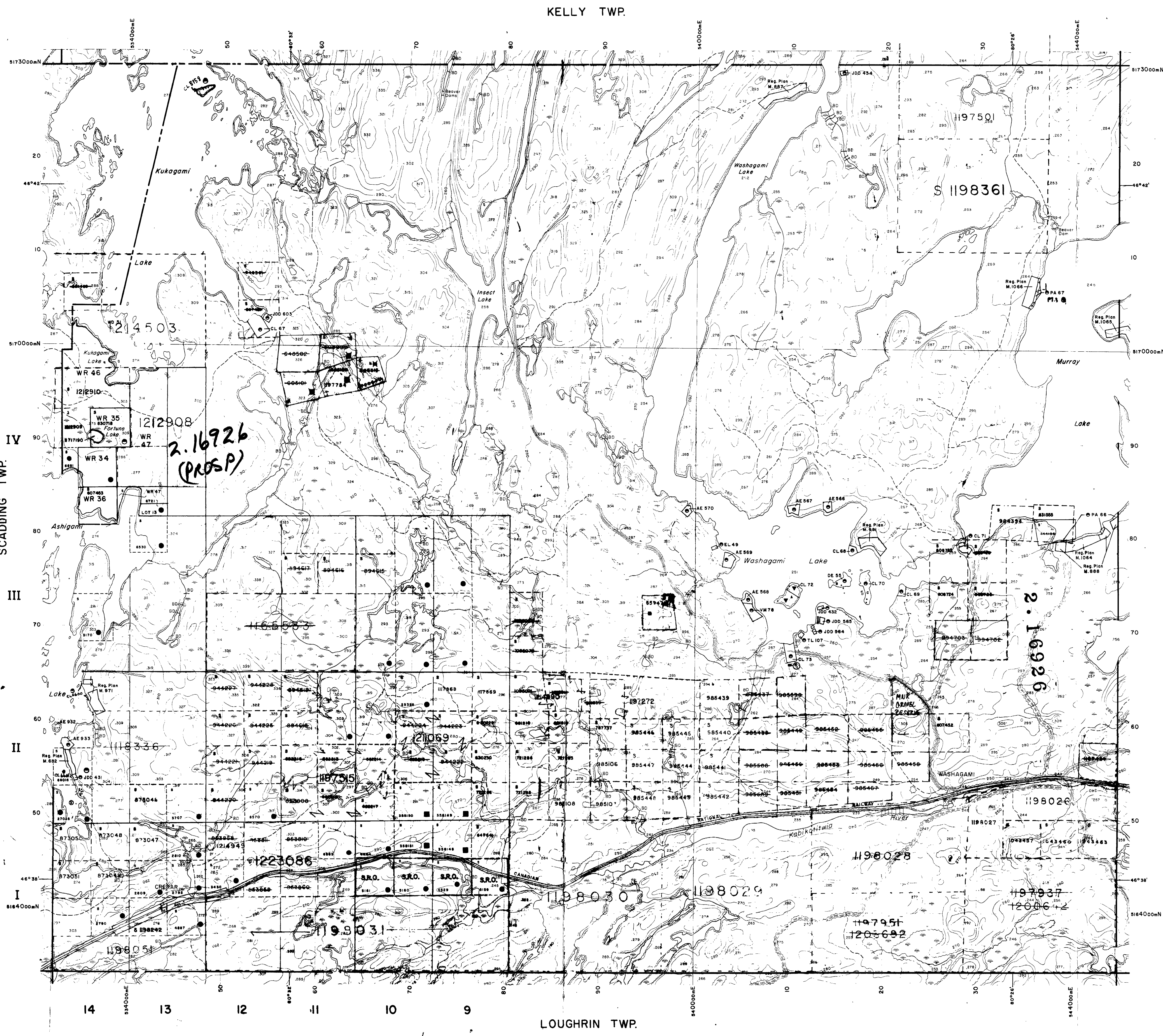

TRAILS	--- ---
SURVEYED LINES	-----
TOWNSHIPS, BASE LINES, ETC.	-----
LOTS, MINING CLAIMS, PARCELS, ETC.	-----
UNSURVEYED LINES	-----
LOT LINES	-----
PARCEL BOUNDARY	-----
MINING CLAIMS ETC.	-----
RAILWAY AND RIGHT OF WAY	-----
UTILITY LINES	-----
NON-PERENNIAL STREAM	-----
FLOODING OR FLOODING RIGHTS	-----
SUBDIVISION OR COMPOSITE PLAN	-----
RESERVATIONS	-----
ORIGINAL SHORELINE	-----
MARSH OR MUSKIE	-----
MINES	-----
TRAVERSE MONUMENT	-----

DISPOSITION OF CROWN LANDS

TYPE OF DOCUMENT	SYMBOL
PATENT, SURFACE & MINING RIGHTS	●
.. SURFACE RIGHTS ONLY	○
.. MINING RIGHTS ONLY	○
LEASE, SURFACE & MINING RIGHTS	■
.. SURFACE RIGHTS ONLY	□
.. MINING RIGHTS ONLY	□
LICENCE OF OCCUPATION	▽
ORDER-IN-COUNCIL	○
RESERVATION	○
CANCELLED	○
SAND & GRAVEL	○

NOTE: MINING RIGHTS IN PARCELS PATENTED PRIOR TO MAY 8, 1913, VESTED IN ORIGINAL PATENTEES BY THE PUBLIC LANDS ACT, R.S.O. 1970, CHAP. 300, SEC. 63, SUBSEC. 1.
 S.R.O. - SURFACE RIGHTS ONLY

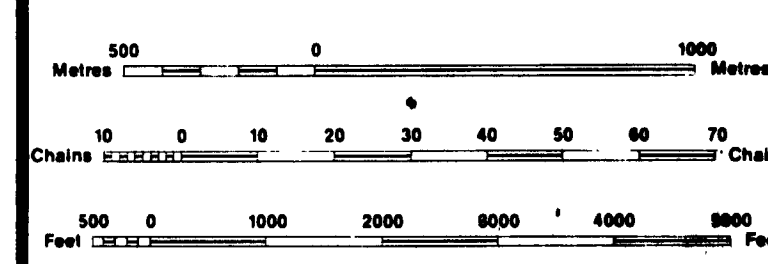

SCALE 1:20 000
 GRID ZONE: I7

THE INFORMATION THAT APPEARS ON THIS MAP HAS BEEN COMPILED FROM VARIOUS SOURCES, AND ACCURACY IS NOT GUARANTEED. THOSE WISHING TO STAKE MINING CLAIMS SHOULD CONSULT WITH THE MINING RECORDER, MINISTRY OF NORTHERN DEVELOPMENT AND MINES, FOR ADDITIONAL INFORMATION ON THE STATUS OF THE LANDS SHOWN HEREON.

JUNE 1971 OPENINGS
 ONTARIO GAZETTE VOL. 22-18
 27th 5th 1989
 SE 1/4 OF N 1/2 LOT 9 CONJ
 SW 1/4 OF N 1/2 LOT 9 CONJ
 SE 1/4 OF N 1/2 LOT 10 CONJ
 SW 1/4 OF N 1/2 LOT 10 CONJ

DATE OF ISSUE
 NOV 21 1988
 SUDBURY
 MINING RECORDER'S OFFICE

S.144136 SEE ONTARIO GAZETTE (Page 224) MAY 4TH, 1985 (COPY ALSO IN LAND ROLL)
 * JUNE 1, 1994, OPENINGS ONTARIO GAZETTE VOL. 27-20 MAY 14, 1994.

TOWNSHIP
DAVIS
 M.N.R. ADMINISTRATIVE DISTRICT
 SUDBURY
 MINING DIVISION
 SUDBURY
 LAND TITLES / REGISTRY DIVISION
 SUDBURY

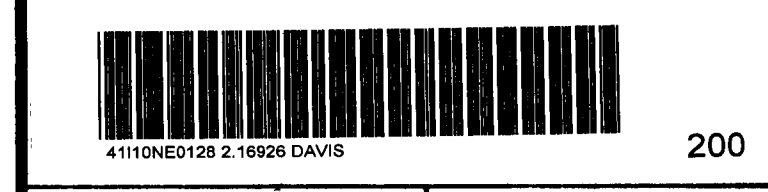

Original Completion: SEPT., 1985
 Number: G-3182

MAP SYMBOLOLOGY

Aerial Cableway	Pipeline
Boundary	Railroad
Intermittent	Single Track
Intermittent	Double Track
District, Township	Abandoned
Indian Reserve	Turbine
Approximate	Road
Lot, Concession	Highway, County
Approximate	Township
Park Boundary	Access (road of doubtful
Bridge	importance or
Road, Railroad	significant)
Building	Trail, Bush Road
Chimney	(various sizes)
Cliff, Pit, Pile	Rapids
Contours	Double line river
Approximate	with multiple rapids
Intermittent	Reservoir
Depression	River, Stream, Canal
Control Points	Approximate
Vertical	location of flow
Horizontal	Spot Elevation
Vertical	(over elevation) -300
Culvert	Tower
Dam	Transmission Line
Double line river	Pole
with multiple rapids	Pyrene
Feature Outline	Tunnel
(Construction features, etc.)	Utility Poles
Flooded Land	Wharf, Dock, Pier
Lock	Wooded Area
Marsh or Swamp	
Moat	
Mine Head Frame	
Outcrop	

AREAS WITHDRAWN FROM DISPOSITION

Description	Order No.	Date	Disposition	File
M.R.O. - MINING RIGHTS ONLY				
S.R.O. - SURFACE RIGHTS ONLY				
M.+S. - MINING AND SURFACE RIGHTS				
REC PURP	SEC 3 PLA			18843
	W 97/77	18/12/77	S.R.O.	88555

SAND AND GRAVEL

(S) GRAVEL	53668
(G) GRAVEL	68760

THIS TWP SUBJECT TO FOREST ACTIVITY IN 1905/196
FURTHER INFORMATION AVAILABLE ON FILE.

THE INFORMATION THAT APPEARS ON THIS MAP HAS BEEN COMPILED FROM VARIOUS SOURCES AND ACCURACY IS NOT GUARANTEED. THOSE WISHING TO STAKE MINING CLAIMS SHOULD CONSULT WITH THE MINING RECORDER, MINISTRY OF NORTHERN DEVELOPMENT AND MINES, FOR ADDITIONAL INFORMATION ON THE STATUS OF THE LANDS SHOWN HEREON.

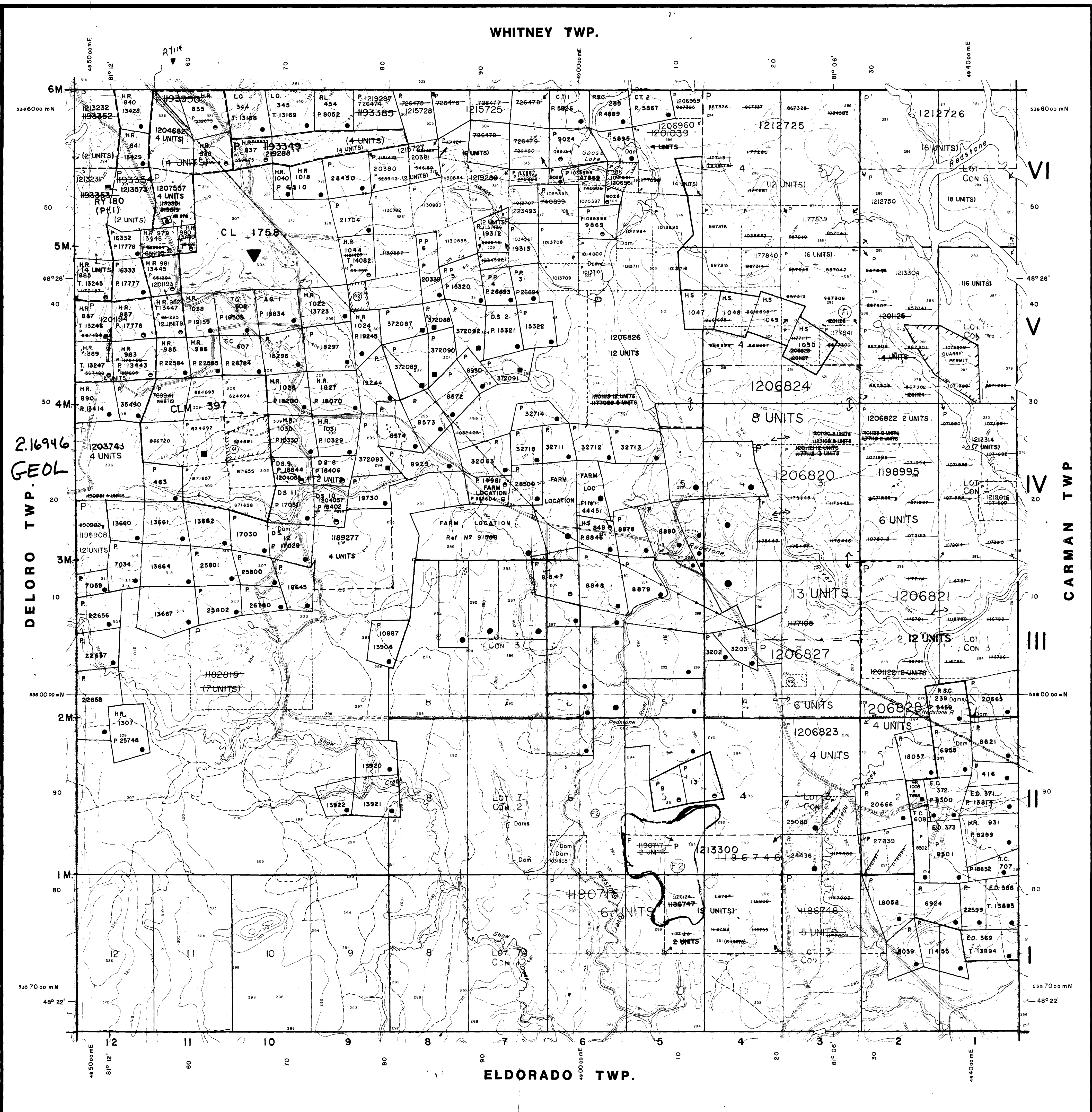

LEGEND

HIGHWAY AND ROUTE No.

OTHER ROADS

TRAILS

SURVEYED LINES

TOWNSHIPS, BASE LINES, ETC.

LOTS, MINING CLAIMS, PARCELS, ETC.

UNSURVEYED LINES

LOT LINES

PARCEL BOUNDARY

MINING CLAIMS ETC.

RAILWAY AND RIGHT OF WAY

UTILITY LINES

NON PERENNIAL STREAM

FLOODING OR FLOODING RIGHTS

SUBDIVISION OR COMPOSITE PLAN

RESERVATIONS

ORIGINAL SHORELINE

MARSH OR MUSKIE

MINES

TRAVERSE MONUMENT

DISPOSITION OF CROWN LANDS

TYPE OF DOCUMENT	SYMBOL
PATENT, SURFACE & MINING RIGHTS	●
" SURFACE RIGHTS ONLY	○
" MINING RIGHTS ONLY	◐
LEASE, SURFACE & MINING RIGHTS	◑
" SURFACE RIGHTS ONLY	◒
" MINING RIGHTS ONLY	◓
LICENCE OF OCCUPATION	◔
ORDER-IN-COUNCIL	OC
RESERVATION	⊙
CANCELLED	⊘
SAND & GRAVEL	⊙

NOTE: MINING RIGHTS IN PARCELS PATENTED PRIOR TO MAY 6, 1912, VESTED IN ORIGINAL PATENTEES BY THE PUBLIC LANDS ACT, R.S.O. 1970, CHAP. 380, SEC. 63, SUBSEC. 1

Scale: 1:20 000
GRID ZONE: 17

TOWNSHIP SHAW

M.N.R. ADMINISTRATIVE DISTRICT
TIMMINS

MINING DIVISION
PORCUPINE

LAND TITLES REGISTRY DIVISION
COCHRANE

4110NE0228 2 1628 DAVIDS 210

ORIGINAL COMPILED JULY 1984
IN SERVICE DEC 5, 1995
REVISED
CHECKED BY

G-3999

2.16926

MAIN GOLD OCCURRENCE
(SEE FIG. 5 FOR DETAIL)

CLAIM 830718

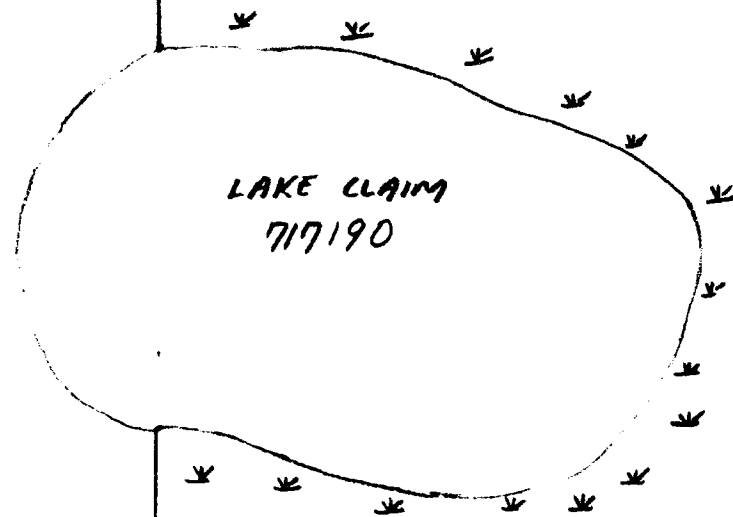

PELANGIO LARDBR
MINES
SHOWING LOCATION MAP

FIG # 4



41110NE0128 2.16926 DAVIS

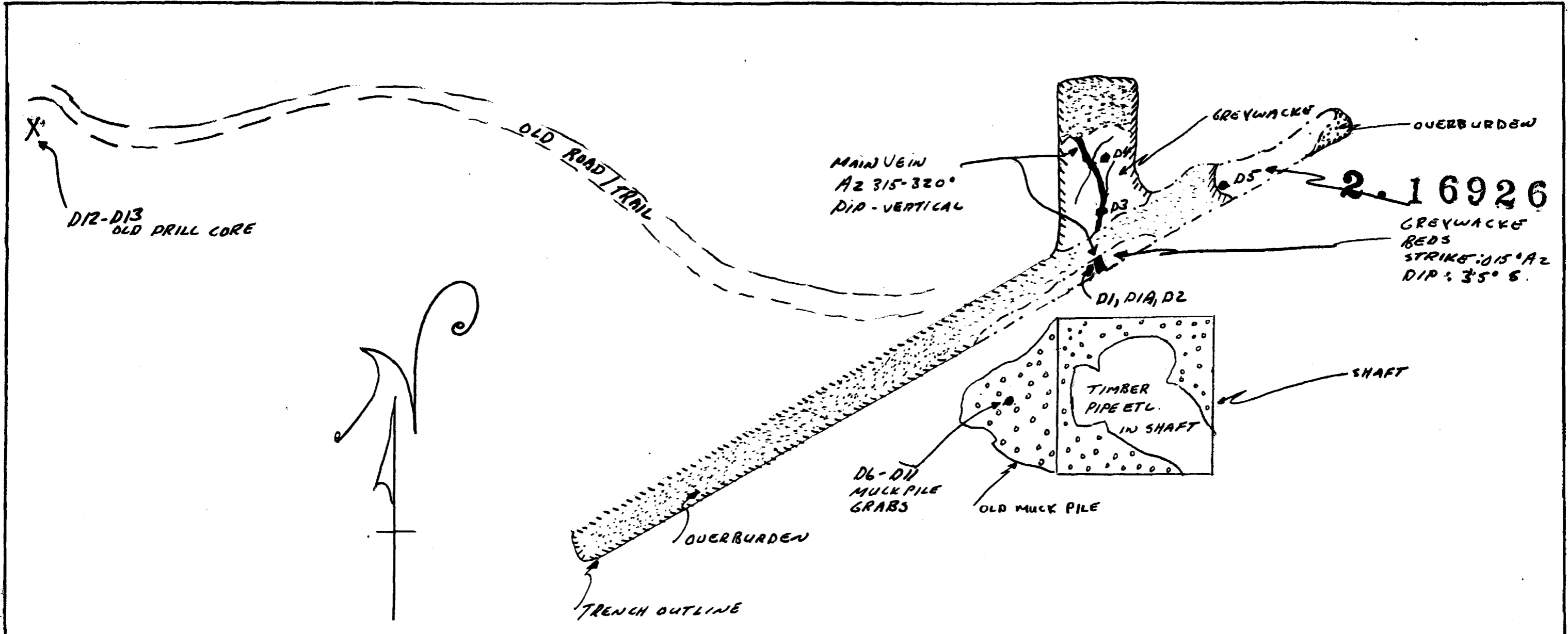

PELANGIO LARDER MINES
 PROSPECTING
 SKETCH
 FORTUNE LAKE GOLD PROPERTY
 DAVIS TWP.
 M.D. FIG # 5

