

Report On Prospecting
Claims: 1140885, 3010714, 3010715
Davis Township- G 3182
Sudbury Mining Division
Ontario.

J.D. Bradley
Prospector's License # C- 36085
August 16, 2003.

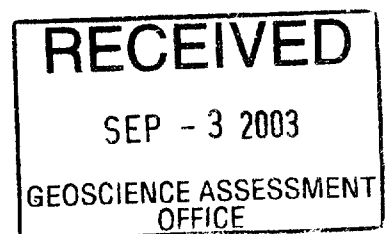

41110NE2025 2.26202 DAVIS

010

Table of Contents

Introduction	page 1
Property, Location and Access	page 1
Property Description	page 1
Prospecting Targets	page 1
Regional Location Map	page 2
Local Location Map	page 3
Claim Map	page 4
Flooded Roadway	page 5
General Geology	page 5
Claim Geology	page 5
Prospecting	page 6
Prospecting Daily Log	page 6
Rock and Drill Core Sampling	page 7
Summary and Conclusions	page 8
References	page 9
Prospecting Map	page 10

Introduction:

This report covers prospecting work carried out on the Fortune Lake Gold Property located in Davis Township Sudbury Mining Division, Ontario. The principle purpose of this work was to maintain the prospect in good standing. A total of 16 samples were taken during the course of the visit to the property. Of these, 7 were submitted to be assayed for gold. Originally, a more comprehensive work program was planned for this summer. However, owing to a 200- foot section of road being flooded by a beaver dam, the comprehensiveness of the program had to be modified. Prospecting was carried out on one day, August 13th 2003.

Property, Location and Access:

NTS map	41-I/9
Latitude	46 41`N
Longitude	80 34`W

Claims 1140885, 3010714, 3010715 are located in N.W. Davis Twp. G-3182 near the Scadding/Davis Township boundary approximately 25 air miles northeast of the city of Sudbury.

Access to the property is by Highway #535 departing north from the Trans Canada Highway (Highway #17) approximately 50 kilometers east of Sudbury, at the village of Hagar. Some 23 kilometers north of the village of Hagar, the road crosses the Kabikotitwia River at Washagami. At this point, travel is in a northwest direction for some 7.1 kilometers, then branching left onto an old logging road for a further 4.6 kilometers, again branching left approximately 2 kilometers to the property.

Property Description:

The Fortune Lake Gold Property consists of three claims numbered 1140885, 3010714, and 3010715, approximately 80 ha.

1140885 staked: June 4, 1998, recorded June 5th, 1998.
 3010714 staked: November 23, 2002, recorded December 20, 2002.
 3010715 staked: November 23, 2002, recorded December 17, 2002.

Prospecting Targets:

1. Old trenches, test-pits and shafts
2. Zone of gold-bearing quartz veins
3. Recovery of old drill core

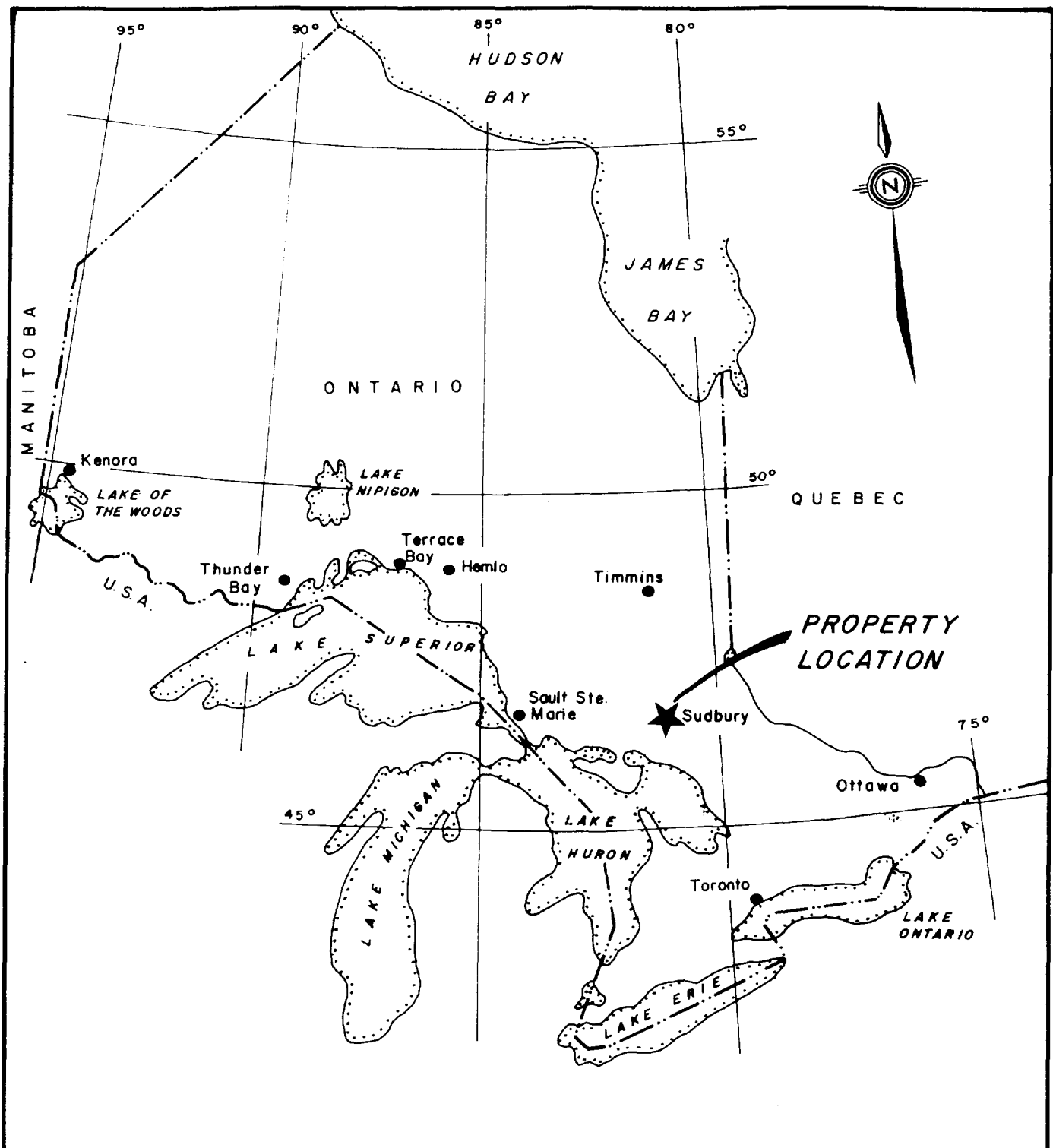
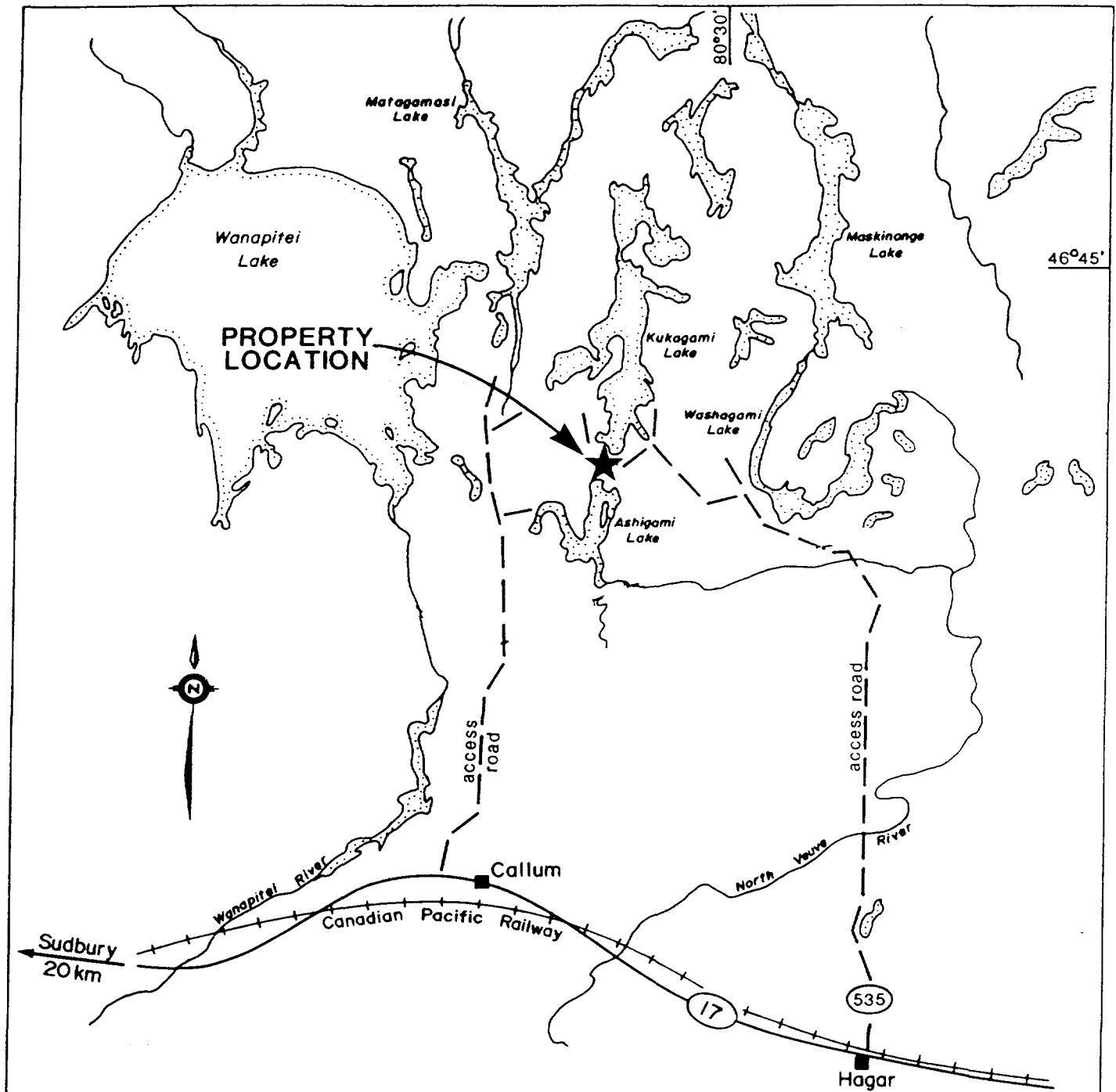

FIG. 1

FORTUNE LAKE PROPERTY REGIONAL LOCATION MAP

DAVIS TOWNSHIP
SUDBURY MINING DIVISION, ONTARIO



SCALE 1 : 250,000



Figure 2
**FORTUNE LAKE PROPERTY
LOCAL
LOCATION MAP**
Sudbury Mining Division
Ontario
NTS : 41 I/9

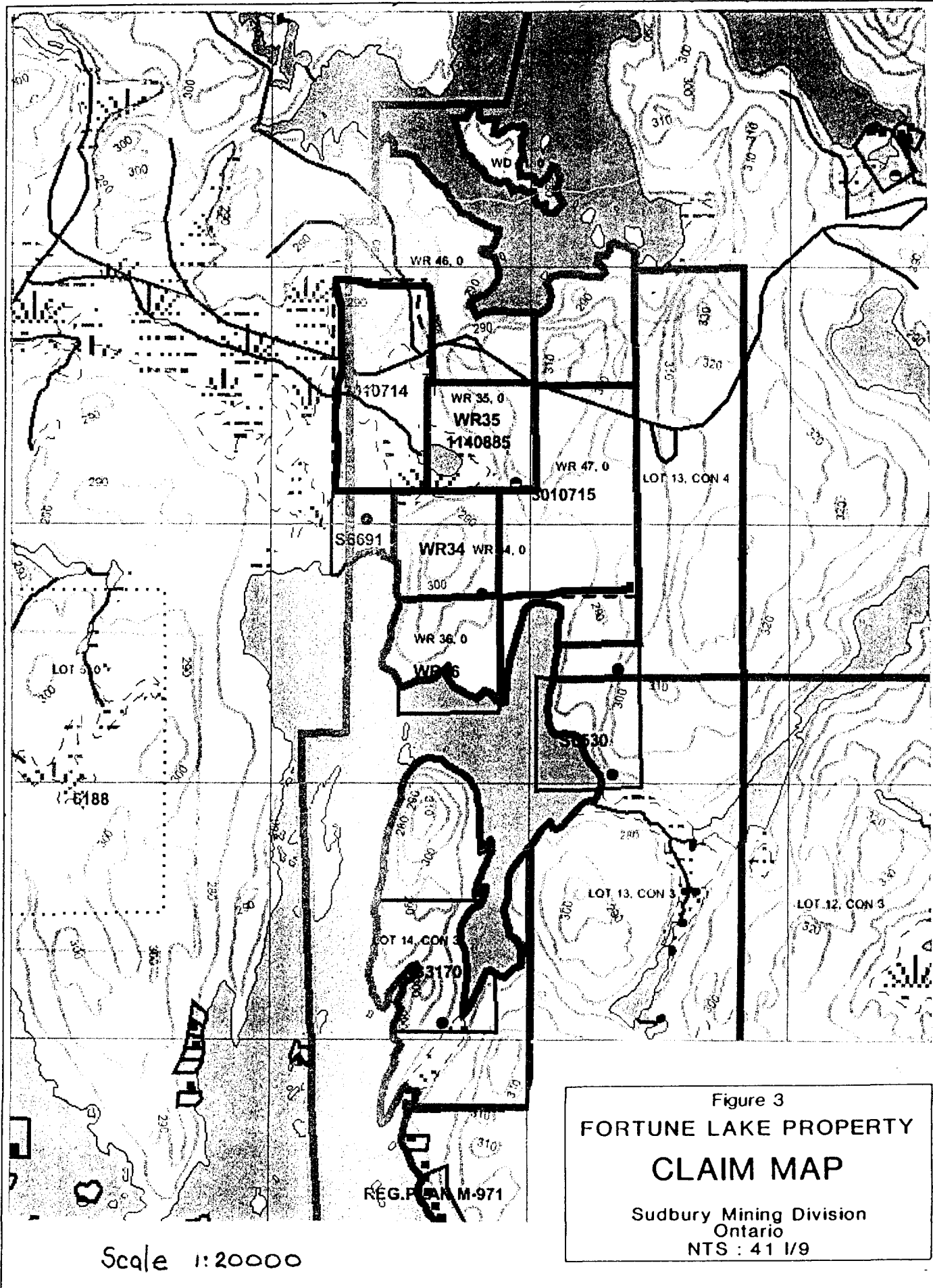

Figure 3
**FORTUNE LAKE PROPERTY
 CLAIM MAP**
 Sudbury Mining Division
 Ontario
 NTS : 41 I/9

Flooded Roadway:

On Tuesday, August 12, 2003, while driving to the Fortune Lake Gold Property, the truck was passed by an ATV. About a kilometer ahead the journey was abruptly terminated by a 200 foot section of road having been flooded by a large beaver dam. The ATV, by this time, had already crossed the water and was stopped on the other side. I called over and asked the driver the depth of the water. He estimated it to be 3 feet deep. The fact that we were driving a new rented 4-wheel drive truck factored into the decision to not attempt crossing the water by this means. It was thought the risk of becoming stuck or perhaps damaging the vehicle was too great. The ATV driver crossed back to where we were standing. I explained to him where I wanted to go and what I was planning to do. He asked if I would be prepared to pay him for transportation by his ATV to the property. A financial arrangement was reached.

General Geology:

The geology of the Wanapitei Lake Gold Area has been described in Ontario Department of Mines publications dated 1932 and 1983 as well as in an Ontario Geological Survey report dated 1982.

The rocks of the Wanapitei area were formed during the Early, Middle and Late Precambrian period. The eastern part of the area (Davis Twp.) is underlain mainly by sedimentary rocks of the Huronian Age Supergroup and by Nipissing Gabbro. The rocks of the Huronian Supergroup were deposited in the Middle Precambrian period after the Early Precambrian felsic plutonic rocks and before the Nipissing intrusive.

A large part of Davis Township and adjacent parts of Scadding Township located to the west are underlain by Cobalt Group sediments which formed the upper part of the Huronian Supergroup. The Fortune Lake Gold Property is underlain by unlaminated, wacke conglomerates argillite with minor interbedded quartzite of the Gowganda Formation which is the basal formation of the Cobalt Group.

Claim Geology:

The claim is located along a gentle slope on the north side of Fortune Lake in an area of drift cover with outcrop exposures of only about 5-10 %. The host rock is Gowganda Formation (greywacke, siltstone, laminated siltstone and possible arkose). Irregular narrow quartz veins which strike the 330 and dip 50 SW were observed to carry free gold.

From report, Gates, B. I. 1991 Sudbury Mineral Occurrence Study, Ontario Geological Survey, Open File Report 5771 235p (Fortune Lake Property page 150) .

Gates goes on to say that erratic gold-bearing quartz veins are located within strongly potassium-altered siltstones. Gold-bearing quartz veins are also located within an altered grey arkosic-quartzite and cutting Sudbury-type breccia. Ankerite rhombs were seen within Sudbury Breccia and within the Gowganda Formation.

Prospecting:

On Wednesday, August 13, 2003, we arrived by ATV at the property at 8:30 AM. As this was the first visit to the claims by the owner, G. Jackson, it was decided to visit the main showing (shaft area) on Claim 1140885. The most easterly shaft (#2) is 100 feet deep and was sunk to test the gold-bearing quartz structure originally discovered in the late 1800's. There is a large muck pile located here and 4 grab samples were obtained. Trench #2 is located next to the main shaft. It is 44 metres long and is overgrown at this time. Host of the veins in Trench #2 is massive to thick-bedded greywacke. The greywackes are fresh except in the vicinity of some of the veins where minor sulphide and silica introduction occurs. Four samples were taken in a section of 6 gold-bearing quartz veins being the main vein system. Pelangio Larder Mines Limited did a VLF-EM survey on what is now Claim #1140885 and reported finding 2 drill collars of unknown age 100 and 200 feet southwest of the #1 shaft. No records of these holes and/or the results obtained appear to exist. This drill core was located and examined. Some was discovered on surface but the majority was found buried. Five pieces were kept for analysis.

The second half of the day was spent on Claim #3010714 systematically run traverses were made to locate any old test-pits or trenches or areas that might indicate past prospecting and/or development activity. Old records state that the vein system has been traced and exposed through trenching across the boundary lines on the adjoining west and east claims. Today this represents Claim #3010714 to the west and Claim #3010715 to the east. The claims were staked in November of 2002 to cover the extension of the gold-bearing quartz vein system along the strike. The north portion of this claim was prospected, exposure of outcrops is very limited, perhaps less than 5%. Only 1 old trench was located and 3 samples were taken at this site.

Prospecting Daily Log:

Claim# 1140885 Davis Township

Date: Wednesday August 13, 2003.

Started the day at #1 claimpost, followed claim-line south to old trail which leads to #2 shaft area and muck pile. Four grab samples were obtained at this location. Adjacent to shaft area is Trench #2. Four samples were taken from the main vein system found here. Following an old trail which is covered by large fern growth, the drill core was found. Some of the drill core was located on surface but it was necessary to dig for 80% which was recovered. It is likely that some drill core is still to be found in the area. The core was stored safely to be recovered at another time.

Claim #3010714 Davis Township

Date: Wednesday August 13, 2003.

The second half of the day was spent on the north portion of this claim. The purpose of this work was to locate old test-pits or trenches. Traverses were run (east – west). Only one trench was located. Three rock samples were taken from Gowganda Fm.

Rock and Drill Core Sampling:

Sample Descriptions

Sample Number

#1 grab- dump site Greywacke – Gowganda Fm. Quartz vein 2% pyrite.

#2 grab- dump site dirty gray quartz vein material 4-5% pyrite.

* #3 grab – dump site white and gray quartz material stain carbonate 1% pyrite.

#4 grab- dump site greywacke – Gowganda Fm. Sheared staining 1% pyrite.

* #5 chip – trench #2 white to gray quartz vein material some stain 3-4% pyrite.

#6 chip – trench #2 smoky quartz vein material 2-3% pyrite.

* #7 chip – trench #2 vein material white-gray quartz carbonate with staining 2% pyrite.

#8 chip – trench #2 greywacke Gowganda Fm. Mostly white-gray quartz 5% pyrite.

#9 drill core – 5 inches – greywacke relatively unaltered with trace pyrite.

* #10 drill core – 3.5 inches greywacke dark stain chlorite with trace pyrite.

* #11 drill core – 4 inches gray unaltered banded fine-grained greywacke chlorite hematite trace pyrite.

#12 drill core – 4 inches greywacke medium gray chlorite alteration.

#13 drill core – 3 inches greywacke unaltered fine-grained some chlorite tr. pyrite.

* #14 chip – trench 714 Gowganda Fm. off white – gray quartzite fine-grained clastics some breccia.

* #15 chip – trench 714 Gowganda Fm. white – gray quartzite minor breccia .

#16 chip- trench 714 Gowganda Fm. dark gray – black quartz vein clasts , breccia.

* Sample #'s 3,5,7,10,11,14, 15 were sent for gold analysis August 14, 2003.

Summary and Conclusions:

Originally a more comprehensive work program of establishing a grid and a geochemical survey (soil sampling) was envisioned for this summer. The 200 foot section of flooded roadway 6.5 kilometers from the property compromised the plan in terms of cost but more importantly, in safety. In November 2002, claims were staked on the east and west sides of Claim #1140885 (Fortune Lake Property). Old records indicate tracing the main vein system on what is now Claim #3010714 a sample from a trench assayed over 1 oz./ton. Prospecting and sampling was carried out on Wednesday, August 13, 2003 to maintain the prospect in good standing and to locate the target quartz vein system. The overall objective was to determine the extent and grade of the gold bearing quartz veins. Past work on the property has shown it to be highly prospective for the discovery of economic gold deposits. With the addition of the two new claims, a priority for all future work is a proper control grid to be established on the entire property so that all of the past exploration can be accurately located and interpreted collectively. An inquiry to the Ministry of Natural Resources will be made to reach a solution in dealing with the flooded portion of the road which prevents easy access to the property.

References

Mac-Auer Gold Mines Limited. May 17, 1934. Prospectus, Montreal Stock Exchange

Thomson, J.E. – Card, K.D. 1983 Kelly and Davis Townships, Ontario Department of Mines Geological Report No. 15 20 p. accompanied by map #2037 scale 1 inch to 2640 feet.

Hutteri, H.F. August 28, 1985 Electromagnetic VLF Survey Fortune Lake Gold Property For Pelangio-Larder Mines Ltd.

Gates, B.I. 1991. Sudbury Mineral Occurrence Study; Ontario Geological Survey, Open-file Report 5771, 235p.

Cavey, G. – LeBel L. December 5, 1986 Report on Trenching Fortune Lake Property for Golden Hemlock Resources Ltd.

Claim 1140885 + 3010714

Prospecting + Daily Log Map

Wed. Aug. 13 2003

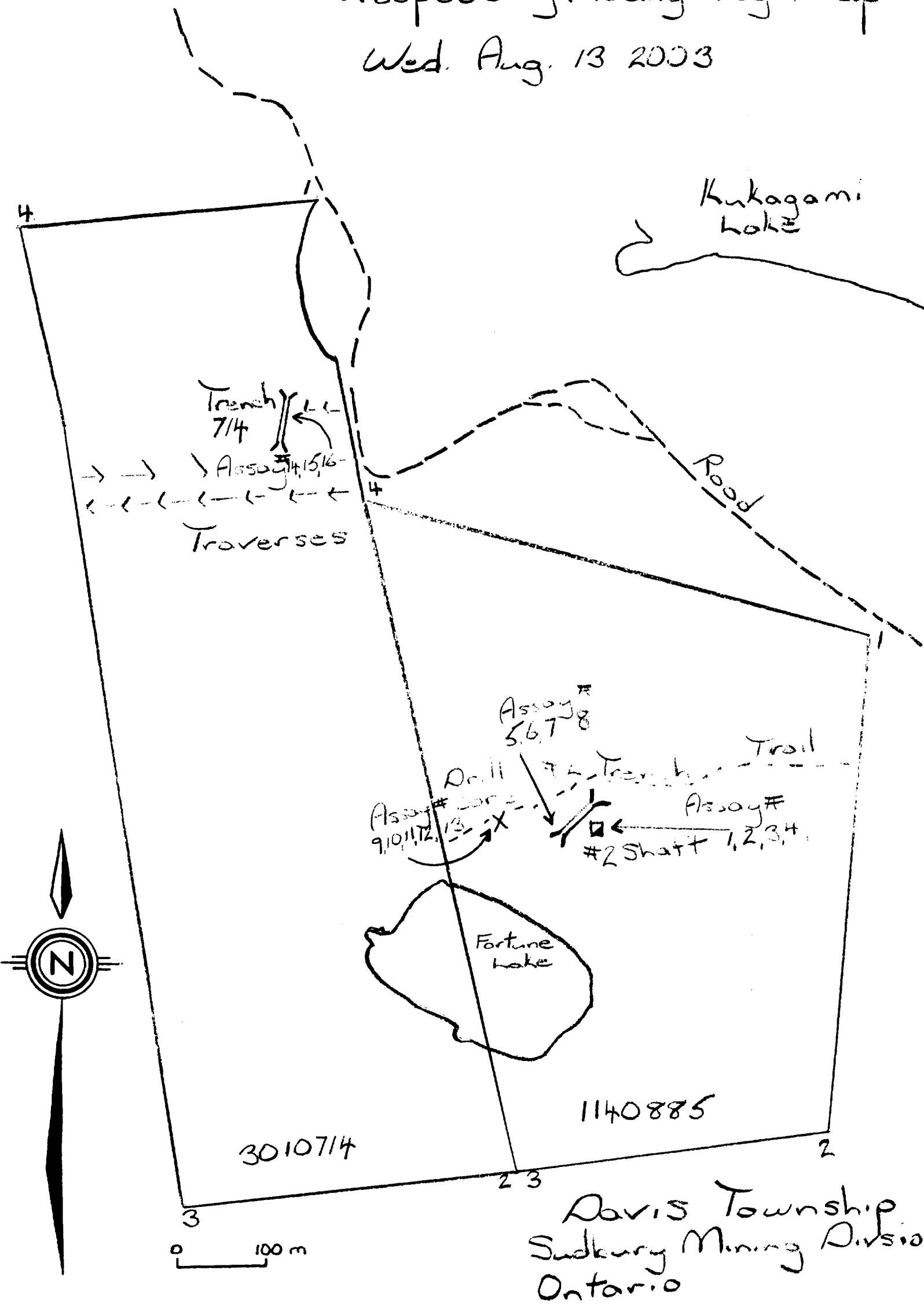

Davis Township
Sudbury Mining Division
Ontario



CERTIFICATE OF ANALYSIS



Geoscience Laboratories (Geo Labs)
933 Ramsay Lake Road, Bldg A4
Sudbury, ON P3E 6B5
Phone: (705) 670-5637
Toll Free: 1-866-436-5227
Fax: (705) 670-3047

Issued To : Mr. J Bradley Consultant 4-46 Old Burnhomthoroe Toronto, ON - Canada	Certificate Date : 09/02/2003 Certificate No. : 13935 Project Number : n/a
Phone : 416-529-7244 Fax : 416-695-4887 E-Mail : - Client No. : 719	Geo Labs Job No. : 03-0218 Submission Date : 08/14/2003
	Delivery Via : FAX QC Requested : NO

Method Code reported with this certificate : GFA

Method Code	Description	Qty	Status
GFA	Gravimetric Fire Assay	7	COMPLETE

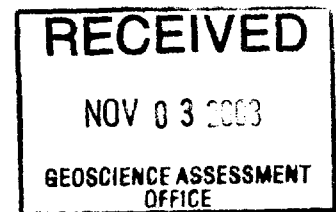

Legend:

N.R. = Analysis not requested
N.D. = Not detected
N.M. = Not measured
Please refer to Geo Labs Job No. 03-0218 if you have any questions.

CERTIFIED BY

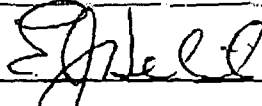
 Date : September 2, 2003

Ed Debicki, Laboratory Manager

Except by special permission, reproduction of these results must include any qualifying remarks made by this Ministry with reference to any sample. Results are for samples as received.



GEO SCIENCE LABORATORIES CERTIFICATE OF ANALYSIS



CLIENT : Bradley
Geo Labs JOB # : 03-0218
DATE : 09/02/2003
METHOD CODE : gfa

Client ID	Au
Units	oz/ton
Detection Limit	0.01

#1	0.12
#2	0.34
#3	0.44
#4	N.D.
#5	N.D.
#6	N.D.
#7	N.D.

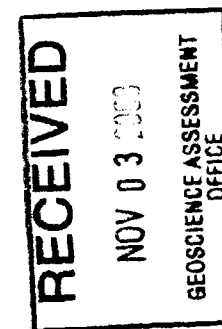

NDU 03 2003 14:10 FR MINES & MINERALS INFO416 314 3797 TO 918776701555

P.05/05

Work Report Summary

Transaction No: W0370.01367 Status: APPROVED
Recording Date: 2003-SEP-03 Work Done from: 2003-AUG-13
Approval Date: 2003-NOV-07 to: 2003-AUG-13

Client(s):
301639 JACKSON, GLENDA IRENE

Survey Type(s):
ASSAY PROSP

Work Report Details:

Claim#	Perform	Perform Approve	Applied	Applied Approve	Assign	Assign Approve	Reserve	Reserve Approve	Due Date
S 1140885	\$715	\$715	\$1,430	\$1,430	\$0	0	\$0	\$0	2007-JUN-05
S 3010714	\$715	\$715	\$0	\$0	\$715	715	\$0	\$0	2004-DEC-20
	\$1,430	\$1,430	\$1,430	\$1,430	\$715	\$715	\$0	\$0	

External Credits: \$0

Reserve: \$0 Reserve of Work Report#: W0370.01367

 \$0 Total Remaining

Status of claim is based on information currently on record.



Date: 2003-NOV-10

GEOSCIENCE ASSESSMENT OFFICE
933 RAMSEY LAKE ROAD, 6th FLOOR
SUDBURY, ONTARIO
P3E 6B5

GLENDIA IRENE JACKSON
46 OLD BURNHAMTHORPE ROAD
APT.4
ETOBICOKE, ONTARIO
M9C 3J5 CANADA

Tel: (888) 415-9845
Fax: (877) 670-1555

Submission Number: 2.26202
Transaction Number(s): W0370.01367

Dear Sir or Madam

Subject: Approval of Assessment Work

We have approved your Assessment Work Submission with the above noted Transaction Number(s). The attached Work Report Summary indicates the results of the approval.

At the discretion of the Ministry, the assessment work performed on the mining lands noted in this work report may be subject to inspection and/or investigation at any time.

If you have any question regarding this correspondence, please contact STEVEN BENETEAU by email at steve.beneteau@ndm.gov.on.ca or by phone at (705) 670-5855.

Yours Sincerely,



Ron C. Gashinski
Senior Manager, Mining Lands Section

Cc: Resident Geologist

John Douglas Bradley
(Agent)

Glenda Irene Jackson
(Assessment Office)

Assessment File Library

Glenda Irene Jackson
(Claim Holder)

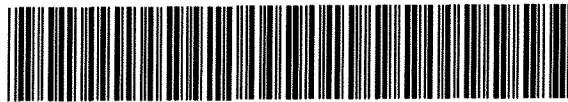

41110NE2025 2.26202 DAVIS

200

ONTARIO CANADA

MINISTRY OF NORTHERN DEVELOPMENT AND MINES
PROVINCIAL MINING RECORDER'S OFFICE

Mining Land Tenure Map

Date / Time of Issue: Thu Nov 20 11:40:04 EST 2003

TOWNSHIP / AREA
DAVIS

PLAN
G-3182

ADMINISTRATIVE DISTRICTS / DIVISIONS

Mining Division
Land Titles/Registry Division
Ministry of Natural Resources District

Sudbury
SUDBURY
SUDBURY

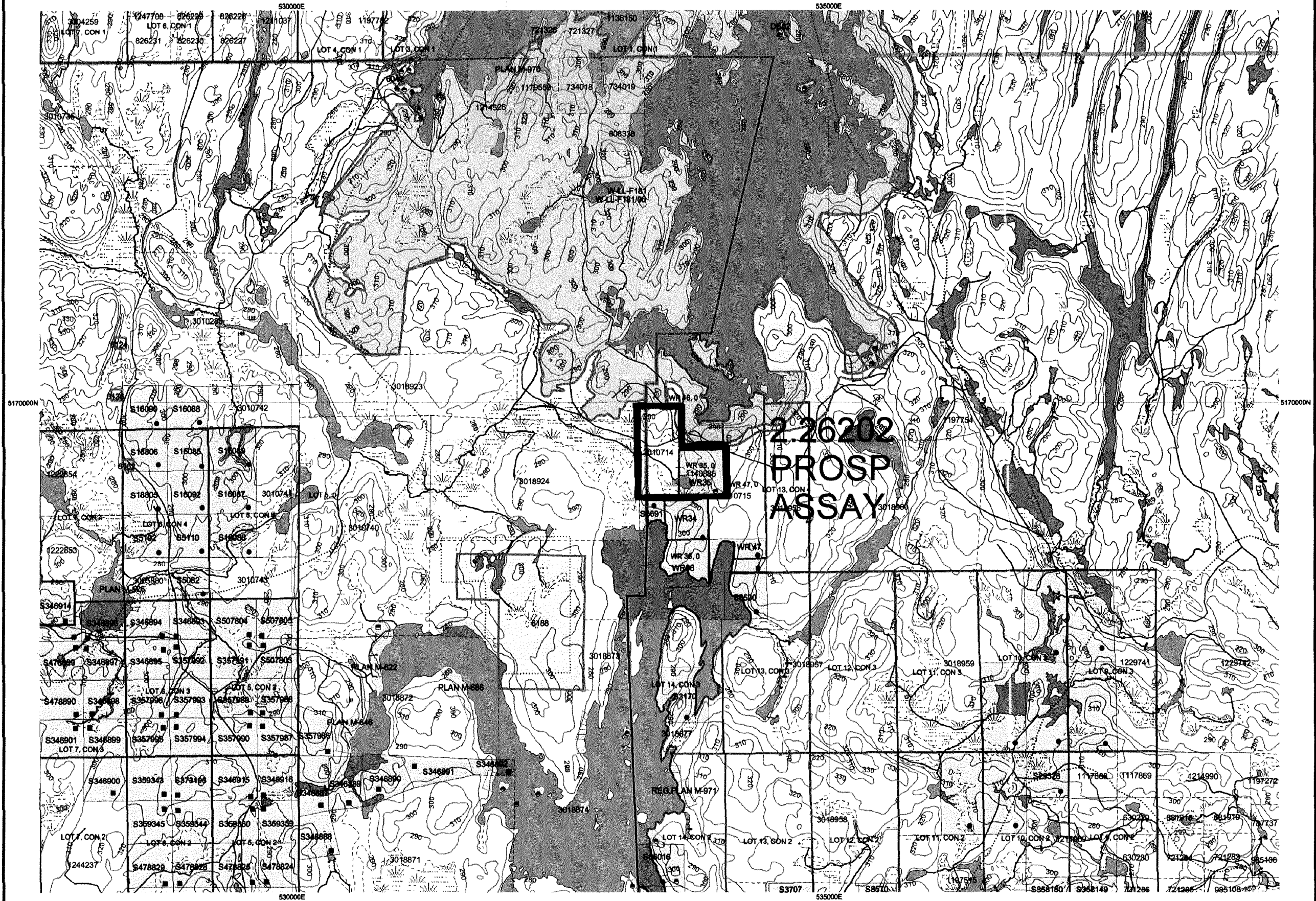

TOPOGRAPHIC

- Administrative Boundaries
- Township
- Concession Lot
- Provincial Park
- Indian Reserve
- Cliff, Pit & Pile
- Contour
- Mine Shafts
- Mine Headframe
- Railway
- Road
- Trail
- Natural Gas Pipeline
- Utilities
- Tower

Land Tenure

- Freehold Patent**
 - Surface And Mining Rights
 - Surface Rights Only
 - Mining Rights Only
- Leasehold Patent**
 - Surface And Mining Rights
 - Surface Rights Only
 - Mining Rights Only
- Licence of Occupation**
 - Uses Not Specified
 - Surface And Mining Rights
 - Surface Rights Only
 - Mining Rights Only
 - Land Use Permit
 - Order in Council (Not open for staking)
 - Water Power Lease Agreement
 - Mining Claim
 - Filed Only Mining Claims

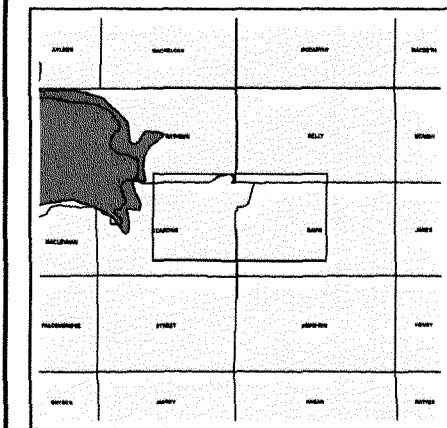

- LAND TENURE WITHDRAWALS**
- Areas Withdrawn from Disposition
- Mining Acts Withdrawal Types
 - Wsm Surface And Mining Rights Withdrawn
 - Wsb Surface Rights Only Withdrawn
 - Wsb Mining Rights Only Withdrawn
 - Wsm Order in Council Withdrawal Types
 - Wsb Surface And Mining Rights Withdrawn
 - Wsb Surface Rights Only Withdrawn
 - Wsm Mining Rights Only Withdrawn
- No
- IMPORTANT NOTICES**

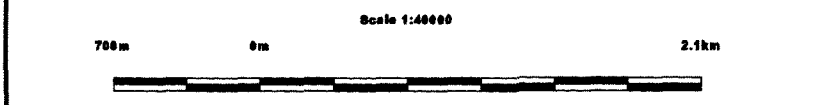

LAND TENURE WITHDRAWAL DESCRIPTIONS

Identifier	Type	Date	Description
6042	Wsm	Jan 1, 2001	CROWN RES. S.R.O.
6124	Wsm	Jan 1, 2001	ISLANDS IN WANAPITEI LAKE WITHDRAWN FROM STAKING UNDER SEC.38 (C)
6136	Wsm	Jan 1, 2001	FLOODING H.E.P.C. ELEVATION: 100.5 FT FILE: 43815 L.O. 6186
6182	Wsm	Jan 1, 2001	MINING RIGHTS OF THE LAND AND LAND UNDER THE WATERS OF WANAPITEI
6188	Wsm	Jan 1, 2001	AP13831
W-L-F175	Wsm	Nov 21, 2001	Mining and Surface rights withdrawn Section 35 of the Mining Act RSO 1990 Order
W-L-F181	Wsm	Aug 29, 2002	http://www.mndm.gov.on.ca/MNDMMINESLANDS/Integ/gtiks/2002ordr/w-l-f181.htm
W-L-F181/00	Wsm	Oct 4, 2000	Sec. 35 W-L-F181/00 ONT OCT.04/00 M+S
W-L-F174	Wsm	Jan 30, 2002	http://www.mndm.gov.on.ca/MNDMMINESLANDS/Integ/gtiks/2002ordr/w-l-f174.htm
W.8776	Wsm	Jan 1, 1980	SEC.38/80 W.8776 1711/176 MRO 7588 vol.8 Mining rights of the land and land

Those wishing to stake mining claims should consult with the Provincial Mining Recorders' Office of the Ministry of Northern Development and Mines for additional information on the status of the lands shown hereon. This map is not intended for navigational, survey, or land title determination purposes as the information shown on this map is compiled from various sources. Completeness and accuracy are not guaranteed. Additional information may also be obtained through the local Land Titles or Registry Office, or the Ministry of Natural Resources.

The information shown is derived from digital data available in the Provincial Mining Recorders' Office at the time of downloading from the Ministry of Northern Development and Mines web site.

General Information and Limitations
 Contact Information:
 Provincial Mining Recorders' Office
 Wildcat Green Miller Centre 933 Ramsey Lake Road
 Sudbury ON P3E 6B5
 Home Page: www.mndm.gov.on.ca/MNDMMINESLANDS/mlemppg.htm

Toll Free
 Tel: 1 (888) 415-8845 ext 5788
 Fax: 1 (877) 870-1444

Map Datum: NAD 83
 Projection: UTM (6 degree)
 Topographic Data Source: Land Information Ontario
 Mining Land Tenure Source: Provincial Mining Recorders' Office

This map may not show unregistered land tenure and interests in land including certain patents, leases, easements, right of ways, flooding rights, licences, or other forms of disposition of rights and interest from the Crown. Also certain land tenure and land uses that restrict or prohibit free entry to stake mining claims may not be illustrated.