

FALCONBRIDGE-0018-E1

Load: 16 mm

Diamond Drill Sampling Record

Dip at collar 45
 Direction N 70 E
 Length in Feet 419

Hole # 4
 Logged by E. M. Lewin

Copper Prince Mines Ltd. Falconbridge Twp.
 445' N 34W from # 2 Post of Claim # 51303

0.0- 3.8 Casing
 3.8- 4.1 Conglomerate specks of sulphide
 4.1- 4.2 White quartz - no sulphide
 4.2- 10.9 Conglomerate - specks of sulphide
 10.9- 13.1 Core Lost
 13.1- 20.0 Conglomerate - specks of sulphide
 20.0- 23.5 Conglomerate with quartz str.
 23.5- 23.8 Quartz str. slightly min.
 23.8- 24.0 Conglomerate
 24.0- 24.2 Quartz str. slightly min.
 24.2- 25.0 Conglomerate, no sulphide
 25.0- 25.7 Conglomerate lightly min. calco
 25.7- 26.0 Quartz str. well min.
 26.0- 30.0 Conglomerate & quartz str.
 30.0- 35.0 Conglomerate specks of sulphides.
 35.0- 50.0 Conglomerate & Quartz str.
 50.0- 55.0 " no sulphides
 55.0- 56.7 Core Lost
 56.7- 75.0 Conglomerate no sulphide
 75.0- 98.5 Conglomerate specks of sulphide
 98.5- 99.2 Quartz str. no sulphide
 99.2-101.3 Conglomerate, specks of sulphide
 101.3-102.0 Granite(dykelet or boulder)
 102.0-134.0 Conglomerate with quartz str. containing calco.
 134.0-134.1 Quartz str. very heavy calco.
 134.1-157.3 Conglomerate , specks of sulphide
 157.3-157.4 Quartz str. heavy chalco
 157.4-160.0 Conglomerate, lightly min. calco
 160.0-199.0 Conglomerate, no sulphide.
 199.0-199.1 Quartz str. heavy sulphide
 199.1-225.0 Conglomerate with quartz str. lightly min.
 225.0-235.5 Conglomerate, very lightly min.
 235.5-235.7 Quartz str. well min. calco.
 235.7-236.4 Conglomerate, lightly min.
 236.4-237.2 Heavy-solid calco.
 237.2-246.1 Conglomerate, specks of sulphide
 246.1-247.0 Conglomerate and quartz str. lightly min.
 247.0-249.0 " specks of sulphide
 249.0-249.7 Very heavy-solid pyrrhotite & pyrite
 249.7-253.7 Conglomerate lightly min.
 253.7-254.3 Quartz str. heavy calco
 254.3-320.8 Conglomerate specks of sulphide
 320.8-321.3 Heavy calcopyrite
 321.3-322.6 Conglomerate light-fairly min.
 322.6-419.0 " specks of sulphide

END OF HOLE

**DUPLICATE COPY
 POOR QUALITY ORIGINAL
 TO FOLLOW**

DIAMOND DRILL SAMPLING RECORD

Dip at Collar 45
 Direction N 60 E
 Length in feet 765

Hole # 5
 Logged by E. M. Lewin

Copper Prince Mines Ltd. Falconbridge Twp.
 535' N 55 W from # 2 Post of claim # 51303

0.0- 4.6 Casing
 4.6- 40.6 Conglomerate specks of sulphide
 40.6- 46.5 Quartzite no sulphide
 46.5-102.0 Conglomerate specks of sulphide
 102.0-106.5 White quartz
 106.5-136.5 Conglomerate, specks of sulphide
 136.5-138.8 Quartzite, lightly min.
 138.8-214.9 Conglomerate, specks of sulphide
 214.9-215.0 Quartz str. well min. calco & Pyrrhotite
 215.0-219.6 Conglomerate, specks of sulphide
 219.6-220.0 Quartz str. well min. Calco & pyrrhotite
 220.0-222.5 Conglomerate, specks of sulphide
 222.5-222.7 Quartz str. lightly min.
 222.7-264.0 Conglomerate, specks of sulphide
 264.0-264.4 Quartz str. well min.
 264.4-283.0 Conglomerate, specks of sulphide
 283.0-302.8 Quartz str & Conglomerate, fairly min.
 302.8-303.0 Quartz str. very well min.
 303.0-343.4 Conglomerate, very lightly min.
 343.4-347.0 " light to fair min.
 347.0-367.9 " specks of sulphide
 367.9-368.5 " lightly min. Calco & pyrrhotite
 368.5-374.6 " specks of sulphide
 374.6-375.0 Quartz str. well-heavy sulphide calco
 375.0-384.5 Conglomerate specks of sulphide
 384.5-384.8 White quartz str. no sulphide
 384.8-419.2 Conglomerate, specks of sulphide
 419.2-420.0 Quartz str. fair-well min. Calco pyrrhotite & pyrite.
 420.0-420.6 Conglomerate, lightly min.
 420.6-430.6 " specks of sulphide
 430.6-430.8 Quartz str. well min. Calco
 430.8-550.0 Conglomerate, specks of sulphide
 550.0-580.8 " very lightly min.
 580.8-580.85 Calcite seam filled with pyrrhotite
 580.85-679.8 Conglomerate specks of sulphide
 679.8-680.1 " well min.
 680.1-737.3 " specks of sulphide
 737.3-748.0 Quartzite no sulphide
 748.0-761.0 Conglomerate specks of sulphide
 761.0-765.0 Quartzite, no sulphide

END OF HOLE

**DUPLICATE COPY
 POOR QUALITY ORIGINAL
 TO FOLLOW**

Diamond Drill Sampling Record

Dip at Collar 35
Direction S 35 W
Length in feet 275'

Hole # **6a.**
Logged by **L.M. LEWIN.**

Copper Prince Mines Ltd. Falconbridge Tw.
435' N 17 E from # 2 post of claim # 51303.

0 - 4.0 Casing
4.0- 14.2 Conglomerate, specks of sulphide
at 1-2 seam of Calco. & Pyrrhotite.
14.2- 16.7 Conglomerate Specks of sulphide
16.7-16.9 quartzite no "
16.9-22.4 Conglomerate specks of "
22.4-22.45 Calco. & Pyrrhotite.
22.45-43.5 Conglomerate specks of "
43.5-48.0 " no "
48.0-52.0 " specks of "
52.0-77.0 " no "
77.0-82.5 " specks of "
82.5-88.0 " no "
88.0-96.5 " specks of "
96.5-107.0 " no "
107.0-137.0 " specks of "
137.0-185.0 " no "
185.0-261.0 " specks of "
261.0-275.0 quartzite no "

END OF HOLE.

L.M. Lewin

51303

S-51303
S-51549

S-56016

Diamond Drill Sampling Record.

Dip at collar 45
Direction S 4% W
Length in Feet 333

Hole # 1 A.
Logged by E.M.LEWIN.

Copper Prince Mines Ltd. Falconbridge Tw.

600' N 85 E from # 3 post of claim # 56016.

0 - 3.0	Casing		
3.0- 20.6	Gabbro		
20.6-21.3	Core lost		
21.3-23.7	Conglomerate,	specks of sulphide	
23.7- 28.9	quartz str.	fairly min.	
28.9-30.9	Conglomerate,	specks of sulphide	
30.9-31.7	Graywacke	" "	"
31.7-40.1	"	no	"
40.1-42.9	quartzite	"	"
42.9-44.6	Graywacke	specks of sulphide	
44.6-45.5	"	no	"
45.5-47.0	"	specks of sulphide	
47.0-47.7	Quartz	"	"
47.7-48.8	Graywacke	specks "	"
48.8-51.3	Conglomerate	slightly min.	
51.3-56.0	"	Specks of sulphide	
56.0-56.3	quartz str.	slightly min.	
56.3-57.1	Graywacke	no sulphide	
57.1-58.2	Conglomerate,	specks of "	
58.2-58.6	White quartz	no	"
58.6-70.7	Conglomerate	no	"
70.7-72.2	quartz, light-	fairly min.	
72.2-76.5	Conglomerate	no	"
76.5-77.5	Graywacke	no	"
77.5-81.6	Conglomerate	specks of "	
81.6-83.5	quartzite	no	"
83.5-86.0	Conglomerate	specks of "	
88.0-89.3	quartzite	" "	"
89.3-90.4	Conglomerate	" "	"
90.4-91.6	Graywacke	" "	"
91.6-100.4	Conglomerate (at 100.4 calcite seam with sulph.)		
100.4-112.4	Graywacke	no sulphide	
112.4-113.5	Gabbro	no	"
113.5-117.8	Conglomerate,	specks of "	
117.8-120.1	quartzite	" "	"
120.1-121.8	Conglomerate	" "	"
121.8-122.9	quartzite	" "	"
122.9-126.9	Conglomerate	" "	"
126.9-127.2	quartzite	" "	"
127.2-128.4	Conglomerate	" "	"
128.4-129.0	quartz	no	"
129.0-156.6	Conglomerate	specks "	"
156.6-158.6	Quartz well min. Calco., Pyrrhotite & Pyrite.		
158.6-169.8	Gabbro	no Sulphides	
169.8-170.5	Quartz	no	"
170.5-176.0	Conglomerate	specks of "	
176.0-212.8	Gabbro	no	"
212.8-213.8	Lost Core		
213.8-333.0	Gabbro	no	"

END OF HOLE.

E. M. Lewin

DIAMOND DRILL RECORD

Property - Copper Prince Mines Ltd.

Hole No. 1.

Sheet Number 1

Location: 200 feet West of No.1. post on Claim S-52306
100 feet South " " " " " "

Bearing: Due North
Dip: 45° at surface
38° at 300'
18° at 500'
8° at 700'

Started: June 19, 1956
Completed: July 5, 1956
Ultimate Depth: 701 feet
Proposed Depth: 700 feet

<u>Depth Feet</u>	<u>Formation</u>	<u>Sample No.</u>	<u>From</u>	<u>To</u>	<u>Width</u>	<u>Assay Values</u>	
						<u>% Cu</u>	<u>% Ni</u>
0-310	Fine grained quartzite grading to medium grained at 226 with interbedding of sections or layers of fine siliceous material. Shearings and laminations 245-310, minor mineralization, chiefly pyrite.						
310-438	Conglomerate coarse grained, occasional pebbles; interbedded with layers of fine grained quartzite. Extensive shearing 417-438.						
438-560	Finer grained quartzite, some sheared sections.						
560-701	Quartzite coarser grained, fairly massive, interbedded with occasional layers of fine grained quartzite. Some minor sheared sections and sparse mineralization.						
270-275	<u>Sample</u>	12	270	275	5.0	0.03	Trace
630-635	<u>Sample</u>	13	630	635	5.0	0.03	Trace

Core stored at collar of hole

Drilled by: W.C. Brochu

Signed: F.M. Smith

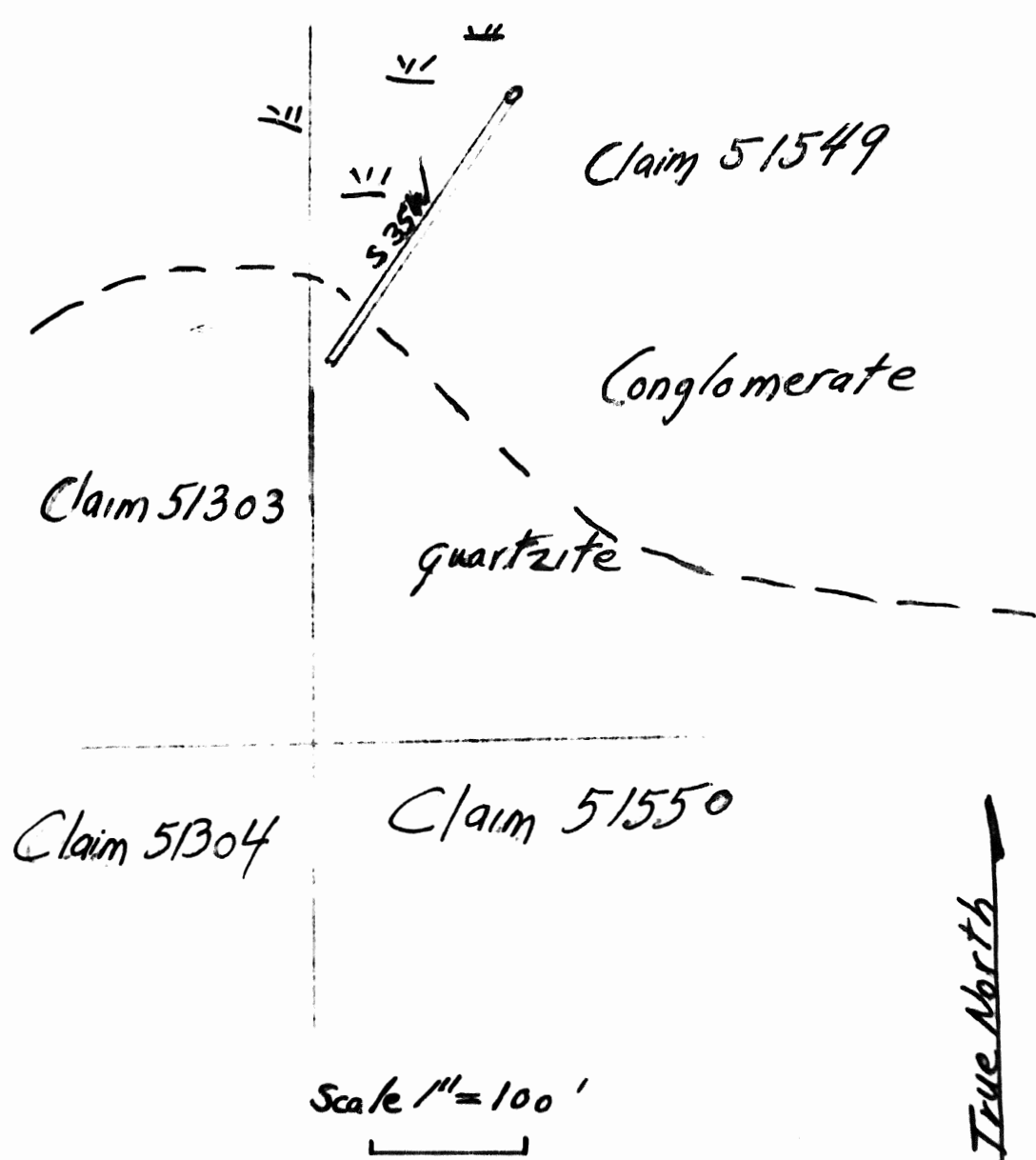

W. C. B. S. C.
Nov 22/51

Claim 56016

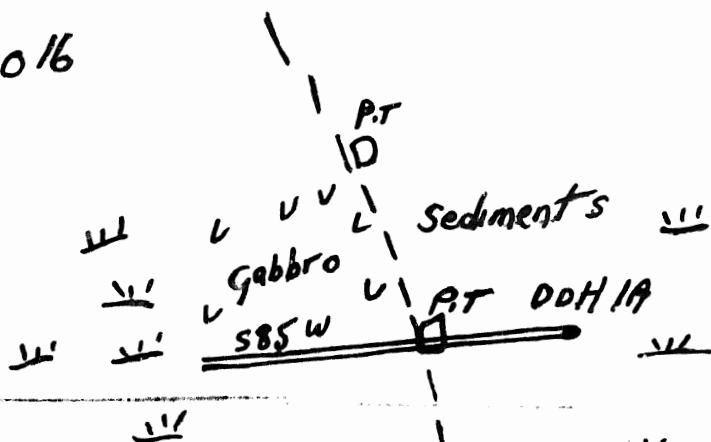

Claim 56018



Scale 1" = 100'

~~By~~ BSC
Nov 22/51

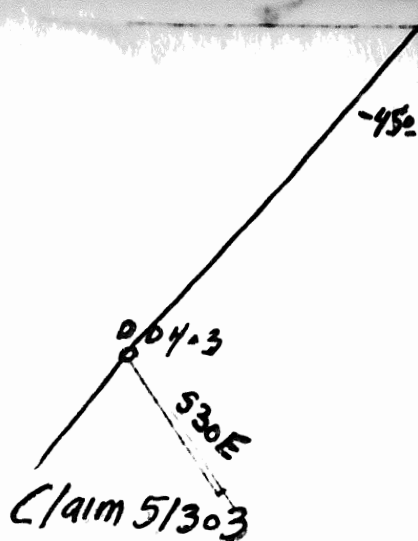

Claim 51549

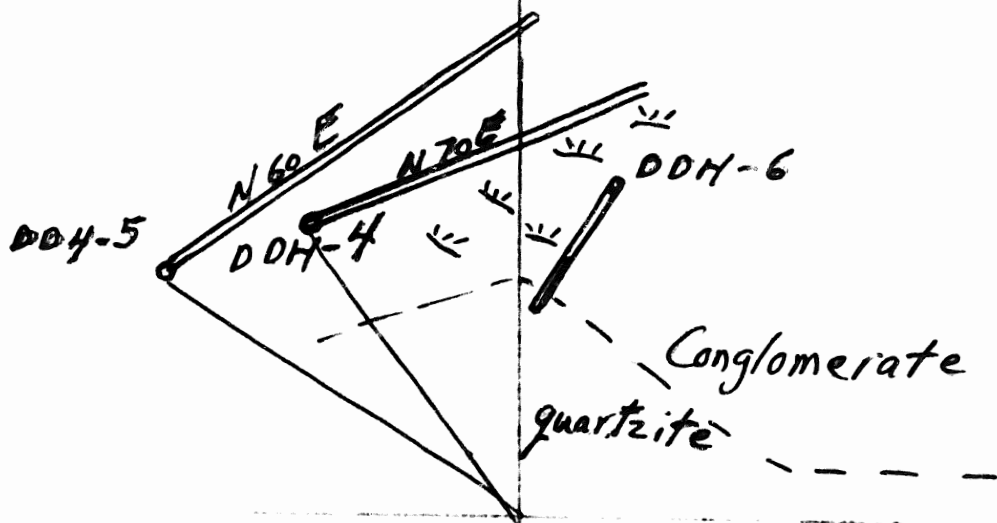

Claim 51304

Claim 51550

Scale 1" = 200'

True North ↑

Amherst BSC
NOV 22/51

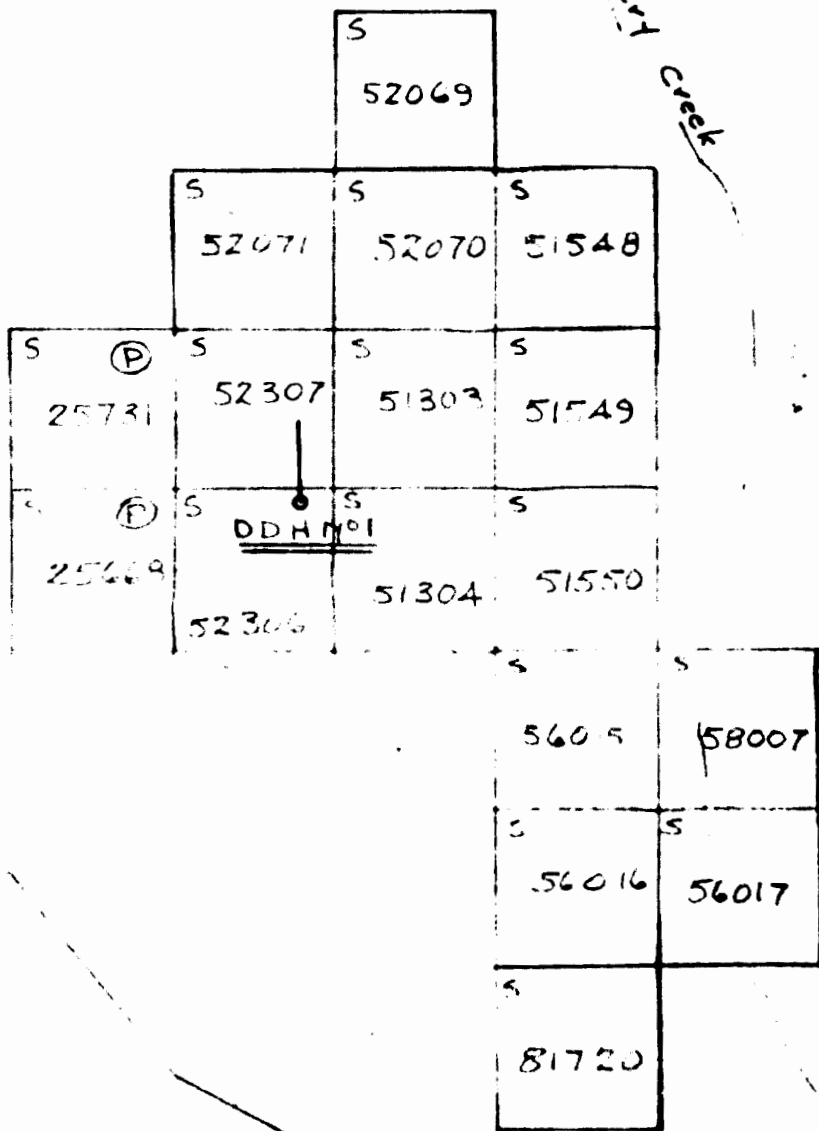

COPPER PRINCE MINES LTD.
 FALCONBRIDGE TR. R.
 CLAIM MAP SHOWING LOCATION
 OF DIAMOND DRILL HOLES
 SCALE - 1320 FT. = 1 IN JULY 1956

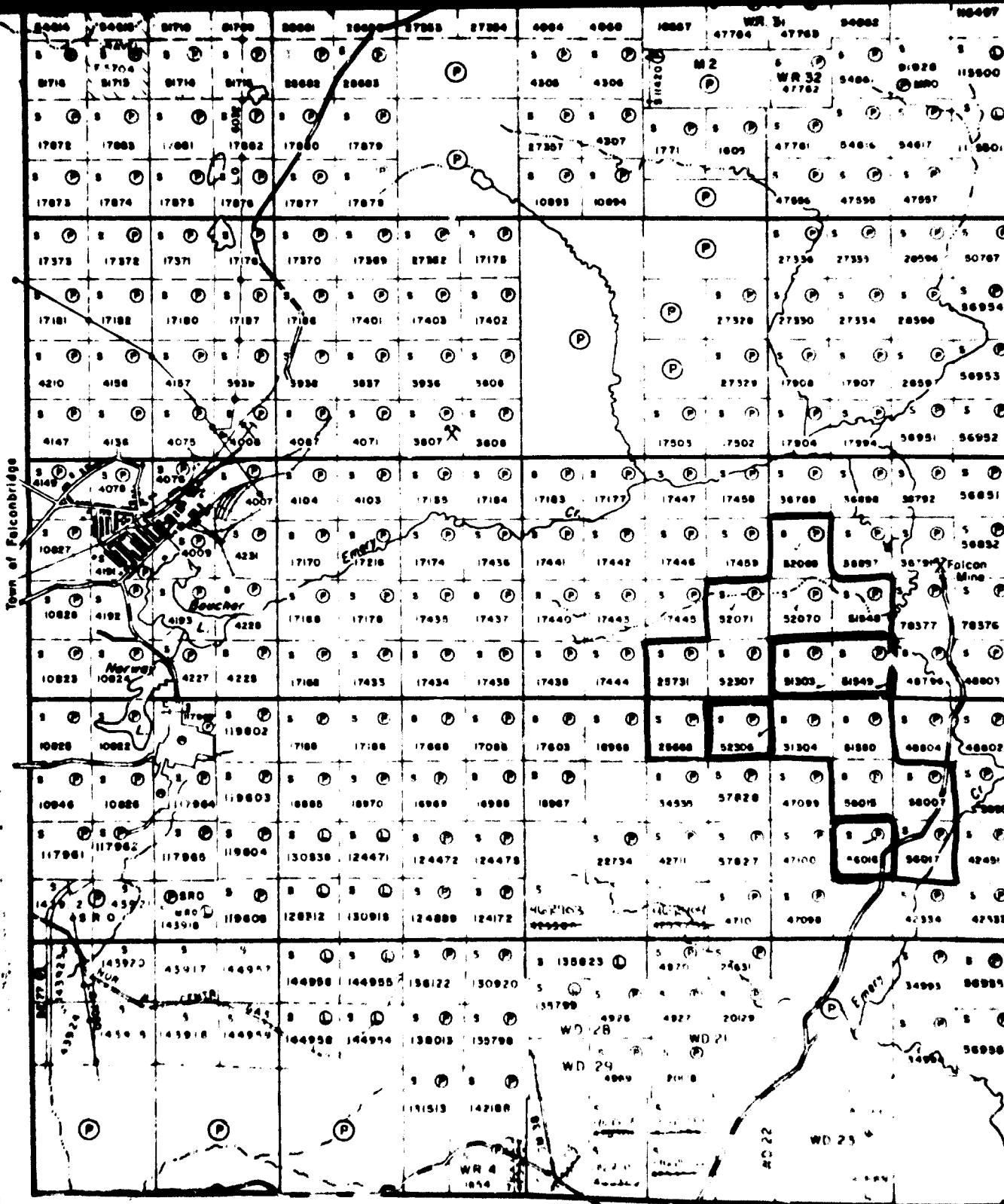

12 11 10 9 8 7 6 5

Falconbridge 19. 7. 11

Map of the Town of Falconbridge

Progressive Map No. 176