

Diamond Drilling

010

Township of NEELON

Report No: 10

Work performed by: Executive Explorations Limited

Claim No	Hole No	Footage	Date	Note
140362	67-1	300.0'	July/67	
	<u>Total: 1DH</u>	<u>300'</u>		

Notes:





41110SE0098 0011 NEELON

020

EXECUTIVE EXPLORATIONS LIMITED

DIAMOND DRILL REPORT

NEELON TOWNSHIP, ONTARIO

EXECUTIVE EXPLORATIONS LIMITED,

Suite 1512-101 Richmond St. West,

Toronto 1, Ontario.

Gentlemen:

This report covers results of a diamond drill program recently conducted over your property located in Neelon Township, Sudbury Area, Ontario.

PROPERTY, LOCATION, ACCESS:

The property consists of two groups of claims separated by a quarter mile's distance. The east group has seven contiguous claims numbered S.140343-349 incl., while the west group, containing nine contiguous claims, bears the following numbers:  
S.140350-353  
S.140358-362.

The claim groups are located in Neelon Township, Sudbury Mining Division, Ontario, and access is easily attained by a half mile walk from Highway 17 to the claim groups.

GEOLOGY:

The eastern group is underlain almost entirely by gabbro and diabase intrusives, with quartzite occupying the area

enclosed by claim S.140347, as indicated on O.D.M. Map No. 2017. Similar intrusives underlie the south and north portions of the western group, separated by a half mile wide band of quartzite trending east-west through the centre of the property.

HISTORY:

Prior to acquisition by Executive Explorations Ltd., no work had been done on the property according to assessment files.

Under present management, a combined magnetic-electro-magnetic survey was done on the claim groups in the winter and spring of 1967. A number of conductors were located and checked out with self potential coverage and a minimum amount of geo-chemical coverage. This work confirmed the presence of sulfide concentrations, and recommendations were made in my report dated May 29, 1967, for 900 ft. of diamond drilling.

DRILL HOLE DATA:

<u>HOLE NO.</u>	<u>LATITUDE</u>	<u>DEPARTURE</u>	<u>AZIMUTH</u>	<u>DIP</u>	<u>DEPTH FT.</u>
67-1	42+00N	23+00E	180°	-45°	300
67-2	9+25S	12+00E	180°	-45°	400
67-3	6+00N	30+00E	180°	-45°	200

DRILL RESULTS:

Drill hole No. 67-1 investigated a large and strong

electromagnetic conductor located in the northeast portion of claim No. S.140362. Gabbro material was intersected in all the core, and disseminated sulfide material, source of conductor, carried very low amounts of copper, no nickel.

Drill hole No. 67-2, investigating a strong conductor located in the southern portions of claims S. 140345-346, intersected gabbro all the way. Considerable sulfide mineralization was encountered and is source of conductor. The sulfide material, up to 20% concentration, consisted essentially of pyrrhotite with lesser amounts of chalcopyrite. The pyrrhotite does not carry nickel values, and the chalcopyrite carried low copper values.

67-3 hole probed a short and relatively weak conductor in claims 140347-348 and encountered essentially siliceous grey quartzite. Variable amounts of sulfide material, from a few feet to 20 ft. in core length, were intersected with concentrations up to about 15%. The pyrrhotite does not carry nickel.

CONCLUSIONS:

Three drill holes for a total of 900 ft. investigated electromagnetic conductors and self potential anomalies on coincident zones over your Neelon Township property.

Zones were explained by sulfide concentrations, and copper with associated silver values, both sub marginal, were returned in assays. The pyrrhotite encountered does not carry nickel.

RECOMMENDATIONS:

The property appears to have been well tested by Executive Explorations Ltd. Prior to due date, a re-appraisal of work done on the property will be made in light of results of exploration programs on properties in the area.

Respectfully submitted,

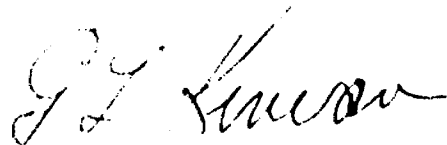

G.L. Kirwan, B.Sc.  
Consulting Geologist

GLK/lk

Toronto, Ontario  
Sept. 7, 1967

CERTIFICATE

I, Gerald L. Kirwan of the city of Toronto in the Province of Ontario, certify as follows:

1. THAT I am a geologist with offices at 160 Bay St., Toronto, and 130 Kingslake Rd., Willowdale, Ontario.
2. THAT I am a graduate of Carleton University, B.Sc., 1957, and that I have practised my profession continuously since graduation.
3. THAT I am a Fellow of the Geological Association of Canada.
4. THAT I have no interest, present or expectant, in the properties or securities of Executive Explorations Ltd.
5. THAT the subject report has been prepared by myself and is based upon a study of pertinent data found in government reports and files, and upon supervision of all programs conducted under present management.

Dated at Toronto, Ontario, this 7th day of September, 1967



G.L. Kirwan





FOR ADDITIONAL

INFORMATION

SEE MAPS:

NEELON - 00 11

# 1

# 2

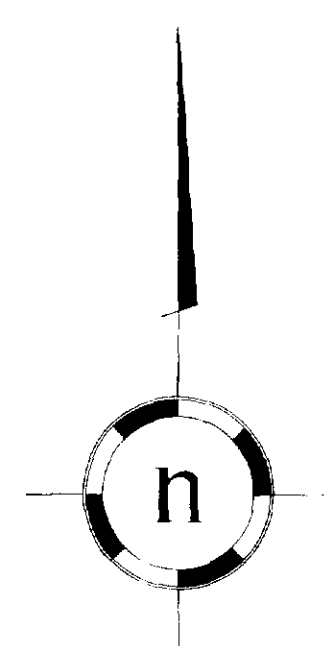
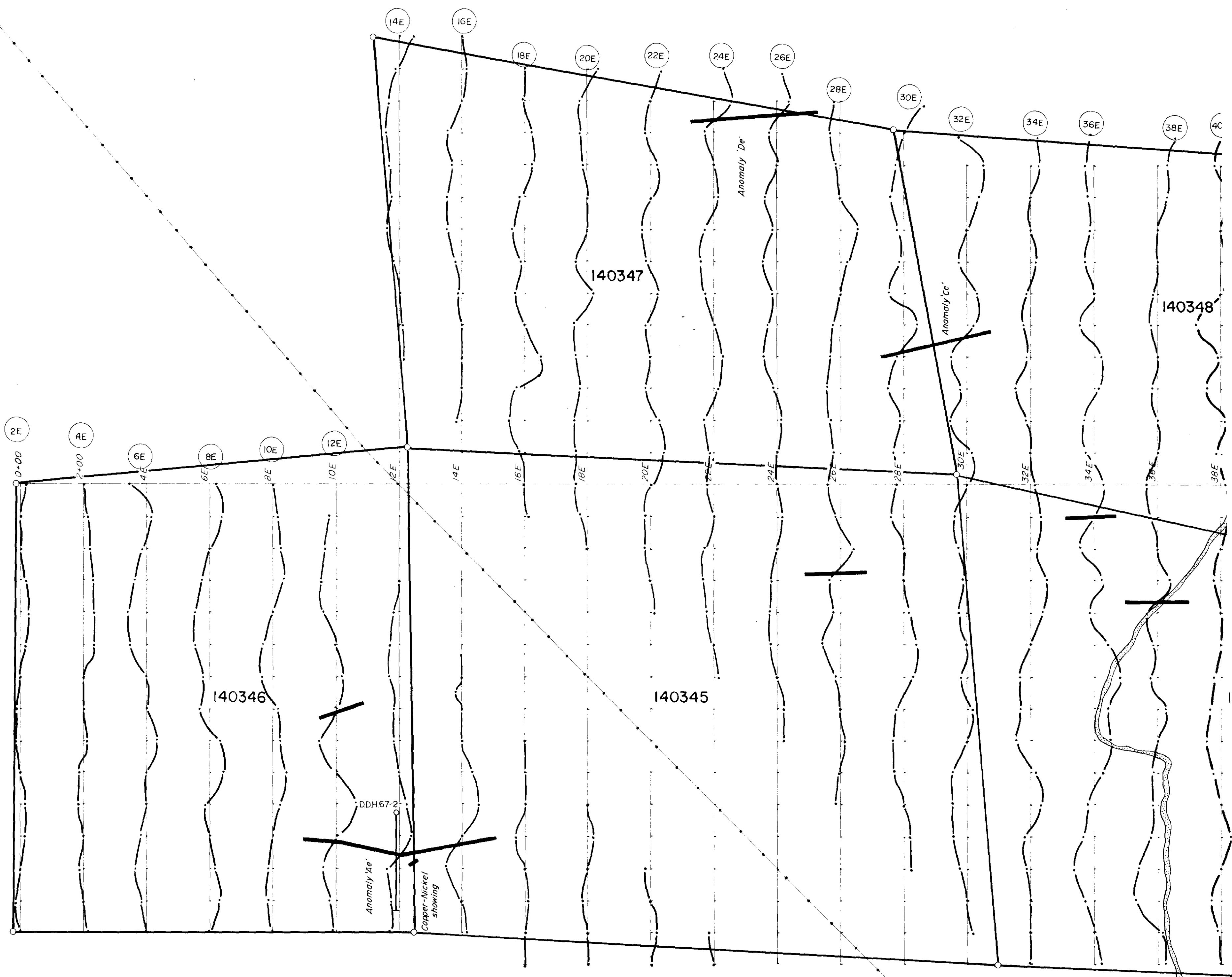
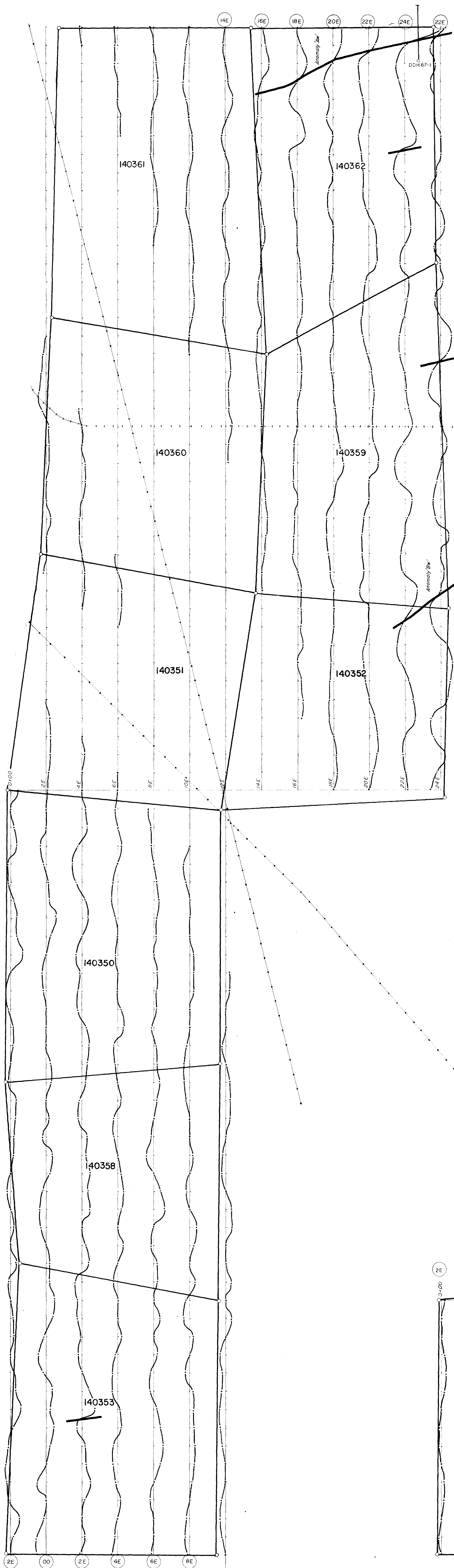

**SYMBOLS**

- Measurement station along picket line
- Dip angle profile N.B. North dips are plotted West of the line  
South " " " East " " "
- Scale of Profile 1" = 20' of tilt
- Indicated Conductor Axis
- INSTRUMENT:** Sharpe SE 200
- Transmitter Line
- Claim post
- Proposed DDH

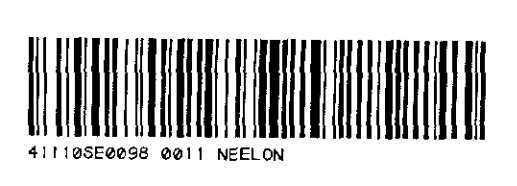

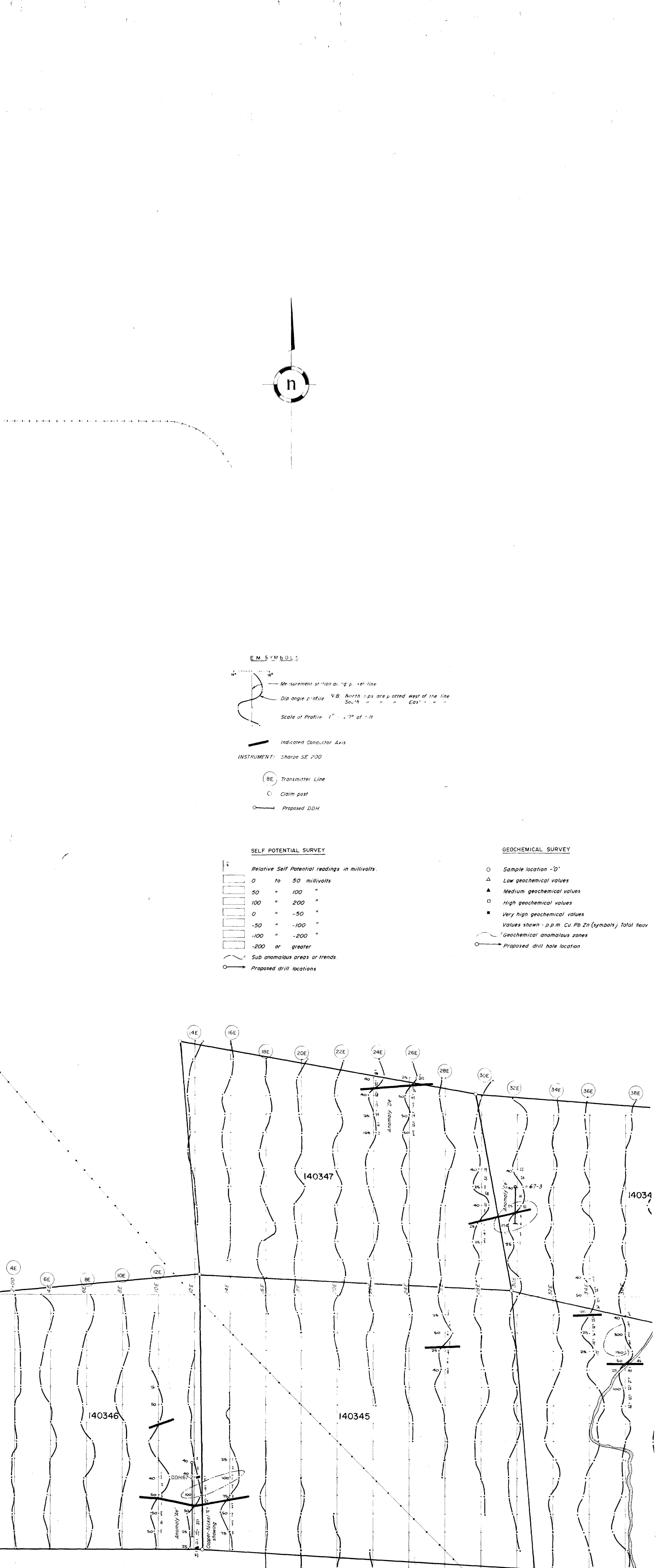
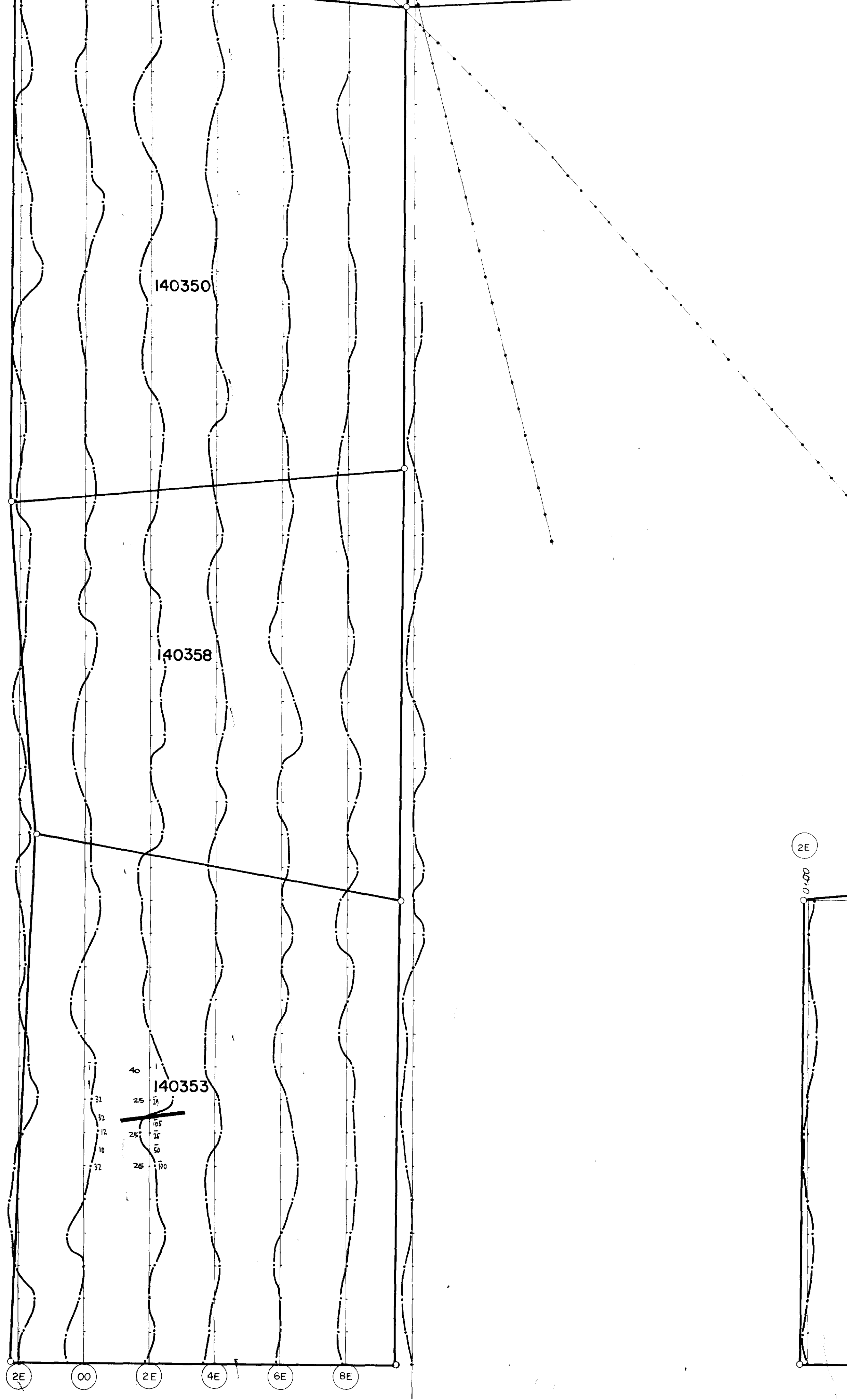
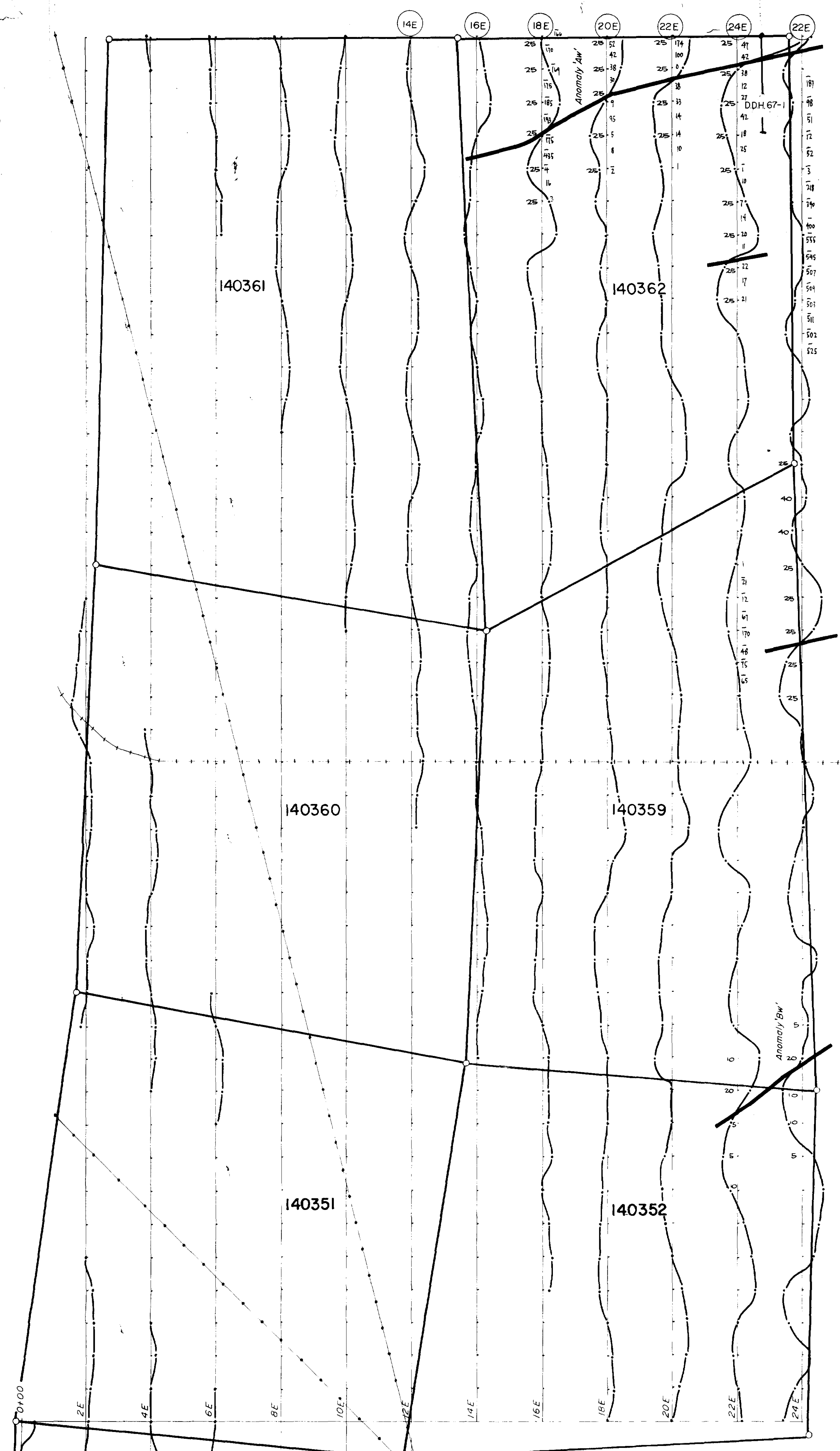

**E.M.S. V.M.B.D.L.**

Measurement station along p. -et line  
 Dip angle profile. N.B. North tips are plotted west of the line  
 South " " " " East " " " "

Scale of Profile 1" = 10' of "ft

Indicated Conductor Axis

INSTRUMENT: Sharpe SE 700

(BE) Transmitter Line  
 (C) Claim post  
 (O) Proposed DDH

**SELF POTENTIAL SURVEY**

Relative Self Potential readings in millivolts.

0 to 50 millivolts
50 " 100 "
100 " 200 "
0 " -50 "
-50 " -100 "
-100 " -200 "
-200 or greater

Sub anomalous areas or trends  
 Proposed drill locations

**GEOCHEMICAL SURVEY**

- Sample location - "0"
- △ Low geochemical values
- ▲ Medium geochemical values
- High geochemical values
- ▣ Very high geochemical values

Values shown - p.p.m. Cu Pb Zn (symbols) Total Heavy  
 Geochemical anomalous zones  
 Proposed drill hole location

17/11/88  
10/11/87

EXECUTIVE EXPLORATION LIMITED  
NEELON TWP PROPERTY, DISTRICT OF SUDBURY, SUDBURY MD.

# ELECTROMAGNETIC SURVEY

ADVANCE GEOLOGY & GEOPHYSICS LTD.  
TORONTO CANADA

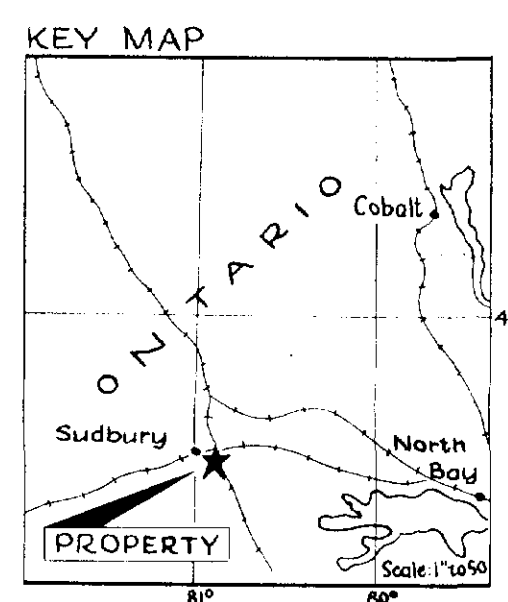
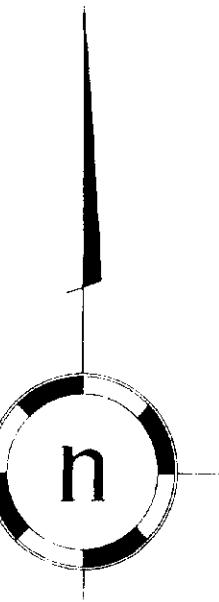

### SYMBOLS

- Measurement station along picket line
- Dip angle profile N.B. North dips are plotted West of the line  
South " " " East " " "
- Scale of Profile 1" = 20' of tilt
- Indicated Conductor Axis
- Sharpe SE 200
- Transmitter Line
- Claim post
- Proposed DDH

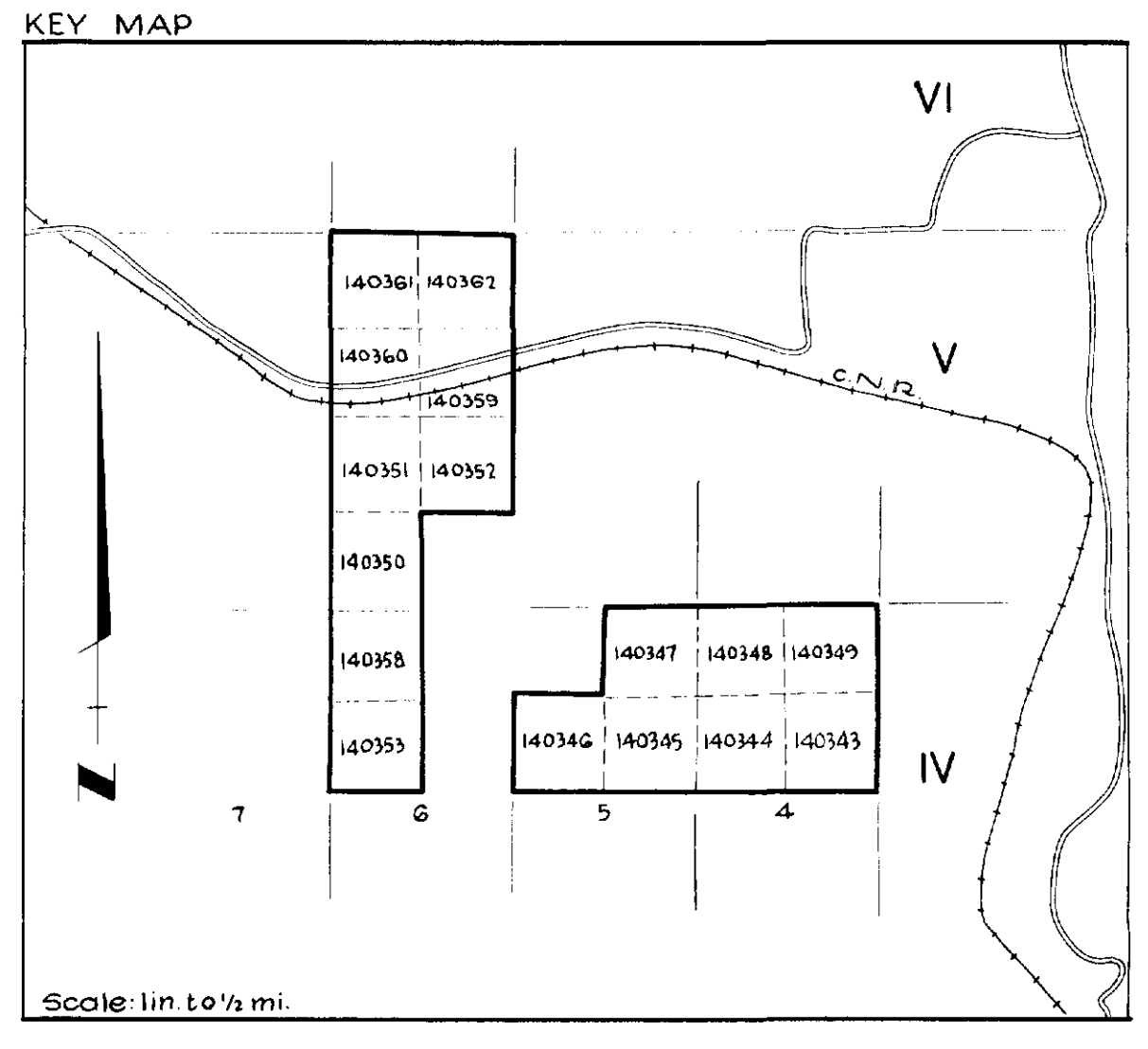

NEELON-0011, #2



G.L.H.  
Sept/69

EXECUTIVE EXPLORATION LIMITED  
NEELON TWP. PROPERTY, DISTRICT OF SUDBURY, SUDBURY MD.

# ELECTROMAGNETIC SURVEY

ADVANCE GEOLOGY & GEOPHYSICS LTD.  
TORONTO CANADA

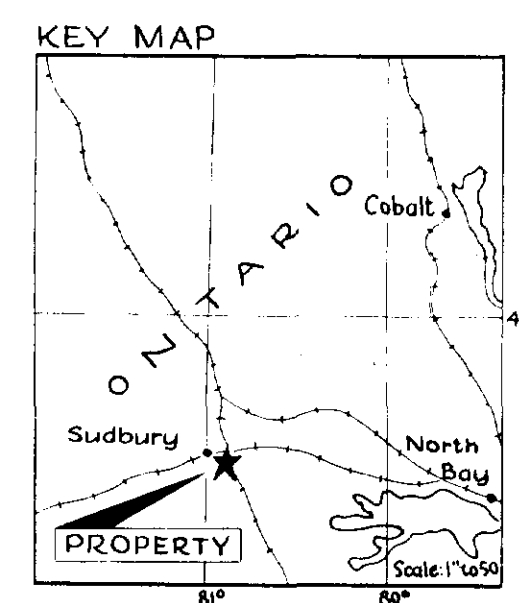
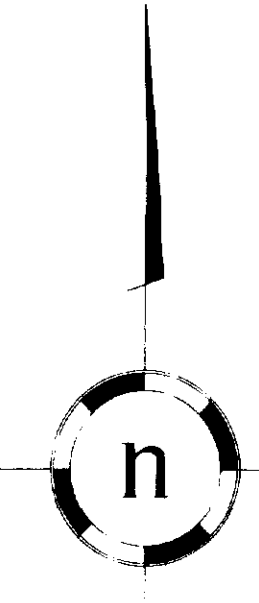
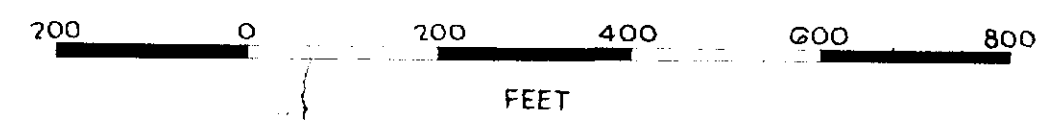

### E.M. SYMBOLS

- Measurement station along profile line
- Dip angle profile. N.B. North dips are plotted west of the line, South dips are plotted east of the line.
- Scale of Profile: 1" = 100' of profile
- Indicated Conductor Axis
- UMENT: Sharpe SE 200**
- Transmitter Line
- Claim post
- Proposed DDH

### SELF POTENTIAL SURVEY

- Relative Self Potential readings in millivolts:
- 0 to 50 millivolts
  - 50 " 100 "
  - 100 " 200 "
  - 0 " -50 "
  - 50 " -100 "
  - 100 " -200 "
  - 200 or greater
- Sub anomalous areas or trends
- Proposed drill locations

### GEOCHEMICAL SURVEY

- Sample location - 'D'
  - Low geochemical values
  - Medium geochemical values
  - High geochemical values
  - Very high geochemical values
- Values shown - p.p.m. Cu Pb Zn (symbols) Total Heavy Metals in p.p.m. shown to left of Line
- Geochemical anomalous zones
  - Proposed drill hole location

### KEY MAP

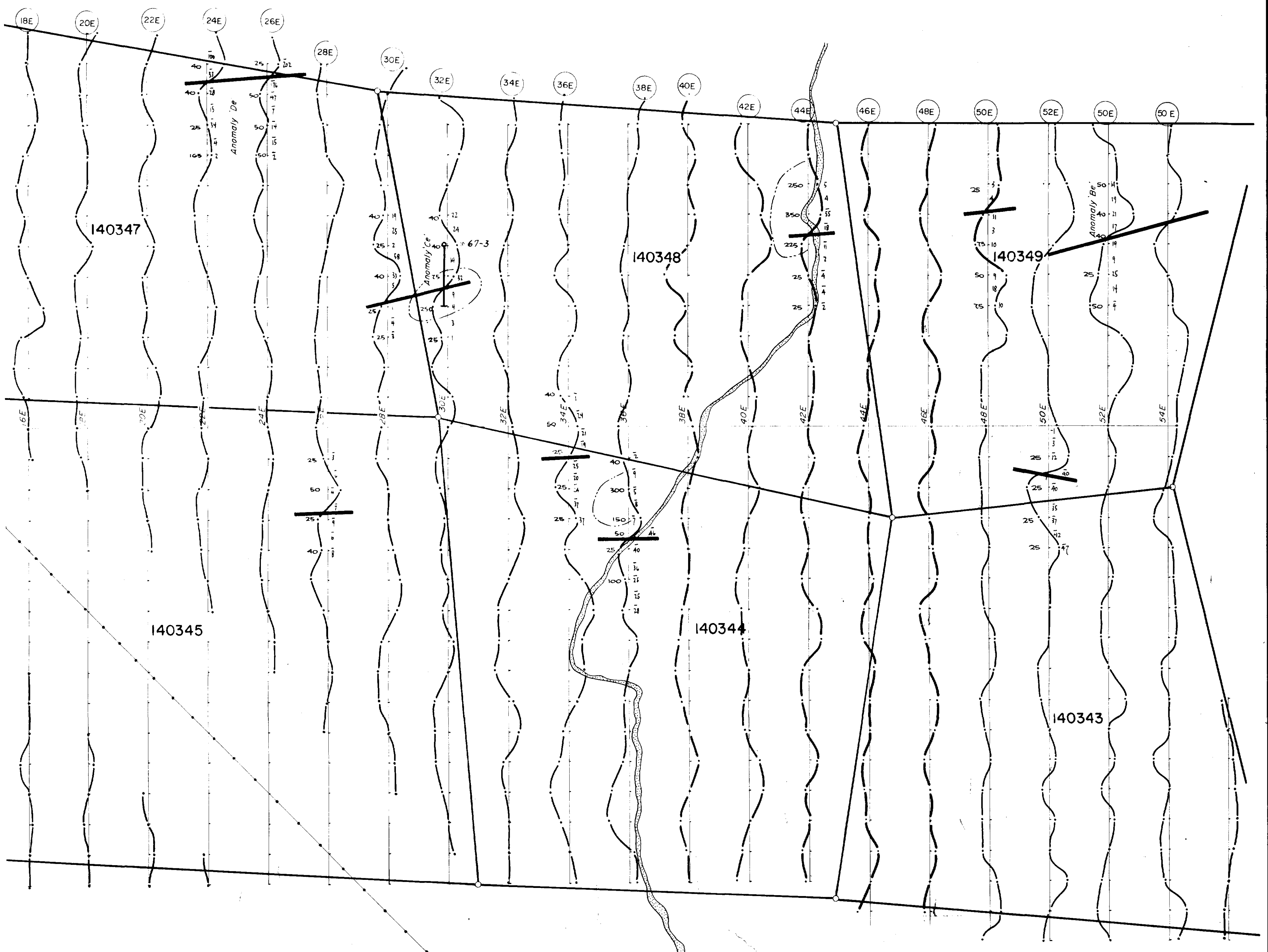
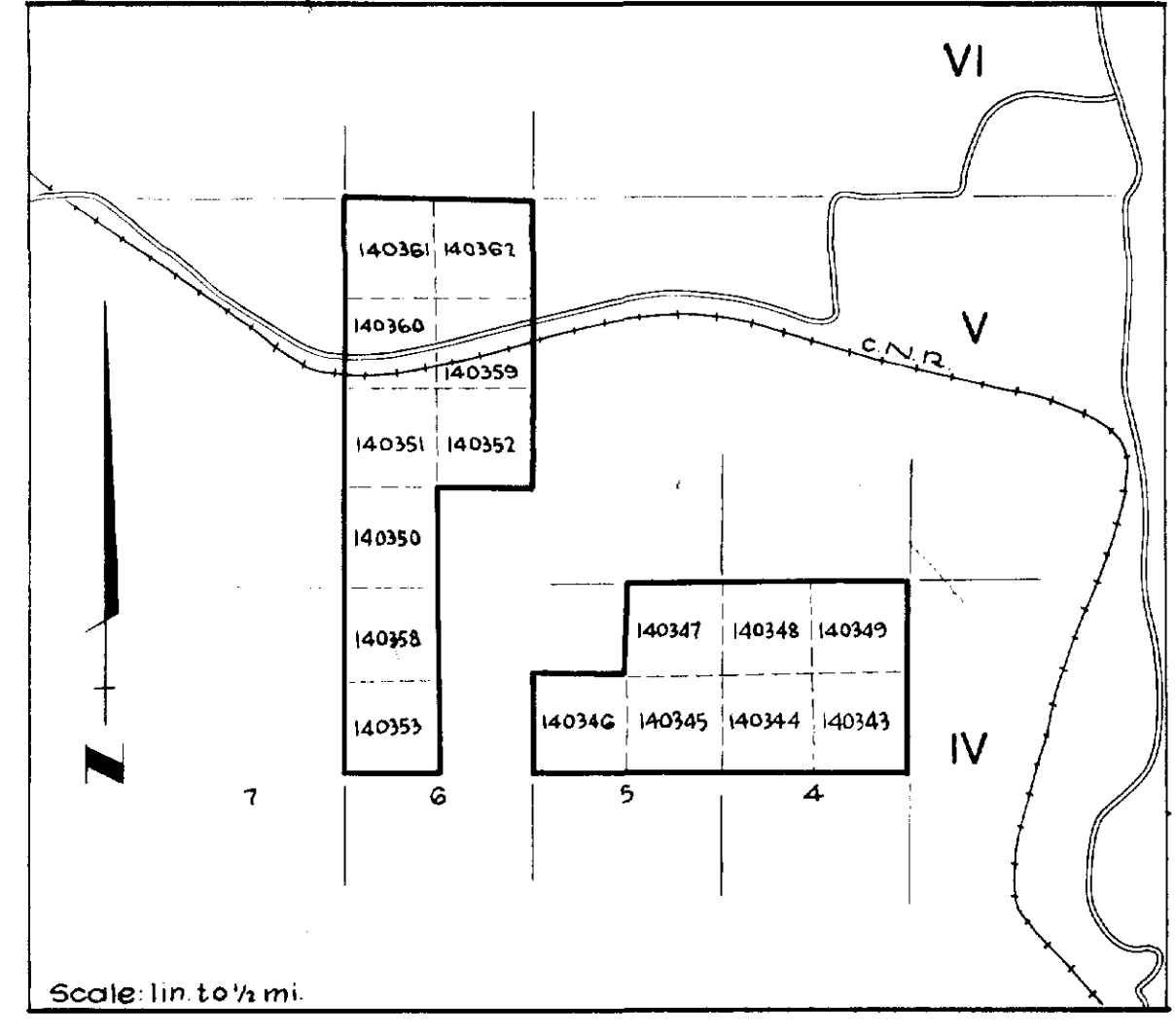

NEELON-0011, #1