

Lumsden (Lumsden), Morgan, Fairbank, 7 all



41111NE9542000100

LUMSDEN
12 LUMSDEN

PROSPECTUS



of

SUDBURY NORTHRIM EXPLORATION

COMPANY LIMITED

NO PERSONAL LIABILITY



SUDBURY NORTHRIM EXPLORATION COMPANY LIMITED

(No Personal Liability)

PROSPECTUS

filed with the Ontario Securities Commission under the provisions of Part VII of The Securities Act (Ontario)

- (a) SUDBURY NORTHRIM EXPLORATION COMPANY LIMITED (No Personal & Liability), 11 King Street West, Toronto, Ontario, was incorporated under the provisions of The Companies Act (Ontario)
- (b) and Part XI thereof by Letters Patent dated February 19th, 1952.

(c) The Officers and Directors are:

John Clifford Rogers, Consulting Mining Geologist	President and Director	248 Joicey Blvd., Toronto, Ontario.
George Alexander Hunter, Office Manager	Secretary and Director	781 O'Connor Dr., Toronto, Ontario.
Fred William Chubb, Prospector	Director	Rural Route No. 1, Whitby, Ontario.
William Edward Beatty, Florist	Director	Brampton, Ontario.
Wilbur Ralph Salter, Q.C.	Director	496 Russell Hill Road, Toronto, Ontario.

The Promoter is Bruce Holdings Limited, 11 King Street West, Toronto, Ontario.

- (d) GUNN, ROBERTS and CO., Chartered Accountants, 36 Toronto Street, Toronto, are the Company's Auditors, and MONTREAL TRUST COMPANY, 15 King Street West, Toronto, is the Company's Registrar and Transfer Agent.
- (f) The authorized capital of the Company is \$5,000,000.00 divided into 5,000,000 shares of the par value of \$1.00 per share, of which 900,005 shares, all fully paid up and non-assessable, have been issued and allotted.
- (g) The Company has not created or issued any bonds or debentures nor does it propose to do so.

- (h) Certificates representing 810,000 shares of the Company are held by Montreal Trust Company, Toronto, in pool or escrow, subject to release on consent of the Ontario Securities Commission and the Company, and subject also to transfer, hypothecation, assignment or other alienation only with the written consent of the Ontario Securities Commission.
- (i) 5 shares have been sold for cash to date at \$1.00 per share. No commissions were paid on the sale of the said shares.
- (j) No securities other than shares have been sold for cash to date.
- (k) No shares have been issued or are to be issued or cash paid or to be paid to any Promoter unless Bruce Holdings Limited, one of the Vendors named herein, is deemed to be the Promoter, in which case, full particulars are hereinafter set forth.
- (l) (1) The Company is the registered owner, free of encumbrance, of 231 unpatented mining Claims situate in the Sudbury Basin Area of the Province of Ontario. The Claims comprise several large blocks with a total area of approximately 9,240 acres, and are all registered in the Sudbury Mining Division as follows:

Mining Claims Numbered S-60172 to S-60208 inclusive, 27 ✓
 Mining Claims Numbered S-60341 to S-60349 inclusive, 9 ✓
 Mining Claims Numbered S-60489 to S-60504 inclusive, 16 ✓
 all in Hamner Township; 52

Mining Claims Numbered S-60209 to S-60216 inclusive, 8 ✓
 Mining Claims Numbered S-60430 to S-60438 inclusive, 9 ✓
 Mining Claims Numbered S-60505 to S-60564 inclusive, 60 ✓
 Mining Claims Numbered S-60587 to S-60591 inclusive, 5 ✓
 all in Lueder Township; 82

Mining Claims Numbered S-60487-8 in Capreol Township; ✓

Mining Claims Numbered S-60565 to S-60586 inclusive, ✓
 Mining Claims Numbered S-60592 to S-60600 inclusive, ✓
 Mining Claims Numbered S-60609, ✓
 all in Morgan Township;

Mining Claims Numbered S-60601 to S-60608 inclusive, ✓
 all in Dowling Township;

Mining Claims Numbered S-59915, ✓
 Mining Claims Numbered S-59931-2, ✓
 Mining Claims Numbered S-60136 to S-60152 inclusive, ✓
 Mining Claims Numbered S-60170-1, ✓
 all in Fairbank Township;

Mining Claims Numbered S-59916 to S-59921 inclusive,
Mining Claims Numbered S-60153 to S-60169 inclusive,
all in Trill Township.

(ii) The following are the names and addresses of all Vendors of property purchased by the Company:

(a) Ernest J. Rivers, 24 Wineva Avenue, Toronto, Ontario, was the Vendor of 45 of the above Claims, the consideration being \$10,000.00 and 100,000 fully paid and non-assessable shares of the capital stock of the Company, of which 10,000 shares are held in pool or escrow;

(b) Fred W. Chubb, Rural Route No. 1, Whitby, Ontario, was the Vendor of 66 of the above Claims, the consideration being 150,000 fully paid and non-assessable shares of the capital stock of the Company, all held in pool or escrow;

(c) Bruce Holdings Limited, 11 King Street West, Toronto, Ontario, was the Vendor of 120 of the above Claims, the consideration being 650,000 fully paid and non-assessable shares of the capital stock of the Company, all held in pool or escrow.

(iii) No person or company has received or is to receive from any Vendor a greater than a five percentum (5%) interest in the shares or other consideration received or to be received by the above-named Vendors.

(m) Particulars relating to all properties:

(i) The Company's Claims are located in the central portion of the Sudbury Basin Area which is well serviced by secondary roads, off the main Sudbury-Cartier Highway which crosses the central part of the Basin. The main line of the C. P. R. also crosses the central part of the Basin. The Claims are situate approximately 25 miles north-east and north-west from Sudbury.

(ii) No underground exploration or development work has been carried on by the Company, and there is no underground plant or equipment.

(iii) Some surface exploration is said to have been done by previous owners and for further particulars reference is made to the Report of J. M. Powelson, Registered Professional Engineer (Ontario), dated May 5th, 1952 which accompanies and forms a part of this Prospectus. There is no surface plant or equipment.

(iv) The known history of the property is set forth in the said Report of J. M. Powelson, Registered Professional Engineer (Ontario) dated May 5th, 1952 referred to in Sub-paragraph (m) (iii).

(v) No work has been done or improvements made to the property by the present management.

(n) By an Agreement dated the 24th day of April, 1952 made between the Company and Bruce Holdings Limited, 11 King Street West, Toronto, as Underwriter, the Underwriter for and on its own behalf agreed to purchase 2,500,000 shares of the Company at 25¢ per share, the purchase price of \$625,000.00 to be payable thirty (30) days after the acceptance for filing by the Ontario Securities Commission of the requisite documents under Section 38 of The Securities Act and the obtaining by the Company of a receipt therefor, the date of acceptance being the 27th day of June, 1952. The following are the only persons having more than a five per centum (5%) interest in the Underwriter: Marshal Stearns, Mrs. Helen Stearns, George A. Richardson, Mrs. Justine Richardson, H. C. Shields, Vincent J. McLelland and P. H. Douglas. There are no sub-underwriting agreements. In the event of default, an amended Statement will be filed within twenty (20) days from the date of such default if primary distribution of these shares is still under way.

(o) All monies paid into the Treasury of the Company through the sale of shares as set out above, will be expended by the Company in such surface development work and underground mining operations on the Company's property as shall be recommended by its Engineers and Geologists, payment of \$10,000.00 for properties acquired as set out in item (1) (ii) (a), the acquisition by staking or otherwise of additional mining Claims, the purchase of necessary equipment and generally for corporate purposes.

	<u>Administrative</u>	<u>Development</u>
Preliminary Expenses -	\$ 3,242.50	\$ 582.00
Estimated Future Expenditures - (during first year)	\$ 1,500.00	\$100,000.00

(q) There is no indebtedness to be created or assumed other than as shown on the Balance Sheet dated as of May 15th, 1952 attached hereto.

(r) (1) John Clifford Rogers has been a Consulting Mining Geologist, self-employed, carrying on his practice in the City of Toronto for over three years;
George Alexander Hunter has been Office Manager of T. A. Richardson & Co., Toronto for over three years;
Fred William Chubb has been a Prospector (self-employed) for over three years;
William Edward Beatty has been a Florist and an Executive of Dale Estate Limited, Brampton, Ontario, for over three years;
Wilbur Ralph Salter has been a partner in the firm of Salter, Reilly & Jamieson, Toronto for over three years.

(ii) No Officer or Director has had any interest either direct or indirect in any property acquired or to be acquired by the Company, except as hereinbefore disclosed in Paragraph (1) (ii). During the last financial year no Officer or Director of the Company has received any remuneration as such. No remuneration has been paid or will be paid during the current financial year to the Officers or Directors as such. Secretarial services for the current financial year are estimated at \$1,200.00.

- (s) No dividends have been paid by the Company during the last five years.
- (t) The Underwriter and Vendors are in a position to elect or cause to be elected a majority of the Directors of the Company.
- (u) There is no arrangement for the sale of Vendor shares.
- (v) The foregoing constitutes full, true and plain disclosure of all material facts in respect of the offering of securities referred to above as required by Section 38 of The Securities Act (Ontario), and there is no further material information applicable other than in the Financial Statements or Reports where required.

DATED at Toronto this 18th day of June, 1952.

DIRECTORS AND OFFICERS

"WILLIAM E. BEATTY"

"JOHN C. ROGERS"

"F. W. CHUBB"

"W. R. SAITER"

"G. A. HUNTER"

- (w) To the best of our knowledge, information and belief, the foregoing constitutes full, true and plain disclosure of all material facts in respect of the offering of securities referred to above as required by Section 38 of The Securities Act (Ontario), and there is no further material information applicable other than in the Financial Statements or Reports where required. In respect of matters which are not within our knowledge, we have relied upon the accuracy and adequacy of the foregoing.

DATED at Toronto this 18th day of June, 1952.

BRUCE HOLDINGS LIMITED

By:

"T. A. RICHARDSON"

President

"G. A. HUNTER"

Secretary

UNDERWRITER

Corporate
Seal

SUDBURY NORTHRIM EXPLORATION COMPANY LIMITED

(Engineering Report)

May 5, 1952.

SUMMARY AND CONCLUSION

The SUDBURY NORTHRIM EXPLORATION COMPANY LIMITED holds 231 Claims (approximately 9,240 acres) in various blocks along the west end and the north sides of the central part of the Sudbury Basin area. These groups of Claims are located to cover the slate-tuff contact in a similar manner to those properties on the south contact which contain lead-zinc-copper ore adjacent to this same contact. Similar structural conditions also appear to be present near this contact on both the north and the south sides of the central basin area. Mineralization like that on the south side is reported from mineral showings on the north side. Consequently, on the basis of similar rocks, similar structural conditions in part, and seemingly similar mineralization, a program is desirable for the exploration and evaluation of the extensive holdings of the Sudbury Northrim Exploration Co. Ltd.

The exploration program suggested would be one of geological mapping on such a scale, along with some prospecting, as to give information on where detailed work might be done to advantage. Such detailed work would take form of trenching, drilling where indicated by other results, and the usual sampling of showings known or which might be located.

PROPERTY AND OWNERSHIP

Sudbury Northrim Exploration Company Limited is the registered owner of 231 unpatented mining Claims situated in the Sudbury Mining Division, Ontario. The Claims held are listed below:

	<u>No. of Claims</u>
S-60172 to S-60216	45
S-60341 to S-60349 inclusive	9
S-60430 to S-60438 "	9
S-60487 to S-60609 "	123
S-59915 to S-59921 "	7
S-59931-32	2
S-60136 to S-60171 "	36
	<u>231</u>

LOCATION AND ACCESS

The Claims held by Sudbury Northrim Exploration Company Limited are located in the central portion of the Sudbury Basin area in Hammer, Lumaden, Morgan, Fairbank and Trill Townships. The largest block of contiguous Claims stretches across Lumaden Twp. and part of Hammer Twp. Other blocks are in Hammer Twp. to the north and east of the large block. Some ground is located in Fairbank and Trill Twps., west of Ontario Pyrites Ltd. (Sudbury Basin) holdings. These blocks cover a portion of the slate-tuff contact on the western part of the basin.

LOCATION AND ACCESS (cont'd)

In general the central Sudbury basin area is well serviced by secondary roads, off the main Sudbury-Cartier highway which crosses the central part of the basin, as does the main line of the C. P. R. Sudbury is the commercial centre for the district, and adequate power is available, should it be required.

GEOLOGY

The Sudbury Northrim Exploration Company Limited holdings were acquired, in part, on the basis of their location in relation to the Onaping Formation (agglomerate and tuffs) - Orwatin Formation (slate) contact. In Creighton and Fairbanks Townships, on the south side of the Sudbury Basin, lead-zinc-copper ore was found near this contact under certain structural conditions, on what is now Ontario Pyrites Ltd. ground. The details of reasons are not fully determined as yet as to why the localization, near this contact, of ore found to date. This contact is variably folded and crenulated as a result of regional and local stresses related to thrust faulting from the south-west in the basin area.

There are carbonate rich beds or bands in many places near the slate-tuff contact, and widespread introduced mineralization of a quartz-carbonate type with some local accompanying pyrite, pyrrhotite, chalcopyrite, sphalerite, and galena. A number of these showings require re-evaluation and further exploration. It is not unreasonable to expect that similar ore conditions to those on the south rim area, as at Ontario Pyrites Ltd., may be encountered under similar geological and mineralized conditions on the north and west sides of the basin.

EXPLORATION

Exploration has been done in the past on showings on some of the more accessible claims and where concerned with good exposures. Changed base metal economics related to prices and metallurgy indicate a new evaluation is merited. More recent information on the geology of the area, and specifically with possible reasons for localization of lead-zinc-copper sulphides values, also suggests renewed exploration is required.

The program of exploration recommended would be:

- (a) Preparation of adequate geological and other maps for direction of later work.
- (b) Evaluation of known showings.
- (c) Prospecting, trenching, and sampling as indicated by stages (a) and (b).
- (d) Diamond drilling as required.

EXPLORATION (Cont'd)

References:

- Ontario Department of Mines Reports on area.
- G. S. C. reports and maps on area.
- Personal observation relative to work in area in past years.

(signed) J. M. Powelson

May 5, 1952.

J. M. Powelson, P. Eng.

C E R T I F I C A T E

With reference to the report, dated May 5, 1952 and made by me on the property of SUDBURY NORTHERN EXPLORATION COMPANY LIMITED (No Personal Liability), I certify:

- (1) That my address is Haileybury, Ontario.
- (2) That I am a mining geologist by profession, a Registered Professional Engineer (Mining Branch) Province of Ontario, a graduate of the University of Minnesota, and have had eighteen years experience in Mining and Geological work.
- (3) That I have not, and have never had, any interest directly or indirectly in any of the properties or securities of the Company upon behalf of which my said report is to be filed with the Ontario Securities Commission, and I do not expect to receive any such interest.
- (4) That the accompanying report is based on examination of available records on past exploration of ground and relative references from Ontario Department of Mines Reports.

DATED at Toronto this 5th day of May, 1952.

(signed) J. M. Powelson

J. M. Powelson, P. Eng.

SUDBURY NORTHRIM EXPLORATION COMPANY LIMITED
(No Personal Liability)

Incorporated under the Ontario Companies Act

BALANCE SHEET

May 15, 1952

ASSETS

CURRENT ASSETS:

Cash in bank	\$	5.00
Mining Claims located in the Sudbury Mining Division, Ontario, acquired for 900,000 shares of the capital stock of the Company issued at 5 cents per share and \$10,000 cash	\$55,000.00	
Cost of registration of Claims	<u>486.40</u>	55,486.40

DEFERRED CHARGES:

Exploration and administrative expenditures deferred	\$ 939.50	
Incorporation and organization expenses	<u>2,885.00</u>	<u>3,824.50</u>
		<u>\$59,315.90</u>

LIABILITIES

CURRENT LIABILITIES:

Accounts payable and accrued liabilities		\$14,310.90
--	--	-------------

CAPITAL STOCK:

Authorized: 5,000,000 shares of \$1.00 each		
Issued: 5 shares for cash	5.00	
900,000 shares for mining claims	\$900,000.00	
Less discount	<u>855,000.00</u>	<u>45,000.00</u>
<u>900,005</u> shares		45,005.00

Note: The Company has entered into an agreement to sell 2,500,000 shares at 25¢ each payable 30 days after acceptance for filing by the Ontario Securities Commission of the requisite documents.

\$59,315.90

Approved:

"G. A. HUNTER"
Director

"W. R. SALTER"
Director

AUDITORS' REPORT

We have examined the balance sheet of Sudbury Northrim Exploration Company Limited (No Personal Liability) as at May 15, 1952 and have obtained all the information and explanations we have required. Our examination included a general review of the accounting procedures and such tests of accounting records and other supporting evidence for the period from incorporation on February 19, 1952 to May 15, 1952 as we considered necessary in the circumstances.

In our opinion the above balance sheet is properly drawn up so as to exhibit a true and correct view of the state of the affairs of the Company as at May 15, 1952, according to the best of our information and the explanations given to us and as shown by the books of the Company.

(signed) Gunn, Roberts and Co.

Toronto,
June 3, 1952.

CHARTERED ACCOUNTANTS.

SUDBURY NORTHRIM EXPLORATION COMPANY LIMITED

(No Personal Liability)

STATEMENT OF EXPLORATION AND ADMINISTRATIVE EXPENDITURES DEFERRED

For the period from incorporation on February 19, 1952 to May 15, 1952

Exploration expenditures		
Engineer's fees and expenses	\$507.00	
Mining license	<u>75.00</u>	\$582.00
Administrative expenditures		
Share certificate expenses		<u>357.50</u>
Balance, May 15, 1952		<u>\$939.50</u>

A
REVIEW
of the
HOLDINGS and INTERESTS
of the
SUDBURY NORTHRIM EXPLORATION COMPANY LIMITED

JOHNSTON & POWELSON
GEOLOGISTS

JOHNSTON & POWELSON
GEOLOGISTS

December 22, 1952.

Sudbury Northern Exploration Co. Ltd.,
11 King Street West,
Toronto, Ont.

Dear Sirs:

Enclosed herewith a summary of the work to date
on the holdings of Sudbury Northern Exploration Co. Ltd.

Of the 426 claim holdings in the area 283 are to
be abandoned immediately, 87 are to be held until the due
date, and on the remaining 56 further work is warranted
as outlined in the attached report.

This further work entails -

8 1/2 man days work and 5,000 feet of diamond drilling
which should cost an estimated \$35,000.00.

Respectfully submitted

A. W. Johnston

For H. Powelson
JOHNSTON & POWELSON.

AWJ/JBS

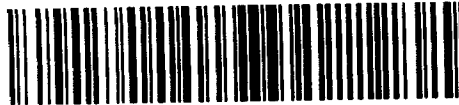

41111NE9542 LUMSDEN 12 LUMSDEN

020

A

REVIEW

of the

HOLDINGS and INTERESTS

of the

SUDBURY NORTHRIM EXPLORATION COMPANY LIMITED

December 17th, 1952.

R. Massey Williams

CONTENTS

Purpose

Holdings

Recommendations

Explanation Terms Used

Work Required

Cost of Work Required

Reasons for Work Recommended



020C

Table No. 1
Summary of Groups with Recommendations.

Table No. 2
Cross Reference - Claims to Groups to Townships.

Table No. 3
References in Weekly Reports.

Appendix

Details on the twenty-three (23) groups, the three (3) options, and the eight (8) examinations.

Maps

Property Holdings

Frontpiece

Chelmsford Sheet 871A
Falconbridge Sheet 872A

In pocket
In pocket

Maps already supplied -

1. Geological Plan - 1" equals $\frac{1}{2}$ mile.
Holdings in the Townships of Capreol, Ham-
mer, Lumsden and Morgan. November 1952.
2. Geological Plan - 1" equals 400 ft.
Trill Township July 19, 1952.
3. Sketch showing Assessment Requirements
Townships of Hammer and Capreol.
Scale 1" equals $\frac{1}{2}$ mile November 26, 1952.
4. Sketch showing E. M. Anomalies
Morgan and Lumsden Townships.
Scale 1" to 1 mile November 1952.

THE SUDBURY NORTHRIM EXPLORATION COMPANY LIMITED

PURPOSE

The purpose of this report is to review the findings to date on the Holdings of the Company, and to prepare a schedule of work for the new year.

HOLDINGS

The Northrim Company Holdings are mainly in the Sudbury Basin Area Proper, but the program of work included the examination of some eight (8) groups removed from the Basin.

They consist of,-

Direct Holdings

23 groups or some 338 claims or 13,520 acres.

Options

3 groups or some 10 claims or 401 acres.

Examinations

8 groups or some 78 claims or 3,120 acres.

RECOMMENDATIONS

From a review of the work done to date, the following recommendations can be made,-

1. None of the eight groups examined can be recommended.
2. The three optioned groups show little merit.
3. For the Company held claims, the following is recommended,-

<u>Total Claims</u>	<u>Work</u>	<u>Restake</u>	<u>Hold Until Due Date</u>	<u>Abandon or Drop</u>
338	56	26	61	195

The details for the above are given on Table No. 1 and Cross Referenced on Table No. 2 in terms of claim numbers.

Reference is also given in Table No. 3 to comments made under the Weekly Reports.

EXPLANATION

of terms used in Table No. 1.

1. **Abandon or Drop.**
These claims are of little interest, and can be dropped immediately.
2. **Hold until Due Date.**
Abstracts should be obtained to keep the record straight, in case work in other groups improves the overall picture.
3. **Restake.**
Claim holdings have some merit, if findings made by others on adjacent groups.
4. **Work Required.**
Prospecting or examination incomplete.

WORK REQUIRED

Further work is required in the following groups,-

Group # 3	Fairbanks	19	Claims	D & D 1000 to 1500 ft.
Group 7	Morgan	12	"	42 man days
Group 13	Lumsden	11	"	42 man days
Group 14	Hammer	12	"	D & D 1500 to 2000 ft.
Group 22	Capreol	2	"	D & D 1500 ft.

COST OF WORK REQUIRED

84 man days	@ \$15.00 per day	\$ 1,260.00
5,000 ft. D. D.	@ 6.00 " ft.	30,000.00
Contingencies Nearest	10%	3,740.00
Total of		\$ 35,000.00

REASONS FOR WORK RECOMMENDED

There is attached, as an appendix to this report, a review of the Holdings, group by group, with comments.

- 2 -

It is relevant to note here that the contact of the Onaping "Tuffs" and the Onwatin "Slates" on its southern boundary, under certain conditions, has shown itself favorable to the deposition of Lead and Zinc mineralisation.

To date, however, no values have been found at the contact on the north side of the Basin, possibly due to topographic features.

Some exploratory diamond drilling, however, is justified on groups that straddle this contact, in areas that show some change in strike (buckle) or where the contact is cut by a known shearing.

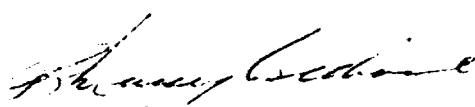
R. Massey Williams

for Johnston & Rowelson

Sudbury, Ontario,

December 17th, 1952.

TABLES 1 2 & 3

TABLE NO. 1

SUMMARY OF HOLDINGS

<u>Group No.</u>	<u>Township</u>	<u>No. of Claims</u>		<u>Recommendations</u>
1	Trill	23		Restake
2	Fairbank	3		Restake
3	Fairbank	19	x	Work required
4	Dowling	8		Abandon & drop all 8
5	Dowling	17		Abandon & drop all 17
6	Dowling	6		Abandon & drop all 6
7	Morgan	12	x	Work required
8	Morgan	4		Abandon & drop all 4
9	Morgan	4		Hold until due date
10	Morgan	8		Drop 2 - Hold 6 until due date
11	Morgan	28		Drop 12 - Hold 16 until due date
12	Lumsden	98		Drop 90 - Hold 8 until due date
13	Lumsden	11	x	Work required
14	Hammer	12	x	Work required
15	Hammer	8		Hold 8 until due date
16	Hammer	20		Abandon & drop all 20
17	Hammer	6		Abandon & drop all 6
18	Hammer	8		Drop 4 - Hold 4 until due date
19	Hammer	23		Drop 16 - Hold 7 until due date
20	Hammer	2		Abandon & drop all 2
21	Capreol	8		Hold 8 until due date
22	Capreol	2	x	Work required
23	Capreol	8		Abandon & drop all 8
		Sub-total	338	or 13,520 acres

OPTIONS

01	Hammer	4		Drop all options
02	Hammer	2		Drop all options
03	Morgan	4		Drop all options
		Sub-total	10	or 401 acres

EXAMINATIONS

1	Frechette	15		Not recommended
2	Balfour	4		Not recommended
3	MacMurchy	28		Not recommended
4	Street	14		Not recommended
5	Township 149	4		Not recommended
6	Hudson/Lundy/Henwood 8			Not recommended
7	Norman	2		Not recommended
8	Dowling	6		Not recommended
		Sub-total	78	or 3,120 acres

TABLE
SHOWING RELATION
OF
CLAIMS TO GROUPS TO TOWNSHIPS

<u>Claim Nos.</u> <u>Company Holdings</u>		<u>Group No.</u>	<u>Township</u>
56388 - 56390	3	6	Dowling
56391 - 56395	5	5	Dowling
56396 - 56398	3	6	Dowling

Refer letter J.C.R. - Nov. 12/52.

57738 - 57745	8	15	Hammer
---------------	---	----	--------

Look for new numbers after Dec. 16/52.

59915	1	2	Fairbank
59916 - 59921	6	1	Trill
59931 - 59932	2	2	Fairbank

60136 - 60152	17	3	Fairbank
60153 - 60169	17	1	Trill
60170 - 60171	2	3	Fairbank
60172 - 60187	16	19	Hammer
60188 - 60189	2	18	Hammer
60190 - 60199	10	16	Hammer
60200 - 60204	5	16	Hammer
60205 - 60208	4	16	Hammer
60209 - 60216	8	12	Lumsden

TABLE NO. 2 (Cont'd.)

<u>Claim Nos.</u> <u>Company Holdings</u>		<u>Group No.</u>	<u>Township</u>
60341 - 60342	2	16	Hanmer /
60343 - 60348	6	17	Hanmer /
60349	1	16	Hanmer /
60430 - 60438	9	12	Lumsden
60487 - 60488	2	22	Capreol
60489 - 60500	12	14	Hanmer /
60501 - 60504	4	18	Hanmer /
60505 - 60564	60	12	Lumsden /
60565 - 60582	18	11	Morgan /
60583 - 60586	4	10	Morgan /
60587 - 60591	5	12	Lumsden /
60592 - 60596	5	11	Morgan
60597 - 60600	4	10	Morgan
60601 - 60608	8	4	Dowling /
60609	1	11	Morgan
60799	1	19	Hanmer /
60800 - 60802	3	19	Hanmer /
61024	1	19	Hanmer /
61147	1	20	Hanmer /
61148 - 61151	4	21	Capreol
61152	1	20	Hanmer /
61153 - 61166	14	12	Lumsden /
61167	1	7	Morgan
61168 - 61171	4	8	Morgan
61172 - 61180	9	7	Morgan
61181 - 61184	4	21	Capreol
61185 - 61186	2	19	Hanmer /

TABLE NO. 3 (Cont'd.)

<u>Claim Nos.</u> <u>Company Holdings</u>		<u>Group No.</u>	<u>Township</u>
61187	1	12	Lumsden ✓
61188 - 61189	2	7	Morgan ✓
61190	1	12	Lumsden ✓
61191 - 61199	9	5	Dowling ✓
61200 - 61202	3	5	Dowling ✓

61816 - 61819	4	11	Morgan ✓
---------------	---	----	----------

61891 - 61898	8	23	Capreol
---------------	---	----	---------

62953 - 62956	4	9	Morgan
---------------	---	---	--------

Newly staked B.C.F. Ref. W.R. 27/9/52.

63598 - 63599	2	13	Lumsden ✓
63600 - 63608	9	13	Lumsden ✓

Newly staked B.C.F. Ref. W.R. 7/12/52.

OPTIONED CLAIMS

Parcels 407 & 927	4	01	Hanmer
-------------------	---	----	--------

Parcels 2263	2	02	Hanmer
--------------	---	----	--------

Parcels 5497	4	03	Morgan
--------------	---	----	--------

EXAMINATIONS

TABLE
SHOWING WEEKLY REPORT REFERENCES
TO TOWNSHIP HOLDINGS

<u>Township</u>	<u>Weekly Report References</u>
Capreol	31/8/52, 14/9/52, 11/10/52
Dowling	23/8/52, 31/8/52, 14/9/52
Fairbank	26/7/52, 2/8/52, 16/11/52
Hammer	26/7/52, 2/8/52, 23/8/52, 31/8/52, 11/10/52, 18/10/52, 25/10/52, 1/11/52, 9/11/52, 16/11/52
Lumsden	31/8/52, 6/10/52, 4/10/52, 16/11/52
Morgan	9/8/52, 23/8/52, 27/9/52
Trill	28/6/52, 5/7/52, 12/7/52, 19/7/52
Hudson/Lundy/Henwood	25/10/52
Street	4/10/52, 11/10/52
Twp. 149	18/10/52
Shining Tree	20/9/52
Fréchette	26/7/52 x Separate report
Balfour	9/8/52
MacMurchy	23-25/9/52
Norman	16/11/52
Dowling	22/11/52 x Separate report

APPENDIX

THE SUDBURY NORTHRIM EXPLORATION COMPANY LIMITED

COMMENTS ON THE

1. PROPERTY HOLDINGS
2. OPTIONED GROUPS
3. EXAMINATIONS

THE SUDBURY NORTHRIM EXPLORATION COMPANY LIMITED

PROPERTY HOLDINGS

GROUP NO. 1 - TRILL TOWNSHIP

23 CLAIMS

Property includes

Claims No. S 59916 to 21 incl. and
S 60153 to 69 incl.

OR

N/2 Lot 4 Conc. 4	4
S/2 " 4 " 5	4
S/2 " 3 " 5	4
S/2 of N/2 Lot 3 Conc. 5	2
S/2 " Lot 2 Conc. 5	4
S.W/4 & NW/4 of N/2 Lot 2 Conc. 5	2
S/2 Lot 1 Conc. 5	2
S/2 of S/2 Lot 1 Conc. 6	1

Work Done

1. Geological surface map 400' to 1".
Control - the base line between Concessions 4 & 5 with total chainage 10,920 feet, with lot lines out for mapping on a total of 16,000 feet of line outing.
2. General prospecting.
3. Miscellaneous stripping and trenching
of which
93 days applicable as assessment on Claims
59916 & 59917.

Findings

Referred to in Weekly Reports 28/6/52; 3/7/52; 12/7/52
and 19/7/52.

Geology

The property is underlain by members of the Onaping Series, consisting mainly on the group of Tuffs. In the east portion of the group there are outcroppings of a finely grained sheared tuff, which places the group in close proximity to the Onwatin Slates.

GROUP NO. 1 - TRILL TOWNSHIP (Cont'd.)

Structure

The possible extension of the "so-called" Cameron Creek fault passes in a NE/SW direction through the south-east portion of the property.

Showings

Three old workings, located in the southern portion of the group, were cleaned out and sampled, with negative results; but the three showings tend to have an east-west alignment.

Other Work

Inco (refer to Weekly Report of 16/11/52) has located the apparent continuity of the Ontario Pyrities Shear on Lot 12, Concession 4 of Fairbanks Township.

Conclusion

It would be advisable to hold the southern tier of Group No. 1 until such time as Inco completes the program mentioned in the Weekly Report of 16/11/52; this would require a diamond drill program of 800 to 1,000 feet. To hold the group, it would be more advisable to restake.

Drop Nil

Restake 23

GROUP NO. 2 - FAIRBANK TOWNSHIP

3 CLAIMS

Property includes

Claims No. 59915 - 59931 & 59932

or

S/2 Lot 12 Conc. 5	2
S/2 of N/2 Lot 12 Conc. 5	1

Work Done

1. Geological mapping as a part of Group No. 1 - Trill Township, with one isolated outcrop in SW corner.
2. General prospecting.
3. Remainder of claims heavily overburdened.

Conclusion

These three claims should be held as a part of Group No. 1.

Drop Nil

Restake 3

Property includes

Claims No. 60136 - 52 inclusive
60170 - 71 inclusive

or

N/2 of S/2	Lot 12	Cone. 6	3
N2/3 of N/2	" 12	" 6	4
N/2 of S/2	" 11	" 6	2
N/2 of	" 11	" 6	4
N/2 of	" 10	" 6	4
N/2 of S/2	" 10	" 6	2

Work Done

1. Control prospecting in NW quarter, balance of group either sandplain or flooded.
2. Dip needle survey, cross sectioning the NE extension of the "so-called" Cameron Creek fault, results negative.
3. Slatey tuffs located on south boundary 60144.

Findings

Nil

Importance

Straddles Cameron Creek fault in proximity to the Tuff-Slate contact.

Conclusion

To be held and diamond drilled under winter conditions, in the south control portion of the group, which would call for a 1,000 to 1,500 foot program.

Work required

GROUP NO. 4 - DOWLING TOWNSHIP

8 CLAIMS

Property includes

Claims No. S 60601 - 08 inclusive

or

N/2 of Lots 5 & 6 Cons. 1

Work Done

1. Surface prospecting in vicinity of Diabase Dike.

Findings

Nil; located too far in hanging wall to be of current interest.

Conclusion

Abandon.

Drop 8

GROUP NO. 5 - DOWLING TOWNSHIP

17 CLAIMS

Property includes

Claims No. S 61191 - 99 inclusive
S 61200 - 02 inclusive
S 56391 - 95 inclusive

or

	Lot 3	Conc. 5	8
S/2	" 3	" 6	4
SW/4 of N/2	Lot 3	Conc. 6	1
W/2	Lot 2	Conc. 5	4

Work Done

General prospecting.

Findings

Attempt made unsuccessfully to locate fecunis
lake fault, some pyritic float located.

The property wholly underlain by the Onaping
Tuffs.

Conclusion

Abandon.

GROUP NO. 8 - DOWLING TOWNSHIP

6 CLAIMS

Property includes

Claims No. 8 56388 - 90 inclusive
9 56396 - 98 inclusive

or

S/2 of Lot 1 Conc. 6	4
E/2 of S/2 Lot 2 Conc. 6	2

Work Done

General prospecting.

Findings

Minor carbonate and shearing along south boundary in the S & W portion of property, no mineral.

The claims are wholly underlain by Onaping Tuffs.

Conclusion

Abandon.

Drop 6

GROUP NO. 7 - MORGAN TOWNSHIP

18 CLAIMS

Property includes

Claims No. S 61172 - 61180 inclusive	9
S 61188 - 61189 inclusive	2
S 61167	1

or

Lot 12 Conc. 1	8
W/2 of Lot 11 Conc. 1	4

Work Done

1. General prospecting.

Findings

Nothing of interest, these claims wholly underlain by Onaping formation.

A Lundberg anomaly lies within Lot 12, Conc. 1 of this group, but no details of the geophysical results are available.

Conclusion

Ground should be held until airborne anomaly checked by dip needle, which would call for three weeks work by two men.

Work

42 man days of work

GROUP NO. 8 - MORGAN TOWNSHIP

4 CLAIMS

Property includes

Claims No. 8 61168 - 71 inclusive 4

or

W/2 Lot 10 Conc. 1

Work Done

1. General prospecting.

Findings

The group is wholly underlain by the Onaping formation.

Conclusions

Abandon.

Drop 4

Property includes

Claims No. 8 62953 - 56 inclusive 4

or

S/2 of N/2 of Lot 4 Cons. 3
N/2 of S/2 " " 4 " 3

Work Done

1. General prospecting.
2. Preliminary surface mapping.

Findings

The group is traversed by the Sandoherry Creek fault, and is immediately south of patented claims held by P. Neault, on which is found a flat, south dipping, Quartz - Carbonate zone of little economic importance.

The claims are underlain by the Onaping group.

Conclusion

No work, but hold until due date.

Hold 4

GROUP NO. 10 - MORGAN TOWNSHIP

8 CLAIMS

Property includes

Claims No. S 60583 - 86 inclusive	4
S 60597 - 60600 "	4

or

W/2 of Lot 3 Conc. 2	4
W/2 of E/2 of Lot 3 Conc. 2	2
E/2 of W/2 of Lot 3 Conc. 1	2

Work Done

1. General prospecting.

Findings

No outcrops within the boundaries, with the exception of one hill of Chelmsford Arkose.

The group straddles the intersection of the Sandoherry Creek fault with the Slate-Tuff contact.

Conclusions

Dubious; abandon the two claims in Concession 1, and hold only until due date.

Drop 2

Hold 6

GROUP NO. 11 - MORGAN TOWNSHIP

28 CLAIMS

Property includes

Claims No. S 60565 - 60582 inclusive	18
S 60592 - 60596 "	5
S 60609	1
S 61816 - 61819 "	4

or

Lot 2 Conc. 2	8
E/2 of Lot 3 Conc. 1	4
Lot 1 Conc. 2	8
Lot 1 Conc. 1	8

Work Done

1. General prospecting.

Findings

The property underlain by Onwatin slate and Chelmsford arkose, the former being obscured by sandplains.

Conclusions

Abandon claims in Concession 1, and hold those in Concession 2 until due date.

Drop 12

Hold 16

Property includes

Claims No. 8 60505 - 64 inclusive	60
8 60587 - 91 "	3
8 60430 - 38 "	9
8 61153 - 66 "	14
8 60209 - 16 "	8
8 61187 & 61190	2

or

N/2 of Lot 11 Conc. 3	2
S/2 of " 11 " 4	2
S/2 of " 10 " 4	4
S/2 of " 9 " 4	4
S/2 of " 8 " 4	4
S/2 of " 7 " 4	4
S/2 of " 7 " 3	4
" " 6 " 4	8
S/2 of " 6 " 3	4
" " 5 " 4	8
" " 5 " 3	8
S/2 of " 4 " 4	4
S/2 of " 3 " 4	4
S/2 of " 3 " 5	4
E/2 of " 3 " 3	4
E/2 of W/2 Lot 3 Conc. 3	2
S/2 of Lot 2 Conc. 5	4
S/2 of " 2 " 4	4
W/2 of " 2 " 3	4
" 1 " 5	8
" 1 " 4	8

Work Done

1. General prospecting.
2. Preliminary geological mapping.
3. River traverse.

GROUP NO. 12 - LUMSDEN TOWNSHIP (Cont'd.)

Findings

1. All but the most westerly 14 claims are under sandplain.
2. Minor shattering along a draw on Lot 9, Conc. 4, carries minor pyrite.
3. A second pyrite occurrence was located 1,200 feet east.
4. The outcrops on the river traverse were all Chelmsford arkose.

Conclusions

Drop all claims except those immediately and adjacent to Group No. 13, i.e., 60558-59-60-61-62 and 63, plus 60430, 60431, as these may be important when Group No. 13 studied.

Drop 90

Restake 8

GROUP NO. 13 - LUMSDEN TOWNSHIP

11 CLAIMS

Property includes

Claims No. S 63598 & 99 2
S 63600 - 08 inclusive 9

or

S/2 of S/2 Lot 8 Conc. 5 2
N/2 of " 8 " 4 4
N/2 of " 9 " 4 4
SE/4 of S/2 " 9 " 5 1

Work Done

1. Newly staked Dec. 2/52 recording.
2. Some general prospecting.

Findings

The ground restaked because of the Lundberg anomaly.

Conclusion

Dip needle survey in progress; will require a further two weeks with two men.

Work

42 man days required

Property includes

Claims No. S 60489 - 60500 inclusive

or

S/2 of Lot 10	Cont.	6
S/2 of " 11	"	6
S/2 of " 12	"	6

Work Done

1. Prospected and preliminary mapping.

Findings

The property straddles the apparent contact, between the Onwatin Slates and Onaping Tuffs, which, from exposures in the immediate vicinity, indicate a possible buckling or warping in the regional contact.

Conclusions

A limited diamond drilling program of 1,500 to 2,000 feet to test the economic possibilities in the vicinity of indicated buckle.

Work

1,500' - 2,000' D.D.

GROUP NO. 15 - HAMMER TOWNSHIP

8 CLAIMS

Property includes

Claims No. 57738 - 45 inclusive (old numbers)

or

N/2 of Lots 10 & 11 Conc. 5

Work Done

Restaked December 18th/52.

Findings

Staked to protect Group No. 14.

Conclusion

Hold until due date, and findings on Group No.
14.

Note--

Hold 8

The new claim numbers are
S 63675 - 82 incl.

GROUP NO. 16 - HAMMER TOWNSHIP

20 CLAIMS

Property includes

Claims No. 60205 - 60208 inclusive	4
60190 - 60199 "	10
60349	1
60200 - 60204 "	5

or

S/2 of Lots 10, 11 & 12 Cons. 5	12
S/2 of N/2 Lot 12 Cons. 5	2
E/2 of " 12 " 4	4
N/2 of E/2 " 11 " 4	2

Work Done and Findings

1. The Vermilion River traversed by canoe.
2. Property underlain by Chelmsford sandstones and Onwatin slates, which latter are heavily overburdened.

Conclusion

Abandon.

Drop 20

GROUP NO. 17 - HAMMER TOWNSHIP

6 CLAIMS

Property includes

Claims No. S 60343 - 48 inclusive

or

S/2 of Lot 8	Cone. 5	4
E/2 of S/2 of Lot 9	Cone. 5	2

Work Done and Findings

1. Canoe traverse.
2. Slate - arkose contact found near river.
3. No evidence of regional Diabase Dike.
4. Dubious locational value.

Conclusion

Abandon.

Drop 6

GROUP NO. 18 - HAMMER TOWNSHIP

8 CLAIMS

Property includes

Claims No. S 60188 & 60189
S 60341 & 60342
S 60501 - 60504

or

S/2 of Lot 6 Cono. 6
W/2 of " 6 " 5

Work Done

1. Preliminary mapping and prospecting.

Findings

One outcrop of slate near concession line,
sheared, and some pyrite mineralization.

Apparently straddles Slate-Tuff contact.

Conclusions

Of dubious locational value; abandon claims
in Concession 5, and hold those in Concession
6 until due date.

Drop 4

Hold 4

Property includes

Claims No. S 60172 - 60187 inclusive	16
S 60799	1
S 60800 - 60802 "	3
S 61185 - 61186	2
S 61024	1

or

N/2 of Lot 5	Conc. 5	4
N/2 of " 4	" 5	4
" 3	" 5	8
S/2 of " 3	" 6	4
W/2 of S/2 Lot 2	Conc. 6	2
W/2 of S/4 " 2	" 6	1

Work Done

1. Prospecting -- no outcrops found.

Findings

None -- all sandplain.

The northern portion should straddle one mile in length of Tuff-Slate contact.

Conclusion

Abandon ground in Concession 5, and temporarily retain ground in Concession 6.

Drop 16

Hold 7

GROUP NO. 20 - HANMER TOWNSHIP

2 CLAIMS

ADJACENT TO GROUP NO. 21 - CAPREOL TOWNSHIP

Property includes

Claims No. S 61147
S 61152

or

NE/4 & SE/4 of N/2 Lot 1 Cons. 5

Work Done

None

Findings

None; all sandplains; of dubious merit.

Conclusion

Abandon.

Drop 2

Hold Nil

GROUP NO. 21 - CAPREOL TOWNSHIP

8 CLAIMS

ADJACENT TO GROUP NO. 20 - HAMMER TOWNSHIP

Property includes

Claims No. S 61148 - 61151 inclusive 4
S 61181 - 61184 " 4

or

S/2 of Lot 12 Conc. 6
N/2 of " 12 " 5

Work Done

No work done; all sandplain.

Conclusion

Hold until Group No. 22 drilled.

Drop Nil

Hold 8

GROUP NO. 22 - CAPREOL TOWNSHIP

2 CLAIMS

Property includes

Claims No. "Bed of Lake only"
S 60487 - 88

or

Central portion Lots 10 & 11, Conc. 5.

Work Done

None to date.

"These claims cover a N.E. trending shear mineralized with pyrite and possibly interests the Slate-Tuff contact in this area. This contact zone has made Copper-Lead-Zinc Ore at Ontario Pyrites, and it merits investigation here where cut by the shear" - Refer J.M.P. letter Dec. 3rd/52 following visit by J.M.P. and B.C.F.

Conclusion

1500 feet diamond drilling required.

Work

GROUP NO. 23 - CAPREOL TOWNSHIP

8 CLAIMS

Property includes

Claims No. S 61891 - 61898

or

All Lot 8 Cons. 3

Work Done

No work; all sandplains; of dubious merit.

Conclusion

Abandon.

Drop 8

Hold Nil

OPTION NO. 01 - HAMMER TOWNSHIP

160 ACRES

Optionor - R. Carriere

Agreement dated May 19th, 1952.

Purchase Price - \$8,000.00 payable as follows:

\$ 500.00	within	one	year
500.00	"	two	"
500.00	"	three	"
6,500.00	"	four	"

Mining Rights to E $\frac{1}{2}$ Lot 3, Conc. 1

or Parcels 407 and 927 N.W.S.

Work Done

No work done - farmland - of dubious merit.

Conclusion

Abandon.

Drop all options.

OPTION NO. 02 - HAMMER TOWNSHIP

80 ACRES

Optionors - T. and A. Despatie

Agreement dated March 12th, 1952.

Purchase Price - \$30,000.00 payable as follows:

\$ 4,000.00	within	one	year
4,000.00	"	two	"
4,000.00	"	three	"
4,000.00	"	four	"
14,000.00	"	five	"

Mining Rights to S $\frac{1}{4}$ of E $\frac{1}{4}$ Lot 2, Conc. 2
or Parcel 2263, S.E.S.

Work Done

Surface examined by J.M.P.; states that "A block of dubious locational merit, covering a minor mineralization zone in sheared dark tuffs, which failed to respond to considerable drilling in the past".

Conclusion

Abandon.

Drop all options.

OPTION NO. 03 - MORGAN TOWNSHIP

161 ACRES

Optionors - T. & D. Rheaume

Agreement dated March 15th, 1952.

Purchase Price - \$8,050.00 payable as follows:

\$ 161.00	on execution of agreement
805.00	within one year
1,610.00	" two "
2,737.00	" three "
2,737.00	" four "

Mining Rights to W $\frac{1}{4}$ Lot 2, Concession 1
or Parcel 5497 S.W.S.

Work Done

None, partially sandplain, and underlying
formation all Chelmsford sandstone.

Conclusion

Abandon.

Drop all options.

EXAMINATIONS

Other properties examined for the Sudbury Northrim
Exploration Company Limited during 1952 -

JULY 26, 1952

Name of Property	-	Knight, Hawke & Morris
Location	-	Frechette Township, District of Sudbury
Claims	(15) -	49542 - 56 inclusive
Conclusion	-	Property turned down
Reference	-	Weekly Report July 26/52 Separate Report July 20/52

AUGUST 9, 1952

Name of Property	-	Wallace Bradley Farm
Location	-	N ^o Lot 9, Conc. V Balfour Township District of Sudbury
Conclusion	-	Property turned down
Reference	-	Weekly Report August 9/52

SEPTEMBER 23-25, 1952

Name of Property	-	Jerome - McNeilly - Fellows Claims
Location	-	MacMurchy Township Shining Tree Area District of Sudbury
Claims	(25) -	59279 - 59303
Conclusion	-	Property turned down
Reference	-	Separate report dated September 23-25/52.

EXAMINATIONS (Cont'd.)

- 2 -

OCTOBER 4, 1952

Name of Property - Bennett - McVittie Group
Location - Street Township,
District of Sudbury
Claim Numbers - 20283-89; 20446-47; 20476;
20517; 20501
License of Occupation - L.O. 2011
Conclusion - Property was turned down
Reference - Weekly Report October 4/52

OCTOBER 18, 1952

Name of Property - Arthur Roy Group
Location - Township 149, Algoma District
The group is in S.E. corner of
Township and adjoins the Town-
ship boundary of 149 and Esten.
Conclusion - Property was turned down
Reference - Weekly Report October 18/52

OCTOBER 25, 1952.

Name of Property - W. A. Spencer and Bill Saddleman
Groups
Location - Corner - Hudson, Lundy, Henwood
Townships, Timiskaming District
Showings are in N.W. corner
Lot 12 Concession VI, Henwood
Township
Conclusion - Properties turned down
Reference - Weekly Report October 25/52.

EXAMINATIONS (Cont'd.)

- 3 -

NOVEMBER 10, 1952

Name of Property	- Grant & Johnston Claims
Location	- Norman Township in vicinity of Inco "H" Orebody
Conclusion	- Property turned down
Reference	- Weekly Report November 16/52 Separate Report filed

NOVEMBER 22, 1952

Name of Property	- Croteau Claim Group owned by Cochise Prospecting Syndicate
Location	- Dowling Township, Sudbury Area
Claim Numbers	- 62514 - 22 61548 - 55 63277 - 80

This property adjoins Sudbury Northria Group No. 5 to the west.

Conclusion	- Property was turned down
Reference	- Separate report dated November 22/52.



41111NE9542 LUMSDEN 12 LUMSDEN

900

(b)

Langridge's MAP OF THE SUDBURY MINING AREA

SUDBURY NORTHMIN EXPLORATION COMPANY LTD.

HOLDINGS

Groups # 1 - 23
Options # 1 - 3

- A Abandon Or Drop
- B Hold Until Due Date
- Restake
- D Work Required

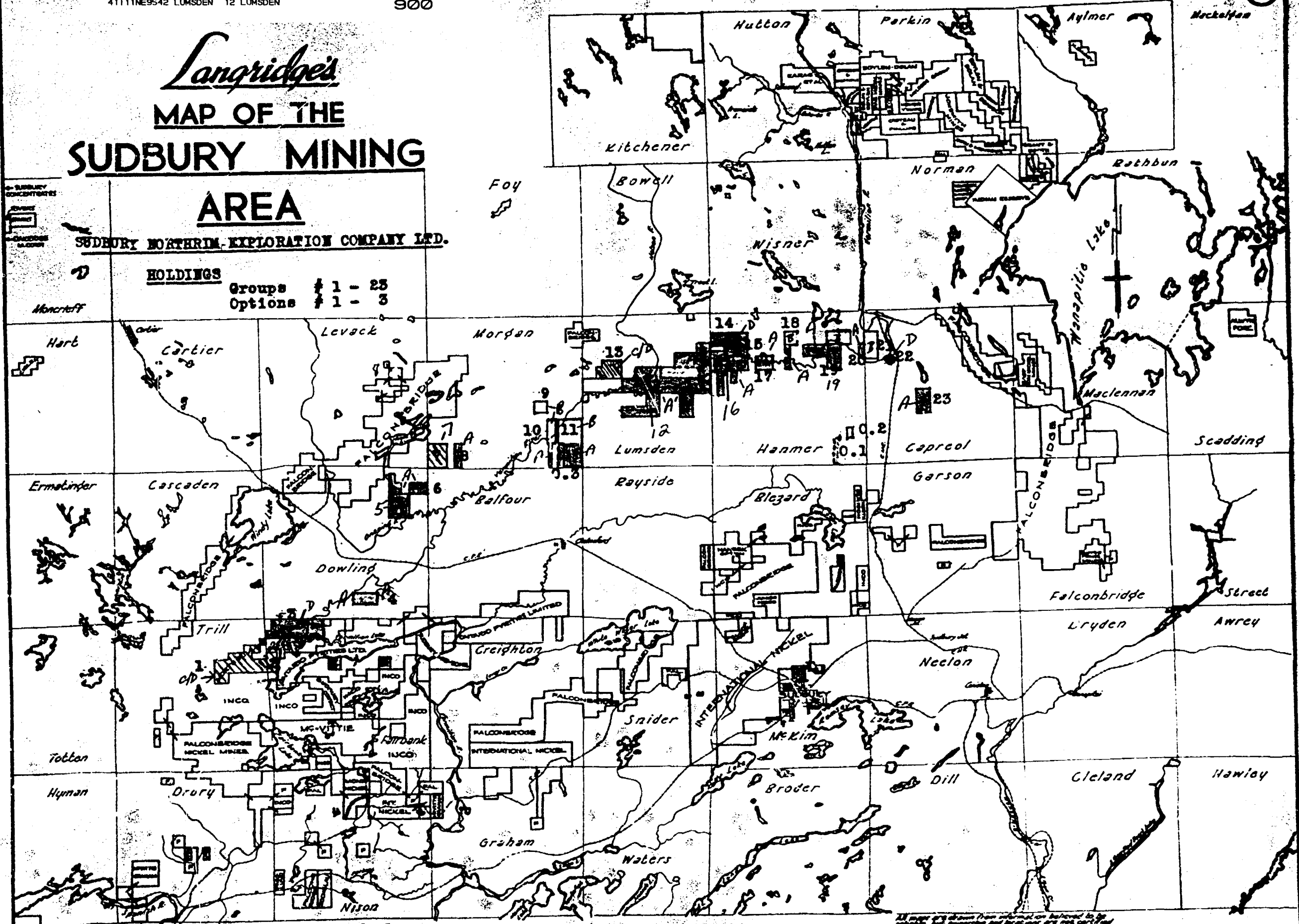

All maps are drawn from information believed to be reliable. Full ownership and location are not guaranteed by Langridge's.

DOWLING TWP.

200

Vermilion R.

FAIRBANK TWP



VI

V

IV

III

Levack Twp

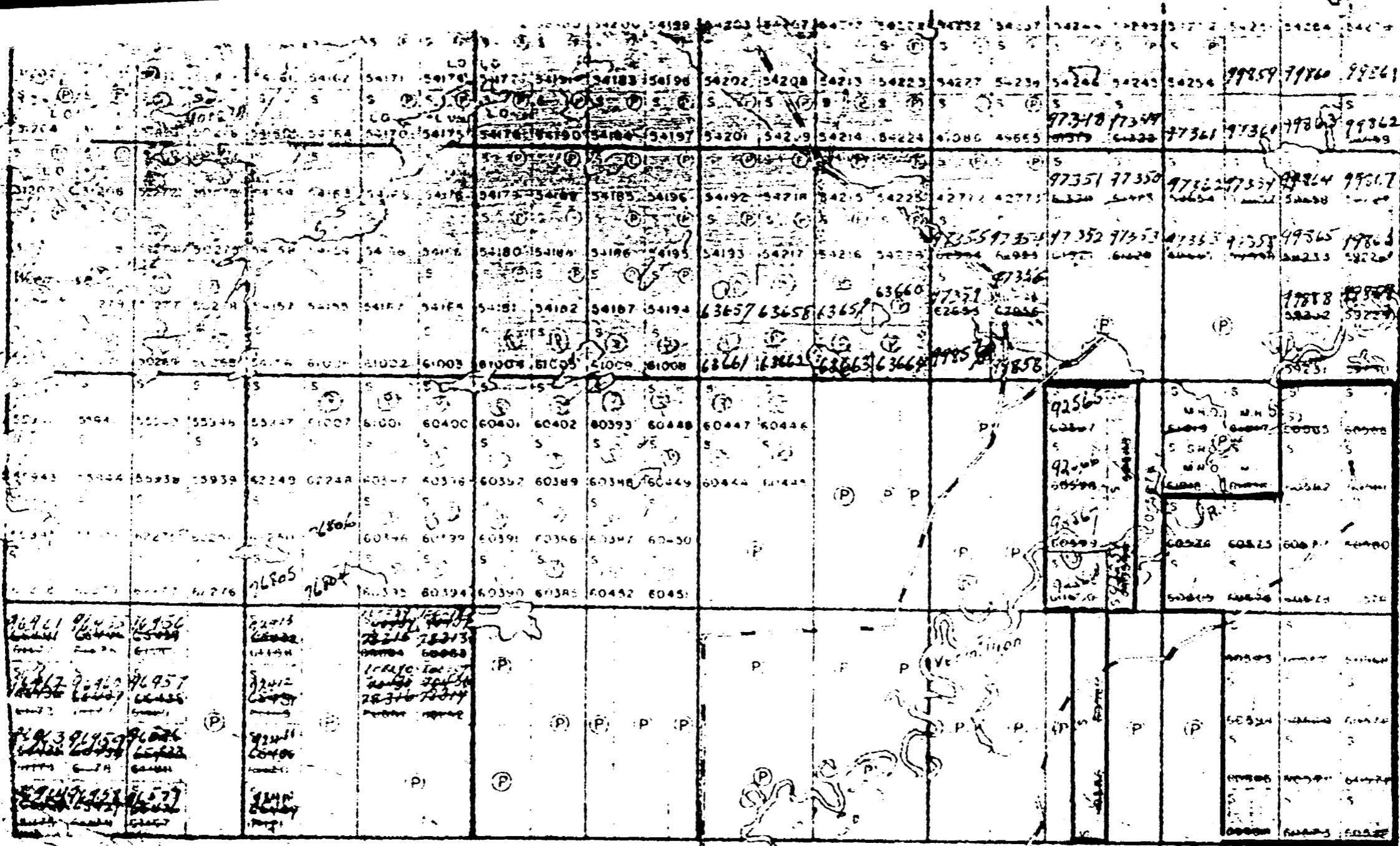

IV

III

II

I

12 11 10 9 8 7 6 5 4 3 2 1

MORGAN TWP

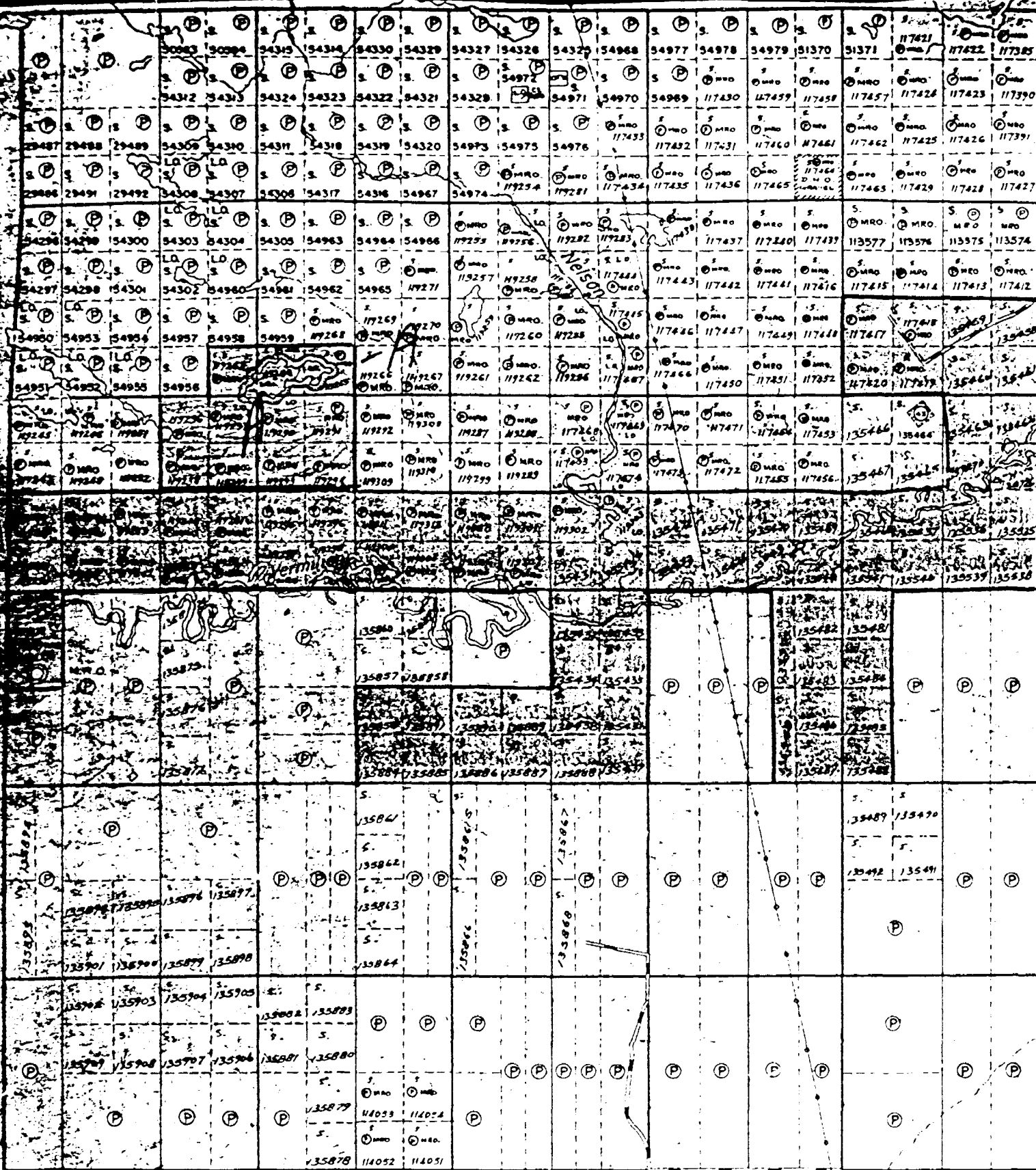

VI
V
IV
III
II
I

Hanner Twp

11 10 9 8 7 6 5 4 3 2 1

(SUDBURY NORTH
EPL C. LTD.)

Rayside Twp

LUMSDEN TWP

A- ~~---~~ DIP NEEDLE SVY REPORTED
DIP NEEDLE SURVEY REPIATED

1" = 40 CHAINS

HANMER TWP

WISNER TWP

200
200' Res.
↓

HANMER TWP

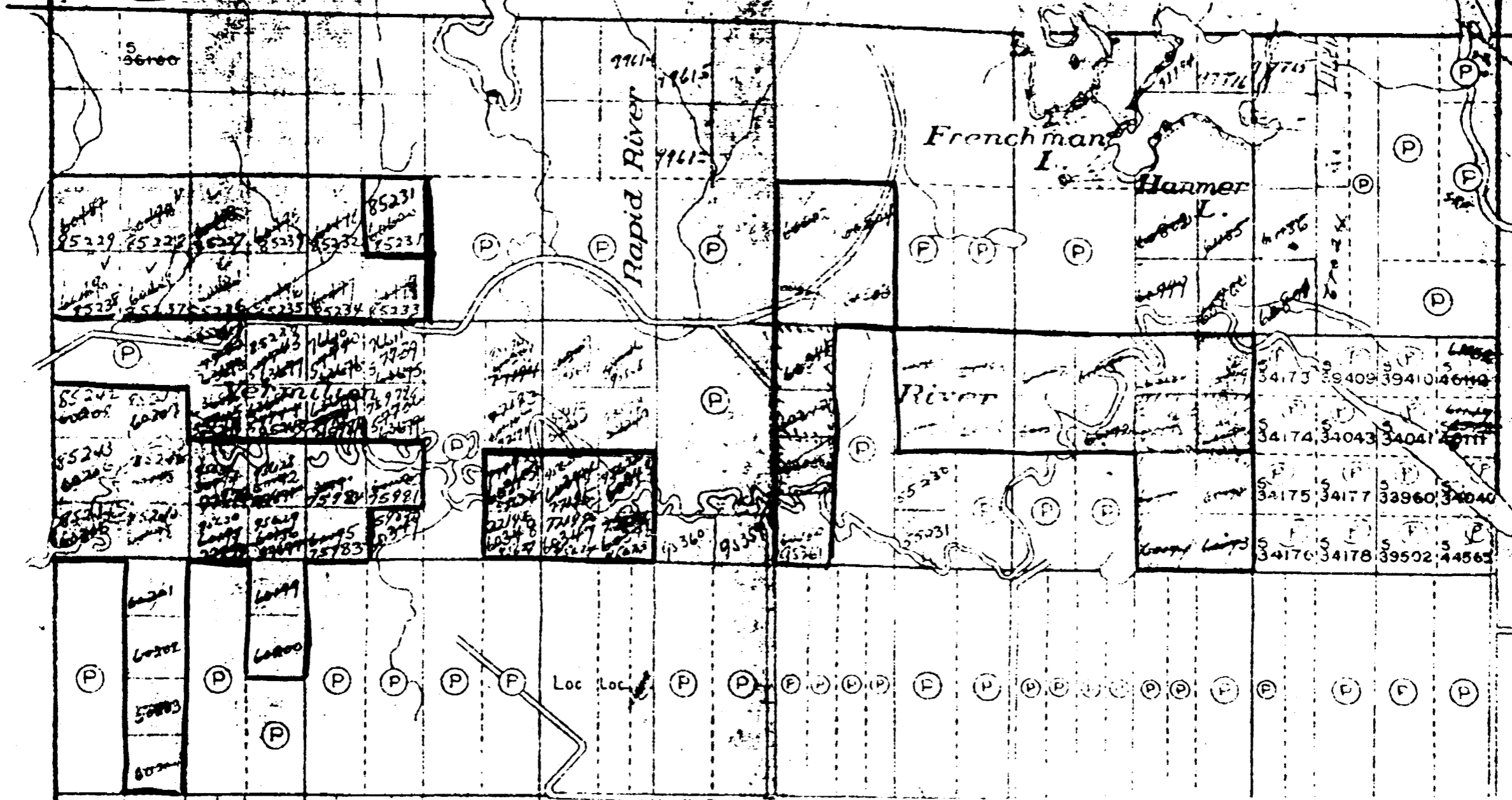

VI

V

IV

VI

V

IV

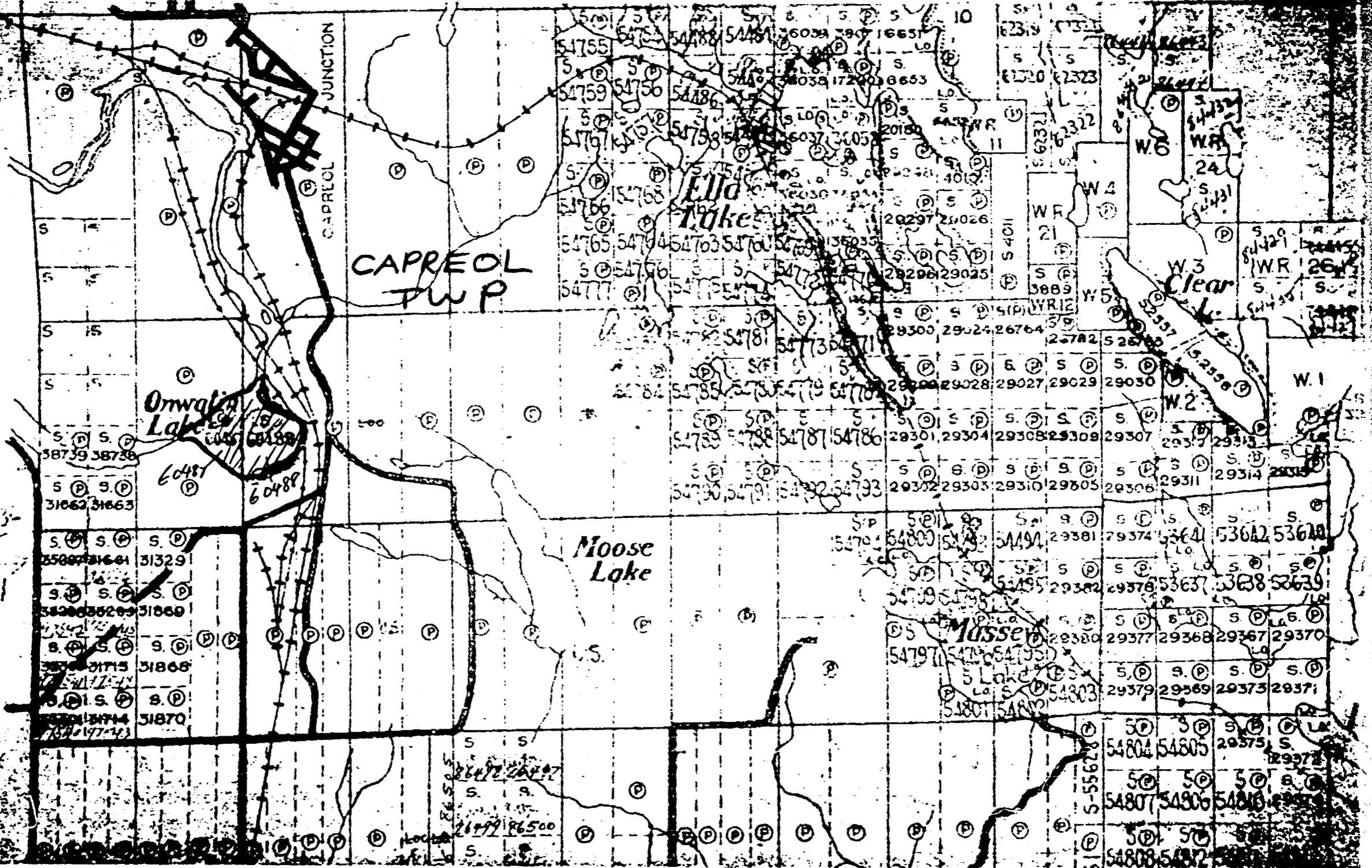

CAPREOL TWP

Orwata Lake

Eldon Lake

Moose Lake

Mussey Lake

Clear Lake

CAPREOL JUNCTION

38739 38738
31662 31663

35000 31664 31329

34200 35200 31869

33700 31715 31868

33200 31714 31870

32700 31713

26472 26497

26999 26500

54804 54805 29375

54807 54806 54808 29376

54808 54807