



411118W0057 0011B1 CREIGHTON

010

Diamond Drilling

Township of CREIGHTON

Report NO 16

Work performed by: Sturdy Mines

Claim NO	Hole NO	Footage	Date	Note
S 91193	AS-1	412.0'	Aug/56	
	AS-2	400.0'	Aug/56	
TOTAL 2		812'		

Notes:

STURDY

ASSESSMENT WORK (Creighton Twp)

LEVEL SURFACE DRILL SIZE

COMMENCED Aug.24/56

LOCATION Bend of Vermilion

COMPLETED Aug.30/56

-from S. to W. Flow claim S 91193

DEPTH	AZIMUTH	DIP	ELEVATION	LOGGED BY
200	-63°			J. S. ROS
400	-58°			
		-70°		

FOOTAGE		DESCRIPTION	SAMPLE			ASSAYS					AVERAGES		
FROM	TO		FOOTAGE FROM	TO	TOTAL	NUMBER	Cu.	Pb.	Zn.	As.	Ag.	% Cu.	% Zn.
0	23	Casing											
23	412	Tuff : Dark-greenish-grey; medium-grained, moderately altered with 10-15% sericite. Moderate foliation at 45-60°, minor to low pyrrhotite streaks; 1" quartz-dolomite vein at 43.5'. Lost core 73-76'. Quartz-carbonate vein (barren) from 80-80.8' (probable fault). 40% sericite schist 67.5'-80' (fault) at 80° to core. Erratic disseminated lime throughout avg. 5-10%. Lost core 186.5-189', 214-215', 216.5-218.5 and 231.5-240.6. Scant narrow 1/4" quartz-dolomite veinlets. Lost core 252-253', 282-283', 327-328.4', 329.5-330.5', 338-339', 349-354'. Fault 251-252' with high slips at 30°. Coarse-grained 356-363'. Mod. black frags. Lost core 383-384'. 412 - END OF HOLE											

**DUPLICATE COPY
POOR QUALITY ORIGINAL
TO FOLLOW**

MINE **STURDY**
 REMARKS **ASSESSMENT WORK** *C. REIGHTON TP*
 LEVEL **SURFACE** DRILL SIZE _____ COMMENCED **Aug. 24, 1956**
 LOCATION **Bend of Vermilion** SIZE **AXT** COMPLETED **Aug. 30, 1956**
 from S.toW. flow claim *59119.3*

FOOTAGE	DIP	AZIMUTH	FOOTAGE	DIP	AZIMUTH
200	-63°				
400	-58°				

DEPARTMENT _____ LENGTH **412'**
 ELEVATION _____ SHEET NO. **1**
 AZIMUTH *N* LOGGED BY **J. S. Ross**
 DIP **-70°** *J. S. Ross*

FOOTAGE		DESCRIPTION	SAMPLE				ASSAYS					AVERAGES			
FROM	TO		FROM	TO	TOTAL	NUMBER	% Cu.	% Pb.	oz./TON Zn.	oz./TON Au.	Ag	% Cu.	% Pb.	oz./TON Zn.	oz./TON Au.
0	23	<u>Casing</u>													
<i>23</i>	<i>412</i>	<u>Tuff</u> - dark-greenish-grey; medium-grained, moderately altered with 10 - 15% sericite. Moderate foliation at 45 - 50°, minor to low pyrrhotite streaks; 1" quartz-dolomite vein at 43.5'. Lost core 73' - 76'. Quartz-carbonate vein (barren) from 80 - 80.9' (probable fault). 40% sericite schist 67.5 - 80' (fault) at 80° to core. Erratic disseminated lime throughout avg. 5 - 10%. Lost core 166.5 - 189', 214 - 215', 216.5 - 218.5' and 231.5 - 240.6'. Scant narrow (1/4") quartz-dolomite veinlets. Lost core 252 - 253', 282 - 283', 327 - 328.4', 329.5 - 330.5', 338 - 339', 349 - 354'. Fault 251 - 252' with high slips at 30°. Coarse-grained 356 - 363'. Mod. black frags. Lost core 383 - 384'. <i>42</i> - <u>END OF HOLE</u> -													

DIAMOND DRILL RECORD

MINING DIVISION

SUBBITUMINOUS RECEIVED

STURDY

SECOND ASSESSMENT HOLE (Creighton Twp)

LEVEL SURFACE

DRILL SIZE

COMMENCED Aug. 30/56

200 61°

400 51°

LOCATION On W. flowing
Vermilion Claim

CORE SIZE AXT

COMPLETED Sep. 6/56

DIP

70° (?)

LOGGED BY J.S. ROS

FOOTAGE		DESCRIPTION	SAMPLE		ASSAYS					AVERAGES					
FROM	TO		FOOTAGE FROM	TO	TOTAL	NUMBER	Fe	Pb	Zn	Cu	Ag	% Cu	% Zn	oz./TON	oz./TON
0	26'	Casing													
26	138.6	<u>Tuff</u> : Greenish-Grey; extremely coarse-grained with commonly elongated frags. avg. 1"x½". Frags upto 2", some of which are chert. Mod. to highly chloritic. 6" quartz-calc. vein 93.5-94'. Rock is soft, moderate foliation at 45°. Major fault 137-138.6 with 10% quartz-dolomite stringers and abrupt change in colour and grain size at end of section.													
138.6	208	<u>Limy Tuff</u> : Black, good foliation at 45°, coarse-grained, 15% disseminated lime, minor to trace pyrite and pyrrhotite.													
208	227.2	<u>Tuff</u> : Black, medium-grained, good foliation 45°-60°, minor disseminated lime. Lost core 225 to 226'.													
227.2	227.8	<u>Quartz-dolomite</u> : 5% later pink dolomite; low chalcopryrite, galena and pyrrhotite. Fault.													
227.8	229	<u>Lost core</u>													
229	230	<u>Quartz-dolomite</u> : Scant chalcopryrite, sphalterite and pyrrhotite. 20% tuff frags.													
230	257.1	<u>Tuff</u> : Black, coarse-grained, frags upto 1", good foliation at 60°. Mod. chloritic; minor quartz-dolomite stringers.													
257.1	266.2	<u>Quartz-dolomite</u> : Low hem.stain, minor to low pyrrhotite, few grains chalcopryrite, major fault.													
266.2	400	<u>Limy Tuff</u> : Black, medium-grained, good foliation at 45°, 10-15% disseminated lime. Occasional ½" quartz-dolomite vein with minor pyrrhotite. Fine-grained to medium-grained 291' on. Lost core 297-298'. Lime decreasing towards end. Lost core 356.3-358', 362.8-363.8', 369-370', 373-375', 382-383'. 400' END OF HOLE.													

**DUPLICATE COPY
POOR QUALITY ORIGINAL
TO FOLLOW**

NAME STURDY
REMARKS SECOND ASSESSMENT HOLE CREIGHTON TP
LEVEL SURFACE **DRILL SIZE** COMMENCED Aug. 30, 1956
LOCATION On W. flowing Vermilion Claim **CORE SIZE** AXT **COMPLETED** Sept. 6, 1956

FOOTAGE	DIP	AZIMUTH	FOOTAGE	DIP	AZIMUTH
200	61°				
400	51°				

DEPARTMENT **LENGTH** 400'
ELEVATION **SHEET NO.** 1
AZIMUTH N
DIP 70°?
 LOGGED BY J.S. ROSS
 J.S. Ross

	FOOTAGE		DESCRIPTION	SAMPLE			ASSAYS					AVERAGES	
	FROM	TO		FOOTAGE FROM	TO	TOTAL	NUMBER	% Cu	% Zn	% Au	% Ag	% Co	% Zn
	0	26'	<u>Casing</u>										
	26	138.6	<u>Tuff</u> - Greenish-Grey; extremely coarse-grained with commonly elongated frags. avg. 1" x 1/4". Frags. up to 2", some of which are chert. Mod. to highly onloritic. 6" quartz-calc. vein 93.5 - 94'. Rock is soft, moderate foliation at 45°. Major fault 137 - 138.6 with 10% quartz-dolomite stringers and abrupt change in colour and grain size at end of section.										
	138.6	208	<u>Limy Tuff</u> - black, good foliation at 45°, coarse-grained, 15% disseminated lime, minor to trace pyrite and pyrrhotite										
	208	227.2	<u>Tuff</u> - black, medium-grained, good foliation 45° - 60°, minor disseminated lime. Lost core 225' to 225'.										
	227.2	227.9	<u>Quartz-Dolomite</u> - 5% later pink dolomite; low chalcopyrite, galena and pyrrhotite. Fault.										
	227.8	229	<u>Lost Core</u>										
	229	230	<u>Quartz-Dolomite</u> - scant chalcopyrite, sphalerite and pyrrhotite. 20% tuff frags.										

DIAMOND DRILL RECORD

Dowling
Twp.

Balfour
Twp.

27
Con. IV

27
Con. III

Con. II

Con. I

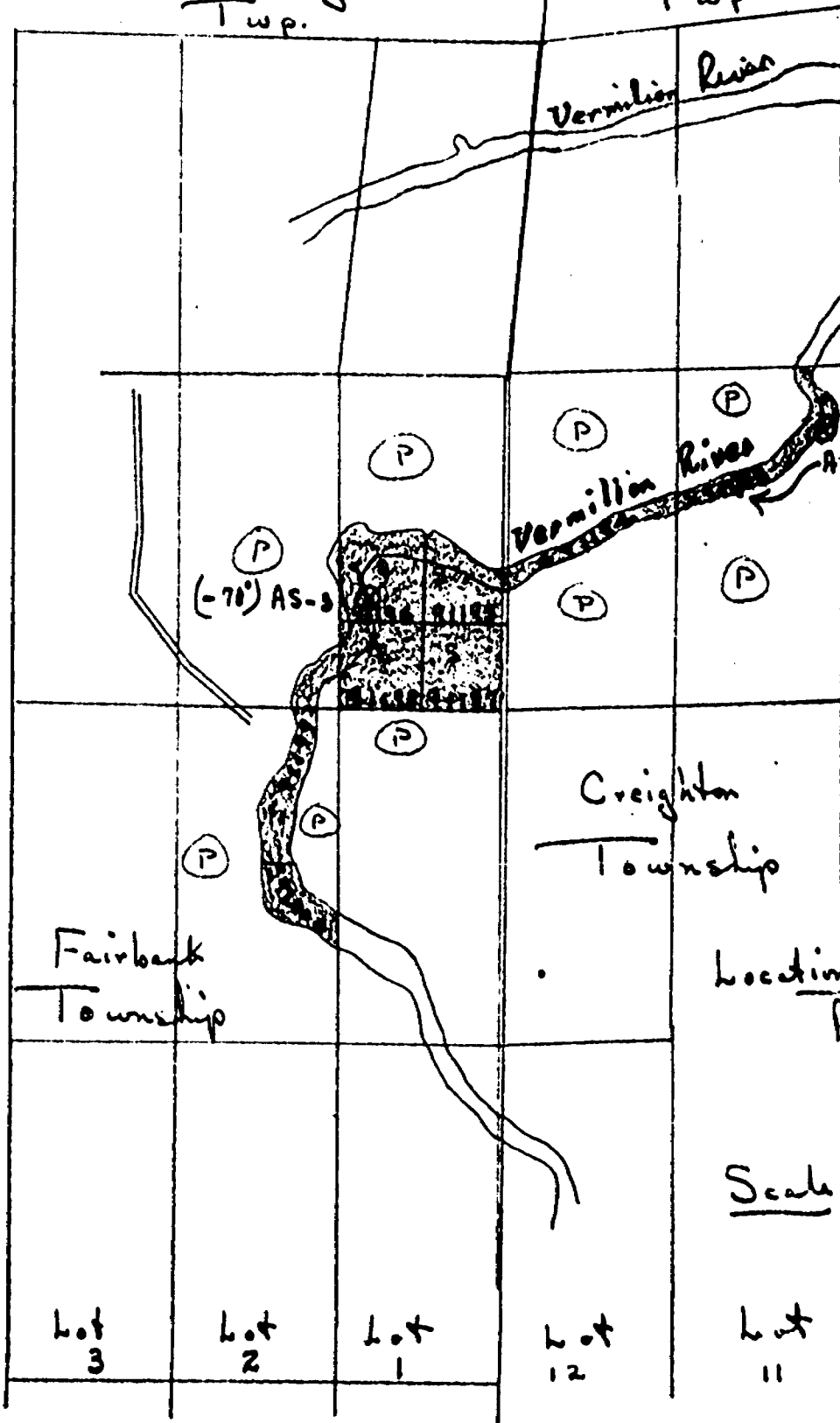

Midim
Location of Sudbury Midim
Assessment Work

Scale: 1" = 40 chains

J. S. Ross