



Your file:
Our file:

September 14, 1987

Harold J. Tracanelli
P.O. BOX 167
Chemlsford, Ontario
POm 1L0

Dear Mr. Tracanelli;

In reply to your request for a "positive" mineral identification for samples submitted to the TTL for assay, I am enclosing a brief visual description of minerals observed. Unfortunately, the weathered condition, small size (ie.<1") of the sample components and fine-grained nature of the minerals make a positive identification difficult with the resources available at this office. For a more accurate identification, samples should be submitted to the Ontario Geological Survey Laboratory in Toronto.

Two types of samples were present in the bag and included narrow, massive metallic vein material and mafic rocks with a minor metallic content. The latter samples contained, as the major constituent, <1% chalcopyrite in disseminated clots and in narrow quartz veinlets and <1% erythrite (cobalt bloom) on fracture surfaces. The massive vein material is comprised of a relatively soft, moderately dense granular mineral which appears to be either smaltite or skutterudite (cobalt/nickel arsenide). No silver, gold or nickel minerals were observed. I would expect moderately high cobalt, arsenic, nickel and copper values in your requested assay. Anomalous values of silver and/or antimony may also be present.

Yours respectfully,

Leo Owsicki
Resident Geologist
Northeastern Region
Mines & Minerals Division
P.O. Box 230
Cobalt, Ontario
POJ 1C0

Telephone: 705-679-8558

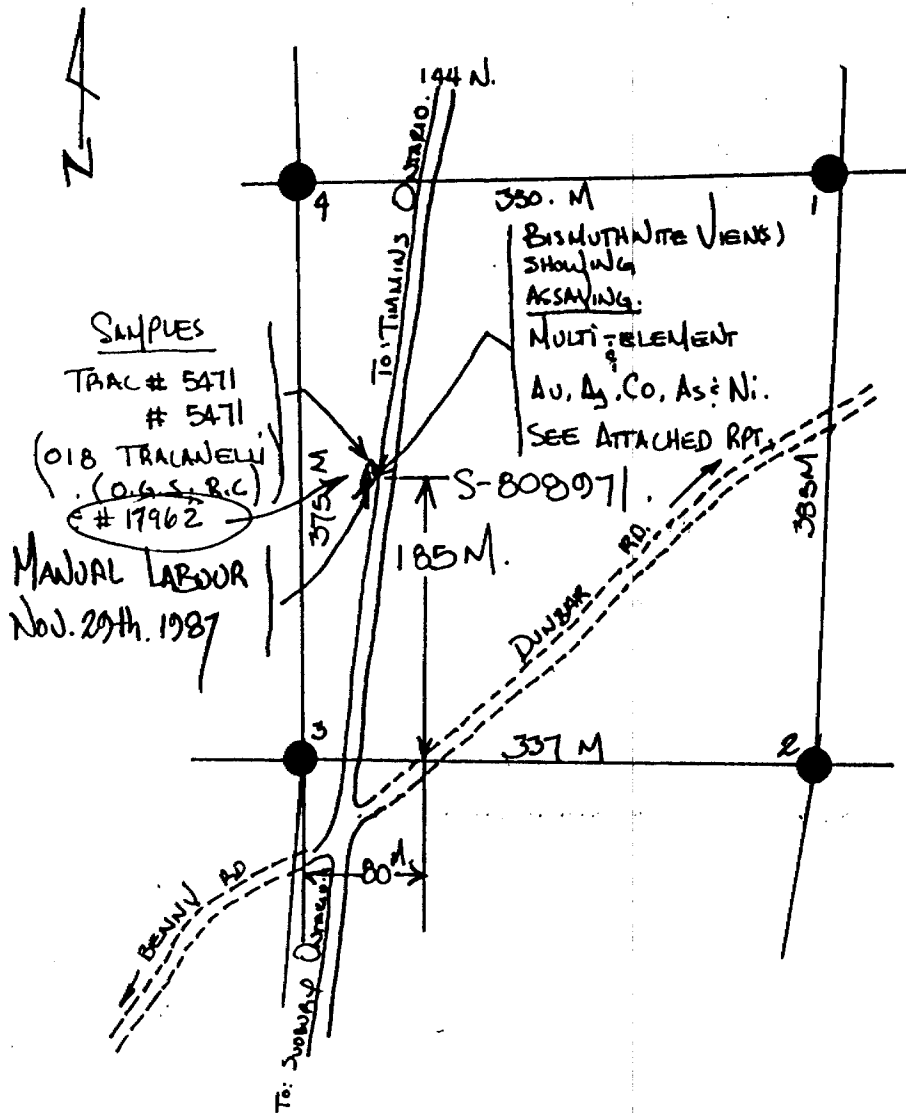

ASSAYING PLAN.

PART OF MONCRIEFF TWP. (M-869).
DRAWN BY: HAROLD J. TRACANELLI, GETN.
DATE: MON. DEC. 28th. 1987

SCALE 1:5,000

Handwritten signature: Harold J. Tracanelli



Ministry of
Northern Development
& Mines

Temiskaming
Testing
Laboratories

P.O. Box 799
Presley St.
Cobalt, Ontario
POJ 1C0
(705) 679-8313

FILE # T-21

Report Number
CB 9839

Laboratory Report

Date Sept. 16/87.

Issued To: Mr. Harold Tracanelli, P.O. Box 167, Chelmsford, Ont. POM 1L0

Sample Number	Gold Oz. Per Ton	Silver Oz. Per Ton	Co%	As%	Ni%
#5471 CLAIM# 5-808971 MUDCRAIFF TWP.	0.022	Trace	3.07	12.88	4.47

PLEASE REFER TO OUR FILE NUMBER T-21

D.L. Larabie
Manager. *D.L.*

ACKNOWLEDGEMENT OF ASSAY COUPON CREDIT

Name Mr. Harold Tracanelli, Date Sept. 16/87.

Address P.O. Box 167, Chelmsford, Ont.

$\frac{8}{6}$ Assay Coupons were received to your credit.
 $\frac{2}{2}$ Coupons have been applied to assay work.
Coupons remain to your credit in our files.

Ministry of
Northern
Development
& Mines

Geoscience Laboratories &
Temiskaming Testing Laboratories

Form MS.007

es Received Charged 6 coupons card #0916

D.L. Larabie
Manager *m.*

Except by special permission, reproduction of these results must include any
qualifying remarks made by this ministry with reference to any sample.



Ministry of
Northern Development
and Mines

Ontario
Geological
Survey

77 Grenville Street
11th Floor
Toronto, Ontario
M7A 1W4
Telephone 965-1337

Geoscience
Laboratories
Report

MONCRIEFF TW?

NOV. 24. 87.

Issued to:

T.T.L.

P.O. BOX 799

COBALT, ONTARIO POJ 100

For: Mr. Harold Tracanelli,
15 Errinton Street,
P.O. Box 167,
Chelmsford, Ont.
POM 1L0

FURTHER TO CERTIFICATE 641-87

QUALITATIVE ICP-SPECTROMETRIC ANALYSIS

ELEMENT/SAMPLE TRAC 5471

ALUMINUM	H
BARIUM	-
BERYLLIUM	-
CALCIUM	LM
CERIUM	T
CHROMIUM	-
COBALT	M
COPPER	L
IRON	MH
LANTHANUM	T
LEAD	LM
MAGNESIUM	M
MANGANESE	TL
MOLYBDENUM	T
NICKEL	M
NIOBIUM	-
NEODYMIUM	-
PHOSPHORUS	-
STRONTIUM	-
TANTALUM	T
TITANIUM	L
TUNGSTEN	-
VANADIUM	-
YTTRIUM	-
ZINC	-
ZIRCONIUM	-
TOT. RADIO.	-

PLEASE REFER TO OUR FILE NUMBER

T - 21

D.L. Larable,
Manager.
for copy

Name: Mr. Harold Tracanelli, Date: Nov. 18/87.
Address: Chelmsford, Ont.

$\frac{3}{0}$
Assay Coupons were returned to your credit. T, TL & Tor. Lab.
Coupons have been applied to assay work.
Coupons remain to your credit in our files. & Tor. Lab.

ACKNOWLEDGEMENT OF ASSAY COUPON CREDIT



Ministry of
Northern
Development
& Mines

Geoscience Laboratories &
Temiskaming Testing Laboratories

Form MS.007

(TOTAL RADIOACTIVITY EXPRESSED IN EQUIVALENT % URANIUM OXIDE)

This completes all analytical work for samples entered in your name on SEPT. 30, 1987.

LEGEND

- H = 10 TO 100%
- MH = 5 TO 10%
- M = 1 TO 5%
- LM = 0.5 TO 1%
- L = 0.1 TO 0.5%
- TL = 0.05 TO 0.1%
- T = 0.01 TO 0.05%
- = <0.01% (NONE DETECTED)

NOV. 10, 1987

Charged 3 coupons card #
0916 and Tor. Lab. File.

Fees Received: ~~DEPA~~

Chris Riddle
CHRIS RIDDLE, CHIEF ANALYST

Except by special permission reproduction of these results must include any qualifying remarks made by this ministry with reference to any sample.



ASSAYERS (ONTARIO) LIMITED
 88 CHAUNGEY AVENUE, TORONTO, ONTARIO M8Z 2Z2

LAB# _____
 REPT # _____
 Date _____
 Carrier _____
 ppd. col. _____
 WB# _____

Request for analyses

Submitted by HAROLD J. TRACANELLI, GETN. C-34300
% NEW-TRAILS EXPLORATIONS. Box 167
CHELMSFORD, ONTARIO. POH-110 (705) 855-5350 PROJECT# S-808971
 AUTHORIZED BY HAROLD J. TRACANELLI DATE THUR. SEPT 10th/87 P.O.# _____

INSTRUCTIONS

Report to: (1) HAROLD J. TRACANELLI, Box 167 CHELMSFORD, ONTARIO POH-110
 (2) JOHN GEORGE HUYCKE, GENERAL DELIVERY PLANNING CTR. POH-180.
 (3) _____

Invoice to: (1) (2) (3)

Type of analysis

<input checked="" type="checkbox"/>	Regular Assay Methods	<input type="checkbox"/>	Geochem Assay Methods
<input type="checkbox"/>	Check Assays	<input type="checkbox"/>	Control or Shipment Assays
<input type="checkbox"/>	Umpire Assays	<input type="checkbox"/>	Deep Overburden Concentration
<input type="checkbox"/>	Whole Rock Analysis	<input type="checkbox"/>	Other _____

Disposal of unused materials

PULPS Discard REJECTS Discard
 Retain 6 months Retain 90 days
 Retain more than 6 months at cost Retain more than 90 days at cost
 Return to HAROLD J. TRACANELLI Return to HAROLD J. TRACANELLI

Type of Sample	Sample Numbers	Au	Ag	Cu	Pb	Zn	Co	Ni	Other
REBALIZED ROCK	5471	✓	✓				✓	✓	As.
→ PLS EXAMINATION OF SAMPLE.									
→ NOTE ASSAYING VALUED AT 6 COUPONS.									
		Au, Ag	Co	Ni	As				
		0.02%	3.07	4.47%	12.88%				
									



Ministry of
Northern Development
and Mines

Ontario
Geological
Survey

77 Grenville Street
11th Floor
Toronto, Ontario
M7A 1W4
Telephone 965-1337

Geoscience
Laboratories
Report

MONCKIEFF TWP
CLM 808971
NOV. 24. 87

Attention: CAMPBELL
10TH FLOOR, 199 LARCH STREET
SUDBURY, ONTARIO
P3E 5P9

0652-87

Identification

87-RWC-018 -The grey metallic mineral was identified by XRD as

bismuthinite (Bi₂S₃).

This is an interim report for samples entered in your name on
October 6, 1987; additional work will follow as soon as possible.

Fees Received: Dept.

Peter Clift
for
Chris Riddle, Chief Analyst

W.D. Hicks
W.D. Hicks, Mineralogist
October 21, 1987

by special permission reproduction of these results must include any qualifying remarks made by this ministry with reference to any sample.

to:
MR. R CAMPBELL GEOLOGIST
10TH FLOOR, 199 LARCH ST.
SUDBURY, ONTARIO
P3E 5P9

MONCRIEFF TWP.
CLAIM 808071
NOV. 24 . 1987

FURTHER TO CERTIFICATE 0652-87

SAMPLE NUMBER	GOLD Au ppb	PLATINUM Pt ppb	PALLADIUM Pd ppb	SILVER Ag ppm
------------------	-------------------	-----------------------	------------------------	---------------------

-018 Tracanelle	510 Hwy 144	<1	<1	4
-----------------	-------------	----	----	---

This is an interim report for samples entered in your name
on OCT.6, 1987 ; additional work will follow as soon as possible

Fees Received: DEPT.

Peter C. Riddle
Chris Riddle, Chief Analyst

NOV. 10, 1987

ANALYTICAL LABORATORY WORK SHEET

D O

MONCRIEFF TWP.

SHEET No.

DATE Sept 27 1987

DATE OF SAMPLE	SOURCE & NUMBER	DESCRIPTION	SAMPLE SIZE	A.A. OR NI GLYOXIME	✓ % NI	A.A. OR ELECTRO CU	✓ % CU	INSOL	Co % INSOL
9/22	33018	MONCRIEFF GRAB SAMPLE	100		1.34		.11	.277	2.77
		BILBY VENTS SHALING							
									~ 100 x10 (100/100) #5 (100)
									CLAIM # S-809971

F.N.M. LTD. 1981
FORM
DATE - 1982

ASSAY ENTERED

LEVEL OR D.D.H. NO.

No. ON 33017

LOCATION

MONCRIEFF TWP

DISTANCE

TO OR FROM

LENGTH OF SAMPLE

GRAB

LENGTH OF WASTE NOT SAMPLED

REMARKS

ESTIMATE %Ni

REJECT SAVED

REJECT DISCARDED

ESTIMATE %Ni

CO 1.02

CU 2.01

FE 2.1

AS 2.01

F.N.M

No. ON 3

CHARGE

SAVE REJECT

DISCARD REJECT

ASSAY FOR Ni

CO

CU

S

FE

AS

AS

PT

PS

OTHER

SEND ASSAY RESULTS

Submitted by HAROLD J. TRACANELLI Box 167

CHELMSFORD, ONTARIO POM-110

The samples of MINERALIZED listed below are to be analyzed by: Geochemical methods
 Rock: Sp. INAA, Dep, AA, XRF: Assessment assay methods
 for the elements circled and/or as indicated in the listing. Report to: Head office, Field office,
 3 Other (please specify) REPORT TO ABOVE ADDRESS.

Invoice to 1, 2 or 3. Unused materials: return to 1, 2 or 3. store at cost _____ days. discard after 90 days.

AUTHORIZED BY HAROLD J. TRACANELLI. DATE WED. DEC -02/87.

for office use only

FILE _____
 REPT _____
 Date _____
 Carrier _____
 ppd. col.
 WB# _____

PROJECT# MONS-20397
 BENNY BEL
 P.O.# _____
 SERVICE AGREEMENT# _____

Au-FANA: Au-INAA; Multielement: BASIC (EXPLORATION) RESEARCH; PGE: As, Sb, W, Br, Cr, Co, Mo, Ta, U, Ba, OTHER

SAMPLE NUMBER		SAMPLE NUMBER	
No 17962.	Ag TO Li	} 52 ELEMENTS	45.00
BISULPHATE	Mg TO Zn		
FILE Use Only	Pb TO Eu. RE'S Th TO Th. SAE'S		
58.50 Assay	PLUS ASSAY FOR	} 2 ELEMENTS	4.50
3.92 POSTAGE			
5.00 LONG DIST	Ha		4.50
TELE TO SA			
HAMILTON			
ONTARIO.	SAMPLE PREPARATION		
ABOVE			
ASSAY CO.	CRUSHING AND MILLING, (CHROME STEEL MILL)		2.75
67.42	SAES		
2	MILLING TO -200 MESH, (CHROME STEEL MILL)		1.75
= 33.71			
		TOTAL (INVOICE)	58.50
HT = 33.71			
IGH = 33.71	NTE CHECK NO 0144 = 58.50		
67.42	THANK YOU VERY MUCH FOR YOUR TIME AND ATTENTION IN THESE MATTERS		

NUCLEAR ACTIVATION SERVICES LIMITED

1290 MAIN STREET WEST, HAMILTON, ONTARIO, L8S 4K1

PHONE (416) 522-5666

TELEX 06-936947

CERTIFICATE OF ANALYSIS

TO: NEW TRAILS EXPLORATION
 ATTN: HAROLD J. TRACANELLI
 P.O. BOX 167
 CHEMLMSFORD, ONTARIO
 P0M 1L0

CUSTOMER NO. 658/01/01

DATE SUBMITTED
 08-DEC-87

REPORT: 9321

FILE NUMBER: 10973

1 UNPREPARED SAMPLE CUST. REF. # MONS-808971

WAS ANALYZED AS FOLLOWS:

ELEMENTS	DETECTION LIMIT	UNITS	METHOD	ELEMENTS	DETECTION LIMIT	UNITS	METHOD
SI02	0.0100	%	XRF	MO	5.0000	PPM	INAA
AL2O3	0.0100	%	XRF	NO	10.0000	PPM	XRF
CAO	0.0100	%	XRF	NI	1.0000	PPM	DCP
MGO	0.0100	%	XRF	PB	2.0000	PPM	DCP
NA2O	0.0100	%	XRF	RB	10.0000	PPM	INAA
K2O	0.0100	%	XRF	SB	0.2000	PPM	INAA
FE2O3	0.0100	%	XRF	SC	0.1000	PPM	INAA
MNC	0.0200	%	DCP	SE	3.0000	PPM	INAA
TIO2	0.0010	%	XRF	SH	3.0000	PPM	WET
P2O5	0.0100	%	XRF	JR	10.0000	PPM	XRF
LOI	0.5000	%	XRF	TA	1.0000	PPM	INAA
SUX	0.1000	%	XRF	TH	0.5000	PPM	INAA
AG	0.5000	PPM	DCP	U	0.5000	PPM	INAA
AS	2.0000	PPM	INAA	V	2.0000	PPM	DCP
AU	5.0000	PPM	INAA	W	3.0000	PPM	INAA
B	10.0000	PPM	DCP	Y	10.0000	PPM	XRF

CERTIFICATE OF ANALYSIS

(CONT'D)

REPORT: 9321

FILE NUMBER: 10973

ELEMENTS	DETECTION LIMIT	UNITS	METHOD	ELEMENTS	DETECTION LIMIT	UNITS	METHOD
BA	10.0000	PPM	XRF	ZN	0.5000	PPM	DCP
BE	1.0000	PPM	DCP	ZR	10.0000	PPM	XRF
BR	1.0000	PPM	INAA	LA	0.5000	PPM	INAA
CD	1.0000	PPM	DCP	CE	3.0000	PPM	INAA
CO	1.0000	PPM	INAA	ND	5.0000	PPM	INAA
CR	2.0000	PPM	INAA	SM	0.1000	PPM	INAA
CS	0.5000	PPM	INAA	EU	0.2000	PPM	INAA
CU	0.5000	PPM	DCP	TB	0.5000	PPM	INAA
GE	10.0000	PPM	DCP	YB	0.2000	PPM	INAA
HF	1.0000	PPM	INAA	LU	0.0500	PPM	INAA
HG	5.0000	PPB	WET	IR	20.0000	PPB	INAA

DATE 20-JAN-88

NUCLEAR ACTIVATION SERVICES LIMITED

CERTIFIED BY *[Signature]*

*** UNLESS INSTRUCTED OTHERWISE WE WILL DISCARD ALL SAMPLES ***
 IRRADIATED SAMPLES AFTER 30 DAYS. ANY OTHER MATERIAL AFTER 120 DAYS.

NUCLEAR ACTIVATION SERVICES LIMITED

DATE: 20-JAN-39

REPORT: 9321

FILE NUMBER: 10973

PAGE: 1

S A M P L E N U M B E R S

ELEMENT !		**
& UNITS !		17962**
SIO2	%	36.5
AL2O3	%	12.3
CAO	%	3.74
MGO	%	4.25
NA2O	%	3.73
K2O	%	0.28
FE2O3	%	9.15 <i>le</i>
MNO	%	0.12
TIO2	%	0.530 <i>Ti</i>
P2O5	%	0.16
LOI	%	4.7
SUM	%	75.3
AG	PPM	4.0
AS	PPM	23000
AU	PPB	460
B	PPM	<10
BA	PPM	130
BE	PPM	4
BR	PPM	<12
CD	PPM	<1
CO	PPM	18000
CR	PPM	200
CS	PPM	<0.5
CU	PPM	300
GE	PPM	<10
HF	PPM	<1
HG	PPB	710
MO	PPM	10
NB	PPM	<10
NI	PPM	12000
PB	PPM	4300
RB	PPM	<10

NUCLEAR ACTIVATION SERVICES LIMITED

DATE: 20-JAN-68

REPORT: 9321

FILE NUMBER: 10973

PAGE: 2

S A M P L E N U M B E R S (CONT'D)

ELEMENT :		**
E UNITS :		17962**
S3	PPM	49
SC	PPM	109
SE	PPM	63
SN	PPM	<3
SR	PPM	<10
TA	PPM	<12
TH	PPM	<6.0
U	PPM	27.5
V	PPM	170
W	PPM	<21
Y	PPM	80
ZN	PPM	140
ZR	PPM	90
LA	PPM	31.0
CE	PPM	<21
ND	PPM	<5
SM	PPM	1.4
EU	PPM	<3.5
T3	PPM	<5.6
Y8	PPM	8.0
LU	PPM	<0.44
IR	PPB	<20

EXPLANATION OF CODES

VARIABLE DETECTION LIMITS DUE TO SAMPLE COMPOSITION

DOCUMENT NO.
WB87.016

Instructions: - Please type or print.
- If number of mining claims traversed exceeds space on this form, attach a list.
Note: - Only days credits calculated in the "Special Provisions" section may be entered

2-10804



900

Type of Survey: **ASSAYING**

Claim Holder(s): **KIDD - CREEK MINES LIMITED**

Address: **P.O. BOX 40 COMMERCE COURT WEST, TORONTO, ONTARIO, M5L-1B4.**

Survey Company: **NUCLEAR ACTIVATION SERVICES LIMITED LBS-4KI**
1280 MAIN ST. W. HAMILTON ONT. PH. 416-522-5666.

Date of Survey (from & to): **02 12 87**
 Day | Mo. | Yr. | Day | Mo. | Yr.

Total Miles of line Cut: **—**

Name and Address of Author (of Geo-Technical report):
SIGNATURE OF CERTIFYING PERSON ON ASSAY RETURN SHEETS.

Credits Requested per Each Claim in Columns at right

Special Provisions	Geophysical	Days per Claim
For first survey: Enter 40 days. (This includes line cutting)	- Electromagnetic - Magnetometer	
For each additional survey using the same grid: Enter 20 days (for each)	- Radiometric - Other	
	Geological	
	Geochemical	
Man Days Complete reverse side and enter total	Geophysical	Days per Claim
	- Electromagnetic - Magnetometer	
	- Radiometric - Other	
	Geological	
	Geochemical	
Airborne Credits Note: Special provisions credits do not apply to Airborne Surveys.	Electromagnetic Magnetometer Radiometric	Days per Claim

Mining Claims Traversed (List in numerical sequence)

Mining Claim Prefix	Mining Claim Number	Expend. Days Cr.	Mining Claim Prefix	Mining Claim Number	Expend. Days Cr.
S-	808971	4.325			
SUDBURY MINING DIV. RECEIVED FEB - 1 1988 A.M. 7:18/9/10/11/12/1/2/3/4/5/6/7/8/9/10/11/12 MINING GEOLOGICAL SURVEY FEB 17 1988 RECEIVED					
(REPORTS & MAPS ATTACHED.)					

Expenditures (excludes power stripping)

Type of Work Performed: _____

Performed on Claim(s): **S- 808971**

Calculation of Expenditure Days Credits

Total Expenditures: **\$ 64.87** ÷ **15** = **4.325** Total Days Credits

Instructions: Total Days Credits may be apportioned at the claim holder's choice. Enter number of days credits per claim selected in columns at right.

Total number of mining claims covered by this report of work. **ONE.**

Date: **FEB 01 1988**

Recorded Holder or Agent (Signature): *[Signature]*

For Office Use Only

Total Days Cr. Recorded: **4.325**

Date Recorded: **FEB. 31 88**

Date Approved as Recorded: **11 Feb 88**

Mining Recorder: *[Signature]*

Branch Director: *[Signature]*

Certification Verifying Report of Work

I hereby certify that I have a personal and intimate knowledge of the facts set forth in the Report of Work annexed hereto, having performed the work or witnessed same during and/or after its completion and the annexed report is true.

Name and Postal Address of Person Certifying: **HAROLD J. THACANELLI; GETN. 582 VERMILION LAKE ROAD, BOX. 67 CHELMSFORD, ONTARIO, P0N-1L0 705-855-5356.**

Date Certified: **FEB. 01 1988.**

Certified by (Signature): *[Signature]*

DOCUMENT NO. W8807-015

MONCRIEFF TWP. (M. 869)

Instructions: - Please type or print. - If number of mining claims traversed exceeds space on this form, attach a list. Note: - Only days credits calculated in the "Expenditures" section may be entered in the "Expend. Days Cr." columns. - Do not use shaded areas below.

2-10804

Mining Act

Type of Survey(s) ASSAYING - GEOSCIENCE LABORATORIES REPORT. MONCRIEFF TWP (M-869)

Claim Holder(s) KIDD CREEK MINES LIMITED. Prospectors Licence No. 1-1848.

Address P.O. Box 40 COMMERCE COURT WEST, TORONTO, ONTARIO. M5L-1B4.

Survey Company MND?M. O.G.S. GEOSCIENCE LABORATORIES. Date of Survey (from & to) Total Miles of line Cut

Name and Address of Author of Geo-Technical report MR. CHRIS RIDDLE, CHIEF ANALYST, 77 GREENVILLE ST., 11th FLOOR TORONTO, ONTARIO M7A-1W4

MR. D.L. LABRUE, MANAGER, TEMISKAMING TESTING LABORATORIES P.O. Box 799 (OBAAT), ONTARIO. P01-1C0.

Credits Requested per Each Claim in Columns at right

Mining Claims Traversed (List in numerical sequence)

Special Provisions For first survey: Enter 40 days. (This includes line cutting) For each additional survey using the same grid: Enter 20 days (for each)	Geophysical	Days per Claim
	- Electromagnetic - Magnetometer - Radiometric - Other	
Man Days Complete reverse side and enter total RECEIVED FEB 05 1988 MINING LANDS SECTION	Geophysical	Days per Claim
	- Electromagnetic - Magnetometer - Radiometric - Other	
Airborne Credits Note: Special provisions credits do not apply to Airborne Surveys.	Geological	Days per Claim
	Geochemical	Days per Claim
	Electromagnetic Magnetometer Radiometric	

Mining Claim			Mining Claim		
Prefix	Number	Expend. Days Cr.	Prefix	Number	Expend. Days Cr.
S-	808971	4.733			

RECEIVED FEB 1 1988 A.M. 7 10 11 12 1 3 4 5 6 P.M.

Expenditures (excludes power stripping)

Type of Work Performed ASSAYING (SEE REPORTS & MAPS ATTACHED)

Performed on Claim(s) S-808971.

MULTI-ELEMENT ASSAY (TRAC 5471 & #5471). ALSO ASSAYS FOR Au, Ag, Co, As, & Ni.

Calculation of Expenditure Days Credits
 Total Expenditures \$ 71.00 ÷ Total Days Credits 15 = 4.733

Instructions: Total Days Credits may be apportioned at the claim holder's choice. Enter number of days credits per claim selected in columns at right.

Total number of mining claims covered by this report of work. 1

Date DEC 28/87
 Recorded Holder or Agent (Signature)

For Office Use Only
 Total Days Cr. Recorded 4.733
 Date Recorded FEB. 3/88
 Mining Recorder
 Date Approved at Recorded 11 FEB 8 88
 Branch Director

I hereby certify that I have a personal and intimate knowledge of the facts set forth in the Report of Work annexed hereto, having performed the work or witnessed same during and/or after its completion and the annexed report is true.

Name and Postal Address of Person Certifying
 HAROLD J. TRACANGU, GETN. 582 VERMILION WK. RD, BOX 167
 CHEMSFORD, ONTARIO. P0M-1U0.
 Date Certified DEC-28/87
 Certified by (Signature)

ULSTER TWP (M-1168)

MUNS

MONCRIEFF TWP. (M.869)

(N)

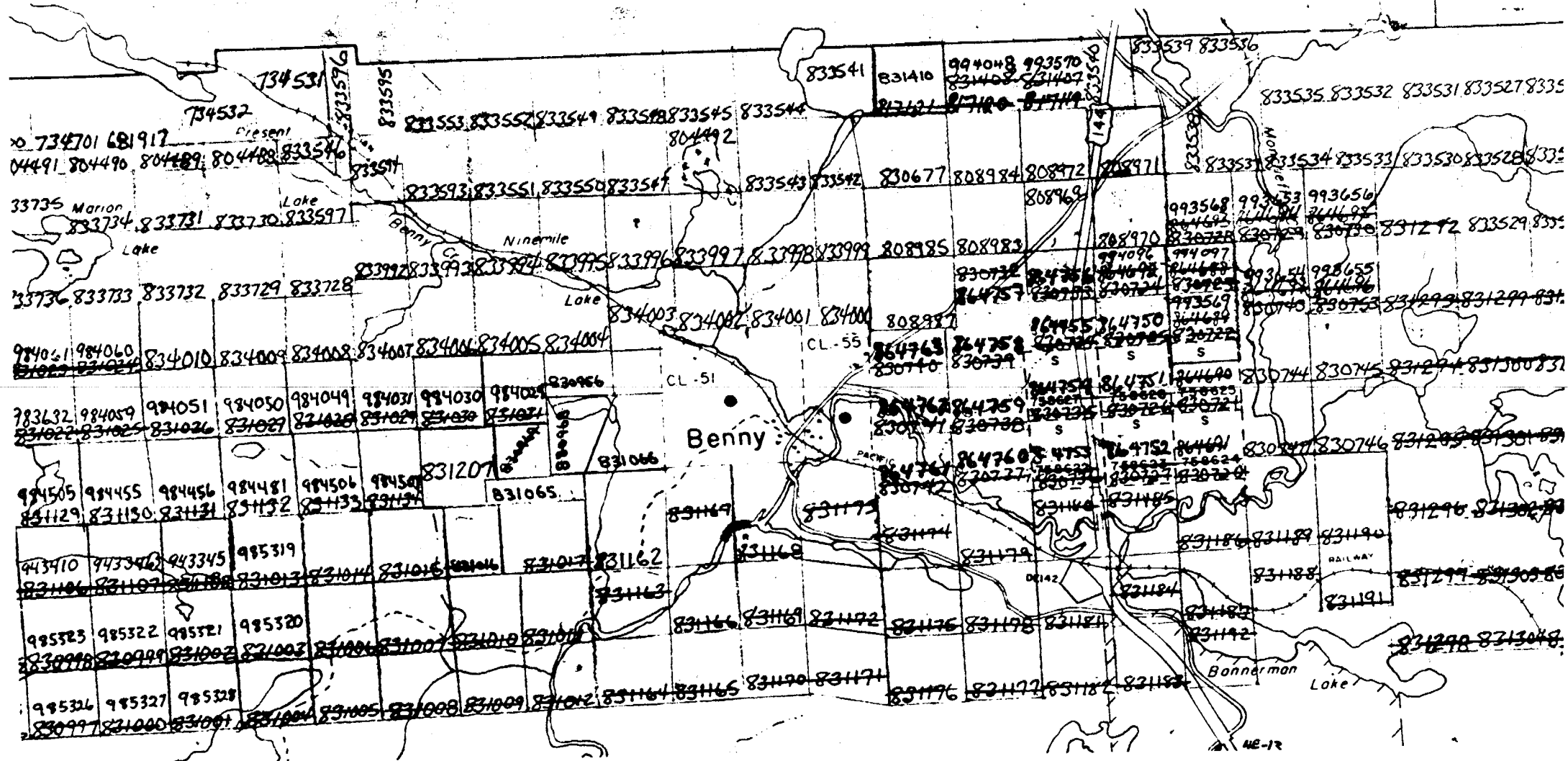

ULSTER TWP. (M-1168)

MUNS

MONCRIEFF TWP. (M. 869)

(N)

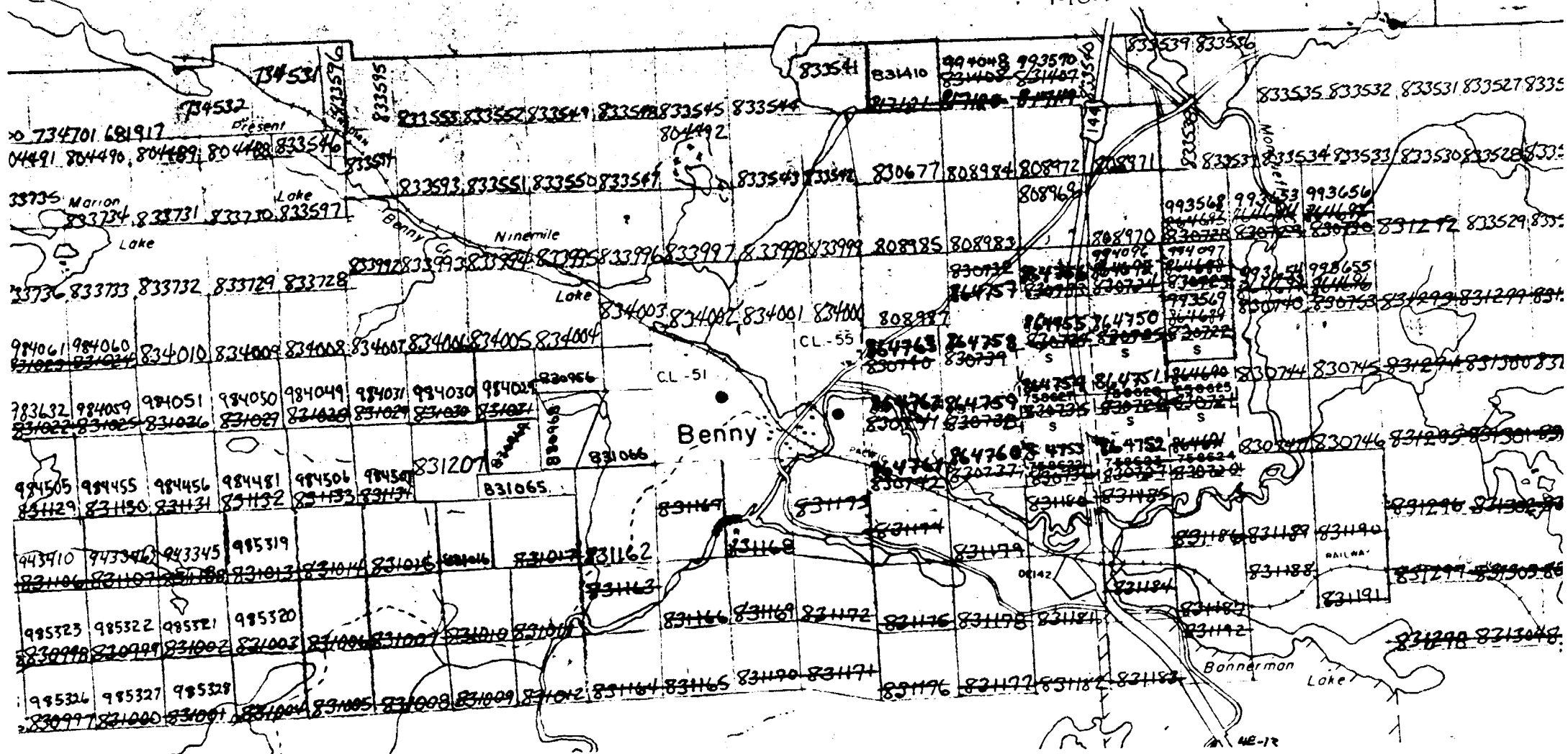

ULSTER TWP (M-1168)

MUNSTER TWP (M-880)

THE TOWNSHIP OF

MONCRIEFF

DISTRICT OF
SUBBURY

SUBBURY
MINING DIVISION

SCALE: 1-INCH = 40 CHAINS

DISPOSITION OF CROWN LANDS

- PATENT, SURFACE AND MINING RIGHTS ●
 - " SURFACE RIGHTS ONLY ○
 - " MINING RIGHTS ONLY ◐
 - LEASE, SURFACE AND MINING RIGHTS ■
 - " SURFACE RIGHTS ONLY □
 - " MINING RIGHTS ONLY ◑
 - LICENCE OF OCCUPATION ▼
-
- ROADS
 - IMPROVED ROADS ▬▬▬
 - KING'S HIGHWAYS ▬▬▬
 - RAILWAYS ▬▬▬
 - POWER LINES ▬▬▬
 - MARSH OR MUSKEG ▬▬▬
 - MINES ⊗
 - CANCELLED C.

NOTES

400' Surface Rights Reservation along the shores of all lakes and rivers.

Subdivision of this township into lots and concessions was annulled 30 June 1953.

SAND and GRAVEL

- ① M.T.C. Gravel Pit 4E-13
- ② " " " 4E-40

Downes Lake development plan
June 11, 1970 File: 183095.

AREAS WITHDRAWN FROM DISPOSITION

S.R. - SURFACE RIGHTS	M.R. - MINING RIGHTS			
DESCRIPTION	ORDER No.	DATE	DISPOSITION	FILE
① SEC. 36/80	W. 4/82	14/8/82	S.R.	137685

MONCRIEFF

PLAN NO. M-869

ONTARIO
MINISTRY OF NATURAL RESOURCES
SURVEYS AND MAPPING BRANCH

CRAIG TWP (M-736)

HESS TWP (M-930)

HART TWP (M-919)

46°44'40"



41112NE0065 2.10804 MONCRIEFF