

**GEOPHYSICAL SURVEY REPORT
ANDY J. LECLAIR PROPERTY
STRALAK TOWNSHIP**

**SURVEY CONDUCTED BY:
Paul St. Pierre**

**SURVEY CONDUCTED ON:
March 29th and 30th, 1997**

**CLAIM HOLDER:
Andy J. Leclair
1824 Huntington Drive
Sudbury, Ontario
P3A 1J6
Claim # 1211398**

2.17572



41113NW0001 2.17572 STRALAK

Introduction

In January of 1997, Andy Leclair approached me, Paul St. Pierre, to conduct a geophysical survey on his claim in Stralak Township. The work on his proper consisted of cutting the grid, putting in the stations, and doing a geophysical survey using the Omni Plus Magnetometer. On March 29th and 30th, 1997, a geophysical survey was conducted on claim 1211398, in Stralak Township, by Paul St. Pierre. The survey took two days at eight hours per day. A short traverse of two hundred and twenty meters was run to the East from the railway tracks along the southerly boundry of the claim to get to the top of the hill. The grid was done in meters with a line spacing of twenty meters and a station spacing of ten meters. The baseline has an an Azimuth of 26°, magnetic.

Location and Access

Andy J. Leclairs Claim, # 1211398, is located 10 km North of the village of Benny, an old logging town, which is 64 km North of the city of Sudbury. Claim post number two is located at NTM coordinate 5191000N, 442840E. Access to the property is by C.P. Rail only, at this time. Immediately East of the property is an old logging trail that was built years ago when logging was done in the Benny area. Path Creek, which runs from the Northeast to the Southwest, runs diagonally through the middle of the claim. Hydro and water may be obtained from the C.P. Railway and Path Creek respectively.

Topography and Exposure

The property relief consists of hills that are 30 m above the tracks with a small creek running through the property. The outcrop trends Northeast, Southwest. Several small outcrops border the North and East claim lines. There is 100% exposure of the outcrop due to the fact that it is 30 m high. Forest cover is moderate with Jack Pines covering the north and west sides of the property along the claim lines. In the southwest corner there is sand and gravel along the creek. There are no swamps on the property.

Regional Geology

There is no detailed geology of the area since no Ontario Geological Survey or Geological Survey of Canada maps have been done on this area. General geology of the area, taken from O.G.S. map 2393, Ontario Geological Map, East Central Sheet, consists of early Precambrian rocks with early Felsic Igneous and Metamorphic rocks of the Algoma Formation.

Property Geology

The geology of the property is the same as the regional geology due to the lack of maps for this area since its never been mapped. At the time this survey was run no trenches, channel cuts, or blasting had been conducted on the property. There is no previous history on the property.

Structural Geology: The structural geology of the area is unknown, due to the fact that there was four feet of snow on the outcrop, but, according to Andy Leclair there are some quartz veins on the top of the outcrop that have an azimuth of approximately 70°. No faulting was visible due to snow cover.

Mineralization: There is some sulfide mineralization along the creek in the southwest corner of the property. On the east side of the tracks along the south side of the creek, on the north side of the outcrop that was surveyed, was more sulfide mineralization.

Grid Details

The grid station 0+00 is located 100 m West and 60 m North of claim post number two and has an azimuth of 26°. The grid itself consists of three lines, two of which are 70 m long and one line 50 m long, due the fact that the grid sits on top of a 30 m high hill, and station 0+00 starts on the south side of the hill right on the edge. The grid lines are twenty meters apart with the stations being ten meters apart. The grid was cut by Andy Leclair and Paul St. Pierre, the one conducting the survey. It took one eight hour day to cut and chain the grid and one eight hour day to run the survey. Three separate stations were surveyed on the West side of the hill, but no tie station was set up to coordinate the points.

Conclusions and Recommendations

The geophysical survey shows that there is a small anomaly on the baseline at line at 0+00 and increases along the baseline. At line 0+20N on the baseline the anomaly is more visable but at line 0+40N, the anomaly is considerably larger with a 400 gamma increase. Further exploration is needed, possibly diamond drilling, to see what the anomaly is.

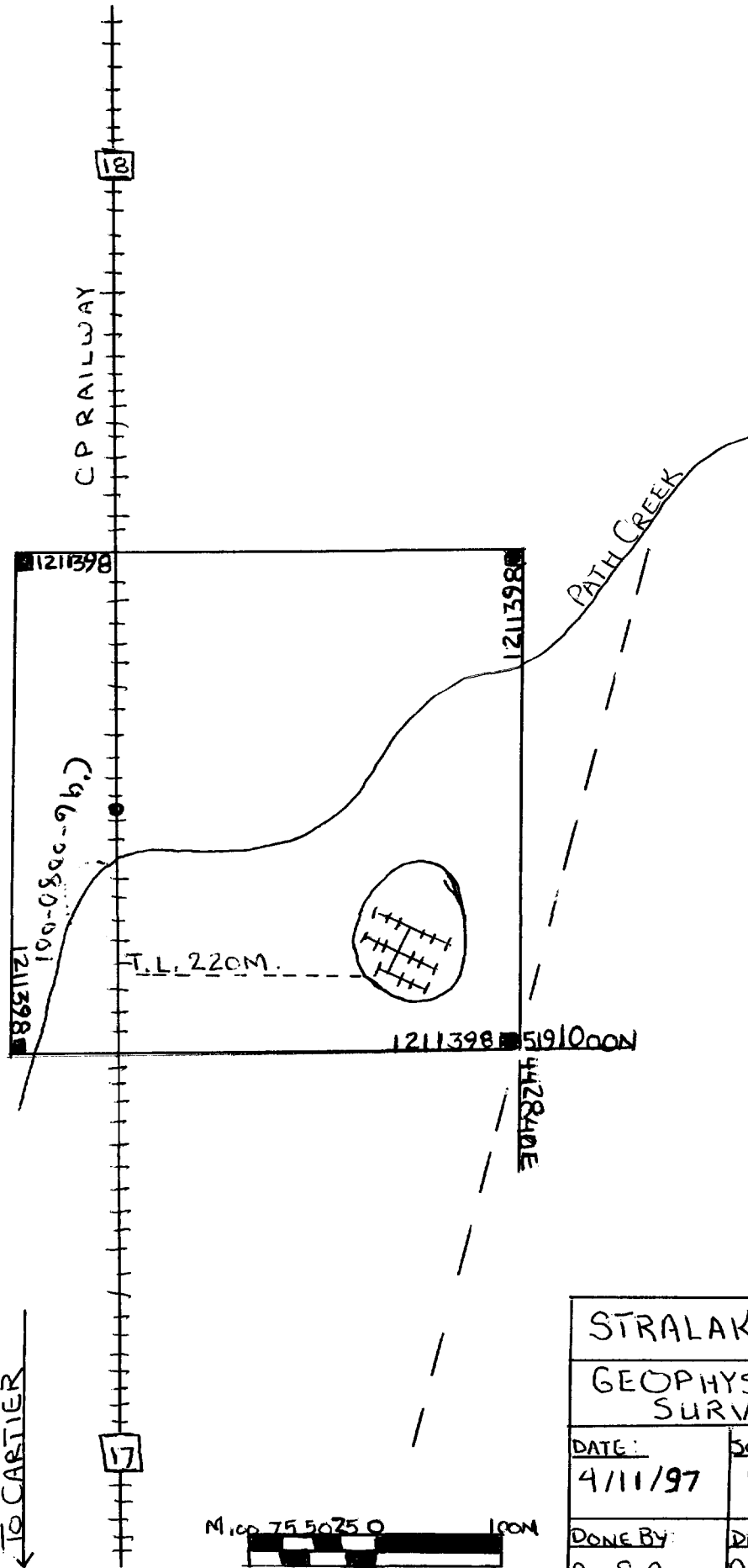
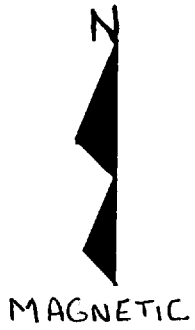

CHIP sample

	RAILWAY MILEAGE MARK
	CLAIM POST W/NUMBER
	TRAIN STOP
	T.L. TRAVERSE LINE
	TRAIL OR PATH
	OUTCROP

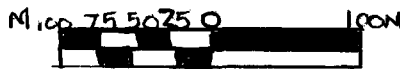

Line 0+00
Stralak Township

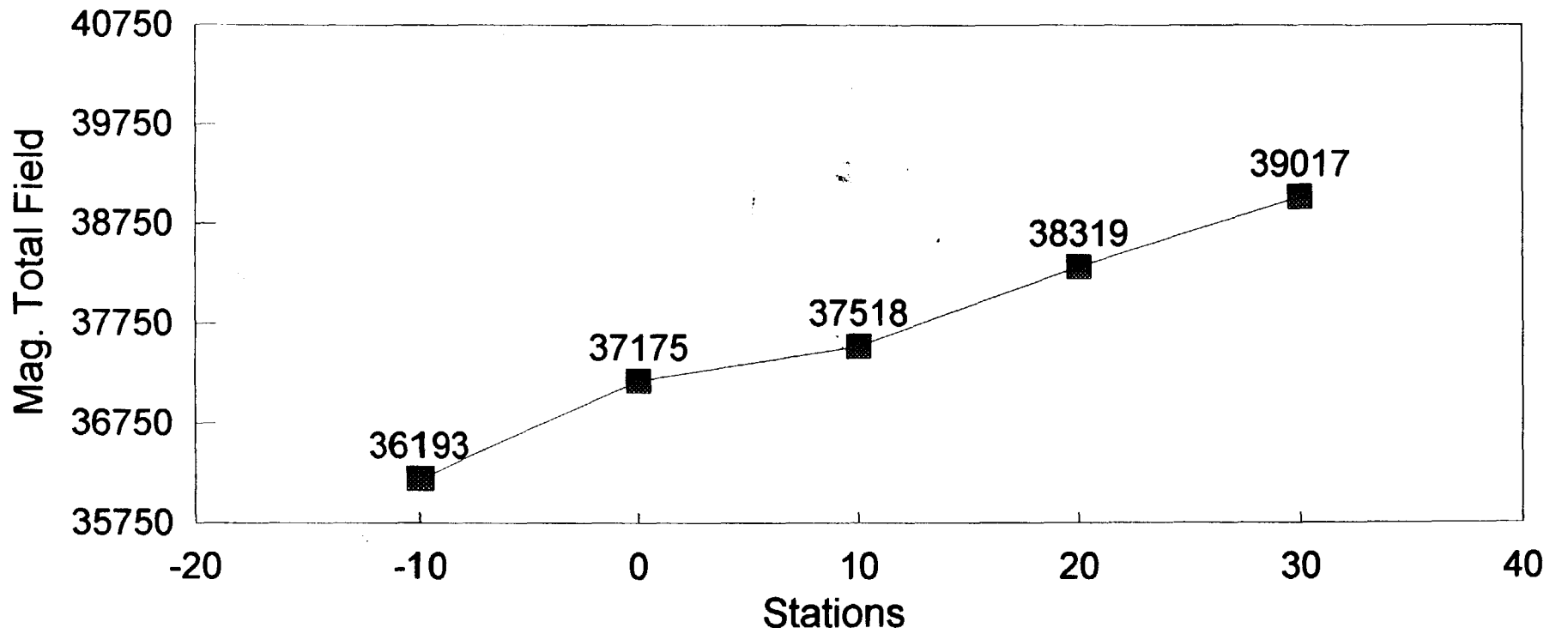

Line 0+20 N
Stralak Township

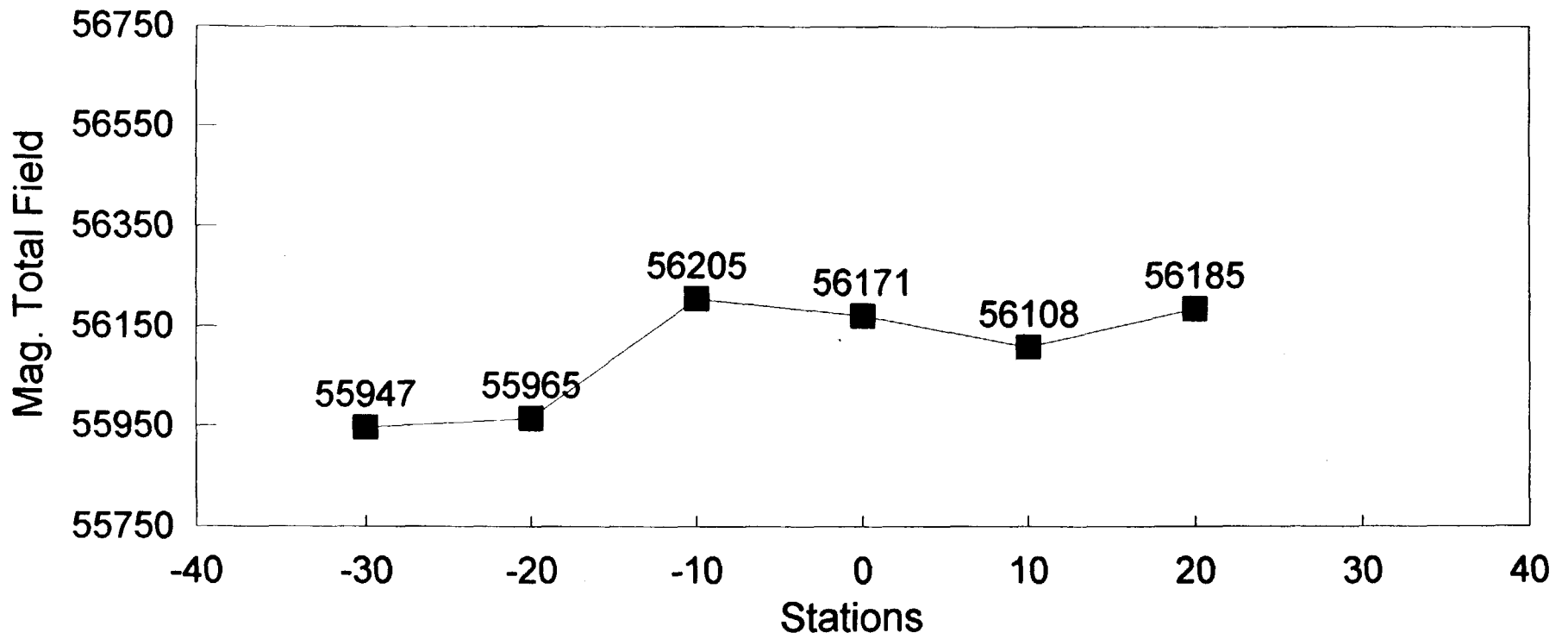

Line 0+40N
Stralak Township

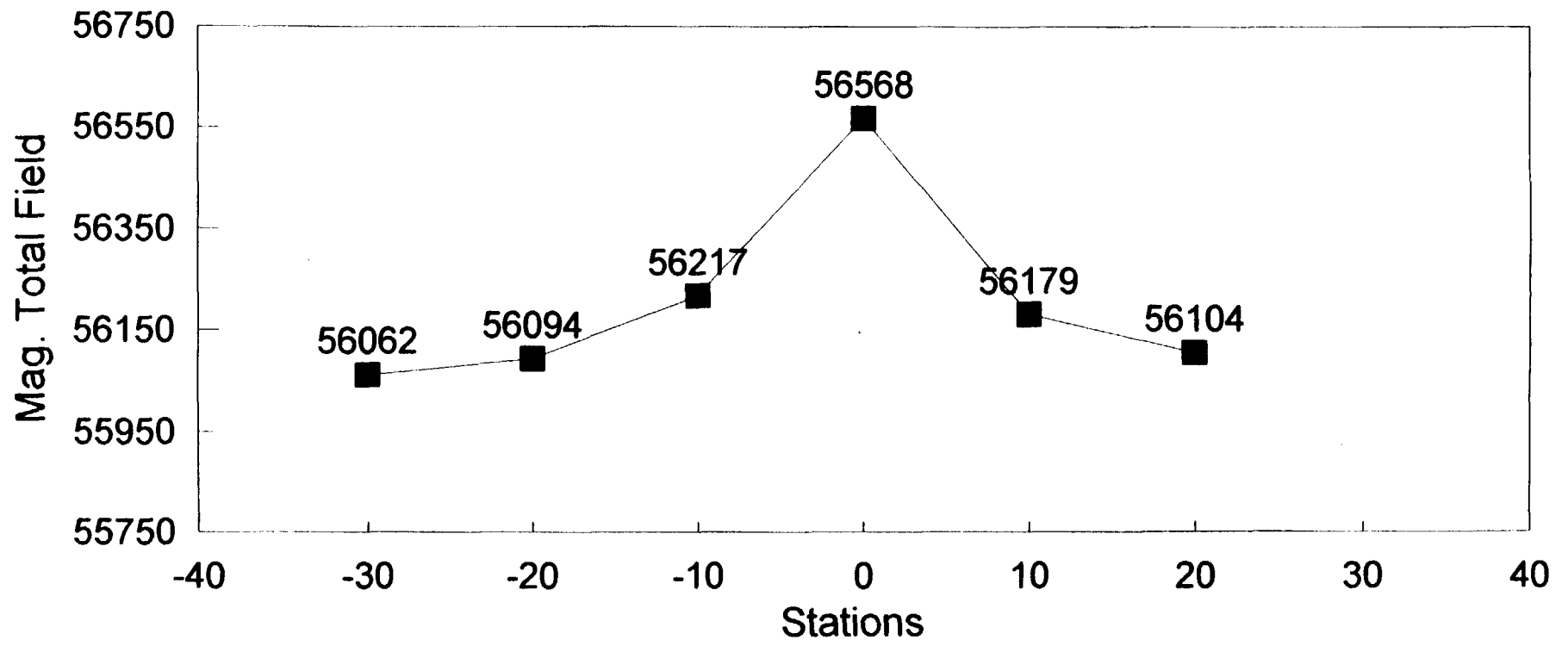

Date: March 30/97

Line	0	
POSITION	FIELD	TIME
-10	36193	10:57:01
0	37175	10:57:57
10	37518	10:58:33
20	38319	10:58:52
30	39017	10:59:10

Line	0+20N	
30	48268	11:01:15
20	56185	11:01:55
10	56108	11:02:26
0	56171	11:02:58
-10	56205	11:03:29
-20	55965	11:04:11
-30	55947	11:05:59

Line	0+40N	
-30	56062	11:06:50
-20	56094	11:07:34
-10	56217	11:08:50
0	56568	11:09:23
10	56179	11:09:45
20	56104	11:10:38

#19	55903	11:28:13
#20	55942	11:29:33
#21	56264	11:30:34

OMNI-PLU Tie-line MAG/VLF V12G Ser #18126
 TOTAL FIELD DATA (uncorrected)

Reference field: 0??0.0
 Datum subtracted: 0?>0.0Date 20 AP ??
 Operator: 3001
 Records: 21
 Bat: 16.7 Volt Lithium: 3.5 Volt
 Last time update: 0.2 10:54:00
 Start of print: 0.190476 12:32:28

Line	0	Date	20	APR	??	#1
POSITION	FIELD	ERR	DRIFT	TIME	DS	CULT
10	36192.9	15	0	10:57:01	42	
10	37174.8	8.9	0	10:57:57	53	
20	37518	9.6	0	10:58:33	52	
30	38318.9	9.4	0	10:58:52	52	
40	39017.4	11	0	10:59:10	52	
-40	48267.8	7.6	0	11:01:15	73	58
-30	56184.5	0.11	0	11:01:55	88	55
-20	56107.8	0.1	0	11:02:26	88	
-10	56170.5	0.1	0	11:02:58	88	
0	56205	0.11	0	11:03:29	88	
10	55964.9	0.1	0	11:04:11	88	
30	55946.9	0.11	0	11:05:59	88	
40	56061.8	0.1	0	11:06:50	88	
0	56093.5	0.1	0	11:07:34	88	
0	56216.8	0.12	0	11:08:50	88	
10	56568.1	0.12	0	11:09:23	88	
20	56179.1	0.09	0	11:09:45	88	
30	56104.4	0.1	0	11:10:38	88	
#19	55902.5	0.11	0	11:28:13	88	
#20	55941.5	0.12	0	11:29:33	88	
#21	56263.7	0.13	0	11:30:34	88	

OMNI-PLU Tie-line MAG/VLF V12G Ser #18126
 TOTAL FIELD DATA (uncorrected)

Reference field: 0
 Datum subtracted: 0
 Operator: 3001
 Records: 21
 Bat: 16.7 Volt Lithium: 3.5 Volt
 Last time update: 0.2 10:54:00
 Start of print: 0.190476 12:32:28

Line	0	Date	Mar/30/97	??	#1
POSITION	FIELD	ERR	DRIFT	TIME	DS CULT
-10	36192.9	15	0	10:57:01	42
0	37174.8	8.9	0	10:57:57	53
10	37518	9.6	0	10:58:33	52
20	38318.9	9.4	0	10:58:52	52
30	39017.4	11	0	10:59:10	52

Line	0+20N				
30	48267.8	7.6	0	11:01:15	73 58
20	56184.5	0.11	0	11:01:55	88 55
10	56107.8	0.1	0	11:02:26	88
0	56170.5	0.1	0	11:02:58	88
-10	56205	0.11	0	11:03:29	88
-20	55964.9	0.1	0	11:04:11	88
-30	55946.9	0.11	0	11:05:59	88

Line	0+40N				
-30	56061.8	0.1	0	11:06:50	88
-20	56093.5	0.1	0	11:07:34	88
-10	56216.8	0.12	0	11:08:50	88
0	56568.1	0.12	0	11:09:23	88
10	56179.1	0.09	0	11:09:45	88
20	56104.4	0.1	0	11:10:38	88
#19	55902.5	0.11	0	11:28:13	88
#20	55941.5	0.12	0	11:29:33	88
#21	56263.7	0.13	0	11:30:34	88

EOF



Geoscience Laboratories
 Ontario GEOservices Centre
 Willet Green Miller Centre
 933 Ramsey Lake Road
 Sudbury, Ontario
 P3E 6B6
 Phone: (705) 870-5632
 Fax: (705) 870-3047

**Geoscience
 Laboratories
 Analytical
 Certificate**

Issued To :
 Mr. A. LeClair
 Capricorn Explorations
 1824 HUNTINGTON DR.,
 SUDBURY ONT Canada
 Phone: 5243319
 FAX:

Certificate Date :	24/10/96
Certificate Number :	001500
GL Job No :	C96-0080
Submission Date :	23/08/96

Test groups reported in this certificate : T21

Status of your Job :

Test Group(s)	# Samples	Elements	Status
T2.1 : ICP-OES	1	Be, Co, Cu, Mo, Ni, Sc, Sr, V, W, Y, Zn	COMPLETE
T2.2 : FA/ICP-OES	1	Au, Pd, Pt	COMPLETE

Please refer to Analytical Certificate Number C96-0080 if you have any questions.

 Graeme Spiers, Ph.D., C.Chem.
 Operations Supervisor
 CHEMIST

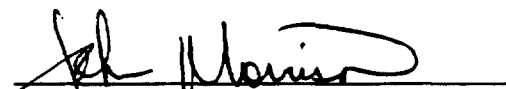
 John Morrison, CET
 Quality Assurance Scientist

Ontario GEOServices Centre
 Geoscience Laboratories
 Certificate of Quality Control
 Trace 2 Elements by ICP-OES QC Report

Report Date : Oct 24 1996
 Batch # : T21-0073

Lab ID	Sample ID	Be	Co	Cu	Mo	Ni	Sc	V	Y	Zn	Sr	W	Comments
C96-0080-001	ORIG	<3.000	775.78	25660.51	<8.00	16149.97	8.871	71.27	5.914	215.41	173.317	<35.0	
C96-0080-001	DUP	<3.000	783.20	25743.23	<8.00	16347.69	8.957	72.62	5.993	216.72	174.219	<35.0	
C96-0080-001	DUPRPD	2.5	1.0	0.3	6.4	1.2	1.0	1.9	1.3	0.6	0.5	6.8	
CCU-1B-0006	INTL_STD	-	-	253154.90	-	-	-	-	-	59253.02	-	-	
ES1-11-0051	INTL_STD	476.314	<5.00	5248.76	514.56	5.29	<1.000	<5.00	<2.000	4981.64	5095.454	508.4	
ES1-8-0057	INTL_STD	47.930	513.35	504.62	51.73	493.60	<1.000	505.72	475.304	548.40	515.426	48.8	
MRB-29-0960	IH_STD	<3.000	48.33	147.78	<8.00	110.72	29.305	307.04	23.777	112.90	308.015	<35.0	
MRG-1-0056	INTL_STD	<3.000	88.00	133.32	<8.00	184.97	47.673	520.44	11.983	184.88	270.406	<35.0	
RBLK-0306	BLANK	<3.000	<5.00	<5.00	<8.00	<5.00	<1.000	<5.00	<2.000	<2.00	<1.000	<35.0	
SU-1A-0053	INTL_STD	<3.000	397.23	10050.22	<8.00	12447.83	15.968	123.64	15.280	163.75	234.447	<35.0	
W-1-0087	INTL_STD	191.304	5.25	825.88	<8.00	10.14	2.525	14.06	4.684	2834.00	204.137	161.8	

***** END OF REPORT *****

Ontario GEOServices Centre
Geoscience Laboratories
Certificate of Analysis
Trace 2 Elements by ICP-OES Final Report

Client : LeClair
Project Number :

Report Date : Oct 24 1996
GL Ref Number : C96-0080

Lab ID	Sample ID	Rep #	Be	Co	Cu	Mo	Ni	Sc	V	Y	Zn	Sr	W	Comments
C96-0080-001	1		<3.000	775.78	25660.51	<8.00	16149.97	8.871	71.27	5.914	215.41	173.317	<35.0	

Total number of samples : 1

Comments pertaining to your samples :

**** END OF REPORT ****

Special Notes : All values in ppm
: <n = Less than lower quantification limit
: >n = Greater than upper quantification limit
: - = Not Measured

Analyst(s) T21 : NE

T21 QC Checked by : JLM

Procedure # : EA-18



Swastika Laboratories

A Division of TSL/Assayers Inc.

Established 1928

Assaying - Consulting - Representation

Assay Certificate

7W-0168-RA1

Company: A. LECLAIR

CAPRICORN (EXPLOR)

Date: JAN-23-97

Project:

970319430

Attn: A. LecLair

1-705-5243319

We hereby certify the following Assay of 1 Rock samples submitted JAN-20-97 by .

Sample Number	Au oz/ton	Au Check oz/ton	Co %	Cu %	Ni %	Zn %	Pt oz/ton	Pd oz/ton
No #	0.024	0.027	0.090	4.08	1.88	0.025	0.023	0.013

Swastika LAB.,

Certified by

STRALAK TOWNSHIP
GEOPHYSICAL SURVEY CONDUCTED
ON CLAIM 1211398

To: Mine Recorder

From: Paul St. Pierre, Cambrian College Student

Date: April 11, 1997

Subject: Survey Report

Mine Recorder

A survey was conducted on claim number 1211398 on March 29th, and 30th, 1997. The survey shows that there is an anomaly that starts on the baseline (AZ 26°) at line 0+20N and continues on to line 0+40N.

The survey was conducted by Paul St. Pierre, a Cambrian College student studying geology and geophysics. Fees were paid by Mr. Leclair for the survey to Paul St. Pierre.

Sincerely

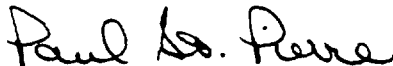



Paul St. Pierre

enc: Tables, Graphs, Map

2.17572

LEGEND

	RAIL ROAD MILE MARKER
	CLAIM POST
	TRAIN STOP



C.P. RAIL ROAD

PATH CREEK

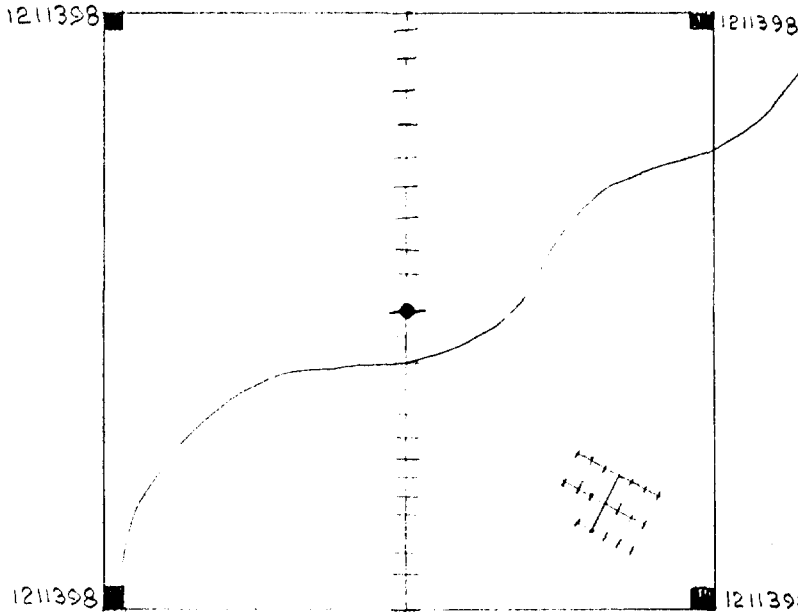

RECEIVED
 AUG 14 1997
 MINING LANDS BRANCH

RECEIVED
 AUG 05 1997
 10:00 AM
 GEOSCIENCE ASSESSMENT OFFICE

CARTIER

STRALAK TWP.	
GEOPHYSICAL SURVEY	
DATE: 4/11/97	SCALE: 1:5000
DONE BY: PAUL ST. PIERRE	DRWN BY: PAUL ST. PIERRE
Qual # 2.17572	

STRALAK TOWNSHIP
GEOPHYSICAL SURVEY CONDUCTED
ON CLAIM 1211398

To: Mine Recorder

From: Paul St. Pierre, Cambrian College Student

Date: April 11, 1997

Subject: Survey Report

Mine Recorder

A survey was conducted on claim number 1211398 on March 29th, and 30th, 1997. The survey shows that there is an anomaly that starts on the baseline (AZ 26°) at line 0+20N and continues on to line 0+40N.

The survey was conducted by Paul St. Pierre, a Cambrian College student studying geology and geophysics. Fees were paid by Mr. Leclair for the survey to Paul St. Pierre.

Sincerely

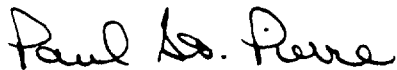

Paul St. Pierre

enc: Tables, Graphs, Map

Line 0+00
Stralak Township

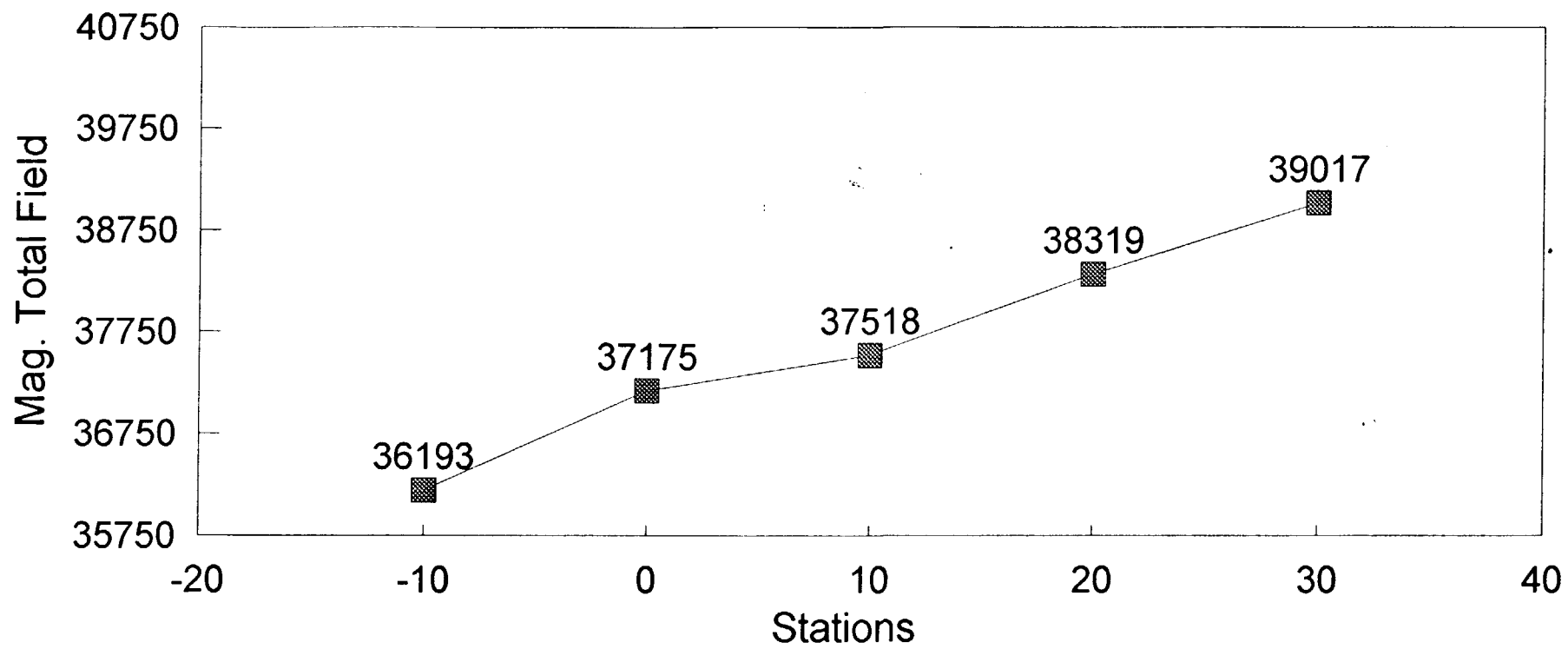

Line 0+20 N
Stralak Township

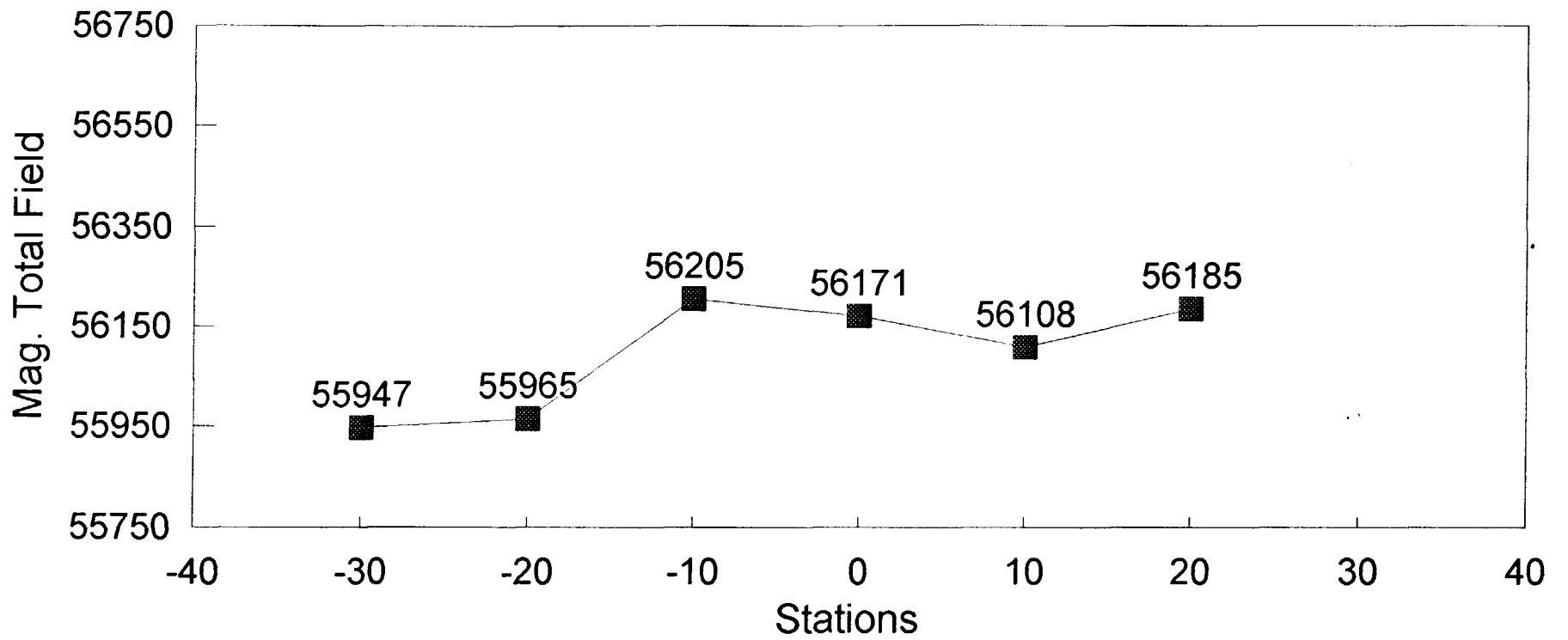

Line 0+40N
Stralak Township

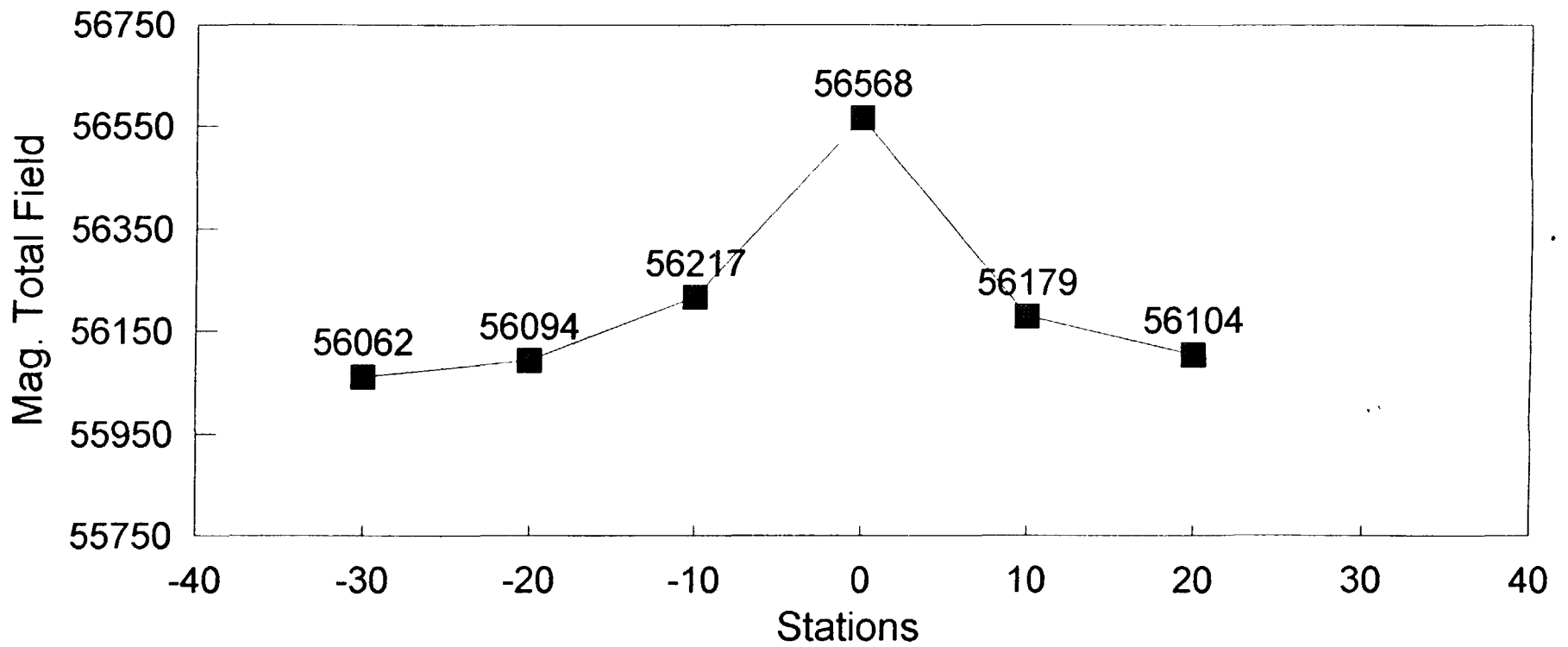

Date: March 30/97

Line	0	
POSITION	FIELD	TIME
-10	36193	10:57:01
0	37175	10:57:57
10	37518	10:58:33
20	38319	10:58:52
30	39017	10:59:10

Line	0+20N	
30	48268	11:01:15
20	56185	11:01:55
10	56108	11:02:26
0	56171	11:02:58
-10	56205	11:03:29
-20	55965	11:04:11
-30	55947	11:05:59

Line	0+40N	
-30	56062	11:06:50
-20	56094	11:07:34
-10	56217	11:08:50
0	56568	11:09:23
10	56179	11:09:45
20	56104	11:10:38

#19	55903	11:28:13
#20	55942	11:29:33
#21	56264	11:30:34

OMNI-PLU Tie-line MAG/VLF V12G Ser #18126
 TOTAL FIELD DATA (uncorrected)

Reference field: 0??0.0
 Datum subtracted: 0?>0.0Date 20 AP ??
 Operator: 3001
 Records: 21
 Bat: 16.7 Volt Lithium: 3.5 Volt
 Last time update: 0.2 10:54:00
 Start of print: 0.190476 12:32:28

Line	0	Date	20	APR	??	#1
POSITION	FIELD	ERR	DRIFT	TIME	DS	CULT
10	36192.9	15	0	10:57:01	42	
10	37174.8	8.9	0	10:57:57	53	
20	37518	9.6	0	10:58:33	52	
30	38318.9	9.4	0	10:58:52	52	
40	39017.4	11	0	10:59:10	52	
-40	48267.8	7.6	0	11:01:15	73	58
-30	56184.5	0.11	0	11:01:55	88	55
-20	56107.8	0.1	0	11:02:26	88	
-10	56170.5	0.1	0	11:02:58	88	
0	56205	0.11	0	11:03:29	88	
10	55964.9	0.1	0	11:04:11	88	
30	55946.9	0.11	0	11:05:59	88	
40	56061.8	0.1	0	11:06:50	88	
0	56093.5	0.1	0	11:07:34	88	
0	56216.8	0.12	0	11:08:50	88	
10	56568.1	0.12	0	11:09:23	88	
20	56179.1	0.09	0	11:09:45	88	
30	56104.4	0.1	0	11:10:38	88	
#19	55902.5	0.11	0	11:28:13	88	
#20	55941.5	0.12	0	11:29:33	88	
#21	56263.7	0.13	0	11:30:34	88	

OMNI-PLU Tie-line MAG/VLF V12G Ser #18126
TOTAL FIELD DATA (uncorrected)

Reference field: 0
Datum subtracted: 0
Operator: 3001
Records: 21
Bat: 16.7 Volt Lithium: 3.5 Volt
Last time update: 0.2 10:54:00
Start of print: 0.190476 12:32:28

Line	0	Date	Mar/30/97	??	#1
POSITION	FIELD	ERR	DRIFT	TIME	DS CULT
-10	36192.9	15	0	10:57:01	42
0	37174.8	8.9	0	10:57:57	53
10	37518	9.6	0	10:58:33	52
20	38318.9	9.4	0	10:58:52	52
30	39017.4	11	0	10:59:10	52

Line	0+20N				
30	48267.8	7.6	0	11:01:15	73 58
20	56184.5	0.11	0	11:01:55	88 55
10	56107.8	0.1	0	11:02:26	88
0	56170.5	0.1	0	11:02:58	88
-10	56205	0.11	0	11:03:29	88
-20	55964.9	0.1	0	11:04:11	88
-30	55946.9	0.11	0	11:05:59	88

Line	0+40N				
-30	56061.8	0.1	0	11:06:50	88
-20	56093.5	0.1	0	11:07:34	88
-10	56216.8	0.12	0	11:08:50	88
0	56568.1	0.12	0	11:09:23	88
10	56179.1	0.09	0	11:09:45	88
20	56104.4	0.1	0	11:10:38	88
#19	55902.5	0.11	0	11:28:13	88
#20	55941.5	0.12	0	11:29:33	88
#21	56263.7	0.13	0	11:30:34	88

EOF

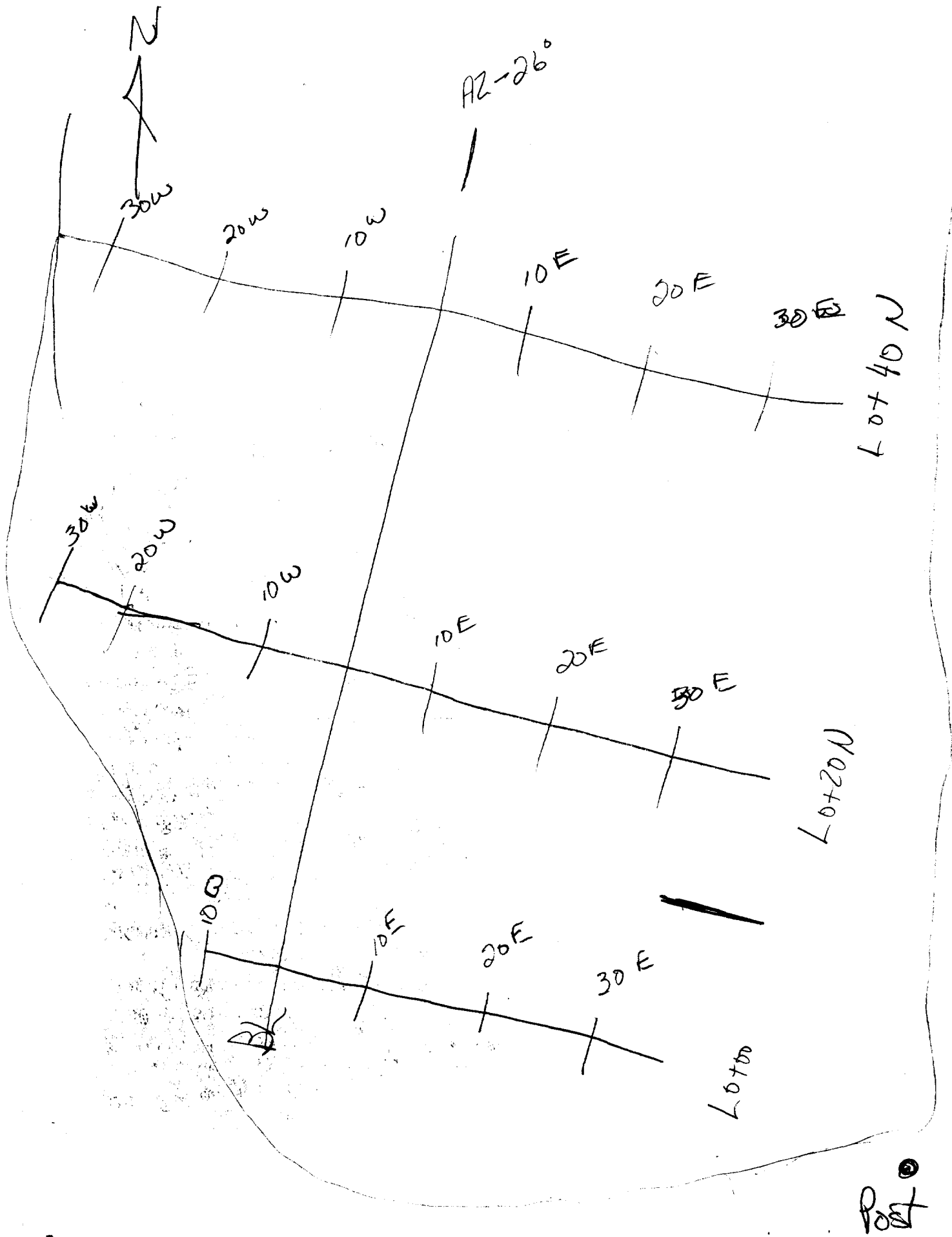

N

ZONE 17

440000mE

10

81°46'

20

30

81°44'

40

MORSE TOWNSHIP

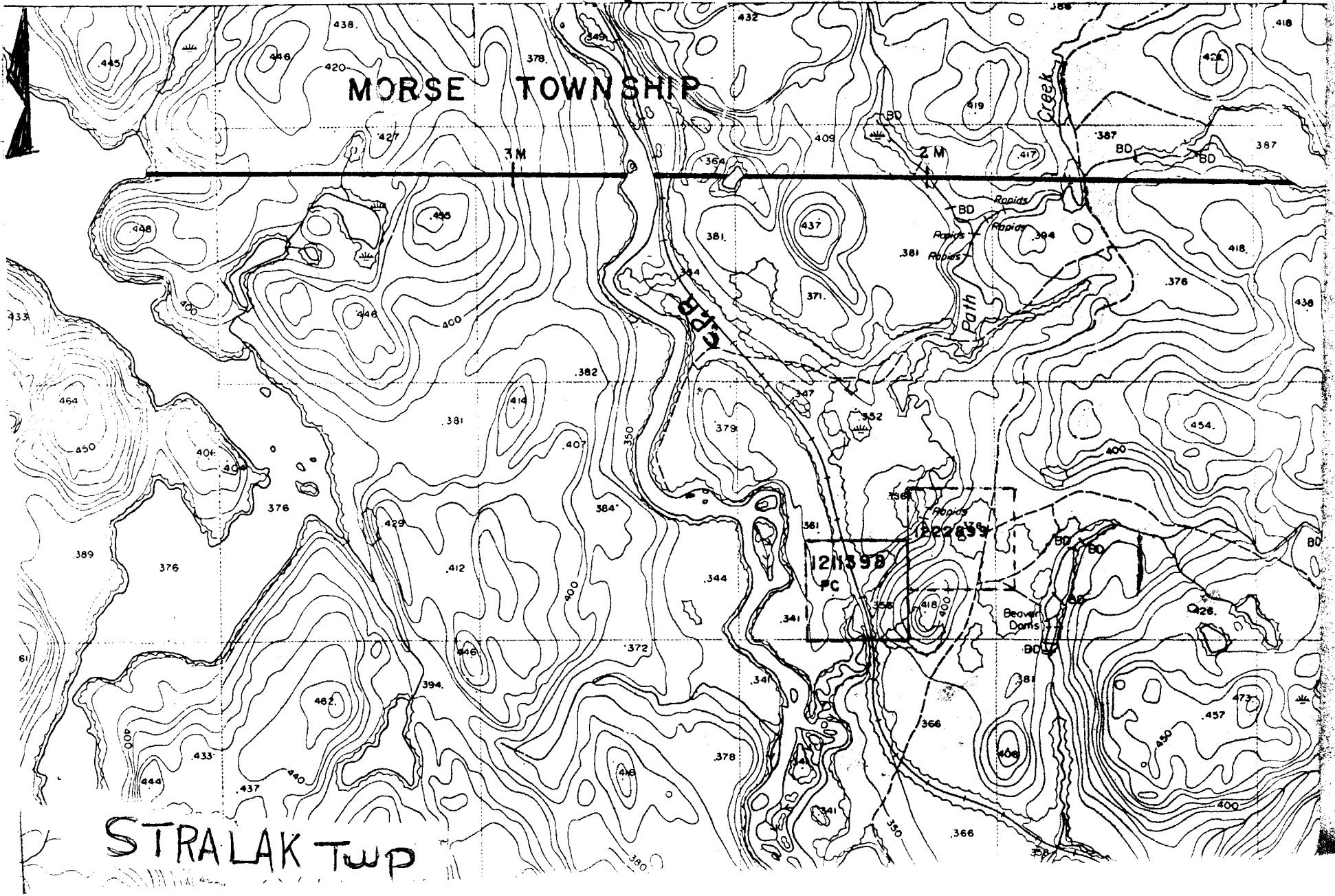

STRALAK TWP



Geoscience Laboratories
 Ontario GEOservices Centre
 Willet Green Miller Centre
 933 Ramsey Lake Road
 Sudbury, Ontario
 P3E 6B5
 Phone: (705) 870-5632
 Fax: (705) 870-3047

**Geoscience
 Laboratories
 Analytical
 Certificate**

Issued To: Mr. A. LeClair
 Capricorn Explorations
 1524 HUNTINGTON DR.,
 SUDBURY ONT Canada
 Phone: 5243319
 FAX:

Certificate Date :	24/10/96
Certificate Number :	001500
GL Job No :	C96-0080
Submission Date :	23/08/96

Test groups reported in this certificate : T21

Status of your Job :

Test Group(s)	# Samples	Elements	Status
T2.1 : ICP-OES	1	Be, Co, Cu, Mo, Ni, Sc, Sr, V, W, Y, Zn	COMPLETE
T2.2 : FA/ICP-OES	1	Au, Pd, Pt	COMPLETE

Please refer to Analytical Certificate Number C96-0080 if you have any questions.

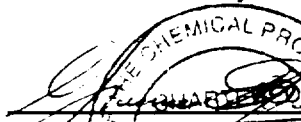
 Graeme Spiers, Ph.D., Chem
 Operations Supervisor
 CHEMIST

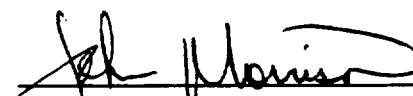
 John Morrison, CET
 Quality Assurance Scientist

Ontario GEOservices Centre
 Geoscience Laboratories
 Certificate of Quality Control
 Trace 2 Elements by ICP-OES QC Report

Report Date : Oct 24 1996
 Batch # : T21-0073

Lab ID	Sample ID	Be	Co	Cu	Mo	Ni	Sc	V	Y	Zn	Sr	W	Comments
C96-0080-001	ORIG	<3.000	775.78	25660.51	<8.00	16149.97	8.871	71.27	5.914	215.41	173.317	<35.0	
C96-0080-001	DUP	<3.000	783.20	25743.23	<8.00	16347.69	8.957	72.62	5.993	216.72	174.219	<35.0	
C96-0080-001	DUPRPD	2.5	1.0	0.3	6.4	1.2	1.0	1.9	1.3	0.6	0.5	6.8	
CCU-18-0006	INTL_STD	-	-	253154.90	-	-	-	-	-	59253.02	-	-	
ESI-11-0051	INTL_STD	476.314	<5.00	5248.76	514.56	5.29	<1.000	<5.00	<2.000	4981.64	5095.454	508.4	
ESI-8-0057	INTL_STD	47.930	513.35	504.62	51.73	493.60	<1.000	505.72	475.304	548.40	515.426	48.8	
MRB-29-0960	IH_STD	<3.000	48.33	147.78	<8.00	110.72	29.305	307.04	23.777	112.90	308.015	<35.0	
MRG-1-0056	INTL_STD	<3.000	88.00	133.32	<8.00	184.97	47.673	520.44	11.983	184.88	270.406	<35.0	
RBLK-0306	BLANK	<3.000	<5.00	<5.00	<8.00	<5.00	<1.000	<5.00	<2.000	<2.00	<1.000	<35.0	
SU-1A-0053	INTL_STD	<3.000	397.23	10050.22	<8.00	12447.83	15.968	123.64	15.280	163.75	234.447	<35.0	
W-1-0087	INTL_STD	191.304	5.25	825.88	<3.00	10.14	2.525	14.06	4.684	2834.00	204.137	161.8	

***** END OF REPORT *****

Ontario GEOServices Centre
Geoscience Laboratories
Certificate of Analysis
Trace 2 Elements by ICP-OES Final Report

Client : LeClair
Project Number :

Report Date : Oct 24 1996
GL Ref Number : C96-0080

Lab ID	Sample ID	Rep #	Be	Co	Cu	Mo	Ni	Sc	V	Y	Zn	Sr	W	Comments
C96-0080-001	1		<3.000	775.78	25660.51	<8.00	16149.97	8.871	71.27	5.914	215.41	173.317	<35.0	

Total number of samples : 1

Comments pertaining to your samples :

**** END OF REPORT ****

Special Notes : All values in ppm
: <n = Less than lower quantification limit
: >n = Greater than upper quantification limit
: - = Not Measured

Analyst(s) T21 : NE

T21 QC Checked by : JLM

Procedure # : EA-18



Ministry of
Northern Development
and Mines

Ontario

Ministère du
Développement du Nord
et des Mines

Official Receipt
Reçu officiel

Date / Date

Apr 15/97

Received From / Reçu de

Ronald Lefair

Address / Adresse

1824 Huntington, Sudbury

<i>1 Asty prep</i>		<i>10.00</i>
<i>1 T2.1</i>		<i>27.00</i>
<i>1 T2.2</i>		<i>54.00</i>
	<i>GST</i>	<i>6.37</i>

Cash Argent	Cheque Chèque	Money Ord Mandat	Total/ Total	<i>97.37</i>
<input checked="" type="checkbox"/>	<input type="checkbox"/>	<input type="checkbox"/>		

Signature of Authorized Official / Signataire autorisé

[Signature]

Mailing Address of Local Headquarters / Adresse postale du bureau local

NGMC-Geoscience LAB

C 0511

Payer's Receipt
Reçu du souscripteur

Swastika Laboratories
 P.O. Box 10
 Swastika, Ontario
 P0K 1T0

INVOICE

NO.: 00039402

DATE: 02/05/97

PAGE: 1

SOLD TO:

SHIP TO:

A. LECLAIR
 1824 HUNTINGTON DRIVE
 SUDBURY ONTARIO
 P3A 1J6

Same

GST Number: R132862640 Proj #/P.O. # N/A

ITEM NO.	QUANTITY	UNIT	DESCRIPTION	GST/PS*	UNIT PRICE	AMOUNT
	1		Au		8.00	8.00
	1		Co		7.25	7.25
	1		Cu		4.00	4.00
	1		Ni		4.00	4.00
	1		Zn		4.00	4.00
	1		Pt & Pd		12.00	12.00
	1		Sample Prep		3.50	3.50
			Cert #7W-0168-RA1			
			GST @ 7%			3.00
COMMENTS						
Net 30 Days					TOTAL	45.75

02/10/97



Swastika Laboratories

A Division of TSL/Assayers Inc.

Assaying - Consulting - Representation

Established 1928

Assay Certificate

7W-0168-RA1

Company: **A. LECLAIR** **CAPRICORN (EXPLOR)**
Project:
Attn: **A. LecLair**
970319430

Date: JAN-23-97

ROCK

1-705-5243319

We hereby certify the following Assay of 1 Rock samples submitted JAN-20-97 by .

Sample Number	Au oz/ton	Au Check oz/ton	Co %	Cu %	Ni %	Zn %	Pt oz/ton	Pd oz/ton
No #	0.024	0.027	0.090	4.08	1.88	0.025	0.023	0.013

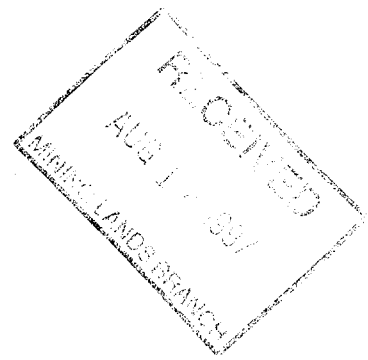

Certified by *G. Leclair*

CAPRICORN EXPLORATIONS
1824 HUNTINGTON DRIVE
SUDBURY, ONTARIO
P3A 1J6
524-3319 or 566-9488

2.17572

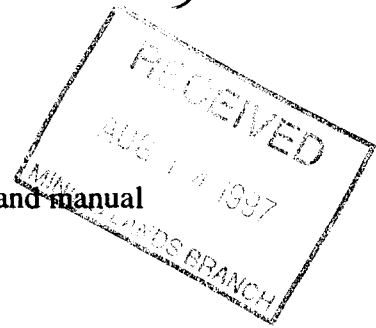
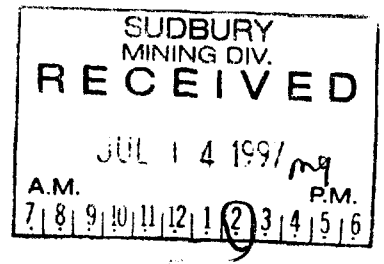

To whom it may concern:

July 10, 1997

CLAIM NO. 1211398:

Physical work, sample collecting, observing and manual labour for claim on Stralak Township.

May 18-19/96

Prospecting and collecting:
10 hours x 2 days=20 hours at \$10.00 per hour=\$200.00
Transportation: Bud Car-C.P. (Via Rail) in the amount of
\$34.24 Return

TOTAL - \$234.24

June 15-16/96 -

Prospecting and collecting (digging) samples, observing on surface for an Assay Report.
10 hours x 2 days=20 hours at \$10.00 per hour=\$200.00
Transportation: Bud Car-C.P. (Via Rail) in the amount of
\$34.24 Return

TOTAL-\$234.24

July 27-28/96-

Prospecting, observing, digging, sample collection at curve of Path Creek on claim.
10 hours x 2 days=20 hours at \$10.00 per hour=\$200.00
Transportation: Bud Car-C.P. (Via Rail) in the amount of
\$34.24 Return

TOTAL-\$234.24

March 15-16/97-

Assisted: A. Leclair; owner/pro prospector and Paul St. Pierre, a 2nd year Cambrian College student studying geology and geophysics.
Transportation and food-\$120.00
Physical work (14 hours)-\$100.00

TOTAL-\$220.00

March 29-30/97

Paid Paul St.Pierre; Cambrian College Student for a Magnetometer Survey on Claim No.1211398 in the sum of three hundred forty dollars.
Hours worked: 34x\$10.00/hr=\$340.00

TOTAL:\$340.00

March 29-30/97

For: A Leclair;owner/pro prospector
Assisted: Paul St.Pierre observing, setting up and supervising grid lines and markers on Claim No.1211398
Hours worked: 34x\$10.00/hr=\$340.00
Transportation: Bud Car-C.P. (Via Rail) at \$34.24/person return fare for three people: in the amount of \$102.72

TOTAL: \$442.72

Plus Assay Cost add



Ministry of
Northern Development
and Mines

**Declaration of Assessment Work
Performed on Mining Land**

Transaction Number (Office Use)
W9730.00614
Assessment Files Research Imaging



41113NW0001 2.17572 STRALAK

Personal information collected
Mining Act, the information
Questions about this code
933 Ramsey Lake Road, Sudbury, Ontario, L6P 6R6

90) of the Mining Act. Under section 8 of the
and correspond with the mining land holder
Northern Development and Mines, 6th Floor,

**SUDBURY
MINING DIV.
RECEIVED**
0240. JUL 14 1997
A.M. 7 8 9 10 11 12 1 2 3 4 5 6 P.M.

2.17572

Instructions: - For work performed on Crown Lands before recording a claim, use form
- Please type or print in ink.

1. Recorded holder(s) (Attach a list if necessary)

Name ANDRÉ J. Leclair	Client Number 158459
Address 1824 Huntington Dr. P3A1J6 Sudbury Ontario	Telephone Number 566 9488 or 524 3310
Name	Fax Number
Client Number	158459 - A.J.L
Telephone Number	
Fax Number	

2. Type of work performed: Check (✓) and report on only ONE of the following groups for this declaration.

Geotechnical: prospecting, surveys, assays and work under section 18 (regs) Physical: drilling, stripping, trenching and associated assays Rehabilitation

Work Type	Office Use
Commodity	
Total \$ Value of Work Claimed	\$1,407
Dates Work Performed From 18 5 96 To 29 3 97	NTS Reference
Global Positioning System Data (if available)	Township/Area STRALAK TWP
M or G-Plan Number	Mining Division SUDBURY
	Resident Geologist District SUDBURY

Please remember to: - obtain a work permit from the Ministry of Natural Resources as required;
- provide proper notice to surface rights holders before starting work;
- complete and attach a Statement of Costs, form 0212;
- provide a map showing contiguous mining lands that are linked for assigning work;
* include two copies of your technical report.

3. Person or companies who prepared the technical report (Attach a list if necessary)

Name Paul St. Pierre	Telephone Number 525 1548
Address 46 Neelon Av, Sudbury Ontario	Fax Number
Name	Telephone Number
Address	Fax Number
Name	Telephone Number
Address	Fax Number

4. Certification by Recorded Holder or Agent

I, **ANDRÉ J. Leclair** (Print Name), do hereby certify that I have personal knowledge of the facts set forth in this Declaration of Assessment Work having caused the work to be performed or witnessed the same during or after its completion and, to the best of my knowledge, the annexed report is true.

Signature of Recorded Holder or Agent André J. Leclair	Date July 14/97
Agent's Address	Telephone Number
	Fax Number

Deemed Done Oct 12/97

5. Work to be recorded and distributed. Work can only be assigned to claims that are contiguous (adjoining) to the mining land where work was performed, at the time work was performed. A map showing the contiguous link must accompany this form.

Mining Claim Number. Or if work was done on other eligible mining land, show in this column the location number indicated on the claim map.	Number of Claim Units. For other mining land, list hectares.	Value of work performed on this claim or other mining land.	Value of work applied to this claim.	Value of work assigned to other mining claims.	Bank. Value of work to be distributed at a future date.
eg TB 7827	16 ha	\$26,825	N/A	\$24,000	\$2,825
eg 1234567	12	\$24,000	\$24,000	0	0
eg 1234568	2	\$8,892	\$4,000	0	\$4,892
1 1211398	16 ha	\$1,406.89	\$800.00	\$800.00	\$606.89
2					
3					
4					
5					
6					
7					
8					
9					
10					
11					
12					
13					
14					
15					
Column Totals		\$1,406.89	\$800.00	\$800.00	\$606.89

RECEIVED
 AUG 14 1997
 MINING LANDS BRANCH

I, André J. Leclair, do hereby certify that the above work credits are eligible under subsection 7 (1) of the Assessment Work Regulation 6/96 for assignment to contiguous claims or for application to the claim where the work was done.

Signature of Recorded Holder or Agent Authorized in Writing

André J. Leclair

Date

July 14/97

6. Instructions for cutting back credits that are not approved.

Some of the credits claimed in this declaration may be cut back. Please check (✓) in the boxes below to show how you wish to prioritize the deletion of credits:

- 1. Credits are to be cut back from the Bank first, followed by option 2 or 3 or 4 as indicated.
- 2. Credits are to be cut back starting with the claims listed last, working backwards; or
- 3. Credits are to be cut back equally over all claims listed in this declaration; or
- 4. Credits are to be cut back as prioritized on the attached appendix or as follows (describe):

2.17572

Note: If you have not indicated how your credits are to be deleted, credits will be cut back from the Bank first, followed by option number 2 if necessary.

For Office Use Only

Received Stamp	Deemed Approved Date	Date Notification Sent
	Date Approved	Total Value of Credit Approved
Approved for Recording by Mining Recorder (Signature)		

2.17572

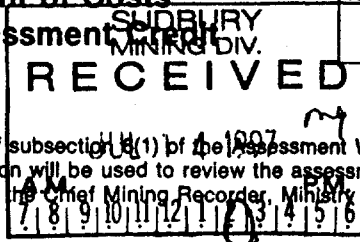

W9770.00618

Personal information collected on this form is obtained under the authority of subsection 4(1) of the Assessment Work Regulation 6/96. Under section 8 of the Mining Act, the information is a public record. This information will be used to review the assessment work and correspond with the mining land holder. Questions about this collection should be directed to the Chief Mining Recorder, Ministry of Northern Development and Mines, 6th Floor, 933 Ramsey Lake Road, Sudbury, Ontario, P3E 6B5.

Work Type	Units of Work <small>Depending on the type of work, list the number of hours/days worked, metres of drilling, kilometres of grid line, number of samples, etc.</small>	Cost Per Unit of work	Total Cost
Prospecting	one claim		\$1163.70
Observing	No.		
Manual Labour	1211398		
Digging			
Magnetometer (Survey)			
Assays		+ Assays Cost	\$143.12
Reports			
Associated Costs (e.g. supplies, mobilization and demobilization).			
Transportation Costs	Attached See Report		
Food and Lodging Costs			\$100.00
Total Value of Assessment Work			1263.72
+ Assay Cost			143.12
			\$1406.84

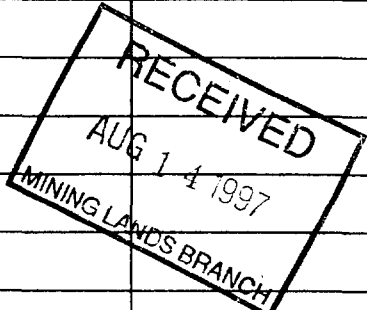

Calculations of Filing Discounts:

1. Work filed within two years of performance is claimed at 100% of the above Total Value of Assessment Work.
2. If work is filed after two years and up to five years after performance, it can only be claimed at 50% of the Total Value of Assessment Work. If this situation applies to your claims, use the calculation below:

TOTAL VALUE OF ASSESSMENT WORK × 0.50 = Total \$ value of worked claimed.

Note:

- Work older than 5 years is not eligible for credit.
- A recorded holder may be required to verify expenditures claimed in this statement of costs within 45 days of a request for verification and/or correction/clarification. If verification and/or correction/clarification is not made, the Minister may reject all or part of the assessment work submitted.

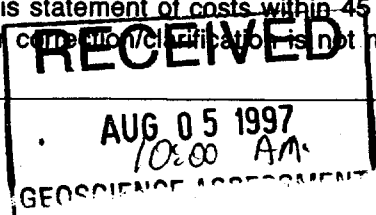

Certification verifying costs:

I, ANDRÉ J. Leclair, do hereby certify, that the amounts shown are as accurate as may reasonably be determined and the costs were incurred while conducting assessment work on the lands indicated on the accompanying Declaration of Work form as _____ I am authorized to make this certification.

Signature: André J. Leclair Date: July 14/97

November 12, 1997

ANDRE JOSEPH LECLAIR
1824 HUNTINGTON DRIVE
SUDBURY, Ontario
P3A-1J6

Geoscience Assessment Office
933 Ramsey Lake Road
6th Floor
Sudbury, Ontario
P3E 6B5

Telephone: (888) 415-9846
Fax: (705) 670-5863

Dear Sir or Madam:

Submission Number: 2.17572

Status

Subject: Transaction Number(s): W9770.00614 Approval After Notice

We have reviewed your Assessment Work submission with the above noted Transaction Number(s). The attached summary page(s) indicate the results of the review. **WE RECOMMEND YOU READ THIS SUMMARY FOR THE DETAILS PERTAINING TO YOUR ASSESSMENT WORK.**

If the status for a transaction is a 45 Day Notice, the summary will outline the reasons for the notice, and any steps you can take to remedy deficiencies. The 90-day deemed approval provision, subsection 6(7) of the Assessment Work Regulation, will no longer be in effect for assessment work which has received a 45 Day Notice.

Please note any revisions must be submitted in **DUPLICATE** to the Geoscience Assessment Office, by the response date on the summary.

If you have any questions regarding this correspondence, please contact Steve Beneteau by e-mail at beneteau_s@torv05.ndm.gov.on.ca or by telephone at (705) 670-5855.

Yours sincerely,



ORIGINAL SIGNED BY
Blair Kite
Supervisor, Geoscience Assessment Office
Mining Lands Section

Work Report Assessment Results

Submission Number: 2.17572

Date Correspondence Sent: November 12, 1997

Assessor: Steve Beneteau

Transaction Number	First Claim Number	Township(s) / Area(s)	Status	Approval Date
W9770.00614	1211398	STRALAK	Approval After Notice	November 10, 1997

Section:

14 Geophysical MAG
9 Prospecting PROSP

All deficiencies associated with this submission have been corrected. Accordingly, assessment work credit has been approved as outlined on the Report of Work form accompanying this submission.

Correspondence to:

Resident Geologist
Sudbury, ON

Recorded Holder(s) and/or Agent(s):

ANDRE JOSEPH LECLAIR
SUDBURY, Ontario

Assessment Files Library
Sudbury, ON



Ministry of
Natural Resources
Ontario

Ministry of
Northern Development
and Mines



200

INDEX TO LAND DISPOSITION

PLAN
G-4106
TOWNSHIP

STRALAK

M.N.R. ADMINISTRATIVE DISTRICT
SUDBURY
MINING DIVISION
SUDBURY
LAND TITLES/REGISTRY DIVISION
SUDBURY

DATE OF ISSUE

OCT 07 1987

Scale 1:20 000

PROVINCIAL RECORDING
OFFICE - SUDBURY



Contour Interval 10 Metres

AREAS WITHDRAWN FROM DISPOSITION

MRO - Mining Rights Only
SRO - Surface Rights Only
M+S - Mining and Surface Rights

SYMBOLS

Description	Order No.	Date	Disposition	File
Boundary				
Township, Meridian, Baseline				
Road allowance; surveyed				
shoreline				
Lot/Concession; surveyed				
unsurveyed				
Parcel; surveyed				
unsurveyed				
Right-of-way; road				
railway				
utility				
Reservation				
Cliff, Pit, Pile				
Contour				
Interpolated				
Approximate				
Depression				
Control point (horizontal)				
Flooded land				
Mine head frame				
Pipeline (above ground)				
Railway; single track				
double track				
abandoned				
Road; highway, county, township				
access				
trail, bush				
Shoreline (original)				
Transmission line				
Wooded area				

NOTES

L.O. 912 for flooding of land to contour elevation 107' on Pogamosing Lake.

DISPOSITION OF CROWN LANDS

Patent	
Surface & Mining Rights	●
Surface Rights Only	○
Mining Rights Only	○
Lease	
Surface & Mining Rights	■
Surface Rights Only	□
Mining Rights Only	□
Licence of Occupation	▼
Order-in-Council	OC
Cancelled	⊙
Reservation	⊙
Sand & Gravel	⊙
LAND USE PERMIT	
REMOTE TOURIST SET-UP	RTS
PLACER CLAIM	PC

THE INFORMATION THAT APPEARS ON THIS MAP HAS BEEN COMPILED FROM VARIOUS SOURCES, AND ACCURACY IS NOT GUARANTEED. THOSE WISHING TO STAKE MINING CLAIMS SHOULD CONSULT WITH THE MINING RECORDER, MINISTRY OF NORTHERN DEVELOPMENT AND MINES, FOR ADDITIONAL INFORMATION ON THE STATUS OF THE LANDS SHOWN HEREON.

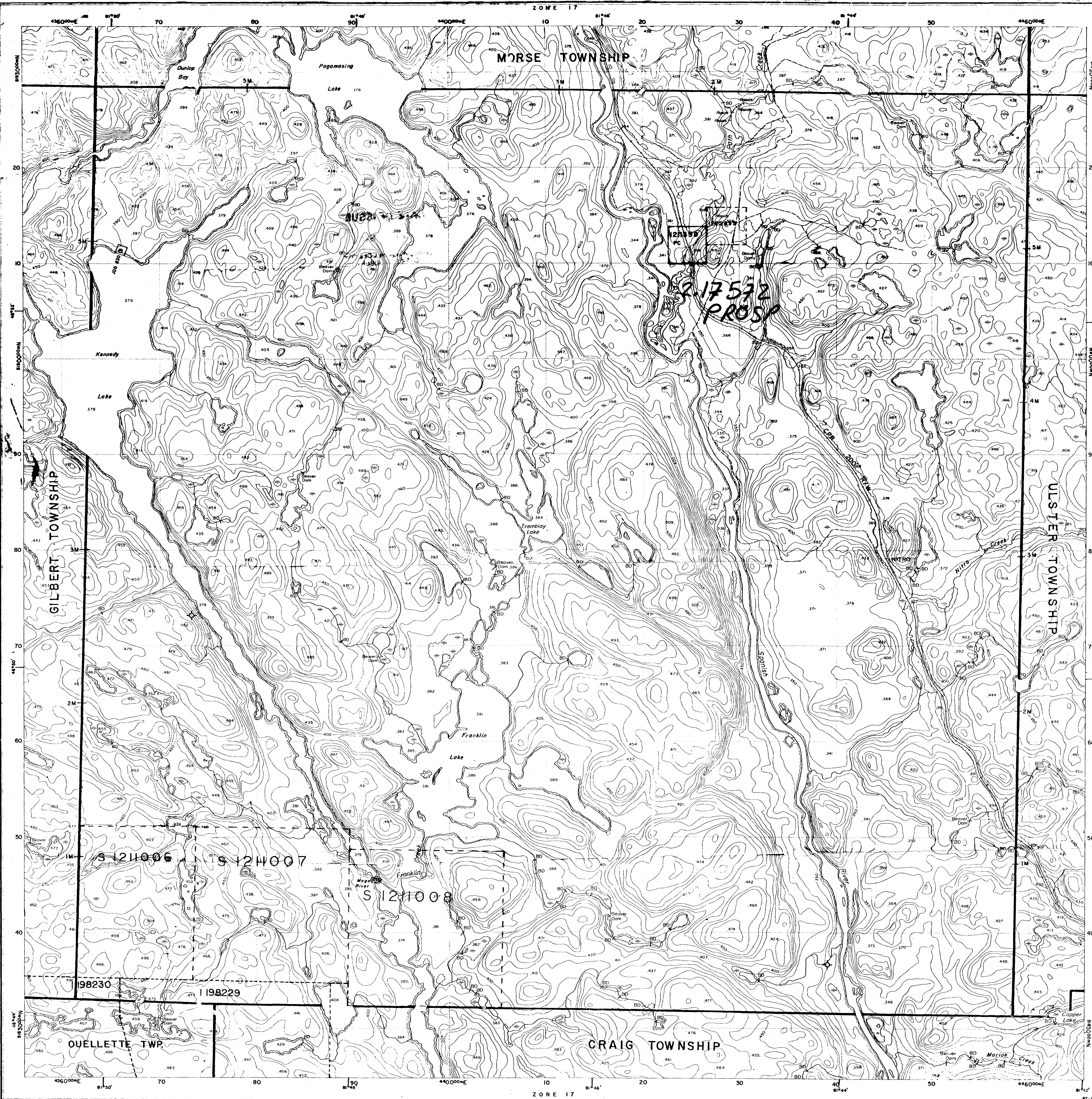

4106

STRALAK TOWNSHIP

G-4106