

Diamond Drilling

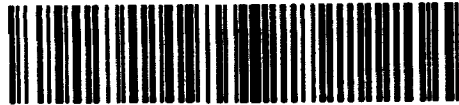

41113SE0010 0011B1 MUNSTER

010

Township of MUNSTER

Report N^o: 14

Work performed by: B & H Explorations Limited

Claim N ^o	Hole N ^o	Footage	Date	Note
S 91527	#2	542.0'	Jan/57	
	#1	345.0'	Dec/56	
	#1	106.0'	Oct/58	
	#2	75.0'	Oct/58	
	#3	90.0'	Oct/58	
	#4	103.0'	Oct/58	
	#5	106.0'	Oct/58	
	#6	91.0'	Nov/58	
	#7	50.0'	Nov/58	
	#8	100.0'	Nov/58	

TOTAL 10 DH 1608 FT

Notes:

Property B & M Exploration Ltd.

Minister Allen Tpo

DIAMOND DRILL RECORD

Hole No. 2 Sheet No. 1 Lat. 1 + 65 N Total Depth 542.0'
 Section 2 Dep. 0 + 00 Elev. Collar _____
 Date begun Jan. 5, 1957 Bearing 140° Elev. Bottom _____
 Date finished Jan. 22, 1957 Angle 45°

DEPTH FEET	FORMATION	SAMPLE NO.	WIDTH OF SAMPLE	GOLD g	SLUDGE GOLD. g
0-7.0	Casing				
7.0-19.0	Chlorite Schist				
19.0-25.3	Mixed chlorite schist & fine grained silicified material (rhyolite?) 3" specular hematite & pyrite @ 23.0				
25.3-63.6	Chlorite schist - highly altered - mixed with blue qtz - some brecciation.				
63.6-111.8	Chlorite schist - siliceous section with some narrow calcite stringers @ 67.0-68.5 102.4-103.4 breccia with calcite & a few angular remnants of qtz.				
111.8-119.4	Banded chlorite schist & rhyolite (?) banding parallel to core.				
119.4-153.8	Chlorite schist - highly altered - as 25.3-63.6				
153.8-156.6	Chlorite schist - with a few vuggy section containing specular hematite and magnetite.				
156.6-322.0	Chlorite schist - 238.0-239.0 breccia with calcite & quartz. 260.8-261.1 specular hematite & magnetite 275.5-275.7 " " " & chlorite.				
322.0-326.3	Granite - containing about equal amounts plagioclase & orthoclase feldspar.				
326.3-334.2	Chlorite schist				
334.2-363.3	Granite - as above				
363.3-365.2	Chlorite schist				

(see page 2)

Property B & M Exploration Ltd.

DIAMOND DRILL RECORD

Hole No. 1 Sheet No. 1 Lat. 0400 Total Depth 345.0'
 Section _____ Dep. 0-00 Elev. Collar _____
 Date begun December 14, 1956 Bearing 140° Elev. Bottom _____
 Date finished December 29, 1956 Angle 45°

DEPTH FEET	FORMATION	SAMPLE NO.	WIDTH OF SAMPLE	GOLD		SLUDGE	
				g	g	GOLD. g	g
0-15.0	Casing (overburden, boulders and 2.0' of bedrock)						
15.0-21.0	Chloritized Greenstone						
21.0-22.0	Brecciated Silicified Section						
22.0-23.2	Chlorite Schist and Quartz Stringers with 50% iron (magnetite & hematite) - (schist and quartz parallel to core)						
23.2-35.0	Banded Rhyolite with Greymilky Quartz (rhyolite bands are twisted and contorted)						
35.0-46.4	Mixed Rhyolite and Chlorite Schist - some pyrite mineralization						
46.4-47.2	Vuggy Quartz - pink to gray						
47.2-53.7	Mainly Chlorite Schist - some narrow quartz stringers and minor rhyolite						
53.7-75.0	Chlorite Schist with some narrow sections of mixed hematite and chlorite						
	56.5-57.0 Brecciated zone with quartz and minor Hematite						
	Some narrow vuggy section with hematite and pyrite						
75.0-79.0	Silicified section - mixed Rhyolite and Quartz						
79.0-80.5	Chlorite Schist and quartz with 30% Hematite						
80.5-80.9	Milky Quartz						
80.9-81.1	Hematite and Magnetite						
81.1-88.2	Vuggy Chlorite Schist and Iron (magnetite and hematite)						
	Iron at 82.3-82.8 and 83.7-84.1						
88.2-93.5	Chlorite Schist						

Property B & E Exploration Ltd.

DIAMOND DRILL RECORD

Hole No. 1 Sheet No. 2 Lat. 0-00 Total Depth 345.0'
 Section _____ Dep. 0-00 Elev. Collar _____
 Date begun December 14, 1956 Bearing 140° Elev. Bottom _____
 Date finished December 29, 1956 Angle 45°

DEPTH FEET	FORMATION	SAMPLE NO.	WIDTH OF SAMPLE	Fe ₂ O ₃		SLUDGE GOLD. g	
				g	%		
93.5-100.0	Vuggy Chlorite Schist and Iron (magnetite and hematite) Iron at 94.0-14.5 and 98.8-99.4	0352	6.5'	17.85			
100.0-103.0	Chlorite Schist						
103.0-111.5	Vuggy Chlorite Schist and iron (magnetite and hematite)	0353	8.5'	45.59			
111.5-138.1	Chloritized Greenstone						
138.1-139.1	Chlorite Schist and iron (magnetite and hematite) with 2" qtz.						
139.1-140.4	Chlorite Schist						
140.4-142.0	Chlorite Schist and Iron (magnetite and hematite) with 2" qtz.						
142.0-148.8	Chlorite Schist						
148.8-150.5	Vuggy Chlorite Schist and iron (magnetite and hematite) - some quartz stringers up to 2".						
150.5-160.7	Chlorite Schist						
160.7-165.7	Vuggy Chlorite Schist and iron (magnetite and hematite)	0351	5.0'	32.72			
165.7-321.6	Silicified Chlorite Schist - some minor narrow sections of magnetite and hematite						
321.6-323.3	Grey granite						
323.3-338.8	Silicified Chlorite Schist						
338.8-345.0	Grey Granite - blocky ground - some lost core						
Hole ends at 345.0'							

DIAMOND DRILL RECORD

Hole No. 1 Sheet No. 6

Property B & M. Explorations Ltd
 Location Muskeg & Hess Township
Swabey Mining Division
 Latitude 0-00
 Departure 0-00
 Bearing _____

Dip 90°
 Total Footage 106'

Elev. Collar _____
 Datum _____
 Date Started Oct 11th 1958
 Date Completed Oct 13 1958
 Drilled by Rich Knight Drilling Contractor
 Logged by Loreca T. Barry

Footage		Formation	Sample Number	Sample Footage	Sample Width	Gold Sample	Gold Sludge	Remarks
From	To							
0'	1'	Basing						
1'	106'	Diorite trace of sulphides and minor magnetite.						

Date of Examination October 15th 1958

For B & M. Explorations Ltd
 Loreca T. Barry, Pres.

DIAMOND DRILL RECORD

Hole No. 2 Sheet No. 1

Property B4 M. Explorations Ltd.
Location Munster & Hesse Townships
Sudbury Mining Division
Latitude _____
Departure _____
Bearing _____

Dip 90°

Total Footage 75'

Elev. Collar _____
Datum _____
Date Started Oct. 14th 1958
Date Completed Oct. 15th 1958
Drilled by A. W. Knight Drilling Contractor
Logged by Geoffrey T. Barry

Footage		Formation	Sample Number	Sample Footage	Sample Width	Gold Sample	Gold Sludge	Remarks
From	To							
0'	5'	Basing						
5'	75'	Yug. g. Chlorite schist and iron inclusions Magnetite & Hematite at 35.0 - 35.5' and 52.6 - 57.6						

Date of Examination October 15th 1958

for B4 M. Explorations Ltd.
Geoffrey T. Barry.

DIAMOND DRILL RECORD

Hole No. 3

Sheet No. 1

Property B & N Explorations Ltd.
 Location Arizona & New Lanarkshire
Quabury Mining Division
 Latitude 0-00
 Departure 0-00
 Bearing _____

Dip 145°

 Total Footage 90'

Elev. Collar _____
 Datum _____
 Date Started Oct 16th 1958
 Date Completed Oct 19th 1958
 Drilled by W. Knight Drilling Contractor
 Logged by Garrett Berry

Footage		Formation	Sample Number	Sample Footage	Sample Width	Gold Sample	Gold Sludge	Remarks
From	To							
<u>0'</u>	<u>10'</u>	<u>Basing</u>						
<u>10'</u>	<u>90'</u>	<u>Granite coarse grained, silicified and chloritized</u>						

Date of Examination Oct 20th 1958

for B & N Explorations Ltd.
Garrett T. Berry

DIAMOND DRILL RECORD

Hole No. 4 Sheet No. 1

Property B & M Explorations Ltd.
 Location Muskrat & Hess Leasehold
Manitoba Mining Division

Latitude 0 0 08
 Departure 0-00
 Bearing _____

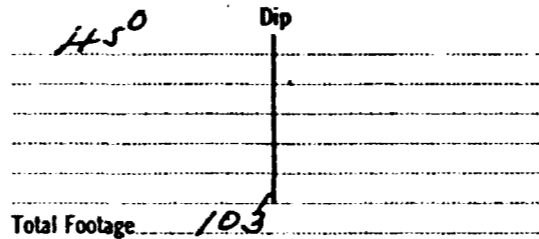

Elev. Collar _____
 Datum _____
 Date Started Oct 23rd 1958
 Date Completed Oct 26th 1958
 Drilled by Light Knight Drilling Contractor
 Logged by Gene & Barry

Footage		Formation	Sample Number	Sample Footage	Sample Width	Gold Sample	Gold Sludge	Remarks
From	To							
0'	7'	Basing						
7'	25'	Tunggy Bllorite Schist and Iron (Magnetite & Hematite) Iron at 10' - 13-6 and 21'-5 - 25'						
25'	75'	Blloritgon & Greenstone.						
75'	103'	Tunggy Bllorite Schist and Iron (Magnetite & Hematite) some quartz stringers up to 2"						

Date of Examination October 26th 1958

For B & M Explorations Ltd
Gene & Barry Pres.

DIAMOND DRILL RECORD

Hole No. 5 Sheet No. 1

Property B & H. Explorations Ltd.
 Location Myarsta Hill Township
Sudbury Mining Division.

Latitude 45-60
 Departure 0-60
 Bearing _____

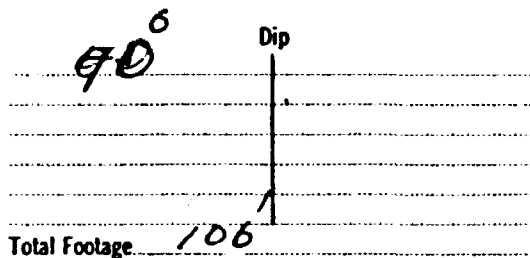

El. Collar _____
 Datum _____
 Date Started October 28th 1958
 Date Completed October 31st 1958
 Drilled by Rich Height Drilling Contractor
 Logged by Gene & Barry

Footage		Formation	Sample Number	Sample Footage	Sample Width	Gold Sample	Gold Sludge	Remarks
From	To							
0'	3'	<u>Gravel</u>						
3'	80'	<u>blende schist and iron (magnetite & hematite)</u>						
80'	106'	<u>blende schist and Phyllosite.</u>						

Date of Examination Oct. 31st 1958

For B & H. Explorations Ltd.
Gene & Barry Pres.

DIAMOND DRILL RECORD

Hole No. 6 Sheet No. 1

Property B. M. Explorations Ltd.
 Location Mustard Hill, Laurier, Quebec

Dip
45°

 Total Footage 96

Elev. Collar _____
 Datum _____
 Date Started Nov. 4th 1958
 Date Completed Nov. 7th 1958
 Drilled by _____
 Logged by _____

Latitude 0-00
 Departure 0-00
 Bearing _____

Footage		Formation	Sample Number	Sample Footage	Sample Width	Gold Sample	Gold Sludge	Remarks
From	To							
<u>0'</u>	<u>5'</u>	<u>Gravel</u>						
<u>5'</u>	<u>91'</u>	<u>illite schist and horn (magnetite & hematite)</u>						

Date of Examination Nov. 8th 1958

B. M. Explorations Ltd.
Gusca & Barry Pres.

DIAMOND DRILL RECORD

Hole No. 7 Sheet No. 1

Property B + M Explorations Ltd.
Location Mustard & Hess Township, Sudbury Mining Division.
Latitude 0-00
Departure 0-00
Bearing _____

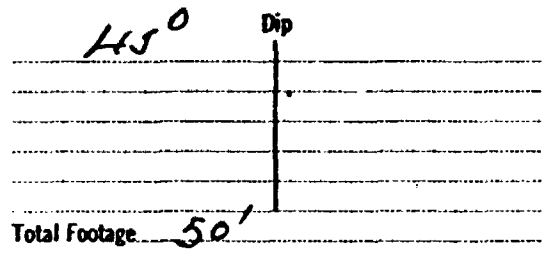

Elev. Collar _____
Datum _____
Date Started Nov 12th 1958
Date Completed Nov 14th 1958
Drilled by Li. McKnight Drilling Contractor
Logged by Gerard T. Barry

Footage		Formation	Sample Number	Sample Footage	Sample Width	Gold Sample	Gold Sludge	Remarks
From	To							
0'	3'	basins						
3'	25'	chlorite schist and Iron (magnetite & hematite)						
25'	50'	Granite						

Date of Examination Nov. 15th 1958

For B + M Explorations Ltd.
Gerard T. Barry

DIAMOND DRILL RECORD

Hole No. 8 Sheet No. 6

Property B&M Explorations Ltd.
 Location Musta, 18 Miles Township,
 Sudbury Mining Division.
 Latitude 0-00
 Departure 0-00
 Bearing 0-00

45° Dip

 Total Footage 100'

Elev. Collar _____
 Datum _____
 Date Started Nov. 18, 1958
 Date Completed Nov. 27, 1958
 Drilled by W. McKnight Drilling Contractor
 Logged by Yves J. Barry

Footage		Formation	Sample Number	Sample Footage	Sample Width	Gold Sample	Gold Sludge	Remarks
From	To							
0'	14'	Basing						
11'	14'	Blonite Greenstone						
14'	15.4'	Blonite Schist & Iron (magnetite and Hematite)						
15'	25'	Blonite Schist						
25'	65'	Blonite Schist & Iron (magnetite and Hematite) with 2" ore						
65'	100'	Blonite Schist & Gneiss						

Date of Examination Nov. 22nd 1958

For B&M Explorations Ltd.
Yves J. Barry

DRILLING LOGS.

B.M. EXPLORATIONS LTD

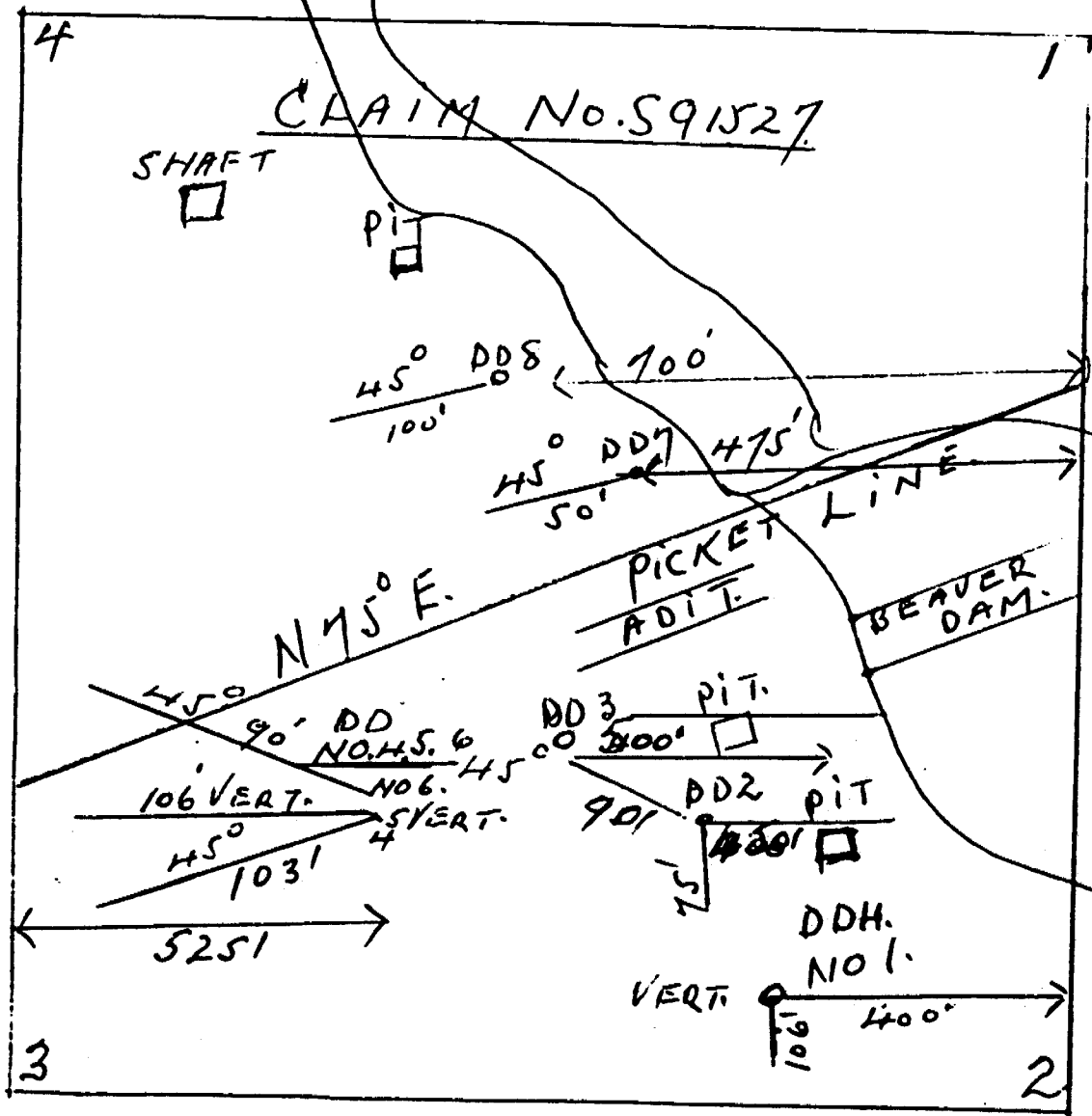

B. + M.

91519	91528	91529	
91520	91527 No. 1 HOLE 3	91527 No. 2 HOLE 2	91530
91521	91526	91531	91536
91522	91525	91532	91535
91523	91524	91533	91534

HOLE NO. 1. 345'

HOLE NO. 2. 542'

Uister

I einster

Munster

Munster

Munster Twp

S-2-289

SCALE: 1" = 40 CH

Bruin L.

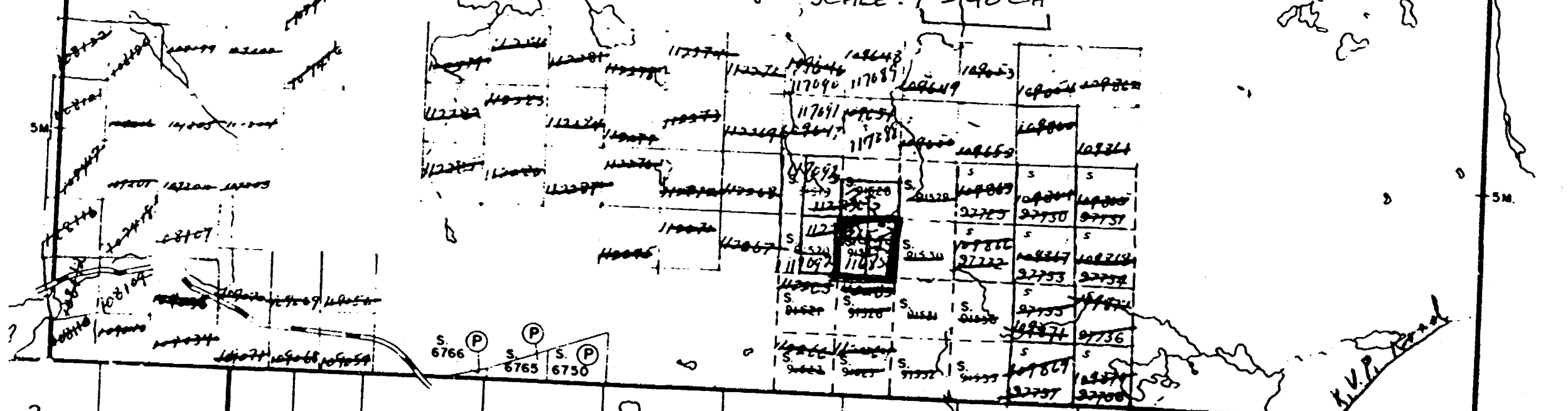

2 1 12 11 10 9 8 7 6 5 4 3 2 1

Jeff Twp. Hess Twp.

S. 6766 (P) S. 6765 S. 6750 (P)

K.V.P. Canal