



Summary of work performed for period running from May 5 to Aug 5 1987

Work performed consists of:

1. Geophysical survey. A copy of the report by H.J. Tracanelli is included.
2. Basic explorations such as prospecting, sampling, surface drilling and blasting, preparing samples for assaying and field analysis work, using chemicals and acids.
3. Dredging. Equipment used: one Keene 5" dredge, and was mostly used for bulk sampling.

Method used for bulk sampling and testing.

The original equipment uses a system of sluice boxes equipped with Hungarian riffles over carpets. This system is very efficient in metals of 100 mesh or bigger, but only recovers about 30 to 35% of very fine gold flakes. Since in this portion of Northern Ontario, gold occurs in dust and small flakes, and the probability of finding nuggets is so remote, a modification has been effectuated on the dredge, permitting a rate of recovery of 85% in fine flakes and dust. First, using the dredge in its original state, it was operated at site 1 of claim 943465 (see map). A total of 100 cubic yards was processed through the sluice boxes, and after screening to 200 mesh, the result was 100 lbs of concentrate which has been assayed at .304 oz per ton. The net result was that approximately 65 tons of gravel would have to be processed in order to recover one ounce of gold, and then the machine had to be cleaned every 10 minutes in order to recover that amount. This was abandoned as impractical and unfeasible economically.

Several days of testing were needed before deciding on a modification to the basic principle of the dredge. The Hungarian riffles were removed, and only a mesh screen on top of a carpet was used. This system has since yielded positive results. The dredge has a capacity of 15 tons per hour and was operated for 6.5 hours therefore processing a volume of near 100 tons in gravel that had previously been assayed at .046 oz per ton. The concentrate obtained was amalgamated with mercury weighted before and after the amalgamation. A net gain of 13 grams was shown, and therefore set the rate of recovery at 85%, and cleaning the dredge only every two hours. Work remains to be done in assaying this concentrate for platinum elements. In one location, the assay showed a value of .1324 oz per ton of combined platinum group elements. Supposing the same rate of recovery remains true for platinum as for gold, the operation could prove to be lucrative. Further testing will be conducted following the recommendation contained in the geophysical survey.

4. Brushes and trees were removed from future roadsites

ANNEX 1

SAMPLE ANALYSIS No 1

Both samples were taken about one hundred feet apart at location 5, 2W-9N on claim 943466. They come from a layer of sand approximately 3 feet from the surface and about 18 inches in thickness. This sand was not panned or modified in any way.

The gold value itself does not justify further work, but platinum elements totalling .1324 oz per ton could be interesting, providing the same rate of recovery of 85% is maintained as with gold.

SAMPLE ANALYSIS NO 2

Sample 1 - Concentrate taken from the sluice box for the purpose of evaluating the rate of recovery of fine gold. Gravel from this area had previously been assayed at .0051 oz per ton with no significant amount of platinum group elements present. This was reflected in the result of this concentrate and the recovery of fine gold was from 30 to 35%

Sample 2 - This sample is from location 2 at 1W-4N of claim S944388. Not a channel sampling but simply a piece of mineral quartz taken at the surface from a geothermal vein.

Sample 3 - This piece of rock is from the outer edge of the same vein. It is felt that the values shown do not justify channel sampling.

SAMPLE ANALYSIS NO 3

Samples 1 and 2. These samples are from location 1 at 9W 2N on claim S 943388. Not a channel sampling. Portions of a mineralized geothermal quartz vein have been crushed to a dust. This main vein is about 24" in width on the average with a system of secondary veins running parallel, and as far as can be determined, runs at or near the surface for a distance of one quarter mile

SAMPLE ANALYSIS NO 4

Sample 1 - This sample comes from claim 943466 at 5W 2N, which proved to be near a crossover point on the geophysical survey, and is one of the areas where further testing is recommended. Sample consists of native gravel after larger pieces have been removed.

Sample 2 - This sample is from another area, south of French River and does not concern the present work in any way.

Prepared by: J Claude Gervais
31 July 1987

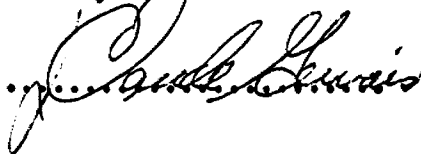

SAMPLE ANALYSIS

ANALYZED ON 22-8-86
 ICP 22/8/86-27
 RESULTS IN % FOR

	CU	NI	CO	FE	S	SI	AG	AL
C1 - BROWN	.0047	.0254	.0307	3.70	.0411	29.4	<.0023	7.29
1-C1 - BROWN	.0083	.0148	.0202	4.03	.0624	28.9	<.0023	7.61
C2 - CLEAR	.0069	<.0090	<.0029	2.31	.0546	33.1	<.0023	6.51
1-C2 - CLEAR	.0062	<.0089	<.0029	2.48	.0637	32.6	<.0023	6.50

	AS	AU	B	BA	BI	CA	CR	IR
C1 - BROWN	<.0107	<.0046	<.0040	.108	<.0104	1.79	.0039	<.0381
1-C1 - BROWN	<.0106	<.0045	<.0040	.118	<.0103	1.53	.0046	<.0379
C2 - CLEAR	<.0107	<.0045	<.0040	.0652	<.0104	1.48	.0045	<.0381
1-C2 - CLEAR	<.0106	<.0045	<.0040	.0657	<.0104	1.39	.0066	<.0380

	K	LI	MG	MN	MO	P	PB	PD
C1 - BROWN	2.28	.0010	1.05	.0758	<.0022	.149	<.0248	<.0170
1-C1 - BROWN	2.36	.0014	1.15	.0781	<.0022	.106	<.0246	<.0169
C2 - CLEAR	2.02	<.0009	.732	.0403	<.0022	.0672	<.0247	<.0170
1-C2 - CLEAR	2.04	<.0009	.762	.0413	<.0022	.0597	<.0247	<.0169

	PT	RH	RU	SB	SE	SN	TE	TI
C1 - BROWN	<.0366	<.0290	<.0117	<.0353	<.0409	<.0048	<.0476	.467
1-C1 - BROWN	<.0364	<.0288	<.0116	<.0351	<.0406	<.0048	<.0474	.434
C2 - CLEAR	<.0366	<.0289	<.0117	<.0353	<.0408	<.0048	<.0475	.252
1-C2 - CLEAR	<.0365	<.0289	<.0116	<.0352	<.0407	<.0048	<.0475	.256

	V	ZN
C1 - BROWN	.0081	<.0023
1-C1 - BROWN	.0089	<.0023
C2 - CLEAR	.0066	<.0023
1-C2 - CLEAR	.0066	<.0023

CO. K

INCO LIMITED

Miscellaneous analyses

*In Serpentine
Copper cliff*

USER
This is your return mailing label
PLEASE PRINT

To Location
Dept
Name

CUSTOM ASSAY

Dept approval		Charge number		Date <i>MAY 22 1987</i>					
Project description <i>Claude Gervais</i>		<i>(Tel 682-0254)</i>							
User leave blank	User's sample no. and/or description	Analyses required <i>(put estimates on sample bags)</i>							
		<input checked="" type="checkbox"/> Indicate highest priority, if any							
		<i>try oz/short ton</i>							
		<i>Pt</i>	<i>Pd</i>	<i>Au</i>					
<i>7-7223</i>	<i>Sample 1 Concentrate</i>	<i>1.001</i>	<i>.002</i>	<i>.304</i>					
<i>24</i>	<i>2 Silica</i>	<i>1.001</i>	<i>.004</i>	<i>.054</i>					
<i>25</i>	<i>3 Rock</i>	<i>.002</i>	<i>.005</i>	<i>.054</i>					
<i>charge \$15 per sample for Pt Pd Au</i> <i>charge \$22 in total for sample prep</i>									
Date received	<i>MAY 22/87</i>	Date completed	<i>June 8/87</i>	Analyst's initial		Approved	<i>RD</i>		

NO CARBON PAPER NEEDED

USER Indicate accuracy required	Accuracy	Element	Note: High accuracy means additional time and cost
	Better than 1%		
	1 to 5%		
	5 to 10%		

- Samples to be Filed Returned
- Forward top 3 copies with samples to
 COPPER CLIFF
 PROCESS TECHNOLOGY BUILDING
 ANALYTICAL SERVICES LABORATORY
- User keep last copy

INCO LIMITED

Miscellaneous analyses

Process Technology - Technical Services

R8111

Form 78-R

870

USER
This is your return mailing label
PLEASE PRINT

To Location
Dept
Name

Dept approval	Charge number <i>Y</i>	Date <i>Aug 24 87</i>			
Project description					
User leave blank	User's sample no. and/or description	Analyses required (<i>put estimates on sample bags</i>)			
		<input type="checkbox"/> Indicate highest priority, if any			
	<i>#1 - BROWN</i>	<i>TAG 02</i> <i>AU</i> <i>.21</i>	<i>PER</i> <i>Ag</i> <i>.54</i>	<i>SHORT</i>	<i>TUN</i>
	<i>#2 - CLEAR</i>	<i>.19</i>	<i>.03</i>		
Date received <i>Aug 24/87</i>	Date completed <i>Aug 27/87</i>	Analyst's initial	Approved <i>R.D.</i>		

NO CARBON PAPER NEEDED

USER Indicate accuracy required	Accuracy	Element	Note: High accuracy means additional time and cost
	Better than 1%		
	1 to 5%		
	5 to 10%		

- Samples to be Filed Returned
- Forward top 3 copies with samples to
COPPER CLIFF
PROCESS TECHNOLOGY BUILDING
ANALYTICAL SERVICES LABORATORY
- User keep last copy



Ontario

Ministry of
Natural
Resources

Ontario
Geological
Survey

77 Queen Street
11th Floor
Toronto, Ontario
M5S 1B3
Telephone 965-1337

Geoscience
Laboratories
Report



ISSUED TO

T.T.L.
P.O. BOX 799
COBALT, ONTARIO
P0J 1C0

For: Mr. J. Claude Gervais,
P.O. Box 831,
Coppercliff, Ont. POM 1N0

C. 24612

SAMPLE NUMBER	GOLD Au ppb	PLATINUM Pt ppb	PALLADIUM Pd ppb
GERVAIS 1	2380	0.0702/t	1
GERVAIS 2	<2	<1	<1

This is an interim report for samples entered in your name on NOV.19,1986 ; additional work will follow as soon as possible

Fees Received: ~~REPAY~~ Charged 4 coupons card #0868, paid receipt #A497983

Chris Riddle, Chief Analyst

DEC.1,1986

Note that the value shown on this preliminary test is gravel and surface value. From this standpoint and examination of surface rocks, the area seems to justify the present work program.



ASSAYERS (ONTARIO) LIMITED

33 CHANCELLOR AVENUE, SUITE 100, MISSISSAUGA, ONTARIO L4V 1P1 TELEPHONE (416) 239-3527

Certificate of Analysis

Certificate No. MI-1702/6454 Date: July 9, 1987
Received July 6/87 3 Samples of Rock
Submitted by New-Trails Explorations Att'n: Mr. H. J. Tracanelli
c.c. Mr. J. Claude Gervais

Project: ULS-001

Sample No.	Au oz/ton	Ag oz/ton
HJT-01	<.001	.02
HJT-02	<.001	.03
HJT-03	<.001	<.01

ASSAYERS (ONTARIO) LIMITED

J. van Engelen Mgr.

ANNEX 2

Attached, is a copy of a daily log used to record the days of work performed on the group of claims concerned in this report.

Please note that all persons employed are immediate family and equal partners in the claims. Each person has a group of claims registered in his name, and all the five groups are pooled into a family partnership.

No formal agreement has been drawn out yet, but a document is being drafted to outline the terms of the agreement. A copy of this document will be sent to your department when available.

The same working days are being reported and claimed as work performed towards assessment work.

Working days were at least 10 hours of work per day.

MAP GROUP SHOWING
LOCATION OF NEW CLAIMS

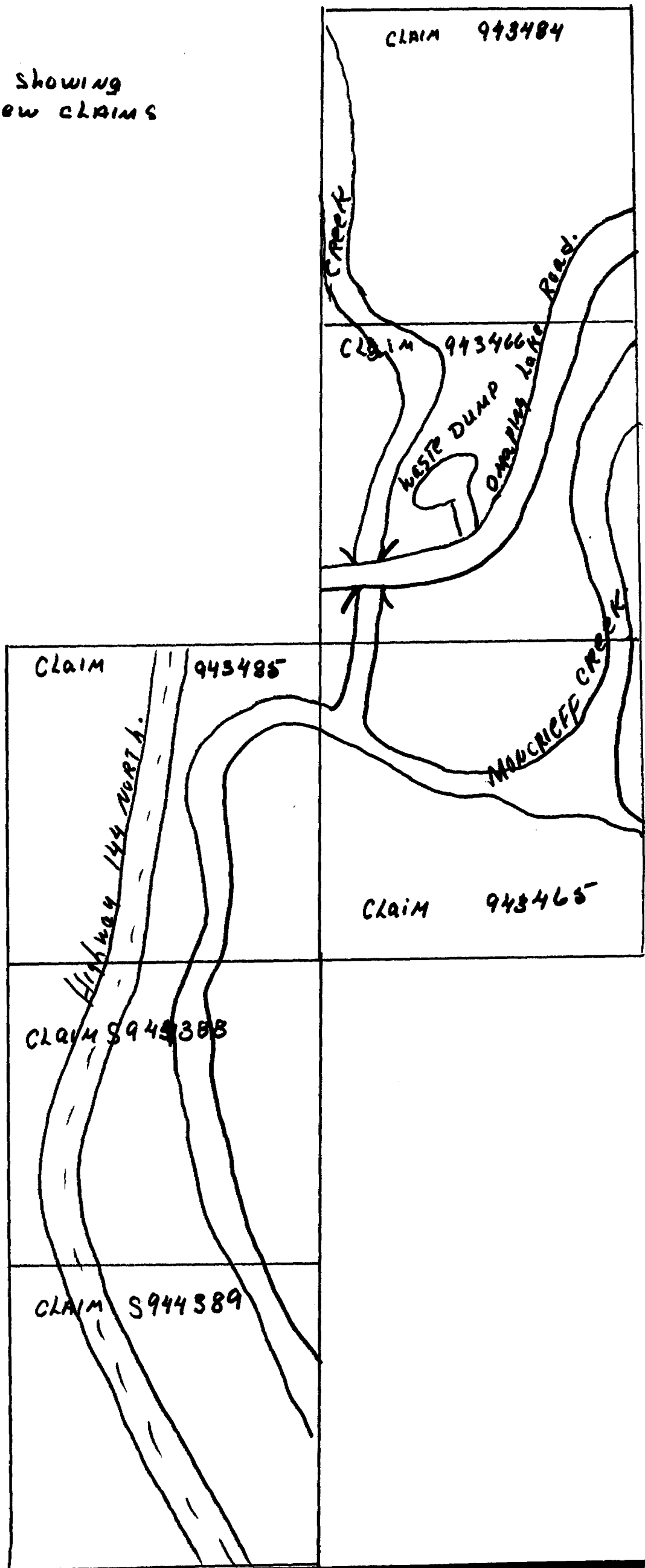



411135E0023 63.5094 ULSTER

900

#63. 5094

OM87-8-I-049

THIS SUBMITTAL CONSISTED OF VARIOUS REPORTS, SOME OF WHICH HAVE BEEN CULLED FROM THIS FILE. THE CULLED MATERIAL HAD BEEN PREVIOUSLY SUBMITTED UNDER THE FOLLOWING RECORD SERIES (THE DOCUMENTS CAN BE VIEWED IN THESE SERIES):

Report #1 on Ground geophysical surveys on the Gervais Gp. Property	→ see Toronto file # 2.10324 R.O.W # 87-62
by: H. J. Tracaneli Aug/87	

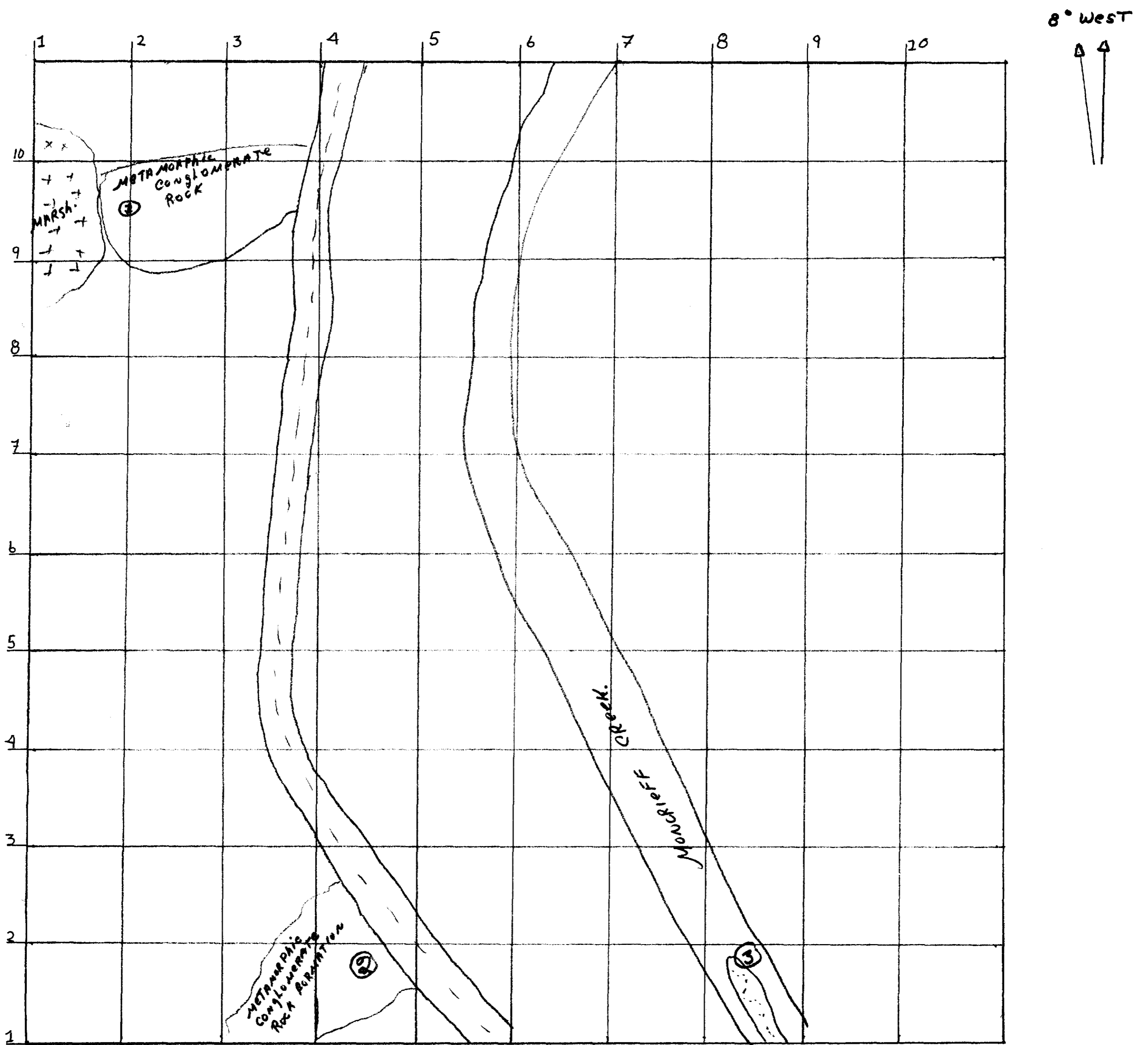

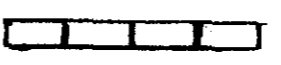
SCALE  = 4 CHAINS

- LOCATION 1 9W - 2N GEOPHYSICAL FEATURE - GEOTHERMAL QUARTZ VEIN
RUNNING FROM HIGHWAY 144 TO EDGE OF CLAIM - DRILLING & BLASTING OPERATIONS
- LOCATION 2 1W - 4N GEOTHERMAL QUARTZ VEIN
SURFACE DRILLING & BLASTING
- LOCATION 3 1W - 8N PLACER GRAVEL TESTING

PREPARED BY: J.C. GERVAIS 31 JULY 07



CLAIM # 943465

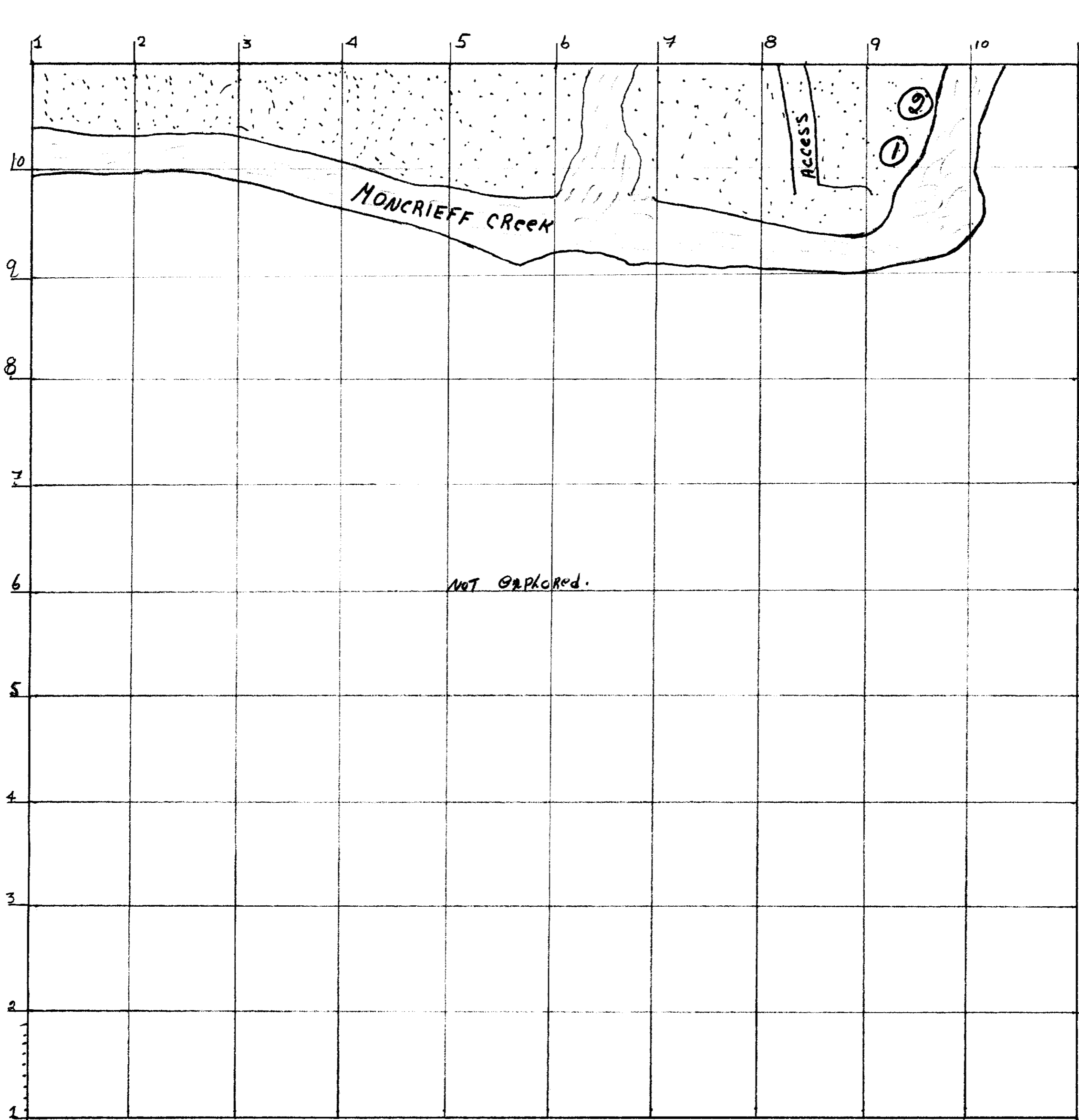

8° west

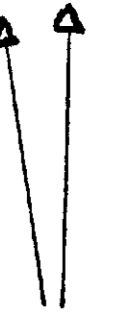

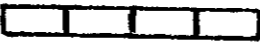
SCALE  = 4 CHAINS

- LOCATION 1 SITE OF DREDGE SETTING WHERE ALL SAMPLES HAVE BEEN TRANSPORTED FOR SLUICING
- LOCATION 2 SITE OF GRAVEL SAMPLED FOR ASSAY C24612 (ATTACHED) SHOWING 2380 PPM

PREPARED BY J.C. CERVAIS 31 JULY 87



411135E0023 63.5894 ULSTER

CLAIM # 943466

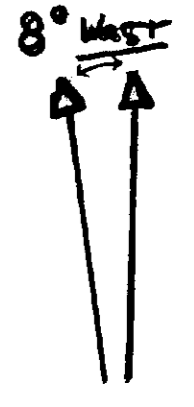
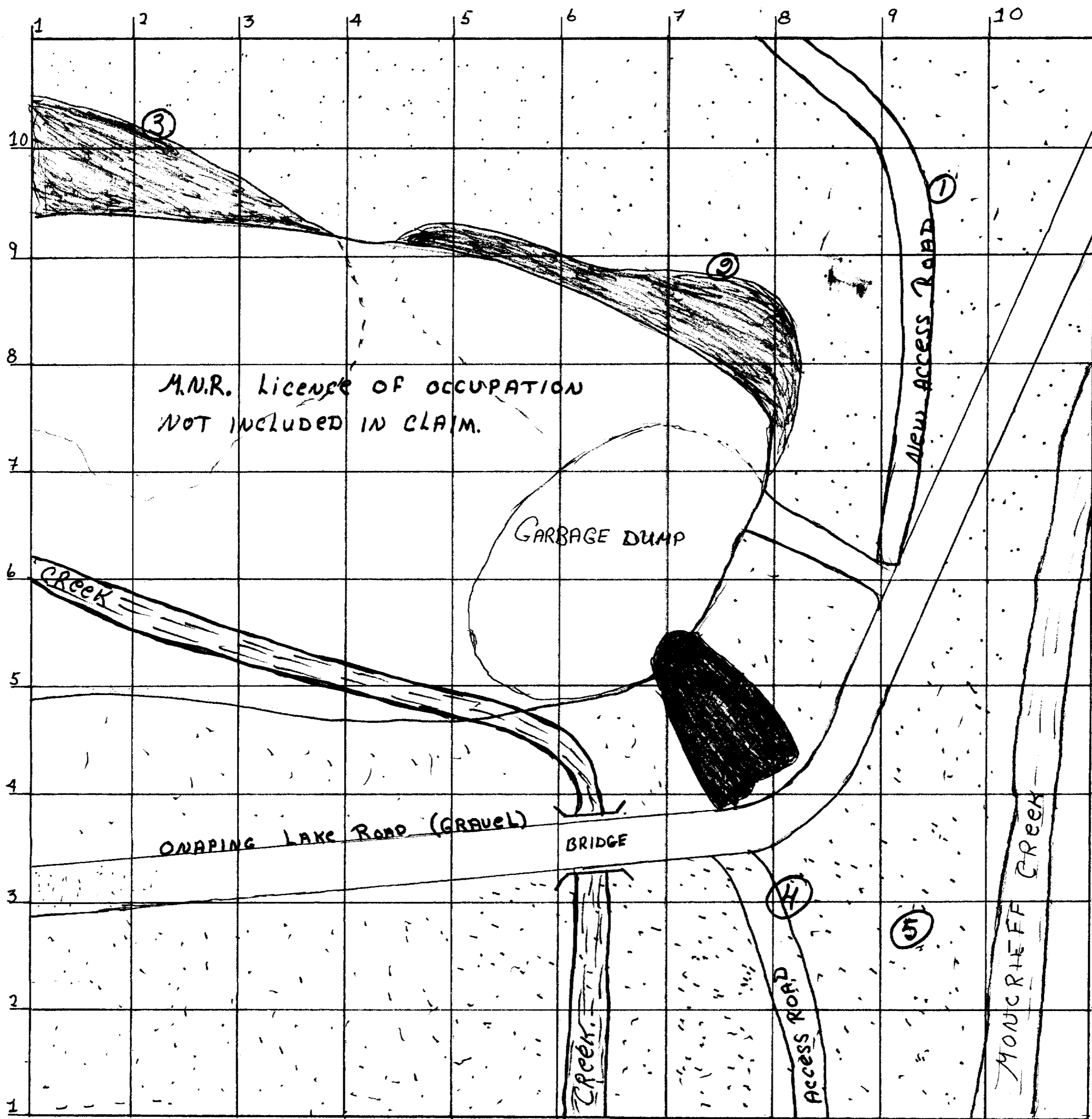

SCALE  = 4 CHAINS

- LOCATION 1 REMOVAL OF TREES & BRUSHES
- LOCATION 2 & 3 STRIPPING TO BARE ROCK TO EXAMINE QUARTZ VEINS
- LOCATION 4 REMOVAL OF TREES & BRUSHES
- LOCATION 5 SAMPLING OF GRAVEL FOR PLACER CONTENT

PREPARED BY J.C. GERVAIS 31 July .87

