

CRAIG - 0011-A1

LOAD: COMBO

22-12

Diamond Drilling

Township of CRAIG

Report N^o 12

Work performed by: Oakridge Mining Corporation Ltd.

Claim N ^o	Hole N ^o	Footage	Date	Note
S 57554	3	357.0'		(1)
	5	229.0'		(1)
	6	195.6'		(1)
	7	256.0'		(1)
	8	339.0'		(1)
S 57553	1	284.6'		(1)
	2	216.0'		(1)
	4	209.0'		(1)
	<u>8 HOLES</u>	<u>2086.2'</u>		
		<u>2086.2 FEET TOTAL.</u>		

Notes:

(1) All dates for above holes unknown

OAKRIDGE MINING CORPORATION

LISTED

NO PERSONAL LIABILITY

Sales and
Executive Offices

2882 BLOOR ST. WEST
TORONTO 18, CANADA

Sudbury Mining Division

Craig Township

Claim #57554 ✓

Diamond Drill Hole #3

Drilled at 45 degree angle
Set-up 175' north of picket line

SEE PAGE 5

*75' E of N. claim line
25' E of N. claim line*

00'0"	-	10'0"	Casing		
10'0"	-	225'0"	Diabase		
225'0"	-	227'0"	Chlorite schist		
227'0"	-	320'0"	Disseminated pyrite & pyrrhotite		
320'0"	-	325'0"	"	"	Sulphur 13.80%
					Nickel Trace
325'0"	-	327'6"	Massive pyrite & pyrrhotite		Sulphur 27.62%
					Cobalt Trace
327'6"	-	332'6"	Chlorite schist and quartz, some disseminated pyrite		
332'6"	-	337'6"	Disseminated pyrite & pyrrhotite;		Cobalt Trace
337'6"	-	357'0"	Disseminated pyrite & pyrrhotite		

Hole bottomed at 357'0"

J. P. Jones
.....
Superintendent.

OAKRIDGE MINING CORPORATION

LIMITED

NO PERSONAL LIABILITY

2822 BLOOR ST. WEST
TORONTO 18, CANADA

Sales and
Executive Offices

Sudbury Mining Division

Craig Township

Claim #67554

Diamond Drill Hole # 5

Drilled at 45 degree angle
Set-up 100 feet North of picket line
280' E of Hole # 6

STRIKE 5

00'0" - 10'0"
10'0" - 106'6"
106'6" - 180'6"
180'6" - 185'6"
185'6" - 190'6"
190'6" - 195'6"
195'6" - 200'6"
200'6" - 205'6"
205'6" - 209'4"
209'4" - 216'4"
216'4" - 229'0"

Casing				
Dense grey siliceous rock				
Very lean disseminated pyrite & pyrrhotite				
Disseminated pyrite & pyrrhotite;	Sulphur			6.93%
" " "	Sulphur			6.32%
" " "	Sulphur			6.02%
" " "	Sulphur			10.79%
" " "	Sulphur			6.97%
" " "	Cobalt			Trace
Quartz				
Dense grey siliceous rock				

Hole bottomed at 229 feet 0 inches

J. P. Morris
.....
Superintendent

OAKRIDGE MINING CORPORATION

LIMITED

NO PERSONAL LIABILITY

Sales and
Executive Offices

2932 BLOOR ST. WEST
TORONTO 18, CANADA

Sudbury Mining Division

Craig Township

Claim #57554

Diamond Drill Hole #6

Drilled at 45 degree angle
Set-up 60 feet North of picket line

STRIP 5

294' E of hole #3

001.0"	-	10'0"
10'0"	-	102'6"
102'6"	-	143'0"
143'0"	-	147'0"
147'0"	-	152'0"
152'0"	-	154'0"
154'0"	-	159'0"
159'0"	-	195'6"

Casing

Dense grey siliceous rock	
Disseminated pyrite & pyrrhotite	
Disseminated pyrite & pyrrhotite;	Sulphur 9.85%
" " "	Sulphur 9.62%
" " "	Sulphur 13.70%
Dense grey siliceous rock	

Hole bottomed at 195'6"

J. J. [Signature]
.....
Superintendent

OAKRIDGE MINING CORPORATION

LIMITED

NO PERSONAL LIABILITY

2882 BLOOR ST. WEST
TORONTO 18, CANADA

Sales and
Executive Offices

Sudbury Mining Division

Craig Township

Claim # 8-67564

Diamond Drill Hole #7

Drilled at 45 degree angle
Set-up 100 feet north of picket line

STRIKE 5

200' E of Hole #5

00.0 - 10'0"
10'0" - 102'0"
102'0" - 128'0"
128'0" - 165'0"
165'0" - 186'0"
186'0" - 187'0"

Casing

Dense grey siliceous rock
Disseminated pyrite and pyrrhotite
Dense grey siliceous rock
Disseminated pyrite & pyrrhotite
Massive pyrite & pyrrhotite,

Sulphur 17.76%
Nickel 0.06%
Cobalt Trace

187'0" - 233'0"
233'0" - 234'0"
234'0" - 240'0"
240'0" - 256'0"

Disseminated pyrite & pyrrhotite
Massive pyrite & pyrrhotite,
Disseminated pyrite & pyrrhotite
Dense grey siliceous rock

Sulphur 21.52%

Hole bottomed at 256'0"

J. D. M.
Superintendent

OAKRIDGE MINING CORPORATION

LIMITED

NO PERSONAL LIABILITY

Sales and
Executive Offices

2882 BLOOR ST. WEST
TORONTO 18, CANADA

Sudbary Mining Division

Craig Township

Claim # S-57554

Diamond Drill Hole #8

Drilled at 45 degree angle
set-up 160 feet north of picket line

STRIKE 5

200' E of Hole #7

00.0 - 10'0"
 10'0" - 152'0"
 152'0" - 325'0"
 325'0" - 326'0"
 326'0" - 334'0"
 334'0" - 339'0"

Casing
 Dark grey siliceous rock
 Disseminated pyrite & pyrrhotite
 Massive pyrite & pyrrhotite,
 Disseminated pyrite & pyrrhotite
 Dark grey siliceous rock

Sulphur 18.40%

Hole bottomed at 339'0"

J. D. Moore

 Superintendent

OAKRIDGE MINING CORPORATION

INCORPORATED

NO PERSONAL LIABILITY

Sales and
Executive Offices

2813 BLOOR ST. WEST
TORONTO 18, CANADA

Sudbary Mining Division Craig Township Claim #67553

Diamond Drill Hole # 1 Drilled at 45 degree angle *STRIKE N*

Set-up 150' south of picket line *700' N. of East claim line*
200' N. of " " " "

00'0" - 10'0"
10'0" - 191'3"
191'3" - 196'3"
196'3" - 201'3"
201'3" - 206'3"
206'3" - 211'3"
211'3" - 215'3"
215'3" - 239'2"
239'2" - 284'6"

Casing			
Chlorite schist			
Disseminated pyrite & pyrrhotite;		Sulphur	3.73%
" " "		Sulphur	8.45%
" " "		Sulphur	7.66%
" " "		Sulphur	11.35%
" " "		Sulphur	6.64%
Chlorite schist.			

Hole bottomed at 284'6"

J. D. M...
.....
Superintendent

1952

284.6
216
209

709.6

OAKRIDGE MINING CORPORATION

LIMITED

NO PERSONAL LIABILITY

Sales and
Executive Offices

2892 BLOOR ST. WEST
TORONTO 18, CANADA

St. Aubury Mining Division Craig Township Claim # S-57553 ✓

Diamond Drill Hole #2 Drilled at 45 degree angle. STRIKE N

Set-up 150' south of picket line 100' East of #1 Hole

00.0	-	10' 0"	Casing		
10'0"	-	67' 0"	Dense grey siliceous rock		
67'0"	-	76' 0"	Diabase		
76'0"	-	176' 0"	Dense grey siliceous rock		
176'0"	-	182' 0"	Disseminated pyrite & pyrrhotite;	Sulphur 10.82%	
				Nickel .10%	
				Cobalt Trace	
182'0"	-	185' 0"	Disseminated pyrite & pyrrhotite;	Sulphur 8.30%	
				Nickel .03%	
				Cobalt Trace	
185'0"	-	190' 6"	Disseminated pyrite & pyrrhotite;	Sulphur 10.16%	
190'6"	-	199' 6"	Disseminated pyrite & pyrrhotite		
199'6"	-	203' 6"	Disseminated pyrite & pyrrhotite;	Sulphur 7.69%	
203'6"	-	213' 0"	Disseminated pyrite & pyrrhotite		
213'0"	-	216' 0"	Dense grey siliceous rock		

Hole bottomed at 216'

J. P. Mans
.....
Superintendent

OAKRIDGE MINING CORPORATION

LIMITED

NO PERSONAL LIABILITY

Sales and
Executive Offices

222 BLOOR ST. WEST
TORONTO 12, CANADA

Sudbury Mining Division

Craig Township

Claim #57553

Diamond Drill Hole #4

Drilled at 45 degree angle

STRIKE N

Set-up 163 feet south of picket line *200' west of #1 hole*

00'0"	-	10'0"	Casing		
10'0"	-	158'5"	Chlorite schist		
158'5"	-	163'5"	Disseminated pyrrhotite & pyrite;	Sulphur	4.06%
163'5"	-	178'5"	Disseminated pyrrhotite & pyrite;	Sulphur	14.35%
				Iron	10.19%
				Nickel	Trace
				Cobalt	Trace
				Copper	0.10%
178'5"	-	183'5"	Very lean pyrite & pyrrhotite	Sulphur	0.82%
183'5"	-	209'0"	Very lean pyrite mineralisation.		

Hole bottomed at 209'0"

J. B. Munro
.....
Superintendent.

Kennedy Lake

Craig Twp

CRAIG TWP

Bluewater Lake

SPANISH

89379 89380 89381 89378

89382 89383 89384 89385

89386 89387 89388 89389

89390 89391 89392 89393

Section grid with handwritten numbers and labels:

- Top row: 5, 5, 5, 5, 5, 5
- Second row: 5, 5, 5, 5, 5, 5
- Third row: 5, 5, 5, 5, 5, 5
- Section 57551
- Section 57552
- Section 57553
- Section 57554
- Section 57555
- Section 57556
- Section 57557
- Section 57558
- Section 57559
- Section 57560
- Section 57561
- Section 57562
- Section 57563
- Section 57564
- Section 57565
- Section 57566
- Section 57567
- Section 57568
- Section 57569
- Section 57570
- Section 57571
- Section 57572
- Section 57573
- Section 57574
- Section 57575
- Section 57576
- Section 57577
- Section 57578
- Section 57579
- Section 57580
- Section 57581
- Section 57582
- Section 57583
- Section 57584
- Section 57585
- Section 57586
- Section 57587
- Section 57588
- Section 57589
- Section 57590
- Section 57591
- Section 57592
- Section 57593
- Section 57594
- Section 57595
- Section 57596
- Section 57597
- Section 57598
- Section 57599
- Section 57600

Ⓟ → Ⓟ

Ⓟ

Ⓟ

Ⓟ

MG LOC.

5-57556

MG LOC. E

57551 57555

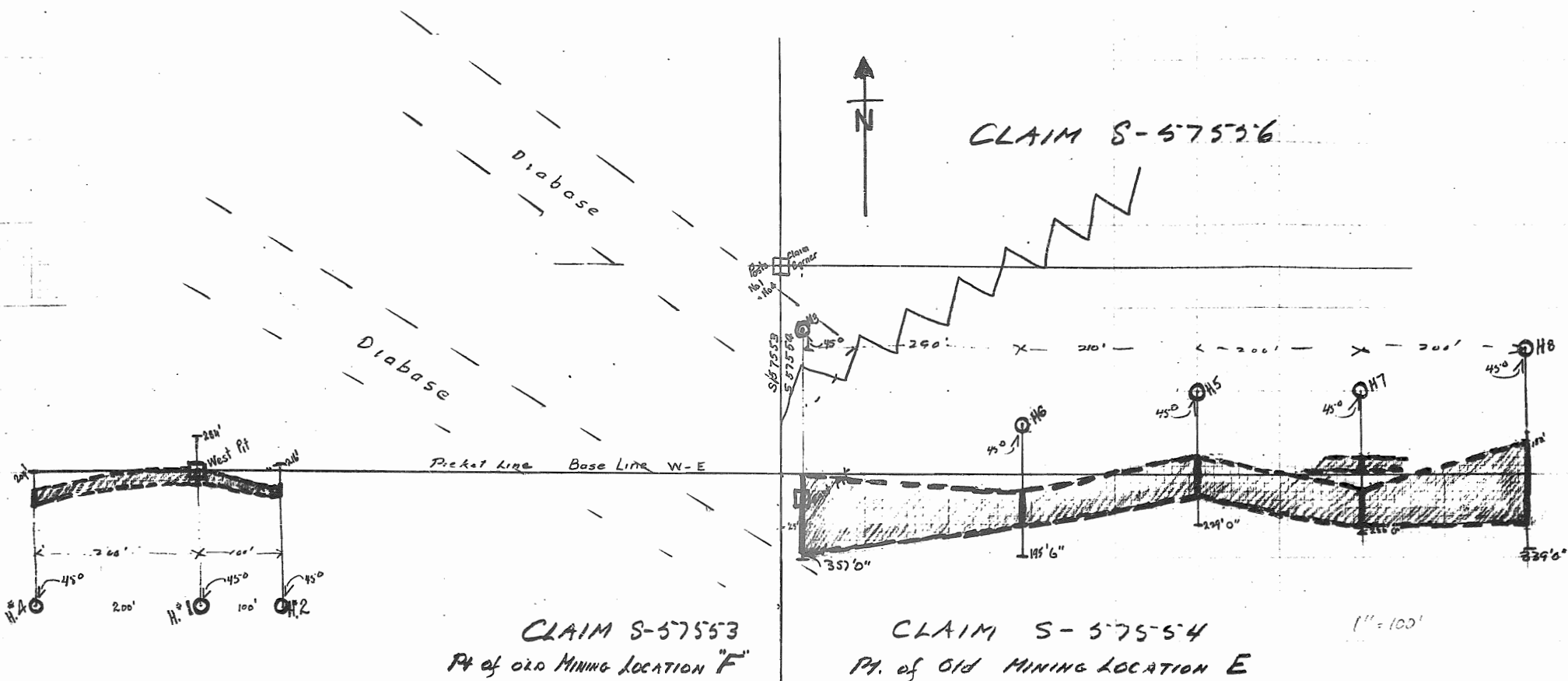



CRAIG TOWNSHIP
SUDBURY MINING DIVISION

DIAMOND DRILL PLAN

SCALE
1 INCH = 100 FEET.

Recorded Holder; OAKRIDGE MINING CORPORATION LIMITED - A, 23890
 Date of work; Dec. 1951, Jan. + Feb. 1952
 Drill Contractor; ARNO DIAMOND DRILLING CO. LTD.
 Field Supt; J. R. MOSSO
 Geologist; Reginald E. HORE

J. B. Moss
Field Superintendent
Reginald E. Hore
Consulting Geologist

 INDICATED PYRITE & PYRROHOTIT
 PYRITE & PYRROHOTITE INTERSECTED IN DRILLING

★ CRAIG-0011 - A1, #1

