

010

Search by: G-Plan Numbers Township/Area Names Claims Dispositions

Search!

Begin your search by clicking on one of the radio buttons (G-Plan, Township/Area, Claim, or Disposition). Then enter your search criteria in the text box and click on the search button.

Select from a list below and press its "Go" button to jump to the specified view.

Mining Division G-Plan # Township / Area

View Reports:

DUPLICATE

The centre of your map is in: Division: Sudbury Township: CRAIG G-Plan: G-

CONTIGUITY

2 222 97

STRALAK TOWNSHIP

ULSTER TOWNSHIP

1043259

S539305

S539304

S539303

S539302

S539306

S539307

S734698

S734699

CRAIG TOWNSHIP

0 m

532.6 m

Map Tools

Go to Ontario View.

4x Zoom Factor.

Zoom In Zoom Out

Pan Identify Alienation

Identify Disposition Identify Claim

Legend Help



CRAIG

2.22297

411135E2007

#1 POST 539303
#4 POST 539302

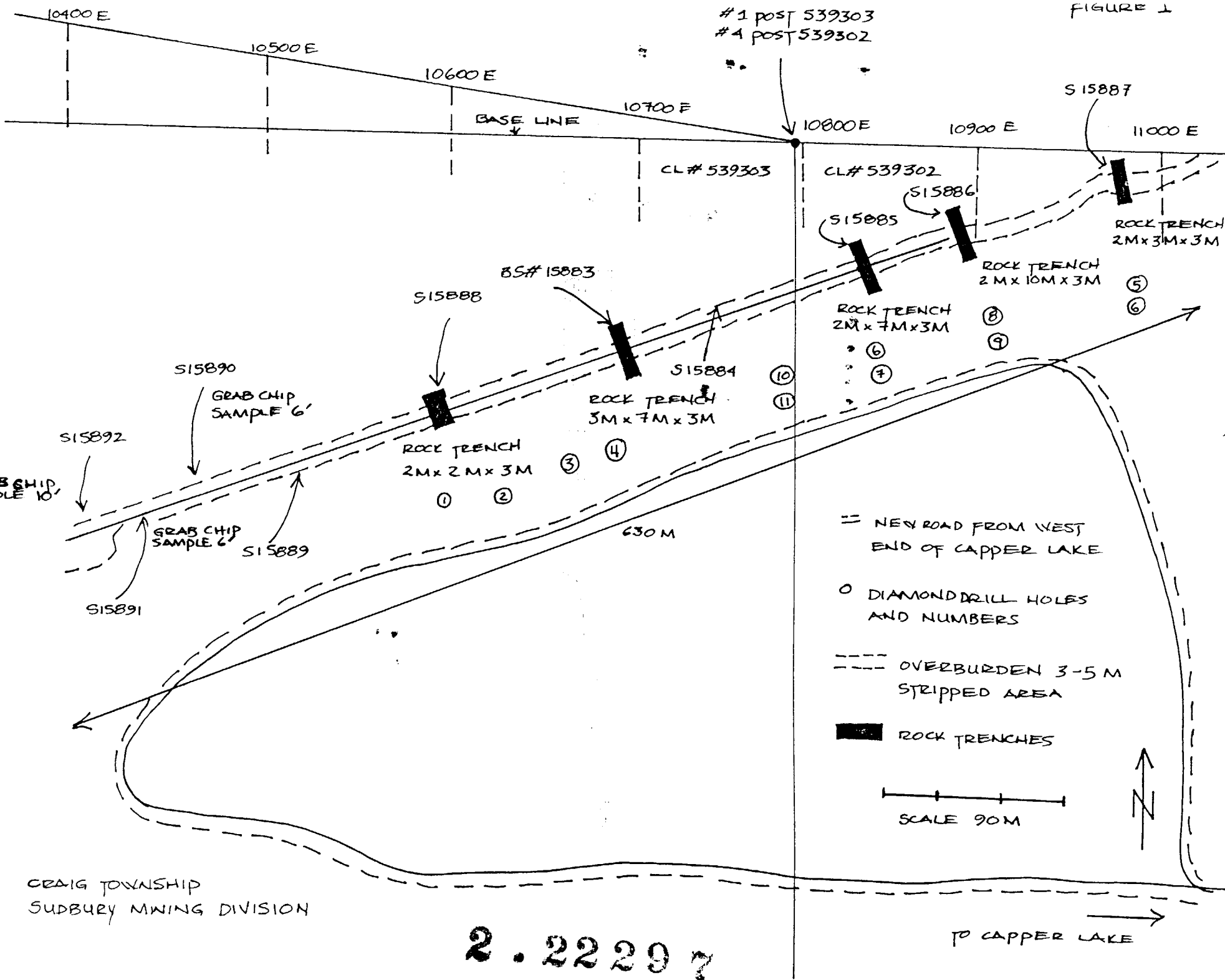

- == NEW ROAD FROM WEST END OF CAPPER LAKE
 - DIAMOND DRILL HOLES AND NUMBERS
 - OVERBURDEN 3-5 M STRIPPED AREA
 - ROCK TRENCHES
- SCALE 90M

CRAIG TOWNSHIP
SUDBURY MINING DIVISION

2.2229 ?

TO CAPPER LAKE

COMPOSITE BULK SAMPLE

11000 E

TRENCH DIMENSIONS: 2 M x 3 M x 3 M

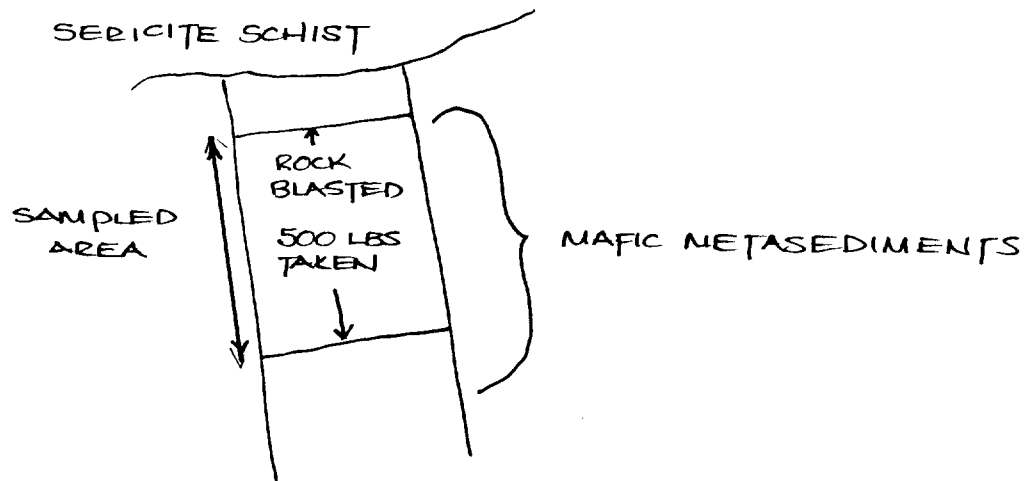

500 LBS BULK SAMPLE CRUSHED TO $-3/8$ "
5 LBS COLLECTED WITH MECHANICAL SAMPLER
SENT FOR ANALYSES - SAMPLE #15887

SCALE 30 M

COMPOSITE BULK SAMPLE

FIGURE 3

10900 E

TRENCH DIMENSIONS: 2 M x 10 M x 3 M

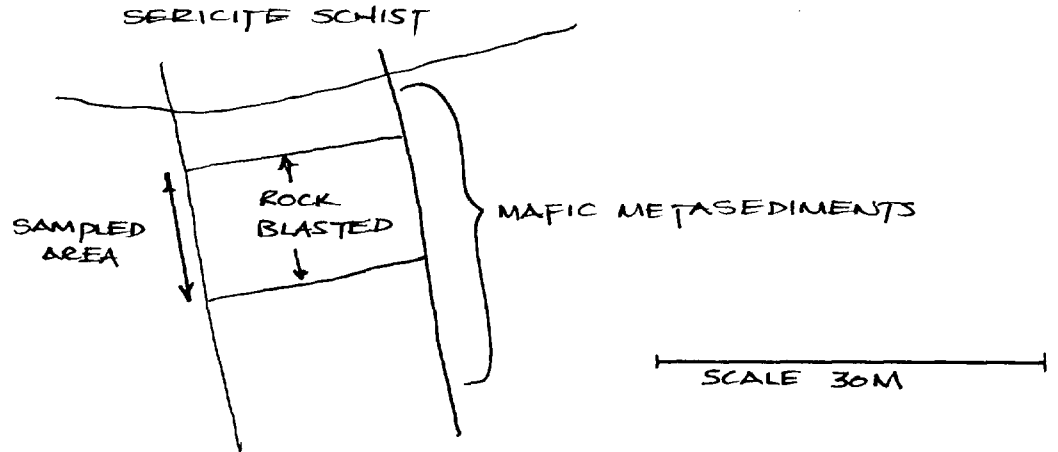

410 LBS BULK SAMPLE TAKEN, CRUSHED TO $-3/8"$.
4.2 LBS TAKEN WITH MECHANICAL SAMPLER.
4.2 LBS SENT FOR ANALYSES - SAMPLE #15886

COMPOSITE BULK SAMPLE

FIGURE 4

10800 E

TRENCH DIMENSIONS: 2 M x 7 M x 3 M

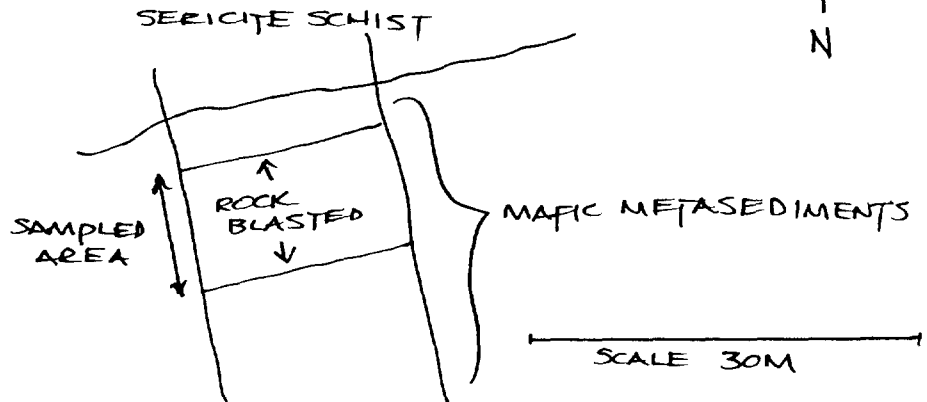

465 LBS TAKEN AND CRUSHED TO $-3/8"$.
4.6 LBS TAKEN WITH MECHANICAL SAMPLER.
4.65 LBS SENT FOR ANALYSES - SAMPLE #15883.

COMPOSITE BULK SAMPLE

FIGURE 5

10700 E

TRENCH DIMENSIONS: 3M x 7M x 3M

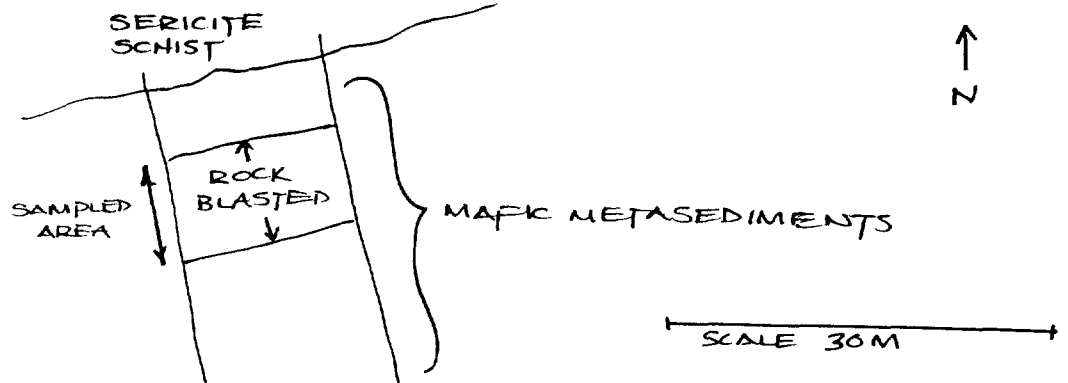

410 LBS TAKEN AND CRUSHED TO $-3/8"$.
4.1 LBS TAKEN VIA MECHANICAL SAMPLER
4.1 LBS SENT FOR ASSAY - SAMPLE #15883

COMPOSITE BULK SAMPLE

FIGURE 6

10600 E

TRENCH DIMENSIONS: 2M x 2M x 3M

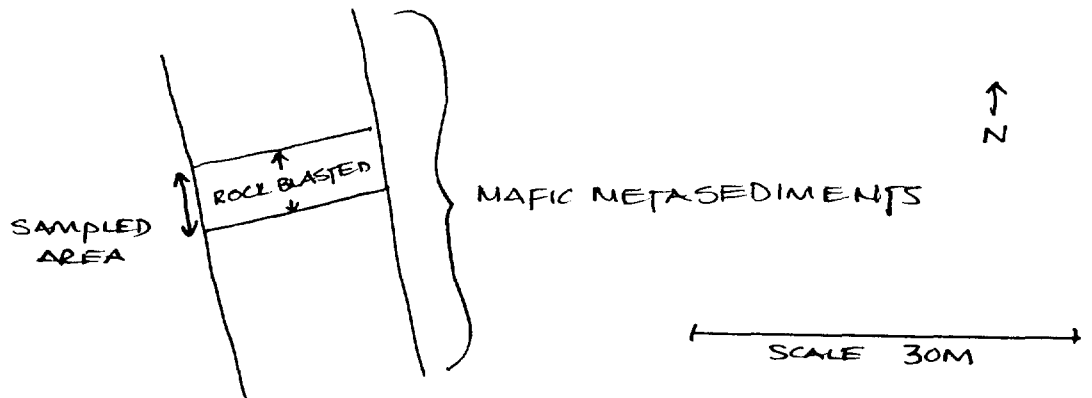

160 LBS TAKEN AND CRUSHED TO $-3/8"$
1.6 LBS TAKEN WITH MECHANICAL SAMPLER.
1.6 LBS SENT FOR ASSAY - SAMPLE #15888

2.22297

Assessment Work Report

Mining Claims #539302 and 539303, Craig Township, Ontario

Segment of Work report: June 27, 1999 to August 7, 1999

Stralak Resources Inc. owns a contiguous block of 17 claims in the corner of Craig, Ulster, Stralak and Moncreiff Townships. This area is accessible by Highway 144 north of Sudbury to Benny village, where bush roads lead to the property. These claims, which are located 40 air-miles northwest of Sudbury, lie on the northern margin of the Benny Greenstone Belt, an intercalated sequence of archaean mafic to felsic metasediments, tuffs and flows.

A new showing was discovered approximately 1/4 mile west of Capper Lake. Although some mag and EM surveys were done, they did not respond very well to the zinc mineralization. A backhoe and bulldozer were used to strip the deposit for 630 meters long and 10 meters wide. After stripping and washing, several rock trenches were put in for bulk sampling purposes. Several areas were bulk sampled, with analysis on composite samples of each. Analysis completed in August 1999 indicated a good range of zinc values, with supporting values in silver, copper and lead. See attached analyses. This program was carried out during the summer of 1999, but for assessment purposes, the work program segment submitted spans June 27, 1999 to August 7, 1999.

The work was performed by Erana Mines Limited of Lively, Ontario, for Goldcore Exploration and Mining Ltd., 75 The Donway West, Suite 712, North York, M3C 2E9. The employees or subcontractors of Erana Mines Limited who performed the work were Albert Jerome, Matthew Coulton and Peter Hauser. The equipment used to perform the work was a 690E excavator, a Way-Ox Mark 3 water pump, compressor, and GDS83F plugger. Goldcore is the contractor for 1098881 Ontario Limited, an optionee under an agreement with Stralak Resources Inc., dated May 19, 1998. Goldcore has provided copies of the paid invoices for the work segment in question, so that Stralak Resources Inc. may file assessment work on its mining claim.

Several drill holes for further testing have been set up and tied in to the established grid system.

Drilling is to commence in November, 1999.

Dated : August 31, 1999

Signed:

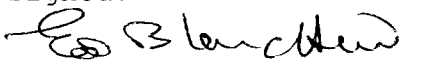
Edward J. Blanchard

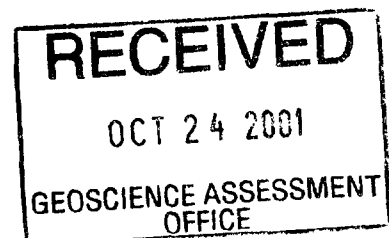

41113SE2007 2.22297 CRAIG

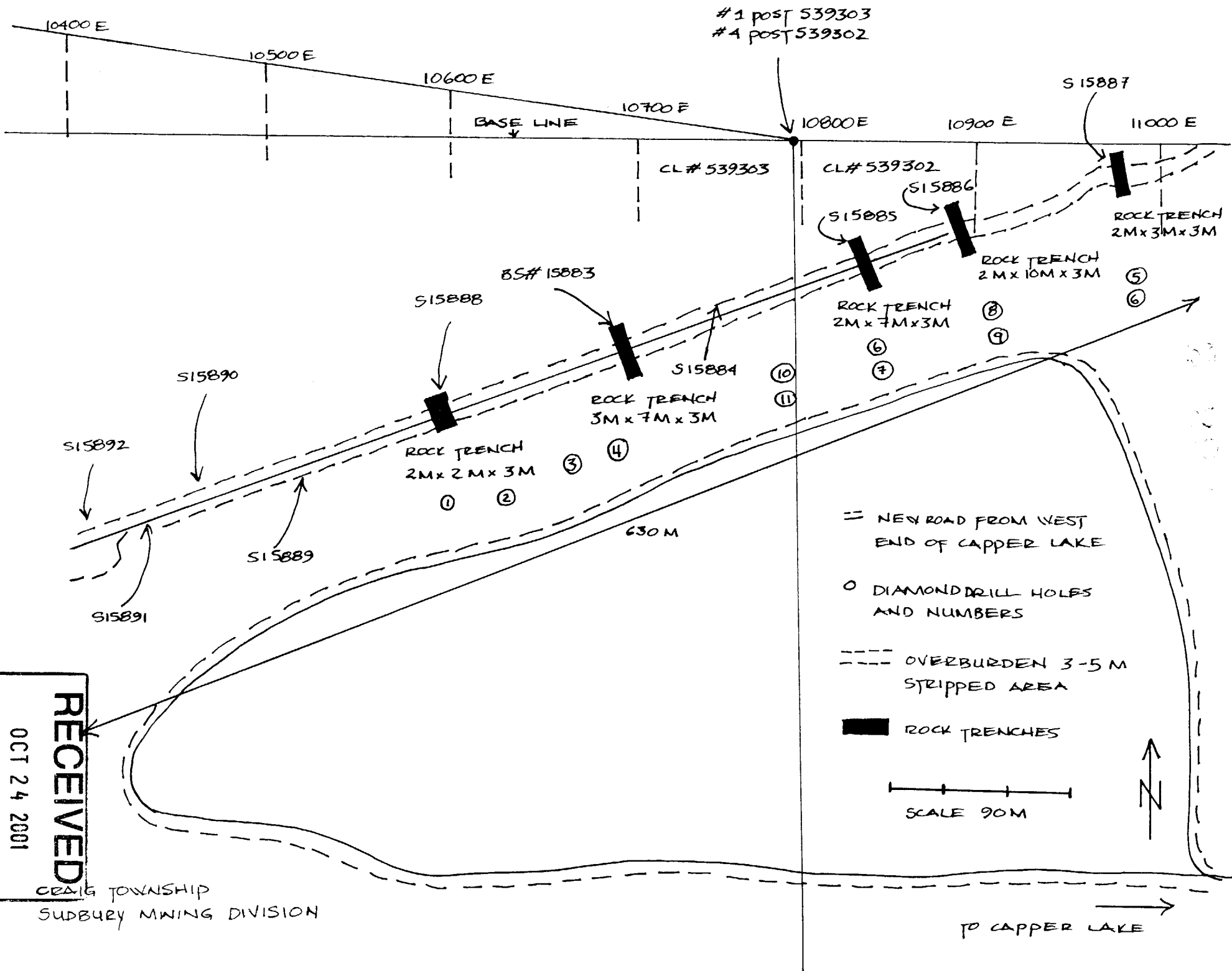

#1 post 539303
 #4 post 539302

RECEIVED
 OCT 24 2001
 GEOSCIENCE ASSESSMENT
 OFFICE

CRAIG TOWNSHIP
 SUDBURY MINING DIVISION

== NEW ROAD FROM WEST
 END OF CAPPER LAKE

○ DIAMOND DRILL HOLES
 AND NUMBERS

--- OVERBURDEN 3-5 M
 STRIPPED AREA

■ ROCK TRENCHES

SCALE 90 M

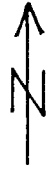

TO CAPPER LAKE →

ERANA MINES LIMITED
106 Fielding Road
Lively, Ontario
P3Y 1L5

TEL: (705) 682-0649...FAX: (705) 682-2447

TO: Goldcore Exploration
and Mining Ltd. (CONTRACTOR)
75 The Donway W.
Suite 712
North York, ON
M3C 2E9

INVOICE NO.: GC/C-48
DATE : Jul-14-99
TERMS : Due upon receipt.

RE: "Stralak-Craig/Ulster Twp." - stripping/trenching

LABOUR	: June 27 to July 10/99 (see attached Time Schedule) A. Jerome 60 hrs. @ \$20./hr. \$1200. P. Hauser 60 hrs. @ \$20./hr. 1200. \$2,400.00**
EQUIPMENT RENTAL	: 690E (unoperated) 45 hrs. @ \$70./hr. 3,150.00**
TRANSPORTATION	: 2 service vehicle P/U 5 days per vehicle 10 days @ \$50./day 500.00**
FUEL	: 45 gal (64 Lt.) drawn from Erana Mines yard tank 204.75Lt. @ \$0.359/Lt. 73.51**
FREIGHT	: FedEx Inv. No.1-280-75179 July 6/99 - \$1.38 GST 19.76*
ASSAYS	: Swastika Laboratories Inv. No. 00046289 - June22/99 \$1.04 GST 14.75* \$6,158.02
G.S.T.	: 7% #101671618 on ** \$428.65 * 2.42 431.07 \$6,589.09 =====

POSTED
12330
July 22/99

PAID DEC 17 1999

RECEIVED
OCT 24 2001
SCIENCE ASSESSMENT
OFFICE

Cheque # 0091

TIME SCHEDULE: Craig/Ulster Township

<u>DATE</u>	<u>A. Jerome</u>	<u>P. Hauser</u>	<u>690E</u>
Jun-30-99	12 hrs.	12 hrs.	9 hrs.
Jul-05-99	12 "	12 "	9 "
06	12 "	12 "	9 "
07	12 "	12 "	9 "
08	12 "	12 "	9 "
	60 hrs.	60 hrs.	45 hrs.



INVOICE DETAIL

ERANA MINES LTD
106 FIELDING RD
LIVELY ON P3Y 1L5

ACCOUNT NO: 1522-1051-5 PAGE: 3 OF 6
DATE: 06 JUL 1999
INVOICE NUMBER: 1-280-75179

BN 121832950RT0001

SHIPMENT NUMBERS	SENDER NAME AND ADDRESS	RECIPIENT	SERVICES	ITEMS WEIGHT	CHARGES	CAD AMOUNT
40074965822 YSB-YYB	A B JEROME GC /C ERANA MINES LTD 106 FIELDING RD <i>gcl</i>	SHASTIKA LABORATORIES 1 CAMERON AVE	PRIORITY OTH DEDUCTION CANADA GST	1 5.0P	30.40CAD 10.64CAD 1.38CAD	30.40 10.64 1.38
00294	LIVELY ON CA P3Y1L5 SENT: 17 JUN 1999	SHASTIKA ON CA POK1TO DELIVERED: 18 JUN 1999, 11:32 SIGNED: R.LANDI 49, 18 JUN 99, 08:10 DESCRIPTION ON LAST PAGE		(2.3K)	NET DUE:	21.14

gcl

Swastika Laboratories
 Div. of TSL/Assayers Inc.
 P.O. Box 10
 1 Cameron Avenue
 Swastika, Ontario
 P0K 1T0

Tel: (705) 642-3244

INVOICE

NO: 00046574

DATE: 08/04/99

PAGE: 1

SOLD TO:

ERANA MINES LIMITED
 106 FIELDING ROAD
 LIVELY ONTARIO
 P3Y 1L5

SHIP TO: E002

Same

*POST
 P0138T
 Aug 31/99*

GST Number: R132862640

Proj #/P.O. # N/A

ITEM NO.	QUANTITY	UNIT	DESCRIPTION	G	P	UNIT PRICE	AMOUNT	
	10		Ag			7.25	72.50 ✓	
	10		Cu			4.00	40.00	
	10		Pb			4.00	40.00	
	10		Zn			4.00	40.00	
	10		Sample Prep			3.50	35.00	
			Cert #9W-2094-RG1					
			GST @ 7%				15.93	
							<i>2160</i>	<i>15.93</i>
							<i>227.22</i>	<i>6600</i>
							<i>243.43</i>	
COMMENTS:							TOTAL	243.43 ✓
Net 30 Days <i>copied for billing</i>								

RECEIVED AUG - 6 1999

*Paid Oct. 5/99
 Chq # 2757
 \$243.43*



Established 1928

Swastika Laboratories

A Division of Assayers Corporation Ltd.

Assaying - Consulting - Representation

Geochemical Analysis Certificate

9W-2094-RG1

Company: **ERANA MINES**

Date: AUG-04-99

Project:

Attn: E. Blanchard

We hereby certify the following Geochemical Analysis of 10 Rock samples submitted AUG-02-99 by .

Sample Number	Ag oz / ton	Cu %	Pb %	Zn %
15883	3.61	0.123	1.38	9.57
15884	3.05	0.51	0.272	8.04
15885	4.10	0.065	2.05	7.63
15886	2.01	0.089	0.92	4.15
15887	0.76	0.023	0.226	0.61
15888	0.85	0.052	0.56	1.35
15889	0.59	0.029	0.392	1.46
15890	3.25	1.43	1.22	9.25
15891	3.24	0.181	1.71	5.00
15892	4.78	0.105	0.99	5.18

Certified by

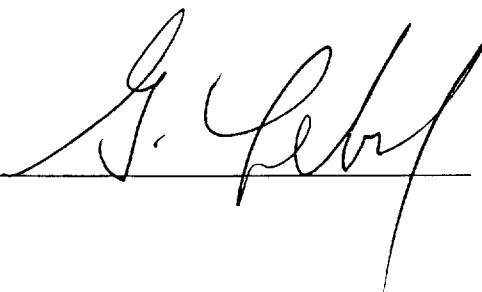

ERANA MINES LIMITED
106 Fielding Road
Lively, Ontario
P3Y 1L5

TEL: (705) 682-0649...FAX: (705) 682-2447

TO: Goldcore Exploration
and Mining Ltd.(CONTRACTOR)
75 The Donway W.
Suite 712
North York, ON
M3C 2E9

INVOICE NO.: GC/C-49
DATE : Jul-29-99
TERMS : Due upon receipt.

**RE: "Stralak-Craig/Ulster Twp." - stripping/trenching,
drill/blast and wash
down rock**

LABOUR : July 11-24/99
(see attached Time Schedule)
A. Jerome
84 hrs. @ \$20./hr. \$1680.
P. Hauser
84 hrs. @ \$20./hr. 1680. \$3,360.00**

EQUIPMENT RENTAL : 690E (unoperated)
63 hrs. @ \$70./hr. 4,410.00**
Way-OX Mark 3 Water Pump
2 wks. @ \$100./wk. 200.00**
compressor
2 wks. @ \$225./wk. 450.00**
GDS83F Plugger
2 wks. @ \$100./wk. 200.00**

TRANSPORTATION : 2 service vehicle P/U
7 days per vehicle
14 days @ \$50./day 700.00**

FUEL : July 10/99 - 90 gal.
" 17/99 - 45 "
135 gal(614 Lt.) drawn from
Erana Mines yard tank
614 Lt. @ \$0.359/Lt. 220.43**

G.S.T. : 7% #101671618 on **
\$ 9,540.43
667.83
\$10,208.26
=====

*PAID
13/7/99
July 31/99*

PAID DEC 17 1999
Chq # 0091

TIME SCHEDULE: Craig/Ulster Township

<u>DATE</u>	<u>A.Jerome</u>	<u>P.Hauser</u>	<u>690E</u>
Jul-12-99	12 hrs.	12 hrs.	9 hrs.
13	12 "	12 "	9 "
14	12 "	12 "	9 "
15	12 "	12 "	9 "
Jul-19-99	12 "	12 "	9 "
20	12 "	12 "	9 "
21	12 "	12 "	9 "
	84 hrs.	84 hrs.	63 hrs.

ERANA MINES LIMITED
106 Fielding Road
Lively, Ontario
P3Y 1L5

TO: Goldcore Exploration
and Mining Ltd. (CONTRACTOR)
75 The Donway W.
Suite 712
North York, ON

INVOICE NO.: GC/C-50
DATE : Aug. 13/99
TERMS : Due upon receipt.

RE: "Stralak-Craig/Ulster Twp." - drill and blast
- wash-down bed rock

LABOUR	: July 25 - Aug. 7/99 (see attached Time Schedule) A. Jerome 48 hrs. @ \$20./hr. \$960. M. Colton 48 hrs. @ \$11./hr. 528. \$ 1,488.00** S+T	
EQUIPMENT RENTAL	: Way-0X Mark 3 water pump 1 wk. @ \$100./wk. 100.00** S+T Compressor 1 wk. @ \$225./wk. 225.00** S+T GDS83F Plugger 1 wk. @ \$100./wk. 100.00** S+T	
TRANSPORTATION	: 1 service vehicle P/U 4 days @ \$50./day 200.00**	
FREIGHT	: (copy attached) Northland Courier Service Inc. July 30/99-Inv.No.28379 \$0.56 GST 23.00*	
ASSAYS	: (copy of inv. attached) Swastika Laboratories Aug. 4/99 - Inv. No.46574 \$15.93 GST 227.50*	
G.S.T.	: 7% GST #101671618 on ** 147.91 on * 16.49	\$2,363.50 164.40 \$2,527.90 =====

POSTED
355
Aug 31/99

PAID DEC 17 1999

cheque #00911

5

TIME SCHEDULE: Craig/Ulster Townships

<u>DATE</u>	<u>A.Jerome</u>	<u>M.Coulton</u>
Jul-25-99	-- hrs.	-- hrs.
26	12 "	12 "
27	12 "	12 "
28	12 "	12 "
29	12 "	12 "
30	-- "	-- "
31	-- "	-- "
Aug-01-99	-- hrs.	-- hrs.
02	-- "	-- "
03	-- "	-- "
04	-- "	-- "
05	-- "	-- "
06	-- "	-- "
07	-- "	-- "
	48 hrs.	48 hrs.

Northland Courier Service Inc.

854 Notre Dame Ave., Sudbury, Ont. P3A 2T4

INFO 524-9911

PICK UP 560-9226

REFERENCE

28379

307 99

SHIPPER'S NAME & ADDRESS	
Ereha	
m. nos	POSTAL CODE
SHIPPER'S SIGNATURE	
<i>[Signature]</i>	

DESTINATION & CONSIGNEE	
BUS	
Suas+11A	POSTAL CODE
RECEIVED IN GOOD ORDER EXCEPT AS NOTED	
CONSIGNEE PER	X
DATE	TIME

CHARGED TO	SHIPPER	<input checked="" type="checkbox"/>
	DESTINATION	X
COURIER PER		
A.M.		

PCS	DESCRIPTION	WEIGHT	CHARGES
2	Boxes		\$16.00
TRANSHIP CHARGES			7.00
G.S.T #R130289069			
INSURANCE SPECIAL COVERAGE			56
TOTAL AMOUNT			23.56

P.P.C.

CPC-10

CASH

Swastika Laboratories
 Div. of TSL/Assayers Inc.
 P.O. Box 10
 1 Cameron Avenue
 Swastika, Ontario
 P0K 1T0

Tel: (705) 642-3244

INVOICE

NO: 00046574

DATE: 08/04/99

PAGE: 1

SOLD TO:
 ERANA MINES LIMITED
 106 FIELDING ROAD
 LIVELY ONTARIO
 P3Y 1L5

SHIP TO: E002

Same

GST Number: R132862640

Proj #/P.O. # N/A

ITEM NO.	QUANTITY	UNIT	DESCRIPTION	G	P	UNIT PRICE	AMOUNT
	10		Ag			7.25	72.50
	10		Cu			4.00	40.00
	10		Pb			4.00	40.00
	10		Zn			4.00	40.00
	10		Sample Prep			3.50	35.00
			Cert #9W-2094-RG1				
			GST @ 7%				15.93

RECEIVED AUG - 6 1999

COMMENTS:
 Net 30 Days

TOTAL

243.43

Work Report Summary

Transaction No: W0170.30973 Status: APPROVED
Recording Date: 2001-OCT-24 Work Done from: 1999-JUN-27
Approval Date: 2001-DEC-20 to: 1999-AUG-07

Client(s):
 198246 STRALAK RESOURCES INC.

Survey Type(s):
 ASSAY PSTRIP PTRNCH

Work Report Details:

Claim#	Perform	Perform Approve	Applied	Applied Approve	Assign	Assign Approve	Reserve	Reserve Approve	Due Date
G 7070002	\$9,031	\$9,031	\$0	\$0	\$2,000	2,000	\$7,031	\$7,031	
S 1043259	\$0	\$0	\$2,000	\$2,000	\$0	0	\$0	\$0	2006-OCT-26
	\$9,031	\$9,031	\$2,000	\$2,000	\$2,000	\$2,000	\$7,031	\$7,031	

Status of claim is based on information currently on record.



Date: 2001-DEC-20

GEOSCIENCE ASSESSMENT OFFICE
933 RAMSEY LAKE ROAD, 6th FLOOR
SUDBURY, ONTARIO
P3E 6B5

STRALAK RESOURCES INC.
1620 IBM TOWER,
701 WEST GEORGIA STREET
VANCOUVER, BRITISH COLUMBIA
V7Y 1G2 CANADA

Tel: (888) 415-9845
Fax: (877) 670-1555

Submission Number: 2.22297
Transaction Number(s): W0170.30973

Dear Sir or Madam

Subject: Approval of Assessment Work

We have approved your Assessment Work Submission with the above noted Transaction Number(s). The attached Work Report Summary indicates the results of the approval.

At the discretion of the Ministry, the assessment work performed on the mining lands noted in this work report may be subject to inspection and/or investigation at any time.

The revisions outlined in the Notice dated December 12, 2001 have in part been corrected. Accordingly, assessment work credit has been approved as outlined on the Declaration of Assessment Work Form that accompanied this submission. NOTE: the nature of the rocks and mineralization exposed will be required for the area stripped on all future submissions.

If you have any question regarding this correspondence, please contact BRUCE GATES by email at bruce.gates@ndm.gov.on.ca or by phone at (705) 670-5856.

Yours Sincerely,



Ron Gashinski
Supervisor, Geoscience Assessment Office

Cc: Resident Geologist

Edward J Blanchard
(Agent)

Stralak Resources Inc.
(Assessment Office)

Assessment File Library

Stralak Resources Inc.
(Claim Holder)

Date / Time of Issue Jan 7 2002 09:13h Eastern
TOWNSHIP / AREA PLAN
CRAIG G-2952

ADMINISTRATIVE DISTRICTS / DIVISIONS
Mining Division Sudbury
Land Titles/Registry Division SUDBURY
Ministry of Natural Resources District SUDBURY

TOPOGRAPHIC

- Administration Boundary
- Township
- Commission Lot
- Province Park
- Indian Reserve
- CRA, P&E or P&M
- Contour
- Contour - Ass'n. Authority or Person
- Shut
- Water Headings
- Railway
- Flow
- Tide
- Natural Gas Pipeline
- Hydro Line
- Communication Line
- Woods Area
- Monument - Concrete, Historical, Wood, Corner

LAND TENURE

Freehold Patent

- Surface And Mining Rights
- Surface Rights Only
- Mining Rights Only

Leasehold Patent

- Surface And Mining Rights
- Surface Rights Only
- Mining Rights Only

License of Occupation

- License Specified
- Surface And Mining Rights
- Surface Rights Only
- Mining Rights Only

Other Land Tenure

- Leasehold Patent
- Open Pit Closure
- Water Power Lease Agreement
- Mining Claims

LAND TENURE WITHDRAWALS

- Area Withdrawal from Disposition Mining Act Withdrawal System
- Withdrawal from Disposition Mining Act Withdrawal System
- Withdrawal from Disposition Mining Act Withdrawal System
- Order in Council Withdrawal System
- Withdrawal from Disposition Mining Act Withdrawal System
- Withdrawal from Disposition Mining Act Withdrawal System

IMPORTANT NOTICES

- None



LAND TENURE WITHDRAWAL DESCRIPTIONS

Identifier	Type	Date	Description
WLL 176281	When	Jul 27 2001	SEC 35 WLL 176281 ONT JULY 27 01 M-6
WLL 176281	When	Jul 27 2001	SEC 34 WLL 176281 ONT JULY 27 01 M-6
WLL 176281	When	Jul 27 2001	SEC 33 WLL 176281 ONT JULY 27 01 M-6
WLL 176281	When	Jul 27 2001	SEC 32 WLL 176281 ONT JULY 27 01 M-6
WLL 176281	When	Jul 27 2001	SEC 31 WLL 176281 ONT JULY 27 01 M-6
WLL 176281	When	Jul 27 2001	SEC 30 WLL 176281 ONT JULY 27 01 M-6
WLL 176281	When	Jul 27 2001	SEC 29 WLL 176281 ONT JULY 27 01 M-6
WLL 176281	When	Jul 27 2001	SEC 28 WLL 176281 ONT JULY 27 01 M-6
WLL 176281	When	Jul 27 2001	SEC 27 WLL 176281 ONT JULY 27 01 M-6
WLL 176281	When	Jul 27 2001	SEC 26 WLL 176281 ONT JULY 27 01 M-6
WLL 176281	When	Jul 27 2001	SEC 25 WLL 176281 ONT JULY 27 01 M-6
WLL 176281	When	Jul 27 2001	SEC 24 WLL 176281 ONT JULY 27 01 M-6
WLL 176281	When	Jul 27 2001	SEC 23 WLL 176281 ONT JULY 27 01 M-6
WLL 176281	When	Jul 27 2001	SEC 22 WLL 176281 ONT JULY 27 01 M-6
WLL 176281	When	Jul 27 2001	SEC 21 WLL 176281 ONT JULY 27 01 M-6
WLL 176281	When	Jul 27 2001	SEC 20 WLL 176281 ONT JULY 27 01 M-6
WLL 176281	When	Jul 27 2001	SEC 19 WLL 176281 ONT JULY 27 01 M-6
WLL 176281	When	Jul 27 2001	SEC 18 WLL 176281 ONT JULY 27 01 M-6
WLL 176281	When	Jul 27 2001	SEC 17 WLL 176281 ONT JULY 27 01 M-6
WLL 176281	When	Jul 27 2001	SEC 16 WLL 176281 ONT JULY 27 01 M-6
WLL 176281	When	Jul 27 2001	SEC 15 WLL 176281 ONT JULY 27 01 M-6
WLL 176281	When	Jul 27 2001	SEC 14 WLL 176281 ONT JULY 27 01 M-6
WLL 176281	When	Jul 27 2001	SEC 13 WLL 176281 ONT JULY 27 01 M-6
WLL 176281	When	Jul 27 2001	SEC 12 WLL 176281 ONT JULY 27 01 M-6
WLL 176281	When	Jul 27 2001	SEC 11 WLL 176281 ONT JULY 27 01 M-6
WLL 176281	When	Jul 27 2001	SEC 10 WLL 176281 ONT JULY 27 01 M-6
WLL 176281	When	Jul 27 2001	SEC 9 WLL 176281 ONT JULY 27 01 M-6
WLL 176281	When	Jul 27 2001	SEC 8 WLL 176281 ONT JULY 27 01 M-6
WLL 176281	When	Jul 27 2001	SEC 7 WLL 176281 ONT JULY 27 01 M-6
WLL 176281	When	Jul 27 2001	SEC 6 WLL 176281 ONT JULY 27 01 M-6
WLL 176281	When	Jul 27 2001	SEC 5 WLL 176281 ONT JULY 27 01 M-6
WLL 176281	When	Jul 27 2001	SEC 4 WLL 176281 ONT JULY 27 01 M-6
WLL 176281	When	Jul 27 2001	SEC 3 WLL 176281 ONT JULY 27 01 M-6
WLL 176281	When	Jul 27 2001	SEC 2 WLL 176281 ONT JULY 27 01 M-6
WLL 176281	When	Jul 27 2001	SEC 1 WLL 176281 ONT JULY 27 01 M-6

IMPORTANT NOTICES
Areas under which special regulations, limitations or conditions apply that affect mineral prospecting, mining and mineral development activities.

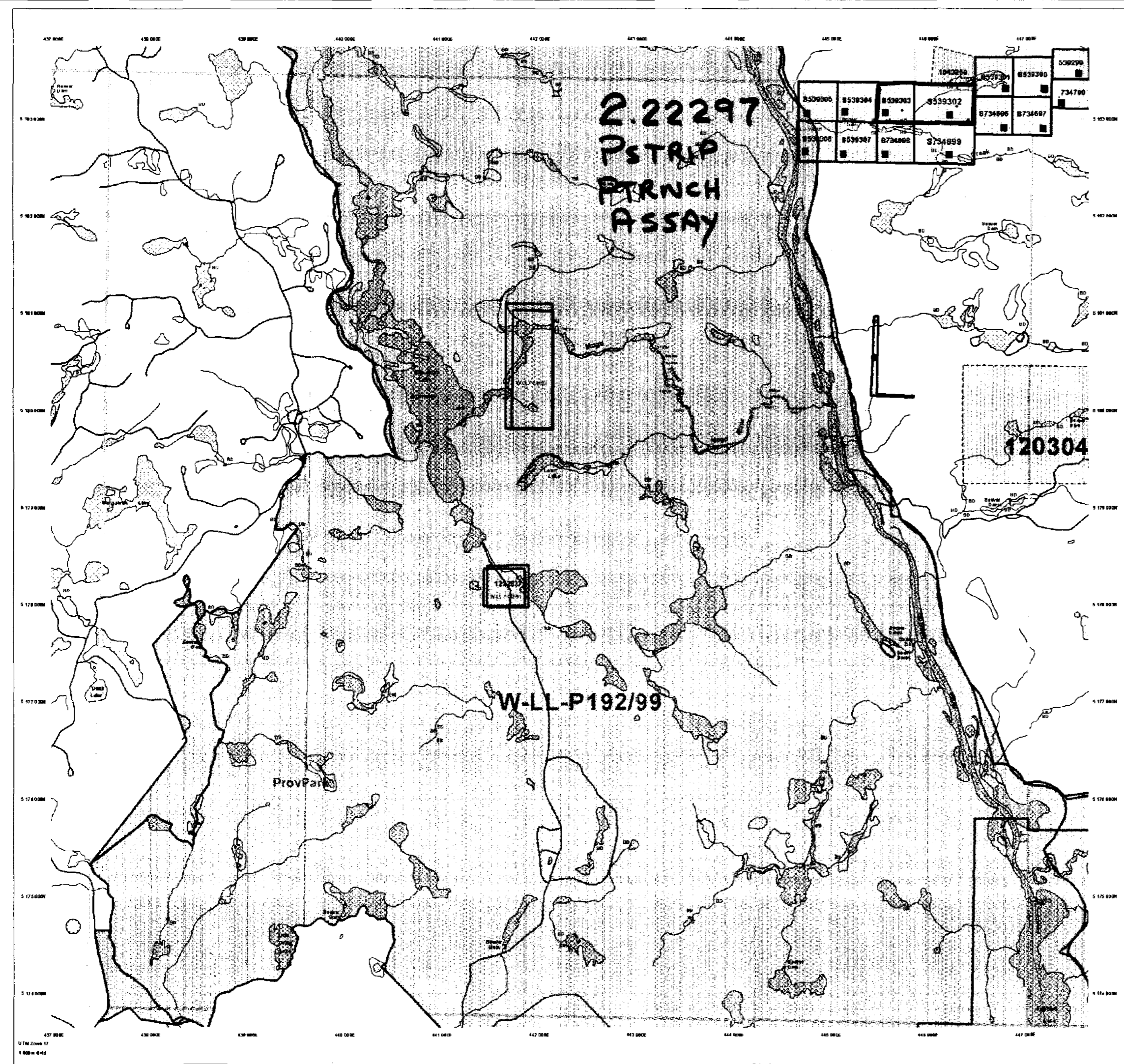

This map is a planning tool and does not constitute a guarantee of the accuracy of the information shown on the map. It is the user's responsibility to verify the information shown on the map with the appropriate authorities. The information shown is derived from the Mining Record Office and is subject to change without notice. The information shown is for informational purposes only and does not constitute a guarantee of the accuracy of the information shown on the map. It is the user's responsibility to verify the information shown on the map with the appropriate authorities.

General Information and Limitations
Contact Information: Provincial Mining Record Office, 1200 University Ave, Sudbury, ON N3A 4W5, Tel: 705-525-4500, Fax: 705-525-4501, www.mnr.gov.on.ca/mining
Map Datum: NAD 83
Projection: UTM (18N)
Source: Mining Records Office
Scale: 1:50,000

This map is not intended to be used as a basis for any legal proceedings or as a basis for any claim of ownership. It is the user's responsibility to verify the information shown on the map with the appropriate authorities. The information shown is for informational purposes only and does not constitute a guarantee of the accuracy of the information shown on the map. It is the user's responsibility to verify the information shown on the map with the appropriate authorities.

