

## Location and Access

*Ray Leclair and*  
Andy J. Leclairs Claim, # 1211398, is located 10 km North of the village of Benny, an old logging town, which is 64 km North of the city of Sudbury. Claim post number two is located at NTM coordinate 5191000N, 442840E. Access to the property is by C.P. Rail only, at this time. Immediately East of the property is an old logging trail that was built years ago when logging was done in the Benny area. Path Creek, which runs from the Northeast to the Southwest, runs diagonally through the middle of the claim. Hydro and water may be obtained from the C.P. Railway and Path Creek respectively. Figure 1 shows the location of Andy Leclairs' property in relation to the city of Sudbury. Figure 2 shows property details with train tracks, creek, and grid layout.

## Topography and Exposure

The property relief consists of hills that are 68 m above the tracks with a small creek running through the property. The outcrop trends Northeast, Southwest. Several small outcrops border the North and East claim lines. There is 90% exposure of the outcrop due to the fact that it is 68 m high with moderate tree cover on top. Forest cover is moderate on the rest of the property with Jack Pines covering the north and west sides of the property along the claim lines. In the southwest corner there is sand and gravel along the creek. There are no swamps on the property.

## Regional Geology

There is no detailed geology of the area since no Ontario Geological Survey or Geological Survey of Canada maps have been done, on this area. General geology of the area, taken from O.G.S. map 2393, Ontario Geological Map, East Central Sheet, consists of early Precambrian rocks with early Felsic Igneous and Metamorphic rocks of the Algoma Formation. This map information ends at the small town of Benny, located ten kilometres south of the claim.

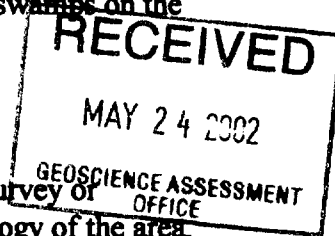

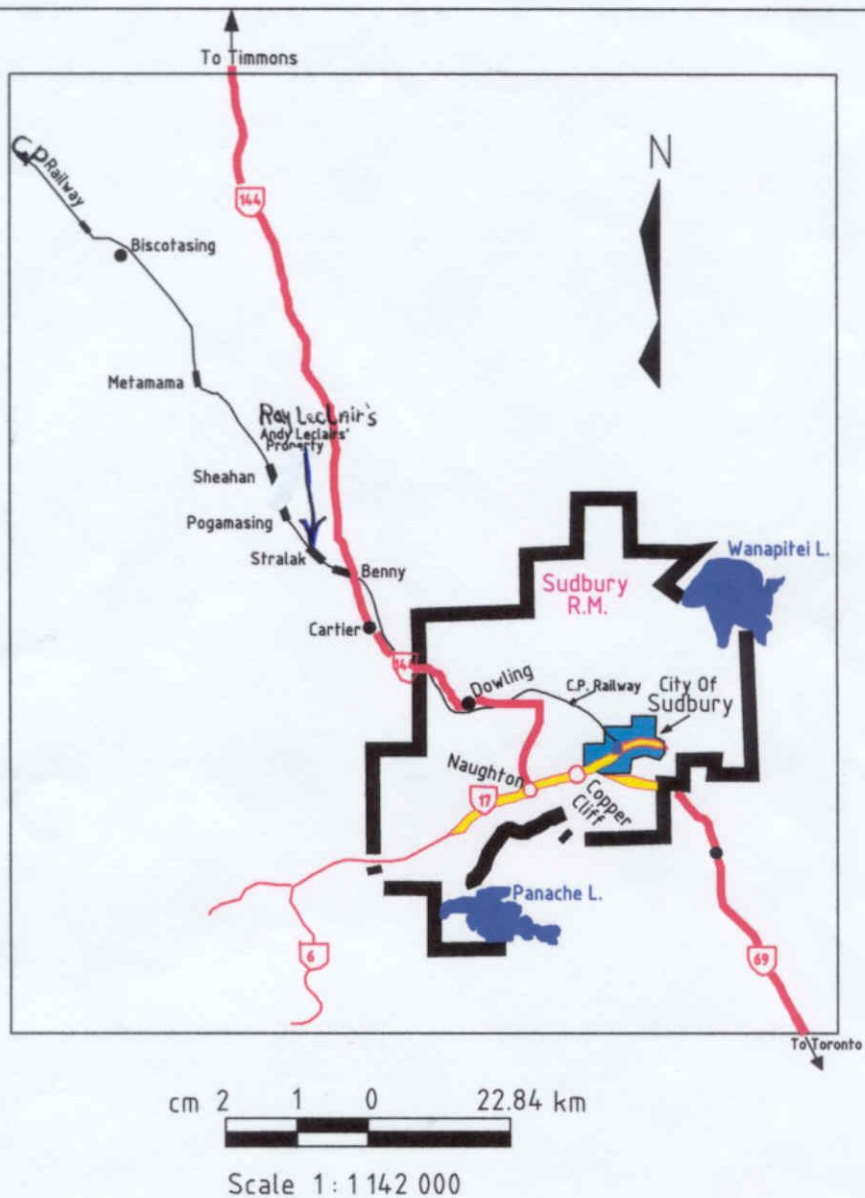

Figure : 1  
 Location map showing Andy Leclair's claim, (# 1211398), in relation to Sudbury.

Search by:  G-Plan Numbers  Township/Area Names  Claims  Disposit

Begin your search by clicking on one of the radio buttons (G-Plan, Township/Area, Claim, or Disposition). Then enter your search criteria in the text box and click on the search button.

Select from a list below and press its "Go" button to jump to the specified view.

Mining Division  G-Plan #  Township / Area

View Reports:

The centre of your map is in: Division: Sudbury Township: STRAL

### Map Tools



Go to Ontario View.

Zoom Factor.



Zoom In



Zoom Out



Pan



Identify Alienation



Identify Disposition



Identify Claim



Legend



Help

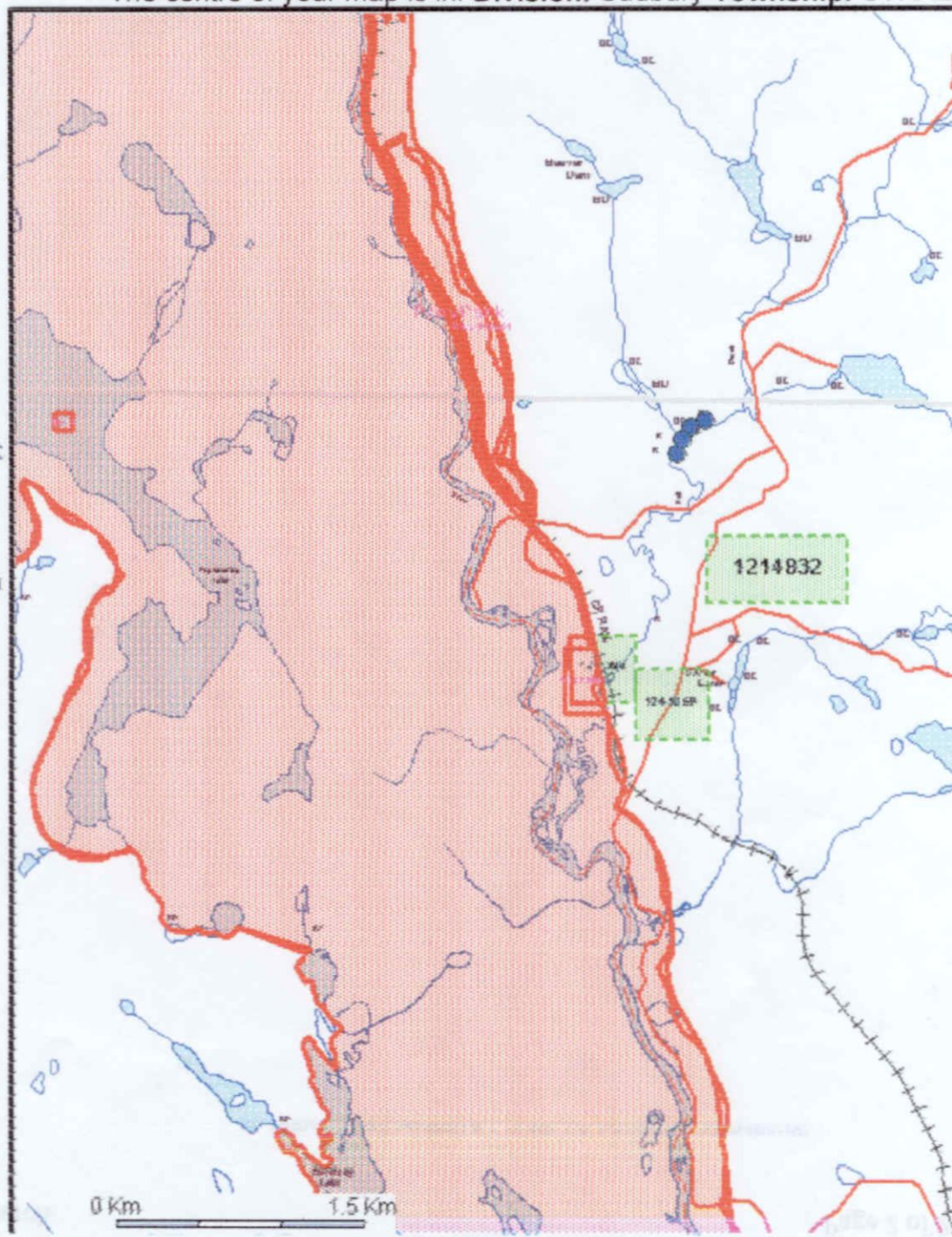

Search by:  G-Plan Numbers  Township/Area Names  Claims  Dispositi

Search!

Help

Begin your search by clicking on one of the radio buttons (G-Plan, Township/Area, Claim, or Disposition). Then enter your search criteria in the text box and click on the search button.

Select from a list below and press its "Go" button to jump to the specified view.

Mining Division

G-Plan #

Township / Area

View Reports:

The centre of your map is in: **Division: Sudbury Township: STRAL**

### Map Tools



Go to Ontario View.

Zoom Factor.



Zoom In

Zoom Out



Pan

Identify Alienation



Identify Disposition

Identify Claim



Legend

Help

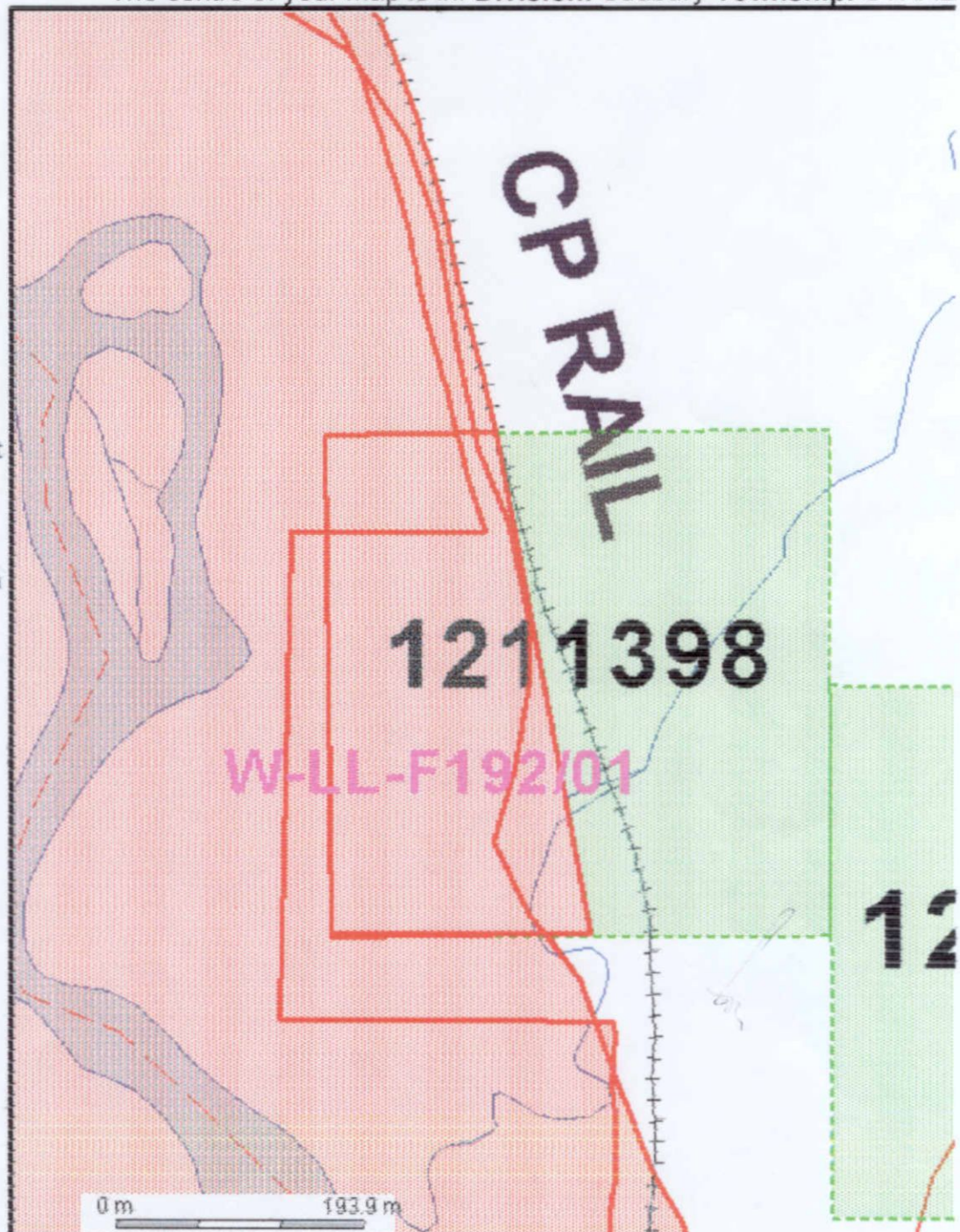

**Swastika Laboratories Ltd.**  
**P.O. Box 10, 1 Cameron Ave.,**  
**Swastika, Ontario P0K 1T0**  
**Tel:(705) 642-3244**  
**Fax:(705) 642-3300**  
**E-Mail:swaslab@nt.net**

# Invoice

DATE	INVOICE #
5/14/2002	4236

To:

**A. LECLAIR**  
**1824 HUNTINGTON DR.**  
**SUDBURY, ONTARIO**

P.O. NO.		TERMS		PROJECT #	
QTY	DESCRIPTION	CERT#	RATE	AMOUNT	
2	Ag	2W-1043-RG1	3.00	6.00T	
2	AS		1.50	3.00T	
2	Co		1.50	3.00T	
2	Cu		1.50	3.00T	
2	Ni		1.50	3.00T	
2	Pb		1.50	3.00T	
2	Zn		1.50	3.00T	
2	Sample Prep		3.50	7.00T	
Business Number: RT883022329					
			<b>GST</b>	2.17	
<b>TOTAL</b>			<b>\$33.17</b>		

name/nom STWARD/LARRY		type SEN	
services			
from/de	date	time/heure	
SUDBURY	ON 30Apr	0940	
to/A	date	time/heure	
POGAMASING	ON 30Apr	1110	
carrier/trans	train	class/klasse	
VIA 185 ECNO Q			
from/de	date	time/heure	
POGAMASING	ON 01Mai	1715	
to/A	date	time/heure	
SUDBURY	ON 01Mai	1900	
carrier/trans	train	class/klasse	
VIA 186 ECNO Q			
fare/prix	GST/TPS 7% HST/TVH 15%	P.S.T./T.V.P.	total
26.00	1.82	0.00	27.82
G.S.T. No./N° T.P.S.	105521785	P.S.T. No./N° T.V.P.	prov.
payment 1/peaiement 1			
DB			27.82CAD
payment 2/peaiement 2			
discount enti. 1/edm. au rabais 1			
discount enti. 2/edm. au rabais 2			
travel credit/crédit voyage			
			Mit 17.0
ref./réf.			VIA PRÉF
issuance/émission			
CA	SUDBSV 23Apr		0930
transaction No./N° de transaction			
NW281 23Apr 02 1717	1	1	

Marek Noj  
508 Kelman

nu./n°nom ECLAIRE/P L RAYMONDE		type SEN	
services			
from/de	date	time/heure	
SUDBURY	ON 30Apr	0940	
to/A	date	time/heure	
POGAMASING	ON 30Apr	1110	
carrier/trans	train	class/klasse	
VIA 185 ECNO Q			
from/de	date	time/heure	
POGAMASING	ON 01Mai	1715	
to/A	date	time/heure	
SUDBURY	ON 01Mai	1900	
carrier/trans	train	class/klasse	
VIA 186 ECNO Q			
fare/prix	GST/TPS 7% HST/TVH 15%	P.S.T./T.V.P.	total
26.00	1.82	0.00	27.82
G.S.T. No./N° T.P.S.	105521785	P.S.T. No./N° T.V.P.	prov.
payment 1/peaiement 1			
DB			27.82CAD
payment 2/peaiement 2			
discount enti. 1/edm. au rabais 1			
discount enti. 2/edm. au rabais 2			
travel credit/crédit voyage			
			Mit 17.0
ref./réf.			VIA PRÉF
issuance/émission			
CA	SUDBSV 23Apr		0930
transaction No./N° de transaction			
NW281 23Apr 02 1716	1	1	



On train cash fare  
Place payée à bord du train

Name/Nom	RAY LECLAIRE		
Train	18.5	Date	April 16 62
From/De	CARTER		
To/A	POGAMASING		
Adult Adulte	<input type="checkbox"/>	3	Child Enfant
Senior Ainé	<input type="checkbox"/>		Other Autre
Student Étudiant	<input type="checkbox"/>		

Price  
Prix \$ 45.00

Price includes applicable tax(es) unless the box is checked. / Le prix inclut toute(s) taxe(s) applicable(s) sauf si la boîte est cochée.

Tax exempt / Exempt de taxe(s)

GST/TPS (7%) 105521785 QST 1001106674  
HST/TVH (15%) TVQ

Ref. of credit card, pass or other  
Réf. de carte de crédit, passe ou autre



Established 1928

# Swastika Laboratories Ltd

Assaying - Consulting - Representation

## Geochemical Analysis Certificate

2W-1043-RG1

Company: **ANDRE LECLAIR**

Date: MAY 14-02

Project:

Attn: A. Leclair

We hereby certify the following Geochemical Analysis of 2 Rock samples submitted MAY-06-02 by .

Sample Number	Ag PPM	As PPM	Co PPM	Cu PPM	Ni PPM	Pb PPM	Zn PPM
#1	0.2	<5	31	293	47	31	154
#2	0.1	<5	28	167	23	1	75

One assay ton portion used.

Certified by *Denis Chantre*

1 Cameron Ave., P.O. Box 10, Swastika, Ontario P0K 1T0  
Telephone (705) 642-3244 Fax (705) 642-3300

STRALAK TWP

CLAIM #121139B

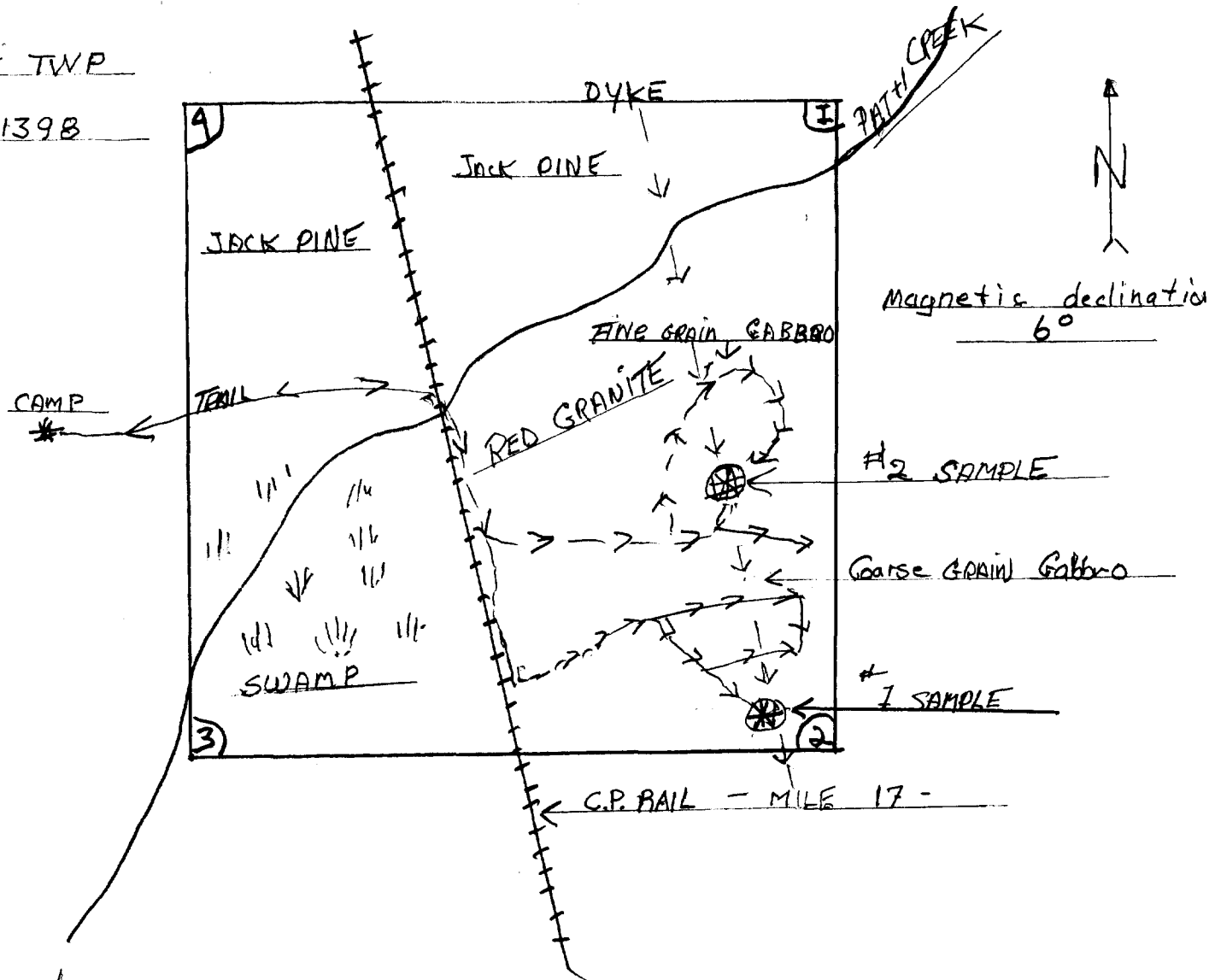

April 16/02 } Travelled by train from CARTIER to MILE 17. with  
April 17/02 } equipment. Went up track and up mountain, cutting  
trees, removing overburden, rocks etc. Got sample no #1  
on second day of prospecting. Took samples out to  
camp, loaded everything and took Train back to CARTIER.  
First sample was taken from a dyke about 30m. from #2 post.

April-30-02- } Took train from SUDBURY to MILE 17, with equipment  
MAY-01-02- } Both days, we did more prospecting on top of  
mountain, moving boulders, overburden, cutting trees.  
On second day took sample about 150 m. from the  
first sample also in a dyke that we followed under  
overburden. Packed up, and took the Train back home.



**Mining Lands - Mining Claims Client Report****Sudbury - Division 70**

05-21-02

**CLIENT: 304053 - LECLAIR, RAYMOND LUCIEN**

<b>TOWNSHIP / AREA</b>	<b>Claim Number</b>	<b>Recording Date</b>	<b>Claim Due Date</b>	<b>Status</b>	<b>Percent Option</b>	<b>Work Required</b>	<b>Total Applied</b>	<b>Total Reserve</b>	<b>Claim Bank</b>
MARQUETTE	S 1231200	1999- JUN-07	2005- JUN-07	A	50.00 %	380	1620	0	0
MARQUETTE	S 1240247	1999- SEP-27	2007- SEP-27	A	50.00 %	400	2400	318	0
MARQUETTE	S 1246433	2000- OCT-11	2002- OCT-11	A	50.00 %	400	0	0	0
STRALAK	S 1211398	1996- AUG-22	2002- AUG-22	A	50.00 %	122	1878	0	0
STRALAK	S 1214832	1999- DEC-09	2002- DEC-09	A	50.00 %	800	800	44	0
STRALAK	S 1241359	2000- OCT-26	2002- OCT-26	A	50.00 %	400	0	0	0

**{ [Back](#) | [Main Menu](#) | [Mining Lands](#) }****© Copyright 2001 Queen's Printer for Ontario****This information is provided as a public service, but we cannot guarantee that the information is current or accurate. Readers should verify the information before acting on it.**



Date: 2002-JUN-27

GEOSCIENCE ASSESSMENT OFFICE  
933 RAMSEY LAKE ROAD, 6th FLOOR  
SUDBURY, ONTARIO  
P3E 6B5

RAYMOND LUCIEN LECLAIR  
141 PATTERSON  
SUDBURY, ONTARIO  
P3C 2J6 CANADA

Tel: (888) 415-9845  
Fax: (877) 670-1555

**Submission Number:** 2.23469  
**Transaction Number(s):** W0270.00752

Dear Sir or Madam

**Subject: Approval of Assessment Work**

We have approved your Assessment Work Submission with the above noted Transaction Number(s). The attached Work Report Summary indicates the results of the approval.

At the discretion of the Ministry, the assessment work performed on the mining lands noted in this work report may be subject to inspection and/or investigation at any time.

If you have any question regarding this correspondence, please contact STEVEN BENETEAU by email at [steve.beneteau@ndm.gov.on.ca](mailto:steve.beneteau@ndm.gov.on.ca) or by phone at (705) 670-5855.

Yours Sincerely,



Ron Gashinski  
Senior Manager, Mining Lands Section

**Cc:** Resident Geologist

Andre Joseph Leclair  
(Claim Holder)

Raymond Lucien Leclair  
(Assessment Office)

Assessment File Library

Raymond Lucien Leclair  
(Claim Holder)



MINISTRY OF  
NORTHERN DEVELOPMENT  
AND MINES  
PROVINCIAL MINING  
RECORDS OFFICE

### MINING LAND TENURE MAP

Date / Time of Issue **May 24 2002** **14:05h Eastern**  
**TOWNSHIP / AREA** **PLAN**  
**STRALAK** **G-4108**

**ADMINISTRATIVE DISTRICTS / DIVISIONS**  
 Mining Division **Sudbury**  
 Land Titles/Registry Division **SUDBURY**  
 Ministry of Natural Resources District **SUDBURY**

TOPOGRAPHIC	LAND TENURE
	<b>Freehold Cases</b>  <b>Leasehold Cases</b>  <b>Licence of Occupation</b>  <b>Land Use Plans</b>  <b>Mining Claims</b> 
LAND TENURE WITHDRAWALS	
IMPORTANT NOTICES	



#### LAND TENURE WITHDRAWAL DESCRIPTIONS

Ministry	Type	Date	Description
234	Wm	Jan 1 2001	FLOODING ILLINOIS FROM 1975 T.L.D. 9112
WLL 922599	Wm	May 12 1989	SEC 25 WLL 922599 ONT. MAY 12 1989 M-5. Notice, this withdrawal was not withdrawn until after a Consolidation Review, consult the Mining Records Office for the regulated boundary as it may be beyond the withdrawal Order.
WLL 119201	Wm	Jul 20 2001	SEC 25 WLL 119201 ONT. JULY 20 2001 M-5
WLL 119201	Wm	Jul 21 2001	SEC 25 WLL 119201 ONT. JULY 21 2001 M-5
WLL 119201	Wm	Jul 21 2001	SEC 25 WLL 119201 ONT. JULY 21 2001 M-5
Provincial	Wm	Nov 21 2000	Henry Lee Provincial Park session
Provincial	Wm	Oct 20 2001	Spanish River Provincial Park
WLL 119209	Wm	May 17 1989	SEC 25 WLL 119209 ONT. MAY 17 1989 M-5 (200 m FROM WATER'S EDGE)
WLL 119201	Wm	Jul 20 2001	SEC 25 WLL 119201 ONT. JULY 20 2001 M-5
Provincial	Wm	Oct 20 2001	Agawa River Provincial Park

#### IMPORTANT NOTICES

Areas under which special regulations, limitations or conditions apply that affect normal prospecting, mining and mineral development activities.

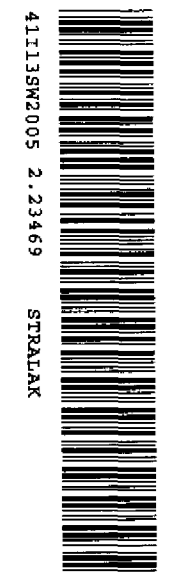
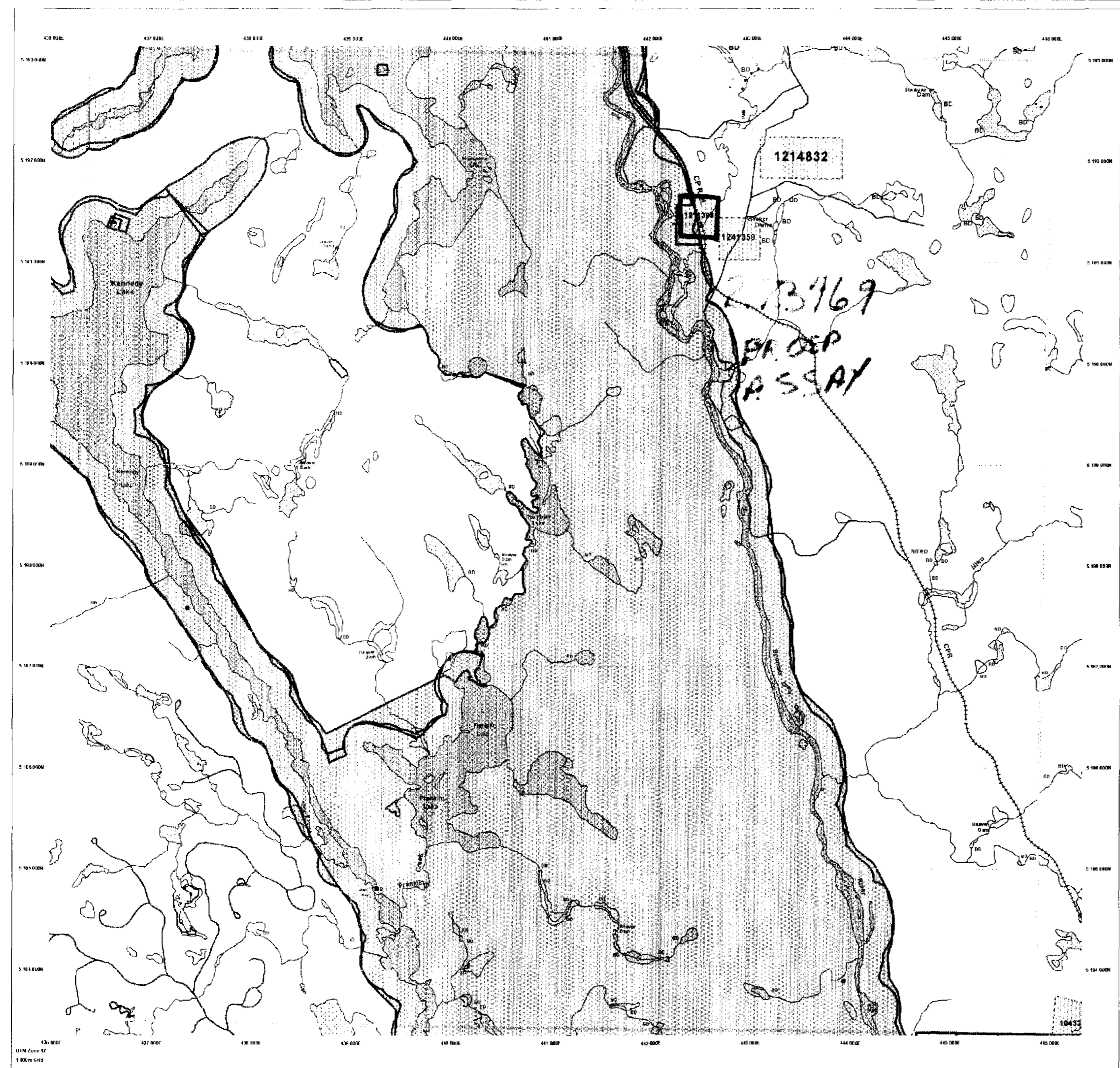

200

This Mining Land Tenure Map should be used in conjunction with the Provincial Mining Records Office of the Ministry of Northern Development and Mines for additional information on the status of mining claims. This map is not intended to be used for legal purposes. It is the responsibility of the user to verify the information shown on this map against the Provincial Mining Records Office. The information shown is derived from digital data available in the Provincial Mining Records Office at the time of downloading from the Ministry of Northern Development and Mines web site.

#### General Information and Limitations

Copyright Information:  
 Provincial Mining Records Office 1-888-318-3188  
 1400 Queen Street East Tel: (905) 415-9865  
 203 Ramsey Lake Road Fax: (905) 570-1444  
 Sudbury, ON P3B 6D5  
 Home Page: www.gov.on.ca/MNDMINE/SR/MSD/SurveyMap.htm

This map may not show complete land tenure and interests in land including certain mineral interests, easements, rights of way, flooding rights, licences, or other forms of encumbrances or rights and interests from the Crown. Also, certain land tenure and interests that cannot be shown on this map may exist. Mining claims may not be shown.