



1114NE0024 0012C1 CREELMAN

010

2.2994

GAMMA RAY SURVEY
ON
URANIUM PROPERTIES
IN
ROBERTS & CREELMAN TOWNSHIPS
GUDFURY MINING DIVISION, CNT.
FOR
TX RESOURCES LIMITED

June 28, 1979.

RECEIVED

JUN 28

MINING LANDS SECTION

Gamma Ray Survey
on
Uranium Properties
in
Roberts and Creelman Townships
Sudbury Mining Division, Ontario
for
TX Resources Limited

SUMMARY

A gamma ray scintillometer survey was carried out on a group of 75 claims covering 3 or more miles of strike along the lower unit of the Bruce Group. These rocks are of a similar age to those that are uranium producing at Elliott Lake, Ontario.

An anomalous zone stretched the full length of the folded sediments. Prospecting is recommended in this area to further the search for uranium.

Additional claims were acquired on strike to the northwest to the south and west of the Creelman Township claims.

Gamma Ray Survey
on
Uranium Properties
in
Roberts and Creelman Townships
Sudbury Mining Division, Ontario
for
TX Resources Limited

INTRODUCTION

Following up on recommendations made by E.O.Chisholm, in a report dated March 25, 1978, for TX Resources Limited, mapping of 61 claims and surveying with scintillometer of 75 claims were completed in November 1978.

The geological and geophysical work is separately described. A report on the geological survey accompanies this report.

PROPERTY AND LOCATION

The property consists of 75 contiguous unpatented claims in Roberts & Creelman Townships, Sudbury Mining Division. Claim numbers are as follows:

429861-69 incl; 442765-86 incl; 442866-86 incl;
443220-31 incl; 443698-703 incl; 438845;
438849-52 incl; and 450064.

The property is located about 20 miles north of Capreol, Ontario and is reached - on the eastern or Creelman side - by rail via the Canadian National railways to mileage 19.5 a siding named Raphoe from which point a drill road leads southward to the small lake on the Burns property. The western or Roberts portion is best served by a private road through the Hanna Mining Company in Hutton Township. A branch road also might serve the southern part of the Creelman group since it approaches within a quarter mile of the southwest corner of the property.

GAMMA RAY SURVEY

The survey was conducted with a threshold spectrometer UG130, manufactured by Urtec Limited, with a threshold value on the total count of 0.5 MEV. The counts were recorded counts per second on the map and contoured. The survey was carried out over lines out and flagged for a geologic survey which is not yet complete. The traverse lines are N-S at 400 feet perpendicular to strike varying from EW on the east to NE-SW to N-S on the west.

DISCUSSION OF RESULTS

The background counts of the property range from 200 to 400 counts per second. An anomalous trend extends from the south end of the property swinging westward through the Burns claims to east-west on the western end of the property. The formations here are easterly dipping. These anomalies represent the lower unit of the Bruce Group of the Huronian. More work will have to be carried out before the importance of these can be assessed. The southern portion appears the most promising. Several more claims were acquired on strike to the southwest on the main anomalous feature.

CONCLUSIONS AND RECOMMENDATIONS

The scintillometer survey has proven an excellent method of outlining the radioactivity in these Huronian rocks. The areas of anomalous readings warrant detailed prospecting work before any drilling is carried out.

Respectfully submitted,

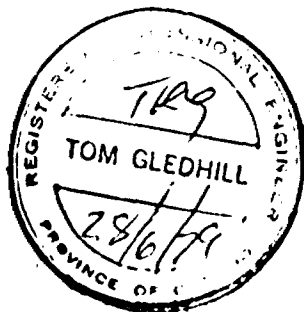

Tom Gledhill, B.A., P.Eng.

SELF POTENTIAL

Instrument _____ Range _____

Survey Method _____

Corrections made _____

RADIOMETRIC

Instrument U.G. 130 Scintillometer

Values measured counts/sec

Energy windows (levels) _____

Height of instrument 4 feet Background Count _____

Size of detector 4 cubic inches

Overburden variable
(type, depth - include outcrop map)

OTHERS (SEISMIC, DRILL WELL LOGGING ETC.)

Type of survey _____

Instrument _____

Accuracy _____

Parameters measured _____

Additional information (for understanding results) _____

AIRBORNE SURVEYS

Type of survey(s) _____

Instrument(s) _____
(specify for each type of survey)

Accuracy _____
(specify for each type of survey)

Aircraft used _____

Sensor altitude _____

Navigation and flight path recovery method _____

Aircraft altitude _____ Line Spacing _____

Miles flown over total area _____ Over claims only _____

Reports to California Claims
 Held by Registrar's Department 1/18/36

Claims	days work
S 429861	20
429862	20
429863	20
429864	20
429865	20
429866	20
429867	20
429868	20
429869	20
S 438845	20 - 1/2 NC
S 438849	20
438850	20
438851	20
438852	20
S 442765	20
442766	20
442767	20
442768	20
442769	20
442770	20
442771	20
442772	20
442773	20
442774	20
442775	20
442776	20
442777	20
442778 1/3	20
442779 1/3	20
442780	20
442781	20
442782	20
442783	20
442784	20
442785	20
S 442866	20
442867	20
442868	20
442869	20
442870	20
442871	20
442872	20
442873	20
442874	20
442875	20
442876	20
442877	20
442878	20
442879	20
442880	20
442881	20
442882	20
442883	20
442884	20
442885	20
442886	20

Claims	days work
S 443220	20
443221	20
443222	20
443223	20
443224	20
443225	20
443226 1/3	20
443227	20
443228	20
443229	20
443230	20
443231	20
S 443698	20
443699	20
443700	20
443701	20
443702	20
443703	20

5450064 20 1/3

allow full credits as the
 claims were well traversed

BERESFORD TWP. M. 140

GREELMAN TWP.

SCALE 1" = 40 CHAINS

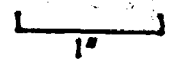

ROBERTS TWP. M. 1078

FRALECK TWP. M. 816

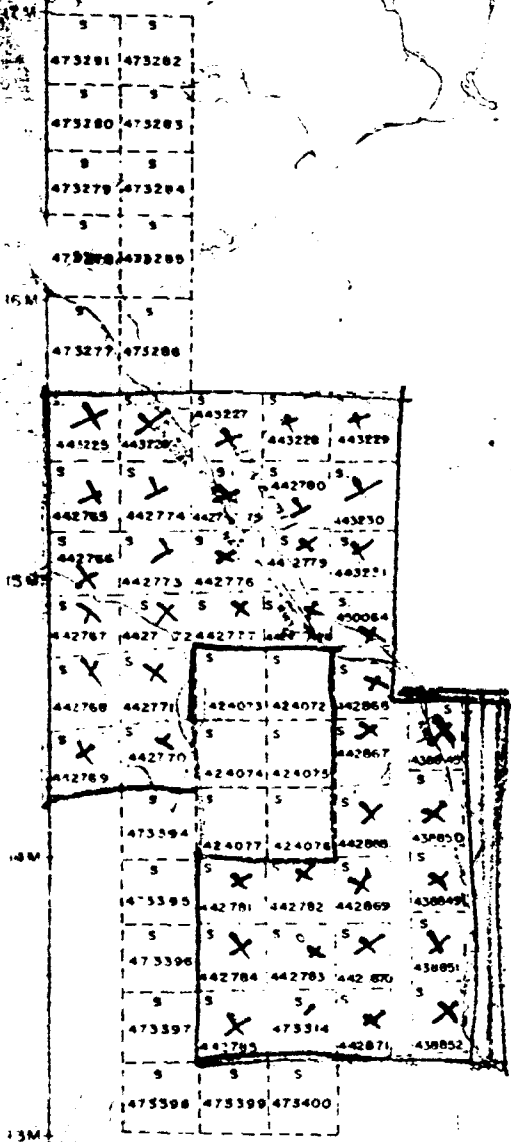
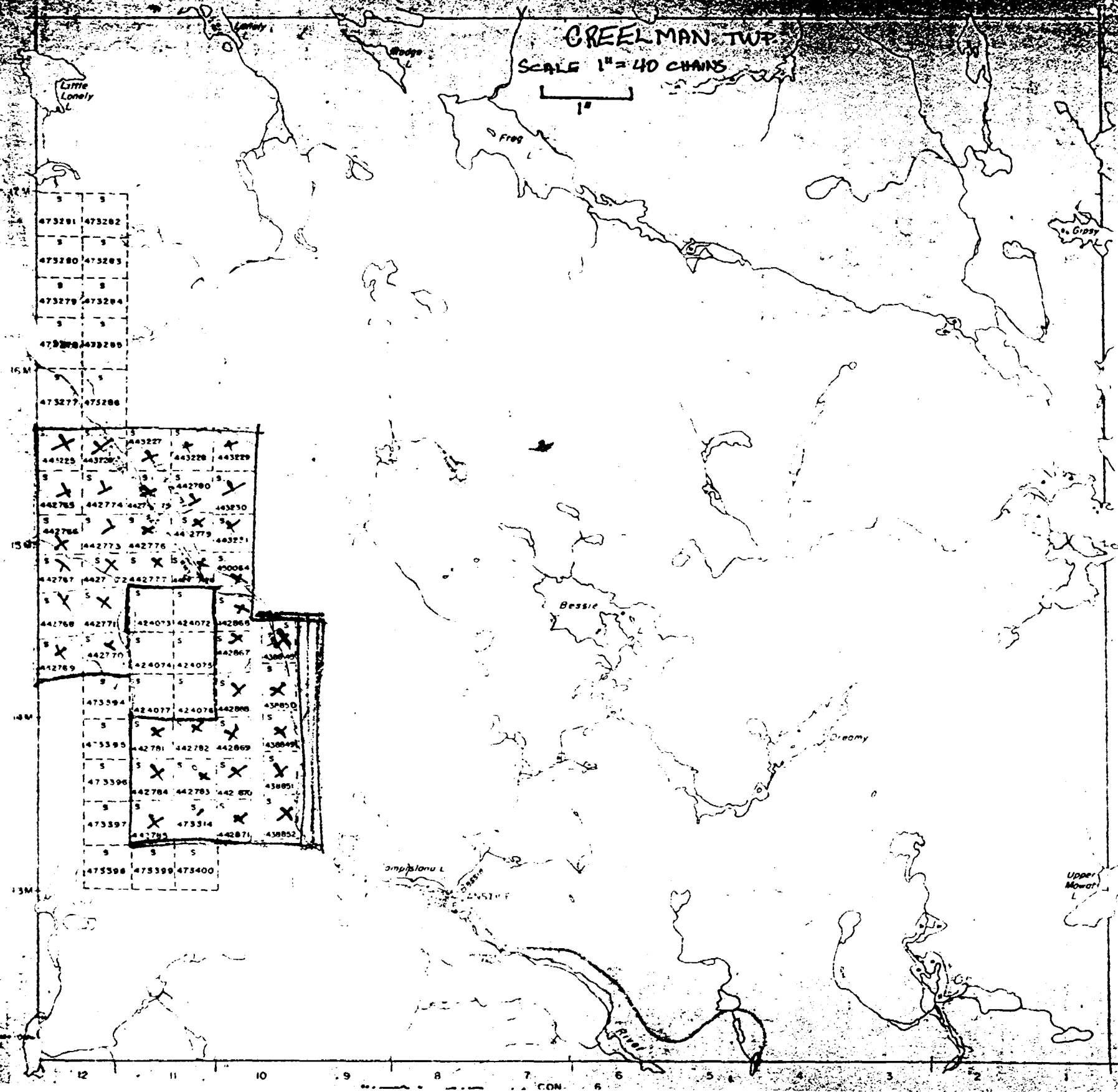

Botha Twp. M. 674

Creelman Twp. M. 737

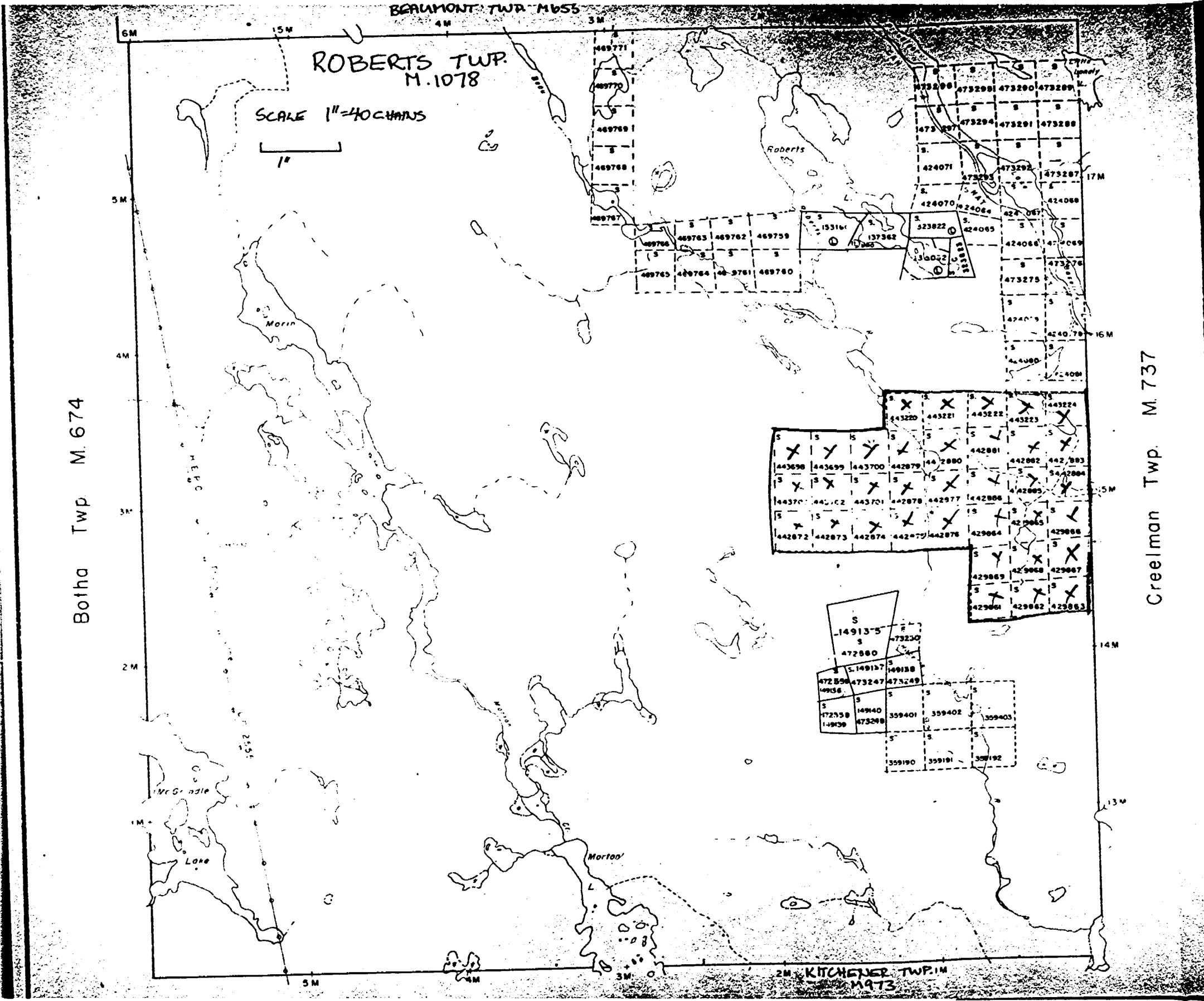

SEE ACCOMPANYING
MAP(S) IDENTIFIED AS

CREEKMAN - 0012 - C1 #1

#2

LOCATED IN THE MAP
CHANNEL IN THE FOLLOWING
SEQUENCE (X)

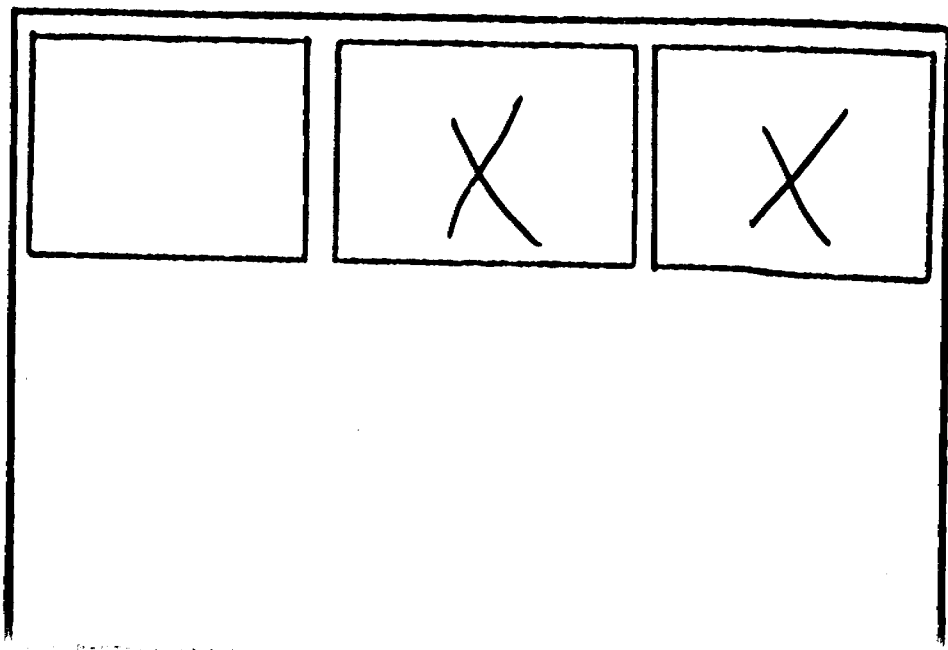

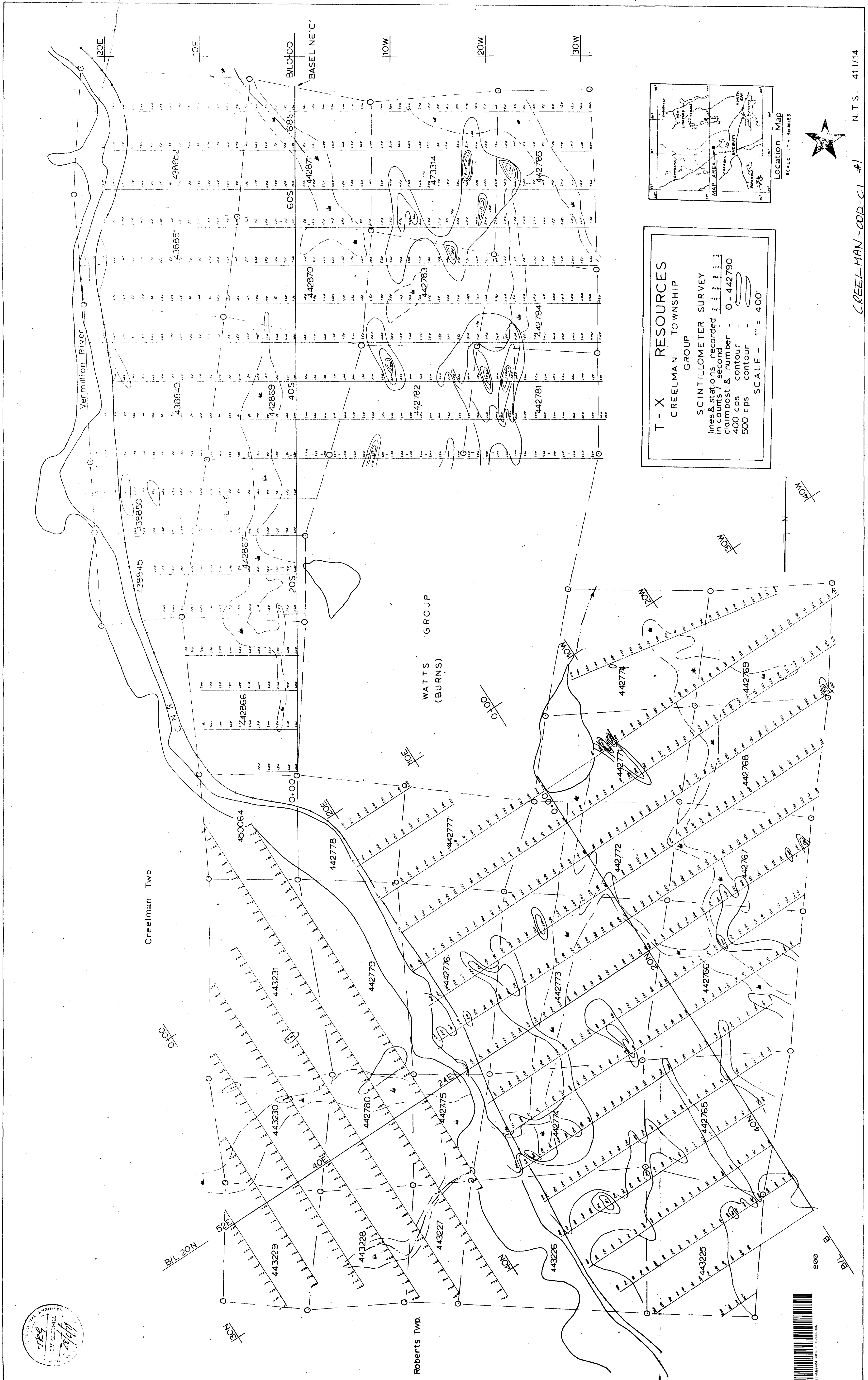

T - X RESOURCES
 CREELMAN TOWNSHIP GROUP
 SCINTILLOMETER SURVEY
 lines & stations recorded in counts / second
 claim post & number - 0 - 442790
 400 cps contour -
 500 cps contour -
 SCALE - 1" = 400'

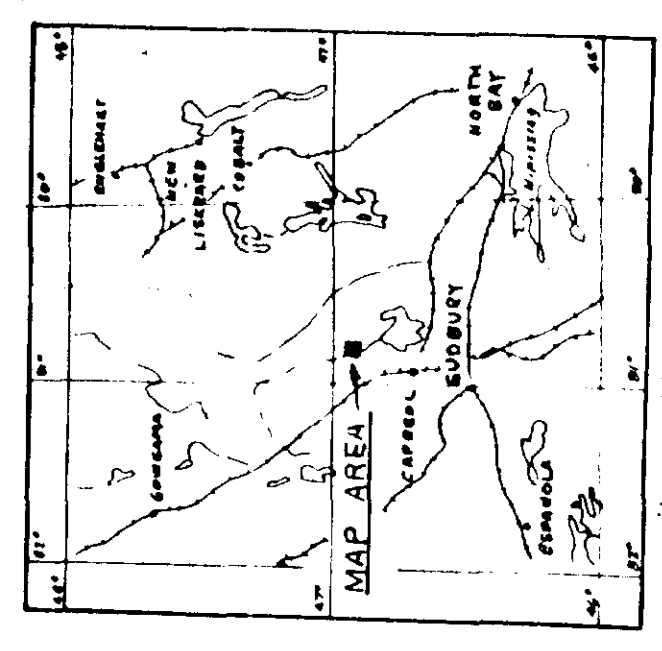

Location Map
 SCALE 1" = 30 MILES

CREELEMAN - 002-C1 #1 N.T.S. 41/1/14

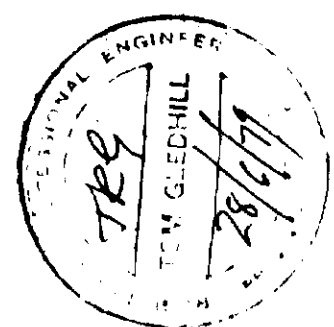

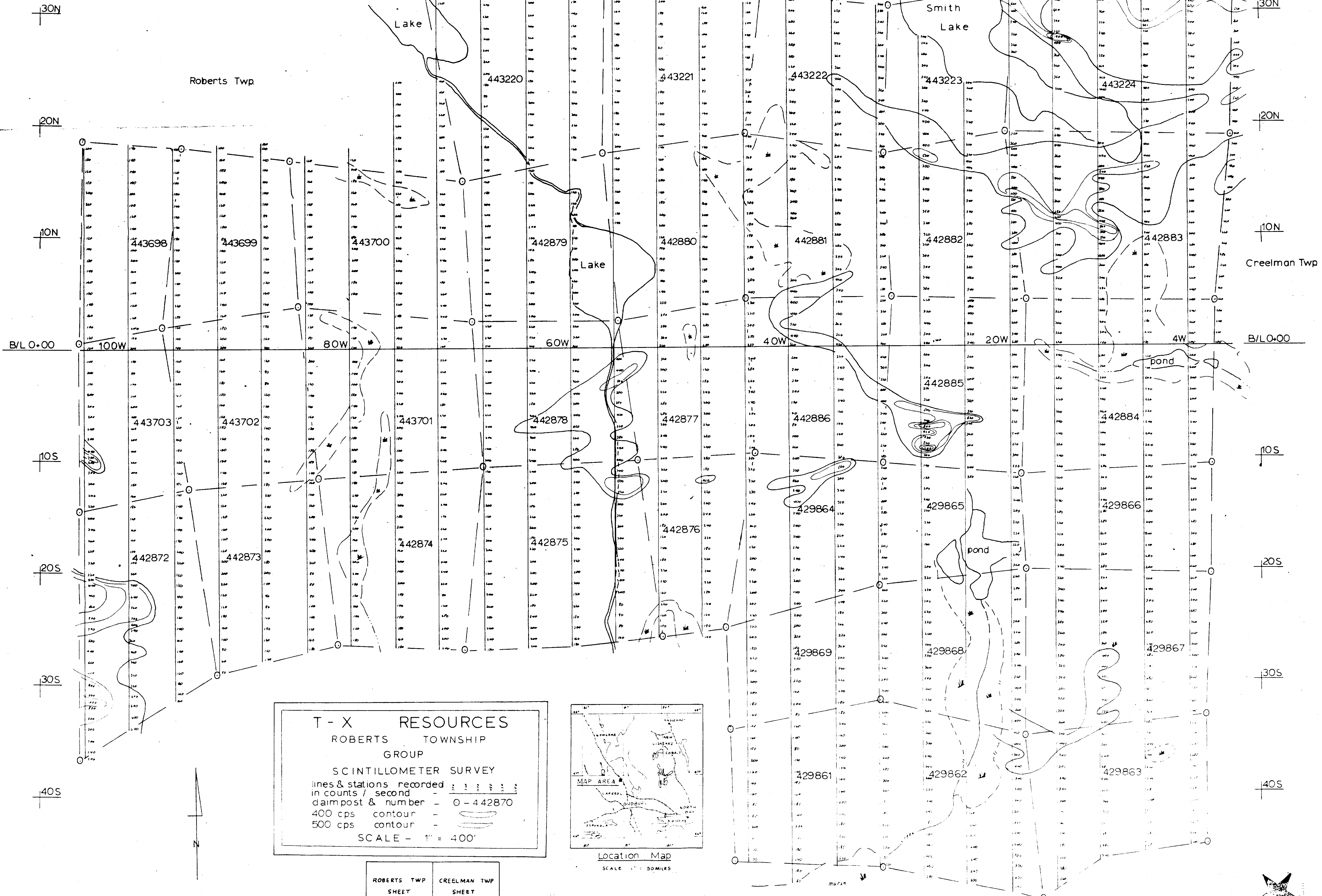

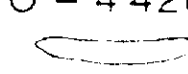
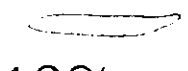
T - X RESOURCES
 ROBERTS TOWNSHIP GROUP
 SCINTILLOMETER SURVEY
 lines & stations recorded in counts / second
 daimpost & number - 0 - 442870
 400 cps contour - 
 500 cps contour - 
 SCALE - 1" = 400'

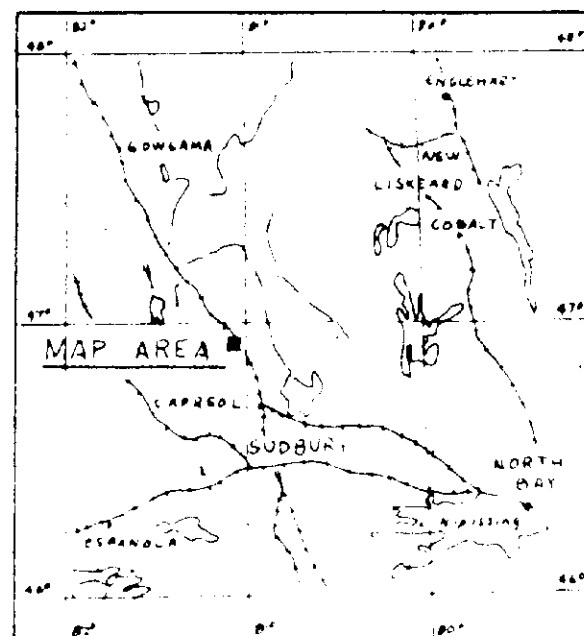

Location Map
SCALE 1" = 50 MILES

ROBERTS TWP SHEET	CREELMAN TWP SHEET
-------------------	--------------------

KEY MAP

