



Re WORK REPORT by J. BRADY - dated JAN 21/93 Hutton Twp claim 1117877

(A) Contractor - Tidewater Construction - Komatsu Excavator.

July 26/92 - 8 hrs @ 100.00 = 800.00

Aug 20/92 - 8.5 hrs @ 100.00 = 850.00

GST. 115.50

~~the~~ Total. 1765.50

(B) Rental: Pioneer Gas Drill and WATAX Fire Pump.

July 26, 27, 28, 30

Aug 19, 20, 21, 22, 23, 28, 29, 30

① Gas Drill 2 weeks @ 500.00 / wk including steel. 1000.00

② WATAX Pump 2 weeks @ 500.00 / wk including hose 1000.00

Total 2000.00

Total of (A) 1765.50

+ (B) 2000.00

Total 3765.50.

(C) Labour:

J BRADY 1227 Holland Rd. Sudbury.

M. BRADY 1227 Holland Rd. Sudbury

July 26, 27, 28, 30

Aug 19, 20, 21, 22, 23, 28, 29, 30

Total 12 days x 2 workers = 24 man days

@ 100.00 = 2400.00

Totals of (A) 1765.50

+ (B) 2000.00

+ (C) 2400.00

6165.50



**TIDEWATER TRUCKING CORPORATION
C.O.B. TIDEWATER CONSTRUCTION**

COMMERCIAL AND RESIDENTIAL
100 GARLAND STREET
SUDBURY, ONTARIO P3B 3P1 Tel. 522-5979

RENTED TO: John Beady,

LOCATION OF WORK: Behind Capreal

DATE		OPERATOR	YOUR ORDER NO.	OUR ORDER NO.	TERMS	
1992 Aug 20		<u>Ken Tremblay</u>			NET 30 DAYS 2% SERVICE CHARGE PER MONTH	
EQUIPMENT TYPE	JOB SITE	DESCRIPTION	HOURS	RATE PER HOUR/FOOT	AMOUNT	
1 1/2 Yrd	Excavator	STRIP ROCK - Hutton Tap.	8 1/2 hrs 8 hrs		Aug 20 1992 July 26 1992	
			16 1/2 hrs.			
			x 100.00/hr			
			1650.00.			
			215.50.			
			<u>1765.50</u>			
E. & O. E.		GST R106305618				
		FEDERAL SALES TAX L.T.C. NO. GST-12550.	PROV. SALES TAX L.T.C. NO.	TOTAL		

2939

PAY BY INVOICE — NO STATEMENT WILL BE ISSUED

JOB SUPERVISOR SIGNATURE [Signature]

INVOICE



BLUELINE

DATE Dec 10 19 92

RECEIVED FROM
RECU DE

J BRADY

Re Kellon King

Two Thousand

2 DOLLARS

2550B

FOR
POUR

Rental Pioneer Drill 2 weeks @ 500. total 1000.00

WATAX FIRE Pump 2 weeks @ 500 total 1000.00

FROM
DE

July 26/92

to Aug 30/92

total 2000.00

\$ 2000.00

BY
PKR

Geoff Vardak

1221 NOTTAWAN ROAD
Sudbury, Ontario
P3A 3R1

January 12, 1993

TO:
MINING RECORDER
M.N.O.M., Sudbury
ATT. MEGHANIE
RE: WORK REPORT

1) Building Stone - Hutton township (Map 6)

The Espanola limestone beds in Lot 4, Concession IV, Hutton township are not well exposed and our objective was to strip and expose portions of the bed to determine continuity and to test the limestone for building stone potential. The program demonstrated that the limestone beds are continuous, are widely

page 2

spaced (2-3 m). Cutting and polishing highlighted an attractive gray-white marble with black to green wavy lines and white to pink calcitic inclusions.

Two samples from the deposit were assayed for gold but gave only a trace response. In addition, sample No. 182198 was submitted for a multi-element analysis. (Accurassay Laboratories, Certificate of Analysis 45900). This analysis gave values of:

Ca	18.02%
Mg	11.29%
Si	0.73%
Al	0.54%

Meyn (1970) reports that "For the manufacture of Portland cement the limestone should contain less than 2.5% magnesia. Silica should not exceed 13% and alumina should not exceed 3.7%". Sample 182198 gives calculated values of:

CaCO ₃	45.05%
MgCO ₃	39.14%
SiO ₂	1.56%
Al ₂ O ₃	1.02%

On the basis of the magnesia content of one sample the material is not suitable for Portland cement however, the silica and alumina contents are acceptable. Additional work may indicate areas of acceptable magnesia content, i.e., less than 2.5%. This work is of a very preliminary nature however, it indicates that additional exploration and sampling may indicate material acceptable for agricultural and/or industrial applications. The work to date has indicated a significant tonnage of limestone is available if material of appropriate

grade can be obtained.

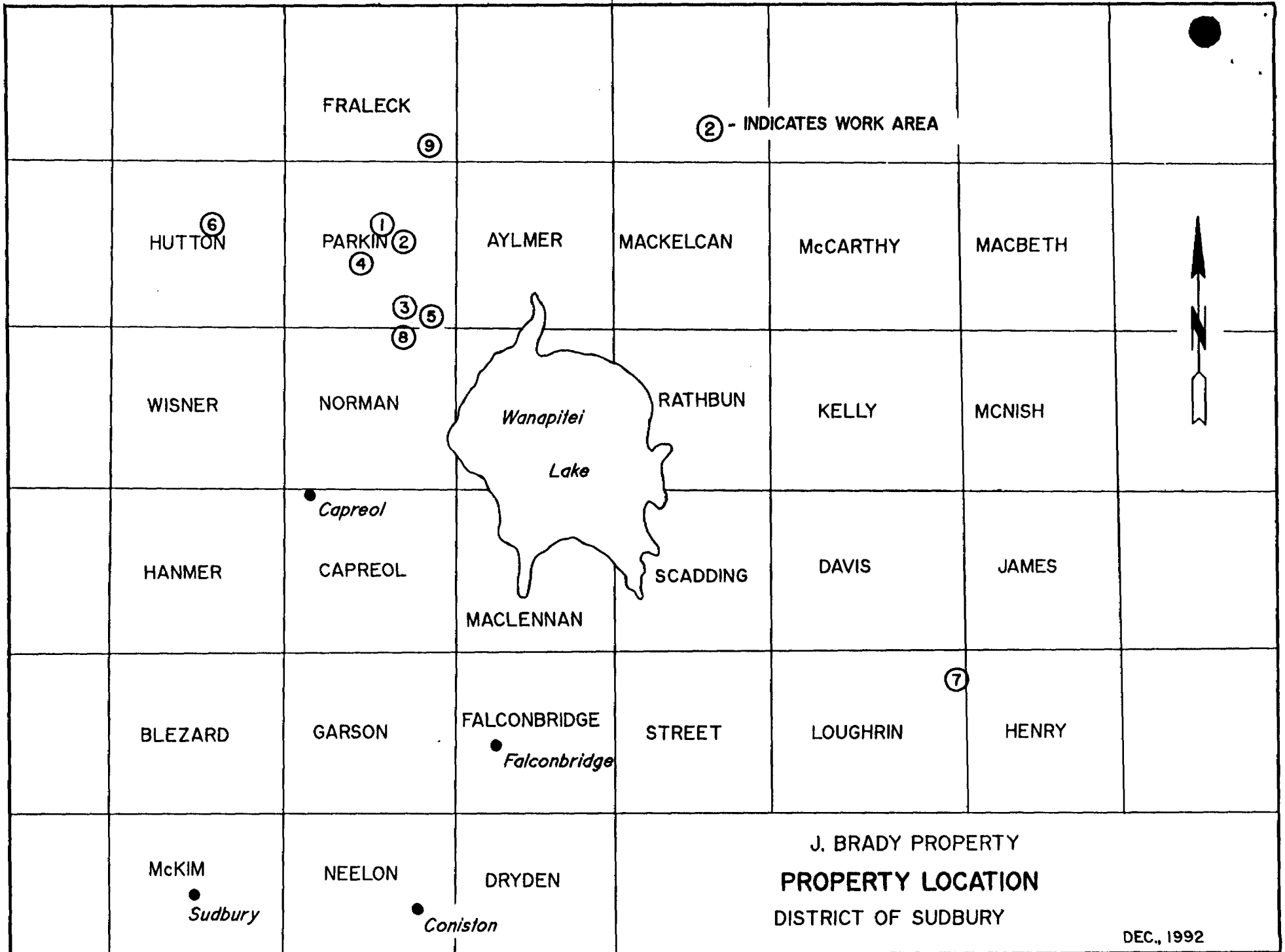

J. BRADY PROPERTY
PROPERTY LOCATION
 DISTRICT OF SUDBURY

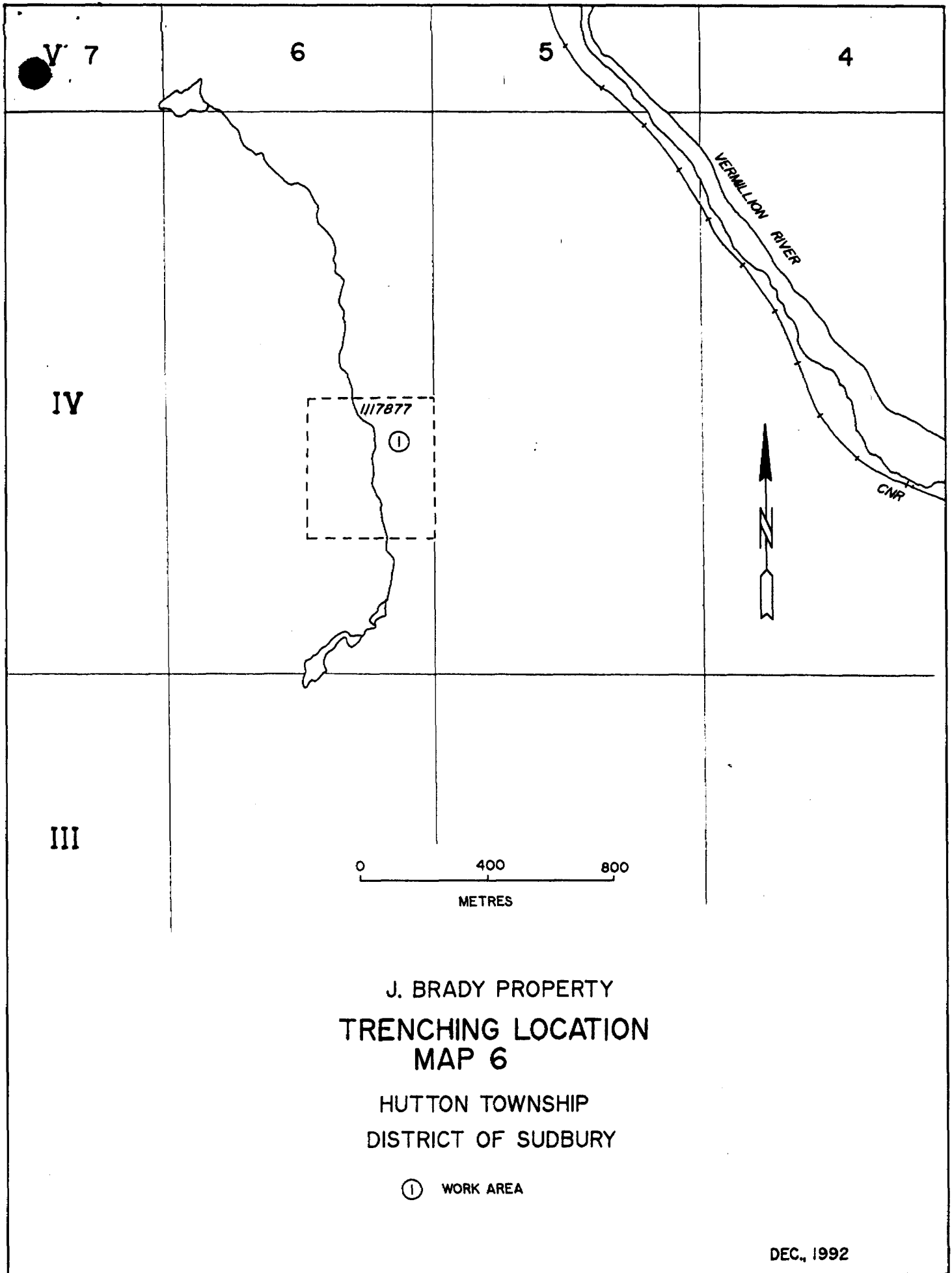

DEC., 1992

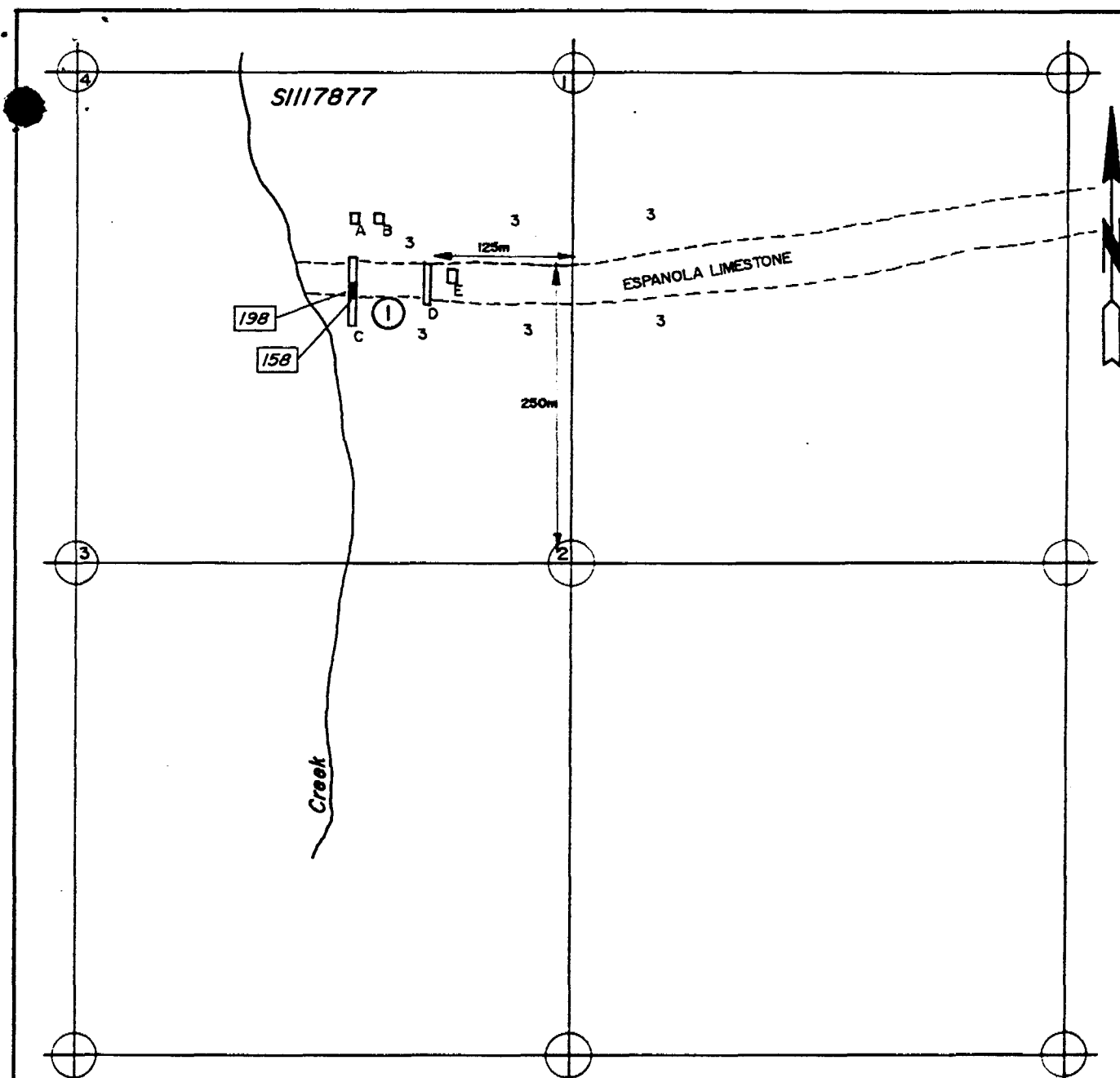

SCALE: 1 : 500

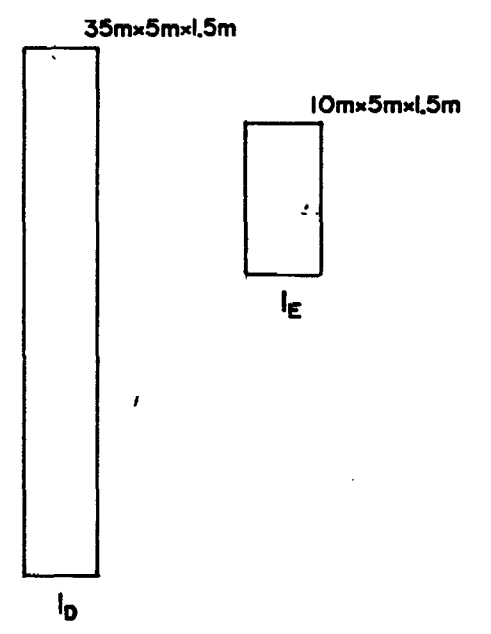
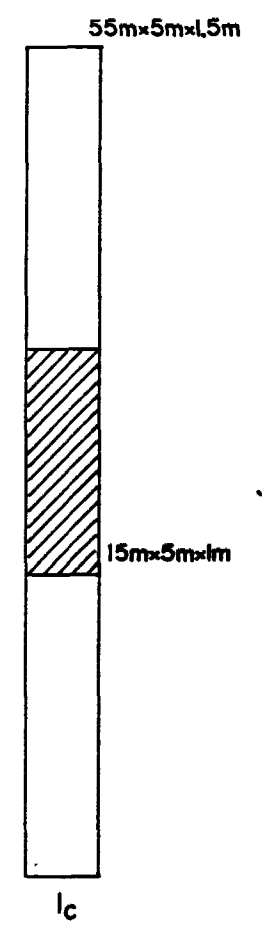
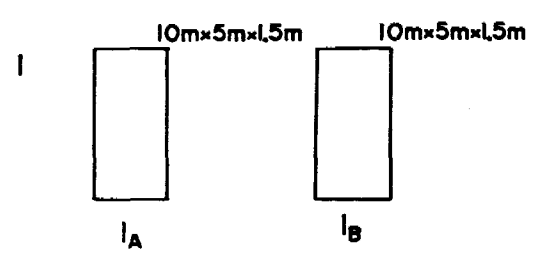

LEGEND

- 5 QUARTZ DIABASE
- 4 QUARTZ DIORITE DYKE
- 3 GREYWACKE
- 2 FELSIC VOLCANICS
- 1 MAFIC VOLCANICS
- Ⓢ SULPHIDES



- ① WORK AREA
- ROAD
- - - TRAIL
- 198 SAMPLE NUMBER

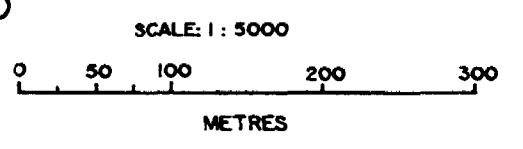

J. BRADY PROPERTY

TRENCHING
MAP 6

DISTRICT OF SUDBURY
TOWNSHIP: HUTTON
BASE MAP NO: G4066
DATE:



Ministry of
Northern Development
and Mines

**Report of Work Done
After Recording**

Mining Act



41114SE0001 63.6175 HUTTON

900

Personal information collected on this form is obtained under the authority of the MI
this collection should be directed to the Provincial Manager, Mining Lands, Ministry of Northern Development and Mines, Fourth Floor, 159 Cedar Street,
Sudbury, Ontario, P3E 6A5, telephone (705) 670-7264.

63.6175

- Instructions:**
- Please type or print and submit in duplicate.
 - Refer to the Mining Act and Regulations for requirements of filing assessment work or consult the Mining Recorder.
 - A separate copy of this form must be completed for each Work Group.
 - Technical reports and maps must accompany this form in duplicate.
 - A sketch, showing the claims the work is assigned to, must accompany this form.

Recorded Holder(s) <i>John Brady / Randy White</i>	Client No. <i>111562</i>
Address <i>1227 Holland Rd.</i>	Telephone No. <i>5254129</i>
Mining Division <i>Sudbury Ont.</i>	Township/Area <i>Hutton Twp.</i>
Dates Work Performed From: <i>July 26/92</i>	To: <i>Aug 30/92</i>
	M or G Plan No. <i>64066</i>

Work Performed (Check One Work Group Only)

Work Group	Type
Geotechnical Survey	
Physical Work, Including Drilling	<i>Power Stripping, Trenching, washing, manual, mechanical.</i>
Rehabilitation	
Other Authorized Work	
Assays	
Assignment from Reserve	

ONTARIO GEOLOGICAL SURVEY
GIS - ASSESSMENT FILES
RECEIVED

Total Assessment Work Claimed on the Attached Statement of Costs FES \$ *71493.00*

Note: The Minister may reject for assessment work credit all or part of the assessment work submitted if the recorded holder cannot verify expenditures claimed in the statement of costs within 30 days of a request for verification.

Persons and Survey Company Who Performed the Work (Give Name and Address of Author of Report)

Name	Address
<i>J. BRADY</i>	<i>1227 Holland Rd. Sudbury, ONT. P3A3R1</i>

RECORDED
JAN 22 1993

(attach a schedule if necessary)

Certification of Beneficial Interest * See Note No. 1 on reverse side

I certify that at the time the work was performed, the claims covered in this work report were recorded in the current holder's name or held under a beneficial interest by the current recorded holder.

Date: *Jan 21/93* Recorded Holder or Agent (Signature): *Brady*

Certification of Work Report

I certify that I have a personal knowledge of the facts set forth in this Work report, having performed the work or witnessed same during and/or after its completion and annexed report is true.

Name and Address of Person Certifying: *J. BRADY 1227 Holland Rd. Sudbury, ONT. P3A3R1*

Telephone No.: *5254129* Date: *Jan 21/93* Certified By (Signature): *Brady*

For Office Use Only

Total Value Cr. Recorded <i>46 7149</i>	Date Recorded <i>January 20/93</i>	ACTING Mining Recorder <i>K. Biron</i>	Received Stamp RECEIVED
	Deemed Approval Date <i>April 22, 1993</i>	Date Approved	<i>JAN 22 1993</i>
	Date Notice for Amendments Sent		A.M. 7 8 9 10 11 12 1 2 3 4 5 6 P.M.

Statement of Costs for Assessment Credit

Transaction No./N° de transaction

État des coûts aux fins du crédit d'évaluation

Mining Act/Loi sur les mines

Personal information collected on this form is obtained under the authority of the Mining Act. This information will be used to maintain a record and ongoing status of the mining claim(s). Questions about this collection should be directed to the Provincial Manager, Minings Lands, Ministry of Northern Development and Mines, 4th Floor, 159 Cedar Street, Sudbury, Ontario P3E 6A5, telephone (705) 670-7264.

Les renseignements personnels contenus dans la présente formule sont recueillis en vertu de la Loi sur les mines et serviront à tenir à jour un registre des concessions minières. Adresser toute question sur la collecte de ces renseignements au chef provincial des terrains miniers, ministère du Développement du Nord et des Mines, 159, rue Cedar, 4^e étage, Sudbury (Ontario) P3E 6A5, téléphone (705) 670-7264.

1. Direct Costs/Coûts directs

Type	Description	Amount Montant	Totals Total global
Wages Salaires	Labour Main-d'oeuvre	2400	2400
	Field Supervision Supervision sur le terrain		
Contractor's and Consultant's Fees Droits de l'entrepreneur et de l'expert-conseil	Type EXCAVATOR	1765. ⁵⁰	
			1765. ⁵⁰
Supplies Used Fournitures utilisées	Type		
Equipment Rental Location de matériel	Type PIONEER Drill	1000. ⁰⁰	
	WATAX Pump	1000. ⁰⁰	
Total Direct Costs Total des coûts directs			6165.⁵⁰

2. Indirect Costs/Coûts indirects

** Note: When claiming Rehabilitation work indirect costs are not allowable as assessment work. Pour le remboursement des travaux de réhabilitation, les coûts indirects ne sont pas admissibles en tant que travaux d'évaluation.

Type	Description	Amount Montant	Totals Total global
Transportation Transport	Type If any of these categories are being included in Direct Costs, they must be broken down & included in Indirect costs.		
	4x4 Dodge 140KM x 12 TRIPS x .30	504. ⁰⁰	504
Food and Lodging Nourriture et hébergement	400 ⁰⁰ /day x 12	480. ⁰⁰	480
Mobilization and Demobilization Mobilisation et démoblisation			
Sub Total of Indirect Costs Total des coûts indirects			984
Amount Allowable (not greater than 20% of Direct Costs) Montant admissible (n'excédant pas 20% des coûts directs)			984
Total Value of Assessment Credit (Total of Direct and Allowable Indirect costs) Valeur totale du crédit d'évaluation (Total des coûts directs et indirects admissibles)			7149.

Note: The recorded holder will be required to verify expenditures claimed in this statement of costs within 30 days of a request for verification. If verification is not made, the Minister may reject for assessment work all or part of the assessment work submitted.

Note: Le titulaire enregistré sera tenu de vérifier les dépenses demandées dans le présent état des coûts dans les 30 jours suivant une demande à cet effet. Si la vérification n'est pas effectuée, le ministre peut rejeter tout ou une partie des travaux d'évaluation présentés.

Filing Discounts

- Work filed within two years of completion is claimed at 100% of the above Total Value of Assessment Credit.
- Work filed three, four or five years after completion is claimed at 50% of the above Total Value of Assessment Credit. See calculations below:

Total Value of Assessment Credit	Total Assessment Claimed
	x 0.50 =

Remises pour dépôt

- Les travaux déposés dans les deux ans suivant leur achèvement sont remboursés à 100 % de la valeur totale susmentionnée du crédit d'évaluation.
- Les travaux déposés trois, quatre ou cinq ans après leur achèvement sont remboursés à 50 % de la valeur totale du crédit d'évaluation susmentionné. Voir les calculs ci-dessous.

Valeur totale du crédit d'évaluation	Evaluation totale demandée
	x 0,50 =

Certification Verifying Statement of Costs

I hereby certify: that the amounts shown are as accurate as possible and these costs were incurred while conducting assessment work on the lands shown on the accompanying Report of Work form.

that as Recorded Holder I am authorized (Recorded Holder, Agent, Position in Company)

to make this certification

Attestation de l'état des coûts

J'atteste par la présente: que les montants indiqués sont le plus exact possible et que ces dépenses ont été engagées pour effectuer les travaux d'évaluation sur les terrains indiqués dans la formule de rapport de travail ci-joint.

Et qu'à titre de _____ je suis autorisé (titulaire enregistré, représentant, poste occupé dans la compagnie)

à faire cette attestation.

Signature Brady Date Jan 21/93