

010

DIAMOND DRILLING

TOWNSHIP: HUTTON TWP.

REPORT NO: 24

WORK PERFORMED FOR: Edward Reed

RECORDED HOLDER: Same as Above [xx]
: Other []

<u>Claim No.</u>	<u>Hole No.</u>	<u>Footage</u>	<u>Date</u>	<u>Note</u>
S 853927	R-4	201	Sept/88	(1)

NOTES: (1) #W8807, 217 filed Feb/89

PROPERTY REEDMAC PROSPECTING SYNDICATE

D.D.H. No. R-4
LOCATION 5+65S 3+40W
S-853927
SECTION 6+00S

LATITUDE _____ **STARTED** Sept. 12, 1988
DEPARTURE _____ **COMPLETED** Sept. 30, 1988
ELEVATION _____ **V.D.** _____ **H.D.** _____

BEARING East **DEPTH** 201.0
DIP -45°

GENERAL GEOLOGY	ASSAY		SAMPLE		FOOTAGE	ECONOMIC GEOLOGY
	OZ.	VALUE	FEET	NUMBER		
0.0-54.0 Andesite, dark green, altered with dykes stringers and fragments of red to white granite.						
0.5-2.7 Red granite dyke, contacts at 60° to the core.						
33.5-35.0 Siliceous white granite, 60% grey quartz, sulphides rare.						
35.5-37.6 Siliceous whiye and pink granite, 50% grey quartz, bleb of ZnS and chalco at 37.5 feet. Contacts 60° to the core.						
39.0-39.6 white granite dyke, 60° to the core.						
40.2-45.0 Grey granite, somewhat porphyritic local blebs of po, speck of chalco.						
48.1-49.6 Grey granite as above.						

Paul W. Jan

GENERAL GEOLOGY	ASSAY		SAMPLE		FOOTAGE	ECONOMIC GEOLOGY
	OZ.	VALUE	FEET	NUMBER		
54.0-60.3 Mineralized zone, in part siliceous. 02 - bedded sediment. 10% to 30% po with specks of chalco.	cu Zn Au	Ag Nil	.01	6.3	650	54.0-60.3 Mineralized zone, cherty sediments 10% to 30% pyrrhotite, specks of chalcopyrite.
60.3-65.8 highly altered zone with 7% dissem- po with specks of ZnS throughout. Minor chalco. considerable brown biotite in this section.	.02	Nil	.02	5.5	651	60.3-65.8 Highly altered lava with fine po throughout. Brown biotite common.
65.8-139.6 Andesite, patches of brown biotite to 70 feet, then becoming more normal looking lava.						
70.0-72.0 grey granite						
90.0-90.7 pink granite						
118.3-119.4 silicified and altered granite with narrow seams of po and a little chalco.						
123.5-131.4 50% grey granite fragments						
139.6-147.5= Bedded section 85° to the core, 15% sulphides, mostly po with a little chalco and ZnS also present.	.05.25	Nil	trace	2.5	652	145.0-147.4 Mineralized zone, fine magnetite with local sulphides, specks of chalco 15% pyrrhotite, a few grains of ZnS Some graphite noted.
144.6-145.0 pegmatite dyke, mostly quartz with feldspar xtals.						

S-839703

2

S-839799

S-853927

S-853928

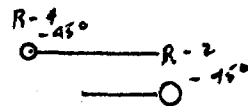

TRENCH 56' X 8', 4' TO 8' DEEP

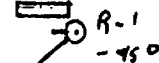

BASE LINE

ROBERTS RIVER

REEDMAC PROSPECTING SYNDICATE
PLAN OF DRILLING



Scale:

1 inch = 200 feet

Paul H. L.

Oct 1, 1986

Aug 20 / 1987

Sept 1 / 87

Nov. 9 / 88



HUTTON TWP. (M. 944)

Name and Postal Address of Recorded Holder

Edward Reed

C 34803

928 Main St. W. North Bay, Ont.

Summary of Work Performance and Distribution of Credits

Total Work Days Cr. claimed	Mining Claim			Mining Claim			Mining Claim		
	Prefix	Number	Work Days Cr.	Prefix	Number	Work Days Cr.	Prefix	Number	Work Days Cr.
201	S	839703	40						
for Performance of the following work. (Check one only) <input type="checkbox"/> Manual Work <input type="checkbox"/> Shaft Sinking Drifting or other Lateral Work. <input type="checkbox"/> Compressed Air, other Power driven or mechanical equip. <input type="checkbox"/> Power Stripping <input checked="" type="checkbox"/> Diamond or other Core drilling <input type="checkbox"/> Land Survey		839799	40						
		853927	41						
		853928	40						
		853929	40						

All the work was performed on Mining Claim(s): S-853927

Required Information eg: type of equipment, Names, Addresses, etc. (See Table Below)

DRILLING OPERATOR.
REEDMAC PROSPECTING SYNDICATE
GENERAL DELIVERY
SOUTH RIVER, ONTARIO

SUDBURY MINING DIV.
RECEIVED
NOV 14 1988
A.M. 7/8/9/10/11/12/1/2/3/4/5/6 P.M.

ONTARIO GEOLOGICAL SURVEY
ASSESSMENT FILES OFFICE
NOV 18 1988
RECEIVED

RECORDED
NOV 15 1988
Receipt # *PK*

Date of Report	Recorded Holder or Agent (Signature)
Nov. 9, 1988	<i>Paul C. McLean</i>

Certification Verifying Report of Work

I hereby certify that I have a personal and intimate knowledge of the facts set forth in the Report of Work annexed hereto, having performed the work or witnessed same during and/or after its completion and the annexed report is true.

Name and Postal Address of Person Certifying

Paul C. McLean General Delivery, South River, Ontario

Date Certified

Nov. 9, 1988

Certified by (Signature)

Paul C. McLean

Table of Information/Attachments Required by the Mining Recorder

Type of Work	Specific information per type	Other information (Common to 2 or more types)	Attachments
Manual Work	Nil	Names and addresses of men who performed manual work/operated equipment, together with dates and hours of employment.	Work Sketch: these are required to show the location and extent of work in relation to the nearest claim post.
Shaft Sinking, Drifting or other Lateral Work			
Compressed air, other power driven or mechanical equip.	Type of equipment	Names and addresses of owner or operator together with dates when drilling/stripping done.	Work Sketch (as above) in duplicate
Power Stripping	Type of equipment and amount expended. Note: Proof of actual cost must be submitted within 30 days of recording.		
Diamond or other core drilling	Signed core log showing; footage, diameter of core, number and angles of holes.	1 hole -45° core bq ¹ / ₄ "	
Land Survey	Name and address of Ontario land surveyer.	Nil	Nil

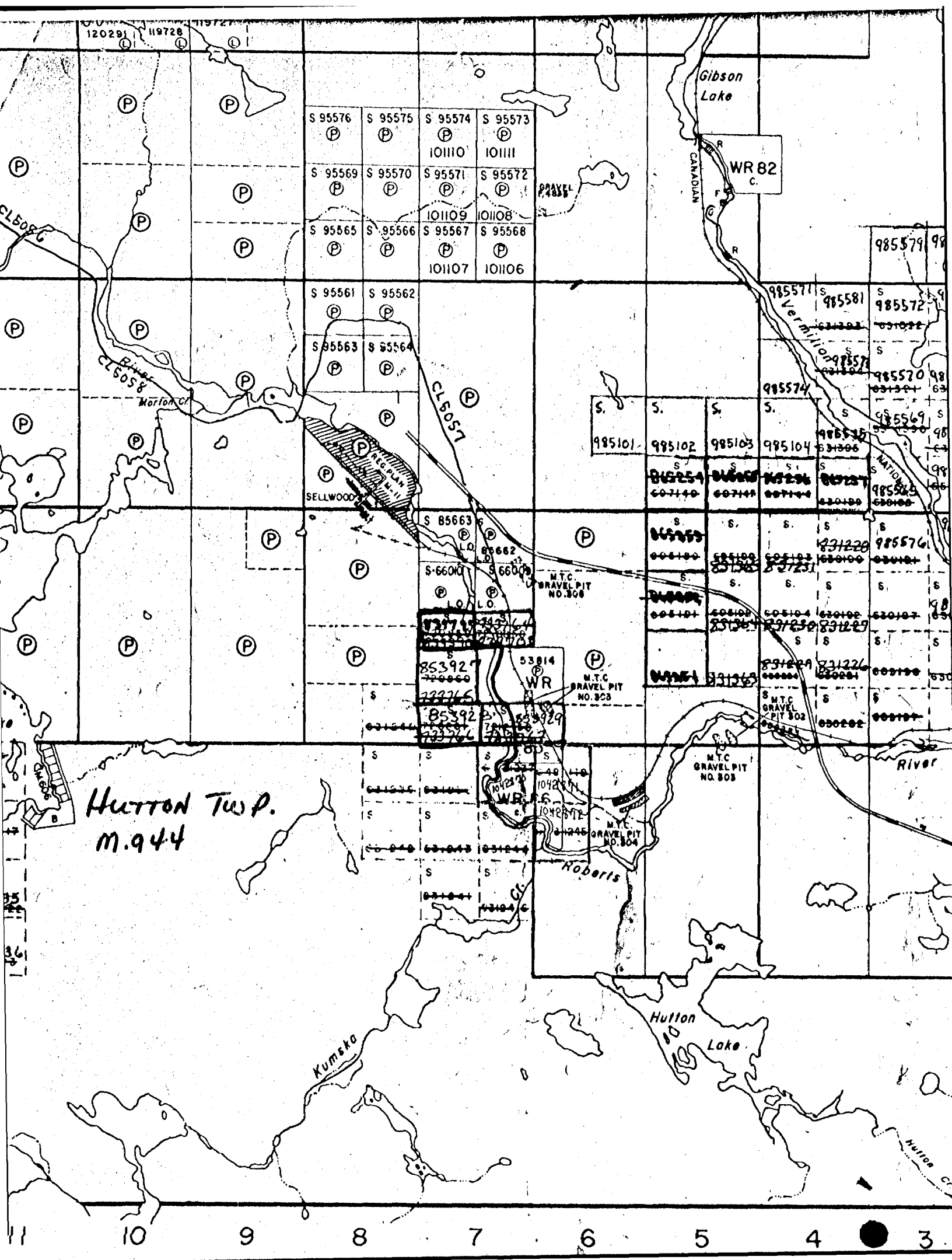

Hutton Twp.
M. 944

S 95576 (P)	S 95575 (P)	S 95574 (P) 101110	S 95573 (P) 101111
S 95569 (P)	S 95570 (P)	S 95571 (P) 101109	S 95572 (P) 101108
S 95565 (P)	S 95566 (P)	S 95567 (P) 101107	S 95568 (P) 101106

S 95561 (P)	S 95562 (P)
S 95563 (P)	S 95564 (P)

S 985101	S 985102	S 985103	S 985104	S 985571 985574	S 985581 985577	S 985572 985570	S 985569 985565	S 985576 985574	S 985576 985574
S 985105	S 985106	S 985107	S 985108	S 985109	S 985110	S 985111	S 985112	S 985113	S 985114
S 985115	S 985116	S 985117	S 985118	S 985119	S 985120	S 985121	S 985122	S 985123	S 985124

S 85392 72000	S 85392 72000	S 85392 72000	S 85392 72000
S 53814 WR	S 53814 WR	S 53814 WR	S 53814 WR

S M.T.C. GRAVEL PIT NO. 308	S M.T.C. GRAVEL PIT NO. 303	S M.T.C. GRAVEL PIT NO. 304	S M.T.C. GRAVEL PIT NO. 302	S M.T.C. GRAVEL PIT NO. 302	S M.T.C. GRAVEL PIT NO. 302
--------------------------------	--------------------------------	--------------------------------	--------------------------------	--------------------------------	--------------------------------