

CLAIM # 1197457

KITCHENER TWP



010

THIS 12 UNIT CLAIM IS IN SOUTHEAST PORTION OF KITCHENER TWP AND IS ACCESSED BY A TRAIL FROM IRONSIDE LAKE, ROBERTS TWP. CAPREOL.

A G.P.S. UNIT WAS UTILIZED AT THIS SITE TO MARK WORK AND SAMPLE LOCATIONS. WE LOCATED THE EM/MAG. CONDUCTOR AREAS THAT HAD PREVIOUSLY BEEN IDENTIFIED BY SCOTIA MINES LTD (1967). THESE ARE INDICATED ON MAP AS CONDUCTOR AXIS 1-2-3. STRIPPING OF THE CONDUCTORS WAS LIMITED DUE TO DEEP OVERBURDEN. LOCALIZED SHEARING WAS OBSERVED AT WORK AREAS 2 AND 3. ALL WORK AREAS EXHIBITED ALTERATION, GENERALLY GOSSAN (SULFIDE ENRICHED), SILIFICATION AND SHEARING (LOCALIZED). WORK AREA 2 (SHAFT AREA) YIELDED THE BEST RESULTS IN ZINC WITH 7700 PPM ACROSS 1M. WITH 1600 PPM COPPER. WORK AREA 5 YIELDED 5835 PPM OF ZINC FROM MASSIVE TO DISSEMINATED PO. PY. BY FAR, THE BEST RESULTS WERE OBTAINED OVER CONDUCTOR AXIS # 3 AT WORK AREA 6, WHERE A 2M SECTION OF HIGHLY CARBONATED, ALTERED ROCK (DIORITE?) YIELDED 3.25% COPPER. THIS IS NEAR THE CONTACT BETWEEN THE GABBRO INTRUSIVE AND THE VOLCANIC HORIZON. THE ACTUAL CONTACT PROBABLY OCCURS IN THE CREEK BED BETWEEN WORK AREAS 5 AND 6. DEEP OVERBURDEN AND MUD LIMITED OUR WORK EFFORTS. WORK AREA 6 IS THE BEST AREA FOR FOLLOW UP. DIAMOND DRILLING IS RECOMMENDED HERE DUE TO THE TERRAIN.

"SIGNIFICANT" ASSAYS AND ASSAY CERTIFICATE NO'S  
ARE LISTED ON MAP.

THE 1<sup>3</sup>/<sub>4</sub> YARD EXCAVATOR USED WAS A POCLAIN 160  
WHICH WORKED A TOTAL OF 259 HRS, AT THE  
HOURLY RATE OF \$90 INCLUDING OPERATOR.  
THE DATES ARE SUMMARIZED IN ATTACHED LIST.

THE GAS OPERATED DRILL WAS A ATLAS COPCO "COBRA"  
DRILL WHICH WAS RENTED FOR 10 WEEKS AT \$450 PER  
WEEK.



RENE GERVAIS

DATES WORKED	LOCATION - MAP REFERENCE	TYPE OF WORK PERFORMED	TYPE OF EQUIPMENT	CONTRACTOR / OPERATOR / WORKER	HOURS/DAYS WORKED	RATE/COST	TRAVEL COST
APRIL 18-27 INCL.	Kitchener Tp MAP A	FLAGGING EXCAVATOR TRAIL FROM IRONSIDE LAKE TO COPENHAGEN LAKE. PROSPECTING, LOCATED EM/MS CONDUCTORS AT WORK AREAS 5+6; WORK AREA 7 AND 420 M. SOUTH OF WORK AREA 7. MANUAL STRIPPING WORK AREA 2		RENGER EXPL. A. GERVAIS A. GERVAIS	10 days x 2	20 MAN DAYS @100. = 2000.	41 KM RETURN FROM CONSTRUCTION YARD - MUTTON TWP X 10 TRIPS = 410 KM
MAY 2-10 INCL. 14, 12, 13, 14, 15 6, 17, 18, 19, 20 MAY 22-31 INCL.	" "	MANUAL STRIPPING ROCK TRENCHING	COBRA DRILL - RENTAL - RENGEX EXPL.	RENGEX EXPL. R. GERVAIS A. GERVAIS	28 days x 2	56 MAN DAYS @100 = 5600.	X 28 TRIPS X 41 KM = 1148 KM.
JUNE 2-12 INCL. JUNE 15, 16, 17 8, 19, 23, 24, 25	" "	" "	" "	RENGEX EXPL. R. GERVAIS N. GERVAIS	19 days x 2.	38 MAN DAYS @100 = 3800	19 TRIPS X 41 KM. = 779 KM.
JULY 1, 2, 3, 8 7, 15, 16, 22, 23 29, 30 AUG 5, 6, 12	" "	" "	" "	RENGEX EXPL. N. GERVAIS, R. GERVAIS + J. BRADY, M. BRADY	14 days x 4	56 MAN DAYS @100. = 5600.	14 TRIPS X 41 KM = 574 KM.
SEPT 18-30 INCL.	" "	MANUAL CLEARING ROCK TRENCHING MUCKING SAMPLING	" "	RENGEX EXPL. A. GERVAIS, N. GERVAIS	13 days x 2.	26 MAN DAYS @100. = 2600.	13 TRIPS X 41 KM. = 533 KM.
100	" "	" "	" "	RENGEX EXPL. R. GERVAIS, N. GERVAIS + J. BRADY	8 days x 3	24 MAN DAYS @100 = 2400	8 TRIPS X 41 KM. = 328 KM.
JUNE 17, 18, 19, 20 22, 26, 27, 28, 30	" "	POWER STRIPPING	PODLAIN 160 H EXCAVATOR	RENGEX EXPL. OPER. A. GERVAIS	9 days = 78 hrs	78 @ 90. = 7020.	TOTAL KM = 3772 KM
CT. 2, 3, 4, 5, 6, 8, 10, 11, 12 4, 15, 17, 18, 20 JULY 8, 9, 10, 12	" "	" "	" "	" "	20 days = 181 hrs	181 @ 90. = 16,290.	@ .30 / KM = 1131
AUG 2 - OCT 30	" "	ROCK TRENCHING	COBRA GAS DRILL	RENTAL - RENGEX EXPL.	10 WKS @ 450.	10 WKS @ 450. = 4500	
						TOTAL WAGES - 22,000 EXCAVATOR 24 310 DRILL 4500 50,810.	Grand Total } 1131. 50810. 51,941.



# Report of Work Conducted After Recording Claim

## Mining Act

Personal information collected on this form is obtained under the authority of the Access to Information Act. This collection should be directed to the Provincial Manager, Mining Lands, Sudbury, Ontario, P3E 6A5, telephone (705) 670-7264.



41114SE0014 W9670-00123 KITCHENER

900

- Instructions:**
- Please type or print and submit in duplicate
  - Refer to the Mining Act and Regulations for Recorder.
  - A separate copy of this form must be completed for each Work Group.
  - Technical reports and maps must accompany this form in duplicate.
  - A sketch, showing the claims the work is assigned to, must accompany this form.

Recorded Holder(s) RENE GERVAIS 136118 AND JOHN BRADY 111562		Client No.
Address LOT 13 CONC 6 HUTTON TWP CAPREOL ONT POMIHO		Telephone No. 705-525-4129
Mining Division SUDBURY	Township/Area KITCHENER	M or G Plan No. C 4069
Dates Work Performed From: APRIL 18/95		To: OCT 30/95

**Work Performed (Check One Work Group Only)**

Work Group	Type
Geotechnical Survey	
Physical Work, including Drilling	TRENCHING AND STRIPPING.
Rehabilitation	
Other Authorized Work	SECTION 18 ONLY
Assays	
Assignment from Reserve	

Total Assessment Work Claimed on the Attached Statement of Costs \$ 51,941

**Note:** The Minister may reject for assessment work credit all or part of the assessment work submitted if the recorded holder cannot verify expenditures claimed in the statement of costs within 30 days of a request for verification.

**Persons and Survey Company Who Performed the Work (Give Name and Address of Author of Report)**

Name	Address
RENCER RESOURCES LTD ANDRE GERVAIS	12 BALLPARK RD CAPREOL ONT
NOELLA GERVAIS	HUTTON TWP CAPREOL ONT
RENE GERVAIS	HUTTON TWP CAPREOL ONT
MARY BRADY JOHN BRADY	1237 HOLLAND RD. SUDBURY ONT

(attach a schedule if necessary)

**Certification of Beneficial Interest \* See Note No. 1 on reverse side**

I certify that at the time the work was performed, the claims covered in this work report were recorded in the current holder's name or held under a beneficial interest by the current recorded holder.	Date JUNE 25/96	Recorded Holder or Agent (Signature) <i>Rene</i>
--	--------------------	---

**Certification of Work Report**

I certify that I have a personal knowledge of the facts set forth in this Work report, having performed the work or witnessed same during and/or after its completion and annexed report is true.

Name and Address of Person Certifying RENE GERVAIS HUTTON TWP CAPREOL ONT POMIHO		
Telephone No. 705-858-0100	Date JUNE 25/96	Certified By (Signature) <i>Rene</i>

**For Office Use Only**

Total Value Cr. Recorded Applied \$ 41,000.00 \$ 47,141.00	Date Recorded June 26/96	Mining Recorder <i>[Signature]</i>	Received Stamp SUDBURY MINING DIV <b>RECEIVED</b> JUN 26 1996 A.M. P.M. 7 8 9 10 11 12 1 2 3 4 5 6 <i>JP</i>
	Deemed Approval Date Sept. 24/96	Date Approved August 14/96	
	Date Notice for Amendments Sent		





Ministry of  
Northern Development  
and Mines

Ministère du  
Développement du Nord  
et des mines

Statement of Costs  
for Assessment Credit

État des coûts aux fins  
du crédit d'évaluation

Mining Act/Loi sur les mines

Transaction No./N° de transaction

W9670.00123

Personal information collected on this form is obtained under the authority of the Mining Act. This information will be used to maintain a record and ongoing status of the mining claim(s). Questions about this collection should be directed to the Provincial Manager, Minings Lands, Ministry of Northern Development and Mines, 4th Floor, 159 Cedar Street, Sudbury, Ontario P3E 6A5, telephone (705) 670-7264.

Les renseignements personnels contenus dans la présente formule sont recueillis en vertu de la Loi sur les mines et serviront à tenir à jour un registre des concessions minières. Adresser toute question sur la collecte de ces renseignements au chef provincial des terrains miniers, ministère du Développement du Nord et des Mines, 159, rue Cedar, 4<sup>e</sup> étage, Sudbury (Ontario) P3E 6A5, téléphone (705) 670-7264.

1. Direct Costs/Coûts directs

Type	Description	Amount Montant	Totals Total global
Wages Salaires	Labour Main-d'oeuvre	10,100	
	Field Supervision Supervision sur le terrain	11,900	22,000
Contractor's and Consultant's Fees Droits de l'entrepreneur et de l'expert- conseil	Type STRIPPING	24,310	
			24,310
Supplies Used Fournitures utilisées	Type		
Equipment Rental Location de matériel	Type COBRA DRILL	4500	
			4500
Total Direct Costs Total des coûts directs			50,810

2. Indirect Costs/Coûts indirects

\*\* Note: When claiming Rehabilitation work Indirect costs are not allowable as assessment work.  
Pour le remboursement des travaux de réhabilitation, les coûts indirects ne sont pas admissibles en tant que travaux d'évaluation.

Type	Description	Amount Montant	Totals Total global
Transportation Transport	Type		
	Pick up TRUCK	565.00	
VAN	VAN	565.00	
			1131.00
Food and Lodging Nourriture et hébergement			
Mobilization and Demobilization Mobilisation et démobilisation			
Sub Total of Indirect Costs Total partiel des coûts indirects			1131.00
Amount Allowable (not greater than 20% of Direct Costs) Montant admissible (n'excédant pas 20 % des coûts directs)			1131.00
Total Value of Assessment Credit (Total of Direct and Allowable Indirect costs)			51,941.00
Valeur totale du crédit d'évaluation (Total des coûts directs et indirects admissibles)			51,941.00

Note: The recorded holder will be required to verify expenditures claimed in this statement of costs within 30 days of a request for verification. If verification is not made, the Minister may reject for assessment work all or part of the assessment work submitted.

Note : Le titulaire enregistré sera tenu de vérifier les dépenses demandées dans le présent état des coûts dans les 30 jours suivant une demande à cet effet. Si la vérification n'est pas effectuée, le ministre peut rejeter tout ou une partie des travaux d'évaluation présentés.

Filing Discounts

1. Work filed within two years of completion is claimed at 100% of the above Total Value of Assessment Credit.
2. Work filed three, four or five years after completion is claimed at 50% of the above Total Value of Assessment Credit. See calculations below:

Total Value of Assessment Credit	Total Assessment Claimed
	x 0.50 =

Remises pour dépôt

1. Les travaux déposés dans les deux ans suivant leur achèvement sont remboursés à 100 % de la valeur totale susmentionnée du crédit d'évaluation.
2. Les travaux déposés trois, quatre ou cinq ans après leur achèvement sont remboursés à 50 % de la valeur totale du crédit d'évaluation susmentionné. Voir les calculs ci-dessous.

Valeur totale du crédit d'évaluation	Évaluation totale demandée
	x 0,50 =

Certification Verifying Statement of Costs

I hereby certify:  
that the amounts shown are as accurate as possible and these costs were incurred while conducting assessment work on the lands shown on the accompanying Report of Work form.

that as RECORDED HOLDER I am authorized  
(Recorded Holder, Agent, Position in Company)

to make this certification

Attestation de l'état des coûts

J'atteste par la présente :  
que les montants indiqués sont le plus exact possible et que ces dépenses ont été engagées pour effectuer les travaux d'évaluation sur les terrains indiqués dans la formule de rapport de travail ci-joint.

Et qu'à titre de \_\_\_\_\_ je suis autorisé  
(titulaire enregistré, représentant, poste occupé dans la compagnie)

à faire cette attestation.

Signature [Signature] Date JUNE 25/96



Ontario

Ministry of  
Northern Development  
and Mines

Ministère du  
Développement du Nord  
et des Mines

~~Mining Recorders Office~~  
933 Ramsey Lake Road  
3rd Floor (B)  
Sudbury, Ontario  
P3E 6B5

Phone: (705) 670-5742  
Fax: (705) 670-5681

August 14, 1996

Trans. #W9670.00123

Rene Gervais  
Lot 12, Con.VI  
Hutton Township  
Capreol, ON P0M 1H0

Dear Rene:

**SUBJECT: APPROVAL OF ASSESSMENT WORK**

The assessment work credits as listed on the attached Report of Work form have been approved as of **August 14, 1996**.

If you have any questions, please contact our office.

Yours truly,

A handwritten signature in black ink, appearing to read "Roy Denomme", written over a circular stamp or seal.

**Roy Denomme**  
Mining Recorder  
Sudbury/Southern Ontario  
Mining Divisions

/kg  
Encls.

**INDEX TO LAND DISPOSITION**

PLAN  
**G-4069**  
 TOWNSHIP

M.N.R. ADMINISTRATIVE DISTRICT  
**SUDBURY**  
 MINING DIVISION  
**SUDBURY**  
 LAND TITLES/REGISTRY DIVISION  
**SUDBURY**

**KITCHENER**

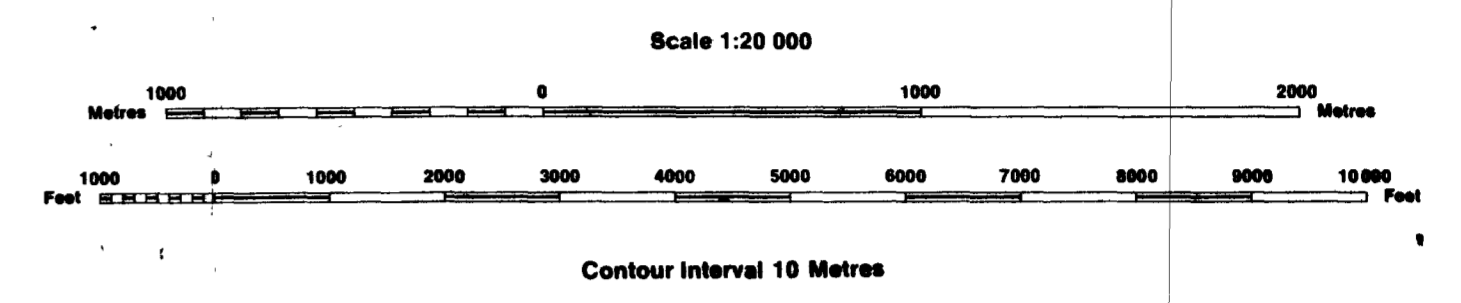

**AREAS WITHDRAWN FROM DISPOSITION**

MRO - Mining Rights Only  
 SRO - Surface Rights Only  
 M + S - Mining and Surface Rights

Description	Order No.	Date	Disposition	File
SEC-34/80	W-90/88	NOV 6/88	M + S	KITCHENER LAND ROLL
SEC-36/80	W-97/88	JAN 19/89	M + S	KITCHENER LAND ROLL
SEC-38/80	O-3-35/82	MAY 5/82	M + S	LAND ROLL
SEC-39/80	O-3-36/82	MAY 5/82	M + S	LAND ROLL

**SYMBOLS**

- Boundary
- Township, Meridian, Baseline
- Road allowance; surveyed
- shoreline
- Lot/Concession; surveyed
- unsurveyed
- Parcel; surveyed
- unsurveyed
- Right-of-way; road
- railway
- utility
- Reservation
- Cliff, Pit, Bldg
- Contour
- Interpolated
- Approximate
- Depression
- Control point (horizontal)
- Flooded land
- Mine head frame
- Pipeline (above ground)
- Railway; single track
- double track
- abandoned
- Road; highway, county, township
- access
- trail, bush
- Shoreline (original)
- Transmission line
- Wooded area

**DATE OF ISSUE**

**AUG 14 1986**

SUDBURY  
 MINING RECORDER'S OFFICE

\* M.R. & S.R. OPENED JUNE 1, 1982

(PTRXCH)  
 (PSTRIP)

**DISPOSITION OF CROWN LANDS**

- Patent
- Surface & Mining Rights
- Surface Rights Only
- Mining Rights Only
- Lease
- Surface & Mining Rights
- Surface Rights Only
- Mining Rights Only
- Licence of Occupation
- Order-in-Council
- Cancelled
- Reservation
- Sand & Gravel
- LAND USE PERMIT

THE INFORMATION THAT APPEARS ON THIS MAP HAS BEEN COMPILED FROM VARIOUS SOURCES, AND ACCURACY IS NOT GUARANTEED. THOSE WISHING TO STAKE MINING CLAIMS SHOULD CONSULT WITH THE MINING RECORDER, MINISTRY OF NORTHERN DEVELOPMENT AND MINES, FOR ADDITIONAL INFORMATION ON THE STATUS OF THE LANDS SHOWN HEREON.

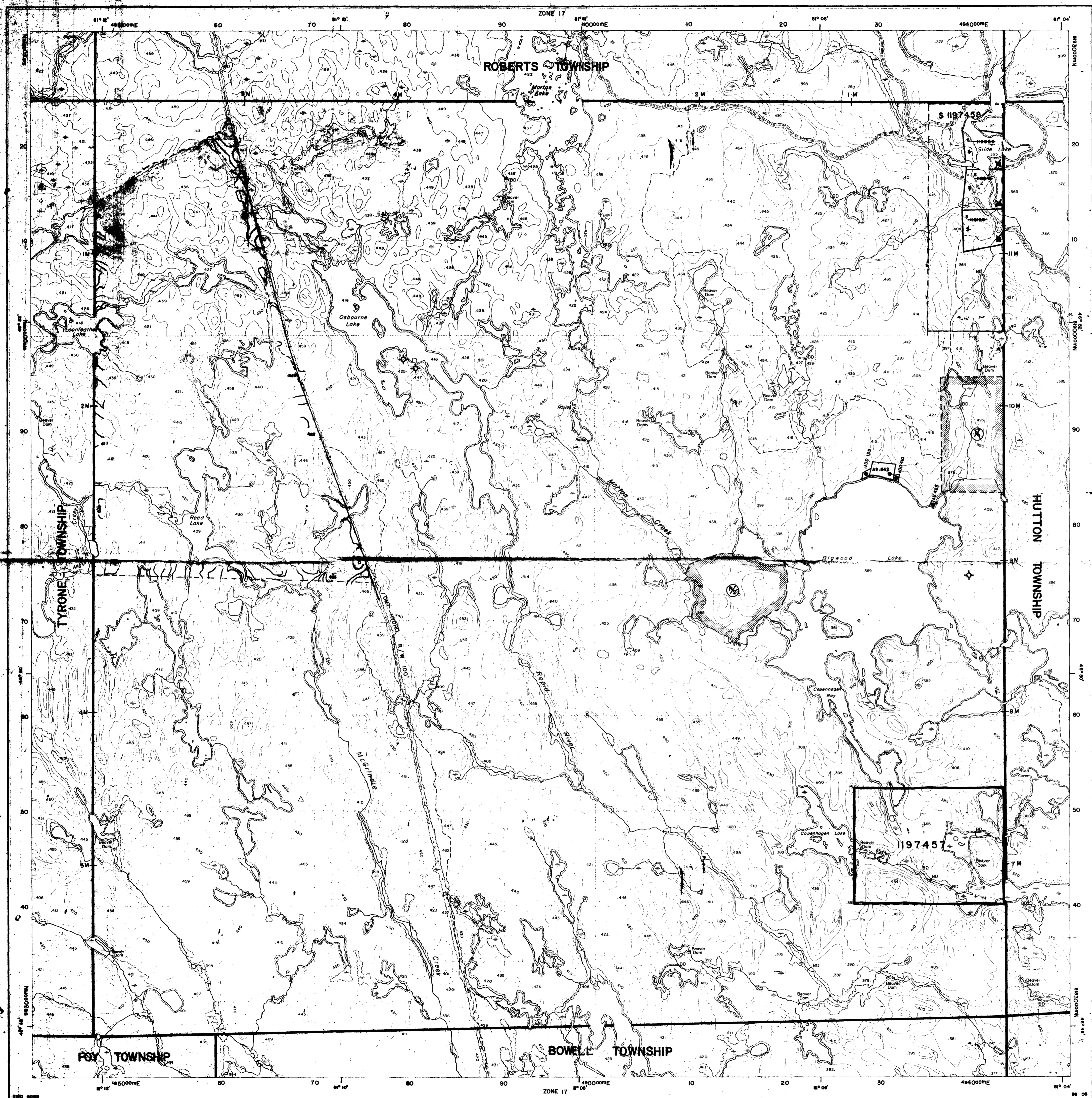



MAP A  
Kitchener Twp

ACCESS ROAD  
CROSSES TOWNSHIP  
LINE AT N 46° 49' 494"

W 81° 04' 547"  
N 46° 49' 359"  
SULPHIDE SHOWING  
STAKE 0-02  
331 M FROM  
TWP LINE

WORK AREA #7  
TWP LINE  
EXCAVATION 60 X 31 METRES  
TRENCHING 7 X 2 X 8 METRES

WORK AREA #8  
ACCESS ROAD CONSTRUCTION  
APPROX 3400 METRES

MAP A  
SCALE  
1 - 2500 METRES

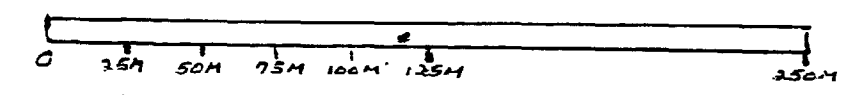

NORTH AST.

J. BRADY, 1995

LEGEND

**SIGNIFICANT ASSAYS**

Sample No.	WORK AREA/TRENCH	ASSAY CERT. No.	Results	Type
228598	2	M 5890	CU 1600 PPM; ZN 1700 PPM - 1M. chip	
228600	2	"	CU 1700 PPM	
17775	5	M 5960	2N 5835 PPM	- 1M chip sample
17778	6	5W-4293-RA1	CU 3.25%	- 2M chip sample
17779	6	M 5960	CU 1054 PPM	

Total Samples 16 - Type - gmb (unless otherwise noted)

Assay Cert. Nos. 5W-3957-RA1  
 5890 } SWASTIKA ROAD TSH  
 5W-4293-RA1  
 M 5960

- [A] GRANITE - GRANODIORITE
- [B] GABBRO - DIORITE - ALTERED GNEISS
- [C] VOLCANICS - ANDESITE - BASALT

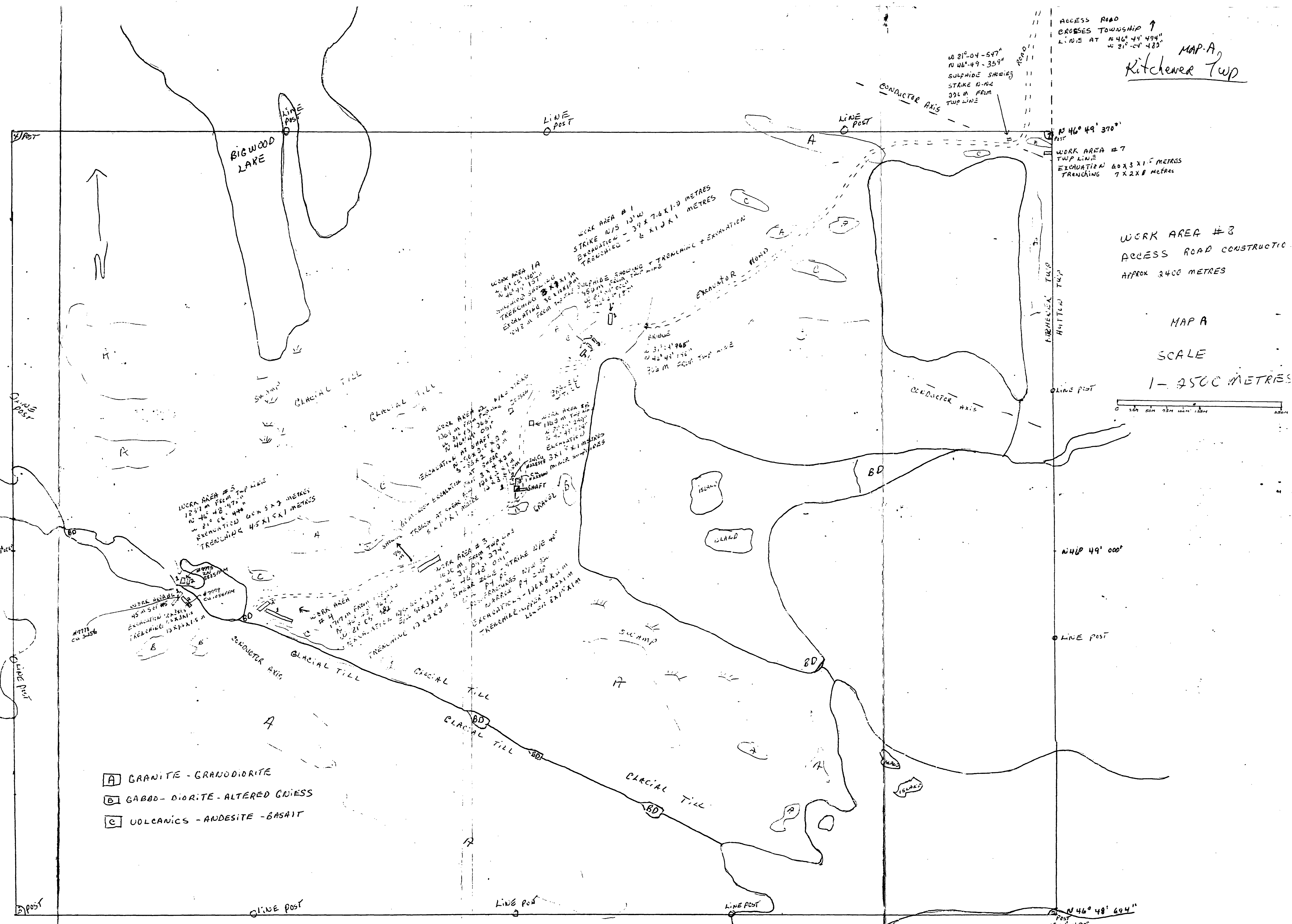

CLAIM # 1197457  
KITCHENER TOWNSHIP