

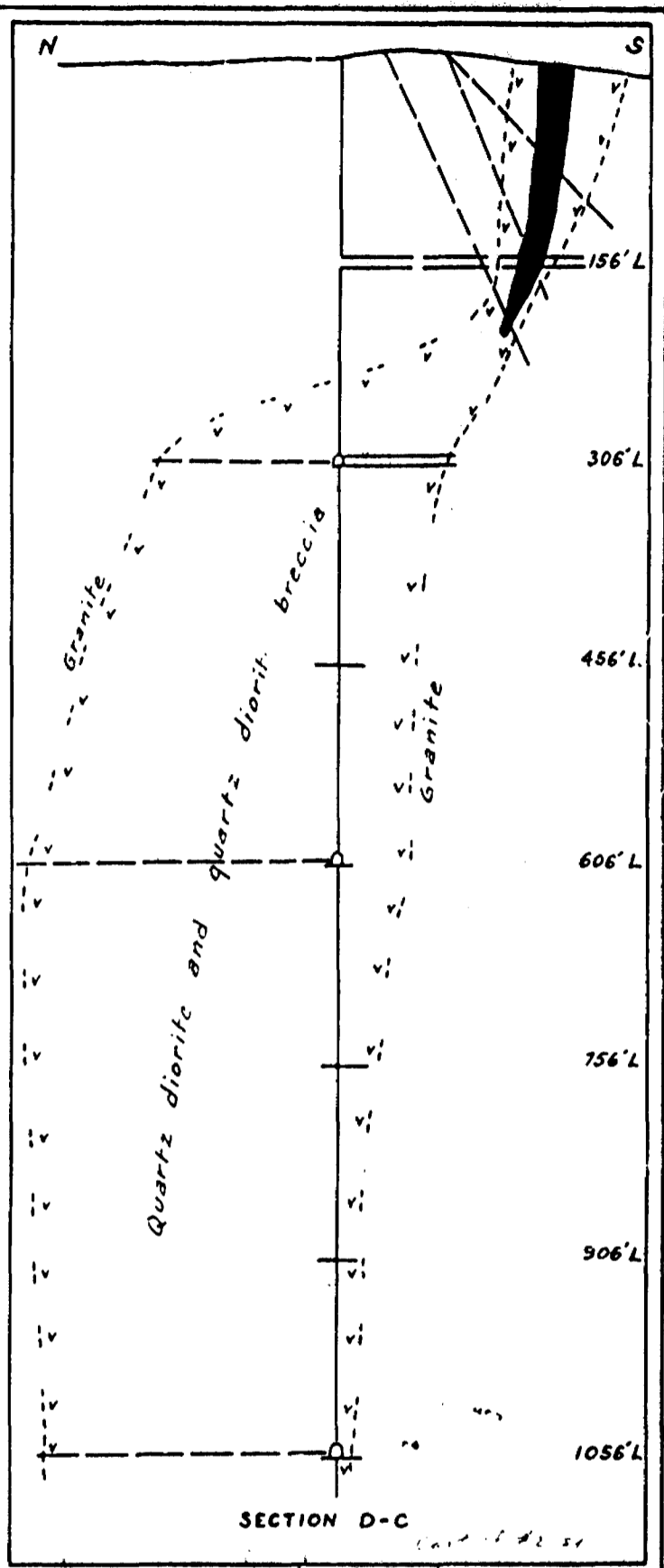

41114SE0040 FOY13 FOY

010

NOTE : THIS FILE CONSISTS OF MAPS/  
DRILL SECTIONS ONLY, AND  
CONCERNS INFORMATION ON  
DRILL HOLES, TRENCH, GEOLOGY.

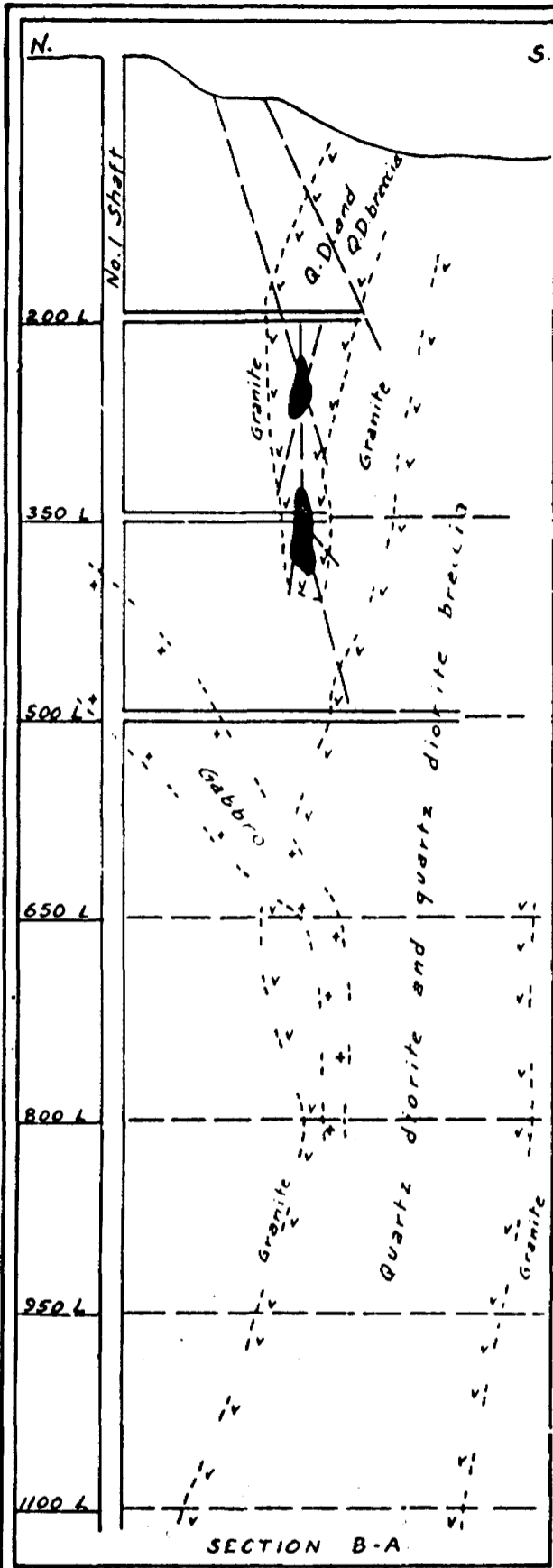

■ Sulphides

Scale of Feet  
 0 100 200 300

Location of sections is shown on Fig 1<sup>st</sup> = 100'

Geological sections through the Nickel Offsets mine, Foy township.  
 (Modified after mine plans, July, 1949)

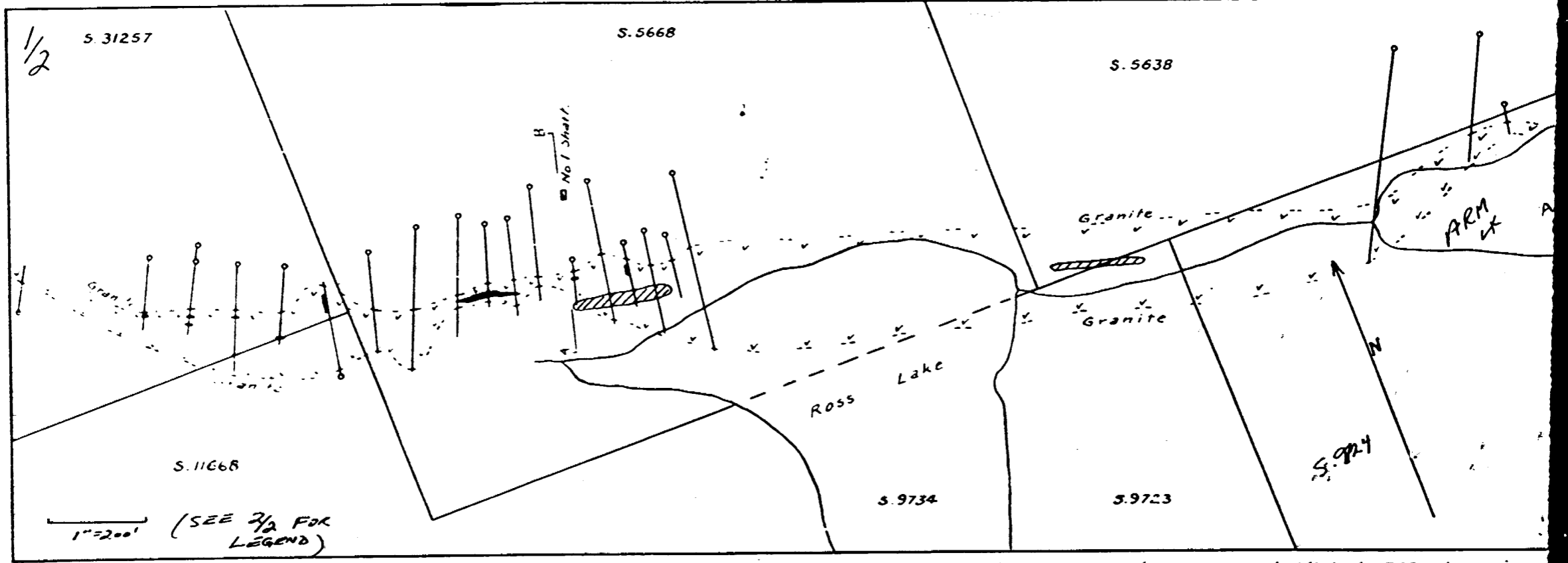

Surface geological plan showing the main sulphide zone at Nickel Offsets mine, Foy TWP

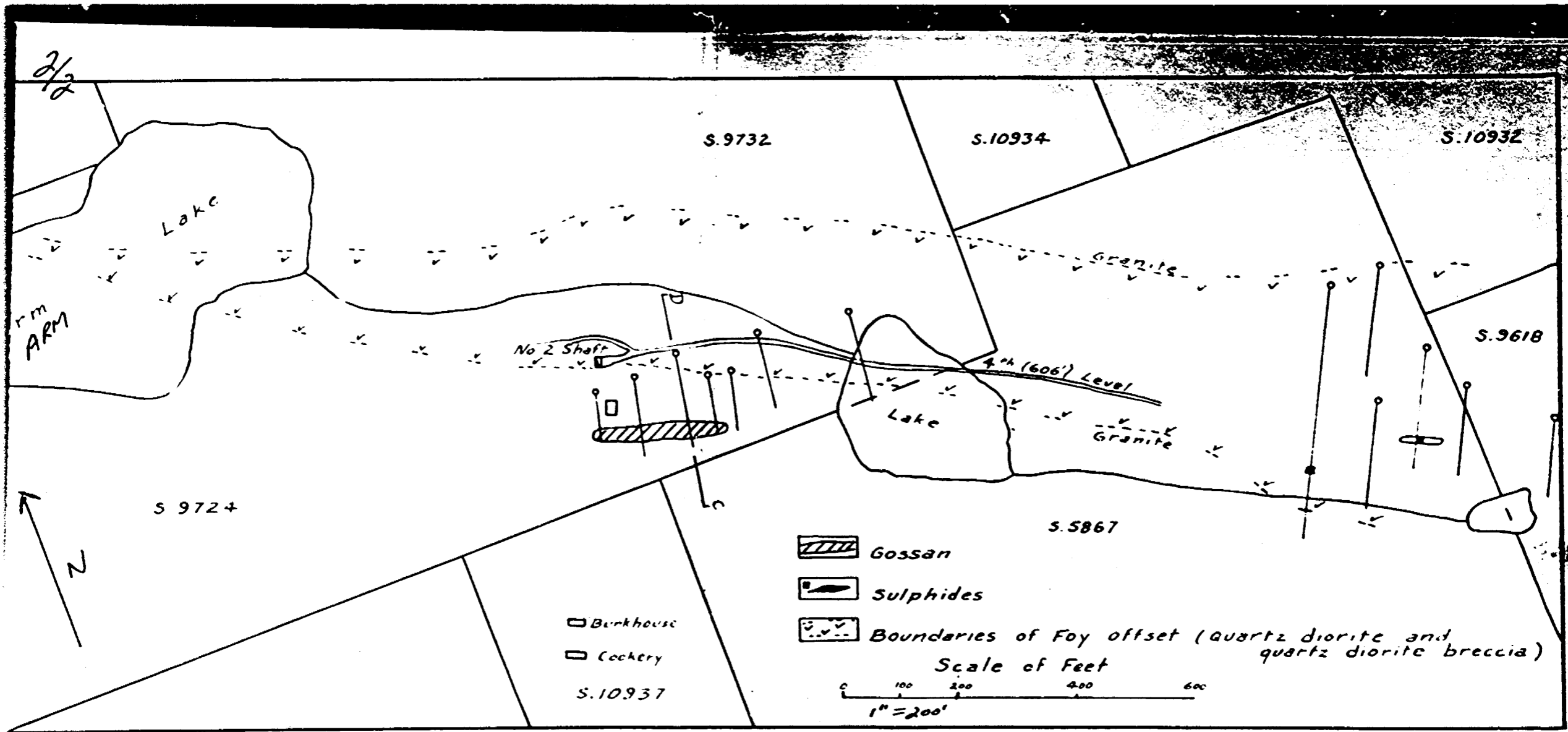

Foy township. (Modified after mine plans, July, 1949.)

SEE ACCOMPANYING  
MAP(S) IDENTIFIED AS

F04-0013, #1, #2, #3

-----

-----

LOCATED IN THE MAP  
CHANNEL IN THE FOLLOWING  
SEQUENCE (X)

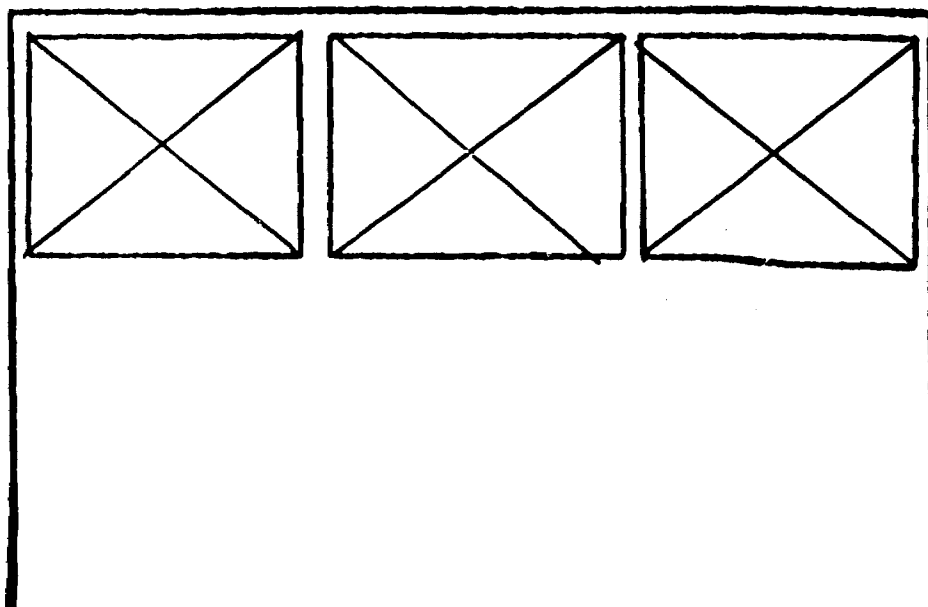

FOR ADDITIONAL  
INFORMATION

SEE MAPS:

F04-0013 #4-11

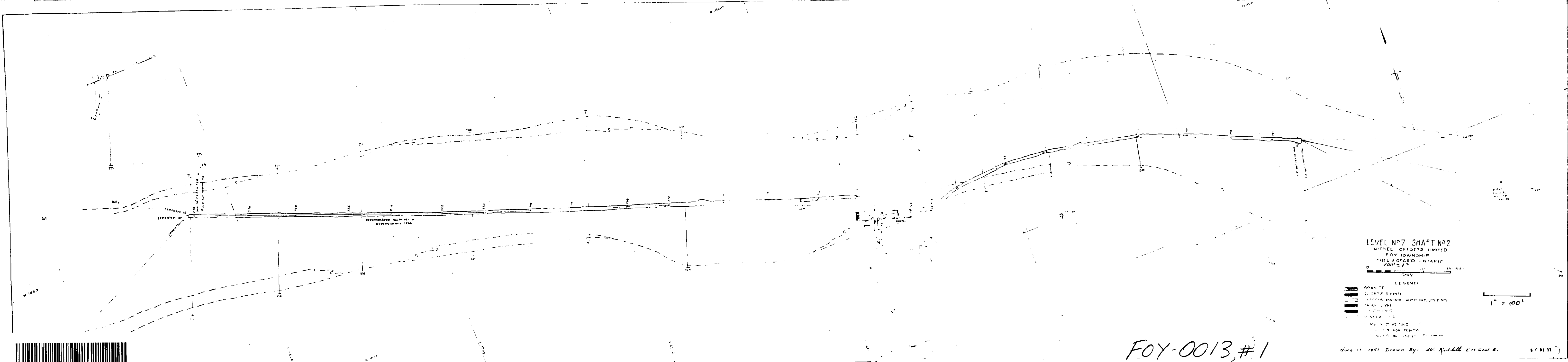
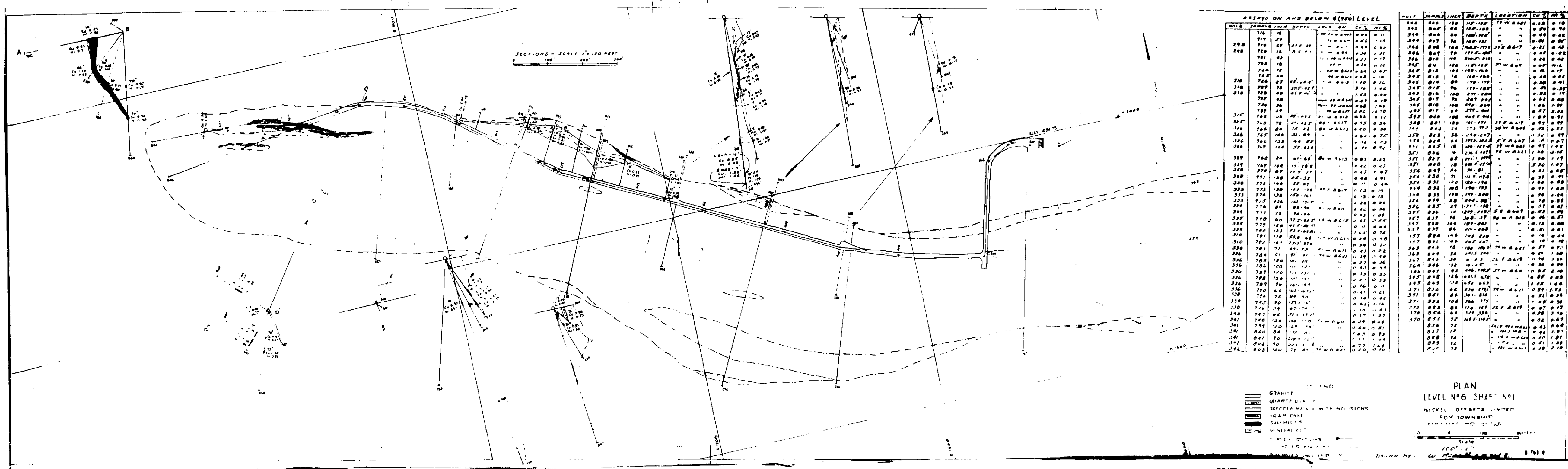
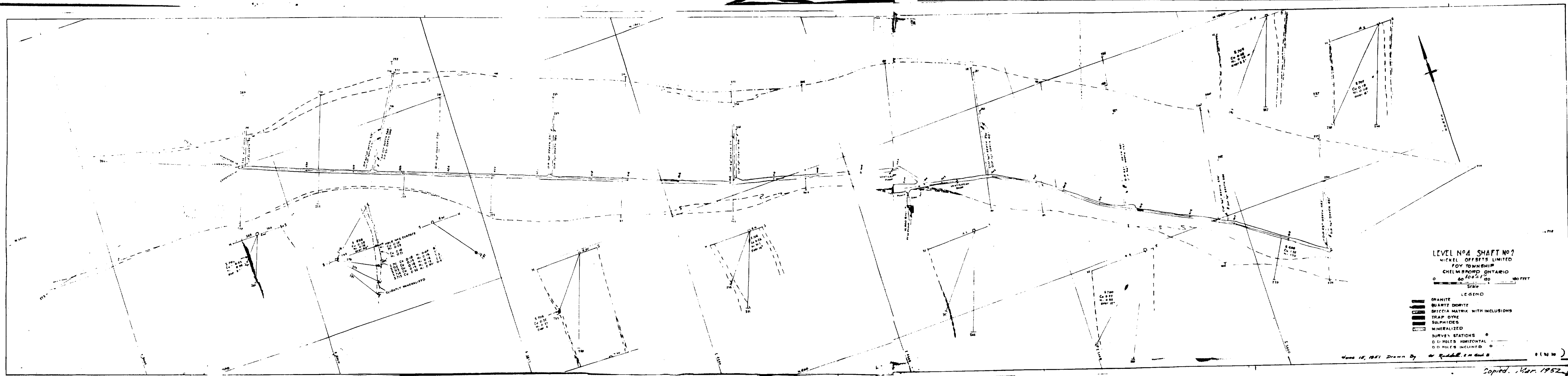
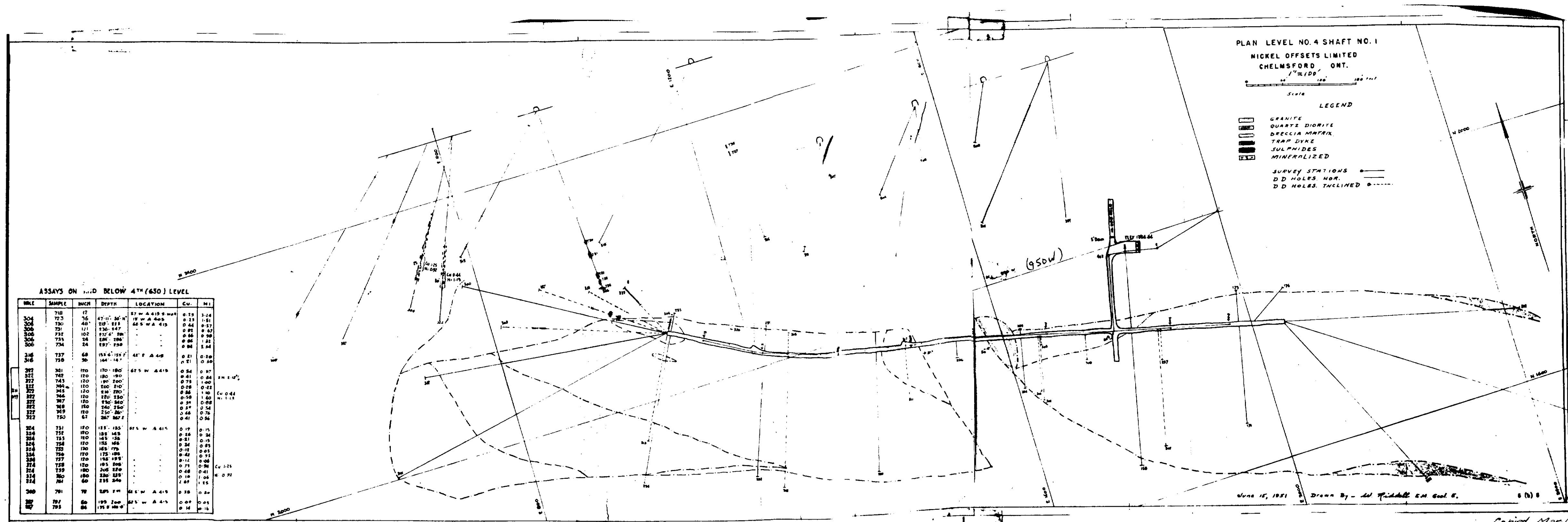

FOY-0013, #1

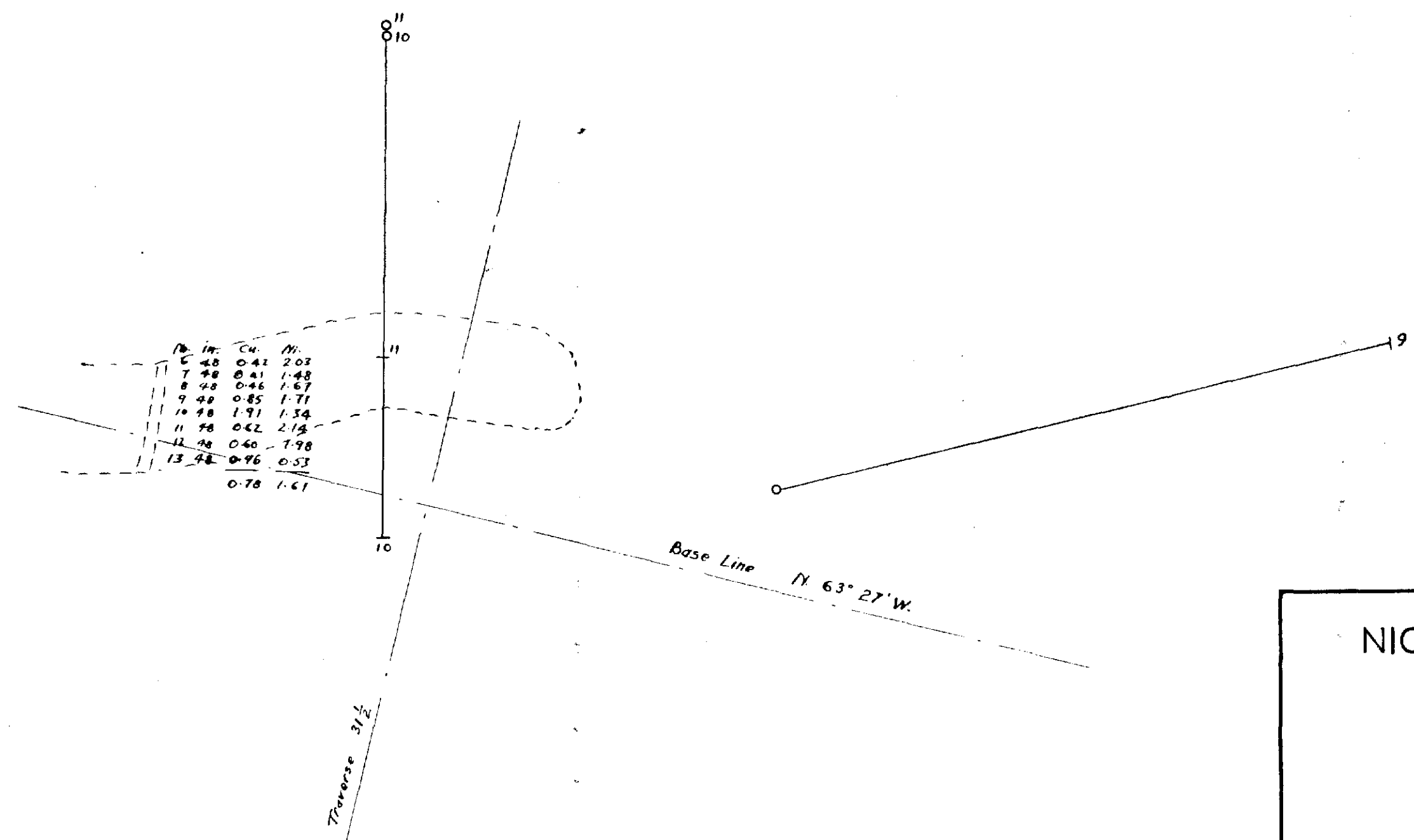
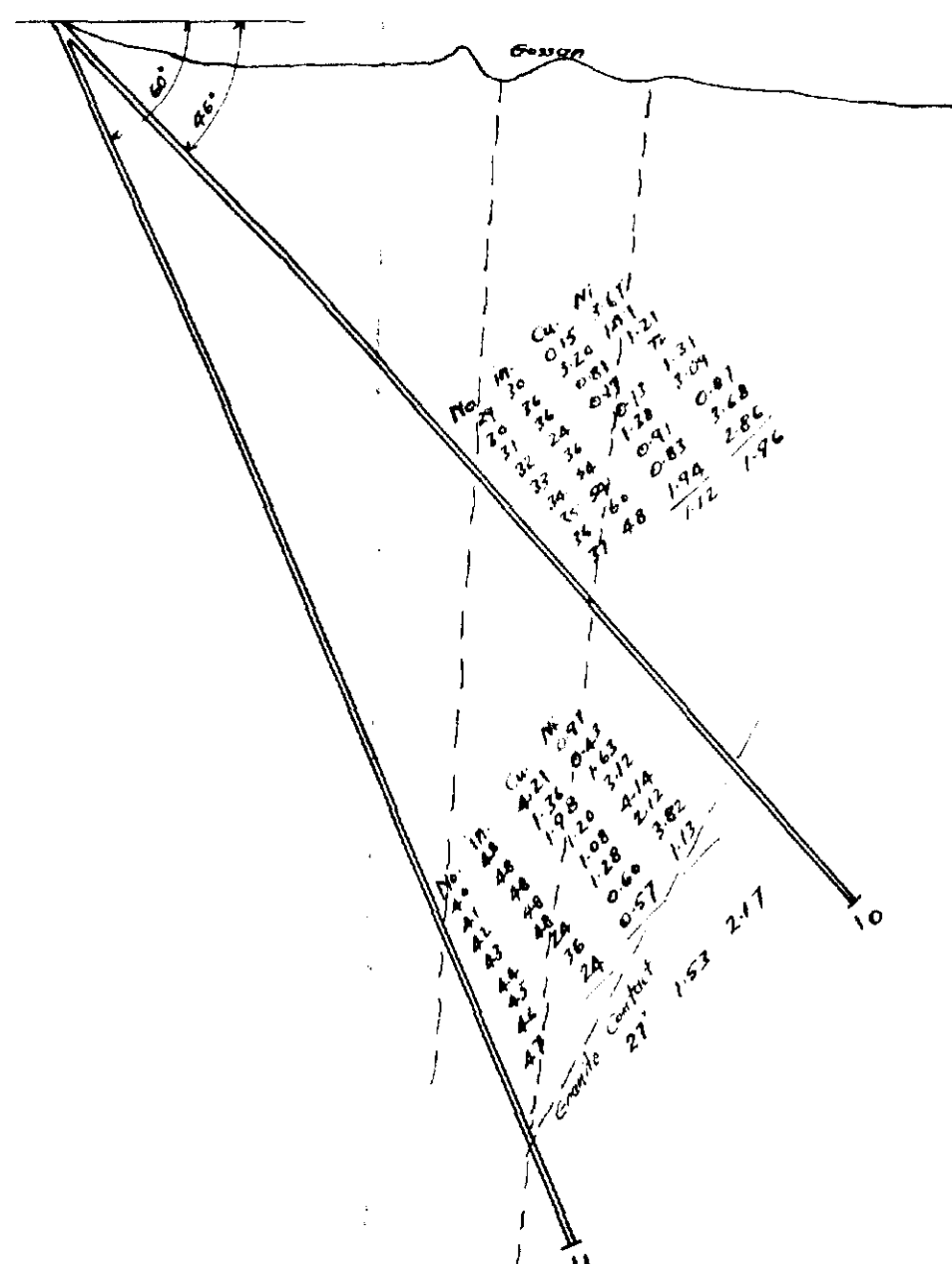
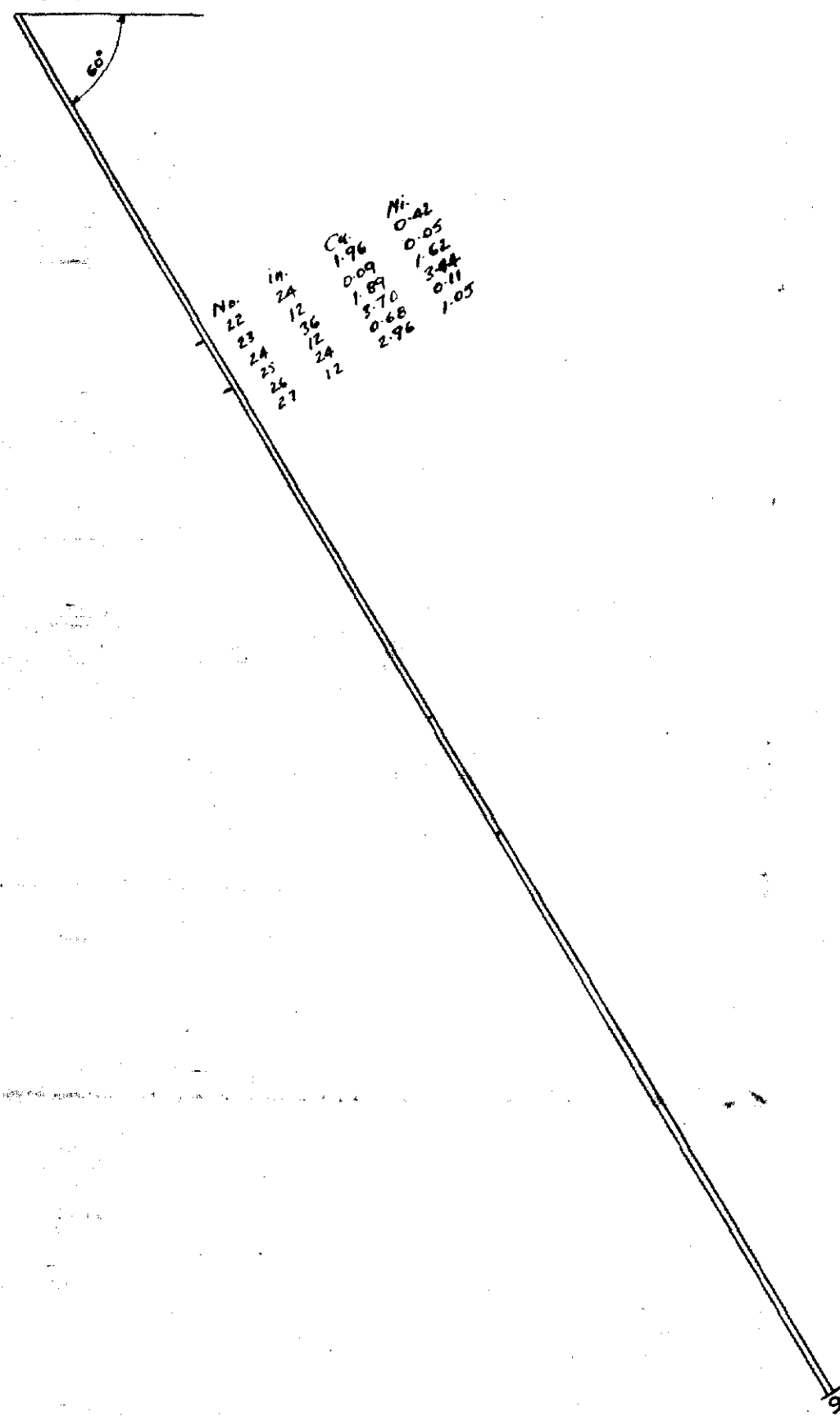

NICKEL OFFSETS, LTD.

SCALE 1 INCH = 30 FEET





No. 20 of 75° on same plane as No. 19.

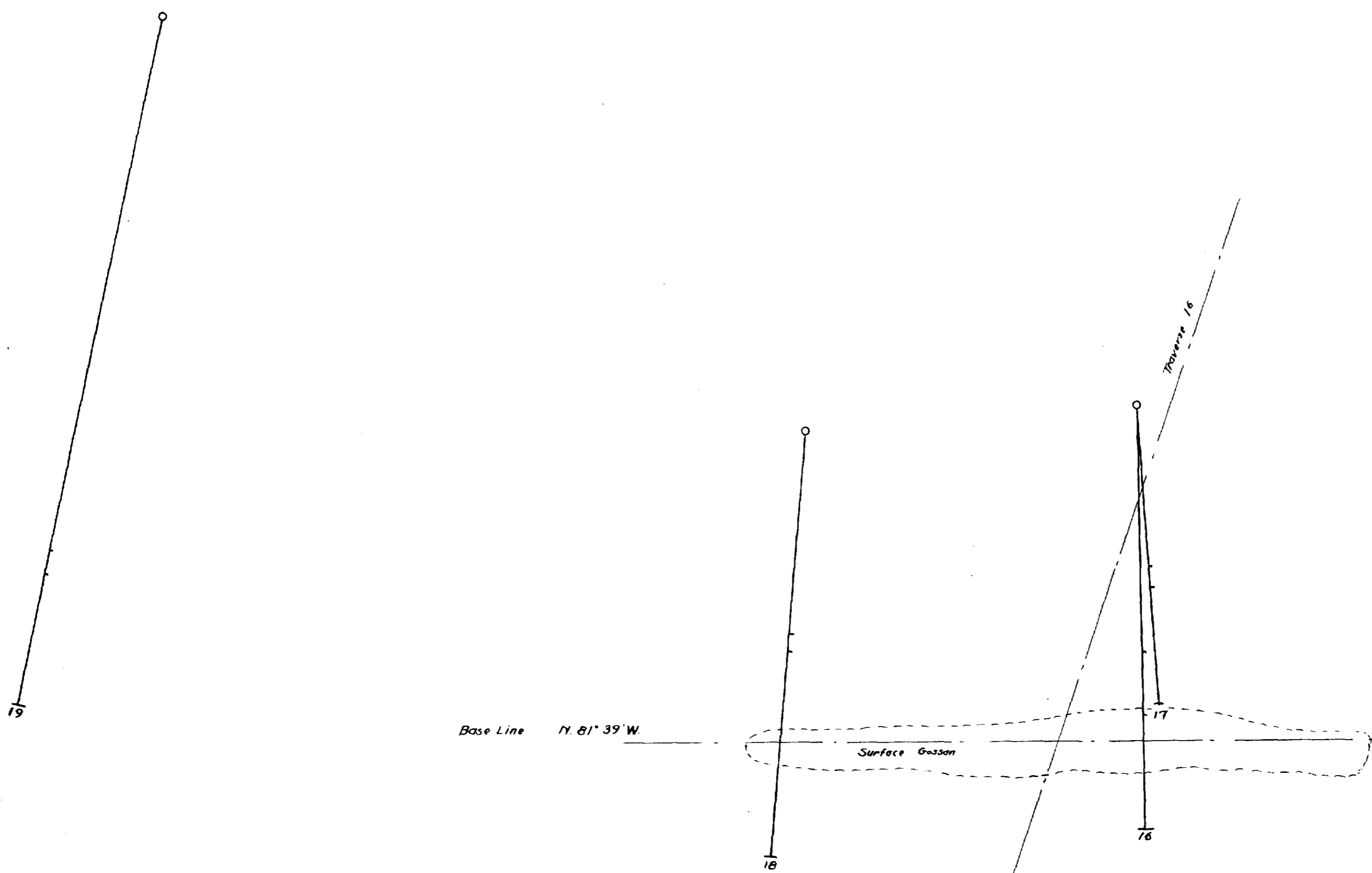
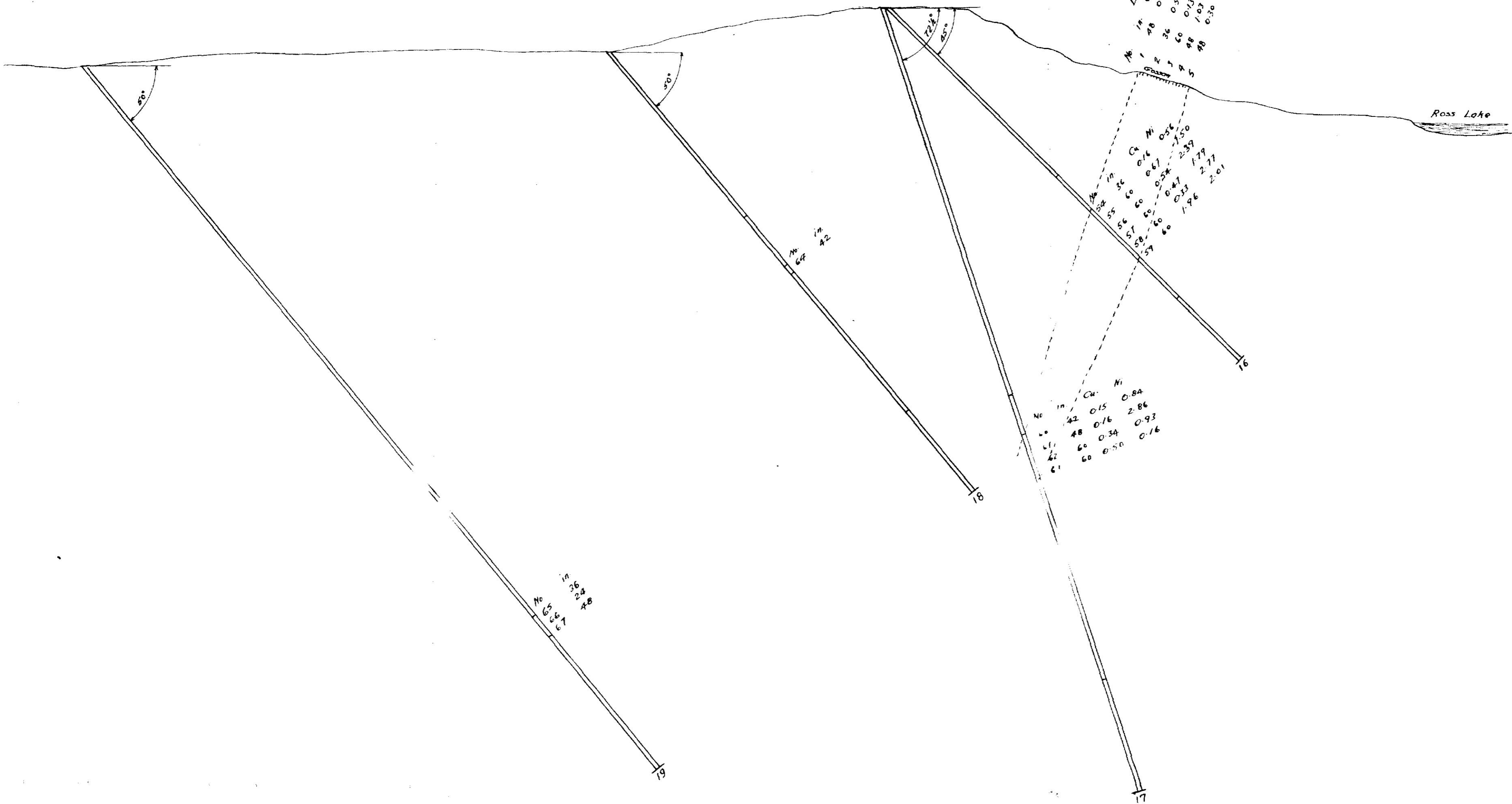

NICKEL OFFSETS, LTD.

SCALE 1 INCH = 30 FEET



41145E0046 F0\*13 F0Y

E-01-0013#3

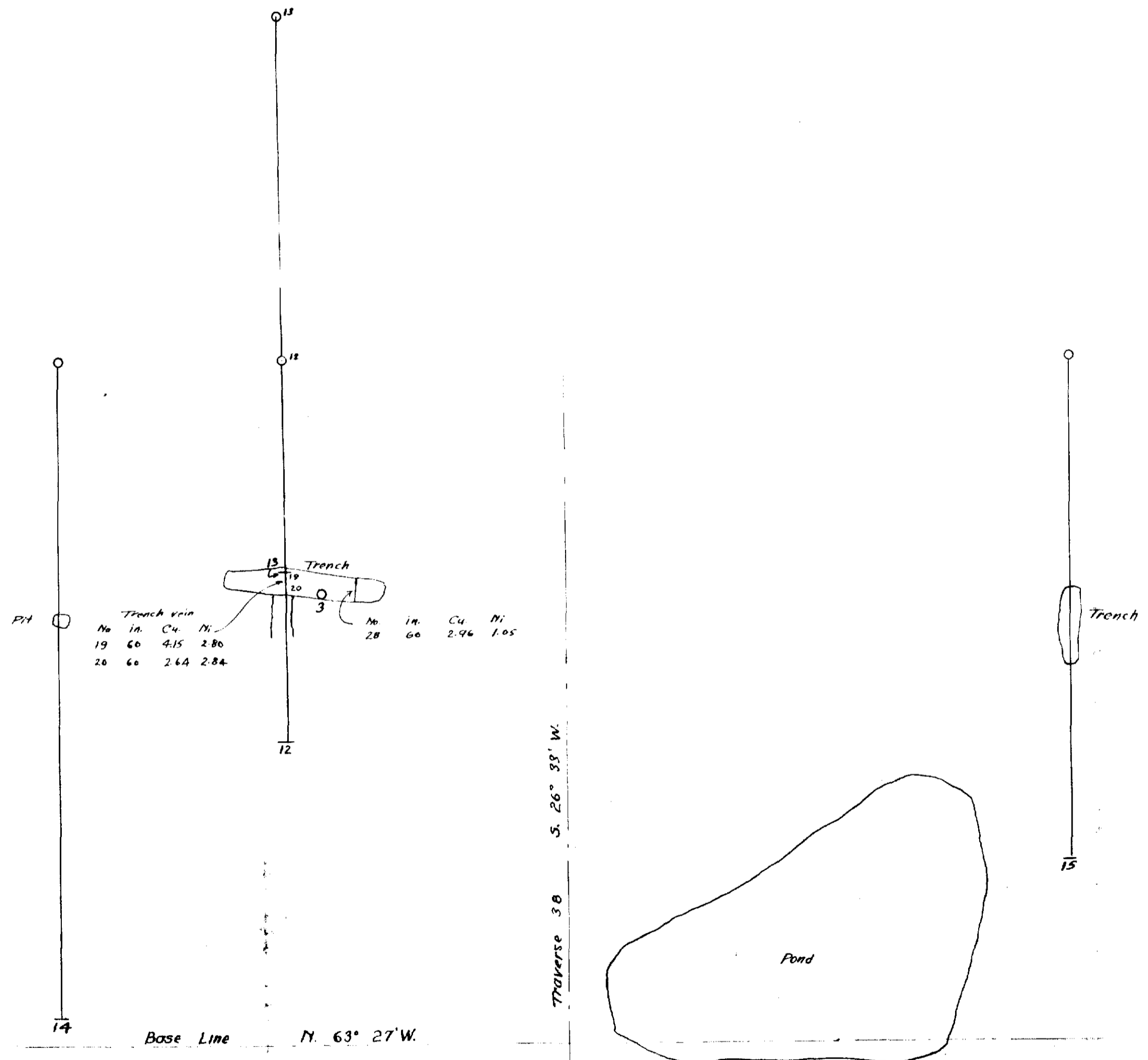
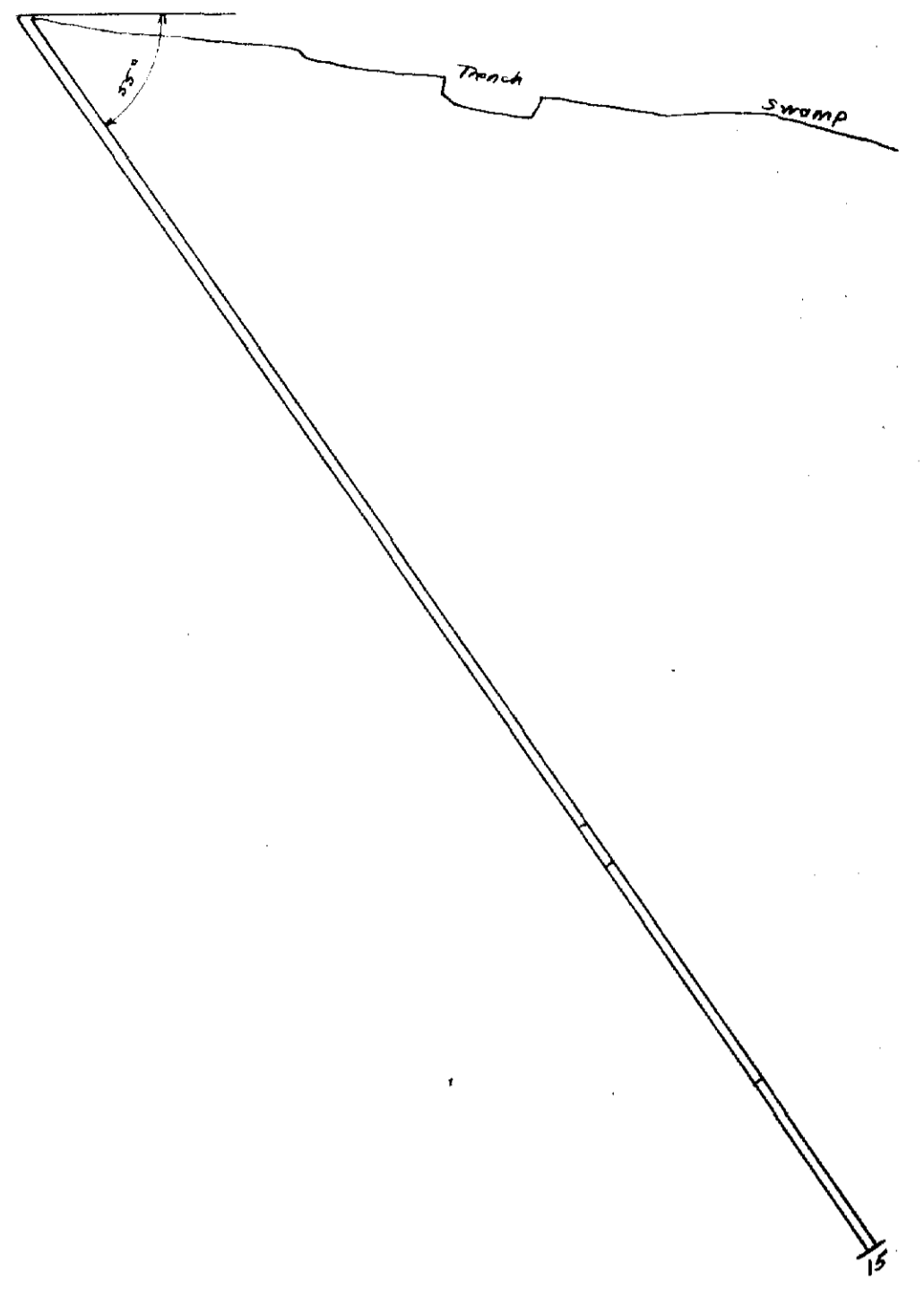
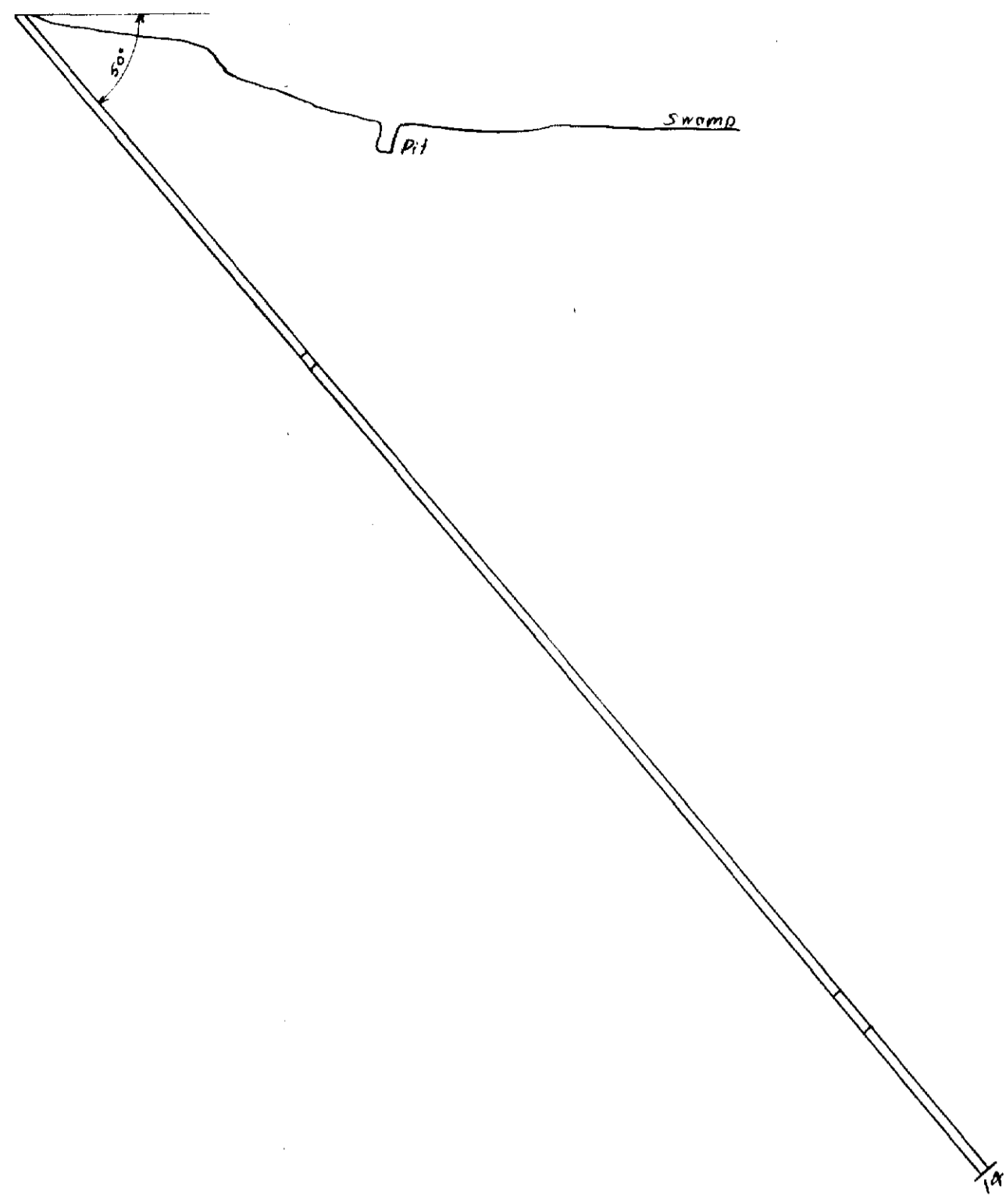
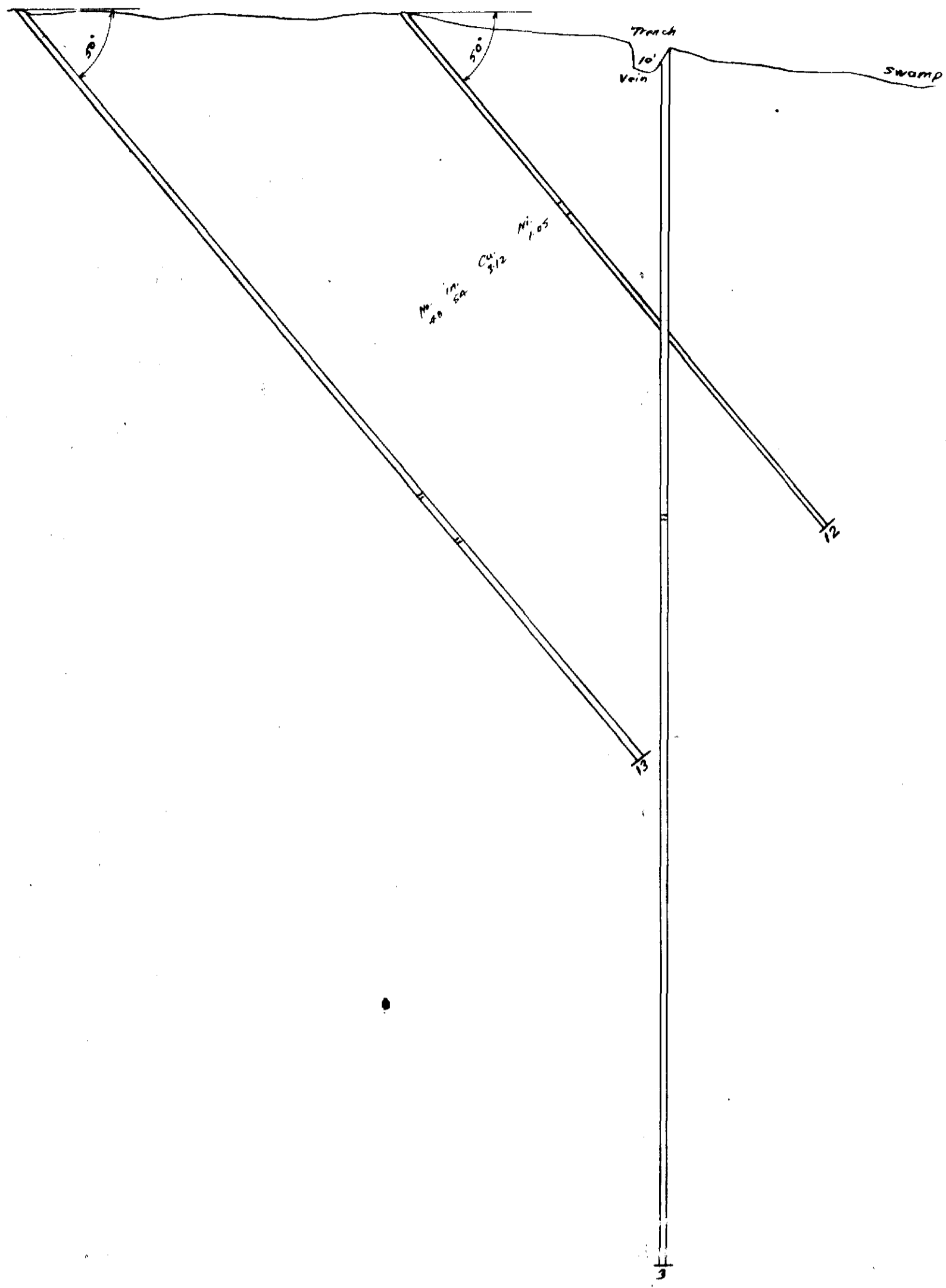

Trench 10-11				Trench 11-12			
No	In	Cu	Di	No	In	Cu	Di
19	60	4.15	2.86	28	60	2.96	1.05
20	60	2.40	2.86				

Distance between Traverses  $31\frac{1}{2} + 38 = 1500$  ft.

NICKEL OFFSETS, LTD.  
 FOY TWP  
 SCALE 1 INCH = 30 FEET

FOY-0013, #4



Duffin River Survey Station 114

HOLE 12-13

HOLE 14

HOLE 15

SECTION TRAVERSE 372 326° 33' W

SECTION TRAVERSE 372 326° 33' W

SECTION TRAVERSE 372 326° 33' W

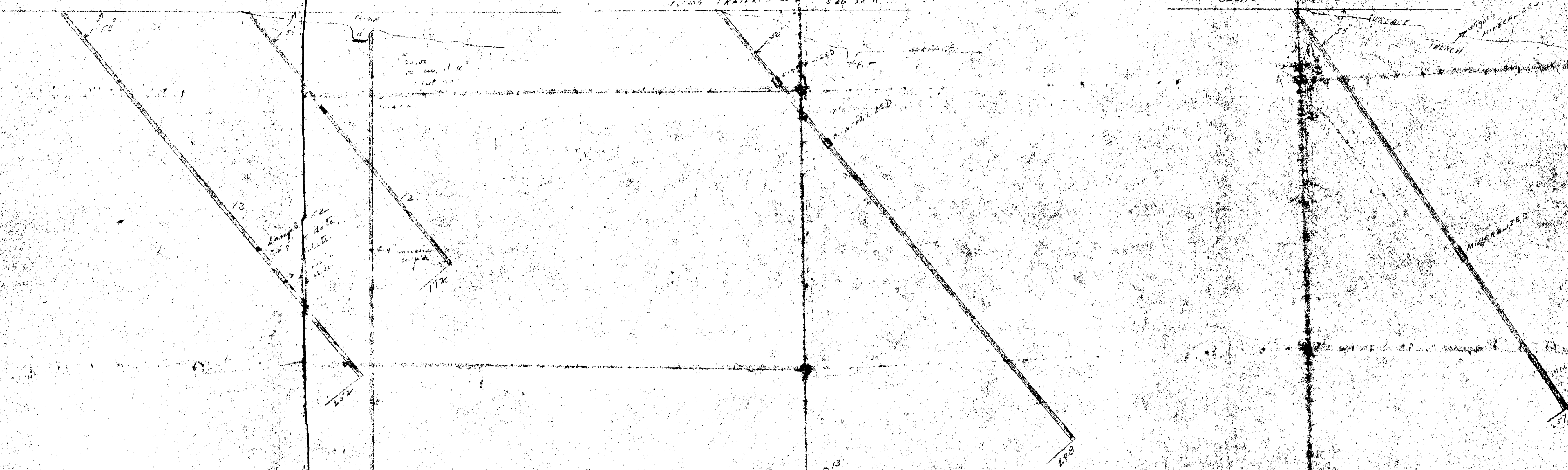

BASE LINE N 132° 17' W

PLAN DD HOLE 12-13-14-15

SCALE 1:500

→ EAST

FOX-0013, #5



N

S

75°

50'

Scale 1" = 30'

19

20

342'

19

FRUITLAND  
LAND SURVEY

NO. 152  
152

152 800000

MIN. HAYE DEPT. TO SOUTH

MUD SEAM - MAY BE EQUIPED

← 6' Trap dike (DARK)

1" Trap dike



FOY-0013, #7

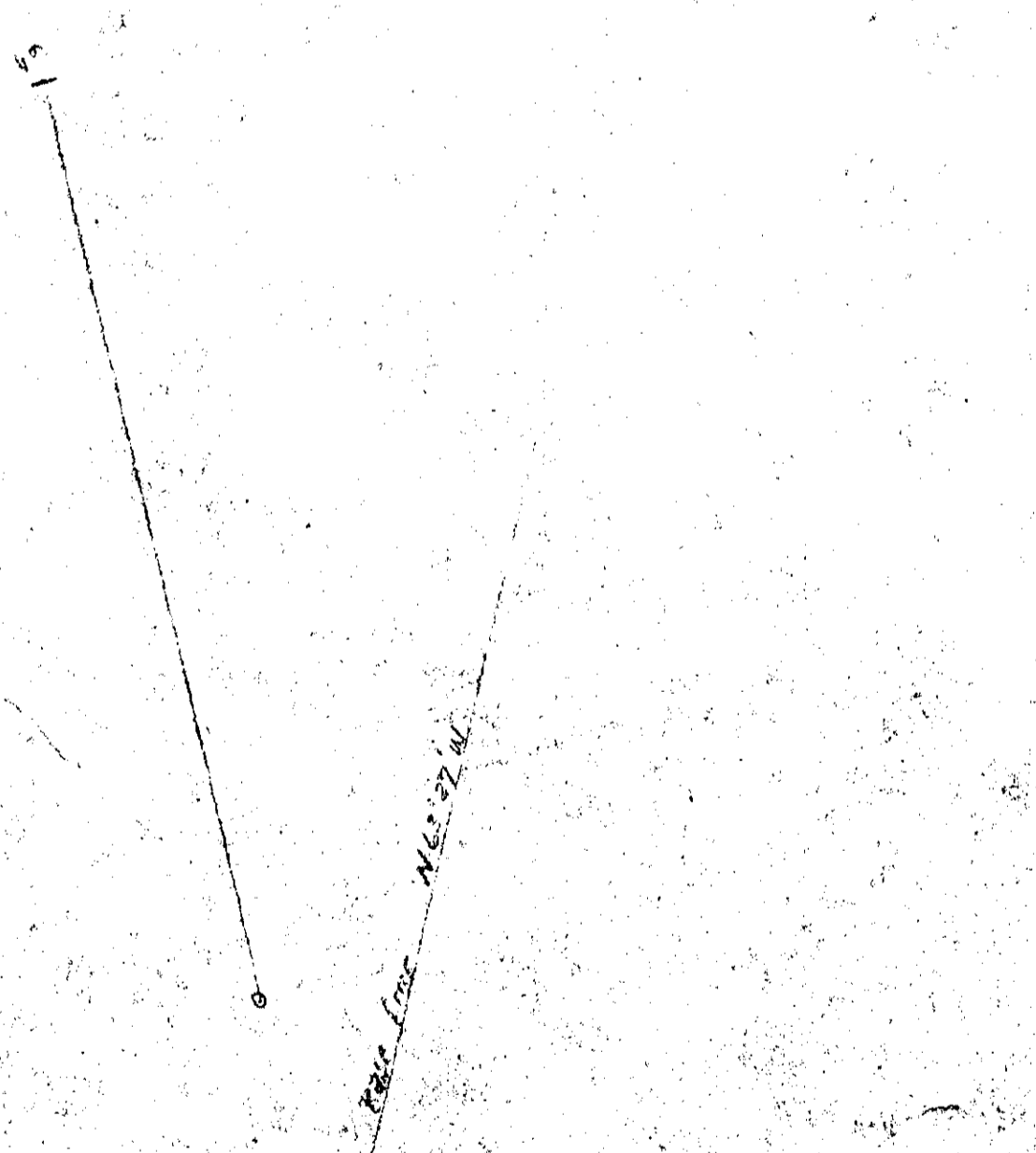
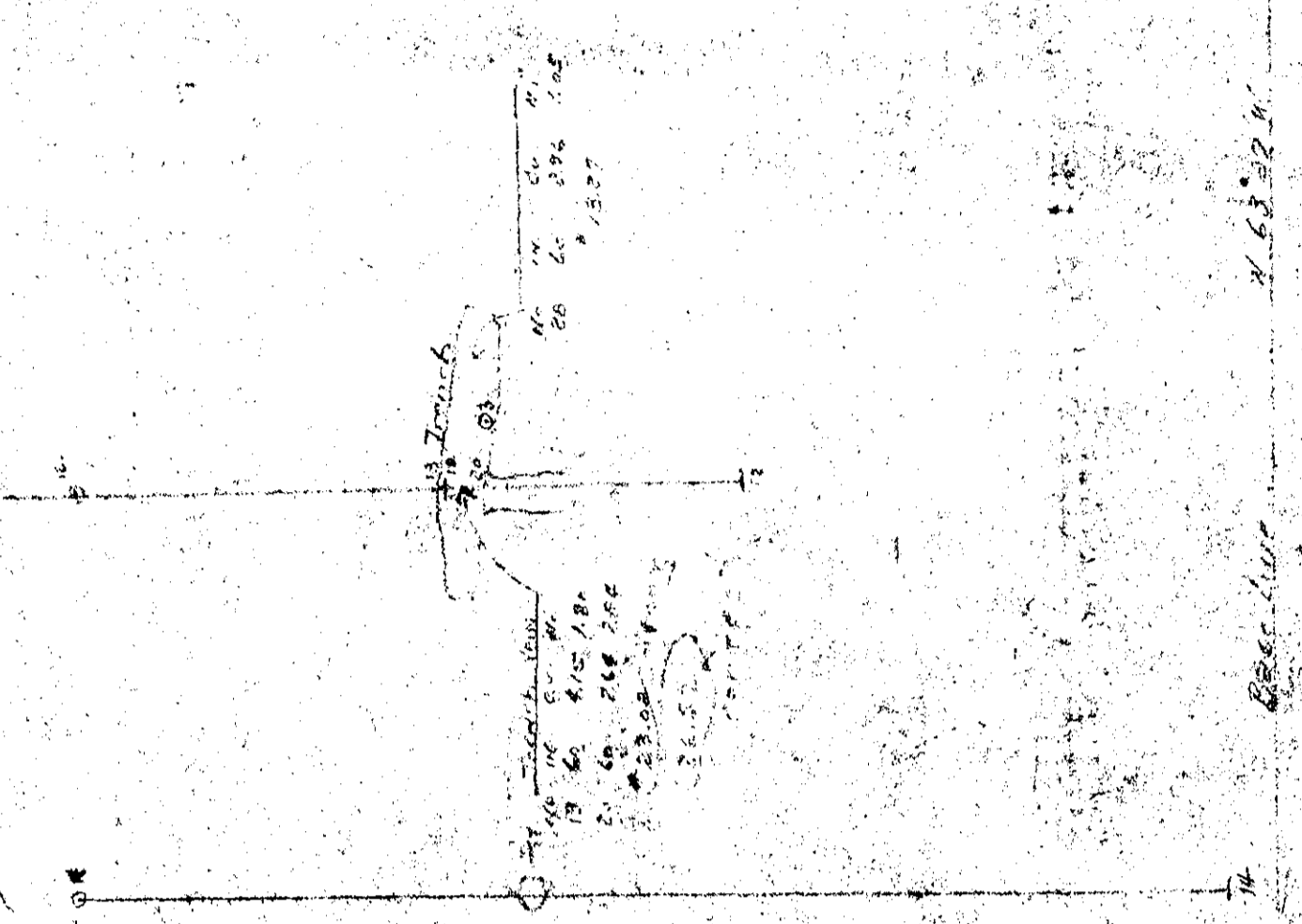
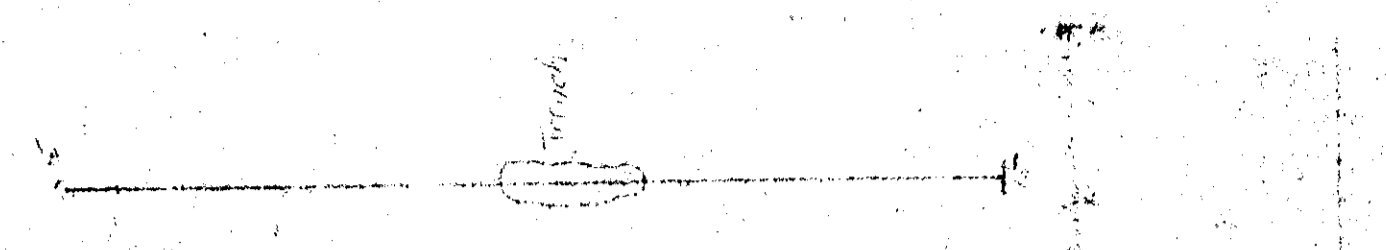
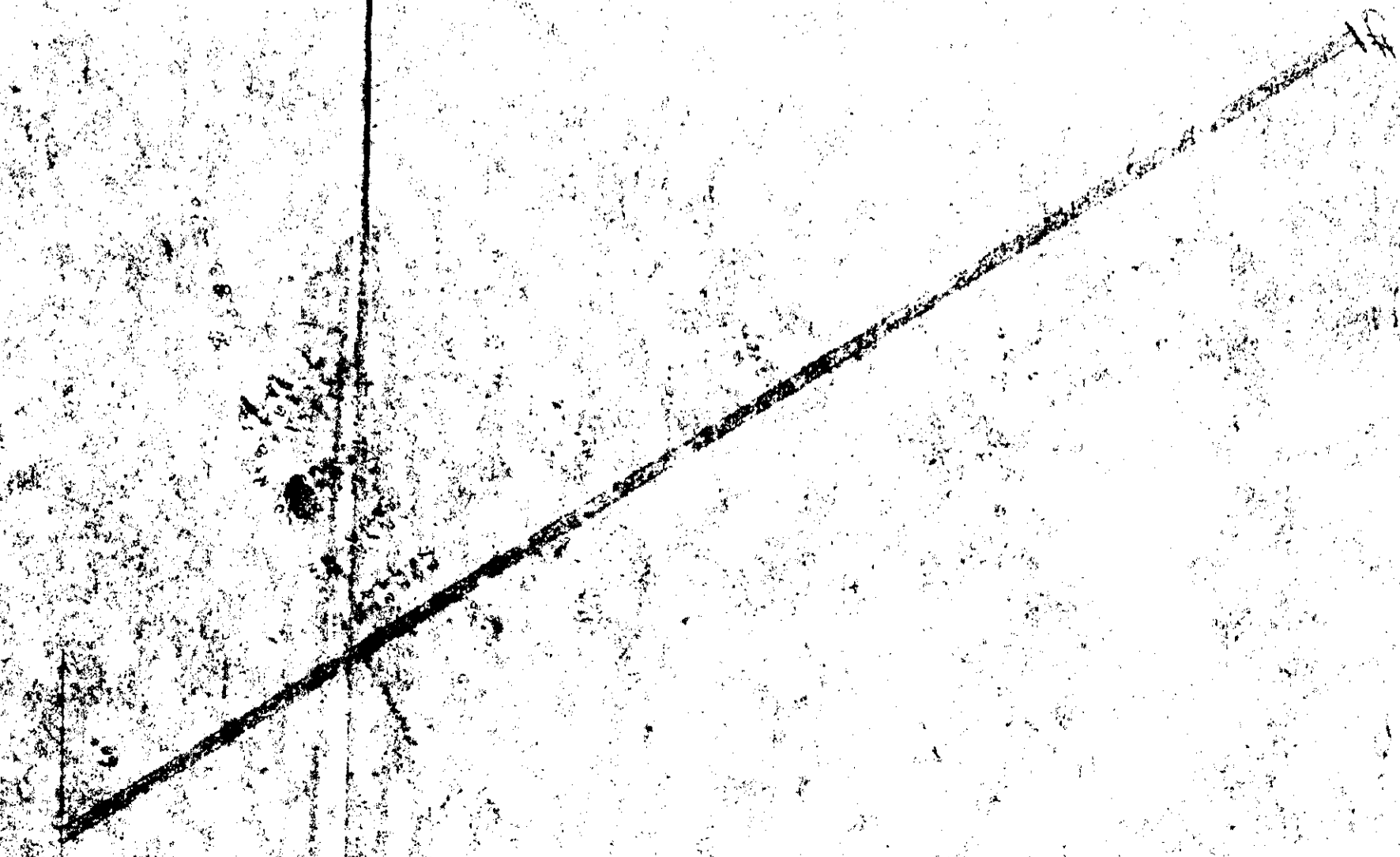
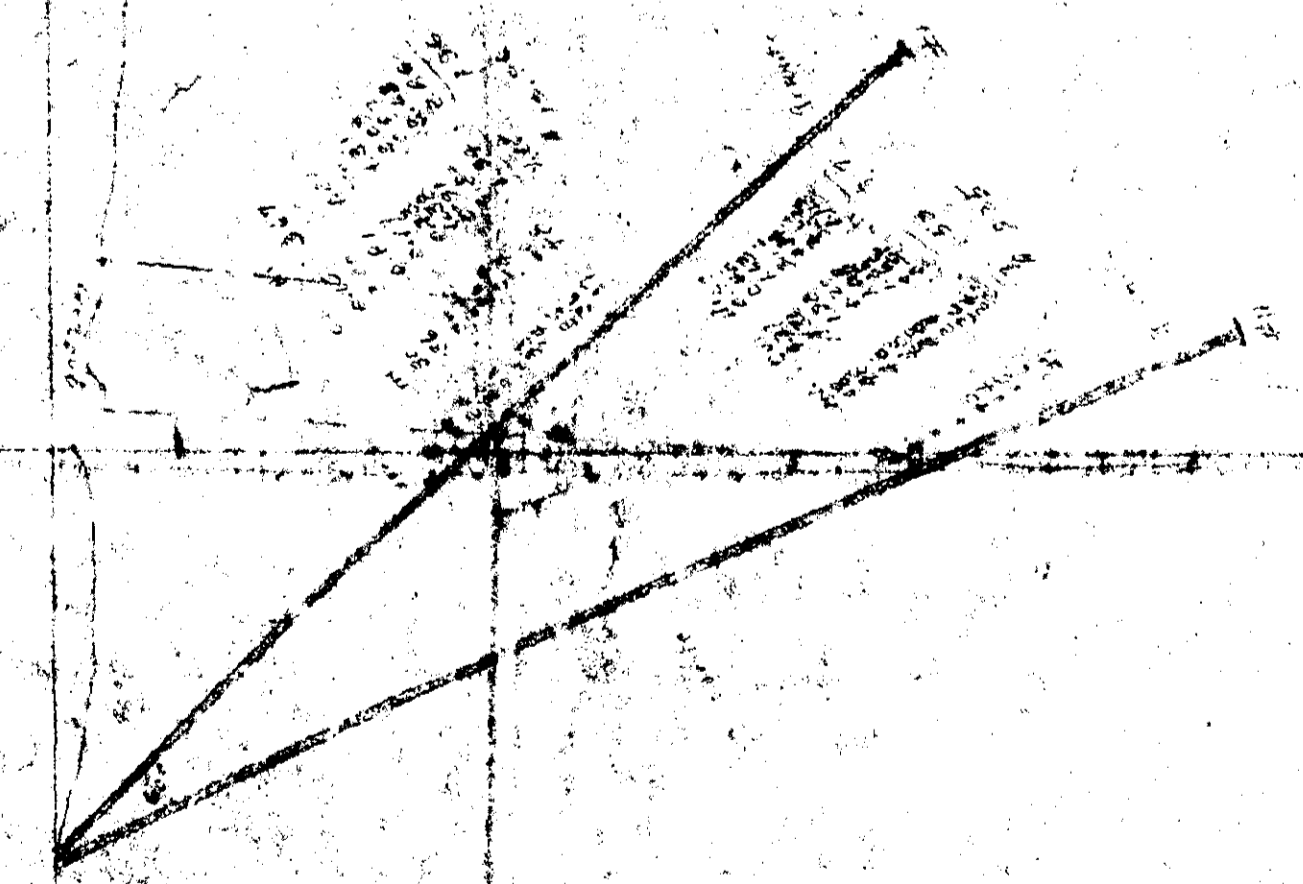
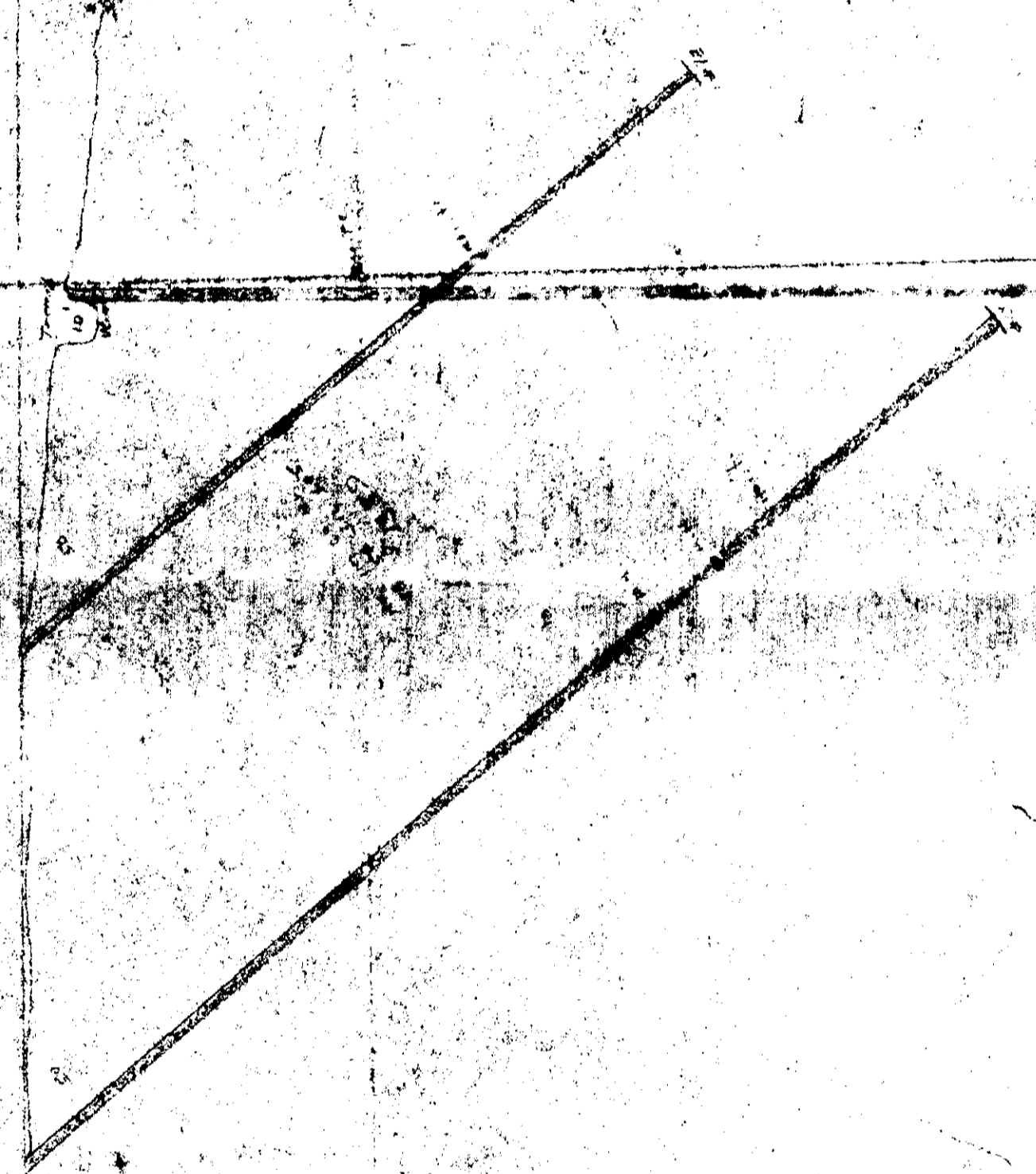
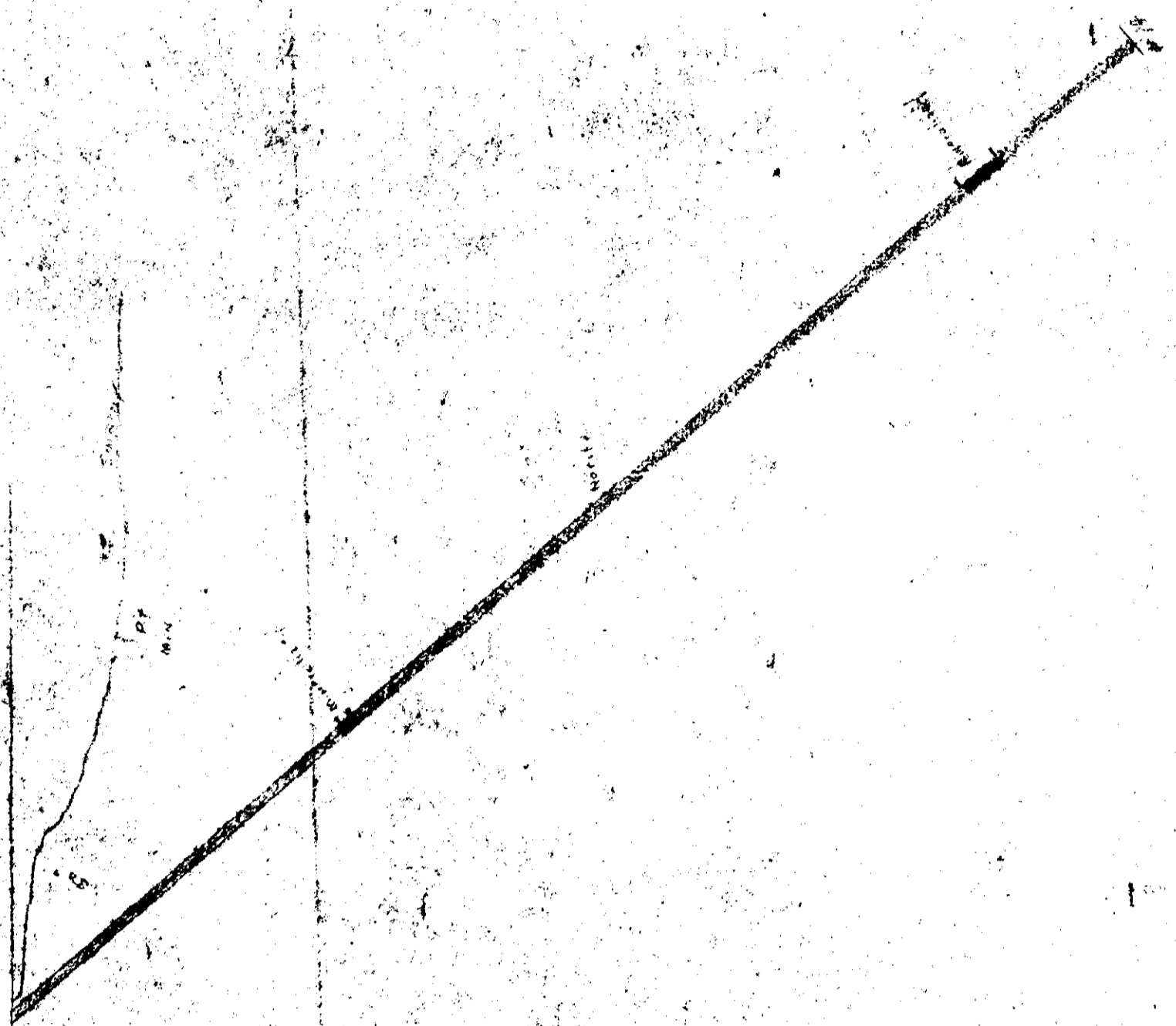

**Problem Page**

The original page in this document had a problem when scanned and as a result was unable to convert to Portable Document Format (PDF).

We apologize for the inconvenience.

**Problème de conversion de page**

Un problème est survenu au moment de balayer la page originale dans ce document. La page n'a donc pu être convertie en format PDF.

Nous regrettons tout inconvénient occasionné par ce problème.

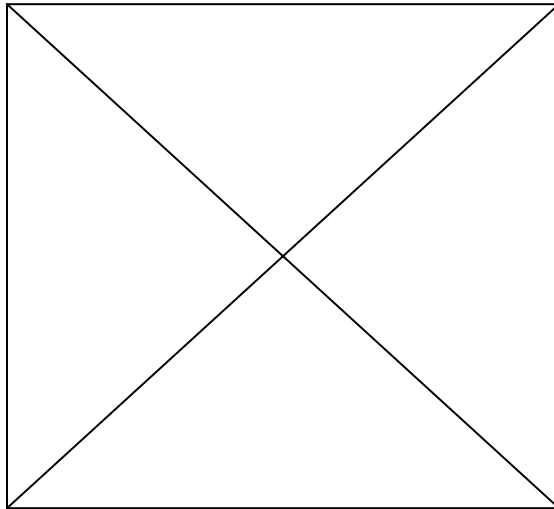

*[Handwritten scribbles]*

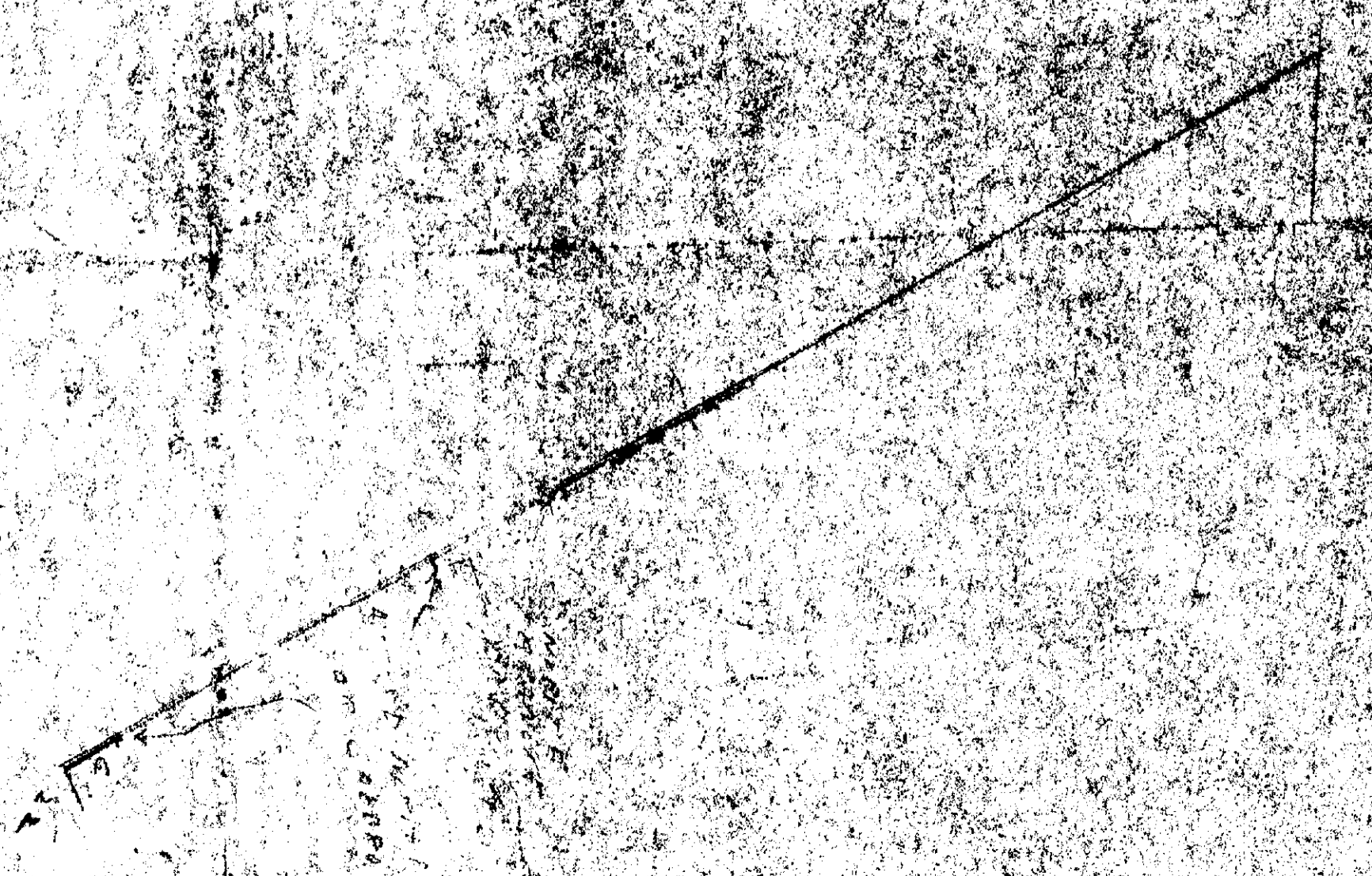
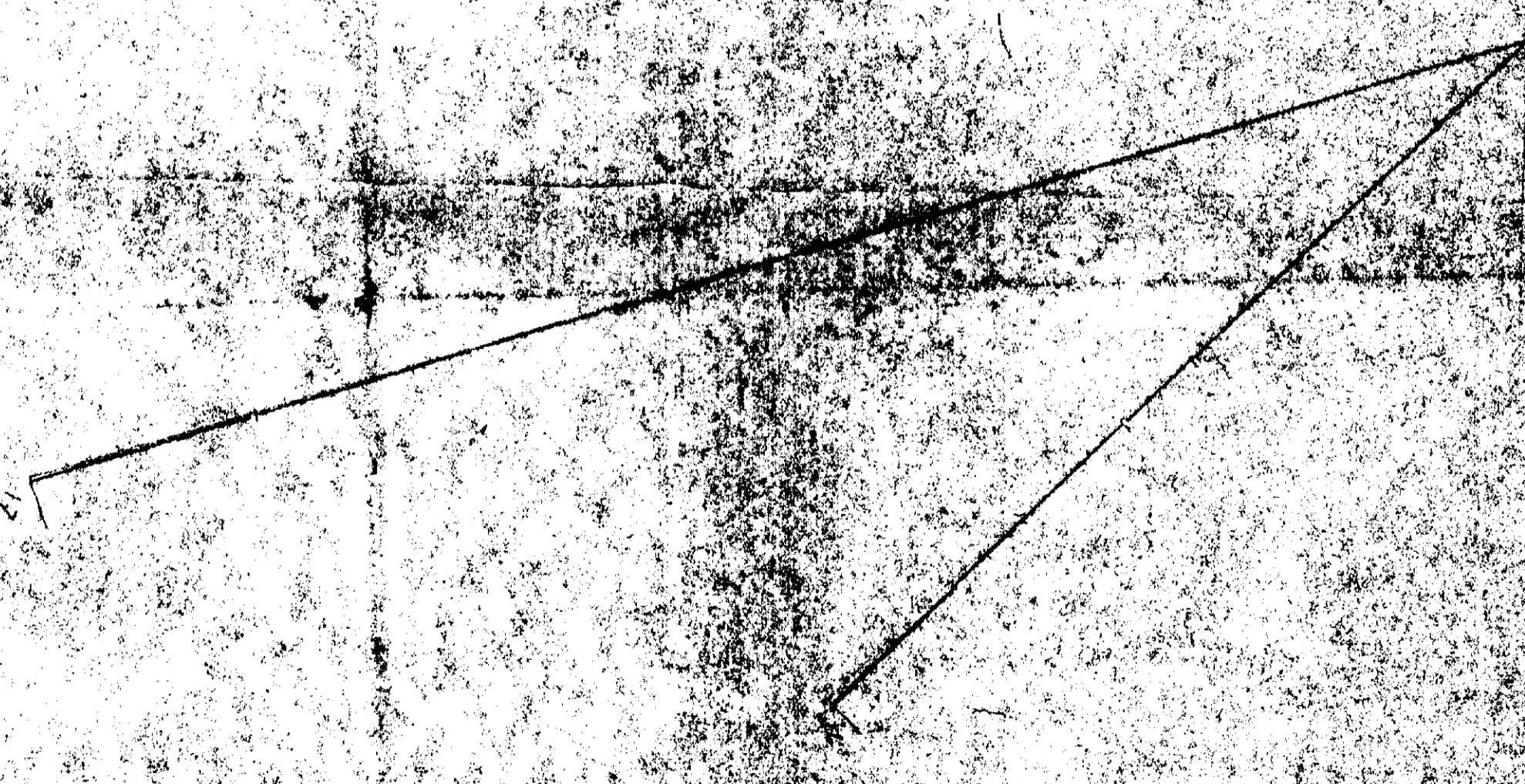
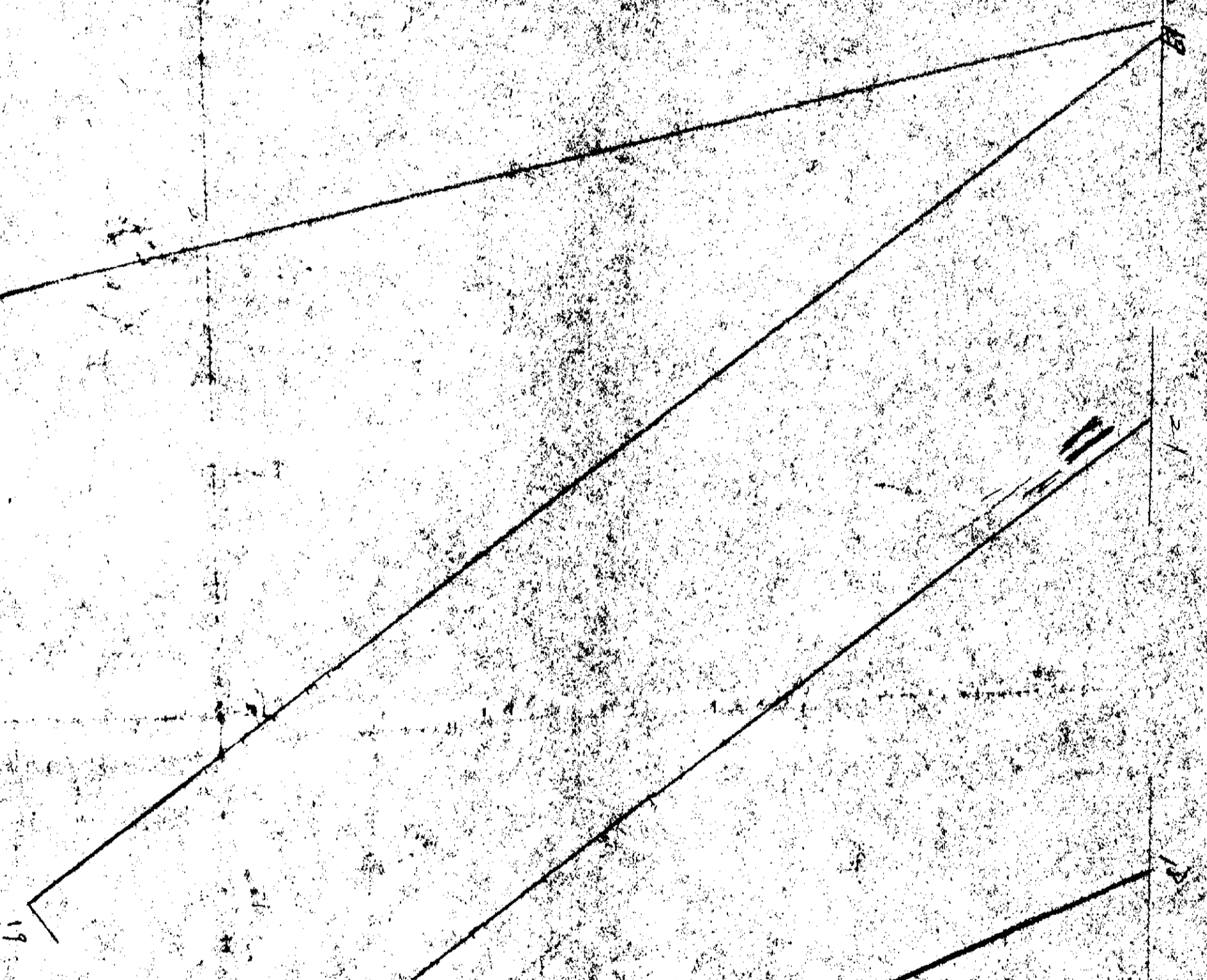
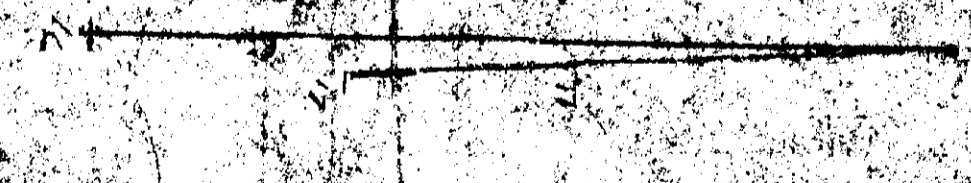
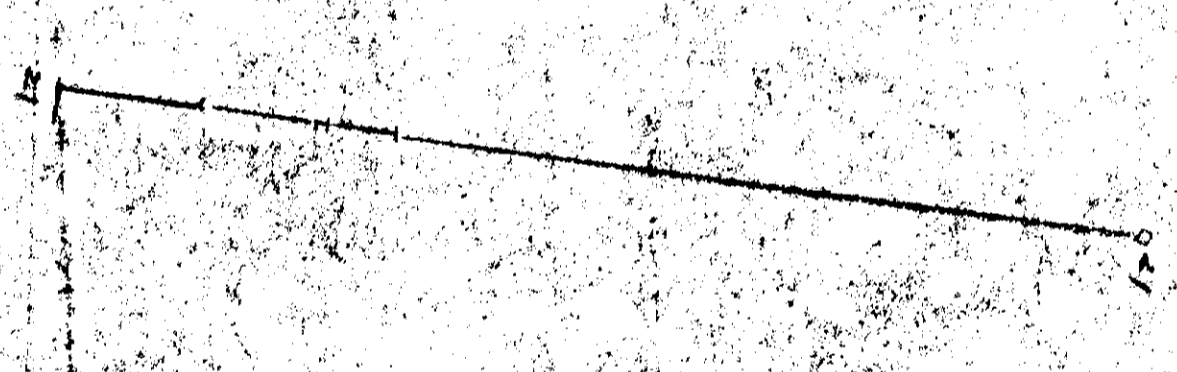
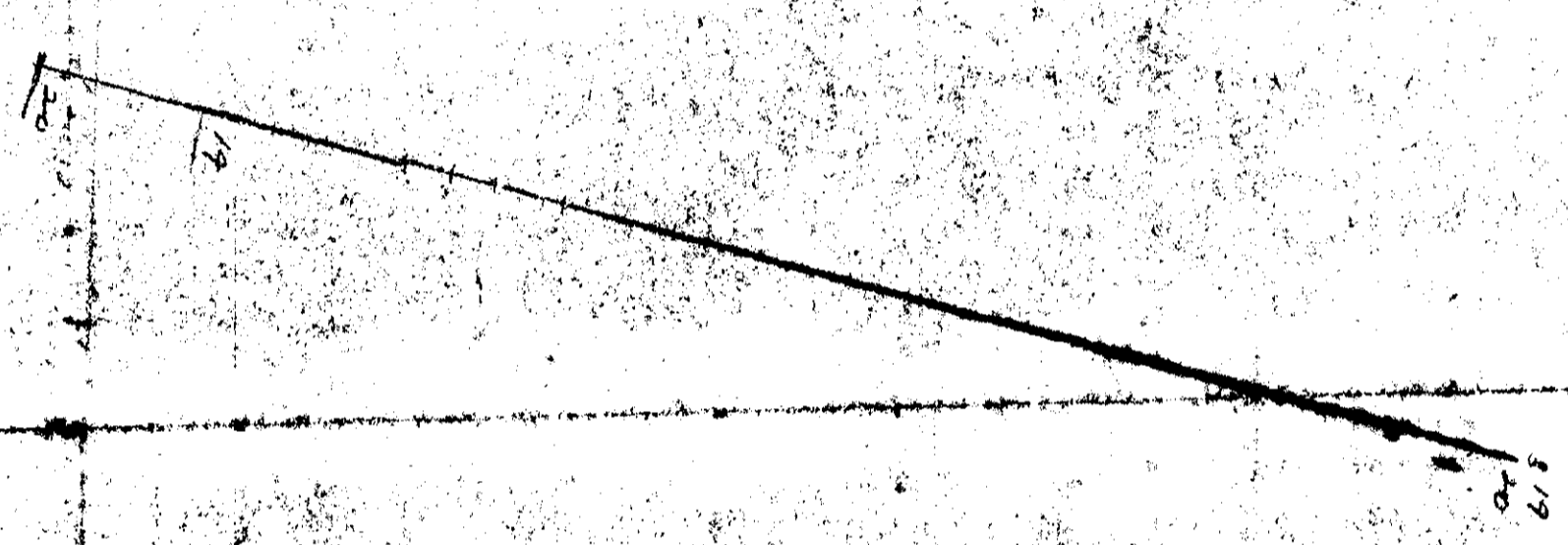
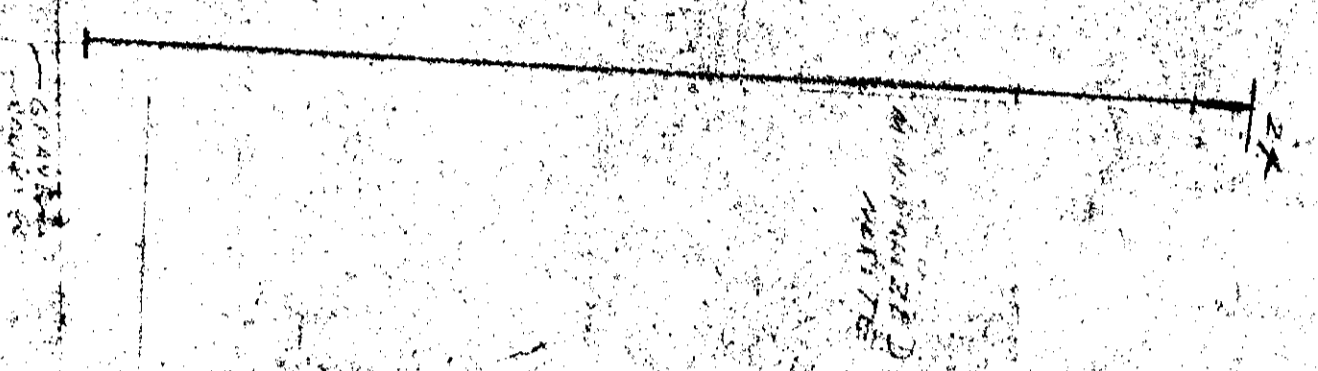

FOY-0013, #9

LINE

No. 071.000 WA (1977)

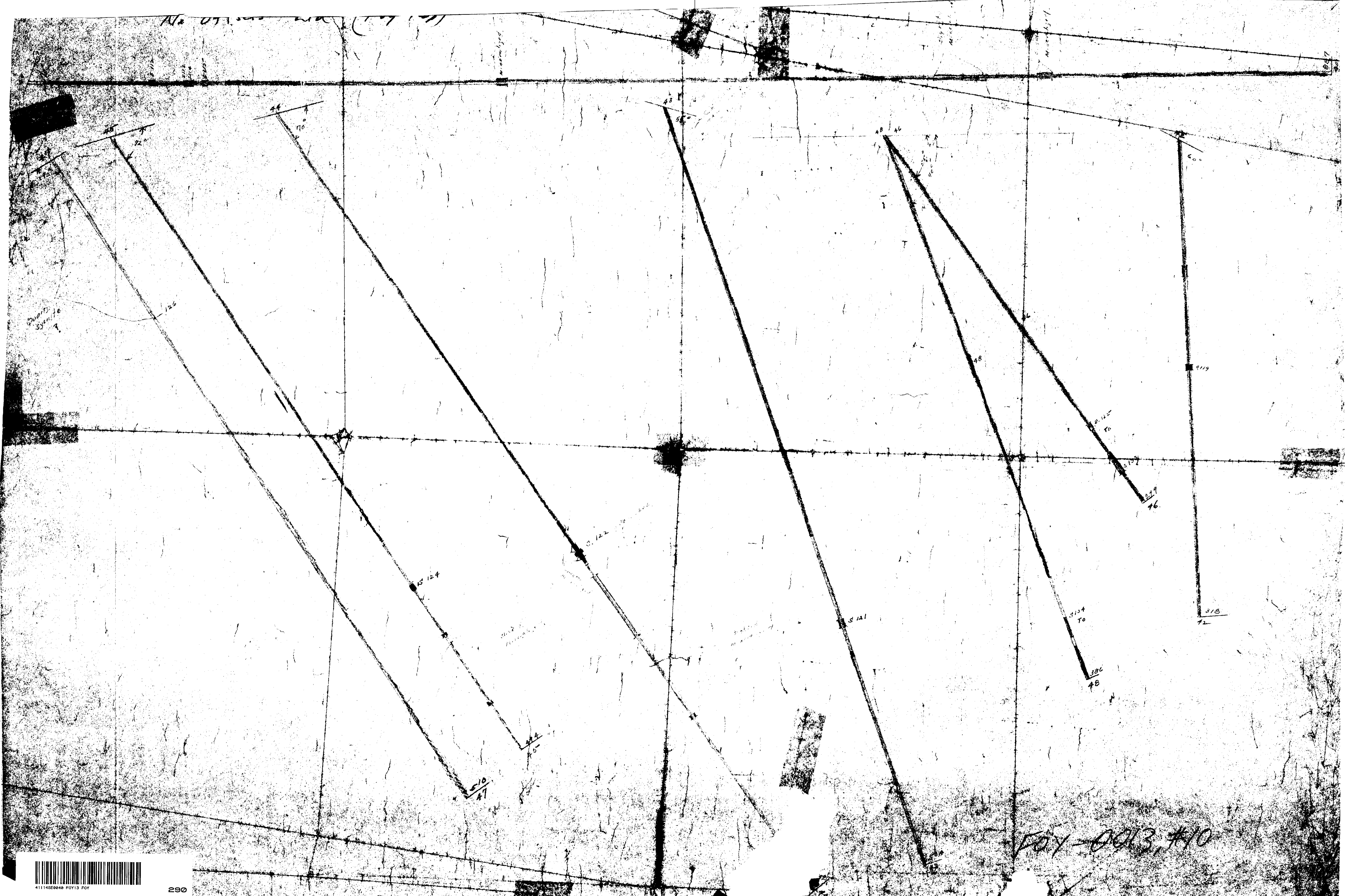

FOY-0013, #10





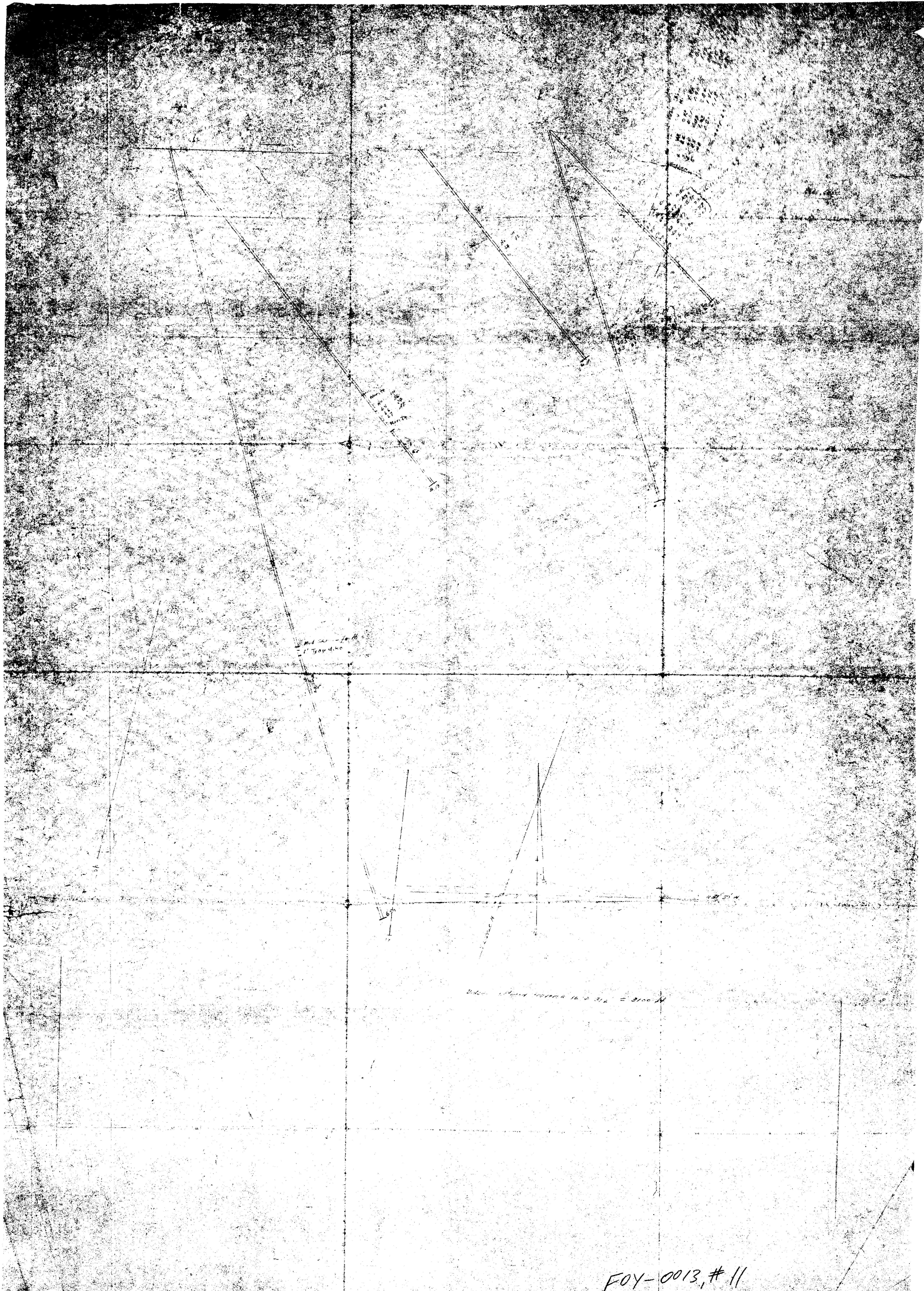

Mid line - 100 ft  
1' Top d.k.c

2000 ft. 1000 ft. 1000 ft. = 3000 ft.

FOY-0013, # 11

