



41115NW0001 63.6094 PARKIN

J. BRADY
1277 Holland Rd.
Sudbury, ONT.
P3A3R1

010

JAN 9/91

O.M.I.P. Administrator.

ATT. MR. Ed. Solonyka.

Dear MR. Solonyka:

Thank you for your assistance under the O.M.I.P. program. The Frateck Twp portion of the program outlined a large area of significant sulfides enriched in both Copper and Gold. While assay results are relatively low the program was successful in outlining a large altered quartz vein structure alongside a major shear zone. Further work is planned to locate enriched areas of Cu, Au mineralization. Flag Resources and Teck Corp have both expressed interest in the property. Falconbridge Ltd. recently acquired a large group of claims to the south and east of the property.

The program in Parkin Twp was successful in expanding the previously known gold zones by ± 500 ft. with Trenches ① and ② returning anomalous values and trench #3 returning values of .132 oz Au x 3'. Toward the north end of the claim (631396) the known gold zone was also extended by 50' with an assay return of .208 oz Au. I am continuing to negotiate with 2 separate companies on this ground and will advise you of the results.

Yours truly
John Brady

DMIP 90-099

Judoway, ONY
Sept 20/90.

ATTENTION O.M.I.P. Administrator.
RE. South East Frazeck Township property

I have been involved in ~~the~~ exploration of the subject property for the past five years. The property consists of 10 unpatented mining claims in South ~~West~~ ^{EAST} Frazeck Township in the Sudbury Mining Division.

Access to the property is via the Moose Mountain Mine Road for four miles north of Capreol ONT. (Capreol is \pm 16 miles north of Sudbury) From this point access is achieved by proceeding for \pm 10 miles north east via the North River Road. Both International Nickel and Falconbridge Nickel have visited the property and expressed some interest in its potential for base metals (nickel, copper) due to the proximity ~~to the~~ of the property to the Parkin offset, nickel irruptive dyke which has been located approximately one mile to the south. They have both recommended further prospecting work for both base and precious metals and these are my targets. My work to date has resulted in assays of 1% Cu and 8.9 ppm Au. However values are erratic and it is difficult to follow the main fractured and altered zone due to light to moderate cover of overburden.

The regional geology indicates intrusive dykes of Nipissing Diabase adjacent to Espanola and Serpent Formation of the Huronian Group.

(RE: ONTARIO Geological Survey MAP 2361)

The local geology confirms the above and also highlights mineral occurrences of Au, Ag, Pb, Cu and Zn within or adjacent to the claim boundaries. [MAP 2212 from Geological Report # 91]

The focus of my project is on claims 854568 and 854569 where the brecciated contact of the diabase and limestone have returned significant Au and Cu values. This brecciated zone has the appearance of a major structure in that it is now exposed over a \pm 140 ft. width for \pm 200'.

Falconbridge staff geologists who recently visited the property have recommended further stripping and trenching and sampling to more fully define the structure. ~~I require some financial support under OMTA in order to~~

As per the attached map my project will consist of stripping, trenching and sampling to fully intersect the structure at right angles to evaluate width, length and mineral values.

I plan to commence my project on July 21/90 and to complete by ^{by working days} DEC 30/90.

I estimate that 200 ~~man days~~ ^{working days} will be spent on the project. ~~at~~ Geological Reference is attached.

Thank you for your assistance
John Brady



Ministry of
Northern Development
and Mines

Temiskaming
Testing
Laboratories

P.O. Box 799
Presley St.
Cobalt, Ontario
POJ 1C0
(705) 679-8313

Report Number
CB 11603

Laboratory Report

Date Nov. 23, 1990

Issued To: Mr. John Brady, 1227 Holland Rd., Sudbury, Ont. P3A 3R1

Sample Number	Gold Oz. Per Ton	Silver Oz. Per Ton	
chip x4' #182122 PARKIN TR 2	0.035	N11	} MAP #12 - PARKIN TR 2 - OMLP 1990
chip x3' 182123 PARKIN TR 3	0.132		
chip x5' 182125 PARKIN TR 1	0.031		
chip x6' 182128 PARKIN TR 1	0.006		
chip x2' 182130 PARKIN TR 6	0.208		

Fees Received **Charged 6 coupons card \$1100**

L. McNaught for **J. Ireland**
Manager (Acting)

Except by special permission, reproduction of these results must include any
qualifying remarks made by this ministry with reference to any sample.

LOCATION: PARKIN TWP.
 MAP No. 2 - OMIP - JBRADY 1990.

No.	STRIPPED	TRENCHED	ASSAY SHEET NO.
			CB 11603
①	500'x10'x4'	50'x8'x3'	#182128 .006 Au #182125 .031 Au
②	300'x10'x5'	60'x8'x3'	#182122 .035 Au
③	50'x12'x5'	30'x10'x4'	#182123 .132 Au
④	110'x12'x5'	25'x10'x3'	
⑤	25'x10'x4'	—	
⑥	200'x10'x5'	70'x8'x3'	#182130 .208 oz Au

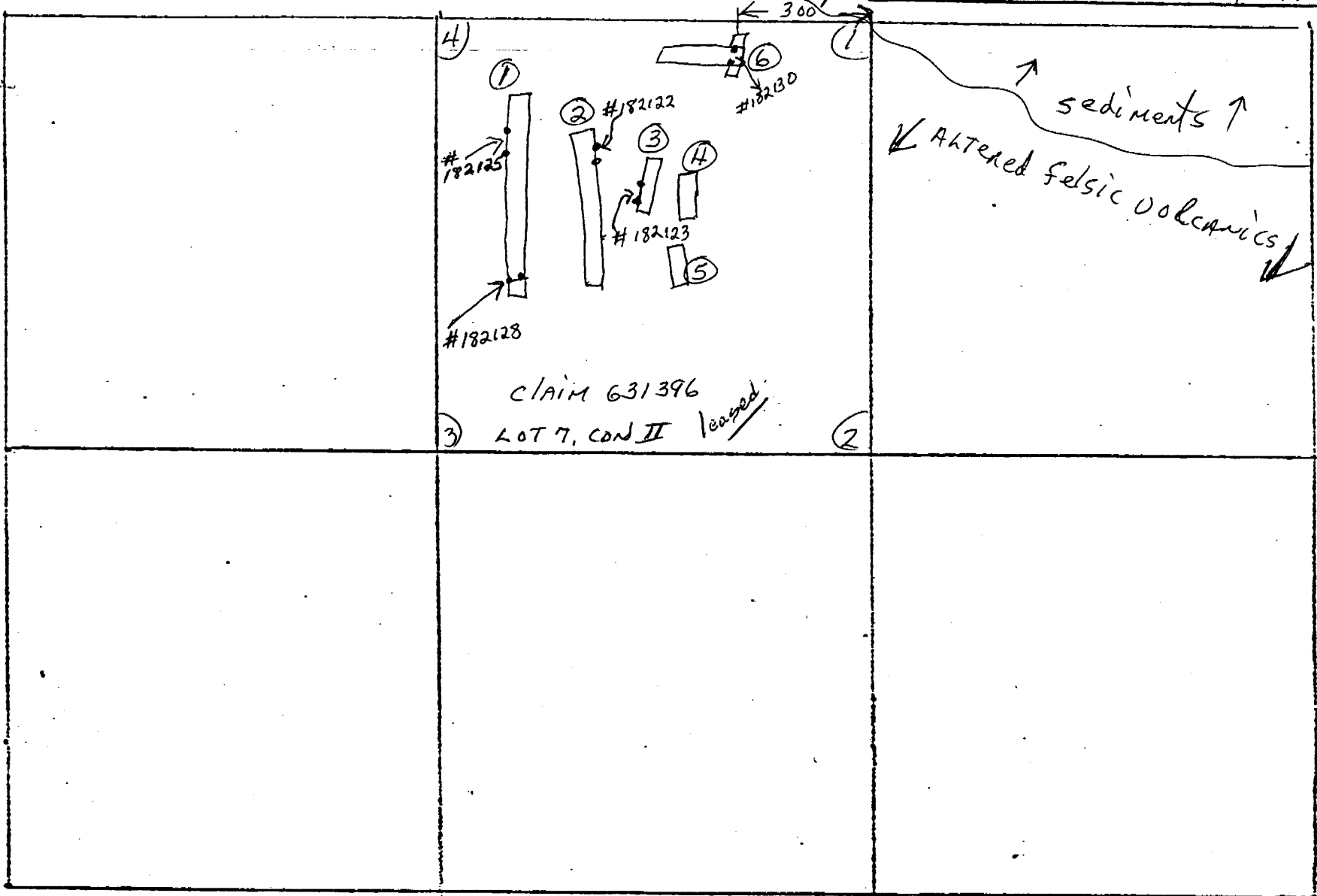

N
 lot 1
 con 2

SCALE: 1" = 440'
 MAP No. 2

J. BRADY 1990



Ministry of
Northern Development
and Mines

Temiskaming
Testing
Laboratories

P.O. Box 799
Presley St.
Cobalt, Ontario
P0J 1C0
(705) 679-8313

Report Number

CB 11626

Laboratory Report

Date Dec. 21, 1990

Issued To: Mr. John Brady, 1227 Holland Rd., Sudbury, Ont. P3A 3R1

Sample Number	Gold Oz. Per Ton	Silver Oz. Per Ton	Cu%	Co%	Ni%	Zn%
chip X4' #18124 FRALECK TR 4	0.027					
chip X1' 18125 FRALECK TR 2	0.016					
chip X1' 18126 FRALECK TR 5	0.007					
GRAB 18127 FRALECK TR 5	0.005					
chip X2' 18129 FRALECK TR 3	0.015					
chip X5' 8497 FRALECK TR ①	0.022	Trace	0.224	0.008	0.012	0.022
chip X4' 8498 FRALECK TR ①	Trace		0.134		0.019	0.006

MAP #1
FRALECK Twp
OMIP 1990

Fees Received Charged Invoice #003564
Receipt #A855658

J. Ireland for J. Ireland
Manager (Acting)

Except by special permission, reproduction of these results must include any
qualifying remarks made by this ministry with reference to any sample.

LOCATION: FRALECK Twp
 MAP No. 1 - OMLP - JBRADY 1990

No.	STRIPPED	TRENCHED	ASSAY sheet NO.
			CB 11626
(1)	800'x10'x5'	40'x8'x3'	#8497 .022 Au, .224 Cu #8498 TR. Au, .134 Cu
(2)	400'x10'x6'	20'x10'x3'	#18125 Au .016
(3)	500'x10'x4'	30'x7'x3'	#18129 .015 Au
(4)	300'x10'x5'	50'x9'x4'	#18124 .027 Au
(5)	550'x10'x3'	40'x7'x2'	#18126 .007 Au #18127 .005 Au

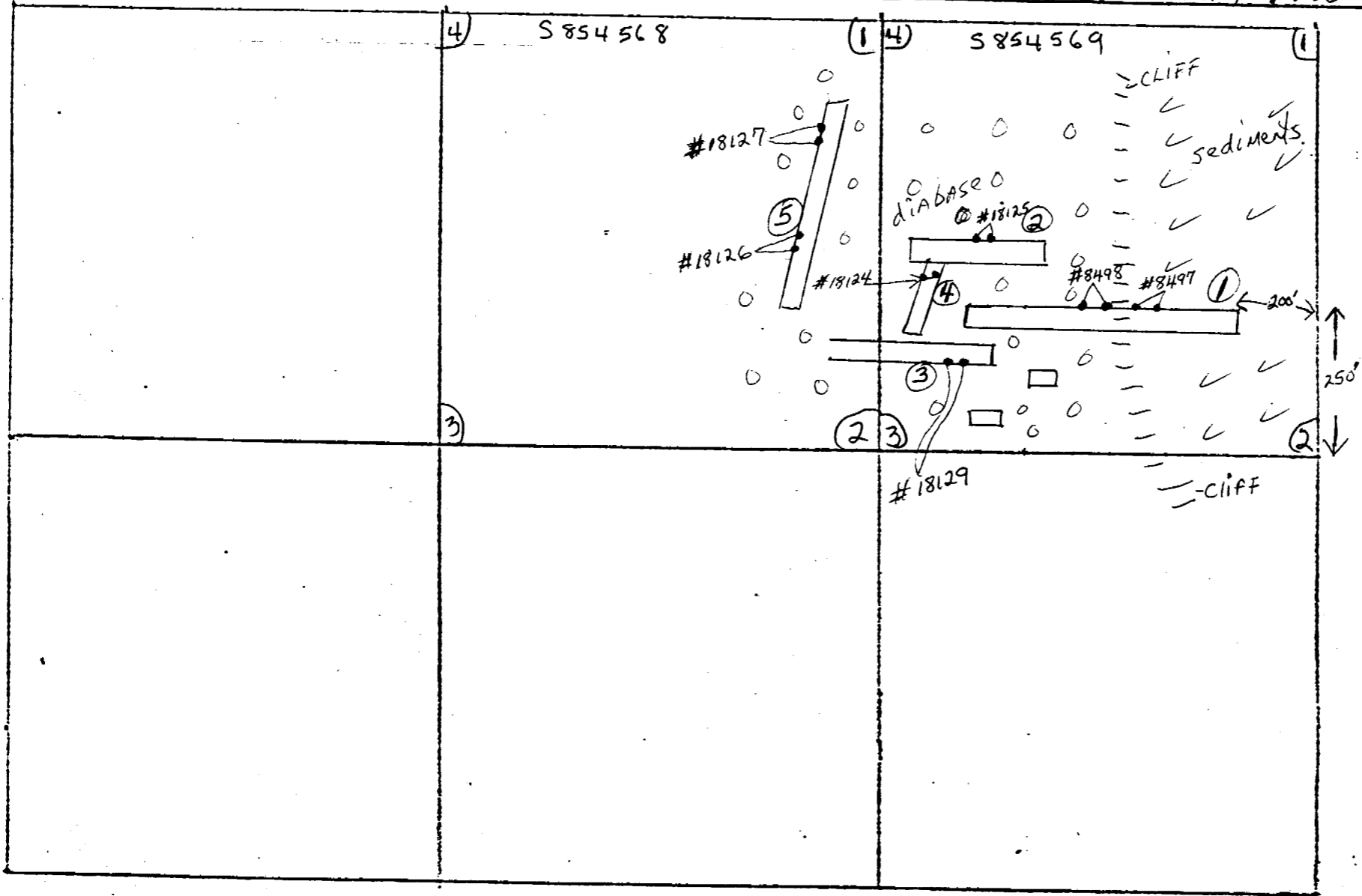

N
 LLL - sedimentary Rock - Conglomerate
 OOOO - NIPISING DIABASE

SCALE: 1" = 440'
 MAP No. 1

J. BRADY. 1990