



41115NW0010 0015 CREELMAN

010

RECEIVED

FEB 11 1977

PROJECTS UNIT

by hand

REPORT ON
AIRBORNE GAMMA RAY SPECTROMETER
SURVEY
IN
ROBERTS, CREELMAN AND FRALECK
TOWNSHIPS
ONTARIO

February 10, 1977.



41115NW0010 0015 CREELMAN

010C

TABLE OF CONTENTS

	<u>Page</u>
I. Introduction	1
II. Equipment	2
III. Geology	3
Figure I.	4
Table I.	6
IV. Discussion of Results	9
Accompany this report -	
Sketch of Roberts-Creelman Area 1" = 1/2 mile	10
Sketch of Fraleck Area 1" = 1/2 mile	11
Geological References	12
Plan Maps at the scale of 1" = 1320 feet	
(a) Roberts - Creelman Area	
(b) Fraleck Area	

Report on
Airborne Gamma Ray Spectrometer Survey
in
Roberts, Creelman and Fraleck Townships
Ontario

I. INTRODUCTION

Between October 1 and November 1, 1976
Ingamar Exploration Limited conducted an airborne
gamma ray spectrometer survey of 2 separate claim groups
in the Roberts - Creelman - Fraleck Townships area,
Sudbury Mining Division, Ontario. The survey was carried
out by a Cessna 180 aircraft based at Connaught, equipped
with Exploranium Spectrometer GR-440 and GPX-24
sensor.

Flight line direction for both areas was due
north. Traverses were spaced at 1/8 mile intervals and
the mean terrain clearance of the aircraft during the
survey flights was 200 feet.

A total of 59.5 line miles of geophysical data was
acquired over the Roberts - Creelman area and 45.5 line
miles over the Fraleck area for a combined total of 105.0
line miles.

The following personnel were associated with the project.

Mr. Hibbard - Pilot-Navigator
F. Hussey - Field Technician
P. Brown - Project Geologist
Tom Gledhill - Geophysicist

The radio metric results are plotted on 2 plan maps at a scale of 1" = 1320 feet. Forest Inventory Base Maps were the base for these maps.

II. EQUIPMENT

(1) Hewlett Packard 7155B recorder was used employing 12 cm wide chart with fiducial marker and single channel recording pen. Holding the chart so the fiducial numbers increase from left to right, the trace reads total count of gamma radiation each cm representing 10 counts. The time constant of the trace is 2 sec. The zero mark is at the bottom or near side of the trace.

(2) The Gamma Ray Spectrometer is manufactured by Exploranium with an analogue output for total count, potassium, uranium and thorium. For this survey only the total count was used.

It is intended to cover the properties in more detail with the uranium readout. The detector was Exploranium CPX-21 (sodium iodide crystal of 21 cubic inches).

The total count anomalies are plotted on the maps, circled and lettered A, B, etc.

III. GEOLOGY

A list of geological references is attached.

Within an arcuate belt stretching from Sault Ste. Marie in the west almost to Noranda in the east, the Proterozoic Huronian metasediments occupy three main areas, (see Figure 1), geographically described as the Quirke, Espanola and Cobalt basins. The Huronian formations rest with great unconformity on Archean basement consisting of metavolcanics and iron formation, intruded by granitic and mafic rocks. The Huronian formations in turn are intruded by Nipissing and Keweenawan diabase dykes and sills. The bedrock geology is covered by a discontinuous veneer of Quaternary till and fluvial deposits, and swamp land.

The Huronian metasediments were deposited transgressively from south to north upon a rugged surface being subjected variously to earth movement. Complex sedimentology and difficult time-stratigraphy relationships make many correlations uncertain. Although unsupported simplification in literature still has to be accepted with reservation, area geologists, since 1969, have tried to use consistent division of the Huronian into three groups and

FIG. 1

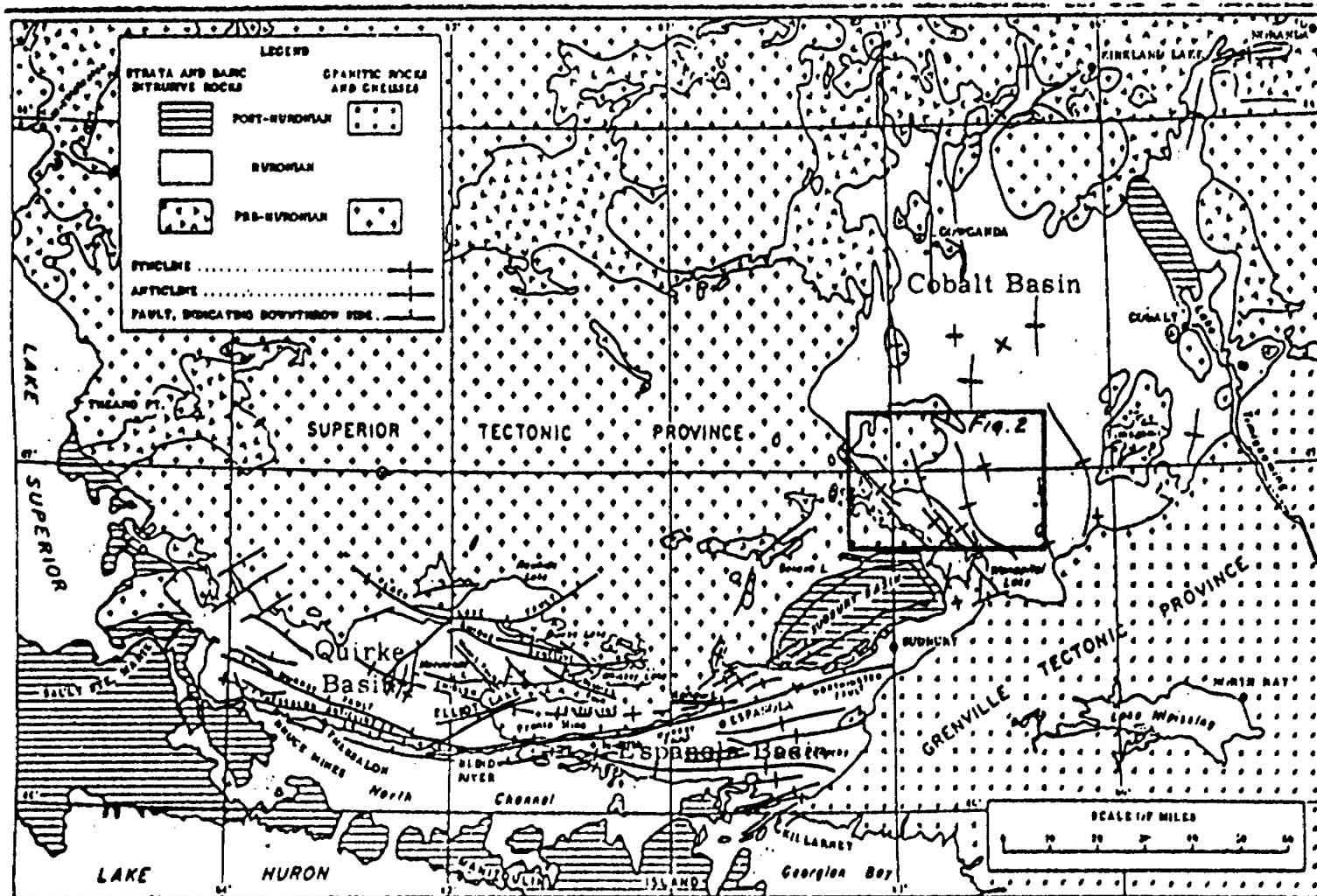

Figure 1. Distribution and structure of Huronian rocks.

SCALE

From Roscoe, 1909.

lithostratigraphic formations, (see Table 1). Economic significance of the subdivisions arises because progressively younger groups have wider aerial extent mainly northward, and each in turn lies directly on basement. As the sediments were derived from the north, detrital uranium deposition occurred where circumstances were favourable at or near the base of each group.

TABLE 1

PROTEROZOIC LITHOLOGIC UNITS OF THE HURONIAN BASIN

MAFIC INTRUSIONS

LATE DIABASE INTRUSIONS

Diabase, olivine diabase

Intrusive Contact

NIPISSING DIABASE

Gabbro, granophyre, metagabbro, amphibolite

Intrusive Contact

HURONIAN SUPERGROUP

COBLAT GROUP

BAR RIVER FORMATION

Sanstone

GORDON LAKE FORMATION

Sandstone, argillite, chert, chert breccia

LORRAINE FORMATION

Sanstone, conglomerate, greywacke, siltstone

GOWGANDA FORMATION

Conglomerate, greywacke, argillite, siltstone, sandstone

Unconformity

QUIRKE LAKE GROUP

SERPENT FORMATION

Sandstone, argillite, siltstone

ESPANOLA FORMATION

Limestone, siltstone

BRUCE FORMATION

Conglomerate, sandstone

HOUGH LAKE GROUP

MISSISSAGI FORMATION

Sandstone, conglomerate, argillite, siltstone

Unconformity

The clastic sequences found mainly near the base of each group are often variable and many sequences suggest that rock fragments and sediment were transported rapidly on steep slopes before being dumped, or partly sorted. The circumstances have been interpreted as being dominated by faults, causing disruption of sedimentary processes, reworking, and mixing of rock types into breccias. Archean structures such as iron formations played a role in locating erosion channels and sedimentary basins, and probably in preserving them. The effects of these early structures are recognizable despite subsequent folding, reactivated movement on the old faults, new faults, intrusion of diabase, and erosion. This deformation includes many minor folds and faults, but is dominated by major east trending folds and faults in the Quirke and Espanola Basins, and south to southeast trending folds and faults in the Cobalt Basin (see Figure 1).

The uranium deposits are believed to have formed at a time when the earth did not have an oxidizing atmosphere. (Oxidized iron and monazite concentrations instead of pyrite and uranium minerals indicate that an oxidizing atmosphere existed by the time the Lorraine Formation was deposited). Their formation also required a source area that could provide

enough uranium-rich heavy minerals. The economic concentrations developed where the depositional setting allowed sorting. A setting, described by Robertson and Douglas (1970), which suits the Elliot Lake ore, is a delta-like surface on which braided streams winnowed silt from the conglomerates leaving channel-like lenses and sheets piled upon each other to make up mining widths. Another favourable setting is envisaged especially near the northern limit of the Mississagi Formation where it is likely that the Mississagi once extended farther north, and was reworked. Channels cut into the basement are sites where sorting is likely to have continued longest, and heavy minerals been concentrated.

IV. DISCUSSION OF RESULTS

(a) Roberts - Creelman Area.

There are nine total count gamma ray anomalies A to I inclusive. Since some anomalies could be due to radioactive glacial till distributed down-ice, i.e. south or southwest and some due to high potassium granites, an examination on the ground is recommended prior to extensive work is recommended.

Anomalies A, B, C, D and E all warrant a ground examination. F, G and I maybe the result of the three Leslie showings and should be checked. Anomaly H may arise potassium-rich granites.

(b) Fraleck Area.

Anomalies A, B and C occur on the outcrop of the basal bed of Huronian sediments. The area is broken up by Nipissing diabase dykes and sills. If the anomalies result from uranium bearing basal beds, the anomalies could be smeared to the south and southwest by glacial action. Examination on the ground is recommend before further work is undertaken.

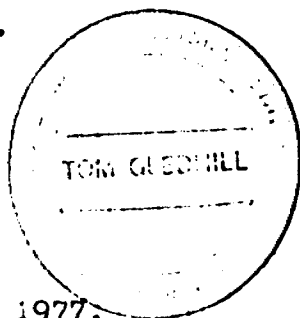

Respectfully submitted,

T. Gledhill

Tom Gledhill, B.A., P.Eng.

February 10, 1977.

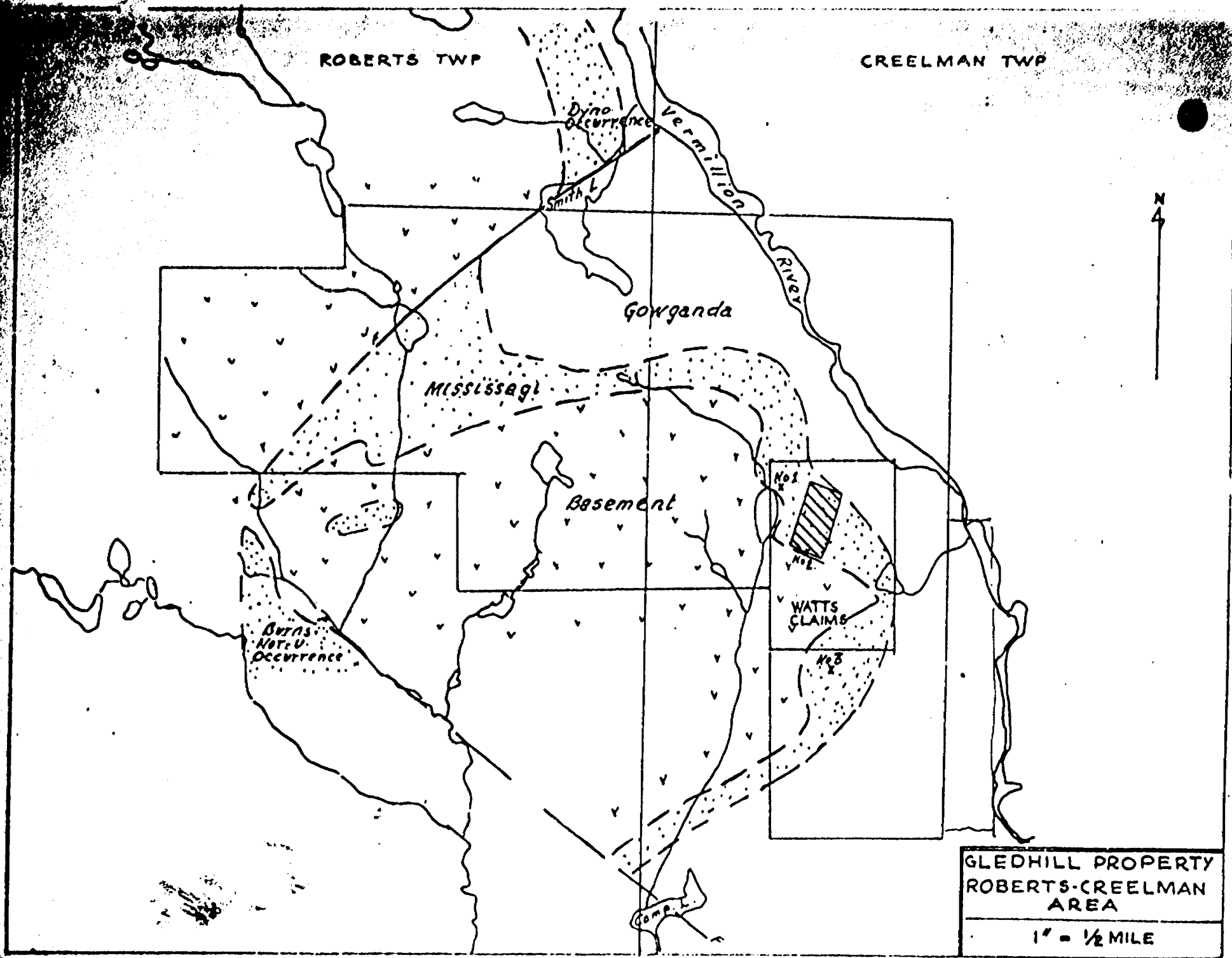

GLEDHILL PROPERTY
 ROBERTS-CREELMAN
 AREA
 1" = 1/2 MILE

1" = 1/2 mile FIG. 2.

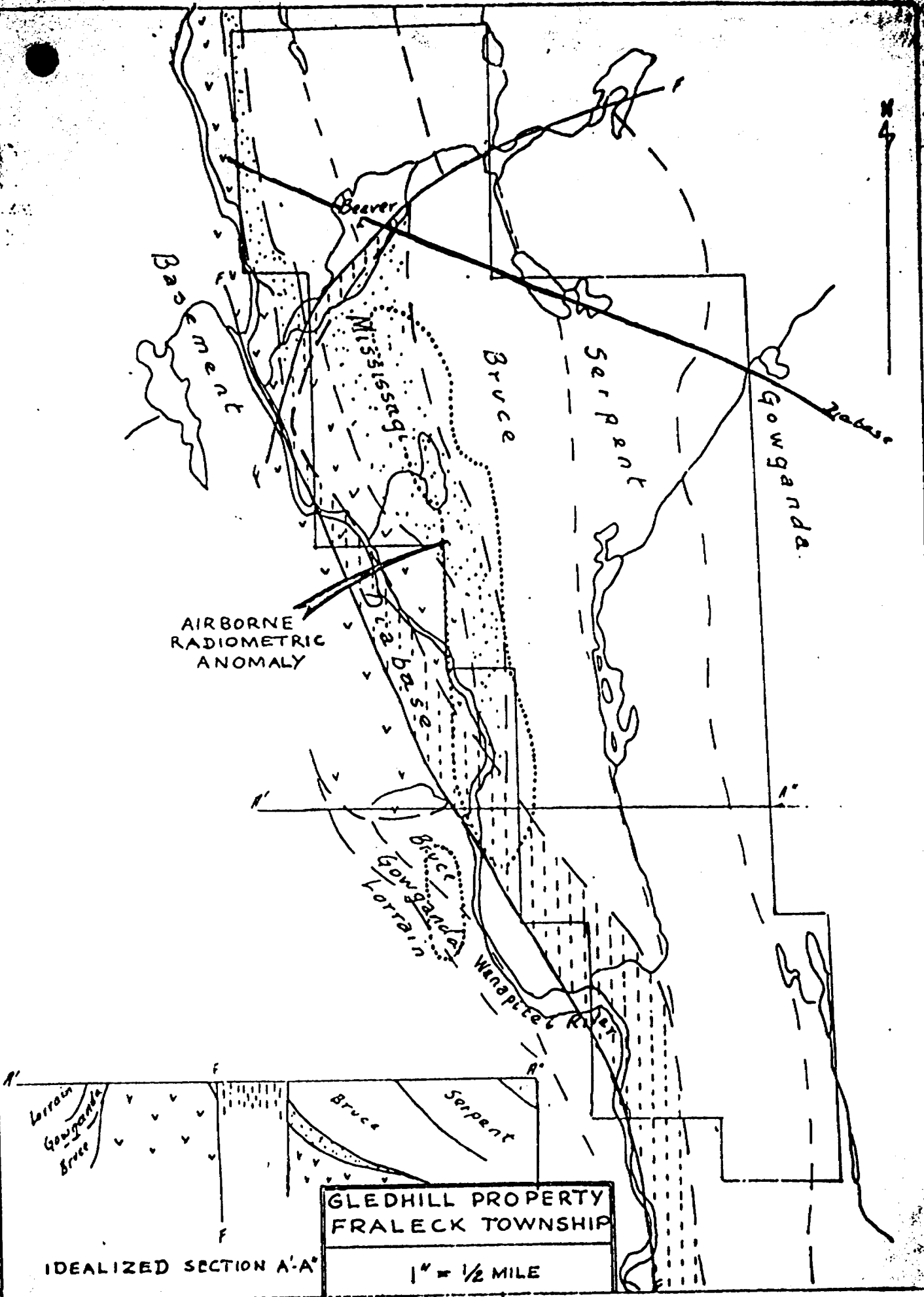

AIRBORNE RADIOMETRIC ANOMALY

GLEDHILL PROPERTY
FRALECK TOWNSHIP

IDEALIZED SECTION A-A

1" = 1/2 MILE

REFERENCES

- Darnley, A.G., R.L. Grasty and B.W. Charbonneau, 1971.
"A Radiometric profile across part of the Canadian
Shield". G.S.C. Paper 70-46.
- Little, H.W., 1974. "Uranium deposits in Canada and their
exploration, reserves and potential". Bul. C.I.M.,
Vol. 67, No.743.
- Robertson, D.S., and R.F. Douglas, 1970. "Sedimentary
uranium deposits". Bul. C.I.M., Vol. 63, No.697.
- Roscoe, S.M., 1969. "Huronian rocks and uraniferous con-
glomerates". G.S.C. Paper 68-40.

RECENT REPORTS ON THE AREA PUBLISHED BY
ONTARIO DEPARTMENT OF MINES:-

- "Geology of Hutton and Parkin Townships"
By H. D. Meyn. G.R. 80, 1970.
- "Geology of Roberts, Creelman and Fraleck Townships".
By H. D. Meyn. G.R. 9., 197..
- "Geology of Grigg and Stoble Townships".
By H. D. Meyn. G.R. 100, 1972.
- "Geology of the Maple Mountain Area".
By K. L. Card, W. H. McIllwaine and H. D. Meyn.
G.R. 106, 1973.

PRELIMINARY MAPS Scale 1" = 1/4 miles, are available
for all townships in the area except Howey.



41115NW0010 0015 CREELMAN

900 ICAL - GEOCHEMICAL STATEMENT

FILE 2.2307 RECEIVED

FEB 11 1977

PROJECTS UNIT

TO BE ATTACHED AS AN APPENDIX TO TECHNICAL REPORT
FACTS SHOWN HERE NEED NOT BE REPEATED IN REPORT
TECHNICAL REPORT MUST CONTAIN INTERPRETATION, CONCLUSIONS ETC.

Type of Survey: Airborne Spectrometry
Township or Area: Roberts, Creelman & Fossil
Claim holder(s):
Author of Report: Tom Glendon
Address: 21 Grandwood Place
Covering Dates of Survey: Oct 1 - Dec 1976
Total Miles of Line cut: 10.5

MINING CLAIMS TRAVERSED
List numerically

- S 429861-69
S 438845
S 438849-52
S 442765-85
S 442844-86
S 442986-3015
S 443038-52
S 443068-82
S 443220-31
S 443698-3703
S 450064

Table with columns: SPECIAL PROVISIONS CREDITS REQUESTED, DAYS per claim, and categories: Geophysical, Geological, Geochemical.

AIRBORNE CREDITS (Special provision credits do not apply to airborne surveys)
Magnetometer Electromagnetic Radiometric 20/d

DATE: Feb 14/77 SIGNATURE: T. Glendon

PROJECTS SECTION
Res. Geol. Qualifications 63.1085
Previous Surveys

Checked by: date:

GEOLOGICAL BRANCH

Approved by: date:

GEOLOGICAL BRANCH

Approved by: date:

TOTAL CLAIMS

OFFICE USE ONLY

SELF POTENTIAL

Instrument _____ Range _____

Survey Method _____

Corrections made _____

RADIOMETRIC

Instrument _____

Values measured _____

Energy windows (levels) _____

Height of instrument _____ Background Count _____

Size of detector _____

Overburden _____

(type, depth - include outcrop map)

OTHERS (SEISMIC, DRILL WELL LOGGING ETC.)

Type of survey _____

Instrument _____

Accuracy _____

Parameters measured _____

Additional information (for understanding results) _____

AIRBORNE SURVEYS

Type of survey(s) Gamma Ray - Spectrometer

Instrument(s) Exploranium 410
(specify for each type of survey)

Accuracy 10 cps/cm
(specify for each type of survey)

Aircraft used Cessna

Sensor altitude 200'

Navigation and flight path recovery method Forest Inventory Thru

Aircraft altitude 200' Line Spacing 1/8 mile

Miles flown over total area 105 Over claims only 102

ROBERTS TWP. M. 1078

FRALECK TWP. M. 816

CREEKMAN TWP. M. 737
SCALE: 1" = 40 CHAINS

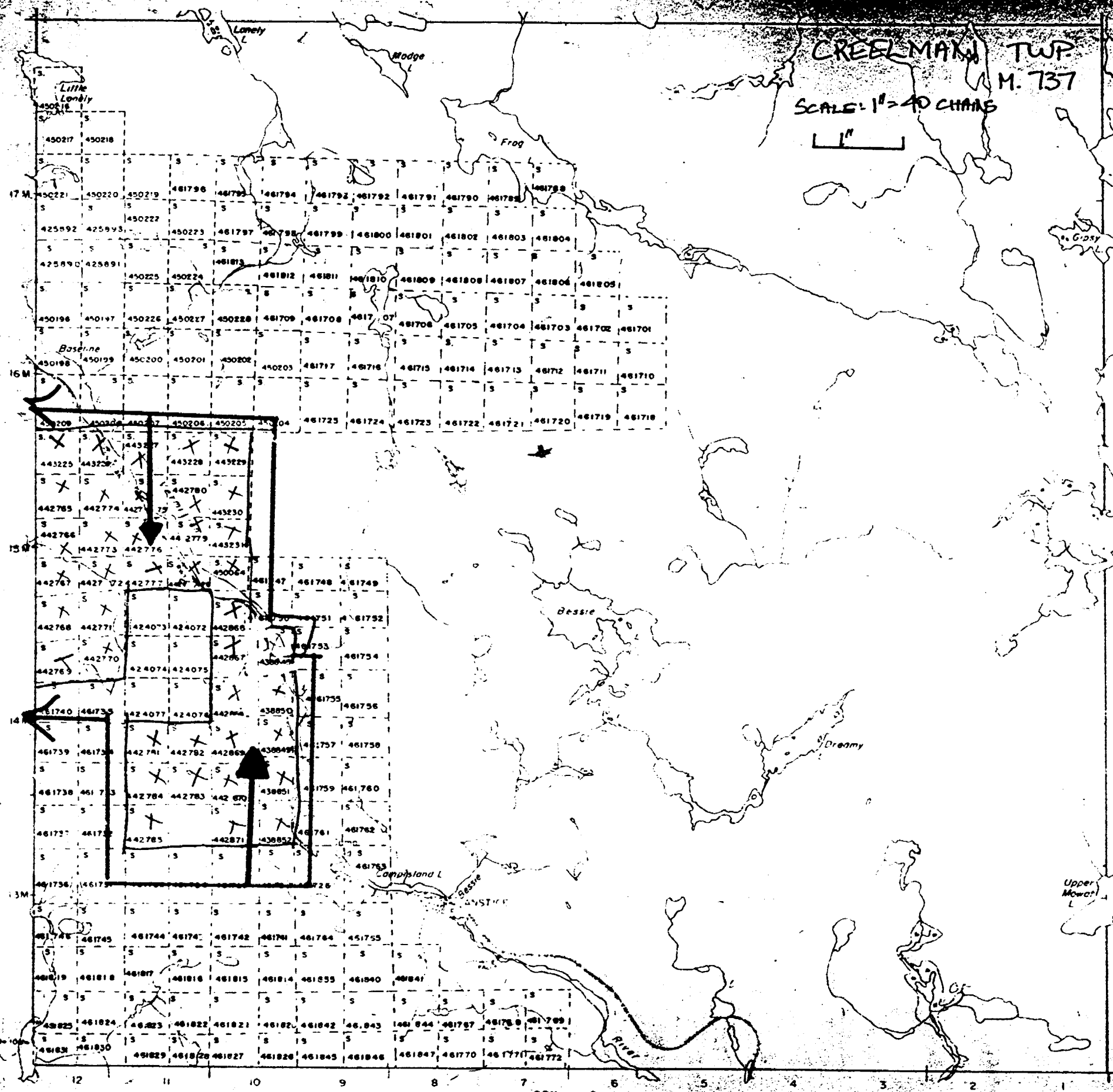

Botha Twp. M. 674

ROBERTS TWP.
M. 1078
Scale 1"=40 chains

Creelman Twp. M. 737

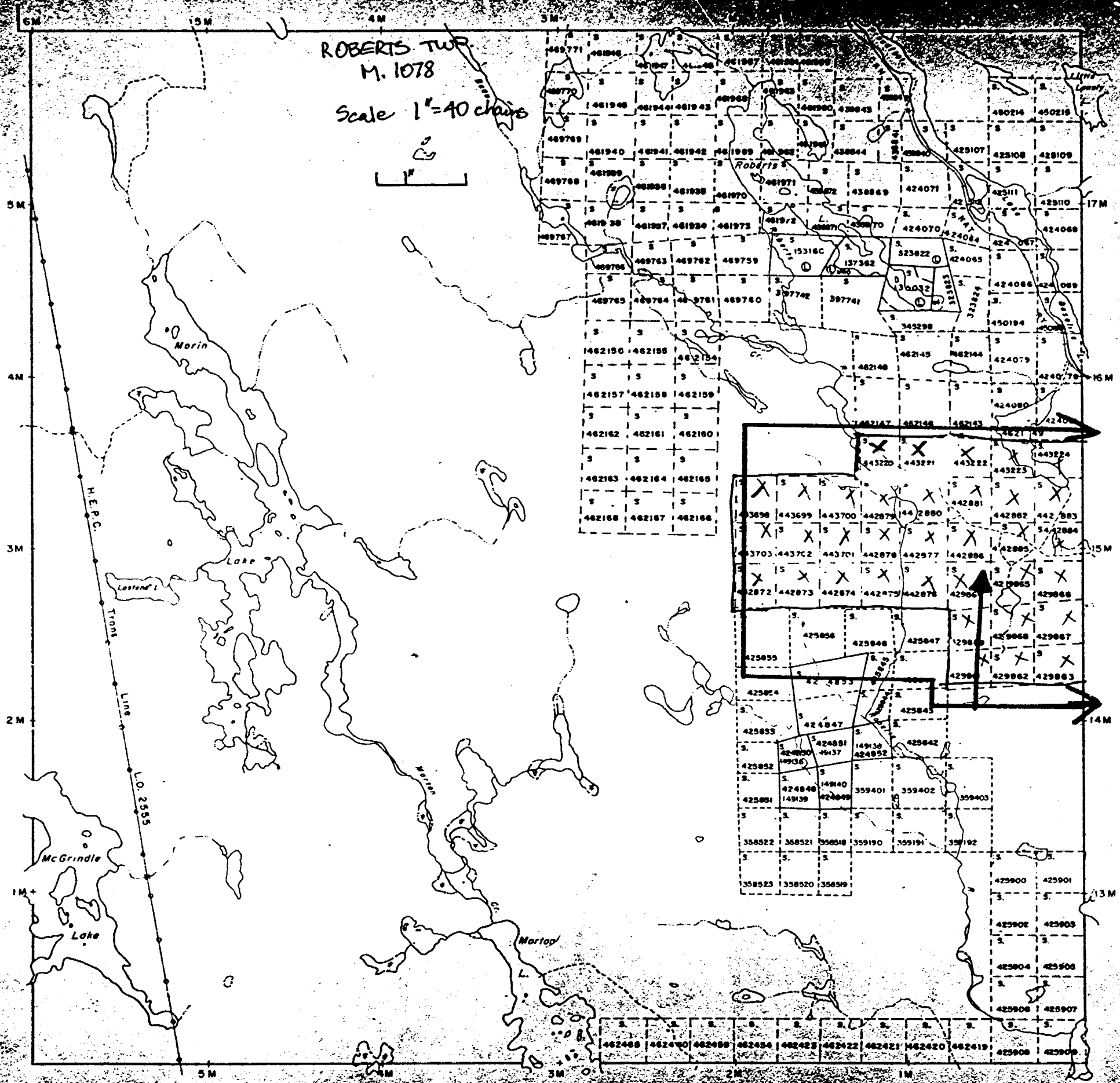

Grigg Twp. M. 89

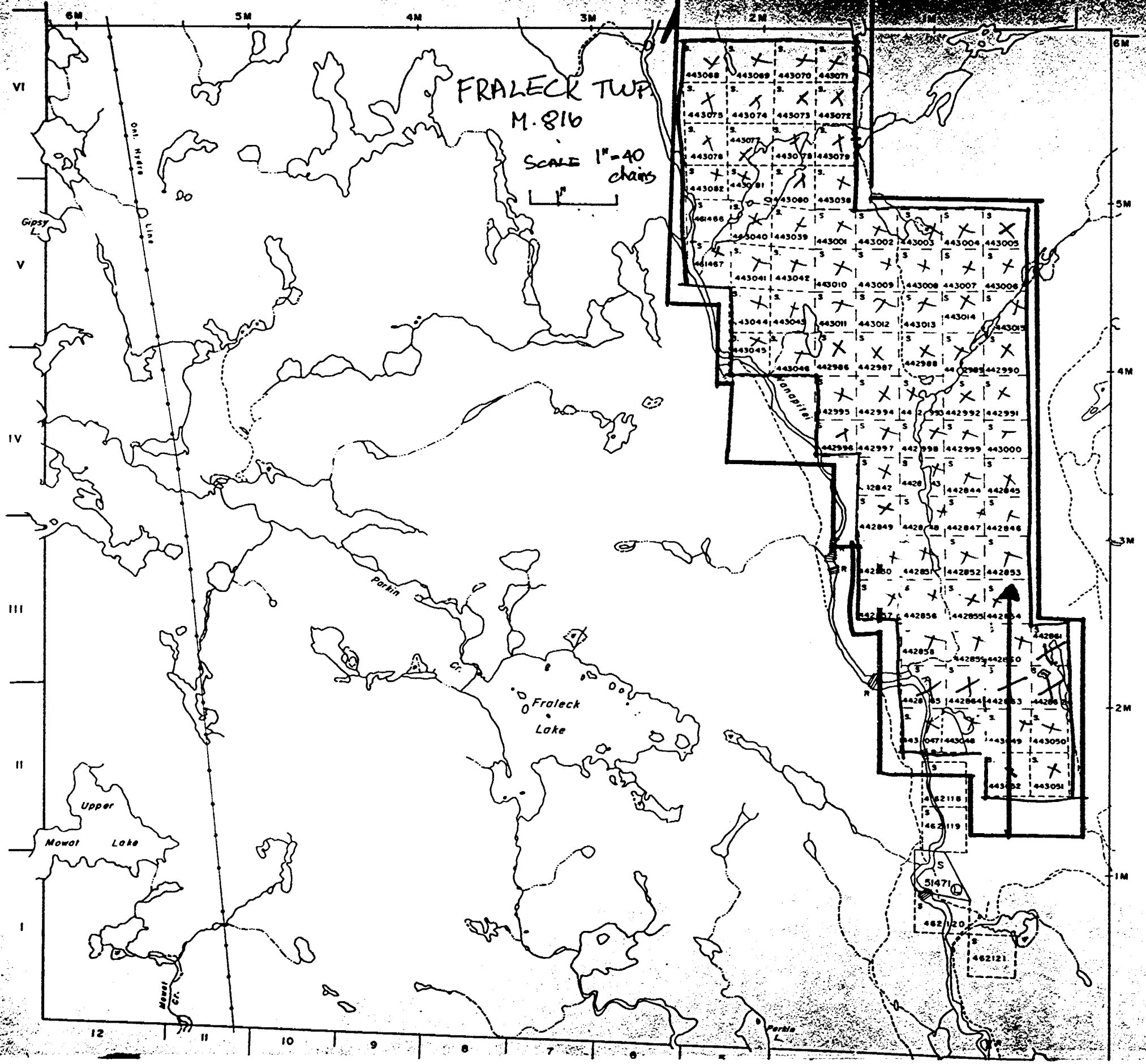

Telfer Twp. M. 1154



Ministry of
Natural
Resources

Ontario

1977 07 27

JUL 29 1977

Your file:

Our file: 2.2307

Mrs. R. M. Charnesky
Mining Recorder
Ministry of Natural Resources
174 Douglas Street West.
SUDBURY, Ontario
P3E 1G1

Re: Mining Claims S. 429861 et al.
Roberts, Creelman and Fraleck Townships
File 2.2307

The Airborne Geophysical (Radiometric) assessment work credits on the attached statement have been approved as of the above date.

Please inform the recorded holders of these mining claims and so indicate on your records.

Yours very truly

Orville J. McGinn

for J. R. McGinn
Director
Lands Administration Branch

Whitney Block, Room 1617
Queen's Park
Toronto, Ontario
M7A 1X1

DN:maf

cc: Mr. T. Gledhill
Don Mills, Ontario

cc: Deputy Regional Director
Sudbury, Ontario
Attention: Resident Geologist ✓

..... 2)

commodity sought: U

Page 2

cc: Mr. Marc Lefort
Connaught, Ontario

cc: Mr. Larry Salo
Connaught, Ontario

cc: Mr. Ernest Sicard
Val Gagne, Ontario

cc: Mr. Daniel Rochon
Timmins, Ontario

cc: Mr. Donald Miller
Connaught, Ontario

cc: Mr. Douglas Hopper
Vancouver, B. C.



Recorded Holder Mr. Marc Lefort, R. R. #1, Connaught, Ontario, et al.

Township or Area Roberts, Creelman and Fraleck Townships

Type of survey and number of Assessment days credit per claim	Mining Claims
Geophysical	S 429861 to 69 inclusive
Electromagnetic _____ days	S 438845
Magnetometer _____ days	S 438849 to 52 inclusive
Radiometric 25 _____ days	S 442765 to 85 inclusive
Induced polarization _____ days	S 442842 to 86 inclusive
Section 86 (18) _____ days	S 442986 to 443015 inclusive
Geological _____ days	S 443038 to 52 inclusive
Geochemical _____ days	S 443068 to 82 inclusive
	S 443220 to 31 inclusive
	S 443698 to 443703 inclusive
Man days <input type="checkbox"/> Airborne <input checked="" type="checkbox"/>	S 450064
Special provision <input type="checkbox"/> Ground <input type="checkbox"/>	

Notice of Intent to be issued:

Credits have been reduced because of partial coverage of claims.

Credits have been reduced because of corrections to work dates and figures of applicant.

No credits have been allowed for the following mining claims as they were not sufficiently covered by the survey:

The Mining Recorder may reduce the above credits if necessary in order that the total number of approved assessment days recorded on each claim does not exceed the maximum allowed as follows: Geophysical — 80; Geological — 40; Geochemical — 40;

76-113

(FILE 5. 429861)

RECEIVED

DEC 22 1976

ROBERTS TWP.
CREELMAN TWP.
FRALECK TWP. Ontario



THE MINING ACT REPORT OF WORK

A separate form is required for each type of work to be recorded.

To the Recorder of *Simcoe* Mining Division

I, *Daniel Rodon*
name of Recorded Holder
% Tom Gledhill 21 Sandalwood Pl Don Mills, Ont
Prospector's Licence *M18456*

do hereby report the performance of *180* days of *Geophysical* type of work

not before reported to be applied on the following contiguous claims

Claim No.	Days	Claim No.	Days	Claim No.	Days
<i>S. 429861</i>	<i>20</i>	<i>S. 429867</i>	<i>20</i>		
<i>429862</i>	<i>20</i>	<i>429868</i>	<i>20</i>		
<i>429863</i>	<i>20</i>	<i>429869</i>	<i>20</i>		
<i>429864</i>	<i>20</i>				
<i>429865</i>	<i>20</i>				
<i>429866</i>	<i>20</i>				

Geological Branch..O.D.M
ASSESSMENT FILES
RESEARCH OFFICE
DEC 15 1976
RECEIVED

All the work was performed on Mining Claim (s) *as above*
(In the case of geological and/or geophysical survey (s) where more than 18 claims are involved attach a schedule)

READ CAREFULLY: THE FOLLOWING INFORMATION IS REQUIRED BY THE MINING RECORDER.

- For Manual Work, Stripping or Opening up of Mines, Sinking Shafts or Other Actual Mining Operations - Names and addresses of the men who performed the work and the dates and hours of their employment.
- For Diamond and other Core Drilling - Footage, No. and angle of holes and diameter of core. Name and address of owner or operator of drill. Dates when drilling was done. Signed core log and sketch in duplicate.
- For Compressed Air or Other Power Driven or Mechanical Equipment
Type of drill or equipment. Names and addresses of men engaged in operating equipment and the dates and hours of their employment.
- For Power Stripping - Type of equipment. Name and address of owner or operator. Amount expended. Dates on which work was done. Proof of actual cost must be submitted within 30 days of recording.
- With each of the above types of work sketches are required to show the location and extent of the work in relation to the nearest claim post. In the case of diamond or other core drilling the sketch must be submitted in duplicate.
- For Geophysical, Geological, Geochemical Surveys and Expenditure Credits - the name of author of report. Covering dates of survey. Linecutting & office. Type of instrument used. Total amount of expenditure. Technical reports, maps, expenditure breakdown, receipts must be filed in duplicate with the Minister within 60 days of recording.
- For Land Survey - the name and address of Ontario Land surveyor.

The Required Information is as Follows: (Attach a list if this space is insufficient)

*Oct 1 - Nov. 30/76 - Ingammur Exploration Limited
Exploration Spectrometer
Phil Brown P. Eng.
% 21 Sandalwood Place
Don Mills, Ont.*

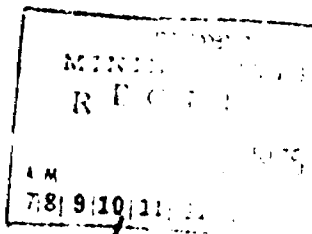

Date *Dec 5/1976* Signature of Recorded Holder or Agent *Tom Gledhill*

The Mining Act Certificate Verifying Report of Work
I, *Tom Gledhill*
21 Sandalwood Pl. Don Mills, Ont.
(Post Office Address)

hereby certify:
1. That I have a personal and intimate knowledge of the facts set forth in the report of work annexed here-to, having performed the work or witnessed same during and/or after its completion.
2. That the annexed report is true.
Dated *Dec 5/76* 19 *Tom Gledhill* Signature

THE PENALTY FOR MAKING A FALSE STATEMENT IN THIS REPORT AND/OR CERTIFICATE IS \$500. OR SIX MONTHS IMPRISONMENT OR BOTH



Ontario

THE MINING ACT REPORT OF WORK

A separate form is required for each type of work to be recorded.

To the Recorder of Sudbun Mining Division

1, Donc Harper name of Recorded Holder

21 Sandalwood Place Post Office Address

do hereby report the performance of 200 days of Geophysical type of work

not before reported to be applied on the following contiguous claims

Table with columns: Claim No., Days, Claim No., Days, Claim No., Days. Includes handwritten claim numbers 54.3885, 438849, 438850, 438851, 438852 and days 20, 20, 20, 20, 20.

Geological Branch ODM ASSESSMENT FILES RESEARCH OFFICE DEC 15 1976 RECEIVED

All the work was performed on Mining Claim (s) as above

READ CAREFULLY: THE FOLLOWING INFORMATION IS REQUIRED BY THE MINING RECORDER.

- For Manual Work, Stripping or Opening up of Mines, Sinking Shafts or Other Actual Mining Operations - Names and addresses of the men who performed the work and the dates and hours of their employment.
For Diamond and other Core Drilling - Footage, No. and angle of holes and diameter of core. Name and address of owner or operator of drill. Dates when drilling was done. Signed core log and sketch in duplicate.
For Compressed Air or Other Power Driven or Mechanical Equipment
Type of drill or equipment. Names and addresses of men engaged in operating equipment and the dates and hours of their employment.
For Power Stripping - Type of equipment. Name and address of owner or operator. Amount expended. Dates on which work was done. Proof of actual cost must be submitted within 30 days of recording.
With each of the above types of work sketches are required to show the location and extent of the work in relation to the nearest claim post. In the case of diamond or other core drilling the sketch must be submitted in duplicate.
For Geophysical, Geological, Geochemical Surveys and Expenditure Credits - the name of author of report. Covering dates of survey (linecutting & office). Type of instrument used. Total amount of expenditure. Technical reports, maps, expenditure breakdown, receipts must be filed in duplicate with the Minister within 60 days of recording.
For Land Survey - the name and address of Ontario Land surveyor.

The Required Information is as Follows: (Attach a list if this space is insufficient)

Oct. - Nov. 30/76 Jugawan Exploration Ltd.

MINING DIVISION RECEIVED 13 1976

Explorin Spectrometer Phil Brown P.Eng. 21 Sandalwood Place Don Mills, Ont

Date Dec 5/1976

Signature of Recorded Holder or Agent

The Mining Act Certificate Verifying Report of Work

1, Tom Slidhill 21 Sandalwood Place (Post Office Address)

hereby certify:

- 1. That I have a personal and intimate knowledge of the facts set forth in the report of work annexed hereto, having performed the work or witnessed same during and/or after its completion.
2. That the annexed report is true.

Dated Dec 5 19 76

Signature

THE PENALTY FOR MAKING A FALSE STATEMENT IN THIS REPORT AND/OR CERTIFICATE IS \$500. OR SIX MONTHS IMPRISONMENT OR BOTH

file 5.429861



Ontario

THE MINING ACT REPORT OF WORK

A separate form is required for each type of work to be recorded.

To the Recorder of Subbury Mining Division

I, Ernest Secord name of Recorded Holder
VAL. CALNE, INT. M. 1964.3
Prospector's Licence

1/2 Tom Sedhill, 21 Sandalwood Place, Don Mills, Ont
Post Office Address

do hereby report the performance of 560 days of Geophysical type of work

not before reported to be applied on the following contiguous claims

Claim No.	Days	Claim No.	Days	Claim No.	Days
<u>S. 442765</u>	<u>20</u>	<u>442771</u>	<u>20</u>	<u>442783</u>	<u>20</u>
<u>442766</u>	<u>20</u>	<u>442772</u>	<u>20</u>	<u>442784</u>	<u>20</u>
<u>442767</u>	<u>20</u>	<u>442773</u>	<u>20</u>	<u>442785</u>	<u>20</u>
<u>442768</u>	<u>20</u>	<u>442774</u>	<u>20</u>	<u>442786</u>	<u>20</u>
<u>442769</u>	<u>20</u>	<u>442775</u>	<u>20</u>	<u>442787</u>	<u>20</u>
<u>442770</u>	<u>20</u>	<u>442776</u>	<u>20</u>	<u>442788</u>	<u>20</u>
		<u>442777</u>	<u>20</u>	<u>442789</u>	<u>20</u>
		<u>442778</u>	<u>20</u>	<u>442790</u>	<u>20</u>
		<u>442779</u>	<u>20</u>	<u>442791</u>	<u>20</u>
		<u>442780</u>	<u>20</u>	<u>442792</u>	<u>20</u>
		<u>442781</u>	<u>20</u>	<u>442793</u>	<u>20</u>
		<u>442782</u>	<u>20</u>	<u>442794</u>	<u>20</u>

Geology Branch ODM
ASSESSMENT FILES
RESEARCH OFFICE
DEC 15 1976
RECEIVED

All the work was performed on Mining Claim (s) as above
(In the case of geological and/or geophysical survey (s) where more than 18 claims are involved attach a schedule)

READ CAREFULLY: THE FOLLOWING INFORMATION IS REQUIRED BY THE MINING RECORDER.

- For Manual Work, Stripping or Opening up of Mines, Sinking Shafts or Other Actual Mining Operations - Names and addresses of the men who performed the work and the dates and hours of their employment.
- For Diamond and other Core Drilling - Footage, No. and angle of holes and diameter of core. Name and address of owner or operator of drill. Dates when drilling was done. Signed core log and sketch in duplicate.
- For Compressed Air or Other Power Driven or Mechanical Equipment
Type of drill or equipment. Names and addresses of men engaged in operating equipment and the dates and hours of their employment.
- For Power Stripping - Type of equipment. Name and address of owner or operator. Amount expended. Dates on which work was done. Proof of actual cost must be submitted within 30 days of recording.
- With each of the above types of work sketches are required to show the location and extent of the work in relation to the nearest claim post. In the case of diamond or other core drilling the sketch must be submitted in duplicate.
- For Geophysical, Geological, Geochemical Surveys and Expenditure Credits - the name of author of report. Covering dates of survey (linecutting & office). Type of instrument used. Total amount of expenditure. Technical reports, maps, expenditure breakdown, receipts must be filed in duplicate with the Minister within 60 days of recording.
- For Land Survey - the name and address of Ontario Land surveyor.

The Required Information is as Follows: (Attach a list if this space is insufficient)
Oct 1 - Nov. 30/76 Juganar Exploration Ltd
Exploration Spectrometer
Phil Brown P. Eng.
c/o 21 Sandalwood Place
Don Mills, Ontario

MINING DIVISION
RECORDS
DEC 15 1976
7,8 | 9 | 10 | 11 | 12 | 13 | 14 | 15 | 16

Date Dec 8 1976 Signature of Recorded Holder or Agent T. Sedhill

The Mining Act Certificate Verifying Report of Work
I, Tom Sedhill
21 Sandalwood Place, Don Mills, Ont
(Post Office Address)

hereby certify:
1. That I have a personal and intimate knowledge of the facts set forth in the report of work annexed hereto, having performed the work or witnessed same during and/or after its completion.
2. That the annexed report is true.
Dated Dec 5 19 76 Signature T. Sedhill

THE PENALTY FOR MAKING A FALSE STATEMENT IN THIS REPORT AND/OR CERTIFICATE IS \$500. OR SIX MONTHS IMPRISONMENT OR BOTH

10-113 1007

file 5.429861



Ontario

THE MINING ACT REPORT OF WORK

A separate form is required for each type of work to be recorded.

To the Recorder of Seidburg Mining Division
I, Larry Sale R.A.N.I.
name of Recorded Holder PROSPECTOR M 20010
Prospector's Licence
c/o 21 Sandalwood Place Don Mills, Ont.
Post Office Address
do hereby report the performance of 300 days of Geophysical type of work

not before reported to be applied on the following contiguous claims

Claim No.	Days	Claim No.	Days	Claim No.	Days
5442842	20	5442848	20	5442854	20
442843	20	442849	20	442855	20
442844	20	442850	20	442856	20
442845	20	442851	20		
442846	20	442852	20		
442847	20	442853	20		

Geological Branch ODM
ASSESSMENT FILED
RESEARCH OFFICE
DEC 15 1976
RECEIVED

All the work was performed on Mining Claim (s) as above
(In the case of geological and/or geophysical survey (s) where more than 18 claims are involved attach a schedule)

READ CAREFULLY: THE FOLLOWING INFORMATION IS REQUIRED BY THE MINING RECORDER.

- For Manual Work, Stripping or Opening up of Mines, Sinking Shafts or Other Actual Mining Operations - Names and addresses of the men who performed the work and the dates and hours of their employment.
- For Diamond and other Core Drilling - Footage, No. and angle of holes and diameter of core. Name and address of owner or operator of drill. Dates when drilling was done. Signed core log and sketch in duplicate.
- For Compressed Air or Other Power Driven or Mechanical Equipment
Type of drill or equipment. Names and addresses of men engaged in operating equipment and the dates and hours of their employment.
- For Power Stripping - Type of equipment. Name and address of owner or operator. Amount expended. Dates on which work was done. Proof of actual cost must be submitted within 30 days of recording.
- With each of the above types of work sketches are required to show the location and extent of the work in relation to the nearest claim post. In the case of diamond or other core drilling the sketch must be submitted in duplicate.
- For Geophysical, Geological, Geochemical Surveys and Expenditure Credits - the name of author of report. Covering dates of survey (linecutting & office). Type of instrument used. Total amount of expenditure. Technical reports, maps, expenditure breakdown, receipts must be filed in duplicate with the Minister within 60 days of recording.
- For Land Survey - the name and address of Ontario Land surveyor.

The Required Information is as Follows: (Attach a list if this space is insufficient)

Oct 1 - Nov 30/76

MINING DIVISION
RECEIVED
DEC 15 1976
A.M. 7:10 P.M. 4:56

Ingram Exploration Ltd.
Explorator Spectrometer
Phil Brown P. Eng.
c/o 21 Sandalwood Place
Don Mills, Ont.

Date Dec 5/76 Signature of Recorded Holder or Agent Tom Seidhill

The Mining Act
Certificate Verifying Report of Work

I, Tom Seidhill
21 Sandalwood Place, Don Mills, Ont.
(Post Office Address)

hereby certify:
1. That I have a personal and intimate knowledge of the facts set forth in the report of work annexed hereto, having performed the work or witnessed same during and/or after its completion.
2. That the annexed report is true.

Dated Dec 5 1976 Signature Tom Seidhill

THE PENALTY FOR MAKING A FALSE STATEMENT IN THIS REPORT AND/OR CERTIFICATE IS \$500. OR SIX MONTHS IMPRISONMENT OR BOTH

file 5.429861



Ontario

THE MINING ACT REPORT OF WORK

A separate form is required for each type of work to be recorded.

To the Recorder of Sudbury Mining Division

I, Ernest Seaman R.R. #1
name of Recorded Holder 514 GARDNER, M.T. M. 19643
Prospector's Licence

90 Tom Sedhill, 21 Sandalwood Pl, Don Mills
Post Office Address

do hereby report the performance of 180 days of Geophysical
type of work

not before reported to be applied on the following contiguous claims

Claim No.	Days	Claim No.	Days
<u>5442857</u>	<u>20</u>	<u>5442863</u>	<u>20</u>
<u>442858</u>	<u>20</u>	<u>442864</u>	<u>20</u>
<u>442859</u>	<u>20</u>	<u>442865</u>	<u>20</u>
<u>442860</u>	<u>20</u>		
<u>442861</u>	<u>20</u>		
<u>442862</u>	<u>20</u>		

Geological Branch ODM
ASSESSMENT FILES
RESEARCH OFFICE
DEC 15 1976
RECEIVED

All the work was performed on Mining Claim (s) As above
(In the case of geological and/or geophysical survey (s) where more than 18 claims are involved attach a schedule)

READ CAREFULLY: THE FOLLOWING INFORMATION IS REQUIRED BY THE MINING RECORDER.

- For Manual Work, Stripping or Opening up of Mines, Sinking Shafts or Other Actual Mining Operations - Names and addresses of the men who performed the work and the dates and hours of their employment.
- For Diamond and other Core Drilling - Footage, No. and angle of holes in core. Name and address of owner or operator of drill. Dates when drilling was done. Signed core log and sketch in duplicate.
- For Compressed Air or Other Power Driven or Mechanical Equipment
Type of drill or equipment. Names and addresses of men engaged in operating equipment and the dates and hours of their employment.
- For Power Stripping - Type of equipment. Name and address of owner or operator. Amount expended. Dates on which work was done. Proof of actual cost must be submitted within 30 days of recording.
- With each of the above types of work sketches are required to show the location and extent of the work in relation to the nearest claim post. In the case of diamond or other core drilling the sketch must be submitted in duplicate.
- For Geophysical, Geological, Geochemical Surveys and Expenditure Credits - the name of author of report. Covering dates of survey (linecutting & office). Type of instrument used. Total amount of expenditure. Technical reports, maps, expenditure breakdown, receipts must be filed in duplicate with the Minister within 60 days of recording.
- For Land Survey - the name and address of Ontario Land surveyor.

The Required Information is as Follows: (Attach a list if this space is insufficient)

Ont 1 - Nov 30/76 Juguan Corporation Ltd.
Exploratory Geotechnical
Phil Brown P. Eng.
do 21 Sandalwood Place
DON MILLS, ONT
Tom Sedhill
Signature of Recorded Holder or Agent

RECEIVED
DEC 5 1976
AM 9:01

The Mining Act
Certificate Verifying Report of Work

I, Tom Sedhill
21 Sandalwood Place, Don Mills, Ont
(Post Office Address)

hereby certify:

- That I have a personal and intimate knowledge of the facts set forth in the report of work annexed hereto, having performed the work or witnessed same during and/or after its completion.
- That the annexed report is true.

Dated Dec 5 1976 Tom Sedhill
Signature

THE PENALTY FOR MAKING A FALSE STATEMENT IN THIS REPORT AND/OR CERTIFICATE IS \$500. OR SIX MONTHS IMPRISONMENT OR BOTH

file 5.429861



Ontario

THE MINING ACT REPORT OF WORK

A separate form is required for each type of work to be recorded.

To the Recorder of Sudbury Mining Division
I, Marc Lafont name of Recorded Holder
21 Sandalwood Place Don Mills, Ont
do hereby report the performance of 30 days of Sandalwood type of work

not before reported to be applied on the following contiguous claims

Table with 6 columns: Claim No., Days, Claim No., Days, Claim No., Days. Lists claim numbers 5442986 through 442996 and their respective durations of 20 days.

Geological Branch ODM ASSESSMENT FILES RESEARCH OFFICE

DEC 15 1976

All the work was performed on Mining Claim (s) as above (In the case of geological and/or geophysical survey (s) where more than 18 claims are involved attach schedule)

READ CAREFULLY: THE FOLLOWING INFORMATION IS REQUIRED BY THE MINING RECORDER.

- For Manual Work, Stripping or Opening up of Mines, Sinking Shafts or Other Actual Mining Operations - Names and addresses of the men who performed the work and the dates and hours of their employment.
For Diamond and other Core Drilling - Footage, No. and angle of holes and diameter of core. Name and address of owner or operator of drill. Dates when drilling was done. Signed core log and sketch in duplicate.
For Compressed Air or Other Power Driven or Mechanical Equipment
Type of drill or equipment. Names and addresses of men engaged in operating equipment and the dates and hours of their employment.
For Power Stripping - Type of equipment. Name and address of owner or operator. Amount expended. Dates on which work was done. Proof of actual cost must be submitted within 30 days of recording.
With each of the above types of work sketches are required to show the location and extent of the work in relation to the nearest claim post. In the case of diamond or other core drilling the sketch must be submitted in duplicate.
For Geophysical, Geological, Geochemical Surveys and Expenditure Credits - the name of author of report. Covering dates of survey (linecutting & office). Type of instrument used. Total amount of expenditure. Technical reports, maps, expenditure breakdown, receipts must be filed in duplicate with the Minister within 60 days of recording.
For Land Survey - the name and address of Ontario Land surveyor.

The Required Information is as Follows: (Attach a list if this space is insufficient)

Oct - Nov 30/76 Jugumar Exploration Ltd
Exploratory Spectrometry
Phil Brown P. Eng.

MINING DIVISION RECEIVED
DEC 13 1975
A.M. 11:11 12:13 2:13 4:16 P.M.

Date Dec 5 1976

Signature of Recorded Holder or Agent

The Mining Act Certificate Verifying Report of Work

I, Tom Seidwell
21 Sandalwood Place, Don Mills, Ont
(Post Office Address)

hereby certify:

- 1. That I have a personal and intimate knowledge of the facts set forth in the report of work annexed hereto, having performed the work or witnessed same during and/or after its completion.
2. That the annexed report is true.

Dated Dec 5 1976

Signature

THE PENALTY FOR MAKING A FALSE STATEMENT IN THIS REPORT AND/OR CERTIFICATE IS \$500. OR SIX MONTHS IMPRISONMENT OR BOTH

file 5.429861



Ontario

THE MINING ACT REPORT OF WORK

A separate form is required for each type of work to be recorded.

To the Recorder of Sudbury Mining Division

I, Harry Solo name of Recorded Holder M 20010 Prospector's Licence

21 Sandalwood Place, Don Mills, Ont Post Office Address

do hereby report the performance of 300 days of Geophysical type of work

not before reported to be applied on the following contiguous claims

Claim No.	Days	Claim No.	Days	Claim No.	Days
5443001	20	5443007	20	5443013	20
443002	20	443008	20	443014	20
443003	20	443009	20	443015	20
443004	20	443010	20		
443005	20	443011	20		
443006	20	443012	20		

Geological Branch ODM
ASSESSMENT FILES
RESEARCH OFFICE
DEC 15 1976
RECEIVED

All the work was performed on Mining Claim (s) as above
(In the case of geological and/or geophysical survey (s) where more than 18 claims are involved attach a schedule)

READ CAREFULLY: THE FOLLOWING INFORMATION IS REQUIRED BY THE MINING RECORDER.

For Manual Work, Stripping or Opening up of Mines, Sinking Shafts or Other Actual Mining Operations - Names and addresses of the men who performed the work and the dates and hours of their employment.

For Diamond and other Core Drilling - Footage, No. and angle of holes and diameter of core. Name and address of owner or operator of drill. Dates when drilling was done. Signed core log and sketch in duplicate.

For Compressed Air or Other Power Driven or Mechanical Equipment
Type of drill or equipment. Names and addresses of men engaged in operating equipment and the dates and hours of their employment.

For Power Stripping - Type of equipment. Name and address of owner or operator. Amount expended. Dates on which work was done. Proof of actual cost must be submitted within 30 days of recording.

With each of the above types of work sketches are required to show the location and extent of the work in relation to the nearest claim post. In the case of diamond or other core drilling the sketch must be submitted in duplicate.

For Geophysical, Geological, Geochemical Surveys and Expenditure Credits - the name of author of report. Covering dates of survey (linecutting & office). Type of instrument used. Total amount of expenditure. Technical reports, maps, expenditure breakdown, receipts must be filed in duplicate with the Minister within 60 days of recording.

For Land Survey - the name and address of Ontario Land surveyor.

The Required Information is as Follows: (Attach a list if this space is insufficient)

Date - Nov. 30/76

Juganar Exploration Ltd.
Exploration Geoscientist
Phil Brown P. Eng.
c/o 21 Sandalwood Place
Don Mills, Ont.
Tom Sedhill

RECEIVED
DEC 5 1976

Date Dec 5, 1976

Signature of Recorded Holder or Agent

The Mining Act
Certificate Verifying Report of Work

I, Tom Sedhill
21 Sandalwood Place Don Mills, Ont
(Post Office Address)

hereby certify:

1. That I have a personal and intimate knowledge of the facts set forth in the report of work annexed hereto, having performed the work or witnessed some during and/or after its completion.
2. That the annexed report is true.

Dated Dec 5/76 19

Tom Sedhill
Signature

THE PENALTY FOR MAKING A FALSE STATEMENT IN THIS REPORT AND/OR CERTIFICATE IS \$500. OR SIX MONTHS IMPRISONMENT OR BOTH

file 5.429861



Ontario

THE MINING ACT REPORT OF WORK

A separate form is required for each type of work to be recorded.

To the Recorder of Sudbury Mining Division
I, Harry Sulo name of Recorded Holder RR #1 ST. MARYS, ONT. M 20010 Prospector's Licence
do hereby report the performance of 300 days of Geophysical type of work

not before reported to be applied on the following contiguous claims

Table with 6 columns: Claim No., Days, Claim No., Days, Claim No., Days. Lists claims 5443038, 443039, 443040, 443041, 443042, 443043, 5443044, 443045, 443046, 443047, 443048, 443049, 5443050, 443051, 443052 with 20 days each.

Geological Branch, O.D.M. ASSESSMENT FILES RESEARCH OFFICE DEC 15 1976 RECEIVED

All the work was performed on Mining Claim (s) as above (In the case of geological and/or geophysical survey (s) where more than 18 claims are involved attach schedule)

READ CAREFULLY: THE FOLLOWING INFORMATION IS REQUIRED BY THE MINING RECORDER.

- For Manual Work, Stripping or Opening up of Mines, Sinking Shafts or Other Actual Mining Operations - Names and addresses of the men who performed the work and the dates and hours of their employment.
For Diamond and other Core Drilling - Footage, No. and angle of holes and diameter of core. Name and address of owner or operator of drill. Dates when drilling was done. Signed core log and sketch in duplicate.
For Compressed Air or Other Power Driven or Mechanical Equipment
Type of drill or equipment. Names and addresses of men engaged in operating equipment and the dates and hours of their employment.
For Power Stripping - Type of equipment. Name and address of owner or operator. Amount expended. Dates on which work was done. Proof of actual cost must be submitted within 30 days of recording.
With each of the above types of work sketches are required to show the location and extent of the work in relation to the nearest claim post. In the case of diamond or other core drilling the sketch must be submitted in duplicate.
For Geophysical, Geological, Geochemical Surveys and Expenditure Credits - the name of author of report. Covering dates of survey (linecutting & office). Type of instrument used. Total amount of expenditure. Technical reports, maps, expenditure breakdown, receipts must be filed in duplicate with the Minister within 60 days of recording.
For Land Survey - the name and address of Ontario Land surveyor.

The Required Information is as Follows: (Attach a list if this space is insufficient)

Oct 1 - Nov 30/76 Jagannath Exploration Ltd.
Cyanide Spectrometer
Pril Brown P. Eng
960 21 Sandalwood Pl.
DON MILLS, Ont.

MINING DIVISION RECEIVED NOV 13 1976 A.M. 7:10 P.M. 4:56

Date Dec 5 1976

Signature of Recorded Holder or Agent

The Mining Act Certificate Verifying Report of Work

I, Tom Sedwell 21 Sandalwood Place, Don Mills, Ont (Post Office Address)

hereby certify:

- 1. That I have a personal and intimate knowledge of the facts set forth in the report of work annexed hereto, having performed the work or witnessed same during and/or after its completion.
2. That the annexed report is true.

Dated Dec 5 1976

Signature

THE PENALTY FOR MAKING A FALSE STATEMENT IN THIS REPORT AND/OR CERTIFICATE IS \$500. OR SIX MONTHS IMPRISONMENT OR BOTH



Ontario

THE MINING ACT REPORT OF WORK

A separate form is required for each type of work to be recorded.

To the Recorder of Sudbury Mining Division

I, Marc LeFort name of Recorded Holder R.R.#1 GENVAUGH T. CNT. M 20089 Prospector's Licence

c/o 21 Sandalwood Place Don Mills, Ont Post Office Address

do hereby report the performance of 300 days of Geophysical type of work

not before reported to be applied on the following contiguous claims

Claim No.	Days	Claim No.	Days	Claim No.	Days
5443068	20	5443073	20	5443079	20
443069	20	443074	20	443080	20
443070	20	443075	20	443081	20
443071	20	443076	20	443082	20
443072	20	443077	20		
443073	20	443078	20		

DEC 15 1976
RECEIVED
Geological Branch
ASSESSMENT FILES
RESEARCH OFFICE

All the work was performed on Mining Claim (s) as above
(In the case of geological and/or geophysical survey (s) where more than 18 claims are involved attach a schedule)

READ CAREFULLY: THE FOLLOWING INFORMATION IS REQUIRED BY THE MINING RECORDER.

- For Manual Work, Stripping or Opening up of Mines, Sinking Shafts or Other Actual Mining Operations - Names and addresses of the men who performed the work and the dates and hours of their employment.
- For Diamond and other Core Drilling - Footage, No. and angle of holes and diameter of core. Name and address of owner or operator of drill. Dates when drilling was done. Signed core log and sketch in duplicate.
- For Compressed Air or Other Power Driven or Mechanical Equipment - Type of drill or equipment. Names and addresses of men engaged in operating equipment and the dates and hours of their employment.
- For Power Stripping - Type of equipment. Name and address of owner or operator. Amount expended. Dates on which work was done. Proof of actual cost must be submitted within 30 days of recording.
- With each of the above types of work sketches are required to show the location and extent of the work in relation to the nearest claim post. In the case of diamond or other core drilling the sketch must be submitted in duplicate.
- For Geophysical, Geological, Geochemical Surveys and Expenditure Credits - the name of author of report. Covering dates of survey (linecutting & office). Type of instrument used. Total amount of expenditure. Technical reports, maps, expenditure breakdown, receipts must be filed in duplicate with the Minister within 60 days of recording.
- For Land Survey - the name and address of Ontario Land surveyor.

The Required Information is as Follows: (Attach a list if this space is insufficient)

Oct 1 - Nov 30/76

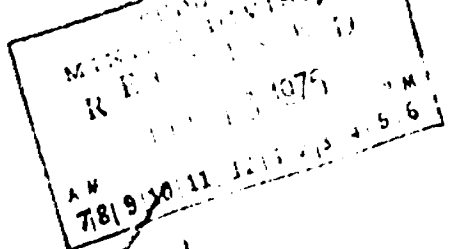

Dugamer Exploration Ltd
Exploranium Spectrometer
Phil Brown P. Eng.
c/o 21 Sandalwood Place
Don Mills, Ont
Tom Seidman
Signature of Recorded Holder or Agent

Date Dec 5 1976

The Mining Act Certificate Verifying Report of Work

I, Tom Seidman
21 Sandalwood Place, Don Mills, Ont
(Post Office Address)

hereby certify:

- That I have a personal and intimate knowledge of the facts set forth in the report of work annexed hereto, having performed the work or witnessed same during and/or after its completion.
- That the annexed report is true.

Dated Dec 5 1976 Tom Seidman Signature

THE PENALTY FOR MAKING A FALSE STATEMENT IN THIS REPORT AND/OR CERTIFICATE IS \$500. OR SIX MONTHS IMPRISONMENT OR BOTH



Ontario

THE MINING ACT REPORT OF WORK

file 5.429861

A separate form is required for each type of work to be recorded.

To the Recorder of Sudbury Mining Division

I, Donald Miller name of Recorded Holder

1/4 Tom Sedhill, 21 Sandalwood Place, Don Mills, Ont Post Office Address

do hereby report the performance of OGC days of Geophysical type of work

not before reported to be applied on the following contiguous claims

Claim No.	Days	Claim No.	Days	Claim No.	Days
507225	20	5443703	20	442883	20
442226	20	442872	20	442884	20
442227	20	442873	20	442885	20
442228	20	442874	20	442886	20
442229	20	442875	20	443220	20
442230	20	442876	20	443221	20
442231	20	442877	20	443222	20
442232	20	442878	20		
442233	20	442879	20	443223	20
442234	20	442880	20		
442235	20	442881	20		
442236	20	442882	20		

Geological Branch ODM
SEGMENT 4 FILES
RESEARCH OFFICE

All the work was performed on Mining Claim (s) C10 67 Avenue DEC
(In the case of geological and/or geophysical survey (s) where more than 18 claims are involved attach a schedule)

READ CAREFULLY: THE FOLLOWING INFORMATION IS REQUIRED BY THE MINING RECORDER.

- For Manual Work, Stripping or Opening up of Mines, Sinking Shafts or Other Actual Mining Operations - Names and addresses of the men who performed the work and the dates and hours of their employment.
- For Diamond and other Core Drilling - Footage, No. and angle of holes and diameter of core. Name and address of owner or operator of drill. Dates when drilling was done. Signed core log and sketch in duplicate.
- For Compressed Air or Other Power Driven or Mechanical Equipment
Type of drill or equipment. Names and addresses of men engaged in operating equipment and the dates and hours of their employment.
- For Power Stripping - Type of equipment. Name and address of owner or operator. Amount expended. Dates on which work was done. Proof of actual cost must be submitted within 30 days of recording.
- With each of the above types of work sketches are required to show the location and extent of the work in relation to the nearest claim post. In the case of diamond or other core drilling the sketch must be submitted in duplicate.
- For Geophysical, Geological, Geochemical Surveys and Expenditure Credits the name of author of report. Covering dates of survey (linecutting & office). Type of instrument used. Total amount of expenditure. Technical reports, maps, expenditure breakdown, receipts must be filed in duplicate with the Minister within 60 days of recording.
- For Land Survey - the name and address of Ontario Land surveyor.

The Required Information is as Follows: (Attach a list if this space is insufficient)

Oct 1 - Nov 30/76

Ingramm Exploration Ltd.
Explorations Spectrometer
Phil Brown P. Eng.
c/o 21 Sandalwood Place
Don Mills, Ont.

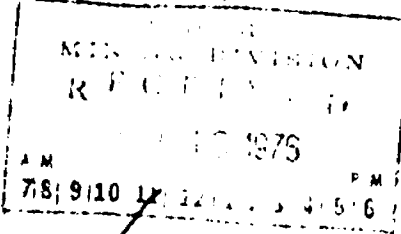

Date Dec 5/76 Signature of Recorded Holder or Agent Tom Sedhill

The Mining Act Certificate Verifying Report of Work
I, Tom Sedhill
21 Sandalwood Place, Don Mills, Ont
(Post Office Address)

hereby certify:
1. That I have a personal and intimate knowledge of the facts set forth in the report of work annexed here-to, having performed the work or witnessed same during and/or after its completion.
2. That the annexed report is true.

Dated Dec 5 19 76 Signature Tom Sedhill

THE PENALTY FOR MAKING A FALSE STATEMENT IN THIS REPORT AND/OR CERTIFICATE IS \$500. OR SIX MONTHS IMPRISONMENT OR BOTH



Ontario

THE MINING ACT REPORT OF WORK

file 5.429861

A separate form is required for each type of work to be recorded.

To the Recorder of Sudbury Mining Division
I, Larry Serls A.R.H.
Tom Shidwell name of Recorded Holder
21 Sandalwood Place, Don Mills Prospector's License
Ont. Post Office Address
do hereby report the performance of 20 days of Geophysical type of work

not before reported to be applied on the following contiguous claims

Claim No.	Days	Claim No.	Days	Claim No.	Days
S450064	20				

Geological Branch ODM
ASSESSMENT FILES
RESEARCH OFFICE
DEC 1.5.1976
RECEIVED

All the work was performed on Mining Claim (s) as above
(In the case of geological and/or geophysical survey (s) where more than 18 claims are involved attach a schedule)

READ CAREFULLY: THE FOLLOWING INFORMATION IS REQUIRED BY THE MINING RECORDER.

- For Manual Work, Stripping or Opening up of Mines, Sinking Shafts or Other Actual Mining Operations - Names and addresses of the men who performed the work and the dates and hours of their employment.
- For Diamond and other Core Drilling - Footage, No. and angle of holes and diameter of core. Name and address of owner or operator of drill. Dates when drilling was done. Signed core log and sketch in duplicate.
- For Compressed Air or Other Power Driven or Mechanical Equipment
- Type of drill or equipment. Names and addresses of men engaged in operating equipment and the dates and hours of their employment.
- For Power Stripping - Type of equipment. Name and address of owner or operator. Amount expended. Dates on which work was done. Proof of actual cost must be submitted within 30 days of recording.
- With each of the above types of work sketches are required to show the location and extent of the work in relation to the nearest claim post. In the case of diamond or other core drilling the sketch must be submitted in duplicate.
- For Geophysical, Geological, Geochemical Surveys and Expenditure Credits - the name of author of report. Covering dates of survey (linecutting & office). Type of instrument used. Total amount of expenditure. Technical reports, maps, expenditure breakdown, receipts must be filed in duplicate with the Minister within 60 days of recording.
- For Land Survey - the name and address of Ontario Land surveyor.

The Required Information is as Follows: (Attach a list if this space is insufficient)

Oct 1 - Nov 30, 76

MINING DIVISION
RECORDS
DEC 5 1976

Ingram Exploration Ltd.
Exploranium Spectrometer
Phil Brown P. Eng.
% 21 Sandalwood Place
DON MILLS, Ontario
Tom Shidwell
Signature of Recorded Holder or Agent

Date Dec 5, 1976

The Mining Act
Certificate Verifying Report of Work

I, Tom Shidwell
21 Sandalwood Place Don Mills, Ont.
(Post Office Address)

hereby certify:

- That I have a personal and intimate knowledge of the facts set forth in the report of work annexed hereto, having performed the work or witnessed same during and/or after its completion.
- That the annexed report is true.

Dated Dec 5 19 76

Tom Shidwell
Signature

THE PENALTY FOR MAKING A FALSE STATEMENT IN THIS REPORT AND/OR CERTIFICATE IS \$500. OR SIX MONTHS IMPRISONMENT OR BOTH

CREELMAN TWP.

#77-100



Ontario

JAN 5 1978

THE MINING ACT REPORT OF WORK

file 5.438845

A separate form is required for each type of work to be recorded.

To the Recorder of Sudbury Mining Division

I, Doug Apper name of Recorded Holder C. 31761 Prospector's Licence

21 Sandwood Pl. Dow Mills Post Office Address

do hereby report the performance of 5 x 40 = 200 days of Geophysical Survey type of work AIRBORNE RADIOMETRIC

Table with columns: Claim No., Days, Claim No., Days, Claim No., Days. Contains handwritten entries for claims 5438845, 438849, 438850, 438851, 438852.

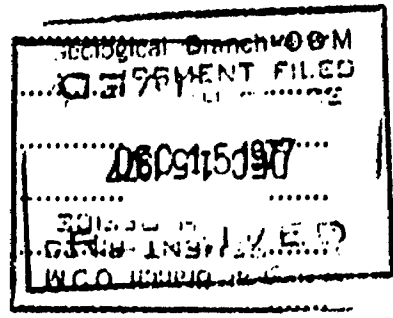

All the work was performed on Mining Claim (s) as above (In the case of geological and/or geophysical survey (s) where more than 18 claims are involved attach a schedule)

READ CAREFULLY: THE FOLLOWING INFORMATION IS REQUIRED BY THE MINING RECORDER.

- For Manual Work, Stripping or Opening up of Mines, Sinking Shafts or Other Actual Mining Operations - Names and addresses of the men who performed the work and the dates and hours of their employment.
For Diamond and other Core Drilling - Footage, No. and angle of holes and diameter of core. Name and address of owner or operator of drill. Dates when drilling was done. Signed core log and sketch in duplicate.
For Compressed Air or Other Power Driven or Mechanical Equipment Type of drill or equipment. Names and addresses of men engaged in operating equipment and the dates and hours of their employment.
For Power Stripping - Type of equipment. Name and address of owner or operator. Amount expended. Dates on which work was done. Proof of actual cost must be submitted within 30 days of recording.
With each of the above types of work sketches are required to show the location and extent of the work in relation to the nearest claim post. In the case of diamond or other core drilling the sketch must be submitted in duplicate.
For Geophysical, Geological, Geochemical Surveys and Expenditure Credits - the name of author of report. Covering dates of survey (linecutting & office). Type of instrument used. Total amount of expenditure. Technical reports, maps, expenditure breakdown, receipts must be filed in duplicate with the Minister within 60 days of recording.
For Land Survey - the name and address of Ontario Land surveyor.

The Required Information is as Follows: (Attach a list if this space is insufficient)

Airborne Gamma Ray Survey
Author Tom Sedhill
Instrument Explorer Spectrometer 41
Expenditure \$20 / line miles @ \$100
July 1 - July 31 / 77

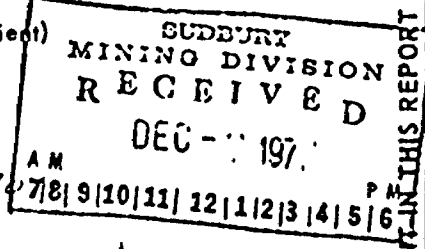

Date Dec 1 / 77 Signature of Recorded Holder or Agent Tom Sedhill

The Mining Act Certificate Verifying Report of Work

I, Tom Sedhill 21 Sandwood Place Dow Mills (Post Office Address)

hereby certify:

- 1. That I have a personal and intimate knowledge of the facts set forth in the report of work annexed hereto, having performed the work or witnessed same during and/or after its completion.
2. That the annexed report is true.

Dated Dec 1 19 77 Signature Tom Sedhill

THE PENALTY FOR MAKING A FALSE STATEMENT IN THIS REPORT AND/OR CERTIFICATE IS \$500. OR SIX MONTHS IMPRISONMENT OR BOTH

U



JAN 5 1978

Ontario

file 5. 442765

A separate form is required for each type of work to be recorded.

THE MINING ACT REPORT OF WORK

To the Recorder of Sudbury Mining Division

I, Grant Secord name of Recorded Holder

G. Sedhill Consultants Inc. 21 Sandalwood Place Post Office Address

do hereby report the performance of 27 x 40 = 1080 days of Geophysical Survey type of work

Claim No.	Days	Claim No.	Days	Claim No.	Days
5-442765	40	5442771	40	5442777	40
442766	40	442772	40	442778	40
442767	40	442773	40	442779	40
442768	40	442774	40	442780	40
442769	40	442775	40	442786	40
442770	40	442776	40	442868	40
				442869	40
				442870	40
				442871	40

Geological Branch ODM
 RECEIVED
 DEC 5 1977

All the work was performed on Mining Claim (s) 5442782-40 5442783-40 5442784-40

READ CAREFULLY: THE FOLLOWING INFORMATION IS REQUIRED BY THE MINING RECORDER.

- For Manual Work, Stripping or Opening up of Mines, Sinking Shafts or Other Actual Mining Operations - Names and addresses of the men who performed the work and the dates and hours of their employment.
- For Diamond and other Core Drilling - Footage, No. and angle of holes and diameter of core. Name and address of owner or operator of drill. Dates when drilling was done. Signed core log and sketch in duplicate.
- For Compressed Air or Other Power Driven or Mechanical Equipment
- Type of drill or equipment. Names and addresses of men engaged in operating equipment and the dates and hours of their employment.
- For Power Stripping - Type of equipment. Name and address of owner or operator. Amount expended. Dates on which work was done. Proof of actual cost must be submitted within 30 days of recording.
- With each of the above types of work sketches are required to show the location and extent of the work in relation to the nearest claim post. In the case of diamond or other core drilling the sketch must be submitted in duplicate.
- For Geophysical, Geological, Geochemical Surveys and Expenditure Credits - the name of author of report. Covering dates of survey (linecutting & office). Type of instrument used. Total amount of expenditure. Technical reports, maps, expenditure breakdown, receipts must be filed in duplicate with the Minister within 60 days of recording.
- For Land Survey - the name and address of Ontario Land surveyor.

The Required Information is as Follows: (Attach a list if this space is insufficient)

Carlson Gamma Ray Survey
Author Tom Sedhill
Instrument Exploration Spectrometer 410
Expenditure 20 plane miles = 540
June 1 - July 31/77

SUDBURY
 MINING DIVISION
 RECEIVED
 DEC 11 1977
 AM 7 9 | 10 | 11 | 12 | 1 | 2 | 3 | 4 | 5 | 6 PM

Date Dec 1/77

Tom Sedhill
Signature of Recorded Holder or Agent

The Mining Act Certificate Verifying Report of Work

I, Tom Sedhill
21 Sandalwood Place Don Mills, Ont.
(Post Office Address)

hereby certify:

- That I have a personal and intimate knowledge of the facts set forth in the report of work annexed hereto, having performed the work or witnessed some during and/or after its completion.
- That the annexed report is true.

Dated Dec 1 19 77

Tom Sedhill
Signature

U

THE PENALTY FOR MAKING A FALSE STATEMENT IN THIS REPORT AND/OR CERTIFICATE IS \$500. OR SIX MONTHS IMPRISONMENT OR BOTH

ROBERTS TWP.

#77-104



Ontario

file S.429861

JAN 5 1978

THE MINING ACT REPORT OF WORK

A separate form is required for each type of work to be recorded.

To the Recorder of Sudbury Mining Division

I, Daniel Rakhon M18456 name of Recorded Holder Prospector's Licence

21 Sandalwood Rd. Don Mills, Ont. Post Office Address

do hereby report the performance of 40 days of Geophysical Survey type of work

not before reported to be applied on the following contiguous claims

Table with 3 columns: Claim No., Days, Claim No., Days, Claim No., Days. Includes claim numbers 429861, 429862, 429863, 429864, 429865, 429866 and 5429867, 429868, 429869.

Stamp: RECEIVED DEC 15 1977

All the work was performed on Mining Claim (s) as above (In the case of geological and/or geophysical survey (s) where more than 18 claims are involved attach a schedule)

READ CAREFULLY: THE FOLLOWING INFORMATION IS REQUIRED BY THE MINING RECORDER.

For Manual Work, Stripping or Opening up of Mines, Sinking Shafts or Other Actual Mining Operations - Names and addresses of the men who performed the work and the dates and hours of their employment. For Diamond and other Core Drilling - Footage, No. and angle of holes and diameter of core. Name and address of owner or operator of drill. Dates when drilling was done. Signed core log and sketch in duplicate. For Compressed Air or Other Power Driven or Mechanical Equipment Type of drill or equipment. Names and addresses of men engaged in operating equipment and the dates and hours of their employment. For Power Stripping - Type of equipment. Name and address of owner or operator. Amount expended. Dates on which work was done. Proof of actual cost must be submitted within 30 days of recording. With each of the above types of work sketches are required to show the location and extent of the work in relation to the nearest claim post. In the case of diamond or other core drilling the sketch must be submitted in duplicate. For Geophysical, Geological, Geochemical Surveys and Expenditure Credits - the name of author of report. Covering dates of survey (linecutting & office). Type of instrument used. Total amount of expenditure. Technical reports, maps, expenditure breakdown, receipts must be filed in duplicate with the Minister within 60 days of recording. For Land Survey - the name and address of Ontario Land surveyor.

The Required Information is as Follows: (Attach a list if this space is insufficient)

Car borne Gamma Ray Survey. Author: Tom Sedhill Instrument: Geonics Spectrometer 440 Expenditure: 50/hour = 180 Dates: June - July 1977

Stamp: SUDBURY MINING DIVISION RECEIVED DEC 11 1977

Date Dec 1/77 Signature of Recorded Holder or Agent Tom Sedhill

The Mining Act Certificate Verifying Report of Work

I, Tom Sedhill 21 Sandalwood Rd. Don Mills, Ont. (Post Office Address)

hereby certify:

- 1. That I have a personal and intimate knowledge of the facts set forth in the report of work annexed hereto, having performed the work or witnessed same during and/or after its completion. 2. That the annexed report is true.

Dated Dec 1/77 19 77 Signature Tom Sedhill

THE PENALTY FOR MAKING A FALSE STATEMENT IN THIS REPORT AND/OR CERTIFICATE IS \$500. OR SIX MONTHS IMPRISONMENT OR BOTH

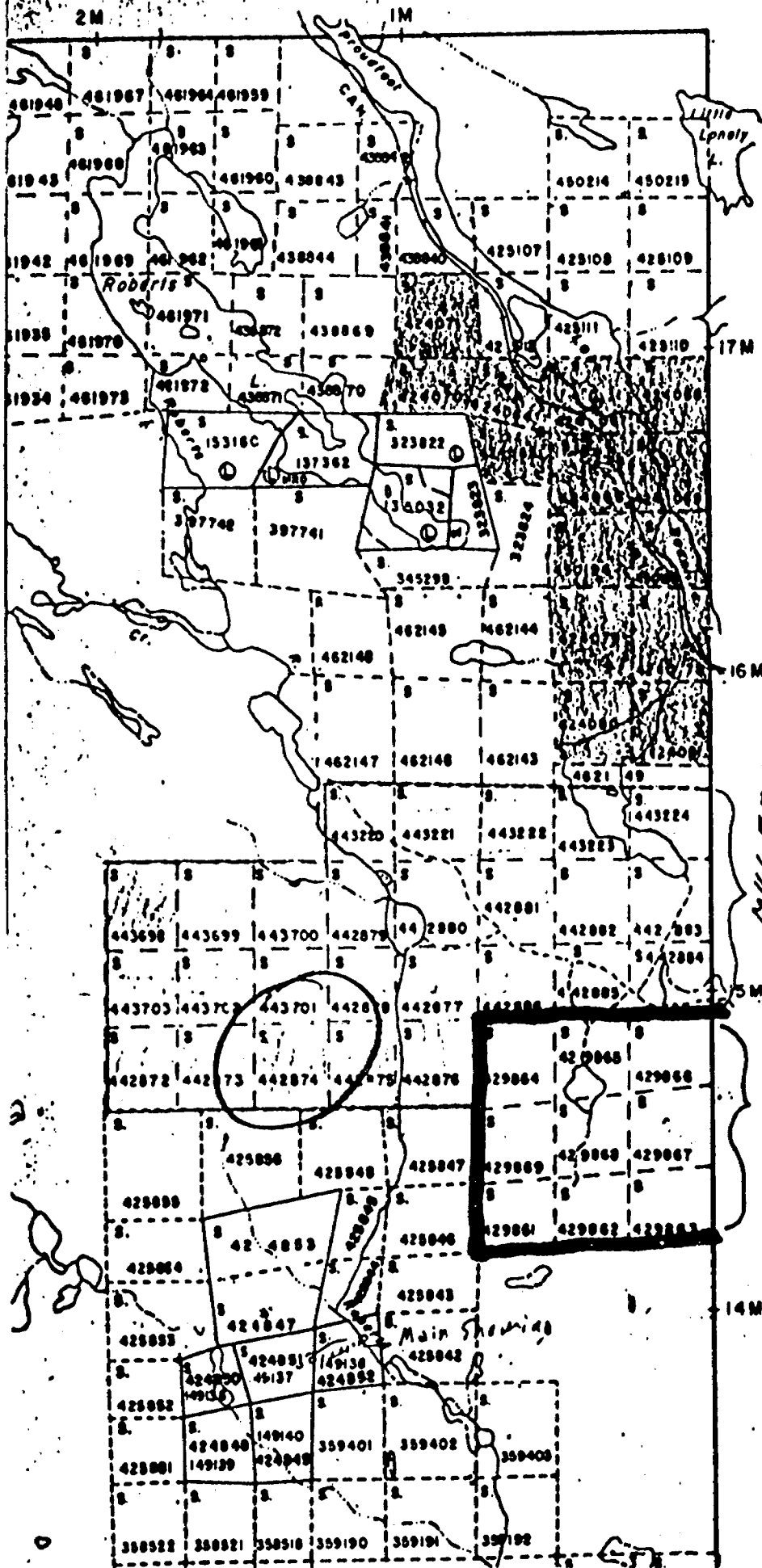

MILLER, D. 1977
 ROCHON, D. 1977
 Creelman Twp. M. 737

SCA

- PATEN
- CROW
- LEASI
- LOCAT
- LICEN
- MININ
- SURFI
- ROAD
- IMPRC
- KING
- RAIL
- POWE
- MARE
- MINE:
- CANC

400'
 Lake



Ontario

file S.442872

A separate form is required for each type of work to be recorded.

JAN 5 1978

THE MINING ACT REPORT OF WORK

To the Recorder of Sudbury Mining Division

I, Donald Miller name of Recorded Holder M. 19936 Prospector's Licence

90 Gledhill Crescent Inc. Post Office Address

do hereby report the performance of 28 X 40 = 1120 days of Geophysical Survey Type of work

not before reported to be applied on the following contiguous claims AIRBORNE RADOMETRIC

Claim No.	Days	Claim No.	Days	Claim No.	Days
S 443225 U	40	5443702 R	40	3442882 R	40
443226 L	40	443708 R	40	442883 L	40
443227 L	40	442872 L	40	442884 L	40
443228 L	40	442873 R	40	442885 L	40
443229 L	40	442874 R	40	442886 L	40
443230 L	10	442875 L	40	443220 L	40
443231 U	40	442876 L	40	443221 L	40
S 443498 R	40	442877 L	40	443222 L	40
443699 R	40	442878 L	40	443223 L	40
443700 R	40	442879 L	40	443224 R	40
443701 L	40	442880 L	40		
		442881 L	40		

RECEIVED
 DEC 18 1977
 MINING DIVISION
 SUDBURY
 RECEIVED
 DEC - 19 1977
 7 8 | 9 | 10 | 11 | 12 | 1 | 2 | 3 | 4 | 5 | 6 P.M.

All the work was performed on Mining Claim (s) no claim
(In the case of geological and/or geophysical survey (s) where more than 18 claims are involved attach a schedule)

READ CAREFULLY: THE FOLLOWING INFORMATION IS REQUIRED BY THE MINING RECORDER.

- For Manual Work, Stripping or Opening up of Mines, Sinking Shafts or Other Actual Mining Operations - Names and addresses of the men who performed the work and the dates and hours of their employment.
- For Diamond and other Core Drilling - Footage, No. and angle of holes and diameter of core. Name and address of owner or operator of drill. Dates when drilling was done. Signed core log and sketch in duplicate.
- For Compressed Air or Other Power Driven or Mechanical Equipment
 Type of drill or equipment. Names and addresses of men engaged in operating equipment and the dates and hours of their employment.
- For Power Stripping - Type of equipment. Name and address of owner or operator. Amount expended. Dates on which work was done. Proof of actual cost must be submitted within 30 days of recording.
- With each of the above types of work sketches are required to show the location and extent of the work in relation to the nearest claim post. In the case of diamond or other core drilling the sketch must be submitted in duplicate.
- For Geophysical, Geological, Geochemical Surveys and Expenditure Credits - the name of author of report. Covering dates of survey (linecutting & office). Type of instrument used. Total amount of expenditure. Technical reports, maps, expenditure breakdown, receipts must be filed in duplicate with the Minister within 60 days of recording.
- For Land Survey - the name and address of Ontario Land surveyor.

The Required Information is as Follows: (Attach a list if this space is insufficient)

Airborne Gamma Ray Survey
Arthur Tom Gledhill
Instrument Registration Spectrometer
Expenditure: 20/line mile - 660
Jan - July 31 77

SUDBURY
 MINING DIVISION
 RECEIVED
 DEC - 19 1977
 7 8 | 9 | 10 | 11 | 12 | 1 | 2 | 3 | 4 | 5 | 6 P.M.

Date Dec 1 77 Signature of Recorded Holder or Agent Tom Gledhill

The Mining Act Certificate Verifying Report of Work
 I, Tom Gledhill THOMAS R. GLEDHILL
21 Sandalwood Place Ron Hill
 (Post Office Address)

hereby certify:
 1. That I have a personal and intimate knowledge of the facts set forth in the report of work annexed hereto, having performed the work or witnessed some during and/or after its completion.
 2. That the annexed report is true.
 Dated Dec 1 77 Signature T. Gledhill

THE PENALTY FOR MAKING A FALSE STATEMENT IN THIS REPORT AND/OR CERTIFICATE IS \$500. OR SIX MONTHS IMPRISONMENT OR BOTH

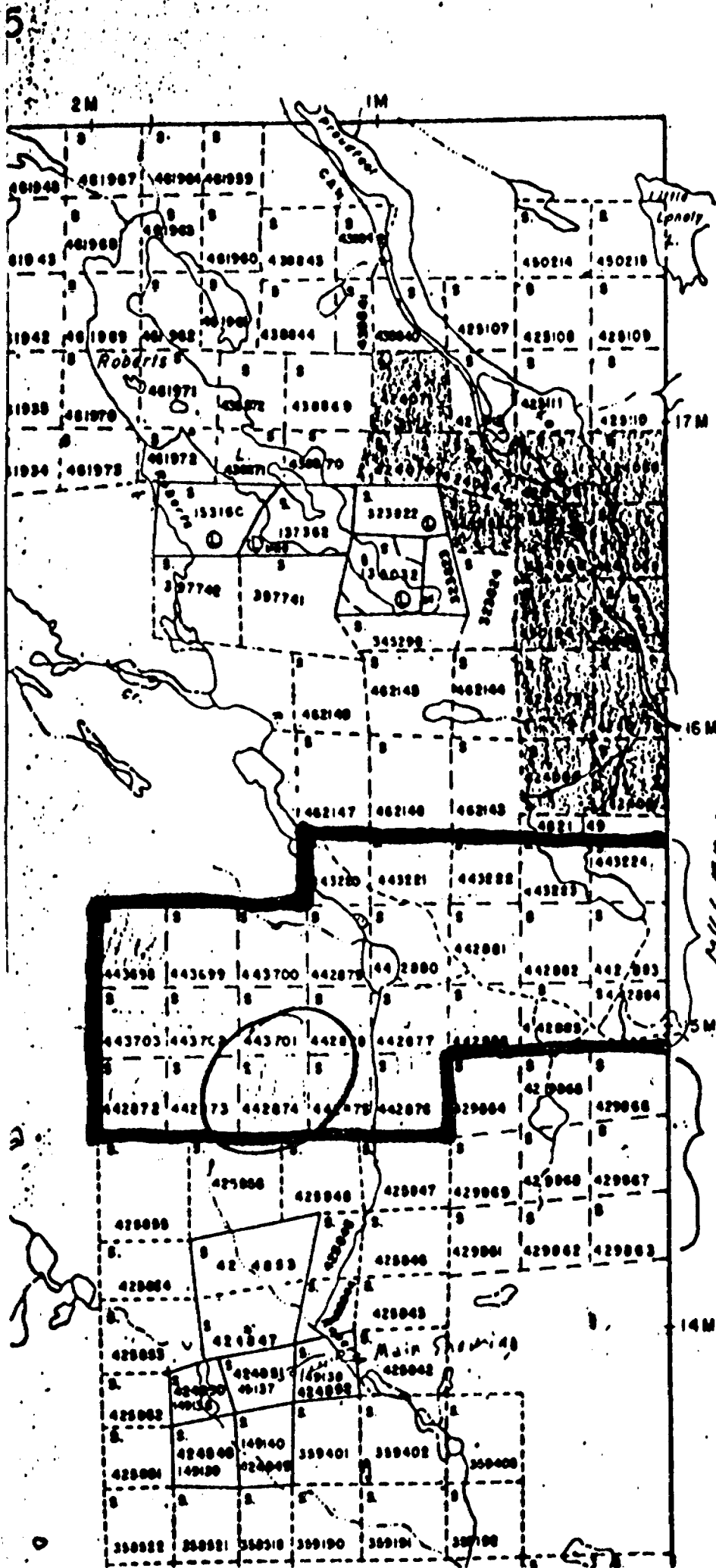

MILLER, D. 1977
 Racine, D. 1977
 Creelman Twp. M. 737

SCA

- PATEN
- CROW
- LEASI
- LOCAT
- LICEN
- MININ
- SURFI
- ROAD
- IMPRC
- KING
- RAIL
- POWE
- MARE
- MINE
- CANC

400'
Lake



Ontario

JAN 5 1978

THE MINING ACT REPORT OF WORK

A separate form is required for each type of work to be recorded.

file S. 450064

To the Recorder of Sudebury Mining Division
I, Larry Sudo name of Recorded Holder
Prospector's Licence M 20010
do hereby report the performance of 40 days of Geophysical Surveys type of work
not before reported to be applied on the following contiguous claims AIRBORNE RADIMETRIC

Table with 6 columns: Claim No., Days, Claim No., Days, Claim No., Days. Includes handwritten entry S. 450064, 40 and a RECEIVED stamp dated DEC 15 1977.

All the work was performed on Mining Claim (s) as above.
(In the case of geological and/or geophysical survey (s) where more than 18 claims are involved attach a schedule)

READ CAREFULLY: THE FOLLOWING INFORMATION IS REQUIRED BY THE MINING RECORDER.

- For Manual Work, Stripping or Opening up of Mines, Sinking Shafts or Other Actual Mining Operations - Names and addresses of the men who performed the work and the dates and hours of their employment.
For Diamond and other Core Drilling - Footage, No. and angle of holes and diameter of core. Name and address of owner or operator of drill. Dates when drilling was done. Signed core log and sketch in duplicate.
For Compressed Air or Other Power Driven or Mechanical Equipment
Type of drill or equipment. Names and addresses of men engaged in operating equipment and the dates and hours of their employment.
For Power Stripping - Type of equipment. Name and address of owner or operator. Amount expended. Dates on which work was done. Proof of actual cost must be submitted within 30 days of recording.
With each of the above types of work sketches are required to show the location and extent of the work in relation to the nearest claim post. In the case of diamond or other core drilling the sketch must be submitted in duplicate.
For Geophysical, Geological, Geochemical Surveys and Expenditure Credits - the name of author of report. Covering dates of survey (linecutting & office). Type of instrument used. Total amount of expenditure. Technical reports, maps, expenditure breakdown, receipts must be filed in duplicate with the Minister within 60 days of recording.
For Land Survey - the name and address of Ontario Land surveyor.

The Required Information is as Follows: (Attach a list if this space is insufficient)

Airborne Gamma Ray Survey
Author Tom Sedhill
Instrument Explorerian Spectrometer
Expenditure - \$20/line mile - 40
June 1 - July 31/77

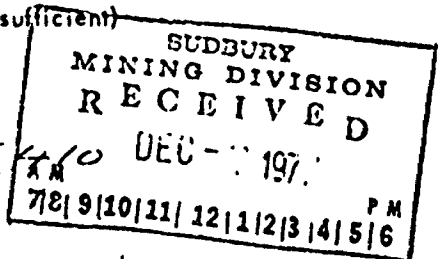

Date Dec 1 1977
Signature of Recorded Holder or Agent Tom Sedhill

The Mining Act Certificate Verifying Report of Work

I, Tom Sedhill
21 Sandalwood Place, Down Hills
(Post Office Address)

hereby certify:

- 1. That I have a personal and intimate knowledge of the facts set forth in the report of work annexed hereto, having performed the work or witnessed same during and/or after its completion.
2. That the annexed report is true.

Dated Dec 1 1977
Signature Tom Sedhill

THE PENALTY FOR MAKING A FALSE STATEMENT IN THIS REPORT AND/OR CERTIFICATE IS \$500. OR SIX MONTHS IMPRISONMENT OR BOTH

U

CREELMAN

M-737

1" = 40 chains

ROBERTS TWP. M.1078

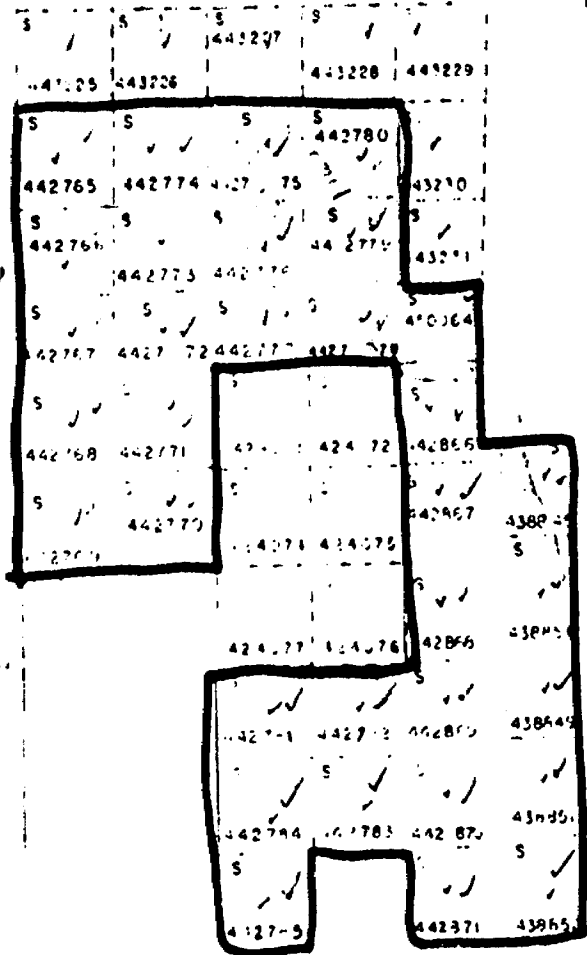

HUTTON TWP

Roberts Tp.

Ingram Exploration

Soumont Twp. M. 655

G.P.: Rad. Air. Spectr. survey & map.
Feb. 10/77

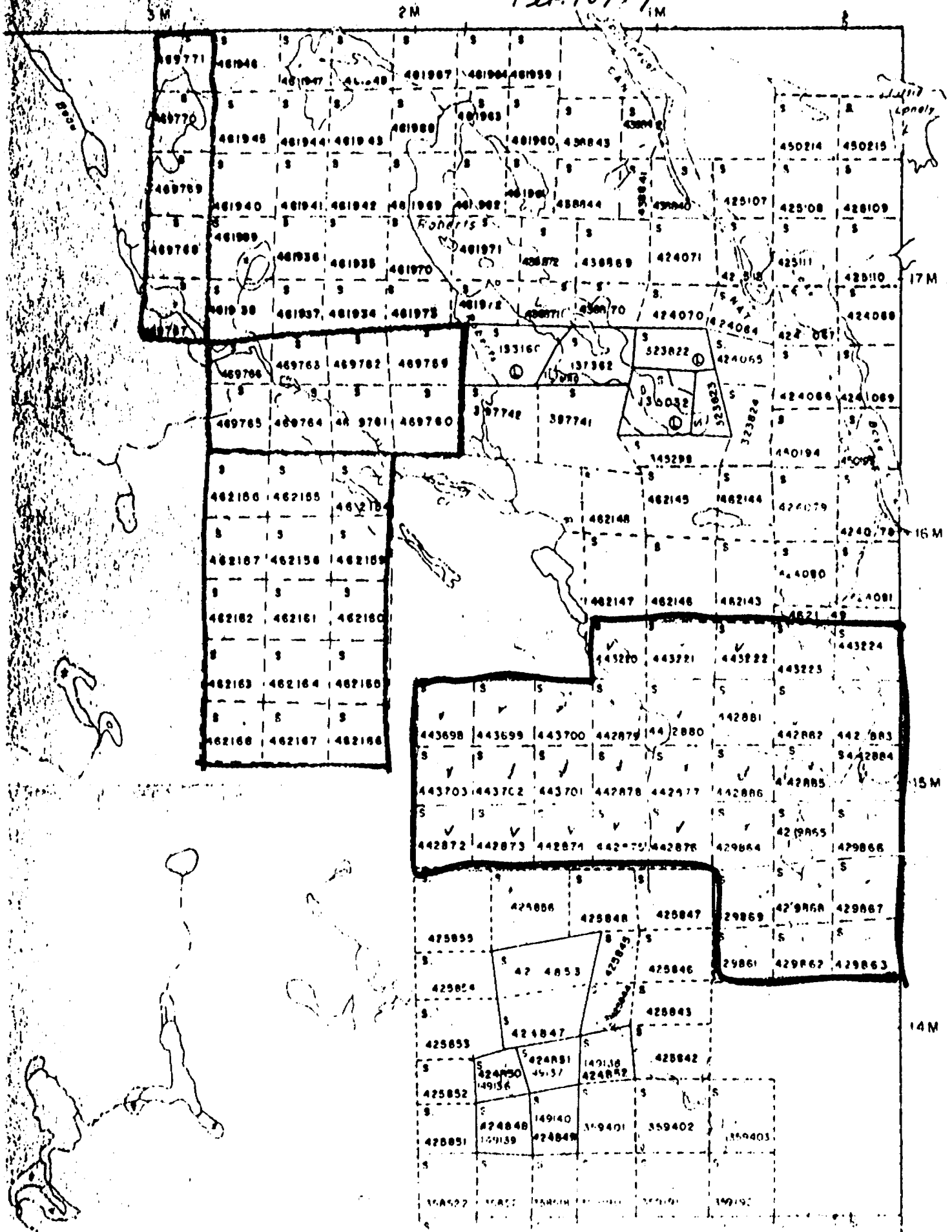

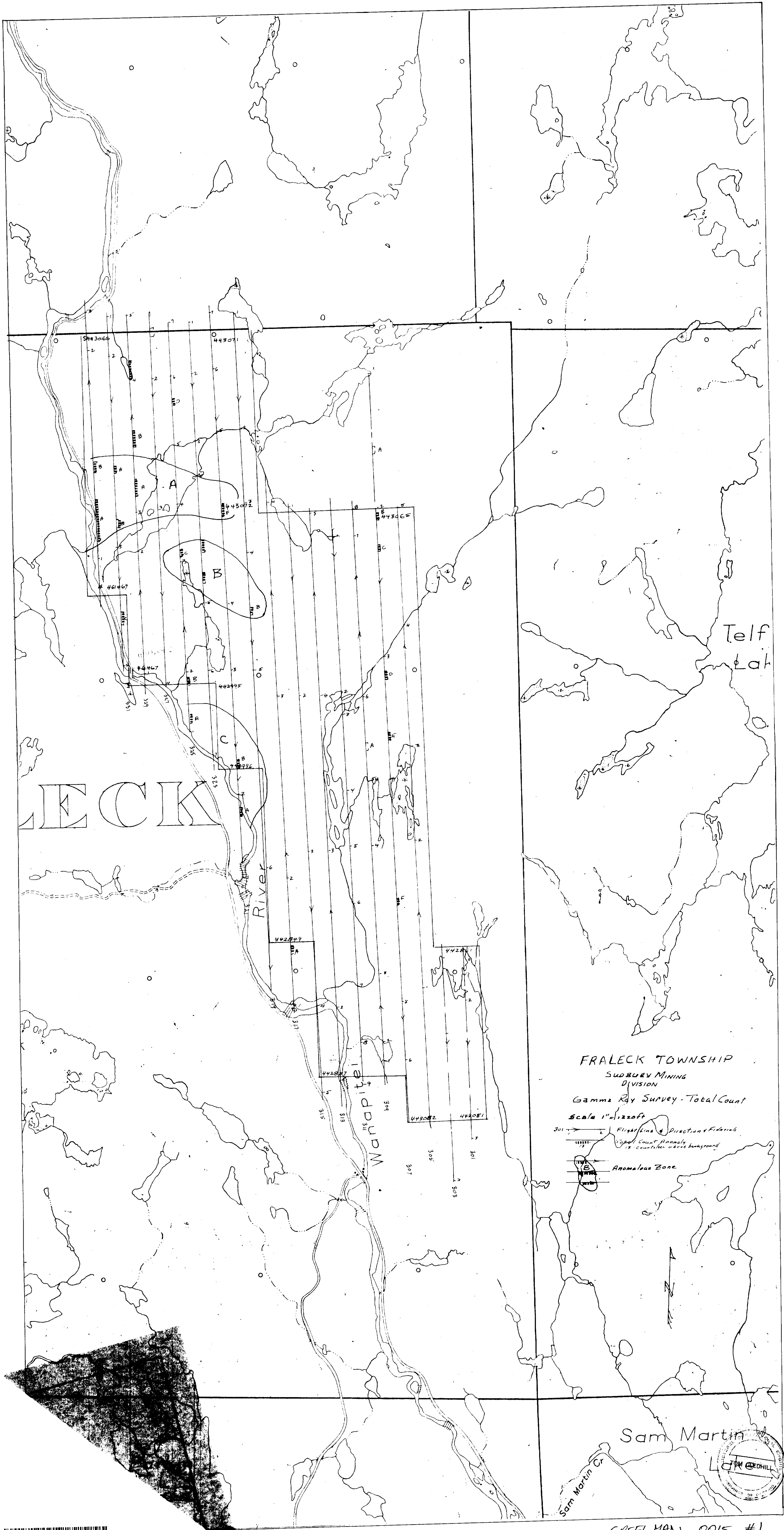

Telf
Lah

FRALECK

River

Wanapitei

FRALECK TOWNSHIP
SUBBURY MINING
DIVISION

Gamma Ray Survey - Total Count

Scale 1" = 1220ft

Flight Line & Direction of Flight
Total Count Anomaly
15 Count/Sec above background

Anomalous Zone

Sam Martin

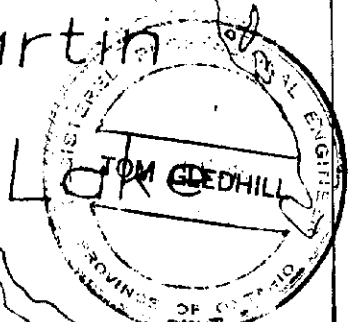

CREELMAN 0015 #1

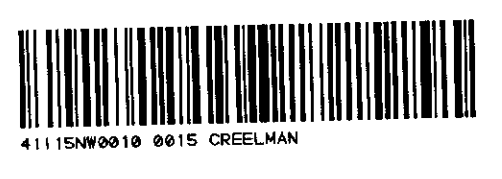

ROBERTS

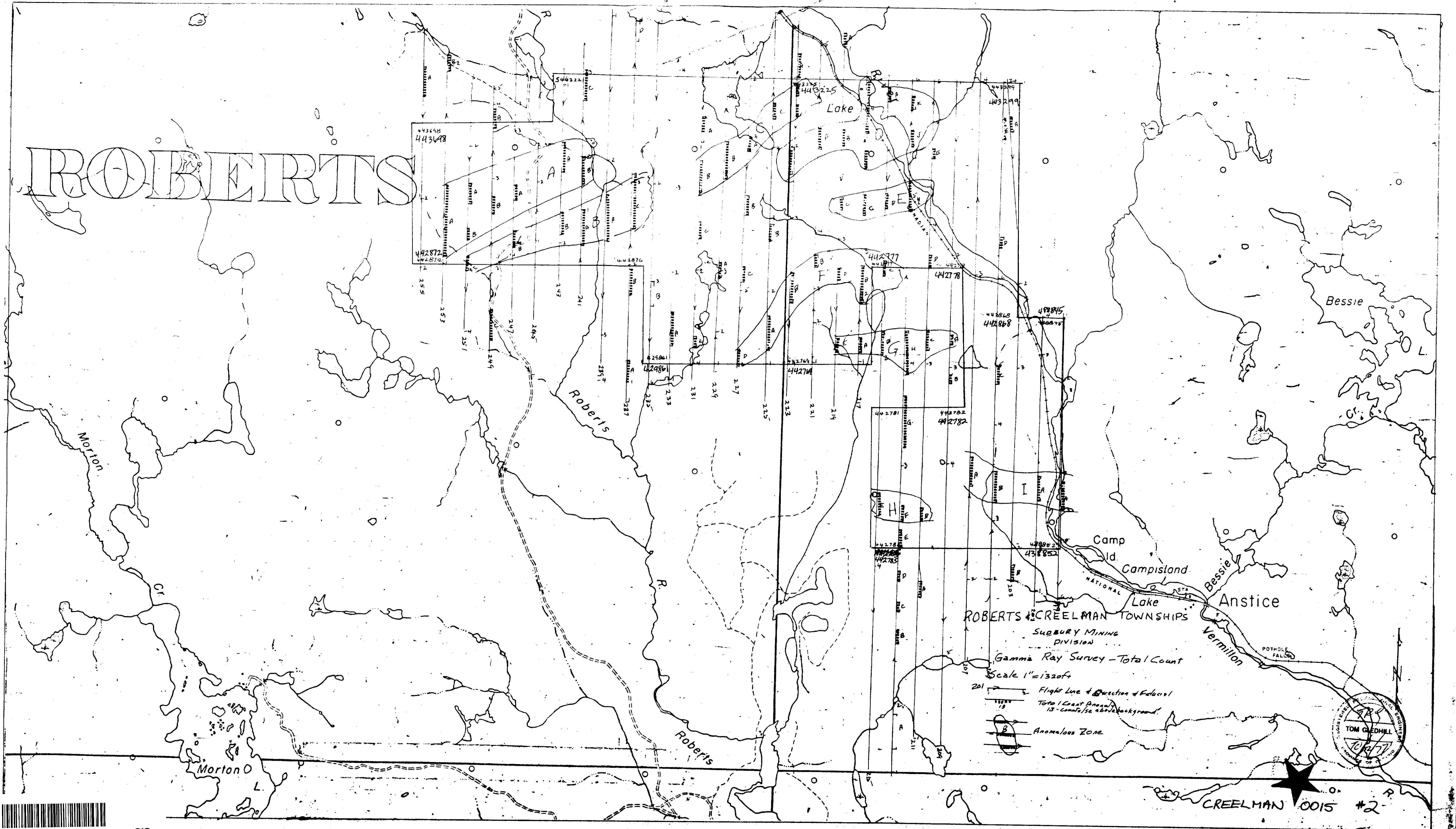

ROBERTS & CREELMAN TOWNSHIPS
SUDBURY MINING
DIVISION

Gamma Ray Survey - Total Count
Scale 1" = 1320ft

- Flight Line & Direction & Elevation
- Total Count Anomaly
15 - Counts/sec above background
- Anomalous Zone

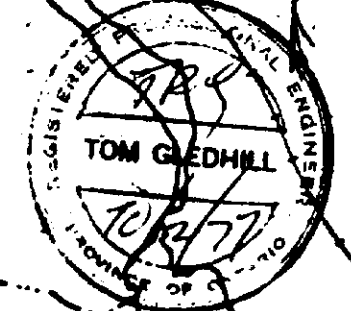

CREELMAN 0015 #2

