



41115NW0115 0014A1 PARKIN

010

FARRIN TOWNSHIP

REPORT #23

This file contains work performed by Hucliff Porcupine

Mines Ltd. on claims:

| | | | |
|-----------|-----------|-------|------------|
| S. 117086 | Holes #5; | 222.0 | May, 1965 |
| | #6; | 224.0 | May, 1965 |
| S. 117085 | Hole #7; | 218.0 | June, 1965 |

TOTAL: 3 DN 664.0

DIAMOND DRILL RECORD

PROPERTY HUGLIP PORCUPINE MINES LTD. - Parkin Twp. HOLE No. 5
 SHEET NUMBER 1 SECTION FROM 0 TO 79.4' STARTED May 18th, 1965
 LATITUDE 150' N. DATUM #5 K.L. Post 117086 COMPLETED May 21st, 1965
 DEPARTURE 500' E. BEARING 180° ULTIMATE DEPTH 222 ft.
 ELEVATION X DIP -45° PROPOSED DEPTH 200 ft.

| DEPTH FEET | FORMATION | SAMPLE NO. | FROM | TO | WIDTH | ASSAY VALUES | | | |
|------------|---|------------|------|----|-------|--------------|--|--|--|
| | | | | | | | | | |
| 0 - 25 | Casing | | | | | | | | |
| 25 - 51 | Very fine grained greywacke - slips and seams of pyrrhotite - very little chalcopryite | | | | | | | | |
| 51-40.0 | Greywacke - up to 5% sulphides - Pyrrhotite - some blue mud. - very little chalcopryite | | | | | | | | |
| 40-40.2 | Seam of black basic greywacke | | | | | | | | |
| 40.2-46.5 | Greywacke as before - 3% sulphides - no pyrite or chalcopryite | | | | | | | | |
| 46.5-47.0 | Two small quartz seams to 1-1/4 in. in greywacke | | | | | | | | |
| 47-50.6 | Greywacke - very low to no mineral | | | | | | | | |
| 50.6 | Greywacke - up to 2% sulphides disseminated - seams and slips | | | | | | | | |

NORTHERN MINER FORM 505 REV. 54

DRILLED BY Bradley Bros. Ltd.

SIGNED

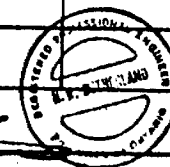

DIAMOND DRILL RECORD

PROPERTY Huclif Porcupine Mines Ltd. - Parkin Twp. **HOLE No.** 5
SHEET NUMBER 2 **SECTION FROM** _____ **TO** _____ **STARTED** _____
LATITUDE _____ **DATUM** 79.4' - 154.0' **COMPLETED** _____
DEPARTURE _____ **BEARING** _____ **ULTIMATE DEPTH** _____
ELEVATION _____ **DIP** _____ **PROPOSED DEPTH** _____

| DEPTH FEET | FORMATION | SAMPLE NO. | FROM | TO | WIDTH | ASSAY VALUES | | | |
|------------|--|------------|------|----|-------|--------------|--|--|--|
| | | | | | | | | | |
| 79.4 | Filled with sulphides - up to 1/16 in. thick | | | | | | | | |
| 79.4-96.5 | Greywacke - badly fractured Some quartz seams to 1/4 in. with sulphide - sulphide blebs and seams | | | | | | | | |
| 96.6-107.5 | Dark greywacke - approaching greenstone - blebs of sulphide in seams, very little | | | | | | | | |
| 107.5- | Grey quartzose greywacke - | | | | | | | | |
| 123.1 | up to 5% sulphides - no chalcopryrite - prob. pyrrhotite | | | | | | | | |
| 123.1 - | Greywacke - less quartz and less min. - | | | | | | | | |
| 154 | darker | | | | | | | | |

NORTHERN MINER FORM 808 REV./84

DRILLED BY Bradley Bros. Ltd.

SIGNED _____



DIAMOND DRILL RECORD

PROPERTY: **Euclif Porcupine Mines Ltd. - Parkin Twp.**

HOLE No. **5**

SHEET NUMBER **5**

SECTION FROM **154.0'** TO **222.0'** STARTED.....

LATITUDE..... DATUM.....

COMPLETED.....

DEPARTURE..... BEARING.....

ULTIMATE DEPTH.....

ELEVATION..... DIP.....

PROPOSED DEPTH.....

| DEPTH FEET | FORMATION | SAMPLE NO. | FROM | TO | WIDTH | ASSAY VALUES | | | |
|-------------|--|------------|------|----|-------|--------------|--|--|--|
| | | | | | | | | | |
| 154.0 - | Silicified greywacke - medium sulphides | | | | | | | | |
| 142.8 | (plus-minus 5%) - prob. pyrrhotite | | | | | | | | |
| 142.8-149.4 | Normal greywacke - low mineralization | | | | | | | | |
| 149.4-151.6 | Fractured shaley greywacke | | | | | | | | |
| 151.6- | Slightly silicified greywacke - | | | | | | | | |
| 165.2 | low mineralization | | | | | | | | |
| 165.2-171.0 | Greywacke - very low mineralization | | | | | | | | |
| 171.0 - | Greywacke - occasional seams (- 1/16") | | | | | | | | |
| 175.0 | and crystals of chalcopyrite | | | | | | | | |
| 175.0 - | Normal greywacke - light colour - | | | | | | | | |
| 202.0 | high quartz, low mineralization | | | | | | | | |
| 202.0 | Contact | | | | | | | | |
| | Silicified quartzite, greywacke | | | | | | | | |
| 222.0 | light colour - very little mineralization to end hole. | | | | | | | | |

NORTHERN MINES FORM 202 REV. 54

DRILLER'S

Bradley Bros. Ltd.



[Handwritten signature]

DIAMOND DRILL RECORD

PROPERTY Euclif Porcupine Mines Ltd. - Parkin Twp. HOLE No. 8
 SHEET NUMBER 1 SECTION FROM 0 TO 78.6 STARTED May 21, 1965
 LATITUDE 150' N. DATUM #3 Post Cl. S.117086 COMPLETED May 25, 1965
 DEPARTURE 500' E. BEARING 0° ULTIMATE DEPTH 224
 ELEVATION X DIP -45° PROPOSED DEPTH 220

| DEPTH FEET | FORMATION | SAMPLE NO. | FROM | TO | WIDTH | ASSAY VALUES | | | |
|------------|--|------------|------|----|-------|--------------|--|--|--|
| | | | | | | | | | |
| 0 - 8 | Casing | | | | | | | | |
| 8-27.8 | Silicified greywacke - medium low sulphides (pyrro.) - high quartz content | | | | | | | | |
| 27.8 - | Dark greywacke - approaching greenstone - | | | | | | | | |
| 51.6 | very fine grained - no mineralisation | | | | | | | | |
| 51.6 - | Normal greywacke - medium | | | | | | | | |
| 64.1 | low mineralization (pyrro.) - Some silicification from 56' | | | | | | | | |
| 64.1 - | Dark normal greywacke - less | | | | | | | | |
| 71.5 | min. and seams | | | | | | | | |
| 71.5 - | Light rhyolitic vein - high quartz and | | | | | | | | |
| 72.5 | white feldspar - granular | | | | | | | | |
| 72.5 - | Silicified greywacks - | | | | | | | | |
| 78.6 | low to medium min. (pyrro.) | | | | | | | | |

NORTHERN MINER FORM 903 REV./64

DRILLED BY Bradley Bros. Ltd.

SIGNED

[Handwritten Signature]

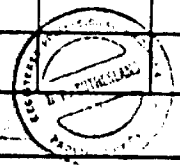

DIAMOND DRILL RECORD

PROPERTY Huelif Porcupine Mines Ltd. - Parkin Twp. HOLE No. 6
 SHEET NUMBER 2 SECTION FROM 78.8' TO 167.0' STARTED.....
 LATITUDE..... DATUM..... COMPLETED.....
 DEPARTURE..... BEARING..... ULTIMATE DEPTH.....
 ELEVATION..... DIP..... PROPOSED DEPTH.....

| DEPTH FEET | FORMATION | SAMPLE NO. | FROM | TO | WIDTH | ASSAY VALUES | | | |
|------------|---|------------|------|----|-------|--------------|--|--|--|
| | | | | | | | | | |
| 78.8 - | Rhyolitic greywacke - carbonate | | | | | | | | |
| 89.0 | quartz and feldspar seams and blebes - | | | | | | | | |
| | silicified - darkens at 89.0 | | | | | | | | |
| 89.0 - | Carbonated and silicified greywacke - | | | | | | | | |
| 92.5 | dark | | | | | | | | |
| 92.5 - | Normal dark greywacke - | | | | | | | | |
| 102.0 | low mineralization - few seams | | | | | | | | |
| 102.0 - | Silicified greywacke - some feldspar | | | | | | | | |
| 125 | seams - very little mineralization - no slips | | | | | | | | |
| 125 - | As above - occasional bands of | | | | | | | | |
| 160.0 | darker slatey greywacke - very fine grained | | | | | | | | |
| | to 2" wide | | | | | | | | |
| 160.0 - | Alteration zone - greywacke with | | | | | | | | |
| 167.0 | igneous products in vein - seams | | | | | | | | |

NORTHERN MINER FORM 505 REV./54

DRILLED BY Bradley Bros. Ltd.

SIGNED _____

[Handwritten Signature]

DIAMOND DRILL RECORD

PROPERTY Huclif Porcupine Mines Ltd. - Parkin Twp. HOLE No. 6
 SHEET NUMBER 5 SECTION FROM 167.0 TO 214.6 STARTED.....
 LATITUDE..... DATUM..... COMPLETED.....
 DEPARTURE..... BEARING..... ULTIMATE DEPTH.....
 ELEVATION..... DIP..... PROPOSED DEPTH.....

| DEPTH FEET | FORMATION | SAMPLE NO. | FROM | TO | WIDTH | ASSAY VALUES | | | |
|------------|--|------------|------|----|-------|--------------|--|--|--|
| | | | | | | | | | |
| 167.0 - | Rhyolitic zone - mixture of | | | | | | | | |
| 185.1 | greywacke and acid volcanics - | | | | | | | | |
| | granular - broken - some pyrrhotite | | | | | | | | |
| | on slips | | | | | | | | |
| 185.1 - | Granitic texture - white seams - | | | | | | | | |
| 211.6 | crystals of hematite - | | | | | | | | |
| | some porphyritic texture of orange | | | | | | | | |
| | feldspar in light grey matrix - | | | | | | | | |
| | Iron formation becomes more | | | | | | | | |
| | evident at 187 to 189 - | | | | | | | | |
| | more granitic at 198 - becomes very red to 211.6 | | | | | | | | |
| 211.6 - | Granite with iron formation | | | | | | | | |
| 214.6 | red - sandstonish | | | | | | | | |
| | Hematite and feldspar | | | | | | | | |

NORTHERN MINER FORM 505 REV./54

DRILLED BY Bradley Bros. Ltd.

SIGNED

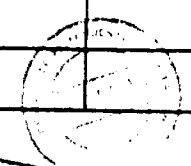

DIAMOND DRILL RECORD

PROPERTY Euclif Porcupine Mines Ltd. - Parkin Twp. HOLE No. 6
 SHEET NUMBER 4 SECTION FROM 214.6 TO end STARTED.....
 LATITUDE..... DATUM..... COMPLETED.....
 DEPARTURE..... BEARING..... ULTIMATE DEPTH.....
 ELEVATION..... DIP..... PROPOSED DEPTH.....

| DEPTH FEET | FORMATION | SAMPLE NO. | FROM | TO | WIDTH | ASSAY VALUES | | | |
|---------------|-----------------------------|------------|------|----|-------|--------------|--|--|--|
| | | | | | | | | | |
| 214.6 | Grey green granitic - some | | | | | | | | |
| 216.0 | Hematite included | | | | | | | | |
| 216.0 - 216.9 | Ground core | | | | | | | | |
| 216.9 - 217.5 | Grey granit. | | | | | | | | |
| 217.5 - 218.1 | Ground core | | | | | | | | |
| 218.1 - 218.7 | Granite - broken | | | | | | | | |
| 218.7 - 219.6 | Ground core | | | | | | | | |
| 219.6 - | Grey granite - porous small | | | | | | | | |
| 222.6 | hematite incl. | | | | | | | | |
| 222.6 - 225 | Ground core | | | | | | | | |
| 225-224 | Grey granite | | | | | | | | |
| 224. | End of hole. | | | | | | | | |
| | | | | | | | | | |
| | | | | | | | | | |

NORTHERN MINER FORM 509 REV./84

DRILLED BY Bradley Bros. Ltd.

SIGNED

S-117087



S-117086

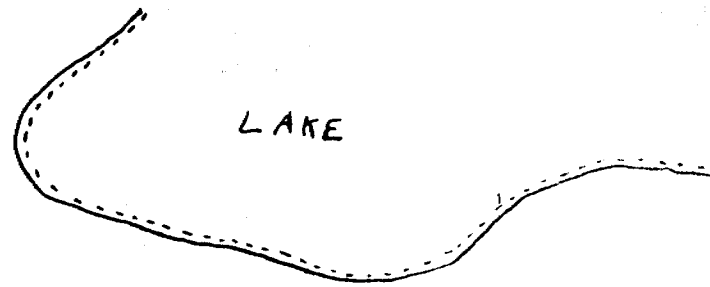

500'

Trench and RKE trench
40' x 6', 4' 9" deep



295'

2 3
0 0
1 20324

430'

Trench and RKE trench
75' x 20', 2' 9" deep



#6
-45°
224'

DDH
25' 46" ...

#5, 220'
-45°

150'

Scale: 
1 inch = 100 feet.

SKETCH OF TRENCHES

PROPERTY HUCLIF PORCUPINE MINES LTD-Parkin Twp. HOLE NO. 7

SHEET NUMBER 1 SECTION FROM _____ TO _____ STARTED June 18, 1965
 LATITUDE S.600' DATUM Cl. Post # 1 - S.117085 COMPLETED June 26, 1965
 DEPARTURE W.50' BEARING N.250° ULTIMATE DEPTH 220
 ELEVATION X DIP -45° PROPOSED DEPTH 218

| DEPTH FEET | FORMATION | SAMPLE NO | WIDTH OF SAMPLE | GOLD \$ | SLUDGE GOLD \$ |
|-------------|---|-----------|------------------|----------|----------------|
| 0.0- 4.0 | Casing | | | | |
| 4.0- 5.4 | Very fine grained greenstone, sugary-grey green colour-alt. sediment 30% quartz-disseminated pyrrhotite, lightly in blebs and in hair slips. | | | | |
| 5.4- 5.8 | Darker Greenstone | | | | |
| 5.8- 40.0 | As from 40'-higher quartz content from 26 to 40' | | | | |
| 40.0- 50.4 | Quartzite gradational from greywacke and greenstone-frequent quartz stringers to 1/2" - med. chalcopryrite blebs, crystals and seams associated with quartz and in core - disseminated. | 1 2 | 40-45' 45-50' | 5' 5' | |
| 50.4- 68.1 | Greenstone, bedded-seams of quartz with pyrrhotite and pyrite in slips - badly broken and fractured. | | | | |
| 68.1- 72.5 | Quartzite - some scattered pyrite. | | | | |
| 72.5- 73.0 | Greenstone-some quartz stringers with disseminated pyrrhotite and pyrite - very little chalco in slips. | | | | |
| 73.0- 75.6 | Greywacke - low mineralization. | | | | |
| 75.6- 76.0 | Slate | | | | |
| 76.0- 77.0 | Greenstone-low mineralization | | | | |
| 77.0- 88.0 | Greywacke - low mineralization | | | | |
| 88.0- 92.7 | Bedded greenstone and greywacke-quartz stringer low sulphides. | | | | |
| 92.7-134.0 | Quartzite-approaching greywacke | | | | |
| 134.0-139.1 | Bedded greenstone and greywacke-some quartz slips and seams with pyrite. | | | | |
| 139.1-146.7 | Quartzite with quartz - altered | | | | |
| 146.7-156.6 | Greenstone and greywacke - banded - v.l. min. | | | | |

**DUPLICATE COPY
 POOR QUALITY ORIGINAL
 TO FOLLOW**

PROPERTY _____

HOLE NO. 7SHEET NUMBER 2

SECTION FROM _____ TO _____

STARTED _____

LATITUDE _____

DATUM _____

COMPLETED _____

DEPARTURE _____

BEARING _____

ULTIMATE DEPTH _____

ELEVATION _____

DIP _____

PROPOSED DEPTH _____

| DEPTH FEET | FORMATION | SAMPLE NO | WIDTH OF SAMPLE | GOLD % | SLUDGE GOLD % | | | |
|--------------|--|-----------|-----------------|--------|---------------|--|--|--|
| 156.6-160.0 | Quartzite - fractured | | | | | | | |
| 160.0-162.0 | Ground or cave | | | | | | | |
| 162.0-202.0 | Quartzite-silicified-approaching greywacke - quartz stringer - becomes lighter and more green 185-188 and 195-202. | | | | | | | |
| 202.0-207.0 | Quartzite approaching greywacke -blebs and splotches of quartz-slatey slips-possible slickenslides or movement polishing - low mineralization. | | | | | | | |
| 207.0-218.0 | Greywacke becomes more green and approaching greenstone - slatey slips. | | | | | | | |
| 218 | End of Hole. | | | | | | | |
| Drilled by : | Bradley Bros. Ltd. | | | | | | | |

**DUPLICATE COPY
POOR QUALITY ORIGINAL
TO FOLLOW**

DIAMOND DRILL RECORD

PROPERTY NUCLIF PORCUPINE MINES LTD. - Parkin Twp. HOLE No. 7
 SHEET NUMBER 1 SECTION FROM 0 TO 50.4' STARTED June 18, 1965
 LATITUDE S. 800' DATUM Cl. Post #1 - S. 117085 COMPLETED June 28, 1965
 DEPARTURE N. 50' BEARING N. 250° ULTIMATE DEPTH 220
 ELEVATION X DIP -45° PROPOSED DEPTH 218

| DEPTH FEET | FORMATION | SAMPLE NO. | FROM | TO | WIDTH | ASSAY VALUES | | | |
|------------|---|------------|------|-----|-------|--------------|--|--|--|
| | | | | | | | | | |
| 0 - 4 | Casing | | | | | | | | |
| 4 - 5.4 | Very fine grained greenstone, sugary - gray green colour - alt. sediment 30% quartz - disseminated pyrrhotite lightly in blebs and in hair slips | | | | | | | | |
| 5.4 - 5.8 | Darker greenstone | | | | | | | | |
| 5.8 - | As from 40' - higher quartz content | | | | | | | | |
| 40.0 | from 28 to 40' | | | | | | | | |
| 40.0 - | Quartzite gradational from graywacke | 1 | 40' | 45' | 5 | | | | |
| 50.4 | and greenstone - frequent quartz stringers to 1/2" - med. chalcocite blebs, crystals and seams associated with quartz and in core - disseminated | 2 | 45' | 50' | 5 | | | | |

NORTHERN MINER FORM 505 REV. 1964

DRILLED BY Bradley Bros. Limited

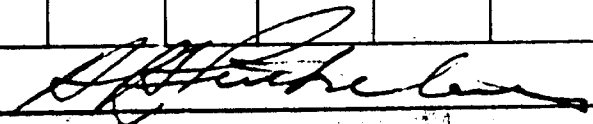
SIGNED 

DIAMOND DRILL RECORD

PROPERTY HUGLIF PORCUPINE MINES LTD. - Parkin Twp. HOLE No. 7
 SHEET NUMBER 2 SECTION FROM 50.4' TO 92.7' STARTED June 18, 1965
 LATITUDE S. 600' DATUM Cl. Post #1 - S. 117085 COMPLETED June 28, 1965
 DEPARTURE W. 50' BEARING N. 250° ULTIMATE DEPTH 220
 ELEVATION X DIP -45° PROPOSED DEPTH 218

| DEPTH FEET | FORMATION | SAMPLE NO. | FROM | TO | WIDTH | ASSAY VALUES | | | |
|------------|--|------------|------|----|-------|--------------|--|--|--|
| | | | | | | | | | |
| 50.4 - | Greenstone, bedded - seams of quartz | | | | | | | | |
| 61.1 | with pyrrhotite and pyrite in slips - badly broken and fractured | | | | | | | | |
| 68.1 - | Quartzite - some scattered | | | | | | | | |
| 72.5 | pyrite | | | | | | | | |
| 72.5 - | Greenstone - some quartz stringers with | | | | | | | | |
| 75.0 | disseminated pyrrhotite and pyrite - very little chalc in slips | | | | | | | | |
| 75 - 75.6 | Graywacke - low mineralization | | | | | | | | |
| 75.6-76 | Slate | | | | | | | | |
| 76 - 77 | Greenstone - low mineralization | | | | | | | | |
| 77 - 88 | Graywacke - low mineralization | | | | | | | | |
| 88-92.7 | Banded greenstone and graywacke - quartz stringer - low sulphides | | | | | | | | |

NORTHERN MINER FORM 505 REV 1/54

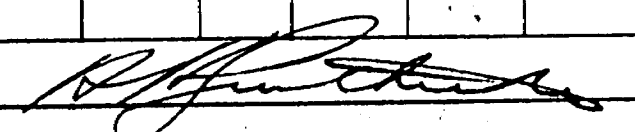
DRILLED BY Bradley Bros. Limited SIGNED 

DIAMOND DRILL RECORD

PROPERTY HUGLIF PORCUPINE MINES LTD. - Parkin Twp. HOLE No. 7
 SHEET NUMBER 5 SECTION FROM 82.7' TO 207' STARTED June 18, 1965
 LATITUDE S. 600' DATUM Cl. Post #1 - S.117085 COMPLETED June 26, 1965
 DEPARTURE W. 50' BEARING N02°250' ULTIMATE DEPTH 220
 ELEVATION X DIP -45° PROPOSED DEPTH 218

| DEPTH FEET | FORMATION | SAMPLE NO. | FROM | TO | WIDTH | ASSAY VALUES | | | |
|-------------|---|------------|------|----|-------|--------------|--|--|--|
| | | | | | | | | | |
| 82.7-154 | Quartzite - approaching greywacke | | | | | | | | |
| 154.0 - | Banded greenstone and greywacke - | | | | | | | | |
| 159.1 | some quartz slips and seams with pyrite | | | | | | | | |
| 159.1-146.7 | Quartzite with quartz - altered | | | | | | | | |
| 146.7-156.6 | Greenstone and greywacke - banded - v.l. min. | | | | | | | | |
| 156.6-160 | Quartzite - fractured | | | | | | | | |
| 160-162 | Ground or cave | | | | | | | | |
| 162-202 | Quartzite-silicified-approaching greywacke - quartz stringer - becomes lighter and more green 185-188 and 195-202 | | | | | | | | |
| 202-207 | Quartzite approaching greywacke - blebs and splotches of quartz - slaty slips - possible slickensides or movement polishing - low mineralization | | | | | | | | |

NORTHERN MINER FORM 908 REV./54

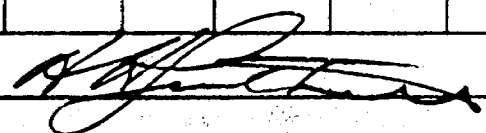
DRILLED BY Bradley Bros. Limited SIGNED 

DIAMOND DRILL RECORD

PROPERTY HUCLEF PORCUPINE MINES LTD. - Parkin Twp. HOLE No. 7
 SHEET NUMBER 4 SECTION FROM 207' TO 218' STARTED June 18, 1965
 LATITUDE N. S. 6001 DATUM Cl. Post #1 - S. 117085 COMPLETED June 26th, 1965
 DEPARTURE S.W. 50' BEARING N. 250° ULTIMATE DEPTH 220
 ELEVATION X DIP - 45° PROPOSED DEPTH 218

| DEPTH FEET | FORMATION | SAMPLE NO. | FROM | TO | WIDTH | ASSAY VALUES | | | |
|------------|---|------------|------|----|-------|--------------|--|--|--|
| | | | | | | | | | |
| 207-218 | Greywacke becomes more green and approaching greenstone - slaty slips | | | | | | | | |
| 218 | End of hole. | | | | | | | | |
| | | | | | | | | | |
| | | | | | | | | | |
| | | | | | | | | | |
| | | | | | | | | | |
| | | | | | | | | | |
| | | | | | | | | | |
| | | | | | | | | | |
| | | | | | | | | | |
| | | | | | | | | | |
| | | | | | | | | | |
| | | | | | | | | | |
| | | | | | | | | | |
| | | | | | | | | | |
| | | | | | | | | | |
| | | | | | | | | | |
| | | | | | | | | | |
| | | | | | | | | | |
| | | | | | | | | | |
| | | | | | | | | | |
| | | | | | | | | | |

NORTHERN MINER FORM 808 REV./64

DRILLED BY Bradley Bros. Limited

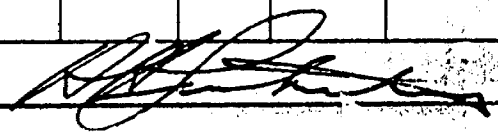
SIGNED 

LOCATION OF R.R. IN
 PARKIN TOWNSHIP
 ONTARIO
 HULLIFF OPTION.

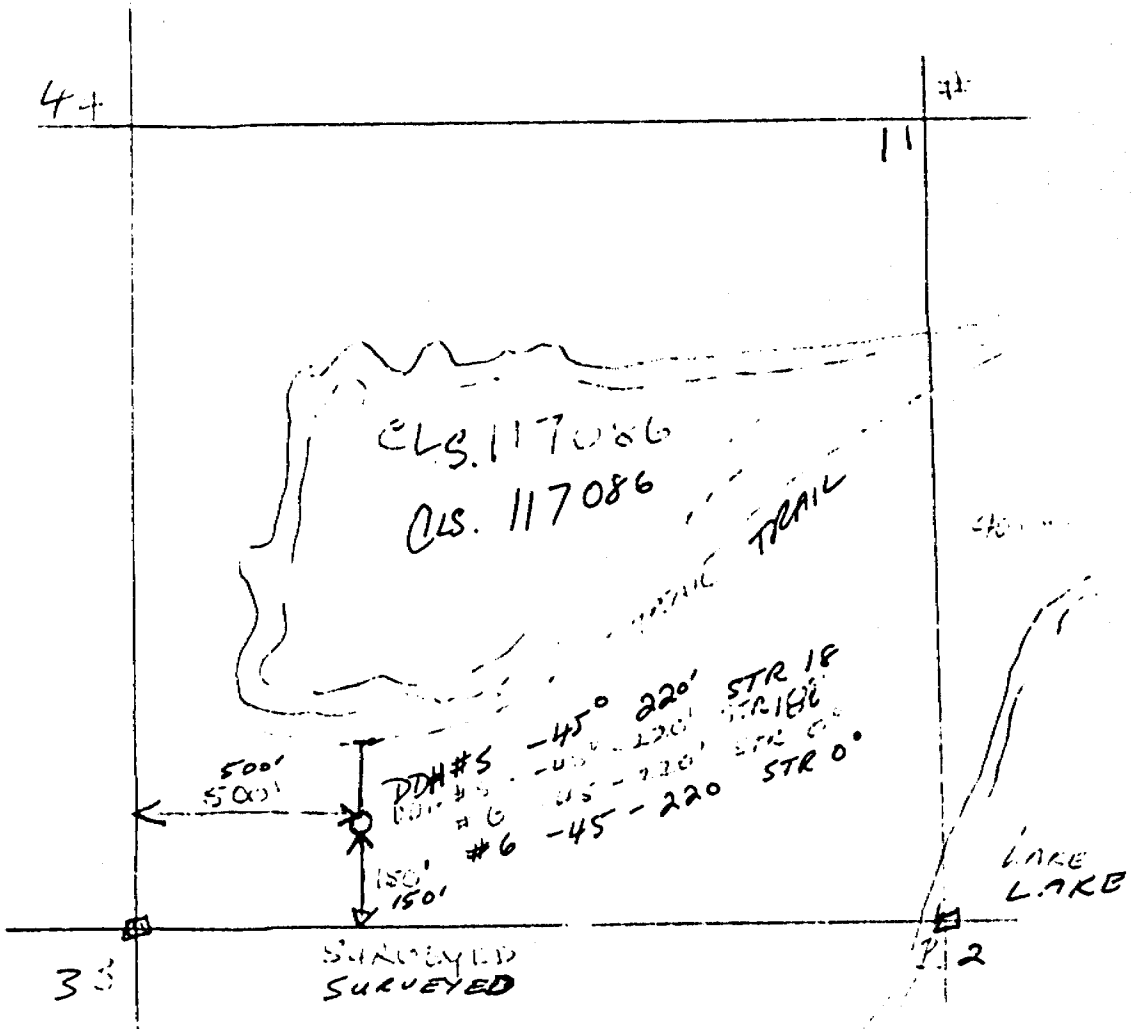

H. H. Hulliff



Dated May 18-29-1965

not to scale

S 117807

#1 POST

600'S

#7

250'
220'

50' W

S 117065

S 117086

500'
500'

TRAIL

150'
150'
120'
120'
66
5.5
5.5

S 117808

LOCATION OF
DIAMOND DRILL
HOLE # 7

HUGLIEF-PARKIN OPTION

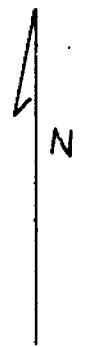

HOLE LOCATION
FROM #1 POST
CL S 117085'
600'S
50' W
DIP. -45°
LENGTH 220'
BEARING 250°



B. L. Bethlem
July 65
SCALE 1" = 400'

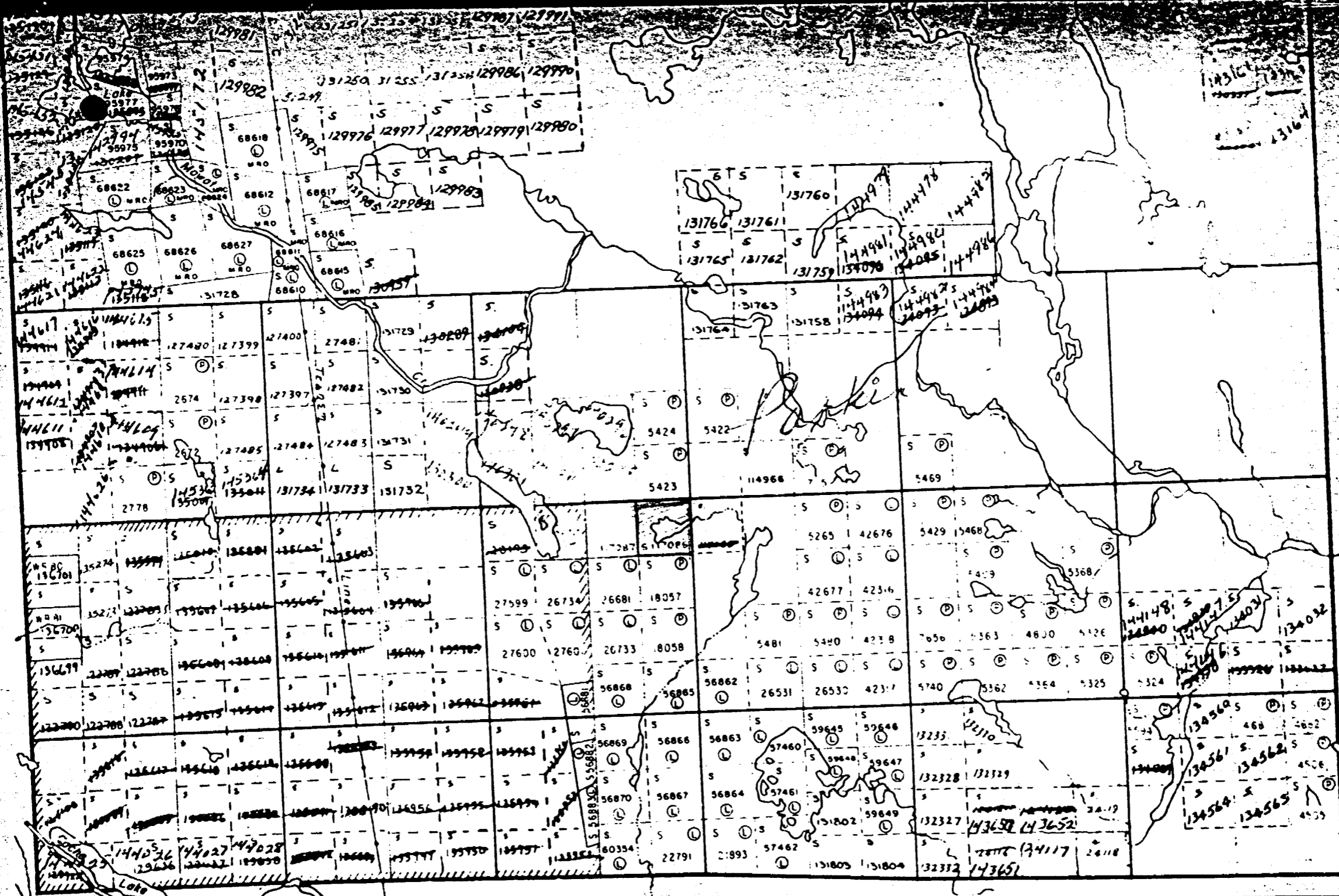

4115NWE15 00141 PARKIN



000

AY 1978

Fraleck Twp. M-816

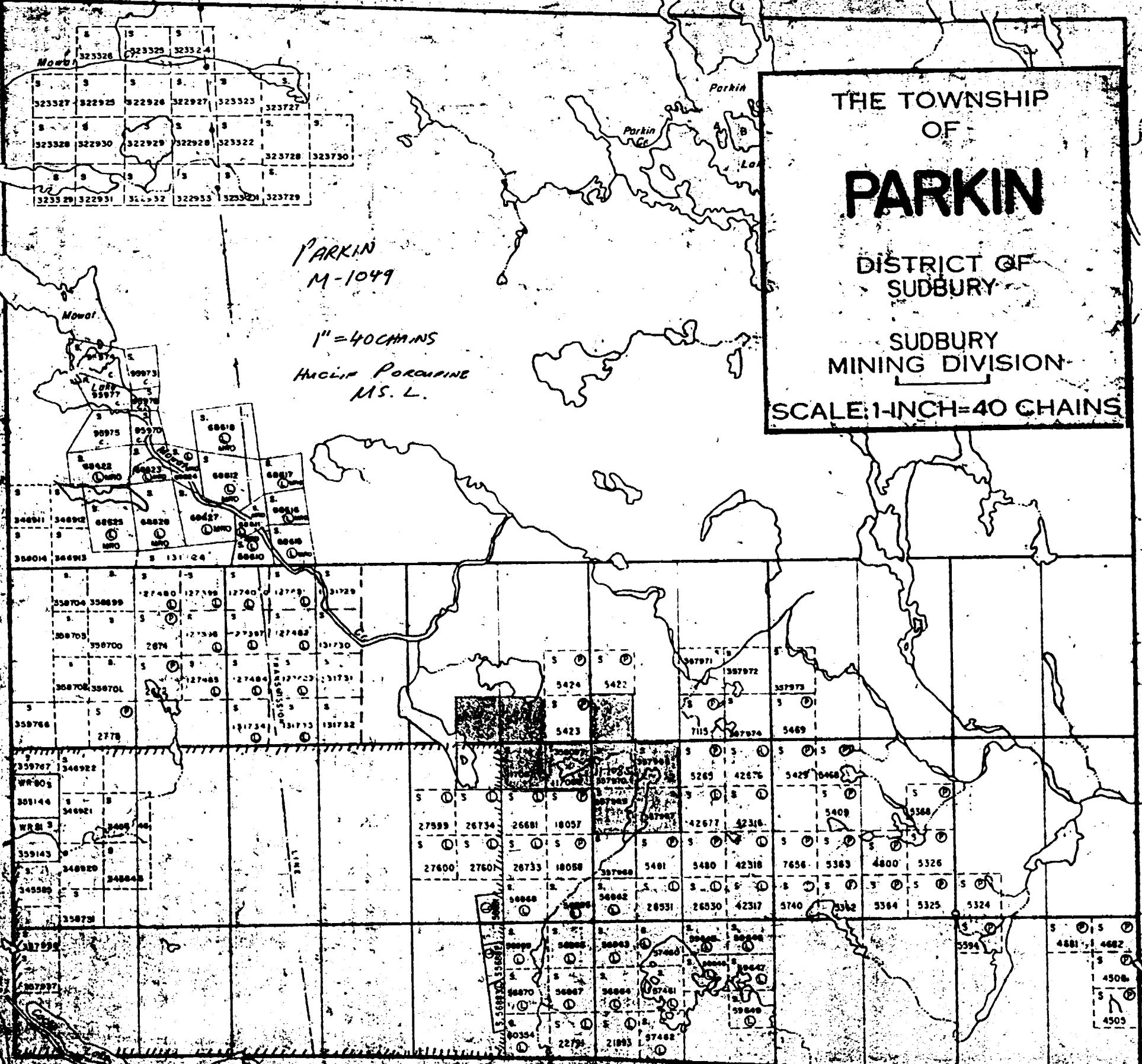

THE TOWNSHIP
OF
PARKIN
DISTRICT OF
SUDBURY
SUDBURY
MINING DIVISION
SCALE: 1 INCH = 40 CHAINS

PARKIN
M-1049
1" = 40 CHAINS
HURON PARKIN
M.S.L.

Huron Twp. M-944

Aylmer Twp. M-641



| | | |
|--------|--------|--------|
| 323326 | 323325 | 323324 |
| 323327 | 322925 | 322926 |
| 323328 | 322930 | 322929 |
| 323329 | 322931 | 322932 |

| | | |
|-------|-------|-------|
| 90973 | 90974 | 90975 |
| 90976 | 90977 | 90978 |
| 90979 | 90980 | 90981 |
| 90982 | 90983 | 90984 |

| | | |
|--------|--------|--------|
| 358704 | 358705 | 358706 |
| 358707 | 358708 | 358709 |
| 358710 | 358711 | 358712 |
| 358713 | 358714 | 358715 |

| | | |
|--------|--------|--------|
| 359767 | 359768 | 359769 |
| 359770 | 359771 | 359772 |
| 359773 | 359774 | 359775 |
| 359776 | 359777 | 359778 |

| | | |
|-------|-------|-------|
| 27480 | 27481 | 27482 |
| 27483 | 27484 | 27485 |
| 27486 | 27487 | 27488 |
| 27489 | 27490 | 27491 |

| | | |
|-------|-------|-------|
| 27593 | 27594 | 27595 |
| 27596 | 27597 | 27598 |
| 27599 | 27600 | 27601 |
| 27602 | 27603 | 27604 |

| | | |
|------|------|------|
| 5424 | 5425 | 5426 |
| 5427 | 5428 | 5429 |
| 5430 | 5431 | 5432 |
| 5433 | 5434 | 5435 |

| | | |
|------|------|------|
| 5265 | 5266 | 5267 |
| 5268 | 5269 | 5270 |
| 5271 | 5272 | 5273 |
| 5274 | 5275 | 5276 |

| | | |
|------|------|------|
| 5409 | 5410 | 5411 |
| 5412 | 5413 | 5414 |
| 5415 | 5416 | 5417 |
| 5418 | 5419 | 5420 |

| | | |
|------|------|------|
| 4881 | 4882 | 4883 |
| 4884 | 4885 | 4886 |
| 4887 | 4888 | 4889 |
| 4890 | 4891 | 4892 |