



4115SE0045 30 RATHBUN

010

DIAMOND DRILLING

TOWNSHIP: RATHBUN

REPORT NO: #30

WORK PERFORMED FOR: Augdome Corp. Ltd.

RECORDED HOLDER: Same as Above (xx)  
: Other ( )

| <u>Claim No.</u> | <u>Hole No.</u> | <u>Footage</u> | <u>Date</u> | <u>Note</u> |
|------------------|-----------------|----------------|-------------|-------------|
| 574962           | R89-1           | 353'           | Aug/89      | (1)         |
|                  | R89-2           | 351'           | Aug/89      | (1)         |

NOTES: (1) W8907-103 date filed Oct/89

# DIAMOND DRILL RECORD

NAME OF PROPERTY AUCDOME CORP. LTD.  
 HOLE NO. R89-1 LENGTH 353.0'  
 LOCATION Rathbun Twp. BQ Core  
 LATITUDE \_\_\_\_\_ DEPARTURE \_\_\_\_\_  
 ELEVATION \_\_\_\_\_ AZIMUTH 045 DIP -45  
 STARTED Aug 15 FINISHED Aug 17/89

| FOOTAGE | DIP | AZIMUTH | FOOTAGE | DIP | AZIMUTH |
|---------|-----|---------|---------|-----|---------|
| 0       | -45 | 045     |         |     |         |
|         |     |         |         |     |         |
|         |     |         |         |     |         |
|         |     |         |         |     |         |

HOLE NO. R89-1 SHEET NO. 1

REMARKS CLAIM 574962

LOGGED BY [Signature]

| FOOTAGE |      | DESCRIPTION   | SAMPLE |             |              |       | ASSAYS |      |   |              |        |
|---------|------|---|--------|-------------|--------------|-------|--------|------|---|--------------|--------|
| FROM    | TO   |   | NO.    | % SULPHIDES | FOOTAGE FROM | TO    | TOTAL  | %    | % | Al<br>OZ/TON | OZ/TON |
| 0       | .5'  | <u>CASING</u> - No Core recovered - bedrock set-up  |        |             |              |       |        |      |   |              |        |
| .5      | 353' | <u>GREYWACKE</u> - dark grey, fine grained siltstone, glassy siliceous, massive homogeneous to 315'<br>- slight fracture/lineation (bedding?) @50 t.c.a.<br>- from 0-7' core has odd bleb py along fractures specks chlorite or carb. amygs.<br>- after 82' increased py cubes + alt. with small qtz. filled fractures from 83.0-83.5'<br>- increasingly rusty with light carb./sil. alteration from 83.5-86' <u>SAMPLE A-1</u><br>- From 86-87.0' - 1' qtz vein @45 t.c.a./white but qtz. poorly mineralized except odd py bleb @lonce contact (1/2") <u>SAMPLE A-2</u><br>- from 87-89.0': grades to dark grey, massive greywacke with carb.amygs. <u>SAMPLE-3</u><br>- Increased burcreation/fracturing from 149-157'<br>- odd carb. stringer/frost. filling @45 c.a. up to 157'<br>- from 222-223' (1" q.v. in altered/bleached core @60 t.c.a. w. lot of micro fracturing <u>SAMPLE A-4</u><br>- from 224-225' 2" q.v. @ 60 t.c.a. + rusty blobs on footwall + hangingwalls + 6" microfracturing on both sides |        |             |              |       |        |      |   |              |        |
|         |      |   | 56     | 801         | 1/2          | 82.0  | 86.0   | 3.0' |   |              | .003   |
|         |      |   | 56     | 802         | 2-3%         | 86.0  | 87.0   | 1.0' |   |              | .007   |
|         |      |   | 56     | 803         | 1/2          | 87.0  | 89.0   | 2.0' |   |              | .004   |
|         |      |   | 56     | 804         | 1/2          | 222.0 | 223.0  | 1.0' |   |              | .001   |
|         |      |   | 56     | 805         |              | 224.0 | 225.0  | 1.0' |   |              | .002   |

# DIAMOND DRILL RECORD

NAME OF PROPERTY AUGDOME CORP. LTD.  
 HOLE NO. R89-1 LENGTH \_\_\_\_\_  
 LOCATION Rathbun Twp  
 LATITUDE \_\_\_\_\_ DEPARTURE \_\_\_\_\_  
 ELEVATION \_\_\_\_\_ AZIMUTH \_\_\_\_\_ DIP \_\_\_\_\_  
 STARTED Aug 15 FINISHED Aug 17/89

| FOOTAGE | DIP | AZIMUTH | FOOTAGE | DIP | AZIMUTH |
|---------|-----|---------|---------|-----|---------|
|         |     |         |         |     |         |
|         |     |         |         |     |         |
|         |     |         |         |     |         |
|         |     |         |         |     |         |

HOLE NO. R89-1 SHEET NO. 2  
 REMARKS CL. S. 574.2

LOGGED BY [Signature]

| FOOTAGE |    | DESCRIPTION   | SAMPLE |             |         |       | ASSAYS |   |   |           |        |
|---------|----|---|--------|-------------|---------|-------|--------|---|---|-----------|--------|
| FROM    | TO |   | NO.    | % SULPHIDES | FOOTAGE |       |        | % | % | AU OZ/TON | OZ/TON |
|         |    |   |        |             | FROM    | TO    | TOTAL  |   |   |           |        |
|         |    | - @ 225.0' less than lft section w. tension fractures w. carb. filling - core generally broken/brittle to + 240' (sheared or sil.)  |        |             |         |       |        |   |   |           |        |
|         |    | - @ 271.0' - qtz. vein (1") with bleached/alteration from 269-275.0' <u>SAMPLE A-6</u> 56   | 806    | poor 5%     | 271.0   | 272.5 | 1.5'   |   |   | .013      |        |
|         |    | +2" q.v. @ 272.5 w. sulphide stringers @ 70 t.c.a. (55 t.c.a.)  |        |             |         |       |        |   |   |           |        |
|         |    | - <u>Foot wall section</u> - 2' zone with bleached/ alt. core with qtz. stringer. <u>SAMPLE A-7</u> 56  | 807    | poor        | 272.5   | 273.5 | 1.0'   |   |   | .001      |        |
|         |    | - <u>after 315'</u> - observed coarse pebbles/cobbles of rounded igneous material (Gowganda Fm. ?) w. increased carb. fracture filling along fractures @ 75 c.a. @ all angles |        |             |         |       |        |   |   |           |        |
|         |    | - increased alt./bleached core from 329-333' with 1" + 2" qtz. veins @ 70 t.c.a. + red carb. filling from 330-331' <u>SAMPLE A-8: 333-336' rusty broken core</u> 56           | 808    | ?           | 330.0   | 331.0 | 1.0    |   |   | .001      |        |
|         |    | <u>SAMPLE A-9</u> - q.v. @ 337.5' (1/2") + 341.5 (6") @ 60 t.c.a. w. buff alt 56  | 809    | poor        | 341.0   | 342.0 | 1.0    |   |   | .001      |        |
|         |    | 353.0' END OF HOLE in bleached, alt. core   |        |             |         |       |        |   |   |           |        |

ANGRIGES - TORONTO - 366-1168

# DIAMOND DRILL RECORD

NAME OF PROPERTY AUGDOME CORP. LTD.  
 HOLE NO. R89-2 LENGTH 351.0'  
 LOCATION \_\_\_\_\_  
 LATITUDE \_\_\_\_\_ DEPARTURE \_\_\_\_\_  
 ELEVATION \_\_\_\_\_ AZIMUTH \_\_\_\_\_ DIP -45  
 STARTED Aug 17 FINISHED Aug 19/89

| FOOTAGE | DIP | AZIMUTH | FOOTAGE | DIP | AZIMUTH |
|---------|-----|---------|---------|-----|---------|
|         |     |         |         |     |         |
|         |     |         |         |     |         |
|         |     |         |         |     |         |
|         |     |         |         |     |         |

HOLE NO. R89-2 SHEET NO. 1  
 REMARKS core @ drill  
site  
CL. 574962

LOGGED BY [Signature]

| FOOTAGE |      | DESCRIPTION   | SAMPLE |             |              |            | ASSAYS        |   |   |           |           |
|---------|------|---|--------|-------------|--------------|------------|---------------|---|---|-----------|-----------|
| FROM    | TO   |   | NO.    | % SULPHIDES | FOOTAGE FROM | FOOTAGE TO | FOOTAGE TOTAL | % | % | AU OZ/TON | CU OZ/TON |
| 0       | 2.0' | CASING - No core recovered  |        |             |              |            |               |   |   |           |           |
| 2.0'    |      | GREYWACKE - dark grey massive, broken & fractured to 10'<br>- from 15'-59' - speckled with carbonate, altered bleached buff brown with less 1% disseminated py all through<br>- qtz. vn. @ 15 t.c.a. @ 23.0 <u>SAMPLE B-1</u> 56 810 ½ 23.0 24.0 1.0' .001<br>- altered buff color w. diss.py <u>SAMPLE B-2</u> 56 811 poor 40.0 41.0 1.0' .001<br>- after 59-130' grades to darker more massive gwke<br><u>SAMPLE B-3</u> bull qtz, glassy, milky 56 812 poor 44.5 46.0 1.5' .002<br>@ 30 t.c.a.<br><u>SAMPLE B-4</u> py. in lower contact ½-1 59.0 60.0 1.0' .001<br>@ 59-60' cubic + diss. py<br>w. odd fract./slip w. diss. py @ 65-66'<br>@ 67', 369'<br>- core broken @ 65-66'; hint of lineation @ 80 t.c.a.<br>- odd rusty fracture with increased carb. amyg after 130'; some broken sections 136-137', 143-144', 182-183' 162-163' due to sil./brittleness + carb. fracture filling<br>- @ 177' lineation/bedding @ 45 c.a.<br>- from 238-242' core bleached sil/felspar with lineation/bedding @ 45-50 t.c.a. - micro folded |        |             |              |            |               |   |   |           |           |

INGRIDGES - TORONTO - 368-1168

# DIAMOND DRILL RECORD

NAME OF PROPERTY AUGDOME CORP. LTD.  
 HOLE NO. R89-2 LENGTH 351.0'  
 LOCATION Ratibun Twp.  
 LATITUDE \_\_\_\_\_ DEPARTURE \_\_\_\_\_  
 ELEVATION \_\_\_\_\_ AZIMUTH \_\_\_\_\_ DIP \_\_\_\_\_  
 STARTED \_\_\_\_\_ FINISHED \_\_\_\_\_

| FOOTAGE | DIP | AZIMUTH | FOOTAGE | DIP | AZIMUTH |
|---------|-----|---------|---------|-----|---------|
|         |     |         |         |     |         |
|         |     |         |         |     |         |
|         |     |         |         |     |         |
|         |     |         |         |     |         |

HOLE NO. R89-2 SHEET NO. 2  
 REMARKS cc. 574962

LOGGED BY [Signature]

| FOOTAGE |    | DESCRIPTION  | SAMPLE |             |         |     | ASSAYS |      |       |        |        |  |
|---------|----|--|--------|-------------|---------|-----|--------|------|-------|--------|--------|--|
| FROM    | TO |  | NO.    | % SULPHIDES | FOOTAGE |     | %      | %    | AU    |        |        |  |
|         |    |  |        |             | FROM    | TO  |        |      | TOTAL | OZ/TON | OZ/TON |  |
|         |    | - after 242' darker f.g. greywacke with lin. @ 257'<br>@ 50-70 t.c.a.<br>- after 267' more homogeneous, dark grey<br>- after 282' observed cobbles up to 4" of granitic<br>composition in dk. f.g. gwke. matrix<br>- after 319' increased carb. specks + micro fracturing<br>w. carb. filling<br>From 325-326' - red, granitic fragment w. odd blk<br>py diss. on contacts, odd glassy sil. section @ 327.5'<br>with marbled look - hint of lineation @ 70 t.c.a.<br><u>SAMPLE B-5</u> | 56     | 813         | poor    | 325 | 326.0  | 1.0' |       |        | .001   |  |
| 351.0   |    | END OF HOLE  |        |             |         |     |        |      |       |        |        |  |

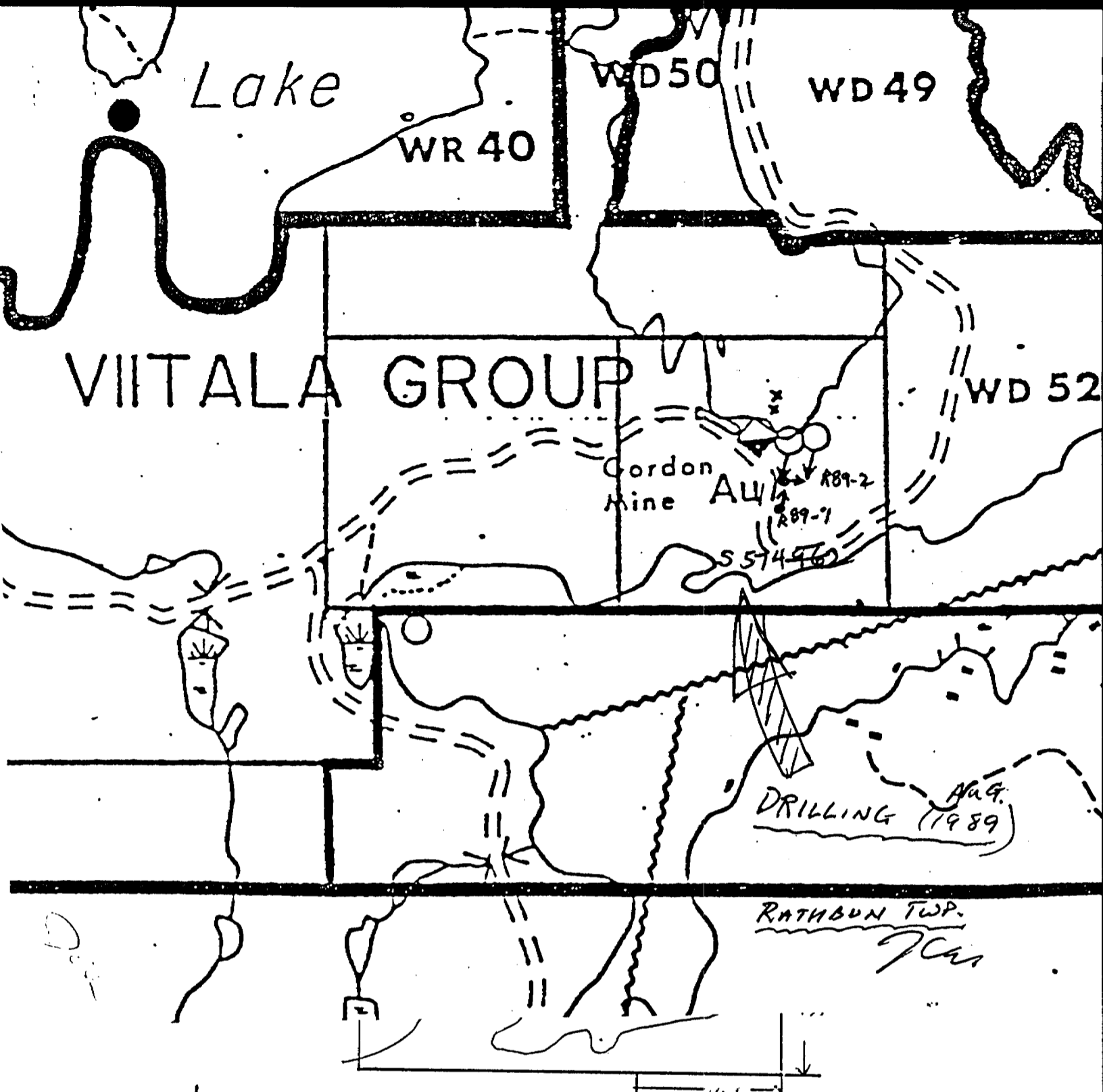

CLAIM  
 S. 574962  
 RATHBUN TWP.

|       | <u>Angle</u> | <u>Depth</u> |
|-------|--------------|--------------|
| R89-1 | - 45° ENE    | 353.0'       |
| R89-2 | - 45° E.     | 351.0'       |
|       |              | <u>704'</u>  |

*Examined*

*Jan*

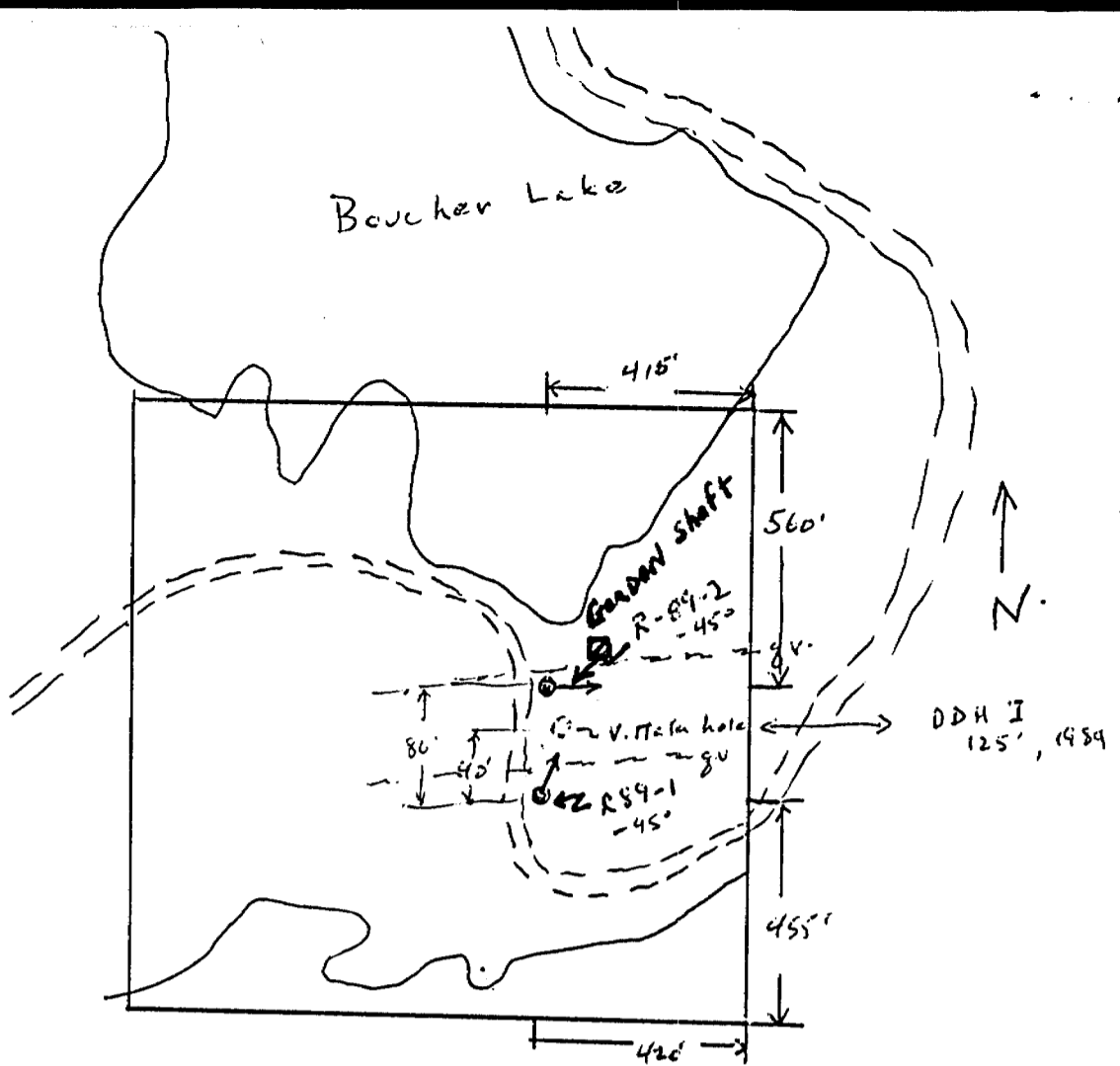

CLAIM

S. 574962

RATHBUN TWP.

|       | <u>Angle</u> | <u>Dist</u> |
|-------|--------------|-------------|
| R89-1 | -45° ENE     | 353.0'      |
| R89-2 | -45° E.      | 351.0'      |
|       |              | <u>704'</u> |

*Examined*

*OK*



Ministry of Northern Development and Mines

Report of Work

DOCUMENT No. W8907-103



411155E0045 30 RATHBUN

900

**Rathburn Type (M.1071) Mining Act**

Name and Postal Address of Recorded Holder: AGG DOME CORP. LTD.  
31 JUTLAND Rd. TORONTO, ONT. M8Z 2G6

License No.: T.850

Summary of Work Performance and Distribution of Credits

| Total Work Days Cr. claimed<br><b>MN 700 695</b>        | Mining Claim |         | Work Days Cr. | Mining Claim |        | Work Days Cr. | Mining Claim |        | Work Days Cr. |
|---|--------------|---------|---------------|--------------|--------|---------------|--------------|--------|---------------|
|   | Prefix       | Number  |               | Prefix       | Number |               | Prefix       | Number |               |
| for Performance of the following work. (Check one only) | S            | 874550  | 95            |              |        |               |              |        |               |
|   |              | 874551  | 95            |              |        |               |              |        |               |
|   |              | 874552  | 100           |              |        |               |              |        |               |
|   |              | 943 620 | 135           |              |        |               |              |        |               |
|   |              | 943 621 | 135           |              |        |               |              |        |               |
|   | 443 622      | 135     |               |              |        |               |              |        |               |

All the work was performed on Mining Claim(s): 574 962

Required Information eg: type of equipment, Names, Addresses, etc. (See Table Below)

Colbert DIAMOND DRILLING  
167 LAKESHORE LANE  
TIMMINES, ONT.

2 HOLES  
FOOTAGE: 700 FT.  
BQ SIZE  
45° ANGLES

Peter Colbert  
Edward Colbert address same as above.

**RECORDED**  
**SEP 26 1989**  
 Receipt # MF

ONTARIO GEOLOGICAL SURVEY  
 ASSESSMENT FILES OFFICE  
**SEP 27 1989**  
**RECEIVED**

SUDBURY MINING DIV.  
**RECEIVED**  
**AUG 24 1989**  
 A.M. 7|8|9|10|11|12|1|2|3|4|5|6 P.M.  
K.S.

Date of Report: Aug. 8/89. Recorded Holder or Agent (Signature): [Signature]

Certification Verifying Report of Work

I hereby certify that I have a personal and intimate knowledge of the facts set forth in the Report of Work annexed hereto, having performed the work or witnessed same during and/or after its completion and the annexed report is true.

Name and Postal Address of Person Certifying: JOHN C. ALCHIBAD  
57 Cheriton Ave  
TORONTO, ONT M4R 1S7

Date Certified: Aug 8/89. Certified by (Signature): [Signature]

Table of Information/Attachments Required by the Mining Recorder

| Type of Work  | Specific information per type  | Other information (Common to 2 or more types)   | Attachments  |
|---|--|---|--|
| Manual Work   | Nil  | Names and addresses of men who performed manual work/operated equipment, together with dates and hours of employment. | Work Sketch: these are required to show the location and extent of work in relation to the nearest claim post. |
| Shaft Sinking, Drifting or other Lateral Work           |  |   |  |
| Compressed air, other power driven or mechanical equip. | Type of equipment  | Names and addresses of owner or operator together with dates when drilling/stripping done.                            | Work Sketch (as above) in duplicate  |
| Power Stripping   | Type of equipment and amount expended. Note: Proof of actual cost must be submitted within 30 days of recording. |   |  |
| Diamond or other core drilling                          | Signed core log showing: <u>footage, diameter of core, number and angles of holes.</u>                           | Nil   | Nil  |
| Land Survey   | Name and address of Ontario land surveyer.   |   |  |



CL 4314 Part 1 S.R.O.  
DE 158  
GH 188

**LEGEND**

- PATENTED LAND
  - PATENTED FOR SURFACE RIGHTS ONLY
  - LEASE
  - LICENSE OF OCCUPATION
  - CROWN LAND SALES
  - LOCATED LAND
  - CANCELLED
  - MINING RIGHTS ONLY
  - SURFACE RIGHTS ONLY
  - HIGHWAY & ROUTE NO.
  - ROADS
  - TRAILS
  - RAILWAYS
  - POWER LINES
  - MARSH OR MUSKEL
  - MINES
  - ORIGINAL SHORELINE
- \* used only with summer resort locations or ...

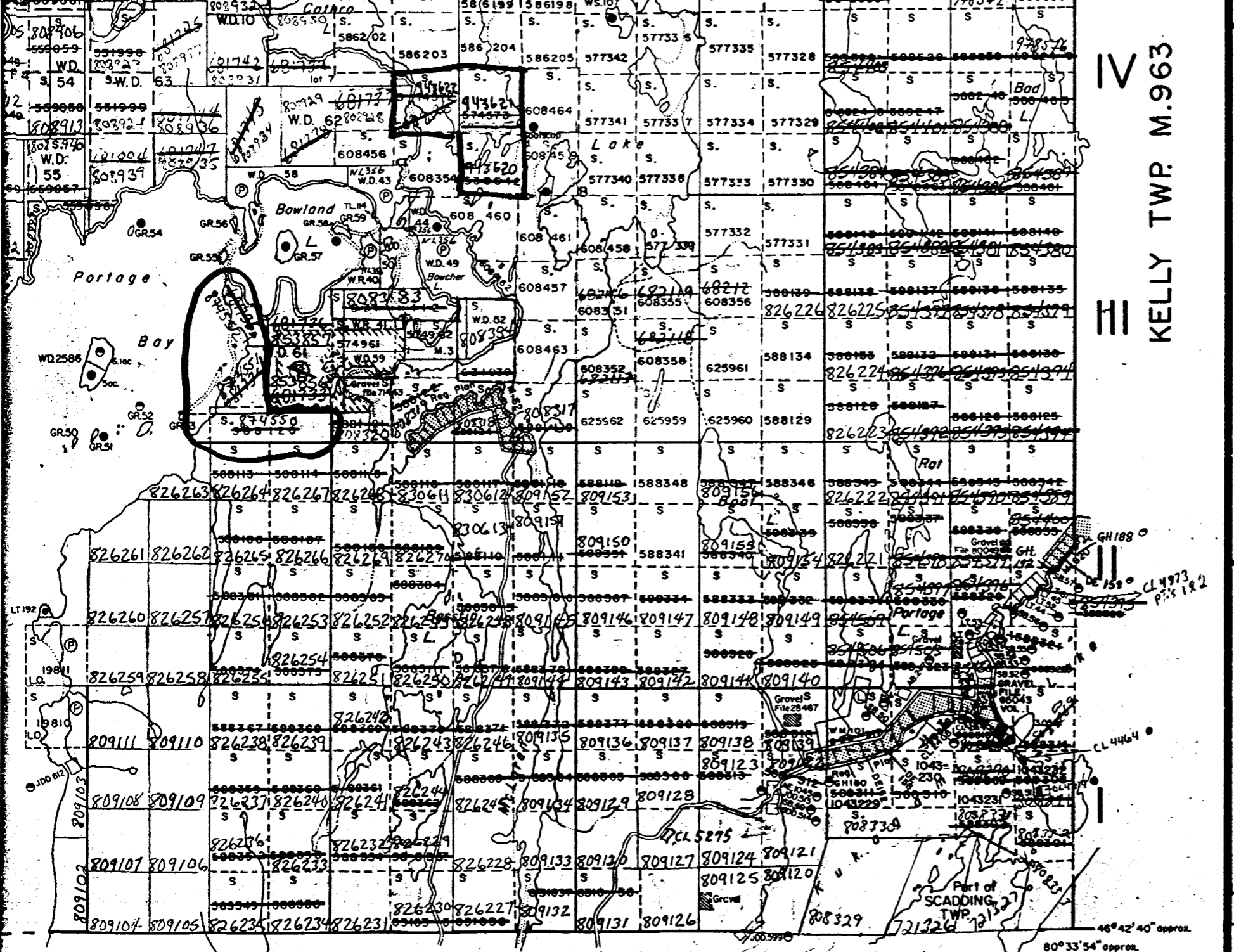

IV  
KELLY TWP. M.963  
III

TOWNSHIP OF

# RATHBUN

DISTRICT OF  
SUDBURY

SUDBURY  
MINING DIVISION

SCALE : 1 INCH = 40 CHAINS (1/2 MILE)

DR. D.T.  
DATE APR /72

PLAN NO. **M.1071**

SCADDING TWP. M.1092

ONTARIO  
MINISTRY OF NATURAL RESOURCES