



THE MINING ACT - DEPARTMENT OF MINES
DIAMOND DRILLING LOG

Start a new page for every new hole, but fill in top portion of form only on first page for each hole.

FILL IN ON EVERY PAGE

HOLE NO. **L-3** PAGE NO. **1**

DRILLING COMPANY		COLLAR ELEVATION	BEARING OF HOLE FROM TRUE NORTH	TOTAL FOOTAGE	DIP OF HOLE AT COLLAR	LOCATION OF HOLE IN RELATION TO A FIXED POINT ON THE CLAIM	MAP REFERENCE NO.	CLAIM NO.
DATE HOLE STARTED	DATE COMPLETED	DATE LOGGED	LOGGED BY					
EXPLORATION CO. OWNER OR OPTIONEE		DATE SUBMITTED	SUBMITTED BY (Signature)			PROPERTY NAME	LOCATION (Tp., Lot, Con. OR Lat. and Long.)	

FOOTAGE		ROCK TYPE	DESCRIPTION Colour, grain size, texture, minerals, alteration, etc.	PLANAR FEATURE ANGLE	CORE SPECIMEN FOOTAGE*	YOUR SAMPLE NUMBER	SAMPLE FOOTAGE		SAMPLE LENGTH	ASSAYS
FROM	TO						FROM	TO		
0	5	Granite								
5	20	Granite	big columnar mass of coarse grained							
20	50	Granite	massive granitic							
50	75	Granite	massive granitic							
75	100	Granite	massive granitic							
100	121	Granite	massive granitic							

* For features such as foliation, bedding, schistosity, measured from the long axis of the core.



THE MINING ACT - DEPARTMENT OF MINES
DIAMOND DRILLING LOG

Start a new page for every new hole, but fill in top portion of form only on first page for each hole.

FILL IN ON EVERY PAGE

HOLE NO. D-1 PAGE NO. 1

DRILLING COMPANY		COLLAR ELEVATION	BEARING OF HOLE FROM TRUE NORTH South	TOTAL FOOTAGE 508'	DIP OF HOLE AT collar 40°	LOCATION OF HOLE IN RELATION TO A FIXED POINT ON THE CLAIM 240' southeast of # 4 post of claim S-127016	MAP REFERENCE NO.	CLAIM NO. S-127016
DATE HOLE STARTED June 9/71	DATE COMPLETED June 22/71	DATE LOGGED June 25/71	LOGGED BY M. Burton		200 ft 40°		LOCATION (Tp., Lot, Con. OR Lat. and Long.) Lot 10, Conc. IV RATHBURN TWP.	PROPERTY NAME
EXPLORATION CO., OWNER OR OPTIONEE Burco Explorations		DATE SUBMITTED Aug.3/71	SUBMITTED BY (Signature) M. Burton		500 ft 40°			
					ft			

FOOTAGE		ROCK TYPE	DESCRIPTION Colour, grain size, texture, minerals, alteration, etc.	PLANAR FEATURE ANGLE	CORE SPECIMEN FOOTAGE +	YOUR SAMPLE NUMBER	SAMPLE FOOTAGE		SAMPLE LENGTH	ASSAYS +	
FROM	TO						FROM	TO			
0	25	Sediments	Dark fine grained								
25	50	Sediments	Dark fine grained								
50	100	Sediments	Dark fine grained, very blocky drilling								
100	200	Sediments	Dark fine grained, sediments are badly broken, very blocky drilling								
200	220	sediments	dark fine grained, still badly broken								
220	250	Gabbro	contact with gabbro at 220'								
250	275	Gabbro	coarse to medium grained								
275	300	Gabbro	coarse to medium grained								
300	380	Gabbro	Medium to coarse grained gabbro								
380	400	Sediments	contact with sediments at 380'								
400	500	Sediments	dark fine grained								
500	508	Sediments	dark fine grained, very blocky drilling, sediments are badly broken.								

**DUPLICATE COPY
POOR QUALITY ORIGINAL
TO FOLLOW**

* For features such as foliation, bedding, schistosity, measured from the long axis of the core.

+ Additional credit available. See Assessment Work Regulations



THE MINING ACT - DEPARTMENT OF MINES
DIAMOND DRILLING LOG

Start a new page for every new hole, but fill in top portion of form only on first page for each hole.

FILL IN ON EVERY PAGE

MOLE NO. D-1 PAGE NO. 1.

DRILLING COMPANY		COLLAR ELEVATION	BEARING OF HOLE FROM TRUE NORTH	TOTAL FOOTAGE	DIP OF HOLE AT		LOCATION OF HOLE IN RELATION TO A FIXED POINT ON THE CLAIM	MAP REFERENCE NO.	CLAIM NO.
DATE HOLE STARTED		DATE COMPLETED	DATE LOGGED	LOGGED BY	collar		240' south east of No 4 Port of claim S.127016	LOCATION (Tp., Lot, Con. OR Lot. and Long.) LOT 10. CON IV RATHBUN TWP.	PROPERTY NAME
EXPLORATION CO., OWNER OR OPTIONEE		DATE SUBMITTED	SUBMITTED BY (Signature)	200 ft		40°			
BURCO EXPLORATIONS LTD		Aug 3/71	M. Burton	500 ft		40°			
				ft					

FOOTAGE		ROCK TYPE	DESCRIPTION Colour, grain size, texture, minerals, alteration, etc.	PLANAR FEATURE ANGLE	CORE SPECIMEN FOOTAGE +	YOUR SAMPLE NUMBER	SAMPLE FOOTAGE		SAMPLE LENGTH	ASSAYS +	
FROM	TO						FROM	TO			
0	25	Sediments	Dark fine grained								
25	50	Sediments	Dark fine grained								
50	100	Sediments	Dark fine grained very blocky drilling								
100	200	Sediments	Dark fine grained sediments are blocky broken very blocky drilling								
200	220	Sediments	Dark fine grained sediments are blocky broken								
220	250	Gabbro	Contact with gabbro at 220'								
250	275	Gabbro	Coarse to medium grained								
275	300	Gabbro	Coarse to medium grained gabbro								
300	380	Gabbro	Medium to coarse grained gabbro								
380	400	Sediments	Contact with sediments at 380'								
400	500	Sediments	Dark fine grained								
500	508	Sediments	Dark fine grained very blocky drilling sediments are blocky broken								

+ For features such as foliation, bedding, schistosity, measured from the long axis of the core.

+ Additional credit available. See Assessment Work Regulations.



THE MINING ACT - DEPARTMENT OF MINES
DIAMOND DRILLING LOG

Start a new page for every new hole, but fill in top portion of form only on first page for each hole.

FILL IN ON EVERY PAGE

HOLE NO. **D-2** PAGE NO. **1**

DRILLING COMPANY		COLLAR ELEVATION	BEARING OF HOLE FROM TRUE NORTH	TOTAL FOOTAGE	DIP OF HOLE AT COLLAR	LOCATION OF HOLE IN RELATION TO A FIXED POINT ON THE CLAIM	MAP REFERENCE NO.	CLAIM NO.
DATE HOLE STARTED		DATE COMPLETED	DATE LOGGED	LOGGED BY	ft		LOT 10 CON 14 RATHBUN TWP	S 127016
EXPLORATION CO., OWNER OR OPTIONEE		DATE SUBMITTED	SUBMITTED BY (Signature)	ft	ft			
BURCO EXPLORATIONS LTD		OCT 5/71	M. Barton	ft	ft			
				ft	ft			
							PROPERTY NAME	
							BURCO EXPLORATIONS LTD	

FOOTAGE FROM	TO	ROCK TYPE	DESCRIPTION Colour, grain size, texture, minerals, alteration, etc.	PLANAR FEATURE ANGLE	CORE SPECIMEN FOOTAGE +	YOUR SAMPLE NUMBER	SAMPLE FOOTAGE		SAMPLE LENGTH	ASSAYS +		
							FROM	TO				
0	25	Sediment	Dark fine grained									
25	50	Sediment	Dark fine grained blocky dull									
50	75	Talies	Contact with Talies S1									
75	100	Talies	Light colour coarse grained									
100	125	Talies	Coarse grained very blocky dull									
125	150	Talies	Contact with Sediments at 144									
150	175	Sediment	Dark fine grained very blocky									
175	206	Sediment	Blocky throughout									

RECEIVED
 OCT 6 1971
 P.M.
 S. J. WILSON
 12345678

* For features such as foliation, bedding, schistosity, measured from the long axis of the core.

+ Additional credit available. See Assessment Work Regulations.

Drilling Company		Collar Elevation	Bearing of hole from true North	Total Footage	Dip of Hole at	Location of hole in relation to a fixed point on the claim.	Map Reference No.	Claim No.	
Date Hole Started		Date Completed	Date Logged	Logged by	Com: 55°		Lot 10, Con. IV Rathbun Twp.	Property Name	S-12705
July 7/71		July 17/71	July 18	M. Burton	Ft.				
Exploration Co., Owner or Optionee		Date Submitted	Submitted by (Signature)		Ft.				
Burco Explorations Ltd.		Oct. 5/71	M. Burton		Ft.				

Footage		Rock Type	Description <small>Colour, grain size, texture, minerals, alteration, etc</small>	Planar Feature Angle *	Core Specimen Footage †	Your Sample No.	Sample Footage		Sample Length	Assays ‡
From	To						From	To		
0	5	Casing								
5	25	Gabbro	Light colour coarse grained							
25	50	Gabbro	Coarse grained light colour							
50	75	Gabbro	Coarse grained light colour							
75	100	Gabbro	odd specks of chalcopyrite							
100	125	Gabbro	coarse grained							
125	150	Gabbro	coarse grained, then becoming fine grained.							
150	175	Gabbro	coated with sediments at 156'							
175	204	Sediments	Dark fine grained blocky sections							

END OF HOLE.

**DUPLICATE COPY
POOR QUALITY ORIGINAL
TO FOLLOW**



THE MINING ACT - DEPARTMENT OF MINES
DIAMOND DRILLING LOG

Start a new page for every new hole, but fill in top portion of form only on first page for each hole.

FILL IN ON EVERY PAGE

MOLE NO. **S-1** PAGE NO. **1**

DRILLING COMPANY		COLLAR ELEVATION	BEARING OF HOLE FROM TRUE NORTH	TOTAL FOOTAGE	DIP OF HOLE AT COLLAR	LOCATION OF HOLE IN RELATION TO A FIXED POINT ON THE CLAIM	MAP REFERENCE NO.	CLAIM NO.
DATE HOLE STARTED		DATE COMPLETED	DATE LOGGED	LOGGED BY			LOT 10 CON IV RATHBUN TWP	PROPERTY NAME BURCO EXPLORATIONS LTD
EXPLORATION CO., OWNER OR OPTIONEE		DATE SUBMITTED	SUBMITTED BY (Signature)		ft			
BURCO EXPLORATIONS LTD		OCT 5/71	M. BURTON		ft			

FOOTAGE FROM	TO	ROCK TYPE	DESCRIPTION Colour, grain size, texture, minerals, alteration, etc.	PLANAR FEATURE ANGLE	CORE SPECIMEN FOOTAGE +	YOUR SAMPLE NUMBER	SAMPLE FOOTAGE		SAMPLE LENGTH	ASSAYS +	
							FROM	TO			
0	5	Coarse									
5	25	Talbro	light calcareous coarse grained								
25	50	Talbro	Coarse grained light calcareous								
50	75	Talbro	" " " "								
75	100	Talbro	odd specks of calcareous								
100	125	Talbro	Coarse grained								
125	150	Talbro	Coarse grained, with heavy fine grained								
150	175	Talbro	Contact with sandstone at 156'								
175	204	Sandstone	Dark fine grained siliceous End of Hole								

RECEIVED
 OCT 3 1971
 78101111818456

+ Additional credit available. See Assessment Work Regulations.

RATHBUN TWP

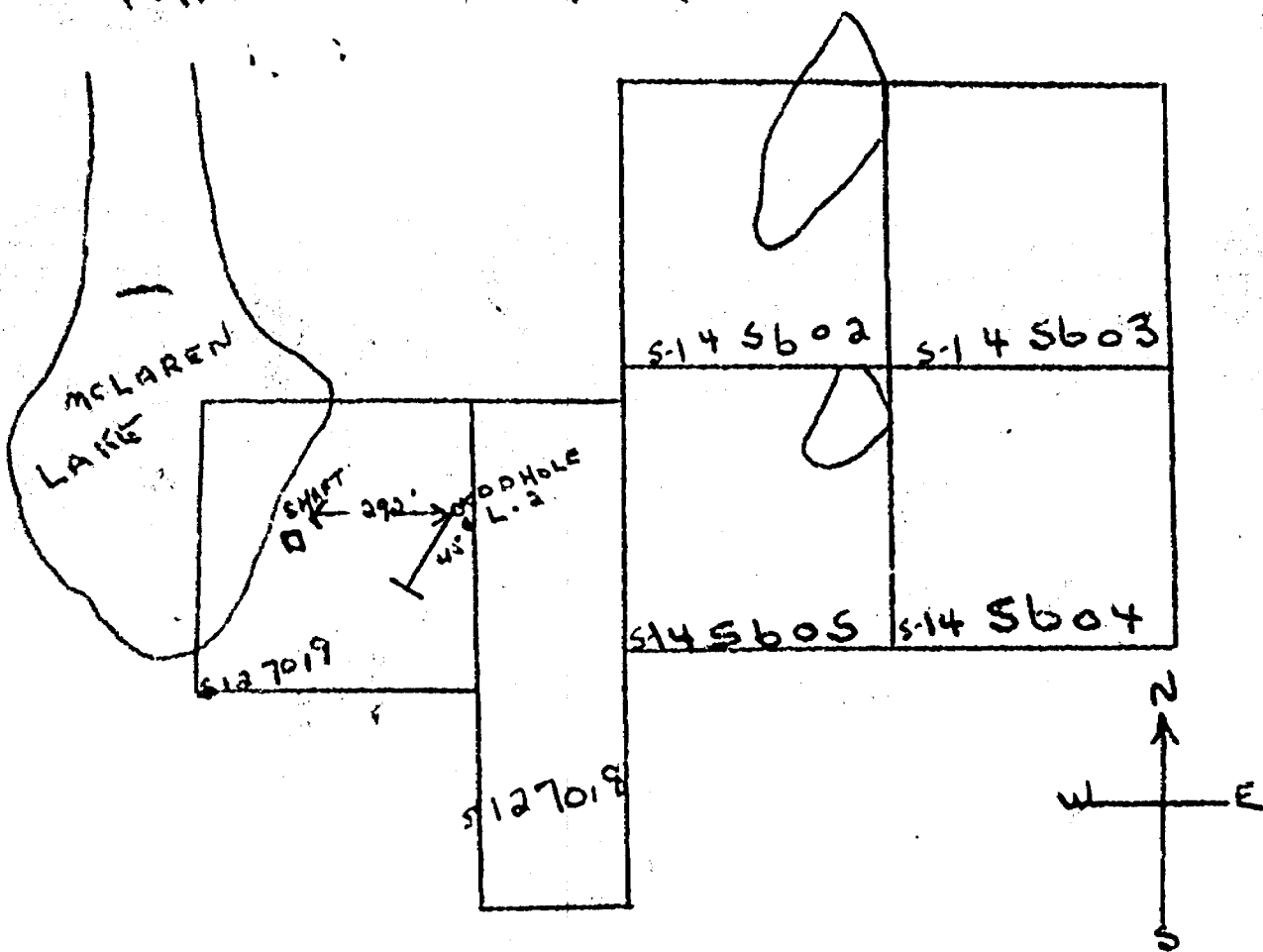

Sketch showing location of
 Drill hole L-2 located on claim
 S-127019 Rathbun Twp
 For assessment work on
 claim S-127018 S-127019
 S-145602 S-145603 S-145604
 S-145605

MINING DIV.
RECEIVED
 DEC 2 - 1968
 AM 7,8,9,10,11,12,13,14,15,16,17,18,19,20,21,22,23,24,25,26,27,28,29,30,31,32,33,34,35,36,37,38,39,40,41,42,43,44,45,46,47,48,49,50,51,52,53,54,55,56,57,58,59,60,61,62,63,64,65,66,67,68,69,70,71,72,73,74,75,76,77,78,79,80,81,82,83,84,85,86,87,88,89,90,91,92,93,94,95,96,97,98,99,100,101,102,103,104,105,106,107,108,109,110,111,112,113,114,115,116,117,118,119,120,121,122,123,124,125,126,127,128,129,130,131,132,133,134,135,136,137,138,139,140,141,142,143,144,145,146,147,148,149,150,151,152,153,154,155,156,157,158,159,160,161,162,163,164,165,166,167,168,169,170,171,172,173,174,175,176,177,178,179,180,181,182,183,184,185,186,187,188,189,190,191,192,193,194,195,196,197,198,199,200,201,202,203,204,205,206,207,208,209,210,211,212,213,214,215,216,217,218,219,220,221,222,223,224,225,226,227,228,229,230,231,232,233,234,235,236,237,238,239,240,241,242,243,244,245,246,247,248,249,250,251,252,253,254,255,256,257,258,259,260,261,262,263,264,265,266,267,268,269,270,271,272,273,274,275,276,277,278,279,280,281,282,283,284,285,286,287,288,289,290,291,292,293,294,295,296,297,298,299,300,301,302,303,304,305,306,307,308,309,310,311,312,313,314,315,316,317,318,319,320,321,322,323,324,325,326,327,328,329,330,331,332,333,334,335,336,337,338,339,340,341,342,343,344,345,346,347,348,349,350,351,352,353,354,355,356,357,358,359,360,361,362,363,364,365,366,367,368,369,370,371,372,373,374,375,376,377,378,379,380,381,382,383,384,385,386,387,388,389,390,391,392,393,394,395,396,397,398,399,400,401,402,403,404,405,406,407,408,409,410,411,412,413,414,415,416,417,418,419,420,421,422,423,424,425,426,427,428,429,430,431,432,433,434,435,436,437,438,439,440,441,442,443,444,445,446,447,448,449,450,451,452,453,454,455,456,457,458,459,460,461,462,463,464,465,466,467,468,469,470,471,472,473,474,475,476,477,478,479,480,481,482,483,484,485,486,487,488,489,490,491,492,493,494,495,496,497,498,499,500,501,502,503,504,505,506,507,508,509,510,511,512,513,514,515,516,517,518,519,520,521,522,523,524,525,526,527,528,529,530,531,532,533,534,535,536,537,538,539,540,541,542,543,544,545,546,547,548,549,550,551,552,553,554,555,556,557,558,559,560,561,562,563,564,565,566,567,568,569,570,571,572,573,574,575,576,577,578,579,580,581,582,583,584,585,586,587,588,589,590,591,592,593,594,595,596,597,598,599,600,601,602,603,604,605,606,607,608,609,610,611,612,613,614,615,616,617,618,619,620,621,622,623,624,625,626,627,628,629,630,631,632,633,634,635,636,637,638,639,640,641,642,643,644,645,646,647,648,649,650,651,652,653,654,655,656,657,658,659,660,661,662,663,664,665,666,667,668,669,670,671,672,673,674,675,676,677,678,679,680,681,682,683,684,685,686,687,688,689,690,691,692,693,694,695,696,697,698,699,700,701,702,703,704,705,706,707,708,709,710,711,712,713,714,715,716,717,718,719,720,721,722,723,724,725,726,727,728,729,730,731,732,733,734,735,736,737,738,739,740,741,742,743,744,745,746,747,748,749,750,751,752,753,754,755,756,757,758,759,760,761,762,763,764,765,766,767,768,769,770,771,772,773,774,775,776,777,778,779,780,781,782,783,784,785,786,787,788,789,790,791,792,793,794,795,796,797,798,799,800,801,802,803,804,805,806,807,808,809,810,811,812,813,814,815,816,817,818,819,820,821,822,823,824,825,826,827,828,829,830,831,832,833,834,835,836,837,838,839,840,841,842,843,844,845,846,847,848,849,850,851,852,853,854,855,856,857,858,859,860,861,862,863,864,865,866,867,868,869,870,871,872,873,874,875,876,877,878,879,880,881,882,883,884,885,886,887,888,889,890,891,892,893,894,895,896,897,898,899,900,901,902,903,904,905,906,907,908,909,910,911,912,913,914,915,916,917,918,919,920,921,922,923,924,925,926,927,928,929,930,931,932,933,934,935,936,937,938,939,940,941,942,943,944,945,946,947,948,949,950,951,952,953,954,955,956,957,958,959,960,961,962,963,964,965,966,967,968,969,970,971,972,973,974,975,976,977,978,979,980,981,982,983,984,985,986,987,988,989,990,991,992,993,994,995,996,997,998,999,1000

RATHBUN TWP.

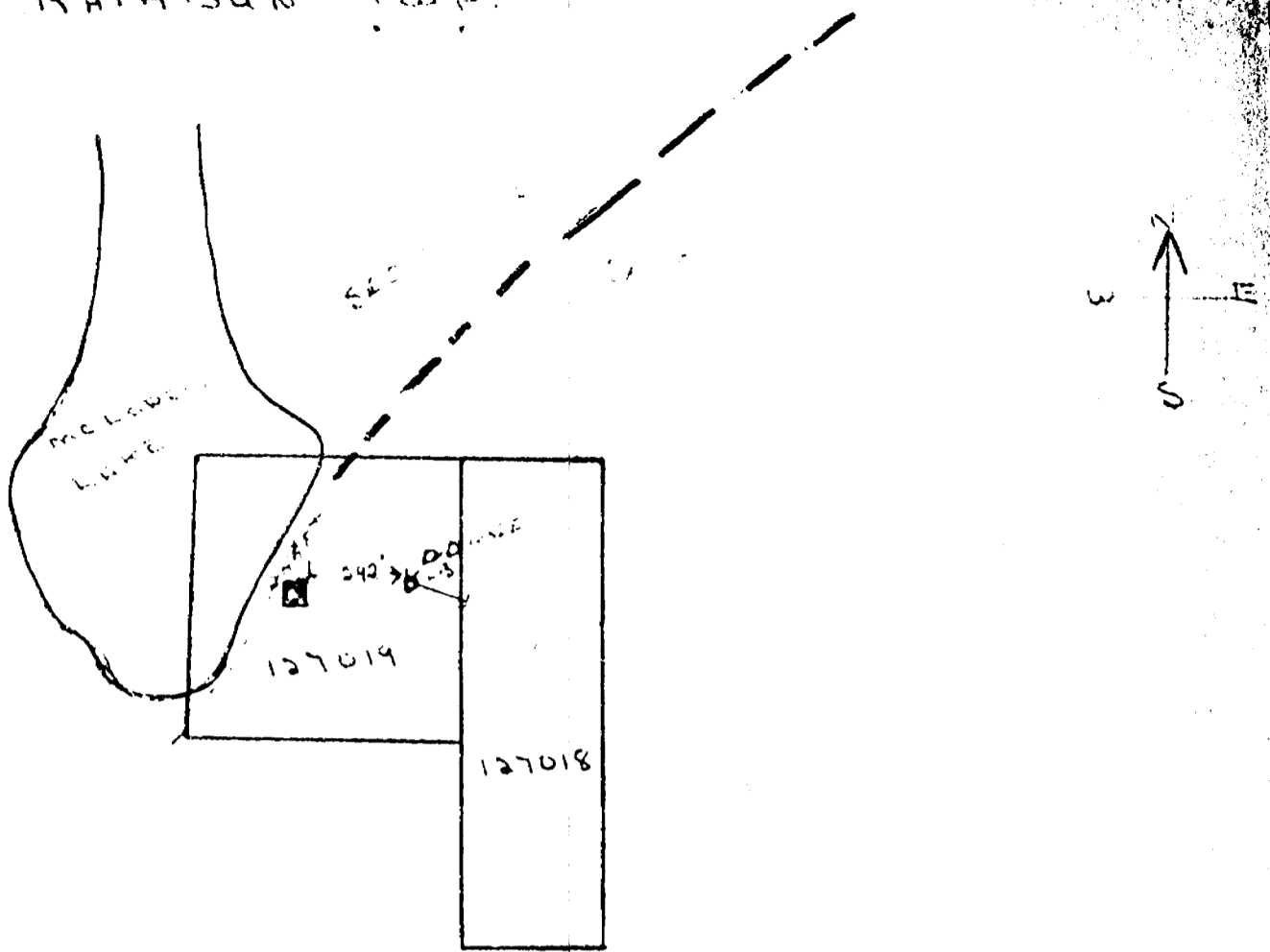

Sketch showing location of
diamond drill hole L. 3 located
on claim S-127019 Rathbun Twp.

RATHBUN TWP

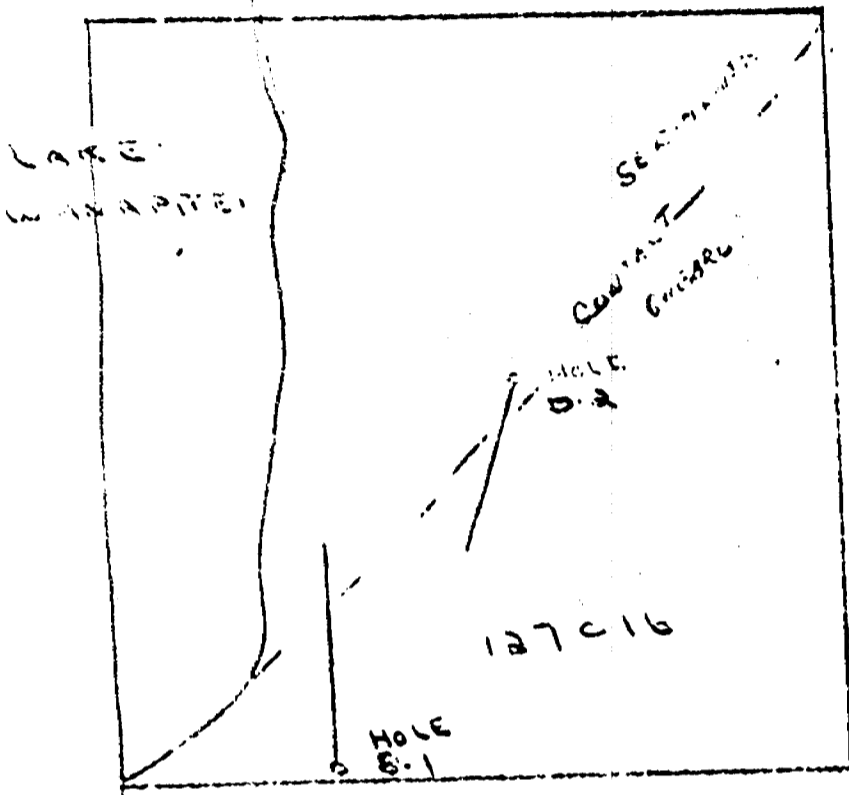

Section 6 Twp 12 S. R. 10 E. S. 1

RECEIVED
OCT 3 1931
BUREAU OF LANDS

8



RATHBUN
TWP

Location of Dredge Hole D-1

Lot 10 Con. 10

WANAPITSI
LAKE

HOLE D-1
40'
DEPTH
508'

S. 127016

S.
281505

4" 14 20

1" 35 5'

MACKELCAN TWP. M.840

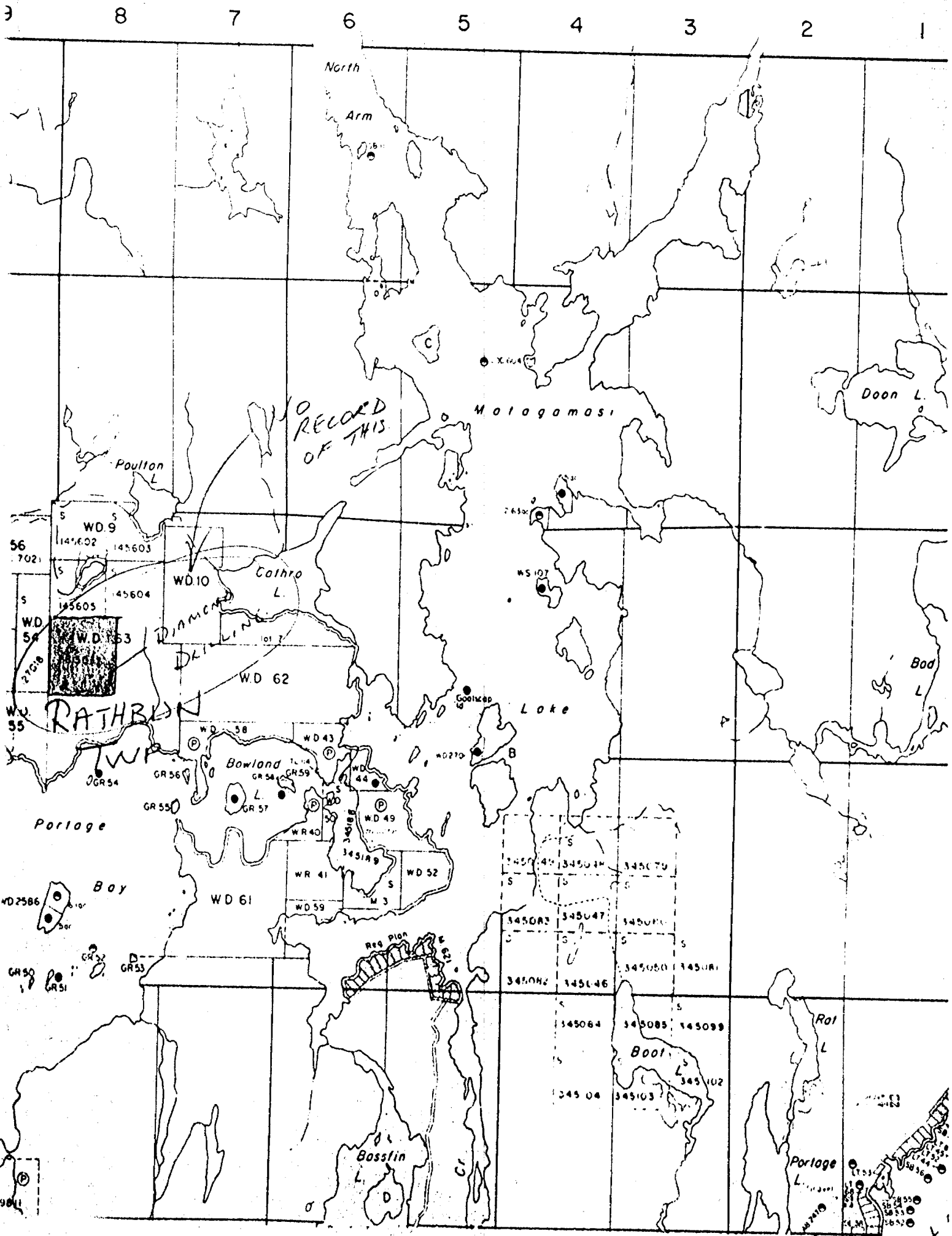

Burco Explorations Ltd.

Buro Explorations Ltd. MACKELCAN TWP. M.840



41155E0091 RATHBUN1201 RATHBUN

900

RATHBUN TWP.
M. 1071

scale
1" = 40 chs.

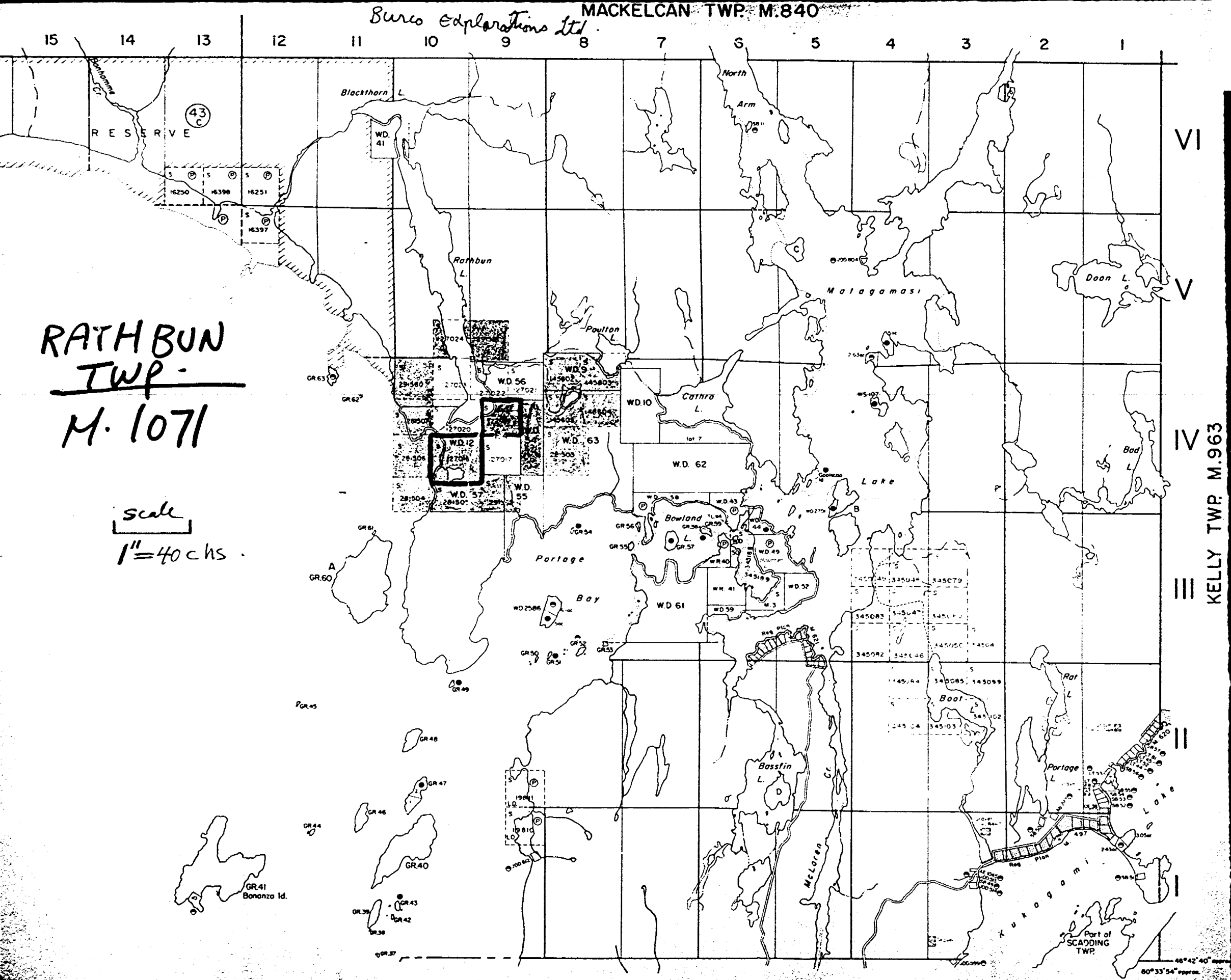

VI

V

IV

III

KELLY TWP. M.963

SCADDING TWP. M.1092

46° 42' 40" approx.
80° 33' 54" approx.