

5-3-456

DOLMAC MINES LIMITED

LOG DIAMOND DRILL HOLE NO. 1

Location 405 ft. at 124 degrees from #1 post S-73075

Direction: 144°

Started Sept 2, 1955.

Inclination: 35°

Finished Sept. 8, 1955.

Depth: 135 ft.

- 0 - 135 Sediments gowganda series. conglomerate
- 0 - 25 Dark grey fine grained rock, argillaceous with siliceous crystals and sparse pebbles and granitic fragments
- 25-50 Dark grey fine grained rock fracturing more abundant. A mosaic of pebbles at 46-47 matrix more siliceous.
- 50-75 Dark grey fine grained rock. more massive pebbles more abundant ranging in size from 1/4 inch to 3/4.
- 75-100 Dark grey fine grained rock. Very little fracturing. Pebbles very widely scattered mainly granitic.
- 100-125 Dark grey fine grained rock. Pebbles more abundant ranging up to 1 inch in size. Matrix more siliceous. Lost core 120-122.
- 125-135 More massive dark grey fine grained rock. Pebbles not so abundant.

END OF HOLE # 1. GOOD CORE RECOVERY

F. M. Smith P. Eng.

(sgd) F. M. SMITH.

DOLMAC MINES LIMITED

LOG OF DIAMOND DRILL HOLE NO. 2.

Location: 500 ft. at 109 degrees from #1 post of S-73075
Direction: 139° Started Sept. 8, 1955.
Inclination: 35° Finished Sept. 15, 1955.
Depth: 145 ft.

0-145 Sediments Gowganda Series. Conglomerate.
0-25 Fine grained dark grey rock, argillaceous with siliceous fragments and crystals. Pebbles mainly granitic ranging in size from minute particles to 3/4 inch.
25-50 Fine grained dark grey rock. Pebbles less abundant matrix more massive.
50-75 Fine grained dark grey rock. Pebbles sparse and very small.
75-100 Fine grained dark grey rock. Pebbles more abundant. One section 3.4 granite boulder.
100-125 Dark grey fine grained rock. Pebbles abundant, ranging in size from 1/4 inch to 1 inch. From 113-125 matrix shows evidence of alteration with some recrystallization, evidence of extensive fracturing
125-145 Very hard flinty structure, intensely fractured. Presence of pebbles indicated but whole section very much altered.

END OF HOLE #2. GOOD CORE RECOVERY

F. M. Smith P. Eng.
(sgd) F. M. Smith.

The following work days were carried out in mapping
 Claims S 72014, 72009, 72013, 73075, 72839, 72840, 73071,
 72812, 72811, 73073, 73116, currently registered in the name
 of Mangovan.

1955

F. M. Smith, P. Eng. Mining Engineer, Toronto, Ontario.	June 16 - 31	16 days	
	July 1 - 16	16 days	32 days
L. Perrier, Assistant and Line Cutter, Carson, Ontario.	June 16 - 31	16 days	
	July 3 - 19	17 days	33 days
	TOTAL:		65 days

Total applicable for assessment work. 260 days

Total requested as per application to
 record work. 253 days.

NOTE: The party continued work on the balance of the
 group of claims which include claims indicated
 above, and by the end of August mapping of the
 whole group was completed.

DOLMAC MINES LIMITED

Log of Diamond Drill Hole No. 3.

Location: Claim S 72011 -- See Map attached

Direction: 297°

Started: September 17, 1955

Inclination: 45°

Finished: September 24, 1955.

Depth: 90 feet

- 0 - 90.0 Fine to medium grained basic intrusive rock. Intensely fractured throughout; minor amount of pyrite, chalcopyrite and pyrrhotite but well distributed over practically all the core.
- 0 - 1 Casing
- 1 - 7 Medium grained crystallized dark grey rock. Chiefly hornblende pyroxene with crystals of albite.
- 7 -16 Coarser crystals of albite, some chalcopyrite mineralization disseminated.
- 16 -20 Coarse crystals up to 1/8 inch Albite, hornblende, and pyroxene.
- 20 -32 Medium grained dark grey rock, albite more abundant grading to fine grained at 32 feet. Presence of albite gives core a speckled appearance.
- 32 -72 Fine to medium grained dark grey rock, numerous fractures and mud seams. Becoming slightly more massive at 41 feet. Mineral slightly more plentiful from 37-40 feet as disseminated chalcopyrite and pyrrhotite; some quartz threads.
- 72 -90 Fine grained dark grey rock, some flecks of pink feldspar. Becoming very fine grained from 85 feet.

END OF HOLE #3. 90 FEET. GOOD CORE RECOVERY.

F. M. Smith P. Eng.
(sgd) F. M. Smith.

DIAMOND DRILL RECORD

PROPERTY: Dolmas Mines Limited

HOLE NO. 4

Sheet Number: 1

Location: 50 Feet S. - 20 Feet W #1 Post S - 73115

CL 73115

Started: February 21, 1956

Completed: February 26, 1956.

400 SC. PLAN SHOWS HOLE ON CL 72841

Brq \rightarrow N70W

Ultimate Depth: 270

Dip: 45 Degrees

Depth Feet

Formation

14	Casing
-30	Oxidized, broken rusty diabase.
-110	Fine to medium grained diabase. Very dark grey grading to medium grey at 110 feet. Numerous radiating hornblende crystals. Occasional small crystals of light colored feldspar increasing in number and size as hole gets deeper. At footage 79 and again at 94 narrow shear belts with 1 inch of quartz carbonate containing a few crystals of tourmaline and some few minute specks of a dark mineral possibly magnetite.
110-270	Lighter colored larger feldspar crystals increasing in number. Core grading to light grey with coarser crystallization as hole deepens. A 2 foot section 161-163 contains a number of coarse pink feldspar crystals. Core quite massive to end of hole at footage 270. Core stored at collar of hole.

DRILLED BY: Inspiration Diamond Drilling Co.

SIGNED: F.M. Smith



DIAMOND DRILL RECORD

PROPERTY: Dolma Mines Limited

HOLE NO. 5

Sheet Number: 1

CL 73115

Started: February 29, 1956

Location: 220 Feet W. 20 Feet S. of Post S-72115

73115

Completed: March 4, 1956

400 SC PLAN SHOWS HOLE ON CL 72841

Brg 57°E

Ultimate Depth: 373

Dip: 45 Degrees

Depth Foot

Formation

- 0 - 6 Casing
- 6 - 373 Diabase. Coarse, light grey, consisting of a mixture of hornblende and light colored feldspar crystals. The texture grades progressively to medium grained at 175 and finer grained to 373. Feldspar crystals at upper reaches of the hole approach the size of a small pea. These become smaller as the hole deepens, becoming minute from 300 to end of hole.
- At footage 42 an open fracture was encountered. A great deal of fine material of the consistency of fine yellow sand, interferred with the drilling at this horizon. This was eventually sealed off with grease but water returns from this point onward were very poor. At footage 162, a 1 foot section of coarse crystallized material was encountered containing a number of pink feldspar crystals. Examples of similar segregations were encountered during the surface mapping and apparently have no significance; merely local phases of an otherwise homogeneous massive igneous body. No metallic mineral was observed in the examination of this core. Core stored at collar of hole.

DRILLED BY: Inspiration Diamond Drilling Co.

SIGNED: F.M. Smith

DIAMOND DRILL RECORD

PROPERTY: Dolmao Mines Limited

HOLE NO. 6

Sheet Number 1

Location: 620 Feet W. 590 Feet N. of #2 Post S-72011

CL 72012
By S 70 E
Dip: 45 Degrees

Started: March 6, 1956

Completed: March 9, 1956

Ultimate Depth: 183 Feet

Depth Feet

Formation

0 - 13	Casing
13 - 65	Bedded sediments. Argillaceous bedded material, bedding planes ranging from $\frac{1}{4}$ inch to several inches in width. Generally massive material with scattered pebbles and fragments of granite. Bedding inclined at about 30 degrees to direction and dip of hole. Blocky drilling.
65 - 68	Rusty fracture zone. A few copper stains and a little scattering of pyrite crystals in rusty fragmental material.
68 - 125	Diabase. Fine grained dark grey diabase.
125 - 127	Rusty contact zone, fragmentals.
127 - 165	Bedded sediments. Very blocky drilling.
165 - 182	Fracture zone, red sand and rusty fragmental material. 9 Feet lost core.
182 - 183	Bedded sediments. End of hole. Correct dip test at 170' 43 degrees. Core stored at collar of hole.

DRILLED BY: Inspiration Diamond Drilling Co.

SIGNED: F.M. Smith

DIAMOND DRILL RECORD

PROPERTY: Dolmao Mines Limited

HOLE NO. 7

Sheet Number: 1

CL 72011

Started: March 11, 1956

Location: 540 Feet W. 310 Feet N. of #2 Post S-72011

Completed: March 14, 1956.

Brg N 70 W

Ultimate Depth: 161

Dip: 45 Degrees

Depth Feet

Formation

0 - 6	Casing
0 - 107	Diabase. Coarse grained grey diabase with large crystals of light colored feldspar; grading to medium grained at 40 feet and fine grained from 82 feet. From 82 feet to 107 feet a number of carbonate stringers were encountered cutting the core at varying angles. These carbonate stringers some of them up to $\frac{1}{2}$ inch in width were layered from both walls, indicating fracture filling by carbonate solutions. No visible mineral but some of the carbonate tinted pink indicating the presence of some iron oxide in the solutions. One stringer had a streak of hematite.
107 - 135	Diabase. Dense, fine grained, massive, black diabase.
135 - 136	Fracture zone, broken material, rusty with some carbonates. No visible mineral.
136 - 161	Bedded sediments becoming massive. End of hole 161 feet. Good core recovery. Core stored at collar of hole.

DRILLED BY; Inspiration Diamond Drilling Co.

SIGNED: F.H. Smith



DIAMOND DRILL RECORD

PROPERTY: Dolma Mines Limited

HOLE NO. 8

Sheet Number: 1

Started: March 15, 1956

Location: 490 Feet N. 430 Feet E. of 22 Post S-72011

Completed March 18, 1956.

Ry N 70 W

Ultimate Depth 184 Feet

Dip: 45 Degrees

Depth Feet

Formation

0 - 6	Casing
6 - 177	Diabase. Coarse grained diabase with large crystals of light colored feldspar, grading to medium grained at 90 feet and fine grained from 140 feet. A few narry stringers of carbonate from 101-110. No metallic minerals.
177 - 184	Sediments. Toded sediments. From 177-178 much broken material slightly rusty with a little carbonate in evidence on broken shards. No metallic minerals.
	End of hole 33 184 Feet. Good core recovery.
	Core stored at collar of hole.

DRILLED BY Inspiration Diamond Drilling Co.

SIGNED: F.M. Smith

DIAMOND DRILL RECORD

PROPERTY: Dolrao Mines Limited

HOLE NO. 9

Sheet Number: 1

Started: March 19, 1956

Location: 405 Feet W. 610 Feet E. 52 Post S-72011

CC 72012

Finished: March 21, 1956

B. N 7064

Ultimate Depth: 163 Feet

Dip: 45 Degrees

Depth Feet	Formation
0 - 14	Casing
14 - 147	Diabase. Coarse grained grey diabase with crystals of light color of feldspar; grading to medium grained at 80 feet, and fine grained at 110 feet. At 147 feet a frozen contact with bedded sediments. Core massive throughout; no fracturing; or broken ground. A few speck of pyritic minerals at 125.5 feet.
147 - 163	Sediments. Bedded sediments with fragments and small pebbles of granite imbedded. Massive. Bedding planes cross core at 40 degrees. No metallic minerals. End of hole 163 feet. Good core recovery. Core stored at collar of hole.

DRILLED BY: Inspiration Diamond Drilling Co.

SIGNED: F.M. Smith

DIAMOND DRILL RECORD

PROPERTY: Dolmac Mines Limited

HOLE NO. 10

Sheet Number: 1

Started: March 22, 1956.

Location: 30 Feet W. 130 Feet N. of #2 Post S-72006

CL 72 012

Completed: March 23, 1956.

By N 70 W.

Ultimate Depth: 149 Feet

Dip: 45 Degrees

Depth Feet

Formation

0 - 10	Casing
10 - 149	Sediments. Argillaceous, bedded sediments with occasional small pebbles and fragments of granite. At 74.5 and 80.3 open vugs $\frac{1}{8}$ " to $\frac{3}{8}$ " in width partially filled with rusty quartz. A few specks of mineral. Core massive, no fracturing. End of hole 149 feet. Good core recovery. Core stored at collar of hole.

DRILLED BY: Inspiration Diamond Drilling Co.

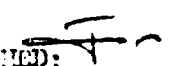
SIGNED: 

DIAMOND DRILL RECORD

PROPERTY: Dolmar Mines Limited

HOLE NO. 11

Sheet Number: 1

Started: March 24, 1955

Located: 250 Feet W. 160 Feet N. of Post #2 S-72006

Completed: March 25, 1956.

By S70E

Dip: 45 Degrees

Ultimate Depth: 163

Depth Feet

Formation

0 - 6	Casing
6 - 163	Sediments. Argillaceous bedded sediments with occasional small pebbles and fragments of granite. Bedding planes at 15 degrees to direction of hole. Core massive. No fracturing, no metallic minerals. End of Hole 11 - 163 Feet. Good Core recovery. Core stored at collar of hole.

DRILLED BY : Inspiration Diamond Drilling Co.

SIGNED: 

Rathbun J.P.

DOLMAC MINES LIMITED

Sudbury Property

DIAMOND DRILLING PROGRAMME

by

Michael Ogden

**Toronto, Ontario.
April 18th, 1958.**

HALET, BROADHURST & OGDEN

DOLMAC MINES LIMITED

Sudbury Property

Diamond Drilling Programme

REFERENCES:

1. Rathbun Township Claim Map.
2. Wanapitei Lake Area, T.T. Quirke, G.S.C. 1922.
3. Magnetometer and Elektromagnetic Survey, Koulemsine & Geoffroy, March, 1954.
4. Report on the Property, F.M. Smith, August, 1955.
5. Report on Work Done, June 1955 to May 1956, J.R. MacDonald, May, 1956.
6. Examination, M. Ogden, Progress Report No. 4, July, 1957.
7. Geological Map, 400 scale, G.G. Garen, October, 1957.
8. Geological Report, Ogden, November, 1957.
9. Plans and Sections of Drill holes, 10 scale, accompanying this report.

INTRODUCTION:

Following the geological mapping done last Fall, it was decided to proceed with a programme of diamond drilling during the winter. The purpose of the drilling programme was to investigate the vicinity of the shaft with a series of short, closely spaced, holes.

Six holes were drilled close to the shaft to determine the attitude of the original zone of copper-nickel and evaluate its potential. The other six holes were drilled into a new showing, found last summer, to similarly evaluate its attitude and potential.

PROPERTY:

The property consists of 19 mining claims numbered as

follows:

S-72006 to S-72013 inclusive	8 claims
S-72839 to S-72842 inclusive	4 claims
S-73115 and S-73116	2 claims
S-73075	1 claim
S-104909 to S-104912 inclusive	4 claims
	<u>19 claims</u>

LOCATION, ACCESS AND HISTORY:

The property is located astride Rathbun Lake on the north-east shore of Wanapitei Lake about 25 miles north-east of the city of Sudbury. See the referenced reports for further details.

SUMMARY OF DRILL HOLES:

<u>Hole No.</u>	<u>Length</u>	<u>Location</u>	<u>Purpose and Result</u>
1	40.0 ft.	East of Shaft	To probe mineralization in shaft area. Weak zones encountered.
2	52.5 ft.	East of Shaft	Same as above.
3	27.0 ft.	West of Shaft	Same as above.
4	60.5 ft.	West of Shaft	Same as above.
5	60.5 ft.	West of Shaft	Same as above.
6	49.0 ft.	West and South of Shaft	To try to prove a folded contact theory. Results inconclusive for the sediments and altered gabbro are too alike near their contact.
7	47.0 ft.	230 feet North of Shaft, East of mineralized showing	To probe ground East of showing for mineralized zones - some found.
8	57.0 ft.	Same as above.	Same as above.
9	55.0 ft.	West of showing	Same as above, but West of showing.
10	61.0 ft.	Same as above.	Same as above.
11	51.0 ft.	Same as above.	Same as above - a vertical hole.
12	58.0 ft.	Further West	To probe extension of mineralization - some found.
Total - 618.5 ft.			

ASSAYS:

Two sections of core were split and sent for assay as a check against the estimates of mineralization appearing on the drill logs. The estimates are in percent chalcopyrite by volume which have to be cut in half ^{by 2/3} to arrive at percent copper by weight.

<u>Hole No.</u>	<u>From</u>	<u>To</u>	<u>Length</u>	<u>Est. % Chalco.</u>	<u>Copper</u>	<u>Nickel</u>
9	20.3	21.3	1.0	2%	0.45%	0.15%
10	16.0	18.5	2.5	1%	0.10%	0.05%

CONCLUSIONS:

1. The drilling has shown that the copper mineralization occurs in broad, ill-defined zones striking about 135 degrees true and dipping steeply (60 degrees to 70 degrees) to the north.

2. The mineralization does not necessarily improve in close proximity to the contact; e.g. the shaft zone was best at the contact, whereas the "showing zone", 220 feet north, seemed better about 35 feet away from the contact.

3. The gabbro or diorite is the host to the copper mineralization and the mineralization seems to be concentrated near folds or irregularities in the gabbro-sediment contact.

4. The original high-grade showing at the shaft was mined out during the sinking of the shaft.

ASSAYS:

Two sections of core were split and sent for assay as a check against the estimates of mineralization appearing on the drill logs. The estimates are in percent chalcopyrite by volume which have to be cut in half ^{by 2/3} to arrive at percent copper by weight.

<u>Hole No.</u>	<u>From</u>	<u>To</u>	<u>Length</u>	<u>Est. % Chalco.</u>	<u>Copper</u>	<u>Nickel</u>
9	20.3	21.3	1.0	2%	0.45%	0.15%
10	16.0	18.5	2.5	1%	0.10%	0.05%

CONCLUSIONS:

1. The drilling has shown that the copper mineralization occurs in broad, ill-defined zones striking about 135 degrees true and dipping steeply (60 degrees to 70 degrees) to the north.

2. The mineralization does not necessarily improve in close proximity to the contact; e.g. the shaft zone was best at the contact, whereas the "showing zone", 220 feet north, seemed better about 35 feet away from the contact.

3. The gabbro or diorite is the host to the copper mineralization and the mineralization seems to be concentrated near folds or irregularities in the gabbro-sediment contact.

4. The original high-grade showing at the shaft was mined out during the sinking of the shaft.

5. Estimates of percent chalcopyrite in the drill logs should be cut to one quarter to arrive at estimated copper content.

6. The ratio of nickel to copper as shown by the recent and previous assays is about 0.15 to 1.0.

7. The gabbroic rocks near the sediment contact should

now be explored in detail by the electromagnetic (McPhar type) method. For this is the area of mineralization and now that the attitude of the expected mineralization has been established the survey can be ^{laid} out in the manner most suitable to this type of occurrence.

RECOMMENDATIONS:

Conduct a McPhar type electromagnetic survey over the contact zone. Readings should be taken at 100-foot intervals on lines striking north-east spaced 200 feet apart. The size of the area to be surveyed is about 1,200 by 8,000 feet and the estimated cost is \$2,500.00.

Respectfully submitted,



Michael Ogden.

DIAMOND DRILL LOG

PROPERTY: Delmas Mines Limited, Sudbury Property

HOLE NUMBER: 1

LOCATION: Based on Picket Line Grid - see note below.
Claim 3-72012

DIP TESTS

Latitude: 477.5

Dip: 45°

Footage

Reading

Corrected

Departure: 490.7

Depth: 40.0 feet

Elevation: Top of Timber -
Shaft Cellar

Commenced: March 9, 1958

Azimuth: 25° true

Finished: March 10, 1958

Logged by: M. Ogden

SAMPLE NUMBER	DESCRIPTION			
0.0-12.0	Casing.			
12.0-15.5	Gabbro, a black and white, even textured, rice size grained rock of 30% to 40% white plagioclase and the remainder of mafic or altered mafic minerals. It visually carries a little disseminated pyrite (py.) and pyrrhotite (ph.). This section badly broken up.			
15.5-18.5	"Grey dyke" - a hazy grained, rice size or smaller grained, fairly even textured rock which seems to have originally been gabbro but is now altered by a little silicification, granitization and carbonatization which has obscured the original texture and usually reduced the apparent grain size. The rock is grey-green in colour. This portion carries 1% pyrrhotite, 1/2% pyrite and 1/2% chalcopyrite, all very finely disseminated.			
18.5-40.0	Gabbro as above with 1/2% pyrite and 1/2% pyrrhotite.			
40.0	END OF HOLE.			
<p><u>Note:</u> The picket line along the base of the small cliff runs at 25° true, this is "grid north", and the holes are located with respect to the picket line. The intersection of this picket line with the short one across the shaft is designated at 500N and 500E.</p>				

DIAMOND DRILL LOG

PROPERTY: **Delmac Mines Limited, Sudbury Property**

HOLE NUMBER: **2**

LOCATION: *claims 72017*

DIP TESTS

Latitude: **477.3**

Dip: **58°**

Footage

Reading

Corrected

Departure: **490.7**

Depth: **52.5 feet**

Elevation: **Shaft Collar**

Commenced: **March 11, 1958**

Azimuth: **25° true**

Finished: **March 11, 1958**

Logged by: **M. Ogden**

SAMPLE NUMBER	DESCRIPTION			
0.0- 7.0	Casing.			
7.0- 8.5	Gabbro, trace of pyrite.			
8.5-13.5	"Grey Dyke", appears to be an alteration of the gabbro in which the spotted black and white effect of the gabbro disappears yet often, on close examination, the vague outlines of the original crystals can be seen. The net result is a grey-green sugar grained (apparently) rock. This rock seems to carry the mineralization. Contacts vague. Trace of chalcopyrite and $\frac{1}{2}\%$ pyrrhotite.			
13.5-17.5	Gabbro, trace of pyrite.			
17.5-18.5	"Grey Dyke", a few specks of chalcopyrite, $\frac{1}{2}\%$ pyrrhotite. Contacts vague.			
18.5-40.0	Gabbro, trace of pyrite and pyrrhotite.			
40.0-42.8	"Grey Dyke", contacts clear at 30 degrees to core. $\frac{1}{2}\%$ fine chalcopyrite, 1% pyrrhotite.			
42.8-47.0	Gabbro.			
47.0-52.5	Broke through into drift.			
52.5	In mud on floor of drift. END OF HOLE.			

DIAMOND DRILL LOG

PROPERTY: **Delmas Mines Limited, Sudbury Property.**

HOLE NUMBER: **3**

LOCATION: **Centre line machine head is collar.**
Plan 5-72012

DIP TESTS

Latitude: **46618**

Dip: **35°**

Footage

Reading

Corrected

Departure: **472.7**

Depth: **27 feet**

Elevation: **shaft collar plus
1.2 feet**

Commenced: **March 12, 1958**

Azimuth: **25° true**

Finished: **March 12, 1958**

Logged by: **M. Ogden**

SAMPLE NUMBER	DESCRIPTION			
0.0-14.0	Casing.			
14.0-27.0	"Grey Dyke", a few specks of chalcoppyrite throughout particularly at 15.0 and 16.0 feet.			
23.5-27.0	Break through into old workings.			
27.0	END OF HOLE.			

DIAMOND DRILL LOG

PROPERTY: **Belmas Mines Limited, Sudbury Property.**

HOLE NUMBER: **4**

LOCATION: *Claim 3-72012*

DIP TESTS

Latitude: **466.5**

Dip: **46°**

Footage Reading Corrected

Departure: **472.7**

Depth: **60.5 feet**

Note: Added 7.5 feet to core box footage to get true footage from centre line of head.

Elevation: **plus 1.2 feet**

Commenced: **March 12, 1958**

Azimuth: **25° true**

Finished: **March 12, 1958**

Logged by: **M. Ogden**

SAMPLE NUMBER	DESCRIPTION			
0.0- 7.5	Distance centre line of machine to outcrop.			
7.5-60.5	"Grey Dyke" like rock, possibly sediment but not sure. 7.5-14.5 Like altered gabbro and then a gradational contact with possible sediment. 14.5-28.5 Like siliceous sediment. Final contact sharp at 45 degrees. 28.5-60.5 Like altered gabbro. 39.0-40.0 1/2" pyrrhotite. 46.2 1/2" seam of massive pyrite and some hematite at 60 degrees to core.			
60.5	END OF HOLE.			
	Note: Only 53 feet of drilling.			

DIAMOND DRILL LOG

PROPERTY: **Delmar Mines Limited, Sudbury Property.**

HOLE NUMBER: **5**

LOCATION: **Claim 3-72012**

DIP TESTS

Latitude: **466.5**

Dip: **56°**

Footage Reading Corrected
 Note: Added 6.5 feet to
 core box footage to get
 true footage from centre
 line of head.

Departure: **472.7**

Depth: **60.5 feet**

Elevation: **plus 1.2 feet**

Commenced: **March 13, 1958.**

Azimuth: **25° true**

Finished: **March 13, 1958.** Logged by: **N. Ogden.**

SAMPLE NUMBER	DESCRIPTION		
0.0- 6.5	Distance from centre line of machine to outcrop.		
6.5-14.0	"Grey Dyke" rock with lower contact gradational.		
14.0-21.5	Apparent siliceous sediment, both contacts gradational. A very fine grain, massive, even textured, dark grey rock. 19.5 2 inches of 2% pyrrhotite.		
21.5-39.5	"Grey Dyke" rock as above, no visible mineralization.		
39.5-60.5	Sediments as above. 52.8 Carbonate stringer with chalcopyrite at 45 degrees. 56.5 Speck of chalcopyrite.		
60.5	END OF HOLE.		

DIAMOND DRILL LOG

PROPERTY: **Delmac Mines Limited, Sudbury Property**

HOLE NUMBER: **6**

LOCATION: *claim 3-72012*

DIP TESTS

Latitude: **478.5**

Dip: **48°**

Footage

Reading

Corrected

Departure: **460.0**

Depth: **49 feet**

Elevation: **Shaft collar, less 2.5 feet** Commenced: **March 13, 1958**

Azimuth: **127° true**

Finished: **March 14, 1958**

Logged by: **M. Ogden**

SAMPLE NUMBER	DESCRIPTION		
0.0- 0.5	Sediments.		
0.5- 4.4	"Grey Dyke", altered gabbro. Initial contact clear at 45 degrees, final contact clear at 60 degrees. Specks of malachite in fractures at 2.0 feet.		
4.4-23.2	Sediments. Grey, sugary grained, even textured, with frequent fine hematite stringers in the fractures. More siliceous than the gabbro and finer grained.		
23.2-31.3	Probable "Grey Dyke" rock.		
31.3-36.0	Sediments. 32.0-36.0 Fault zone at 45 degrees to core. Badly broken core.		
36.0-49.0	Gabbro, a few specks of chalcopyrite, 1/2 pyrrhotite. First 2.5 feet badly broken. 43.0 1/4 inch of pink feldspar vein at 90 degrees with blobs of chalcopyrite on edges.		
49.0	END OF HOLE.		

DIAMOND DRILL LOG

PROPERTY: **Delmas Mines Limited, Sudbury Property**

HOLE NUMBER: **7**

LOCATION: **Claim S-72012**

DIP TESTS

Latitude: **727.5**

Dip: **21°**

Footage

Reading

Corrected

Departure: **550**

Depth: **47 feet**

Elevation: **Trench floor less
1.0 feet**

Commenced: **March 15, 1958**

Azimuth: **205° true**

Finished: **March 15, 1958**

Logged by: **M. Ogden**

SAMPLE NUMBER	DESCRIPTION			
0.0-11.5	Casing.			
11.5-35.0	"Grey Dyke" like rock, fine grain, altered gabbro.			
12.5-16.5	Small blobs (1/8 inch to 1/4 inch) of pyrrhotite with chalcopyrite on the edges (about 5 blobs).			
19.5	Speck of chalcopyrite.			
25.0	Speck of chalcopyrite.			
33.8	1/8 inch seam of pyrrhotite and chalcopyrite at 70 degrees to core.			
35.0-47.0	Gabbro.			
42.5-43.5	A fine speck of pyrrhotite in the chalcopyrite.			
47.0	END OF HOLE.			

DIAMOND DRILL LOG

PROPERTY: Dolmas Mines Limited, Sudbury Property

HOLE NUMBER: 8

LOCATION: Claim 5-72 012

DIP TESTS

Latitude: 729.5

Dip: 51°

Footage

Reading

Corrected

Departure: 550.0

Depth: 57 feet

Elevation: Trench floor less
1.0 feet

Commenced: March 16, 1958

Azimuth: 205° true

Finished: March 16, 1958

Logged by: M. Ogden

SAMPLE NUMBER	DESCRIPTION			
0.0- 3.0	Casing.			
3.0-57.0	Gabbro with a trace of pyrite. 21.5-25.0 Three gobs of pyrrhotite ($\frac{1}{2}$ inch) with chalcopyrite on the edges. This is the same type of mineralization as in the trench.			
57.0	END OF HOLE.			

DIAMOND DRILL LOG

PROPERTY: **DeLme Mines Limited, Sudbury Property**

HOLE NUMBER: **9**

LOCATION: **Claim 5-72012**

DIP TESTS

Latitude: **725.0**

Dip: **43°**

Footage

Reading

Corrected

Departure: **520.0**

Depth: **55 feet**

Elevation: **-11.0 feet from trench**

Commenced: **March 17, 1958**

Azimuth: **205° true**

Finished: **March 17, 1958**

Logged by: **M. Ogden**

SAMPLE NUMBER	DESCRIPTION	Width	Cu	Ni
	0.0- 4.0 Casing.			
	4.0-55.0 Gabbro.			
1	17.0-19.0 Broken core. Slips at 30 degrees and 0 degrees to core.			
	20.0-21.0 3% pyrrhotite, 2% chalcopyrite.	1.0	0.45	0.15
	26.5-28.0 Broken core. Slips at 0 degrees to 30 degrees to core.			
	32.5 A few specks of chalcopyrite.			
	44.5-50.5 "Grey Dyke". Contact clear at 30 degrees to 60 degrees to core.			
	55.0 END OF HOLE.			

DIAMOND DRILL LOG

PROPERTY: **Delmac Mines Limited, Sudbury Property**

HOLE NUMBER: **10**

LOCATION: *Chim 5-72012*

DIP TESTS

Latitude: **727.0**

Dip: **68°**

Footage

Reading

Corrected

Departure: **520.0**

Depth: **61.0 feet**

Elevation: **Trench less 11.0 feet**

Commenced: **March 18, 1958**

Azimuth: **295° true**

Finished: **March 18, 1958**

Logged by: **M. Ogden**

SAMPLE NUMBER	DESCRIPTION	Width	Cu	Pt
2	0.0- 3.0 Casing.			
	3.0-61.0 Gabbro.			
	6.5-9.5 Odd speck of chalcopyrite.			
	16.0-18.5 Mineralized shear zone at 30 degrees to core, 1% to 2% chalcopyrite and 2% to 3% pyrrhotite. Some fault and gouge and hematite in the shears.	2.5	0.10	0.05
	32.0-33.0 1/2% to 1% chalcopyrite and pyrite, disseminated.			
	38.0-39.5 1% pyrite, disseminated.			
	50.8 1/2 inch quartz at 30 degrees to core and 2% chalcopyrite.			
52.5 1 inch shear at 30 degrees to core and hematite.				
55.0 1/2 inch hematite shear.				
61.0	END OF HOLE.			

DIAMOND DRILL LOG

PROPERTY: **Delmas Mines Limited, Sudbury Property**

HOLE NUMBER: **11**

LOCATION: **Claim 5-72012**

DIP TESTS

Latitude: **727.0**

Dip: **90°**

Footage

Reading

Corrected

Departure: **820.0**

Depth: **51 feet**

Elevation: **-11.0 feet**

Commenced: **March 19, 1958**

Azimuth: **N11**

Finished: **March 19, 1958**

Logged by: **M. Ogden**

SAMPLE NUMBER	DESCRIPTION		
0.0- 2.0	Casing.		
2.0-51.0	Gabbro.		
	11.0-12.0 Speck of pyrite, trace of chalcopyrite.		
	14.1-14.7 "Grey Dyke" at 45 degrees. Contact vague. 3% pyrrhotite and 2% chalcopyrite.		
	15.5-19.5 A few hematitic slips at 30 degrees to core.		
	21.5 1 inch of 1% disseminated chalcopyrite.		
	28.5 1 inch 2% chalcopyrite and 3% pyrrhotite in "Grey Dyke", vague.		
	32.0-36.0 1% pyrite, trace of chalcopyrite.		
	45.0-49.0 10 hematitic slips, some with gouge at 30 degrees to core. Shear zone. Rock also sheared at 30 degrees to core.		
51.0	END OF HOLE.		

DIAMOND DRILL LOG

PROPERTY: **Dolmae Mines Limited, Sudbury Property**

HOLE NUMBER: **13**

LOCATION: **Claim 3-72012**

DIP TESTS

Latitude: **747.0**

Dip: **45°**

Footage

Reading

Corrected

Departure: **490.0**

Depth: **58.0 feet**

Elevation: **Trench floor less
19.0 feet**

Commenced: **March 20, 1958**

Azimuth: **205° true**

Finished: **March 20, 1958**

Logged by: **M. Ogden**



SAMPLE NUMBER	DESCRIPTION			
0.0-10.0	Casing in air and 3 feet of overburden.			
10.0-58.0	Gabbro. 27.0-28.0 "Grey Dyke" with 3 hematite slips at 60 degrees to core. 30.0-35.0 1/2 disseminated pyrite. 38.0-40.0 Trace of disseminated pyrite. 42.5 1/2 inch seam of carbonate-hematite at 45 degrees to core. 54.0-56.0 Trace of disseminated pyrite.			
58.0	END OF HOLE.			

Rathbrun Tuff

	72009	72013
72006 11/10	72012	72008
72010	72011 6/9 7/8	72007
73075	72839	72840
	72842	72841
	73116	73115 5/4

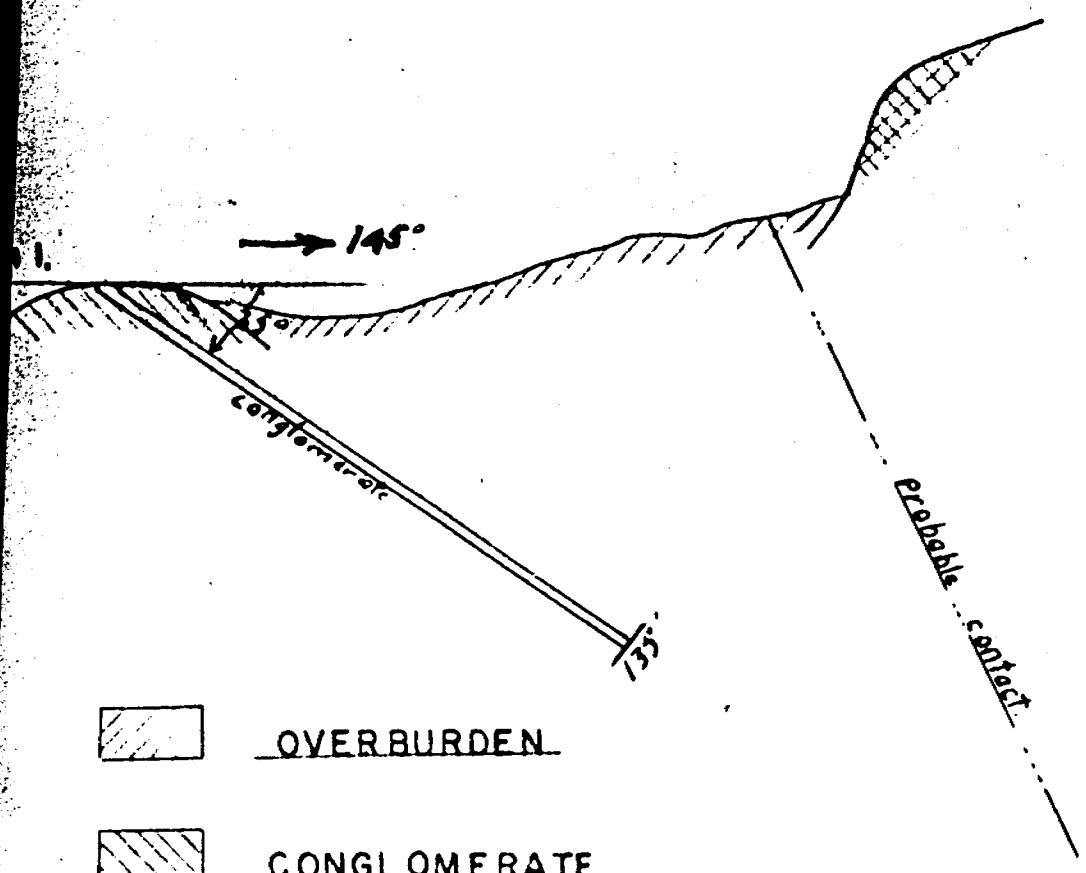
profile dd. hole. 1.

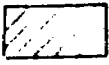

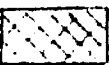
-  OVERBURDEN
-  CONGLOMERATE
-  BASIC INTRUSIVE

SCALE 1" = 40 FT
1" = 40 FT

DOLMAC MINES LTD

PROFILE DDH 2.

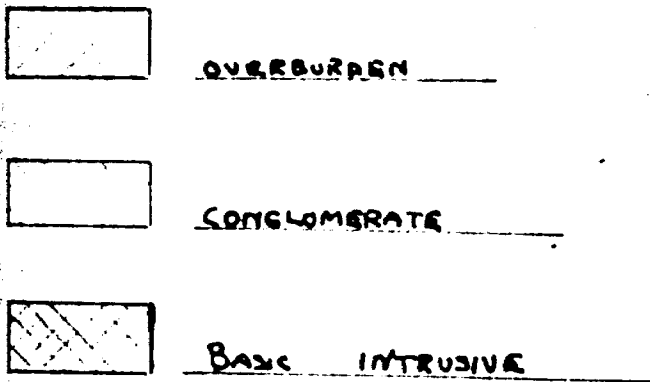
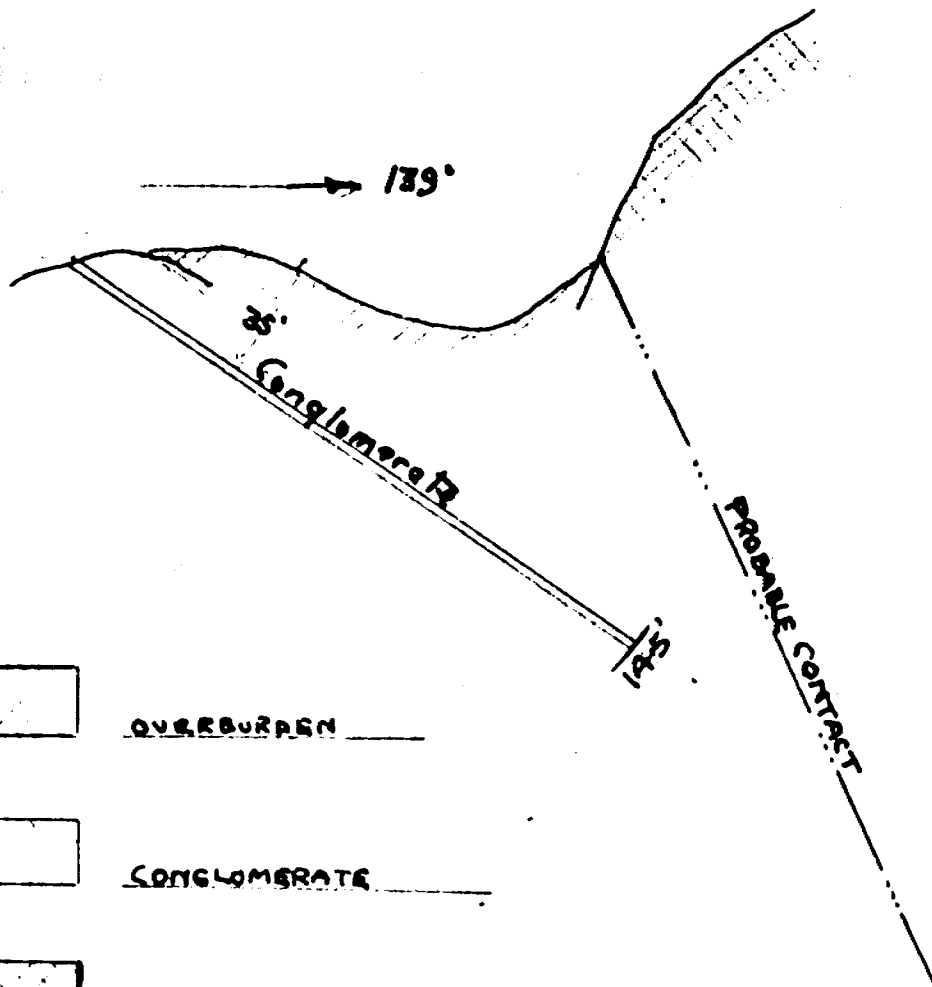

SCALE 1" = 40'
1" = 40'

DOLMAC MINES LTD

PROFILE DDH 3

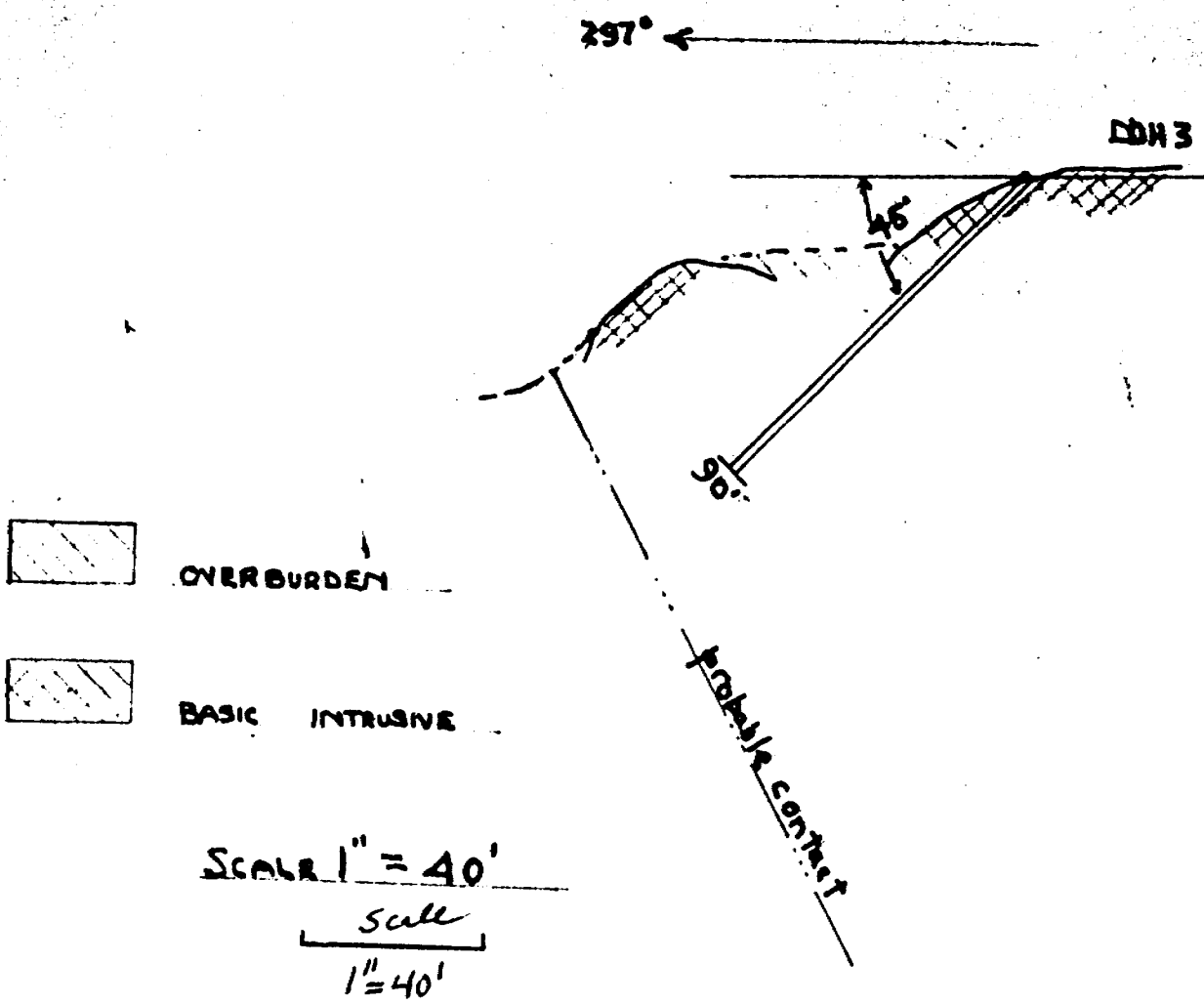

DOLMAC MINES LTD

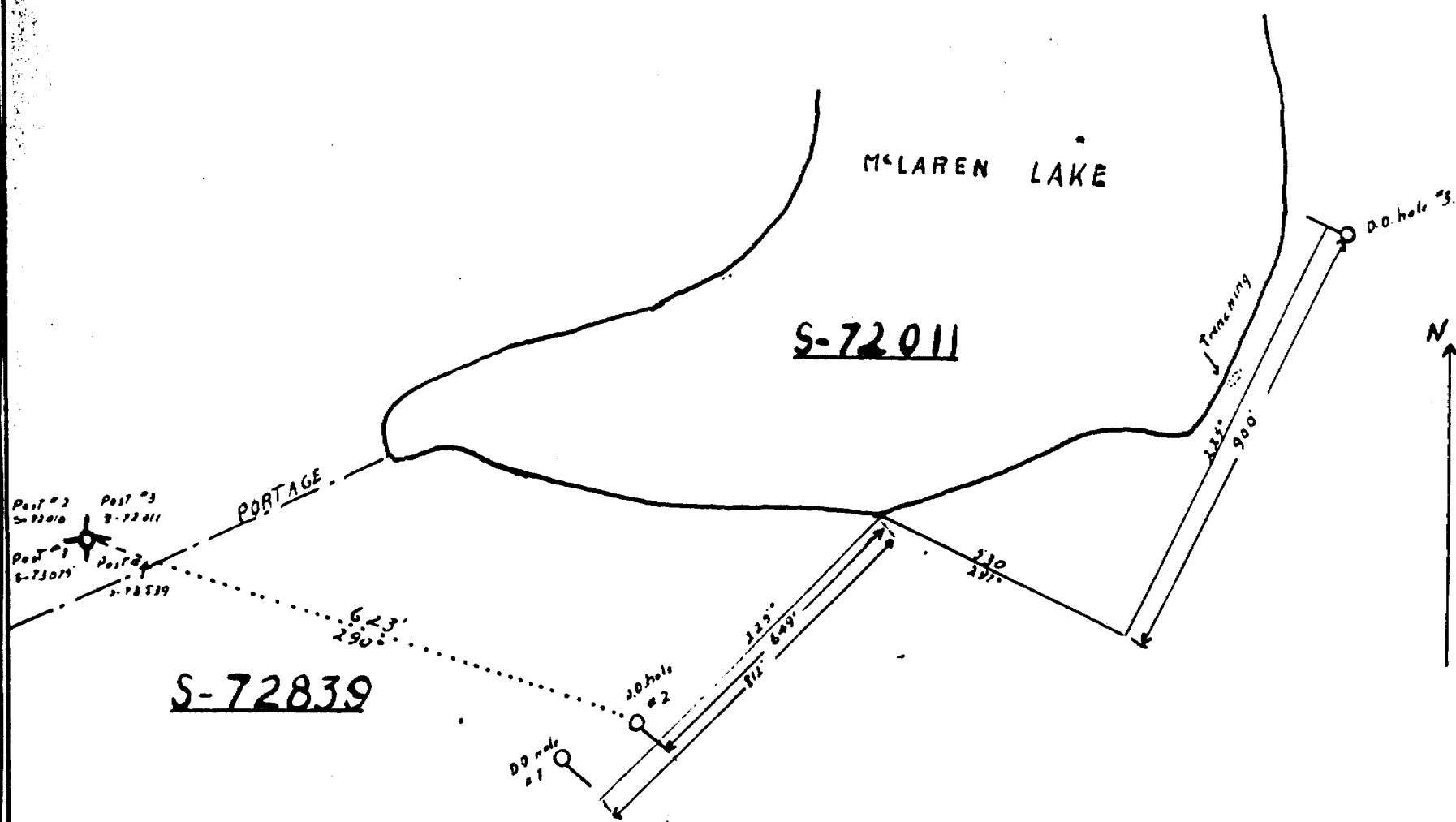

SKETCH Showing location D. D. holes & trenching.

DOLMAC MINES RATHBUN TWP.

Note: (a) Claims marked by a cross are to be allowed to lapse.
 (b) Markings in * red indicate deep work already recorded.

WANAPITEI LAKE

Scale
 1" = 1/8 miles.

DOLMAC MINES LIMITED
 RATHBUN TOWNSHIP
 SKETCH MAP SHOWING
 D.D. HOLES 1, 2, 3, 4, 5, 6, 7, 8, 9, 10, 11
 SCALE 1 INCH = 50 CHAINS

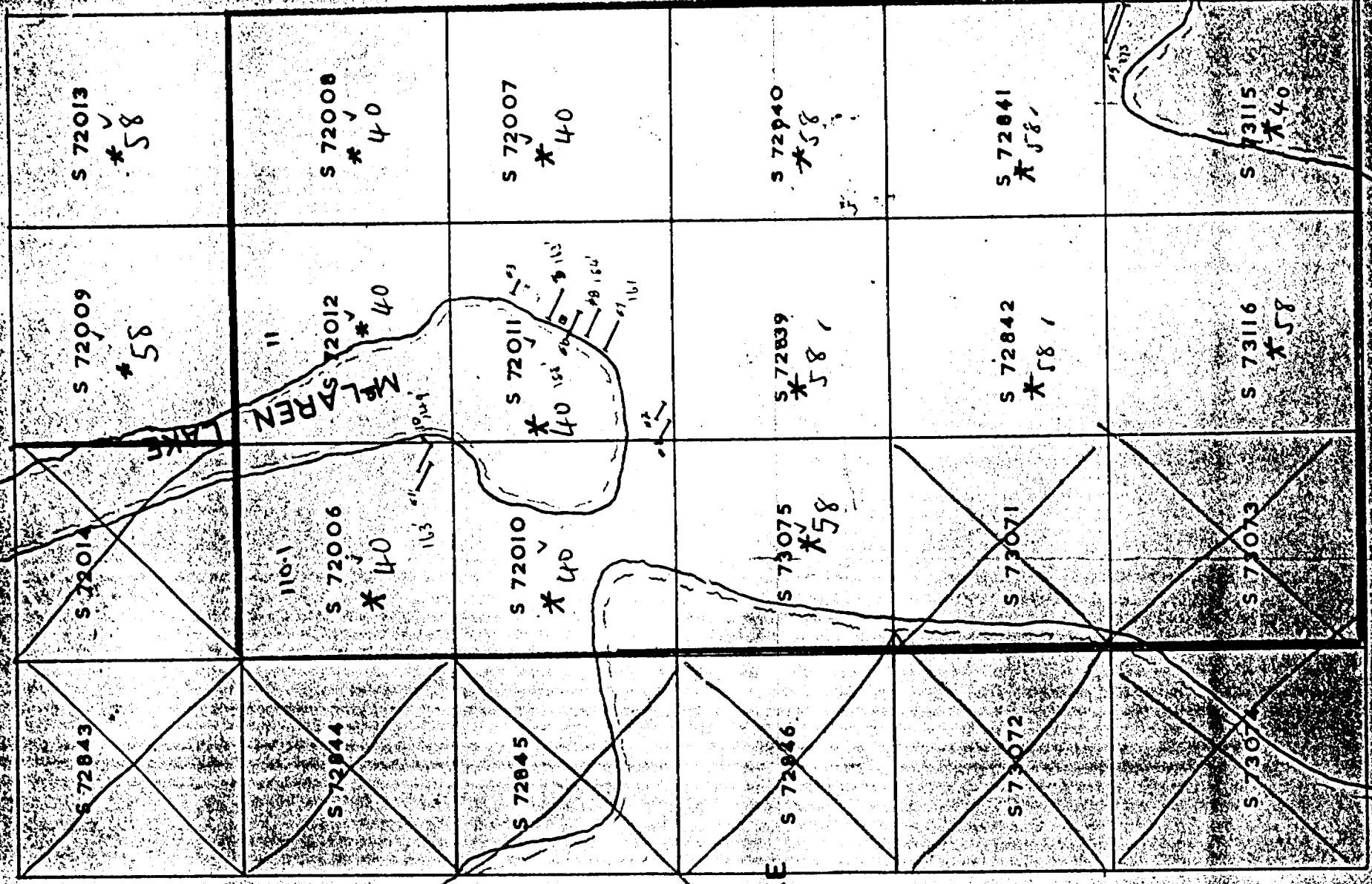

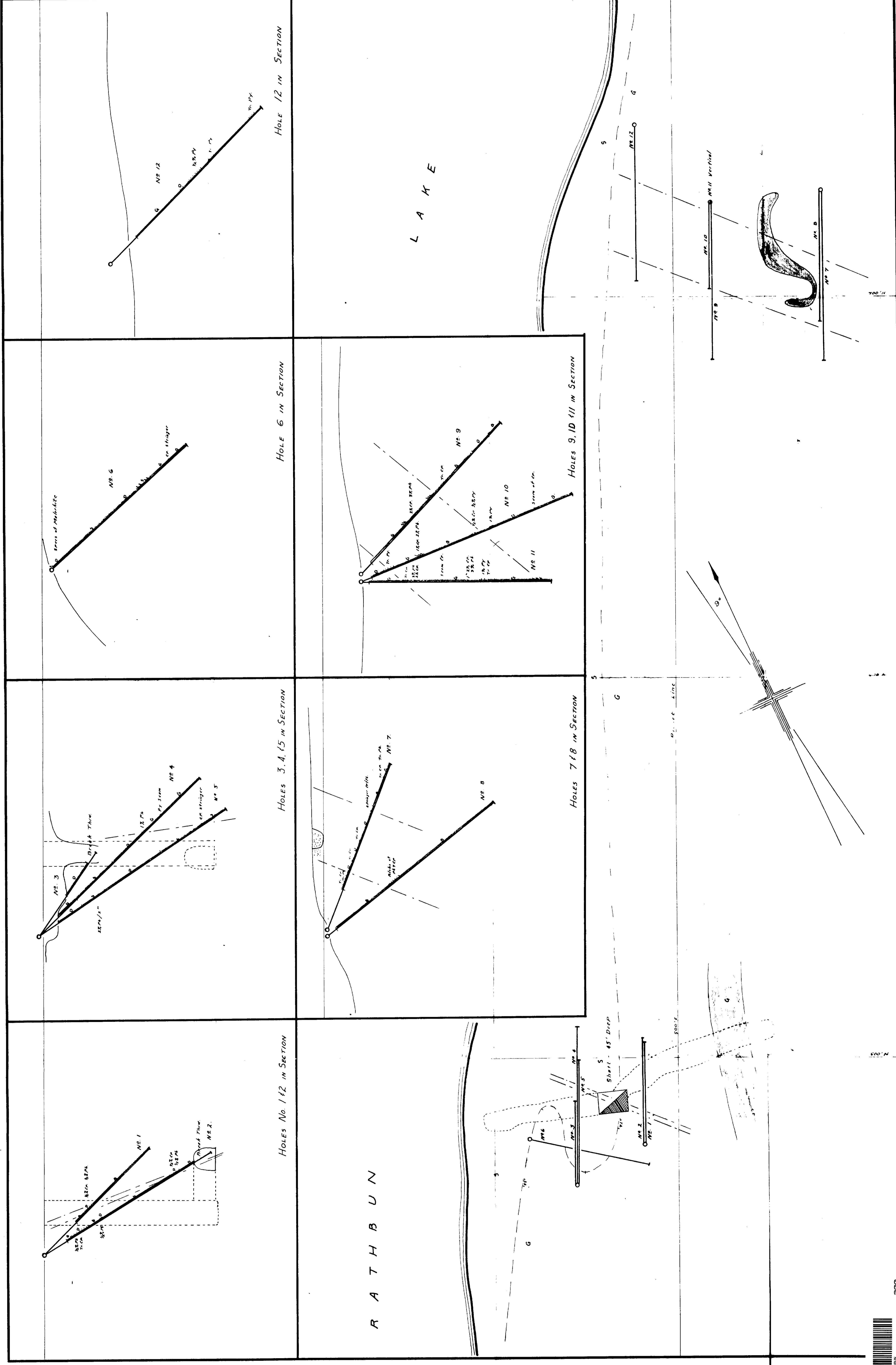

LEGEND

- Drill hole
- Gabbro
- Pyrite
- Chert
- Sediment
- Chertinite
- Pyrobitite
- Disseminated Mineralization
- Shear or Fault Zone
- Zone of Mineralization