



411 155W0003 AYLME14A1 AYLME1

010

(May 10, 1950)

BARRY COPPER SHOWING

AYLMER TOWNSHIP

(THIS SHOWING WAS  
LATER (1958) MAPPED  
SAMPLED & DRILLED BY K. NNCO  
EXPLORATIONS  
(CANADA) LTD.  
Q.E.T.

In 1949 H. Barry, of Sudbury, and associates held a group of 27 claims in the northwest quarter of Aylmer township. These are reached by roads of the Poupore Lumber Company. An old copper discovery lies about 280 feet north of the No.1 post of claim S-52182, No recent work had been done when the writer visited the property in July, 1949.

The copper showing lies in a zone or band of brecciated thinly bedded sediments of the Gowganda formation. The country rock is a thinly laminated greywacke that has a dip of 45 degrees. Insufficient work has been done to outline the brecciated zone but it is at least 350 feet by 50 feet. The breccia consists of very angular pieces of sediments embedded in a matrix of crystalline quartz, carbonate, and chalcopryrite. The breccia matrix contains many vugs and openings. It reminds the writer of fault breccias he has seen at other places but Collins<sup>1</sup> has

---

1. W.H. Collins, Memoir 95, Geol. Surv. Can. 1917, p.68

---

explained the brecciation in this area as being contemporaneous with the formation of the sediments.

At the discovery pit chalcopryrite occurs in the matrix of the breccia across a width of 6.5 feet. A chip sample taken across this width by the writer in 1949 assayed 2.07 per cent copper and traces of gold and silver; no nickel was present in

the sample. A random grab sample of the "ore pile" taken from this pit assayed 2.70 per cent copper and traces of gold and silver but contained no nickel.

Copper stain and traces of chalcopyrite may be seen elsewhere throughout the surface exposures of the breccia but no attempt had been made to blast <sup>open</sup> these areas at the time of the writer's visit.

# DIAMOND DRILL RECORD

Hole No. 1 Sheet No. 1

Property Barry Option  
 Location Aylmer twp.  
drilled on S. 55+20  
 Latitude \_\_\_\_\_  
 Departure \_\_\_\_\_  
 Bearing \_\_\_\_\_

Dip Vertical

---

Total Footage 100'

Elev. Collar \_\_\_\_\_  
 Datum \_\_\_\_\_  
 Date Started Oct. 15th, 1952  
 Date Completed Oct. 30th, 1952  
 Drilled by V. Hicks, Haileybury, Ont.  
 Logged by W. C. Martin

16/10 "  
EXT

Footage		Formation	Sample Number	Sample Footage	Sample Width	Gold Sample	Gold Sludge	Remarks
From	To							
0	7.5	CASING						
7.5	13.5	Brecciated red felsite and highly silicified slate with filling of white quartz and carbonate. A little chalcopyrite and pyrite. Estimate copper content less than 0.5%						
13.5	100.00	Highly silicified laminated Gowganda slate, pinkish colour weak chlorite and amphibole spotting in places. A few quartz stringers with pyrite 53' - 57'. $\frac{1}{2}$ " quartz with considerable pyrite at 73' and 83'. Barren quartz in breccia 88' - 89'.						
100.0		End of hole.						
		<u>CORE WILL BE AT</u> <u>ONT. PYRITES, CHELSEA</u>						

Date of Examination Oct. 30/52

Logged by W. C. Martin

# DIAMOND DRILL RECORD

Hole No. 2 Sheet No. 1

Property Barry Option  
 Location Aylmer twp.  
drilled on S.55425  
 Latitude \_\_\_\_\_  
 Departure \_\_\_\_\_  
 Bearing \_\_\_\_\_

Dip 45 degrees

Elev. Collar \_\_\_\_\_  
 Datum \_\_\_\_\_  
 Date Started Oct. 15th, 1952  
 Date Completed Oct. 30th, 1952  
 Drilled by V. Hicks, Hallowbury, Ont.  
 Logged by H. V. Barry

Total Footage 215'

15/16" EXT

Footage		Formation	Sample Number	Sample Footage	Sample Width	Gold Sample	Gold Sludge	Remarks
From	To							
0	50	Quartz & fine chalcopryrite						
50	75	15% quartz						
75	215	Gowganda laminated slate						
215		End of hole						
<u>CORE AT ONE PYRITES.</u>								

Date of Examination Oct. 30/52

Logged by H. V. Barry



ONTARIO  
DEPARTMENT OF MINES

SUDBURY MINING DIVISION  
SUDBURY, ONTARIO



411155W0003 AYLNER14A1 AYLNER

900

October 31, 1952.

Dr. M. E. Hurst,  
Provincial Geologist,  
Ont. Dept. of Mines,  
Parliament Buildings,  
TORONTO, Ontario.

Dear Sir:-

Enclosed please find logs of diamond drilling  
and sketch submitted by H. V. Barry, Gatchell, Ont., on Mining  
Claims in Aylmer Township.

Yours very truly,

JRM:GA  
Encls.

  
J. R. McCann,  
Mining Recorder.

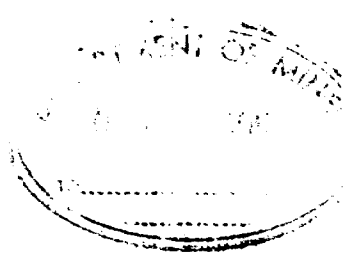

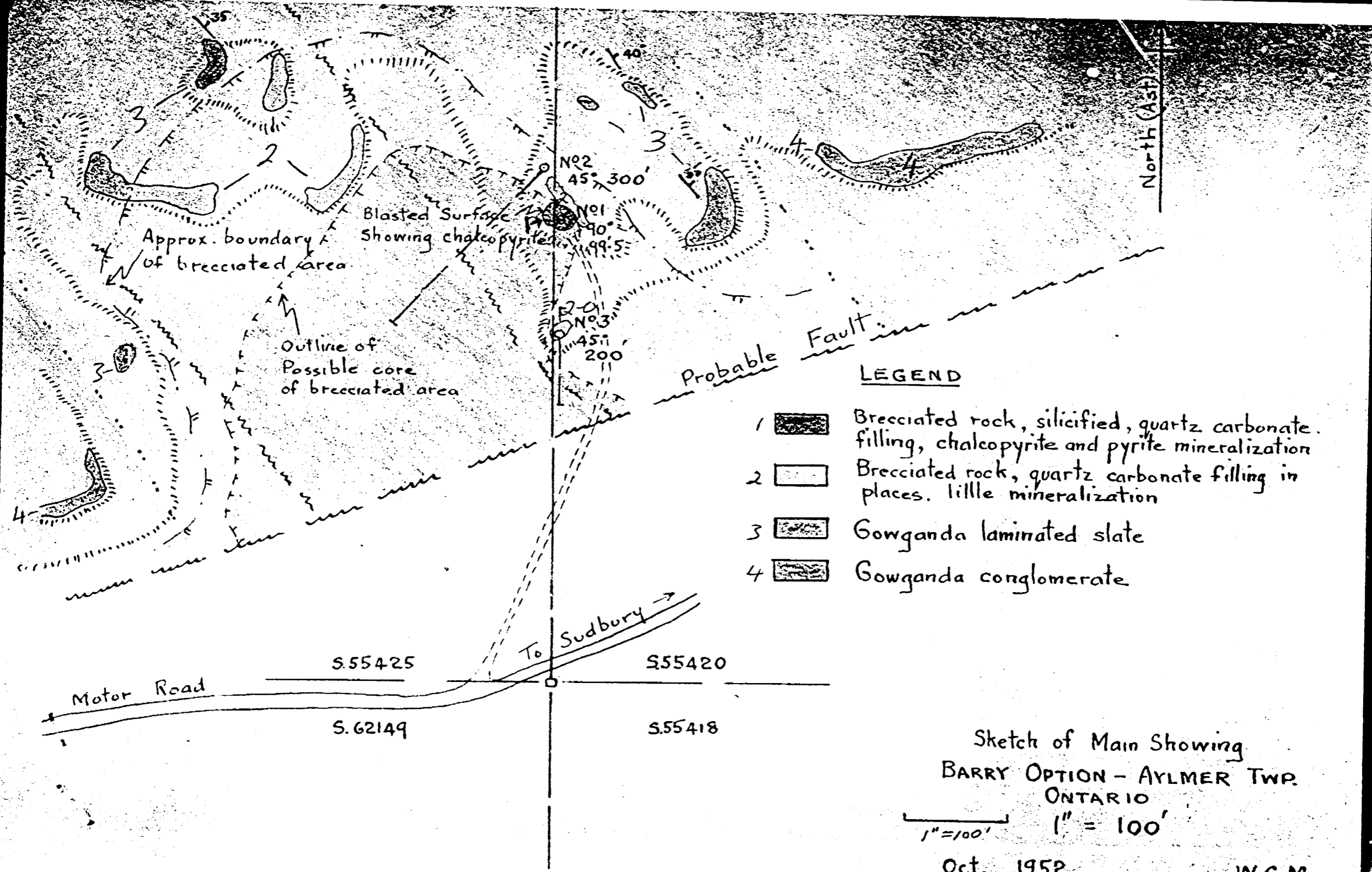

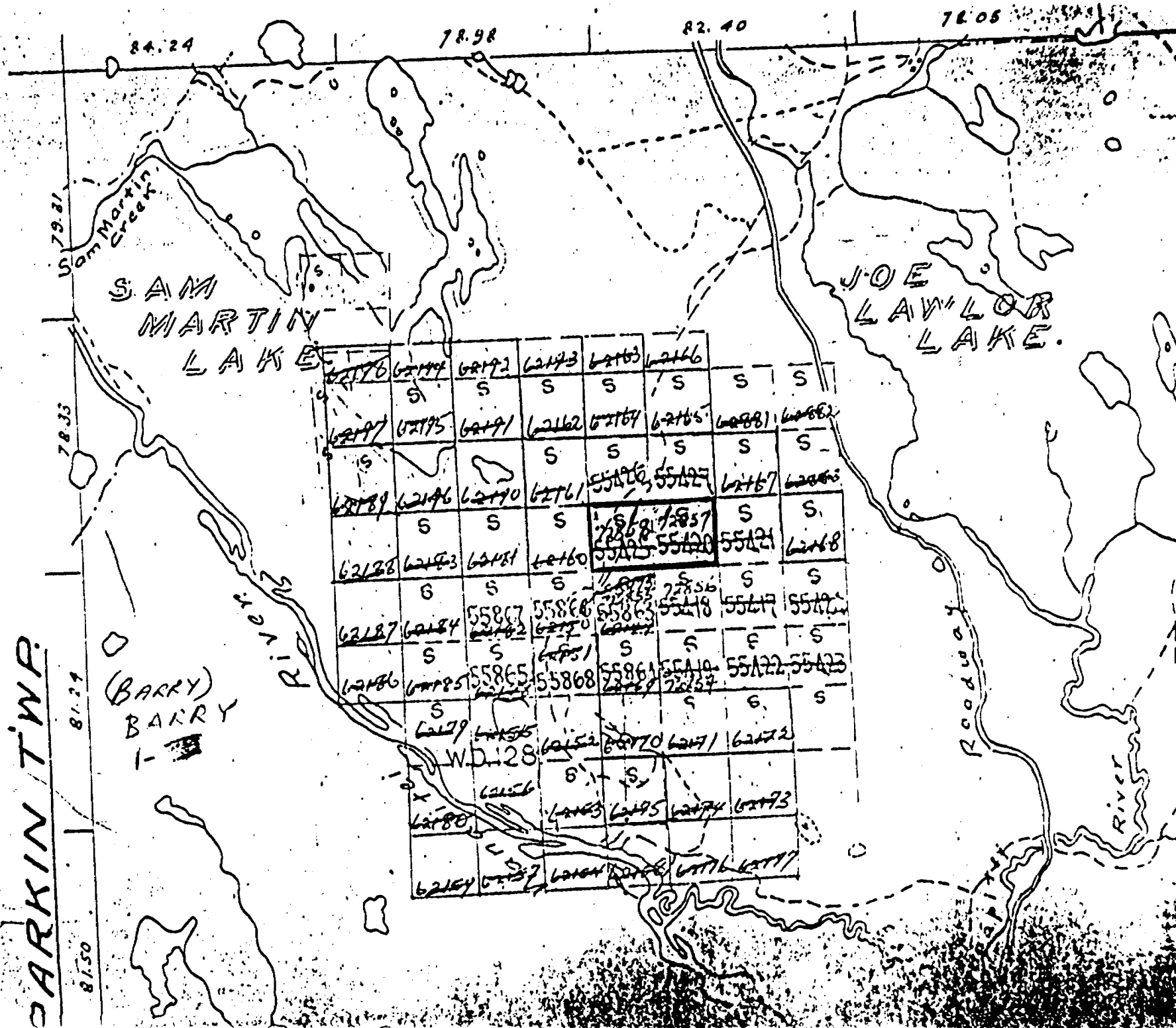

SAM  
MARTIN  
LAKE

JOE  
LAW'OR  
LAKE.

SARVIN TWP.

(BARRY)  
BARRY

SARVIN  
RIVER

Roadway

River

62176	62177	62172	62173	62173	62176		
S	S	S	S	S	S	S	S
62177	62175	62171	62162	62167	62165	62161	62162
S			S	S	S	S	S
62179	62176	62170	62161	55126	55127	62167	62163
S	S	S	S	55128	55127	S	S
62178	62173	62171	62160	55125	55128	55121	62168
S	S	S	S	55125	55128	55121	62168
62187	62184	55867	55866	55863	55118	55117	55115
S	S	62170	62171	62170	S	S	S
62186	62185	55865	55868	55864	55110	55122	55123
S	S			62170	62171	62172	
62180	62179	62175	62172	62170	62171	62172	
62184	62183	62184	62186	62176	62177		

1 ELFER 1 WF.

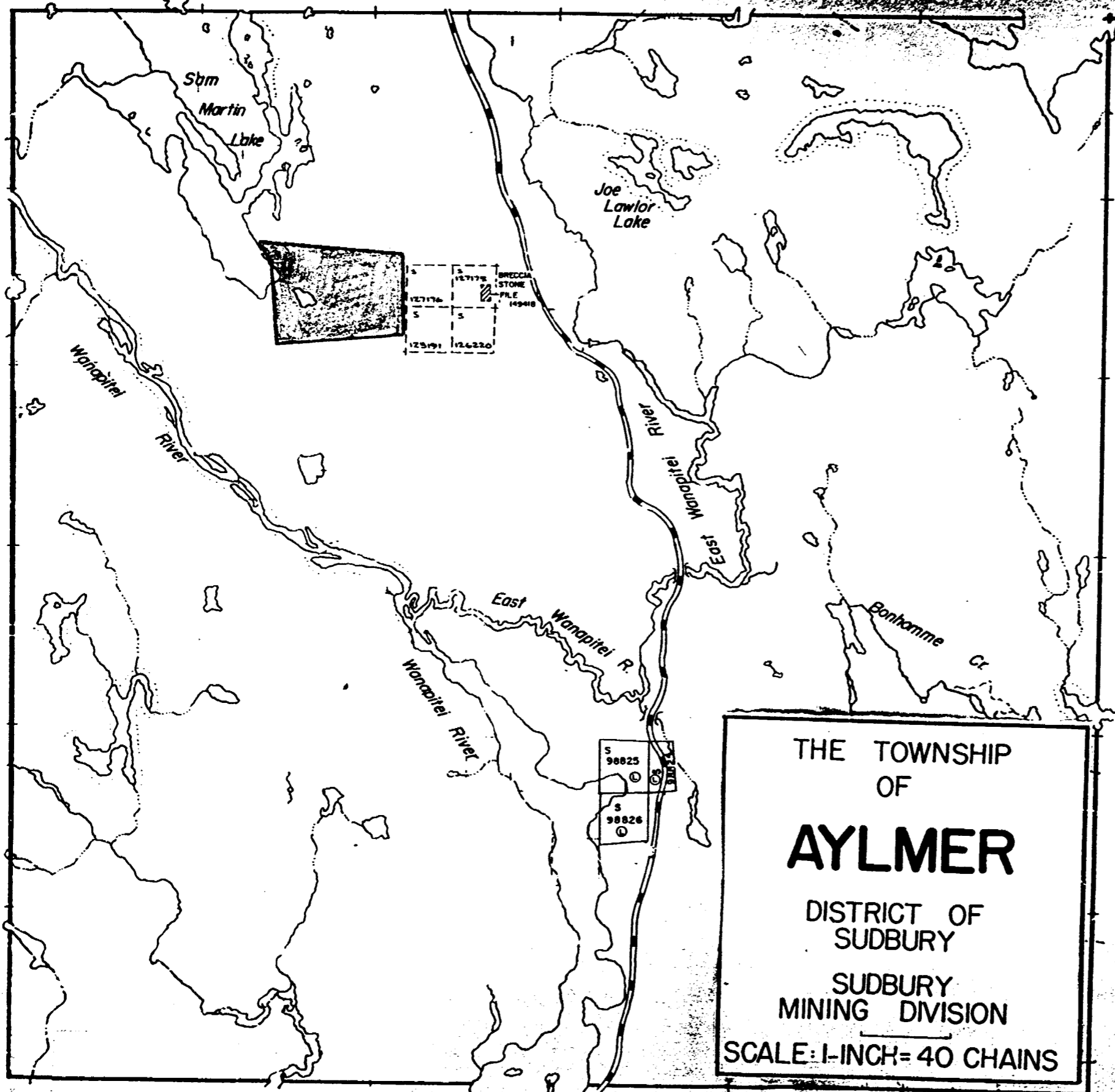

PARKIN TWP.

MACKELCAN TWP.

Barry, H.V.

PARTIAL TWP.