



4115SW0004 0010C1 AYLNER

010

# Diamond Drilling

Township OF AYLNER

Report NO: 12

Work performed by: JOHN BILLOKI

Claim NO	Hole NO	Footage	Date	Note
S 123191	B-1	369'	May/65	
	<u>B-2</u>	<u>541'</u>	May/65	
	TOTAL: 2 DH	910'		

Notes:



# DIAMOND DRILL GEOLOGICAL LOG

40 SCALE

COLOR PLOT & DIPS

ORE CLASSES

OBJECTIVE:

SAMPLED:

LOGGED BY:

DATE:

COMPOSITES:

LOGS:

SECT:

PLACE:

APP. BEAR:

APP. DIP:

LENGTH

FROM

TO

REMARKS:

REASON:

*FROM 168  
TO 369*

Quartzite - mainly grey well bedded with some buff coloured quartzite due to alteration effects.

195 - <sup>bedding</sup> bedding parallel to core

226.6 - few spots chalcopyrite in slightly brecciated irregular pink carbonate vein

236 - 239 - light buff coloured

237.5 - 3/4" massive pyrite in white carbonate vein

246 - 248 - flesh coloured quartzite, pyrite crystals with 1/4" pyrite vein cutting core at 80° at 247.

257 - 260 - flesh coloured quartzite

305.5 - 308 - buff quartzite, bedding parallel, narrow py seam at 307

326 - 3/4" carbonate vein

336 - 1/8" pyrite seam

END OF HOLE 369 feet

*END OF HOLE: 369 FEET*

CORE SIZE

HOLE No.

PAGE

*B-1*

*2*

# DIAMOND DRILL GEOLOGICAL LOG

40 SCALE

**SUBJECTIVE:** To determine cause of I.P. anomaly.  
*TO DETERMINE CAUSE OF I.P. ANOMALY*

**LOGGED BY:** R.E. Robinson  
*R.E. ROBINSON*

**DATE:** May 26, 1965

**SAMPLED:**

**COMPOSITES:**

**LOGS:** /

**SECT:** LHM/9450N

**PLACE:** Aylmer Twp., Ontario

**APP. BEAR:** 207° azi.

**APP. DIP:** -45°  
 -42° at 300 ft.  
 -42° AT 350'

**LENGTH:** 541 feet  
*541 FEET*

(Billoxi Property)

FROM	TO	DISCARD:	REASON:
0	5	Casing	
(5)	130	Slaty quartzite - grey, fine grained, bedded from normal to 85° to core axis	
(5)	(130)	56 - 1/4" pink carbonate vein with few spots pyrite and chalcopyrite?	
		59 - 7/8" - contains white spots of alteration minerals	
		65 - 1/2" brecciated white carbonate vein	
		94 - 1/2" brecciated quartzite, pyrite	
		99 - 1/8" carbonate vein, pyrite and magnetite	
		110 - 115 - narrow hematite stringers in buff coloured rock	
130	233	Quartzite - buff and grey interbedded, generally hard and dense fine grained but with some softer dark coloured argillaceous beds. Also some greywacke beds. Bedding normal to 80° to core axis. Occasional thin network of quartz veins. Altered to pink-buff colour around quartz carbonate veins, some magnetite in carbonate veins.	
		190.5, 214 - 215 - bedding contorted	
233	281	Conglomerate - grey matrix with mainly granitic boulders of random size but generally small pebbles. Few narrow quartz-carbonate veins throughout.	
		233 - 248 - pebbles scarce	
		252 - some chalcopyrite in 1/8" quartz-carbonate vein	
		257.5 - few specs chalcopyrite in 1/4" carbonate vein	
		259 - 8" granitic boulder	
		264 - 264.7 - few spots of chalcopyrite and magnetite in thin quartz-carbonate vein.	
		271.5 - 1/2" quartz-carbonate vein at steep angle with few pyrite crystals and blebs of magnetite. <i>With few pyrite crystals and blebs</i>	

**CORE SIZE** AXT

**HOLE NO.** B-2      **PAGE** 1

**COLOR IN LOG & CORE**      **ORE CLASS**

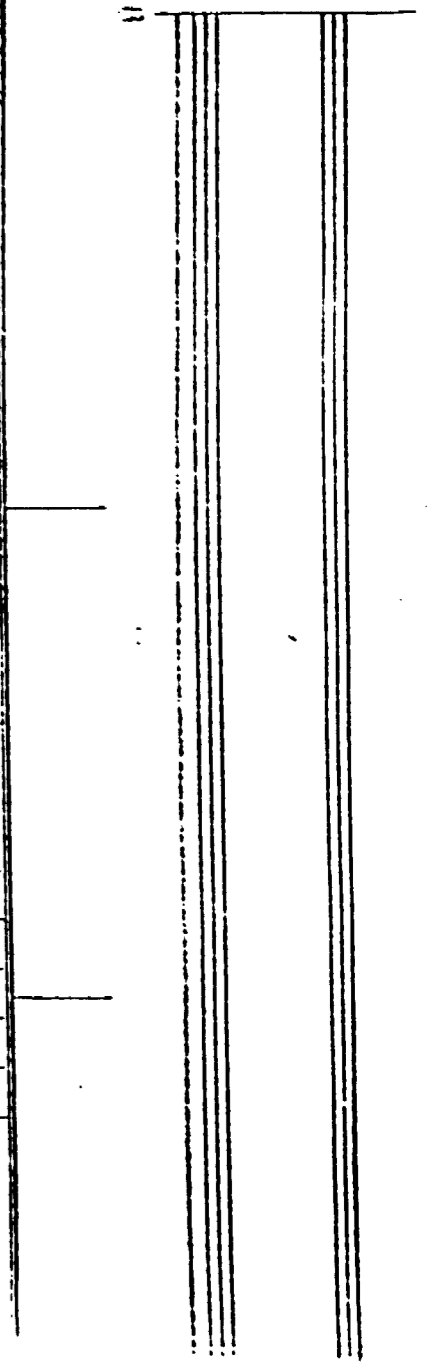

# DIAMOND DRILL GEOLOGICAL LOG

40 SCALE

OBJECTIVE: \_\_\_\_\_  
 LOGGED BY: \_\_\_\_\_ DATE: \_\_\_\_\_

SAMPLED: \_\_\_\_\_  
 COMPOSITES: \_\_\_\_\_

COLOR PLOT & SHEETS      CORE CLASSES A

CORE:	DEPTH:	PLACE:	APP. BEAR:	APP. DIP:	LENGTH:
-------	--------	--------	------------	-----------	---------

NO.	TO	DISCARD:	REASON:
-----	----	----------	---------

279 - 1/8" quartz-carbonate, few spots chalcopyrite.

281 (369) Greywacke - grey-green, thinly bedded, fine grained but with some coarser beds, occasional pebble near top of section.  
 281) (369) Occasional 1/8" to 1/4" quartz-carbonate stringer with few pyrite crystals.

300 - bedding 80° to core axis  
 and 320

321 and 321.5 - chalcopyrite along paper thin quartz-carbonate vein.

369 (438) Greywacke - grey to light buff coloured, similar to previous section except for colour, thinly bedded.

378 - bedding 80° to core axis  
 380 - some alteration and dislocation of beds along fractures  
 386 - 1" quartz-carbonate vein  
 390, 398 - 1/8" to 1/4" quartz-carbonate veins  
 405, 414 - narrow carbonate veins, few specs cp with py  
 410 - bedding 80° to core axis  
 417 - 1/8" hematite vein  
 420 - few irregular white carbonate veins  
 429, 434, 436 - narrow (up to 1/4") carbonate veins, few spots pyrite

438 (513) Quartzite (QUARTZITE)  
 438 - 463 - light buff, hard, well fractured, numerous quartz-carbonate veins some with hematite and pyrite.

~~(463-513) - buff + grey quartzite, bedded at 85° at 480.~~  
 463 - 513 - buff and grey quartzite, bedded at 85° at 480.  
 504 - 1" brecciated material filling fracture  
 (504 - 1" brecciated material filling fracture.)

CORE SIZE

HOLE NO.	PAGE
11-2	2
R-2	2

# DIAMOND DRILL GEOLOGICAL LOG

40 SCALE

OBJECTIVE:  
 LOGGED BY: \_\_\_\_\_ DATE: \_\_\_\_\_

SAMPLED:  
 COMPOSITES:

COLOR PLOT & SHEET ONE CLASSIFIED

BLOCK: \_\_\_\_\_ SECT: \_\_\_\_\_ PLACE: \_\_\_\_\_ APP. BEAR: \_\_\_\_\_ APP. DIP: \_\_\_\_\_ LENGTH: \_\_\_\_\_

FROM	TO	DISCARD:	REASON:
		507 - 1" quartz-carbonate vein, pyrite	(507 - 1" QUARTZ-CARBONATE VEIN, PYRITE)
513	521	Breccia - mainly breccia, quartzite fragments in pink and white carbonate and quartz matrix.	
(513)	(521)	513 - 519 - matrix pink carbonate surrounding small angular quartzite fragments, few blebs chalcopyrite.	
		520 - 3" pink carbonate vein	
521	541	Quartzite - buff to grey banded, very hard and dense, some minor brecciation along fractures.	
(521)	(541)	522 - bedding 70°	
		534 - bedding 60°	
END OF HOLE 541 feet			
(END OF HOLE 541 FEET)			

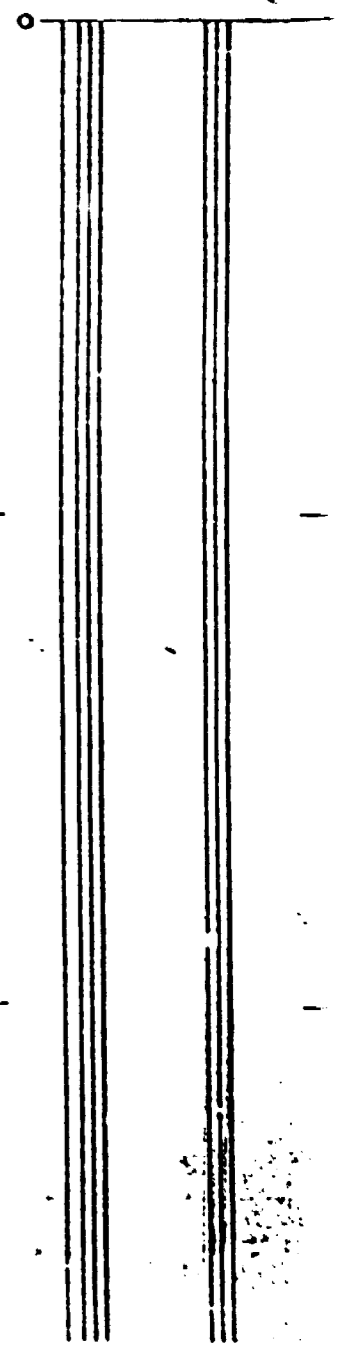

CORE SIZE

HOLE NO

PAGE

B2

3

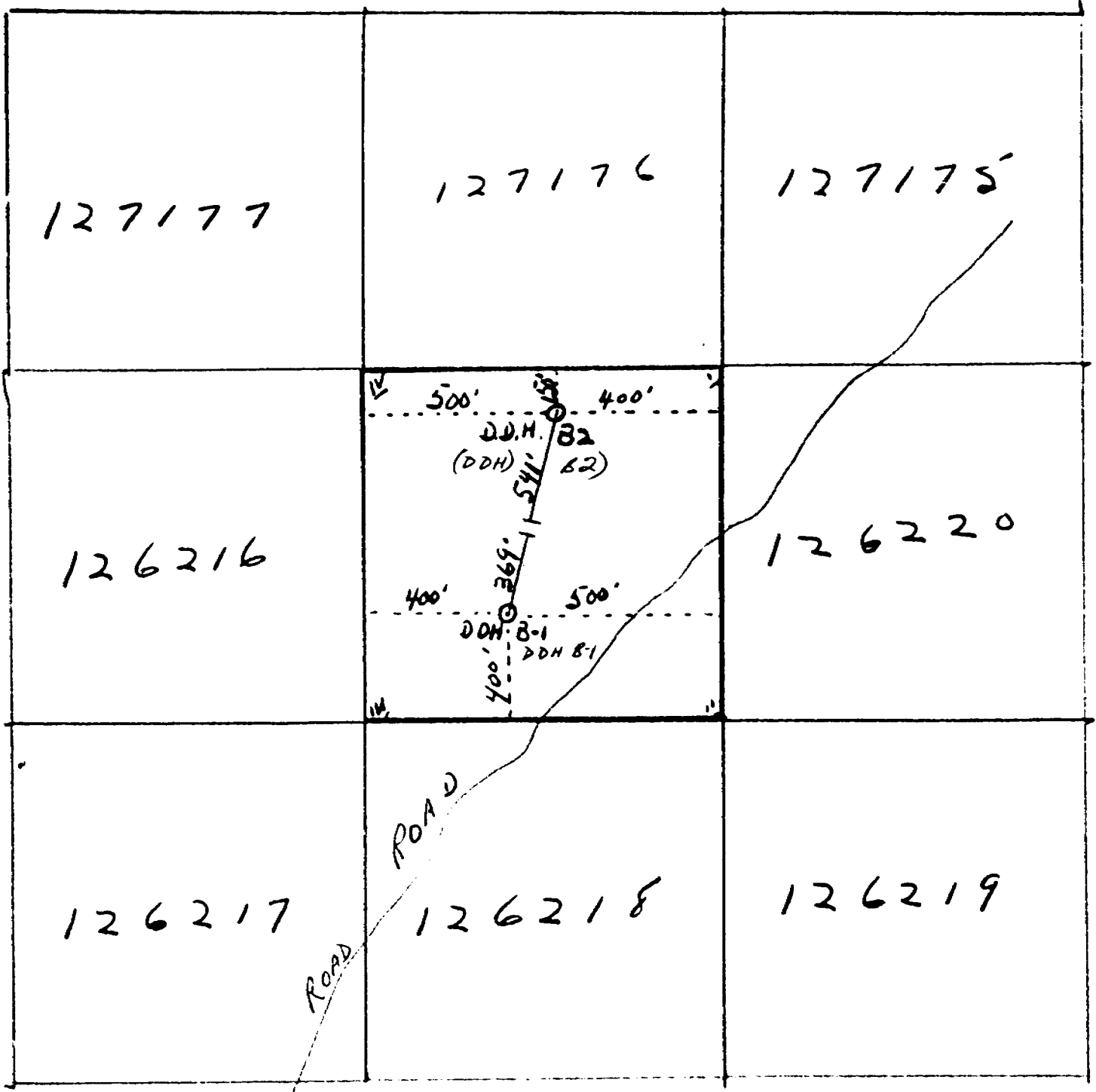

SKETCH SHOWING LOCATION OF D.D.H. # B1 - B2  
 CLAIM # 123191 AYLMER TWP. S. M. DIV.

J. J. Billotti



411155W0004 0010C1 AYLME

October 5th, 1965.

900

Dr. K.D. Card,  
Provincial Geologist,  
Box 1030,  
Sudbury, Ontario.

Dear Sir:

Enclosed herewith please find diamond drill  
log and sketch pertaining to work performed in Aylmer  
Township on claim S.123191, in the name of John J.  
Billoki.

Yours very truly,

*per R. Dural*

K.M. Hallock,  
Mining Recorder.

Encl: