

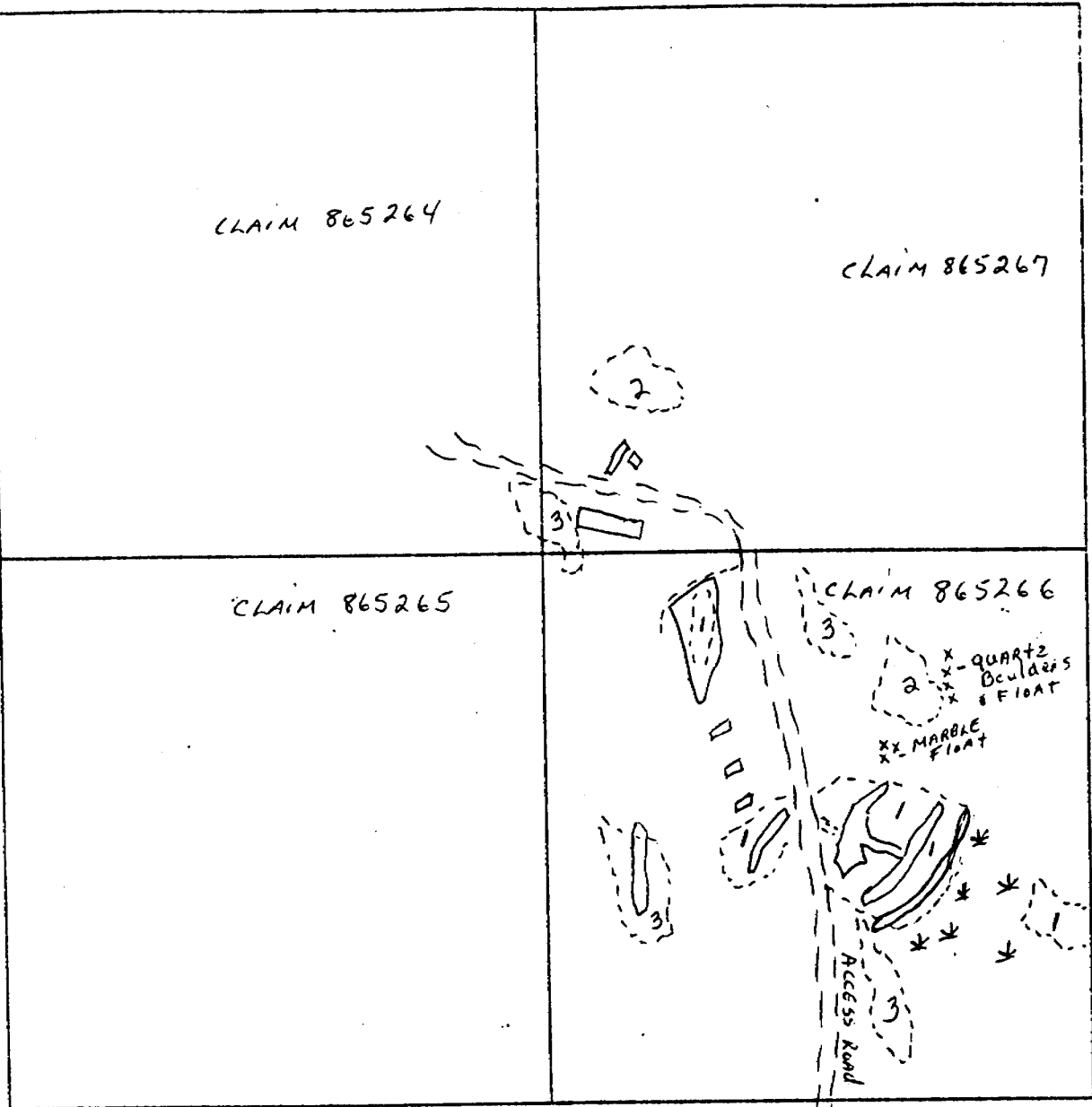

411155W0010 63.5713 PARKIN

010



Scale - 1:5000

1cm = 50m

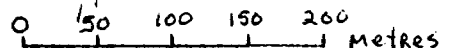

① Base Map Reference G2915      ② Refer to Detail Map No. II-B-HARAMA

③ Legends: ▨ - TRENCH AREA      ⊥ - SWAMP      (---) MARBLE  
(2) siltstone      (3) Gabbro

Work Location	Type of Work	Dimensions	Assays & Ref. No's	Other
REFER TO DETAIL MAP II-B AND "description of trenching" sheet.				

NOTES:

# HARAMA PROJECT

PARKIN TWP - DETAIL MAP II-B

REFER TO LOCATION MAP II-B

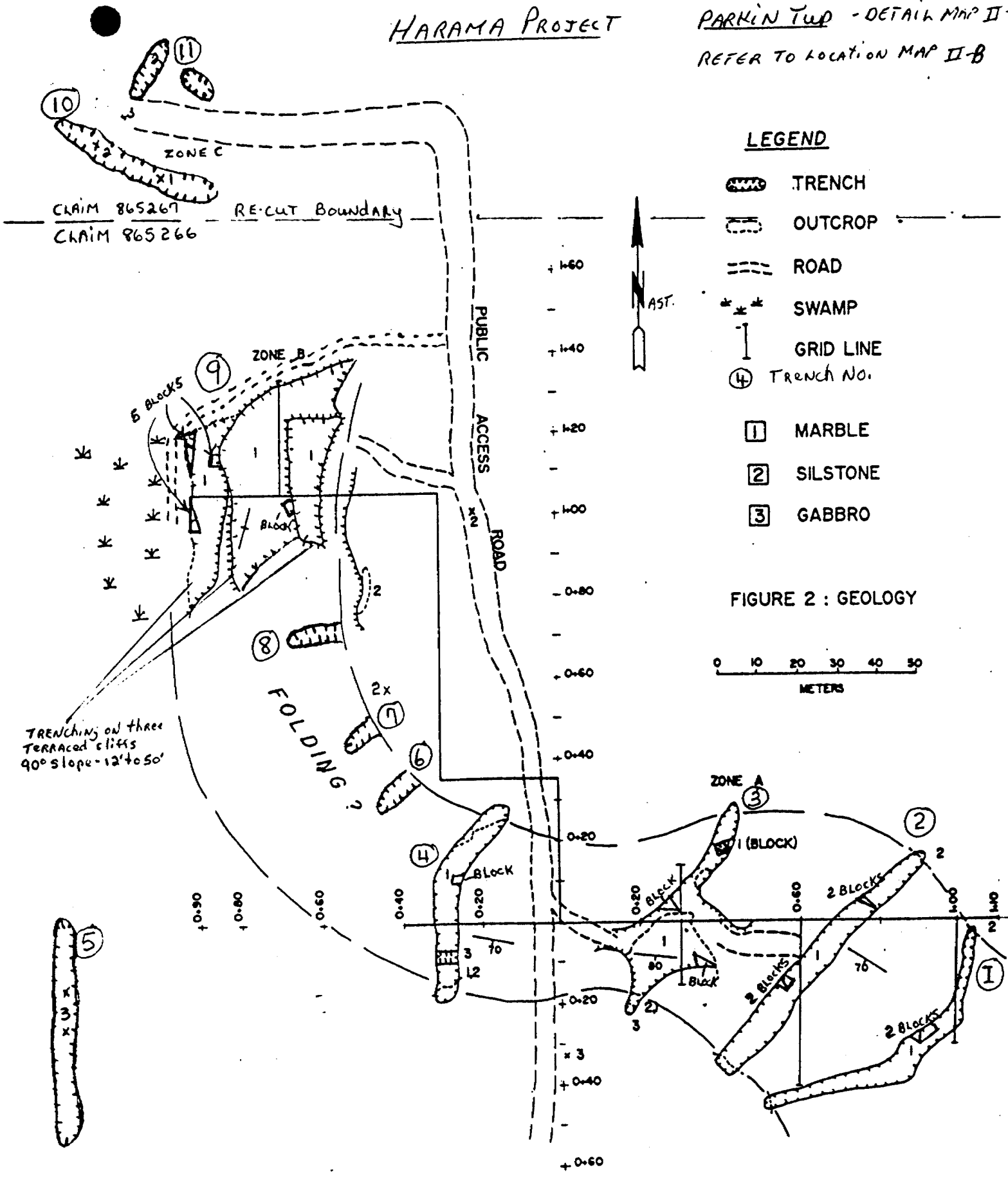

## LEGEND

- TRENCH
- OUTCROP
- ROAD
- SWAMP
- GRID LINE
- TRENCH NO.

- MARBLE
- SILSTONE
- GABBRO

FIGURE 2 : GEOLOGY

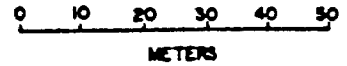

Description of TRENCHING, STONE REMOVED AND Method

OMEP  
J. BRADY / 91

TRENCH NO.	DIMENSIONS	MARBLE COLOR	MARBLE TYPE	EXCAVATED BLOCK SIZES	EQUIPMENT used
①	75M X 5M X 1.8M	PINK/GREEN	Layered, wavy lines 1-3cm banding	17 Blocks 1M X 1M X 5M 1 Block .7M X .6M X .5M 2 Blocks .6M X .5M X .8M	gas drill - portable gas excavator gas water pump hydraulic drill
②	75M X 5M X 2M	PINK/GREEN bluegray/buff	" " "	1 Block 2M X 1.5M X 1.5M 2 Blocks .6M X .6M X .5M 1 Block .7M X .5M X .4M	hydraulic excavator hydraulic excavator
③	60M X 15M X 1.7M	PINK/GREEN	" " "	1 Block 2M X 1.5M X 1.5M 2 Blocks .6M X .6M X .5M 1 Block .7M X .5M X .4M	+ manual tools - chisels shovels, scrapers
④	+ 40M X 20M X 1.7M 55M X 6M X 1.8M	grey/green PINK/GREEN	" " "	1 Block 2M X 1.5M X 1.5M 2 Blocks .6M X .6M X .5M 1 Block .7M X .5M X .4M	brooms, pulleys, chains, axes etc.
⑥⑦⑧	Total 16M X 5M X 2.7M	No Bedrock	MUSKEG & GRAVEL		+ vehicles Boom Truck HX Hs. X2
⑨ EAST	40M X 15M X 1.5M	PINK/GREEN	Layered, wavy lines 1-3cm banding	1 Block .7M X .6M X 1.5M 1 Block .7M X .5M X 1M 4 Blocks 2.5M X 2M X 1.5M 1 Block 600CM X 500CM X 300CM	+ cutting and polishing equipment AT Khouri GRANITE AND ELLERO MARBLE AND HERCULES STONE
⑨ CENTRE	45M X 20M X 1.5M	PINK/GREEN RUST/GREEN/GREY	BRECCIA MARBLE		
⑨ WEST	30M X 6M X 1M	" "	" "		
⑩	40M X 5M X 1.6M	PINK/GREEN	Layered, wavy lines 1-3cm banding		
⑪	Total 25M X 5M X 1.5M	SILTSTONE			

Report of Work Conducted After Recording Claim

Mining Act

W.R.C. Physical

Transaction Number  
W9270.00016

Personal information collected on this form is obtained under the authority of the Mining Act. This collection should be directed to the Provincial Manager, Mining Lands, 1 Sudbury, Ontario, P3E 6A5, telephone (705) 670-7264.



900

- Instructions:**
- Please type or print and submit in duplicate.
  - Refer to the Mining Act and Regulations for requirements of filing assessment work or consult the Mining Recorder.
  - A separate copy of this form must be completed for each Work Group.
  - Technical reports and maps must accompany this form in duplicate.
  - A sketch, showing the claims the work is assigned to, must accompany this form.

Recorded Holder(s) <i>John Brady</i>	Client No. <i>111562</i>
Address <i>1227 Holland Rd. Sudbury, ONT. P3A3R1</i>	Telephone No. <i>5660613</i>
Mining Division <i>Sudbury</i>	Township/Area <i>PARKIN</i>
M or G Plan No. <i>62915</i>	
Dates Work Performed From: <i>April 1/91</i>	To: <i>NOV 30/91</i>

Work Performed (Check One Work Group Only)

Work Group	Type
Geotechnical Survey	
Physical Work, Including Drilling	<i>Power Stripping, Trenching, washing, manual/mechanical</i>
Rehabilitation	
Other Authorized Work	
Assays	
Assignment from Reserve	

ONTARIO GEOLOGICAL SURVEY  
GIS - ASSESSMENT FILES  
JUN 16 1992  
**RECEIVED**

Total Assessment Work Claimed on the Attached Statement of Costs \$ *37,770*

**Note:** The Minister may reject for assessment work credit all or part of the assessment work submitted if the recorded holder cannot verify expenditures claimed in the statement of costs within 30 days of a request for verification.

Persons and Survey Company Who Performed the Work (Give Name and Address of Author of Report)

Name	Address
<i>J BRADY</i>	<i>1227 Holland Rd. Sudbury, ONT.</i>

(attach a schedule if necessary)

Certification of Beneficial Interest \* See Note No. 1 on reverse side

I certify that at the time the work was performed, the claims covered in this work report were recorded in the current holder's name or held under a beneficial interest by the current recorded holder.	Date <i>Mar 30/92</i>	Recorded Holder or Agent (Signature) <i>J Brady</i>
--	--------------------------	--

Certification of Work Report

I certify that I have a personal knowledge of the facts set forth in this Work report, having performed the work or witnessed same during and/or after its completion and annexed report is true.		
Name and Address of Person Certifying <i>J. BRADY 1227 Holland Rd. Sudbury, ONT. P3A3R1</i>		
Telephone No. <i>5660613</i>	Date <i>Mar 30/92</i>	Certified By (Signature) <i>J Brady</i>

For Office Use Only

Total Value Cr. Recorded <i>Reserve</i> <i>311910</i>	Date Recorded <i>April 2/92</i>	Mining Recorder <i>[Signature]</i>	Received Stamp <i>APR. 2, 1992</i> <i>[Signature]</i>
	Deemed Approval Date <i>July 11/92</i>	Date Approved <i>[Signature]</i>	
	Date Notice for Amendments Sent		

Work Report Number for Applying Reserve	Claim Number (see Note 2)	Number of Claim Units
	865246	1
	865267	1
2		2

**Total Number of Claims**

Value of Assessment Work Done on this Claim	Value Applied to this Claim
20,000 <sup>1/2</sup>	
<del>10,910</del>	
8m.	
31,910.	

**Total Value Work Done**

**Total Value Work Applied**

Value Assigned from this Claim	Reserve: Work to be Claimed at a Future Date
	20,000
	11,910
	31,910.

**Total Assigned From**

**Total Reserve**

Credits you are claiming in this report may be cut back. In order to minimize the adverse effects of such deletions, please indicate from which claims you wish to prioritize the deletion of credits. Please mark (✓) one of the following:

1.  Credits are to be cut back starting with the claim listed last, working backwards.
2.  Credits are to be cut back equally over all claims contained in this report of work.
3.  Credits are to be cut back as prioritized on the attached appendix.

In the event that you have not specified your choice of priority, option one will be implemented.

**Note 1:** Examples of beneficial interest are unrecorded transfers, option agreements, memorandum of agreements, etc., with respect to the mining claims.

**Note 2:** If work has been performed on patented or leased land, please complete the following:

I certify that the recorded holder had a beneficial interest in the patented or leased land at the time the work was performed.	Date
Signature	



Ministry of  
Northern Development  
and Mines

Ministère du  
Développement du Nord  
et des mines

Statement of Costs  
for Assessment Credit

État des coûts aux fins  
du crédit d'évaluation

Mining Act/Loi sur les mines

WORK REPORT "C" - Physical.

Transaction No./N° de transaction  
W 9270.00016

Personal information collected on this form is obtained under the authority of the Mining Act. This information will be used to maintain a record and ongoing status of the mining claim(s). Questions about this collection should be directed to the Provincial Manager, Minings Lands, Ministry of Northern Development and Mines, 4th Floor, 159 Cedar Street, Sudbury, Ontario P3E 6A5, telephone (705) 670-7264.

Les renseignements personnels contenus dans la présente formule sont recueillis en vertu de la Loi sur les mines et serviront à tenir à jour un registre des concessions minières. Adresser toute question sur la collecte de ces renseignements au chef provincial des terrains miniers, ministère du Développement du Nord et des Mines, 159, rue Cedar, 4<sup>e</sup> étage, Sudbury (Ontario) P3E 6A5, téléphone (705) 670-7264.

1. Direct Costs/Coûts directs

Type	Description	Amount Montant	Totals Total global
Wages Salaires	Labour <sup>Prospecting</sup> Main-d'oeuvre <sup>MANUAL</sup>	5500	5500
	<sup>mechanical</sup>	7450	5950
	Field Supervision Supervision sur le terrain		5300 5950
Contractor's and Consultant's Fees Droits de l'entrepreneur et de l'expert- conseil	Type EXCAVATING/renting	10095	
	MANUAL/mechanical	2600	
	MANUAL/mechanical	3200	15,895.
Supplies Used Fournitures utilisées	Type		
Equipment Rental Location de matériel	Type Hydraulic DRILL	3611.	
	GAS EXCAVATOR		
	GAS drille pump	3877	
Total Direct Costs Total des coûts directs			7488. 28,883

2. Indirect Costs/Coûts indirects

\*\* Note: When claiming Rehabilitation work Indirect costs are not allowable as assessment work.  
Pour le remboursement des travaux de réhabilitation, les coûts indirects ne sont pas admissibles en tant que travaux d'évaluation.

Type	Description	Amount Montant	Totals Total global
Transportation Transport	Type HX4 90KM X 55 trips X.30	1485	
			1485
Food and Lodging Nourriture et hébergement		1542	1542
Mobilization and Demobilization Mobilisation et démobilisation			
Sub Total of Indirect Costs Total partiel des coûts indirects			3027
Amount Allowable (not greater than 20% of Direct Costs) Montant admissible (n'excédant pas 20 % des coûts directs)			3027
Total Value of Assessment Credit (Total of Direct and Allowable Indirect costs)			Valeur totale du crédit d'évaluation (Total des coûts directs et indirects admissibles) 31,910

Note: The recorded holder will be required to verify expenditures claimed in this statement of costs within 30 days of a request for verification. If verification is not made, the Minister may reject for assessment work all or part of the assessment work submitted.

Note: Le titulaire enregistré sera tenu de vérifier les dépenses demandées dans le présent état des coûts dans les 30 jours suivant une demande à cet effet. Si la vérification n'est pas effectuée, le ministre peut rejeter tout ou une partie des travaux d'évaluation présentés.

Filing Discounts

- Work filed within two years of completion is claimed at 100% of the above Total Value of Assessment Credit.
- Work filed three, four or five years after completion is claimed at 50% of the above Total Value of Assessment Credit. See calculations below:

Total Value of Assessment Credit	Total Assessment Claimed
	× 0.50 =

Remises pour dépôt

- Les travaux déposés dans les deux ans suivant leur achèvement sont remboursés à 100 % de la valeur totale susmentionnée du crédit d'évaluation.
- Les travaux déposés trois, quatre ou cinq ans après leur achèvement sont remboursés à 50 % de la valeur totale du crédit d'évaluation susmentionné. Voir les calculs ci-dessous.

Valeur totale du crédit d'évaluation	Évaluation totale demandée
	× 0,50 =

Certification Verifying Statement of Costs

I hereby certify:  
that the amounts shown are as accurate as possible and these costs were incurred while conducting assessment work on the lands shown on the accompanying Report of Work form.

that as Recorded Holder am authorized  
(Recorded Holder, Agent, Position in Company)

to make this certification

Attestation de l'état des coûts

J'atteste par la présente :  
que les montants indiqués sont le plus exact possible et que ces dépenses ont été engagées pour effectuer les travaux d'évaluation sur les terrains indiqués dans la formule de rapport de travail ci-joint.

Et qu'à titre de \_\_\_\_\_ je suis autorisé  
(titulaire enregistré, représentant, poste occupé dans la compagnie)

à faire cette attestation.

Signature C. Bradley Date mar 30/92

Re: Work Report W9270.00016 - Apr 2/92 - page 1  
physical work (report 'c') \$ 31,910. J. BRADY

CONTRACTOR - Hercules Stone Ltd.

EXCAVATING/TRENCHING - Hercules Stone Ltd.

Boom Truck: Aug 30/92 - 10 hrs

Aug 31/92 - 10 hrs

Sept 1/92 - 6 hrs - Total 26 hrs @ 100.00/hr = 2600.00

Front-end loader: July 9/91 - 4 hrs @ 40.00 = 160.00

Boom Truck : July 9/91 - 12 hrs @ 100.00 = 1200.00

Drill & generator : July 9/91 - 6 hours = 150.00

Materials used: powder & steel chisels

Aug 30/31 & Sept 1/91 800.00

Contract workers fees and operator fees

for above dates - operator H. Tsambis

4425.00

TOTAL

9435.00

GST

660.45

Value paid to H. Tsambis Hercules Stone Ltd.

10,095.00



WR. 9270.00016

J. BRADY - pg 2

Contractor - Tidewater Constn.

Hydraulic Drill

Aug 30/92 - 10 hrs } Total 32 hrs.

Aug 31/92 - 11 hrs } Fixed fee \* 3611.00

Sept 1/92 - 11 hrs } operator Ken Tremblay.

\* includes drill bits & operator.

Rentals: Pionax Gas Drill & WATAX Pump.

MAY 20, 21, 22, 23, 24, 25, 26, 27, 28, 29.

JUNE: 14, 15, 16, 17

JULY 4, 5, 6, 7, 8, 9, 10, 11, 12, 19, 21, 22, 23, 24

Ⓟ Aug 19 - 31 incl.

① GAS Drill - 4 weeks @ 500.00 incl steel 2000.00

② WATAX Fire Pump 3 wks @ 500.00 incl 500' hose 1500.00

Portable Excavator

Sept 1 & 2/92

Total 377.00  
3877.00

0 : 1-9- PROSPECTING - 9 X 150' = 1350.0'

IV. DAILY REPORTS (Summarize work activity in Section I)

Day	Project Area	*WORKER	Date
1	PARKIN TWP - MAP II - B (HARAMA)	JB	APRIL 20/91
2		JB	" 21 "
3		JA	" 26 "
4		JB, HB	" 27 "
5		JB, HB	" 28 "
6		JO, MB	MAY 9/91
7		JB	" 10 "
8		JB, HB	" 11 "
9		JO, MB	" 12 "
10		HB	" 20 "
11		HA	" 21 "
12		HB	" 22 "
13		HA	" 23 "
14		HB	" 24 "
15		HA	" 25 "
16		HB	" 26 "
17		HA	" 27 "
18		HB	" 28 "
19		HB	" 29 "
20		HB	JUNE 14/91
21		HB	" 15 "
22		HB	" 16 "
23		HB	" 17 "
24		HB	" 18 "
25		HB	" 19 "
26		HB	" 20 "
27		JO, MB	JULY 4/91
28		JA, HO	" 5 "
29		JB	" 6 "
30		JA, HB	" 7 "
31		JO, MB	" 8 "
32		HB	" 9 "
33		HA	" 10 "
34		HB	" 11 "
35		HB	" 12 "
36		JB, HO	" 19 "
37		JB	" 20 "
38		JB, MB	" 21 "
39		JB, MB	" 22 "
40		HB	" 23 "
41		JB, MB	" 24 "

Prospecting is  
A MISNOMER  
Actually manual  
I Brady

Work Performed

Prospecting - CLM 865267 <sup>MANUAL - STONE REMOVAL</sup>  
 " - CLM 865266 N.E. PORTION  
 " CLM 865266 - S.E. PORTION  
 " CLM 865266 - CENTRAL PORTION  
 Prospecting - central area of 865266  
 " collected small marble sample  
 " for cutting & evaluation  
 " " "  
 " " "  
 manual stripping, drilling with  
 gas plugger (portable) -  
 closely spaced holes, wedging  
 with steel chisels - small  
 block removal for testing  
 in trenches (location) 3 x 4  
 " " "  
 " " "  
 " " "  
 washing of stripped areas  
 with pump - Stripping TR. 5ARCA  
 " " "  
 " " "  
 Re-cutting of claim boundary  
 " " "  
 Power Stripping, washing,  
 drilling Trench AREAS (2) (3)  
 (4) (9)  
 " " "  
 " " "  
 washing, drilling, block  
 splitting/removal areas  
 (2) (3) (4) (9)  
 " " "  
 " " "  
 " " "  
 " " "  
 " " "  
 " " " + Hercules  
 center

Attach additional sheets as required.  
 \* WORKERS  
 MANUAL/MECHANICAL } JB = J BRADY - 10 days  
 } MB = M. BRADY - 8 days  
 } HB = H. BRADY - 27 days CONTRACT

IV. DAILY REPORTS (Summarize work activity in Section I)

Day	Project Area	*WORKER	Date	Work Performed
1	PARK TWP - MAP II - B (HARRMA)	H.B	JULY 26/91	Manual stripping, drilling (portable)
2		JB, MB	" 27 "	AREAS (1) (10) (11) & washing
3		JB, MB	" 28 "	" " "
4		HB	Aug 6/91	" " "
5		HA	" 7 "	" " "
6		HB	" 8 "	" " "
7		HA	" 9 "	" " "
8		JB, MB	" 19 "	Power stripping, drilling,
9		JB	" 20 "	block REMOVAL AREAS (1) (2) (3)
10		JB, MB	" 21 "	(4) & (9)
11		JB, MB	" 22 "	" "
12		JB	" 23 "	" "
13		JB, MB	" 24 "	" "
14		JB, MB	" 25 "	" "
15		JB, MB	" 26 "	Power stripping (5) (6) (7) (8) (10) (11)
16		JB	" 27 "	" "
17		JB	" 28 "	" "
18		JB, MB	" 29 "	Power stripping, power drilling, block
19		JB	" 30 "	Removal - AREA (3) & (9) & washing.
20		JB	" 31 "	" " "4 Hercules Strip"
21		JB, MB	Sept 1/91	Portable excavator for stripping
22		JB, MB	" 2 "	and block removal for testing
23		JB	" 7 "	TRENCH AREAS (1) (2) & (3)
24		JB	" 8 "	" "
25		JB	" 13 "	" "
26		JB, MB	" 14 "	" "
27		JB, MB	" 15 "	" "
28		JB, MB	" 16 "	" "
29		JB	OCT 9/91	DRILLING / splitting blocks in
30		JB	" 10 "	TR. AREAS (2) & (9)
31		JB, MB	" 11 "	" "
32	JB, MB	" 12 "	" "	
33	JB	" 13 "	" "	
34	JB, MB	" 25 "	ITALIAN delegation & MRK officials - 7 days site	
35	JB, MB	" 26 "	Block removal & manual stripping	
36	JB	" 27 "	" " & washing.	
37	JB	NOV 19/91	CLEAN-UP of sites	
38	JB	" 22 "	" " "	
39	JB	" 23 "	REPORT & MAP Preparation, car & 50 sort	
40	JB	" 29 "	" " " " "	
41	" "	JB	" 30 "	" " " "

Attach additional sheets as required - JB = J. BRADY - 36 days  
 \*WORKERS MB = M. BRADY - 18 days  
 HB = H. BARRY - 5 days - CONTRACT

J. BRADY  
1227 Holland Rd.  
Sudbury, ONT  
P3A 3R1  
MAR 30/92

Mining Recorder  
Sudbury, ONT.

Re Work Report "C" - Physical

I've enclosed location and detail maps  
for prospecting (9 days) and other physical  
work on claims 865266, 865267, PARKIN Twp.  
These include: Equipment Rentals 7488.00  
for trenching, washing & excavating

: Contractors fees for stone  
excavation & removal and mechanical equipment  
operation and manual related work 15,895.00

: My own fees for 1) Prospecting - 1350.  
and 2) mechanical equipment operation and manual  
related work.

This work as shown on enclosed maps involved  
prospecting, stripping, trenching, washing and  
building stone block removal along limestone  
beds on the subject claims.

John Brady

PARKIN TWP G2915  
J. BRADY, 1991

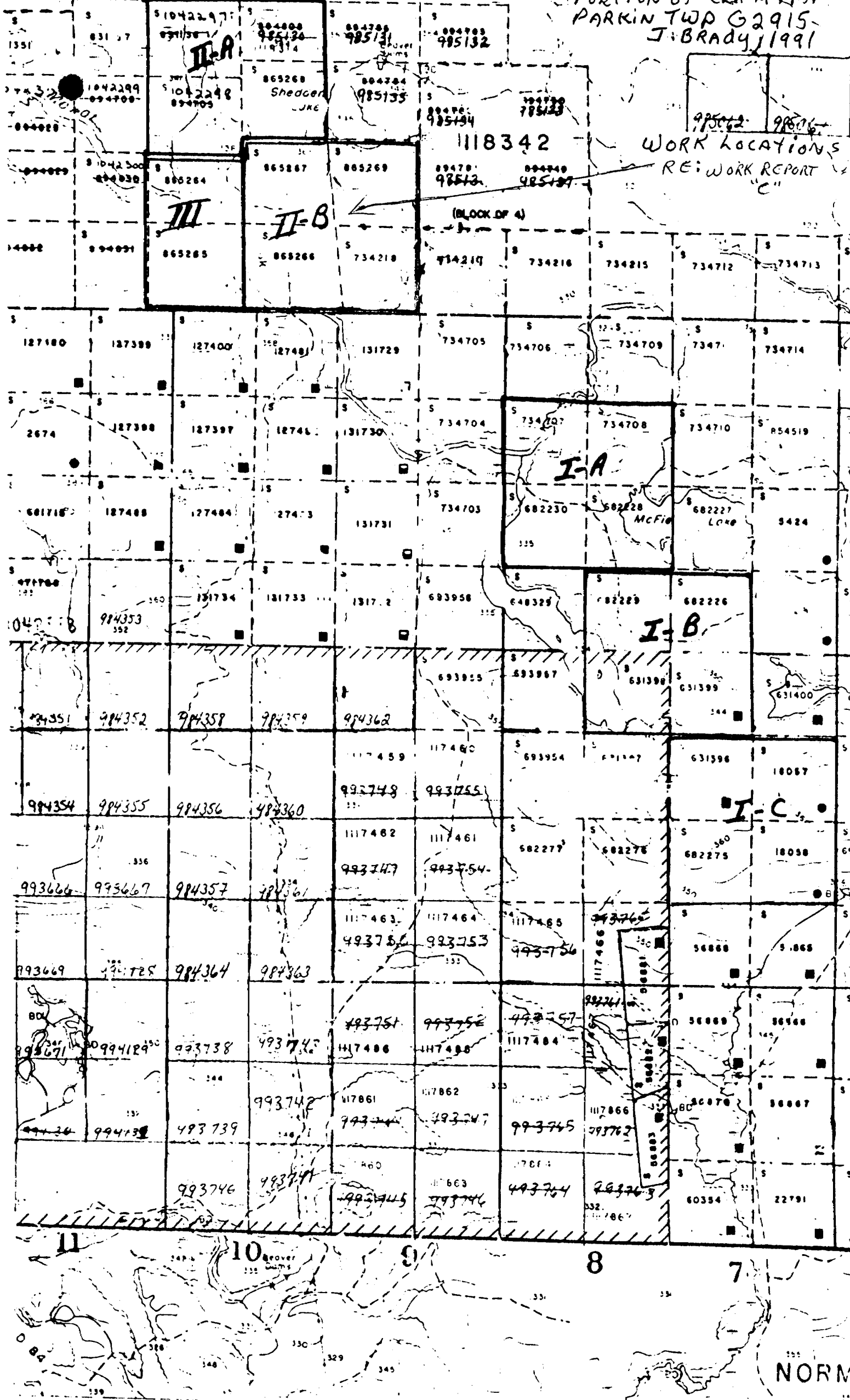

WORK LOCATIONS  
RE: WORK REPORT  
"C"

(BLOCK OF 4)

II-B

I-A

I-B

I-C

NORM