

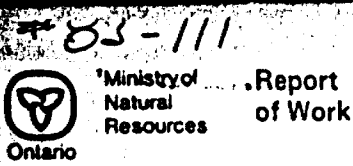

41155W0068 PARKIN35B1 PARKIN

900



85-111
PARKIN TWP.
 (M. 1049)
 The Mining Act

Instructions - Supply required data on a separate form for each type of work to be recorded (see table below).
 - For Geo-technical work use form no. 1362 "Report of Work (Geological, Geophysical, Geochemical and Expenditures)".

File S. 693951

Name and Postal Address of Recorded Holder John Brady	Prospector's Licence No. C32203
1227 Holland Rd. Sudbury, ONT. P3A3R1	

Summary of Work Performance and Distribution of Credits

Total Work Days Cr. claimed 66	Mining Claim			Work Days Cr.	Mining Claim			Work Days Cr.	Mining Claim			Work Days Cr.
	Prefix	Number	Work Days Cr.		Prefix	Number	Work Days Cr.		Prefix	Number	Work Days Cr.	
For Performance of the following work. (Check one only) <input checked="" type="checkbox"/> Manual Work <input type="checkbox"/> Shaft Sinking Drifting or other Lateral Work. <input type="checkbox"/> Compressed Air, other Power driven or mechanical equip. <input type="checkbox"/> Power Stripping <input type="checkbox"/> Diamond or other Core drilling <input type="checkbox"/> Land Survey	S	693951	22									
		693952	22									
		693953	22									

Required Information eg: type of equipment, Names, Addresses, etc. (See Table below)

John Brady
 1227 Holland Rd. Sudbury, ONT. - MAY 7, 8, 14, 15, 16, 21, 22, 23, 24, 28, 29 / 1983 - 12 hrs each day
 11 days x 2 = 22 days MANUAL WORK

Mike Brady
 46 Cabot St. - MAY 7, 8, 14, 15, 16, 21, 22, 23, 24, 28, 29 / 1983 - 12 hours each day
 Sudbury, ONT. 11 days x 2 = 22 days MANUAL WORK

Richard Deschamps - MAY 7, 8, 14, 15, 16, 21, 22, 23, 24, 28, 29 / 1983 - 12 hours each day
 1265 ARSO ST. 11 days x 2 = 22 days MANUAL WORK
 Sudbury, ONT.

- STRIPPING, hand mucking, dewatering pits

Total 66 days

SUDBURY MINING DIV. RECEIVED SEP 26 1983 A.M. 7, 8, 9, 10, 11, 12, 1, 2, 3, 4, 5, 6 P.M.	WORK DESIGN. S. 693959 = 66, BAL. 3934
	Date of Report Sept 23

Certification Verifying Report of Work
 I hereby certify that I have a personal and intimate knowledge of the facts set forth in the Report of Work annexed hereto, having performed the work or witnessed same during and/or after its completion and the annexed report is true.

Name and Postal Address of Person Certifying JOHN BRADY	Date Certified Sept 23	Certified by (Signature) John Brady
1227 Holland Rd. Sudbury, ONT.		

Type of Work	Specific information per type	Other information (Common to 2 or more types)	Attachments
Manual Work	Nil	Names and addresses of men who performed manual work, operated equipment, together with dates and hours of employment.	Work Sketch: these are required to show the location and extent of work in relation to the nearest claim post.
Shaft Sinking, Drifting or other Lateral Work			
Compressed air, other power driven or mechanical equip.	Type of equipment	Names and addresses of owner or operator together with dates when drilling/stripping done.	Work Sketch (as above) in duplicate
Power Stripping	Type of equipment and amount expended. Note: Proof of actual cost must be submitted within 30 days of recording.		
Diamond or other core drilling	Signed core log showing: footage, diameter of core, number and angles of holes.	Nil	Nil
Land Survey	Name and address of Ontario land surveyor.		



41155W0068 PARKIN35B1 PARKIN

010

#83-112

PARKIN TWP.
(M. 1049)
The Mining Act

FILE 5.693951

Ministry of
Natural
ResourcesReport
of WorkInstructions - Supply required data on a separate form for each
type of work to be recorded (see table below).
- For Geo-technical work use form no. 1362 "Report
of Work (Geological, Geophysical, Geochemical and
Expenditures)".

Name and Postal Address of Recorded Holder John Brady 1227 Holland Rd. Sudbury, ONT. P3A3R1	Prospector's Licence No. C 3 2 2 0 3
---	---

Summary of Work Performance and Distribution of Credits

Total Work Days Cr. claimed 104	Mining Claim			Work Days Cr.			Mining Claim			Work Days Cr.		
	Prefix	Number	Work Days Cr.	Prefix	Number	Work Days Cr.	Prefix	Number	Work Days Cr.	Prefix	Number	Work Days Cr.
for Performance of the following work. (Check one only) <input type="checkbox"/> Manual Work <input type="checkbox"/> Shaft Sinking Drifting or other Lateral Work. <input checked="" type="checkbox"/> Compressed Air, other Power driven or mechanical equip. <input type="checkbox"/> Power Stripping <input type="checkbox"/> Diamond or other Core drilling <input type="checkbox"/> Land Survey	S	693951	36									
		693952	34									
		693953	34									

Required information eg: type of equipment, Names, Addresses, etc. (See Table below)

Work done on 5.693958 : 5.693959

HAROLD BARRY
1265 ARNO ST. SUDBURY, ONT.
MAY 10, 11, 12, 13, 17, 18, 19, 20, 25, 26, 27, 30, 31 / 1983
13 days - 12 hours each day x 4 = 52 days plus

MIKE BRADY
46 CABOT ST.
SUDBURY, ONT.
MAY 10, 11, 12, 13, 17, 18, 19, 20, 25, 26, 27, 30, 31 / 1983
13 days - 12 hours each day x 4 = 52 days plus

Total days - 104 days
ATLAS COPCO - BBM 45 - GAS PLUGGER

RECEIVED
SEP 26 1983
A.M. P.M.
8 9 10 11 12 1 2 3 4 5 6

WORK ASSIGN.
S. 693958 = 78, BAL. 3922
S. 693959 = 26, BAL. 3908

Date of Report: Sept 23/83
Recorded Holder or Agent (Signature): John Brady

Certification Verifying Report of Work
I hereby certify that I have a personal and intimate knowledge of the facts set forth in the Report of Work annexed hereto, having performed the work or witnessed same during and/or after its completion and the annexed report is true.

Name and Postal Address of Person Certifying
John Brady
1227 Holland Rd. Sudbury, ONT.

Date Certified: Sept 23/83
Certified by (Signature): John Brady

Type of Work	Specific information per type	Other information (Common to 2 or more types)	Attachments
Manual Work	Nil	Names and addresses of men who performed manual work/operated equipment, together with dates and hours of employment.	Work Sketch: these are required to show the location and extent of work in relation to the nearest claim post.
Shaft Sinking, Drifting or other Lateral Work			
Compressed air, other power driven or mechanical equip.	Type of equipment	Names and addresses of owner or operator together with dates when drilling/stripping done.	Work Sketch (as above) in duplicate
Power Stripping	Type of equipment and amount expended. Note: Proof of actual cost must be submitted within 30 days of recording.		
Diamond or other core drilling	Signed core log showing; footage, diameter of core, number and angles of holes.	Nil	Nil
Land Survey	Name and address of Ontario land surveyor.		

- Pit #1 - 16' wide X 14' long X 7' deep - trenching
- Pit #2 - 12' wide X 6' long X 5' deep - Trenching
- Pit #3 - 5.5' wide X 5' long X 3' deep - Trenching
- Pit #3 - 6' wide X 40' long X 3' deep - stripping

5693951
(J. Brady)

5481 (P)

PORTLAND RD.

BASE LINE 30° N 0° E.

SUBURBY
MINING DIV.
RECEIVED
SEP 26 1983
A.M. P.M.
7 8 9 10 11 12 1 2 3 4 5 6

Cl. 693958

~~Cl. 693958~~ Cl. 693959

~~Cl. 693958~~ Cl. 693960

MALDEN LAKE

Scale: 1" = 200'
J. Brady Sept 24/83

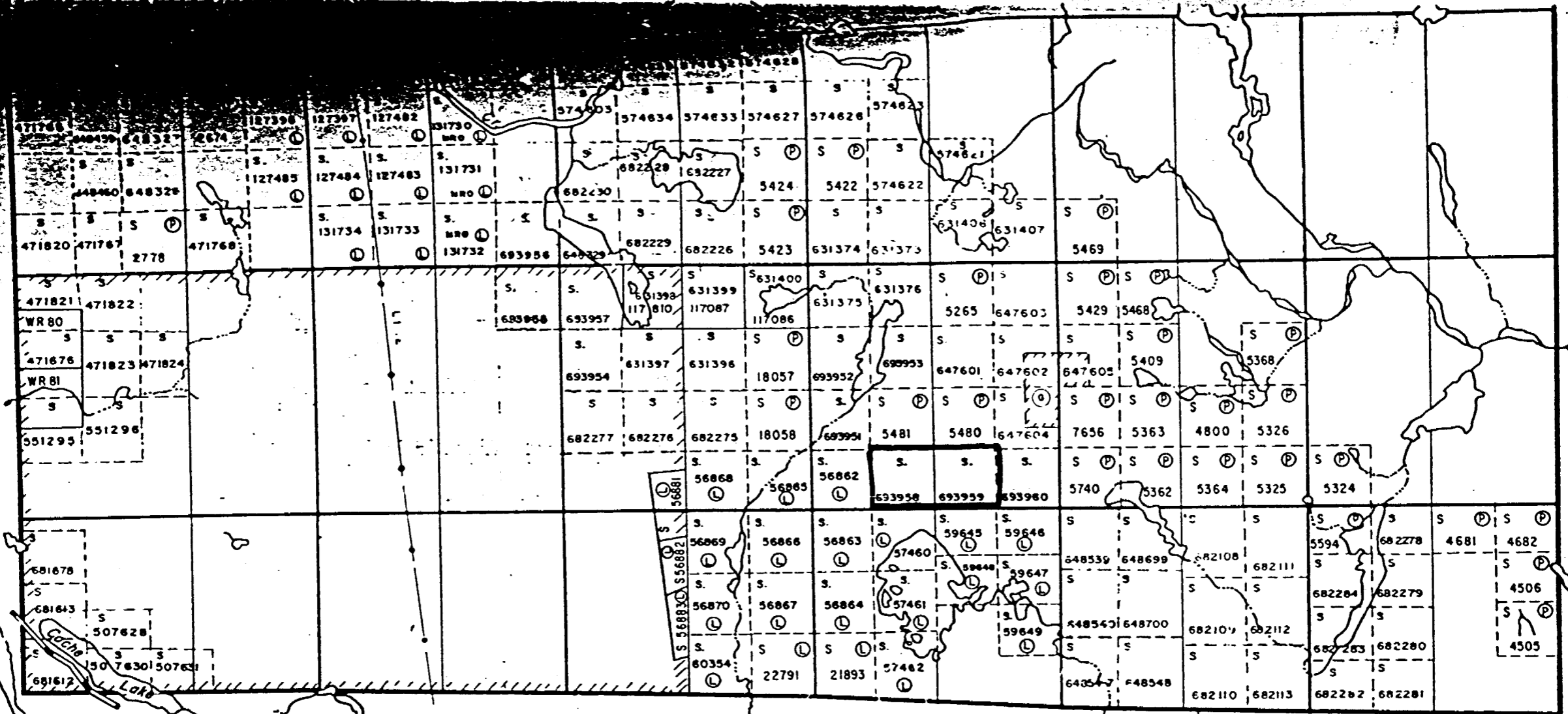

12 11 10 9 8 7 6 5 4 3 2 1
 1" = 40 chains

Norman Twp. M. 1027

PARKIN TWP
 (M. 1049)