



4115SW0081 0018A1 PARKIN

DIAMOND DRILLING

010

TOWNSHIP: PARKIN

REPORT No.: 34

WORK PERFORMED BY: MID-PINES EXPLORATIONS INCORPORATED

<u>CLAIM No.</u>	<u>HOLE No.</u>	<u>FOOTAGE</u>	<u>DATE</u>	<u>NOTE</u>
S 471806	M-1	261.0	Dec/78	(1)
	M-2	462.0	Jan/79	(1)
	M-3	214.0	Feb/79	(1)
	M-4	305.0	Feb/79	(1)
	<u>4 DH</u>	<u>1242. FT</u>		

NOTES: (1) # 5-80

PROPERTY BARRY-BLANCHARD-McVITTIE PROPERTY
MIDPINES EXPLORATIONS INC.

PAGE 1 (OF 1)

LOCATION CLAIM S 471806, PARKIN TWP. ONT. BEARING 180°T HOLE NO. M-1

LOGGED BY ROSS KIDD ELEVATION _____ DIP -50° FINAL DEPTH 261.0 FEET

STARTED DECEMBER 7TH, 1978 TESTS (CORRECTED) _____

FINISHED JANUARY 24TH, 1979

CASING PULLED NONE

CORE SIZE 1 INCH

FROM	TO	DESCRIPTION
0.0	9.0	<u>OVERBURDEN</u>
9.0	10.0	<u>DIABASE BOULDER</u>
10.0	205.0	<u>TUFF</u> FINE-GRAINED. DENSE. BLUEISH-GREY. BECOMING COARSER IN TEXTURE AS HOLE DEEPENS. QUITE SOFT. VAGUE BANDING @ 35° TO CORE. VERY MINOR PYRITE IN 1/16 INCH SEAMS ALONG THE OCCASIONAL BEDDING PLANE. MINOR PYRITE IN QUARTZ-CARBONATE BLEBS FROM 129'-134'. ROCK HARDENS IN LAST 20 FEET.
205.0	249.0	<u>RHYOLITE</u> HARD. GREY. VERY FINE-GRAINED. OCCASIONAL OCCURRENCE OF FINE CUBIC PYRITE ON FRACTURE PLANES. LOWER CONTACT @ 40° TO CORE, AND A FEW BLEBS PYRRHOTITE NEAR CONTACTS.
249.0	261.0	<u>ANDESITE</u> GREY. MEDIUM-GRAINED. DENSE.
	261.0	<u>END OF HOLE</u>

SAMPLE LIST

<u>NUMBER OF SAMPLE</u>	<u>FROM</u>	<u>TO</u>	<u>CORE LENGTH</u>	<u>GOLD OZS/TON</u>
2500	235.0	240.0	5.0 FT.	TRACE

Ross Kidd

HOLE NO. M-1

PROPERTY BARRY-BLANCHARD-McVITTIE PROPERTY
MIDPINES EXPLORATIONS INC.

PAGE 1 (OF 1)

LOCATION CLAIM S.471806, PARKIN TWP, ONT. BEARING _____ HOLE NO. M-2
 LOGGED BY ROSS KIDD ELEVATION _____ DIP -50° FINAL DEPTH 462.0 FEET
 STARTED JANUARY 26TH, 1979 TESTS (CORRECTED) _____
 FINISHED FEBRUARY 10TH, 1979
 CASING PULLED NONE
 CORE SIZE 1 INCH

FROM	TO	DESCRIPTION
0.0	10.0	<u>CASING</u>
10.0	58.0	<u>ANDESITE</u> LIGHT GREY. MEDIUM-GRAINED. DENSE. MILDLY FRACTURED @ 80° TO CORE.
58.0	72.0	<u>GABBRO</u> COARSE-GRAINED. DENSE. BOTH CONTACTS BRECCIATED.
72.0	122.6	<u>ANDESITE</u> MEDIUM-GRAINED. GREY. A FEW QUARTZ-CARBONATE VEINLETS @ 70° TO CORE.
122.6	130.0	<u>TUFF</u> DARK GREY. FINE-GRAINED. BOTH CONTACTS ARE GRADATIONAL.
130.0	147.0	<u>RHYOLITE</u> LIGHT GREY. HARD. FINE-GRAINED.
147.0	178.7	<u>ANDESITE</u> LIGHT GREY. MEDIUM-GRAINED. FLOW LINES @ 50° TO CORE.
178.7	190.0	<u>RHYOLITE</u> UPPER CONTACT @ 30° TO CORE. HARD. MEDIUM-GRAINED. LIGHT GREY.
190.0	462.0	<u>ANDESITE</u> GREY. MEDIUM-GRAINED. OCCASIONAL TUFF BED. VUGGY PINK QUARTZ VEINLETS @ 197.5, 198.2, 198.3, 199.4, 201.3, 344, ALL AT 30° TO CORE. OCCASIONAL FLOW LINE @ 30° TO CORE. OCCASIONAL SPLASH OF PYRITE ON FLOW PLANES. ROCK TEXTURE COARSENING AS HOLE DEEPENS.
	462.0	<u>END OF HOLE</u>

LOST CORE: 199.6 - 201.0 202.0 - 202.5
 203.0 - 204.0 204.3 - 205.7

Ross Kidd

HOLE NO. M-2

PROPERTY

BARRY-BLANCHARD-McVITTIE PROPERTY
MIDPINES EXPLORATIONS INC.

LOCATION CLAIM S.471806, PARKIN TWP. ONT. BEARING _____ HOLE NO. M-3
 LOGGED BY ROSS KIDD ELEVATION _____ DIP -50° FINAL DEPTH 214.0 FEET
 STARTED FEBRUARY 11TH, 1979 TESTS (CORRECTED) _____
 FINISHED FEBRUARY 20TH, 1979 _____
 CASING PULLED NONE
 CORE SIZE AQ (ONE INCH DIAMETER)

FROM	TO	DESCRIPTION
0.0	22.0	<u>CASING</u>
22.0	144.0	<u>RHYOLITE</u> HARD. MEDIUM-GRAINED. FLOW LINES @ 30°-40° TO CORE. HEMATITE STAIN ON SOME FRACTURE PLANES. FRACTURING ALSO MAINLY @ 30° TO CORE.
144.0	158.0	<u>ANDESITE</u> LIGHT GREY. MEDIUM-GRAINED. DENSE.
158.0	166.0	<u>TUFF</u> FINE-GRAINED. DARK GREY. CONSIDERABLE HEMATITE STAINING. BANDING @ 80° TO CORE.
166.0	214.0	<u>ANDESITE</u> LIGHT GREY. DENSE. MEDIUM TO FINE-GRAINED.
	214.0	<u>END OF HOLE</u> <u>NO SAMPLES TAKEN.</u>

Ross Kidd

HOLE NO. M-3

PROPERTY BARRY-BLANCHARD-McVITTIE PROPERTY
MIDPINES EXPLORATIONS INC.

LOCATION CLAIM S, 471806, PARKIN TWP., ONT. BEARING 180° T HOLE NO. M-4
 LOGGED BY ROSS KIDD ELEVATION _____ DIP -50° FINAL DEPTH 305.0 FEET
 STARTED FEBRUARY 22ND, 1979 TESTS (CORRECTED) _____
 FINISHED MARCH 1ST, 1979
 CASING PULLED NONE
 CORE SIZE A₄ (ONE INCH)

FROM	TO	DESCRIPTION
0.0	12.0	<u>CASING</u>
12.0	56.0	<u>ANDESITE</u> LIGHT GREY. DENSE. MEDIUM-GRAINED.
56.0	62.0	<u>BRECCIA ZONE</u> WEAKLY BRECCIATED. SOME QUARTZ IN VEINLETS.
62.0	200.0	<u>ANDESITE</u> GREY. MEDIUM-GRAINED. WHERE FLOW LINES ARE EVIDENT, THEY LIE AT 30°-40° TO CORE. OCCASIONAL 1/16 INCH SEAMLET PYRITE.
200.0	210.0	<u>RHYOLITE</u> HARD. DENSE. LIGHT GREY. ALMOST NO SULFIDES.
210.0	240.0	<u>ANDESITE</u> SOME INCLUDED NARROW TUFFACEOUS BANDS.
240.0	269.0	<u>RHYOLITE</u> HARD. DENSE. LIGHT GREY. ALMOST NO SULFIDES.
269.0	305.0	<u>ANDESITE</u> LIGHT GREY, MEDIUM-GRAINED. FLOW LINES @ 40° TO CORE.
	305.0	<u>END OF HOLE</u>

NO SAMPLES TAKEN.

Ross Kidd

HOLE NO. **M-4**

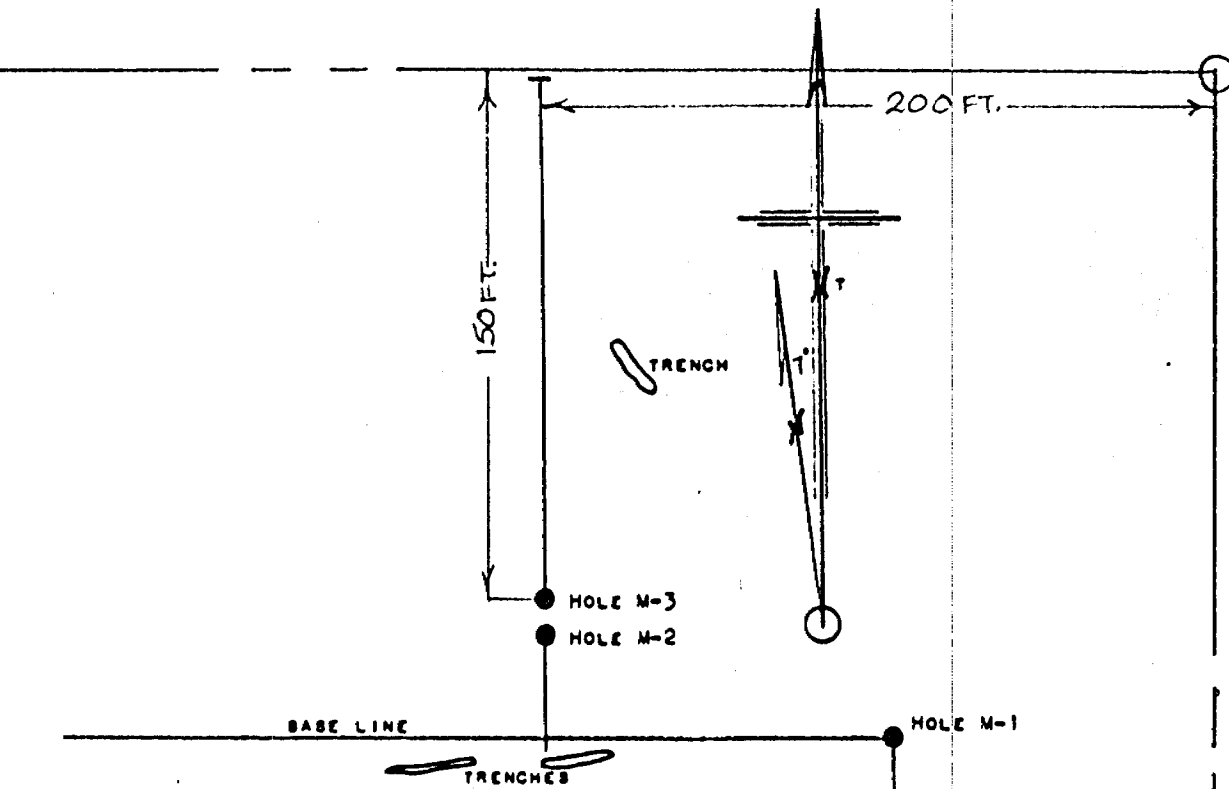

CLAIM NO. S. 471806

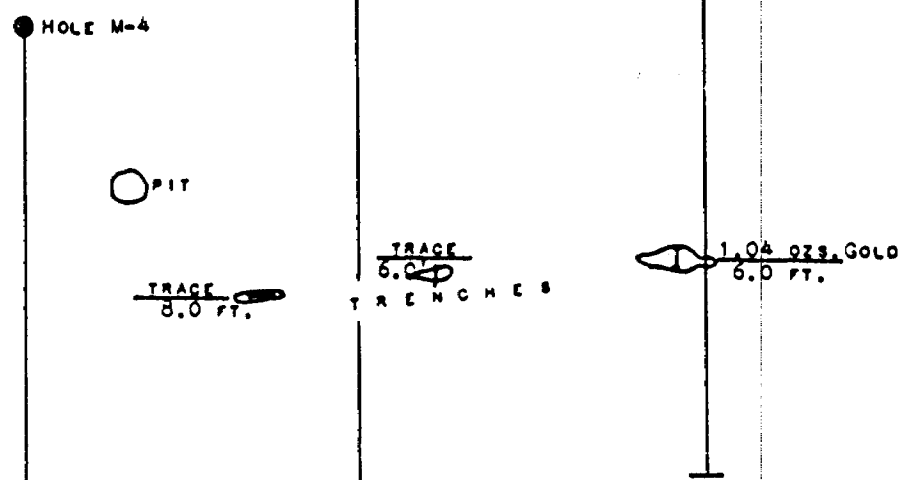

DRILL PLAN

MIDPINES EXPLORATIONS INC.

PARKIN TOWNSHIP SUDBURY AREA ONTARIO

SCALE: 1 INCH = 55 FEET

	= TRENCH
	= DRILL HOLE COLLAR

MARCH, 1979

Ross Kidd

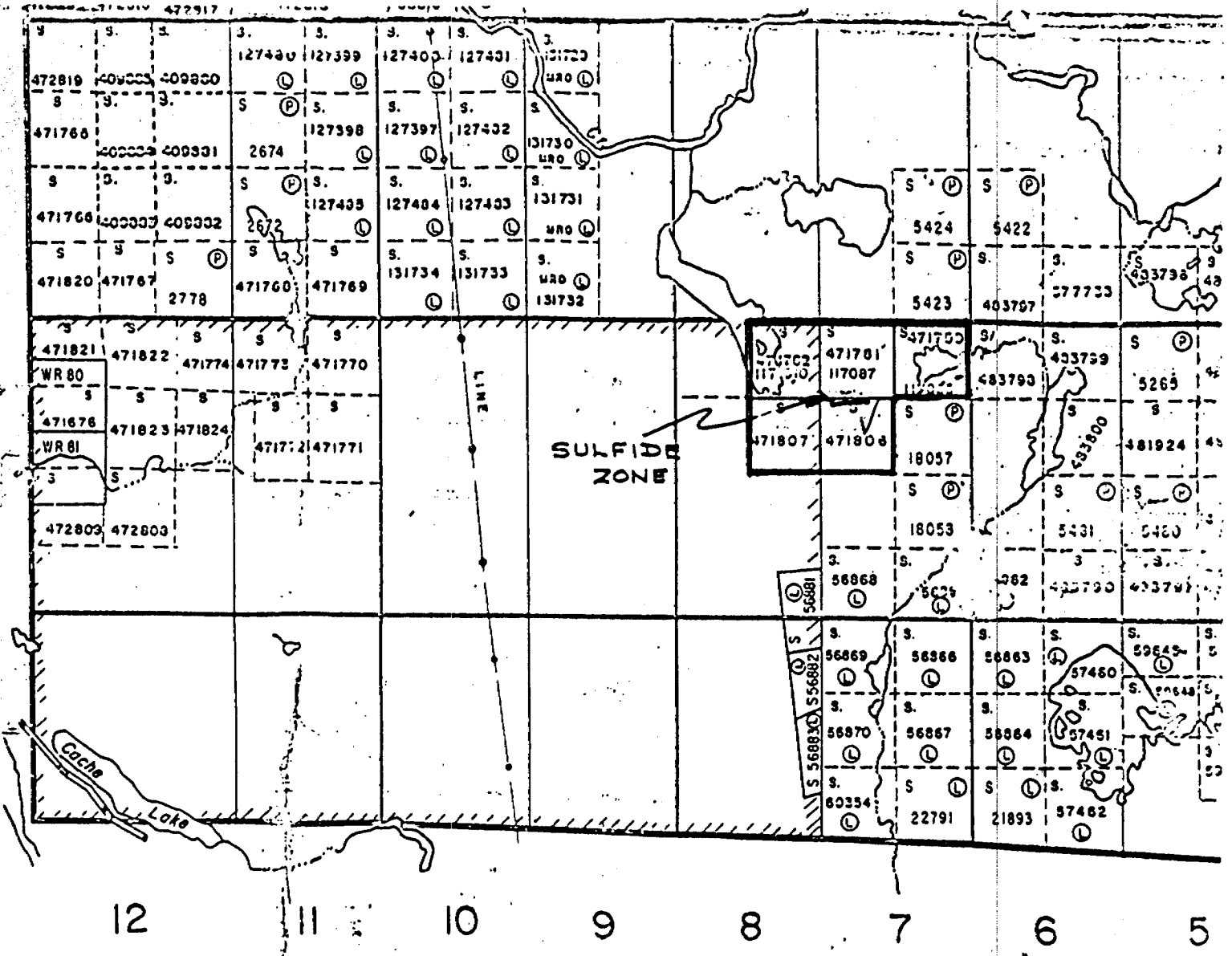

REPRODUCTION OF PARKIN TOWNSHIP CLAIM MAP

(SOUTHWEST SECTION)

SCALE: 1 INCH = 1/2 MILE

Norman Twp. M. 11

SUDBURY
MINING DIV.
RECEIVED
JAN - 8 1930
A.M. 7/8/9/10/11/12/13/14/15/16 P.M.

Hutton Twp.

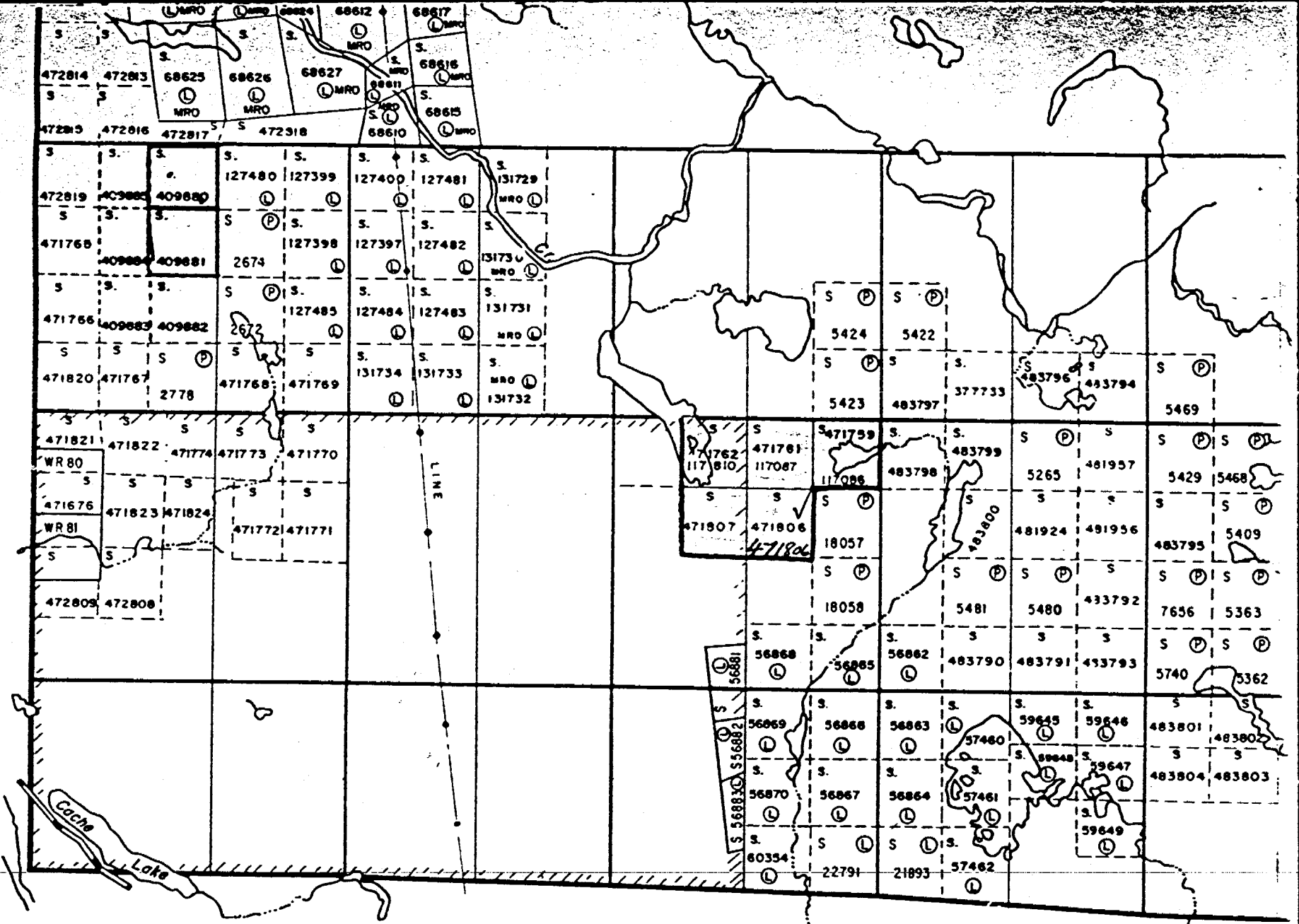

12 11 10 9 8 7 6 5 4

Midpines Exploration Inc.
Jan. 24/79 - HDDH (1242')

Parker TP.
Norman Twp. M. 1027