



4115SW0087 OF91-070 PARKIN

010

January 15, 1992

To O.P.A.P. Administrator

The main objective of our original proposal was to prospect along the main NW-SE trending volcanic sedimentary contact in the search for base and precious metals. Our project achieved this objective with very encouraging results.

In addition, we modified our project to capitalize on heightened interest in building stone (especially marble) that occurred in the Sudbury area early in the field season. Again, the results were very positive.

As can be seen on the enclosed claim map (Base Map) of Parkin Twp., project areas I-A, I-B, I-C and II-A are staggered NW-SE to follow the aforementioned volcanic sedimentary contact. Following, is a description of: 1) the base and precious metals focus; 2) the building stone focus.

1) Base & Precious Metals Focus

Project Area I-C

The objective at this location was to determine if a gold occurrence, discovered during the 1990 field season (OPAP -4' of 1.19 oz AU), followed the NW-SE contact. While the values encountered (.059 and .083 oz AU) were moderate, the significant factor was that

- a) the new occurrence was "on strike" 800' to the N.W. of the previous discovery (see location map I-C - claim 631396)
- b) the occurrence was at or near the same contact zone
- c) the alteration pattern is the same, ie. the mafic volcanic rock is chloritized and silicified

Negotiations with Teck Corp are currently taking place.

Project Area I-B

While significant gold values were not encountered here, the work was encouraging due to the discovery that the "contact" zone described above continued through this area and some evidence of chloritization occurs.

Project Area I-A

The surprise at this location was the discovery of Mafic volcanics within the sedimentary horizon. Some surface material was encouraging in ZN and CU values (CU 1869 PPMS - ZN 3650 PPMS), however, no continuity was established.

2) **Building Stone Focus**

Project Area I-A

Prospecting has established the potential of this area for potential MARBLE deposits. Both the breccia marble (location Map I-A - S.E. portion of claim 734708) and the wavy marble (N.W. portion claim 734707) are similar in characteristics to a significant marble discovery .75 km to the N.W. (Harama deposit OMIP 1991 - J. Brady) the Jarvis Resources deposit is 400 - 500 metres to the East of this new discovery.

Project Area II-A

On the Northern part of claims 865268 and 1042298, a significant marble deposit (35 m wide x 175 m long) was outlined. The distinct white to buff marble with brown to black banding was received positively at the Verona Marble Show in Italy in September '91 as well as by local manufacturers Khouri & Ellero. Discussions are currently taking place with 2 parties on this discovery.

This dual O.P.A.P. venture has been very successful both from the precious metals (Au) and building stone perspective. I expect to be reporting an option agreement on the former in the near future. The latter commodity's development is more tenuous with respect to the lack of industrial infrastructure to support production and marketing. However, serious discussions with 2 different parties are on-going and many other expressions of interest are taking place.

Thank you for your support in this endeavour which would not have been possible without O.P.A.P. assistance.

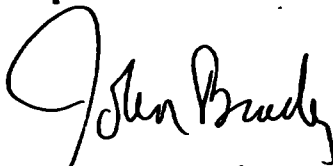

Marie Brady/John Brady
1227 Holland Rd.
Sudbury, Ontario
P3A 3R1



Laboratory Report

Date Sept. 11, 1991

Issued To: John Brady, 1227 Holland Dr., Sudbury, Ont. P3A 3R1

Type of Sample	Sample Number	Gold Oz. Per Ton	MAP Reference	Cu Ppm	Zn Ppm	Rock Type	Mineralization
GRAB	#1 Pink Rock	0.011	LOCATION MAP I-A			Altered, Breccia Limestone	MINOR Sulphides
GRAB	#2 Green Grey Rock	0.007	LOCATION MAP I-A			ALTERED BRECCIA Limestones	MINOR Sulphides
chip .8M	#182133	0.006	DETAIL MAP I-A	422	105	Fractured Mafic Volcanic	MINOR Sulfides
GRAB	182133 SEP.	0.002	DETAIL MAP I-A	454	93	ALTERED MAFIC Volcanics	MINOR Sulfides
chip 1M	182137	0.007	DETAIL MAP I-A			CARBONATED Diabase	MINOR Sulfides
GRAB	182138	0.003	DETAIL MAP I-A	1869	3650	ALTERED MAFIC Volcanics	MAJOR Sulfides
chip .6M	182139	N11	DETAIL MAP I-B			ALTERED QUARTZITE	290 Sulfides
	182140	Trace	N/A				
	182141	Trace					
	182142	N11					
	182143	0.009					
	182144	Trace					
	182145	0.049					
	182146	0.002					
	182147	0.002					
	182148	Trace					
	182149	N11					

DAVIS TWP

Fees Received Paid Receipt #A2550
Invoice #003620 (Also used 2 coupons card #1100)

L. McNaught for J. Ireland
AI Manager

Except by special permission, reproduction of these results must include any qualifying remarks made by this ministry with reference to any sample.



Laboratory Report

Date Oct. 28, 1991

Issued To: Mr. John Brady, 1227 Holland Rd., Sudbury, Ont. P3A 3R1

Type of Sample	Sample Number	Gold Oz. Per Ton	MAP REFERENCE	Rock Type	Mineralization	
GRAB	182150A	0.003	LOCATION MAP I B	BRECCIATED Volcanic-sedimentary CONTACT	MINOR sulfides	chloritic
GRAB	182151A	0.002	"	FRACTURED MAFIC VOLCANICS	MINOR PYRITE	
GRAB	182152A	Trace	LOCATION MAP I C	FRACTURED FELSIC VOLCANICS	44% PYRITE	
GRAB	182153A	Trace	"	ALTERED MAFIC VOLCANICS	MINOR sulfides	
GRAB	182154A	0.005	"	ALTERED FELSIC VOLCANICS	34% PYRITE	
Chip 1M	182155A	0.006	DETAIL MAP I-B	FRACTURED MAFIC VOLCANIC	MINOR sulfides	
Chip .5M	182156A	0.003	DETAIL MAP I-C	FELSIC VOLCANIC + CARBONATE	24% PYRITE	
Chip .7M	182157A	N11	DETAIL MAP I-C	MAFIC VOLCANICS	MINOR PYRITE	
GRAB	182158A	Trace	DETAIL MAP I-B	ALTERED Volcanic-sedimentary CONTACT	MINOR sulfides	
Chip .8M	182159A	0.059	DETAIL MAP I-C	ALTERED MAFIC VOLCANICS-CHLORITIC	MINOR PYRITE SILICIFIED	* see note
Chip .6M	182160A	Trace	DETAIL MAP I-C	FRACTURED FELSIC VOLCANICS	34% PYRITE	
Chip .5M	182161A	N11	DETAIL MAP I-C	ALTERED FELSIC VOLCANICS	54% PYRITE	
Chip .6M	182162A	0.003	DETAIL MAP I-C	FRACTURED FELSIC VOLCANIC	44% PYRITE	
Chip .6M	182163A	N11	DETAIL MAP I-C	" "	35% PYRITE	
GRAB	182164A	0.002	DETAIL MAP I-C	" "	MINOR PYRITE	
GRAB	182165A	0.011	DETAIL MAP I-C	" "	MINOR PYRITE	
GRAB	182166A	Trace	DETAIL MAP I-C	ALTERED-CARBONATED FELSIC VOLCANICS	64% PYRITE	
Chip 1M	182167A	0.083	DETAIL MAP I-C	ALTERED-CHLORITIC MAFIC VOLCANICS	MINOR PYRITE SILICIFIED	* see note
GRAB	182168A	0.002	DETAIL MAP I-C	SHEARED MAFIC VOLCANICS	14% PYRITE	
Total 193 samples						
* #s 182159 & 182167 ARE SIGNIFICANT AS THEY REPRESENT A "NEW" ZONE OF GOLD MINERALIZATION WHERE ALTERATION (CHLORITIZED) AND ROCK TYPE (ALTERED MAFICS) ARE SIMILAR AND ON STRIKE TO A SIGNIFICANT GOLD DISCOVERY ABOUT 800' ESE (OPAP-1990)						

Fees Received Charged Invoice #003625

L. McNaught for J. Ireland
AI Manager

Except by special permission, reproduction of these results must include any qualifying remarks made by this ministry with reference to any sample.

North

SKETCH of Stripping, Trenching & Sampling

DETAIL MAP No. IIA

Refer to Location Map No. IIA

PROJECT AREA IIA

--- Stripping - Average depth 1.8M

▭ Trenching - Average depth 1.6M

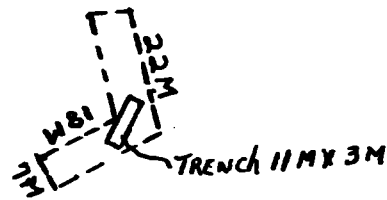
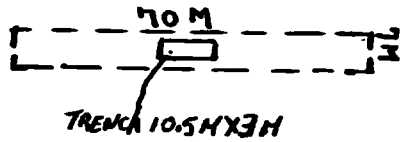
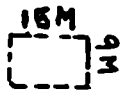

scale 1:1500 1CM = 15M

J. BRADY 1991

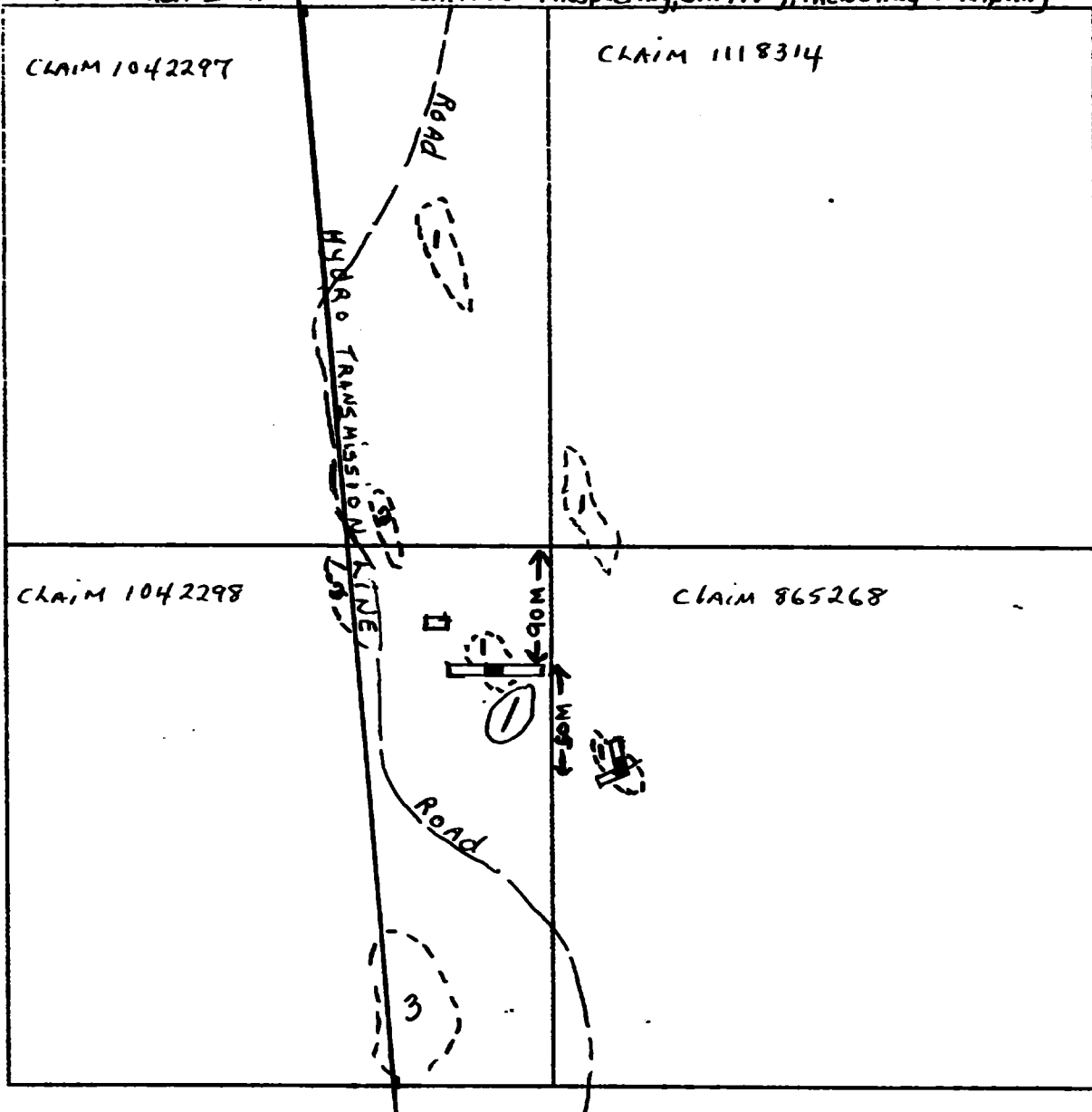

PROJECT AREA II A

LOCATION OF PROSPECTING, STRIPPING, TRENCHING & SAMPLING

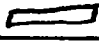

Scale - 1:5000 1cm = 50m

① Base Map Reference G2915 ② Refer to Detail Map No. II A

③ Legends: STRIPPING  TRENCHING  WORK/TRENCH LOCATION ①
OUTCROP 

Work Location	Type of Work	Dimensions	Assays & Ref. No's	Other
① MAP AREA	STRIPPING, TRENCHING & SAMPLING Prospecting	see DETAIL MAP II A	Block Removal for Testing -	discovery of marble beds as shown (1, 2, 3)

NOTES: OUTCROP INVESTIGATED (1) lined MARBLE white, grey, brown, buff
 (2) limestone/marble, grey, white
 (3) DIABASE

J BRADY OPAP/91

NORTH

SKETCH of Stripping, Trenching & Sampling

--- STRIPPING - Average depth 1.8M
— TRENCHING - average depth 1.5M

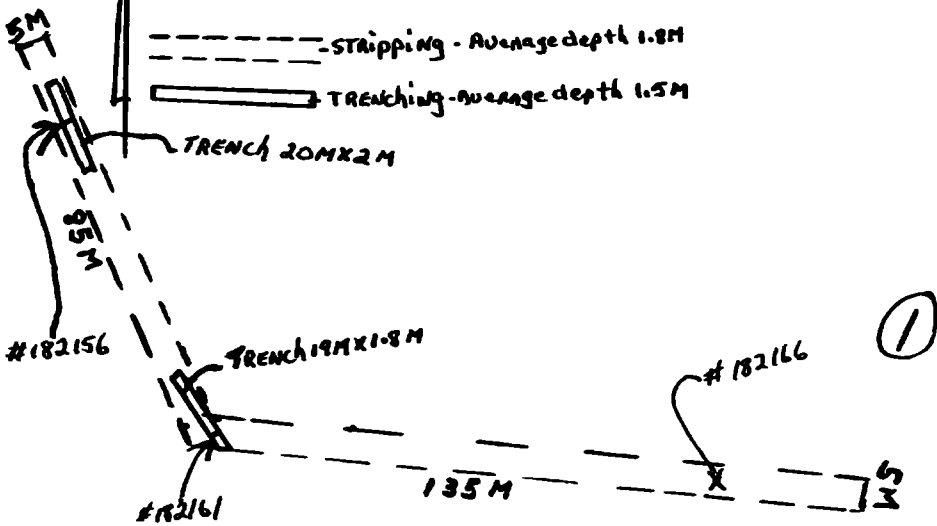

DETAIL MAP No I C
REFER TO LOCATION MAP No. I C
PROJECT AREA I C

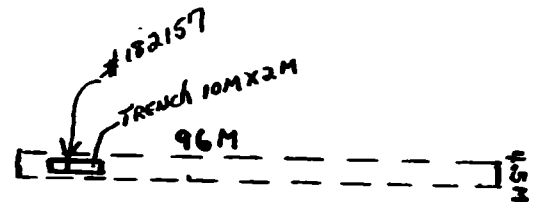

WORK AREA ① ↑
WORK AREA ② ↓

②

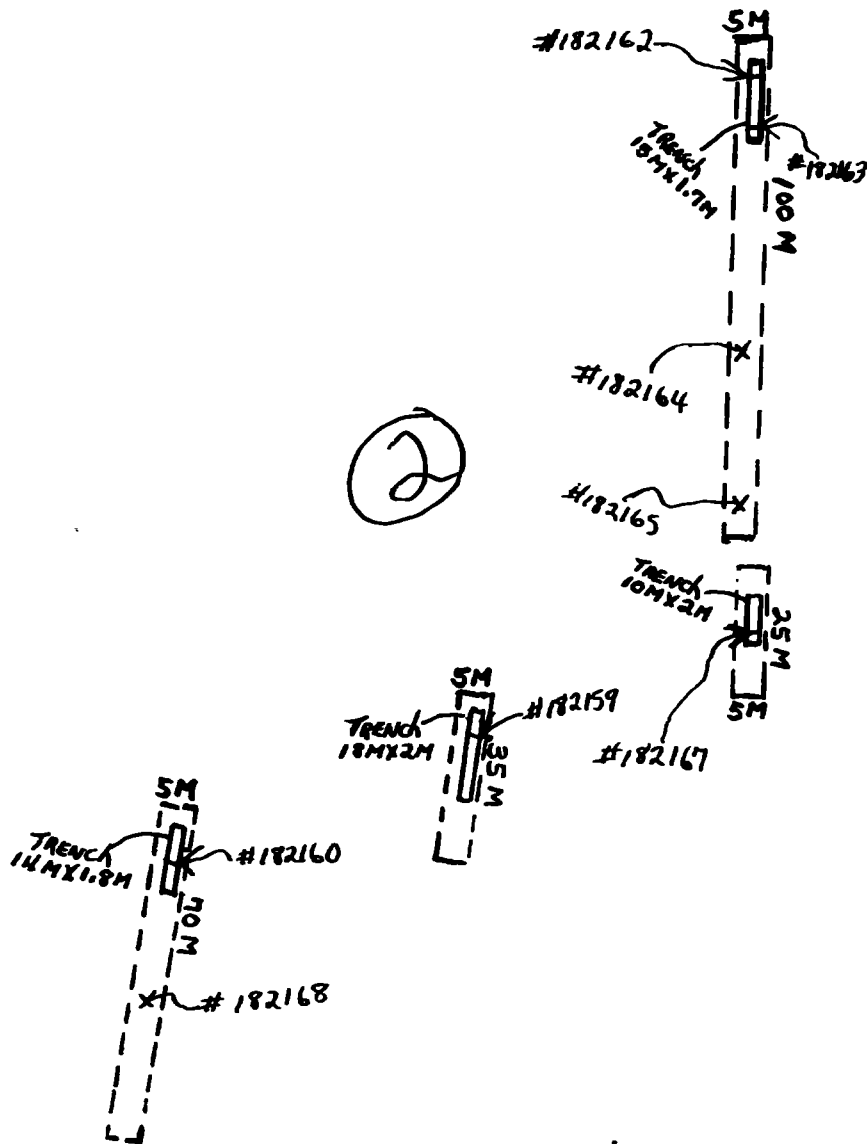

Scale 1:1500 1CM = 15M

Jorady 1991

PROJECT AREA I-C

LOCATION OF PROSPECTING, STRIPPING, TRENCHING, & SAMPLING

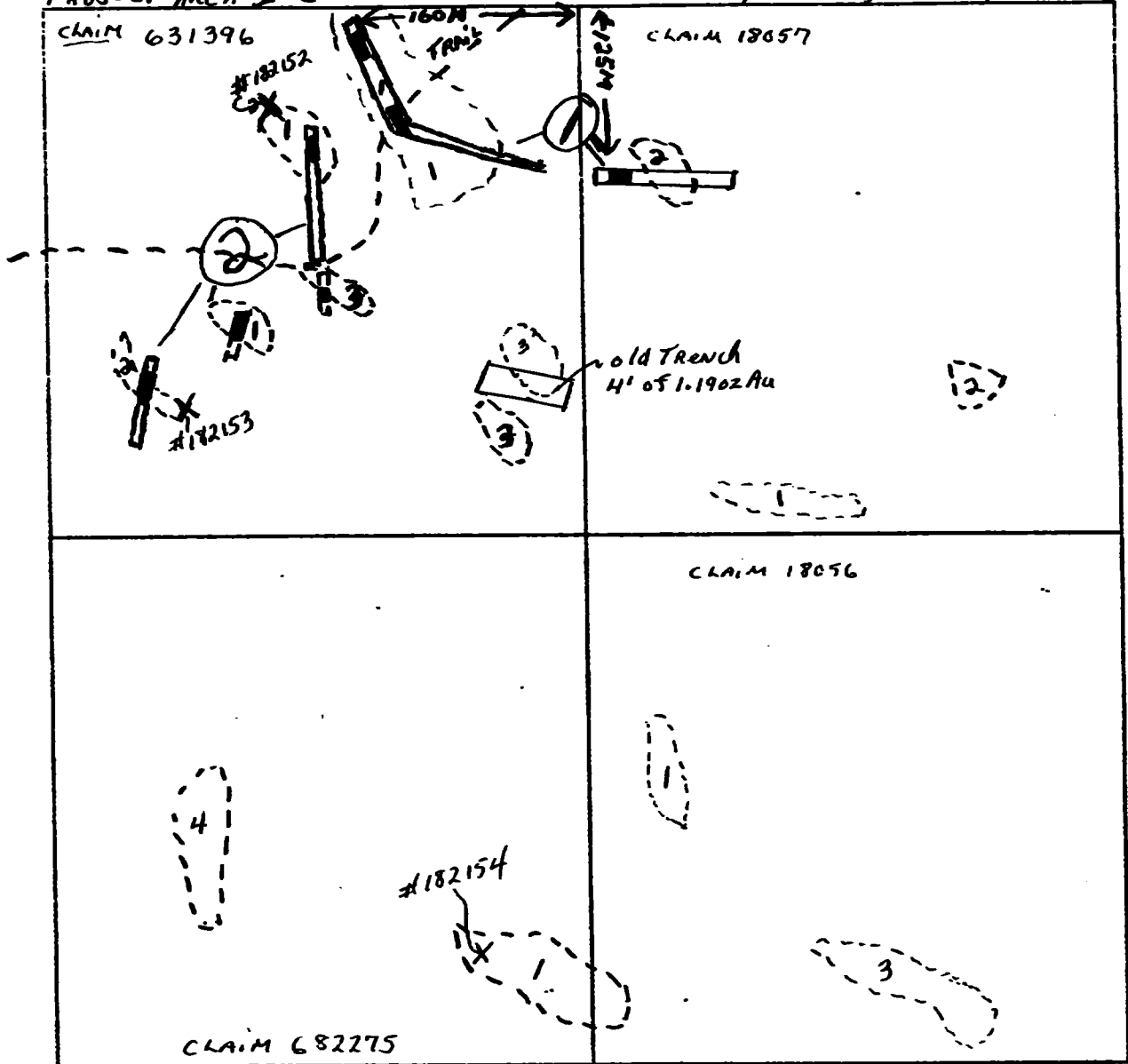

Scale - 1:5000 1cm = 50m

① Base Map Reference Q2915 ② Refer to Detail Map No. I-C

③ Legends: STRIPPING TRENCHING WORK/TRENCH LOCATION ①

Work Location	Type of Work	Dimensions	Assays & Ref. No's	Other
①	STRIPPING, TRENCHING	see detail MAP I-C	ASSAY sheet CB 11925	
②	STRIPPING/TRENCHING	see detail MAP I-C	" " "	
X #182152	SAMPLE	GRAB	ASSAY sheet CB 11925	Au-TRACE
X #182153	SAMPLE	GRAB	" " "	Au-TRACE
X #182154	SAMPLE	GRAB	" " "	Au .00502

NOTES: OUTCROP INVESTIGATED (1) FELSIC VOLCANICS (2) MAFIC VOLCANICS (3) ALTERED MAFIC VOLCANICS (4) GREY GRANITE

NORTH

SKETCH of STRIPPING, TRENCHING & SAMPLING

DETAIL MAP No. I B

REFER to LOCATION Map No. I B

PROJECT AREA I B

- STRIPPING - Average depth 1.7M
- TRENCHING - Average depth 1.5M

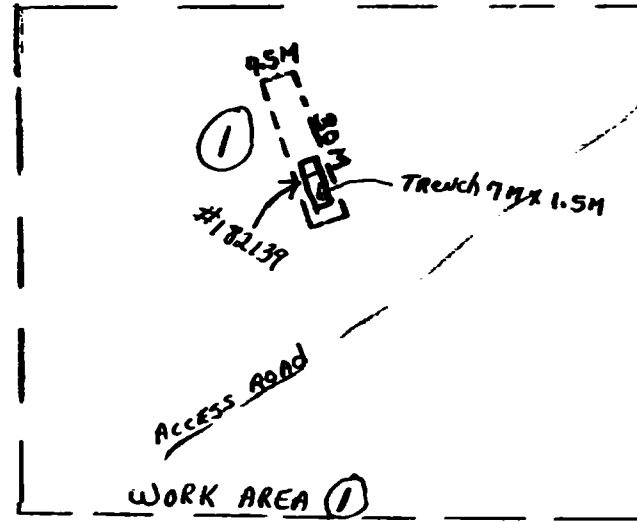

WORK AREA 2

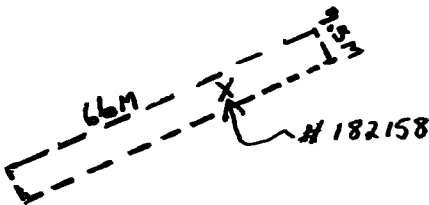
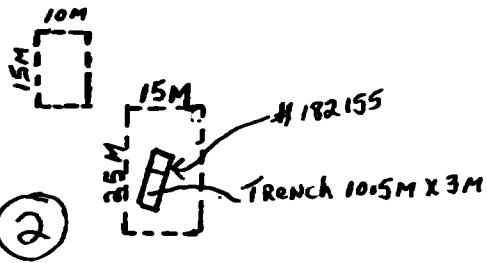

scale 1:1500 1CM=15M

J. BRADY 1991

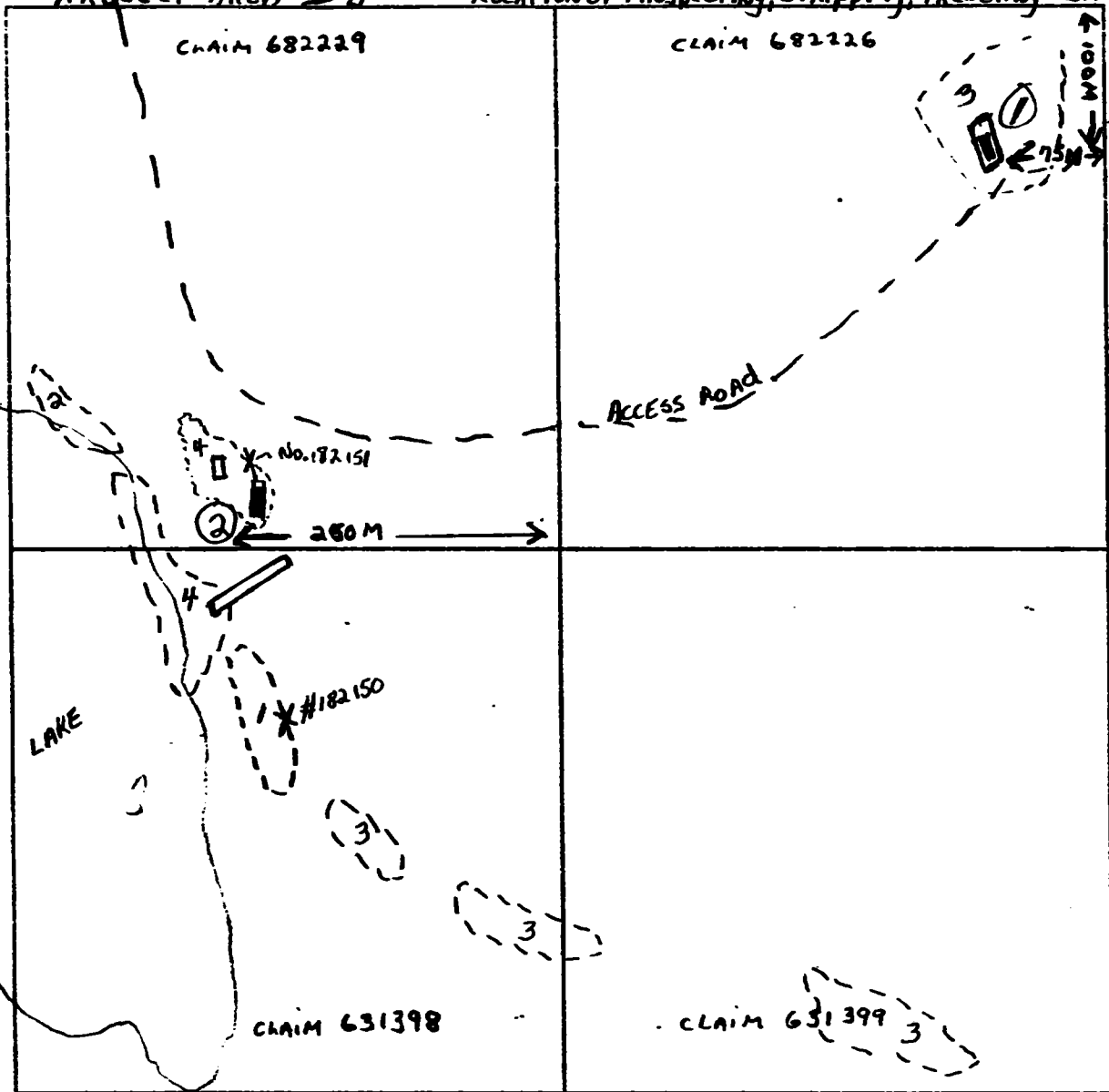

Scale - 1:5000 1cm = 50m

① Base Map Reference G 2915 ② Refer to Detail Map No. I B

③ Legend: STRIPPING TRENCHING WORK/TRENCH LOCATION ①
 OUTCROP

Work Location	Type of Work	Dimensions	Assays & Ref. No's	Other
①	STRIPPING/TRENCHING	DETAIL MAP I B	Assay sheet CB 11859	
②	STRIPPING/TRENCHING	DETAIL MAP I B	Assay sheet CB 11925	
X #182150	SAMPLE	GRAB	ASSAY sheet CB 11925 - Au .0030z.	
X #182151	SAMPLE	GRAB	" " CB 11925 - Au .0020z.	

NOTES: OUTCROP INVESTIGATED (1) Brecciated Volcanic (MAFIC) - sedimentary contact
 (2) MAFIC Volcanics (2) soft sediment breccia
 (3) grey quartzite J BRADY OPAP/91

NORTH

SKETCH of STRIPPING, TRENCHING & SAMPLING

DETAIL MAP NO. I A

LOCATION MAP NO. I A

PROJECT AREA I A

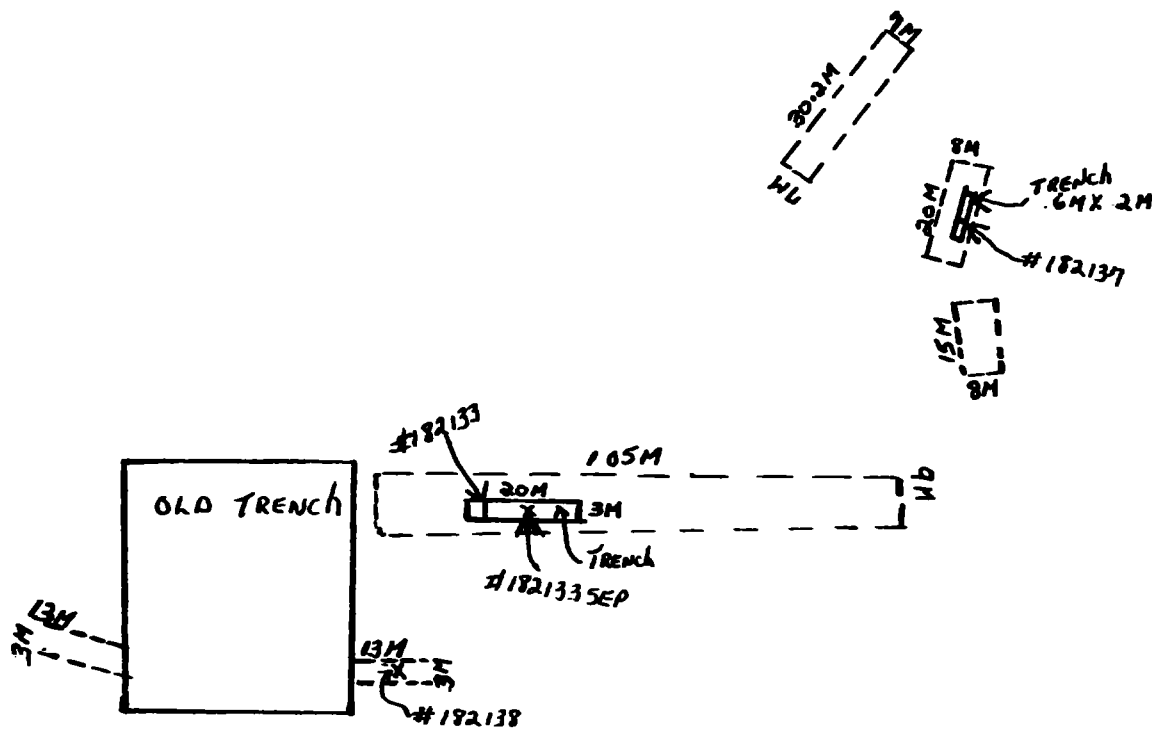
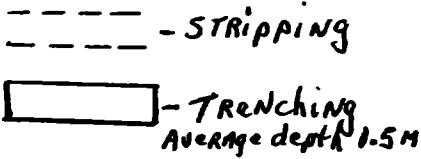

scale: 1:1500 1CM = 15M

J. BRADY 1991

LOCATION MAP I A
PROJECT AREA I A

PARKIN TWP

LOCATION OF PROSPECTING, STRIPPING, TRENCHING & SAMPLING

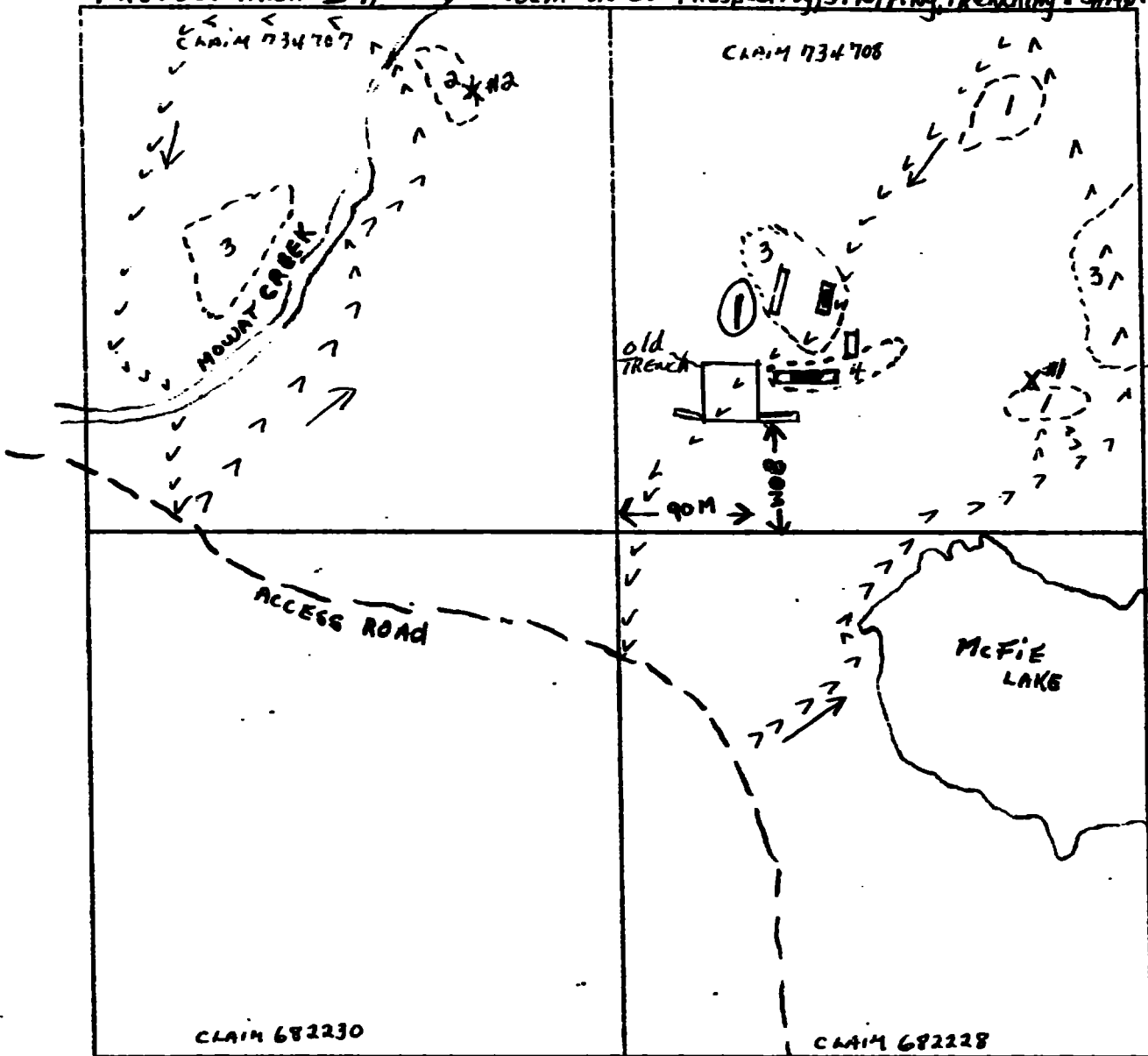

Scale - 1:5000 1cm = 50m

① Base Map Reference G 2915 ② Refer to Detail Map No. I A

③ Legends: STRIPPING TRENCHING PROSPECTING TRAVERSES OUTCROP X-SAMPLE LOCATION

Work Location	Type of Work	Dimensions	Assays & Ref. No's	Other
①	STRIPPING, TRENCHING SAMPLING	see DETAIL MAP I A	Assay sheet NO. CB11925	
X#1	SAMPLE	grab	Assay sheet CB 11859 - Au .01102	
X#2	SAMPLE	grab	Assay sheet CB 11859 - Au .00702	
MAP AREA	prospecting - discovery of marble		beds AS SHOWN (1 & 2)	

NOTES: OUTCROP Investigated (1) - Breccia limestone/MARBLE - pink, buff
(2) wavy limestone/MARBLE - green, buff
(3) diabase

J. BRADY CPAP/91