

DIAMOND DRILL RECORD

Hole No. 0 Sheet No. 1

Property.. G. Frank Honlan, Parkin Twp.
 Location.. On S-68617

45° Dip

Elev. Collar _____
 Datum _____
 Date Started... July 4, 55
 Date Completed Aug. 4, 55
 Drilled by... W.C. Brochu, North Bay, Ont
 Logged by... Hugh Carey, Milnet, Ont

Latitude.. 1085
 Departure
 Bearing.. 55° E

Total Footage 105

Footage		Formation	Sample Number	Sample Footage	Sample Width	Gold Sample	Gold Sludge	Remarks
From	To							
0	7	G 2 feet Lorrain feldspathic quartzite						NO
7	50	G 2½ " " " "						Reading (?) on Plugger Contact
50	60	G 1½ " " " "						" "
60	105	G 3 " " " "						" "



Ø10

(Bruce FM)

Aug. 16/55

**DUPLICATE COPY.
 POOR QUALITY ORIGINAL
 TO FOLLOW**

DIAMOND DRILL RECORD

Hole No. 0 Sheet No. 13

Property Location W. Frank Wheeler Parker Twp. 45° Dip
ON S-68617

Latitude 122°
 Departure 55° E
 Bearing 55° E
 Total Footage 105

Elev. Collar _____
 Datum _____
 Date Started July 4/53
 Date Completed Jan 4/54
 Drilled by W.C. Graham
 Logged by Hugh C. ...

Footage		Formation	Sample Number	Sample Footage	Sample Width	Gold Sample	Gold Sludge	Remarks
From	To							
0	7	LORRAIN fold parallel QUARTZITE						See Remarks
7	10	"						
10	60	"						
60	105	"						
		(B.C. 1.5 FM)						

Date of Examination Jan 4/54

DIAMOND DRILL RECORD

Roll No. 1 Sheet No. 1

Property Location: **G Frank Hanlon, Parkin Twp on S-68617**

45° Dip

Elev. Collar _____
 Datum _____
 Date Started... **July 4/55**
 Date Completed **Aug. 4/55**
 Drilled by... **W.C. Brochu, North Bay, Ont.**
 Logged by... **Hugh Carey**

Latitude **1102**
 Departure
 Bearing **N5°W**

Total Footage **704'**

Footage		Formation	Sample Number	Sample Footage	Sample Width	Gold Sample	Gold Sludge	Remarks
From	To							
		(BRUCE FM)						
0	25	LORRAIN FELDSPATH QUARTZITE						
25	59	" "						SLITE READING ON GEIGER CONTACT
59	116	" "						
116	153	" "						
153	190	" "						
190	220	" "						NO READING
220	238	IMPURE GREEN QUARTZITE						
238	266	" "						
266	286	" "						
286	327	" "						
327	346	" "						
346	380	" "						
380	401	" "						
401	434	" "						
434	484	" "						
484	513	" "						
513	555	" "						
555	585	" "						
585	604	" "						
604	630	" "						
630	653	" "						
653	681	" "						
681	704	" "						

**DUPLICATE COPY
 FOR QUALITY ORIGINAL
 TO FOLLOW**

DIAMOND DRILL RECORD

Hole No. 1 Sheet No. ①

Property Location of Frank Hamilton Pickin Twp. 45°
on S-68617

Latitude 1102
 Departure
 Bearing N 5° W

Dip 70°
 Total Footage 700

Elev. Collar _____
 Datum _____
 Date Started July 4 1930
 Date Completed Aug 10 1930
 Drilled by W. E. Branch North Bay Ont.
 Logged by Thos. Craig

Footage		Formation	Sample Number	Sample Footage	Sample Width	Gold Sample	Gold Sludge	Remarks
From	To							
0	25	(BRUC F)						
25	69	Carboniferous shale						thin section on page 2
69	116	"						
116	133	"						
133	190	"						
190	220	"						
220	252	Shale						
252	266	"						Soft shale
266	286	"						
286	327	"						
327	346	"						
346	380	"						
380	421	"						
421	437	"						
437	454	"						
454	513	"						
513	555	"						
555	585	"						
585	600	"						
600	630	"						
630	650	"						
650	680	"						
680	700	"						

Date of Examination Aug 16 1930

Thos. Craig

DIAMOND DRILL RECORD

Hole No. 2 Sheet No. 1

Property.. G Frank Hanlon Parkin Twp.
 Location.. on S-68617
 Latitude.. 1102
 Departure
 Bearing.. S85°W

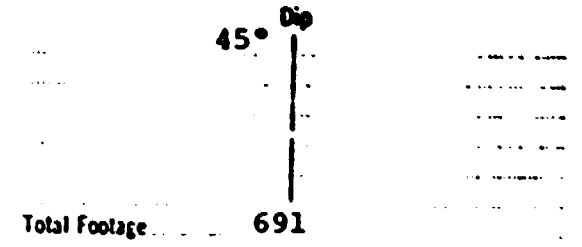

Elev. Collar _____
 Datum _____
 Date Started... Aug. 4/55
 Date Completed July 4/55
 Drilled by... W. C. Brochu, North Bay, Ont.
 Logged by... Hugh Carey

Footage		Formation	Sample Number	Sample Footage	Sample Width	Gold Sample	Gold Sludge	Remarks
From	To							
0	7	(BRUCE FM) LORRAN FELDSPATH QUARTZITE						
7	23	" " "						SLITE READING ON PLUGGER CONTACT
23	48	" " "						" "
48	63	" " "						" "
63	74	" " "						" "
74	92	" " "						" "
92	119	" " "						" "
119	149	" " "						" "
149	173	" " "						NO READING
173	192	IMPURE GREEN QUARTZITE						" "
192	218	" " "						" "
218	246	" " "						" "
246	264	" " "						" "
264	286	" " "						" "
286	315	" " "						" "
315	340	" " "						" "
340	367	" " "						" "
367	393	" " "						" "
393	413	" " "						" "
413	443	" " "						" "
443	468	" " "						" "
468	488.2	" " "						" "
488.2	498.5	" " "						" "
498.5	568	" " "						" "
568	588.6	" " "						" "
588.6	608.7	- WITH SOME PEBBLE CONGLOMERATE						" "
608	629	" " "						" "
629	661	" " "						" "
661	691	SLITE ? IRON PYRITE						" "

**DUPLICATE COPY
 POOR QUALITY ORIGINAL
 TO FOLLOW**

→ NO READING ON PLUGGER CONTACT

DIAMOND DRILL RECORD

Hole No. 2 Sheet No. 1

Property Location Dr. Frank Hosiess Park TWP 45° Dip
on S-68617

Latitude 1102
 Departure
 Bearing S 35° W

Total Footage 691

Elev. Collar _____
 Datum _____
 Date Started Aug 11 1910
 Date Completed 1910
 Drilled by McC Branch
 Logged by Edw. Craig

Footage		Formation	Sample Number	Sample Footage	Sample Width	Gold Sample	Gold Sludge	Remarks
From	To							
0	7	Granite						
7	23	Granite						
23	48	Granite						
48	63	Granite						
63	74	Granite						
74	92	Granite						
92	119	Granite						
119	149	Granite						
149	173	Granite						
173	192	Granite						
192	212	Granite						
212	246	Granite						
246	264	Granite						
264	276	Granite						
276	312	Granite						
312	340	Granite						
340	367	Granite						
367	393	Granite						
393	413	Granite						
413	443	Granite						
443	462	Granite						
462	482	Granite						
482	498	Granite						
498	568	Granite						
568	585	Granite						
585	608	Granite						
608	629	Granite						
629	661	Granite						
661	691	Granite						

Date of Examination Aug 16 1910 Edw. Craig

DIAMOND DRILL RECORD

PROPERTY HANLON CLAIMS - PARKIN TWP. SUDBURY MIN. DIV. HOLE NO. 1

SHEET NUMBER 1 SECTION FROM _____ TO _____ STARTED JULY 8/57
LATITUDE CLAIM S 68615 (AS PER ATTACHED SKETCH) DATUM _____ COMPLETED JULY 8/57
DEPARTURE _____ BEARING S 40° W ULTIMATE DEPTH _____
ELEVATION _____ DIP 56° PROPOSED DEPTH _____

DEPTH FEET	FORMATION	SAMPLE NO.	WIDTH OF SAMPLE	GOLD g	SLUDGE GOLD g		
0 - 27	<i>Nipissing Diabase</i> GREENSTONE - AT 5', 1' FELSPATHIC QUARTZITE						
	END OF HOLE.						
	CORE IS LOCATED AT COLLAR OF HOLE.						

N.M.P., TORONTO-STOCK FORM NO 801 REV. 12/51

DRILLED BY H. CRAIG

SIGNED D. A. McDonald
D. A. McDONALD, P. ENG.

DIAMOND DRILL RECORD

PROPERTY HANLON CLAIMS - PARKIN TWP. SUDBURY MIN. DIV. HOLE NO. 2

SHEET NUMBER 1 SECTION FROM _____ TO _____ STARTED JULY 10/57
 LATITUDE CLAIM S 68611 (AS PER ATTACHED SKETCH) COMPLETED JULY 10/57
 DEPARTURE _____ BEARING S 5° W ULTIMATE DEPTH _____
 ELEVATION _____ DIP 59° PROPOSED DEPTH _____

DEPTH FEET	FORMATION	SAMPLE NO.	WIDTH OF SAMPLE	GOLD S	SLUDGE GOLD S
0 - 27	BANDED LIMESTONE <i>ESPANOLA FM</i>				
	AT 4' - PINK QUARTZ				
	AT 7' - PINK QUARTZ				
	END OF HOLE				
	CORE IS LOCATED AT COLLAR OF HOLE.				

N.M.P. TORONTO-STOCK FORM NO. 901 REV. 12/51

DRILLED BY H. CRAIG

SIGNED *Donna Donald*
D. A. McDONALD, P. ENG.

G. Z. Hanson

DIAMOND DRILL RECORD

PROPERTY NALON CLAIMS - PARKIN TWP. SUDBURY MIN. DIV. HOLE NO. 3

SHEET NUMBER 568623 1 SECTION FROM _____ TO _____ STARTED JULY 8/57
 LATITUDE 45° 18' 30" N LONGITUDE 81° 48' 30" W DATUM _____ COMPLETED JULY 6/57
 DEPARTURE _____ BEARING N 22° E ULTIMATE DEPTH _____
 ELEVATION _____ DIP 65° PROPOSED DEPTH _____

DEPTH FEET	FORMATION	SAMPLE NO.	WIDTH OF SAMPLE	GOLD g	SLUDGE GOLD g
0 - 25	BANDED Limestone				
25 - 50	BANDED Limestone				
50 - 60	BANDED Limestone				
END OF HOLE.					
CORE IS LOCATED AT COLLAR OF HOLE.					

N.M.P., TORONTO-STOCK FORM NO. 801 REV. 12/51

DRILLED BY H. CRAIG

SIGNED *Beni' Goulet*
D. A. McDONALD, P. Eng.

DIAMOND DRILL RECORD

PROPERTY MANLON CLAIMS - PARKIN TWP., SUDBURY MINING DIV. HOLE NO. 4

SHEET NUMBER 1 SECTION FROM _____ TO _____ STARTED JULY 3/57
 LATITUDE CLAIM 8 68682 (AS PER ATTACHED SKETCH) DATUM _____ COMPLETED JULY 4/57
 DEPARTURE _____ BEARING N 20° E ULTIMATE DEPTH _____
 ELEVATION _____ DIP 53° PROPOSED DEPTH _____

DEPTH FEET	FORMATION	SAMPLE No.	WIDTH OF SAMPLE	GOLD g	SLUDGE GOLD g
0 - 45	BANDED Limestone NIPISSING DIABASE				
45 - 57	KEDDATHA - MINERALIZED, SPECKS OF PYRITE THROUGHOUT				
57 - 65	BANDED LIMESTONE				
	END OF HOLE				

CORE IS LOCATED AT BOTTOM OF HOLE.

N.M.P. TORONTO-STOCK FORM NO. 901 REV 12/51

DRILLED BY H. CRAIG

SIGNED *D.A. McDonald*
D. A. McDONALD, P. ENG.

DIAMOND DRILL RECORD

PROPERTY WALTON CLAIM - PARKIN TWP., SIDNEY MINING DIV. HOLE NO. 5

SHEET NUMBER 1 SECTION FROM _____ TO _____

STARTED JULY 2/57

LATITUDE CLAIM S 68623 (AS PER ATTACHED SECTION) DATUM _____

COMPLETED JULY 2/57

DEPARTURE _____ BEARING N 14° E

ULTIMATE DEPTH _____

ELEVATION _____ DIP 50°

PROPOSED DEPTH _____

DEPTH FEET	FORMATION	SAMPLE NO.	WIDTH OF SAMPLE	GOLD g	SLUDGE GOLD g		
0 - 20	BANDED LIMESTONE						
	END OF HOLE						
	CORE IS LOCATED AT COLLAR OF HOLE.						

N.M.P., TORONTO-STOCK FORM NO. 901 REV. 12/51

DRILLED BY N. CRAIG

SIGNED Wm. Donald

W. A. McDONALD, P. ENG.

DIAMOND DRILL RECORD

PROPERTY HARLOW CLAIMS - PARKIN TWP, SODBURY MIN. DIV. HOLE NO. 6

SHEET NUMBER 1 SECTION FROM S-68627 (AS PER ATTACHED SKETCH) TO

STARTED July 11/57

LATITUDE CLAIM S 68627 (AS PER ATTACHED SKETCH) JM

COMPLETED July 11/57

DEPARTURE BEARING N 13° W

ULTIMATE DEPTH

ELEVATION DIP 54°

PROPOSED DEPTH

DEPTH FEET	FORMATION	SAMPLE NO.	WIDTH OF SAMPLE	GOLD g	SLUDGE GOLD g		
0 - 45	KEEWATIN						
0-45	KEEWATIN						
	AT 25' - 27', CORE BROWN						
	END OF HOLE						
	CORE IS LOCATED AT COLLAR OF HOLE.						

DRILLED BY M. CRAIG

SIGNED D. A. McDonald
D. A. McDONALD, P. ENG.

DIAMOND DRILL RECORD

PROPERTY HANLON CLAIMS - PARKIN TWP., SUDBURY MIN. DIV. HOLE NO. 7

SHEET NUMBER 5-68627 (AS PER ATTACHED SKETCH) SECTION FROM _____ TO _____ STARTED JULY 12/37

LATITUDE CLAIN S 68627 (AS PER ATTACHED SKETCH) KEEWATIN COMPLETED JULY 12/37

DEPARTURE _____ BEARING N 20° W ULTIMATE DEPTH _____

ELEVATION _____ DIP 61? PROPOSED DEPTH _____

DEPTH FEET	FORMATION	SAMPLE NO.	WIDTH OF SAMPLE	GOLD %	SLUDGE GOLD %
0 - 39	KEEWATIN				
0 - 39	KEEWATIN - (CORE HAS BEEN BUMPED BY A BEAR)				
	END OF HOLE.				
	CORE IS LOCATED AT COLLAR OF HOLE.				

N.M.P. TORONTO - STOCK FORM NO. 901 REV. 12/51

DRILLED BY M. CRAIG

SIGNED [Signature]
 D. A. [unclear]

DIAMOND DRILL RECORD

PROPERTY HARLOW CLAIMS - PARKIN TWP., SIDBURY MIN. DIV.

HOLE NO. 9

July 16/57

SHEET NUMBER 1

SECTION FROM _____ TO _____

STARTED JULY 16/57

LATITUDE CLAIN S 6827 (AS PER ATTACHED SKETCH) M _____

COMPLETED JULY 16/57

DEPARTURE _____

BEARING N 30° W N 30° W

ULTIMATE DEPTH _____

ELEVATION _____

DIP 62° 62°

PROPOSED DEPTH _____

DEPTH FEET	FORMATION	SAMPLE NO.	WIDTH OF SAMPLE	GOLD g	SLUDGE GOLD g
<u>0 - 32</u>	<u>KERVATIN KERVATIN</u>				
	<u>END OF HOLE</u>				
	<u>CORE IS LOCATED AT COLLAR OF HOLE</u>				

M.P.F. TORONTO-STOCK FORM NO. 801 REV. 12/51

DRILLED BY N. CRAIG

SIGNED D. A. McDonald
 D. A. McDONALD, P. ENG.

DIAMOND DRILL RECORD

PROPERTY HANLON CLAIMS - PARKIN TWP., SUDBURY MIN. DIV. HOLE NO. 10

SHEET NUMBER 1 SECTION FROM _____ TO _____ STARTED JULY 17/57 JULY 17/57

LATITUDE CLAIM 8 68611 (AS PER ATTACHED CERTIFICATE) COMPLETED JULY 18/57

DEPARTURE _____ BEARING N 12° E ULTIMATE DEPTH _____

ELEVATION _____ DIP 45° PROPOSED DEPTH _____

DEPTH FEET	FORMATION	SAMPLE NO.	WIDTH OF SAMPLE	GOLD g	SLUDGE GOLD g		
0 - 20 0-20	BANDED LIMESTONE <i>spanola</i> ESPANOLA AT 6' - GROUND CORE						
	PINK QZ AT 11' - GROUND CORE						
20 - 25	PINK QUARTZ - SOME STREAKS OF LIMESTONE						
25 - 42	BANDED LIMESTONE						
42 - 43½	CONGLOMERATE PEBBLE <i>Bruce</i> BRUCE						
43½ - 47	IMPURE QUARTZITE						
	END OF HOLE						
	CORK IS LOCATED AT COLLAR OF HOLE						

N.M.P. TORONTO-STOCK FORM NO. 901 REV. 12/51

DRILLED BY H. CRAIG

SIGNED *D. A. McDONALD*
D. A. McDONALD, P. ENG.

DIAMOND DRILL RECORD

PROPERTY HARLOW CLAIMS - PARKIN TWP., SUDBURY MIN. DIV. HOLE NO. 11

SHEET NUMBER 1 SECTION FROM _____ TO _____

STARTED July 19/57

LATITUDE CLAIM 8 68611 (AS PER ATTACHED SKETCH)

COMPLETED July 19/57

DEPARTURE _____ BEARING N 20° E

ULTIMATE DEPTH _____

ELEVATION _____ DIP 52°

PROPOSED DEPTH _____

DEPTH FEET	FORMATION	SAMPLE NO.	WIDTH OF SAMPLE	GOLD g	SLUDGE GOLD g
0 - 10	BANDED LIMESTONE				
10 - 14	COKE BROKEN				
14 - 27	LIMESTONE & IMPURE QUARTZITE				
	AT 25', 2' GROUND CORE				
27 - 32	LIMESTONE				
27-32	AT 32', 1' GROUND CORE				
32 - 43	CONGLOMERATE				
43 - 47	BANDED IMPURE QUARTZITE → BANDED IMPURE QUARTZITE				
	END OF HOLE				

CORE IS LOCATED AT COLLAR OF HOLE

N.M.P. TORONTO-STOCK FORM NO. 501 REV. 12/51

DRILLED BY M. CRAIG

SIGNED D. A. McDonald
D. A. McDONALD, P. ENG.

DIAMOND DRILL RECORD

PROPERTY MANLON CLAIMS - PARKIN TWP., SUDBURY MIN. DIV.HOLE NO. 12SHEET NUMBER 1

SECTION FROM _____ TO _____

STARTED JULY 22/57 July 22/57LATITUDE S 69° 11' (AS PER ATTACHED SKETCH) DATUM _____COMPLETED JULY 22/57

DEPARTURE _____

BEARING N 15° E N 15° E

ULTIMATE DEPTH _____

ELEVATION _____

DIP 61° 61°

PROPOSED DEPTH _____

DEPTH FEET	FORMATION	SAMPLE No.	WIDTH OF SAMPLE	GOLD \$	SLUDGE GOLD \$
0 - 25	<u>BANDER LIMESTONE</u>				
	<u>AT 19 1/2 - 24' - GROUND CORE AT 19 1/2 - 24' GROUND CORE</u>				
25 - 31	<u>GROUND CORE GROUND CORE</u>				
	<u>AT 25' - 1' LIMESTONE AT 25' - 1' LIMESTONE</u>				
	<u>END OF HOLE</u>				
	<u>CORE IS LOCATED AT COLLAR OF HOLE</u>				

DRILLED BY M. CRAIG

SIGNED

Orlando [signature]
 D. A. McDONALD, P. Eng.

DIAMOND DRILL RECORD

PROPERTY HARLOW CLAIMS - PARKIN TWP., SOUBURY MIN. DIV. HOLE NO. 13

SHEET NUMBER 1 SECTION FROM _____ TO _____

STARTED July 23/57 July 23/57

LATITUDE CLAIM S 68611 (AS PER ATTACHED SURVEY)

COMPLETED JULY 23/57

DEPARTURE _____ BEARING E 10° E N 10° E

ULTIMATE DEPTH _____

ELEVATION _____ DIP 63° 63°

PROPOSED DEPTH _____

DEPTH FEET	FORMATION	SAMPLE No	WIDTH OF SAMPLE	GOLD g	MUDE GOLD g
<u>0-15</u> <u>0-15</u>	<u>BANDED LIMESTONE</u> <u>BANDED LIMESTONE</u>				
<u>16-19</u> <u>16-19</u>	<u>GROUND CORE</u> <u>GROUND CORE</u>				
<u>19-28</u> <u>19-28</u>	<u>SLATE (ARGILLITE) SOME STREAKS OF WHITE CALCITE</u>				
	<u>SLATE (ARGILLITE) SOME STREAKS OF WHITE CALCITE</u>				
	<u>END OF HOLE.</u>				
	<u>CORE IS LOCATED AT COLLAR OF HOLE.</u>				

N.M.P. TORONTO-STOCK FORM NO. 501 REV. 12/51

DRILLED BY M. CRAIG

SIGNED Don Bond

DIAMOND DRILL RECORD

PROPERTY NAILON CLAIMS - PARKIN TWP., SUDBURY MIN. DIV. HOLE NO. 14

SHEET NUMBER 1 SECTION FROM _____ TO _____ STARTED JULY 24/57 July 24/57
 LATITUDE CLAIM S 6811 (AS PER ATTACHED DRAWING) COMPLETED JULY 25/57
 DEPARTURE _____ BEARING S 68° W S 68° W ULTIMATE DEPTH _____
 ELEVATION _____ DIP 54° 54° PROPOSED DEPTH _____

DEPTH FEET	FORMATION	SAMPLE NO	WIDTH OF SAMPLE	GOLD g	SLUDGE GOLD g
0 - 60 0-60	DIORITE DIORITE				
	END OF HOLE				
	CORE IS LOCATED AT COLLAR OF HOLE				

N.M.P. TORONTO-STOCK FORM NO 501 REV 12/51

DRILLED BY M. CRAIG SIGNED D. A. McDONALD, P. ENG.

DIAMOND DRILL RECORD

PROPERTY MARLOW CLAIMS - PARKIN TWP., SUDBURY MIN. DIV. HOLE NO. 16

SHEET NUMBER 1 SECTION FROM _____ TO _____ STARTED JULY 28/57 July 28/57

LATITUDE S 69°11' (AS PER ATTACHED SKETCH) DATUM _____ COMPLETED JULY 29/57

DEPARTURE _____ BEARING S 60° W S 60° W ULTIMATE DEPTH _____

ELEVATION _____ DIP 66° 66° PROPOSED DEPTH _____

DEPTH FEET	FORMATION	SAMPLE NO.	WIDTH OF SAMPLE	GOLD \$	SLUDGE GOLD \$	
<u>9-55</u> <u>0-55</u>	<u>DIORITE</u> <u>DIORITE</u>					
	<u>END OF HOLE.</u>					
	<u>CORE IS LOCATED AT COLLAR OF HOLE.</u>					

N.M.P. TORONTO - STOCK FORM NO 501 REV. 12/51

DRILLED BY H. CRAIG

SIGNED Ben C. Linnell

DIAMOND DRILL RECORD

PROPERTY HANLON CLAIMS & PARKIN T.P., SUDBURY MIN. DIV.

HOLE NO. 18

SHEET NUMBER S-58615¹

SECTION FROM _____ TO _____

STARTED AUG. 2/57 AUG. 2/57

LATITUDE S 68°15' (AS PER ATTACHED SKETCH)

DATUM _____

COMPLETED AUG. 3/57 AUG. 3/57

DEPARTURE _____

BEARING N 70° W N 70° W

ULTIMATE DEPTH _____

ELEVATION _____

DIP 53° 53°

PROPOSED DEPTH _____

DEPTH FEET	FORMATION	SAMPLE NO.	WIDTH OF SAMPLE	GOLD \$	SLUDGE GOLD \$
0-23	KEEWATIN - <u>NIPISSING</u> DIABASE				
0-23	KEEWATIN				
23-24	23-24 WHITE CALCITE				
	AT 23', CHALCOPYRITE				
24-50	24-50 KEEWATIN WITH CALCITE STRINGERS				
50-75	50-75 KEEWATIN				
75-82	75-82 KEEWATIN				
	END OF HOLE.				
	CORE IS LOCATED AT COLLAR OF HOLE.				

N.M.P. TORONTO-STOCK FORM NO. 501 REV. 12/51

DRILLED BY H. CRAIG

SIGNED Donna L. Bernal

1957

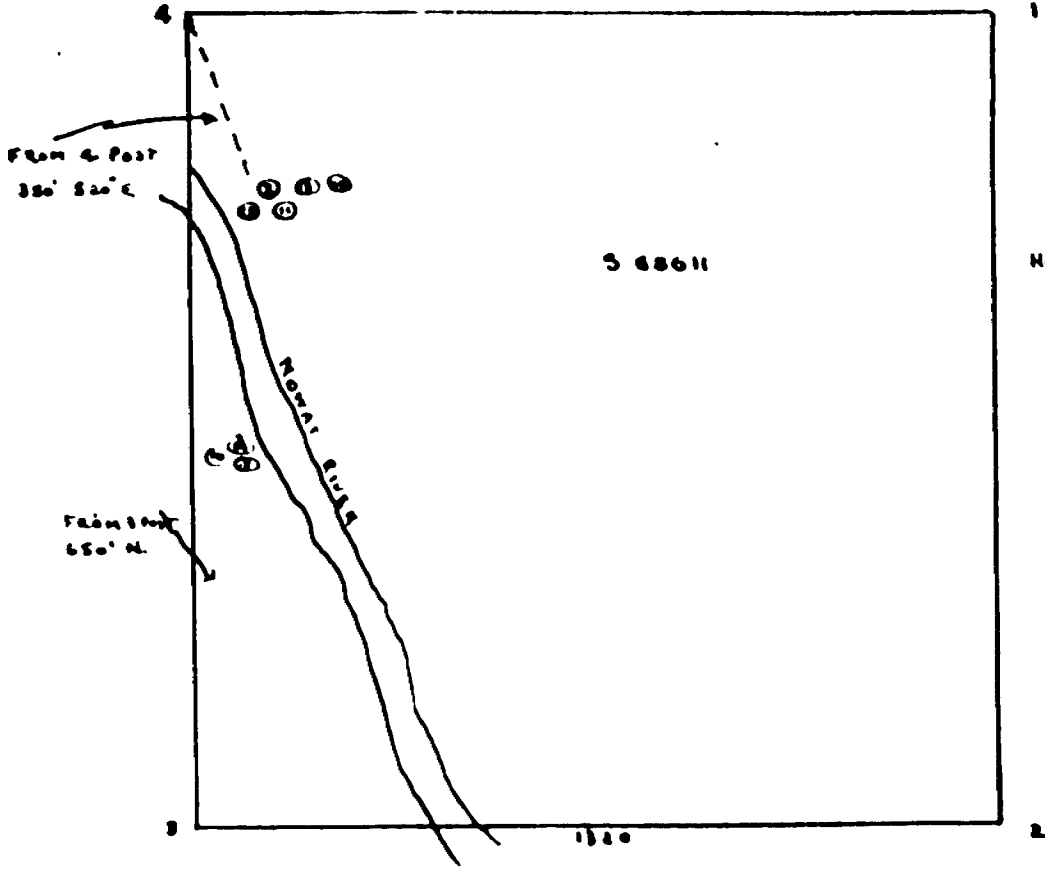

Hole No	DIRECTION	DIP
2	S 5° W	39°
10	N 42° E	43°
11	N 20° E	32°
12	N 15° E	61°
13	N 10° E	63°
14	S 60° W	30°
15	S 62° W	61°
16	S 60° W	66°

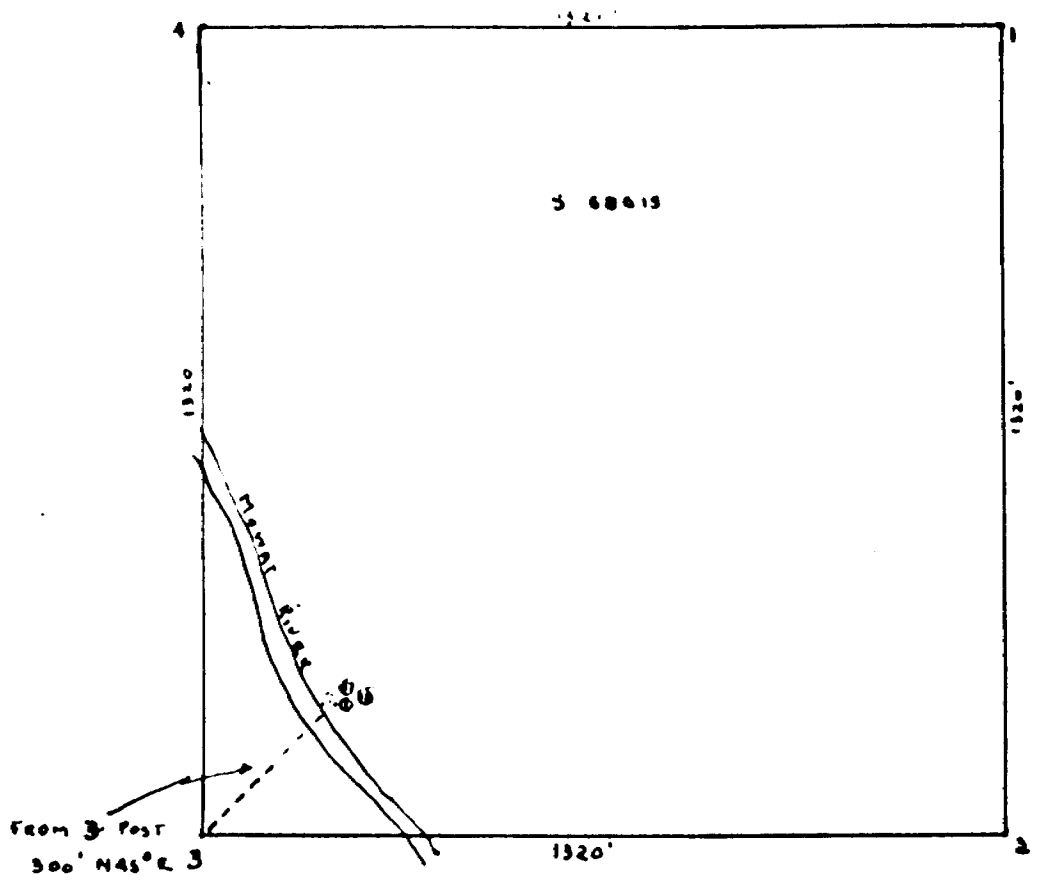

Hole No	DIRECTION	DIP
1	S 40° W	56°
17	N 35° W	57°
18	N 70° W	53°

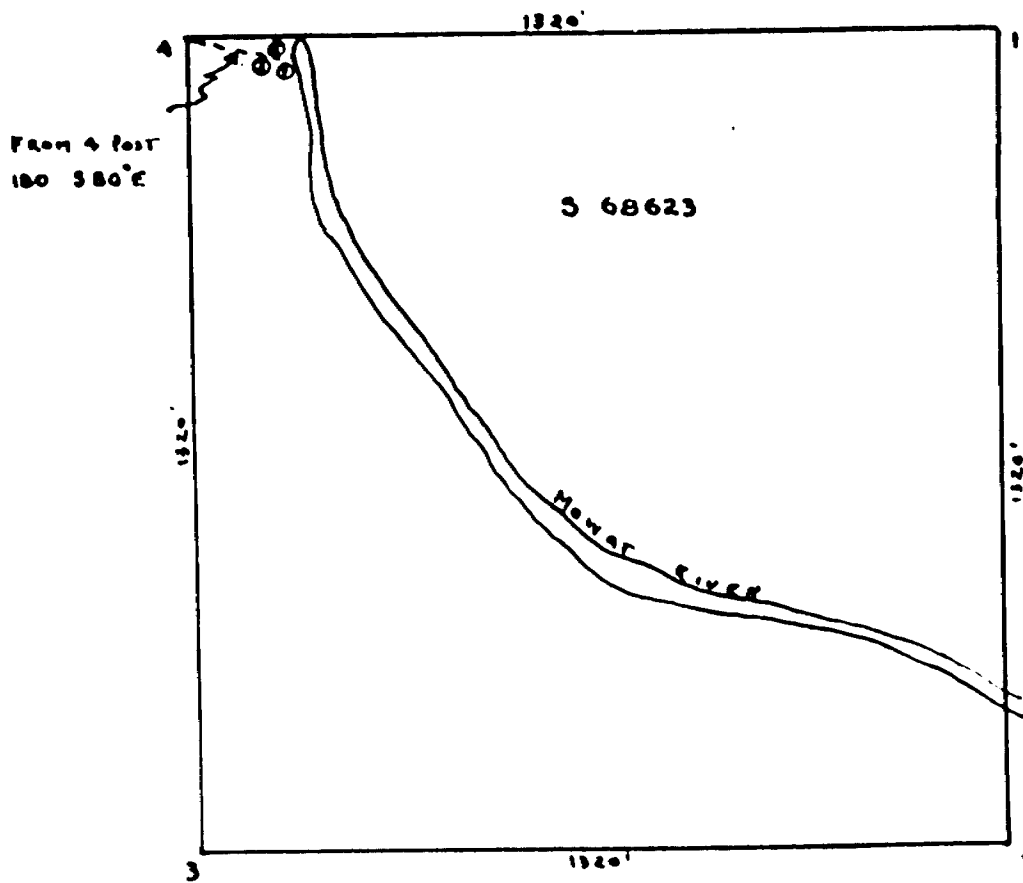

Hole No	Direction	Dip
5	N 14° E	58°
6	N 20° E	53°
3	N 18° E	65°

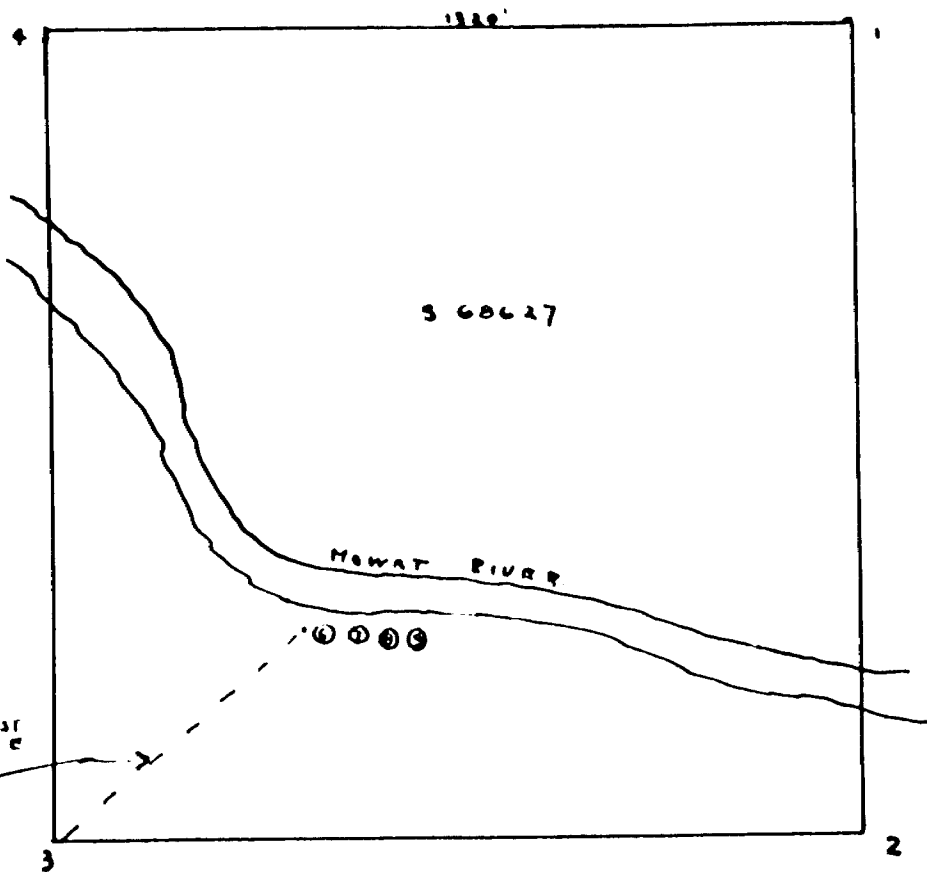

Hole No	Direction	Dip
6	N 13° W	54°
7	N 20° W	61°
8	N 25° W	78°
9	N 30° W	62°

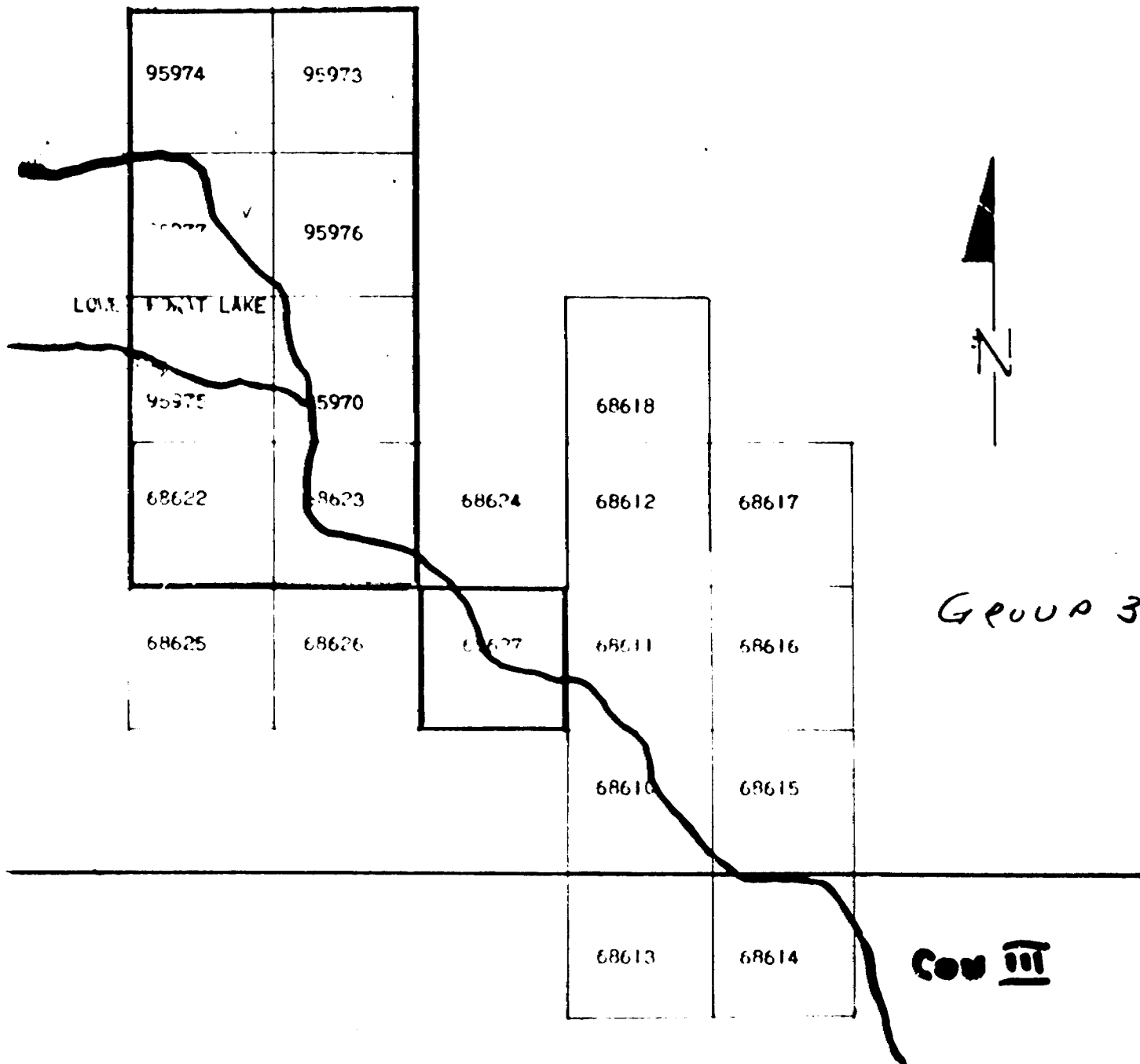

C. FRANK HANLAN CLAIMS
 PARKIN TOWNSHIP
 SUDBURY MINING DIVISION

LOT 10

GRAVEEK T.W.P.

DARKIN T.W.P.
Sudbury Mining Div

MOWAT L.

160 chms.

360 chms.

Ayl.
T.W.

Hutton
T.W.P.

68620

68621

68622

68623

68624

68612

68617

75262

68620

68619

68625

68626

68627

68611

68616

75211

68610

68615

68613

68614

Cores stored in
boxes at drill holes.

MOWAT CREEK

Hutton Twp. M-944



Fraleck Tw

Hutton Twp. M-944

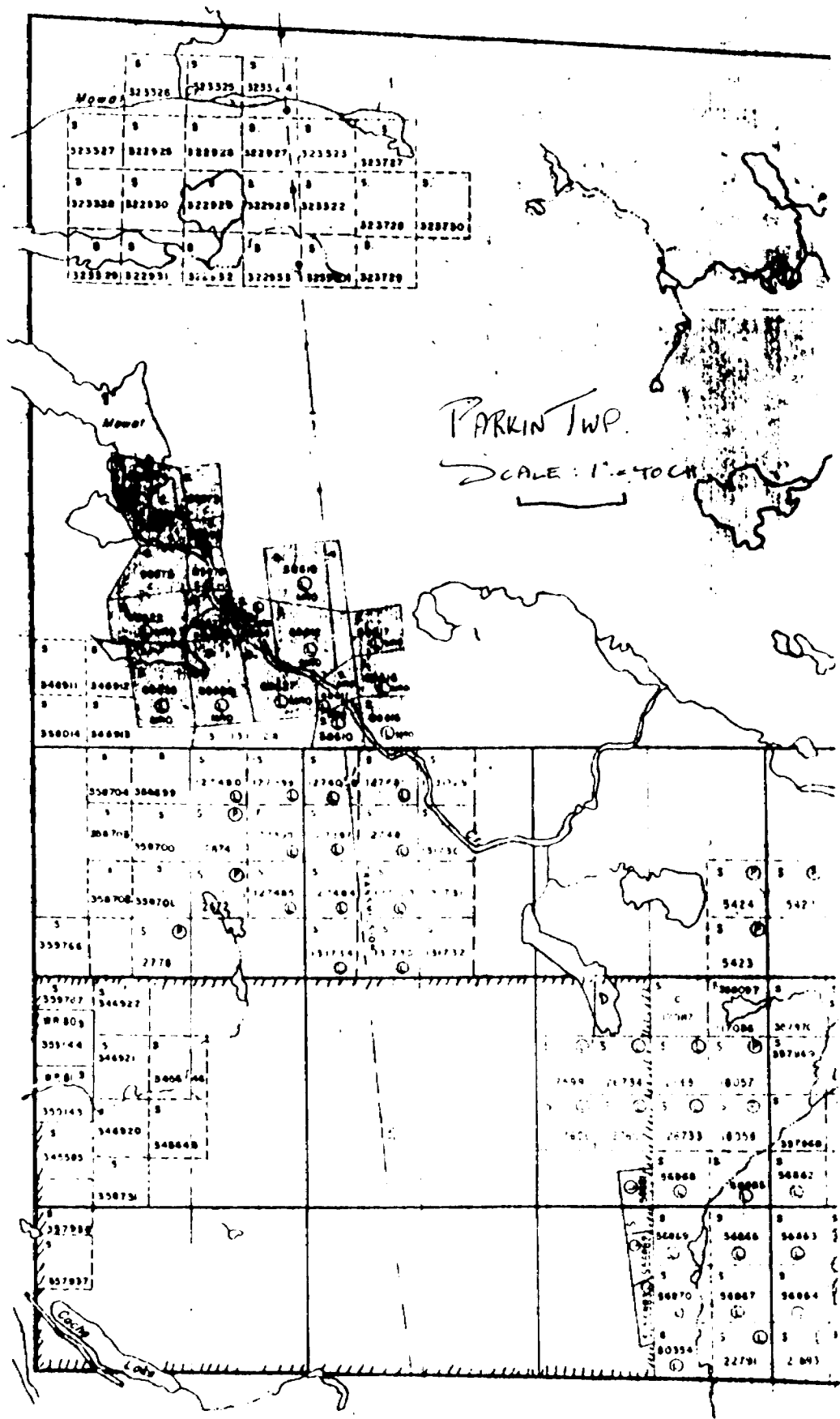

12 11 10 9 8 7 6

CLAIM No 68618



No 4 P

No 1 P

CLAIM No 568617

CLAIM No 68612

CLAIM 5-75263

IMPURE QUARTZITE + GREEN SLATE

Hole No 1
Depth 704
Dip 45°

ARLEIGH BAY

IMPURE QUARTZITE + GREEN SLATE

ELEV 1102

Hole No 2
Depth 691
Dip 45°

ELEV 1085

Hole No 3
Depth 105
Dip 45°

QUARTZITE

No 3 P

No 2 P

CLAIM No 68616

FRANK HANLAN
of Toronto Ont
PARKIN I.L.P.
Sudbury MINING DIV

SCALE 1" = 100'

★ PARKIN-0019, #1

