



41155W0121 0013E1 PARKIN

010

PARKIN TOWNSHIP REPORT #22

This file contains work performed by Ironco Mining & Smelting Co. Ltd. on claims:

S. 124117	Hole #1; 220.0	June, 1964
-----------	----------------	------------

S. 124118	Hole #2; 197.0	June, 1964
-----------	----------------	------------

	<u> </u>	
TOTAL: 2 DH	417.0	
	<u> </u>	

PARKIN TWP.

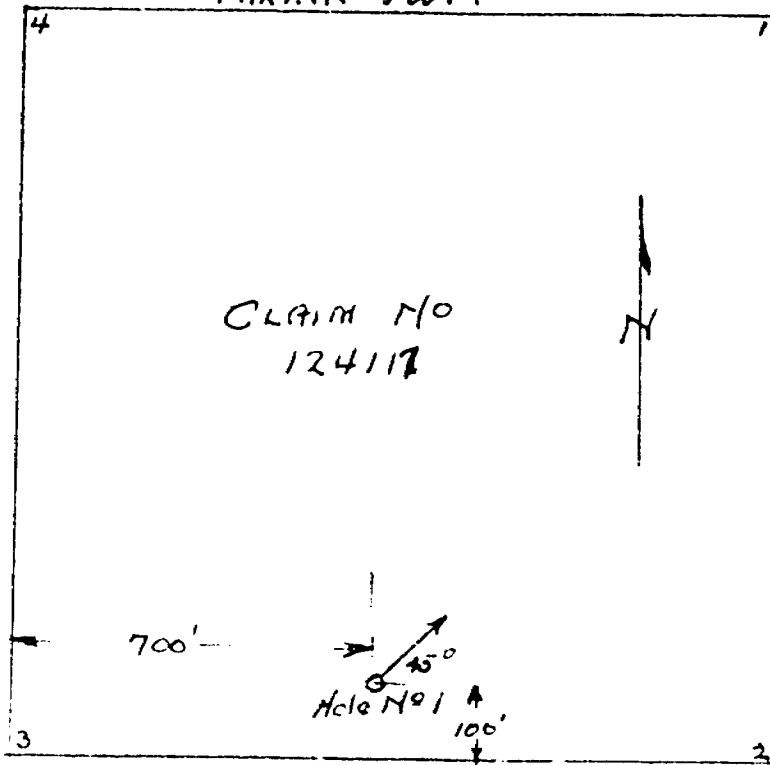

PARKIN TWP.

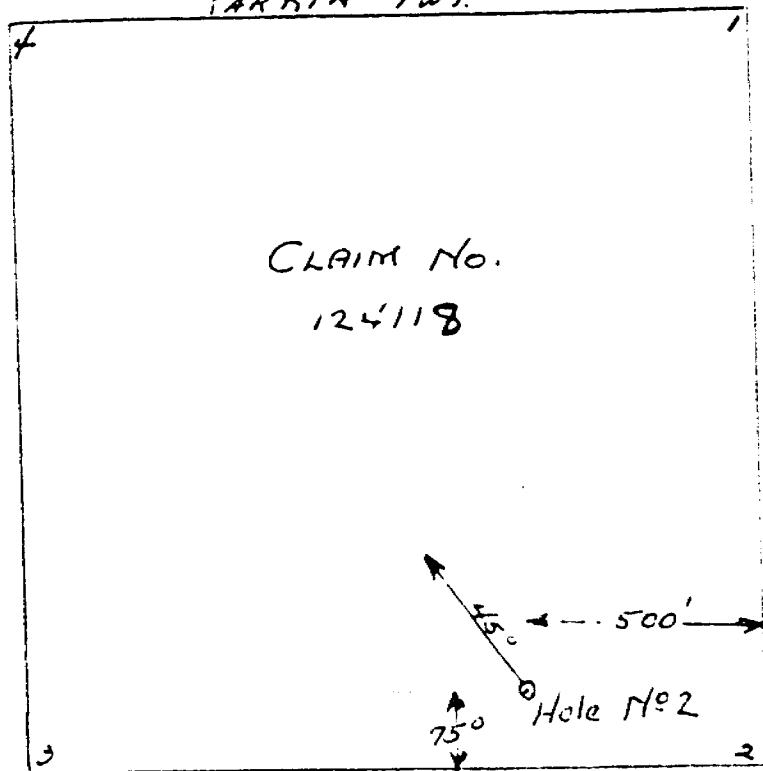

Ach.

Feb:

Ernest Mining & Smelting Co.

Parkin TP.

Claim: 124117, - 118.

D.D. - logs & location, 1967.

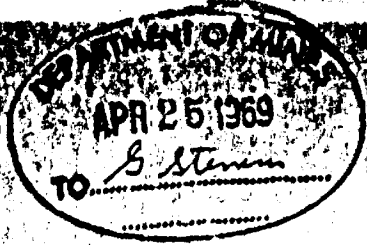

REPORT #10
PARKIN TWP.



41155W0121 0013E1 PARKIN

900

Form 12 A

THE MINING ACT



REPORT OF WORK

To the Recorder of SUDBURY Mining Division:

I, IRONCO MINING & SMELTING CO. LTD.
(Name of Applicant)
159 BAY ST TORONTO ONT.
(Post Office Address)

the recorded holder of mining claim No. S. 124117 hereby report the performance of 40 days' work not before reported, to be applied to this claim.

*This mining claim is one of a group of contiguous claims numbered S. 124116-17-18-19-20-21
S. 123637-38-39-40-41-42-43

of which I am the recorded holder under Mining License No. A35981 and the work

was performed on mining claim(s) S. 124117-18 and is to be applied

in respect of mining claim(s) S. 124117
(*Complete above section only if applicable)

The work is as follows:

Stripping or opening up mines, sinking shafts or other actual mining operations

The names and addresses of the men who performed the work and the dates upon which each man worked in its performance are: (If more space is required, attach list).

.....
.....
.....

Total No. of days

Diamond or other Core Drilling

Footage drilled 417' 4 1/2" No. of holes drilled 2 Angle 45°

Diameter of core 1 1/2" 1 1/2" Names and addresses of owner and operator of drill Sudbury Diamond Drilling Co. Ltd. 375 Lakeview Sq. Sudbury

Dates upon which drilling was done June 15 to July 2/64
(Core log and Sketch in duplicate by core examiner accompanies this Report.)

Total No. of days 417

Work by Compressed Air or other Power Driven Rock Drill or Mechanical Equipment.

Type of drill

Names and addresses of men engaged in operating drill.

Dates upon which each man worked

Total No. of days

The penalty for making a false statement in this certificate is \$500, or six months imprisonment or both.

124117
PARKIN TWP.

THE MINING ACT



REPORT OF WORK

ONTARIO

To the Recorder of SUDBURY Mining Division:
BRANCO MINING & SMELTING CO LTD
(Name of Applicant)
159 BAY ST TORONTO ONT
(Post Office Address)

As certified holder of mining claim No. S. 124118 hereby report the performance of 417 days' work as before reported, to be applied to this claim.

This mining claim is one of a group of contiguous claims numbered S. 124116-17-18-19-20-21
S. 123637-38-39-40-41-42-43
 of which I am the recorded holder under Mining License No. A 35-981 and the work was performed on mining claim(s) S. 124117-18 and is to be applied in respect of mining claim(s) S. 124118
(Complete above section only if applicable)

The work is as follows:
~~Excepting the working of mines, sinking shafts or other general mining operations~~
 The names and addresses of the men who performed the work and the dates upon which each man worked in its performance are: (If more space is required, attach list)

Diamond or other Core Drilling
 Footage drilled 417' No. of holes drilled 2 Angle 45°
 Diameter of core 1 1/2" Names and addresses of owner and operator of drill Sudbury Diamond Drilling Co Ltd 375 HARGREAVES AVE SUDBURY
 Dates upon which drilling was done JUNE 15/64 to JULY 2/64
(Core log and sketch in duplicate by core examiner accompanies this Report.)

Total No. of days 417
Work by Compressed Air or other Power Driven Rock Drill or Mechanical Equipment.
 Type of drill _____
 Names and addresses of men engaged in operating drill _____

Dates upon which each man worked _____
 Total No. of days _____

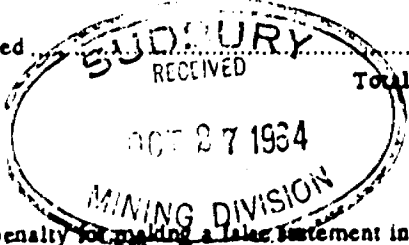

The penalty for making a false statement in this certificate is \$500. or six months imprisonment or both.

HULLOCK TWP. M-944

Aylmer Twp. M-641

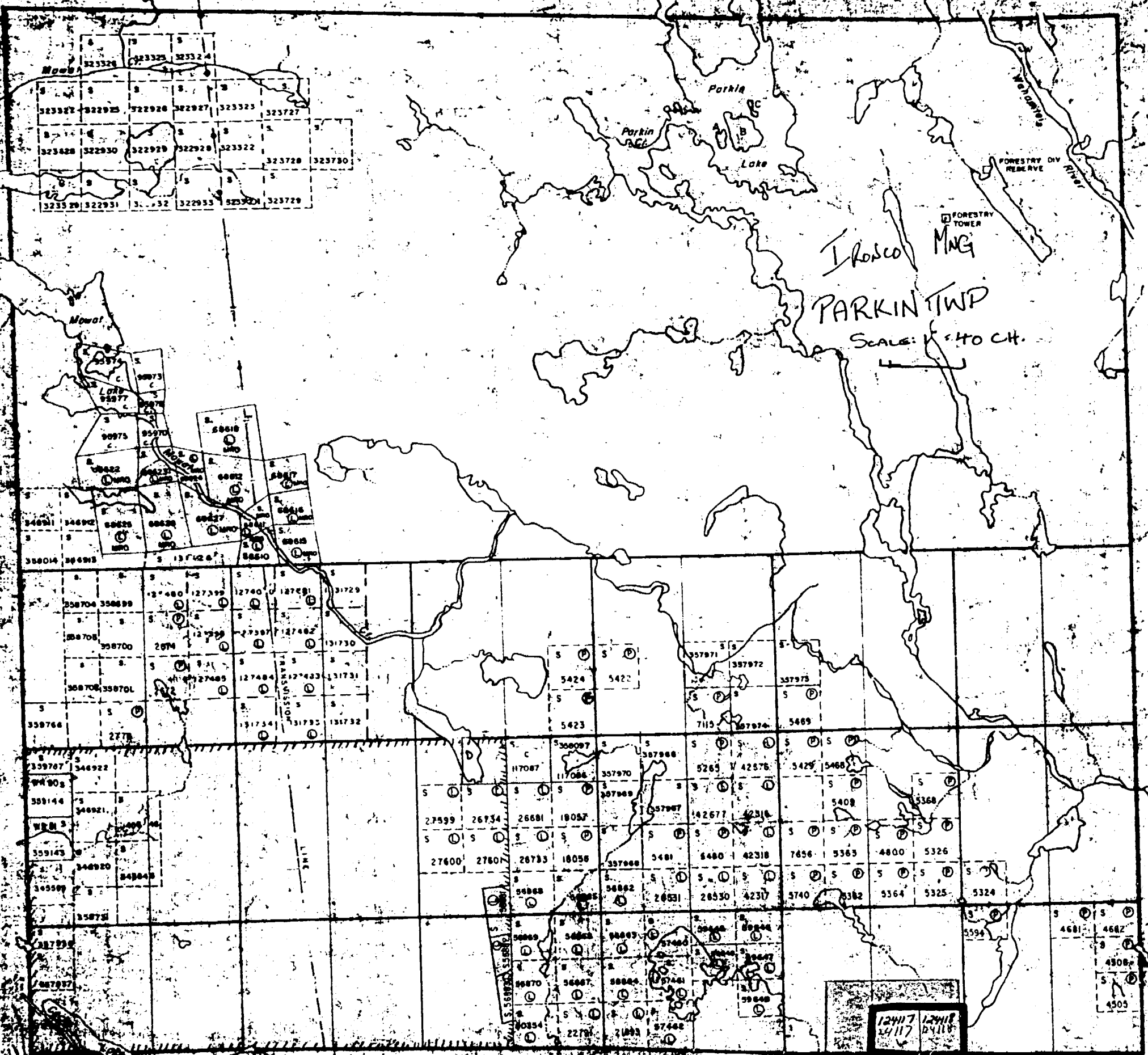

I Rosco MNG
 PARKIN TWP
 SCALE: 1" = 40 CH.

12417 12418
 12419 12420

