



411155W0128 0014D1 PARKIN

010

PARKIN TOWNSHIP REPORT #24

This file contains work performed on claim:

S. 127484

Holes #1; 115.0 Sept., 1965

#2; 103.0 Sept., 1965

#3; 137.0 Sept., 1965

                       
TOTAL: 3 DH 355.0

# DIAMOND DRILL RECORD

Hole No. 1

Sheet No. 2

Property Mining claim # 127484  
 Location Parkling top  
 Elevation \_\_\_\_\_  
 Departure \_\_\_\_\_  
 Bearing West

Dip 52 degrees

Total Footage 115'

Elev. Collar \_\_\_\_\_  
 Datum \_\_\_\_\_  
 Date Started Aug. 25<sup>th</sup> / 65  
 Date Completed Aug. 31<sup>st</sup> / 65  
 Drilled by Stanley Brennan  
 Logged by Stanley Brennan

Footage		Formation	Sample Number	Sample Footage	Sample Width	Gold Sample	Gold Sludge	Remarks
From	To							
0	62'	<i>Greenstone, sparse mineralization.</i>						
62'	80'	<i>Greenstone, considerable quartz and mineralization.</i>						
80'	115'	<i>Greenstone, considerable quartz and sparse mineralization.</i>						

Date of Examination Aug. 31<sup>st</sup> / 65.

Stanley Brennan.

PARKIN TWP.

*Diamond drilling*

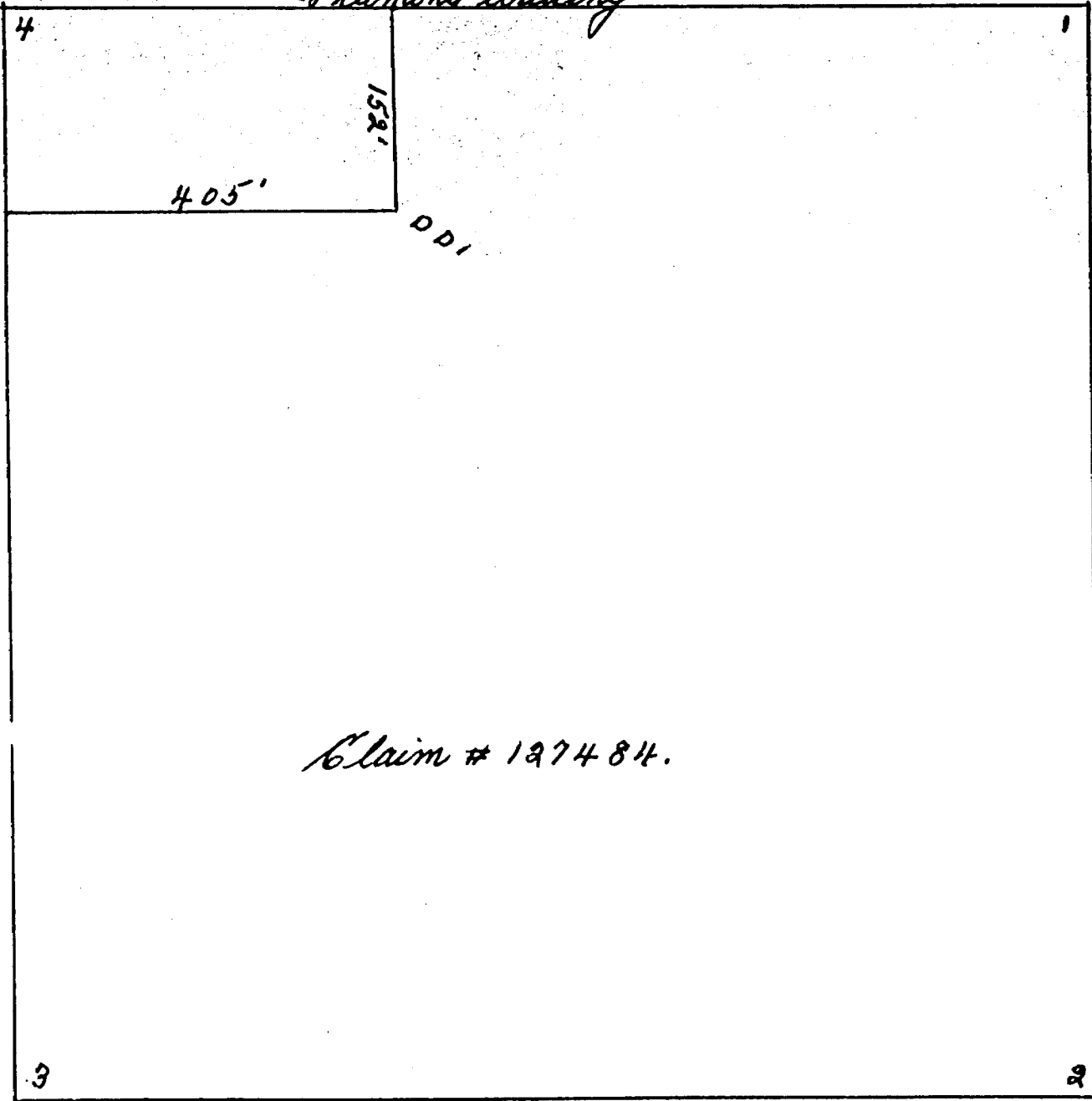

*Claim # 127484.*

# DIAMOND DRILL RECORD

Hole No. 2 Sheet No. 1

Property Mining Claim # 197484  
 Location Parkburg exp.  
 Latitude \_\_\_\_\_  
 Departure \_\_\_\_\_  
 Bearing \_\_\_\_\_

Dip 90 degrees

Elev. Collar \_\_\_\_\_  
 Datum \_\_\_\_\_  
 Date Started Sept. 1st 1965  
 Date Completed Sept. 4 1965  
 Drilled by Stanley Brennan  
 Logged by Stanley Brennan

Total Footage 103'

Footage		Formation	Sample Number	Sample Footage	Sample Width	Gold Sample	Gold Sludge	Remarks
From	To							
0	100'	<i>Greenstone, considerable quartz and mineralization.</i>						
100'	103'	<i>Greenstone, considerable mineralization and sparse quartz.</i>						

Date of Examination Sept. 4th 1965

Stanley Brennan

*Diamond drilling*

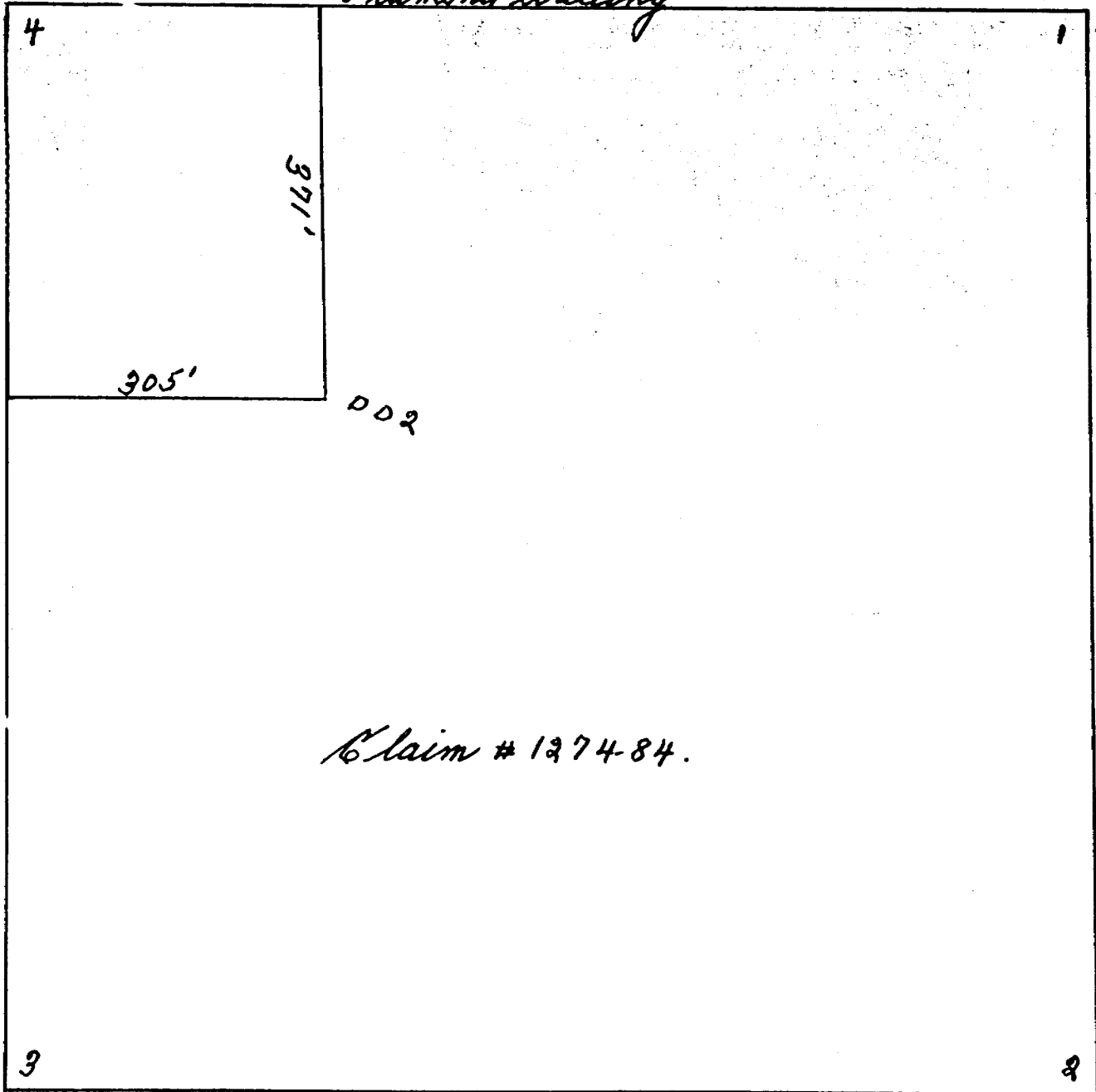

# DIAMOND DRILL RECORD

Hole No. 3. Sheet No. 2.

Property Mining claim # 127484  
 Location Parking trap.  
 Latitude \_\_\_\_\_  
 Departure \_\_\_\_\_  
 Bearing South.

Dip 45 degrees.

---

Total Footage 137'

Elev. Collar \_\_\_\_\_  
 Datum \_\_\_\_\_  
 Date Started Sept. 4<sup>th</sup> 1965.  
 Date Completed Sept. 13<sup>th</sup> 1965.  
 Drilled by Stanley Brennan  
 Logged by Stanley Brennan

Footage		Formation	Sample Number	Sample Footage	Sample Width	Gold Sample	Gold Sludge	Remarks
From	To							
0	60'	<u>Greenstone, considerable quartz and sparse mineralization.</u>						
60'	137'	<u>Greenstone, considerable quartz and mineralization.</u>						

Date of Examination Sept. 13<sup>th</sup> 1965.

Stanley Brennan.

*Diamond drilling:*

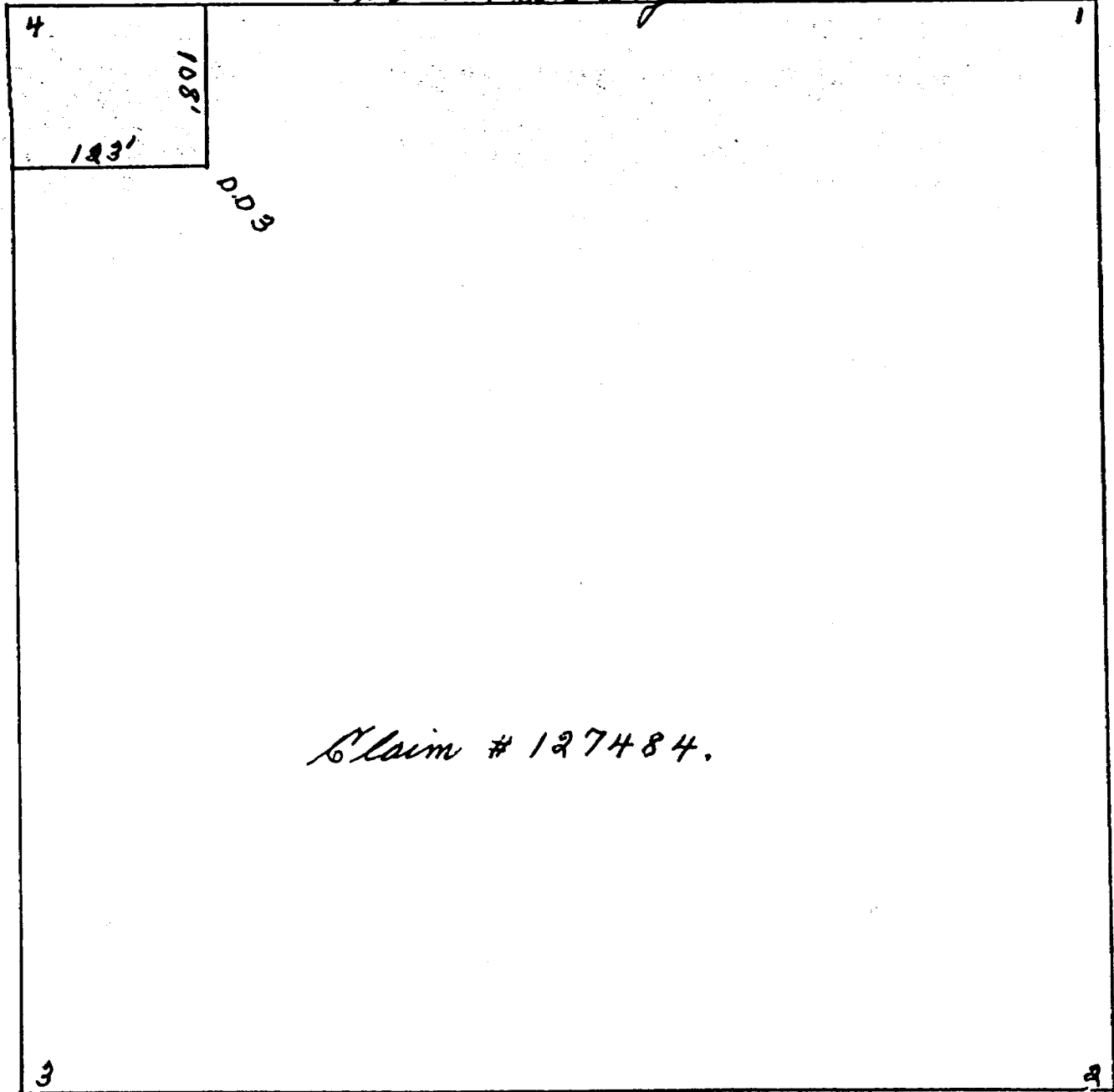

*Claim # 127484.*



411155W0128 0014D1 PARKIN

900

THE MINING ACT REPORT OF WORK

A separate form is required for each type of work to be recorded.

To the Recorder of Sudbury Mining Division  
I, Stanley Brennan C. 29280  
name of Recorded Holder Callander, Ontario Miner's Licence

R.R. 1, Callander, Ontario  
do hereby report the performance of 355 (355) Diamond drilling type of work

not before reported to be applied on the following contiguous claims

Claim No.	Days	Claim No.	Days
127397	30	127482	30
127398	30	127483	30
127399	30	127484	35
127400	30	127485	30
127480	30	131738	30
127481	30	131729	30

All the work was performed on Mining Claim (s) 127484 127484  
(In the case of geological and/or geophysical survey (s) where more than 18 claims are involved attach a schedule)

READ CAREFULLY: THE FOLLOWING INFORMATION IS REQUIRED BY THE MINING RECORDER

- For Manual Work, Stripping or Opening up of Mines, Sinking Shafts or Other Actual Mining Operations - Names and addresses of the men who performed the work and the dates and hours of their employment
- For Diamond and other Core Drilling - Footage, No. and angle of holes and diameter of core. Name and address of owner or operator of drill. Dates when drilling was done. Signed core log and sketch in duplicate.
- For Compressed Air or Other Power Driven or Mechanical Equipment - Type of drill or equipment. Names and addresses of men engaged in operating equipment and the dates and hours of their employment.
- For Power Stripping - Type of equipment, Name and address of owner or operator. Amount expended. Dates when work was done. Proof of actual cost must be submitted within 30 days of recording.
- With each of the above types of work sketches are required to show the location and extent of the work in relation to the nearest claim post. In the case of diamond or other core drilling the sketch must be submitted in duplicate.
- For Geological and Geophysical Survey - The names and addresses of men employed as well as dates. Type of instrument used in the case of geophysical survey. Reports and maps in duplicate must be filed with the Minister within 60 days of recording.
- For Land Survey - the name and address of Ontario Land surveyor.

The Required Information is as Follows: (Attach a list if this space is insufficient)

Packsack diamond drill, 7/8 inch core owned and operated by Stanley Brennan. Drilling done from Aug. 23<sup>rd</sup> to Sept 17<sup>th</sup> 1965. Men engaged:

<u>Stanley Brennan, Callander, Ont.</u>	<u>4-6 hr. days</u>
<u>Harold Barry, 217.5 Tasalle Pl. Sudbury, Ont.</u>	<u>4-6 hr. days</u>
<u>Fred Beauchamp, 11 Tandem rd, Gathert, Ont.</u>	<u>6-6 hr. days</u>
<u>Richard Paschamps, 1260 O. Gouguen St, Garrison Ont</u>	<u>4-6 hr. days</u>

Date Sept 17<sup>th</sup> 1965 Signature of Recorded Holder or Agent Stanley Brennan

The Mining Act Certificate Verifying Report of Work

I, Stanley Brennan  
R.R. 1, Callander, Ont.  
(Post Office Address)

- hereby certify:
- That I have a personal and intimate knowledge of the facts set forth in the report of work annexed hereto, having performed the work or witnessed same during and/or after its completion.
  - That the annexed report is true,

Dated Sept. 17<sup>th</sup> 1965 Signature Stanley Brennan  
S. BRENNAN

PARKIN TWP S. 127397/34

THE PENALTY FOR MAKING A FALSE STATEMENT IN THIS REPORT IS FINE OR IMPRISONMENT OR BOTH



Hutton Twp. M-944

Aylmer Twp. M-641

PARKIN TWP  
M-1049  
1" = 40 CHAINS  
(BRENNAN, STANLEY)

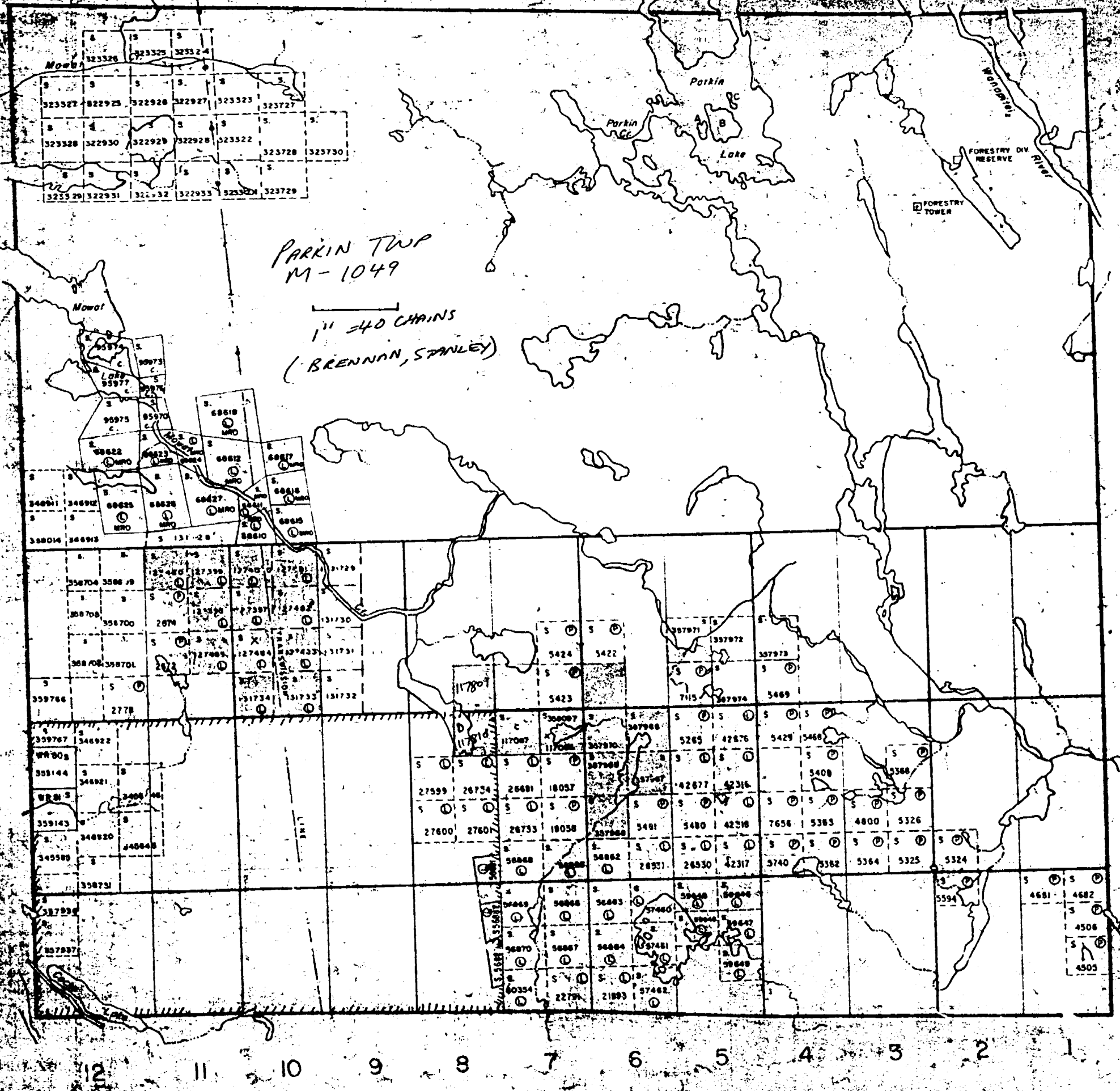

Norman Twp. M-1027