



41155W0142 2.10412 HUTTON

010

**WORK REPORT ON THE VERMILION RIVER  
PROPERTY**

**Hutton Township  
Sudbury District, Ontario**

**FOR THE PERIOD UP TO AND INCLUDING  
SEPTEMBER 30, 1987**

**OREVCO INC.**

**RECEIVED**

SEP 01 1987

**MINING LANDS SECTION**

**SUDBURY  
MINING DIV.  
RECEIVED**

SEP 10 1987

A.M. P.M.

7|8|9|10|11|12|1|2|3|4|5|6

## INTRODUCTION

The 30 claims forming the Vermilion River Property (Appendix A) were optioned from the original staker, Oliver Maki, in June 1987. The claims were optioned in order to assess the placer gold potential, as this area has been known to contain gold bearing gravels, sands and clays.

## WORK PERFORMED

This portion of the work program consisted of mapping and sampling for assay the western portion of the claim block. This mapping, performed on claims 894727, 894728, 943428, 943429 and 943430, is subsequent to and in addition to mapping done by Sandex Developments Ltd. in 1975, where all ground had not been covered. Work credits are being assigned through expenditure reporting, to claims 809450, 809451 and 864799.

## RESULTS and DISCUSSION

The resultant map shows small Pleistocene channel sequences, which have been assayed for gold and silver, and some for platinum. Traversing has identified topographical features which may be indicative of further possible channel sequences. Such features, over which past surveys have shown magnetic anomalies, may be candidates for vibracore drilling. A drilling program is anticipated to begin early this fall.

APPENDIX A  
(see attached map)

The Vermilion River property is comprised of the following 30 claims in Hutton, Parkin, Norman and Wisner Townships, Sudbury District, Ontario:

TOWNSHIP	CLAIM #
Hutton	864642
	864643
	864644
	864645
	864646
	864647
	894727
	894728
	894729
	943428
	943429
	943430
	515437
	809450
	809451
894736	
894737	
943431	
Parkin	894735
	894738
	894739
	894740
943432	
Norman	943427
	864799
	943463
Wisner	943464
	943461
Hutton	943462
	943433

VERMILION RIVER CLAIM BLOCK

OREVCO INC.

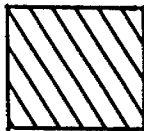
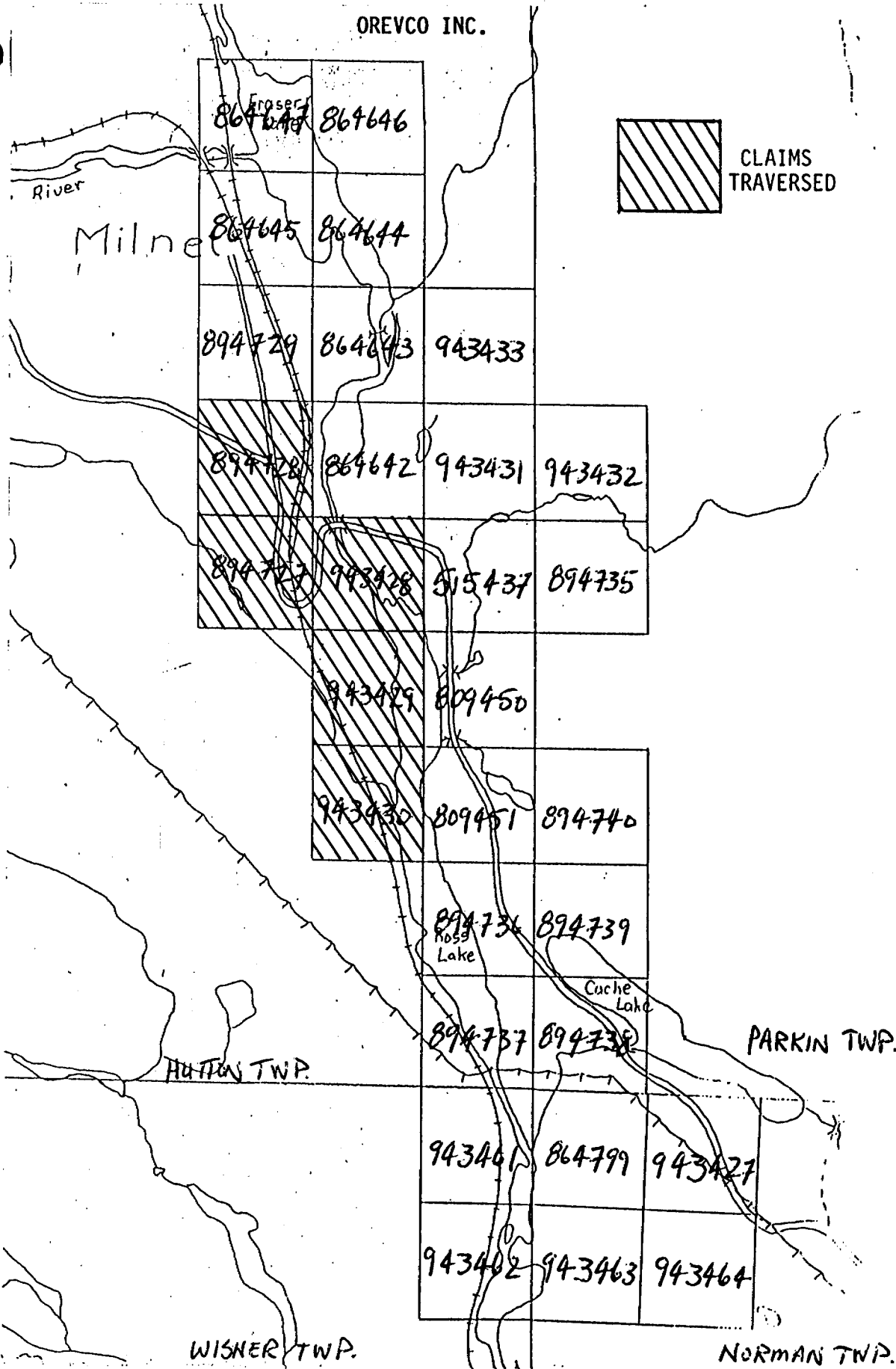

CLAIMS TRAVERSED

River

Milne

HUTTEN TWP.

PARKIN TWP.

WISNER TWP.

NORMAN TWP.

Ross Lake

Cache Lake

SAMPLE		CLAIM	POST	DISTANCE FROM POST (m)		ASSAY RESULTS
GROUP "A" SAMPLES						
VR-87	5-1	943428	4	E-0	S-52	
	5-2	943428	4	E-0	S-52	
	5-3a	943428	4	E-0	S-52	
	5-3b	943428	4	E-0	S-52	
	5-4a	943428	4	E-0	S-52	
	5-4b	943428	4	E-0	S-52	
	5-5	943428	4	E-0	S-52	
	5-6	943428	4	E-0	S-52	
	5-7	943428	4	E-0	S-52	
VR-87	P-1	943428	4	E-0	S-52	
	P-2	943428	4	E-0	S-52	
	P-3	943428	4	E-0	S-52	
	P-4	943428	4	E-0	S-52	
	P-5	943428	4	E-0	S-52	
	P-6	943428	4	E-0	S-52	
	P-7	943428	4	E-0	S-52	
	P-8	943428	4	E-0	S-52	
GROUP "B" SAMPLES						
VR-87	ST-1	943429	3	E-74	N-65	
	ST-2	943429	3	E-80	N-32	
	ST-3	943430	4	E-138	S-4	
	ST-4	943430	4	E-138	S-4	
	ST-6	943430	4	E-122	S-20	
	ST-7	943430	4	E-144	S-14	
	ST-8	943430	4	E-210	S-98	
	ST-9	943430	4	E-222	S-134	
	ST-10	943430	4	E-222	S-134	
	ST-11	943430	4	E-226	S-136	
VR-87	10-1	943429	4	E-74	S-166	

APPENDIX B - SAMPLE LOCATIONS

**CERTIFICATE OF ANALYSIS**

**FROM:** Orevco Incorporated,  
P.O. Box 2116,  
164 Sherbrooke Street,  
Peterborough, Ontario.  
K9J 7Y4

**Date:** Sept. 17, 1987  
**Received:** Sept. 10, 1987  
**Our Reference No.:** LR 8728117  
**Your Reference No.:** VR-87  
**Invoice No.:** 24881

Samples submitted to us show results as follows:

Sample No.	(g) Dry Weights	Ag, g/t	Au, g/t	Pt, g/t
VR87 P-1	19.9	4.3	0.94	-
P-2	12.8	6.0	0.82	-
P-3	17.0	<2.0	0.07	-
P-4	22.8	<2.0	0.08	-
P-5	25.9	<2.0	0.04	-
P-6	30.0	<2.0	0.07	-
P-7	102.0	<2.0	0.05	-
P-8	32.0	<2.0	0.05	-
10-1	401.0	2.5	0.02	-
5-1	46.0	<2.0	0.33	-
5-2	5.8	<2.0	2.68	<0.02
5-3A	12.2	<2.0	0.64	-
5-3B	3.4	<2.0	0.25	-
5-4A	8.4	<2.0	0.09	<0.02
5-4B	7.4	22.8	0.39	<0.02
5-5	6.7	<2.0	1.15	-
5-6	8.8	<2.0	0.38	<0.02
5-7	10.9	<2.0	0.76	-
ST-1	14.7	<2.0	0.07	-
ST-2	3.0	<2.0	3.65	<0.02
ST-3	30.6	<2.0	0.03	-
ST-4	7.0	3.5	0.07	-
ST-6	17.6	<2.0	0.05	-
ST-7	11.5	<2.0	0.14	-
ST-8	10.4	<2.0	0.13	-
ST-9	9.2	<2.0	<0.02	-
ST-10	18.1	<2.0	0.12	-
St-11	8.8	<2.0	0.45	-

To: K. Wait

SIGNED *A. E. Carr*  
MANAGER  
A. E. Carr, Manager - Assay Services

NOTE: Rejects will be discarded after 6 months.



411155W0142 2.10412 HUTTON

900

November 23, 1987

Your File: 79  
Our File: 2.10412

Mining Recorder  
Ministry of Northern Development and Mines  
199 Larch Street  
Sudbury, Ontario  
P3E 5P9

Dear Sir:

Re: Notice of Intent dated November 17, 1987  
Date for Assaying submitted on Mining Claims  
S 894727 et al in Hutton Township

---

Please disregard the above-mentioned Notice of Intent. The file has been reassessed and credits granted as recorded.

Please inform the recorded holder of these mining claims and so indicated on your records.

Yours sincerely,

W.R. Cowan, Manager  
Mining Lands Section  
Mines & Minerals Division

Whitney Block, Room 6610  
Queen's Park  
Toronto, Ontario  
M7A 1W3

Telephone: (416) 965-4888

SH:pl  
Enclosure

cc: Orevco Inc.  
P.O. Box 2116  
164 Sherbrooke St.  
Peterborough, Ontario  
K9J 7Y4

Mr. Kemp Wait  
531 King St.  
Peterborough, Ontario  
K9J 2T4

Mr. Rick Gagne  
308 Stewart St.  
Peterborough, Ontario  
K9J 3N1

Mr. G.H. Ferguson  
Mining & Lands Commissioner  
Toronto, Ontario

Resident Geologist  
Sudbury, Ontario



Ministry of  
Northern Development  
Mines

*Norman & Hudson Turso*

Report of Work # 87-79  
(Geophysical, Geological,  
Geochemical and Expenditures)

Instructions: - Please type or print.  
- If number of mining claims traversed exceeds space on this form, attach a list.  
Note: - Only days credits calculated in the "Expenditures" section may be entered in the "Expend. Days Cr." columns.  
- Do not use shaded areas below.

File: S. 809450

Mining Act 2.10412

Type of Survey(s)		Township or Area <b>HUTTON</b>	
Claim Holder(s) <b>OREVCO INC.</b>		Prospector's Licence No. <b>t 4948</b>	
Address <b>P.O. Box 2116 164 Sherbrooke St. Peterborough, Ontario K9J 7Y4</b>			
Survey Company <b>Same as above</b>	Date of Survey (from & to) Day   Mo.   Yr.   Day   Mo.   Yr.		Total Miles of line Cut
Name and Address of Author (of Geo-Technical report) <b>Rick Gagné 308 Stewart St. Peterborough, Ontario K9J 3M1</b>			

Credits Requested per Each Claim in Columns at right			Mining Claims Traversed (List in numerical sequence)		
Special Provisions	Geophysical	Days per Claim	Mining Claim		Expend. Days Cr.
			Prefix	Number	
For first survey: Enter 40 days. (This includes line cutting)	- Electromagnetic			864799	20
	- Magnetometer			809450	42
	- Radiometric				
	- Other				
For each additional survey: using the same grid: Enter 20 days (for each)	Geological				
	Geochemical				
Man Days Complete reverse side and enter total(s) here	Geophysical	Days per Claim	Mining Claim		Expend. Days Cr.
			Prefix	Number	
	- Electromagnetic				
	- Magnetometer				
	- Radiometric				
	- Other				
	Geological				
	Geochemical				
Airborne Credits Note: Special provisions credits do not apply to Airborne Surveys.	Electromagnetic	Days per Claim	Mining Claim		Expend. Days Cr.
			Prefix	Number	
	Magnetometer				
	Radiometric				

SUBBURY MINING DIV. RECEIVED  
SEP 16 1987

RECEIVED

SEP 01 1987

Total number of mining claims covered by this report of work. **2**

Expenditures (excludes power stripping)

Type of Work Performed  
**ASSAYS and Sample Prep.**

Performed on Claim(s)  
**894727, 894728, 943428, 943429, 943430**

Calculation of Expenditure Days Credits		Total Days Credits
Total Expenditures		
\$ 933.50	+ 15 =	62

Instructions  
Total Days Credits may be apportioned at the claim holder's choice. Enter number of days credits per claim selected in columns at right.

Date **87 09 17** Recorded by Agent (Signature) *[Signature]*

For MINING CLAIMS SECTION

Total Days Cr. Recorded	Date Recorded	Mining Recorder
<b>62</b>	<b>1987 09 28</b>	<i>V.C. Miller</i>
Date Approved as Recorded		Branch Director
<i>See Revised Statement</i>		<i>[Signature]</i>

Certification Verifying Report of Work

I hereby certify that I have a personal and intimate knowledge of the facts set forth in the Report of Work annexed hereto, having performed the work or witnessed same during and/or after its completion and the annexed report is true.

Name and Postal Address of Person Certifying  
**Kemp Wait 531 King St. Peterborough, Ontario K9J 2T4**

Date Certified **87 09 17** Certified by (Signature) *[Signature]*



CREELMAN TWP. M.737

THE TOWNSHIP OF  
OF  
**HUTTON**

DISTRICT OF  
SUDBURY

'SUDBURY'  
MINING DIVISION

SCALE: 1-INCH=40 CHAINS

LEGEND

- |                       |        |
|-----------------------|--------|
| PATENTED LAND         | ● or ⊕ |
| CROWN LAND SALE       | C.S.   |
| LEASES                | ⊙      |
| LOCATED LAND          | L.C.   |
| LICENSE OF OCCUPATION | L.O.   |
| MINING RIGHTS ONLY    | M.R.O. |
| SURFACE RIGHTS ONLY   | S.R.O. |
| ROADS                 | —      |
| IMPROVED ROADS        | —      |
| KING'S HIGHWAYS       | —      |
| RAILWAYS              | —      |
| POWER LINES           | —      |
| MARSH OR MUSKEG       | —      |
| MINES                 | —      |
| CANCELLED             | —      |

NOTES

400' Surface Rights Reservation plan, the shares of all lakes and rivers.

Lots 1 to 6, concessions 1 to 6 may be staked in the same manner as mining claims in unsurveyed territory. May 16, 1946 - File 83.5 - Mining Act Sec. 63 (52 A 1946). K. 30 1910

Land required for railway purposes shown thus: Files 4826 & 4841.

Parts of Con. 1, 2, 4, 5 & 6: Subdivision Annulled.

SAND AND GRAVEL

⊙ QUARRY PERMIT

PLAN NO. **M-944**

ONTARIO

MINISTRY OF NATURAL RESOURCES

SURVEYS AND MAPPING BRANCH

KITCHENER TWP. M.973

PARKIN TWP. M.1049

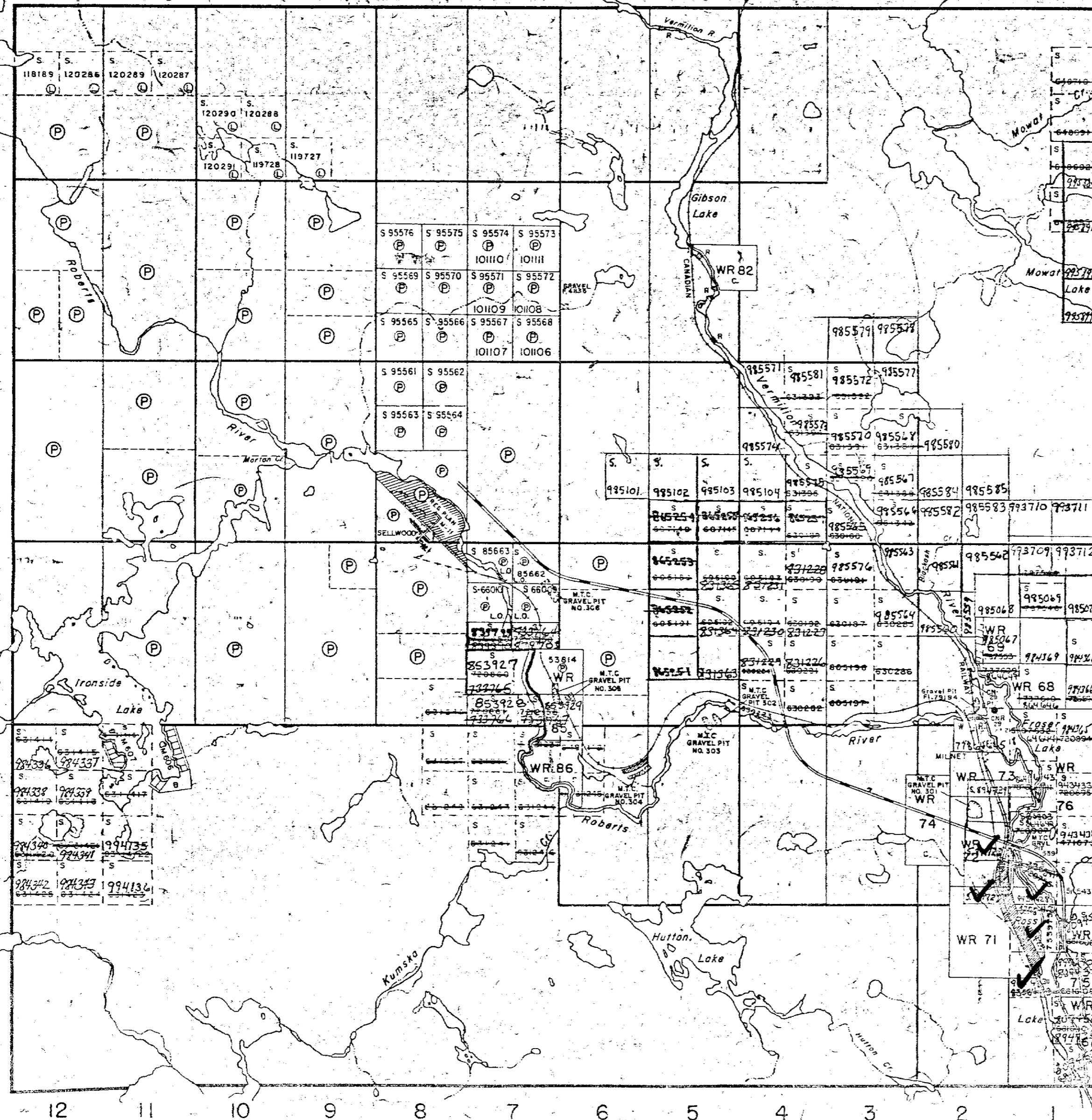

4111550142 2.10412 HUTTON

WISNER TWP. M.1185

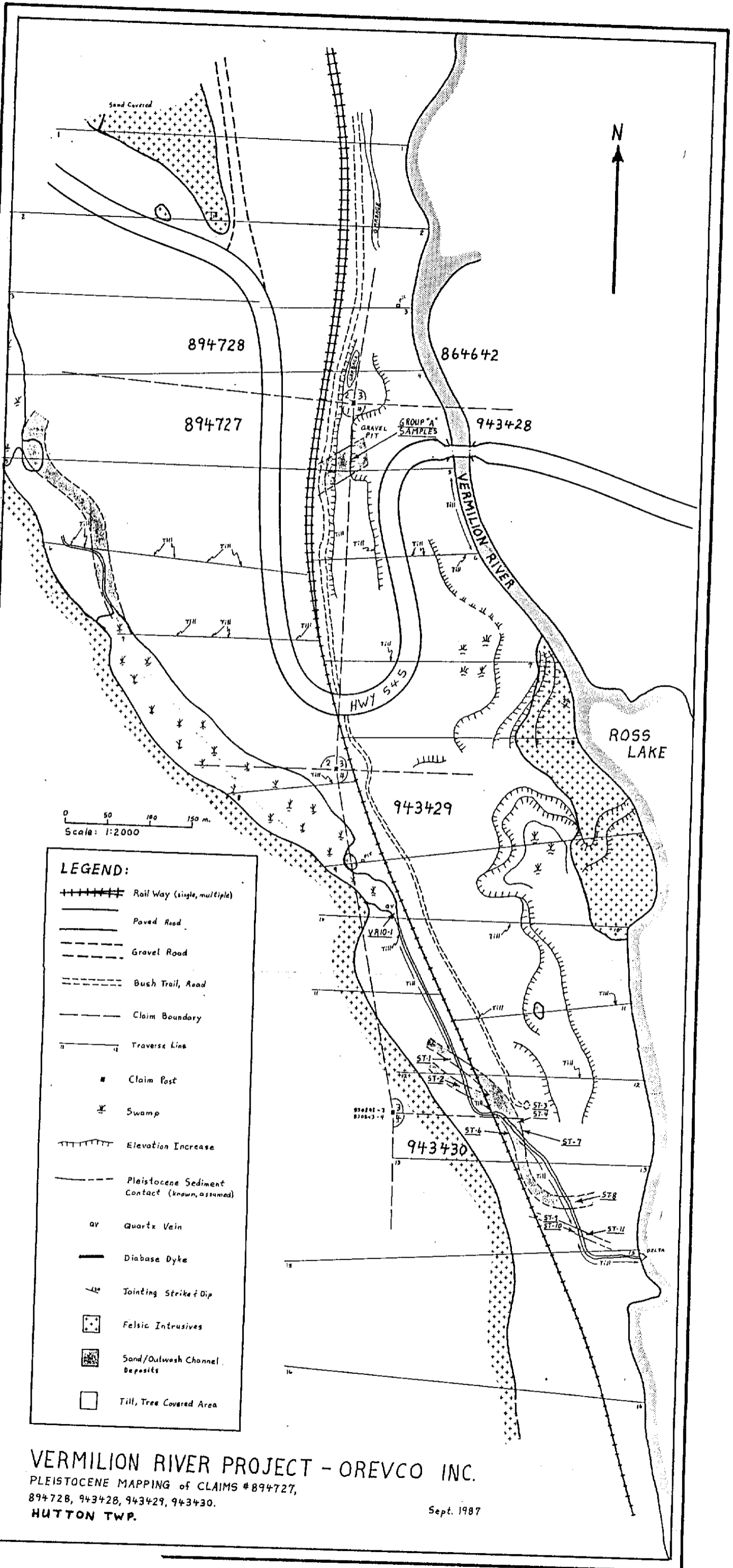

- LEGEND:**
- +++++ Rail Way (single, multiple)
  - Paved Road
  - Gravel Road
  - Bush Trail, Road
  - Claim Boundary
  - ||—||— Traverse Line
  - Claim Post
  - ⊗ Swamp
  - ~~~~~ Elevation Increase
  - Pleistocene Sediment Contact (known, assumed)
  - qv Quartz Vein
  - Diabase Dyke
  - ↘ Jointing Strike & Dip
  - Felsic Intrusives
  - Sand/Oulwash Channel Deposits
  - Till, Tree Covered Area

**VERMILION RIVER PROJECT - OREVCO INC.**  
 PLEISTOCENE MAPPING of CLAIMS #894727,  
 894728, 943428, 943429, 943430.  
 HUTTON TWP. Sept. 1987

