

471673

#4 POST

N  
↑



010

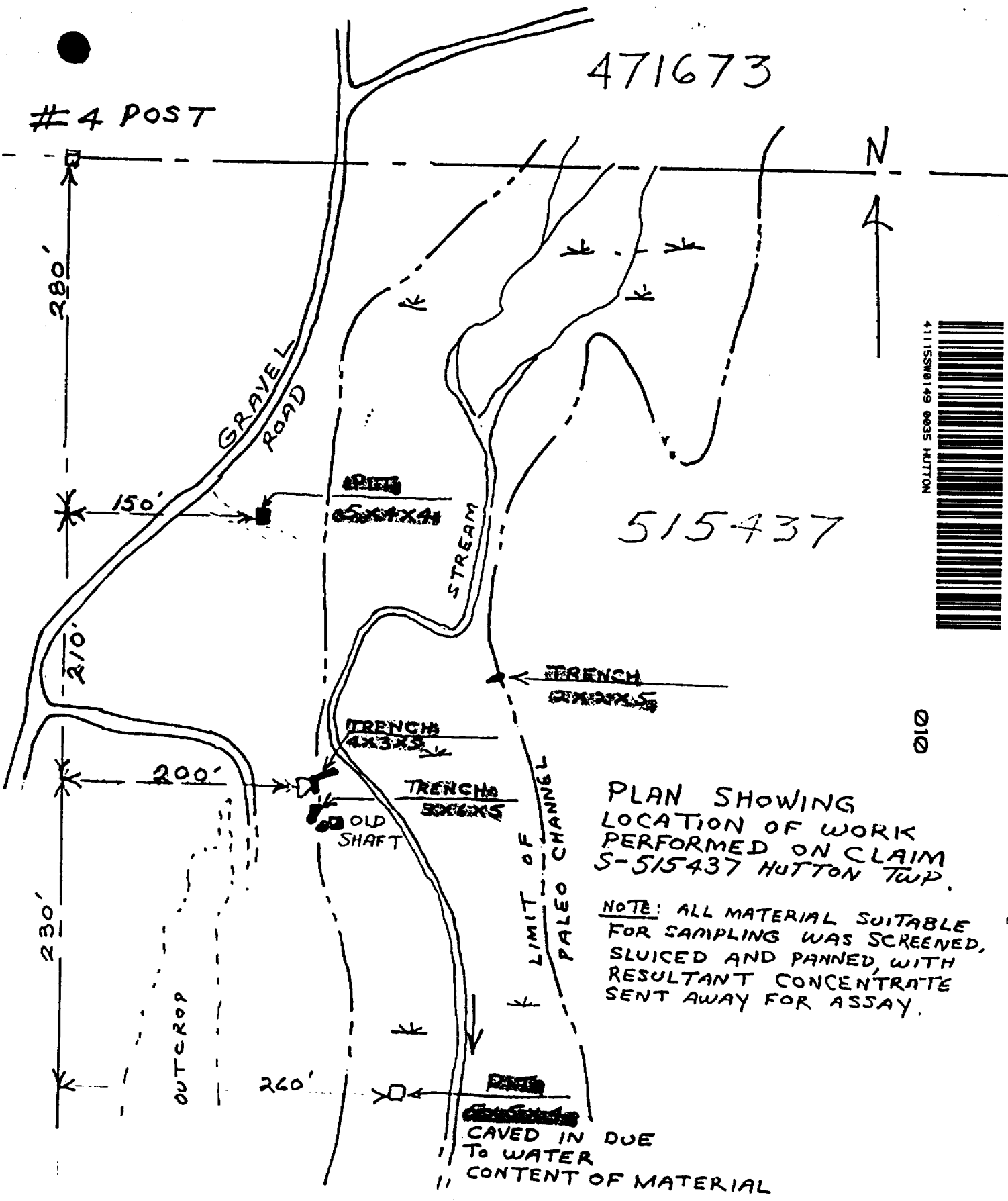

515437

PLAN SHOWING  
LOCATION OF WORK  
PERFORMED ON CLAIM  
S-515437 HUTTON TWP.

NOTE: ALL MATERIAL SUITABLE  
FOR SAMPLING WAS SCREENED,  
SLICED AND PANNED, WITH  
RESULTANT CONCENTRATE  
SENT AWAY FOR ASSAY.

CAVED IN DUE  
TO WATER  
CONTENT OF MATERIAL

SCALE 1 INCH = 100 FEET.  
1" = 100 FT

27 AUG/82.



ROUYN, QUE. July 20, 1982

**CERTIFICATE OF ANALYSIS**

Received from: Oliver T. Maki  
 Reçu de: \_\_\_\_\_

Date Received: July 19, 1982  
 Reçu le: \_\_\_\_\_

Samples of: Sample No. 2-82  
 Echantillons de: \_\_\_\_\_

Identification: Lab. No. 20611  
 \_\_\_\_\_

Gold ----- 146.02 milligrams

Note: Above gold obtained from sluicing and panning approx. 0.5 cubic yards of material. Due to high water velocity from pump used, the recovery is probably about 65%.

Grade:  $\frac{0.146}{31.1} \times \frac{1}{0.5} = 0.009$  or say 0.01 ounces/ cubic yard.

Assuming a recovery of 65% the heads would be 0.015 oz/yd<sup>3</sup>.

With a 90% recovery of values, the recoverable grade would be ~~0.014 ounces/cubic yard~~ **recoverable grade**

With gold at \$350/oz U.S. the recoverable value per cubic yard would be \$6.37 Canadian. (\$1 Can = \$0.80 U.S.)

OTM

**ASSAYERS LIMITED**

PER PAR 1.0000

ASSAYERS - SHIPPERS' REPRESENTATIVES - CONSULTANTS

"AU SERVICE DE L'INDUSTRIE DEPUIS PLUS DE 40 ANS"

"SERVING INDUSTRY FOR OVER 40 YEARS"



**ASSAYERS  
LIMITED**

QUEBEC: 183 GAMBLE ST. W., P.O. BOX 665, ROUYN, J9X 2R8, TEL: 819-762-3010

ONTARIO: 20 VICTORIA STREET, SUITE 506, TORONTO, M5C 2N8, TEL: 416-366-3100

VENDU A  
SOLO TO

Oliver T. Maki  
1801 Lamothe Street  
Sudbury, Ontario  
P3A 2J9

A  
T  
O  
C  
O  
M  
P  
A  
N  
Y

| DATE                 | TRANSPORTEUR<br>SHIP PED VIA | NO D'EXEMPT DE TAXE FED<br>FED LICENCE NO | NO D'EXEMPT DE TAXE PROV<br>PROV. LICENCE NO | VOTRE NO DE COMMANDE<br>YOUR ORDER NO | NOTRE NO DE COMMANDE<br>OUR ORDER NO | CONDITIONS<br>TERMS         | VENDEUR<br>SALESMAN |
|----------------------|------------------------------|---|--|---------------------------------------|--------------------------------------|-----------------------------|---------------------|
| July 20/82           |                              |   |  |                                       |                                      | 30 days                     |                     |
| QUANTITE<br>QUANTITY | DESCRIPTION                  |   |  |                                       |                                      | PRIX UNITAIRE<br>UNIT PRICE | MONTANT<br>AMOUNT   |
| 1                    | assay for Au                 |   |  |                                       |                                      | 8.00                        | \$8.00              |

SPEEDSET MOORE BUSINESS FORMS 3 70008

ESTD 1942 CTA

FACTURE/INVOICE

"SERVING INDUSTRY FOR OVER 40 YEARS"





ROUYN, QUE. July 12, 1982

### CERTIFICATE OF ANALYSIS

Received from: Mr. Oliver T. Maki  
 Reçu de: \_\_\_\_\_

Date Received: July 1982  
 Reçu le: \_\_\_\_\_

Samples of: 1-82  
 Echantillons de: \_\_\_\_\_

Identification: Lab no. 27,778

|              |                 |
|--------------|-----------------|
| Total Gold   | 8.08 milligrams |
| Total Silver | 1.49 milligrams |

Note: Above metal obtained from sluicing and panning  
 0.015 cubic metres of material. Purity of gold  
 approximately 85%. Recovery possibly 75% to 80%.

8.08 milligrams Au. from 0.015 cubic metres =  
 $8.08 : 0.015 = 538.66$  milligrams/ cubic metre.

$538.66 \text{ mg/m}^3 = 0.53866 \text{ grams/m}^3$

$0.538 \text{ grams/m}^3 = 0.017 \text{ Ounces/m}^3$

$0.017 \text{ ounces/m}^3 = 0.017 \times 77 = 1.309 \text{ ounces/yd}^3$

*O.T.M.*

ASSAYERS LIMITED

PER  
PAR

*[Signature]*

ASSAYERS - SHIPPERS' REPRESENTATIVES - CONSULTANTS

"AU SERVICE DE L'INDUSTRIE DEPUIS PLUS DE 40 ANS"

"SERVING INDUSTRY FOR OVER 40 YEARS"

ANALYTICAL CHEMISTS — ASSAYERS — SHIPPER'S REPRESENTATIVES — CONSULTANTS

10319



**ASSAYERS  
LIMITED**

QUEBEC: 183 GAMBLE ST. W., P.O. BOX 665, ROUYN, J9X 2R8, TEL: 819-762-3010

ONTARIO: 20 VICTORIA STREET, SUITE 506, TORONTO, M5C 2N8, TEL: 416-366-3100

VENDEU A  
SOLD TO

Mr. Oliver T. Hald  
1801 Lamothe Street  
Sudbury, Ontario  
P3A 2J9

A  
R  
D  
E  
R  
N  
O  
1  
0

| DATE                 | TRANSPORTEUR<br>SHIPPED VIA | NO D'EXEMPT DE TAXE FED<br>FED LICENCE NO | NO D'EXEMPT DE TAXE PROV<br>PROV LICENCE NO | VOTRE NO DE COMMANDE<br>YOUR ORDER NO | NOTRE NO DE COMMANDE<br>OUR ORDER NO | CONDITIONS<br>TERMS         | VENDEUR<br>SALESMAN |
|----------------------|-----------------------------|---|---|---------------------------------------|--------------------------------------|-----------------------------|---------------------|
| July 12/82           |                             |   |   |                                       |                                      | 30 days                     |                     |
| QUANTITE<br>QUANTITY | DESCRIPTION                 |   |   |                                       |                                      | PRIX UNITAIRE<br>UNIT PRICE | MONTANT<br>AMOUNT   |
| 1                    | assay for gold & silver     |   |   |                                       |                                      | 16.00                       | \$16.00             |

SPEEDSET MOORE BUSINESS FORMS 3 7060B

FACTURE/INVOICE

"SERVING INDUSTRY FOR OVER 40 YEARS"





**ASSAYERS  
LIMITED**

QUEBEC: 183 GAMBLE ST. W., P.O. BOX 665, ROUYN, J9X 2R8, TEL: 819-762-3010  
 ONTARIO: 20 VICTORIA STREET, SUITE 506, TORONTO, M5C 2N8, TEL: 416-366-3100

VENDU A  
SOLO TO

Mr. Oliver T. Maki  
 1801 Lamothe Street  
 Sudbury, Ontario  
 P3A 2J9

SHIPPED TO

| DATE                 | TRANSPORTEUR<br>SHIPPED VIA  | NO D'EXEMPT DE TAXE FED<br>FED LICENCE NO | NO D'EXEMPT DE TAXE PROV<br>PROV LICENCE NO | VOTRE NO DE COMMANDE<br>YOUR ORDER NO | NOTRE NO DE COMMANDE<br>OUR ORDER NO | CONDITIONS<br>TERMS         | VENDEUR<br>SALESMAN |
|----------------------|------------------------------|---|---|---------------------------------------|--------------------------------------|-----------------------------|---------------------|
| August 19, 1981      |                              |   |   |                                       |                                      | 30 days                     |                     |
| QUANTITE<br>QUANTITY | DESCRIPTION                  |   |   |                                       |                                      | PRIX UNITAIRE<br>UNIT PRICE | MONTANT<br>AMOUNT   |
| 7                    | assays for Au                |   |   |                                       |                                      | 7.25                        | 50.75               |
|                      | Handling charge on 7 samples |   |   |                                       |                                      | 2.50                        | <u>17.50</u>        |
|                      |                              |   |   |                                       |                                      |                             | \$68.25             |

*pd by cheque  
Aug 25/81*

SPEEDSET MOORE BUSINESS FORMS 3 7040B

FACTURE/INVOICE

"SERVING INDUSTRY FOR OVER 40 YEARS"





4115SW0149 0035 HUTTON

900



Ministry of Natural Resources

Report of Work (Geophysical, Geological, Geochemical and Expenditures)

Instructions: - Please type or print. - If number of mining claims traversed exceeds space on this form, attach a list. Note: - Only days credits calculated in the "Expenditures" section may be entered in the "Expend. Days Cr." columns. - Do not use shaded areas below.

The Mining Act

Form with fields: Type of Survey(s) Expenditures for assays, Claim Holder(s) Oliver T. Maki, Address 1801 Lamothe Street, Sudbury, Ontario. P3A 2J9, Survey Company, Date of Survey, Total Miles of line Cut, Name and Address of Author.

Table with 3 columns: Special Provisions, Geophysical, Geological, Geochemical, Days per Claim. Includes rows for first survey, additional surveys, man days, and airborne credits.

Table with 3 columns: Mining Claim Prefix, Mining Claim Number, Expend. Days Cr. Includes handwritten entry: S 515437 5.6 and a large handwritten note: Reports & Map Attached.

Form with fields: Expenditures (excludes power stripping), Type of Work Performed Assaying, Performed on Claim(s) S 515437, Calculation of Expenditure Days Credits: \$84.25 + 15 = 5.6.

Form with fields: For Office Use Only, Total Days Cr. Recorded 5.6, Date Recorded Sept. 3/82, Mining Recorder J.C. Miller, Date Approved as Recorded.

Form with fields: Date 27 Aug/82, Recorded Holder or Agent (Signature) Oliver T. Maki.

Certification Verifying Report of Work. I hereby certify that I have a personal and intimate knowledge of the facts set forth in the Report of Work annexed hereto... Name and Postal Address of Person Certifying: Oliver T. Maki, 1801 Lamothe Street, Sudbury, Ont. P3A 2J9. Date Certified: 27 Aug /82. Certified by (Signature): Oliver T. Maki.



Ministry of  
Natural  
Resources

Geotechnical  
Report  
Approval

File **2.5044**

*Jan 10/83*

Mining Lands Comments

|                             |
|-----------------------------|
| <i>- no cheque receipts</i> |
|                             |
|                             |
|                             |
|                             |
|                             |
|                             |
|                             |

To: Geophysics

|          |
|----------|
| Comments |
|          |
|          |
|          |
|          |
|          |
|          |

|                                   |   |      |           |
|-----------------------------------|---|------|-----------|
| <input type="checkbox"/> Approved | <input type="checkbox"/> Wish to see again with corrections | Date | Signature |
|-----------------------------------|---|------|-----------|

To: Geology - Expenditures *MR. Kustera*

|          |
|----------|
| Comments |
|          |
|          |
|          |
|          |
|          |
|          |

|  |   |                       |                             |
|--|---|-----------------------|-----------------------------|
| <input checked="" type="checkbox"/> Approved | <input type="checkbox"/> Wish to see again with corrections | Date <i>Jan 25/83</i> | Signature <i>C. Kustera</i> |
|--|---|-----------------------|-----------------------------|

To: Geochemistry

|          |
|----------|
| Comments |
|          |
|          |
|          |
|          |
|          |
|          |

*LD*

|                                   |   |      |           |
|-----------------------------------|---|------|-----------|
| <input type="checkbox"/> Approved | <input type="checkbox"/> Wish to see again with corrections | Date | Signature |
|-----------------------------------|---|------|-----------|

To: Mining Lands Section, Room 6462, Whitney Block. (Tel: 5-1380)



1982 10 01

2.5044

Mining Recorder  
Ministry of Natural Resources  
199 Larch Street  
Sudbury, Ontario  
P3E 5P9

Dear Sir:

We have received data for assaying submitted under  
Section 77/19 of the Mining Act R.S.O. 1980 on  
Mining Claim S 515437 in the Township of Hutton.

This material will be examined and assessed and a  
statement of assessment work credits will be  
issued.

Yours very truly,

E.F. Anderson  
Director  
Land Management Branch

Whitney Block, Room 6450  
Queen's Park  
Toronto, Ontario  
M7A 1W3  
Phone 416/965-1316

J. Skura:sc

cc: Oliver T. Maki  
Sudbury, Ontario

1983 08 02

2.5044

Mining Recorder  
Ministry of Natural Resources  
199 Larch Street  
Sudbury, Ontario  
P3E 5P9

Dear Sir:

Mr. Oliver T. Maki recorded 56 days assessment work credits on Mining Claim S515437 in the Township of Hutton on September 3, 1982.

He does not wish to continue with this submission.

You are hereby authorized to delete the work credits recorded on September 3, 1982 from claim record sheet. Please inform the recorded holder accordingly.

Yours very truly,

E.F. Anderson  
Director  
Land Management Branch

Whitney Block, Room 6450  
Queen's Park  
Toronto, Ontario  
M7A 1W3  
Phone: 416/965-1380

A. Barr:sc

cc: Mr. O.J. Maki  
Sudbury, Ontario

Ministry of Natural Resources  
RECEIVED

MAY 4 1983

NORTHEASTERN REGION

1983 05 02

2.5044

Resident Geologist  
Ministry of Natural Resources  
199 Larch Street  
10th Floor  
Sudbury, Ontario  
P3E 5P9

Dear Sir:

RE: Data for Assaying submitted on Mining Claim  
S. 515437 in the Township of Hutton

---

Further to my letter of October 1, 1982 which acknowledged receipt of the above data, Mr. Maki has requested that the credits be cancelled.

Enclosed is a copy of the data for your information.

Yours very truly,

E.F. Anderson  
Director  
Land Management Branch

Whitney Block, Room 6450  
Queen's Park  
Toronto, Ontario  
M7A 1W3  
Phone: 416/965-1380

A. Barr:sc

Encls:

cc: Mr. O.T. Maki  
Sudbury, Ontario

cc: Mining Recorder  
Sudbury, Ontario

*Y call Mr Barr  
tell him we have  
received the data*

1801 Lamothe Street,  
Sudbury, Ontario P3A 2J9,  
6 April 1983.

Mr. E. F. Anderson, Director,  
Land Management Branch,  
Whitney Block, Room #6450,  
Quenn's Park,  
Toronto, Ontario.  
M7A 1W3.

Dear Mr. Mathews:

Re: Your letter 1983 03 31 with respect to  
to assaying submitted for assessment work  
credits on Claim S 515437 Hutton Twp.

The cancelled cheques for verification of  
the expenditures of \$84.25 are available, however, subsequent  
work with a back hoe was applied which was more than adequate  
to cover the balance of assessment work requirements. There is  
a credit of 153 days of work performed on this claim.

Therefore, the submissal of the above assay  
charges for assessment credit would be redundant at this date  
and I would prefer to cancel that portion of the filing.

Yours truly,

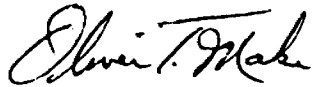

Oliver T. Maki.

|                        |                                     |
|------------------------|-------------------------------------|
| <b>RECEIVED</b>        |                                     |
| Land Management Branch |                                     |
| DATE                   | <input checked="" type="checkbox"/> |
| DEPARTS PLEASE         | <input type="checkbox"/>            |
| APR 11 1983            |                                     |
| E. F. ANDERSON         |                                     |
| J. R. BURTON           |                                     |
| J. C. SMITH            |                                     |
| G. SHERMAN             |                                     |
| J. M. SMITH            |                                     |
| RETURN TO R.6450       |                                     |

# HUTTON

DISTRICT OF  
SUDBURY

1" = 40 chains  
SUDBURY  
MINING DIVISION

SCALE: 1-INCH=40 CHAINS

## LEGEND

|                       |        |
|-----------------------|--------|
| PATENTED LAND         | ● or ⊙ |
| CROWN LAND SALE       | C.S.   |
| LEASES                | ⊙      |
| LOCATED LAND          | Loc.   |
| LICENSE OF OCCUPATION | L.O.   |
| MINING RIGHTS ONLY    | M.R.O. |
| SURFACE RIGHTS ONLY   | S.R.O. |
| ROADS                 | —      |
| IMPROVED ROADS        | —      |
| KING'S HIGHWAYS       | —      |
| RAILWAYS              | —      |
| POWER LINES           | —      |
| MARSH OR MUSKEG       | —      |
| MINES                 | ⊙      |
| CANCELLED             | ⊙      |

## NOTES

400' Surface Rights Reservation along the shores of all lakes and rivers.

Lots 1 to 6, concessions 1 to 6 may be staked in the same manner as mining claims in unsurveyed territory. May 16, 1946 - File 83.5 - Mining Act Sec. 53 (52A 1946).

Land required for railway purposes shown thus:   
Files 4826 & 4841.

Parts of this plan are subject to the provisions of the Mining Act, 1946, and the Mining Division Annulling.

DATE OF ISSUE

FEB - 1 1983

Ministry of Natural Resources  
SARANTO AND GRAVEL  
TORONTO

Ⓢ QUARRY PERMIT

PLAN NO. - M-944

PARKIN TWP. M.1049

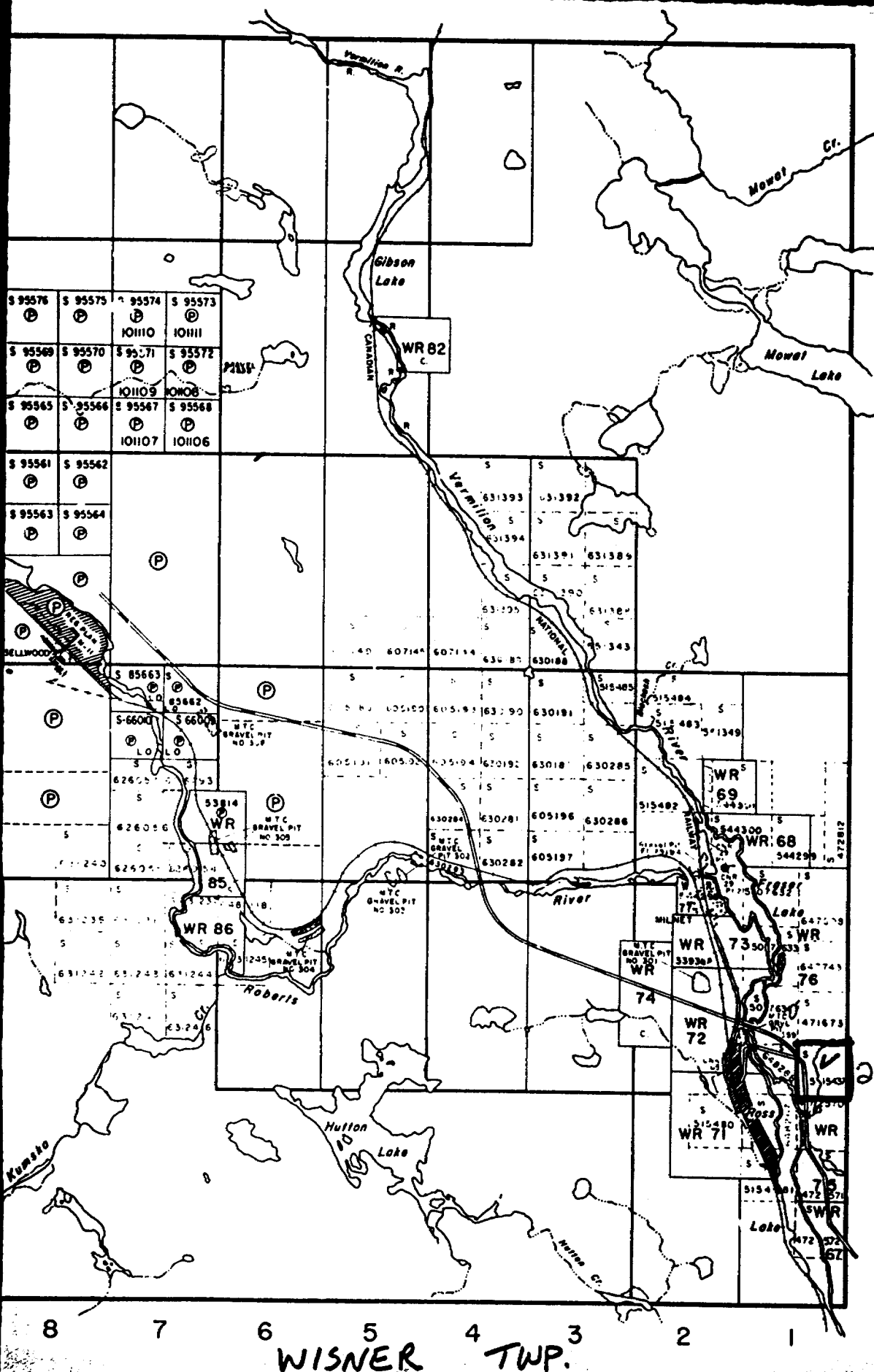

WISNER TWP.

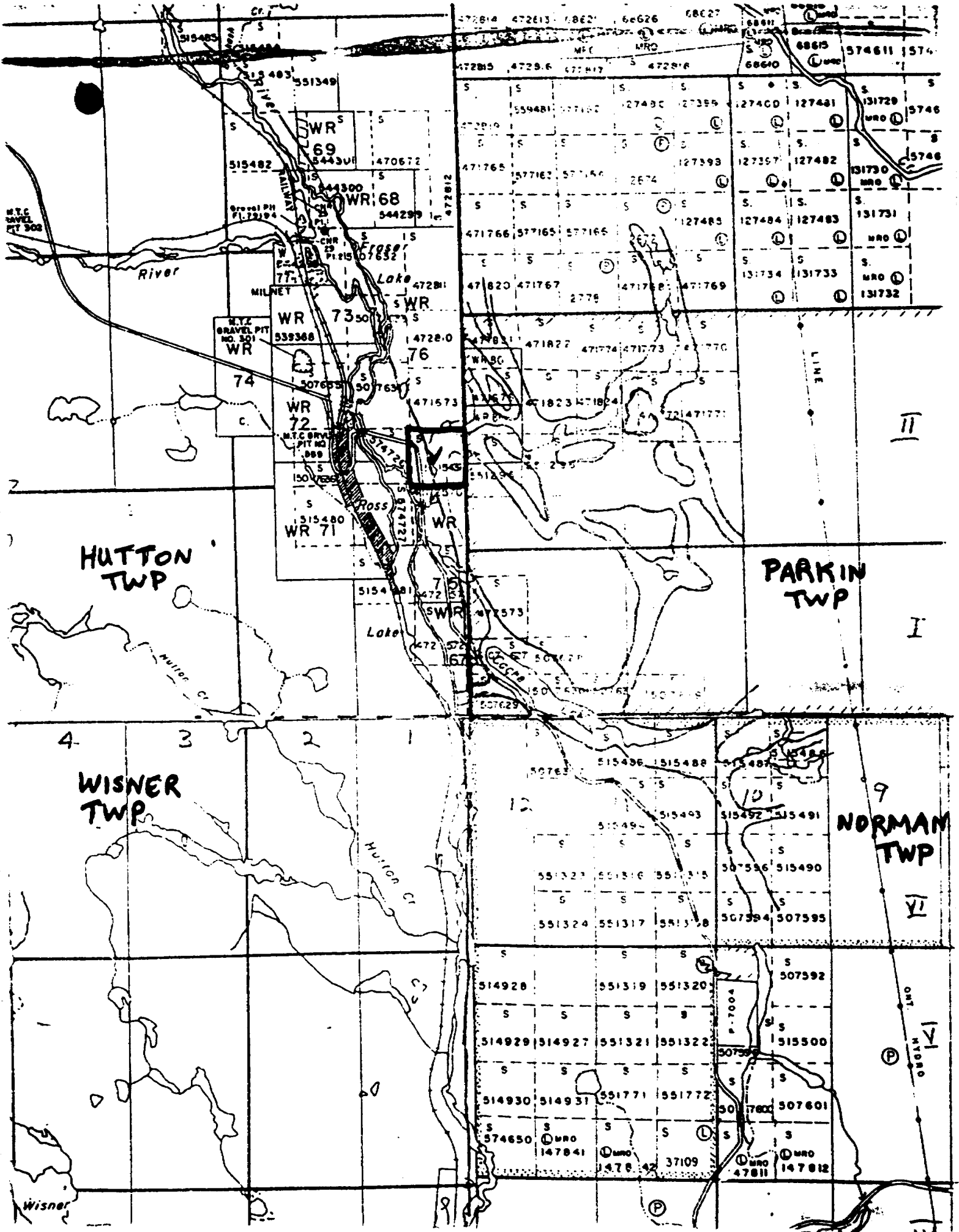

**HUTTON  
TWP**

**PARKIN  
TWP**

**WISNER  
TWP**

**NORMAN  
TWP**

M.T.C.  
GRAVEL  
PIT NO. 302

M.T.C.  
GRAVEL PIT  
NO. 301  
WR

M.T.C.  
GRAVEL  
PIT NO.  
300  
WR

Wisner

114