



411155W0180 63.5448 NORMAN

010

O.M.E.P. Administrator.

My program consisted mainly of stripping and trenching. A number of diabase dykes strike through the granite and migmatites (country rock). It is along the contact of these dykes that the mineralization occurs. Disseminated pyrite and chalcopyrite occur along these contacts. Assaying for gold, silver and copper indicates some non-commercial enrichment. Both Inco and Falconbridge have visited the property and expressed some interest.

Thank You

Harold V. Barry

H V BARRY

15 BLOOR ST

CAPREOL, ONT

JAN 12 1985

LOCATION: NORMAN TWP.

MAP No.

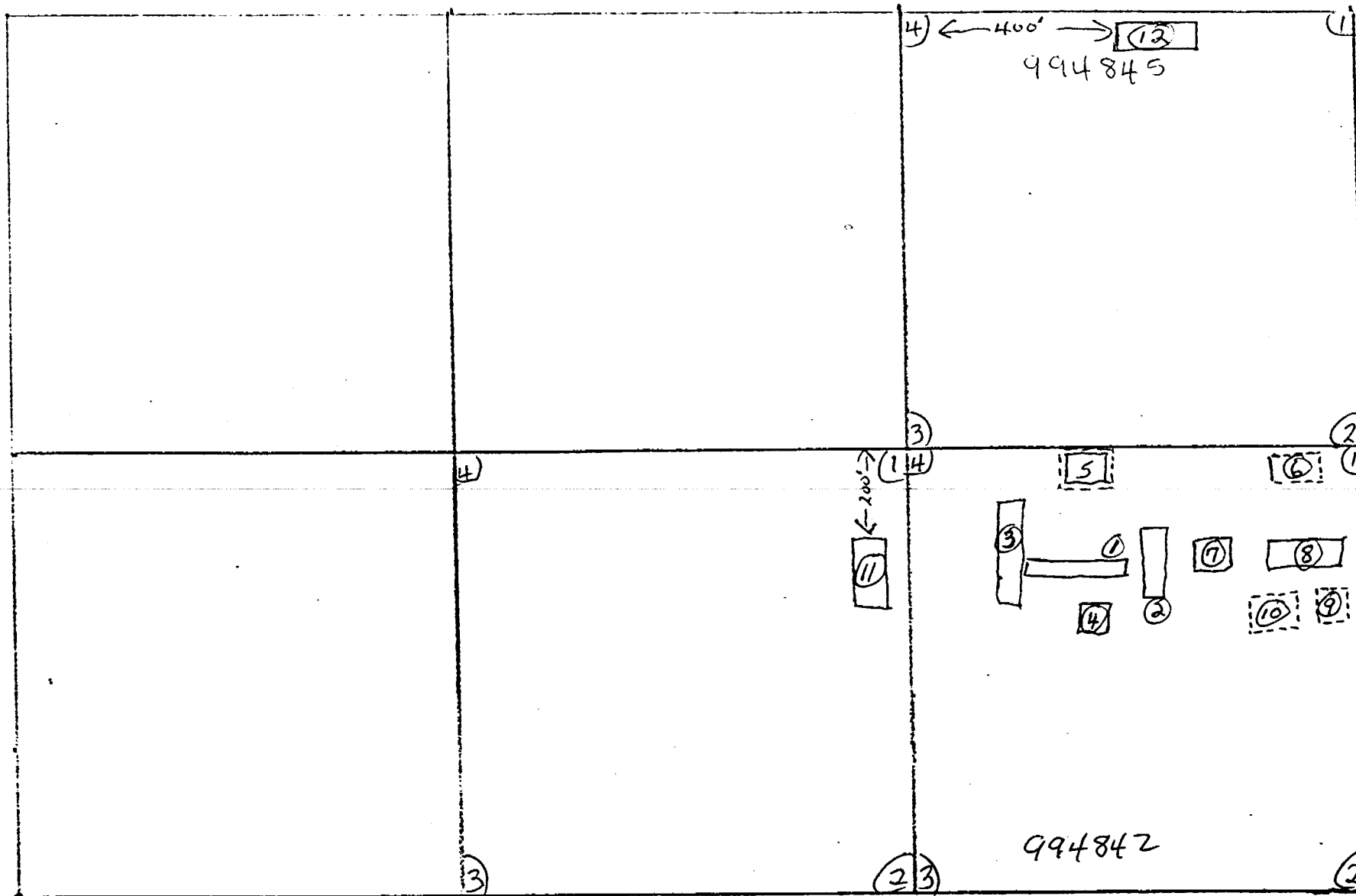

No.	STRIPPED	TRENCHED	ASSAY sheet No.
1		100'x4'x4'	CB 10811 #4
2		70'x4'x4'	
3		60'x5'x4'	
4		10'x6'x4'	
5	7'x7'x6'		
6	7'x7'x3'		
7		4'x4'x3'	CB 10811 #5
8		15'x3'x3'	
9	10'x5'x4'		
10	8'x6'x4'		
11		16'x5'x4'	CB 10811 #6
12		14'x3'x3'	992

N
 SCALE: 1" = 440'
 MAP No. 1 OF 1
 NORMAN Twp.
 H. BARRY, OMEP 1988
 - - - - STRIPPING
 □ - TRENCHING

992

ATOMIC ABSORPTION ASSAY REPORT

FOR: JOE WHITE
11 BALL PARK RD.,
CAPREOL ONTARIO

DATE : 88/12 20
FILE NO.: 992

SAMPLE NUMBER	DESCRIPTION	Ag-CO/TON	Ag-CO/TON	Ag-CO/TON	Co %	Co %	Fe %	Fe %	Mo %	Fe %
		0.005	TRACE		0.005					

pit #12

*H. BARRY OMEP 1988
NORMAN TP*



Ministry of
Northern Development
and Mines

Temiskaming
Testing
Laboratories

P.O. Box 799
Presley St.
Cobalt, Ontario
P0J 1C0
(705) 679-8313

Report Number

CB 10811

Laboratory Report

Date Dec. 29/88.

Issued To: Mr. Gerald Gaudette, P.O. Box 1094, 2 Norman Ave., Capreol, Ont. P0M 1H0

Sample Number	Gold Oz. Per Ton	Silver Oz. Per Ton	Cu%
4 - pit #1	0.004	N11	0.311
5 - pit #7	0.002	Trace	
6 - pit #11	0.004		

H. BARRY OMEP 1988
NORMAN Tp.

Fees Received Charged 6 coupons card #0997

D.L. Lashie
Manager *m.*

Except by special permission, reproduction of these results must include any qualifying remarks made by this ministry with reference to any sample.