

63.617

REPORT ON A GEOPHYSICAL SURVEY ON CLAIMS 836801, 836803

NORMAN TOWNSHIP

The magnetometer survey on Claims 836801, 836803 was part of a survey conducted on the New Dominion Nickel Mines property in Norman Twp. for the purpose of investigating possible offsets from the Sudbury and for assessment work.

The results were of a negative as no strong continuous anomalies were found.

The work was performed on May 26th and 27th, 1955 by Cremac Surveys Ltd. of Toronto, Ont. The type of instrument used was an Askania magnetometer with a sensitivity of 19.6 gammas per scale division.

Twenty eight hundred feet of lines were cut and 57 stations were established at 50 feet intervals.

The rocks underlying the area are granitic.

Statement of man-days required for survey

Line Cutters

George Carr	transit operator	1 day
Roger Beauchamp		1 day
J. Moore		1 day

Instrument Operators

H. Babb	Operator	1 day
A. Dzurban	assistant	1 day
<u>Draughtman</u>	F. Garbutt	1 day



010

New Dominion Nickel Mines Ltd.

E. J. Hawman (Agent)

NEW DOMINION NICKEL MINES LTD

Plan of Geophysical Survey

Magnetic Readings & Contours

Scale 1" = 100'

Scale
1" = 100'

Contour Interval 100 gammas



VI						
V						
IV						
III						
II						
I						
	12	11	10	9	8	7

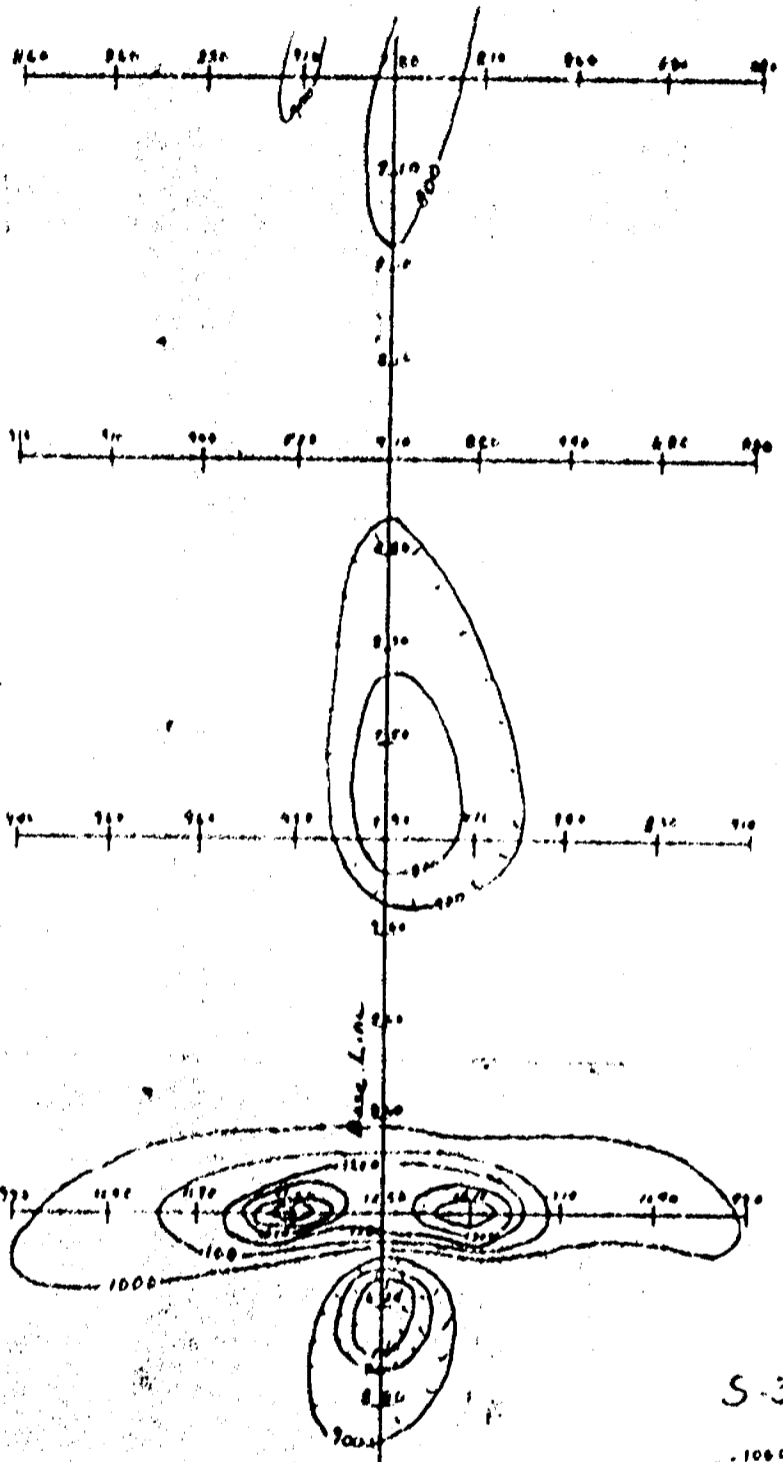

S-36803

S-36801

S36804

S36799

Lot 5

Lot 4

Park Twp



41155W0193 002081 NORMAN

500

VI
V
IV
III
II
I

Wisher Twp

Rathbun Twp

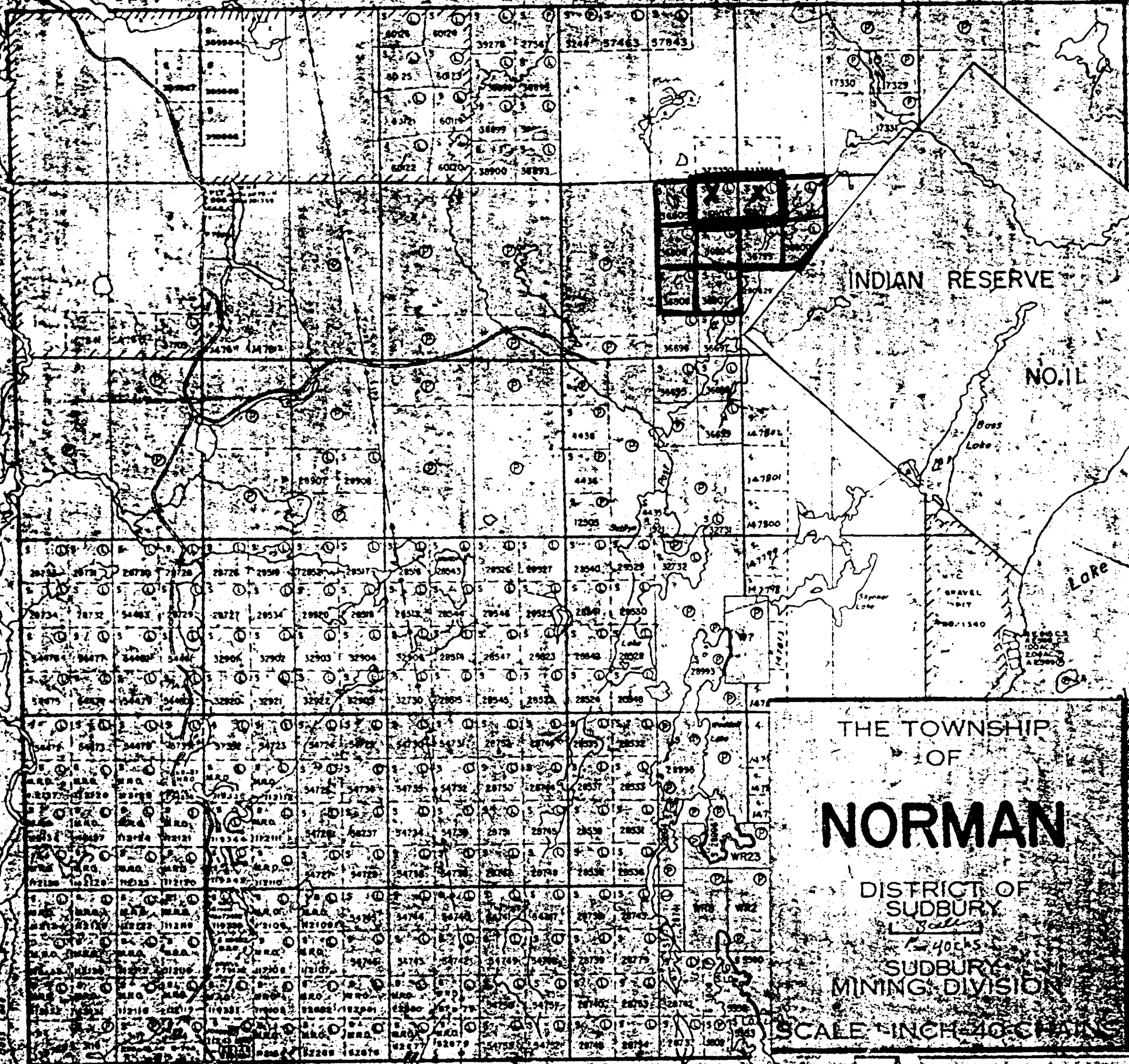

INDIAN RESERVE

NO. 11

Boys Lake

Lake

THE TOWNSHIP
OF
NORMAN

DISTRICT OF
SUDBURY
SUDBURY
MINING DIVISION

SCALE 1 INCH = 40 CHAINS

12 11 10 9 8 7 6 5 4 3 2 1