

OPAP FINAL SUBMISSION

FOR: JOHN BRADY CP97-101
AND MARIE BRADY CP97-102

2.18128

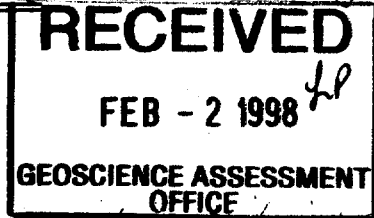

1

AREA 1 - SUEZ PROPERTY

NOTE: This project was modified to include 37 CLAIM UNITS IN S.E. PARKIN Twp AND S.W. AYLMER Twp., CONTIGUOUS TO THE ORIGINAL PROPERTY. (See letter on file dated OCT 3/97 - SOLONYKA-BRADY)

- LOCATION:
- CAPREOL - WAHNAPIITAE LAKE AREA
 - NE NORMAN Twp; N.W. RATHBUN Twp. ^{CLAIM MAPS} 64092, 64093 *
 - ADD-ON - S.E. PARKIN Twp; S.W. AYLMER Twp. ^{CLAIM MAPS} 62915, 62901
 - Sudbury Mining Division
 - Sudbury Resident Geologists AREA
 - NTS 41 I 15
 - UTM - NORMAN/RATHBUN N5181625M AND E 513825M.
 - UTM - AYLMER/PARKIN N5184000M AND E 514500M.
 - LAT 46° 47' ; LONG. 80° 49'
 - * composite of CLAIM MAPS with property outline enclosed
 - Property index map enclosed.
 - LOCATION MAPS 1-A; 1-B; 1-C; 1-D enclosed
 - DETAIL MAPS 1, 2, 3, AND 4 enclosed.

4115582002 2.18128

AYLMER

010



Access:

Access is via Hwy 69 North of Sudbury for 3.5 KM. to Capreol. From CAPREOL follow Hwy 545 (Moose Mountain Rd) for 10 KM. to the North River Rd. Proceed N.E. on the North River Rd. for 10 KM. to the old JONSMITH mine site, which is a large cleared AREA. From here a bush trail leads S.E. for 5 KM. to the WORK AREAS. **NOTE:** EARLY in the program we became aware of a NATIVE LAND CLAIM submitted by IR 11. Since our proposed work area would be affected, negotiations were implemented with the WAHNAPIITAE Band and the Chief, NORMAN RECOLLET. Also, our work area was very close to the RESERVE boundaries (LOCATION MAP 1-D). It was agreed by ourselves and the Band that access would be granted across the reserve (much shorter than the original route) and that we would rent the Band's excavator. In this way the Band would benefit from our activities and could address any work related concerns, (environment-stripping activities, blasting etc.) on site. We waited for final approval until early October, but internal problems in the Band continued to delay the approval. Approval to modify our program was granted by MR. SOLONYKA on OCT 3/97.

Geology:

2

- Rathbun and Norman Twp - LOCATION MAP 1-D

A mafic meta volcanic unit underlies the southern portion of CLAIM 7222381. Just inside the Norman Twp boundary this unit swings to the north - CLAIM 1117878. North and East of the south shore of Boundary Lake, Mississauga quartzites and conglomerate predominate. An ironstone body ± 100 M wide strikes N.W. to S.E. along the S.W. shore of Boundary Lake (OGS MAP 2450 - OTTER LAKE). Our prospecting traverses and manual stripping at R1 and R2 (LOCATION MAP 1-D) confirmed this data. In addition a series of narrow quartz veins (2-4 cm. wide) in a carbonated arkosic rock, were discovered at (R2). The quartz veins contain .5 to 1% fine pyrite.

On the south west side of Boundary Lake the Iron Formation is brecciated and sheared and contains 1-2% pyrite mineralization. More breccia occurs along the access trail just south west of Boundary Lake. Outcrops of mafic meta volcanic rocks occur along the access or "traverse" trail at the Rathbun-Norman Twp boundary. The trail swings north about 150 M west of the township boundary, and 350 M north of this point an outcrop of brecciated mafic volcanic rock occurs. Most of the area traversed is covered in 1 to 3 M of overburden.

- Aylmer Twp - LOCATION MAP 1-A : DETAIL MAPS 1 AND 2

AT WORK AREA 'A' a green, carbonated and brecciated quartzite with minor pyrite (<1%) was exposed. 100 M to the south at work areas 'B' and 'C' the quartzite is strongly sheared and carbonated with minor, disseminated pyrite evident in the fresh rock.

At work areas 'd', 'e' and 'F' carbonated, sheared and fractured diabase predominates. The diabase is coarse grained and contains minor pyrite - <1%.

- Parkin Twp - LOCATION MAP 1-B ; DETAIL MAP 3

AT WORK AREAS 'g', 'h', 'i' and 'j' a green quartzite extends northward for 250 M north of the mafic volcanic horizon on claim 682281. A large quartz stockwork is exposed in an area 100 M x 250 M. The quartz stockwork is essentially barren with only occasional pyrite inclusions. Northward at work areas 'g' and 'h' the quartzite is fractured with 5 cm quartz veins occurring at 'g'. The veins contain $\pm 1\%$ fine pyrite and strike NE.

- Parkin Twp - LOCATION MAP 1-C ; DETAIL MAP 4

AT WORK AREAS 'K' and 'L' a narrow 'band' of north-south striking felsic volcanics was exposed. A series of 1-2 cm. quartz veins, also strike

3
North-south within the felsic unit. Both felsic rock and quartz veins contain 3-5% pyrite. The zone is exposed over an area 6M x 6M and is non-magnetic. However, magnetite and iron formation with 3-5% pyrite are exposed along the east and west flanks of the felsic unit. A shear, 1-2M wide strikes E-W through the center of Trench (7). Quartzites and washes outcrop just north of the work area and iron formation in volcanic rock is exposed for 200-300M S.E. of the work area.

WORK DONE: RATH BUN / NORMAN TUPS - MAP 1-d.

Work in this area consisted of prospecting to identify altered/mineralized areas for stripping and trenching and to develop a suitable access route for excavator/ATV access. Manual stripping and sampling done at locations R1 and R2. Further work was abandoned at this location due to delays in receiving approval from the Wabunpotae First Nations Band. (NOTE: at time of writing this report NOV 20/97 - approval has been received - however our modified program had already been completed) Area stripped was 16M x 2M x 1M.

- Aylmer - PARKIN TUPS - LOCATION MAPS - LOCATION MAPS 1-A; 1-B AND 1-C
- Detail MAPS 1, 2, 3 AND 4

Work performed, consisted mainly of manual and power stripping, rock trenching, washing, mucking, mapping and sampling. Prospecting, sounding and flagging access routes accompanied the above.

Detail map 1 outlines a stripped area of 80M x 3M x 1M. Two rock trenches totalling 4M x 3.5M x 3M were developed on zones of higher alteration.

As per detail map 2, five stripped areas totalling 190M of length and from 2-3M wide and 1-2M deep were completed. Three rock trenches, for a total of 7.5M x 7M x 6.5M were completed.

Detail map 3 shows four stripped areas and one trench. Overall stripping was 80M in length and averaged 2M wide and 1.4M deep. One rock trench, 2M x 1.5M x 1.5M was completed.

The stripped area shown on detail map 4 was 30M x 3M x 1.5M. Here trenches totalling 17M x 3.5M x 3.2M were developed at this location. A total of 22 samples were taken, of which 18 were submitted for assay.

RESULTS: Aylmer Tups.
- Location map 1-A, Detail map 2 - Trench 3. At this location a 1.5M chip sample yielded 6.62 g/t Au within a 3M wide shear zone of carbonated quartzite. The zone is slightly mineralized with < 1% pyrite. To the southwest

4

of trench 3, the diabase intrusive is carbonated and sheared but did not yield significant values.

LOCATION MAP 1-B, DETAIL MAP 3, TRENCH 6 - PARKIN TWP.

At this location, narrow 5CM quartz veins with 1% pyrite inclusions, yielded 1.65 g/t Au. Twenty to thirty metres south of Trench 6, a large quartz stockwork alteration zone occurs, which may provide structural control over gold/pyrite mineralization.

LOCATION MAP 1-C, DETAIL MAP 4 - PARKIN TWP.

Work done at this location (TR7) provided excellent results in gold mineralization. Three separate 'channel' samples yielded grades from 1.44 to 4.90 g/t Au from 1m to 1.5m width. The mineralized zone is exposed 10m north to south and 8m from N.W. to S.E. The pyrite mineralization within the zone is non-magnetic. Outside of the zone, at TR 8 for example, the mineralization is magnetic (partial iron formation + magnetite) however the magnetic zones do not carry significant gold mineralization. The non-magnetic gold bearing pyrite zone is near the volcanic-sedimentary contact. The contact was not exposed due to overburden and very large float boulders.

Recommendations: - Detail map 2, Trench 3 area (6.62g/t Au x 1.5m in shear)

This shear zone ought to be further developed along strike and to depth through additional stripping, trenching and sampling. The shear is on strike with the Bennett shear zone which is ±800m to the south east, on the Rathbun/Aylmer Twp. line.

(This is currently being explored by Flag Resources). The geology and mineralization at the Bennett are very similar to the "Brady" shear.

- Detail map 3, Trench 6 area (1.65g/t Au)

Additional prospecting, stripping, trenching and sampling is recommended; especially along the margins of the large quartz stockwork south of TR 6. There is a reasonable expectation that the contact areas of the stockwork will yield gold bearing sulfides.

- Detail map 4, TR. 7 (1.44 to 5.45 g/t Au - up to 1.5m wide)

The implications for sulfide bearing, mag low areas within the iron rich volcanic belt are very positive for gold discoveries. A detailed study of past geophysical work, additional mag reconnaissance, prospecting, stripping, trenching, sampling are all warranted in view of the discovery described above.

AREA 2 - BLACK CREEK PROJECT

5

LOCATION: CAPREOL - MILNET AREA

Hutton Twp - South east quadrant - 64066 CLAIM MAP
Sudbury Mining Division

Sudbury Resident Geologists' AREA

NTS 41 I 15

UTM N 5187000M AND E 503500M

LAT. $46^{\circ}50'$; Long. $80^{\circ}57'18''$

* Copy of claim map with property outline enclosed.

Property index map enclosed

LOCATION MAP 2 enclosed

DETAIL MAPS 5 and 6 enclosed.

Access:

The property is located 40 KM. north of Sudbury, ONT.
Access is via Hwy 69 N for 35 KM to the town of CAPREOL.
From CAPREOL, Hwy 545 leads north for 15 KM to the ONTARIO
Hydro/HARAMIA Quarry service road. Follow the service road
for 1 KM AND take the left fork for 1 KM to the work site.
Total 52 KM.

Geology:

Hutton Twp. S.E. Quadrant - LOCATION MAP 2
FINE GRAINED MAFIC VOLCANICS outcrop the northern part of the
WORK AREA ON CLAIMS 985067 AND 984369. A MEDIUM TO COARSE
GRAINED GRANITIC ROCK is in contact with the south flank of
the volcanics. IN the south west quadrant of CLAIM 984369 A
body of porphyritic granodiorite is partially exposed, trending
south west into thick overburden. The granodiorite is weakly
mineralized with $\pm 1\%$ pyrite with minor chalcopyrite. Forty
metres north of the granodiorite exposure A small body of
diORITE is also exposed (DETAIL MAP 5). Near the centre of claim
984369 A steep cliff occurs. Sporadic horizontal quartz veining,
5-10 CM. thick is visible in the cliff face. The veins contain
MINOR pyrite AND chalcopyrite of $>1\%$. At the west end of
STRIPPED AREA (17) A .5M wide shear with minor pyrite occurs.
Shearing was also exposed at trenches d, 2 AND f. Here the
sheared MAFIC ROCK contains 1 to 2% pyrite with chalcopyrite.
The shearing strikes 320° N.W. To the south of rock trenches
F AND H ANOTHER "cliff" face was exposed. The rock exposed here
dips straight down at 90° AND the gravel infill or overburden
is ± 7 M deep. (MAXIMUM REACH of excavator bucket).

This AREA of deep gravel overburden or "fault valley" continues for 300M south of pit (14) to stripped AREA (10) on claim 1042861. Here, Rock trench 'g' exposed a 2M zone of $\pm 2\%$ pyrite/magnetite mineralization on the North flank of a granite outcrop. Fifteen metres North of this point at pit 1, the overburden is +7M deep. As shown on Detail MAP 5, the granite-volcanic contact occurs just west of (15). ALL of the workings North and East of the contact are underlain by mafic volcanics

Work Done: Initially our focus was to locate the approximate trend or outline of the Fraser Lake Mag Anomaly discovered by Sandor Dev. in 1975. This anomaly was re-located in 1995 by Pan Global Res. We located the old Pan Global grid and through pace and compass methods re-configured the anomaly as per location MAP 2. A line was then flagged and blazed, striking north-south across the anomaly. This line was used as a control grid for following or tracing any gold dispersion pattern across the anomaly. Initial stripping (manual) and rock trenching occurred in the "cliff" area as a result of mineralized float (pyrite) found south of Trench A - 30-40M south of the cliff. A total of 9 pits were excavated in the gravel to a depth of +7 metres. Gravel samples were collected in the 0-2M sections and in the 3-6M sections. These along with some till samples were transported by ATU to the Vermillion River (3KM south) where they were sluiced to a $\pm 20\%$ concentrate, visually examined with pocket lens and sent for assay. Having visually determined increased gold particles at trenches (1), (2) and (3) and pits 6 and 8, further stripping and rock trenching was performed north of these gold dispersion trains. The 9 test pits in the gravel are numbered 1 through 9 and the average excavation for each is 3M x 4M x 7M. The trenches numbered (10) through (18) were dug in gravel or to strip overburden. A total length of 450M of trenching was performed with the average width at 2 metres and the average depth at 1.7 metres. Nine rock trenches were developed, numbered a through i. These trenches averaged 2M x 1.5M x 1.5M each. A total of 43 samples were taken of which 36 were assayed.

RESULTS: Significant assays in gold and copper were obtained in the sheared mafic and felsic volcanics at trenches d and e. Values in this N.W. trending shear ranged to 1.16 g/t Au, and to 5.9% Cu., with widths up to 1 metre. Initial stripping and trenching work further east in the "cliff" area

did not yield any significant values. While the results of our gravel-concentrate program did not yield any commercial values in gold it did provide us with a discreet gold dispersion train. Pocket lens evaluation of increased numbers of gold grains in the concentrate led us to focus in the area of strip (15) and trenches d, E, F. As well as the shear zone at this location, with significant gold, copper results; another promising feature was the discovery of a slightly mineralized porphyritic granodiorite mass, which yielded 1.10g/t Au and .68% Cu across 1 meter.

Recommendations: It is apparent that there are two possibilities (models) supporting follow-up programs.

- ① To explore westward for additional shear zones that are parallel to the shear at (15). This could be accomplished by prospecting, stripping, trenching etc accompanied by visual inspection of alluvium concentrate for any additional gold dispersion patterns.
- ② To perform additional stripping, trenching, sampling to further evaluate the porphyritic granodiorite as to size, configuration, alteration, consistency in gold, copper values etc.

Summary: The results and recommendations for both project areas have been discussed with:

- Mike Cosec - Sudbury Resident Geologist
- Dr. Fred Browns - OGS - Sudbury
- Phil Brown - Consulting Geologist North Bay (Corbett)

John Marie Brady NOV 21/97
John Marie Brady
 on Brady

SUMMARY OF COSTS AREA 1

DATES WORKED	LOCATION - MAP REFERENCE	TYPE OF WORK PERFORMED	TYPE OF EQUIPMENT	CONTRACTOR / OPERATOR / WORKER	HOURS/DAYS WORKED	RATE/COST	AREA TOTAL	
JUNE 2 to OCT 31	AREA 1 RATHBUN, NORMAN, AYLMER, PARKIN TOWNSHIPS	Prospecting, Sounding, flagging, blazing, manual stripping, rock tracking, washing, mucking, sampling.	Axes, machetes, picks, scaling bars, shovels, gas drill powder, pump etc.	J. BRADY 1227 Holland Rd Sudbury, ONT.	34 days	150/day	5100	
OCT 3 to OCT 29	" "	" " "	" " "	M. BRADY 1227 Holland Rd Sudbury, ONT.	26 days	150/day	3900	
JUNE 2 to OCT 27	" "	" " "	" " "	R. CHARRON 5022 DR. HANMER, ONT	24 days	150/day	3600	
OCT 4 to OCT 7	" "	Power Stripping <u>RENTAL</u>	KOMATSU EXCAVATOR	C. RICHAR CONSTN. GARSON, ONT	21.5 hrs	80 ⁰⁰ /hr + GST	1840.	
OCT 3 to OCT 27	" "	TRANSPORT - WORKERS & Eqpt. <u>RENTAL</u>	Honda ATV	T. MIRON 75 Albany St. Sudbury	3 weeks	500/WK	1500	
OCT 3 to OCT 27	" "	Rock Trenching <u>RENTAL</u>	COBRA GAS DRILL	T. MIRON 75 ALBANY ST. Sudbury	3 weeks	500/WK	1500	
OCT 3 to OCT 27	" "	Power washing & cleaning/washing <u>RENTAL</u>	WATAX FIRE PUMP	G. VAN LITH. MARKSTAY, ONT	3 weeks	400/WK	1200	
JUNE 2 to OCT 27	" "	TRANSPORTATION	HXK TRUCK	J. BRADY 1227 Holland Rd. Sudbury	34 trips ⊙ 110 KM per Round trip = 3740 KM.	45/KM.	1496	
JUNE 2 to OCT 27	" "	Food		" " "	84 person days ⊙	20/person/day	1680.	
	" " Both AREA 1 and AREA 2	ASSAYS	LABORATORY	TSL LABS, SWASTIKA	→ calculated on Summary of costs sheet for AREA 2		Black Creek	
OCT 4/9?	AREA 1	HAULAGE <u>RENTAL</u>	Float	WM-DAY CONSTN.	CONTRACT	65 ⁰⁰ /hr + GST	208.	
							Total	22,024.
WAGES/Labour	12,600							
Rentals	6248							
TRANSPORTATION	1496							
Food	1680							
<u>total</u>	<u>22,024.</u>							

Summary of Costs

AREA 2 - BLACK CREEK PROJECT - BRADY 97

DATES WORKED	LOCATION - MAP REFERENCE	TYPE OF WORK PERFORMED	TYPE OF EQUIPMENT	CONTRACTOR / OPERATOR / WORKER	HOURS/DAYS WORKED	RATE/COST	TOTAL	
MAY 17 to Aug 7 See also Daily Report Attached.	AREA 2 Hutton Twp. LOCATION MAP 2 DETAIL MAPS 5 and 6	Prospecting, sounding, flagging, manual stripping, rock trenching, mucking, washing, sampling	axes, machetes, scaling bars, picks, shovels, gas drill, dynamite, pump etc.	J. BRADY 1227 Holland Rd. Sudbury, ONT.	40 days	150/day	6000.	
MAY 22 to Aug 6	" "	" " "	" " "	M. BRADY 1227 Holland Rd. Sudbury	21 days	150/day	3150	
MAY 17 to JUNE 18	" "	" " "	" " "	R. CHARON Succ DR. HAMMER	21 days	150/day	3150	
JULY 28 to Aug 7	" "	" " "	" " "	T. MIRON 75 Albany St. Sudbury	7 days	150/day	1050	
JULY 28, 29, 30	" "	" " "	" " "	O. MAKI NEW MARKET, ONT	3 days	100.	300.	
JULY 21 - 30 incl.	" "	Power Stripping <u>RENTAL</u>	KOMATSU EXCAVATOR	C. R. CHEN CONSTN. GARSON, ONT	51.5 hrs	75.00/hr + GST	4132.	
MAY 25 to Aug 7	" "	Transport - workers & Eqp. <u>RENTAL</u>	Honda ATV	REAGER CONSTN CAPASOL, ONT	4 weeks	500/wk	2000.	
MAY 25 to Aug 7	" "	Rock Trenching <u>RENTAL</u>	Cobra Plugger	T. MIRON 75 Albany St. Sudbury	4 weeks	500/wk	2000.	
JULY 25 to Aug 7	" "	washing / sluicing <u>RENTAL</u>	Honda Pump clw. hose + fuel	" " "	2 weeks	400/wk	800.	
MAY 17 to Aug 7	" "	TRANSPORTATION	Toyota 4x4	J. BRADY 1227 Holland Rd. Sudbury, ONT	40 TRIPS @ 104 KM / round trip = 4160 KM	@ .40 / KM	1664	
MAY 17 to Aug 7	" "	Food		" " "	93 person days	20. / person / day	1860.	
JUNE 3 to OCT 23	Both AREA 1 AND AREA 2	ASSAYS	LABORATORY	TSN LABS - SWASTIKA			464.	
JUNE 21 / 97	" "	HAULAGE <u>RENTAL</u>	FLOTT	WM. DAY CONST.	CONTRACT	65.00/hr + GST	208.	
JUNE 3 to OCT 23	AREAS 1 AND 2	SAMPLE DELIVERY	Bus	GREYHOUND TRANSPORT Sudbury	4 shipments		48.	
							TOTAL	26,826
WAGES/LABOUR	12,600 + AREA 1	12,600 =	26,250					
RENTALS	9,140 + AREA 1	6,248 =	15,388					
TRANSPORTATION	1,664 + AREA 1	1,496 =	3,160					
FOOD	1,860 + AREA 1	1,680 =	3,540					
ASSAYS	464		464					
BUS TRANSPORT	48		48					
TOTAL	26,826	48,850.	→ TOTAL EXPENDITURES AREAS 1 AND 2					

OPAP/97

JIM BRADY

IV. DAILY REPORTS (Summarize work activity in

Section I)

Day	Project Area	WORKERS	Date	Work Performed
1	AREA 1 - Suez Project	JB, RC	JUNE 2	Prospecting traverses to locate altered/mineralized
2	RATHBUN / NORMAN Tp	JB, RC	3	ZONES + suitable AREAS to strip + trench - Flagged,
3	LOCATION MAP 1-d	JB, RC	4	blazed tentative access route + manual
4	" " "	JB, RC	5	stripping / cleaning ON S.W side of LAKE (Z.F)
5	" " "	JB, RC	6	AND 50M S.E. OF LAKE (quartz veins)
6	" " "	JB, RC	17	" " " " "
7	AREA 1 - Suez Project Modified to	JB, MB	OCT 3	Komatsu Excavator brought in for power stripping,
8	Include S.E Parkin Tp + S. Waylener Tp.	JB, MB	4	GAS ROCK DRILL, steel, gas, picks, bars, shovels etc
9	LOCATION MAPS 1-A, 1-b, 1-c	JB, MB, RC	5	MANUAL stripping / cleaning, washing.
10	DETAIL MAPS 1, 2, 3 AND 4	JB, MB, RC	6	DRILLING, BLASTING, MUCKING
11		JB, MB, RC	7	" " " " " "
12		JB, MB, RC	8	" " " " " "
13		JB, MB, RC	9	" " " " " "
14		JB, MB, RC	10	" " " " " "
15		JB, MB, RC	11	AS ABOVE + cleaning, sampling, washing
16		JB, MB, RC	12	" " " " " "
17		JB, MB, RC	13	MANUAL stripping, ROCK trenching,
18		JB, MB, RC	14	MUCKING, cleaning, sampling, washing
19		JB, MB, RC	15	" " " " " "
20	(DATE ERROR)		16	
21		JB, MB	17	" " " " " "
22		JB, MB	18	" " " " " "
23		JB, MB	19	" " " " " "
24		JB, MB	20	" " " " " "
25		JB, MB, RC	21	" " " " " "
26		JB, MB, RC	22	" " " " " "
27		JB, MB, RC	23	" " " " " "
28		JB, MB, RC	24	" " " " " "
29		JB, MB, RC	25	" " " " " "
30		JB, MB, RC	26	" " " " " "
31		JB, MB, RC	27	CLEAN-UP AND demobilization
32		JB, MB	28	MAP & Report Prep. for AREAS 1 AND 2
33		JB, MB	29	" " " " " "
34		JB	30	" " " " " "
35		JB	31	" " " " " "
36				
37				
38				
39				
40				
41				

WORKER CODE: JB = J. BRADY - 34
 MB = M. BRADY - 26
 RC = R. CHARRON - 24

Attach additional sheets as required.

RENTALS: Excavator - 5 days
 ATU - 3 weeks
 COBRA DRILL - 3 weeks
 FIRE PUMP - 3 weeks

TOTAL PERSON DAYS WORKED = 84 TRAVEL DAYS = 30

IV. DAILY REPORTS (Summarize work activity in

Section I)

Day	Project Area	WORKERS	Date	Work Performed
1	AREA 2-BlackCreek Project	JB, RC	MAY 17	<p>Prospecting - located approximate location of MAG anomaly 200M E of FRASER LAKE - scanned overburden to determine depth for stripping. Traced source of sulfides in float - flagged areas to strip, trench to obtain silt/gravel samples</p> <p>MANUAL STRIPPING, CLEANING IN AREAS OF shallow overburden. Rock trenching - drilling, blasting, mucking, cleaning, washing, sampling.</p> <hr/> <p>Konatsu Excavate, series of test pits and trenches in silt/gravel for 350 meters South to North (Flagged line) across MAG anomaly collected samples from 0 to 7M in pits from each excavation - set up water pump and sluice + screens at Vermillion River (2.5KM) and prepared -10 mesh concentrate for assaying (to follow gold dispersion pattern to source) + stripping + washing + rock trenching, mucking, sampling, etc.</p> <p>" " " "</p> <p>" " " "</p> <p>" " " "</p> <p>" " " "</p> <p>CLEAN-UP AND DEMOBILIZATION</p>
2	LOCATION MAP 2	JB, RC	18	
3	DETAIL MAPS 5 AND 6	JB, RC	21	
4		JB, MB, RC	22	
5		JB, MB, RC	23	
6		JB, MB, RC	24	
7		JB, MB	25	
8		JB, MB, RC	26	
9		JB, MB, RC	27	
10		JB, RC	28	
11		JB, RC	29	
12		JB, RC	30	
13		JB, MB	31	
14		JB, RC	JUNE 9	
15		JB, RC	9	
16		JB, MB, RC	10	
17		JB, MB, RC	11	
18		JB, MB	12	
19		JB, RC	13	
20		JB, RC	14	
21		JB, MB, RC	15	
22		JB, RC	16	
23		JB, RC	17	
24		JB, MB, RC	18	
25		JB, MB	JULY 20	
26		JB, MB	21	
27		JB, MB	22	
28		JB	23	
29		JB	24	
30		JB, MB	25	
31		JB, MB	26	
32		JB,	27	
33		JB, TM, OM	28	
34		JB, TM, OM	29	
35		JB, MB, TM, OM	30	
36		JB, MB, TM	31	
37		JB, TM	August 1	
38		JB, MB, TM	5	
39		JB, MB, TM	6	
40		JB, TM	7	
41				

WORKER CODES: JB = J. BRADY - 40
 MB = M. BRADY - 21
 RC = R. CHARRON - 21
 TM = TED MIRONOFF
 OM = O. MAKI - 3

Attach additional sheets as required.

Rentals: Excavator - 8 days
 ATU - 4 weeks
 GAS DRILL - 4 weeks
 WATER PUMP - 2 weeks

Total Person Days worked = 93

TRAVEL DAYS = 40

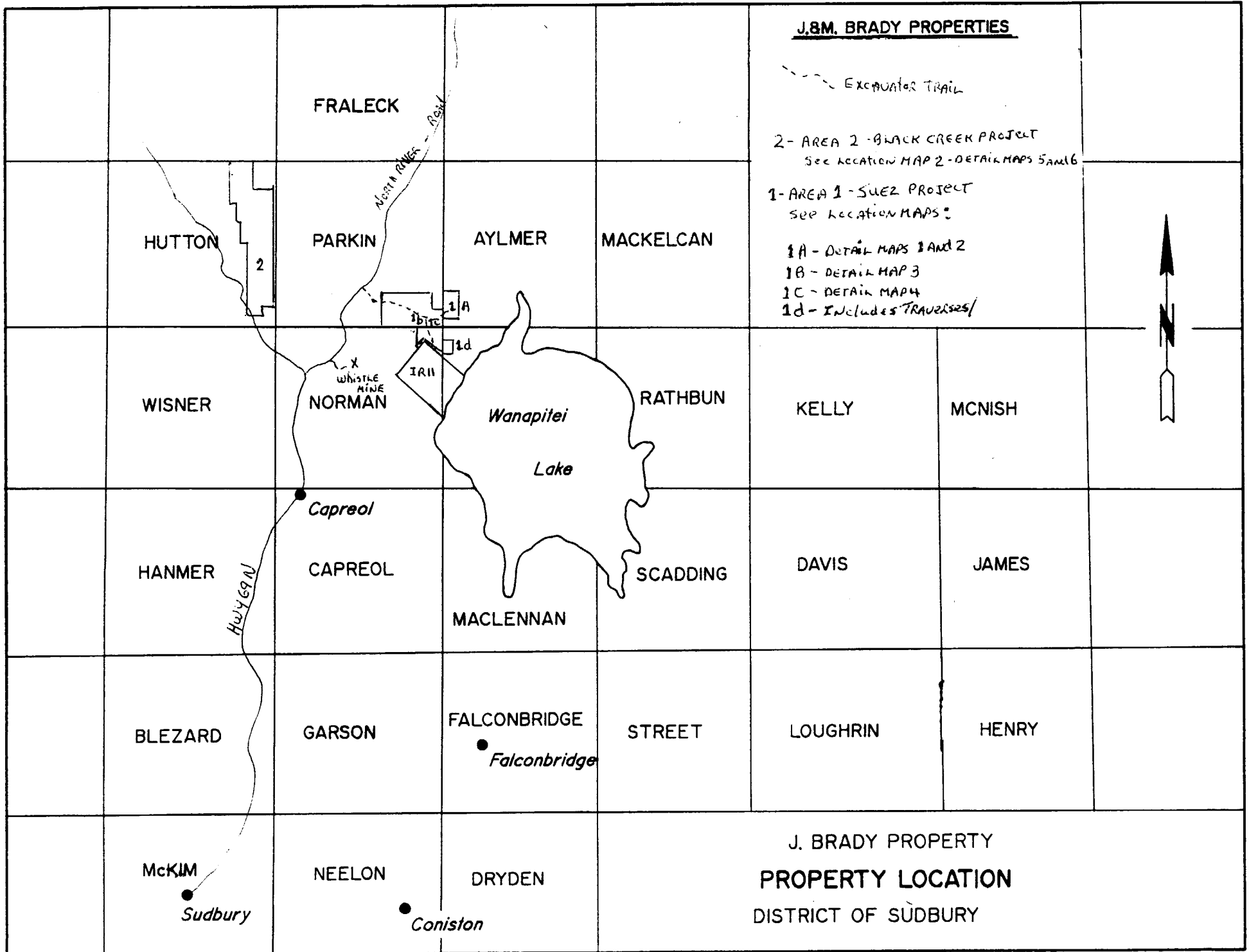

J.B.M. BRADY PROPERTIES

Excavator Trail

2- AREA 2 - BLACK CREEK PROJECT
SEE LOCATION MAP 2 - DETAIL MAPS 5 AND 6

1- AREA 1 - SUEZ PROJECT
SEE LOCATION MAPS:

1A - DETAIL MAPS 1 AND 2

1B - DETAIL MAP 3

1C - DETAIL MAP 4

1D - INCLUDES TRAVERSIS/



J. BRADY PROPERTY
PROPERTY LOCATION
DISTRICT OF SUDBURY

LOCATION MAP 1-d RATHBUN + NORMAN TOWNS.

PART OF AREA 1 - SUEZ PROJECT

NORTH
AST.

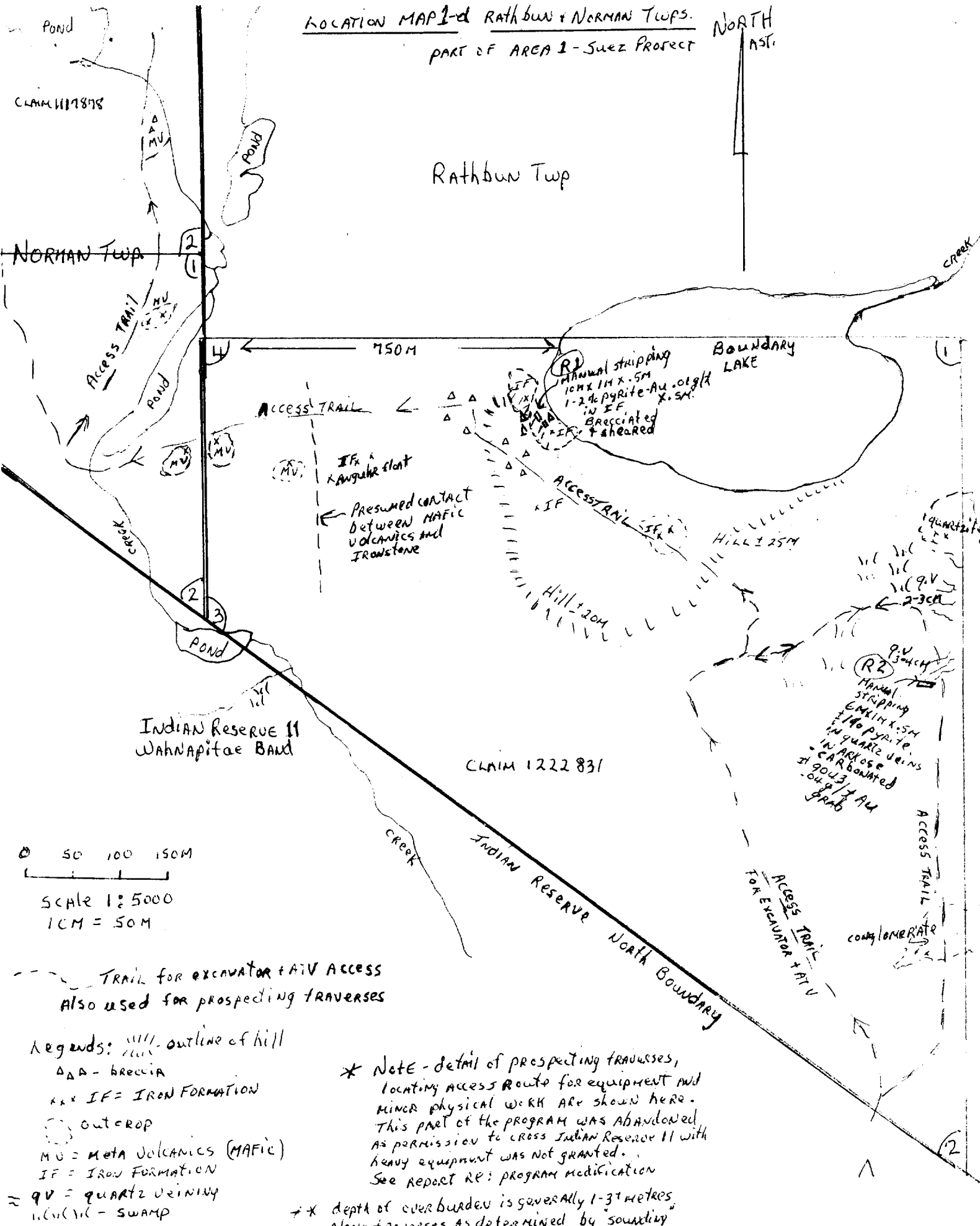

LOCATION MAP NO. 1-A-AREA 1-Suez Project (modified) AYMER TWP (S.W. CORNER) TOWNSHIP

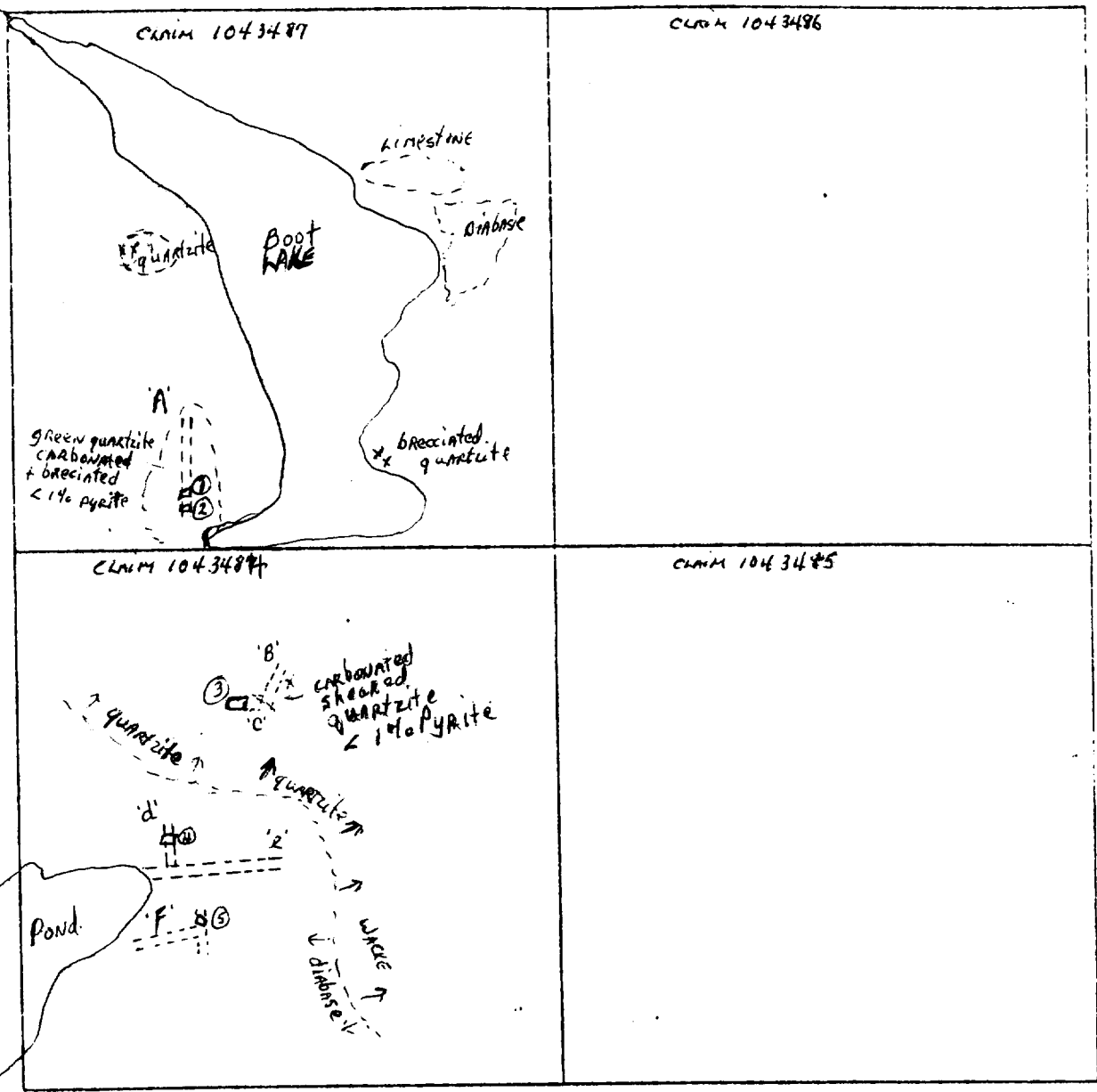

① Base Map Reference G2901 ② Refer to Detail Map No.s 1 AND 2

③ Legend: STRIPPING TRENCHING WORK AREA ①

Work Location	Type of Work	Dimensions	Assays & Ref. No's	Other

NORTH AST

CPAP/97

DETAIL MAP OF STRIPPING, TRENCHING, SAMPLING

LEGEND:

- X SAMPLE LOCATION - GRAB SAMPLES
- ▲ CHIP SAMPLE Δ-----Δ CHANNEL SAMPLE
- - - - - STRIPPING - AVERAGE DEPTH 1.7M
- ▭ TRENCHING - AVERAGE DEPTH 1.5M

DETAIL MAP NO. 1

REFER TO LOCATION MAP NO. 1-A

TOWNSHIP AYLMER

CLAIM NO. 1043487

① - WORK AREA

PANNIN Twp EAST Boundary
AYLMER Twp West Boundary

#4 POST
55 METERS NORTH

75M

"A"
STRIPPED
80M X 3M X 1M

#902 1/2 Au
GRAB

OVER BURDEN
1 - 2.5M

hill 110M RISE @ 30°

green carbonated
quartzite with
MAFIC Inclusions
+ brecciated
> 1% pyrite

LAKE

①
TRENCH
1.5M X 1.5M
X 1M

#901
GRAB 0.1g 1/2 Au

fractured
Rock Pyrite
quartzite

②
TRENCH
2.5M X 2M X 2M

#904
GRAB 0.2g 1/2 Au

ALTERED
GREYWACKE

EXCAVATOR/AFV
TRAIL

SCALE

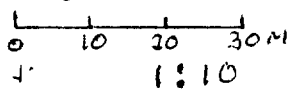

NORTH AST

DETAIL MAP OF STRIPPING, TRENCHING, SAMPLING

LEGEND:

- X SAMPLE LOCATION - GRAB SAMPLES
- ▲ CHIP SAMPLE Δ-----Δ CHANNEL SAMPLE
- STRIPPING - AVERAGE DEPTH 1.7M
- ▭ TRENCHING - AVERAGE DEPTH 1.5M

DETAIL MAP NO. 2

REFER TO LOCATION MAP NO. 1-A

TOWNSHIP AYLMER

CLAIM NO. 1043484

① - WORK AREA

#4 POST
85M NORTH

130M

AYLMER TWP. WEST BOUNDARY

PARKIN TWP. - EAST BOUNDARY

OUTCROP WACKE

STRIP "B" 20M X 2M X 1M

3M wide strip
fractured quartzite
with rusty jugs
and pyrite < 1%

TRENCH
3M X 2.5M X 3M
1.5M chip sample
Au - 6.62g/t

#9039
.01g/t Au
GRAB

quartzite

diabase

Excursion/ATV TRAIL

#9040
.04g/t
GRAB

STRIP "d" 20M X 3M X 1.5M

TRENCH 3M X 3M X 2.5M
1M chip sample
.01g/t Au

carbonated diabase

strongly sheared heavily carbonated diabase w. dis. pyrite

STRIP "e" 9CM X 2M X 1M

TRENCH ③
1.5M X 1.5M X 1M

Altered diabase - Fractured
1CM qtz + feldspar vein lets
disseminated pyrite > 1%
grab .08g/t Au

Pond

DIABASE OUTCROP

STRIP "f" 4.5M X 2M X 1M

SCALE

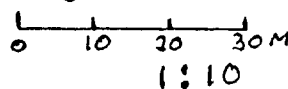

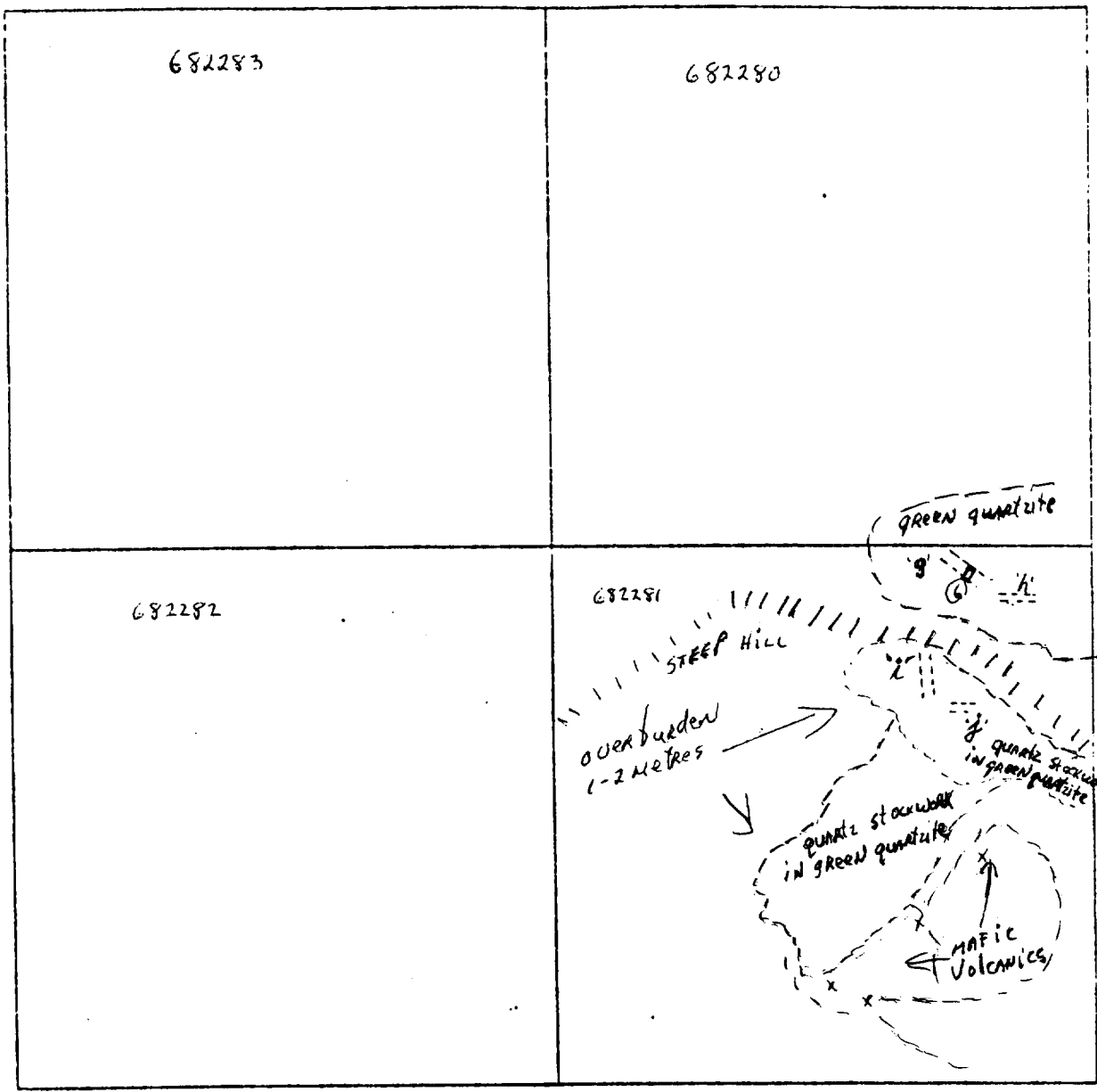

Scale - 1:5000 1cm = 50m 0 50M 100M 150M

① Base Map Reference 62915 ② Refer to Detail Map No. 3

③ Legends: STRIPPING TRENCHING WORK AREA ①

Work Location	Type of Work	Dimensions	Assays & Ref. No's	Other

NOTES:

NORTH AST

DETAIL MAP OF STRIPPING, TRENCHING, SAMPLING

LEGEND:

- X SAMPLE LOCATION - GRAB SAMPLES
- ▲ CHIP SAMPLE Δ-----Δ CHANNEL SAMPLE
- STRIPPING - AVERAGE depth 1.7M
- ▭ TRENCHING - AVERAGE depth 1.5M
- ① WORK AREA

DETAIL MAP NO. 3

REFER TO LOCATION MAP NO. 1 B

TOWNSHIP PARKIN

CLAIM NO. 682281

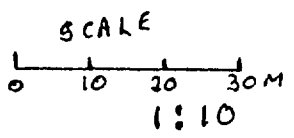
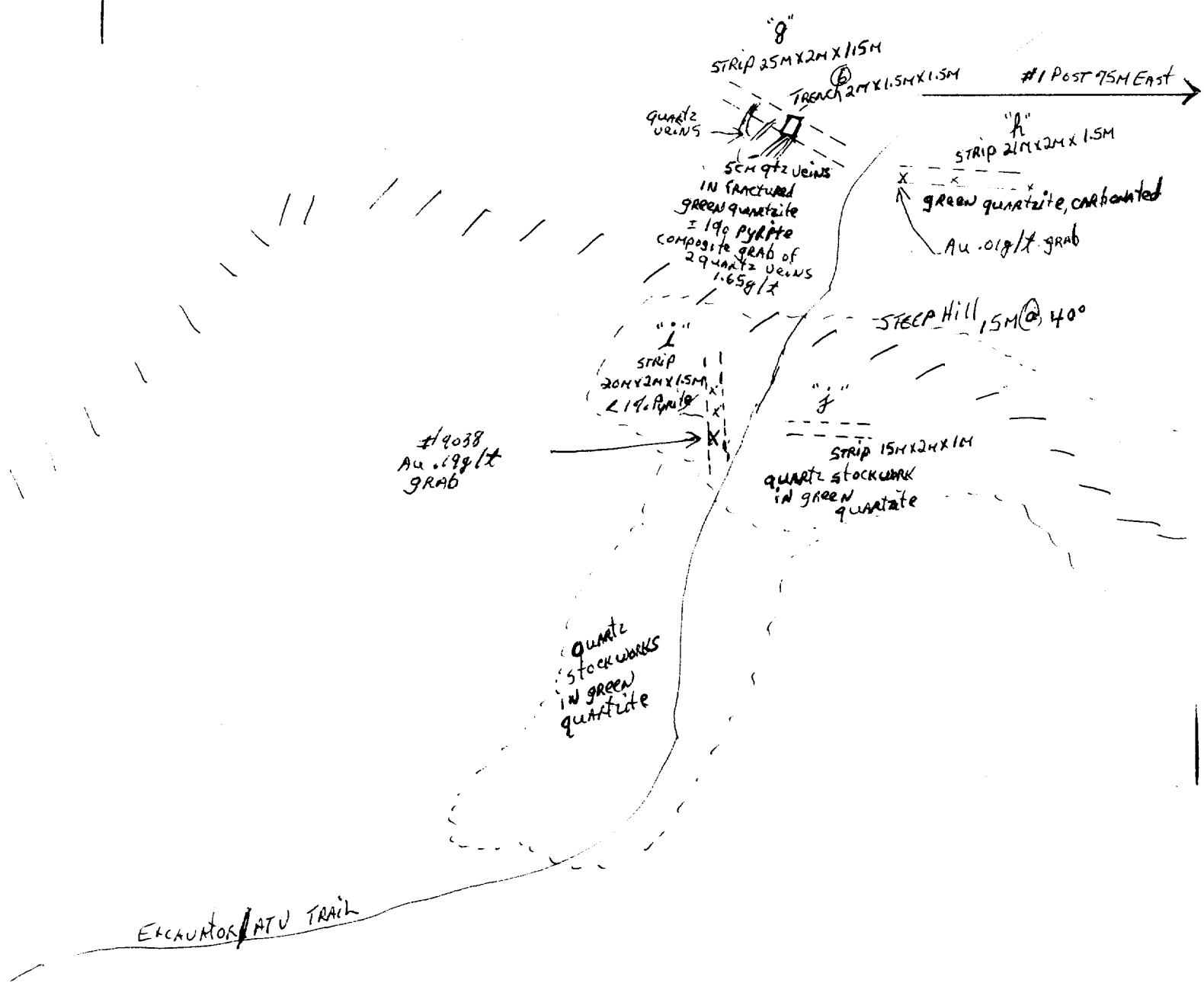

LOCATION MAP NO. 1-C-AREA1

PARKIN Twp (S.E.)

TOWNSHIP

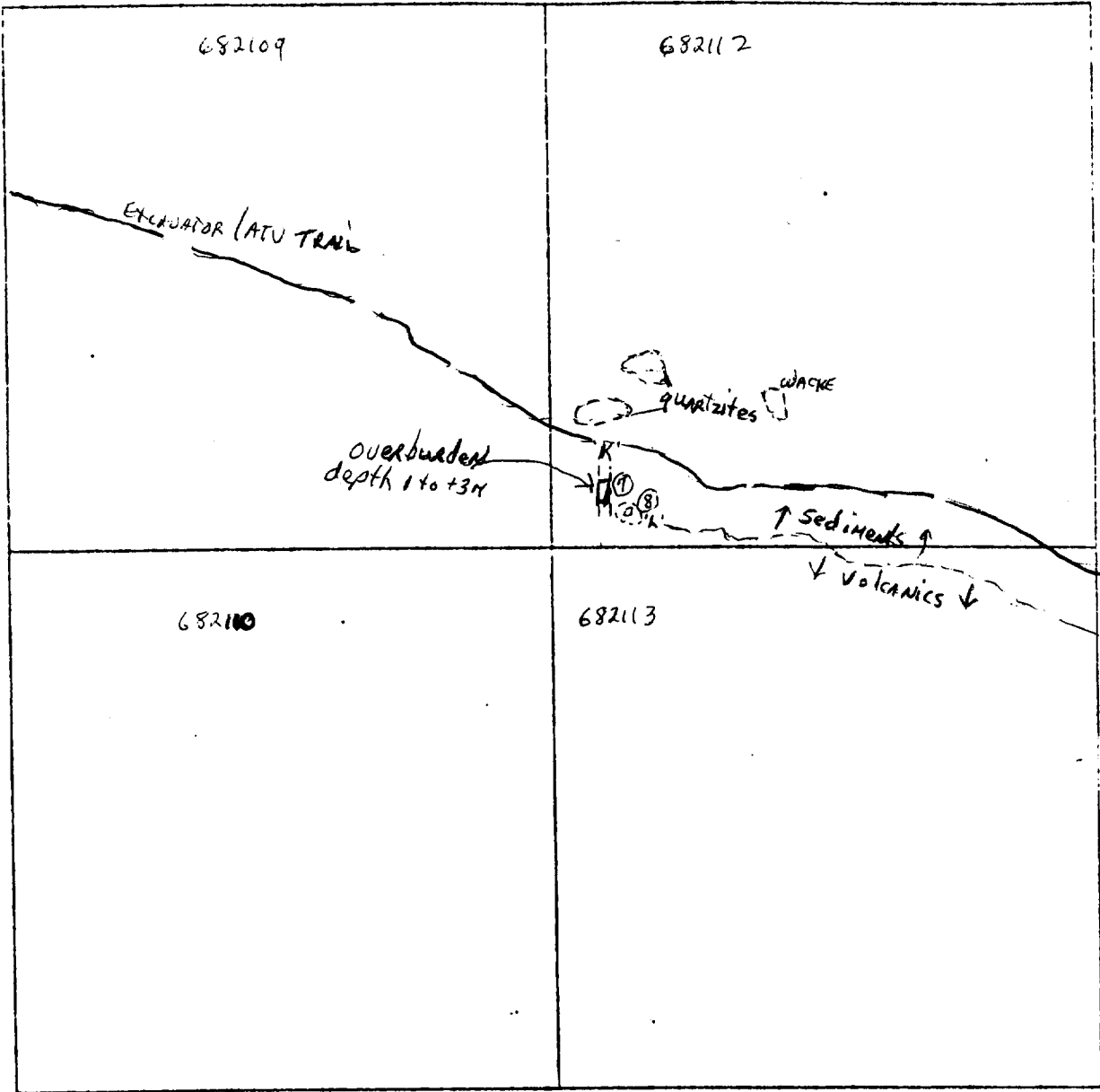

Scale - 1:5000

1cm = 50m

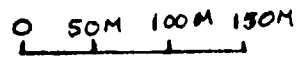

① Base Map Reference G2915 ② Refer to Detail Map No. 4

③ Legend: STRIPPING TRENCHING WORK AREA ①

Work Location	Type of Work	Dimensions	Assays & Ref. No's	Other

NOTES:

NORTH AST

0 PAP/97

DETAIL MAP OF STRIPPING, TRENCHING, SAMPLING

LEGEND:

- X SAMPLE LOCATION - GRAB SAMPLES
- ▲ CHIP SAMPLE, Δ-----Δ CHANNEL SAMPLE
- STRIPPING - AVERAGE DEPTH 1.7M
- ▭ TRENCHING - AVERAGE DEPTH 1.5M

DETAIL MAP NO. H

REFER TO LOCATION MAP NO. 1 C

TOWNSHIP PARKIN

CHAIN NO. 682112

① - WORK AREA

||||| - old work area

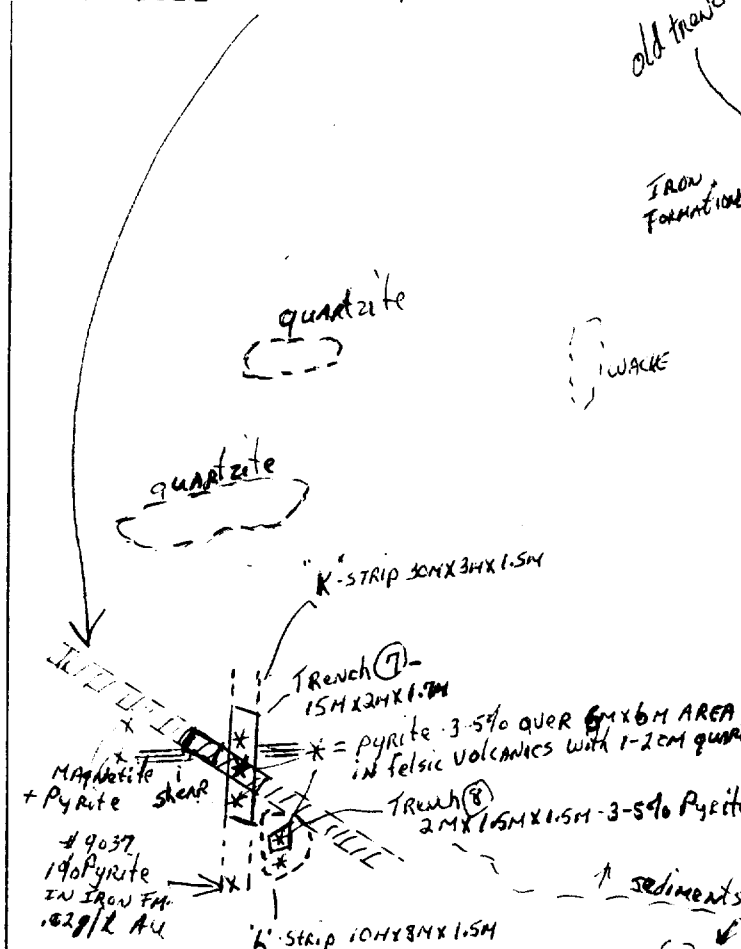

CLAIM 682109

② ③ CLAIM 682112
 ① ④ CLAIM 682113

CLAIM 682110

BLOW-UP OF TR ① AND ② 1 CM = 3M

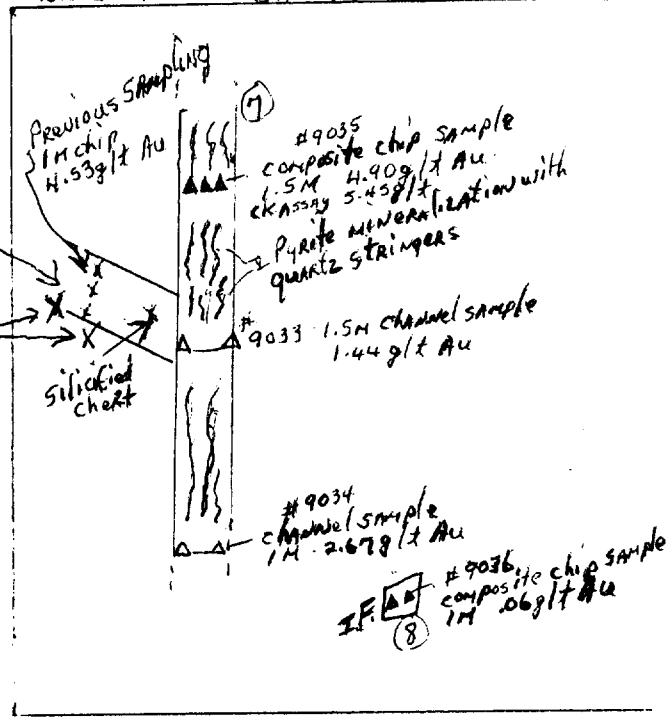

SCALE

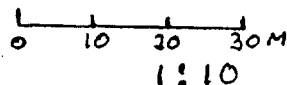

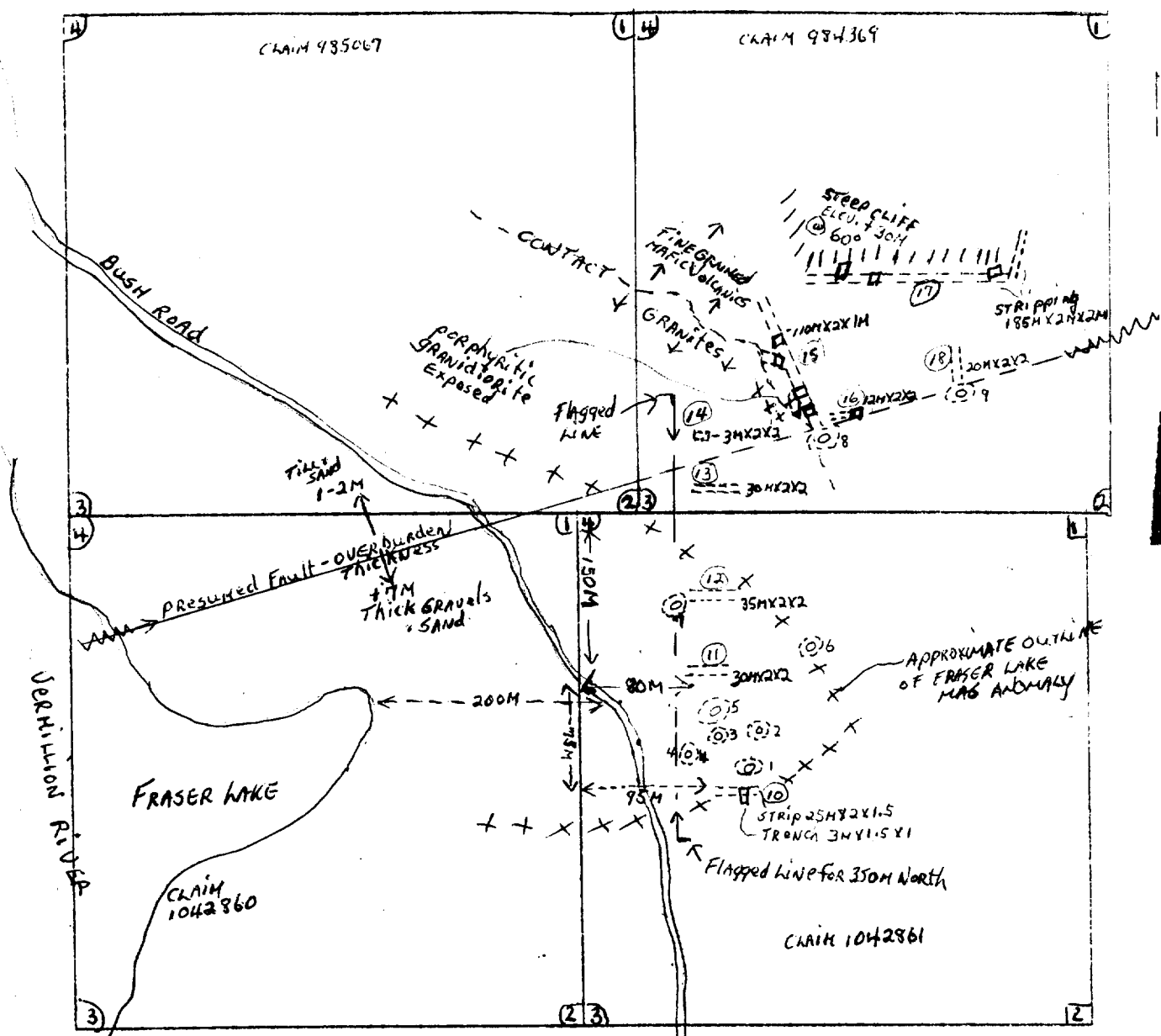

Scale - 1:5000 1cm = 50m 0 50M 100M 150M

① Base Map Reference 64066 ② Refer to Detail Map No's 5 and 6

③ Legend: STRIPPING ----- TRENCHING = WORK AREA ①

4. ⊙ - deep pit in gravel/till
ALL 3M X 4M X 7M - No's 1 to 9

Work Location	Type of Work	Dimensions	Assays & Ref. No's	Other

NOTES:

NORTH AS

DETAIL MAP OF STRIPPING, TRANCHING, SAMPLING

LEGEND:

- X SAMPLE LOCATION - GRAB SAMPLES
- ▲ CHIP SAMPLE. Δ --- Δ CHANNEL SAMPLE
- (15) --- STRIPPING - AVERAGE DEPTH 1.7M
- F --- TRENCHING - AVERAGE DEPTH 1.5M

DETAIL MAP NO. 5

REFER TO LOCATION MAP NO. 2

Township Hutton

CLAIM NO. 984369

AREA 2
BLACK CREEK PROJECT

(5) - deep pit in till + gravel
3M x 4M x 7M

Au = gold assay in gravel from 10 to 34 PPMs

Au⁺ = " " " " " " 300 to 405 PPMs

9006 - significant rock assay

quartz veining - horizontal - 5 to 10cm thick
MINOR Py and chalcopyrite
IN MAFIC VOLCANICS
PRIOR SAMPLING OF qtz veins yielded .01 to .029/t Au

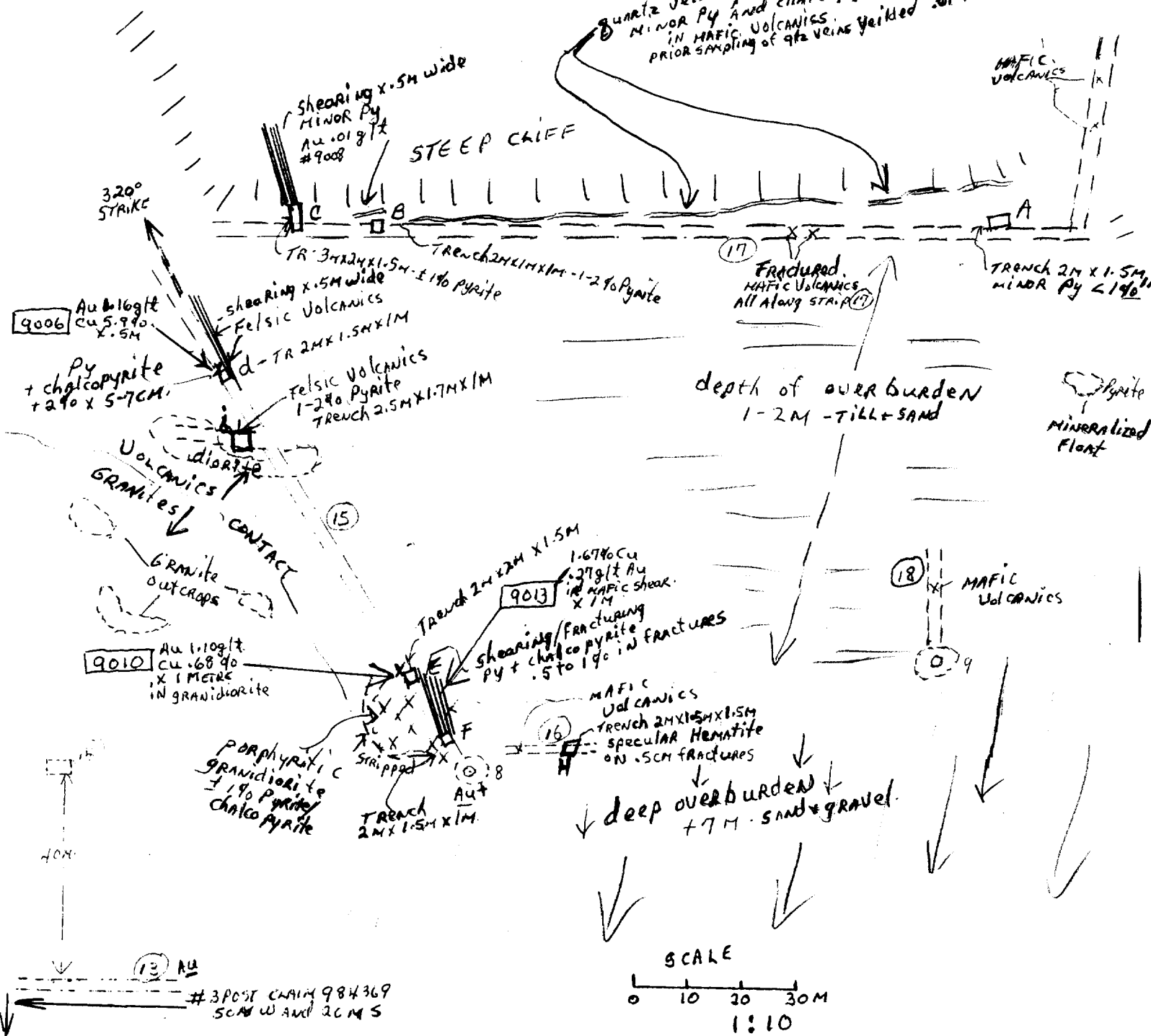

SCALE

0 10 20 30M

1:10

(13) Au
#3 POST CLAIM 984369
5CM W AND 2CM S

NORTH AST

DETAIL MAP OF STRIPPING, TRENCHING, SAMPLING

LEGEND:

- X SAMPLE LOCATION - GRAB SAMPLES
- ▲ CHIP SAMPLE Δ --- Δ CHANNEL SAMPLE
- (S) --- STRIPPING - AVERAGE DEPTH 1.7M
- [8] TRENCHING - AVERAGE DEPTH 1.5M
- 5 (O) - deep pit in till + gravel
3M x 4M x 7M

DETAIL MAP NO. 6

REFER TO LOCATION MAP NO. 2

TOWNSHIP HUTTEN
CLAIM NO. 1042861

AREA 2
BLACK CREEK PROJECT

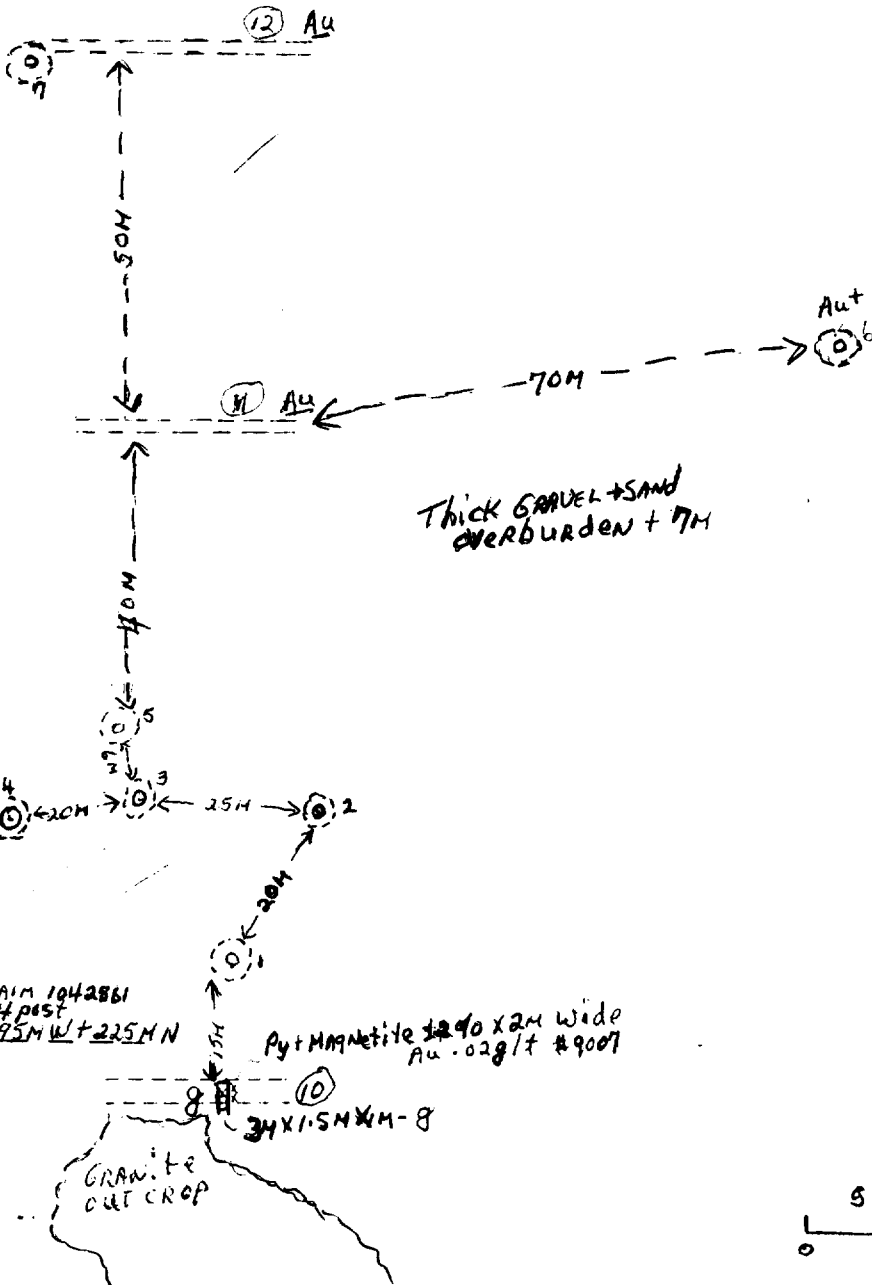



Swastika Laboratories

A Division of TSL/Assayers Inc.

Assaying - Consulting - Representation

Established 1928

Geochemical Analysis Certificate

7W-3127-SG1

Company: **J. BRADY**

Date: AUG-15-97

Project:

Attn: J. Brady

AREA 2 - LOCATION MAP 2

We hereby certify the following Geochemical Analysis of 31 Soil samples submitted AUG-04-97 by .

* NOTE All samples from TILL OR GRAVEL were sluiced & concentrated to ± 20% All samples above 10 PPB plotted on DETAIL MAPS 5 AND 6

Sample Number	Designation on Detail Maps 5 & 6	Au PPB	Au Check PPB	LOCATION
122601		5	10	TR (14)
122602		7	-	" "
122603	Au	<u>24</u>	10	TR (13) EAST side - upper 1M
122604		5	-	" CENTRE "
122605		3	-	" West side "
122606	Au	<u>10</u>	-	TR (13) EAST side "
122607		2	-	TR (13) CENTRE "
122608		5	-	TR (13) Pit 7 - West side "
122609	Au	<u>34</u>	-	TR (11) EAST side "
122610		5	-	" CENTRE "
122611		7	-	" West side "
122612	Au +	<u>300</u>	321	Pit 8 - upper 1M
122613		2	-	" 2-3M depth
122614		3	-	" 4-6M depth
122615		9	7	Pit 5 - upper 2M
122616		3	-	Pit 5 - 3-6M depth
122617		5	-	Pit 3 - upper 2M
122618		3	-	Pit 3 - 3-6M depth
122619		Nil	-	Pit 4 - upper 2M
122620		2	-	" 3-6M depth
122621		5	-	Pit 2 - upper 2M
122622		2	-	" 3-6M depth
122623		7	-	Pit 1 - upper 2M
122624		2	-	" 3-6M depth
122625		5	-	TR (10) - TILL - E side - upper 1M
122626		2	-	TR (10) - TILL W side "
122627		6	-	Pit 9 - upper 2M
122628		2	-	" 3-6M depth
122629		6	-	TR (10) upper 1M - TILL
122630		3	-	Pit 8 - upper 2M
122631	Au +	<u>405</u>	533	Pit 8 - 3-6M depth

2. 18128



41158Z02 2.18128 AYMER

020

Since there was insufficient -80 mesh material available, the -40 mesh fraction was used for assay.

Certified by G. Lebl



Swastika Laboratories

A Division of TSL/Assayers Inc.

Assaying - Consulting - Representation

Established 1928

Assay Certificate

7W-4035-RA1

Company: **J. BRADY**

Date: OCT-21-97

Project:

Att: J. Brady

We hereby certify the following Assay of 20 Rock samples submitted OCT-13-97 by .

OBJECT REF	Sample Number	DETAIL MAP LOCATION	Au g/tonne	Au Check g/tonne	Au 2nd g/tonne	Cu PPM	Pt PPB	Multi Element
1-d	9009	1-d TR (R1)	0.01	-	-	-	-	- .5M chip sample
2	9010	DETAIL MAP 5 - TRENCH E	1.10	1.23	-	6820	-	- 1M chip sample
2-A	9011	DETAIL MAP 1 - TRENCH 1	0.01	-	-	-	-	- GRAB
1-A	9012	DETAIL MAP 2 - TRENCH 4	0.01	-	-	-	-	- 1 METRE chip sample
2	9013	DETAIL MAP 5 - TRENCH E to F	0.27	-	-	16700	-	- 1 METRE chip sample
1-B	9014	DETAIL MAP 3 - STRIP "H"	0.01	-	-	-	-	- GRAB
2-B	9032	DETAIL MAP 3 TRENCH 6	1.65	-	-	-	-	- GRAB - composite of 2 quartz veins
1-E	9033	DETAIL MAP 4 - TRENCH 7	1.44	-	-	-	-	- 1.5M channel sample
1-C	9034	" " " " " "	2.67	2.57	-	-	-	- 1M " "
1-C	9035	" " " " " "	4.90	5.45	4.56	-	-	- 1.5M composite chip sample
1-C	9036	DETAIL MAP 4 TR 8	0.06	-	-	-	-	- 1M " " " "
1-C	9037	" " " TR 7 - S END	0.02	-	-	-	-	- .5M chip sample
1-B	9038	DETAIL MAP 3 - STRIP "L"	0.19	-	-	-	-	- GRAB
1-A	9039	DETAIL MAP 2 TR 3	0.01	-	-	-	-	- GRAB
	9040	" " " STRIP "L" - shear	0.04	-	-	-	-	- GRAB
1-A	9041	DETAIL MAP 1 - TR 2	0.02	-	-	-	-	- GRAB
1-A	9042	" " " STRIP A	0.01	-	-	-	-	- GRAB
1-d	9043	1-d - TR (R2)	0.04	-	-	-	-	- GRAB
1-A	9044	DETAIL MAP 2 TRS	0.08	-	-	-	-	- GRAB
1-A	9045	" " " TR 3	4.11	6.62	-	-	-	<10 GRAB - 1.5 METRE chip sample

One assay ton portion used.

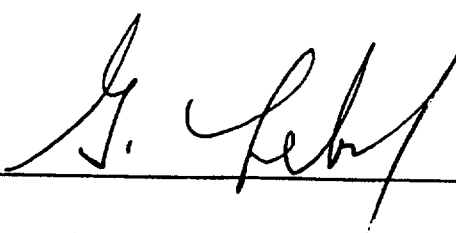
Certified by 



Swastika Laboratories

A Division of TSL/Assayers Inc.

Assaying - Consulting - Representation

Established 1928

Assay Certificate

7W-3126-RA1

Company: **J. BRADY**

Date: AUG-07-97

Project:

Attn: J. Brady

We hereby certify the following Assay of 2 Rock samples *AREA 2 - LOCATION MAP 2* submitted AUG-04-97 by

LOCATION MAP 2 - HOLLOW TOP - AREA 2 - BLACK CREEK

Sample Number	Location	Au g/tonne	Au Check g/tonne	Pd PPB	Multi Element
9007	<i>DETAIL MAP 6 TRENCH</i>	0.02	0.02	-	<i>Pyrite/magnetite in altered granite</i>
9008	<i>DETAIL MAP 5 - TRENCH C</i>	0.01	-	<5	<i>pyrite in sheared mafic volcanics</i>

One assay ton portion used.

Certified by

J. BRADY

ATTN: J. Brady

SAMPLE: ROCK

7U-3126-RA1

1270 PEWSTER DRIVE, UNIT 3, MISSISSAUGA ONTARIO L4W 1A4

PHONE #: (905) 602-8236

FAX #: (905) 206-0513

REPORT No. : M9145

Page No. : 1 of 1

File No. : AU07MA.DW

Date : AUG-11-1997

I.C.A.P. PLASMA SCAN

Aqua-Regia Digestion

SAMPLE #

Ag	Al	As	B	Ba	Be	Bi	Ca	Cd	Co	Cr	Cu	Fe	Mg	Mn	Mo	Na	Ni	P	Pb	Sb	Sc	Sn	Sr	Ti	V	W	Y	Zn	Zr
ppm	%	ppm	ppm	ppm	ppm	ppm	%	ppm	ppm	ppm	ppm	%	%	ppm	ppm	%	ppm	ppm	ppm	ppm	ppm	ppm	ppm	ppm	ppm	ppm	ppm	ppm	ppm
1	1.88	< 5	< 10	29	< 1	< 5	0.88	1	28	478	45	3.75	0.71	242	< 2	0.06	132	1824	57	< 5	3	< 10	43	1302	85	< 10	7	70	27

9008-DATA-NEW S.T.R.C

.5 gm sample is digested with 2 ml of 3:1 HCL/HNO3
: 95 C for 90 min and diluted to 10 ml with DI H2O
is method is partial for many oxide materials

8/97

SIGNED : Paul Magill

J. BRADY
ATTN: J. BRADY

TSL\ASSAYERS Laboratories
1270 FEWSTER DRIVE, UNIT 3, MISSISSAUGA ONTARIO L4W 1A4
PHONE #: (905) 602-8236 FAX #: (905) 206-0513

REPORT No. : **M9463**
Page No. : 1 of 1
File No. : OC28MA
Date : NOV-01-1997

I.C.A.P. PLASMA SCAN
Aqua-Regia Digestion

7W-4035-RA1

SAMPLE #	Ag	Al	As	B	Ba	Be	Bi	Ca	Cd	Co	Cr	Cu	Fe	Mg	Mn	Mo	Na	Ni	P	Pb	Sb	Sc	Sn	Sr	Ti	V	W	Y	Zn	Zr
	ppm	%	ppm	ppm	ppm	ppm	ppm	%	ppm	ppm	ppm	ppm	%	%	ppm	ppm	%	ppm	ppm	ppm	ppm	ppm	ppm	ppm	ppm	ppm	ppm	ppm	ppm	ppm
9033	< 1	0.41	9999	< 10	< 1	< 1	< 5	0.11	233	18	185	328	17.72	0.17	137	< 2	0.02	59	470	15	< 5	< 1	< 10	4	37	17	< 10	6	5	< 1
9034	< 1	0.35	9999	< 10	< 1	< 1	< 5	0.22	454	22	186	269	24.10	0.17	152	< 2	0.01	45	832	17	< 5	< 1	< 10	7	74	9	< 10	7	4	< 1
9035	< 1	0.23	9999	< 10	10	< 1	< 5	0.15	928	5	168	161	18.52	0.07	212	< 2	0.01	57	606	25	15	< 1	< 10	10	25	< 1	30	6	5	< 1
9038	< 1	0.31	8755	< 10	< 1	< 1	< 5	0.63	71	58	226	37	12.95	0.17	633	< 2	0.03	72	302	7	< 5	4	< 10	14	7	18	< 10	7	6	16
9041	< 1	0.06	390	< 10	7	< 1	< 5	0.07	5	28	395	7	20.64	0.02	204	< 2	0.01	21	58	< 1	< 5	1	< 10	3	15	75	< 10	4	2	< 1
9042	< 1	0.05	115	< 10	5	< 1	< 5	0.01	< 1	17	495	4	8.61	< 0.01	50	< 2	0.02	18	16	< 1	< 5	2	< 10	2	12	53	< 10	< 1	3	< 1
9045	< 1	0.61	75	< 10	8	< 1	< 5	0.23	< 1	18	174	71	8.37	0.13	1595	< 2	0.03	171	328	8	< 5	15	< 10	7	68	43	< 10	16	11	14

A .5 gm sample is digested with 2 ml of 3:1 HCL/HNO3 at 95 C for 120 min and diluted to 10 ml with DI H2O. This method is partial for many oxide materials.

SIGNED :

John Maguire



Swastika Laboratories

A Division of TSL/Assayers Inc.

Assaying - Consulting - Representation

Established 1928

Assay Certificate

7W-3048-RA1

Company: **J. BRADY**

Date: JUL-30-97

Project:

Attn: J. Brady

We hereby certify the following Assay of 1 Rock samples submitted JUL-28-97 by .

AREA 2 - LOCATION MAP 2

Sample Number	LOCATION	Au g/tonne	Au Check g/tonne	Co PPM	Cu %	Pd PPB
9006	<i>DETML MAP 5 TRENCH d</i>	1.16	1.20	100	5.91	<i>< 5 .5 metre channel sample in sheared mafic uccs</i>

One assay ton portion used.

Certified by *Denis Chantre*



Ministry of Northern Development and Mines

Declaration of Assessment Work Performed on Mining Land

Mining Act, Subsection 65(2) and 66(3), R.S.O. 1990

Transaction Number (office use) W9840.0004
Assessment Files Research Imaging



41115SW2002 2.18128 AYLME 900

ity of subsections 65(2) and 66(3) of the Mining Act. Under section 8 of the Act, you are required to review the assessment work and correspond with the mining land holder. Contact the Mining Recorder, Ministry of Northern Development and Mines, 6th Floor, 100 King Street West, Toronto, Ontario M5X 1C5.

Instructions: - For work performed on Crown Lands before recording a claim, use form 0240.
- Please type or print in ink.

2.18128

1. Recorded holder(s) (Attach a list if necessary)

Name John Brady	Client Number 111562
Address 1227 Holland Rd. Sudbury, ONT. P3A3R1	Telephone Number 5254129
	Fax Number
Name	Client Number
Address	Telephone Number
	Fax Number

2. Type of work performed: Check (✓) and report on only ONE of the following groups for this declaration.

- Geotechnical: prospecting, surveys, assays and work under section 18 (regs) Physical: drilling, stripping, trenching and associated assays Rehabilitation

Work Type	Office Use
	Commodity
	Total \$ Value of Work Claimed 48,850
Dates Work Performed From 20 Day 05 Month 97 Year To 05 Day 11 Month 97 Year	NTS Reference
Global Positioning System Data (if available)	Mining Division Sudbury
Township/Area See report	Resident Geologist District Sudbury
M or G-Plan Number See report	

Please remember to: - obtain a work permit from the Ministry of Natural Resources as required;
- provide proper notice to surface rights holders before starting work;
- complete and attach a Statement of Costs, form 0212;
- provide a map showing contiguous mining lands that are linked for assigning work;
- include two copies of your technical report.

3. Person or companies who prepared the technical report (Attach a list if necessary)

Name John Brady	Telephone Number (705) 5254129
Address 1227 Holland Rd. Sudbury, ONT. P3A3R1	Fax Number
Name	Telephone Number
Address	Fax Number
Name	Telephone Number
Address	Fax Number

RECEIVED

FEB - 2 1998 *JP*

GEOSCIENCE ASSESSMENT OFFICE

4. Certification by Recorded Holder or Agent

I, **John Brady** (Print Name), do hereby certify that I have personal knowledge of the facts set forth in this Declaration of Assessment Work having caused the work to be performed or witnessed the same during or after its completion and, to the best of my knowledge, the annexed report is true.

Signature of Recorded Holder or Agent <i>John Brady</i>	Date Deemed May 3/98	Date Feb 2/98
Agent's Address 1227 Holland Rd. Sudbury, ONT.	Telephone Number 705-5254129	Fax Number



Personal information collected on this form is obtained under the authority of subsection 6(1) of the Assessment Work Regulation 6/96. Under section 8 of the Mining Act, the information is a public record. This information will be used to review the assessment work and correspond with the mining land holder. Questions about this collection should be directed to the Chief Mining Recorder, Ministry of Northern Development and Mines, 6th Floor, 933 Ramsey Lake Road, Sudbury, Ontario, P3E 6B5.

2.18128

Work Type	Units of Work Depending on the type of work, list the number of hours/days worked, metres of drilling, kilometres of grid line, number of samples, etc.	Cost Per Unit of work	Total Cost
* Labour (sampling)	3 days (Aver 10h/day)	100	300
* Labour- ^{Prospecting, stripping} trending, mucking, washing, sampling etc	173 days (Aver 12h/day)	150	25,950
* Equipment Rentals	gas drills/steel/gas, ATU, pumps Excavators		15,388
* Labour, Equipment rentals etc ARE summarized by dates/hours/rates etc in "Summary of Costs" sheets (AREAS 1 and 2) in attached report			
Associated Costs (e.g. supplies, mobilization and demobilization).			
(From 65 samples taken) 54 ASSAYS			
TRANSPORT samples by bus		VARIOUS	464
Transportation Costs			48
7900KM		@ 40	3160
Food and Lodging Costs 177 person days		@ 20.00	3540
RECEIVED			
FEB - 2 1998 <i>J.P.</i>			
GEOSCIENCE ASSESSMENT OFFICE		Total Value of Assessment Work	48,850.

Calculations of Filing Discounts:

1. Work filed within two years of performance is claimed at 100% of the above Total Value of Assessment Work.
2. If work is filed after two years and up to five years after performance, it can only be claimed at 50% of the Total Value of Assessment Work. If this situation applies to your claims, use the calculation below:

TOTAL VALUE OF ASSESSMENT WORK $\times 0.50 =$ Total \$ value of worked claimed.

Note:

- Work older than 5 years is not eligible for credit.
- A recorded holder may be required to verify expenditures claimed in this statement of costs within 45 days of a request for verification and/or correction/clarification. If verification and/or correction/clarification is not made, the Minister may reject all or part of the assessment work submitted.

Certification verifying costs:

I, John Brady (please print full name), do hereby certify, that the amounts shown are as accurate as may reasonably be determined and the costs were incurred while conducting assessment work on the lands indicated on the accompanying Declaration of Work form as Recorded Holder I am authorized (recorded holder, agent, or state company position with signing authority) to make this certification.

Signature: J Brady Date: Nov 27/97.

Ministry of
Northern Development
and Mines

Ministère du
Développement du Nord
et des Mines



Geoscience Assessment Office
933 Ramsey Lake Road
6th Floor
Sudbury, Ontario
P3E 6B5

Telephone: (888) 415-9846
Fax: (705) 670-5881

May 21, 1998

JOHN GREGORY BRADY
1227 HOLLAND ROAD
SUDBURY, Ontario
P3A-3R1

Visit our website at:
www.gov.on.ca/MNDM/MINES/LANDS/mlsmnpge.htm

Dear Sir or Madam:

Submission Number: 2.18128

Status

Subject: Transaction Number(s): W9870.00014 Approval After Notice

We have reviewed your Assessment Work submission with the above noted Transaction Number(s). The attached summary page(s) indicate the results of the review. **WE RECOMMEND YOU READ THIS SUMMARY FOR THE DETAILS PERTAINING TO YOUR ASSESSMENT WORK.**

If the status for a transaction is a 45 Day Notice, the summary will outline the reasons for the notice, and any steps you can take to remedy deficiencies. The 90-day deemed approval provision, subsection 6(7) of the Assessment Work Regulation, will no longer be in effect for assessment work which has received a 45 Day Notice. Allowable changes to your credit distribution can be made by contacting the Geoscience Assessment Office within this 45 Day period, otherwise assessment credit will be cut back and distributed as outlined in Section #6 of the Declaration of Assessment work form.

Please note any revisions must be submitted in **DUPLICATE** to the Geoscience Assessment Office, by the response date on the summary.

If you have any questions regarding this correspondence, please contact Steve Beneteau by e-mail at benetest@epo.gov.on.ca or by telephone at (705) 670-5855.

Yours sincerely,

A handwritten signature in black ink, appearing to read "Blair Kite".

ORIGINAL SIGNED BY
Blair Kite
Supervisor, Geoscience Assessment Office
Mining Lands Section

Work Report Assessment Results

Submission Number: 2.18128

Date Correspondence Sent: May 21, 1998

Assessor: Steve Beneteau

Transaction Number	First Claim Number	Township(s) / Area(s)	Status	Approval Date
W9870.00014	1222831	CAPREOL, NORMAN, RATHBUN, AYLMER ✓ <i>PARKIN, HUTTON</i>	Approval After Notice	May 20, 1998

Section:

9 Prospecting PROSP

10 Physical PSTRIP

10 Physical PTRNCH

Thank you for the prompt response to the 45 Day Notice dated May 01, 1998. The submitted material has corrected all deficiencies associated with this submission. Accordingly, assessment work has been approved as outlined on the Report of Work form that accompanied this submission.

Correspondence to:

Resident Geologist
Sudbury, ON

Recorded Holder(s) and/or Agent(s):

JOHN GREGORY BRADY
SUDBURY, Ontario

Assessment Files Library
Sudbury, ON

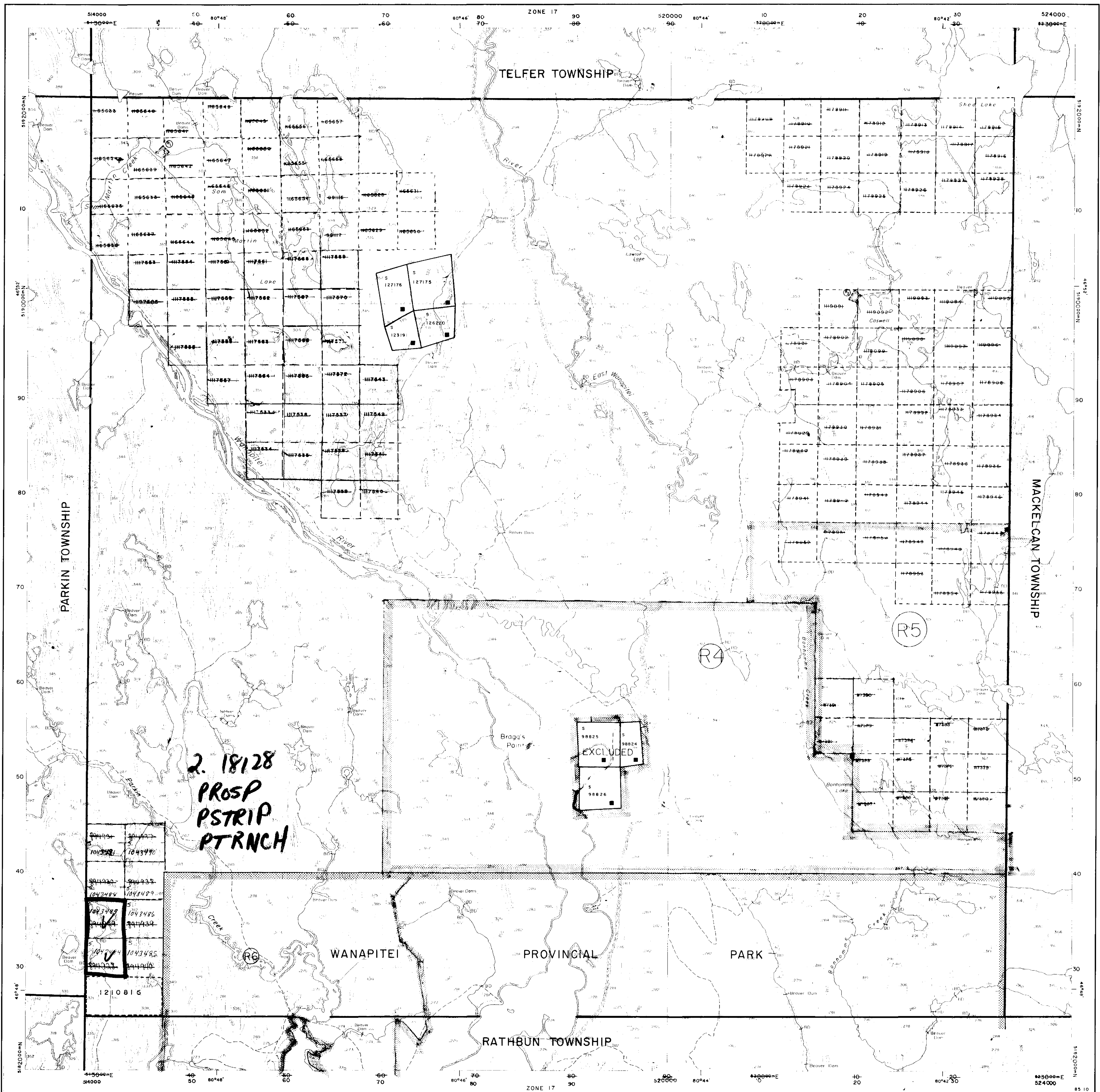

INDEX TO LAND DISPOSITION

PLAN
G - 2901
TOWNSHIP
AYLMER

M. N. R. ADMINISTRATIVE DISTRICT
SUBURRY
MINING DIVISION
SUBURRY
LAND TITLES/REGISTRY DIVISION
SUBURRY

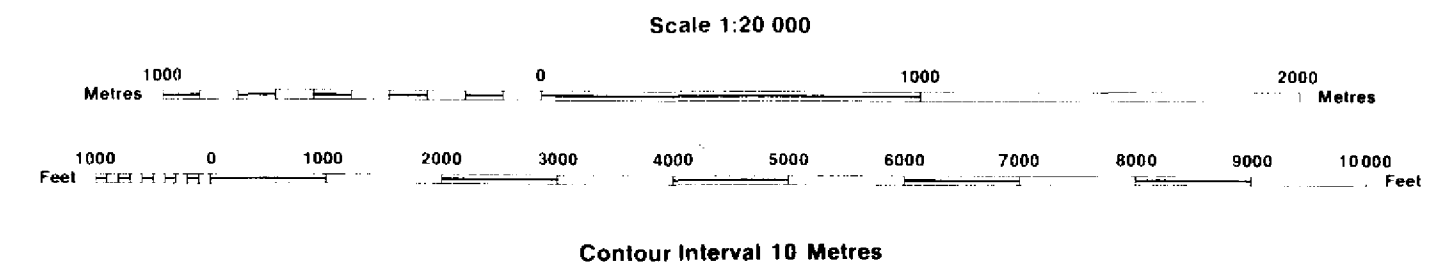

AREAS WITHDRAWN FROM DISPOSITION

MRO - Mining Rights Only
SRO - Surface Rights Only
M + S - Mining and Surface Rights

Description	Order No.	Date	Disposition	File
(R1) PUBLIC ACCESS		1/6/83	S.R.O.	
(R2) PUBLIC ACCESS		1/6/83	S.R.O.	
(R3) RESERVATION	W-6-44/83	8/6/83	S & M	09050
	O-5-24/83	28/07/83	S & M	195150
(R4) WITHDRAWAL	W-5-46/83	28/07/83	S & M	195150
(R5) WITHDRAWAL	W-3-100/84	01/02/84	S & M	195150
(R6) SEC. 36/80	W-8-11/87	01/11/87	S & M	195150
(R6) EXPLORATORY LICENCE OF OCCUPATION				14827

SYMBOLS

Boundary	—————
Township, Meridian, Baseline	—————
Road allowance: surveyed	—————
shoreline	~~~~~
Lot/Concession: surveyed	—————
unsurveyed	-----
Parcel: surveyed	—————
unsurveyed	-----
Right-of-way: road	—————
railway	—————
utility	—————
Reservation
Chf. Pt. Pile
Contour
Interpolated
Approximate
Depression
Control point (horizontal)
Flooded land
Mine head frame
Pipeline (above ground)
Railway: single track
double track
abandoned
Road: highway, county, township
access
trail, bush
Shoreline (original)
Transmission line
Wooded area

DATE OF ISSUE
MAY 22 1998
PROVINCIAL RECORDING
OFFICE - SUBURRY

DISPOSITION OF CROWN LANDS

Patent
Surface & Mining Rights
Surface Rights Only
Mining Rights Only
Lease
Surface & Mining Rights
Surface Rights Only
Mining Rights Only
Licence of Occupation
Order-in-Council
Cancelled
Reservation
Sand & Gravel

THE INFORMATION THAT APPEARS ON THIS MAP HAS BEEN COMPILED FROM VARIOUS SOURCES AND ACCURACY IS NOT GUARANTEED. THOSE WISHING TO STAKE MINING CLAIMS SHOULD CONSULT WITH THE MINING RECORDER, MINISTRY OF NORTHERN DEVELOPMENT AND MINES FOR ADDITIONAL INFORMATION ON THE STATUS OF THE LANDS SHOWN HEREON.

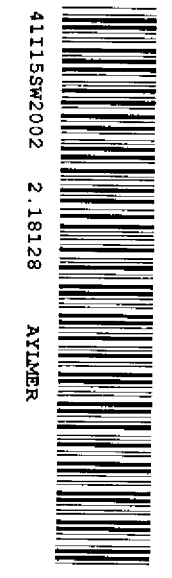

INDEX TO LAND DISPOSITION

PLAN
G-4066
 TOWNSHIP
HUTTON

M.N.R. ADMINISTRATIVE DISTRICT
SUBURRY
 MINING DIVISION
SUBURRY
 LAND TITLES/REGISTRY DIVISION
SUBURRY
DATE OF ISSUE
 MAR 27 1998
PROVINCIAL RECORDING
OFFICE - SUBURRY

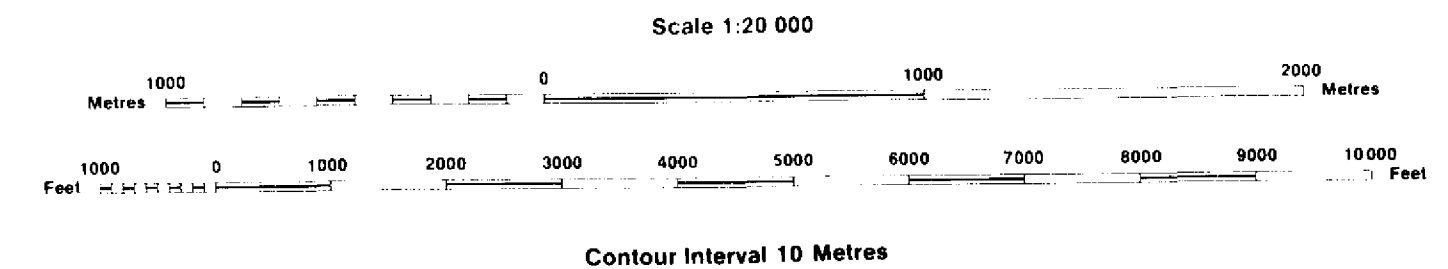

AREAS WITHDRAWN FROM DISPOSITION

Description	Order No.	Date	Disposition	File
MRO - Mining Rights Only				
SRO - Surface Rights Only				
M + S - Mining and Surface Rights				

SYMBOLS

Boundary	—
Township, Meridian, Baseline	—
Road allowance; surveyed	—
shoreline	—
Lot/Concession; surveyed	—
unsurveyed	—
Parcel; surveyed	—
unsurveyed	—
Right-of-way; road	—
railway	—
utility	—
Reservation	—
Cliff, Pit, Pile	—
Contour	—
Interpolated	—
Approximate	—
Depression	—
Control point (horizontal)	—
Flooded land	—
Mine head frame	—
Pipeline (above ground)	—
Railway; single track	—
double track	—
abandoned	—
Road; highway, county, township	—
access	—
trail, bush	—
Shoreline (original)	—
Transmission line	—
Wooded area	—

NOTE

LOTS 1 TO 6, CONCESSIONS 1 TO 6 MAY BE STAKED IN THE SAME MANNER AS MINING CLAIMS IN UNSURVEYED TERRITORY MAY 16, 1946—FILE 63.5—MINING ACT SEC. 45 R.S.O. 1980 (52 A 1946)

LAND REQUIRED FOR RAILWAY PURPOSES SHOWN THUS
 FILES 4825 & 4841

PARTS OF CON. 1, 2, 4, 5 & 6 SUBDIVISION ANNULLED.

DISPOSITION OF CROWN LANDS

Patent	●
Surface & Mining Rights	○
Surface Rights Only	○
Mining Rights Only	○
Lease	■
Surface & Mining Rights	■
Surface Rights Only	■
Mining Rights Only	■
Licence of Occupation	○
Order-in-Council	OC
Cancelled	⊙
Reservation	⊙
Sand & Gravel	⊙
LAND USE PERMIT	◇
Placer Claim	PC

THE INFORMATION THAT APPEARS ON THIS MAP HAS BEEN COMPILED FROM VARIOUS SOURCES, AND ACCURACY IS NOT GUARANTEED. THOSE WISHING TO STAKE MINING CLAIMS SHOULD CONSULT WITH THE MINING RECORDER, MINISTRY OF NORTHERN DEVELOPMENT AND MINES, FOR ADDITIONAL INFORMATION ON THE STATUS OF THE LANDS SHOWN HEREON.

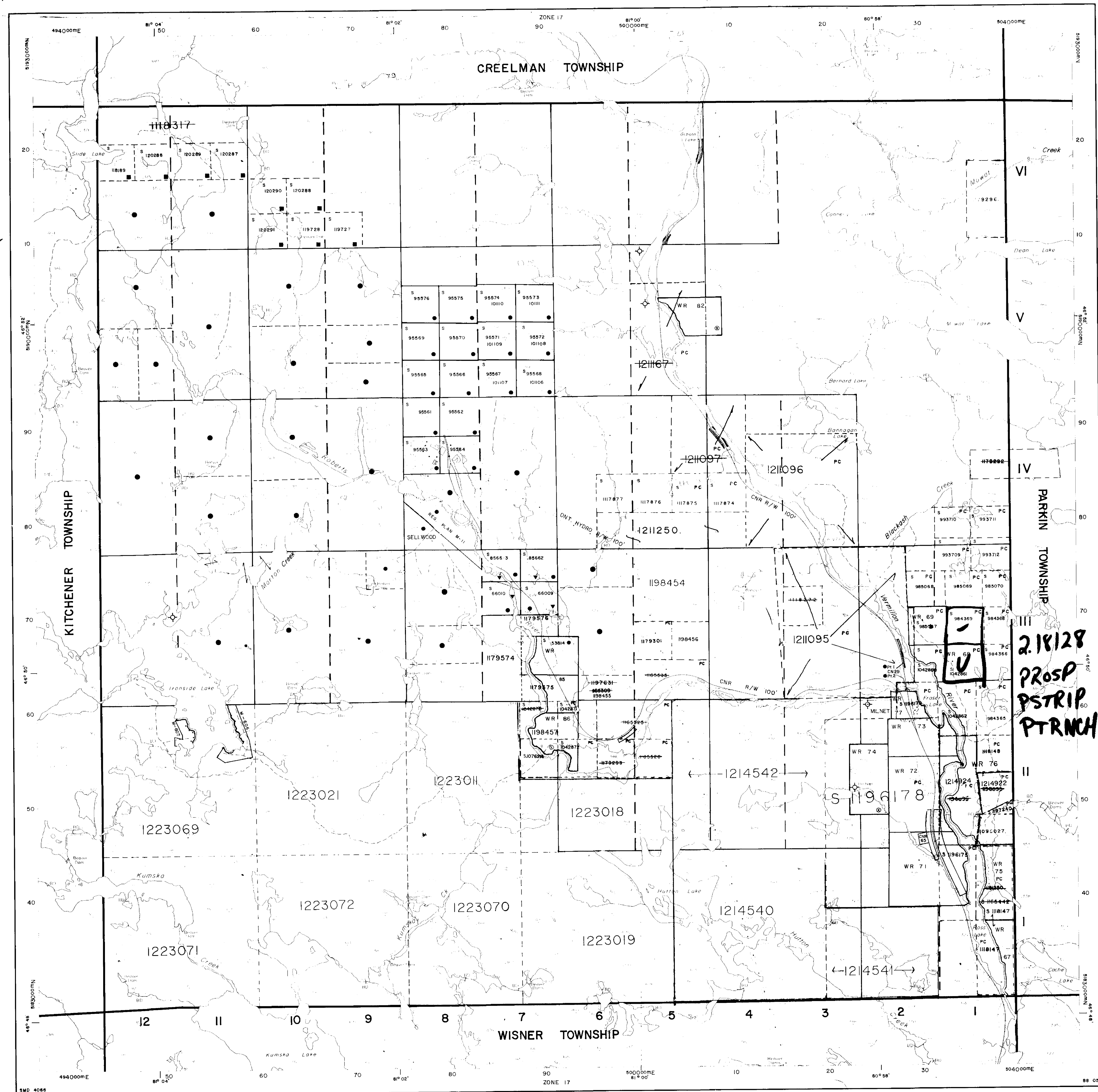

100-1000
100-1000
100-1000
100-1000

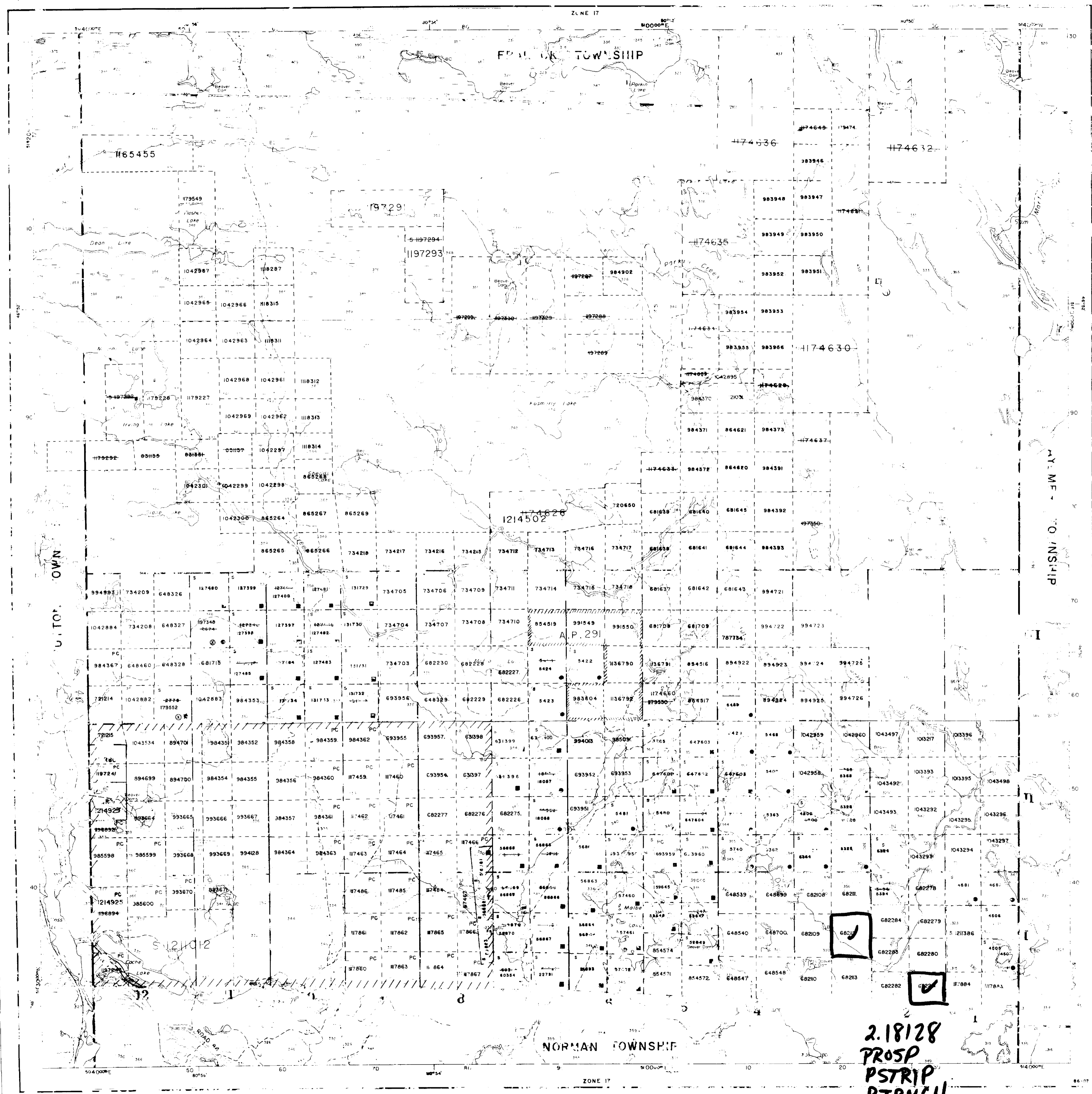

PUT INTO SERVICE MARCH 18, 1994

FRANK TOWNSHIP

PLAN 218128

PROSP

PSTRIP

PTRNCH

DATE OF ISSUE
MAY 25 1998
PROVINCIAL RECORDING OFFICE - SUDBURY

SYMBOLS

LEGEND

AREAS WITHDRAWN FROM DISPOSITION

DATE OF ISSUE
MAY 25 1998
PROVINCIAL RECORDING OFFICE - SUDBURY

DESCRIPTION OF TOWNSHIP LANDS

NOTICE

IN AREA MARKED THUS [diagonal lines] STAKING ALLOWED

AS IN UNSUBDIVIDED TOWNSHIP

THE INFORMATION THAT APPEARS ON THIS MAP HAS BEEN COMPILED FROM VARIOUS SOURCES AND ACCURACY IS NOT GUARANTEED. THOSE WISHING TO STAKE MINING CLAIMS SHOULD CONSULT WITH THE MINING RECORDER, MINISTRY OF NORTHERN DEVELOPMENT AND MINES FOR ADDITIONAL INFORMATION ON THE STATUS OF THE LANDS SHOWN HEREON.

THE DISPOSAL OF LAND, LOCATION OF LOT BOUNDARIES AND SURFACE BOUNDARIES ON THIS INDEX WAS COMPILED FOR ADMINISTRATIVE PURPOSES ONLY.

100-1000
100-1000
100-1000
100-1000

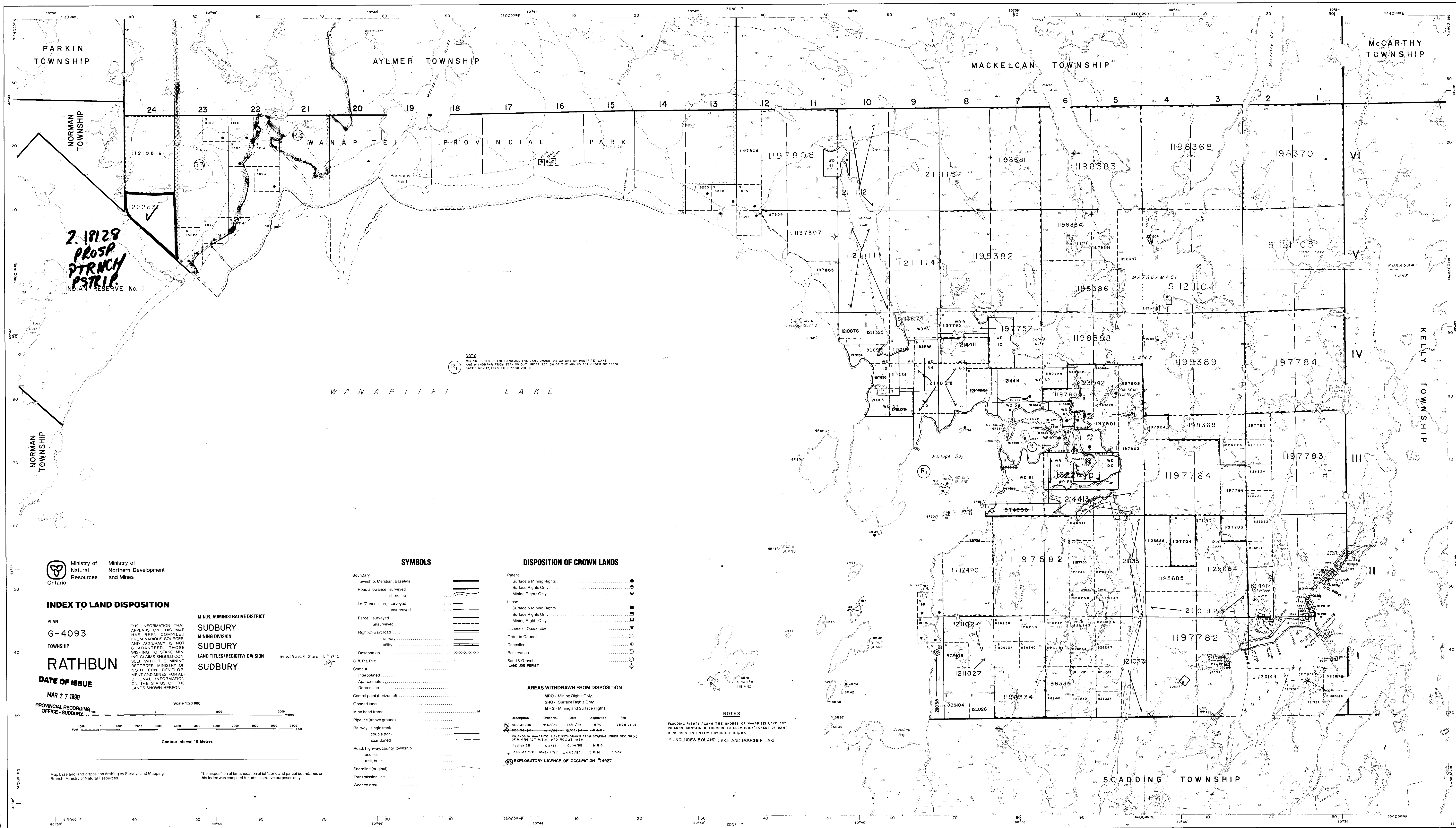

2. 19128
PROSP
STRICH
PSTRIP.
INDIAN RESERVE No. 11

NOTE
MINING RIGHTS OF THE LAND AND THE LAND UNDER THE WATERS OF WANAPITEI LAKE
WAS WITHDRAWN FROM DISPOSITION UNDER SEC 36 OF THE MINING ACT, ORDER NO. 67/76
DATED NOV. 17, 1976 FILE T596 00.5

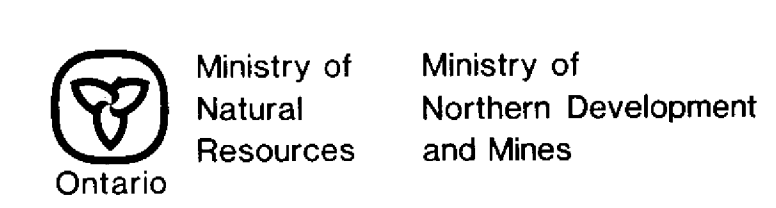

INDEX TO LAND DISPOSITION

PLAN
G-4093
TOWNSHIP
RATHBUN
DATE OF ISSUE
MAR 27 1998
PROVINCIAL RECORDING
OFFICE - SUDBURY

M.N.R. ADMINISTRATIVE DISTRICT
SUDBURY
MINING DIVISION
SUDBURY
LAND TITLES/REGISTRY DIVISION
SUDBURY

IN SERVICE SINCE 16th 1912

THE INFORMATION THAT APPEARS ON THIS MAP HAS BEEN COMPILED FROM VARIOUS SOURCES AND ACCURACY IS NOT GUARANTEED. THOSE WISHING TO STAKE MINING CLAIMS SHOULD CONSULT WITH THE MINING RECORDER, MINISTRY OF NORTHERN DEVELOPMENT AND MINES, FOR ADDITIONAL INFORMATION ON THE STATUS OF THE LANDS SHOWN HEREON.

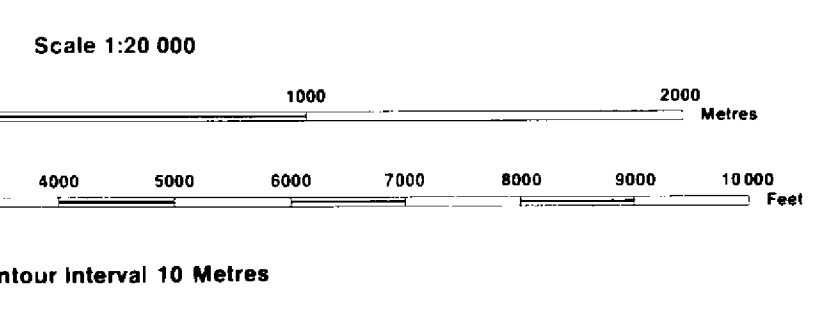

SYMBOLS

Boundary
Township, Meridian, Baseline
Road allowance, surveyed
shoreshline
Lot/Concession, surveyed
unsurveyed
Parcel, surveyed
unsurveyed
Right-of-way, road
railway
utility
Reservation
Cliff, Pit, Pile
Contour
Interpolated
Approximate
Depression
Control point (horizontal)
Flooded land
Mine head frame
Pipeline (above ground)
Railway, single track
double track
abandoned
Road, highway, county, township
access
trail, bush
Shoreline (original)
Transmission line
Wooded area

DISPOSITION OF CROWN LANDS

Patent
Surface & Mining Rights
Surface Rights Only
Mining Rights Only
Lease
Surface & Mining Rights
Surface Rights Only
Mining Rights Only
Licence of Occupation
Order-in-Council
Cancelled
Reservation
Sand & Gravel
LAND USE PERMIT

AREAS WITHDRAWN FROM DISPOSITION

MRO - Mining Rights Only
SRO - Surface Rights Only
M + S - Mining and Surface Rights

Description	Order No.	Date	Disposition	File
SEC. 36/80	W-8774	1971/74	MRO	7592 v41.9
SEC. 36/80	W-8774	1971/74	M + S	
ISLANDS IN WANAPITEI LAKE WITHDRAWN FROM STAKING UNDER SEC. 36(1) OF MINING ACT R.S.O. 1970, NO. 23, 1925				
PLAN 36	02181	10/14/85	M + S	
SEC. 35/80	W-81193	04/17/87	S + M	1955C

EXPLOIATORY LICENCE OF OCCUPATION T4927

NOTES

FLOODING RIGHTS ALONG THE SHORES OF WANAPITEI LAKE AND ISLANDS CONTAINED THEREIN TO ELEV. 100'S (CREST OF DAM) RESERVED TO ONTARIO HYDRO, L.O. 6169.

INCLUDES BOLAND LAKE AND BOUCHER LAKE.

G-4093

