



41155W9703 2.15238 PARKIN

010

JARVIS RESOURCES LTD.
O.M.I.P. DESIGNATION REPORT - 1992

2.15238

Kevin Bullock, P. Eng.

December 2, 1992
Sudbury, Ontario

JARVIS RESOURCES LTD.

Application for Designation Summary Report

The main target of exploration on Jarvis Resources Ltd. claims is a band of Huronian (Espanola) limestone, some of which is now marble.

The Jarvis property is located in central Parkin Township, Sudbury Mining Division, Ontario. The property contains a block of twenty-three (23) contiguous unpatented mining claims, of which Jarvis Resources Ltd. owns a one hundred per cent interest, located twenty-five miles Northeast of Sudbury at latitude 46°54'50" North and longitude 80°55'00" West. Access is north of Capreol via paved highway 545 toward Milnet. Turn Northeast at the Whistle Mine haulage road and proceed 5 miles. Just past the 5-mile sign a small fairweather bushroad turns Northwest and after 2 miles arrives at the property. Road extends miles past property to new property to be worked on.

The claims cover approximately 950 acres. All of the twenty-three (23) claims are subject to a royalty per ton shipped and sold. These claims cover an area of approximately 320 acres and may be further described as: claim numbers S.915491, S.991550, S.983604, S.994013, S.985091, S.1136790, S.1136791, S.1136792. The remaining fifteen (15) claims can be further described as 734215, 734709, 734715, 734216, 734711, 734716, 734217, 734705, 734713, 734718, 734706, 734714 and 854519. In addition to the twenty-three (23) claims, Jarvis Resources Ltd. has been granted exclusive mining rights on five (5) leased claims shown on Map 1. This grantor also retains a per ton royalty.

To describe regional and property geology, refer to excerpts of David W. Constable's O.M.I.P. Summary Report of February 8, 1991:

"Most of Parkin Township is underlain by units of the Huronian Supergroup, which strike Northwest and dip steeply or vertically.

"The first unit exposed at the bottom of the Huronian Supergroup is the Mississagi formation composed of quartzites, argillites and conglomerates of the Bruce formation. This is followed by lenses and bands of Espanola formation limestones with major greywacke units. The quartzites and conglomerates of the serpent formation are the last units in the Bruce group. The Gowganda formation argillites, quartzites and conglomerates and quartzites of the Lorraine formation comprise the Cobalt group".

"Large faults cut and displace the sequences and move large blocks out of sequence. The faults trend Northwest, Northeast, and, less frequently, Westward. The faults do exhibit a curvature".

"The archaean metavolcanic sequence is intensely folded about a north 50 degree west axis. An F2 fold about a north 30 degree east axis is also documented. Huronian folds are more obscure but most of this sequence is folded into a near vertical orientation. The lack of clear marker horizons made fold definition difficult. Clearly, the malleable Espanola limestone has been distorted into wisps and lenses by the fold episode(s)".

From September to October 1990 Jarvis completed diamond drill holes PT-90-1 to 6. From October 27 to November 20, 1990 Jarvis Resources Ltd. completed holes PT-90-7 to 13, inclusive. These holes totalled 2765.5 feet and confirmed and delineated a 200-foot wide marble band. The target area was stripped and blown clean using compressed air. Once exposed the marble was mapped in detail.

From June 18 to December 20, 1991 extensive exploration work was carried out in selected areas, namely claims 854519, 1136790, 647602, and on a newly discovered marble outcropping on claim 734706. Overburden was stripped, and cap rock was removed to better assess the consistency and continuity of the deposit. Large blocks of material were removed for testing and sample preparation. As of December 31, 1991, a total of 7,100 tons of material was removed, leaving approximately 1,100 tons of usable marble intact.

The Company also researched quarrying techniques and equipment, which resulted in the decision to employ belt saws at this stage of pit exploration and block extraction.

Jarvis Resources Ltd. continued its market research during the period, hiring one full-time employee for this purpose, and a student from Ryerson Polytechnical for the summer. Several key trade shows were attended, and stone industry data compiled. Numerous contacts with marble end-users were made, and meetings with major marble distributors held. This was part of the continuing program to ascertain the marketability of Jarvis' marble, and to best establish a marketing niche. Research indicates that any future sales of a marble product would, in the United States, be best achieved via major distributors, and in Canada through direct sales to architects and project developers. With this in mind, the company targeted, and established contact with, two major distributors in the United States, and a knowledgeable agent in Canada.

Based on results to date, Jarvis Resources Ltd. wishes to concentrate mainly on a fourth pit (with regards to exploration) which was uncovered through minor surface sampling. This site on claim number 734706 would update reserves and add to the array of colours already found to date. The company also wants to complete its exploration on Pit #3 by drilling two 250 foot diamond drill holes. Stripping, block removal, sampling and testing was completed on this site in 1991, but no drilling was ever done. Pit numbers 1 and 2 are past the exploration stage and therefore are not considered in this exploration phase. The budget attached to this report breaks down the work to be performed on site #4 along with the 500 feet of diamond drilling on Pit #3. Also, the diamond drilling locations are marked on the attached map.

The estimated start date of this phase is May 17, 1993, and the completion would be December 17, 1993.

Proof of funding will follow and bibliography is attached.



Kevin Bullock, P.Eng.

BUDGET

Parkin Township, Ontario

May 17 to December 17, 1993

Diamond drilling - 2050 feet

Pit #3, 500 feet @ \$13.50/ft..... \$ 6,750.

Pit #4, 1550 feet @ \$13.50/ft..... 20,925.

Surface stripping and tree removal

Pit #4 55,000.

Surface dimension stone removal

Pit #4..... 9,530.

Slot dimension stone removal

Pit #4..... 21,460.

Sample preparation for marketing and
quality testing (A.S.T.M.)

Pit #4..... 6,600.

\$ 120,265.

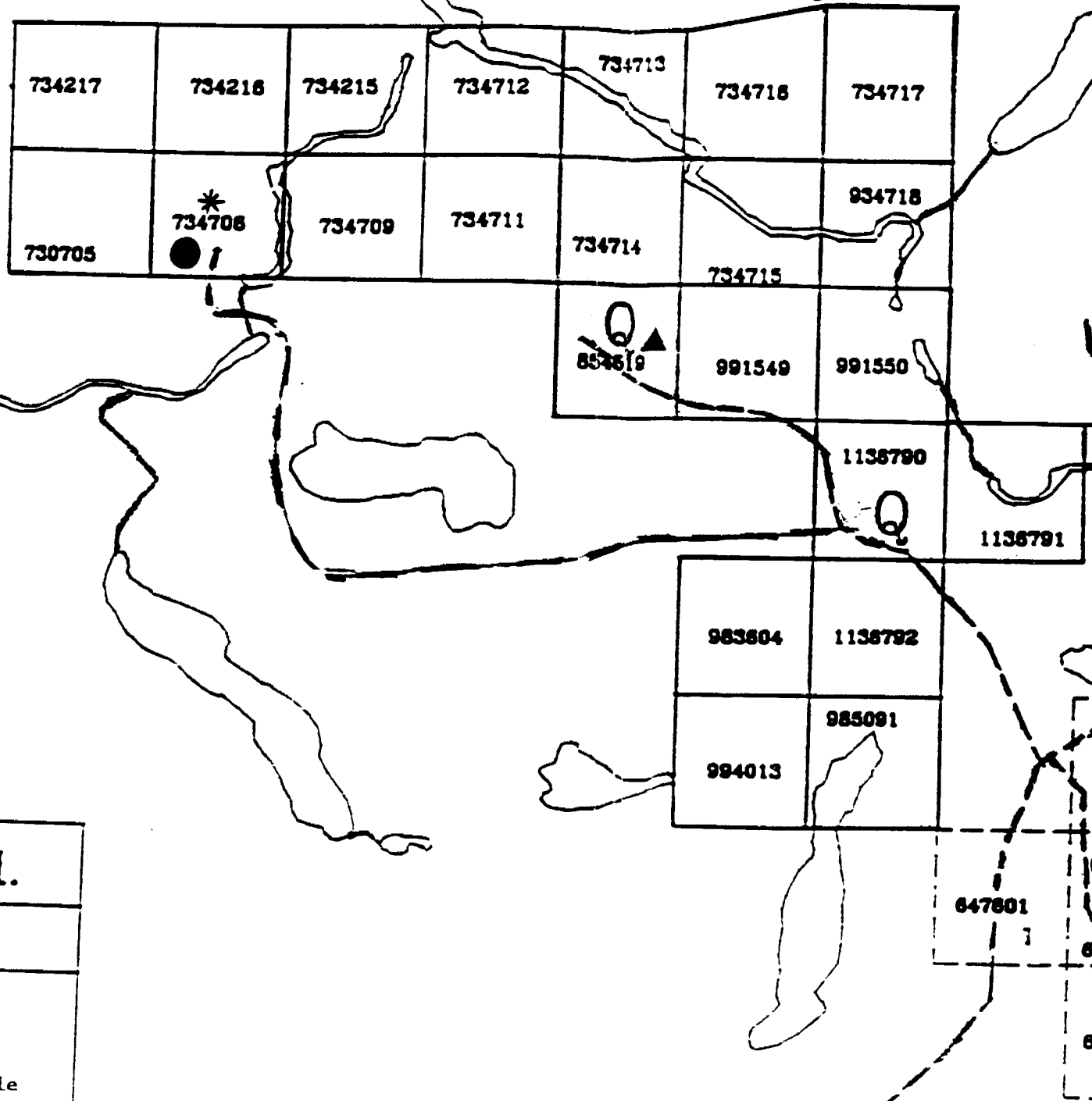

Maibout Lake

Jarvis Resources Ltd.

Parish Twp., On.
MARBLE PROPERTY

LEGEND

- = Leased claim
- = Small creek
- = Gravel Road
- = Jarvis has exclusive right to mine marble deposits
- = Jarvis registered owner
- = Quarry location
- = Target, fourth pit development
- = Site of previous drilling
- = Site of proposed drilling



BIBLIOGRAPHY

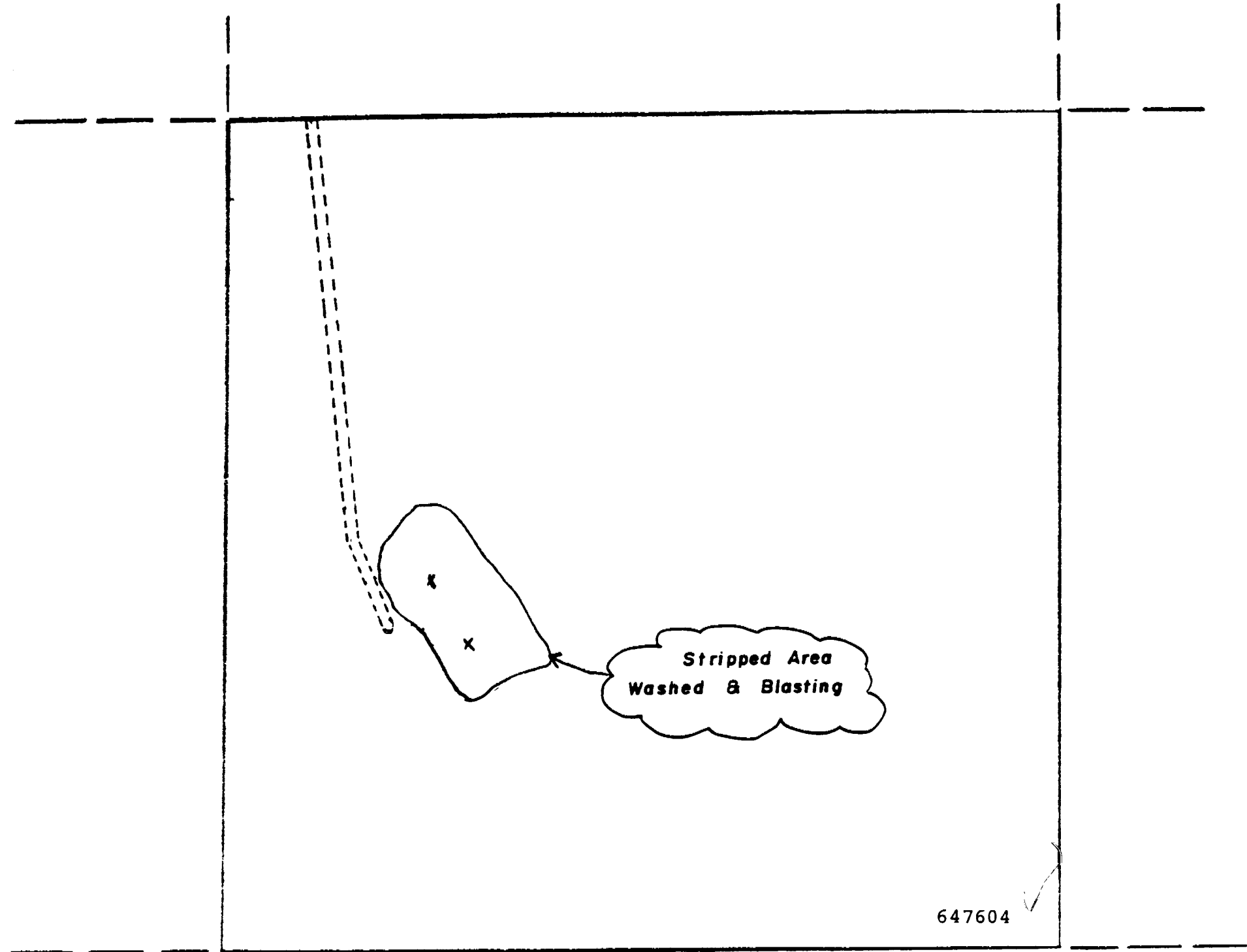

- 1) Constable, D., February 8, 1991, O.M.I.P. SUMMARY REPORT ON THE DIAMOND DRILLING, STRIPPING, BLOCK REMOVAL AND SAMPLE CUTTING AND POLISHING PROGRAM ON THE MARBLE DEPOSIT OF JARVIS RESOURCES LTD. PARKIN TOWNSHIP, SUDBURY MINING DIVISION, ONTARIO.
- 2) Constable, D., March 11, 1991, GEOLOGICAL RESERVE POTENTIAL OF THE MARBLE DEPOSITS ON JARVIS RESOURCES LTD. PARKIN TOWNSHIP PROPERTY, ONTARIO, CANADA.
- 3) Bullock, K., Dupuis, D.A., Jewell, M., February 14, 1992, O.M.I.P. SUMMARY REPORT ON STRIPPING, CAP REMOVAL, BLOCK EXTRACTION AND SAMPLE PREPARATION, JUNE 18, 1991 - DECEMBER 11, 1991, PARKIN TOWNSHIP, ONTARIO.
- 4) Meyer, H.D., 1970. GEOLOGY OF HUTTON AND PARKIN TOWNSHIPS, ODM GEOLOGICAL REPORT 80 (INCLUDES GEOLOGICAL MAP 2180 AT A SCALE OF 1 INCH = $\frac{1}{2}$ MILE).



647604 ✓

x = Block Removal Sites

Jarvis Resources Ltd. Parkin Twp.	
Claim 647604 PIT #3	
Scale : 1" = 200'	Date : Feb. '92
Dwg : KB	

-  GREY TAUPE
-  LIGHT GREEN AND BLACK
-  GREY BLACK

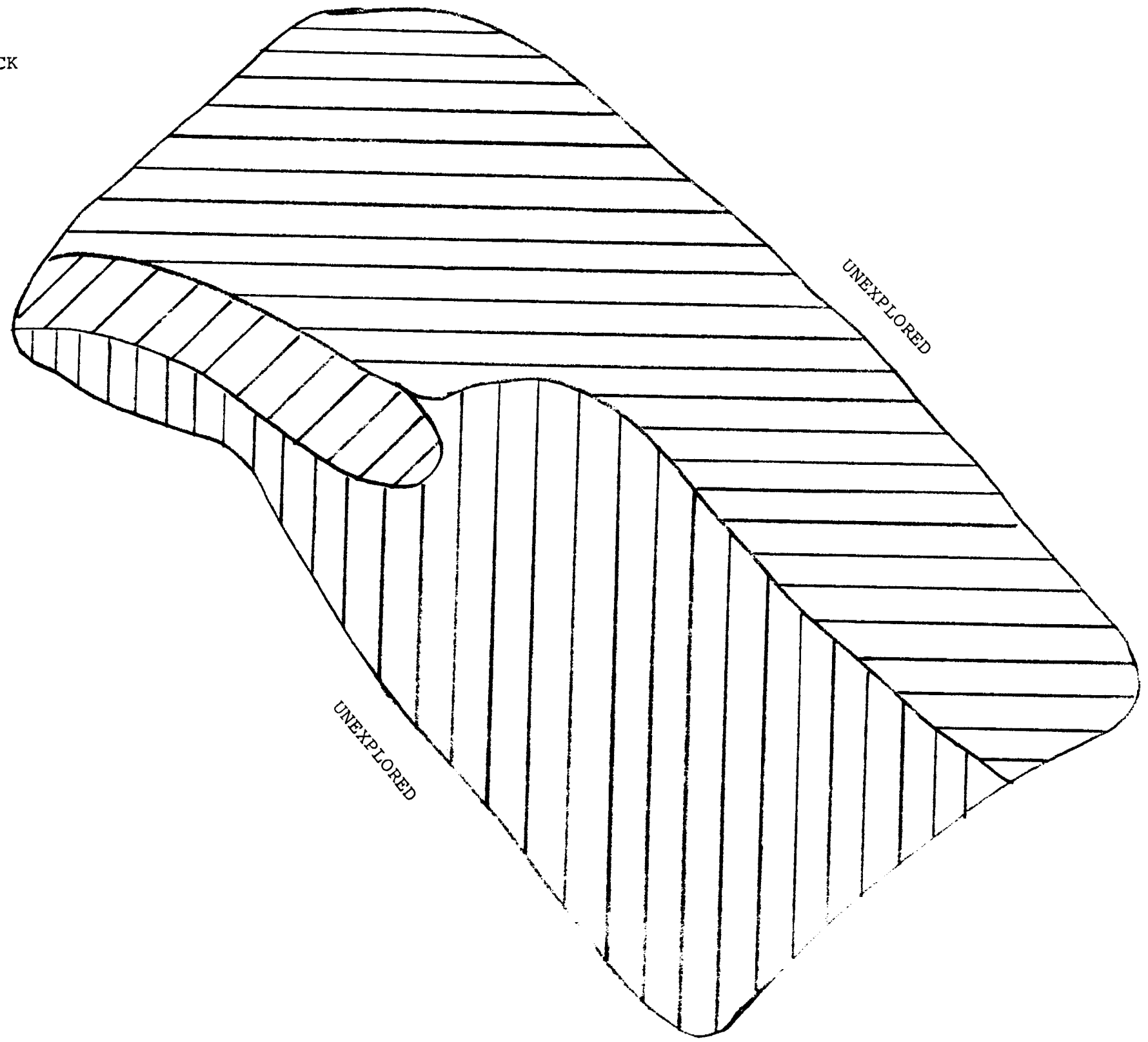

Jarvis Resources Ltd.	
Parkin Twp.	
Marble Deposit	
PIT #3	
Scale : 1" = 40'	Date : Feb. '92
Dwg : <i>LB</i>	

ASSESSMENT WORK REPORT - EQUIPMENT USAGE
 JARVIS RESOURCES LTD. - PARKIN TWP. (HARBLE)

PIT # 3

Contractor: Leuca Mines Ltd. (at least extra on rates)

DATE COVERED	EQUIPMENT RENTAL			OPERATOR	
	Type of Equipment	Rate	Time	Hours	Rate
Sept 1-14/91	JU 850 Bulldozer	80.00/hr	22 hr.	22	15.00/hr
Sept 15-28/91	" " "	80.00/hr	3 hr.	3	15.00/hr
Sept 29-31/91	" " "	80.00/hr	5 hr.	5	15.00/hr
Oct 13-26/91	" " "	80.00/hr	2 hr.	2	30.00/hr
Sept 15-28/91	670 S Excavator	65.00/hr	19 hr	19	15.00/hr
Sept 29- Oct 1/91	" "	65.00/hr	20.5 hr	20.5	15.00/hr
Oct 13-26/91	" "	65.00/hr	16 hr.	16	15.00/hr
Sept 15-28/91	Omega Crane	80.00/hr	16.5 hr	16.5	15.00/hr
Sept 29- Oct 1/91	" "	80.00/hr	24.5 hr	{ 10.0 14.5	{ 15.00/hr 22.50/hr
Oct 13-26/91	" "	80.00/hr	13 hr.	13	15.00/hr
Sept 15-28/91	Austen Weston Crane	75.00/hr	3 hr	3	15.00/hr
Oct 13-26/91	" " "	75.00/hr.	6 hr.	6	15.00/hr
Sept 15-28/91	Ford Tundra	22.00/hr	7 hr	7	15.00/hr
Sept 15-28/91	Heavy Truck	35.00/hr	4 hr.	4	22.50/hr
Sept 15-28/91	Tractor + Flood	50.00/hr	2.5 hr	2.5	15.00/hr
Sept - Oct 1/91	Cummins S 250 Drill	{ 100.00/wk 415.00/mth	2 wks. 1 mth.	200 hr	18.00/hr

ASSESSMENT WORK REPORT - EQUIPMENT USAGE
 JARVIS RESOURCES LTD. - PARKIN TWP. (MARBLE)

PIT # 3

Note: GST extra on rates

Contractor - Erana Mines Ltd.

DATE (S) COVERED	EQUIPMENT RENTAL			OPERATOR	
	Type of Equipment	Rate	Time	Hours	Rate
Sept 1-14/91	JD 850 Bulldozer	80.00/hr	22 hr.	22	15.00/hr
Sept 15-28/91	" " "	80.00/hr	3 hr.	3	15.00/hr
Sept 30-Oct 12/91	" " "	80.00/hr	5 hr.	5	15.00/hr
Oct 13-26/91	" " "	80.00/hr	2 hr.	2.	30.00/hr.
Sept 15-28/91	690 C Excavator	65.00/hr	19 hr	19	15.00/hr
Sept 30-Oct 12/91	" "	65.00/hr	20.5 hr	20.5	15.00/hr
Oct 13-26/91	" "	65.00/hr	16 hr.	16	15.00/hr
Sept 15-28/91	Omega Crane	80.00/hr	16.5 hr	16.5	15.00/hr
Sept 30-Oct 12/91	" "	80.00/hr	24.5 hr	{ 10.0 14.5	{ 15.00/hr 22.50/hr
Oct 13-26/91	" "	80.00/hr	13 hr.	13	15.00/hr
Sept 30-Oct 12/91	Austen Western Crane	75.00/hr.	3 hr	3	15.00/hr
Oct 13-26/91	" " "	75.00/hr.	6 hr.	6	15.00/hr
Sept 15-28/91	Ford Tandem	22.00/hr	7 hr	7	15.00/hr
Sept 15-28/91	Heavy Truck	35.00/hr	4 hr.	4	22.50/hr
Sept 15-28/91	Tractor + Float	50.00/hr	2.5 hr	2.5	15.00/hr
Sept - Oct/91	Secan S 250 Drill	{ 100.00/wk 415.00/mth.	2 wks. 1 mth.	? 200 hr	18.00/hr

PIT #3, ctd.

DATE(S) COVERED	EQUIPMENT RENTAL			OPERATOR	
	Type of Equipment	Rate	Time	Hours	Rate
Sept-Oct/91	2 Petter Pumps	1/3 (516.00 ea/mth)	1/3 mth		
Oct 4-18/91	" " "	516.00 ea/mth	2 wks		
Oct 4-18/91	13 Hp. Flygt Pump	1,032.00/mth	2 wks		
Oct 8-22/91	300KV Generator	3,500.00/mth	2 wks		

Contractor - Erana-Plast Ltd.

Oct 3, 4, 8, 18/91	1978 Chev Dump Truck	\$150.00/load Samples	4 loads		
--------------------	-------------------------	--------------------------	---------	--	--

TEST RESULTS:

Specimen	Bulk Specific Gravity	Average Weight, g	Weight Loss, g	Abrasion Resistance
1	2.715	182.07	1.87	15.81
2	2.709	180.56	1.06	15.73
3	2.715	169.63	1.70	15.75
Average	2.713			15.76

ASTM Standard C 503-89 specifies a minimum abrasion index of 10 for stone subject to foot traffic and 12 for stone subject to heavy foot traffic.

Robert C. Smith
 Robert C. Smith P.E.

File

GENERAL

• Biology • Chemistry • Environmental • Materials • Facilities in Principal Cities •

UNITED STATES TESTING COMPANY, INC. REPORTS AND LETTERS ARE FOR THE PERSONAL USE OF THE CLIENT TO WHOM THEY ARE ADDRESSED AND THEY AND THE NAME OF THE UNITED STATES TESTING COMPANY, INC. OR ITS SEALS OR PERSONS ARE NOT TO BE USED UNDER ANY CIRCUMSTANCES IN ADVERTISING TO THE GENERAL PUBLIC AND THEIR COMMUNICATION WITH ANY OTHERS OR THE USE OF THE NAME OF UNITED STATES TESTING COMPANY, INC. MUST RECEIVE OUR PRIOR WRITTEN APPROVAL. OUR REPORTS APPLY ONLY TO THE STANDARD OR PROCEDURES IDENTIFIED TO THE TESTS CONDUCTED AND TO THE SAMPLES TESTED AND/OR INSPECTIONS MADE, UNLESS OTHERWISE SPECIFIED. THE TEST AND/OR INSPECTION RESULTS ARE NOT INDICATIVE OR REPRESENTATIVE OF THE QUALITIES OF THE LOT FROM WHICH THE SAMPLE WAS TAKEN OR APPARENTLY IDENTICAL OR SIMILAR PRODUCTS AND NOTHING CONTAINED IN OUR REPORTS SHALL BE DEEMED TO APPLY OR VOUCH THAT UNITED STATES TESTING COMPANY, INC. CONDUCTS ANY QUALITY CONTROL PROGRAM FOR THE CLIENT TO WHOM THE REPORT IS ISSUED. SAMPLES NOT TESTED MUST BE RETURNED WITHIN A MAXIMUM OF THIRTY DAYS AT WHICH TIME THE CLIENT SHALL BE RESPONSIBLE FOR THE COST OF STORAGE.

United States Testing Company, Inc.

93-0042

Jarvis Resources Ltd.

3/22/93

Page 2 of 2

Abrasion Index (ASTM C 241):

<u>Specimen</u>	<u>1</u>	<u>2</u>	<u>3</u>	<u>Average</u>
Thickness, in.:	1.015	1.036	0.990	-----
Load, g:	1997.29	1993.71	2001.72	-----
Average Wt., g:	182.07	180.56	169.63	-----
Weight Loss, g:	1.88	1.06	1.70	-----
Abrasion Index:	15.81	15.73	15.75	15.76
Bulk Specific Gravity:	2.715	2.709	2.715	2.713



United States Testing Company, Inc.

1341 NORTH 108TH EAST AVENUE • TULSA, OKLAHOMA 74116 • 918-437-8333 • Fax 918-437-8487

REPORT OF TEST

CLIENT: Jarvis Resources
106 Fielding Road
Lively, Ontario, POM 2E0
Canada

Report No.: EN93-0016
Date: 2/12/93
M O Y

Attn: Mark Jewell

SUBJECT: Tests for MIA Color Plate Book.

MATERIAL TESTED:

Stone specimens were submitted by the client who identified them as Autumn Taupe.

PROCEDURE:

The specimens were tested for absorption and specific gravity, compressive strength, abrasion index, and flexural strength in accordance with ASTM Methods C 97-83 (1988), C 170-87, C241-85, and C 880-89, respectively.

AVERAGE RESULTS:

Specimen	Water Absorption	Density lbs/ft ³	Compressive Strength Psi	Flexural Strength Psi	Abrasion Index
1	0.05	168.98	18,081	1655	22.28
2	0.04	169.73	18,848	1577	21.76
3	0.05	169.42	14,838	1799	20.73
4	----	----	22,210	1832	-----
5	----	----	19,867	1078	-----
Average	0.05	169.38	18,720	1590	21.59
Average	----	2714 Kg/m ³	129.40 MPa	1096 Mpa	-----

Post-it™ brand fax transmittal memo 7871 # of pages = 2

To: JEWELL	From: SMITH
Ca.	Ca.
Dept.	Phone #
Fax # 705. 682. 2447	Fax # 918. 437. 8487

Robert C. Smith
Robert C. Smith, M.Sc., P.E.
Assistant Vice President

Page 1 of 2



Biology • Chemistry • Environmental • Materials • Facilities in Principal Cities

UNITED STATES TESTING COMPANY INC. REPORTS AND TESTS ARE FOR THE EXCLUSIVE USE OF THE CLIENT TO WHOM THEY ARE ADDRESSED AND THEY AND THE NAME OF THE UNITED STATES TESTING COMPANY INC. OR ITS SCALE OR INDICIA ARE NOT TO BE USED UNDER ANY CIRCUMSTANCES IN ADVERTISING TO THE GENERAL PUBLIC AND THEIR COMMUNICATION TO ANY OTHERS OR IN THE NAME OF THE UNITED STATES TESTING COMPANY INC. MUST BE MADE WITH THE PRIOR WRITTEN APPROVAL OF THE COMPANY. OUR REPORTS APPLY ONLY TO THE MATERIALS AND PROCEDURES IDENTIFIED TO THE TESTS CONDUCTED AND TO THE SAMPLES TESTED AND OUR INSPECTIONS MADE. UNLESS OTHERWISE SPECIFIED THE TESTS AND/OR INSPECTION RESULTS ARE NOT INDICATIVE OR REPRESENTATIVE OF THE QUALITY OF THE LOT FROM WHICH THE SAMPLE WAS TAKEN OR OF APPARENTLY IDENTICAL OR SIMILAR PRODUCTS AND WITHOUT LIMITATION OUR REPORTS SHALL BE DEEMED TO MEAN THAT THE UNITED STATES TESTING COMPANY INC. HAS NOT TESTED OR INSPECTED THE ENTIRE LOT.

N93-001

Jarvis Resources

2/12/93

Page 2 of 2

Absorption & Specific Gravity (ASTM C 97):

Specimen:	1	2	3	Average
Dry Weight, g:	357.30	364.32	365.71	-----
Wet Weight, g:	357.49	364.46	365.89	-----
Volume, cm ³ :	131.96	133.94	134.72	-----
Absorption, %:	0.05	0.04	0.05	0.05
Specific Gravity:	2.708	2.720	2.715	2.714
Density, lbs/ft ³ :	168.98	169.73	169.42	169.38

Compressive Strength (ASTM C 170):

Specimen	Width, in.	Thickness, in.	Ultimate Load, lbs.	Compressive Strength, psi
1	2.052	1.981	73,500	18,081
2	2.015	2.067	78,500	18,848
3	2.077	2.028	62,500	14,838
4	2.061	1.977	90,500	22,210
5	2.073	1.978	81,500	19,876
Average				18,770

Abrasion Index (ASTM C 241):

Specimen:	1	2	3	Average
Thickness, in.:	0.992	0.998	0.003	-----
Load, g:	2001.44	2000.36	1999.47	-----
Average Weight, g:	177.49	177.59	175.67	-----
Weight Loss, g:	1.44	1.48	1.55	-----
Abrasion Index:	22.28	21.76	20.73	21.59
Bulk Specific Gravity:	2.699	2.698	2.706	2.701

Flexural Strength (ASTM C 880):

Specimen	Width, in.	Thickness, in.	Ultimate Load, lbs.	Flexural Strength, psi
1	1.545	1.015	295	1,655
2	1.542	1.018	280	1,577
3	1.570	1.027	331	1,799
4	1.559	1.012	325	1,832
5	1.564	1.015	193	1,078
Average				1,590



Ontario



411155W9703 2.15238 PARKIN

900

Ministry of
Northern Development
and Mines

Ministère du
Développement du Nord
et des Mines

Geoscience Approvals Section
933 Ramsey Lake Road
6th Floor
Sudbury, Ontario
P3E 6B5

Telephone: (705) 670-5853
Fax: (705) 670-5863

January 5, 1994

Our File: 2.15238
Transaction #: W9370.00075

Mining Recorder
Ministry of Northern
Development and Mines
933 Ramsey Lake Road
3rd Floor
Sudbury, Ontario
P3E 6B5

Dear Sir:

**RE: APPROVAL OF ASSESSMENT WORK SUBMITTED FOR INDUSTRIAL MINERAL
TESTING ON MINING CLAIM S647602 IN PARKIN TOWNSHIP**

A Notice of Deficiency was not issued on this Report of Work prior to the 90 day deemed approval date and as outlined in subsection 6(5) of the Mining Act Regulations this Report of Work is **deemed approved** as of **DECEMBER 16, 1993**.

The work has been approved as outlined on the attached Assessment Work Credit Form. Notice that a cut-back of \$1937 has occurred on this submission. The cut-back is a result of work that was filed more than twenty-four months after the date of performance (work before September 17, 1991) and an ineligible expense of equipment repair and maintenance.

If you require further information please contact Lucille Jerome at (705) 670-5855.

Yours sincerely

Ron C. Gashinski
Senior Manager, Mining Lands Section
Mining and Land Management Branch
Mines and Minerals Division

LJ/ljs

cc: Resident Geologist
Sudbury, Ontario

Assessment Files Library
Toronto, Ontario

ASSESSMENT WORK CREDIT FORM

FILE NUMBER: 2.15238
DATE: December 16, 1993
RECORDER'S REPORT NUMBER: W9370.00075

RECORDED HOLDER: Jarvis Resources Ltd. CLIENT NUMBER:148720

TOWNSHIP OR AREA: Parkin Township

CLAIM	VALUE OF WORK DONE ON THIS CLAIM	VALUE APPLIED TO THIS CLAIM	VALUE ASSIGNED FROM THIS CLAIM	RESERVE
S647602	\$30,305	0	0	\$30,305

Report of Work Conducted After Recording Claim
Mining Act

Transaction Number
W 9370.00075

Personal information collected on this form is obtained under the authority of the Mining Act. This information will be used for correspondence. Questions about this collection should be directed to the Provincial Manager, Mining Lands, Ministry of Northern Development and Mines, Fourth Floor, 159 Cedar Street, Sudbury, Ontario, P3E 6A5, telephone (705) 670-7264.

2.15228

- Instructions:**
- Please type or print and submit in duplicate.
 - Refer to the Mining Act and Regulations for requirements of filing assessment work or consult the Mining Recorder.
 - A separate copy of this form must be completed for each Work Group.
 - Technical reports and maps must accompany this form in duplicate.
 - A sketch, showing the claims the work is assigned to, must accompany this form.

Recorded Holder(s) JARVIS RESOURCES LTD.		Client No. 148720
Address 106 Fielding Road, Lively, Ontario POM 2E0		Telephone No. (705) 682-2606
Mining Division SUDBURY	Township/Area PARKIN TWP.	M or G Plan No. G-2115
Dates Work Performed From: September /91		To: OCTOBER /91

Work Performed (Check One Work Group Only)

Work Group	Type
<input type="checkbox"/> Geotechnical Survey	
<input checked="" type="checkbox"/> Physical Work, Including Drilling	Stripping, drilling, blasting, cleaning, sawing, moving rubble sample blocks
<input type="checkbox"/> Rehabilitation	
<input type="checkbox"/> Other Authorized Work	SECTION 18 ONLY <i>metallurgical testing & Bulk sampling g.p.</i>
<input type="checkbox"/> Assays	
<input type="checkbox"/> Assignment from Reserve	

Total Assessment Work Claimed on the Attached Statement of Costs \$ 32,242.57

Note: The Minister may reject for assessment work credit all or part of the assessment work submitted if the recorded holder cannot verify expenditures claimed in the statement of costs within 30 days of a request for verification.

Persons and Survey Company Who Performed the Work (Give Name and Address of Author of Report)

Name	Address
Erana Mines Ltd.	106 Fielding Road, Lively, Ontario POM 2E0
Erana-Plast Ltd.	

RECORDED
253/0
DEC 14 1993
MINING

RECORDED
SEP 17 1993
Receipt MU

(attach a schedule if necessary)

Certification of Beneficial Interest * See Note No. 1 on reverse side

I certify that at the time the work was performed, the claims covered in this work report were recorded in the current holder's name or held under a beneficial interest by the current recorded holder.	Date Sept. 20/93	Recorded Holder or Agent (Signature) Joanne A. Funk
--	---------------------	--

Certification of Work Report

I certify that I have a personal knowledge of the facts set forth in this Work report, having performed the work or witnessed same during and/or after its completion and annexed report is true.

Name and Address of Person Certifying
Joanne A. Funk, 106 Fielding Road, Lively, Ontario POM 2E0

Telephone No. (705) 682-2606	Date Sept. 20/93	Certified By (Signature) <i>J. A. Funk</i>
---------------------------------	---------------------	---

For Office Use Only

Total value Cr. Recorded	Date Recorded	Mining Recorder	Received Stamp
	Sept. 17/93	<i>[Signature]</i>	
	Deemed Approval Date	Date Approved	
	Date Notice for Amendments Sent		

Work Report Number for Applying Reserve	Claim Number (see Note 2)	Number of Claim Units
	S 647602	1
Total Number of Claims		1

Value of Assessment Work Done on this Claim	Value Applied to this Claim
32,242.	0
Total Value Work Done	32,242.
Total Value Work Applied	0

Value Assigned from this Claim	Reserve: Work to be Claimed at a Future Date
0	32,242.
Total Assigned From	0
Total Reserve	32,242.

Credits you are claiming in this report may be cut back. In order to minimize the adverse effects of such deletions, please indicate from which claims you wish to prioritize the deletion of credits. Please mark (✓) one of the following:

- Credits are to be cut back starting with the claim listed last, working backwards.
- Credits are to be cut back equally over all claims contained in this report of work.
- Credits are to be cut back as prioritized on the attached appendix.

In the event that you have not specified your choice of priority, option one will be implemented.

Note 1: Examples of beneficial interest are unrecorded transfers, option agreements, memorandum of agreements, etc., with respect to the mining claims.

Note 2: If work has been performed on patented or leased land, please complete the following:

I certify that the recorded holder had a beneficial interest in the patented or leased land at the time the work was performed.	Signature _____	Date _____
---	-----------------	------------



Ministry of
Northern Development
and Mines

Ministère du
Développement du Nord
et des mines

**Statement of Costs
for Assessment Credit**

**État des coûts aux fins
du crédit d'évaluation**

Mining Act/Loi sur les mines

Transaction No./N° de transaction
69370.00075

Personal information collected on this form is obtained under the authority of the Mining Act. This information will be used to maintain a record and ongoing status of the mining claim(s). Questions about this collection should be directed to the Provincial Manager, Minings Lands, Ministry of Northern Development and Mines, 4th Floor, 159 Cedar Street, Sudbury, Ontario P3E 6A5, telephone (705) 870-7264.

Les renseignements personnels contenus dans la présente formule sont recueillis en vertu de la Loi sur les mines et serviront à tenir à jour un registre des concessions minières. Adresser toute question sur la collecte de ces renseignements au chef provincial des terrains miniers, ministère du Développement du Nord et des Mines, 159, rue Cedar, 4^e étage, Sudbury (Ontario) P3E 6A5, téléphone (705) 870-7264.

1. Direct Costs/Coûts directs

Type	Description	Amount Montant	Totals Total global
Wages Salaires	Labour Main-d'oeuvre	10,659.08	
	Field Supervision Supervision sur le terrain		10,659.08
Contractor's and Consultant's Fees Droits de l'entrepreneur et de l'expert- conseil	Type		
Supplies Used Fournitures utilisées	Type Explosives	487.92	
	Fuel, Oil, etc.	693.64	
	Drill Supplies	365.59	
	Repair & Maintenance of Equipment	532.84	2,079.99
Equipment Rental Location de matériel	Type JD 850 Bulldozer	2,737.45	
	640 C Excavator	3,860.03	
	2 Cranes	5,394.65	
	Dump & Heavy Trucks	314.58	
	Tractor & Fleet	133.15	
	Secan 3250 Drill	658.05	
2 Peter Pumps	920.02		
1 Flygt Pump	552.12		
300 kV Generator	1,872.50		
Total Direct Costs Total des coûts directs			29,134.22

2. Indirect Costs/Coûts indirects

** Note: When claiming Rehabilitation work Indirect costs are not allowable as assessment work. Pour le remboursement des travaux de réhabilitation, les coûts indirects ne sont pas admissibles en tant que travaux d'évaluation.

Type	Description	Amount Montant	Totals Total global
Transportation Transport	Type Personnel, Service & Supplies (Eramba Mines)	1,551.50	
	Sample Blocks (Eramba-Plant)	642.00	
			2,193.50
Food and Lodging Nourriture et hébergement			
Mobilization and Demobilization Mobilisation et démobilisation		914.85	914.85
Sub Total of Indirect Costs Total partiel des coûts indirects			3,108.35
Amount Allowable (not greater than 20% of Direct Costs) Montant admissible (n'excédant pas 20 % des coûts directs)			3,108.35
Total Value of Assessment Credit (Total of Direct and Allowable indirect costs)			32,242.57

Note: The recorded holder will be required to verify expenditures claimed in this statement of costs within 30 days of a request for verification. If verification is not made, the Minister may reject for assessment work all or part of the assessment work submitted.

Note: Le titulaire enregistré sera tenu de vérifier les dépenses demandées dans le présent état des coûts dans les 30 jours suivant une demande à cet effet. Si la vérification n'est pas effectuée, le ministre peut rejeter tout ou une partie des travaux d'évaluation présentés.

Filing Discounts

1. Work filed within two years of completion is claimed at 100% of the above Total Value of Assessment Credit.
2. Work filed three, four or five years after completion is claimed at 50% of the above Total Value of Assessment Credit. See calculations below:

Total Value of Assessment Credit	Total Assessment Claimed
	x 0.50 =

Remises pour dépôt

1. Les travaux déposés dans les deux ans suivant leur achèvement sont remboursés à 100 % de la valeur totale susmentionnée du crédit d'évaluation.
2. Les travaux déposés trois, quatre ou cinq ans après leur achèvement sont remboursés à 50 % de la valeur totale du crédit d'évaluation susmentionné. Voir les calculs ci-dessous.

Valeur totale du crédit d'évaluation	Évaluation totale demandée
	x 0,50 =

Certification Verifying Statement of Costs

I hereby certify:
that the amounts shown are as accurate as possible and these costs were incurred while conducting assessment work on the lands shown on the accompanying Report of Work form.

that as ADMINISTRATOR I am authorized
(Recorded Holder, Agent, Position in Company)

to make this certification

Attestation de l'état des coûts

J'atteste par la présente :
que les montants indiqués sont le plus exact possible et que ces dépenses ont été engagées pour effectuer les travaux d'évaluation sur les terrains indiqués dans la formule de rapport de travail ci-joint.

Et qu'à titre de _____ je suis autorisé
(titulaire enregistré, représentant, poste occupé dans la compagnie)

à faire cette attestation.

Signature _____ Date Sept. 20/93

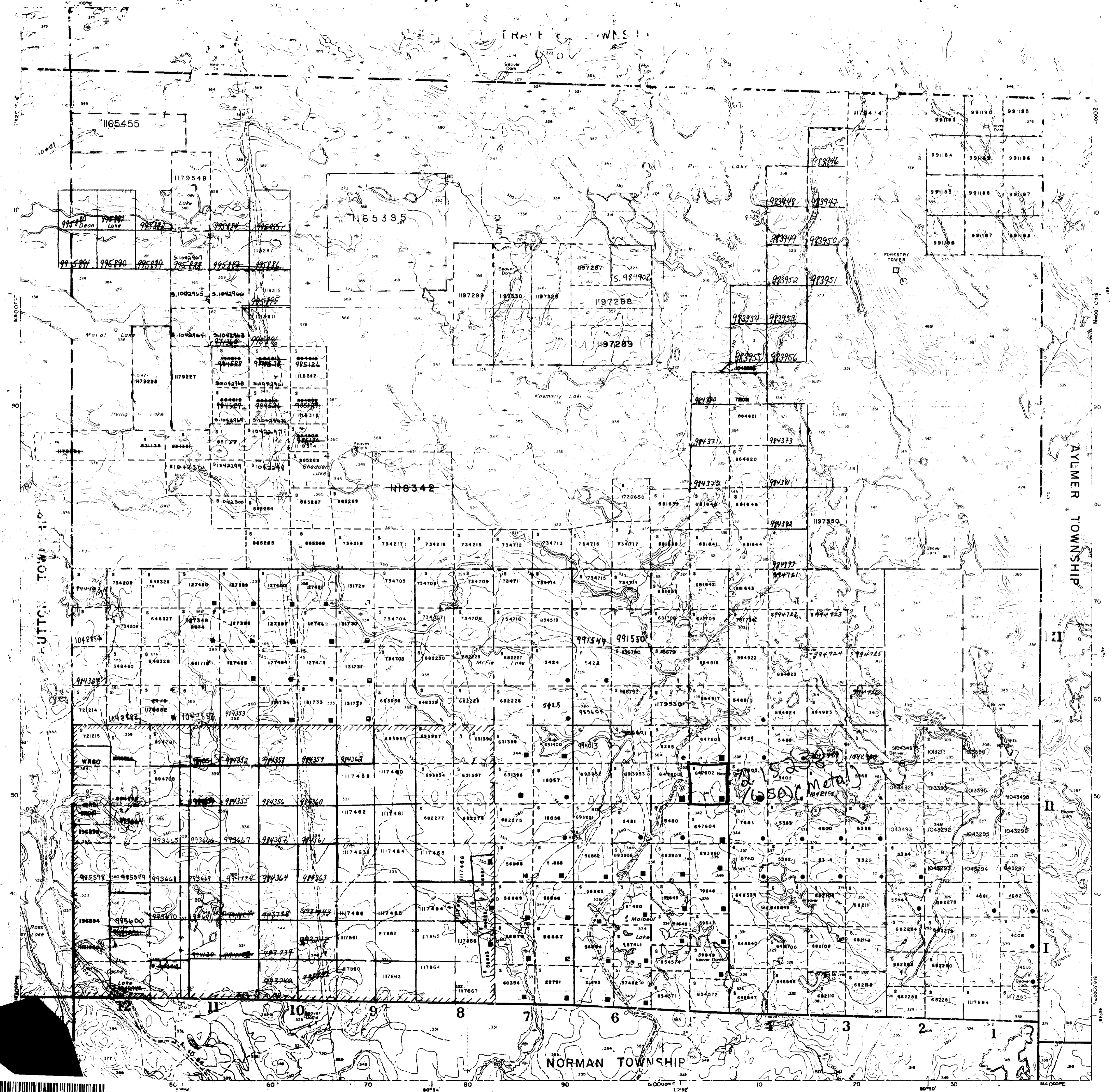

DISPOSITION

MINISTRY OF ENERGY
 SUBURB
 MINISTRY OF ENERGY
 SUBURB
 LAND REGISTRY ADVISOR
 SUBURB

PARKIN

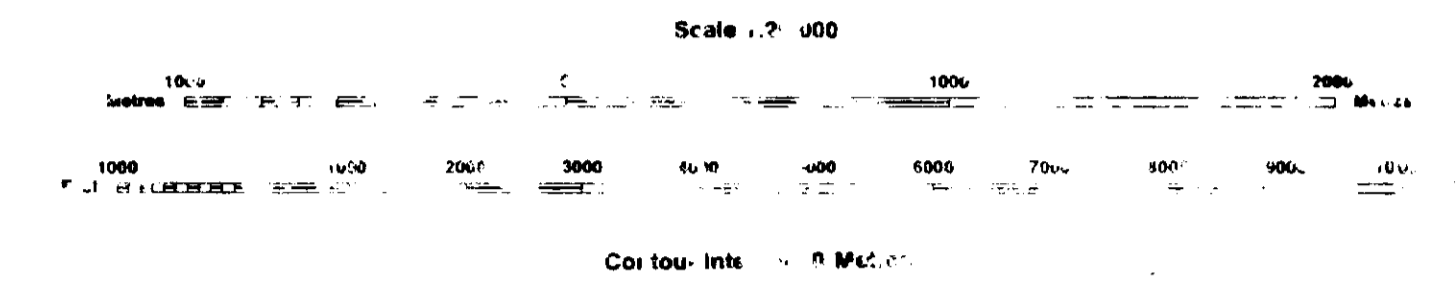

AREAS WITHDRAWN FROM DISPOSITION

MRU - Mining Rights Only
 SRO - Surface Rights Only
 M+S - Mining and Surface Rights

Description	Order No.	Date	Page No.	File
DEC 36/80	M 7/8	7/2/85	1253	172/8

SYMBOLS

- Boundary
- Township, Meridian, Baseline
- Road allowance, surveyed shoreline
- Lot/Concession, surveyed/unsurveyed
- Parcel: surveyed/unsurveyed
- Highway, county, township
- Utility
- Reservation
- Cliff, Pit, Pile
- Contour
- Intermittent
- Approximate
- Depression
- Control point (horizontal)
- Flooded land
- Mine head frame
- Pipeline (above ground)
- Railway: single track, double track, abandoned
- Highway, county, township
- Trail, bush
- Shoreline (original)
- Transmission line
- Wooded area

MINING & SURFACE RIGHTS OPENED JUNE 1, 1992

DISPOSITION OF CROWN LANDS

- Patent
- Surface & Mining Rights
- Surface Rights Only
- Mining Rights Only
- Lease
- Surface & Mining Rights
- Surface Rights Only
- Mining Rights Only
- Licence of Occupation
- Order-in-Council
- Cancelled
- Reservation
- Sand & Gravel

NOTE: TOWNSHIP SUBDIVISION PARTIALLY ANNULLED MARCH 8, 1949

IN AREA MARKED THUS STAKING ALLOWED AS IN UNSUBDIVIDED TOWNSHIP - SECTION 45 MINING ACT.



91-11-2-4

91-11-2-4