



41115SW9705 2.15276 PARKIN

010

## SUMMARY OF WORK DONE

The claims on which the work was done, along with several abutting claims, contain a breccia limestone known as the Harama Marble and other marble types which have been proven to have great potential as a marketable dimension stone. A great deal of work has been completed on these claims during the past year, funded partly by the Province of Ontario through its NORFUND, NORT and OMIP programs.

As part of our on-going work, it became necessary to conduct an environmental study to determine various parameters within Mowat Creek which passes directly through the claims. The work was conducted on claims S865265 and S865266 in Parkin Township, district of Sudbury. Several parameters had to be quantified, identified or addressed. Such parameters included baseline heavy metal content of the creek waters, benthic identification of macroinvertebrates, identification of aquatic plant life, analysis of creek bed substrates, presence and species identification of fish stocks, depth and slope of the creek, flow volumes, flood potential, flow temperatures and classification of the type of aquatic environment found in order to determine the potential impact of the proposed marble quarry operations.

The work was completed through the cooperative efforts of N.A.R. Environmental Consultants Inc., Barringer Laboratories, R. Prudhomme P.Eng. and Frank Villano. A map showing the location of the work, the environmental report conducted by N.A.R. Environmental Consultants Inc., the laboratory report from Barringer Laboratories, the benthic identification summary, the creek bed profile and water depth through a critical portion of the claims, a statement of expected environmental impact and a copy of the paid invoice from N.A.R. and Barringer are included in this submission as Appendices A, B, C, D, E, F and G respectively.

A breakdown of the costs for the work are as follows (detailed costs in work report form):

### CONSULTANTS:

N.A.R. Environmental Inc.	as per invoice presented in Appendix G	\$1,198.51
Barringer Laboratories	paid as a subcontractor by N.A.R.	

### FIELD SUPERVISION:

R. Prudhomme P.Eng.	4 days @ \$200 / day	\$800.00
---------------------	----------------------	----------

### LABOUR:

F. Villano	2 days @ \$100 / day	\$200.00
------------	----------------------	----------

**APPENDIX A**

**MAP SHOWING THE LOCATION OF THE WORK**

**APPENDIX B**

**ENVIRONMENTAL REPORT BY N.A.R.  
ENVIRONMENTAL CONSULTANTS INC.**

**BY FAX, Original by Mail (1 of 3)**

**September 26, 1993**

Ms. Rachel Prudhomme, P. Eng.  
Ontario Quarries Ltd.  
1177 Lonsdale Avenue  
Sudbury, Ontario  
P3B 1K3

Dear Ms. Prudhomme:

Re: Interim Report, Mowat Creek Pre-operative Survey

The following interim report has been prepared subsequent to our site visit to Mowat Creek on September 16, 1993. The report addresses the habitat suitability and presence of brook trout, *Salvelinus fontinalis*, in Mowat Creek proximal to Ontario Quarries Ltd. development in Parkin Township, District of Sudbury.

### **Methods and Results**

Mowat Lake is approximately 2 km upstream of the proposed crossing. The reach between the lake and the crossing is 1.0 to 1.5 m deep and characterized as evenflow. The bottom substrates consists of organic detritus and the stream is bordered by a bog wetland community. Water elevations in this reach are normally controlled by a natural rock outcrop 10 m upstream of Ontario Hydro's existing bridge. A beaver has constructed a small dam, approximately 0.4 m high, along the top of this natural control point. In my opinion neither of these controls points would limit the upstream or downstream migration of fish.

The 250 m long reach downstream of the control point consists of riffles, evenflow and pools. The substrate through the reach consists of bedrock, cobbles, boulders in the erosional channels and silts and organic detritus in the pools. Bank and in-stream cover were limited and I would qualitatively rank them as poor.

At the lower end of this reach, the riffle flows into a pool and evenflow section which extended beyond the my line of sight. Most of the surface area of this lower pool is covered with aquatic macrophytes including coontail, reeds, rushes, waterlilies and Elodea. The streambed throughout this reach consisted of organic detritus. Both the presence of aquatic macrophytes and organic nature of the substrate are atypical for a coolwater fishery.

The organic substrates bottom and water depths throughout much of the study area precluded any fisheries assessment work using either an electroshocker or seine net. A seine and dip net was used to sample some of the sections of reach upstream of the existing bridge and downstream of the existing ford. A number of minnow species (Cyprinidae) and brook sticklebacks (*Culaea inconstans*) were captured. Our limited sampling effort yielded no brook trout or other coolwater indicator species.

A semi-quantitative i.e. timed benthic sample was collected in the riffle/pool such upstream of the bridge using a sweep net. Mayflies (3 genus) were the dominant taxonomic group, followed by clams and crayfish. Low numbers (< 5) of stoneflies and caddisflies were also present, as well as midge, worms, amphipods, damselflies and dragonflies.

The benthic organisms collected will be identified to the genus level in our finalized report. This sample has been forwarded to Aquatic Ecostudies Ltd. for taxonomic identification. We should receive these results in approximately two weeks. Hilsenhoff's index will be used to assess the water quality status of Mowat Creek.

A single water sample was collected as a surficial grab. The sample was forwarded to Barringer Laboratories by courier for analysis of suspended and dissolved solids, total phosphorus, total Kjeldhal nitrogen, copper, nickel and iron. Dissolved oxygen (8.0 mg/L), temperature (13°C), pH (6.20 pH units) and conductivity (30 umhos/cm) were measured in the field and recorded. In-stream flows at the time of sampling were estimated between 0.08 and 0.14 m<sup>3</sup>/s (3 to 5 cfs).

### Summary

In our experience, neither the observed habitats nor the fish captured in the study area are characteristic of a coldwater fishery. The study reach is dominated by organic substrates and aquatic macrophytes.

The benthic macroinvertebrates present (i.e. mayflies, caddisflies and stoneflies) are characteristic of good water quality. Some of the organisms present (e.g. clams, crayfish, amphipods, damselflies and dragonflies) are more typically associated with warmwater environments.

Dissolved oxygen, temperature and pH values were within acceptable limits for a coolwater fishery. This limited data does not assess seasonal differences in water quality. Based on the depth, width and limited canopy cover of the reach upstream of the proposed crossing in-stream temperatures are likely well above the optimal range for brook trout during the summer months.

In the absence of any other suitable substrate for spawning, the reach downstream of the control point might be used by spawning fish migrating from Mowat Lake. However, the habitat conditions present are less than ideal. Brook trout prefer spawning gravel 0.4 - 2.0 cm in diameter, often referred to as "pea" gravel. None of this substrate was observed in the study area.

I trust you will find this interim report adequate to address the nature of the fishery in the project area.

Sincerely

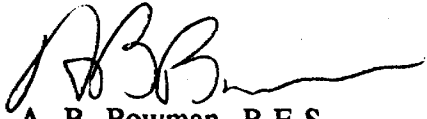
A handwritten signature in cursive script, appearing to read 'A. B. Bowman', with a long horizontal flourish extending to the right.

A. B. Bowman, B.E.S.  
Environmental Scientist/Principal

**APPENDIX C**

**LABORATORY REPORT FROM BARRINGER  
LABORATORIES**

20-Oct-93

NAR ENVIROMENTAL CONSULTANTS INC.  
487 Bouchard Street  
Sudbury, ON  
P3E 2K8

Page: 1  
Copy: 1 of 2  
Set : 1

Attn: Mr. Brad Bowman  
Project: ONTARIO QUARRIES INC

PO #:

Received: 17-Sep-93 11:48

Job: 937143

Status: Final

### Water Samples

Sample Id	TSS Grav. mg/L	TDS Grav. mg/L	Total P A. Col. mg/L	TKN A. Col. mg/L	Cu GFAAS mg/L	Ni GFAAS mg/L	Fe ICAP mg/L
SAMPLE #, MOWAT CREEK	0.2	61	0.016	0.66	0.003	0.007	0.30
Blank	<0.1	<1	<0.002	<0.02	<0.001	<0.001	<0.01
QC Standard (actual)	9.6	243	0.028	0.86	0.020	0.022	10.0
QC Standard (expected)	10.0	250	0.028	0.84	0.020	0.020	10.0
Repeat	0.2	63	0.016	0.66	0.003	0.007	0.30

Job approved by:

Signed:



.....  
Agnes Love, B.Sc.  
Manager, Environmental Inorganic Services



# **APPENDIX D**

## **BENTHIC IDENTIFICATION OF MACROINVERTEBRATES**

Table 1: Benthic Macroinvertebrates Present in Mowat Creek, September 1993

Insects:

BEETLES:

Elmidae:  
Optioservus

CADDISFLIES:

Polycentropodidae:  
Polycentropus  
Hydropsychidae:  
Cheumatopsyche  
Hydropsyche

DAMSELFLIES:

Protoneuridae:  
Agrion maculatum

DRAGONFLIES:

Aeshnidae:  
Boyeria grafiana  
Gomphidae:  
Ophiogomphus carolus  
Hagenius hivistylus

MAYFLIES:

Heptageniidae:  
Stenacron  
Stenonema vicarium  
Stenonema femoratum  
Oligoneuriidae:  
Isonychia  
Ephemerellidae:  
Eurylophella

STONEFLIES:

Perlidae:  
Acroneuria lycorias

TRUE FLIES

Chironomidae:  
Microtendipes

Crustaceans:

AMPHIPODS:

Hyalella azteca

CRAYFISHES:

Asteridae:  
Orconectes propinquus

Molluscs:

CLAMS:

Sphaeridae:  
Musculium securis

Annelids:

LEECHES:

Erpobdellidae:  
Nephelopsis obscura

WORMS:

Tubificidae

**APPENDIX E**

**CREEK BED PROFILE AND WATER DEPTH**

## PROFILE OF MOWAT CREEK BED AND WATER LEVEL

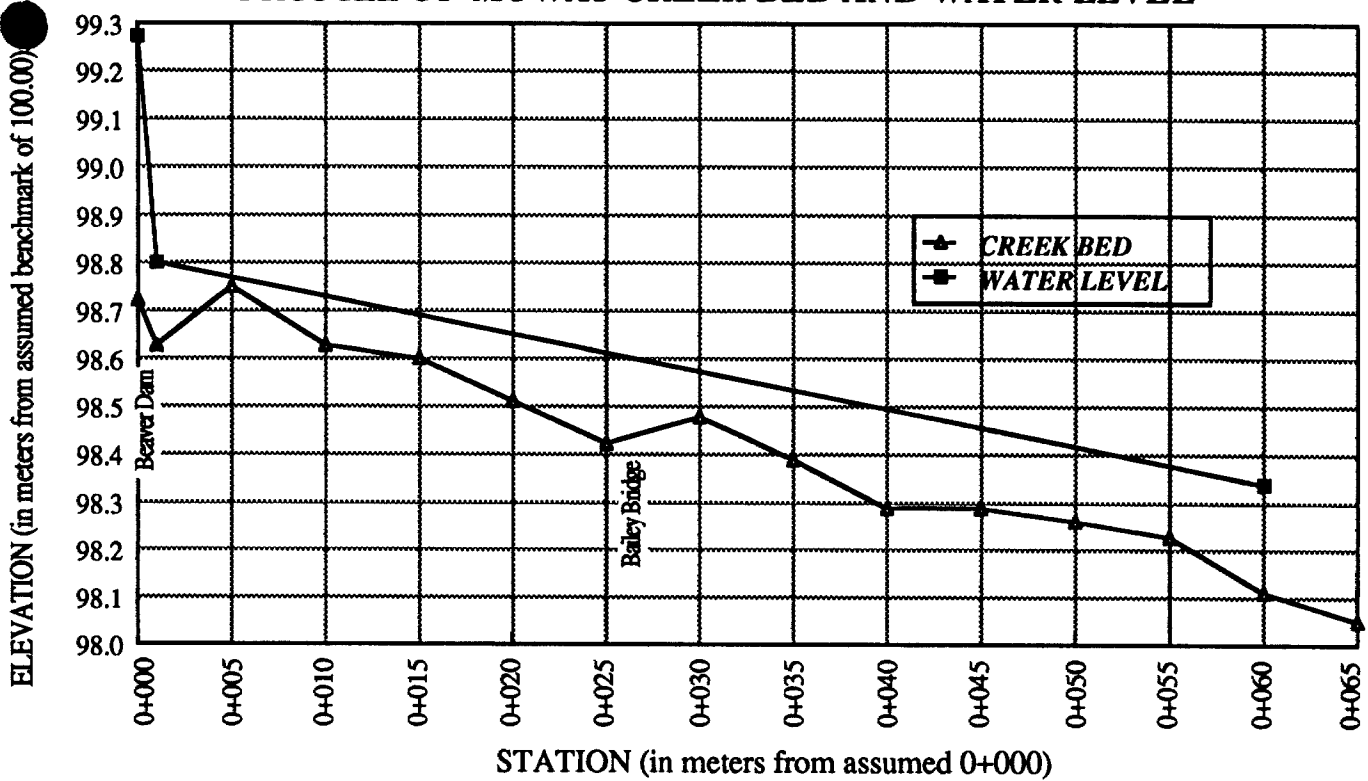

**NOTES:**

1. Elevations are in meters relative to an assumed benchmark of 100.00 taken as a point on the bedrock at north-east corner of existing bailey bridge foundation where the access road crosses Mowat Creek. The benchmark was permanently marked with survey paint.
2. Stations are measured in meters along the centerline of the creek from an assumed 0+000 located at a point immediately west (upstream) of the existing beaver dam which is 26 meters west of the centerline of the existing bailey bridge.
3. The vertical scale is greatly exaggerated with respect to the horizontal scale and therefore, the profile will seem steep when viewing the graph. The actual slope of the channel through this section represents a 1.2 percent grade.

I hereby certify that I personally conducted all field work leading to the above profile and that the information given above is true and accurate as of September 15, 1993.

*Qual #.  
2,15276 (This file)*

*Rachel Prudhomme*

Rachel Prudhomme, M.Sc., P.Eng.



**APPENDIX F**

**STATEMENT OF EXPECTED ENVIRONMENTAL  
IMPACT**

## STATEMENT OF EXPECTED ENVIRONMENTAL IMPACT

It is my professional opinion upon either supervising, conducting or being present during all field work and upon viewing all reports produced as a result of the environmental work that the proposed quarry should likely have a very minimal impact on the aquatic environment in Mowat Creek. The measurements taken and the qualitative analysis of the substrates, plant life and benthic samples indicate a warm water rather than a cold water environment in Mowat Creek. This leads to the presumption that brook trout spawning would likely not occur in the creek area studied. This is in conflict with statements by M.N.R. to the effect that M.N.R. believes this to be a brook trout stream. However, when asked to produce scientific data (either qualitative or quantitative) supporting this claim, M.N.R. was not able to produce any proof. M.N.R. also stated that they had no intention of producing any studies on this area in the near future because of budget restrictions. Based on various field studies and measurements conducted by ourselves and our qualified environmental consultants, we therefore conclude that there are no resident brook trout in this creek.

The baseline heavy metal values reported by Barringer Laboratories will serve as a threshold value for future reference. It will be necessary to take samples periodically to monitor natural changes occurring in these values as well as any seasonal fluctuations. It will then be possible to assess directly the impact, if any, of the quarry operations on the water quality in Mowat Creek. It is expected that, due to the nature of the limestone material being quarried, there will be no acid generation from the quarry activities or from the products stored on site. It is also expected that the limestone products will have a neutralizing effect on any existing acidic conditions. More work needs to be done in this area in order to provide conclusive evidence. Air pollution will be negligible, as almost all of the equipment is electric-hydraulic and has good dust collection systems. A system of catchment basins and/or settling ponds should be designed to collect any sediment from water used for cooling purposes on diamond wire saws or drills.

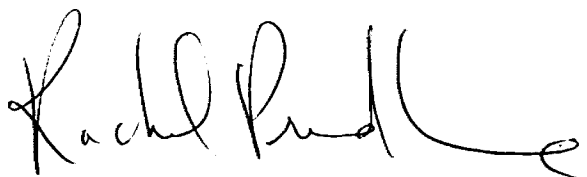

Rachel Prudhomme, M.Sc., P.Eng.



**APPENDIX G**

**COPY OF PAID INVOICE FROM  
N.A.R. ENVIRONMENTAL (INCLUDING COSTS FOR  
BARRINGER LABORATORIES)**

**N.O.R.**  
**Environmental**  
**Consultants Inc.**

487 Bouchard Street  
Sudbury, Ontario  
P3E 2K8  
Tel: (705) 523-2002  
Fax: (705) 523-7411

October 26, 1993

INVOICE # 93-10-26-01

GST Registration # 132405655

TO: Info Tech Research  
1177 Lonsdale Avenue  
Sudbury, Ontario  
P3B 1K3

Attention: Rachel Prudhomme

Consulting Services: Water Quality/Benthic Survey, Mowat  
Creek.

<u>Professional Fees</u>	<u>Cost</u>
Professional time	
Field work 5 hrs @ \$100/hr	\$ 500.00
Reporting 6 hrs @ \$62.50/hr	\$ 375.00
	<hr/>
	\$ 875.00
<u>Disbursements</u>	<u>Cost</u>
Analytical support 1 sample	\$ 120.00
Benthic identification 1 sample @ \$50/sample	\$ 50.00
Equipment rental/ consumables	\$ 25.00
Travel 90 km @ 0.34/km	\$ 30.60
	<hr/>
	\$ 225.60
Overhead @ 10%	19.50
	<hr/>
	\$ 245.10
Sub-total	\$ 1120.10
GST @ 7%	78.41
	<hr/>
<b>TOTAL</b>	<b>\$ 1198.51</b>

  
Janet Mise

*paid in full*  
*Dec 7/93.*





900

Ministry of  
Northern Development  
and Mines

Ministère du  
Développement du Nord  
et des Mines

Geoscience Approvals Office  
933 Ramsey Lake Road  
6th Floor  
Sudbury, Ontario  
P3E 6B5

Telephone: (705) 670-5853  
Fax: (705) 670-5863

February 21, 1994

Our File: 2.15276  
Transaction #: W9370.00106

Recording Office  
Ministry of Northern Development  
and Mines  
933 Ramsey Lake Road  
3rd Floor  
Sudbury, Ontario  
P3E 6B5

Dear Sir/Madam:

**Subject:** APPROVAL OF ASSESSMENT WORK CREDITS ON MINING CLAIMS  
S.865265 AND S.865266 IN PARKIN TOWNSHIP

The assessment work credits for Environmental work filed under Section 18 of the Mining Act Regulations have been approved as outlined in the original submission.

The approval date is February 17, 1994.

If you have any questions regarding this correspondence, please contact Lucille Jerome at (705) 670-5855.

Yours sincerely,

Ron C. Gashinski  
Senior Manager, Mining Lands Section  
Mining and Land Management Branch  
Mines and Minerals Division

KR/jl

Enclosures:

cc: Resident Geologist  
Sudbury, Ontario

Assessment Files Library  
Toronto, Ontario



Report of Work Conducted After Recording Claim

Transaction Number  
W9370.00106

Ontario

Mining Act

2-15276

Personal information collected on this form is obtained under the authority of the Mining Act. This information will be used or disclosed for purposes of the Mining Act. If you have any questions about this collection should be directed to the Provincial Manager, Mining Lands, Ministry of Northern Development and Mines, Fourth Floor, 159 Cedar Street, Sudbury, Ontario, P3E 6A5, telephone (705) 670-7264.

- Instructions:
- Please type or print and submit in duplicate.
  - Refer to the Mining Act and Regulations for requirements of filing assessment work or consult the Mining Recorder.
  - A separate copy of this form must be completed for each Work Group.
  - Technical reports and maps must accompany this form in duplicate.
  - A sketch, showing the claims the work is assigned to, must accompany this form.

Recorded Holder(s) ONTARIO QUARRIES INC.		Client No. 223661
Address 1177 LONSDALE, SUDBURY P3B 1K3		Telephone No. 560-4846
Mining Division SUDBURY	Township/Area PARKIN	M or G Plan No. G2915
Dates Work Performed From: AUGUST 16/93		To: OCTOBER 29/93

Work Performed (Check One Work Group Only)

Work Group		RECORDED Type	RECEIVED
Geotechnical Survey		DEC 16 1993	JAN 27 1994
Physical Work, Including Drilling		Receipt <u>MS</u>	MINING LANDS BRANCH
Rehabilitation			
<input checked="" type="checkbox"/> Other Authorized Work ENVIRO	BASELINE ENVIRONMENTAL STUDY DIRECTLY ON CLAIMS - INCLUDING BASE METAL VALUES, BENTHIC ANALYSIS, IMPACT ASSESSMENT, ETC.		
Assays			
Assignment from Reserve			

Total Assessment Work Claimed on the Attached Statement of Costs \$ ~~2,589.54~~ 2,590 mlk

Note: The Minister may reject for assessment work credit all or part of the assessment work submitted if the recorded holder cannot verify expenditures claimed in the statement of costs within 30 days of a request for verification.

Persons and Survey Company Who Performed the Work (Give Name and Address of Author of Report)

Name	Address
N.A.R. ENVIRONMENTAL CONSULTANTS	487 BOUCHARD ST., SUDBURY P3E 2K8
BARRINGER LABORATORIES	5735 McADAM ROAD, MISSISSAUGA, L4Z-1N9
R. PAUDHOMME, P. ENG.	1177 LONSDALE, SUDBURY P3B-1K3
F. VILLANO	1177 LONSDALE, SUDBURY P3B-1K3

(attach a schedule if necessary)

Certification of Beneficial Interest \* See Note No. 1 on reverse side

I certify that at the time the work was performed, the claims covered in this work report were recorded in the current holder's name or held under a beneficial interest by the current recorded holder.	Date Dec. 8/93	Recorded Holder or Agent (Signature) Rachel Paudhomme
--	-------------------	--

Certification of Work Report

I certify that I have a personal knowledge of the facts set forth in this Work report, having performed the work or witnessed same during and/or after its completion and annexed report is true.		
Name and Address of Person Certifying RACHEL PAUDHOMME, P. Eng., 1177 LONSDALE, SUDBURY P3B-1K3		
Telephone No. 560-4846	Date DEC. 8/93	Certified By (Signature) Rachel Paudhomme

For Office Use Only

Total Value Cr. Recorded \$ 2,590	Date Recorded December 16/93	Mining Recorder <i>[Signature]</i>	Received Stamp SUDBURY MINING DIV. RECEIVED DEC 16 1993
	Deemed Approval Date Mar 16/94	Date Approved <i>[Signature]</i>	A.M. 7 19   10   11   12   1   2   3   4   5   6 P.M.
	Date Notice for Amendments Sent		9:23 mlk

Work Report Number for Applying Reserve	Claim Number (see Note 2)	Number of Claim Units
	5865265	1
	865266	1
	1179227	2
	1179228	2
	1042961	1
	1042962	1
	1042963	1
	1042964	1
	8	

Total Number of Claims

Value of Assessment Work Done on this Claim	Value Applied to this Claim
1,295	Ø
1,295	Ø
	585
	800
	400
	400
	400
	5
\$2,590	\$2,590

Total Value Work Done

Total Value Work Applied

Value Assigned from this Claim	Reserve: Work to be Claimed at a Future Date
1,295	
1,295	
\$2,590	

Total Assigned From

Total Reserve

Credits you are claiming in this report may be cut back. In order to minimize the adverse effects of such deletions, please indicate from which claims you wish to prioritize the deletion of credits. Please mark (✓) one of the following:

- Credits are to be cut back starting with the claim listed last, working backwards.
- Credits are to be cut back equally over all claims contained in this report of work.
- Credits are to be cut back as prioritized on the attached appendix.

In the event that you have not specified your choice of priority, option one will be implemented.

Note 1: Examples of beneficial interest are unrecorded transfers, option agreements, memorandum of agreements, etc., with respect to the mining claims.

Note 2: If work has been performed on patented or leased land, please complete the following:

I certify that the recorded holder had a beneficial interest in the patented or leased land at the time the work was performed.

Signature Date



Statement of Costs for Assessment Credit

État des coûts aux fins du crédit d'évaluation

Mining Act/Loi sur les mines

Transaction No./N° de transaction

W4370.00106

2715 276

Personal information collected on this form is obtained under the authority of the Mining Act. This information will be used to maintain a record and ongoing status of the mining claim(s). Questions about this collection should be directed to the Provincial Manager, Minings Lands, Ministry of Northern Development and Mines, 4th Floor, 159 Cedar Street, Sudbury, Ontario P3E 6A5, telephone (705) 670-7264.

Les renseignements personnels contenus dans la présente formule sont recueillis en vertu de la Loi sur les mines et serviront à tenir à jour un registre des concessions minières. Adresser toute question sur la collecte de ces renseignements au chef provincial des terrains miniers, ministère du Développement du Nord et des Mines, 159, rue Cedar, 4<sup>e</sup> étage, Sudbury (Ontario) P3E 6A5, téléphone (705) 670-7264.

1. Direct Costs/Coûts directs

Type	Description	Amount Montant	Totals Total global
Wages Salaires	Labour Main-d'oeuvre	\$200 ✓	
	Field Supervision Supervision sur le terrain	\$800 ✓	\$1,000
Contractor's and Consultant's Fees Droits de l'entrepreneur et de l'expert-conseil	TYPE N.A.R. ENVIRONMENTAL / BARINGER LABORATORY	\$1,198.51 ✓	
			\$1,198.51
Supplies Used Fournitures utilisées	TYPE M.N.D.M. MAPS 4 @ \$1 + GST	\$4.60	
	Survey paint, ribbon, nails, etc	\$6.00	
	FILM & Processing	\$20.68	
			31.28
Equipment Rental Location de matériel	TYPE TRIPOLI CHAIN, LEVEL & ROD 2 days	\$90	
			\$90.00
Total Direct Costs Total des coûts directs			2,319.79

2. Indirect Costs/Coûts indirects

Note: When claiming Rehabilitation work Indirect costs are not allowable as assessment work. Pour le remboursement des travaux de réhabilitation, les coûts indirects ne sont pas admissibles en tant que travaux d'évaluation.

Type	Description	Amount Montant	Totals Total global
Transportation Transport	Type 1/2 ton 4x4 - 5 trips	\$169.75	
			\$169.75
Food and Lodging Nourriture et hébergement	MEALS	\$100.00	\$100.00
Mobilization and Demobilization Mobilisation et démoblisation			
Sub Total of Indirect Costs Total partiel des coûts indirects			269.75
Amount Allowable (not greater than 20% of Direct Costs) Montant admissible (n'excédant pas 20% des coûts directs)			269.75
Total Value of Assessment Credit (Total of Direct and Allowable indirect costs) Valeur totale du crédit d'évaluation (Total des coûts directs et indirects admissibles)			2,589.54

Note: The recorded holder will be required to verify expenditures claimed in this statement of costs within 30 days of a request for verification. If verification is not made, the Minister may reject for assessment work all or part of the assessment work submitted.

Note: Le titulaire enregistré sera tenu de vérifier les dépenses demandées dans le présent état des coûts dans les 30 jours suivant une demande à cet effet. Si la vérification n'est pas effectuée, le ministre peut rejeter tout ou une partie des travaux d'évaluation présentés.

Filing Discounts

- Work filed within two years of completion is claimed at 100% of the above Total Value of Assessment Credit.
- Work filed three, four or five years after completion is claimed at 50% of the above Total Value of Assessment Credit. See calculations below:

Total Value of Assessment Credit	Total Assessment Claimed
	x 0.50 =

Remises pour dépôt

- Les travaux déposés dans les deux ans suivant leur achèvement sont remboursés à 100% de la valeur totale susmentionnée du crédit d'évaluation.
- Les travaux déposés trois, quatre ou cinq ans après leur achèvement sont remboursés à 50% de la valeur totale du crédit d'évaluation susmentionné. Voir les calculs ci-dessous.

Valeur totale du crédit d'évaluation	Evaluation totale demandée
	x 0,50 =

Certification Verifying Statement of Costs

I hereby certify: that the amounts shown are as accurate as possible and these costs were incurred while conducting assessment work on the lands shown on the accompanying Report of Work form.

that as PRESIDENT I am authorized (Recorded Holder, Agent, Position in Company)

to make this certification

Attestation de l'état des coûts

J'atteste par la présente: que les montants indiqués sont le plus exact possible et que ces dépenses ont été engagées pour effectuer les travaux d'évaluation sur les terrains indiqués dans la formule de rapport de travail ci-joint.

Et qu'à titre de \_\_\_\_\_ je suis autorisé (titulaire enregistré, représentant, poste occupé dans la compagnie)

à faire cette attestation.

Signature: Rachel Prud'homme Date: Dec. 15/93

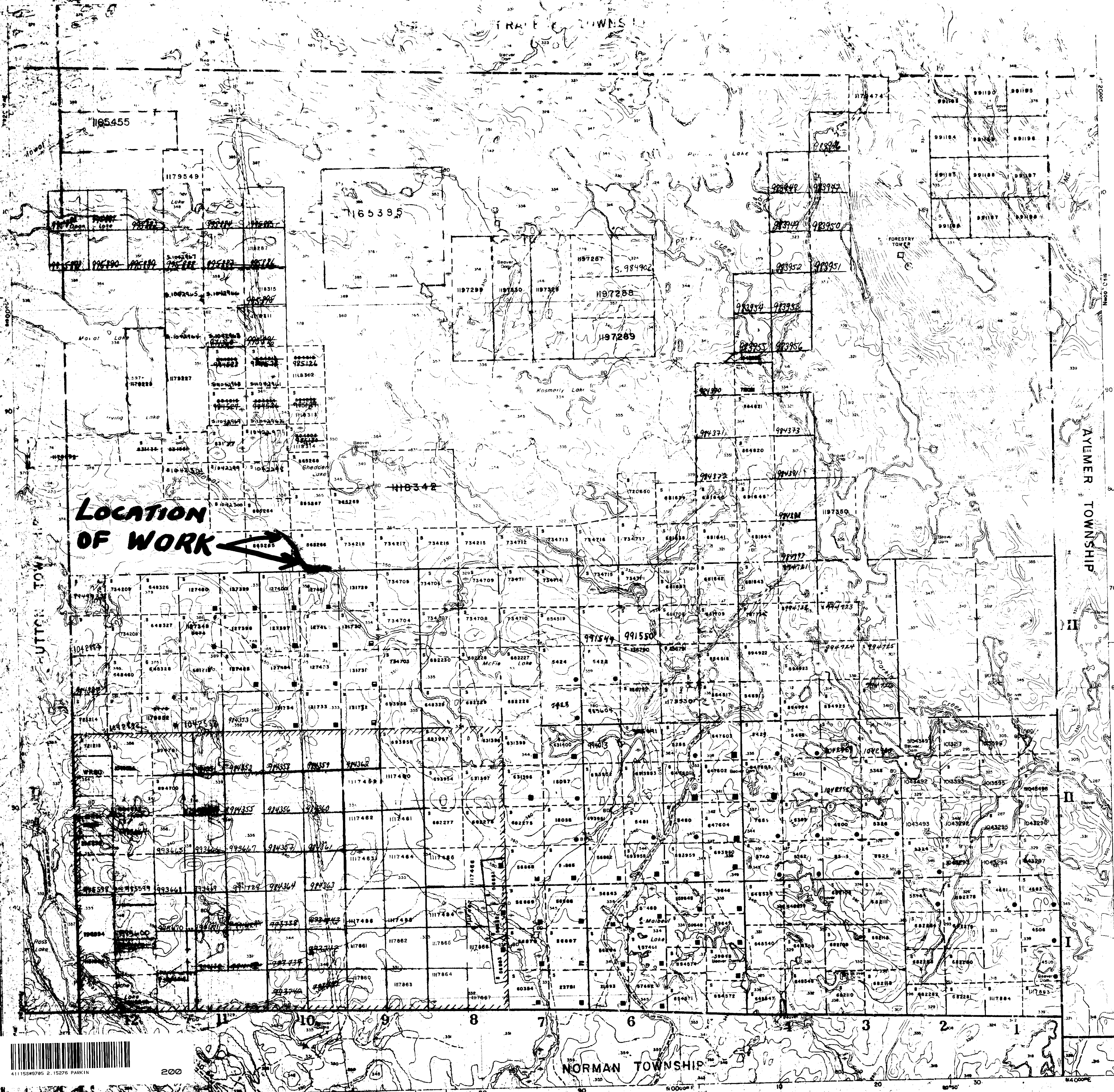

**INDEX TO LAND DISPOSITION**

**PARKIN**

SUBURRY  
MINING DIVISION  
SUBURRY  
LAND REGISTRY DIVISION  
SUBURRY

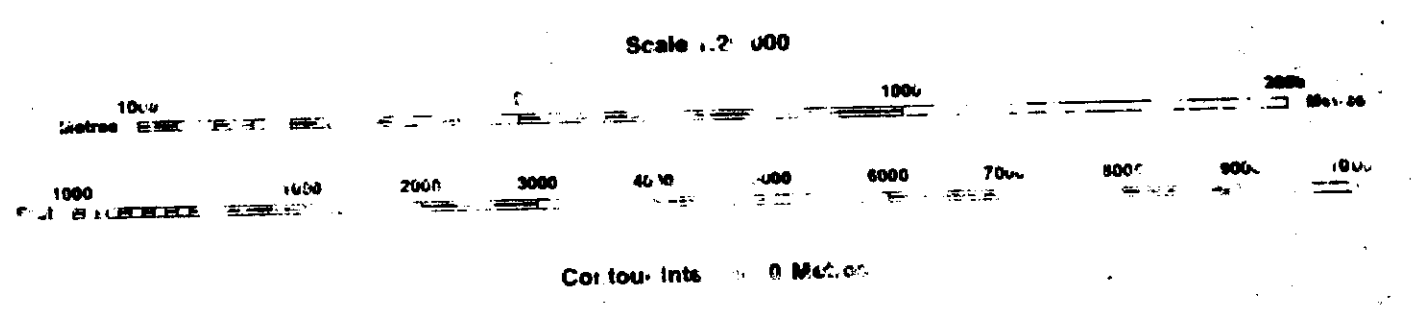

**AREAS WITHDRAWN FROM DISPOSITION**

Description	Crown No.	Date	Page No.	File
SEC. 36/80	87/87	7/1/85	8/8	1075/8

**SYMBOLS**

Boundary	.....
Township, Meridian, Baseline	.....
Road allowance, surveyed	.....
shoreline	.....
Lot/Concession, surveyed	.....
unsurveyed	.....
Parcel, survey	.....
unsurveyed	.....
Right-of-way, road	.....
railway	.....
utility	.....
Reservation	.....
Cliff, Pit, Pile	.....
Contour	.....
Intermittent	.....
Approximate	.....
Depression	.....
Control point (horizontal)	.....
Flooded land	.....
Mine head frame	.....
Pipeline (above ground)	.....
Railway: single track	.....
double track	.....
abandoned	.....
Road, highway, county, township	.....
access	.....
trail, bush	.....
Shoreline (original)	.....
Transmission lines	.....
Wooded area	.....

MINING & SURFACE RIGHTS OPENED JUNE 1, 1998

**DATE OF ISSUE**  
MAY 5 1993  
SUBURRY  
MINING RECORDER'S OFFICE

**DISPOSITION OF CROWN LANDS**

Patent	.....
Surface & Mining Rights	.....
Surface Rights Only	.....
Mining Rights Only	.....
License	.....
Surface & Mining Rights	.....
Surface Rights Only	.....
Mining Rights Only	.....
Licence of Occupation	.....
Order-in-Council	.....
Cancelled	.....
Reservation	.....
Sand & Gravel	.....

THE INFORMATION THAT APPEARS ON THIS MAP HAS BEEN COMPILED FROM VARIOUS SOURCES AND ACCURACY IS NOT GUARANTEED. THOSE WISHING TO STAKE MINING CLAIMS SHOULD CONSULT WITH THE MINING RECORDER, MINISTRY OF NORTHERN DEVELOPMENT AND MINES, FOR ADDITIONAL INFORMATION ON THE STATUS OF THE LANDS SHOWN HEREON.

NOTE: TOWNSHIP SUBDIVISION PARTIALLY ANNULLED MARCH 8, 1949

IN AREA MARKED THIS STAKING ALLOWED AS IN UNSUBDIVIDED TOWNSHIP SECTION 45 MINING ACT.

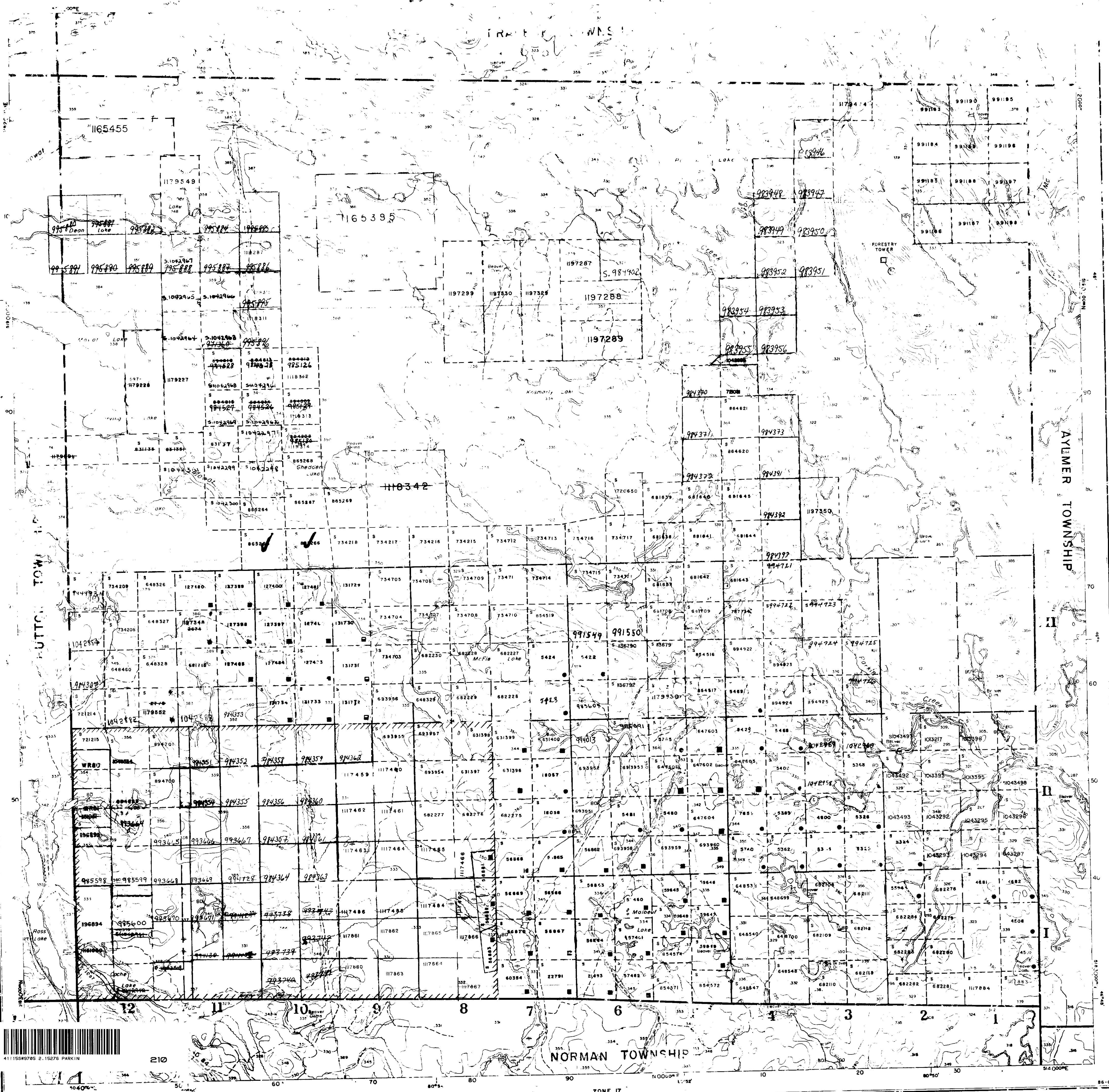

**INDEX TO LAND DISPOSITION**

MINISTRY OF NATURAL RESOURCES  
 SUBURRY  
 MINING DIVISION  
 SUBURRY  
 LAND REGISTRY DIVISION  
 SUBURRY

**PARKIN**

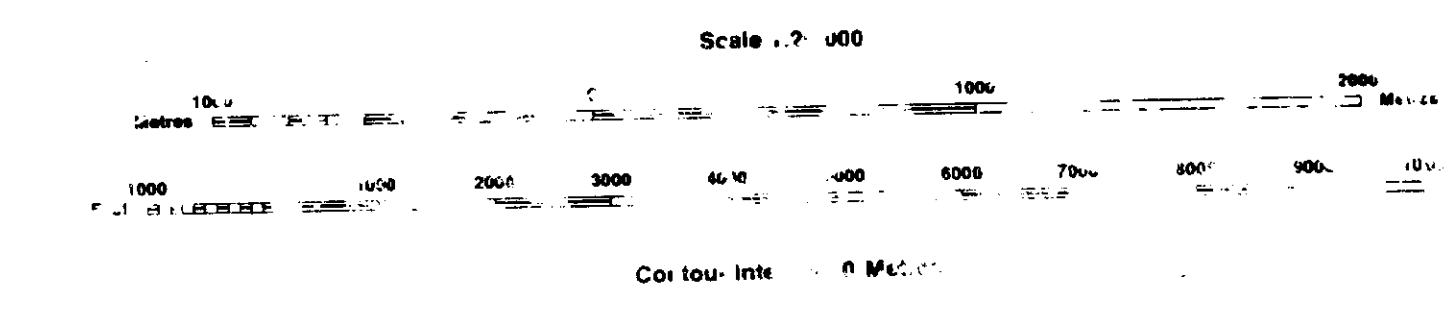

**AREAS WITHDRAWN FROM DISPOSITION**  
 MRU - Mining Rights Only  
 SRO - Surface Rights Only  
 M+S - Mining and Surface Rights

**SYMBOLS**

- Boundary
- Township, Meridian, Baseline
- Road allowance; survey
- shoreline
- Lot/Concession; survey
- Unsurveyed
- Parcel; survey
- survey eye
- Right-of-way; road
- utility
- Reservation
- Cliff, Pit, Pie
- Contour
- Intermittent
- Approximate
- Depression
- Control point (horizontal)
- Flooded land
- Mine head frame
- Pipeline (above ground)
- Railway; single track
- double track
- abandoned
- Road; highway, county, township
- road
- trail, bush
- Shoreline (original)
- Transmission lines
- Wooded area

**DATE OF ISSUE**  
 1993  
 SUBURRY  
 MINING RECORDER'S OFFICE

MINING & SURFACE RIGHTS OPENED JUNE 1, 1992

**DISPOSITION OF CROWN LANDS**

- Patent
- Surface & Mining Rights
- Surface Rights Only
- Mining Rights Only
- Lease
- Surface & Mining Rights
- Surface Rights Only
- Mining Rights Only
- License of Occupation
- Order-in-Council
- Cancelled
- Reservation
- Sand & Gravel

NOTE: TOWNSHIP SUBDIVISION PARTIALLY ANNULLED  
 MARCH 8, 1949

IN AREA MARKED THUS STAKING ALLOWED  
 AS IN UNSUBDIVIDED TOWNSHIP - SECTION 45 MINING ACT



G-5013

G-5013

CLAIM 865267

2 152 76

CLAIM 865266

CLAIM 734214

CLAIM 865265

LINE CORRIDOR

HYDRO-POWER SWAMP

SWAMP

MAIN WEST DEPOSIT

BUILDING

MAIN EAST DEPOSIT

ROAD

ROAD

ACCESS ROAD

MOWAT CREEK

\* LOCATION OF WATER SAMPLE IN CREEK

MOWAT CREEK

BAILEY BRIDGE

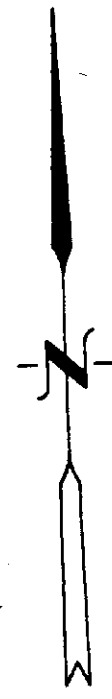

SCALE 1:2500

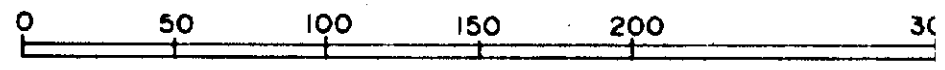

METRES



41115SW9705 2.15276 PARKIN

220

MAP SHOWING LOCATION WHERE WATER SAMPLE WAS TAKEN