

REI



ELECTRICAL J

010

PART OF

LAKE TEMAGAMI PROPERTY

PHYLLIS TWP., ONTARIO

FOR

TEMAGAMI MINING CO., LIMITED

BY

GEOPHYSICAL ENGINEERING & SURVEYS LIMITED

INTRODUCTION

This report covers an electrical resistivity survey completed on claims T-35255 and T-35256 located in the northeast portion of Lake Temagami. The claims are accessible by boat or aircraft from the settlement of Temagami about 15 miles to the northeast.

GENERAL GEOLOGY

The claims are covered by the waters of Lake Temagami. Acid volcanic rocks, including rhyolite flows and fragmentals outcrop on Temagami Island, immediately west of claim T-35255. Conglomerate of the Cobalt series is exposed on Denedus Point to the north of claim T-35256.

GEOPHYSICAL SURVEY

Sixty cycle alternating current was introduced into the earth through electrodes spaced 15,000 feet apart. Two such electrode set-ups were used. Readings were taken between potential probes spaced 200 feet apart along picket lines parallel to the electrode line using a vacuum-tube voltmeter. Apparent average earth resistivities were calculated and plotted logarithmically.

DISCUSSION OF GEOPHYSICAL RESULTS

A local area of lower than average resistivity was indicated near the N.W. corner of claim T-35256 near the shore.

It is recommended that the rocks along the shore be examined in the vicinity of the anomaly mentioned above and that this area be further tested by an electromagnetic survey.

Respectfully submitted,

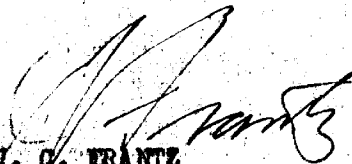

J. O. ERANTZ

GEOPHYSICAL ENGINEERING & SURVEYS LTD.

July 19, 1956  
North Bay, Ontario.

APPENDIX TO GEOPHYSICAL ENGINEERING & SURVEYS LTD. REPORT 133MB

PROPERTY: Claims T-35255, T-35256, Phyllis Twp. ✓

MILES OF PICKET LINE: 5½

GEOPHYSICAL READINGS: 265

TIME DISTRIBUTION

Surveying, picketing, chaining	7 days
Geophysical readings	10 days
Calculating, plotting, drafting, interpretation	6 days

Applicable to assessment credit per claim. 20 X 4 = 80 to be applied forty days ✓

PERSONNEL

Field

- W. Becker - Temagami - Mar. 20 to April 16/56 intermittantly
- E. Aubut - " "
- H. Reynolds, North Bay "
- C. Wilson, " "

Office

- J. C. Frantz - North Bay - June 24 to July 18/56 intermittantly
- H. Stoeckert - " "
- W. Domerecki - " "
- Y. Martin - " "

PART OF LAKE TEMAGAMI PROPERTY (Claim T-35254)PHYLLIS TOWNSHIP ONTARIO

FOR

TEMAGAMI MINING

41116NE0028 63.703 PHYLLIS

020

BY

GEOPHYSICAL ENGINEERING & SURVEYS LTD.INTRODUCTION

Claim T-35254 is located at the south west end of Temagami island in Phyllis township, Ontario, and consists of land under the waters of Lake Temagami. It is accessible by boat or aircraft from the settlement at Temagami about 14 miles to the northeast.

GENERAL GEOLOGY

Flat-lying conglomerate of the Cobalt series outcrops on islands within the claim boundaries. Immediately to the west of the claim, Reswain-type rhyolites and fragmentals have been exposed by erosion of the Cobalt sediments suggesting that the Cobalt sediments are relatively thin in this area.

GEOPHYSICAL SURVEY

The claim was surveyed in the course of an electrical survey covering a large section of the Temagami Mining Co., Ltd. property. Sixty cycle alternating current was introduced into the ground through electrodes spaced two miles apart. Two such electrode configurations were used. Voltage drops were measured along picket lines parallel to the electrode line using a vacuum-tube voltmeter. Apparent average earth resistivities were calculated and plotted logarithmically.

DISCUSSION OF GEOPHYSICAL RESULTS

No significant areas of low resistivity were outlined, and no sizeable concentrations of sulphides were suggested.

Respectfully submitted,

J. C. FRAETZ

May 10, 1966  
North Bay, Ontario

APPENDIX TO REPORT #120NB

PROPERTY: T35254 ✓

INSTRUMENT: Vacuum-tube voltmeter, resistivity survey.

MILES OF PICKET LINE: 2

GEOPHYSICAL STATIONS: 105

PERSONNEL

Field

T.G. Robinson - Kirkland Lake	January 1955.
O. Montroy - Temagami	January 1955.
T. Becker - Temagami	January 1955.
E. Friday - Temagami	January 1955.

Office

W.R. Bergey - Kitchener	January 1955.
J.C. Frantz - North Bay	April 1956.
L. Vosu - North Bay	April 1956.

TIME DISTRIBUTION

Survey, picketing, chaining .....	3 days, January 1955.
Geophysical readings .....	4 days, January 1955.
Calculating and plotting .....	2 days, January 1955.
Drafting, and report .....	1 1/2 days, January 1956.

10 days X4 = 40 days. ✓



41116NE0028 63.703 PHYLLIS

REP

030

ELECTRICAL RESISTIVITY SURVEY

OGAMA SECTION, LAKE TEMAGAMI PROPERTY

PHYLLIS TOWNSHIP, ONTARIO

FOR

TEMAGAMI MINING CO., LTD.

BY

GEOPHYSICAL ENGINEERING & SURVEYS LTD.

INTRODUCTION

The Ogama section of the Lake Temagami property includes six claims in Lake Temagami on the west side of Temagami Island. The claims T-35248 to T-35253 are accessible by boat or aircraft from the town of Temagami about 15 miles to the northeast.

GENERAL GEOLOGY

The claims are covered by the waters of Lake Temagami. Gently-dipping Cobalt conglomerate is exposed on islands within the claim boundaries, and in the surrounding area.

GEOPHYSICAL SURVEY

An electrical resistivity survey was carried out from the ice. Sixty cycle alternating current was introduced into the earth through electrodes spaced 12,000 feet apart. Voltage drops were measured with a vacuum-tube voltmeter, between probes spaced 100 feet apart along lines parallel to the electrode line.

Apparent average earth resistivities in the vicinity of each station were calculated and plotted logarithmically.

DISCUSSION OF RESULTS OF SURVEY

No significant conducting areas were outlined by the survey, and no further work in this section of the property is recommended.

Respectfully submitted,



J. C. PRANTZ

North Bay, Ontario,  
May 3, 1956

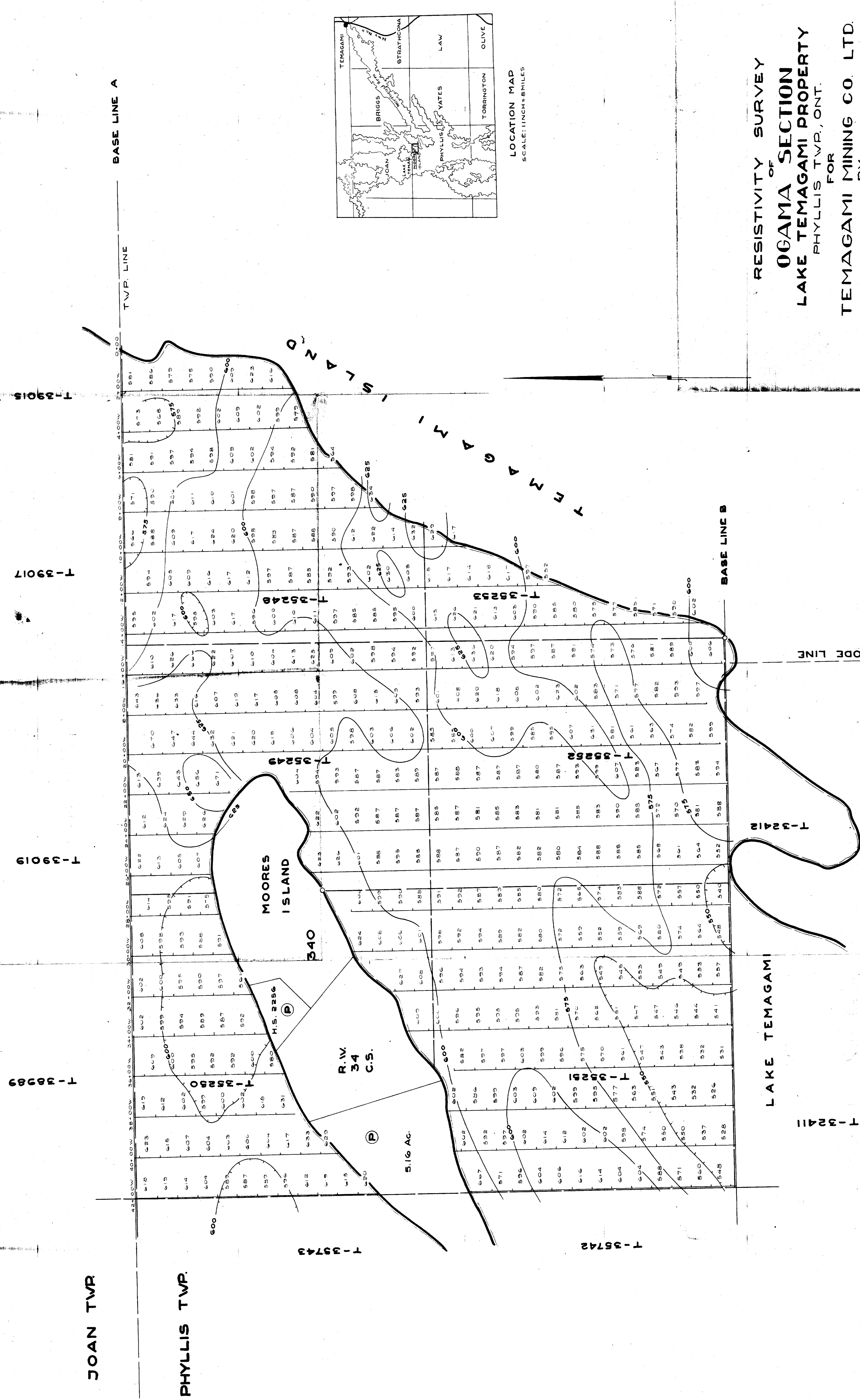

RESISTIVITY SURVEY  
 OF  
**OGAMA SECTION**  
 LAKE TEMAGAMI PROPERTY  
 PHYLIS TWP., ONT.  
 FOR  
 TEMAGAMI MINING CO. LTD.  
 BY  
**GEOPHYSICAL ENGINEERING & SURVEYS LTD.**

NOTE: VALUES ARE APPARENT AVERAGE  
 RESISTIVITIES IN 100 log<sub>10</sub> ohm-cm.

SCALE: 1 INCH = 1250 FEET



411188888 63-703 PHYLIS





ELECTRICAL RESISTIVITY SURVEY  
 PART OF  
**LAKE TEMAGAMI PROPERTY**  
 PHYLIS TWP. ONT.  
 FOR  
**TEMAGAMI MINING CO. LIMITED**  
 BY  
**GEOPHYSICAL ENGINEERING & SURVEYS LIMITED**

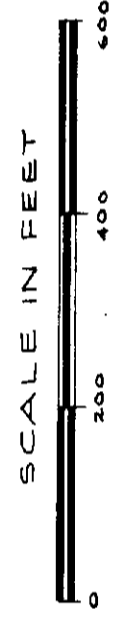

NOTE: VALUES ARE APPARENT  
 AVERAGE EARTH RESIS-  
 TIVITIES AS 100  $\log_{10}$  ohm cm.

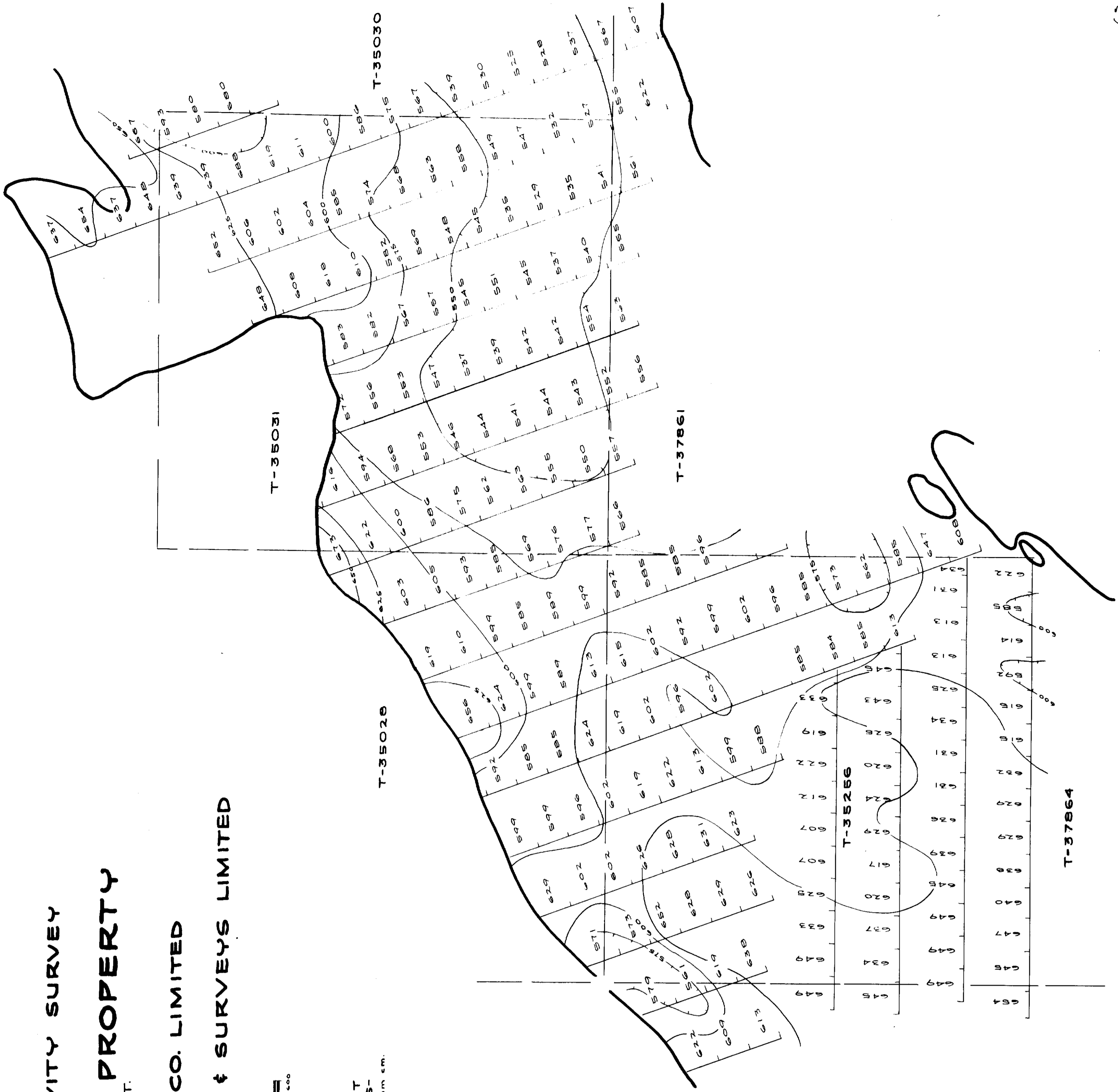
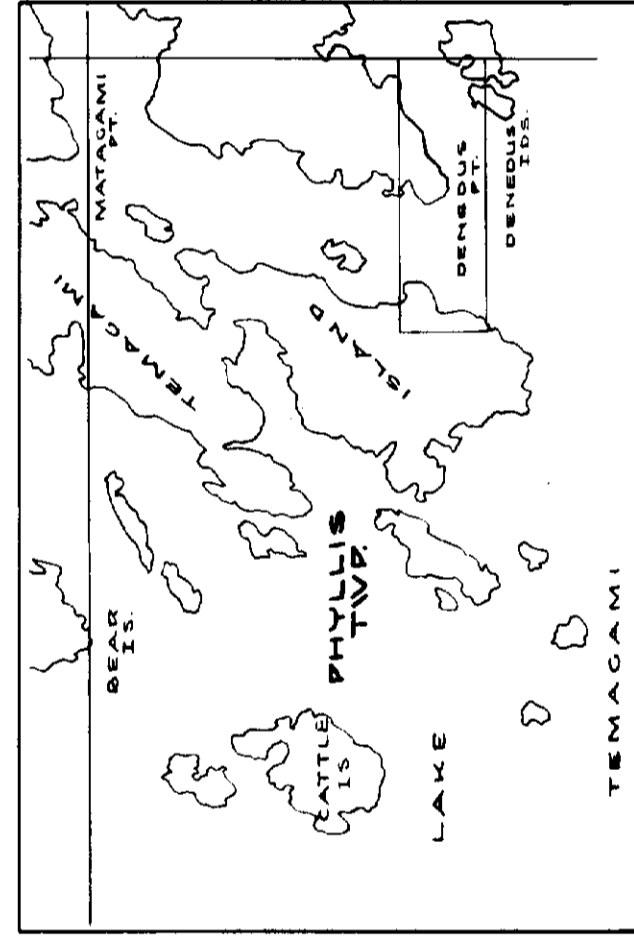

TEMAGAMI  
 ISLAND

