



Diamond Drilling

010

Township of PHYLLIS

Report NO 12

Work performed by: Frontenac Exploration

Claim NO	Hole NO	Footage	Date	Note
T 33041	102	991.0'	Mar/53	
T 32246	70	206.0'	Sept/52	
	101	832.0'	Feb/53	
	64	354.0'	Oct/52	
	58	530.0'	Oct/52	

Notes:

T 32246 682

LOG OF DIAMOND DRILL HOLE XX 70

Hole drilled By Canadian Longyear for Frontenac Exp. & Dev. Co.Ltd.

Hole drilled on Derosier License of Occupation Land - beneath
Lake Temagami under claim T 31,871

Length of Hole: 206' (Portion beneath claim 31,871 - 150')

Inclination: - 45° Bearing: S 63°53' E

Core stored in core shed - Temagami Island - License of Occupation

Size Core: AXT Core logged By: R. F. Roy, Geologist

Date Drilled: September, 1952

Core Log

Distance (Feet)		Geology
From	To	
0	36	Glacial debris - cased.
36	180	Dark gray-green, splotchy and mottled textured, diorite containing siliceous areas and a few specks of pyrite and chalcopyrite. The white phenocrysts are soft and altered. Relatively weak chloritization along contact from 160 to 180 and this area has a somewhat stronger sulfide mineralization.
180	206	Fine, even grained, light gray, rhyolite with few disseminated specks of pyrite and chalcopyrite.



Log - Geology - Diamond Drill Hole 102

Hole drilled for Frontenac Exploration & Development Company Limited
By: Canadian Longyear Limited, North Bay, Ontario

Depth: 991' Bearing: S 17°E Inclination: - 71° Size: AXT

February - March, 1953

Core stored in core racks - Temagami Island - License of Occupation
Derosier Nickel & Copper Mines Limited.

GEOLOGY

Distance		Observations
From	To	
0	25	Lake Temagami - water.
25	75	Glacial Debris - sands, gravels, boulders, etc;
75	80	Diorite: Dark green, medium grained rock containing gray corroded feldspars.
80	99	Andesite: dark green fine to medium grained rock
99	125.5	Diorite:
125.5	181	Andesite: speckled, epidotized, laths of feldspars, diabasic texture (dike rock ?)
181	598	Diorite: Typical diorite with phenocrysts of leucoxene and corroded feldspars.
578	731	Andesite: grey-green, fine to medium grained, diabasic dike (?)
731	991	Diorite: dark green, fine to medium grained, with irregular patchy grey, altered feldspars and white leucoxene blebs. Scattered patches of weak disseminations of pyrite.

Geology logged by J.L.Kelly and C.F. Cheriton, geologists



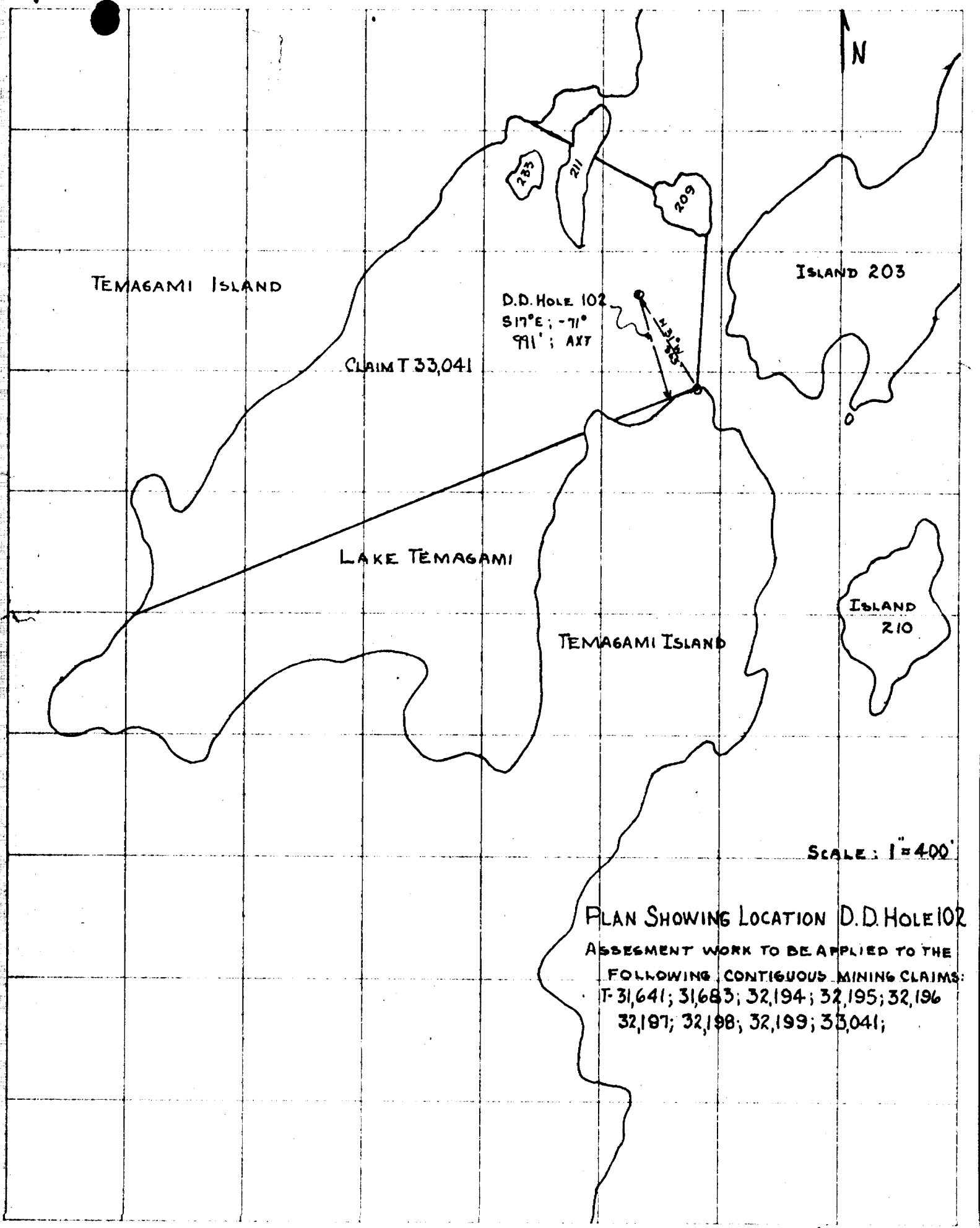

D.D. HOLE 102
 S17°E; -71°
 911' AXZ

CLAIM T 33,041

SCALE: 1" = 400'

PLAN SHOWING LOCATION D.D. HOLE 102
 ASSESSMENT WORK TO BE APPLIED TO THE
 FOLLOWING CONTIGUOUS MINING CLAIMS:
 T 31,641; 31,683; 32,194; 32,195; 32,196
 32,197; 32,198; 32,199; 33,041;

Log - Geology - Diamond Drill Hole 101

Hole drilled for Frontenac Exploration & Development Company Limited
By: Canadian Longyear Limited, North Bay, Ontario

February, 1953

Depth: 832' Bearing: S 27°E Inclination: - 52° Size: AXT

Core stored in core racks - Temagami Island - License of Occupation
Derosier Nickel and Copper Mines Limited.

GEOLOGY

Distance		Observations
From	To	
0	11	Casing thru glacial debris.
11	30.5	Andesite: gray finely granular rock speckled with tiny light brown to white blebs of feldspars.
30.5	43	Diorite: Dark gray-green porphyritic rock with scattered phenocrysts of leucoxene.
43	106	Andesite: Same as 11 to 30.5.
106	442.5	Diorite: same as 30.5 to 43.
442.5	477	Andesite: Gray-green fine, equigranular rock containing numerous tan colored specks.
477	485	Diorite: Bunchy white carbonate with specks and blebs of pyrite with a little chalcopyrite.
485	574	Andesite: same as 442.5 to 477.
574	609	Rhyolite: Grey, fine grained, siliceous rock with narrow stringers and small spots of chlorite containing weak specks of pyrite and chalcopyrite noted.
609	613	Andesite:
613	648	Diorite: gray greenish porphyritic rock with blebs of leucoxene
648	663	Andesite:
663	668	Diorite:
668	832	Andesite:



Geology logged by J.I. Kelly and C.F. Cheriton, geologists

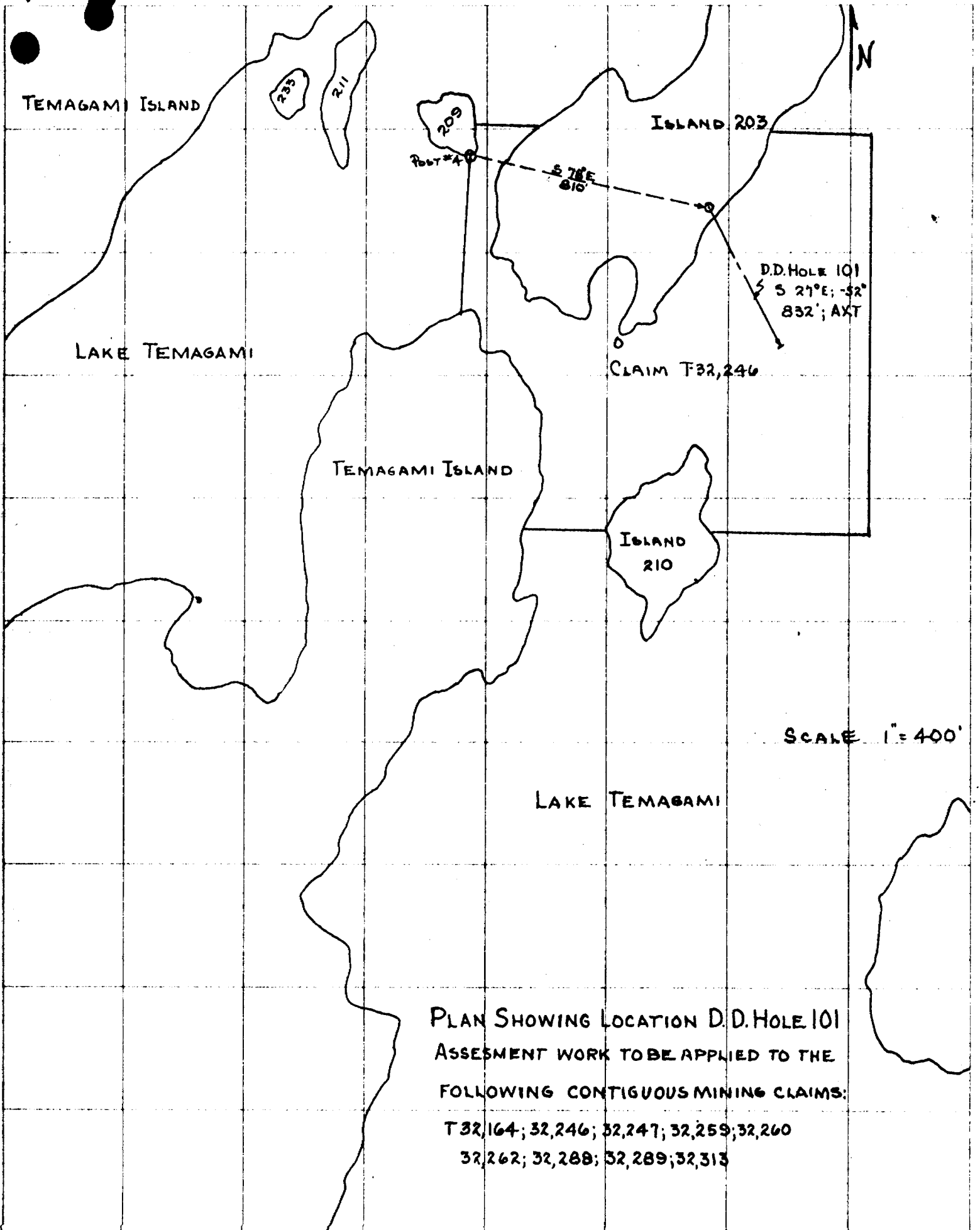

PLAN SHOWING LOCATION D. D. HOLE 101
 ASSESMENT WORK TO BE APPLIED TO THE
 FOLLOWING CONTIGUOUS MINING CLAIMS:
 T32,164; 32,246; 32,247; 32,259; 32,260
 32,262; 32,288; 32,289; 32,313

Log of Geology Hole 64

135746
70R

Hole drilled in area of previous Knight-Derosier Drilling:
Dearing of Hole S 66°E Dip: - 45°

Core located in core shed on the Derosier- License of Occupati on
Core Logged and read by: E.H. Eakland, Geologist

Distance (Feet)		Geology
From	To	
0	16	Casing - thru overburden.
16	130	Variable textured dark grey-green, diorite with weak disseminations of pyrite.
130	152	Fine grained, dark grey, andesite dike with containing a few specks of pyrite.
152	271	Variable textured, dark grey-green diorite becoming more chloritic with depth.
271	290	Dense, fine grained, dark green, chlorite rock with local blotches of massive sulfide mineralization - weak chalcopyrite.
290	354 (bottom)	Mottled, fine grained, grey, rhyolite, containing few specks of sulfides - mostly pyrite.

Hole was drilled by Canadian Longyear Ltd., North Bay, Ont.
September-October, 1952

Work Supervised By: Frontenac Exploration and Development Co.
W.T. Swensen - E.H. Eakland - Geologists



T32206
77R

Log of Geology Hole 58

Hole Drilled on License Of Occupation Land to go below lake and beneath claims Nos. T 32,164 and T 32,246 in the area of the Knight Derosier Drilling.

Bearing of Hole: S 17°E Dip: -45°

Core located in core shed on License of Occupation land - Derosier.

Core Logged and read by: E. F. Roy, Geologist

Distance (feet)		Geology
From	To	
0	17	Casing thru overburden.
17	147	Mottled textured, dark green-gray, diorite with coarse white phenocrysts and contains only weak disseminations of pyrite. Chalcopyrite noted.
147	154	Very fine grained, medium gray, andesite dike.
154	245	Mottled textured diorite with weak disseminations of blotchy pyrite. Chlorite and pyrite increase in amount - downward.
245	270	Dense fine grained, gray green chlorite rock with some massive sulfide replacement from 249 to 260. Massive sulfides mostly pyrite though whalcopyrit chalcopyrite was easily identified.
270	285	Medium gray mottled, fragmental textured rhyolite with only weak disseminations of pyrite and chalcopyrite
		Hole goes beneath lake and claim No. T32,246 at this point.
285	450	Rhyolite as described in interval immediately preceding.
450		Hole crosses under claim No. T 32,164 at this depth.
450	530 (Bottom)	Some rhyolite but with fragmental or agglomeratic texture.

Hole was drilled By: Canadian Longyear Limited, North Bay, Ontario
September-October, 1952

Work Supervised By: Frontenac Exploration and Dev. Co. Ltd.
W.T.Swensen - E.H.Eakland, Geologists

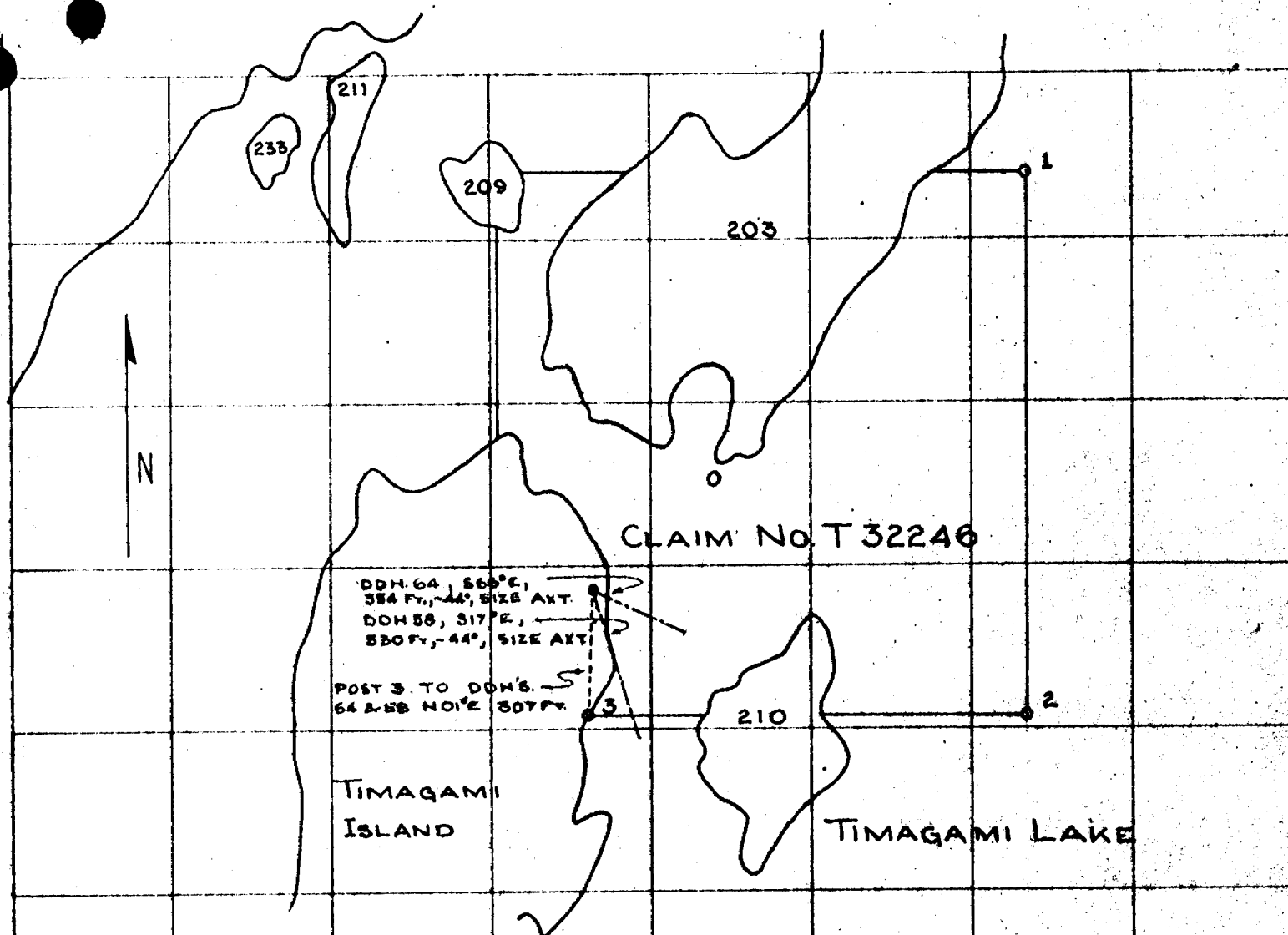

PLAN SHOWING LOCATION OF D.D HOLES 53 & 64
 ASSESSMENT WORK TO BE APPLIED TO THE FOLLOWING
 NINE CONTIGUOUS MINING CLAIMS: T-32246, 32247,
 33041, 32199, 31683, 32198, 31641, 32197, & T-32196

20mc 31 Oct 1952