

Diamond Drilling



41116NE0052 10 PHYLLIS

010

Township of PHYLLIS

Report NO 10

Work performed by: Frontenac Exploration

Claim NO	Hole NO	Footage	Date	Note
T 32656	94	42.0'	Nov/52	..
	109	76.0'	Feb/53	
T 32164	55	510.0'	Oct/52	
	58	530.0'	Oct/52	
	68	216.0'	Oct/52	

Notes:

PHYLLIS
TWP.

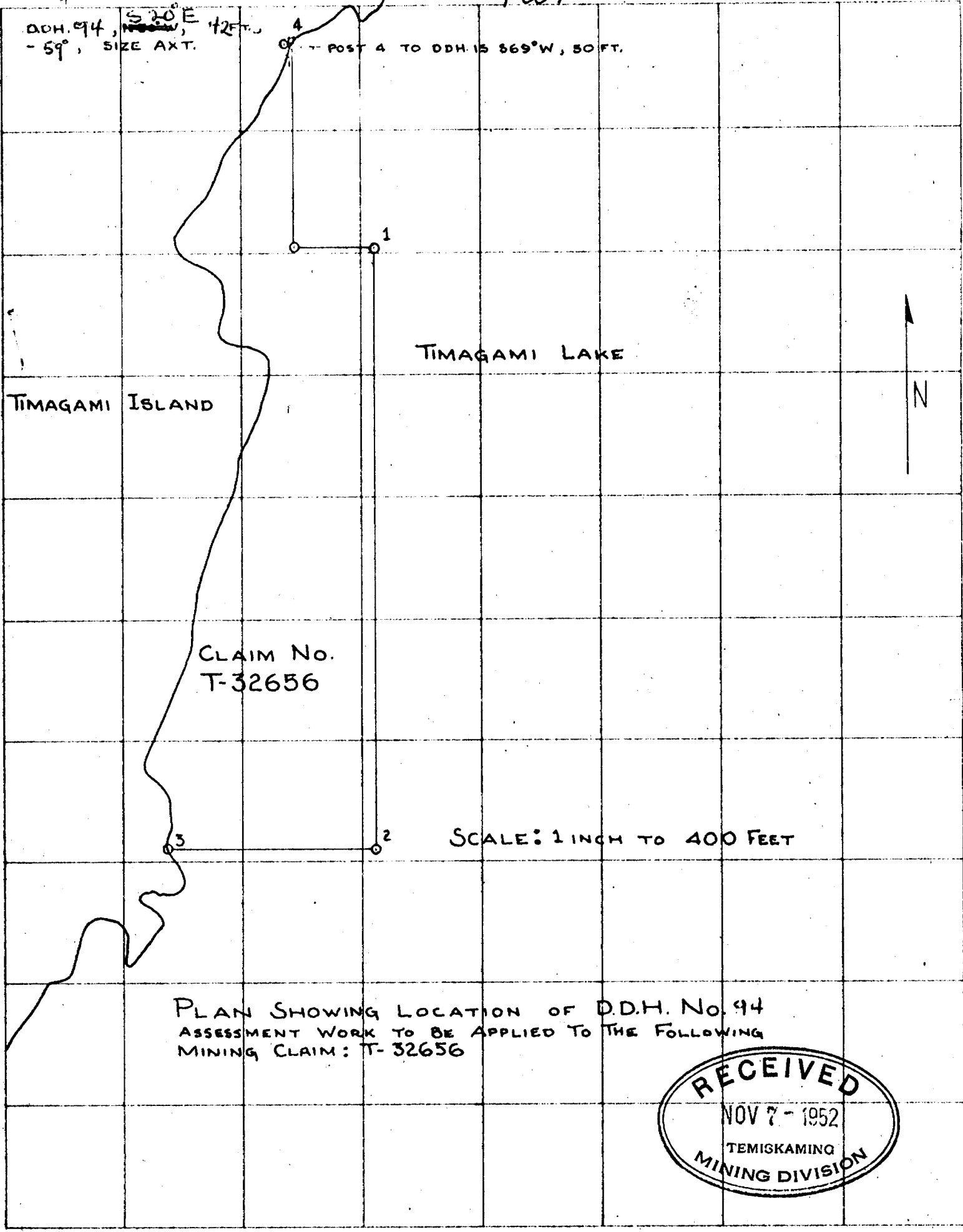

DDH. 94, S 20° E, 42 FT.,
- 59°, SIZE AX'T.

POST 4 TO DDH. IS S 69° W, 50 FT.

TIMAGAMI ISLAND

TIMAGAMI LAKE

CLAIM No.
T-32656

SCALE: 1 INCH TO 400 FEET

PLAN SHOWING LOCATION OF D.D.H. No. 94
ASSESSMENT WORK TO BE APPLIED TO THE FOLLOWING
MINING CLAIM: T-32656



Log Of Diamond Drill Hole 94

Hole Drilled By Canadian Longyear Limited, For Frontenac Exp.
& Dev. Company Limited

Hole was drilled on Claim No. T 32,656 approximately 10 feet from
the shore, in Lake Temagami.

Depth Of Hole: 42' Inclination: -59° Bearing: S 20° E

Core Stored in Core shed located on the License Of Occupation land
of the Derosier Copper & Nickels Mines - Temagami Island.

Size of Core: AXT Core Logged By: E.H. Eakland, Jr., Geologist

Date Drilled: November 5-6, 1952

Core Log

Dist. (Feet)		Geology
From	To	
0	30	Glacial debris - Cased.
30	42	Subschistose fine grained rhyolite; moderately chloritized with few thin veinlets and blebs of white carbonate. Sulfide mineralization limited to few specks of chalcopyrite and pyrite.



Log - of - Geology - Diamond Drill Hole 109

Drilled fro Frontenac Exploration & Development Company Limited
by: Canadian Longyear Limited, North Bay, Ontario

February, 1953

Depth: 76' Bearing: N 45°W Inclination: - 45° Size: AXT

Core stored in core racks - Temagami Island - License of Occupation
Perosier Nickel and Copper Mines Ltd.

GEOLOGY

Distance		Observations
From	To	
o	25	Water - Lake Temagami
25	76	Glacial debris - sand, gravels, boulders, etc;
Hole was abandoned when it became impossible to drive casing any deeper.		



(collar in shallow water of lake)

D.D.H. 94, S 20° E, 42 FT.,
- 59°, SIZE AXT.

POST 4 TO DDH. IS S 69° W, 50 FT.

D.D. HOLE 109; N 45° W
76'; - 45°; AXT

S 15° W
50 FT.

1

TIMAGAMI LAKE

TIMAGAMI ISLAND

N

CLAIM NO.
T-32656

SCALE: 1 INCH TO 400 FEET

PLAN SHOWING LOCATION OF D.D.H. NOS. 94 AND 109
ASSESSMENT WORK TO BE APPLIED TO THE FOLLOWING
MINING CLAIM: T-32656

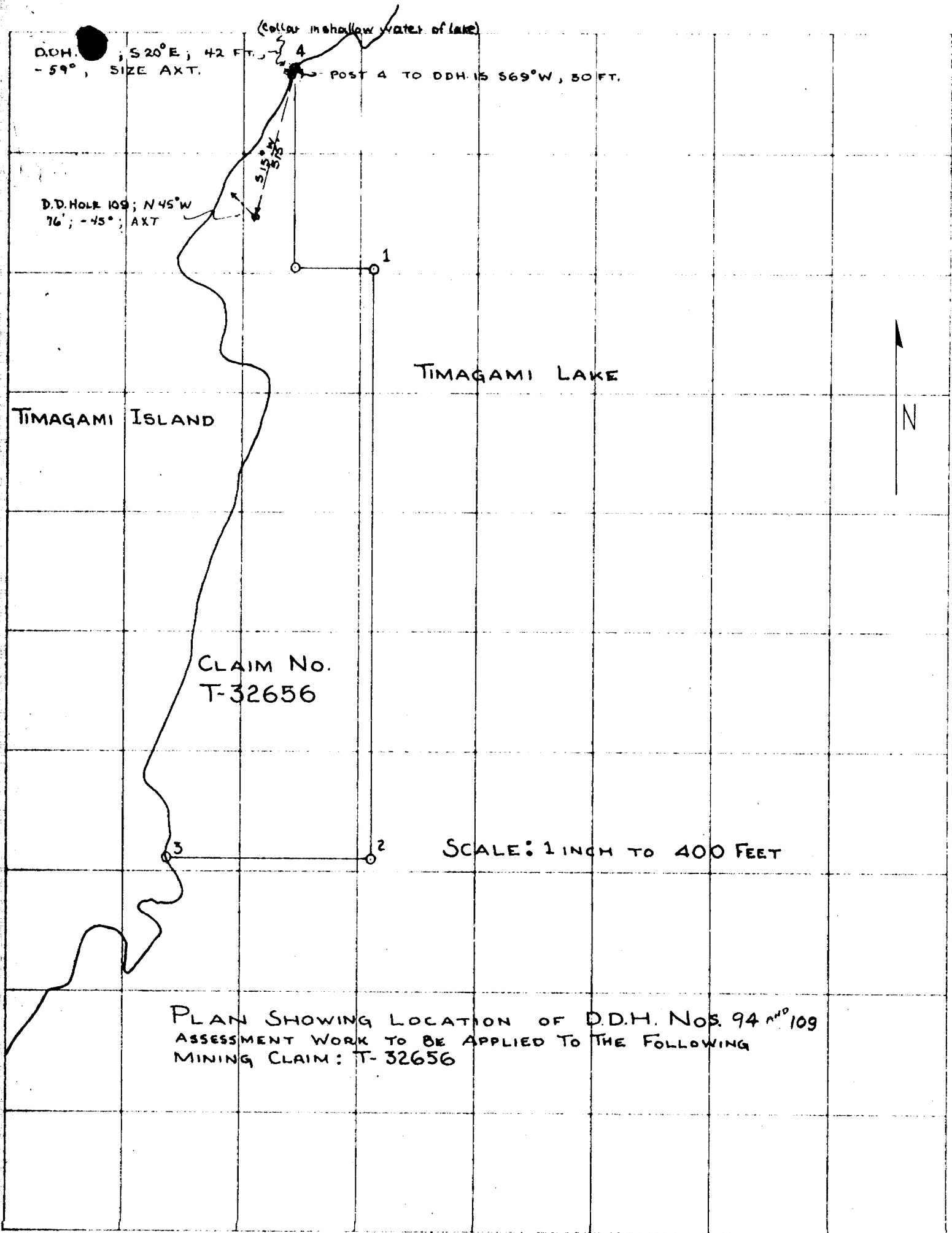

132164

Log of Geology Hole 55

Drilled on License of Occupation land - beneath lake and under claim No. T 32,164.

Bearing of Hole: S 19°E Dip: -40° Core Size: AXT

Core located in Core Shed on the license of Occupation Land - Temagami Island - Derosier.

Core Logged and read by: E.H. Eakland Jr., Geologist

Distance (feet)		Geology
From	To	
0	15	Casing thru overburden
15	160	Porphyritic diorite with fine grained chloritize a groundmass with weak disseminations of pyrite.
160	185	Alternating 5 foot bands of rhyolite and diorite with only weak sulfide mineralization.
185	209	Fine grained, gray andesite dike.
209	255	Gray fine grained andesite(?) porphyry with few patches of chlorite alteration and weak sulfide mineralization.
255	280	Dense, gray-green, fine grained chlorite rock with patches of massive sulfides - replacement mineralization in chlorite rock - generally pyrite - chalcopyrite noted.
280	362	Grey crackled rhyolite with weak disseminations of pyrite; few quartz-carbonate veinlets with border alteration of chlorite - takes on an agglomeratic texture.
		Hole goes beneath lake and claim No T 32,164 at this point.
362	510 (bottom)	Agglomeratic rhyolite with few specks of pyrite and chlorite.

Hole was drilled By: Canadian Longyear Limited, North Bay, Ontario

Work was supervised by: Frontenac Exploration and Development Co.
W.T. Swensen - E.H. Eakland Jr. - Geologist s

132164

Log of Geology Hole 58

Hole Drilled on License Of Occupation Land to go below lake and beneath claims Nos. T 32,164 and T 32,246 in the area of the Knight Derosier Drilling.

Bearing of Hole: S 17°E Dip: -45°

Core located in core shed on License of Occupation land - Derosier.

Core Logged and read by: E. F. Roy, Geologist

Distance (feet)		Geology
From	To	
0	17	Casing thru overburden.
17	147	Mottled textured, dark green-gray, diorite with coarse white phenocrysts and contains only weak disseminations of pyrite. Chalcopyrite noted.
147	154	Very fine grained, medium gray, andesite dike.
154	245	Mottled textured diorite with weak disseminations of blotchy pyrite. Chlorite and pyrite increase in amount - downward.
245	270	Dense fine grained, gray green chlorite rock with some massive sulfide replacement from 249 to 260. Massive sulfides mostly pyrite though chalcopyrite was easily identified.
270	285	Medium gray mottled, fragmental textured rhyolite with only weak disseminations of pyrite and chalcopyrite
		Hole goes beneath lake and claim No. T32,246 at this point.
285	450	Rhyolite as described in interval immediately preceding.
285		Hole crosses under claim No. T 32,164 at this depth.
450	530 (Bottom)	Same rhyolite but with fragmental or agglomeratic texture.

Hole was drilled By: Canadian Longyear Limited, North Bay, Ontario
September-October, 1952

Work Supervised By: Frontenac Exploration and Dev. Co. Ltd.
W.T.Swensen - E.H.Eakland, Geologists

Log of Geology Hole No. 68

132164

32R

Hole drilled in area of previous Knight-Derosier Drilling:

Dearing of hole: S 38°E Dip: - 45°

Core Located in core shed on the Derosier License Of Occupation land.

Core logged and read by: E.H. Bakland and R. Roy, Geologists.

From 0 to 8 feet: Casing - thru Overburden:

From 8 to 98 Feet: Variable textured, dark green, diorite containing scattered blebs of disseminated pyrite with chalcopyrite noted.

From 98 to 126 Feet: Very dark grey-green, dense, chlorite rock with massive sulfide replacement mineralization. Chalcopyrite makes up very small part of the sulfides - pyrite almost the entire composition.

From 126' to 216': Light grey, mottled textured rhyolite locally weakly chloritized and containing very weak disseminations of sulfides - mostly pyrite.

Hole drilled by Canadian Longyear Limited of North Bay, Ontario

September- October, 1952

Work Supervised by: Frontenac Exploration and Development Company; W.T. Swensen, E.H. Bakland Geologists

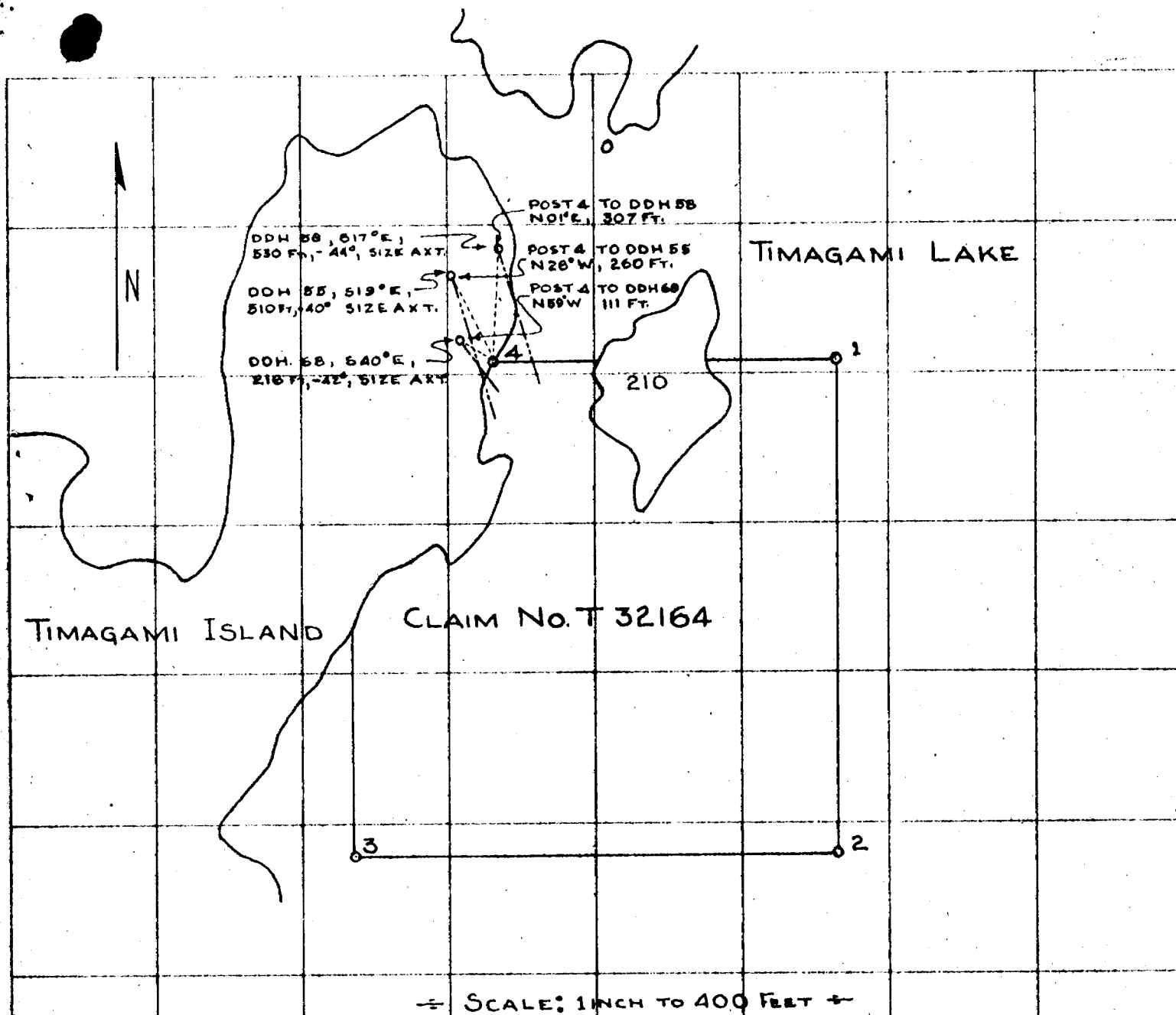

PLAN SHOWING LOCATION OF D.D. HOLES 55, 58, & 68

ASSESSMENT WORK TO BE APPLIED TO THE FOLLOWING
FIVE CONTIGUOUS MINING CLAIMS: T-32164, 32259
32260, 32262, 32313, 32288, & T 32289

EDW 31 OCT 1962