



41116NE0054 11 PHYLLIS

Diamond Drilling

010

Township of PHYLLIS

Report NO 11

Work performed by: Frontenac Exploration

Claim NO	Hole NO	Footage	Date	Note
T 31621	84	461.0'	Oct/52	

Notes:

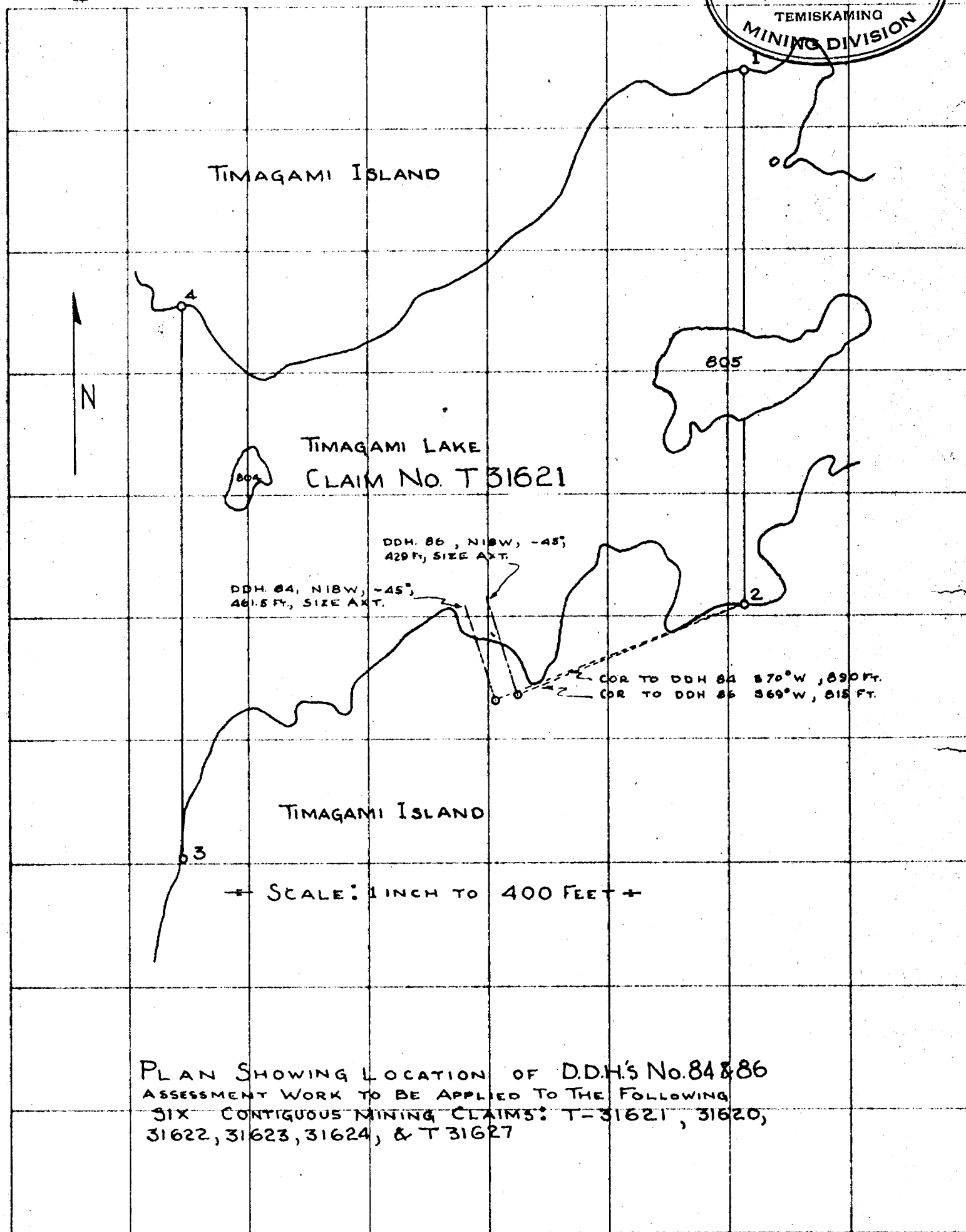

Log Of Diamond Drill Hole 84

Drilled by Canadian Longyear for Frontenac Exploration & Dev.Co.Ltd.

Hole Drilled on Derosier License of Occupation Land - beneath  
Lake Temagami under claim No. T 31,621

Length of Hole: 461' (portion under claim 31,621 - 174')

Inclination: - 45° Bearing: N 13-57 W

Core stored in core shed - Temagami Island - License of Occupation

Size Core: AXT Core Logged by: J. L. Kelly, Geologist

Date Drilled: October, 1952

Core Log

Dist.(Feet)		Geology
From	To	
0	10	Glacial debris - Cased.
10	30	Gray, fine grained, even textured, rhyolite cut by numerous narrow seams of chlorite and white carbonate and quartz. Chlorite increases downward.
30	65	Medium dark green, strongly chloritic rock with evenly distributed small blebs of white corroded carbonate phenocrysts, indistinct altered feldspars, porphyritic appearance - probably diorite. Area contains specks splotches, etc; of sandy pyrite - oxidized in place.
<del>65</del>	92	Chloritized rhyolite(?); even texture, darkgray color.
92	130	Dense, fine grained, dark gray-green chlorite rock containing massive blebs and bunches of pyrite and a little chalcopyrite.
130	319	Dense, fine grained, evenly granular, gray-greenish rhyolite. Rock contains scattered seams of white carb. and quartz and occasional thin seam of pyrite.
319	337	Porphyritic diorite: indistinct pale green feldspars, in strongly chloritic groundmass and scattered corroded bleby carbonate. Weakly disseminated blebs of pyrite.
337	350	Strongly chloritized diorite with blebs and splotches of pyrite.
350	370	Grey-greenish, fine grained, andesite dike.
370	461	Fine grained diorite cut by numerous thin quartz stringers and seams; zones of weak disseminated blebs of pyrite.
(Bottom)		

