



41116NE0060 33 PHYLLIS

010

Diamond Drilling

Township of PHYLLIS

Report NO 33

Work performed by: Temagami Mining Company

Claim NO	Hole NO	Footage	Date	Note
T 49861	SK-16	242.0'	Dec/65	

Notes:

12400W

11400W

8400W

6400W

4400W

2400W

0400

T 49861

T 32489

T 32490

SK-16
-50°



SBR

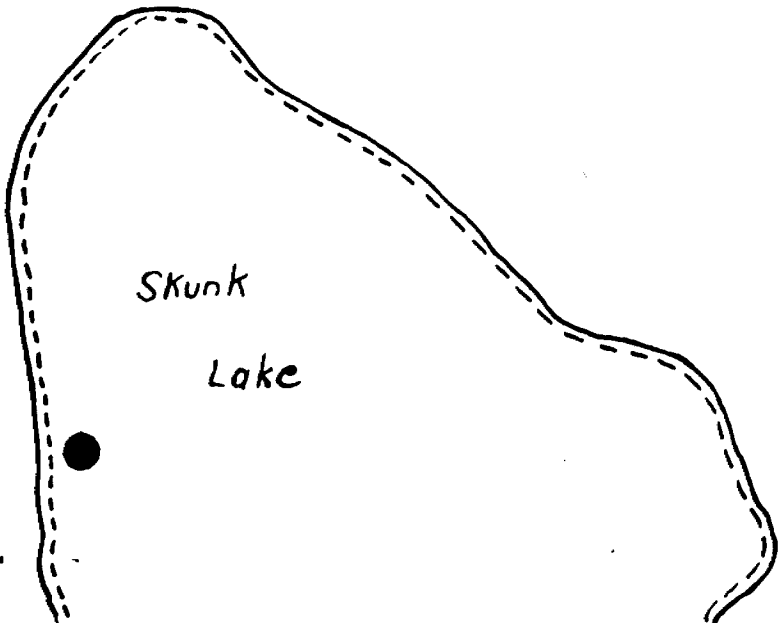

Skunk
Lake

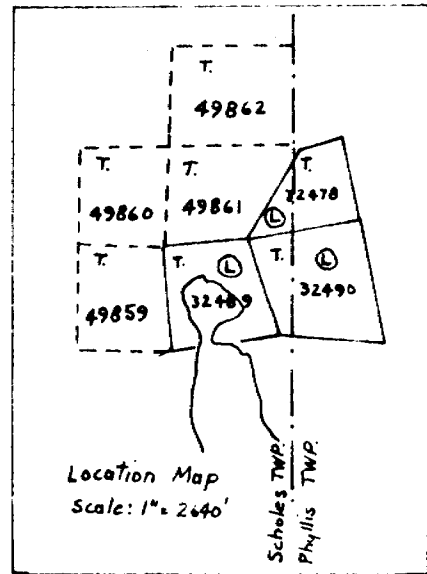

PLAN SHOWING
D.D.H. SK-16
TEMAGAMI MINING CO LIMITED
SCHOLES TWP.
Scale: 1" = 200'

SCHOLES
TWP.

PHYLLIS
TWP.

DIAMOND DRILL RECORD

Phyllis Twp.

508

PROPERTY SKUNK LAKE GROUP

HOLE NO. SK-16

SHEET NUMBER 1

SECTION FROM _____ TO _____

STARTED November 24, 1965

LATITUDE 205 feet N. of Post #2,
Claim 49860

DATUM _____

COMPLETED December 16, 1965.

DEPARTURE 25 feet W. of Post #2
Claim 49860

BEARING _____

ULTIMATE DEPTH 242

ELEVATION Township of Scholes,
Temiskaming Mining Division

DIP Vertical

PROPOSED DEPTH 240

DEPTH FEET	FORMATION	SAMPLE NO.	WIDTH OF SAMPLE				
0.0	Start of hole						
32.0	AX Casing - overburden of sand						
55.0	EX Casing - gravel and boulders						
82.0	Diabase - (Nipissing) medium grained grey, green, fairly massive uniform, joints at 45°, 30° and along core.						
82.1	Quartz carbonate stringer specs, pyritic, chalcopryrite, lower contact 45°						
88.5	Diabase becoming finer grained towards indistinct contact approximately located at 88.5 feet						
97.0	Argillite (Cobalt Sediments) with chlorite, alteration and small grained pebbles to 5 per cent and one inch. Poor bedding planes, generally at 20° to core axis.						
100.5	Argillite as at 97.0 but with heavy chloritization and distinct carbonate laths to 5 per cent.						
129.4	Argillite as at 97.0						
131.4	Lost core						
137.8	Argillite as at 100.5						
	Lost core at 133.6 - 136.0						
147.0	Argillite as at 97.0						
	Lost core at 139.0 to 140.0, 141.0 to 143.0, 144.0 to 145.0,						
181.5	Argillite as at 100.5. Bedding generally at 30°						
	Lost core at 149.1 to 152.3						
	155.0 to 156.2						
	158.2 to 161.6						
	163.5 to 167.1						
	168.7 to 171.4						
	173.7 to 174.3						
	178.4 to 180.6						

RECEIVED

TIMISKAMING MINING DIV.

DEC 30 1965

AM 7 8 9 10 11 12 1 2 3 4 5 6 PM

NUGGET-3566-2M

DRILLED BY Geophysical Engineering & Surveys Ltd.,

SIGNED

R. E. E. L.

602

DIAMOND DRILL RECORD

PROPERTY _____ HOLE NO. _____

SHEET NUMBER 2 SECTION FROM _____ TO _____ STARTED _____

LATITUDE _____ DATUM _____ COMPLETED _____

DEPARTURE _____ BEARING _____ ULTIMATE DEPTH _____

ELEVATION _____ DIP _____ PROPOSED DEPTH _____

DEPTH FEET	FORMATION	SAMPLE NO.	WIDTH OF SAMPLE				
181.4	Argillite as at 97.0 Bedding at 30°						
199.2	Argillite as at 100.5 Bedding at 30°						
	Lost core at 185.3 to 185.9						
	191.6 to 194.5						
200.0	Lost core						
242.0	Argillite as at 100.5						
	Lost core at 226.3 to 228.5						
242.0	Foot of Hole						
<p>NOTE: 32 feet AX Casing) Left in Hole</p> <p>55 feet EX Casing) Left in hole</p>							

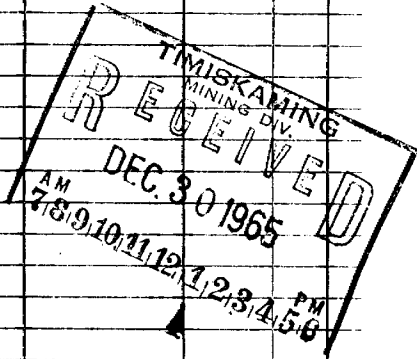

NUGGET-3566-2M

DRILLED BY Geophysical Engineering & Surveys Ltd.

SIGNED R. V. H. Linn

Surface

Overburden
Sand, Gravel,
Large Boulders

Diabase (N. dipping)

Arg. llite (Cobalt)

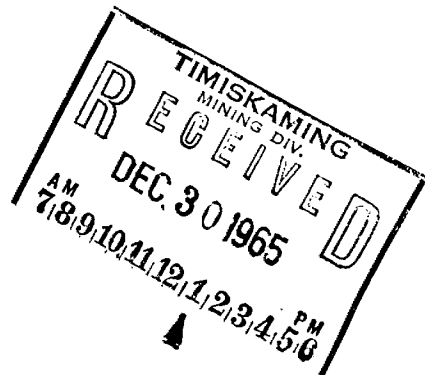

Section of DDH - SK-16
for
Copperfields Mining Corp
Township of Scholes
Scale 1" = 40 FEET

R. W. Mc Linn Dec 1965

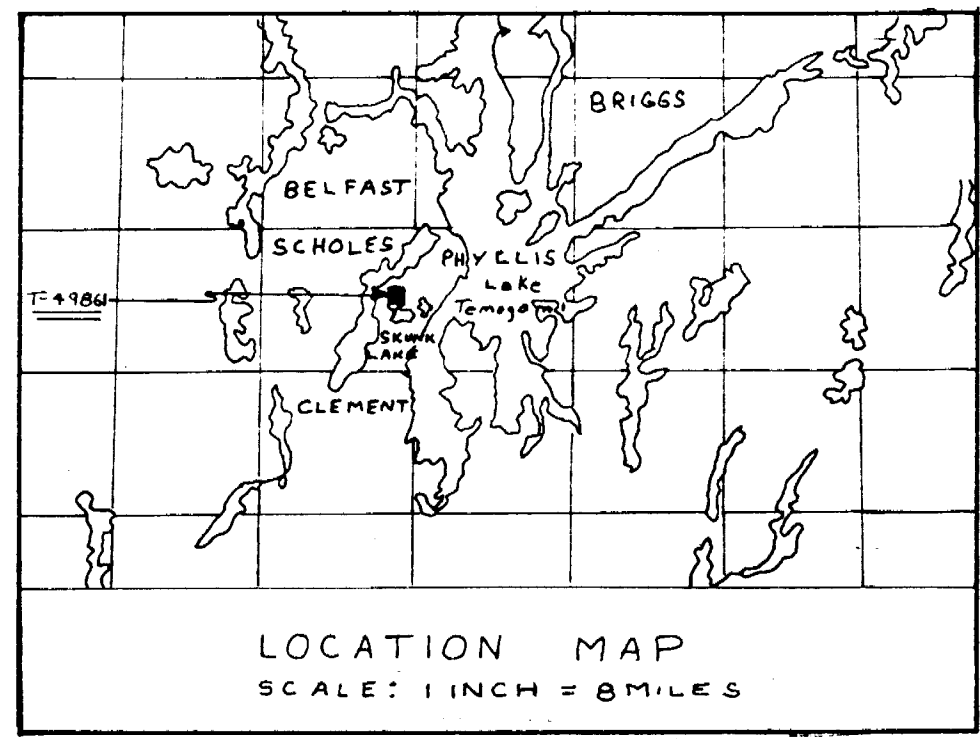
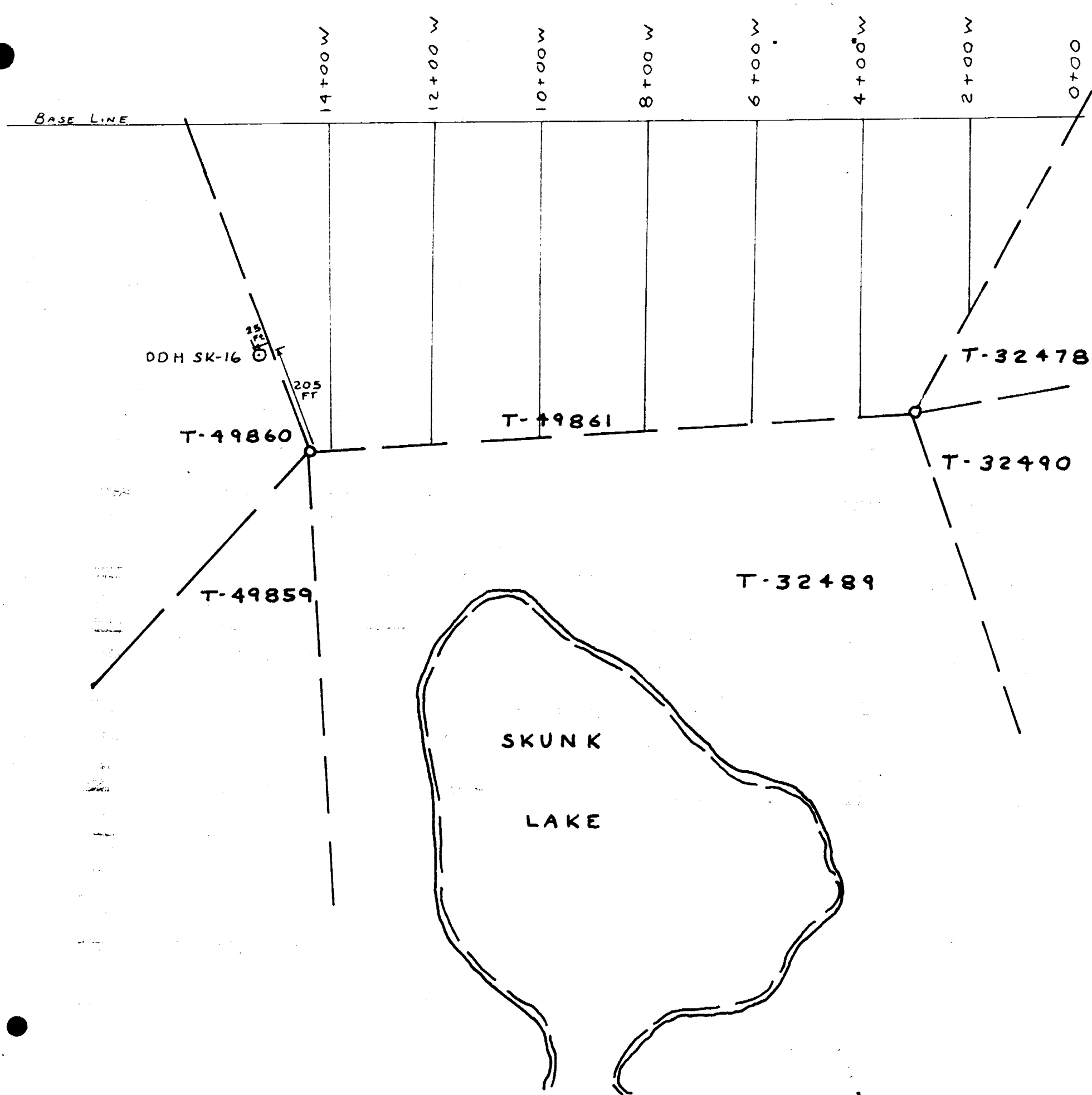

LOCATION SKETCH
 of
 D. D. H. SK-16 on CLAIM T-49860
 TOWNSHIP of SCHOLES
 for
 COPPERFIELDS MINING CORP.
 Temiskaming Mining Division
 SALE 1" = 200 FT

R. S. G. Linn Dec 1965